

Garden City Field Office
2508 Johns Street
Garden City, Kansas 67846-2804

Jackie McClaskey, Secretary
David W. Bartfield, Chief Engineer
Michael A. Meyer, Water Commissioner

Kansas

Department of Agriculture
Division of Water Resources

Phone: (620) 276-2901
Fax: (620) 276-9315
www.agriculture.ks.gov
Sam Brownback, Governor

April 25, 2017

CLAWSON LAND PARTNERSHIP
PO BOX 279
PLAINS KS 67869

RE: Change in Point of Diversion Water Right, File No 6846

Dear Mr. Clawson:

Enclosed you will find a *Summary Order Approving Application for Change in Point of Diversion* for the above referenced file. This order modifies the authorized well location under the referenced file. This order modifies the original document; it should be recorded at the County Register of Deeds.

Your attention is directed to the enclosures and to the terms, conditions, and limitations specified in this order. The diversion works should be completed and reported to the Division of Water Resources by **December 31, 2017**. Enclosed is a form for this purpose, along with other information for reference.

A condition of this order is that an acceptable flow meter must be properly installed on the diversion works authorized under the referenced file number in accordance with the Kansas Administrative Regulations 5-1-4 through 5-1-12. This water flow meter shall be used to provide information required on the annual water use report.

This order shall become final if a request for a hearing is not filed with the Chief Engineer within 15 days of the date of service of this order. The date of service is the date listed on the enclosed *Certificate of Service*.

Should you have any questions, please feel free to call this office. If you would prefer, you could arrange an appointment for additional assistance.

Sincerely,

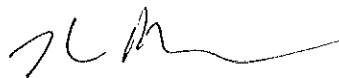

Thomas P. Makens
Assistant Water Commissioner

TPM:tpm
Enclosures
GMD#3

CERTIFICATE OF SERVICE

On this 27th day of April 2017, I hereby certify that the attached original Approval of Application to Change the Point of Diversion under Water Right, File No. 6846 dated April 25, 2017 was mailed postage prepaid, first class, US mail to the following:

CLAWSON LAND PARTNERSHIP
PO BOX 279
PLAINS KS 67869

Copy provided to GMD#3

A handwritten signature in black ink, appearing to be 'JLR', written over a horizontal line.

Division of Water Resources

Submit completed application to:
 Kansas Department of Agriculture
 Division of Water Resources
 Field Office for your area.
 Call for address:

Topeka -- (785) 296-5733
 Stafford -- (620) 234-5311
 Stockton -- (785) 425-6787
 Garden City -- (620) 276-2901
<http://agriculture.ks.gov/dwr>

DWR FIELD OFFICE APPLICATION FOR APPROVAL TO CHANGE THE PLACE OF USE AND/OR THE POINT OF DIVERSION



STATE OF KANSAS

Filing Fee Must Accompany the Application, K.S.A. 82a-708b(b), as amended.
 Fee Schedule is on the third page of this application form.

Paragraph Nos. 1, 2, 3 & 5 must be completed. Complete all other applicable portions. If change in point of diversion is greater than 100 feet, or if place of use will be changed, include a topographic map or detailed plat showing the authorized and proposed point(s) of diversion and/or place of use.

 File No. 6846

RECEIVED
 8:15 AM
 MAR 23 2017

1. Application is hereby made for approval of the Chief Engineer to change the (check one or both):
 Place of Use Point of Diversion
 under the water right which is the subject of this application in accordance with the conditions described below.
 The source of supply is: Groundwater Surface water

Garden City Field Office
 DIVISION OF WATER RESOURCES

2. Name and address of Applicant: CLAWSON LAND PARTNERSHIP
PO BOX 279 PLAINS KS 67869
 Phone Number: (620)482-3260 Email address: _____
 Name and address of Water Use Correspondent: CLAWSON LAND PARTNERSHIP
PO BOX 279 PLAINS KS 67869
 Phone Number: () _____ Email address: _____

3. The presently authorized place of use is:
 Owner of Land ---- NAME: CLAWSON LAND PARTNERSHIP
 ADDRESS: PO BOX 279 PLAINS KS 67869
 (If there is more than one landowner, attach supplemental sheets as necessary.)

Sec.	Twp.	Range	NE¼				NW¼				SW¼				SE¼				TOTAL ACRES	
			NE¼	NW¼	SW¼	SE¼	NE¼	NW¼	SW¼	SE¼	NE¼	NW¼	SW¼	SE¼	NE¼	NW¼	SW¼	SE¼		

4. If this application is for a change in place of use, it is proposed that the place of use be changed to:
 Owner of Land ---- NAME: no change to acres
 ADDRESS: _____
 (If there is more than one landowner, attach supplemental sheets as necessary.)

Sec.	Twp.	Range	NE¼				NW¼				SW¼				SE¼				TOTAL ACRES	
			NE¼	NW¼	SW¼	SE¼	NE¼	NW¼	SW¼	SE¼	NE¼	NW¼	SW¼	SE¼	NE¼	NW¼	SW¼	SE¼		

For Office Use Only: Code _____ Fee \$ 100 TR # _____ Receipt Date 3/21/17 Check # 15290

5. **Presently authorized point of diversion:**
 One in the nw Quarter of the nw Quarter of the nw Quarter
 of Section 16 , Township 31 South, Range 32 W,
 in Seward County, Kansas, 4635 feet North 5225 feet West of Southeast corner of section.
 Authorized Rate _____ Authorized Quantity _____ Depth of well _____ (feet)
 (DWR use only: Computer ID No. 1 GPS _____ feet North _____ feet West)
 This point will not be changed This point will be changed as follows:
Proposed point of diversion: (Complete only if change is requested)
 One in the sw Quarter of the nw Quarter of the nw Quarter
 of Section 16 , Township 31 South, Range 32 W,
 in Seward County, Kansas, 4375 feet North 5222 feet West of Southeast corner of section.
 Proposed Rate _____ Proposed Quantity _____ Proposed well depth (feet) 575
 This point is: Additional Well Geo Center List other water rights that will use this point _____

6. **Presently authorized point of diversion:**
 One in the _____ Quarter of the _____ Quarter of the _____ Quarter
 of Section _____, Township _____ South, Range _____ (E/W),
 in _____ County, Kansas, _____ feet North _____ feet West of Southeast corner of section.
 Authorized Rate _____ Authorized Quantity _____ Depth of well _____ (feet)
 (DWR use only: Computer ID No. _____ GPS _____ feet North _____ feet West)
 This point will not be changed This point will be changed as follows:
Proposed point of diversion: (Complete only if change is requested)
 One in the _____ Quarter of the _____ Quarter of the _____ Quarter
 of Section _____, Township _____ South, Range _____ (E/W),
 in _____ County, Kansas, _____ feet North _____ feet West of Southeast corner of section.
 Proposed Rate _____ Proposed Quantity _____ Proposed well depth (feet) _____
 This point is: Additional Well Geo Center List other water rights that will use this point _____

7. Why do you need a new point of diversion? _____
old well needs to be replaced

8. If a well, is the test hole log attached? Yes No

9. When do you propose to complete the new point of diversion?
April 15, 2017

10. If the point of diversion is a well:
 (a) What are you going to do with the old well?
plug
 (b) When will this be done? 2017

11. Groundwater Management District recommendation attached? Yes No

12. Assisted by lpm

13a. If the proposed point of diversion will be relocated within 100 feet of the existing point of diversion, indicate its location on the diagram below in relation to the existing point of diversion. (PLEASE NOTE: The "X" in center of diagram below represents presently authorized point of diversion.)

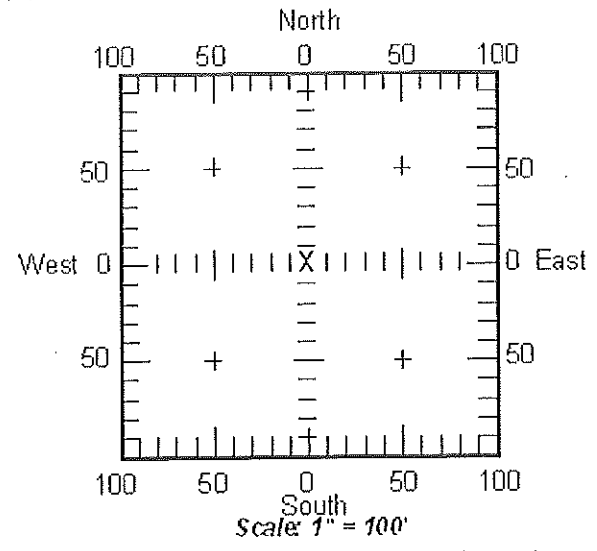

13b. If the proposed point of diversion will be relocated more than 100 feet but within 1320 feet from the existing point of diversion, attach a topographic map or aerial photograph. For groundwater sources, show all wells (including domestic) within one-half mile of the proposed point of diversion and the names and mailing addresses of the owners. For surface water sources, show the names and addresses of the landowner(s) one-half mile downstream and one-half mile upstream from your property lines.

TOPO! map printed on 03/15/17 from "Untitled.tpo"

100.81667° W

NAD27 100.80000° W

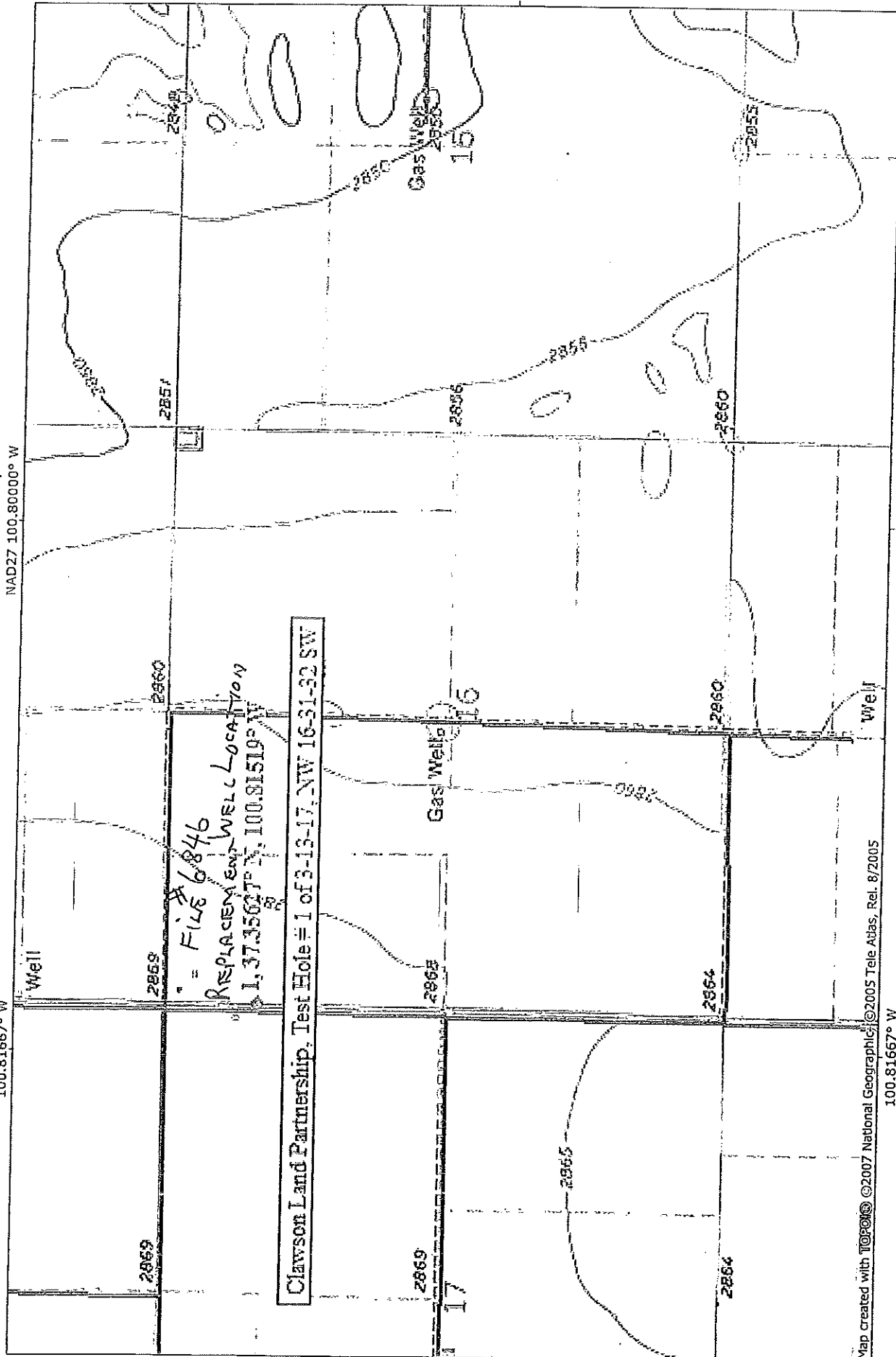

37.35000° N

37.35000° N

Map created with TOPO! ©2007 National Geographic ©2005 Tele Atlas, Rel. 8/2005

100.81667° W

NAD27 100.80000° W

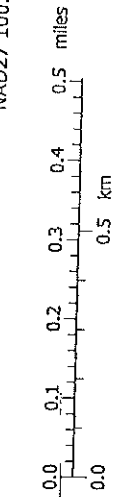

NATIONAL GEOGRAPHIC

TN MN 57.2° 03/15/17

