

Kansas Department of Agriculture  
 Division of Water Resources  
**CHANGE: P/D WORKSHEET**

1. File Number: <b>10734</b>	2. Status Change Date: <b>6/21/18</b>	3. Change Num: <b>C2</b>	4. Field Office: <b>04</b>	5. GMD: <b>03</b>
---------------------------------	--	-----------------------------	-------------------------------	----------------------

6. Status: <input checked="" type="checkbox"/> Approved <input type="checkbox"/> Denied by DWR/GMD <input type="checkbox"/> Dismiss by Request/Failure to Return	7. Filing Date of Change: <b>5/8/18</b>
--	--

8a. Applicant(s) New to system <input type="checkbox"/>	Person ID <b>63217</b> Add Seq# <b>1</b>
<b>GOODEN ENTERPRISE LLC          JOSHUA J GOODEN          109 W 9TH ST          SCOTT CITY KS 67871-1561</b>	

8c. Landowner(s) New to system <input type="checkbox"/>	Person ID <b>36777</b> Add Seq# <b>1</b>
<b>ARCHIE L &amp; SUSIE E GOODEN          485 E MEAD RD          GARDEN CITY KS 67846-9379</b>	

8b. Landowner(s) New to system <input type="checkbox"/>	Person ID <b>63217</b> Add Seq# <b>1</b>
<b>GOODEN ENTERPRISE LLC          JOSHUA J GOODEN          109 W 9TH ST          SCOTT CITY KS 67871-1561</b>	

8d. WUC New to system <input type="checkbox"/>	Person ID <b>36777</b> Add Seq# <b>1</b>
<b>ARCHIE L &amp; SUSIE E GOODEN          485 E MEAD RD          GARDEN CITY KS 67846-9379</b>	

9. Documents and Enclosure(s): <input checked="" type="checkbox"/> DWR Meter(s) Date to Comply: <b>12/31/18</b> <input checked="" type="checkbox"/> N & P Date to Comply: <b>12/31/18</b>	
<input type="checkbox"/> Anti-Reverse Meter <input type="checkbox"/> Meter Seal <input type="checkbox"/> Check Valve <input type="checkbox"/> N & P Form <input type="checkbox"/> Water Tube <input type="checkbox"/> Driller Copy <input type="checkbox"/> H & E Letter <input type="checkbox"/> Conservation Plan    Date Required: _____    Date Approved: _____    Date to Comply: _____	

10. Use Made of Water    From: _____	To: _____
--------------------------------------	-----------

Date Prepared: <b>6/11/18</b>	By: <b>TPM</b>
Date Entered: _____	By: _____

File No. **10734** 11. County: **FI** Basin: **ark** Stream: \_\_\_\_\_ Formation Code: **211** Special Use: \_\_\_\_\_

12. Points of Diversion  
 Rate and Quantity  
 Authorized Additional  
 Rate Quantity Rate Quantity  
 gpm/cfs af/mgy gpm/cfs af/mgy  
 Comment (AKA Line) 'W 'N 'W 814  
 ent sw sw sw 18 21 32w 940 814  
 del 10702

13. Storage: Rate \_\_\_\_\_ NF \_\_\_\_\_ Quantity \_\_\_\_\_ ac/ft Additional Rate \_\_\_\_\_ NF \_\_\_\_\_ Additional Quantity \_\_\_\_\_ ac/ft

14. Limitation: \_\_\_\_\_ af/yr at \_\_\_\_\_ gpm ( \_\_\_\_\_ cfs) when combined with file number(s) \_\_\_\_\_  
 Limitation: \_\_\_\_\_ af/yr at \_\_\_\_\_ gpm ( \_\_\_\_\_ cfs) when combined with file number(s) \_\_\_\_\_

15. 5YR Allocation: Allocation Type \_\_\_\_\_ Start Year \_\_\_\_\_ 5 YR Amount \_\_\_\_\_ Amount Unit \_\_\_\_\_ Base Acres \_\_\_\_\_ Comment \_\_\_\_\_

16. Place of Use CHK MOD DEL ENT	P U S E	S T R I D	NE 1/4			NW 1/4			SW 1/4			SE 1/4			Total	Owner	Chg?	Overlap Files
			NE 1/4	SW 1/4	SE 1/4	NW 1/4	SW 1/4	SE 1/4	NE 1/4	NW 1/4	SW 1/4	SE 1/4	NE 1/4	NW 1/4				
NC																		

Base Acres: \_\_\_\_\_ Year: \_\_\_\_\_ Minimum Reasonable Quantity: \_\_\_\_\_  
 Comments: \_\_\_\_\_

STATE OF KANSAS

DEPARTMENT OF AGRICULTURE  
DIVISION OF WATER RESOURCES  
GARDEN CITY FIELD OFFICE  
2508 JOHNS STREET  
GARDEN CITY, KS 67846-2804



PHONE: (620) 276-2901  
FAX: (620) 276-9315  
www.agriculture.ks.gov

GOVERNOR JEFF COLYER, M.D.  
JACKIE MCCLASKEY, SECRETARY OF AGRICULTURE

June 21, 2018

GOODEN ENTERPRISE LLC  
JOSHUA J GOODEN  
109 W 9TH ST  
SCOTT CITY KS 67871-1561

RE: Change in Point of Diversion Water Right, File No 10734

Dear Mr. Gooden:

Enclosed you will find a *Summary Order Approving Application for Change in Points of Diversion* for the above referenced file. This order modifies the authorized well location under the referenced file. This order modifies the original document; it should be recorded at the County Register of Deeds.

Your attention is directed to the enclosures and to the terms, conditions, and limitations specified in this order. The diversion works should be completed and reported to the Division of Water Resources by **December 31, 2018**. Enclosed is a form for this purpose, along with other information for reference.

A condition of this order is that an acceptable flow meter must be properly installed on the diversion works authorized under the referenced file number in accordance with the Kansas Administrative Regulations 5-1-4 through 5-1-12. This water flow meter shall be used to provide information required on the annual water use report.

This order shall become final if a request for a hearing is not filed with the Chief Engineer within 15 days of the date of service of this order. The date of service is the date listed on the enclosed *Certificate of Service*.

Should you have any questions, please feel free to call this office. If you would prefer, you could arrange an appointment for additional assistance.

Sincerely,

A handwritten signature in black ink, appearing to read "Thomas P. Makens".

Thomas P. Makens  
Assistant Water Commissioner

TPM:tpm  
Enclosures

GMD#3

**CERTIFICATE OF SERVICE**

On this 22<sup>nd</sup> day of June 2018, I hereby certify that the attached original Approval of Application to Change the Point of Diversion under Water Right, File No. 10734 dated June 21, 2018 was mailed postage prepaid, first class, US mail to the following:

GOODEN ENTERPRISE LLC  
JOSHUA J GOODEN  
109 W 9TH ST  
SCOTT CITY KS 67871-1561

Copy provided to GMD#3

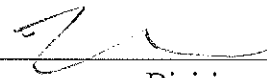

---

Division of Water Resources

Submit completed application to:  
 Kansas Department of Agriculture  
 Division of Water Resources  
 Field Office for your area.

Call for address:

Topeka -- (785) 296-5733  
 Stafford -- (620) 234-5311  
 Stockton -- (785) 425-6787  
 Garden City -- (620) 276-2901  
<http://agriculture.ks.gov/dwr>

## DWR FIELD OFFICE APPLICATION FOR APPROVAL TO CHANGE THE PLACE OF USE AND/OR THE POINT OF DIVERSION



STATE OF KANSAS

Filing Fee Must Accompany the Application, K.S.A. 82a-708b(b), as amended.  
 Fee Schedule is on the third page of this application form.

Paragraph Nos. 1, 2, 3 & 5 must be completed. Complete all other applicable portions. If change in point of diversion is greater than 100 feet, or if place of use will be changed, include a topographic map or detailed plat showing the authorized and proposed point(s) of diversion and/or place of use.

RECEIVED

10:40 AM  
 MAY 08 2018

File No. 10734

1. Application is hereby made for approval of the Chief Engineer to change the (check one or both):  
 Place of Use :                       Point of Diversion  
 under the water right which is the subject of this application in accordance with the conditions described below.  
 The source of supply is:                       Groundwater                       Surface water

Garden City Field Office  
 Division of Water Resources

2. Name and address of Applicant: GOODEN ENTERPRISE LLC JOSHUA J GOODEN  
109 W 9TH ST SCOTT CITY KS 67871-1561  
 Phone Number: (    )                      Email address: \_\_\_\_\_  
 Name and address of Water Use Correspondent: ARCHIE L & SUSIE E GOODEN  
485 E MEAD RD GARDEN CITY KS 67846-9379  
 Phone Number: (    )                      Email address: \_\_\_\_\_

3. The presently authorized place of use is:  
 Owner of Land ---- NAME: ARCHIE L & SUSIE E GOODEN GOODEN ENTERPRISE LLC  
 ADDRESS: 1                      2                      3  
 (If there is more than one landowner, attach supplemental sheets as necessary.)

Sec.	Twp.	Range	NE¼				NW¼				SW¼				SE¼				TOTAL ACRES	
			NE¼	NW¼	SW¼	SE¼	NE¼	NW¼	SW¼	SE¼	NE¼	NW¼	SW¼	SE¼	NE¼	NW¼	SW¼	SE¼		

4. If this application is for a change in place of use, it is proposed that the place of use be changed to:  
 Owner of Land ---- NAME: no change to acres irrigated  
 ADDRESS: \_\_\_\_\_  
 (If there is more than one landowner, attach supplemental sheets as necessary.)

Sec.	Twp.	Range	NE¼				NW¼				SW¼				SE¼				TOTAL ACRES	
			NE¼	NW¼	SW¼	SE¼	NE¼	NW¼	SW¼	SE¼	NE¼	NW¼	SW¼	SE¼	NE¼	NW¼	SW¼	SE¼		

For Office Use Only: Code \_\_\_\_\_ Fee \$ 200 TR # \_\_\_\_\_ Receipt Date 5/8/18 Check # 1875

5. **Presently authorized point of diversion:**  
 One in the sw Quarter of the sw Quarter of the sw Quarter of Section 17, Township 21 South, Range 32 W, in Finney County, Kansas, \_\_\_\_\_ feet North \_\_\_\_\_ feet West of Southeast corner of section.  
 Authorized Rate \_\_\_\_\_ Authorized Quantity \_\_\_\_\_ Depth of well \_\_\_\_\_ (feet)  
 (DWR use only: Computer ID No. 1 GPS 202 feet North 5054 feet West)  
 This point will not be changed  This point will be changed as follows:  No change, point better described with GPS as follows:  
**Proposed point of diversion: (Complete only if change is requested or if existing point is better described by GPS)**  
 One in the sw Quarter of the sw Quarter of the sw Quarter of Section 18, Township 21 South, Range 32 W, in Finney County, Kansas, 940 feet North 814 feet West of Southeast corner of section.  
 Proposed Rate \_\_\_\_\_ Proposed Quantity \_\_\_\_\_ Proposed well depth (feet) \_\_\_\_\_  
 This point is:  Additional Well  Geo Center List other water rights that will use this point \_\_\_\_\_

6. **Presently authorized point of diversion:**  
 One in the \_\_\_\_\_ Quarter of the \_\_\_\_\_ Quarter of the \_\_\_\_\_ Quarter of Section \_\_\_\_\_, Township \_\_\_\_\_ South, Range \_\_\_\_\_ (E/W), in \_\_\_\_\_ County, Kansas, \_\_\_\_\_ feet North \_\_\_\_\_ feet West of Southeast corner of section.  
 Authorized Rate \_\_\_\_\_ Authorized Quantity \_\_\_\_\_ Depth of well \_\_\_\_\_ (feet)  
 (DWR use only: Computer ID No. \_\_\_\_\_ GPS \_\_\_\_\_ feet North \_\_\_\_\_ feet West)  
 This point will not be changed  This point will be changed as follows:  No change, point better described with GPS as follows:  
**Proposed point of diversion: (Complete only if change is requested or if existing point is better described by GPS)**  
 One in the \_\_\_\_\_ Quarter of the \_\_\_\_\_ Quarter of the \_\_\_\_\_ Quarter of Section \_\_\_\_\_, Township \_\_\_\_\_ South, Range \_\_\_\_\_ (E/W), in \_\_\_\_\_ County, Kansas, \_\_\_\_\_ feet North \_\_\_\_\_ feet West of Southeast corner of section.  
 Proposed Rate \_\_\_\_\_ Proposed Quantity \_\_\_\_\_ Proposed well depth (feet) \_\_\_\_\_  
 This point is:  Additional Well  Geo Center List other water rights that will use this point \_\_\_\_\_

7. The changes herein are desired for the following reasons?  
 (please be specific) \_\_\_\_\_  
 old well needs to be replaced \_\_\_\_\_

8. If a well, is the test hole log attached?  Yes  No

9. The change(s) (was)(will be) completed by?  
May 30, 2018

10. If the point of diversion is a well:  
 (a) What are you going to do with the old well?  
plug  
 (b) When will this be done? 2018

11. Groundwater Management District recommendation attached?  
 Yes  No

12. Assisted by tpm \_\_\_\_\_

13a. If the proposed point of diversion will be relocated more than 300 feet but within 2,640 feet of the existing point of diversion, attach a topographic map or aerial photograph. For groundwater sources, show all wells (including domestic) within one-half mile of the proposed point of diversion and the names and mailing addresses of the owners. For surface water sources, show the names and addresses of the landowner(s) one-half mile downstream and one-half mile upstream from your property lines

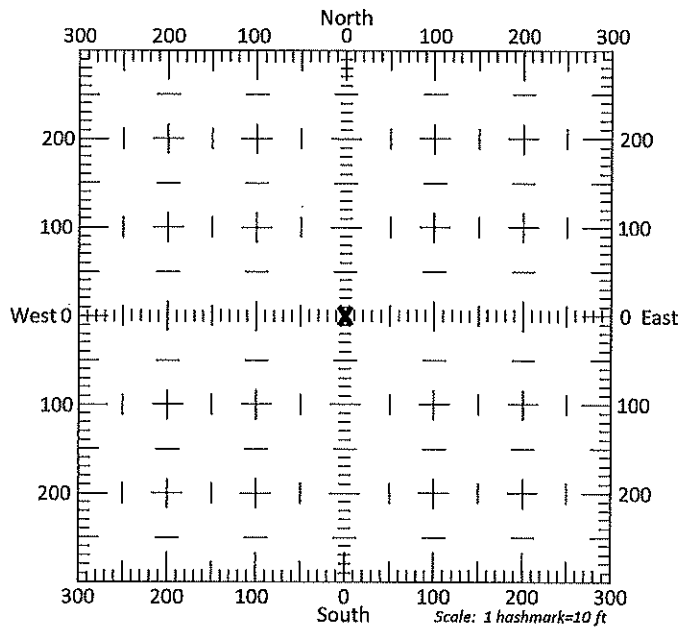

13b. If the proposed point of diversion will be relocated within 300 feet of the existing point of diversion, indicate its location on the diagram shown above in relation to the existing point of diversion. (PLEASE NOTE: The "X" in center of diagram above represents the presently authorized point of diversion.)

14. If the proposed groundwater point of diversion is 300 or fewer feet from the existing point of diversion, complete the following:

- (a) Does the undersigned represent all owners of the currently authorized place(s) of use identified in this application?  
 Yes     No    (If no, all owners must sign this application.)
- (b) Will the ownership interest of any owner of the currently authorized place(s) of use identified in this application be adversely affected if this application is approved as requested?  
 Yes     No    (If yes, all owners must sign this application.)
- (c) If this application is not approved expeditiously, will there be substantial damage to property, public health or safety?  
 Yes     No    (If no, all owners must sign this application.)

If the application proposes a surface water change in point of diversion, a groundwater change in point of diversion greater than 300 feet, or a change in place of use, the application must be signed by all owners of the currently authorized place of use, or their duly authorized agent (attach notarized statement authorizing representation).

I hereby verify, being first duly sworn upon my oath or affirmation and under penalty of perjury, that I am of lawful age and the owner, the spouse of the owner, or a duly authorized agent of the owner(s) to make this application on their behalf, in regards to the water right(s) to which this application pertains. I further verify that the statements contained in this application are true, correct and complete.

Dated at GARDEN CITY, Kansas, this 8<sup>th</sup> day of MAY, 20 18.

X [Signature]  
(Owner)

X [Signature]  
(Spouse)

(Please Print)  
X [Signature]  
(Owner)

(Please Print)  
(Spouse)

(Please Print)  
(Owner)

(Please Print)  
(Spouse)

(Please Print)

(Please Print)

State of Kansas  
County of FINNEY } SS

I hereby certify that the foregoing application was signed in my presence and sworn to before me this 8<sup>th</sup> day of MAY, 20 18.

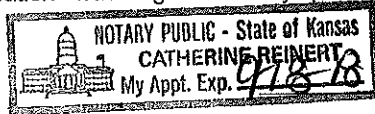

[Signature]  
Notary Public

My Commission Expires 9-18-18

ONLY COMPLETE APPLICATIONS WILL BE PROCESSED. To be complete, all of the applicable portions of the application form must be completed with accurate information; maps, if necessary, must be included; signatures of all the appropriate owners' must be affixed to the application and notarized; and the appropriate fee must be paid.

**FEE SCHEDULE**

Each application to change the place of use or the point of diversion under this section shall be accompanied by the application fee set forth in the schedule below: Make checks payable to: Kansas Department of Agriculture

- (1) Application to change a point of diversion 300 feet or less ..... \$100
- (2) Application to change a point of diversion more than 300 feet ..... \$200
- (3) Application to change the place of use ..... \$200

620-271-8143

**SUMMARY ORDER APPROVING APPLICATION FOR CHANGE AND IMPOSING CONDITIONS**

This Summary Order is issued under authority of K.S.A. 82a-708b, as amended, and K.A.R. 5-5-1, *et seq.* and other applicable provisions of the *Kansas Water Appropriation Law, K.S.A. 82a-701 et seq.*, and rules and regulations promulgated thereunder, With the exception of those conditions expressly contained herein, this Summary Order does not change the terms, conditions and limitations of File No. 21445.

1. A change application was received on MAY 8, 2018 requesting that the place of use and / or point of diversion authorized under the above-referenced file number be changed as described in the application.
2. On and after the effective date of this summary order, the authorized place(s) of use shall be located substantially as shown on the topographic map accompanying the application to change the place of use.  Applicable  Not Applicable
3. The change in point of diversion shall not impair existing rights and shall be limited to the same source or sources of water as previously authorized. The point of diversion authorized by this summary order shall be located within a 300 foot radius of the authorized point(s) of diversion.  Applicable  Not Applicable
4. The point(s) of diversion described herein is administratively corrected to be more accurately described using the Global Positioning System (GPS), as described in the application.  Applicable  Not Applicable
5. The point(s) of diversion authorized herein shall not actually be located more than 2,640 feet from the previously authorized point(s) of diversion.  Applicable  Not Applicable
6. As required by K.A.R. 5-3-5d, if the works for diversion is a well with a diversion rate of 100 gallons per minute or more, a tube or other device suitable for making water level measurements shall be installed, operated and maintained in accordance with K.A.R. 5-6-13.  Applicable  Not Applicable
7. The owner of the authorized place(s) of use shall properly install an acceptable water flow meter on or before **December 31, 2018**, or before the first use of water, whichever occurs first. The water flow meter shall be installed, operated and maintained in accordance with K.A.R. 5-1-4 through 5-1-12. As required by K.S.A. 82a-732, as amended, and K.A.R. 5-3-5e, the owner shall maintain records and report the reading of the water flow meter and the total quantity of water diverted annually to the Chief Engineer by March 1 following the end of each calendar year.  Applicable  Not Applicable
8. Installation of the works for diversion of water shall be completed on or before **December 31, 2018**, or within any authorized extension of time. By March 1, 2019 the applicant shall notify the Chief Engineer that construction of the works for diversion has been completed, on the form provided by the Chief Engineer, as required by K.A.R. 5-8-4e.  Applicable  Not Applicable
9. The completed well log shall be submitted with the required notice.  Applicable  Not Applicable
10. All diversion works into which any type of chemical or other foreign substance will be injected into the water shall be equipped with an in-line, automatic, quick-closing check valve capable of preventing pollution of the source of the water supply. The check valve(s) shall be installed, operated and maintained in accordance with K.A.R. 5-3-5c.  Applicable  Not Applicable
11. Additional Conditions are attached.  Yes  No
12. In accordance with K.S.A. 82a-708a, as amended, and K.A.R. 5-5-14, all of the owners of the authorized place(s) of use of water appropriated under the above-referenced file number are responsible for compliance with its terms, conditions and limitations, as amended and/or supplemented by this Summary Order, and with applicable provisions of the *Kansas Water Appropriation Law* and the *Rules and Regulations* promulgated thereunder. Failure to comply with these provisions may result in civil penalties pursuant to K.S.A. 82a-737, as amended, and/or the suspension or revocation and dismissal of the water or appropriation right or any other enforcement actions authorized by law.

**Administrative Appeal and Effective Date of Order**

If you are aggrieved by this order, pursuant to K.S.A. 82a-1901, you may request an evidentiary hearing before the Chief Engineer or request administrative review by the Secretary of Agriculture. A request for hearing by the Chief Engineer must be filed within **15 days** of service of this Order and a request for administrative review by the Secretary must be filed within **30 days** pursuant to K.S.A. 77-531. Any request for administrative review must state a basis for review pursuant to K.S.A. 77-527. File any request with **Kansas Department of Agriculture, Legal Division, 1320 Research Park Drive, Manhattan, KS 66502**. Failure to timely request a hearing or review may preclude review under the Kansas Judicial Review Act.

*For Use by Register of Deeds*

FOR OFFICE USE ONLY  
**APPLICATION APPROVED AND  
SUMMARY ORDER ISSUED**

By: [Signature]  
Duly Authorized Designee of the Chief Engineer

(Print Name): THOMAS P. MAKENS  
Division of Water Resources - Kansas Department of Agriculture

Date of Issuance: JUNE 21, 2018

State of Kansas )  
County of Finney ) SS

Acknowledged before me on June 21, 2018  
by Thomas P. Makens

Signature: [Signature]  
Notary Public

My commission expires \_\_\_\_\_

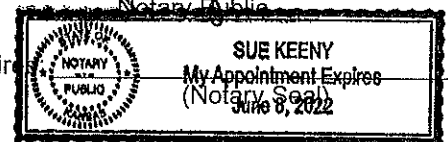



10734

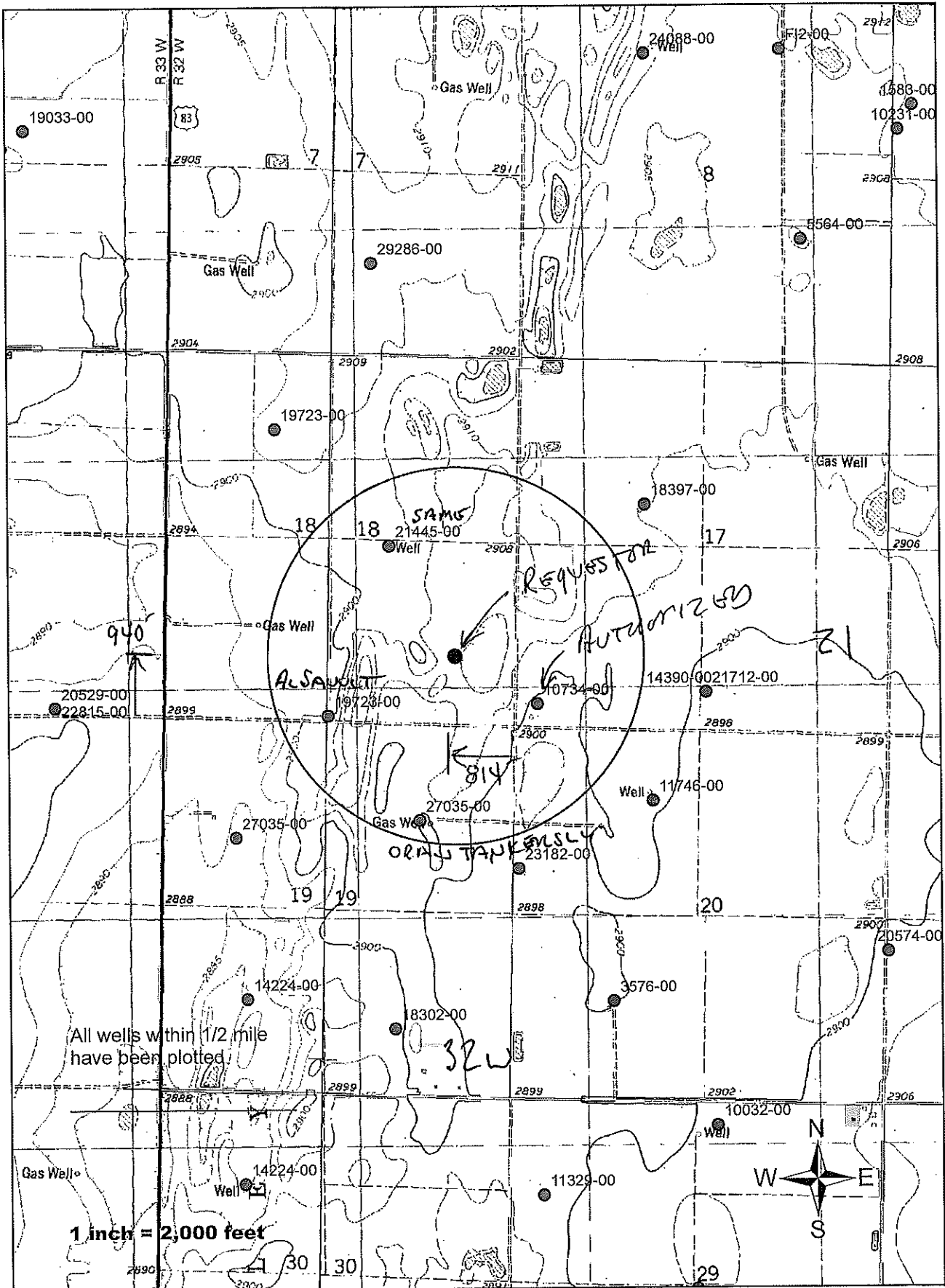

3795 W. Jones Ave.  
 Garden City, KS 67846  
 PH: 620-277-2389



# Hydro

resources

PO Box 639  
 Garden City, KS 67846  
 Fax: 620-277-0224

DR. JOSEPH GOODEN

785-678-8704

APR 28 2018  
 APR 27 2018  
 WDA# 13574

Customer Name: Gooden Enterprises  
 Street Address: 109 W 9th  
 City, State: Scott City, KS 67871  
 County: Finney Quarter: SE Section: 18  
 Location: \_\_\_\_\_  
 Rig #: 10002

Date: 4-26-18  
 E LOG: Yes  
 Test #: 2  
 Driller: Dale Guinn  
 Township: 21 Range: 32

GPS: N38,22420 W100,86864  
 Static WL: 138' Estimated? \_\_\_\_\_  
 Proposed Well Depth: 216  
 POSSIBLE WELL LOCATION: 20' SURF

%	Footage			Description of Strata
	From	Pay	To	
	0		2	Top Soil
	2		8	Brown Sandy Clay
	8		27	Fine sand w/ few clay stringers
	27		53	Brown Sandy Clay
	53		60	Gray Clay
	60		66	Sand fine to med course few small gravel
	66		84	Brown Clay w/ some caliche strips
	84		90	Lime Rock & cemented sand
	90		106	Light Green Sand w/ few lime rock
	106		111	Sand fine to med course
	111		120	Fine sand w/ few clay stringers - Drilled little tight -
	120		131	Sand fine to med
25	131	10	148	Sand fine to med course
10	148	15	163	Fine sand w/ few clay stringers
5	163	22	185	Sand fine to med w/ many clay stringers
25	185	11	196	Sand fine to med course - Drilled loose -
	196		198	White Clay
	198		206	Yellow Sandstone
	206		220	Black Shale
				095456
				Super Gel X -1
				Benti Plug 3/4 -6
				Perma Plug -1
				10734

100.88333° W

NAD27 100.86667° W

38.2333° N

38.2333° N

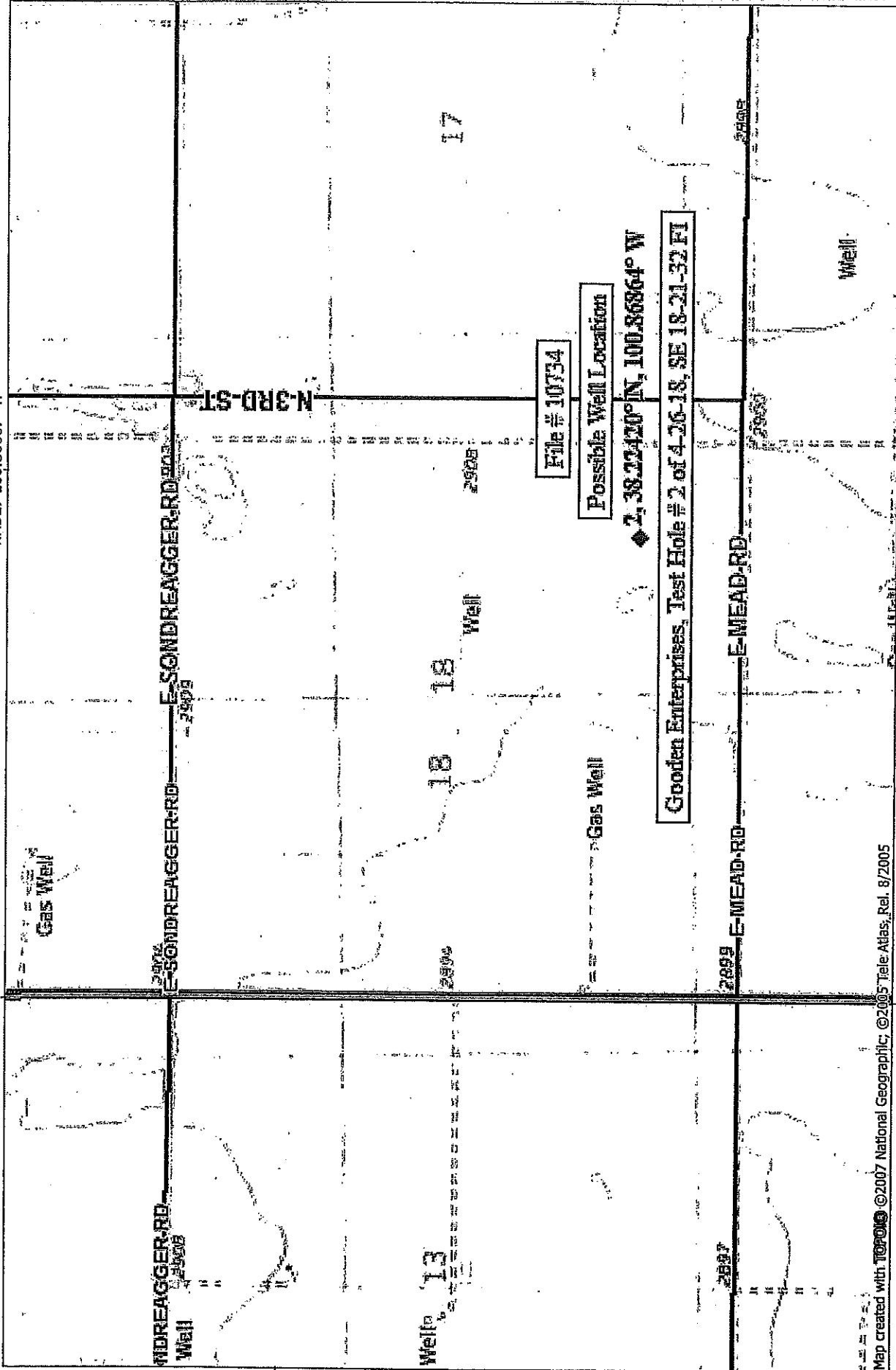

Map created with TOPO! © 2007 National Geographic; © 2005 Tele Atlas, Rel. 8/2005

100.88333° W

NAD27 100.86667° W

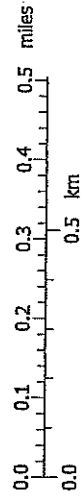

TN MIN 5 1/2"

04/28/18



STATE OF KANSAS

DEPARTMENT OF AGRICULTURE  
DIVISION OF WATER RESOURCES  
GARDEN CITY FIELD OFFICE  
2508 JOHNS STREET  
GARDEN CITY, KS 67846-2804



PHONE: (620) 276-2901  
FAX: (620) 276-9315  
www.agriculture.ks.gov

GOVERNOR JEFF COLYER, M.D.  
JACKIE McCLASKEY, SECRETARY OF AGRICULTURE

May 18, 2018

ALBERT SAVOLT  
2810 N BROADMOOR PL  
GARDEN CITY KS 67846

RE: Water Right 10734

Dear Mr. Savolt:

This is to advise you that the Archie Gooden has filed an application for approval of the Chief Engineer, Division of Water Resources, Kansas Department of Agriculture, to change the point of diversion under the above referenced application.

You can find the complete application posted by water right file number as referenced above at [www.agriculture.ks.gov/divisions-programs/dwr/water-appropriation/notices](http://www.agriculture.ks.gov/divisions-programs/dwr/water-appropriation/notices)

You are notified on this proposed change in point of diversion so that you may furnish this office with any comments or other information you may want to submit. Such comments or other information must be received in this office within 15 days from the date of this letter.

Should you have any questions, please feel free to call this office. If you would prefer, an appointment could be arranged for additional assistance. Please refer to the file number when you contact us if you wish to discuss a specific file.

Sincerely,

Thomas P. Makens  
Environmental Scientist III

pc: GMD#3



STATE OF KANSAS

DEPARTMENT OF AGRICULTURE  
DIVISION OF WATER RESOURCES  
GARDEN CITY FIELD OFFICE  
2508 JOHNS STREET  
GARDEN CITY, KS 67846-2804



PHONE: (620) 276-2901  
FAX: (620) 276-9315  
www.agriculture.ks.gov

GOVERNOR JEFF COLYER, M.D.  
JACKIE McCLASKEY, SECRETARY OF AGRICULTURE

May 18, 2018

ORAN TANKERSLEY  
5461 W ROAD 90  
SCOTT CITY KS 67871

RE: Water Right 10734

Dear Mr. Tankersley:

This is to advise you that the Archie Gooden has filed an application for approval of the Chief Engineer, Division of Water Resources, Kansas Department of Agriculture, to change the point of diversion under the above referenced application.

You can find the complete application posted by water right file number as referenced above at [www.agriculture.ks.gov/divisions-programs/dwr/water-appropriation/notices](http://www.agriculture.ks.gov/divisions-programs/dwr/water-appropriation/notices)

You are notified on this proposed change in point of diversion so that you may furnish this office with any comments or other information you may want to submit. Such comments or other information must be received in this office within 15 days from the date of this letter.

Should you have any questions, please feel free to call this office. If you would prefer, an appointment could be arranged for additional assistance. Please refer to the file number when you contact us if you wish to discuss a specific file.

Sincerely,

A handwritten signature in black ink, appearing to read "Thomas P. Makens".

Thomas P. Makens  
Environmental Scientist III

pc: GMD#3





STATE OF KANSAS



DEPARTMENT OF AGRICULTURE  
DIVISION OF WATER RESOURCES  
GARDEN CITY FIELD OFFICE  
2508 JOHNS STREET  
GARDEN CITY, KS 67846-2804

PHONE: (620) 276-2901  
FAX: (620) 276-9315  
www.agriculture.ks.gov

GOVERNOR JEFF COLYER, M.D.  
JACKIE McCLASKEY, SECRETARY OF AGRICULTURE

June 5, 2018

Southwest Kansas Groundwater  
Management District No 3  
409 Campus Drive, Suite 106  
Garden City KS 67846

Re: Water Right file number 10734

Dear Mr. Norquest;

Archie Gooden has applied to relocate the well authorized by the above water right number. There are three neighboring wells within ½ mile of the requested.

We are delaying action for 15 days on the change application to allow you time to review and provide a recommendation if you feel one is warranted.

Thank you and as always feel free to call or write us at any time.

Sincerely;

Thomas P Makens

TPM:tpm



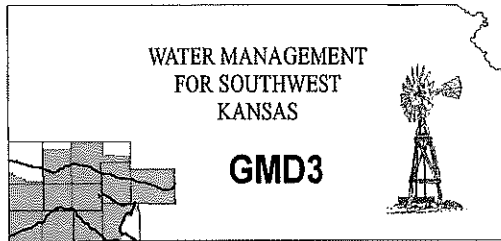

**Southwest Kansas**  
**Groundwater Management District No. 3**  
**2009 E. Spruce Street**  
**Garden City, Kansas 67846**  
(620) 275-7147 phone (620) 275-1431 fax  
[www.gmd3.org](http://www.gmd3.org)

June 7, 2018

RECEIVED

Thomas P. Makens  
Division of Water Resources  
2508 N Johns Street  
Garden City, Kansas 67846

JUN 08 2018

Garden City Field Office  
Division of Water Resources

RE: Application for Change in Point of Diversion  
Water Right, File No. 10734

Dear Thomas:

We have completed a review of the application for the above referenced water right. The proposal is not in conflict with the Management Program of the Southwest Kansas Groundwater Management District No. 3 (GMD3). The proposed distance moved and well spacing is in accordance with K.A.R. 5-23-3. It is therefore recommended that the application be approved at this time.

Thank you for the opportunity to review the applications and to provide a recommendation. If you have any questions, please don't hesitate to contact us.

Sincerely,

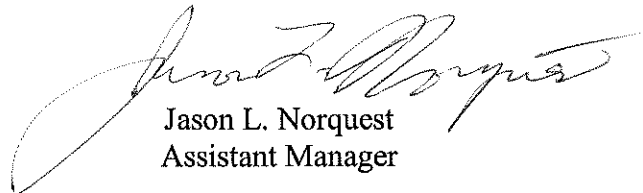
A handwritten signature in black ink, appearing to read "Jason L. Norquest". The signature is fluid and cursive, written over the printed name and title.

Jason L. Norquest  
Assistant Manager



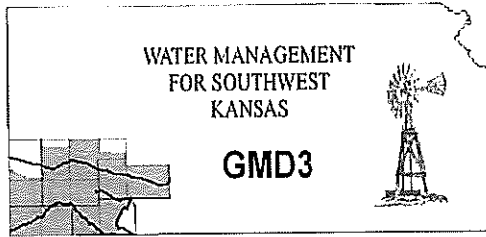

**Southwest Kansas**  
**Groundwater Management District No. 3**  
2009 E. Spruce Street  
Garden City, Kansas 67846  
(620) 275-7147 phone (620) 275-1431 fax  
www.gmd3.org

June 7, 2018

Thomas P. Makens  
Division of Water Resources  
2508 N Johns Street  
Garden City, Kansas 67846

RECEIVED

JUN 08 2018

Garden City Field Office  
Division of Water Resources

RE: Application for Change in Point of Diversion  
Water Right, File No. 10734

Dear Thomas:

We have completed a review of the application for the above referenced water right. The proposal is not in conflict with the Management Program of the Southwest Kansas Groundwater Management District No. 3 (GMD3). The proposed distance moved and well spacing is in accordance with K.A.R. 5-23-3. It is therefore recommended that the application be approved at this time.

Thank you for the opportunity to review the applications and to provide a recommendation. If you have any questions, please don't hesitate to contact us.

Sincerely,

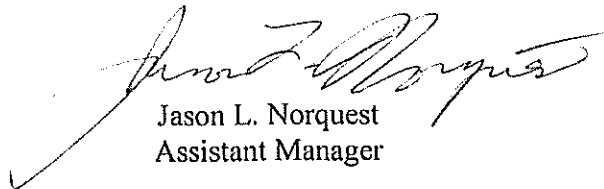
A handwritten signature in cursive script, which appears to read "Jason L. Norquest".

Jason L. Norquest  
Assistant Manager

# GMD3 Change Review

File No(s): 10734. DWR office: GC.

App filed to change: PD.

Is Landowner(s) correct in WRIS: Gooden's.

If NO, is documentation included?

Is Water Use Correspondent correct in WRIS?    .

If NO, is documentation included?

Regulation(s) Reviewed: KAR 5-23-3

Point of diversion ID No(s) 01 being changed.

RECEIVED

JUN 08 2018

	ft. North	ft. West		Garden City Field Office Division of Water Resources
Authorized PD	202	5054	Sect 17-21-32	
Proposed PD	940	814	Sect 18-21-32	
Difference	-738 N	1040 W		
a2 + b2 = c2	544644	1081600	1275.243 foot move NW	

GPS for proposed PD: Lat: 38.22420 Long: -100.86864.

Is proposed PD stacking on existing WRs? NO.

Is Proposed PU overlapping existing WRs?    .

Land Owner(s) notified:    .

Name    . Name    .

Address    . Address    .

Zip    . Zip    .

Neighboring certified well(s) notified: Yes.

Name    . Name    .

Address    . Address    .

Zip    . Zip    .

Domestic well(s) notified: One on the same quarter, but has more than enough spacing.

Name    . Name    .

Address    . Address    .

Zip    . Zip    .

Base Acres:    .

Perfected Acres:    .

Irr. Return-Flow    %

**Lose of production in current well**

**Proposed depth 216'**

**Depth compares to other wells in the area.**

**GPS and footages on the application don't quite match, but the PD will be offset properly to ensure that spacing is met to neighboring wells. Closest well is noted as also being owned by the applicant.**

Is a waiver needed: No.

Final Recommendation: After review of all available information, it appears the current area rules are met. Staff therefore recommends approval of the application.



# GMD3 Change Review

---

RECEIVED

JUN 08 2018

Garden City Field Office  
Division of Water Resources

# 10734 Change Review; PD

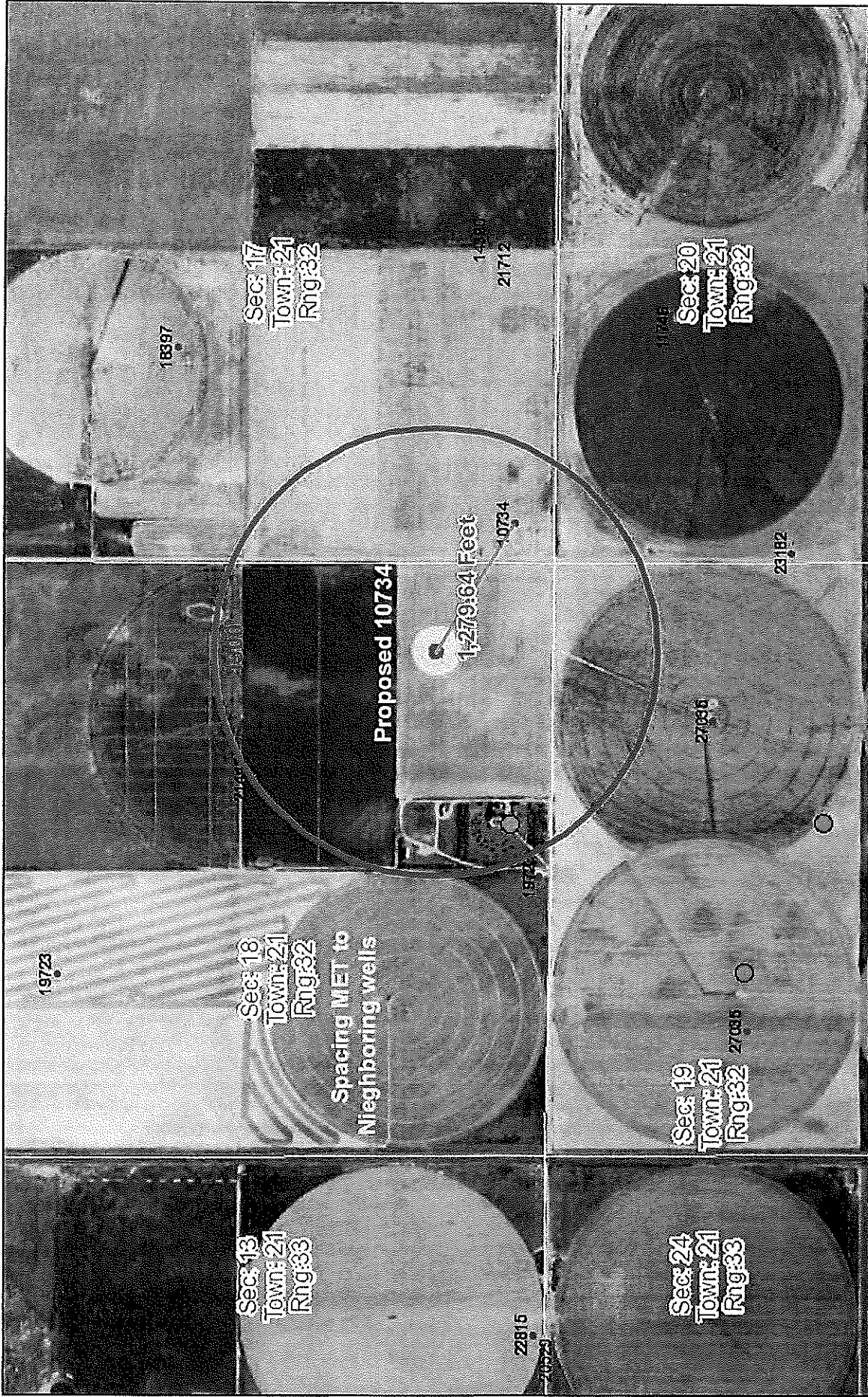

June 7, 2018  
10:08 AM

DISCLAIMER: This map is not intended for conveyances, nor is it a legal survey. The information is presented on a best-efforts basis, and should not be relied upon for making financial, survey, legal or other commitments.

● GPS Position   
 ? Wells   
 + CON   
 ☒ DEW   
 ☒ IRR   
 ☒ Other   
 ☒ FPR   
 ☒ HYD   
 ☒ IND   
 ☒ DOM   
 ☒ STK   
 ☒ REC   
 ☒ ?   
 ☒ THX   
 ☒ Empty

JUN 08 2018

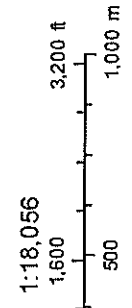

WELLS GMD3 Field Office  
Division of Water Resources



Water Rights and Points of Diversion Within 1.00 miles of point defined as:

940 ft N and 814 ft W of the SE Corner of Section 18, T 21S, R 32W

Located at: 100.868465 West Longitude and 38.224062 North Latitude

GROUNDWATER ONLY

File Number	Use	ST	SR	Dist (ft)	Q4	Q3	Q2	Q1	FeetN	FeetW	Sec	Twp	Rng	ID	Batt	Auth_Quan	Add_Quan	Unit
A_ 3576	00	IRR	NK	G	5228	SW	NE	SW	-----	-----	20	21	32W	1		520.00	520.00	AF 2300
A_ 10734	00	IRR	NK	G*	1301	SW	SW	SW	-----	-----	17	21	32W	1		360.00	360.00	AF 1900
A_ 11746	00	IRR	NK	G	3701	SE	NE	NW	-----	-----	20	21	32W	2		579.00	579.00	AF 2300
A_ 14390	00	IRR	NK	G	3578	SW	SW	SE	580	2570	17	21	32W	2		271.00	271.00	AF 1900
A_ 18397	00	IRR	NK	G	3475	NC	SE	NW	3250	3500	17	21	32W	3		288.00	288.00	AF 1900
A_ 19723	00	IRR	NK	G	4217	SW	NE	NW	4190	3500	18	21	32W	1		115.00	115.00	AF 1900
Same					2050	SE	SE	SW	100	2690	18	21	32W	2		256.00	256.00	AF 1900
A_ 21445	00	IRR	NK	G	1913	NE	NW	SE	2500	1920	18	21	32W	3		310.00	310.00	AF 1900 close
A_ 21712	00	IRR	NK	G	3578	SW	SW	SE	580	2570	17	21	32W	2		49.00	49.00	AF
A_ 23182	00	IRR	NK	G	3105	CW	SW	NW	3300	5220	20	21	32W	3		260.00	21.00	AF 1900
A_ 27035	00	IRR	NK	G	4082	NC	NC	NW	3670	3960	19	21	32W	3		247.00	247.00	AF
Same					2365	NC	NC	NE	3960	1335	19	21	32W	4		192.00	192.00	AF

Total Net Quantities Authorized:	Direct	Storage
Total Requested Amount (AF) =	.00	.00
Total Permitted Amount (AF) =	.00	.00
Total Inspected Amount (AF) =	.00	.00
Total Pro_Cert Amount (AF) =	.00	.00
Total Certified Amount (AF) =	3208.00	.00
Total Vested Amount (AF) =	.00	.00
TOTAL AMOUNT (AF) =	3208.00	.00

*Spacing Appears MET!*

An \* after the source of supply indicates a pending application for change for the file number.

An \* after the ID indicates a 15 AF exemption was granted for the file number.

A "G" in the Batt column indicates the GEO CTR of a battery. A "B" indicates a well in the battery.

The number in the Batt column is the number of wells in the battery.

Water Rights and Points of Diversion Within 1.00 miles of point defined as:

100.868465 West Longitude and 38.224062 North Latitude

GROUNDWATER ONLY

WATER USE CORRESPONDENTS:

File Number	Use	ST	SR
A_ 3576	00	IRR	NK G
>	OLIVER LEE GREATHOUSE		
>	2705 N ROWLAND RD		
>	GARDEN CITY KS 67846		
A_ 10734	00	IRR	NK G
>	ARCHIE L & SUSIE E GOODEN		
>	485 E MEAD RD		
>	GARDEN CITY KS 67846		
A_ 11746	00	IRR	NK G
>	STEVEN W & MELODIE F STERLING		

RECEIVED

JUN 08 2018

Garden City Field Office  
Division of Water Resources

>  
> 2702 N ROWLAND RD  
> GARDEN CITY KS 67846

-----  
A\_\_ 14390 00 IRR NK G  
> STEVEN W & MELODIE F STERLING

>  
> 2702 N ROWLAND RD  
> GARDEN CITY KS 67846

-----  
A\_\_ 18397 00 IRR NK G  
> STEVEN W & MELODIE F STERLING

>  
> 2702 N ROWLAND RD  
> GARDEN CITY KS 67846

-----  
A\_\_ 19723 00 IRR NK G  
> ALBERT SAVOLT

>  
> 2810 N BROADMOOR PL  
> GARDEN CITY KS 67846

-----  
A\_\_ 21445 00 IRR NK G  
> ARCHIE L & SUSIE E GOODEN

>  
> 485 E MEAD RD  
> GARDEN CITY KS 67846

-----  
A\_\_ 21712 00 IRR NK G  
> STEVEN W & MELODIE F STERLING

>  
> 2702 N ROWLAND RD  
> GARDEN CITY KS 67846

-----  
A\_\_ 23182 00 IRR NK G  
> STEVEN W & MELODIE F STERLING

>  
> 2702 N ROWLAND RD  
> GARDEN CITY KS 67846

-----  
A\_\_ 27035 00 IRR NK G  
> ORAN TANKERSLEY

>  
> 5461 W ROAD 90  
> SCOTT CITY KS 67871

-----  
=====

RECEIVED

JUN 08 2018

Garden City Field Office  
Division of Water Resources

INPUTS	
Target Section Definition	
Section	18
Township	21
Range	32
Range Direction	W
Target Point Coordinates (NAD27 or NAD83)	
Target Longitude	-100.868640
Target Latitude	38.224200

Load Data and Compute

- Instructions**
1. Enter values for section, township, range and range direction.
  2. Enter NAD27 or NAD83 longitude and latitude of target point.
  3. Click "Load Data and Compute" button.
  4. Use feet distances corresponding to datum of target point.

*PD description on App was offset to mark location that meets all spacing.*

Loaded Section Data  
From LEOBASE using NAD83

Corner	Corner Latitudes	Corner Longitudes
SW	38.22167109	-100.88362875
NW	38.23607506	-100.88365842
NE	38.23595285	-100.86601887
SE	38.22150295	-100.86606514
Degrees Longitude per Foot		3.48099938E-06
Degrees Latitude per Foot		2.74598330E-06

Target Point Distances from Corners using NAD83

Corner	Feet North(+)/South(-)	Feet East(-)/West(+)
SW	921	-4306
NW	-4325	-4314
NE	-4280	753
SE	982	740

Target point is In Section

Loaded Section Data  
From LEOBASE using NAD27

Corner	Corner Latitudes	Corner Longitudes
SW	38.22164900	-100.88319400
NW	38.23605300	-100.88322400
NE	38.23593100	-100.86558500
SE	38.22148100	-100.86563100
Degrees Longitude per Foot		3.48099833E-06
Degrees Latitude per Foot		2.74598553E-06

Target Point Distances from Corners using NAD27

Corner	Feet North(+)/South(-)	Feet East(-)/West(+)
SW	929	-4181
NW	-4316	-4190
NE	-4272	878
SE	990	864

Target point is In Section

Difference (NAD83 Minus NAD27)	
Corner	Corner Longitudes
SW	0.00002209
NW	0.00002206
NE	0.00002185
SE	0.00002195

Difference (NAD83 Minus NAD27)		
Corner	Feet North(+)/South(-)	Feet East(-)/West(+)
SW	-8.04372413	-124.89103588
NW	-8.03705109	-124.79623293

RECEIVED

JUN 08 2018

Garden City Field Office  
Division of Water Resources

INPUTS		
	Longitude	Latitude
Point 1	-100.868640	38.224200
Point 2	-100.872030	38.228540

10774

*Footages adjusted to meet spacing.*

Proposed 21445  
GPS from GMD3 Insp. 21445

Degrees Longitude per Foot      3.48088349E-06  
 Degrees Latitude per Foot        2.74598500E-06

Distance Between Points (ft)                      1856

Compute Distance Between Points

**Instructions**  
 1. Enter Longitudes and Latitudes of the two points (both must be in the same datum, NAD27 or NAD83).  
 2. Click "Compute Distance Between Points" button.

RECEIVED  
 JUN 08 2018  
 Garden City Field Office  
 Division of Water Resources

INPUTS		
	Longitude	Latitude
Point 1	-100.868640	38.224200
Point 2	-100.873314	38.222456

Proposed 10734  
Domestic well on that Sect.

Degrees Longitude per Foot      3.48073855E-06  
 Degrees Latitude per Foot        2.74598645E-06  
 Distance Between Points (ft)      1485

*more than enough  
spacing.*

**Compute Distance Between Points**

**Instructions**  
 1. Enter Longitudes and Latitudes of the two points (both must be in the same datum, NAD27 or NAD83).  
 2. Click "Compute Distance Between Points" button.

RECEIVED

JUN 08 2018

Garden City Field Office  
 Division of Water Resources

