

12. Points of Diversion		Rate and Quantity			
CHK	MOD	Authorized	Additional		
DEL	PDIV	Rate gpm	Quantity af		
ENT	Qualifier	Comment (AKA Line)	Rate gpm		
	S T R ID	'W	Quantity af		
			Overlap PD Files		
ENT	SWNE	23 25 32W 4045' 1372'	810 260	810 260	NONE
MOD	68635 SWNE	23 25 32W 4026' 3915'	715 260	715 260	NONE

13. Storage: Rate _____ NF _____ Quantity _____ ac/ft Additional Rate _____ NF _____ Additional Quantity _____ ac/ft

14. Limitation: _____ af/yr at _____ gpm (_____ cfs) when combined with file number(s) _____
 Limitation: _____ af/yr at _____ gpm (_____ cfs) when combined with file number(s) _____

15. 5YR Allocation: Allocation Type _____ Start Year _____ 5 YR Amount _____ Amount Unit _____ Base Acres _____ Comment _____

16. Place of Use	CHK	MOD	DEL	ENT	P USE	S	T	R	ID	NE 1/4			NW 1/4			SW 1/4			SE 1/4			Total	Owner	Chg?	Overlap Files
										NE 1/4	NW 1/4	SW 1/4	SE 1/4	NE 1/4	NW 1/4	SW 1/4	SE 1/4	NE 1/4	NW 1/4	SW 1/4	SE 1/4				
NC																									

Base Acres: _____ Year: _____ Minimum Reasonable Quantity: _____
 Comments: _____

DEPARTMENT OF AGRICULTURE
DIVISION OF WATER RESOURCES
GARDEN CITY FIELD OFFICE
2508 JOHNS STREET
GARDEN CITY, KS 67846-2804

STATE OF KANSAS



PHONE: (620) 276-2901
FAX: (620) 276-9315
www.agriculture.ks.gov

GOVERNOR JEFF COLYER, M.D.
JACKIE McCLASKEY, SECRETARY OF AGRICULTURE

July 6, 2018

AMERICAN WARRIOR INC
PO BOX 399
GARDEN CITY KS 67846-0399

RE: Application to Change the Point of Diversion
Water Right, File No. 16911

Dear Sir:

Enclosed is an order executed by the designee of the Chief Engineer, Division of Water Resources, Kansas Department of Agriculture, approving the application for change under the above referenced file number.

Your attention is directed to the enclosures and to the terms, conditions, and limitations specified in this approval for change. A condition of this approval is that an acceptable water flow meter must be installed on the diversion works authorized under the referenced file number and meet current specifications. Please return the required notification of completion of the diversion works and installation of the required meter as soon as these actions are completed.

Since this order modifies the original documents referred to above, it should be recorded with the Register of Deeds as other instruments affecting real estate. Please also submit a copy of the current ownership deed to have our records changed.

The abandoned well must be plugged in accordance with the requirements of Article 30 of the Rules and Regulations as adopted by the Kansas Department of Health and Environment.

Should you have any questions, please feel free to call this office. If you would prefer, you could arrange an appointment for additional assistance.

Sincerely,

Michael A. Meyer
Water Commissioner

MAM:
enclosures

pc: Groundwater Management District No. 3

CERTIFICATE OF SERVICE

On this 6th day of July, 2018, I hereby certify that the foregoing Approval of Application for Change in Point of Diversion, Water Right, File No. 16,911, dated 6th day of July, 2018 was mailed postage prepaid, first class, US mail to the following:

AMERICAN WARRIOR INC
PO BOX 399
GARDEN CITY KS 67846-0399

With photocopies to:

GROUNDWATER MANAGEMENT DISTRICT NO. 3



Division of Water Resources Staff

Submit completed application to:
 Kansas Department of Agriculture
 Division of Water Resources
 Field Office for your area.

Call for address:

Topeka -- (785) 296-5733
 Stafford -- (620) 234-5311
 Stockton -- (785) 425-6787
 Garden City -- (620) 276-2901
<http://agriculture.ks.gov/dwr>

DWR FIELD OFFICE APPLICATION FOR APPROVAL TO CHANGE THE PLACE OF USE AND/OR THE POINT OF DIVERSION



STATE OF KANSAS

Filing Fee Must Accompany the Application, K.S.A. 82a-708b(b), as amended.
 Fee Schedule is on the third page of this application form.

Paragraph Nos. 1, 2, 3 & 5 must be completed. Complete all other applicable portions. If change in point of diversion is greater than 100 feet, or if place of use will be changed, include a topographic map or detailed plat showing the authorized and proposed point(s) of diversion and/or place of use.

RECEIVED
 8:30 A.M.
 JUL 06 2018

File No. 16911

1. Application is hereby made for approval of the Chief Engineer to change the (check one or both):

Garden City Field Office
 Division of Water Resources

Place of Use Point of Diversion

under the water right which is the subject of this application in accordance with the conditions described below.

The source of supply is: Groundwater Surface water

2. Name and address of Applicant: AMERICAN WARRIOR INC; PO BOX 399, GARDEN CITY KS 67846-0399

Phone Number: () Email address: _____

Name and address of Water Use Correspondent: AMERICAN WARRIOR INC; PO BOX 399, GARDEN CITY KS 67846-0399

Phone Number: () Email address: _____

3. The presently authorized place of use is:

Owner of Land ---- NAME: AMERICAN WARRIOR INC

ADDRESS: PO BOX 399, GARDEN CITY KS 67846-0399

(If there is more than one landowner, attach supplemental sheets as necessary.)

Sec.	Twp.	Range	NE¼				NW¼				SW¼				SE¼				TOTAL ACRES
			NE¼	NW¼	SW¼	SE¼	NE¼	NW¼	SW¼	SE¼	NE¼	NW¼	SW¼	SE¼	NE¼	NW¼	SW¼	SE¼	
23	25S	32W	35	35	35	35	35	35	35	35									280

4. If this application is for a change in place of use, it is proposed that the place of use be changed to:

Owner of Land ---- NAME: N/A

ADDRESS: _____

(If there is more than one landowner, attach supplemental sheets as necessary.)

Sec.	Twp.	Range	NE¼				NW¼				SW¼				SE¼				TOTAL ACRES
			NE¼	NW¼	SW¼	SE¼	NE¼	NW¼	SW¼	SE¼	NE¼	NW¼	SW¼	SE¼	NE¼	NW¼	SW¼	SE¼	

For Office Use Only: Code _____ Fee \$ 100.00 TR # _____ Receipt Date 7-6-18 Check # 5465

5. **Presently authorized point of diversion:**
 One in the _____ Quarter of the NC Quarter of the NE Quarter
 of Section 23, Township 25 South, Range 32 W,
 in Finney County, Kansas, 4060 feet North 1395 feet West of Southeast corner of section.
 Authorized Rate 810 gpm Authorized Quantity 260 AF Depth of well _____ (feet)
 (DWR use only: Computer ID No. 4 GPS 37.86962 feet North -100.79674 feet West)
 This point will not be changed This point will be changed as follows: No change, point better described with GPS as follows:
Proposed point of diversion: (Complete only if change is requested or if existing point is better described by GPS)
 One in the SW Quarter of the NE Quarter of the NE Quarter
 of Section 23, Township 25 South, Range 32 W,
 in Finney County, Kansas, 4045 feet North 1372 feet West of Southeast corner of section.
 Proposed Rate 810 gpm Proposed Quantity 260 AF Proposed well depth (feet) 400
 This point is: Additional Well Geo Center List other water rights that will use this point N/A

6. **Presently authorized point of diversion:**
 One in the SW Quarter of the NE Quarter of the NW Quarter
 of Section 23, Township 25 South, Range 32 W,
 in Finney County, Kansas, 3994 feet North 3940 feet West of Southeast corner of section.
 Authorized Rate 715 gpm Authorized Quantity 260 AF Depth of well 391.5 (feet)
 (DWR use only: Computer ID No. 5 GPS 37.86944 feet North -100.80586 feet West)
 This point will not be changed This point will be changed as follows: No change, point better described with GPS as follows:
Proposed point of diversion: (Complete only if change is requested or if existing point is better described by GPS)
 One in the SW Quarter of the NE Quarter of the NW Quarter
 of Section 23, Township 25 South, Range 32 (EAD),
 in Finney County, Kansas, 4026 feet North 3915 feet West of Southeast corner of section.
 Proposed Rate 715 GPM Proposed Quantity 260 AF Proposed well depth (feet) _____
 This point is: Additional Well Geo Center List other water rights that will use this point _____

7. The changes herein are desired for the following reasons?
 (please be specific) OLD WELL NEEDS
TO BE REPLACED QUICKLY

8. If a well, is the test hole log attached? Yes No

9. The change(s) (was)(will be) completed by?
JULY 9, 2018

10. If the point of diversion is a well:
 (a) What are you going to do with the old well?
PLUG
 (b) When will this be done? 2018

11. Groundwater Management District recommendation attached?
 Yes No

12. Assisted by TPM

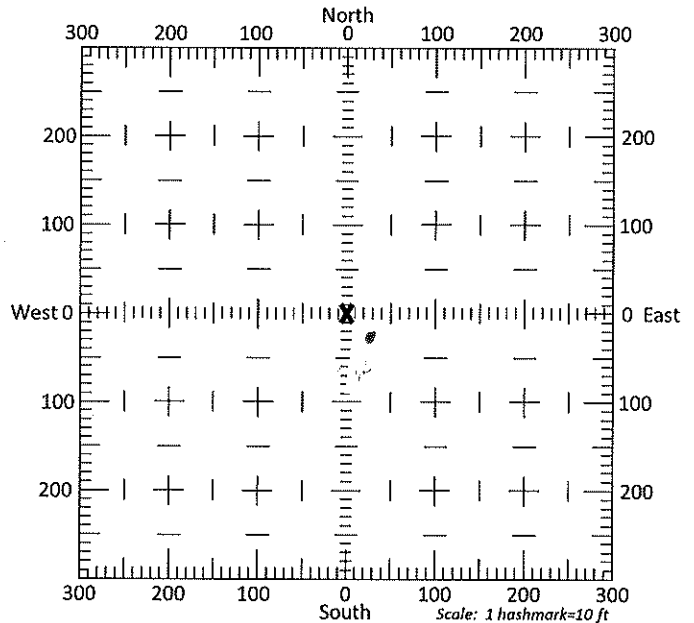

13a. If the proposed point of diversion will be relocated more than 300 feet but within 2,640 feet of the existing point of diversion, attach a topographic map or aerial photograph. For groundwater sources, show all wells (including domestic) within one-half mile of the proposed point of diversion and the names and mailing addresses of the owners. For surface water sources, show the names and addresses of the landowner(s) one-half mile downstream and one-half mile upstream from your property lines

13b. If the proposed point of diversion will be relocated within 300 feet of the existing point of diversion, indicate its location on the diagram shown above in relation to the existing point of diversion. (PLEASE NOTE: The "X" in center of diagram above represents the presently authorized point of diversion.)

14. If the proposed groundwater point of diversion is 300 or fewer feet from the existing point of diversion, complete the following:
- (a) Does the undersigned represent all owners of the currently authorized place(s) of use identified in this application?
 Yes No (If no, all owners must sign this application.)
 - (b) Will the ownership interest of any owner of the currently authorized place(s) of use identified in this application be adversely affected if this application is approved as requested?
 Yes No (If yes, all owners must sign this application.)
 - (c) If this application is not approved expeditiously, will there be substantial damage to property, public health or safety?
 Yes No (If no, all owners must sign this application.)

If the application proposes a surface water change in point of diversion, a groundwater change in point of diversion greater than 300 feet, or a change in place of use, the application must be signed by all owners of the currently authorized place of use, or their duly authorized agent (attach notarized statement authorizing representation).

I hereby verify, being first duly sworn upon my oath or affirmation and under penalty of perjury, that I am of lawful age and the owner, the spouse of the owner, or a duly authorized agent of the owner(s) to make this application on their behalf, in regards to the water right(s) to which this application pertains. I further verify that the statements contained in this application are true, correct and complete.

Dated at GARDEN CITY, Kansas, this 6th day of JULY, 2018.

X Kenneth R Rammt FOR AMERICAN WARRIOR _____
 (Owner) (Spouse)
KENNETH R RAMMT _____
 (Please Print) (Please Print)
 _____ (Owner) (Spouse)
 _____ (Please Print) (Please Print)
 _____ (Owner) (Spouse)
 _____ (Please Print) (Please Print)

State of Kansas }
 County of Finney } SS

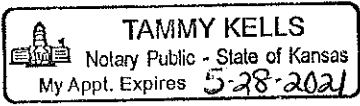

I hereby certify that the foregoing application was signed in my presence and sworn to before me this 6 day of July, 2018.

Tammy Keller
 Notary Public

My Commission Expires 5-28-2021

ONLY COMPLETE APPLICATIONS WILL BE PROCESSED. To be complete, all of the applicable portions of the application form must be completed with accurate information; maps, if necessary, must be included; signatures of all the appropriate owners' must be affixed to the application and notarized; and the appropriate fee must be paid.

FEE SCHEDULE

Each application to change the place of use or the point of diversion under this section shall be accompanied by the application fee set forth in the schedule below: Make checks payable to: **Kansas Department of Agriculture**

(1) Application to change a point of diversion 300 feet or less	\$100
(2) Application to change a point of diversion more than 300 feet	\$200
(3) Application to change the place of use	\$200

3799 W. JONES AVE.
 Garden City, KS 67846
 PH: 620-277-2389



Hydro
 resources

PO Box 639
 Garden City, KS 67846
 Fax: 620-277-0224

MIKE O'BRADE 620-272-2010

Customer Name: American Warrior, Inc.
 Street Address: P.O. Box 389
 City, State: GARDEN CITY, KS. 67846
 County: Finney Quarter: NE Section: 23
 Location: 18' East & 50' South of Existing Well
 Rig #: 10002 Elevation: 2877

WO#: 14123 Date: 7-2-18
 Test #: 1 E LOG: _____
 Driller: Dale Quinn
 Township: 25 Range: 32
 GPS: N 37.86949 W 100.79683
 Static WL: 199' Well Estimated? _____
 Proposed Well Depth: 389

Need Surface Casing

WELL LOCATION: 20' SUMP

%	Footage		Description of Strata	RECEIVED 05 JUL 11 2018 Garden City Field Office Division of Water Resources
	From	Pay To		
	0	2	Top Soil - Sandy -	
	2	34	Fine Sand	
	34	45	Brown Sandy Clay & fine sand mixed	
	45	58	Sand fine to med course	
	58	61	Gray Clay	
	61	135	Sand fine to med course small med some large gravel	
	135	171	Sand fine to med course small few med gravel w/ few clay stringers	
	171	188	Brown Clay - sticky -	
	188	195	Sand fine to med course	
	195	200	Brown Sandy Clay	
25	200	225	Sand fine to med course few small gravel w/ couple clay stringers	
	225	239	Brown Sandy clay	
35	239	283	Sand fine to med course w/ Brown & Tan Rock & couple clay stringers - Drilled Loose -	
	283	289	Brown Sandy Clay	
25	289	311	Sand fine to med course w/ Brown & Tan Rock & few clay ledges	
35	311	369	Sand fine to med course w/ Brown & Tan Rock - Drilled Loose -	
	369	400	Black Shale	
			Super Gel X	-9
			Grout	-5
			Bent. Plug 3/4	-6
			Pena Plug	-1
			4 3/4 Drag Blade	-1

100.80000° W

100.81667° W

NAD27 100.78333° W

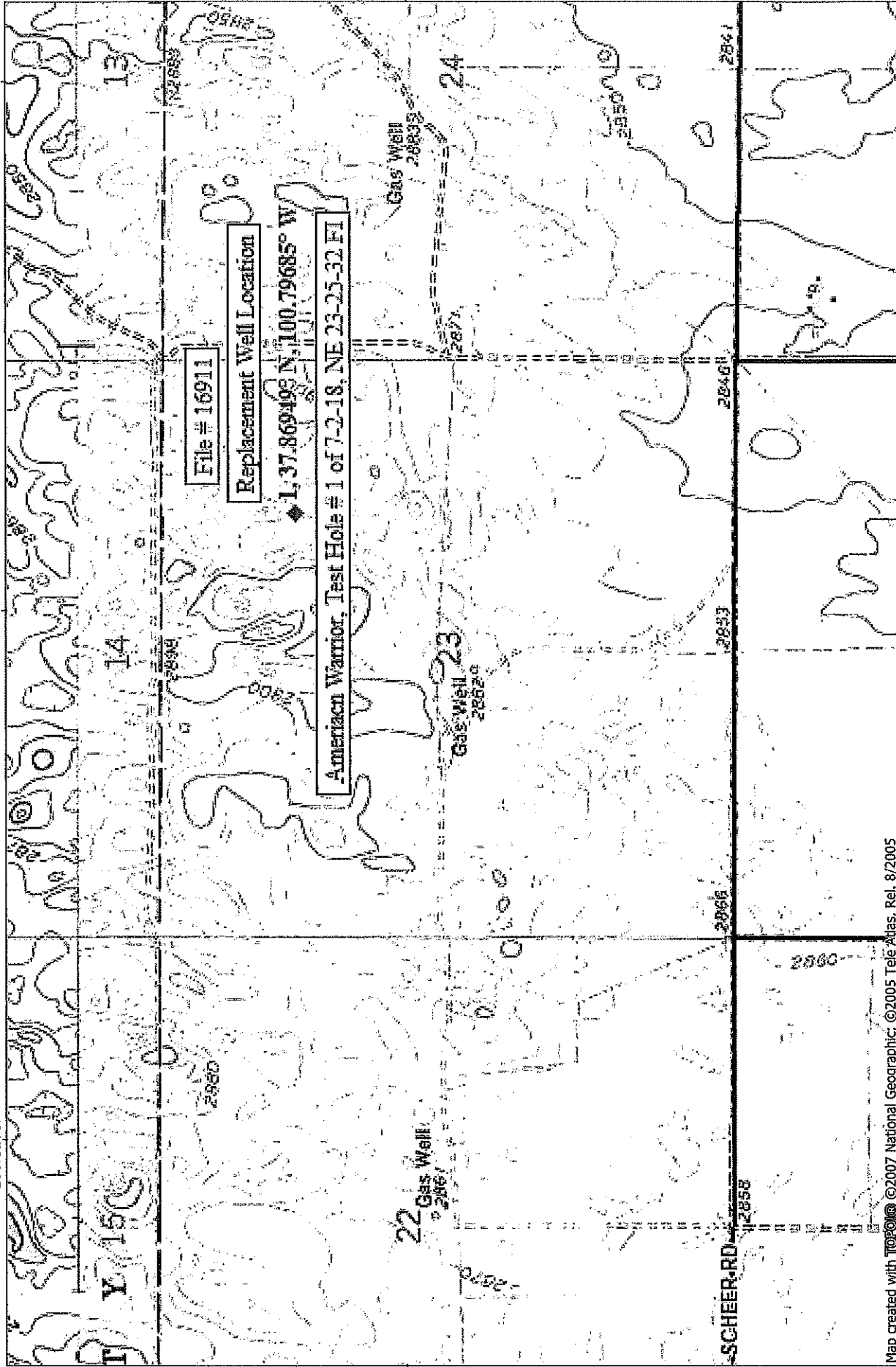

37.86667° N

37.86667° N

Map created with TOPO! ©2007 National Geographic; ©2005 Tele Atlas, Rel. 8/2005

100.81667° W

100.80000° W

NAD27 100.78333° W

NATIONAL GEOGRAPHIC



TN TMN

5 1/2°

07/03/18

