

Kansas Department of Agriculture
 Division of Water Resources
CHANGE: P/U WORKSHEET

1. File Number: 18981	2. Status Change Date: 4/15/18	3. Change Num: c1	4. Field Office: 04	5. GMD: 03
---------------------------------	--	-----------------------------	-------------------------------	----------------------

6. Status: <input checked="" type="checkbox"/> Approved <input type="checkbox"/> Denied by DWR/GMD <input type="checkbox"/> Dismiss by Request/Failure to Return	7. Filing Date of Change: 2/14/18
--	---

8a. Applicant(s) Person ID 2832
 New to system Add Seq# 1

CIRCLE LAND & CATTLE CORPORATION
901 ARKANSAS AVE
HOLCOMB KS 67851

8c. Landowner(s) Person ID 40860
 New to system Add Seq# 1

ARKANSAS RIVER

STATELAND & WATER IN 00000

8b. Landowner(s) Person ID 2832
 New to system Add Seq# 1

CIRCLE LAND & CATTLE CORPORATION
901 ARKANSAS AVE
HOLCOMB KS 67851

8d. WUC Person ID 2832
 New to system Add Seq# 1

CIRCLE LAND & CATTLE CORPORATION
901 ARKANSAS AVE
HOLCOMB KS 67851

9. Documents and Enclosure(s): DWR Meter(s) Date to Comply: 12/31/18 N & P Date to Comply: _____

Anti-Reverse Meter Meter Seal Check Valve N & P Form Water Tube Driller Copy H & E Letter

Conservation Plan Date Required: _____ Date Approved: _____ Date to Comply: _____

10. Use Made of Water From: _____ To: _____

Date Prepared: **3/27/18** By: **TPM**
 Date Entered: _____ By: _____

File No.	18981	Priority Date:	County: FI	Basin: ark	Stream:	Formation Code:																					
11. Place of Use	MOD	T	R	ID	NE%	NW%	SE%	SW%	NE%	NW%	SE%	SW%	NE%	NW%	SE%	SW%	NE%	NW%	SE%	SW%	Total	Owner	Chg?	Overlap Files			
NC 20347	15	24	33W	5																		48	8B	no	12821 18729 18730		
NC 35004	22	24	33W	1	L-1 34				40	39	26	40	37.5	37.5	37.5	37.5	37.5	34	34	34	34	486	18731	18732	18733	18903	18976
ENT 11910	28	24	33W	1	34	34	34	34	34	34	34	34	34	34	34	34	34	34	34	34	34	544	18977	18978	18979	18980	18981
ENT 37784	33	24	33W	1	34	34	34	34	34	34	34	34	34	34	34	34	34	34	34	34	34	544	18982				
ENT 22833	16	24	33W	2																		232					
ENT 23737	21	24	33W	1	38	38	26.5	26.5	38	38	26.5	26.5	34	34	34	34	34	34	34	34	34	530					
ENT NEW	17	24	33W																			10					
ENT 25755	27	24	33W	2	34	34	34	34					34	34	34	34	34	34	34	34	34	408					
ENT 31969	34	24	33W	1	34	34	34	34	34	34	34	34	34	34	34	34	34	34	34	34	34	544					
ENT 3209	21	25	33W	1	34.5	34.5	34.5	34.5	34.5	34.5	34.5	34.5	34.5	34.5	34.5	34.5	34.5	38	38	38	38	566					
ENT 5799	3	25	33W	1	L-1 34	L-2 34	34	34	L-3 37.5	L-4 37.5	37.5	37.5	37.5	37.5	37.5	37.5	37.5	37.5	37.5	37.5	37.5	586					
ENT 8910	10	25	33W	1	34	34	34	34	34	34	34	34	34	34	34	34	34	34	34	34	34	558					
ENT 16102	15	25	33W	1	34	34	34	34	34	34	34	34	34	34	34	34	34	34	34	34	34	544					
ENT 13391	4	25	33W	1	L-1 34	L-2 34	34	34	L-3 34	L-4 34	34	34	34	34	34	34	34	34	34	34	34	544					
ENT 2050	5	25	33W	1	L-1 34	L-2 34	34	34														272					
ENT 9041	8	25	33W	1	34	34	34	34	34	34	34	34	34	34	34	34	34	34	34	34	34	272					
ENT 39456	9	25	33W	1	34	34	34	34	34	34	34	34	34	34	34	34	34	34	34	34	34	544					
ENT 6692	16	25	33W	1	34	34	34	34	34	34	34	34	34	34	34	34	34	34	34	34	34	544					
ENT 17958	17	25	33W	1	34	34	34	34														272					
ENT NEW	15	24	33W																			10	8c	yes			
ENT NEW	16	24	33W																			37	8c	yes			

STATE OF KANSAS



DEPARTMENT OF AGRICULTURE
DIVISION OF WATER RESOURCES
GARDEN CITY FIELD OFFICE
2508 JOHNS STREET
GARDEN CITY, KS 67846-2804

PHONE: (620) 276-2901
FAX: (620) 276-9315
www.agriculture.ks.gov

GOVERNOR JEFF COLYER, M.D.
JACKIE McCLASKEY, SECRETARY OF AGRICULTURE

April 13, 2018

CIRCLE LAND & CATTLE CORPORATION
901 ARKANSAS AVE
HOLCOMB KS 67851

RE: Change the Place of Use, File Nos 12821 18729 18730
18731 18732 18733 18903 18976 18977 18978 18979 18980
18981 18982

Dear Mr. Stillwell;

Enclosed you will find a *Summary Order Approving Application for Change in Place of Use* for the above referenced files. These orders modify the authorized acres that can be irrigated by these files. The authorized place of use is as shown on the plats within the change approvals.

A condition of this order is that an acceptable flow meter must be properly installed on the diversion works authorized under the referenced file number in accordance with the Kansas Administrative Regulations 5-1-4 through 5-1-12. This water flow meter shall be used to provide information required on the annual water use report (including the meter reading at the beginning and end of the report year).

This order shall become final if a request for a hearing is not filed with the Chief Engineer within 15 days of the date of service of this order. The date of service is the date listed on the enclosed *Certificate of Service*.

Should you have any questions, please feel free to call this office or arrange an appointment for additional assistance. Please refer to the file number when you contact us if you wish to discuss a specific file.

Sincerely,

Thomas P. Makens
Assistant Water Commissioner

TPM:tpm
Enclosures
GMD#3

CERTIFICATE OF SERVICE

On this 16th day of April 2018, I hereby certify that the attached original Approval of Application to Change the Place of Use under Water Right File 12821 18729 18730 18731 18732 18733 18903 18976 18977 18978 18979 18980 18981 18982 dated April 5, 2018, was provided in person to the following:

CIRCLE LAND & CATTLE CORPORATION
901 ARKANSAS AVE
HOLCOMB KS 67851

Copy provided to GMD#3



Division of Water Resources

Submit completed application to:
 Kansas Department of Agriculture
 Division of Water Resources
 Field Office for your area.
 Call for address:

Topeka -- (785) 862-6300
 Stafford -- (620) 234-5311
 Stockton -- (785) 425-6787
 Garden City -- (620) 276-2901
www.ksda.gov/dwr

DWR FIELD OFFICE APPLICATION FOR APPROVAL TO CHANGE THE PLACE OF USE AND/OR THE POINT OF DIVERSION



STATE OF KANSAS

Filing Fee Must Accompany the Application, K.S.A. 82a-708b(b), as amended.
 Fee Schedule is on the third page of this application form.

Paragraph Nos. 1, 2, 3 & 5 must be completed. Complete all other applicable portions. If change in point of diversion is greater than 100 feet, or if place of use will be changed, include a topographic map or detailed plat showing the authorized and proposed point(s) of diversion and/or place of use.

RECEIVED
 1:27pm
 FEB 14 2018

File No. 18981

1. Application is hereby made for approval of the Chief Engineer to change the (check one or both): Garden City Field Office
Division of Water Resources
- Place of Use Point of Diversion
- under the water right which is the subject of this application in accordance with the conditions described below.
- The source of supply is: Groundwater Surface water

2. Name and address of Applicant: CIRCLE LAND & CATTLE CORPORATION
- 901 ARKANSAS AVE HOLCOMB, KS 67851
- Phone Number: () Email address: _____
- Name and address of Water Use Correspondent: CIRCLE LAND & CATTLE CORPORATION
- 901 ARKANSAS AVE HOLCOMB, KS 67851
- Phone Number: () Email address: _____

3. The presently authorized place of use is:
- Owner of Land ---- NAME: SEE ATTACHMENTS
- ADDRESS: _____
- (If there is more than one landowner, attach supplemental sheets as necessary.)

Sec.	Twp.	Range	NE¼				NW¼				SW¼				SE¼				TOTAL ACRES	
			NE¼	NW¼	SW¼	SE¼	NE¼	NW¼	SW¼	SE¼	NE¼	NW¼	SW¼	SE¼	NE¼	NW¼	SW¼	SE¼		

4. If this application is for a change in place of use, it is proposed that the place of use be changed to:
- Owner of Land ---- NAME: SEE ATTACHMENTS
- ADDRESS: _____
- (If there is more than one landowner, attach supplemental sheets as necessary.)

Sec.	Twp.	Range	NE¼				NW¼				SW¼				SE¼				TOTAL ACRES	
			NE¼	NW¼	SW¼	SE¼	NE¼	NW¼	SW¼	SE¼	NE¼	NW¼	SW¼	SE¼	NE¼	NW¼	SW¼	SE¼		

For Office Use Only: Code _____ Fee \$ 200 TR # _____ Receipt Date 2/14/18 Check # 2521

5. **Presently authorized point of diversion:**
 One in the _____ Quarter of the _____ Quarter of the _____ Quarter
 of Section _____, Township _____ South, Range _____ W,
 in _____ County, Kansas, _____ feet North _____ feet West of Southeast corner of section.
 Authorized Rate _____ Authorized Quantity _____ Depth of well _____ (feet)
 (DWR use only: Computer ID No. _____ GPS _____ feet North _____ feet West)
 This point will not be changed This point will be changed as follows:
Proposed point of diversion: (Complete only if change is requested)
 One in the _____ Quarter of the _____ Quarter of the _____ Quarter
 of Section _____, Township _____ South, Range _____ W,
 in _____ County, Kansas, _____ feet North _____ feet West of Southeast corner of section.
 Proposed Rate _____ Proposed Quantity _____ Proposed well depth (feet) _____
 This point is: Additional Well Geo Center List other water rights that will use this point _____

6. **Presently authorized point of diversion:**
 One in the _____ Quarter of the _____ Quarter of the _____ Quarter
 of Section _____, Township _____ South, Range _____ W,
 in _____ County, Kansas, _____ feet North _____ feet West of Southeast corner of section.
 Authorized Rate _____ Authorized Quantity _____ Depth of well _____ (feet)
 (DWR use only: Computer ID No. _____ GPS _____ feet North _____ feet West)
 This point will not be changed This point will be changed as follows:
Proposed point of diversion: (Complete only if change is requested)
 One in the _____ Quarter of the _____ Quarter of the _____ Quarter
 of Section _____, Township _____ South, Range _____ (E/W),
 in _____ County, Kansas, _____ feet North _____ feet West of Southeast corner of section.
 Proposed Rate _____ Proposed Quantity _____ Proposed well depth (feet) _____
 This point is: Additional Well Geo Center List other water rights that will use this point _____

7. Why do you need a new point of diversion? _____

 No PD Change

8. If a well, is the test hole log attached? Yes No

9. When do you propose to complete the new point of diversion?

10. If the point of diversion is a well:
 (a) What are you going to do with the old well?

 (b) When will this be done? _____

11. Groundwater Management District recommendation attached? Yes No

12. Assisted by _____

13a. If the proposed point of diversion will be relocated within 100 feet of the existing point of diversion, indicate its location on the diagram below in relation to the existing point of diversion. (PLEASE NOTE: The "X" in center of diagram below represents presently authorized point of diversion.)

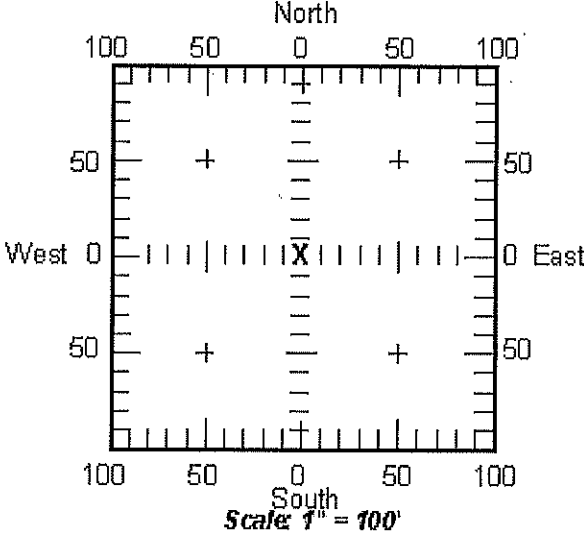

13b. If the proposed point of diversion will be relocated more than 100 feet but within 1320 feet from the existing point of diversion, attach a topographic map or aerial photograph. For groundwater sources, show all wells (including domestic) within one-half mile of the proposed point of diversion and the names and mailing addresses of the owners. For surface water sources, show the names and addresses of the landowner(s) one-half mile downstream and one-half mile upstream from your property lines.

APPLICATION FOR APPROVAL TO CHANGE
THE PLACE OF USE AND/OR POINT OF DIVERSION
SUPPLEMENTAL SHEET
FILE NO. 18981
MAKE ADDITIONAL COPIES AS NECESSARY

3. *Continued:* The presently authorized place of use is:

Owner of Land ---- NAME: CIRCLE LAND & CATTLE CORPORATION
ADDRESS: 901 ARKANSAS AVE HOLCOMB KS 67851

Sec.	Twp.	Range	NE¼				NW¼				SW¼				SE¼				TOTAL ACRES
			NE¼	NW¼	SW¼	SE¼	NE¼	NW¼	SW¼	SE¼	NE¼	NW¼	SW¼	SE¼	NE¼	NW¼	SW¼	SE¼	
17	25	33	34	34	34	34									34	34	34	34	272
16	25	33	34	34	34	34	34	34	34	34	34	34	34	34	34	34	34	34	544

Owner of Land ---- NAME: _____
ADDRESS: _____

Sec.	Twp.	Range	NE¼				NW¼				SW¼				SE¼				TOTAL ACRES
			NE¼	NW¼	SW¼	SE¼	NE¼	NW¼	SW¼	SE¼	NE¼	NW¼	SW¼	SE¼	NE¼	NW¼	SW¼	SE¼	

Owner of Land ---- NAME: _____
ADDRESS: _____

Sec.	Twp.	Range	NE¼				NW¼				SW¼				SE¼				TOTAL ACRES
			NE¼	NW¼	SW¼	SE¼	NE¼	NW¼	SW¼	SE¼	NE¼	NW¼	SW¼	SE¼	NE¼	NW¼	SW¼	SE¼	

4. *Continued:* If this application is for a change in place of use, it is proposed that the place of use be changed to:

Owner of Land ---- NAME: CIRCLE LAND & CATTLE CORPORATION
ADDRESS: 901 ARKANSAS AVE HOLCOMB KS 67851

SEE ATTACHMENT B

Sec.	Twp.	Range	NE¼				NW¼				SW¼				SE¼				TOTAL ACRES
			NE¼	NW¼	SW¼	SE¼	NE¼	NW¼	SW¼	SE¼	NE¼	NW¼	SW¼	SE¼	NE¼	NW¼	SW¼	SE¼	
21	25	33	34.5	34.5	34.5	34.5	34.5	34.5	34.5	34.5	34.5	34.5	34.5	34.5	34.5	34.5	34.5	34.5	566
27	24	33	34	34	34	34								34	34	34	34	34	408
34	24	33	34	34	34	34	34	34	34	34	34	34	34	34	34	34	34	34	544

Owner of Land ---- NAME: CIRCLE LAND & CATTLE CORPORATION
ADDRESS: 901 ARKANSAS AVE HOLCOMB KS 67851

Sec.	Twp.	Range	NE¼				NW¼				SW¼				SE¼				TOTAL ACRES
			NE¼	NW¼	SW¼	SE¼	NE¼	NW¼	SW¼	SE¼	NE¼	NW¼	SW¼	SE¼	NE¼	NW¼	SW¼	SE¼	
3	25	33	34	34	34	34	37.5	37.5	37.5	37.5	37.5	37.5	37.5	37.5	37.5	37.5	37.5	37.5	586
10	25	33	34	34	34	34	34	34	34	34	34	34	34	34	34	34	34	34	558
15	25	33	34	34	34	34	34	34	34	34	34	34	34	34	34	34	34	34	544

Owner of Land ---- NAME: CIRCLE LAND & CATTLE CORPORATION
ADDRESS: 901 ARKANSAS AVE HOLCOMB KS 67851

Sec.	Twp.	Range	NE¼				NW¼				SW¼				SE¼				TOTAL ACRES
			NE¼	NW¼	SW¼	SE¼	NE¼	NW¼	SW¼	SE¼	NE¼	NW¼	SW¼	SE¼	NE¼	NW¼	SW¼	SE¼	
15	24	33																	58
22	24	33		34			40	39	26	40	37.5	37.5	37.5	37.5	34	34	34	34	486
28	24	33	34	34	34	34	34	34	34	34	34	34	34	34	34	34	34	34	544

APPLICATION FOR APPROVAL TO CHANGE
THE PLACE OF USE AND/OR POINT OF DIVERSION
SUPPLEMENTAL SHEET
FILE NO. 18981
MAKE ADDITIONAL COPIES AS NECESSARY

3. *Continued:* The presently authorized place of use is:

Owner of Land ---- NAME: _____
ADDRESS: _____

Sec.	Twp.	Range	NE¼				NW¼				SW¼				SE¼				TOTAL ACRES
			NE¼	NW¼	SW¼	SE¼	NE¼	NW¼	SW¼	SE¼	NE¼	NW¼	SW¼	SE¼	NE¼	NW¼	SW¼	SE¼	

Owner of Land ---- NAME: _____
ADDRESS: _____

Sec.	Twp.	Range	NE¼				NW¼				SW¼				SE¼				TOTAL ACRES
			NE¼	NW¼	SW¼	SE¼	NE¼	NW¼	SW¼	SE¼	NE¼	NW¼	SW¼	SE¼	NE¼	NW¼	SW¼	SE¼	

Owner of Land ---- NAME: _____
ADDRESS: _____

Sec.	Twp.	Range	NE¼				NW¼				SW¼				SE¼				TOTAL ACRES
			NE¼	NW¼	SW¼	SE¼	NE¼	NW¼	SW¼	SE¼	NE¼	NW¼	SW¼	SE¼	NE¼	NW¼	SW¼	SE¼	

4. *Continued:* If this application is for a change in place of use, it is proposed that the place of use be changed to:

Owner of Land ---- NAME: CIRCLE LAND & CATTLE CORPORATION
ADDRESS: 901 ARKANSAS AVE HOLCOMB KS 67851 *SEE ATTACHMENT B*

Sec.	Twp.	Range	NE¼				NW¼				SW¼				SE¼				TOTAL ACRES
			NE¼	NW¼	SW¼	SE¼	NE¼	NW¼	SW¼	SE¼	NE¼	NW¼	SW¼	SE¼	NE¼	NW¼	SW¼	SE¼	
33	24	33	34	34	34	34	34	34	34	34	34	34	34	34	34	34	34	34	544
16	24	33	<i>Lot 1 Lot 2</i>				<i>Lot 3 Lot 4</i>		15	8	<i>31 ACRES 33 ACRES</i>		22	<i>20 ACRES 31 ACRES</i>		35	24	269	
4	25	33	34	34	34	34	34	34	34	34	34	34	34	34	34	34	34	34	544

Owner of Land ---- NAME: CIRCLE LAND & CATTLE CORPORATION
ADDRESS: 901 ARKANSAS AVE HOLCOMB KS 67851

Sec.	Twp.	Range	NE¼				NW¼				SW¼				SE¼				TOTAL ACRES
			NE¼	NW¼	SW¼	SE¼	NE¼	NW¼	SW¼	SE¼	NE¼	NW¼	SW¼	SE¼	NE¼	NW¼	SW¼	SE¼	
5	25	33	<i>11</i> 34	<i>12</i> 34	34	34									34	34	34	34	272
8	25	33	34	34	34	34									34	34	34	34	272
9	25	33	34	34	34	34	34	34	34	34	34	34	34	34	34	34	34	34	544

Owner of Land ---- NAME: CIRCLE LAND & CATTLE CORPORATION
ADDRESS: 901 ARKANSAS AVE HOLCOMB KS 67851

Sec.	Twp.	Range	NE¼				NW¼				SW¼				SE¼				TOTAL ACRES
			NE¼	NW¼	SW¼	SE¼	NE¼	NW¼	SW¼	SE¼	NE¼	NW¼	SW¼	SE¼	NE¼	NW¼	SW¼	SE¼	
16	25	33	34	34	34	34	34	34	34	34	34	34	34	34	34	34	34	34	544
17	25	33	34	34	34	34									34	34	34	34	272
21	24	33	38	38	26.5	26.5	38	38	26.5	26.5	34	34	34	34	34	34	34	34	530

APPLICATION FOR APPROVAL TO CHANGE
THE PLACE OF USE AND/OR POINT OF DIVERSION
SUPPLEMENTAL SHEET
FILE NO. 18981
MAKE ADDITIONAL COPIES AS NECESSARY

3. *Continued:* The presently authorized place of use is:

Owner of Land ---- NAME: _____
ADDRESS: _____

Sec.	Twp.	Range	NE¼				NW¼				SW¼				SE¼				TOTAL ACRES		
			NE¼	NW¼	SW¼	SE¼	NE¼	NW¼	SW¼	SE¼	NE¼	NW¼	SW¼	SE¼	NE¼	NW¼	SW¼	SE¼			

Owner of Land ---- NAME: _____
ADDRESS: _____

Sec.	Twp.	Range	NE¼				NW¼				SW¼				SE¼				TOTAL ACRES			
			NE¼	NW¼	SW¼	SE¼	NE¼	NW¼	SW¼	SE¼	NE¼	NW¼	SW¼	SE¼	NE¼	NW¼	SW¼	SE¼				

Owner of Land ---- NAME: _____
ADDRESS: _____

Sec.	Twp.	Range	NE¼				NW¼				SW¼				SE¼				TOTAL ACRES				
			NE¼	NW¼	SW¼	SE¼	NE¼	NW¼	SW¼	SE¼	NE¼	NW¼	SW¼	SE¼	NE¼	NW¼	SW¼	SE¼					

4. *Continued:* If this application is for a change in place of use, it is proposed that the place of use be changed to: _____

Owner of Land ---- NAME: CIRCLE LAND & CATTLE CORPORATION
ADDRESS: 901 ARKANSAS AVE HOLCOMB KS 67851 *SEE ATTACHMENT B*

Sec.	Twp.	Range	NE¼				NW¼				SW¼				SE¼				TOTAL ACRES				
			NE¼	NW¼	SW¼	SE¼	NE¼	NW¼	SW¼	SE¼	NE¼	NW¼	SW¼	SE¼	NE¼	NW¼	SW¼	SE¼					
17	24	33																					10

Owner of Land ---- NAME: _____
ADDRESS: _____

Sec.	Twp.	Range	NE¼				NW¼				SW¼				SE¼				TOTAL ACRES					
			NE¼	NW¼	SW¼	SE¼	NE¼	NW¼	SW¼	SE¼	NE¼	NW¼	SW¼	SE¼	NE¼	NW¼	SW¼	SE¼						

Owner of Land ---- NAME: _____
ADDRESS: _____

Sec.	Twp.	Range	NE¼				NW¼				SW¼				SE¼				TOTAL ACRES					
			NE¼	NW¼	SW¼	SE¼	NE¼	NW¼	SW¼	SE¼	NE¼	NW¼	SW¼	SE¼	NE¼	NW¼	SW¼	SE¼						

ATTACHMENT "B"
APPLICATION TO CHANGE THE PLACE OF USE
FILE NO. 18981
PROPOSED PLACE OF USE

17 acres in Lot 6
31 acres in Lot 5
4.0 acres in the Southeast Quarter of the Southwest Quarter (SE1/4 SW1/4),
6.0 acres in the Southwest Quarter of the Southeast Quarter (SW1/4 SE1/4),

a total of 58 acres in Section 15,

34 acres in Lot 1
21 acres in the Southwest Quarter of the Northeast Quarter (SW1/4 NE1/4),

40 acres in the Northeast Quarter of the Northwest Quarter (NE1/4 NW1/4),
39 acres in the Northwest Quarter of the Northwest Quarter (NW1/4 NW1/4),
26 acres in the Southwest Quarter of the Northwest Quarter (SW1/4 NW1/4),
40 acres in the Southeast Quarter of the Northwest Quarter (SE1/4 NW1/4),

37.5 acres in the Northeast Quarter of the Southwest Quarter (NE1/4 SW1/4),
37.5 acres in the Northwest Quarter of the Southwest Quarter (NW1/4 SW1/4),
37.5 acres in the Southwest Quarter of the Southwest Quarter (SW1/4 SW1/4),
37.5 acres in the Southeast Quarter of the Southwest Quarter (SE1/4 SW1/4),

34 acres in the Northeast Quarter of the Southeast Quarter (NE1/4 SE1/4),
34 acres in the Northwest Quarter of the Southeast Quarter (NW1/4 SE1/4),
34 acres in the Southwest Quarter of the Southeast Quarter (SW1/4 SE1/4),
34 acres in the Southeast Quarter of the Southeast Quarter (SE1/4 SE1/4),

a total of 486 acres in Section 22,

34 acres in the Northeast Quarter of the Northeast Quarter (NE1/4 NE1/4),
34 acres in the Northwest Quarter of the Northeast Quarter (NW1/4 NE1/4),
34 acres in the Southwest Quarter of the Northeast Quarter (SW1/4 NE1/4),
34 acres in the Southeast Quarter of the Northeast Quarter (SE1/4 NE1/4),

34 acres in the Northeast Quarter of the Northwest Quarter (NE1/4 NW1/4),
34 acres in the Northwest Quarter of the Northwest Quarter (NW1/4 NW1/4),
34 acres in the Southwest Quarter of the Northwest Quarter (SW1/4 NW1/4),
34 acres in the Southeast Quarter of the Northwest Quarter (SE1/4 NW1/4),

34 acres in the Northeast Quarter of the Southwest Quarter (NE1/4 SW1/4),
34 acres in the Northwest Quarter of the Southwest Quarter (NW1/4 SW1/4),
34 acres in the Southwest Quarter of the Southwest Quarter (SW1/4 SW1/4),
34 acres in the Southeast Quarter of the Southwest Quarter (SE1/4 SW1/4),

34 acres in the Northeast Quarter of the Southeast Quarter (NE1/4 SE1/4),
34 acres in the Northwest Quarter of the Southeast Quarter (NW1/4 SE1/4),
34 acres in the Southwest Quarter of the Southeast Quarter (SW1/4 SE1/4),
34 acres in the Southeast Quarter of the Southeast Quarter (SE1/4 SE1/4),

a total of 544 acres in Section 28,

ATTACHMENT "B"
APPLICATION TO CHANGE THE PLACE OF USE
FILE NO. 18981
PROPOSED PLACE OF USE

34 acres in the Northeast Quarter of the Northeast Quarter (NE1/4 NE1/4),
34 acres in the Northwest Quarter of the Northeast Quarter (NW1/4 NE1/4),
34 acres in the Southwest Quarter of the Northeast Quarter (SW1/4 NE1/4),
34 acres in the Southeast Quarter of the Northeast Quarter (SE1/4 NE1/4),

34 acres in the Northeast Quarter of the Northwest Quarter (NE1/4 NW1/4),
34 acres in the Northwest Quarter of the Northwest Quarter (NW1/4 NW1/4),
34 acres in the Southwest Quarter of the Northwest Quarter (SW1/4 NW1/4),
34 acres in the Southeast Quarter of the Northwest Quarter (SE1/4 NW1/4),

34 acres in the Northeast Quarter of the Southwest Quarter (NE1/4 SW1/4),
34 acres in the Northwest Quarter of the Southwest Quarter (NW1/4 SW1/4),
34 acres in the Southwest Quarter of the Southwest Quarter (SW1/4 SW1/4),
34 acres in the Southeast Quarter of the Southwest Quarter (SE1/4 SW1/4),

34 acres in the Northeast Quarter of the Southeast Quarter (NE1/4 SE1/4),
34 acres in the Northwest Quarter of the Southeast Quarter (NW1/4 SE1/4),
34 acres in the Southwest Quarter of the Southeast Quarter (SW1/4 SE1/4),
34 acres in the Southeast Quarter of the Southeast Quarter (SE1/4 SE1/4),

a total of 544 acres in Section 33,

15 acres in the Southwest Quarter of the Northwest Quarter (SW1/4 NW1/4),
8 acres in the Southeast Quarter of the Northwest Quarter (SE1/4 NW1/4),

7 acres in the Northeast Quarter of the Southwest Quarter (NE1/4 SW1/4),
7 acres in the Northwest Quarter of the Southwest Quarter (NW1/4 SW1/4),
29 acres in the Southwest Quarter of the Southwest Quarter (SW1/4 SW1/4),
22 acres in the Southeast Quarter of the Southwest Quarter (SE1/4 SW1/4),

20 acres in Lot 5

7 acres in the Northwest Quarter of the Southeast Quarter (NW1/4 SE1/4),
35 acres in the Southwest Quarter of the Southeast Quarter (SW1/4 SE1/4),
24 acres in the Southeast Quarter of the Southeast Quarter (SE1/4 SE1/4),

31 acres in Lot 7,
33 acres in Lot 8,
31 acres in Lot 6,

a total of 269 acres in Section 16,

38 acres in the Northeast Quarter of the Northeast Quarter (NE1/4 NE1/4),
38 acres in the Northwest Quarter of the Northeast Quarter (NW1/4 NE1/4),
26.5 acres in the Southwest Quarter of the Northeast Quarter (SW1/4 NE1/4),
26.5 acres in the Southeast Quarter of the Northeast Quarter (SE1/4 NE1/4),

38 acres in the Northeast Quarter of the Northwest Quarter (NE1/4 NW1/4),
38 acres in the Northwest Quarter of the Northwest Quarter (NW1/4 NW1/4),
26.5 acres in the Southwest Quarter of the Northwest Quarter (SW1/4 NW1/4),

ATTACHMENT "B"
APPLICATION TO CHANGE THE PLACE OF USE
FILE NO. 18981
PROPOSED PLACE OF USE

26.5 acres in the Southeast Quarter of the Northwest Quarter (SE1/4 NW1/4),

34 acres in the Northeast Quarter of the Southwest Quarter (NE1/4 SW1/4),
34 acres in the Northwest Quarter of the Southwest Quarter (NW1/4 SW1/4),
34 acres in the Southwest Quarter of the Southwest Quarter (SW1/4 SW1/4),
34 acres in the Southeast Quarter of the Southwest Quarter (SE1/4 SW1/4),

34 acres in the Northeast Quarter of the Southeast Quarter (NE1/4 SE1/4),
34 acres in the Northwest Quarter of the Southeast Quarter (NW1/4 SE1/4),
34 acres in the Southwest Quarter of the Southeast Quarter (SW1/4 SE1/4),
34 acres in the Southeast Quarter of the Southeast Quarter (SE1/4 SE1/4),

a total of 530 acres in Section 21,

8 acres in Lot 4

2.0 acres in the Southeast Quarter of the Southeast Quarter (SE1/4 SE1/4),

a total of 10 acres in Section 17,

34 acres in the Northeast Quarter of the Northeast Quarter (NE1/4 NE1/4),
34 acres in the Northwest Quarter of the Northeast Quarter (NW1/4 NE1/4),
34 acres in the Southwest Quarter of the Northeast Quarter (SW1/4 NE1/4),
34 acres in the Southeast Quarter of the Northeast Quarter (SE1/4 NE1/4),

34 acres in the Northeast Quarter of the Southwest Quarter (NE1/4 SW1/4),
34 acres in the Northwest Quarter of the Southwest Quarter (NW1/4 SW1/4),
34 acres in the Southwest Quarter of the Southwest Quarter (SW1/4 SW1/4),
34 acres in the Southeast Quarter of the Southwest Quarter (SE1/4 SW1/4),

34 acres in the Northeast Quarter of the Southeast Quarter (NE1/4 SE1/4),
34 acres in the Northwest Quarter of the Southeast Quarter (NW1/4 SE1/4),
34 acres in the Southwest Quarter of the Southeast Quarter (SW1/4 SE1/4),
34 acres in the Southeast Quarter of the Southeast Quarter (SE1/4 SE1/4),

a total of 544 acres in Section 27,

34 acres in the Northeast Quarter of the Northeast Quarter (NE1/4 NE1/4),
34 acres in the Northwest Quarter of the Northeast Quarter (NW1/4 NE1/4),
34 acres in the Southwest Quarter of the Northeast Quarter (SW1/4 NE1/4),
34 acres in the Southeast Quarter of the Northeast Quarter (SE1/4 NE1/4),

34 acres in the Northeast Quarter of the Northwest Quarter (NE1/4 NW1/4),
34 acres in the Northwest Quarter of the Northwest Quarter (NW1/4 NW1/4),
34 acres in the Southwest Quarter of the Northwest Quarter (SW1/4 NW1/4),
34 acres in the Southeast Quarter of the Northwest Quarter (SE1/4 NW1/4),

34 acres in the Northeast Quarter of the Southwest Quarter (NE1/4 SW1/4),
34 acres in the Northwest Quarter of the Southwest Quarter (NW1/4 SW1/4),

ATTACHMENT "B"
APPLICATION TO CHANGE THE PLACE OF USE
FILE NO. 18981
PROPOSED PLACE OF USE

34 acres in the Southwest Quarter of the Southwest Quarter (SW1/4 SW1/4),
34 acres in the Southeast Quarter of the Southwest Quarter (SE1/4 SW1/4),

34 acres in the Northeast Quarter of the Southeast Quarter (NE1/4 SE1/4),
34 acres in the Northwest Quarter of the Southeast Quarter (NW1/4 SE1/4),
34 acres in the Southwest Quarter of the Southeast Quarter (SW1/4 SE1/4),
34 acres in the Southeast Quarter of the Southeast Quarter (SE1/4 SE1/4),

a total of 544 acres in Section 34,
all in Township 24 South, Range 33 west, in Finney County, Kansas

34.5 acres in the Northeast Quarter of the Northeast Quarter (NE1/4 NE1/4),
34.5 acres in the Northwest Quarter of the Northeast Quarter (NW1/4 NE1/4),
34.5 acres in the Southwest Quarter of the Northeast Quarter (SW1/4 NE1/4),
34.5 acres in the Southeast Quarter of the Northeast Quarter (SE1/4 NE1/4),

34.5 acres in the Northeast Quarter of the Northwest Quarter (NE1/4 NW1/4),
34.5 acres in the Northwest Quarter of the Northwest Quarter (NW1/4 NW1/4),
34.5 acres in the Southwest Quarter of the Northwest Quarter (SW1/4 NW1/4),
34.5 acres in the Southeast Quarter of the Northwest Quarter (SE1/4 NW1/4),

34.5 acres in the Northeast Quarter of the Southwest Quarter (NE1/4 SW1/4),
34.5 acres in the Northwest Quarter of the Southwest Quarter (NW1/4 SW1/4),
34.5 acres in the Southwest Quarter of the Southwest Quarter (SW1/4 SW1/4),
34.5 acres in the Southeast Quarter of the Southwest Quarter (SE1/4 SW1/4),

38 acres in the Northeast Quarter of the Southeast Quarter (NE1/4 SE1/4),
38 acres in the Northwest Quarter of the Southeast Quarter (NW1/4 SE1/4),
38 acres in the Southwest Quarter of the Southeast Quarter (SW1/4 SE1/4),
38 acres in the Southeast Quarter of the Southeast Quarter (SE1/4 SE1/4),

a total of 566 acres in Section 21,

34 acres in Lot 1 (NE1/4 NE1/4),
34 acres in Lot 2 (NW1/4 NE1/4),
34 acres in the Southwest Quarter of the Northeast Quarter (SW1/4 NE1/4),
34 acres in the Southeast Quarter of the Northeast Quarter (SE1/4 NE1/4),

37.5 acres in Lot 3 (NE1/4 NW1/4),
37.5 acres in Lot 4 (NW1/4 NW1/4),
37.5 acres in the Southwest Quarter of the Northwest Quarter (SW1/4 NW1/4),
37.5 acres in the Southeast Quarter of the Northwest Quarter (SE1/4 NW1/4),

37.5 acres in the Northeast Quarter of the Southwest Quarter (NE1/4 SW1/4),
37.5 acres in the Northwest Quarter of the Southwest Quarter (NW1/4 SW1/4),
37.5 acres in the Southwest Quarter of the Southwest Quarter (SW1/4 SW1/4),
37.5 acres in the Southeast Quarter of the Southwest Quarter (SE1/4 SW1/4),

37.5 acres in the Northeast Quarter of the Southeast Quarter (NE1/4 SE1/4),
37.5 acres in the Northwest Quarter of the Southeast Quarter (NW1/4 SE1/4),

ATTACHMENT "B"
APPLICATION TO CHANGE THE PLACE OF USE
FILE NO. 18981
PROPOSED PLACE OF USE

37.5 acres in the Southwest Quarter of the Southeast Quarter (SW1/4 SE1/4),
37.5 acres in the Southeast Quarter of the Southeast Quarter (SE1/4 SE1/4),

a total of 586 acres in Section 3,

34 acres in the Northeast Quarter of the Northeast Quarter (NE1/4 NE1/4),
34 acres in the Northwest Quarter of the Northeast Quarter (NW1/4 NE1/4),
34 acres in the Southwest Quarter of the Northeast Quarter (SW1/4 NE1/4),
34 acres in the Southeast Quarter of the Northeast Quarter (SE1/4 NE1/4),

34 acres in the Northeast Quarter of the Northwest Quarter (NE1/4 NW1/4),
34 acres in the Northwest Quarter of the Northwest Quarter (NW1/4 NW1/4),
34 acres in the Southwest Quarter of the Northwest Quarter (SW1/4 NW1/4),
34 acres in the Southeast Quarter of the Northwest Quarter (SE1/4 NW1/4),

37.5 acres in the Northeast Quarter of the Southwest Quarter (NE1/4 SW1/4),
37.5 acres in the Northwest Quarter of the Southwest Quarter (NW1/4 SW1/4),
37.5 acres in the Southwest Quarter of the Southwest Quarter (SW1/4 SW1/4),
37.5 acres in the Southeast Quarter of the Southwest Quarter (SE1/4 SW1/4),

34 acres in the Northeast Quarter of the Southeast Quarter (NE1/4 SE1/4),
34 acres in the Northwest Quarter of the Southeast Quarter (NW1/4 SE1/4),
34 acres in the Southwest Quarter of the Southeast Quarter (SW1/4 SE1/4),
34 acres in the Southeast Quarter of the Southeast Quarter (SE1/4 SE1/4),

a total of 558 acres in Section 10,

34 acres in the Northeast Quarter of the Northeast Quarter (NE1/4 NE1/4),
34 acres in the Northwest Quarter of the Northeast Quarter (NW1/4 NE1/4),
34 acres in the Southwest Quarter of the Northeast Quarter (SW1/4 NE1/4),
34 acres in the Southeast Quarter of the Northeast Quarter (SE1/4 NE1/4),

34 acres in the Northeast Quarter of the Northwest Quarter (NE1/4 NW1/4),
34 acres in the Northwest Quarter of the Northwest Quarter (NW1/4 NW1/4),
34 acres in the Southwest Quarter of the Northwest Quarter (SW1/4 NW1/4),
34 acres in the Southeast Quarter of the Northwest Quarter (SE1/4 NW1/4),

34 acres in the Northeast Quarter of the Southwest Quarter (NE1/4 SW1/4),
34 acres in the Northwest Quarter of the Southwest Quarter (NW1/4 SW1/4),
34 acres in the Southwest Quarter of the Southwest Quarter (SW1/4 SW1/4),
34 acres in the Southeast Quarter of the Southwest Quarter (SE1/4 SW1/4),

34 acres in the Northeast Quarter of the Southeast Quarter (NE1/4 SE1/4),
34 acres in the Northwest Quarter of the Southeast Quarter (NW1/4 SE1/4),
34 acres in the Southwest Quarter of the Southeast Quarter (SW1/4 SE1/4),
34 acres in the Southeast Quarter of the Southeast Quarter (SE1/4 SE1/4),

a total of 544 acres in Section 15,

ATTACHMENT "B"
APPLICATION TO CHANGE THE PLACE OF USE
FILE NO. 18981
PROPOSED PLACE OF USE

34 acres in Lot 1 (NE1/4 NE1/4),
34 acres in Lot 2 (NW1/4 NE1/4),
34 acres in the Southwest Quarter of the Northeast Quarter (SW1/4 NE1/4),
34 acres in the Southeast Quarter of the Northeast Quarter (SE1/4 NE1/4),

34 acres in Lot 3 (NE1/4 NW1/4),
34 acres in Lot 4 (NW1/4 NW1/4),
34 acres in the Southwest Quarter of the Northwest Quarter (SW1/4 NW1/4),
34 acres in the Southeast Quarter of the Northwest Quarter (SE1/4 NW1/4),

34 acres in the Northeast Quarter of the Southwest Quarter (NE1/4 SW1/4),
34 acres in the Northwest Quarter of the Southwest Quarter (NW1/4 SW1/4),
34 acres in the Southwest Quarter of the Southwest Quarter (SW1/4 SW1/4),
34 acres in the Southeast Quarter of the Southwest Quarter (SE1/4 SW1/4),

34 acres in the Northeast Quarter of the Southeast Quarter (NE1/4 SE1/4),
34 acres in the Northwest Quarter of the Southeast Quarter (NW1/4 SE1/4),
34 acres in the Southwest Quarter of the Southeast Quarter (SW1/4 SE1/4),
34 acres in the Southeast Quarter of the Southeast Quarter (SE1/4 SE1/4),

a total of 544 acres in Section 4,

34 acres in Lot 1 (NE1/4 NE1/4),
34 acres in Lot 2 (NW1/4 NE1/4),
34 acres in the Southwest Quarter of the Northeast Quarter (SW1/4 NE1/4),
34 acres in the Southeast Quarter of the Northeast Quarter (SE1/4 NE1/4),

34 acres in the Northeast Quarter of the Southeast Quarter (NE1/4 SE1/4),
34 acres in the Northwest Quarter of the Southeast Quarter (NW1/4 SE1/4),
34 acres in the Southwest Quarter of the Southeast Quarter (SW1/4 SE1/4),
34 acres in the Southeast Quarter of the Southeast Quarter (SE1/4 SE1/4),

a total of 272 acres in Section 5,

34 acres in the Northeast Quarter of the Northeast Quarter (NE1/4 NE1/4),
34 acres in the Northwest Quarter of the Northeast Quarter (NW1/4 NE1/4),
34 acres in the Southwest Quarter of the Northeast Quarter (SW1/4 NE1/4),
34 acres in the Southeast Quarter of the Northeast Quarter (SE1/4 NE1/4),

34 acres in the Northeast Quarter of the Southeast Quarter (NE1/4 SE1/4),
34 acres in the Northwest Quarter of the Southeast Quarter (NW1/4 SE1/4),
34 acres in the Southwest Quarter of the Southeast Quarter (SW1/4 SE1/4),
34 acres in the Southeast Quarter of the Southeast Quarter (SE1/4 SE1/4),

a total of 272 acres in Section 8,

34 acres in the Northeast Quarter of the Northeast Quarter (NE1/4 NE1/4),
34 acres in the Northwest Quarter of the Northeast Quarter (NW1/4 NE1/4),

ATTACHMENT "B"
APPLICATION TO CHANGE THE PLACE OF USE
FILE NO. 18981
PROPOSED PLACE OF USE

34 acres in the Southwest Quarter of the Northeast Quarter (SW1/4 NE1/4),
34 acres in the Southeast Quarter of the Northeast Quarter (SE1/4 NE1/4),

34 acres in the Northeast Quarter of the Northwest Quarter (NE1/4 NW1/4),
34 acres in the Northwest Quarter of the Northwest Quarter (NW1/4 NW1/4),
34 acres in the Southwest Quarter of the Northwest Quarter (SW1/4 NW1/4),
34 acres in the Southeast Quarter of the Northwest Quarter (SE1/4 NW1/4),

34 acres in the Northeast Quarter of the Southwest Quarter (NE1/4 SW1/4),
34 acres in the Northwest Quarter of the Southwest Quarter (NW1/4 SW1/4),
34 acres in the Southwest Quarter of the Southwest Quarter (SW1/4 SW1/4),
34 acres in the Southeast Quarter of the Southwest Quarter (SE1/4 SW1/4),

34 acres in the Northeast Quarter of the Southeast Quarter (NE1/4 SE1/4),
34 acres in the Northwest Quarter of the Southeast Quarter (NW1/4 SE1/4),
34 acres in the Southwest Quarter of the Southeast Quarter (SW1/4 SE1/4),
34 acres in the Southeast Quarter of the Southeast Quarter (SE1/4 SE1/4),

a total of 544 acres in Section 9,

34 acres in the Northeast Quarter of the Northeast Quarter (NE1/4 NE1/4),
34 acres in the Northwest Quarter of the Northeast Quarter (NW1/4 NE1/4),
34 acres in the Southwest Quarter of the Northeast Quarter (SW1/4 NE1/4),
34 acres in the Southeast Quarter of the Northeast Quarter (SE1/4 NE1/4),

34 acres in the Northeast Quarter of the Northwest Quarter (NE1/4 NW1/4),
34 acres in the Northwest Quarter of the Northwest Quarter (NW1/4 NW1/4),
34 acres in the Southwest Quarter of the Northwest Quarter (SW1/4 NW1/4),
34 acres in the Southeast Quarter of the Northwest Quarter (SE1/4 NW1/4),

34 acres in the Northeast Quarter of the Southwest Quarter (NE1/4 SW1/4),
34 acres in the Northwest Quarter of the Southwest Quarter (NW1/4 SW1/4),
34 acres in the Southwest Quarter of the Southwest Quarter (SW1/4 SW1/4),
34 acres in the Southeast Quarter of the Southwest Quarter (SE1/4 SW1/4),

34 acres in the Northeast Quarter of the Southeast Quarter (NE1/4 SE1/4),
34 acres in the Northwest Quarter of the Southeast Quarter (NW1/4 SE1/4),
34 acres in the Southwest Quarter of the Southeast Quarter (SW1/4 SE1/4),
34 acres in the Southeast Quarter of the Southeast Quarter (SE1/4 SE1/4),

a total of 544 acres in Section 16,

34 acres in the Northeast Quarter of the Northeast Quarter (NE1/4 NE1/4),
34 acres in the Northwest Quarter of the Northeast Quarter (NW1/4 NE1/4),
34 acres in the Southwest Quarter of the Northeast Quarter (SW1/4 NE1/4),
34 acres in the Southeast Quarter of the Northeast Quarter (SE1/4 NE1/4),

34 acres in the Northeast Quarter of the Southeast Quarter (NE1/4 SE1/4),
34 acres in the Northwest Quarter of the Southeast Quarter (NW1/4 SE1/4),
34 acres in the Southwest Quarter of the Southeast Quarter (SW1/4 SE1/4),

ATTACHMENT "B"
APPLICATION TO CHANGE THE PLACE OF USE
FILE NO. 18981
PROPOSED PLACE OF USE

34 acres in the Southeast Quarter of the Southeast Quarter (SE1/4 SE1/4),
a total of 272 acres in Section 17,
all in Township 25 South, Range 33 west, in Finney County, Kansas

14. If the proposed groundwater point of diversion is 300 or fewer feet from existing point of diversion, complete the following:

- (a) Does the undersigned represent all owners of the currently authorized place(s) of use identified in this application?
 Yes No (If no, all owners must sign this application.)
- (b) Will the ownership interest of any owner of the currently authorized place(s) of use identified in this application be adversely affected if this application is approved as requested?
 Yes No (If yes, all owners must sign this application.)
- (c) If this application is not approved expeditiously, will there be substantial damage to property, public health or safety?
 Yes No (If no, all owners must sign this application.)

If the application proposes a surface water change in point of diversion, a groundwater change in point of diversion greater than 300 feet, or a change in place of use, the application must be signed by all owners of the currently authorized place of use, or their duly authorized agent (attach notarized statement authorizing representation).

I hereby verify, being first duly sworn upon my oath or affirmation and under penalty of perjury, that I am of lawful age and the owner, the spouse of the owner, or a duly authorized agent of the owner(s) to make this application on their behalf, in regard to the water right(s) to which this application pertains. I further verify that the statements contained in this application are true, correct and complete.

Dated at Garden City, Kansas, this 14th day of February, 2018.

<u><i>Anna Gigot</i></u> (Owner)	_____	(Spouse)
<u>Gina Gigot</u> (Please Print)	_____	(Please Print)
<u><i>Marc Gigot</i></u> (Owner)	_____	(Spouse)
<u>Marc Gigot</u> (Please Print)	_____	(Please Print)
_____	_____	(Spouse)
_____	_____	(Please Print)

State of Kansas }
County of Finney } SS

I hereby certify that the foregoing application was signed in my presence and sworn to before me this 14th day of February, 2018



My Commission Expires _____

Julie Jones
Notary Public

ONLY COMPLETE APPLICATIONS WILL BE PROCESSED. To be complete, all of the applicable portions of the application form must be completed with accurate information; maps, if necessary, must be included; signatures of all the appropriate owners' must be affixed to the application and notarized; and the appropriate fee must be paid.

FEE SCHEDULE

Each application to change the place of use or the point of diversion under this section shall be accompanied by the application fee set forth in the schedule below: Make checks payable to: **Kansas Department of Agriculture**

- (1) Application to change a point of diversion 300 feet or less \$100
- (2) Application to change a point of diversion more than 300 feet \$200
- (3) Application to change the place of use \$200

SUMMARY ORDER APPROVING APPLICATION FOR CHANGE AND IMPOSING CONDITIONS

This Summary Order is issued under authority of K.S.A. 82a-708b, as amended, and K.A.R. 5-14-3 and other applicable provisions of the *Kansas Water Appropriation Law, K.S.A. 82a-701 et. seq.*, and rules and regulations promulgated thereunder, K.A.R. 5-1-1 *et. seq.* With the exception of those conditions expressly contained herein, this Summary Order does not change the terms, conditions and limitations of File No. 18981.

1. A change application was received on FEBRUARY 14, 2018 requesting that the place of use and / or point of diversion authorized under the above-referenced file number be changed as described in the application.
2. On and after the effective date of this summary order, the authorized place(s) of use shall be located substantially as shown on the topographic map accompanying the application to change the place of use. Applicable Not Applicable
3. The change in point of diversion shall not impair existing rights and shall be limited to the same source or sources of water as previously authorized. The point of diversion authorized by this summary order shall be located within a _____ foot radius of the authorized point(s) of diversion. Applicable Not Applicable
4. The point(s) of diversion authorized herein shall not actually be located more than _____ feet from the previously authorized point(s) of diversion. Applicable Not Applicable
5. As required by K.A.R. 5-3-5d, if the works for diversion is a well with a diversion rate of 100 gallons per minute or more, a tube or other device suitable for making water level measurements shall be installed, operated and maintained in accordance with K.A.R. 5-6-13. Applicable Not Applicable
6. **The owner of the authorized place(s) of use shall properly install an acceptable water flow meter on or before December 31, 2018**, or before the first use of water, whichever occurs first. The water flow meter shall be installed, operated and maintained in accordance with K.A.R. 5-1-4 through 5-1-12. As required by K.S.A. 82a-732, as amended, and K.A.R. 5-3-5e, the owner shall maintain records and report the reading of the water flow meter and the total quantity of water diverted annually to the Chief Engineer by March 1 following the end of each calendar year. Applicable Not Applicable
7. **Installation of the works for diversion of water shall be completed on or before December 31, 20____**, or within any authorized extension of time. By March 1, 20____ the applicant shall notify the Chief Engineer that construction of the works for diversion has been completed, on the form provided by the Chief Engineer, as required by K.A.R. 5-8-4e. Applicable Not Applicable
8. **The completed well log shall be submitted with the required notice.** Applicable Not Applicable
9. All diversion works into which any type of chemical or other foreign substance will be injected into the water shall be equipped with an in-line, automatic, quick-closing check valve capable of preventing pollution of the source of the water supply. The check valve(s) shall be installed, operated and maintained in accordance with K.A.R. 5-3-5c. Applicable Not Applicable
10. Additional Conditions are attached. Yes No
11. In accordance with K.S.A. 82a-708a, as amended, and K.A.R. 5-5-14, all of the owners of the authorized place(s) of use of water appropriated under the above-referenced file number are responsible for compliance with its terms, conditions and limitations, as amended and/or supplemented by this Summary Order, and with applicable provisions of the *Kansas Water Appropriation Law* and the *Rules and Regulations* promulgated thereunder. Failure to comply with these provisions may result in civil penalties pursuant to K.S.A. 82a-737, as amended, and/or the suspension or revocation and dismissal of the water or appropriation right or any other enforcement actions authorized by law.

Administrative Appeal and Effective Date of Order

You have the right to a hearing in accordance with K.A.R. 5-14-3 before this Summary Order becomes final action of the Kansas Department of Agriculture. Any request for a hearing must be filed with the **Chief Engineer, Division of Water Resources, Kansas Department of Agriculture, 109 SW 9th Street, Topeka, Kansas 66612**, within 15 days after the date shown on the Certificate of Service attached hereto. If a hearing is not requested in accordance with K.A.R. 5-14-3, this Summary Order will become effective on the 15th day after the date shown on the Certificate of Service.

For Use by Register of Deeds

FOR OFFICE USE ONLY
APPLICATION APPROVED AND SUMMARY ORDER ISSUED

By: TL P.V.
Duly Authorized Designee of the Chief Engineer

(Print Name): THOMAS P. MAKENS
Division of Water Resources - Kansas Department of Agriculture

Date of Issuance: APRIL 5, 2018

State of Kansas)
County of Finney) SS

Acknowledged before me on April 5, 2018
by Thomas P. Makens

Signature: Sue Keeny
Notary Public

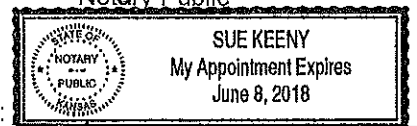

My commission expires: _____
(Notary Seal)

Change in Place of Use: WR 18981

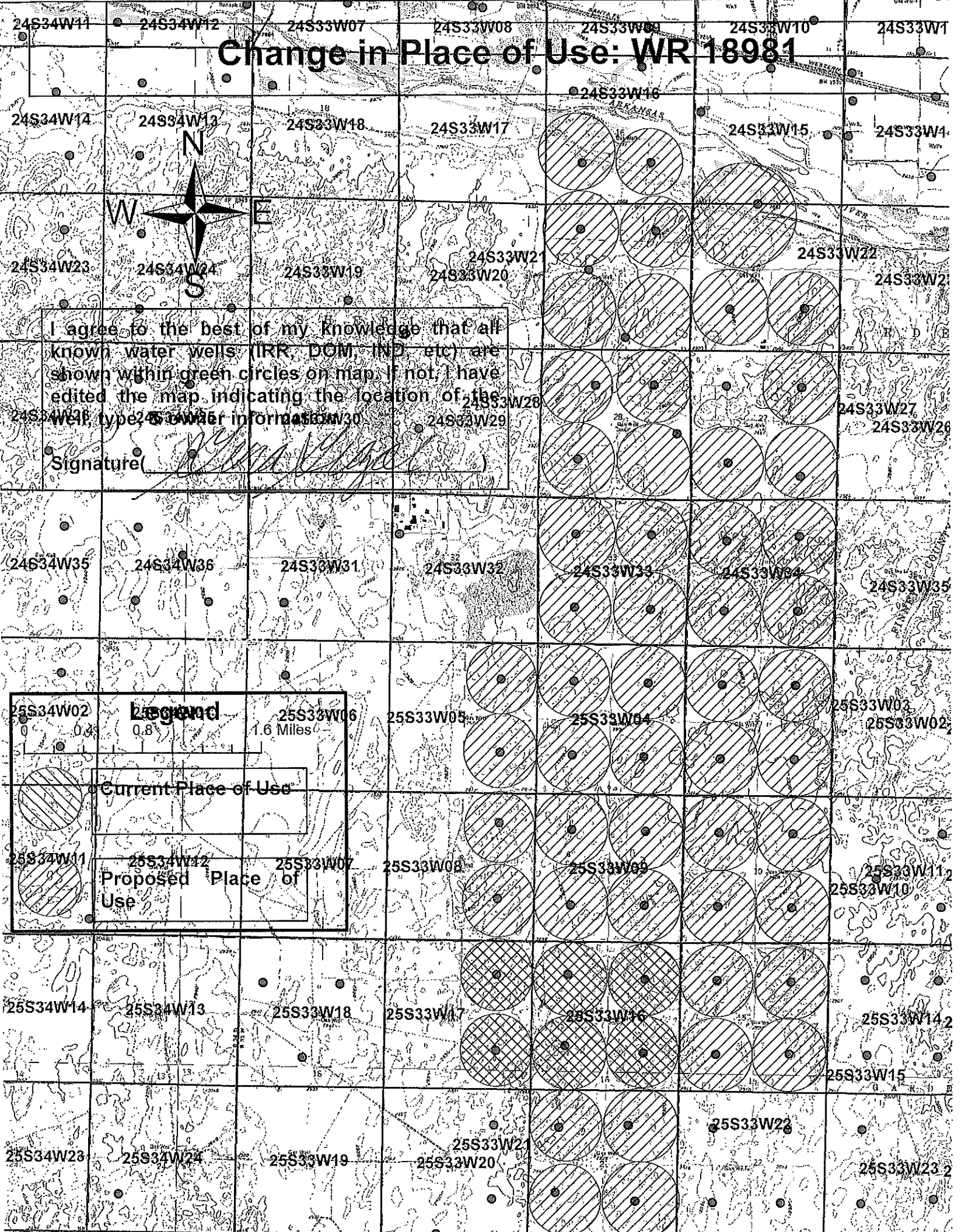

I agree to the best of my knowledge that all known water wells (IRR, DOM, IND, etc) are shown within green circles on map. If not, I have edited the map indicating the location of the well, type, & owner information.

Signature: *[Handwritten Signature]*

Legend

0 0.4 0.8 1.6 Miles

○ Current Place of Use

○ Proposed Place of Use

