

Kansas Department of Agriculture
 Division of Water Resources
CHANGE: P/D WORKSHEET

1. File Number: 20929	2. Status Change Date: 6/29/18	3. Change Num: C1	4. Field Office: 04	5. GMD: 03
6. Status: <input checked="" type="checkbox"/> Approved <input type="checkbox"/> Denied by DWR/GMD <input type="checkbox"/> Dismiss by Request/Failure to Return				7. Filing Date of Change: 5/24/18
8a. Applicant(s) New to system <input type="checkbox"/> WHEATLAND ELECTRIC COOPERATIVE INC PERRY SMITH PO BOX 953 GARDEN CITY KS 67846		Person ID 19316 Add Seq# 1		
8b. Landowner(s) New to system <input type="checkbox"/> NC		Person ID _____ Add Seq# _____		
8c. Landowner(s) New to system <input type="checkbox"/>		Person ID _____ Add Seq# _____		
8d. WUC New to system <input type="checkbox"/> nc		Person ID _____ Add Seq# _____		
9. Documents and Enclosure(s): <input checked="" type="checkbox"/> DWR Meter(s) Date to Comply: 12/31/18 <input checked="" type="checkbox"/> N & P Date to Comply: 12/31/18				
<input type="checkbox"/> Anti-Reverse Meter <input type="checkbox"/> Meter Seal <input type="checkbox"/> Check Valve <input type="checkbox"/> N & P Form <input type="checkbox"/> Water Tube <input type="checkbox"/> Driller Copy <input type="checkbox"/> H & E Letter <input type="checkbox"/> Conservation Plan Date Required: _____ Date Approved: _____ Date to Comply: _____				
10. Use Made of Water From: _____ To: _____				
Date Prepared: 6/20/18 By: tpm Date Entered: _____ By: _____				

File No. **20929** 11. County: **KE** Basin: **ark** Stream: _____ Formation Code: **211/331** Special Use: _____

12. Points of Diversion
 Rate and Quantity
 Authorized Additional
 Rate Quantity Rate Quantity
 gpm/cfs af/mgy gpm/cfs af/mgy
 ent nw sw ne 11 25 35 3399 2025 'W Comment (AKA Line)

del 40593

13. Storage: Rate _____ NF _____ Quantity _____ ac/ft Additional Rate _____ NF _____ Additional Quantity _____ ac/ft

14. Limitation: _____ af/yr at _____ gpm (_____ cfs) when combined with file number(s) _____
 Limitation: _____ af/yr at _____ gpm (_____ cfs) when combined with file number(s) _____

15. 5YR Allocation: Allocation Type _____ Start Year _____ 5 YR Amount _____ Amount Unit _____ Base Acres _____ Comment _____

16. Place of Use CHK MOD DEL ENT	P U S E	S T R I D	NE 1/4			NW 1/4			SW 1/4			SE 1/4			Total	Owner	Chg?	Overlap Files
			NE 1/4	SW 1/4	SE 1/4	NW 1/4	SW 1/4	NE 1/4	SE 1/4	NW 1/4	SW 1/4	SE 1/4						

Base Acres: _____ Year: _____ Minimum Reasonable Quantity: _____
 Comments: _____

STATE OF KANSAS



DEPARTMENT OF AGRICULTURE
DIVISION OF WATER RESOURCES
GARDEN CITY FIELD OFFICE
2508 JOHNS STREET
GARDEN CITY, KS 67846-2804

PHONE: (620) 276-2901
FAX: (620) 276-9315
www.agriculture.ks.gov

GOVERNOR JEFF COLYER, M.D.
JACKIE MCCLASKEY, SECRETARY OF AGRICULTURE

June 29, 2018

WHEATLAND ELECTRIC COOPERATIVE INC
PERRY SMITH
PO BOX 953
GARDEN CITY KS 67846

RE: Change in Point of Diversion Water Right, File No 20929

Dear Mr. Smith;

Enclosed you will find a *Summary Order Approving Application for Change in Points of Diversion* for the above referenced file. This order modifies the authorized well location under the referenced file. This order modifies the original document; it should be recorded at the County Register of Deeds.

Your attention is directed to the enclosures and to the terms, conditions, and limitations specified in this order. The diversion works should be completed and reported to the Division of Water Resources by **December 31, 2018**. Enclosed is a form for this purpose, along with other information for reference.

A condition of this order is that an acceptable flow meter must be properly installed on the diversion works authorized under the referenced file number in accordance with the Kansas Administrative Regulations 5-1-4 through 5-1-12. This water flow meter shall be used to provide information required on the annual water use report.

This order shall become final if a request for a hearing is not filed with the Chief Engineer within 15 days of the date of service of this order. The date of service is the date listed on the enclosed *Certificate of Service*.

Should you have any questions, please feel free to call this office. If you would prefer, you could arrange an appointment for additional assistance.

Sincerely,

Thomas P. Makens
Assistant Water Commissioner

TPM:tpm
Enclosures

GMD#3

CERTIFICATE OF SERVICE

On this 30th day of June 2018, I hereby certify that the attached original Approval of Application to Change the Point of Diversion under Water Right, File No. 20929 dated June 29, 2018 was mailed postage prepaid, first class, US mail to the following:

WHEATLAND ELECTRIC COOPERATIVE INC
PERRY SMITH
PO BOX 953
GARDEN CITY KS 67846

Copy provided to GMD#3



Division of Water Resources

Submit completed application to:
 Kansas Department of Agriculture
 Division of Water Resources
 Field Office for your area.
 Call for address:

Topeka -- (785) 296-5733
 Stafford -- (620) 234-5311
 Stockton -- (785) 425-6787
 Garden City -- (620) 276-2901
<http://agriculture.ks.gov/dwr>

DWR FIELD OFFICE APPLICATION FOR APPROVAL TO CHANGE THE PLACE OF USE AND/OR THE POINT OF DIVERSION



STATE OF KANSAS

Filing Fee Must Accompany the Application, K.S.A. 82a-708b(b), as amended.
 Fee Schedule is on the third page of this application form.

Paragraph Nos. 1, 2, 3 & 5 must be completed. Complete all other applicable portions. If change in point of diversion is greater than 100 feet, or if place of use will be changed, include a topographic map or detailed plat showing the authorized and proposed point(s) of diversion and/or place of use.

RECEIVED
 9:35am
 MAY 24 2018

File No. 20929

1. Application is hereby made for approval of the Chief Engineer to change the (check one or both): Garden City Field Office
Division of Water Resources

Place of Use Point of Diversion

under the water right which is the subject of this application in accordance with the conditions described below.

The source of supply is: Groundwater Surface water

2. Name and address of Applicant: WHEATLAND ELECTRIC COOPERATIVE INC
PO BOX 230 SCOTT CITY KS 67871
 Phone Number: () Email address: _____
 Name and address of Water Use Correspondent: WHEATLAND ELECTRIC COOPERATIVE INC
PO BOX 230 SCOTT CITY KS 67871
 Phone Number: () Email address: _____

3. The presently authorized place of use is:
 Owner of Land ---- NAME: WHEATLAND ELECTRIC COOPERATIVE INC
 ADDRESS: PO BOX 230 SCOTT CITY KS 67871
 (If there is more than one landowner, attach supplemental sheets as necessary.)

Sec.	Twp.	Range	NE¼				NW¼				SW¼				SE¼				TOTAL ACRES		
			NE¼	NW¼	SW¼	SE¼	NE¼	NW¼	SW¼	SE¼	NE¼	NW¼	SW¼	SE¼	NE¼	NW¼	SW¼	SE¼			

4. If this application is for a change in place of use, it is proposed that the place of use be changed to:
 Owner of Land ---- NAME: no change in acres
 ADDRESS: _____
 (If there is more than one landowner, attach supplemental sheets as necessary.)

Sec.	Twp.	Range	NE¼				NW¼				SW¼				SE¼				TOTAL ACRES			
			NE¼	NW¼	SW¼	SE¼	NE¼	NW¼	SW¼	SE¼	NE¼	NW¼	SW¼	SE¼	NE¼	NW¼	SW¼	SE¼				

For Office Use Only: Code _____ Fee \$ 200 TR # _____ Receipt Date 5/24/18 Check # 151776

5. **Presently authorized point of diversion:**
 One in the _____ Quarter of the _____ nc Quarter of the _____ ne Quarter
 of Section _____ 11 _____, Township _____ 25 _____ South, Range _____ 35 _____ W,
 in Finney _____ County, Kansas, _____ 3960 _____ feet North _____ 1320 _____ feet West of Southeast corner of section.
 Authorized Rate _____ Authorized Quantity _____ Depth of well _____ (feet)
 (DWR use only: Computer ID No. 1 _____ GPS _____ feet North _____ feet West)
 This point will not be changed This point will be changed as follows:
Proposed point of diversion: (Complete only if change is requested)
 One in the _____ NW Quarter of the _____ SW Quarter of the _____ NE Quarter
 of Section _____ 11 _____, Township _____ 3399 25 ~~20-25~~ South, Range _____ 35 _____ W,
 in Finney _____ County, Kansas, _____ 3410 _____ feet North _____ 2065 _____ feet West of Southeast corner of section.
 Proposed Rate _____ Proposed Quantity _____ Proposed well depth (feet) _____
 This point is: Additional Well Geo Center List other water rights that will use this point _____

6. **Presently authorized point of diversion:**
 One in the _____ Quarter of the _____ Quarter of the _____ Quarter
 of Section _____, Township _____ South, Range _____
 in _____ County, Kansas, _____ feet North _____ feet West of Southeast corner of section.
 Authorized Rate _____ Authorized Quantity _____ Depth of well _____ (feet)
 (DWR use only: Computer ID No. _____ GPS _____ feet North _____ feet West)
 This point will not be changed This point will be changed as follows:
Proposed point of diversion: (Complete only if change is requested)
 One in the _____ Quarter of the _____ Quarter of the _____ Quarter
 of Section _____, Township _____ South, Range _____
 in _____ County, Kansas, _____ feet North _____ feet West of Southeast corner of section.
 Proposed Rate _____ Proposed Quantity _____ Proposed well depth (feet) _____
 This point is: Additional Well Geo Center List other water rights that will use this point _____

7. Why do you need a new point of diversion? _____
 old well needs to be replaced.

8. If a well, is the test hole log attached? Yes No

9. When do you propose to complete the new point of diversion?
 June 15, 2015 completed

10. If the point of diversion is a well:
 (a) What are you going to do with the old well?
 plug GO
 (b) When will this be done? 2015

11. Groundwater Management District recommendation attached? Yes No

12. Assisted by tpm

13a. If the proposed point of diversion will be relocated within 100 feet of the existing point of diversion, indicate its location on the diagram below in relation to the existing point of diversion. (PLEASE NOTE: The "X" in center of diagram below represents presently authorized point of diversion.)

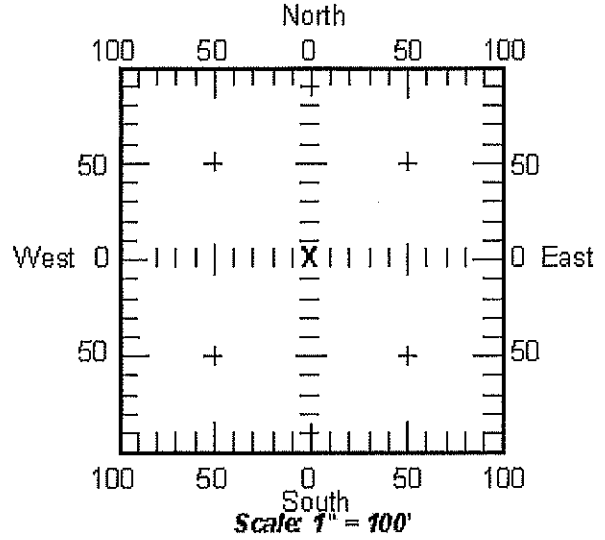

13b. If the proposed point of diversion will be relocated more than 100 feet but within 1320 feet from the existing point of diversion, attach a topographic map or aerial photograph. For groundwater sources, show all wells (including domestic) within one-half mile of the proposed point of diversion and the names and mailing addresses of the owners. For surface water sources, show the names and addresses of the landowner(s) one-half mile downstream and one-half mile upstream from your property lines.

14. If the proposed groundwater point of diversion is 300 or fewer feet from existing point of diversion, complete the following:

- (a) Does the undersigned represent all owners of the currently authorized place(s) of use identified in this application?
 Yes No (If no, all owners must sign this application.)
- (b) Will the ownership interest of any owner of the currently authorized place(s) of use identified in this application be adversely affected if this application is approved as requested?
 Yes No (If yes, all owners must sign this application.)
- (c) If this application is not approved expeditiously, will there be substantial damage to property, public health or safety?
 Yes No (If no, all owners must sign this application.)

If the application proposes a surface water change in point of diversion, a groundwater change in point of diversion greater than 300 feet, or a change in place of use, the application must be signed by all owners of the currently authorized place of use, or their duly authorized agent (attach notarized statement authorizing representation).

I hereby verify, being first duly sworn upon my oath or affirmation and under penalty of perjury, that I am of lawful age and the owner, the spouse of the owner, or a duly authorized agent of the owner(s) to make this application on their behalf, in regard to the water right(s) to which this application pertains. I further verify that the statements contained in this application are true, correct and complete.

Dated at _____, Kansas, this 24th day of May, 2018.

X Luke West (Whetland Electric) _____ (Spouse)
 (Owner)

Luke West _____ (Please Print)
 (Please Print)

 (Owner) _____ (Spouse)

 (Please Print) _____ (Please Print)

 (Owner) _____ (Spouse)

 (Please Print) _____ (Please Print)

State of Kansas }
County of Finney } SS

I hereby certify that the foregoing application was signed in my presence and sworn to before me this 24th day of May, 2018.

My Commission Expires 01-23-2022



Megan Jo Sneath
Notary Public

ONLY COMPLETE APPLICATIONS WILL BE PROCESSED. To be complete, all of the applicable portions of the application form must be completed with accurate information; maps, if necessary, must be included; signatures of all the appropriate owners' must be affixed to the application and notarized; and the appropriate fee must be paid.

FEE SCHEDULE

Each application to change the place of use or the point of diversion under this section shall be accompanied by the application fee set forth in the schedule below: Make checks payable to: **Kansas Department of Agriculture**

- (1) Application to change a point of diversion 300 feet or less \$100
- (2) Application to change a point of diversion more than 300 feet **\$200**
- (3) Application to change the place of use \$200

SUMMARY ORDER APPROVING APPLICATION FOR CHANGE AND IMPOSING CONDITIONS

This Summary Order is issued under authority of K.S.A. 82a-708b, as amended, and K.A.R. 5-14-3 and other applicable provisions of the *Kansas Water Appropriation Law, K.S.A. 82a-701 et. seq.*, and rules and regulations promulgated thereunder, K.A.R. 5-1-1 *et. seq.* With the exception of those conditions expressly contained herein, this Summary Order does not change the terms, conditions and limitations of File No. 20929.

1. A change application was received on MAY 24, 2018 requesting that the place of use and / or point of diversion authorized under the above-referenced file number be changed as described in the application.
2. On and after the effective date of this summary order, the authorized place(s) of use shall be located substantially as shown on the topographic map accompanying the application to change the place of use. Applicable Not Applicable
3. The change in point of diversion shall not impair existing rights and shall be limited to the same source or sources of water as previously authorized. The point of diversion authorized by this summary order shall be located within a 300 foot radius of the authorized point(s) of diversion. Applicable Not Applicable
4. The point(s) of diversion authorized herein shall not actually be located more than _____ feet from the previously authorized point(s) of diversion. Applicable Not Applicable
5. As required by K.A.R. 5-3-5d, if the works for diversion is a well with a diversion rate of 100 gallons per minute or more, a tube or other device suitable for making water level measurements shall be installed, operated and maintained in accordance with K.A.R. 5-6-13. Applicable Not Applicable
6. The owner of the authorized place(s) of use shall properly install an acceptable water flow meter on or before ~~December 31, 2018~~ or before the first use of water, whichever occurs first. The water flow meter shall be installed, operated and maintained in accordance with K.A.R. 5-1-4 through 5-1-12. As required by K.S.A. 82a-732, as amended, and K.A.R. 5-3-5e, the owner shall maintain records and report the reading of the water flow meter and the total quantity of water diverted annually to the Chief Engineer by March 1 following the end of each calendar year. Applicable Not Applicable
7. Installation of the works for diversion of water shall be completed on or before ~~December 31, 2018~~ or within any authorized extension of time. By March 1, ~~2019~~ the applicant shall notify the Chief Engineer that construction of the works for diversion has been completed, on the form provided by the Chief Engineer, as required by K.A.R. 5-8-4e. Applicable Not Applicable
8. The completed well log shall be submitted with the required notice. Applicable Not Applicable
9. All diversion works into which any type of chemical or other foreign substance will be injected into the water shall be equipped with an in-line, automatic, quick-closing check valve capable of preventing pollution of the source of the water supply. The check valve(s) shall be installed, operated and maintained in accordance with K.A.R. 5-3-5c. Applicable Not Applicable
10. Additional Conditions are attached. Yes No
11. In accordance with K.S.A. 82a-708a, as amended, and K.A.R. 5-5-14, all of the owners of the authorized place(s) of use of water appropriated under the above-referenced file number are responsible for compliance with its terms, conditions and limitations, as amended and/or supplemented by this Summary Order, and with applicable provisions of the *Kansas Water Appropriation Law* and the *Rules and Regulations* promulgated thereunder. Failure to comply with these provisions may result in civil penalties pursuant to K.S.A. 82a-737, as amended, and/or the suspension or revocation and dismissal of the water or appropriation right or any other enforcement actions authorized by law.

Administrative Appeal and Effective Date of Order

You have the right to a hearing in accordance with K.A.R. 5-14-3 before this Summary Order becomes final action of the Kansas Department of Agriculture. Any request for a hearing must be filed with the Chief Engineer, Division of Water Resources, Kansas Department of Agriculture, 1320 Research Park Drive, Topeka, Kansas 66502, within 15 days after the date shown on the Certificate of Service attached hereto. If a hearing is not requested in accordance with K.A.R. 5-14-3, this Summary Order will become effective on the 15th day after the date shown on the Certificate of Service.

For Use by Register of Deeds

FOR OFFICE USE ONLY
**APPLICATION APPROVED AND
SUMMARY ORDER ISSUED**

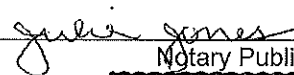
By: 
Duly Authorized Designee of the Chief Engineer
(Print Name): THOMAS P. MAKENS
Division of Water Resources - Kansas Department of Agriculture
Date of Issuance: JUNE 29, 2018
State of Kansas)
County of Jiminy) SS
Acknowledged before me on June 29, 2018
by Thomas P. Makens
Signature: 
Notary Public

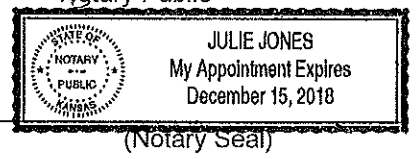

My commission expires: _____

(Notary Seal)

20929

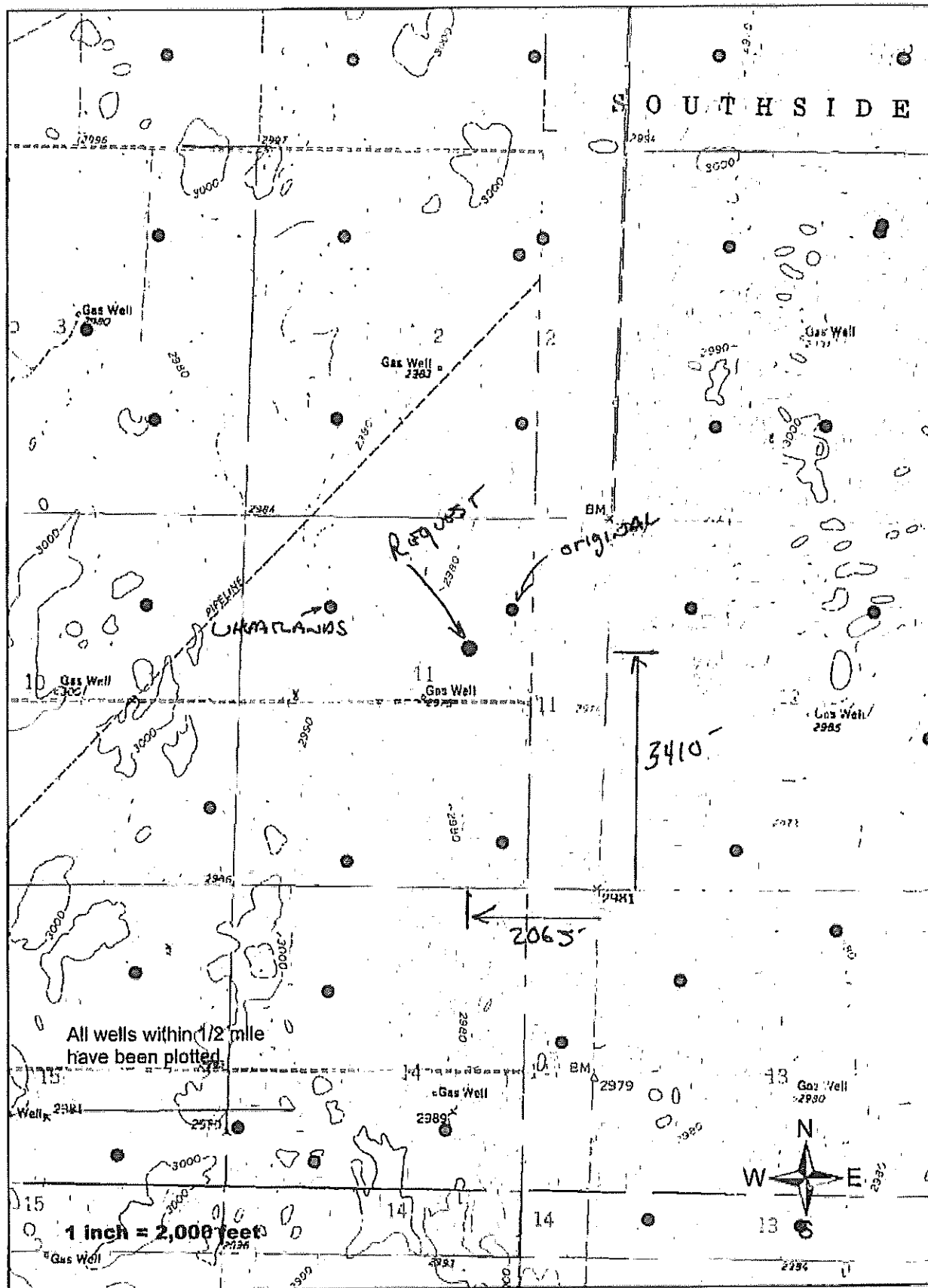



3795 W. Jones Ave
 Phone: 620-277-2399
 Fax: 620-277-0224

PERRY SMITH CRU 620-277-4424

MAY 18 2015

PO Box 639
 Garden City, KS 67846

CUSTOMER'S NAME Wheatland Electric Co-op Attn: Lynn FRESSE
 STREET ADDRESS P.O. Box 230
 CITY & STATE Scottsbluff, KS 67871
 COUNTY Kearney QUARTER NE SECTION 11 TOWNSHIP 25
 RIG # 37 W/O 8602

DATE 5-12-15
 TEST # 4 E. LOG
 DRILLER Mike Gwin
 RANGE 35

LOCATION
 GPS N37.89628 W101.12857

WELL LOCATION
 ELEVATION

%	FOOTAGE			DESCRIPTION OF STRATA	Static Water Level: <u>200'</u> Proposed Well Depth: <u>468'</u> <u>INCLUDING 20' SLUMP</u>
	From	Pay	To		
	0		2	Top Soil - Sandy	
	2		4	Fine sand	
	4		11	Brown sandy clay	
	11		34	Sand fine to med coarse small med fine gravel	
	34		63	Brown sandy clay	
	63		90	Sand fine to med coarse small gravel	
	90		128	Brown Clay	
	128		131	Sand fine to med coarse	
	131		169	Blue Clay	
25	169	22	222	Sand fine to med coarse small gravel	
	222		228	Brown sandy clay	
25	228	21	249	Sand fine to med coarse	
	249		254	Brown sandy clay	
5	254	26	280	Fine sand w/ some clay & silt	
15	280	20	300	Sand fine some med w/ few clay stringers	
25	300	15	315	Sand fine to med	
	315		337	Brown sandy clay sticky	
5	337	24	361	Fine sand w/ more clay stringers	
	361		406	Sandstone	
10	406	42	448	Sandstone - used water min bean - lost circ @ 414' & 440'	
	448		460	Shale	

062824

M & Gel - 9
 Grout - 5
 Bean - 7
 Hole Plug 1/8 - 5
 Pump Plug - 1
 1/4 Day Blade - 1

21380 20825
 20922

STATE OF KANSAS



PHONE: (620) 276-2901
FAX: (620) 276-9315
www.agriculture.ks.gov

DEPARTMENT OF AGRICULTURE
DIVISION OF WATER RESOURCES
GARDEN CITY FIELD OFFICE
2508 JOHNS STREET
GARDEN CITY, KS 67846-2804

GOVERNOR JEFF COLYER, M.D.
JACKIE McCLASKEY, SECRETARY OF AGRICULTURE

June 1, 2018

Southwest Kansas Groundwater
Management District No 3
409 Campus Drive, Suite 106
Garden City KS 67846

Re: Water Right file number 20929

Dear Mr. Norquest;

Wheatland Electric Coop. has applied to relocate the well authorized by the above water right number. There is one neighboring well within ½ mile of the requested.

We are delaying action for 15 days on the change application to allow you time to review and provide a recommendation if you feel one is warranted.

Thank you and as always feel free to call or write us at any time.

Sincerely;

Thomas P Makens

TPM:tpm

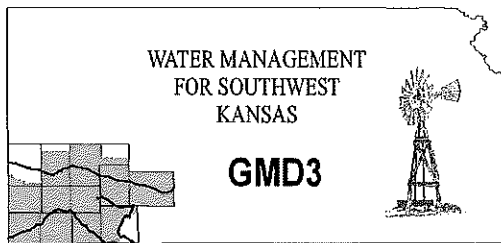

**Southwest Kansas
Groundwater Management District No. 3**
2009 E. Spruce Street
Garden City, Kansas 67846
(620) 275-7147 phone (620) 275-1431 fax
www.gmd3.org

June 4, 2018

Thomas P. Makens
Division of Water Resources
2508 N Johns Street
Garden City, Kansas 67846

RECEIVED

JUN 08 2018

RE: Application for Change in Point of Diversion
Water Right, File No. 20929

Garden City Field Office
Division of Water Resources

Dear Thomas:

We have completed a review of the application for the above referenced water right. The proposal is not in conflict with the Management Program of the Southwest Kansas Groundwater Management District No. 3 (GMD3). The proposed distance moved and well spacing is in accordance with K.A.R. 5-23-3. It is therefore recommended that the application be approved at this time.

Thank you for the opportunity to review the applications and to provide a recommendation. If you have any questions, please don't hesitate to contact us.

Sincerely,

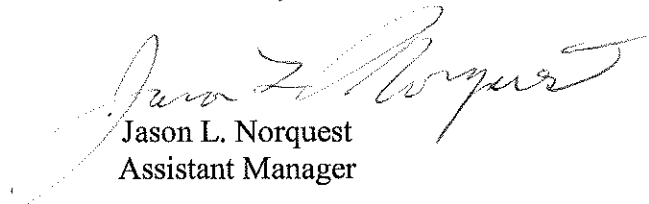

Jason L. Norquest
Assistant Manager

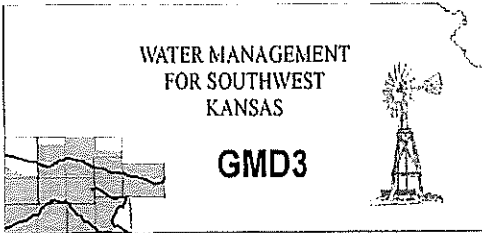

Southwest Kansas
Groundwater Management District No. 3
2009 E. Spruce Street
Garden City, Kansas 67846
(620) 275-7147 phone (620) 275-1431 fax
www.gmd3.org

June 4, 2018

Thomas P. Makens
Division of Water Resources
2508 N Johns Street
Garden City, Kansas 67846

RECEIVED

JUN 04 2018

Garden City Field Office
Division of Water Resources

RE: Application for Change in Point of Diversion
Water Right, File No. 20929

Dear Thomas:

We have completed a review of the application for the above referenced water right. The proposal is not in conflict with the Management Program of the Southwest Kansas Groundwater Management District No. 3 (GMD3). The proposed distance moved and well spacing is in accordance with K.A.R. 5-23-3. It is therefore recommended that the application be approved at this time.

Thank you for the opportunity to review the applications and to provide a recommendation. If you have any questions, please don't hesitate to contact us.

Sincerely,

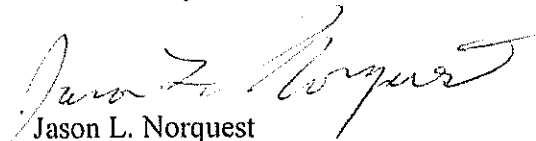
Jason L. Norquest
Assistant Manager

GMD3 Change Review

File No(s): 20929.

DWR office: GC.

App filed to change: PD.

Is Landowner(s) correct in WRIS: Wheatland Electric Coop.

If NO, is documentation included?

Is Water Use Correspondent correct in WRIS? .

If NO, is documentation included?

Regulation(s) Reviewed: KAR 5-23-3

Point of diversion ID No(s) 01 being changed.

RECEIVED

JUN 04 2018

Garden City Field Office
Division of Water Resources

	ft. North	ft. West	
Authorized PD	3960	1320	Sect. 11-25-35
Proposed PD	3410	2065	
Difference	550 S	-745 W	
$a^2 + b^2 = c^2$	302500	555025	926.0265 foot move SW

GPS for proposed PD: Lat: 37.89628 Long: -101.12857.

Is proposed PD stacking on existing WRs? NO.

Is Proposed PU overlapping existing WRs? .

Land Owner(s) notified: .

Name .

Name .

Address .

Address .

Zip .

Zip .

Neighboring certified well(s) notified: Appears so.

Name .

Name .

Address .

Address .

Zip .

Zip .

Domestic well(s) notified: None found in area of concern.

Name .

Name .

Address .

Address .

Zip .

Zip .

Base Acres: .

Perfected Acres: .

Irr. Return-Flow %

Lose of production in current well. Distance moved and spacing appears met. The proposed depth of the well is in common with the area wells.

Is a waiver needed: No.

Final Recommendation: After review of all available information, it appears the current area rules are met. Staff therefore recommends approval of the application.



20929 Change App Review, PD

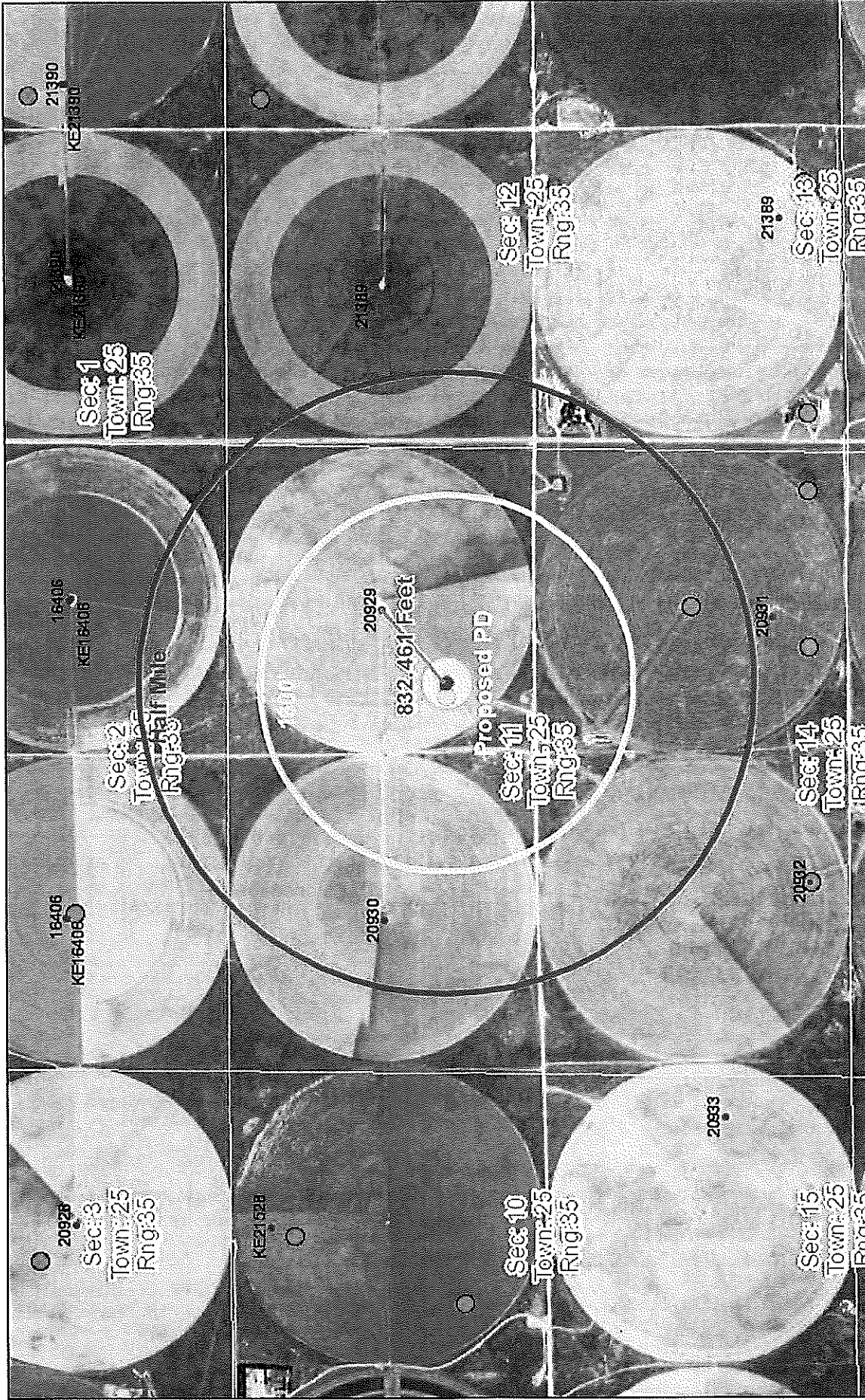

June 4, 2018
09:47 AM

DISCLAIMER: This map is not intended for conveyances, nor is it a legal survey. The information is presented on a best-efforts basis, and should not be relied upon for making financial, survey, legal or other commitments.

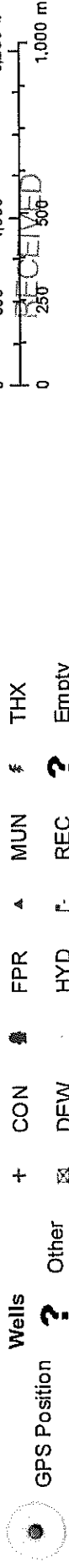

RECEIVED
JUN 04 2018

WVWC5 WELLS GMD3

Water Rights and Points of Diversion Within 1.00 miles of point defined as:

3410 ft N and 2065 ft W of the SE Corner of Section 11, T 25S, R 35W

Located at: 101.128570 West Longitude and 37.896281 North Latitude

GROUNDWATER ONLY

1600' on All

File Number	Use	ST	SR	Dist (ft)	Q4	Q3	Q2	Q1	FeetN	FeetW	Sec	Twp	Rng	ID	Batt	Auth_Quan	Add_Quan	Unit
A__ 16406 00	IRR	NK	G	3324	--	--	NC	SE	1320	1320	2	25	35W	4		252.00	252.00	AF ✓
Same				3777	--	--	NC	SW	1387	4015	2	25	35W	5		252.00	252.00	AF ✓
A__ 20929 00	IRR	NK	G	927	--	--	NC	NE	3960	1320	11	25	35W	1		272.00	272.00	AF ✓
A__ 20930 00	IRR	NK	G	1976	--	--	NC	NW	3960	3960	11	25	35W	2		272.00	272.00	AF ✓
A__ 20931 00	IRR	NK	G	2861	--	--	SE	SW SE	630	1390	11	25	35W	5		272.00	272.00	AF ✓
A__ 20932 00	IRR	NK	G	3591	--	--	SW	SE SW	257	3783	11	25	35W	7		272.00	272.00	AF ✓
A__ 20933 00	IRR	NK	G	4281	--	--	NE	SE SE	1068	335	10	25	35W	5		272.00	272.00	AF ✓
A__ 21389 00	IRR	NK	G	3377	--	--	NC	NW	3960	3960	12	25	35W	2		273.00	273.00	AF ✓
Same				4947	--	--	SE	SE SW	510	3235	12	25	35W	5		270.00	270.00	AF ✓
A__ 21390 00	IRR	NK	G	4840	--	--	NW	SE SW	1307	3760	1	25	35W	3		267.00	267.00	AF ✓
A__ 21528 00	IRR	NK	G	4811	--	--	NW	NE NE	4954	1319	10	25	35W	6		272.00	272.00	AF ✓

Total Net Quantities Authorized:	Direct	Storage
Total Requested Amount (AF) =	.00	.00
Total Permitted Amount (AF) =	.00	.00
Total Inspected Amount (AF) =	.00	.00
Total Pro_Cert Amount (AF) =	.00	.00
Total Certified Amount (AF) =	2946.00	.00
Total Vested Amount (AF) =	.00	.00
TOTAL AMOUNT (AF) =	2946.00	.00

Supply MET!

An * after the source of supply indicates a pending application for change for the file number.
 An * after the ID indicates a 15 AF exemption was granted for the file number.
 A "G" in the Batt column indicates the GEO CTR of a battery. A "B" indicates a well in the battery.
 The number in the Batt column is the number of wells in the battery.

RECEIVED

Water Rights and Points of Diversion Within 1.00 miles of point defined as:

101.128570 West Longitude and 37.896281 North Latitude

GROUNDWATER ONLY

WATER USE CORRESPONDENTS:

JUN 04 2018

Garden City Field Office
Division of Water Resources

File Number	Use	ST	SR
A__ 16406 00	IRR	NK	G
>	WHEATLAND ELECTRIC COOPERATIVE INC		
>	PERRY SMITH		
>	PO BOX 953		
>	GARDEN CITY KS 67846		

A__ 20929 00	IRR	NK	G
>	WHEATLAND ELECTRIC COOPERATIVE INC		
>	PERRY SMITH		
>	PO BOX 953		
>	GARDEN CITY KS 67846		

A__ 20930 00	IRR	NK	G
>	WHEATLAND ELECTRIC COOPERATIVE INC		
>	PERRY SMITH		

> PO BOX 953
> GARDEN CITY KS 67846

A__ 20931 00 IRR NK G
> TIM YOST
>
> 2396 ROAD 115
> LAKIN KS 67860

A__ 20932 00 IRR NK G
> DALE & CYNTHIA G YOST
> DALE YOST
> 1142 ROAD AA
> LAKIN KS 67860

A__ 20933 00 IRR NK G
> WHEATLAND ELECTRIC COOPERATIVE INC
> PERRY SMITH
> PO BOX 953
> GARDEN CITY KS 67846

A__ 21389 00 IRR NK G
> DALE & CYNTHIA G YOST
> DALE YOST
> 1142 ROAD AA
> LAKIN KS 67860

> WHEATLAND ELECTRIC COOPERATIVE INC
> PERRY SMITH
> PO BOX 953
> GARDEN CITY KS 67846

A__ 21390 00 IRR NK G
> WHEATLAND ELECTRIC COOPERATIVE INC
> PERRY SMITH
> PO BOX 953
> GARDEN CITY KS 67846

A__ 21528 00 IRR NK G
> WHEATLAND ELECTRIC COOPERATIVE INC
> PERRY SMITH
> PO BOX 953
> GARDEN CITY KS 67846

RECEIVED

JUN 04 2018

Garden City Field Office
Division of Water Resources

=====

INPUTS	
Target Section Definition	
Section	11
Township	25
Range	35
Range Direction	W
Target Point Coordinates (NAD27 or NAD83)	
Target Longitude	-101.128570
Target Latitude	37.896280

Load Data and Compute

Instructions

1. Enter values for section, township, range and range direction.
2. Enter NAD27 or NAD83 longitude and latitude of target point.
3. Click "Load Data and Compute" button.
4. Use feet distances corresponding to datum of target point.

Loaded Section Data			
From LEOBASE using NAD83			
Corner	Corner Latitudes	Corner Longitudes	
SW	37.88690844	-101.14024809	
NW	37.90143444	-101.14003401	
NE	37.90151089	-101.12157069	
SE	37.88693878	-101.12186088	
Degrees Longitude per Foot	3.46518459E-06		
Degrees Latitude per Foot	2.74614176E-06		
Target Point Distances from Corners using NAD83			
Corner	Feet North(+)/South(-)	Feet East(-)/West(+)	
SW	3413	-3370	
NW	-1877	-3308	
NE	-1905	2020	
SE	3402	1936	

Target point is in Section

Loaded Section Data			
From LEOBASE using NAD27			
Corner	Corner Latitudes	Corner Longitudes	
SW	37.88688700	-101.13980100	
NW	37.90141300	-101.13958700	
NE	37.90148900	-101.12112400	
SE	37.88691700	-101.12141400	
Degrees Longitude per Foot	3.46518358E-06		
Degrees Latitude per Foot	2.74598553E-06		
Target Point Distances from Corners using NAD27			
Corner	Feet North(+)/South(-)	Feet East(-)/West(+)	
SW	3421	-3241	
NW	-1869	-3179	
NE	-1897	2149	
SE	3410	2065	

Target point is in Section

Difference (NAD83 Minus NAD27)			
Corner	Corner Latitudes	Corner Longitudes	
SW	0.00002144	-0.00044709	
NW	0.00002144	-0.00044701	
NE	0.00002189	-0.00044669	
SE	0.00002178	-0.00044688	
Difference (NAD83 Minus NAD27)			
Corner	Feet North(+)/South(-)	Feet East(-)/West(+)	
SW	-8.00192839	-129.02248096	
NW	-7.70096797	-128.99941224	

RECEIVED

JUN 04 2018

Garden City Field Office
Division of Water Resources