

Kansas Department of Agriculture
 Division of Water Resources
CHANGE: P/D WORKSHEET

1. File Number: 22566	2. Status Change Date: 4/12/18	3. Change Num: C1	4. Field Office: 04	5. GMD: 03
6. Status: <input checked="" type="checkbox"/> Approved <input type="checkbox"/> Denied by DWR/GMD <input type="checkbox"/> Dismiss by Request/Failure to Return				7. Filing Date of Change: 3/26/18
8a. Applicant(s) New to system <input type="checkbox"/> TRI-STATE GENERATION & TRANSMISSION SENIOR MANAGER FUEL & WATER RESOURCES 1100 W 116TH AVE WESTMINSTER CO 80234-2814		Person ID 60150 Add Seq# 1		8c. Landowner(s) New to system <input type="checkbox"/> NC
8b. Landowner(s) New to system <input type="checkbox"/> NC		Person ID _____ Add Seq# _____		8d. WUC New to system <input type="checkbox"/> Person ID _____ Add Seq# _____
9. Documents and Enclosure(s): <input checked="" type="checkbox"/> DWR Meter(s) Date to Comply: 12/31/18 <input checked="" type="checkbox"/> N & P Date to Comply: 12/31/18				
<input type="checkbox"/> Anti-Reverse Meter <input type="checkbox"/> Meter Seal <input type="checkbox"/> Check Valve <input type="checkbox"/> N & P Form <input type="checkbox"/> Water Tube <input type="checkbox"/> Driller Copy <input type="checkbox"/> H & E Letter <input type="checkbox"/> Conservation Plan Date Required: _____ Date Approved: _____ Date to Comply: _____				
10. Use Made of Water From: _____ To: _____				
Date Prepared: 4/10/18				By: TPM
Date Entered: _____				By: _____

STATE OF KANSAS

DEPARTMENT OF AGRICULTURE
DIVISION OF WATER RESOURCES
GARDEN CITY FIELD OFFICE
2508 JOHNS STREET
GARDEN CITY, KS 67846-2804



PHONE: (620) 276-2901
FAX: (620) 276-9315
www.agriculture.ks.gov

GOVERNOR JEFF COLYER, M.D.
JACKIE McCLASKEY, SECRETARY OF AGRICULTURE

April 12, 2018

SOUTHWEST AG
PO BOX 897
GARDEN CITY KS 67846

RE: Change in Point of Diversion Water Right, File No 22566

Dear Mr. Hansen:

Enclosed you will find a *Summary Order Approving Application for Change in Points of Diversion* for the above referenced file. This order modifies the authorized well location under the referenced file. This order modifies the original document; it should be recorded at the County Register of Deeds.

Your attention is directed to the enclosures and to the terms, conditions, and limitations specified in this order. The diversion works should be completed and reported to the Division of Water Resources **by December 31, 2018**. Enclosed is a form for this purpose, along with other information for reference.

A condition of this order is that an acceptable flow meter must be properly installed on the diversion works authorized under the referenced file number in accordance with the Kansas Administrative Regulations 5-1-4 through 5-1-12. This water flow meter shall be used to provide information required on the annual water use report.

This order shall become final if a request for a hearing is not filed with the Chief Engineer within 15 days of the date of service of this order. The date of service is the date listed on the enclosed *Certificate of Service*.

Should you have any questions, please feel free to call this office. If you would prefer, you could arrange an appointment for additional assistance.

Sincerely,

Thomas P. Makens
Assistant Water Commissioner

TPM:tpm
Enclosures
GMD#3

CERTIFICATE OF SERVICE

On this 13th day of April 2018, I hereby certify that the attached original Approval of Application to Change the Point of Diversion under Water Right, File No. 22566 dated April 12, 2018 was mailed postage prepaid, first class, US mail to the following:

SOUTHWEST AG
PO BOX 897
GARDEN CITY KS 67846

Copy provided to GMD#3

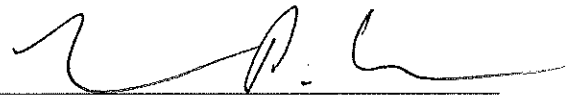
A handwritten signature in black ink, appearing to be 'R. P. L.', written over a horizontal line.

Division of Water Resources

Submit completed application to:
 Kansas Department of Agriculture
 Division of Water Resources
 Field Office for your area.
 Call for address:

Topeka -- (785) 862-6300
 Stafford -- (620) 234-5311
 Stockton -- (785) 425-6787
 Garden City -- (620) 276-2901
www.ksda.gov/dwr

**DWR FIELD OFFICE
 APPLICATION FOR APPROVAL
 TO CHANGE THE PLACE OF
 USE AND/OR THE
 POINT OF DIVERSION**

TRI 8



STATE OF KANSAS

Filing Fee Must Accompany the Application, K.S.A. 82a-708b(b), as amended.
 Fee Schedule is on the third page of this application form.

Paragraph Nos. 1, 2, 3 & 5 must be completed. Complete all other applicable portions. If change in point of diversion is greater than 100 feet, or if place of use will be changed, include a topographic map or detailed plat showing the authorized and proposed point(s) of diversion and/or place of use.

RECEIVED
 1:02 pm
 MAR 26 2018

File No. 22566

1. Application is hereby made for approval of the Chief Engineer to change the (check one or both): Garden City Field Office
Division of Water Resources
 Place of Use Point of Diversion

under the water right which is the subject of this application in accordance with the conditions described below.

The source of supply is: Groundwater Surface water

2. Name and address of Applicant: TRI-STATE GENERATION & TRANSMISSION
1100 W 116TH AVE WESTMINSTER CO 80234-2814
 Phone Number: (620)271-4493 Email address: (% perry hansen)
 Name and address of Water Use Correspondent: TRI-STATE GENERATION & TRANSMISSION
1100 W 116TH AVE WESTMINSTER CO 80234-2814
 Phone Number: () Email address: _____

3. The presently authorized place of use is:
 Owner of Land ---- NAME: TRI-STATE GENERATION & TRANSMISSION
ADDRESS: 1100 W 116TH AVE WESTMINSTER CO 80234-2814
 (If there is more than one landowner, attach supplemental sheets as necessary.)

Sec.	Twp.	Range	NE¼				NW¼				SW¼				SE¼				TOTAL ACRES	
			NE¼	NW¼	SW¼	SE¼	NE¼	NW¼	SW¼	SE¼	NE¼	NW¼	SW¼	SE¼	NE¼	NW¼	SW¼	SE¼		

4. If this application is for a change in place of use, it is proposed that the place of use be changed to:
 Owner of Land ---- NAME: no change to irr acres
ADDRESS: _____
 (If there is more than one landowner, attach supplemental sheets as necessary.)

Sec.	Twp.	Range	NE¼				NW¼				SW¼				SE¼				TOTAL ACRES	
			NE¼	NW¼	SW¼	SE¼	NE¼	NW¼	SW¼	SE¼	NE¼	NW¼	SW¼	SE¼	NE¼	NW¼	SW¼	SE¼		

For Office Use Only: Code _____ Fee \$ 100 TR # _____ Receipt Date 3/26/18 Check # 5430

5. **Presently authorized point of diversion:**
 One in the nc Quarter of the ne NW Quarter of the se Quarter
 of Section 4, Township 25 South, Range 34 W,
 in Finney County, Kansas, 2080 feet North 1287 feet West of Southeast corner of section.
 Authorized Rate 850 Authorized Quantity 272 Depth of well _____ (feet)
 (DWR use only: Computer ID No. 3 GPS 2093 feet North 1332 feet West) GMD
 This point will not be changed This point will be changed as follows:
Proposed point of diversion: (Complete only if change is requested)
 One in the ne Quarter of the nw Quarter of the se Quarter
 of Section 4, Township 25 South, Range 34 W,
 in Finney County, Kansas, 2381 feet North 1370 feet West of Southeast corner of section.
 Proposed Rate NC Proposed Quantity NC Proposed well depth (feet) _____
 This point is: Additional Well Geo Center List other water rights that will use this point _____

6. **Presently authorized point of diversion:**
 One in the nw Quarter of the nw Quarter of the sw Quarter
 of Section 4, Township 25 South, Range 34 W,
 in Finney County, Kansas, 2415 feet North 4755 feet West of Southeast corner of section.
 Authorized Rate 1035 Authorized Quantity 272 Depth of well _____ (feet)
 (DWR use only: Computer ID No. 4 GPS 2464 feet North 4826 feet West)
 This point will not be changed This point will be changed as follows:
Proposed point of diversion: (Complete only if change is requested)
 One in the _____ Quarter of the _____ Quarter of the _____ Quarter
 of Section _____, Township _____ South, Range _____ (EW),
 in _____ County, Kansas, _____ feet North _____ feet West of Southeast corner of section.
 Proposed Rate _____ Proposed Quantity _____ Proposed well depth (feet) _____
 This point is: Additional Well Geo Center List other water rights that will use this point _____

7. Why do you need a new point of diversion? _____
 old well needs to be replaced _____

13a. If the proposed point of diversion will be relocated within 100 feet of the existing point of diversion, indicate its location on the diagram below in relation to the existing point of diversion. (PLEASE NOTE: The "X" in center of diagram below represents presently authorized point of diversion.)

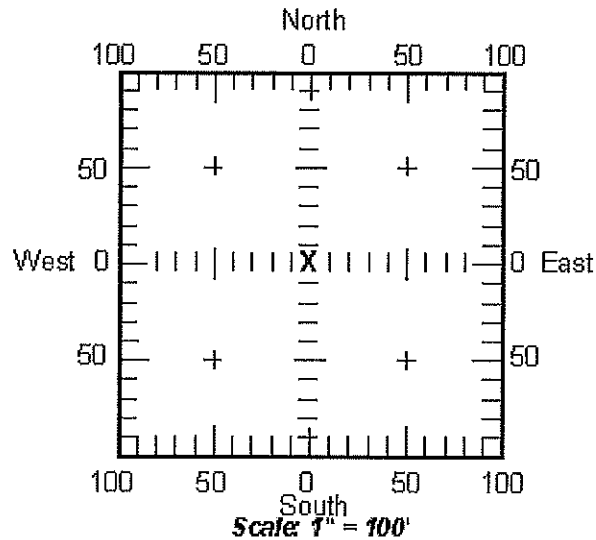

8. If a well, is the test hole log attached? Yes No

9. When do you propose to complete the new point of diversion?
March 15, 2018

10. If the point of diversion is a well:
 (a) What are you going to do with the old well?
plug
 (b) When will this be done? 2018

11. Groundwater Management District recommendation attached? Yes No

12. Assisted by tpm

13b. If the proposed point of diversion will be relocated more than 100 feet but within 1320 feet from the existing point of diversion, attach a topographic map or aerial photograph. For groundwater sources, show all wells (including domestic) within one-half mile of the proposed point of diversion and the names and mailing addresses of the owners. For surface water sources, show the names and addresses of the landowner(s) one-half mile downstream and one-half mile upstream from your property lines.

14. If the proposed groundwater point of diversion is 300 or fewer feet from existing point of diversion, complete the following:

- (a) Does the undersigned represent all owners of the currently authorized place(s) of use identified in this application?
 Yes No (If no, all owners must sign this application.)
- (b) Will the ownership interest of any owner of the currently authorized place(s) of use identified in this application be adversely affected if this application is approved as requested?
 Yes No (If yes, all owners must sign this application.)
- (c) If this application is not approved expeditiously, will there be substantial damage to property, public health or safety?
 Yes No (If no, all owners must sign this application.)

If the application proposes a surface water change in point of diversion, a groundwater change in point of diversion greater than 300 feet, or a change in place of use, the application must be signed by all owners of the currently authorized place of use, or their duly authorized agent (attach notarized statement authorizing representation).

I hereby verify, being first duly sworn upon my oath or affirmation and under penalty of perjury, that I am of lawful age and the owner, the spouse of the owner, or a duly authorized agent of the owner(s) to make this application on their behalf, in regard to the water right(s) to which this application pertains. I further verify that the statements contained in this application are true, correct and complete.

Dated at GARDEN CITY, Kansas, this 26TH day of MARCH, 2018.

*  _____ (Owner)	_____ (Spouse)
_____	_____
(Please Print)	(Please Print)
_____	_____
(Owner)	(Spouse)
_____	_____
(Please Print)	(Please Print)
_____	_____
(Owner)	(Spouse)
_____	_____
(Please Print)	(Please Print)

State of Kansas }
County of FINNEY } SS

I hereby certify that the foregoing application was signed in my presence and sworn to before me this 26TH day of MARCH, 2018.





Notary Public

My Commission Expires 9-14-18

ONLY COMPLETE APPLICATIONS WILL BE PROCESSED. To be complete, all of the applicable portions of the application form must be completed with accurate information; maps, if necessary, must be included; signatures of all the appropriate owners' must be affixed to the application and notarized; and the appropriate fee must be paid.

FEE SCHEDULE

- Each application to change the place of use or the point of diversion under this section shall be accompanied by the application fee set forth in the schedule below: Make checks payable to: **Kansas Department of Agriculture**
- (1) Application to change a point of diversion 300 feet or less **\$100**
 - (2) Application to change a point of diversion more than 300 feet **\$200**
 - (3) Application to change the place of use **\$200**

TOPO! map printed on 02/08/18 from "Untitled.tpo"

101.06667° W

NAD27 101.05000° W

37.91667° N

37.91667° N

37.90000° N

37.90000° N

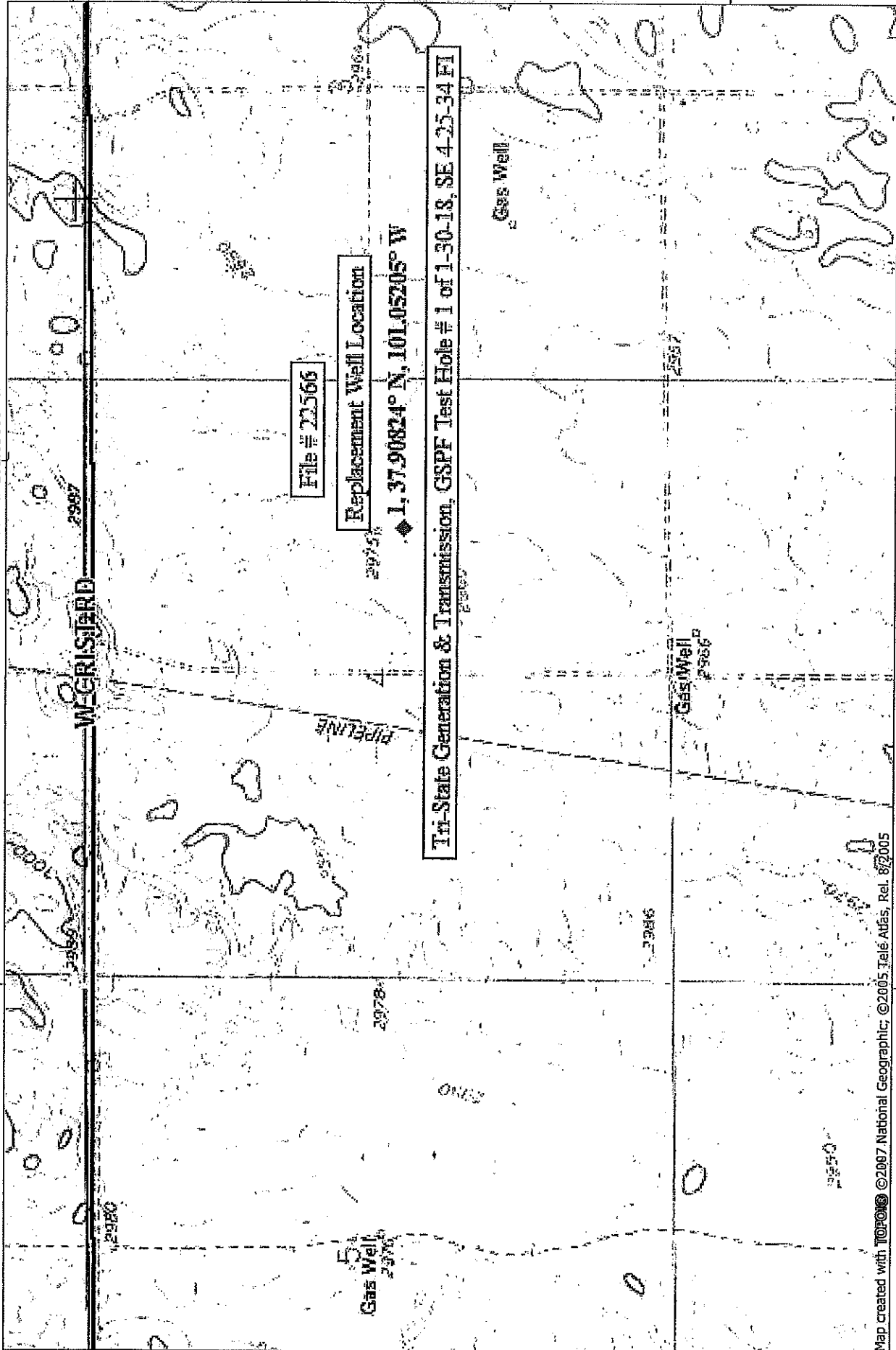

Map created with TOPO! © 2007 National Geographic, © 2005 Tele Atlas, Rel. 8/2005

TWAIN 5 1/2" 02/08/18

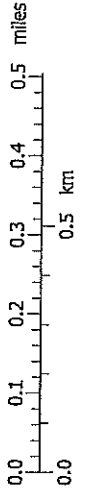

NATIONAL GEOGRAPHIC



PERRY HANSEN
620-271-4493
SOUTHWEST AG

GSPF IRRIGATION SERVICE

710 W Taylor Jones Rd
Holcomb, KS 67851
Phone: 620-277-2503
Fax: 620-277-2581

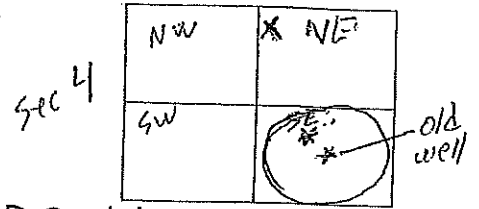

Customer Name: TRI-STATE GENERATION & TRANSMISSION Date: 1-30-18

Address: P.O. Box 33695 Test # 1 E Log NO

City & state DENVER CO. 80233 Driller: Dana Vogts

County Finney Quarter SE section: 4 Township: 25 Range: 34

Location: 280' NORTH & 11' WEST OF EXISTING WEL Elev:

GPS: 37.90824 N 101.05205 W

Rig# 1 WO#

				APPROX FRANK	
%	From	Pay	To	Description of Strata	Static Water Level
	0		2	Sandy top soil	280
	2		8	Fine sand	590
	8		34	Sandy silty clay	20' Sump
	34		46	Sand MC	
	46		53	Small-med gravel	
	53		68	Sand FMC	
	68		69	lime rock	
	69		89	Sand M-C gravel s-L	
	89		104	Tan clay w/ caliche strips	
	104		124	Tan sandy clay	
	124		133	Sand FMC	
	133		144	Tan sandy clay	
	144		158	Sand FMC small-med gravel	
	158		181	Sand FMC s-m gravel few sandy clay strips	
	181		216	Sand FMC few sandy clay strips	
	216		229	grey clay	
	229		237	Black clay	
	237		274	Sand FM Few sandy clay strips	
	274		280	Sandy clay + caliche strips	
				Cont.	22566

GSPF IRRIGATION SERVICE

710 W Taylor Jones Rd

Holcomb, KS 67851

Phone: 620-277-2503

Fax: 620-277-2581

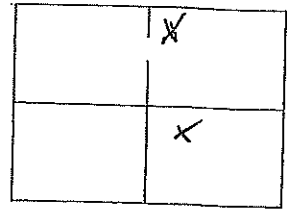

Customer Name: Tri State

Date: 1-30-18

Address: _____

Test # 1

E Log _____

City & state _____

Driller: _____

County Finney

Quarter NE

Section: 24

Township: 25

Range: 34

Location: _____

Elev: _____

Rig# _____

WO# _____

%	From	Pay	To	Description of Strata	Static Water Level <u>280</u>
					Proposed Well Depth _____
	280	16	296	Sand FMC few cemented strips	
	296	18	314	Sand MC	
	314	24	338	Sand MC w/caliche strips	
	338	24	362	Sand FMC Tight few sandy clay strips	
	362	35	397	Sand FM	
	397	14	411	Sand FM Few thin Red clay strips	
	411	17	428	Sand FM Rough	
	428	18	446	Sand MC	
	446	8	454	Fine sand and clay mix	↑ using alot of Water ↓
	454		456	Shale	
	456	17	473	Sand FM few thin yellow clay strips	
	473	6	479	Sand Fine	
	479	6	485	Sand FMC	
	485		487	Shale	
	487	21	508	Sand MC Tight	↑ using alot of water ↓
	508	6	514	Fine grey sand	
	514		520	grey clay	
	520		540	No sample Recovered	
		230			