

Kansas Department of Agriculture  
 Division of Water Resources  
**CHANGE: PU WORKSHEET**

|                                 |                        |                             |                               |                      |
|---------------------------------|------------------------|-----------------------------|-------------------------------|----------------------|
| 1. File Number:<br><b>23218</b> | 2. Status Change Date: | 3. Change Num:<br><b>C2</b> | 4. Field Office:<br><b>04</b> | 5. GMD:<br><b>03</b> |
|---------------------------------|------------------------|-----------------------------|-------------------------------|----------------------|

|  |   |
|--|---|
| 6. Status: <input checked="" type="checkbox"/> Approved <input type="checkbox"/> Denied by DWR/GMD <input type="checkbox"/> Dismiss by Request/Failure to Return | 7. Filing Date of Change:<br><b>11/8/18</b> |
|--|---|

|  |  |
|--|--|
| 8a. Applicant(s) / Landowner<br>New to system <input type="checkbox"/><br><br><b>RYAN BRADY</b><br><b>3405 16 RD</b><br><b>INGALLS KS 67853-9001</b> | 8c. Landowner(s)<br>New to system <input type="checkbox"/><br><br><b>MIKE BRADY</b><br><b>3405 16 RD</b><br><b>INGALLS KS 67853-9001</b> |
|--|--|

|   |  |
|---|--|
| 8b. Landowner(s)<br>New to system <input type="checkbox"/><br><br>Person ID _____<br>Add Seq# _____ | 8d. WUC<br>New to system <input type="checkbox"/><br><br>Person ID _____<br>Add Seq# _____ |
|---|--|

9. Documents and Enclosure(s):  DWR Meter(s) Date to Comply: **12/31/19**     N & P Date to Comply: \_\_\_\_\_

Anti-Reverse Meter   
  Meter Seal   
  Check Valve   
  N & P Form   
  Water Tube   
  Driller Copy   
  H & E Letter

Conservation Plan   
 Date Required: \_\_\_\_\_   
 Date Approved: \_\_\_\_\_   
 Date to Comply: \_\_\_\_\_

10. Use Made of Water    From: \_\_\_\_\_    To: \_\_\_\_\_

Date Prepared: **11/19/18**    By: **MAM**  
 Date Entered: \_\_\_\_\_    By: \_\_\_\_\_

File No. **23218**      11. County: GY      Basin: BUCKNER CREEK      Stream:      Formation Code:      Special Use:

| 12. Points of Diversion<br>CHK<br>MOD<br>DEL<br>ENT | PDIV | Qualifier | S | T | R | ID | 'N | 'W | Comment (AKA Line) | Rate and Quantity |                |             |                |                  |  |
|---|------|-----------|---|---|---|----|----|----|--------------------|-------------------|----------------|-------------|----------------|------------------|--|
|   |      |           |   |   |   |    |    |    |                    | Authorized        |                | Additional  |                |                  |  |
|   |      |           |   |   |   |    |    |    |                    | Rate<br>gpm       | Quantity<br>af | Rate<br>gpm | Quantity<br>af | Overlap PD Files |  |
|   |      |           |   |   |   |    |    |    |                    |                   |                |             |                |                  |  |
|   |      |           |   |   |   |    |    |    |                    |                   |                |             |                |                  |  |
|   |      |           |   |   |   |    |    |    |                    |                   |                |             |                |                  |  |
|   |      |           |   |   |   |    |    |    |                    |                   |                |             |                |                  |  |
|   |      |           |   |   |   |    |    |    |                    |                   |                |             |                |                  |  |

13. Storage: Rate \_\_\_\_\_ NF      Quantity \_\_\_\_\_ ac/ft      Additional Rate \_\_\_\_\_ NF      Additional Quantity \_\_\_\_\_ ac/ft

14. Limitation: \_\_\_\_\_ af/yr at \_\_\_\_\_ gpm ( \_\_\_\_\_ cfs) when combined with file number(s) \_\_\_\_\_  
 Limitation: \_\_\_\_\_ af/yr at \_\_\_\_\_ gpm ( \_\_\_\_\_ cfs) when combined with file number(s) \_\_\_\_\_

15. 5YR Allocation:    Allocation Type \_\_\_\_\_    Start Year \_\_\_\_\_    5 YR Amount \_\_\_\_\_    Amount Unit \_\_\_\_\_    Base Acres \_\_\_\_\_    Comment \_\_\_\_\_

| 16. Place of Use<br>CHK<br>MOD<br>DEL<br>ENT | PUSE  | S         | T | R | ID | NE¼     |         |         |         | NW¼     |         |         |         | SW¼     |         |         |         | SE¼     |         |         |         | Total | Owner | Chg? | Overlap Files |
|--|-------|-----------|---|---|----|---------|---------|---------|---------|---------|---------|---------|---------|---------|---------|---------|---------|---------|---------|---------|---------|-------|-------|------|---------------|
|  |       |           |   |   |    | NE<br>¼ | NW<br>¼ | SW<br>¼ | SE<br>¼ | NE<br>¼ | NW<br>¼ | SW<br>¼ | SE<br>¼ | NE<br>¼ | NW<br>¼ | SW<br>¼ | SE<br>¼ | NE<br>¼ | NW<br>¼ | SW<br>¼ | SE<br>¼ |       |       |      |               |
| ENT  | 32107 | 16-24-28W |   |   |    |         |         |         |         |         | 40      | 40      | 40      | 40      |         |         |         |         |         |         |         | 160   | 8C    | N    | 20089, 23218  |
| ENT  | 59224 | 16-24-28W |   |   |    |         | 40      | 40      | 40      | 40      |         |         |         |         |         |         |         |         |         |         |         | 160   | 8A    | N    | 23218, 20089  |
|  |       |           |   |   |    |         |         |         |         |         |         |         |         |         |         |         |         |         |         |         |         |       |       |      |               |
|  |       |           |   |   |    |         |         |         |         |         |         |         |         |         |         |         |         |         |         |         |         |       |       |      |               |
|  |       |           |   |   |    |         |         |         |         |         |         |         |         |         |         |         |         |         |         |         |         |       |       |      |               |

Base Acres:      Year:      Minimum Reasonable Quantity:  
 Comments:

STATE OF KANSAS

DEPARTMENT OF AGRICULTURE  
DIVISION OF WATER RESOURCES  
GARDEN CITY FIELD OFFICE  
2508 JOHNS STREET  
GARDEN CITY, KS 67846-2804



PHONE: (620) 276-2901  
FAX: (620) 276-9315  
www.agriculture.ks.gov

GOVERNOR JEFF COLYER, M.D.  
JACKIE MCCLASKEY, SECRETARY OF AGRICULTURE

November 20, 2018

RYAN BRADY  
3405 16 RD  
INGALLS KS 67853-9001

RE: Approval of Application to Change the Place of Use  
Water Right, File Nos. 20089 and 23218

Dear Sir:

Enclosed is an order executed by the designee of the Chief Engineer, Division of Water Resources, Kansas Department of Agriculture, approving the application for change under the above referenced file number.

Your attention is directed to the enclosures and to the terms, conditions, and limitations specified in this approval for change. A condition of this approval is that an acceptable water flow meter must be installed on the diversion works authorized under the referenced file number and meet current specifications. Please return the required notification of completion of the diversion works and installation of the required meter as soon as these actions are completed.

Since this order modifies the original documents referred to above, it should be recorded with the Register of Deeds as other instruments affecting real estate. Please also submit a copy of the current ownership deed to have our records changed.

Should you have any questions, please feel free to call this office. If you would prefer, you could arrange an appointment for additional assistance.

Sincerely,

Michael A. Meyer  
Water Commissioner

MAM:  
enclosures

pc: MIKE BRADY  
3405 16 RD  
INGALLS KS 67853-9001

Groundwater Management District No. 3

**CERTIFICATE OF SERVICE**

On this 20<sup>th</sup> day of November, 2018, I hereby certify that the foregoing Approval of Application for Change in Place of Use, Water Right, File Nos. 20,089 and 23,218, dated 20<sup>th</sup> day of November, 2018 was mailed postage prepaid, first class, US mail to the following:

RYAN BRADY  
3405 16 RD  
INGALLS KS 67853-9001  
With photocopies to:

MIKE BRADY  
3405 16 RD  
INGALLS KS 67853-9001

GROUNDWATER MANAGEMENT DISTRICT NO. 3.

  
\_\_\_\_\_  
Division of Water Resources Staff

Submit completed application to:  
 Kansas Department of Agriculture  
 Division of Water Resources  
 Field Office for your area.

Call for address:  
 Topeka -- (785) 296-5733  
 Stafford -- (620) 234-5311  
 Stockton -- (785) 425-6787  
 Garden City -- (620) 276-2901  
<http://agriculture.ks.gov/dwr>

## DWR FIELD OFFICE APPLICATION FOR APPROVAL TO CHANGE THE PLACE OF USE AND/OR THE POINT OF DIVERSION



**STATE OF KANSAS**

**Filing Fee Must Accompany the Application, K.S.A. 82a-708b(b), as amended.**  
 Fee Schedule is on the third page of this application form.

**Paragraph Nos. 1, 2, 3 & 5 must be completed. Complete all other applicable portions.** If change in point of diversion is greater than 100 feet, or if place of use will be changed, include a topographic map or detailed plat showing the authorized and proposed point(s) of diversion and/or place of use.

File No. 23218

**RECEIVED**  
 2:30 pm  
 NOV 08 2018

1. Application is hereby made for approval of the Chief Engineer to change the (check one or both):

Place of Use                       Point of Diversion

under the water right which is the subject of this application in accordance with the conditions described below.

The source of supply is:                       Groundwater                       Surface water

Garden City Field Office  
 Division of Water Resources

2. Name and address of Applicant: RYAN BRADY

Phone Number: (620)474-4917                      Email address: quarterturninc@gmail.com

Name and address of Water Use Correspondent: RYAN BRADY  
3405 16 RD, INGALLS KS 67853-9001

Phone Number: (620)474-4917                      Email address: quarterturninc@gmail.com

3. The presently authorized place of use is:

Owner of Land ---- NAME: RYAN BRADY

ADDRESS: 3405 16 RD, INGALLS KS 67853-9001

(If there is more than one landowner, attach supplemental sheets as necessary.)

| Sec. | Twp. | Range | NE¼ |     |     |     | NW¼ |     |     |     | SW¼ |     |     |     | SE¼ |     |     |     | TOTAL ACRES |
|------|------|-------|-----|-----|-----|-----|-----|-----|-----|-----|-----|-----|-----|-----|-----|-----|-----|-----|-------------|
|      |      |       | NE¼ | NW¼ | SW¼ | SE¼ | NE¼ | NW¼ | SW¼ | SE¼ | NE¼ | NW¼ | SW¼ | SE¼ | NE¼ | NW¼ | SW¼ | SE¼ |             |
| 16   | 24   | 28    | 40  | 40  | 40  | 40  |     |     |     |     |     |     |     |     |     |     |     |     | 160         |
|      |      |       |     |     |     |     |     |     |     |     |     |     |     |     |     |     |     |     |             |

4. If this application is for a change in place of use, it is proposed that the place of use be changed to:

Owner of Land ---- NAME: SEE ATTACHMENT

ADDRESS: \_\_\_\_\_

(If there is more than one landowner, attach supplemental sheets as necessary.)

| Sec. | Twp. | Range | NE¼ |     |     |     | NW¼ |     |     |     | SW¼ |     |     |     | SE¼ |     |     |     | TOTAL ACRES |  |
|------|------|-------|-----|-----|-----|-----|-----|-----|-----|-----|-----|-----|-----|-----|-----|-----|-----|-----|-------------|--|
|      |      |       | NE¼ | NW¼ | SW¼ | SE¼ | NE¼ | NW¼ | SW¼ | SE¼ | NE¼ | NW¼ | SW¼ | SE¼ | NE¼ | NW¼ | SW¼ | SE¼ |             |  |
|      |      |       |     |     |     |     |     |     |     |     |     |     |     |     |     |     |     |     |             |  |
|      |      |       |     |     |     |     |     |     |     |     |     |     |     |     |     |     |     |     |             |  |

**For Office Use Only:** Code \_\_\_\_\_ Fee \$ 200<sup>00</sup> TR # \_\_\_\_\_ Receipt Date 11-8-18 Check # 1299

5. **Presently authorized point of diversion:**  
 One in the \_\_\_\_\_ Quarter of the \_\_\_\_\_ Quarter of the \_\_\_\_\_ Quarter  
 of Section \_\_\_\_\_, Township \_\_\_\_\_ South, Range \_\_\_\_\_ (E/W),  
 in \_\_\_\_\_ County, Kansas, \_\_\_\_\_ feet North \_\_\_\_\_ feet West of Southeast corner of section.  
 Authorized Rate \_\_\_\_\_ Authorized Quantity \_\_\_\_\_ Depth of well \_\_\_\_\_ (feet)  
**(DWR use only: Computer ID No. \_\_\_\_\_ GPS \_\_\_\_\_ feet North \_\_\_\_\_ feet West)**  
 This point will not be changed  This point will be changed as follows:  No change, point better described with GPS as follows:  
**Proposed point of diversion: (Complete only if change is requested or if existing point is better described by GPS)**  
 One in the \_\_\_\_\_ Quarter of the \_\_\_\_\_ Quarter of the \_\_\_\_\_ Quarter  
 of Section \_\_\_\_\_, Township \_\_\_\_\_ South, Range \_\_\_\_\_ (E/W),  
 in \_\_\_\_\_ County, Kansas, \_\_\_\_\_ feet North \_\_\_\_\_ feet West of Southeast corner of section.  
 Proposed Rate \_\_\_\_\_ Proposed Quantity \_\_\_\_\_ Proposed well depth (feet) \_\_\_\_\_  
 This point is:  Additional Well  Geo Center List other water rights that will use this point \_\_\_\_\_

6. **Presently authorized point of diversion:**  
 One in the \_\_\_\_\_ Quarter of the \_\_\_\_\_ Quarter of the \_\_\_\_\_ Quarter  
 of Section \_\_\_\_\_, Township \_\_\_\_\_ South, Range \_\_\_\_\_ (E/W),  
 in \_\_\_\_\_ County, Kansas, \_\_\_\_\_ feet North \_\_\_\_\_ feet West of Southeast corner of section.  
 Authorized Rate \_\_\_\_\_ Authorized Quantity \_\_\_\_\_ Depth of well \_\_\_\_\_ (feet)  
**(DWR use only: Computer ID No. \_\_\_\_\_ GPS \_\_\_\_\_ feet North \_\_\_\_\_ feet West)**  
 This point will not be changed  This point will be changed as follows:  No change, point better described with GPS as follows:  
**Proposed point of diversion: (Complete only if change is requested or if existing point is better described by GPS)**  
 One in the \_\_\_\_\_ Quarter of the \_\_\_\_\_ Quarter of the \_\_\_\_\_ Quarter  
 of Section \_\_\_\_\_, Township \_\_\_\_\_ South, Range \_\_\_\_\_ (E/W),  
 in \_\_\_\_\_ County, Kansas, \_\_\_\_\_ feet North \_\_\_\_\_ feet West of Southeast corner of section.  
 Proposed Rate \_\_\_\_\_ Proposed Quantity \_\_\_\_\_ Proposed well depth (feet) \_\_\_\_\_  
 This point is:  Additional Well  Geo Center List other water rights that will use this point \_\_\_\_\_

7. The changes herein are desired for the following reasons?  
 (please be specific) NO PD CHANGE

8. If a well, is the test hole log attached?  Yes  No

9. The change(s) (was)(will be) completed by?  
 \_\_\_\_\_

10. If the point of diversion is a well:  
 (a) What are you going to do with the old well?  
 \_\_\_\_\_  
 (b) When will this be done? \_\_\_\_\_

11. Groundwater Management District recommendation attached?  
 Yes  No

12. Assisted by \_\_\_\_\_

13a. If the proposed point of diversion will be relocated more than 300 feet but within 2,640 feet of the existing point of diversion, attach a topographic map or aerial photograph. For groundwater sources, show all wells (including domestic) within one-half mile of the proposed point of diversion and the names and mailing addresses of the owners. For surface water sources, show the names and addresses of the landowner(s) one-half mile downstream and one-half mile upstream from your property lines

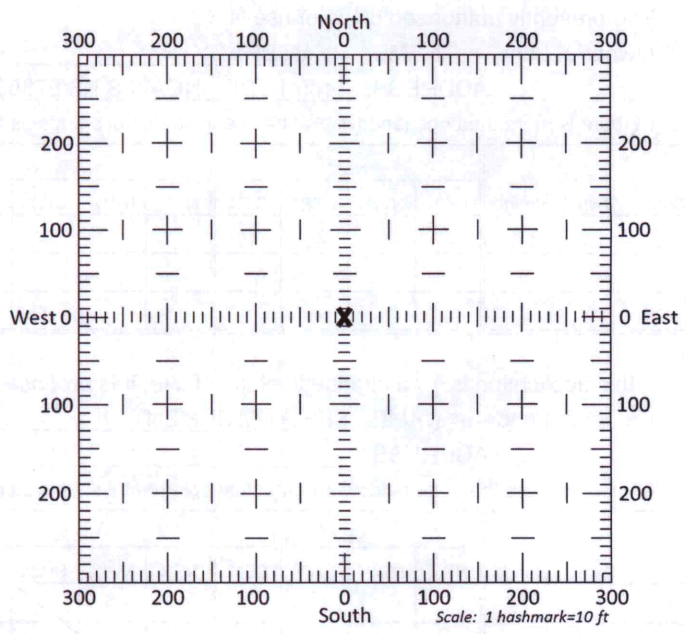

13b. If the proposed point of diversion will be relocated within 300 feet of the existing point of diversion, indicate its location on the diagram shown above in relation to the existing point of diversion. (PLEASE NOTE: The "X" in center of diagram above represents the presently authorized point of diversion.)

APPLICATION FOR APPROVAL TO CHANGE  
THE PLACE OF USE AND/OR POINT OF DIVERSION  
SUPPLEMENTAL SHEET  
**FILE NO. 23218**  
MAKE ADDITIONAL COPIES AS NECESSARY

3. *Continued:* The presently authorized place of use is:

Owner of Land ---- NAME: \_\_\_\_\_  
ADDRESS: \_\_\_\_\_

| Sec. | Twp. | Range | NE¼ |     |     |     | NW¼ |     |     |     | SW¼ |     |     |     | SE¼ |     |     |     | TOTAL ACRES |
|------|------|-------|-----|-----|-----|-----|-----|-----|-----|-----|-----|-----|-----|-----|-----|-----|-----|-----|-------------|
|      |      |       | NE¼ | NW¼ | SW¼ | SE¼ | NE¼ | NW¼ | SW¼ | SE¼ | NE¼ | NW¼ | SW¼ | SE¼ | NE¼ | NW¼ | SW¼ | SE¼ |             |
|      |      |       |     |     |     |     |     |     |     |     |     |     |     |     |     |     |     |     |             |

Owner of Land ---- NAME: \_\_\_\_\_  
ADDRESS: \_\_\_\_\_

| Sec. | Twp. | Range | NE¼ |     |     |     | NW¼ |     |     |     | SW¼ |     |     |     | SE¼ |     |     |     | TOTAL ACRES |
|------|------|-------|-----|-----|-----|-----|-----|-----|-----|-----|-----|-----|-----|-----|-----|-----|-----|-----|-------------|
|      |      |       | NE¼ | NW¼ | SW¼ | SE¼ | NE¼ | NW¼ | SW¼ | SE¼ | NE¼ | NW¼ | SW¼ | SE¼ | NE¼ | NW¼ | SW¼ | SE¼ |             |
|      |      |       |     |     |     |     |     |     |     |     |     |     |     |     |     |     |     |     |             |

Owner of Land ---- NAME: \_\_\_\_\_  
ADDRESS: \_\_\_\_\_

| Sec. | Twp. | Range | NE¼ |     |     |     | NW¼ |     |     |     | SW¼ |     |     |     | SE¼ |     |     |     | TOTAL ACRES |
|------|------|-------|-----|-----|-----|-----|-----|-----|-----|-----|-----|-----|-----|-----|-----|-----|-----|-----|-------------|
|      |      |       | NE¼ | NW¼ | SW¼ | SE¼ | NE¼ | NW¼ | SW¼ | SE¼ | NE¼ | NW¼ | SW¼ | SE¼ | NE¼ | NW¼ | SW¼ | SE¼ |             |
|      |      |       |     |     |     |     |     |     |     |     |     |     |     |     |     |     |     |     |             |

4. *Continued:* If this application is for a change in place of use, it is proposed that the place of use be changed to:

Owner of Land ---- NAME: MIKE BRADY  
ADDRESS: 3405 16 RD, INGALLS KS 67853-9001

| Sec. | Twp. | Range       | NE¼ |     |     |     | NW¼ |     |     |     | SW¼ |     |     |     | SE¼ |     |     |     | TOTAL ACRES |
|------|------|-------------|-----|-----|-----|-----|-----|-----|-----|-----|-----|-----|-----|-----|-----|-----|-----|-----|-------------|
|      |      |             | NE¼ | NW¼ | SW¼ | SE¼ | NE¼ | NW¼ | SW¼ | SE¼ | NE¼ | NW¼ | SW¼ | SE¼ | NE¼ | NW¼ | SW¼ | SE¼ |             |
| 16   | 24   | 28 <i>W</i> |     |     |     |     | 40  | 40  | 40  | 40  |     |     |     |     |     |     |     |     | 160         |

Owner of Land ---- NAME: RYAN BRADY  
ADDRESS: 3405 16 RD, INGALLS KS 67853-9001

| Sec. | Twp. | Range       | NE¼ |     |     |     | NW¼ |     |     |     | SW¼ |     |     |     | SE¼ |     |     |     | TOTAL ACRES |
|------|------|-------------|-----|-----|-----|-----|-----|-----|-----|-----|-----|-----|-----|-----|-----|-----|-----|-----|-------------|
|      |      |             | NE¼ | NW¼ | SW¼ | SE¼ | NE¼ | NW¼ | SW¼ | SE¼ | NE¼ | NW¼ | SW¼ | SE¼ | NE¼ | NW¼ | SW¼ | SE¼ |             |
| 16   | 24   | 28 <i>W</i> | 40  | 40  | 40  | 40  |     |     |     |     |     |     |     |     |     |     |     |     | 160         |

Owner of Land ---- NAME: \_\_\_\_\_  
ADDRESS: \_\_\_\_\_

| Sec. | Twp. | Range | NE¼ |     |     |     | NW¼ |     |     |     | SW¼ |     |     |     | SE¼ |     |     |     | TOTAL ACRES |
|------|------|-------|-----|-----|-----|-----|-----|-----|-----|-----|-----|-----|-----|-----|-----|-----|-----|-----|-------------|
|      |      |       | NE¼ | NW¼ | SW¼ | SE¼ | NE¼ | NW¼ | SW¼ | SE¼ | NE¼ | NW¼ | SW¼ | SE¼ | NE¼ | NW¼ | SW¼ | SE¼ |             |
|      |      |       |     |     |     |     |     |     |     |     |     |     |     |     |     |     |     |     |             |

# Change in Place of Use: WR 23218

I agree to the best of my knowledge that all known water wells (IRR, DOM, IND, etc) are shown within green circles on map. If not, I have edited the map indicating the location of the well, type, & owner information.

Signature( \_\_\_\_\_ )

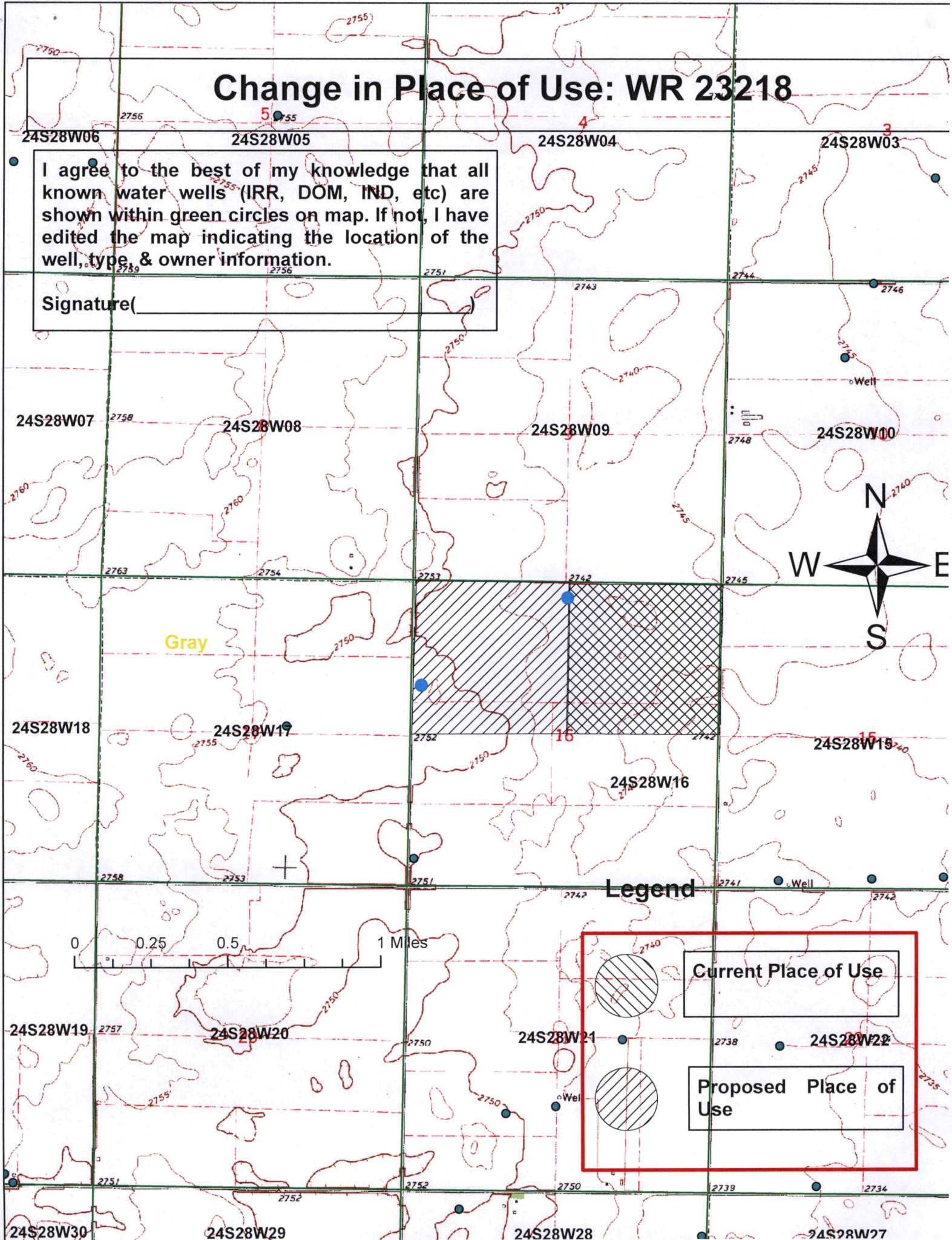

Legend

Current Place of Use

Proposed Place of Use



14. If the proposed groundwater point of diversion is 300 or fewer feet from the existing point of diversion, complete the following:
- (a) Does the undersigned represent all owners of the currently authorized place(s) of use identified in this application?  
 Yes     No    (If no, all owners must sign this application.)
  - (b) Will the ownership interest of any owner of the currently authorized place(s) of use identified in this application be adversely affected if this application is approved as requested?  
 Yes     No    (If yes, all owners must sign this application.)
  - (c) If this application is not approved expeditiously, will there be substantial damage to property, public health or safety?  
 Yes     No    (If no, all owners must sign this application.)

If the application proposes a surface water change in point of diversion, a groundwater change in point of diversion greater than 300 feet, or a change in place of use, the application must be signed by all owners of the currently authorized place of use, or their duly authorized agent (attach notarized statement authorizing representation).

I hereby verify, being first duly sworn upon my oath or affirmation and under penalty of perjury, that I am of lawful age and the owner, the spouse of the owner, or a duly authorized agent of the owner(s) to make this application on their behalf, in regards to the water right(s) to which this application pertains. I further verify that the statements contained in this application are true, correct and complete.

Dated at 10/25/2018 GPCU, Kansas, this 26 day of October, 20 18.

|                              |                    |
|------------------------------|--------------------|
| <u>Paul</u><br>(Owner)       | <br>(Spouse)       |
| RYAN BRADY<br>(Please Print) | <br>(Please Print) |
| <u>Mike Brady</u><br>(Owner) | <br>(Spouse)       |
| MIKE BRADY<br>(Please Print) | <br>(Please Print) |
| <br>(Owner)                  | <br>(Spouse)       |
| <br>(Please Print)           | <br>(Please Print) |

State of Kansas }  
 County of Finney } SS

I hereby certify that the foregoing application was signed in my presence and sworn to before me this 26th day of October, 20 18.

Ben  
 Notary Public

My Commission Expires 08/19/2020.

**ONLY COMPLETE APPLICATIONS WILL BE PROCESSED.** To be complete, all of the applicable portions of the application form must be completed with accurate information; maps, if necessary, must be included; signatures of all the appropriate owners' must be affixed to the application and notarized; and the appropriate fee must be paid.

**FEE SCHEDULE**

Each application to change the place of use or the point of diversion under this section shall be accompanied by the application fee set forth in the schedule below: Make checks payable to: **Kansas Department of Agriculture**

|   |       |
|---|-------|
| (1) Application to change a point of diversion 300 feet or less   | \$100 |
| (2) Application to change a point of diversion more than 300 feet | \$200 |
| (3) Application to change the place of use                        | \$200 |

