

STATE OF KANSAS



DEPARTMENT OF AGRICULTURE  
DIVISION OF WATER RESOURCES  
GARDEN CITY FIELD OFFICE  
2508 JOHNS STREET  
GARDEN CITY, KS 67846-2804

PHONE: (620) 276-2901  
FAX: (620) 276-9315  
www.agriculture.ks.gov

GOVERNOR JEFF COLYER, M.D.  
JACKIE McCLASKEY, SECRETARY OF AGRICULTURE

March 28, 2018

Southwest Kansas Groundwater  
Management District No 3  
409 Campus Drive, Suite 106  
Garden City KS 67846

Re: Water Right file number 23247

Dear Mr. Norquest;

Michael and Cynthia Koehn have applied to alter the acres authorized to add a pivot location. The base acres are 477. There are three neighboring wells all belong to the same owner.

We are delaying action for 15 days on the change application to allow you time to review and provide a recommendation if you feel one is warranted. I have enclosed a copy of the change for your perusal.

Thank you and as always feel free to call or write us at any time.

Sincerely;

Thomas P Makens

encs.

Submit completed application to:  
 Kansas Department of Agriculture  
 Division of Water Resources  
 Field Office for your area.

Call for address:

Topeka -- (785) 862-6300  
 Stafford -- (620) 234-5311  
 Stockton -- (785) 425-6787  
 Garden City -- (620) 276-2901  
[www.ksda.gov/dwr](http://www.ksda.gov/dwr)

## DWR FIELD OFFICE APPLICATION FOR APPROVAL TO CHANGE THE PLACE OF USE AND/OR THE POINT OF DIVERSION



**STATE OF KANSAS**

**Filing Fee Must Accompany the Application, K.S.A. 82a-708b(b), as amended.**  
 Fee Schedule is on the third page of this application form.

**Paragraph Nos. 1, 2, 3 & 5 must be completed. Complete all other applicable portions.** If change in point of diversion is greater than 100 feet, or if place of use will be changed, include a topographic map or detailed plat showing the authorized and proposed point(s) of diversion and/or place of use.

File No. 23247

1. Application is hereby made for approval of the Chief Engineer to change the (check one or both):

Place of Use                       Point of Diversion

under the water right which is the subject of this application in accordance with the conditions described below.

The source of supply is:                       Groundwater                       Surface water

2. Name and address of Applicant: MICHAEL L KOEHN  
35807 8 RD, MONTEZUMA KS 67867

Phone Number: (620)408-6038                      Email address: Michaelckoehn@Gmail.com

Name and address of Water Use Correspondent: MICHAEL L & CYNTHIA J KOEHN  
35807 8 RD, MONTEZUMA KS 67867

Phone Number: (620)408-6038                      Email address: Michaelckoehn@Gmail.com

3. The presently authorized place of use is:  
 Owner of Land --- NAME: MICHAEL L & CYNTHIA J KOEHN

ADDRESS: 35807 8 RD, MONTEZUMA KS 67867

(If there is more than one landowner, attach supplemental sheets as necessary.)

Sec.	Twp.	Range	NE¼				NW¼				SW¼				SE¼				TOTAL ACRES
			NE¼	NW¼	SW¼	SE¼	NE¼	NW¼	SW¼	SE¼	NE¼	NW¼	SW¼	SE¼	NE¼	NW¼	SW¼	SE¼	
31	29S	29W	40	40	40	40	40	39.61	39.64	40									319.25
32	29S	29W					40	38	40	40									158.00

4. If this application is for a change in place of use, it is proposed that the place of use be changed to:

Owner of Land --- NAME: MICHAEL L & CYNTHIA J KOEHN

ADDRESS: 35807 8 RD, MONTEZUMA KS 67867

(If there is more than one landowner, attach supplemental sheets as necessary.)

Sec.	Twp.	Range	NE¼				NW¼				SW¼				SE¼				TOTAL ACRES
			NE¼	NW¼	SW¼	SE¼	NE¼	NW¼	SW¼	SE¼	NE¼	NW¼	SW¼	SE¼	NE¼	NW¼	SW¼	SE¼	
31	29S	29W	30.75	30.75	30.75	30.75	30.75	30.75	30.75	30.75									246.00
32	29S	29W					30.75	30.75	30.75	30.75									123.00
30	29S	29W												30.75	30.75	30.75	16		108.25

For Office Use Only: Code \_\_\_\_\_ Fee \$ 200 TR # \_\_\_\_\_ Receipt Date 3/28/18 Check # 9890

RECEIVED  
 11:15 AM  
 MAR 28 2018

5. **Presently authorized point of diversion:**  
 One in the SE Quarter of the NE Quarter of the NE Quarter of Section 31, Township 29 South, Range 29 W, in GY County, Kansas, 4560 feet North 60 feet West of Southeast corner of section.  
 Authorized Rate 1970 Authorized Quantity 397 Depth of well 320 (feet)  
 (DWR use only: Computer ID No. 1 GPS 4433 feet North 103 feet West)  
 This point will not be changed  This point will be changed as follows:  
**Proposed point of diversion: (Complete only if change is requested)**  
 One in the \_\_\_\_\_ Quarter of the \_\_\_\_\_ Quarter of the \_\_\_\_\_ Quarter of Section \_\_\_\_\_, Township \_\_\_\_\_ South, Range \_\_\_\_\_ W, in \_\_\_\_\_ County, Kansas, \_\_\_\_\_ feet North \_\_\_\_\_ feet West of Southeast corner of section.  
 Proposed Rate \_\_\_\_\_ Proposed Quantity \_\_\_\_\_ Proposed well depth (feet) \_\_\_\_\_  
 This point is:  Additional Well  Geo Center List other water rights that will use this point \_\_\_\_\_

6. **Presently authorized point of diversion:**  
 One in the NE Quarter of the NE Quarter of the NW Quarter of Section 31, Township 29 South, Range 29 W, in GY County, Kansas, 5180 feet North 2700 feet West of Southeast corner of section.  
 Authorized Rate 1050 Authorized Quantity 239 Depth of well 408 (feet)  
 (DWR use only: Computer ID No. 4 GPS \_\_\_\_\_ feet North \_\_\_\_\_ feet West)  
 This point will not be changed  This point will be changed as follows:  
**Proposed point of diversion: (Complete only if change is requested)**  
 One in the \_\_\_\_\_ Quarter of the \_\_\_\_\_ Quarter of the \_\_\_\_\_ Quarter of Section \_\_\_\_\_, Township \_\_\_\_\_ South, Range \_\_\_\_\_ (EW), in \_\_\_\_\_ County, Kansas, \_\_\_\_\_ feet North \_\_\_\_\_ feet West of Southeast corner of section.  
 Proposed Rate \_\_\_\_\_ Proposed Quantity \_\_\_\_\_ Proposed well depth (feet) \_\_\_\_\_  
 This point is:  Additional Well  Geo Center List other water rights that will use this point \_\_\_\_\_

7. Why do you need a new point of diversion? N/A  
 \_\_\_\_\_  
 \_\_\_\_\_

8. If a well, is the test hole log attached?  Yes  No

9. When do you propose to complete the new point of diversion?  
N/A

10. If the point of diversion is a well:  
 (a) What are you going to do with the old well?  
N/A  
 (b) When will this be done? N/A

11. Groundwater Management District recommendation attached?  Yes  No

12. Assisted by Armando Zarco

13a. If the proposed point of diversion will be relocated within 100 feet of the existing point of diversion, indicate its location on the diagram below in relation to the existing point of diversion. (PLEASE NOTE: The "X" in center of diagram below represents presently authorized point of diversion.)

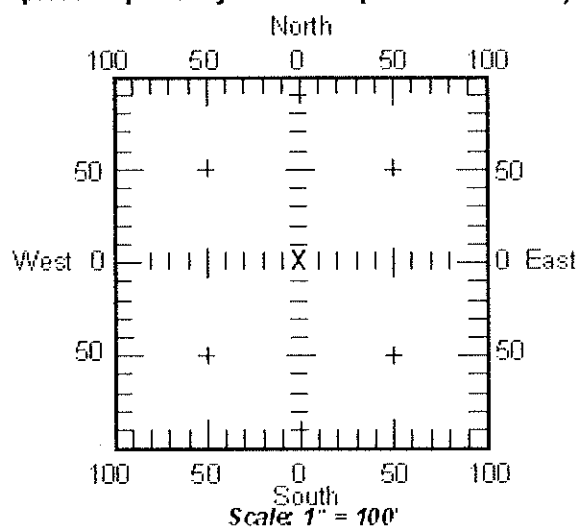

13b. If the proposed point of diversion will be relocated more than 100 feet but within 1320 feet from the existing point of diversion, attach a topographic map or aerial photograph. For groundwater sources, show all wells (including domestic) within one-half mile of the proposed point of diversion and the names and mailing addresses of the owners. For surface water sources, show the names and addresses of the landowner(s) one-half mile downstream and one-half mile upstream from your property lines.

RECEIVED  
 MAR 28 2018

14. If the proposed groundwater point of diversion is 300 or fewer feet from existing point of diversion, complete the following:

- (a) Does the undersigned represent all owners of the currently authorized place(s) of use identified in this application?  
 Yes     No    (If no, all owners must sign this application.)
- (b) Will the ownership interest of any owner of the currently authorized place(s) of use identified in this application be adversely affected if this application is approved as requested?  
 Yes     No    (If yes, all owners must sign this application.)
- (c) If this application is not approved expeditiously, will there be substantial damage to property, public health or safety?  
 Yes     No    (If no, all owners must sign this application.)

If the application proposes a surface water change in point of diversion, a groundwater change in point of diversion greater than 300 feet, or a change in place of use, the application must be signed by all owners of the currently authorized place of use, or their duly authorized agent (attach notarized statement authorizing representation).

I hereby verify, being first duly sworn upon my oath or affirmation and under penalty of perjury, that I am of lawful age and the owner, the spouse of the owner, or a duly authorized agent of the owner(s) to make this application on their behalf, in regard to the water right(s) to which this application pertains. I further verify that the statements contained in this application are true, correct and complete.

Dated at Bank 7, Kansas, this 28<sup>th</sup> day of March, 2018.

Michael Koeh  
(Owner)

Michael Koehn  
(Please Print)

\_\_\_\_\_  
(Owner)

\_\_\_\_\_  
(Please Print)

\_\_\_\_\_  
(Owner)

\_\_\_\_\_  
(Please Print)

Cynthia Koehn  
(Spouse)

Cynthia Koehn  
(Please Print)

\_\_\_\_\_  
(Spouse)

\_\_\_\_\_  
(Please Print)

\_\_\_\_\_  
(Spouse)

\_\_\_\_\_  
(Please Print)

State of Kansas }  
County of Gray } SS

I hereby certify that the foregoing application was signed in my presence and sworn to before me this 28<sup>th</sup> day of March, 2018.

My Commission Expires 4-14-18



[Signature]  
Notary Public

**ONLY COMPLETE APPLICATIONS WILL BE PROCESSED.** To be complete, all of the applicable portions of the application form must be completed with accurate information; maps, if necessary, must be included; signatures of all the appropriate owners' must be affixed to the application and notarized; and the appropriate fee must be paid.

**FEE SCHEDULE**

Each application to change the place of use or the point of diversion under this section shall be accompanied by the application fee set forth in the schedule below: Make checks payable to: **Kansas Department of Agriculture**

(1) Application to change a point of diversion 300 feet or less .....	\$100
(2) Application to change a point of diversion more than 300 feet .....	\$200
(3) Application to change the place of use .....	\$200

RECEIVED

MAR 28 2018



APPLICATION FOR APPROVAL TO CHANGE  
THE PLACE OF USE AND/OR POINT OF DIVERSION  
SUPPLEMENTAL SHEET  
FILE NO. 23247

**Presently authorized point of diversion:**  
One in the SW Quarter of the SW Quarter of the NW Quarter  
of Section 32, Township 29 South, Range 29 W,  
in GY County, Kansas, 2710 feet North 4890 feet West of Southeast corner of section.  
Authorized Rate 1100 gpm Authorized Quantity 320 AF Depth of well 428 (feet)  
(DWR use only: Computer ID No. 2 GPS 2676 feet North 4901 feet West)  
 This point will not be changed  This point will be changed as follows:  
**Proposed point of diversion: (Complete only if change is requested)**  
One in the \_\_\_\_\_ Quarter of the \_\_\_\_\_ Quarter of the \_\_\_\_\_ Quarter  
of Section \_\_\_\_\_, Township \_\_\_\_\_ South, Range \_\_\_\_\_ (E/W),  
in \_\_\_\_\_ County, Kansas, \_\_\_\_\_ feet North \_\_\_\_\_ feet West of Southeast corner of section.  
Proposed Rate \_\_\_\_\_ Proposed Quantity \_\_\_\_\_ Proposed well depth (feet) \_\_\_\_\_  
This point is:  Additional Well  Geo Center List other water rights that will use this point \_\_\_\_\_

**Presently authorized point of diversion:**  
One in the \_\_\_\_\_ Quarter of the \_\_\_\_\_ Quarter of the \_\_\_\_\_ Quarter  
of Section \_\_\_\_\_, Township \_\_\_\_\_ South, Range \_\_\_\_\_ W,  
in \_\_\_\_\_ County, Kansas, \_\_\_\_\_ feet North \_\_\_\_\_ feet West of Southeast corner of section.  
Authorized Rate \_\_\_\_\_ Authorized Quantity \_\_\_\_\_ Depth of well \_\_\_\_\_ (feet)  
(DWR use only: Computer ID No. 3 GPS \_\_\_\_\_ feet North \_\_\_\_\_ feet West)  
 This point will not be changed  This point will be changed as follows:  
**Proposed point of diversion: (Complete only if change is requested)**  
One in the \_\_\_\_\_ Quarter of the \_\_\_\_\_ Quarter of the \_\_\_\_\_ Quarter  
of Section \_\_\_\_\_, Township \_\_\_\_\_ South, Range \_\_\_\_\_ (E/W),  
in \_\_\_\_\_ County, Kansas, \_\_\_\_\_ feet North \_\_\_\_\_ feet West of Southeast corner of section.  
Proposed Rate \_\_\_\_\_ Proposed Quantity \_\_\_\_\_ Proposed well depth (feet) \_\_\_\_\_  
This point is:  Additional Well  Geo Center List other water rights that will use this point \_\_\_\_\_

**Presently authorized point of diversion:**  
One in the \_\_\_\_\_ Quarter of the \_\_\_\_\_ Quarter of the \_\_\_\_\_ Quarter  
of Section \_\_\_\_\_, Township \_\_\_\_\_ South, Range \_\_\_\_\_ w,  
in \_\_\_\_\_ County, Kansas, \_\_\_\_\_ feet North \_\_\_\_\_ feet West of Southeast corner of section.  
Authorized Rate \_\_\_\_\_ Authorized Quantity \_\_\_\_\_ Depth of well \_\_\_\_\_ (feet)  
(DWR use only: Computer ID No. 7 GPS \_\_\_\_\_ feet North \_\_\_\_\_ feet West)  
 This point will not be changed  This point will be changed as follows:  
**Proposed point of diversion: (Complete only if change is requested)**  
One in the \_\_\_\_\_ Quarter of the \_\_\_\_\_ Quarter of the \_\_\_\_\_ Quarter  
of Section \_\_\_\_\_, Township \_\_\_\_\_ South, Range \_\_\_\_\_ (E/W),  
in \_\_\_\_\_ County, Kansas, \_\_\_\_\_ feet North \_\_\_\_\_ feet West of Southeast corner of section.  
Proposed Rate \_\_\_\_\_ Proposed Quantity \_\_\_\_\_ Proposed well depth (feet) \_\_\_\_\_  
This point is:  Additional Well  Geo Center List other water rights that will use this point \_\_\_\_\_

**Presently authorized point of diversion:**  
One in the \_\_\_\_\_ Quarter of the \_\_\_\_\_ Quarter of the \_\_\_\_\_ Quarter  
of Section \_\_\_\_\_, Township \_\_\_\_\_ South, Range \_\_\_\_\_ (E/W),  
in \_\_\_\_\_ County, Kansas, \_\_\_\_\_ feet North \_\_\_\_\_ feet West of Southeast corner of section.  
Authorized Rate \_\_\_\_\_ Authorized Quantity \_\_\_\_\_ Depth of well \_\_\_\_\_ (feet)  
(DWR use only: Computer ID No. \_\_\_\_\_ GPS \_\_\_\_\_ feet North \_\_\_\_\_ feet West)  
 This point will not be changed  This point will be changed as follows:  
**Proposed point of diversion: (Complete only if change is requested)**  
One in the \_\_\_\_\_ Quarter of the \_\_\_\_\_ Quarter of the \_\_\_\_\_ Quarter  
of Section \_\_\_\_\_, Township \_\_\_\_\_ South, Range \_\_\_\_\_ (E/W),  
in \_\_\_\_\_ County, Kansas, \_\_\_\_\_ feet North \_\_\_\_\_ feet West of Southeast corner of section.  
Proposed Rate \_\_\_\_\_ Proposed Quantity \_\_\_\_\_ Proposed well depth (feet) \_\_\_\_\_  
This point is:  Additional Well  Geo Center List other water rights that will use this point \_\_\_\_\_

RECEIVED  
MAR 28 2018

29S30W13

29S29W18

29S29W17

29S29W16

# Change in Place of Use: WR #23247

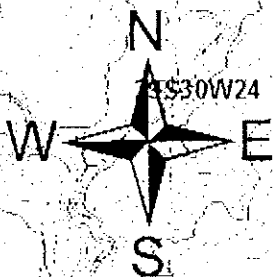

I agree to the best of my knowledge that all known water wells (IRR, DOM, IND, etc) are shown within green circles on map. If not, I have edited the map indicating the location of the well, type, & owner information.

Signature: *Michael Hill*

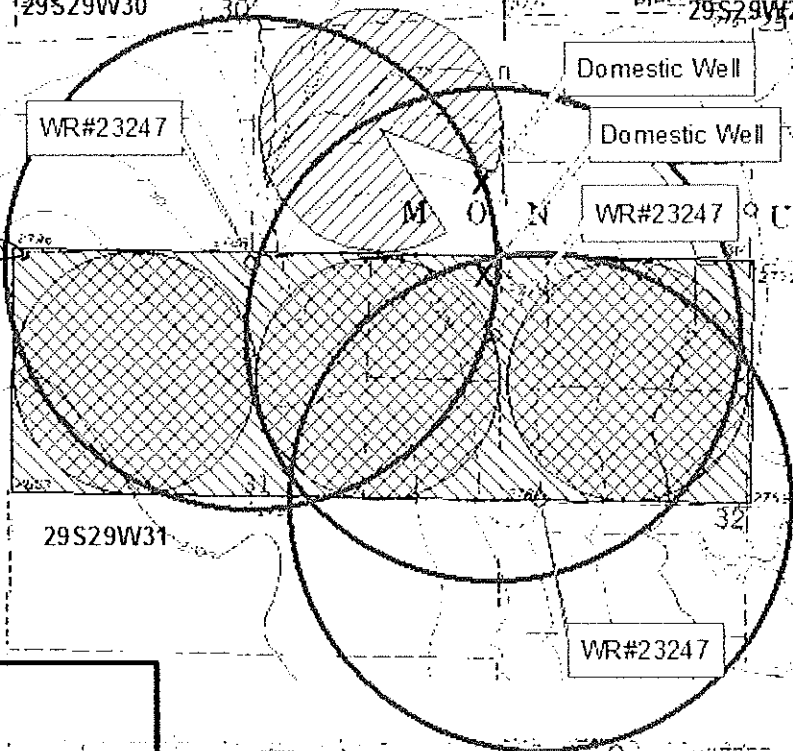

## Legend

0 550 1.00 2.200 3.300 4.400 Feet



Current Place of Use

Proposed Place of Use

RECEIVED

MAR 28 2018

Garden City Field Office  
Division of Water Resources

30S30W12

30S29W07

30S29W08

30S29W09

# Change in Place of Use: WR #23247

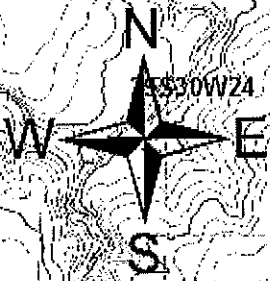

I agree to the best of my knowledge that all known water wells (IRR, DOM, IND, etc) are shown within green circles on map. If not, I have edited the map indicating the location of the well, type & owner information.

Signature: *[Handwritten Signature]*

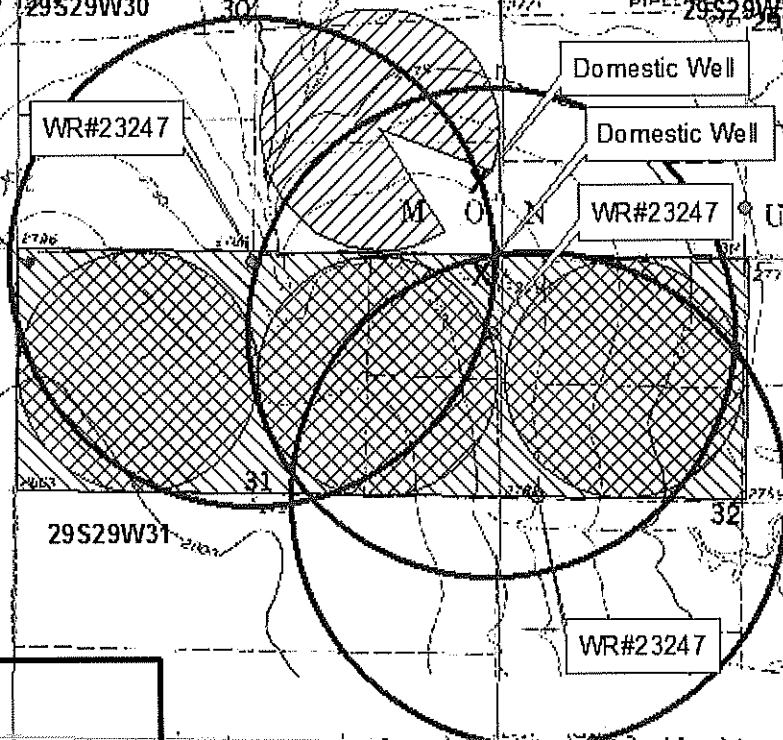

**Legend**

0 550 1,000 2,200 3,300 4,400 Feet

Current Place of Use

Proposed Place of Use

RECEIVED

MAR 25 2018

Garden City Field Office  
Division of Water Resources

30S30W12

30S29W07

30S29W08

30S29W09



This sixteenth day of November, 19 87

JAMES D. SMITH and ELAINE SMITH, husband and wife,

CONVEY            AND WARRANT            TO

MICHAEL LYNN KOEHN and CYNTHIA JANE KOEHN, husband and wife

as JOINT TENANTS and not as tenants in common, with full rights of survivorship, the whole estate to vest in the survivor in the event of the death of either, all the following described REAL ESTATE in the County of Gray and the State of Kansas, to-wit:

The Southeast Quarter (SE<sup>1</sup>/<sub>4</sub>) of Section Thirty (30) in Township Twenty-nine (29) South of Range Twenty-nine (29) West of the 6th P.M.

Entered in Transfer Record in my office this 22nd day of January, A. D., 1988  
Amy Koehn  
Jammy Denny, clerk  
County Clerk.

for the sum of Ten Dollars and other valuable consideration.

EXCEPT AND SUBJECT TO:

Dated November, 19 87

STATE OF KANSAS, GRAY COUNTY, ss

BE IT REMEMBERED, That on this 16th day of Nov.

A. D. 19 87, before me, the undersigned, a

in and for the County and State aforesaid, came

James D. Smith and Elaine Smith,  
husband and wife,

James D. Smith  
(James D. Smith)  
Elaine Smith  
(Elaine Smith)

who are personally known to me to be the same persons who executed the within instrument of writing and such persons duly acknowledged the execution of the same.

IN WITNESS WHEREOF, I have hereunto set my hand and affixed my seal the day and year last above written.

**DERK L. HEDLUND**  
NOTARY PUBLIC  
STATE OF KANSAS  
MY APPT. EXPIRES 5/6/90  
Term expires 5/6, 19 90

[Signature]  
Notary Public.

STATE OF Kansas }  
Gray County, } ss.  
This instrument was filed for record on the 22nd day of January, A. D., 1988, at 1:35 o'clock P. M., and duly recorded in book 96 of Deeds at page 341  
Barbara K. [Signature]  
Register of Deeds.  
**INDEXED**  
**PHOTO-COPIED**  
Fees, \$ 5.00 Deputy.

RECEIVED  
MAR 28 2018

Garden City Field Office  
Division of Water Resources