

Kansas Department of Agriculture
 Division of Water Resources
CHANGE: P/U WORKSHEET

1. File Number: 23247	2. Status Change Date: 4/13/18	3. Change Num: C2	4. Field Office: 04	5. GMD: 03
---------------------------------	--	-----------------------------	-------------------------------	----------------------

6. Status: <input checked="" type="checkbox"/> Approved <input type="checkbox"/> Denied by DWR/GMD <input type="checkbox"/> Dismiss by Request/Failure to Return	7. Filing Date of Change: 3/28/18
--	---

8a. Applicant(s) Person ID **36171**
 New to system Add Seq# **1**

MICHAEL L & CYNTHIA J KOEHN
35807 8 RD
MONTEZUMA KS 67867

8c. Landowner(s) Person ID _____
 New to system Add Seq# _____

8b. Landowner(s) Person ID **36171**
 New to system Add Seq# **1**

MICHAEL L & CYNTHIA J KOEHN
35807 8 RD
MONTEZUMA KS 67867

8d. WUC Person ID **36171**
 New to system Add Seq# **1**

MICHAEL L & CYNTHIA J KOEHN
35807 8 RD
MONTEZUMA KS 67867

9. Documents and Enclosure(s): DWR Meter(s) Date to Comply: **12/31/18** N & P Date to Comply: _____

Anti-Reverse Meter Meter Seal Check Valve N & P Form Water Tube Driller Copy H & E Letter

Conservation Plan Date Required: _____ Date Approved: _____ Date to Comply: _____

10. Use Made of Water From: _____ To: _____

Date Prepared: **4/9/18** By: **TPM**
 Date Entered: _____ By: _____

File No. **23247** 11. County: GY Basin: **crooked** Stream: Formation Code: Special Use:

12. Points of Diversion
 CHK
 MOD
 DEL PDIV
 ENT

Qualifier S T R ID 'N 'W Comment (AKA Line) Rate gpm/cfs Quantity af/mgy Rate gpm/cfs Quantity af/mgy Additional Overlap PD Files

nc

13. Storage: Rate _____ NF Quantity _____ acft Additional Rate _____ NF Additional Quantity _____ acft

14. Limitation: _____ af/yr at _____ gpm (_____ cfs) when combined with file number(s) _____
 Limitation: _____ af/yr at _____ gpm (_____ cfs) when combined with file number(s) _____

15. 5YR Allocation: Allocation Type _____ Start Year _____ 5 YR Amount _____ Amount Unit _____ Base Acres _____ Comment _____

16. Place of Use CHK MOD DEL ENT	P USE	S	T	R	ID	NE 1/4			NW 1/4			SW 1/4			SE 1/4			Total	Owner	Chg?	Overlap Files		
						NE 1/4	NW 1/4	SW 1/4	SE 1/4	NE 1/4	NW 1/4	SW 1/4	SE 1/4	NE 1/4	NW 1/4	SW 1/4	SE 1/4						
MOD	13404	31	29	29W	1	30.75	30.75	30.75	30.75	30.75	30.75	30.75	30.75							246	8b	no	na
MOD	13981	32	29	29W	2				30.75	30.75	30.75	30.75								123	8b	no	na
ENT	NEW	30	29	29W																108.25	8b	no	na

Base Acres: **477** Year: Minimum Reasonable Quantity:
 Comments: **(puse 13404) lot 1 nwnw ; lot 2 swnw**

STATE OF KANSAS



DEPARTMENT OF AGRICULTURE
DIVISION OF WATER RESOURCES
GARDEN CITY FIELD OFFICE
2508 JOHNS STREET
GARDEN CITY, KS 67846-2804

PHONE: (620) 276-2901
FAX: (620) 276-9315
www.agriculture.ks.gov

GOVERNOR JEFF COLYER, M.D.
JACKIE McCLASKEY, SECRETARY OF AGRICULTURE

April 13, 2018

MICHAEL L & CYNTHIA J KOEHN
35807 8 RD
MONTEZUMA KS 67867

RE: Change the Place of Use, File Nos 23247

Dear Mr. & Mrs Koehn;

Enclosed you will find a *Summary Order Approving Application for Change in Place of Use* for the above referenced files. Since these orders modify the original documents, it should be recorded at the County Register of Deeds.

These orders modify the authorized acres that can be irrigated by these files. The authorized place of use is as shown on the plats within the change approvals.

A condition of this order is that an acceptable flow meter must be properly installed on the diversion works authorized under the referenced file number in accordance with the Kansas Administrative Regulations 5-1-4 through 5-1-12. This water flow meter shall be used to provide information required on the annual water use report (including the meter reading at the beginning and end of the report year).

This order shall become final if a request for a hearing is not filed with the Chief Engineer within 15 days of the date of service of this order. The date of service is the date listed on the enclosed *Certificate of Service*.

Should you have any questions, please feel free to call this office or arrange an appointment for additional assistance. Please refer to the file number when you contact us if you wish to discuss a specific file.

Sincerely,

Thomas P. Makens
Assistant Water Commissioner

TPM:tpm
Enclosures
GMD#3

CERTIFICATE OF SERVICE

On this *14th* day of April 2018, I hereby certify that the attached original Approval of Application to Change the Place of Use under Water Right File 23247 dated April 13, 2018, was mailed postage prepaid, first class, US mail to the following:

MICHAEL L & CYNTHIA J KOEHN
35807 8 RD
MONTEZUMA KS 67867

Copy provided to GMD#3

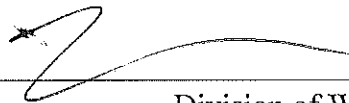
A handwritten signature in black ink, consisting of a stylized 'Z' or 'S' shape with a horizontal line extending to the right.

Division of Water Resources

Submit completed application to:
 Kansas Department of Agriculture
 Division of Water Resources
 Field Office for your area.
 Call for address:

Topeka -- (785) 862-6300
 Stafford -- (620) 234-5311
 Stockton -- (785) 425-6787
 Garden City -- (620) 276-2901
www.ksda.gov/dwr

DWR FIELD OFFICE APPLICATION FOR APPROVAL TO CHANGE THE PLACE OF USE AND/OR THE POINT OF DIVERSION



STATE OF KANSAS

Filing Fee Must Accompany the Application, K.S.A. 82a-708b(b), as amended.
 Fee Schedule is on the third page of this application form.

Paragraph Nos. 1, 2, 3 & 5 must be completed. Complete all other applicable portions. If change in point of diversion is greater than 100 feet, or if place of use will be changed, include a topographic map or detailed plat showing the authorized and proposed point(s) of diversion and/or place of use.

File No. 23247

1. Application is hereby made for approval of the Chief Engineer to change the (check one or both):

Place of Use Point of Diversion

under the water right which is the subject of this application in accordance with the conditions described below.

The source of supply is: Groundwater Surface water

2. Name and address of Applicant: MICHAEL L KOEHN

35807 8 RD, MONTEZUMA KS 67867

Phone Number: (620)408-6038 Email address: Michaelcikoehn@Gmail.com

Name and address of Water Use Correspondent: MICHAEL L & CYNTHIA J KOEHN

35807 8 RD, MONTEZUMA KS 67867

Phone Number: (620)408-6038 Email address: Michaelcikoehn@Gmail.com

3. The presently authorized place of use is:

Owner of Land --- NAME: MICHAEL L & CYNTHIA J KOEHN

ADDRESS: 35807 8 RD, MONTEZUMA KS 67867

(If there is more than one landowner, attach supplemental sheets as necessary.)

Sec.	Twp.	Range	NE¼				NW¼				SW¼				SE¼				TOTAL ACRES
			NE¼	NW¼	SW¼	SE¼	NE¼	NW¼	SW¼	SE¼	NE¼	NW¼	SW¼	SE¼	NE¼	NW¼	SW¼	SE¼	
31	29S	29W	40	40	40	40	40	39.61	39.64	40									319.25
32	29S	29W					40	38	40	40									158.00

4. If this application is for a change in place of use, it is proposed that the place of use be changed to:

Owner of Land --- NAME: MICHAEL L & CYNTHIA J KOEHN

ADDRESS: 35807 8 RD, MONTEZUMA KS 67867

(If there is more than one landowner, attach supplemental sheets as necessary.)

Sec.	Twp.	Range	NE¼				NW¼				SW¼				SE¼				TOTAL ACRES
			NE¼	NW¼	SW¼	SE¼	NE¼	NW¼	SW¼	SE¼	NE¼	NW¼	SW¼	SE¼	NE¼	NW¼	SW¼	SE¼	
31	29S	29W	30.75	30.75	30.75	30.75	30.75	30.75	30.75	30.75									246.00
32	29S	29W					30.75	30.75	30.75	30.75									123.00
30	29S	29W												30.75	30.75	30.75	16		108.25

For Office Use Only: Code _____ Fee \$ 200 TR # _____ Receipt Date 3/28/18 Check # 9890

RECEIVED
 11:15 AM
 MAR 28 2018

APPLICATION FOR APPROVAL TO CHANGE
THE PLACE OF USE AND/OR POINT OF DIVERSION
SUPPLEMENTAL SHEET
FILE NO. 23247

Presently authorized point of diversion:

One in the SW Quarter of the SW Quarter of the NW Quarter
of Section 32, Township 29 South, Range 29 W,
in GY County, Kansas, 2710 feet North 4890 feet West of Southeast corner of section.
Authorized Rate 1100 gpm Authorized Quantity 320 AF Depth of well 428 (feet)
(DWR use only: Computer ID No. 2 GPS 2676 feet North 4901 feet West)
 This point will not be changed This point will be changed as follows:

Proposed point of diversion: (Complete only if change is requested)

One in the _____ Quarter of the _____ Quarter of the _____ Quarter
of Section _____, Township _____ South, Range _____ (E/W),
in _____ County, Kansas, _____ feet North _____ feet West of Southeast corner of section.
Proposed Rate _____ Proposed Quantity _____ Proposed well depth (feet) _____
This point is: Additional Well Geo Center List other water rights that will use this point _____

Presently authorized point of diversion:

One in the _____ Quarter of the _____ Quarter of the _____ Quarter
of Section _____, Township _____ South, Range _____ W,
in _____ County, Kansas, _____ feet North _____ feet West of Southeast corner of section.
Authorized Rate _____ Authorized Quantity _____ Depth of well _____ (feet)
(DWR use only: Computer ID No. 3 GPS _____ feet North _____ feet West)
 This point will not be changed This point will be changed as follows:

Proposed point of diversion: (Complete only if change is requested)

One in the _____ Quarter of the _____ Quarter of the _____ Quarter
of Section _____, Township _____ South, Range _____ (E/W),
in _____ County, Kansas, _____ feet North _____ feet West of Southeast corner of section.
Proposed Rate _____ Proposed Quantity _____ Proposed well depth (feet) _____
This point is: Additional Well Geo Center List other water rights that will use this point _____

Presently authorized point of diversion:

One in the _____ Quarter of the _____ Quarter of the _____ Quarter
of Section _____, Township _____ South, Range _____ w,
in _____ County, Kansas, _____ feet North _____ feet West of Southeast corner of section.
Authorized Rate _____ Authorized Quantity _____ Depth of well _____ (feet)
(DWR use only: Computer ID No. 7 GPS _____ feet North _____ feet West)
 This point will not be changed This point will be changed as follows:

Proposed point of diversion: (Complete only if change is requested)

One in the _____ Quarter of the _____ Quarter of the _____ Quarter
of Section _____, Township _____ South, Range _____ (E/W),
in _____ County, Kansas, _____ feet North _____ feet West of Southeast corner of section.
Proposed Rate _____ Proposed Quantity _____ Proposed well depth (feet) _____
This point is: Additional Well Geo Center List other water rights that will use this point _____

Presently authorized point of diversion:

One in the _____ Quarter of the _____ Quarter of the _____ Quarter
of Section _____, Township _____ South, Range _____ (E/W),
in _____ County, Kansas, _____ feet North _____ feet West of Southeast corner of section.
Authorized Rate _____ Authorized Quantity _____ Depth of well _____ (feet)
(DWR use only: Computer ID No. _____ GPS _____ feet North _____ feet West)
 This point will not be changed This point will be changed as follows:

Proposed point of diversion: (Complete only if change is requested)

One in the _____ Quarter of the _____ Quarter of the _____ Quarter
of Section _____, Township _____ South, Range _____ (E/W),
in _____ County, Kansas, _____ feet North _____ feet West of Southeast corner of section.
Proposed Rate _____ Proposed Quantity _____ Proposed well depth (feet) _____
This point is: Additional Well Geo Center List other water rights that will use this point _____

REMOVED
MAR 28 2018

5. **Presently authorized point of diversion:**
 One in the SE Quarter of the NE Quarter of the NE Quarter of Section 31, Township 29 South, Range 29 W, in GY County, Kansas, 4560 feet North 60 feet West of Southeast corner of section.
 Authorized Rate 1970 Authorized Quantity 397 Depth of well 320 (feet)
 (DWR use only: Computer ID No. 1 GPS 4433 feet North 103 feet West)
 This point will not be changed This point will be changed as follows:
Proposed point of diversion: (Complete only if change is requested)
 One in the _____ Quarter of the _____ Quarter of the _____ Quarter of Section _____, Township _____ South, Range _____ W, in _____ County, Kansas, _____ feet North _____ feet West of Southeast corner of section.
 Proposed Rate _____ Proposed Quantity _____ Proposed well depth (feet) _____
 This point is: Additional Well Geo Center List other water rights that will use this point _____

6. **Presently authorized point of diversion:**
 One in the NE Quarter of the NE Quarter of the NW Quarter of Section 31, Township 29 South, Range 29 W, in GY County, Kansas, 5180 feet North 2700 feet West of Southeast corner of section.
 Authorized Rate 1050 Authorized Quantity 239 Depth of well 408 (feet)
 (DWR use only: Computer ID No. 4 GPS _____ feet North _____ feet West)
 This point will not be changed This point will be changed as follows:
Proposed point of diversion: (Complete only if change is requested)
 One in the _____ Quarter of the _____ Quarter of the _____ Quarter of Section _____, Township _____ South, Range _____ (E/W), in _____ County, Kansas, _____ feet North _____ feet West of Southeast corner of section.
 Proposed Rate _____ Proposed Quantity _____ Proposed well depth (feet) _____
 This point is: Additional Well Geo Center List other water rights that will use this point _____

7. Why do you need a new point of diversion? N/A

8. If a well, is the test hole log attached? Yes No

9. When do you propose to complete the new point of diversion?

N/A

10. If the point of diversion is a well:

(a) What are you going to do with the old well?

N/A

(b) When will this be done? N/A

11. Groundwater Management District recommendation attached? Yes No

12. Assisted by Armando Zarco

13a. If the proposed point of diversion will be relocated within 100 feet of the existing point of diversion, indicate its location on the diagram below in relation to the existing point of diversion. (PLEASE NOTE: The "X" in center of diagram below represents presently authorized point of diversion.)

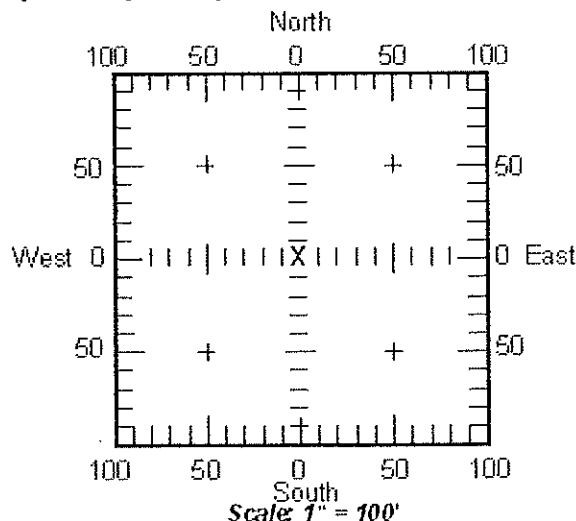

13b. If the proposed point of diversion will be relocated more than 100 feet but within 1320 feet from the existing point of diversion, attach a topographic map or aerial photograph. For groundwater sources, show all wells (including domestic) within one-half mile of the proposed point of diversion and the names and mailing addresses of the owners. For surface water sources, show the names and addresses of the landowner(s) one-half mile downstream and one-half mile upstream from your property lines.

RECEIVED

MAR 28 2018

14. If the proposed groundwater point of diversion is 300 or fewer feet from existing point of diversion, complete the following:

- (a) Does the undersigned represent all owners of the currently authorized place(s) of use identified in this application?
 Yes No (If no, all owners must sign this application.)
- (b) Will the ownership interest of any owner of the currently authorized place(s) of use identified in this application be adversely affected if this application is approved as requested?
 Yes No (If yes, all owners must sign this application.)
- (c) If this application is not approved expeditiously, will there be substantial damage to property, public health or safety?
 Yes No (If no, all owners must sign this application.)

If the application proposes a surface water change in point of diversion, a groundwater change in point of diversion greater than 300 feet, or a change in place of use, the application must be signed by all owners of the currently authorized place of use, or their duly authorized agent (attach notarized statement authorizing representation).

I hereby verify, being first duly sworn upon my oath or affirmation and under penalty of perjury, that I am of lawful age and the owner, the spouse of the owner, or a duly authorized agent of the owner(s) to make this application on their behalf, in regard to the water right(s) to which this application pertains. I further verify that the statements contained in this application are true, correct and complete.

Dated at Bank 7, Kansas, this 28th day of March, 2018.

Michael Koehn
 (Owner)

Michael Koehn
 (Please Print)

 (Owner)

 (Please Print)

 (Owner)

 (Please Print)

Cynthia Koehn
 (Spouse)

Cynthia Koehn
 (Please Print)

 (Spouse)

 (Please Print)

 (Spouse)

 (Please Print)

State of Kansas }
 County of Gray } SS

I hereby certify that the foregoing application was signed in my presence and sworn to before me this 28th day of March, 2018.

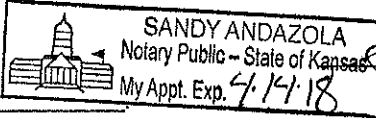
My Commission Expires 4-1-18  [Signature]
 Notary Public

ONLY COMPLETE APPLICATIONS WILL BE PROCESSED. To be complete, all of the applicable portions of the application form must be completed with accurate information; maps, if necessary, must be included; signatures of all the appropriate owners' must be affixed to the application and notarized; and the appropriate fee must be paid.

FEE SCHEDULE

Each application to change the place of use or the point of diversion under this section shall be accompanied by the application fee set forth in the schedule below: Make checks payable to: **Kansas Department of Agriculture**

- (1) Application to change a point of diversion 300 feet or less \$100
- (2) Application to change a point of diversion more than 300 feet \$200
- (3) Application to change the place of use \$200

RECEIVED

MAR 28 2018

SUMMARY ORDER APPROVING APPLICATION FOR CHANGE AND IMPOSING CONDITIONS

This Summary Order is issued under authority of K.S.A. 82a-708b, as amended, and K.A.R. 5-5-1, *et seq.* and other applicable provisions of the *Kansas Water Appropriation Law, K.S.A. 82a-701 et seq.*, and rules and regulations promulgated thereunder, With the exception of those conditions expressly contained herein, this Summary Order does not change the terms, conditions and limitations of File No. 23247.

1. A change application was received on March 28, 2018 requesting that the place of use and / or point of diversion authorized under the above-referenced file number be changed as described in the application.
2. On and after the effective date of this summary order, the authorized place(s) of use shall be located substantially as shown on the topographic map accompanying the application to change the place of use. Applicable Not Applicable
3. The change in point of diversion shall not impair existing rights and shall be limited to the same source or sources of water as previously authorized. The point of diversion authorized by this summary order shall be located within a _____ foot radius of the authorized point(s) of diversion. Applicable Not Applicable
4. The point(s) of diversion described herein is administratively corrected to be more accurately described using the Global Positioning System (GPS), as described in the application. Applicable Not Applicable
5. The point(s) of diversion authorized herein shall not actually be located more than _____ feet from the previously authorized point(s) of diversion. Applicable Not Applicable
6. As required by K.A.R. 5-3-5d, if the works for diversion is a well with a diversion rate of 100 gallons per minute or more, a tube or other device suitable for making water level measurements shall be installed, operated and maintained in accordance with K.A.R. 5-6-13. Applicable Not Applicable
7. The owner of the authorized place(s) of use shall properly install an acceptable water flow meter on or before **December 31, 2018**, or before the first use of water, whichever occurs first. The water flow meter shall be installed, operated and maintained in accordance with K.A.R. 5-1-4 through 5-1-12. As required by K.S.A. 82a-732, as amended, and K.A.R. 5-3-5e, the owner shall maintain records and report the reading of the water flow meter and the total quantity of water diverted annually to the Chief Engineer by March 1 following the end of each calendar year.
 Applicable Not Applicable
8. Installation of the works for diversion of water shall be completed on or before **December 31, 20**_____, or within any authorized extension of time. By March 1, 20____ the applicant shall notify the Chief Engineer that construction of the works for diversion has been completed, on the form provided by the Chief Engineer, as required by K.A.R. 5-8-4e.
 Applicable Not Applicable
9. The completed well log shall be submitted with the required notice. Applicable Not Applicable
10. All diversion works into which any type of chemical or other foreign substance will be injected into the water shall be equipped with an in-line, automatic, quick-closing check valve capable of preventing pollution of the source of the water supply. The check valve(s) shall be installed, operated and maintained in accordance with K.A.R. 5-3-5c. Applicable Not Applicable
11. Additional Conditions are attached. Yes No
12. In accordance with K.S.A. 82a-708a, as amended, and K.A.R. 5-5-14, all of the owners of the authorized place(s) of use of water appropriated under the above-referenced file number are responsible for compliance with its terms, conditions and limitations, as amended and/or supplemented by this Summary Order, and with applicable provisions of the *Kansas Water Appropriation Law* and the *Rules and Regulations* promulgated thereunder. Failure to comply with these provisions may result in civil penalties pursuant to K.S.A. 82a-737, as amended, and/or the suspension or revocation and dismissal of the water or appropriation right or any other enforcement actions authorized by law.

Administrative Appeal and Effective Date of Order

If you are aggrieved by this order, pursuant to K.S.A. 82a-1901, you may request an evidentiary hearing before the Chief Engineer or request administrative review by the Secretary of Agriculture. A request for hearing by the Chief Engineer must be filed within **15 days** of service of this Order and a request for administrative review by the Secretary must be filed within **30 days** pursuant to K.S.A. 77-531. Any request for administrative review must state a basis for review pursuant to K.S.A. 77-527. File any request with **Kansas Department of Agriculture, Legal Division, 1320 Research Park Drive, Manhattan, KS 66502**. Failure to timely request a hearing or review may preclude review under the Kansas Judicial Review Act.

For Use by Register of Deeds

FOR OFFICE USE ONLY
APPLICATION APPROVED AND SUMMARY ORDER ISSUED

By: *Thomas P Makens*
Duly Authorized Designee of the Chief Engineer

(Print Name): Thomas P Makens
Division of Water Resources - Kansas Department of Agriculture

Date of Issuance: April 13, 2018

State of Kansas)

County of Winney) SS

Acknowledged before me on April 13, 2018
by Thomas P Makens

Signature: *Julie Jones*
My commission expires: _____
(Notary Seal)



Change in Place of Use: WR #23247



I agree to the best of my knowledge that all known water wells (IRR, DOM, IND, etc) are shown within green circles on map. If not, I have edited the map indicating the location of the well, type, & owner information.

Signature

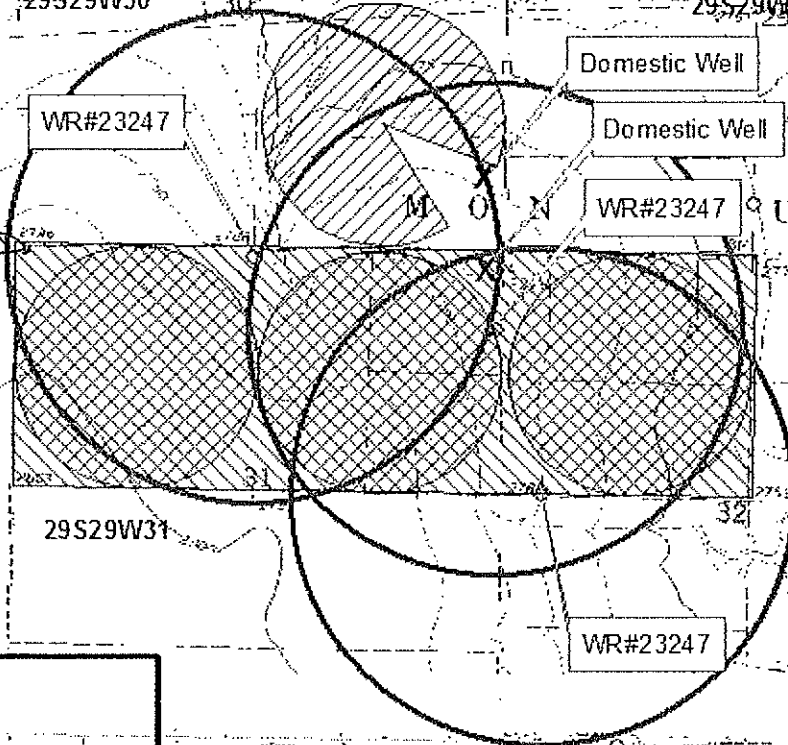

Legend

0 5501.100 2.200 3.300 4.400 Feet



Current Place of Use

Proposed Place of Use

RECEIVED

MAR 28 2018

Garden City Field Office
Division of Water Resources

Change in Place of Use WR #23247

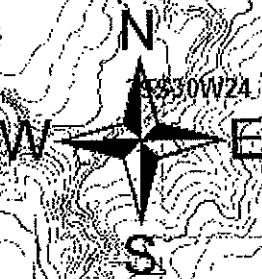

I agree to the best of my knowledge that all known water wells (IRR, DOM, IND, etc) are shown within green circles on map. If not, I have edited the map indicating the location of the well, type, & owner information.

Signature: *Michael Hill*

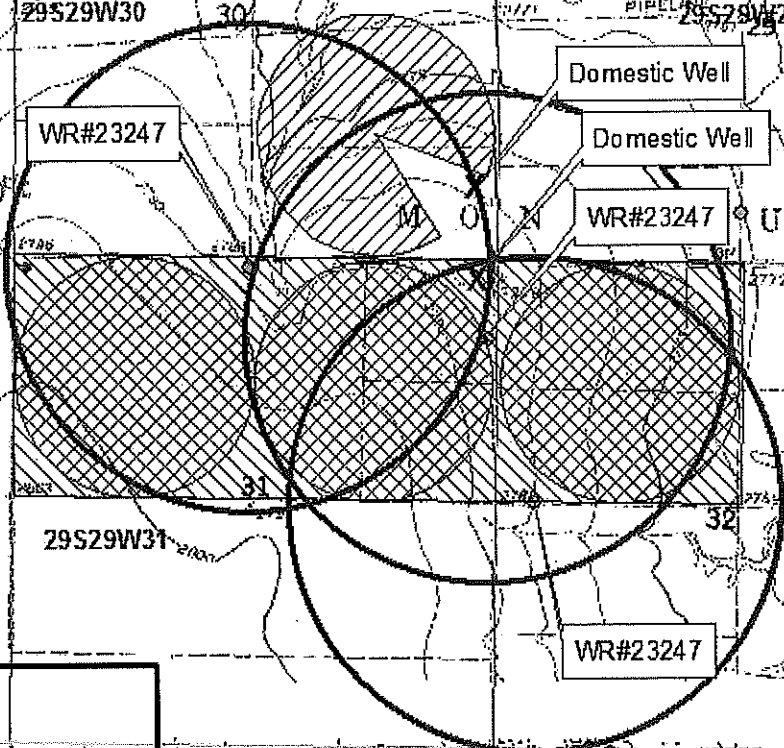

Legend

0 550 1,100 2,200 3,300 4,400 Feet

Current Place of Use

Proposed Place of Use

RECEIVED
MAR 28 2018

Garden City Field Office
Division of Water Resources

STATE OF KANSAS



DEPARTMENT OF AGRICULTURE
DIVISION OF WATER RESOURCES
GARDEN CITY FIELD OFFICE
2508 JOHNS STREET
GARDEN CITY, KS 67846-2804

PHONE: (620) 276-2901
FAX: (620) 276-9315
www.agriculture.ks.gov

GOVERNOR JEFF COLYER, M.D.
JACKIE McCLASKEY, SECRETARY OF AGRICULTURE

March 28, 2018

Southwest Kansas Groundwater
Management District No 3
409 Campus Drive, Suite 106
Garden City KS 67846

Re: Water Right file number 23247

Dear Mr. Norquest;

Michael and Cynthia Koehn have applied to alter the acres authorized to add a pivot location. The base acres are 477. There are three neighboring wells all belong to the same owner.

We are delaying action for 15 days on the change application to allow you time to review and provide a recommendation if you feel one is warranted. I have enclosed a copy of the change for your perusal.

Thank you and as always feel free to call or write us at any time.

Sincerely;

Thomas P Makens

encs.

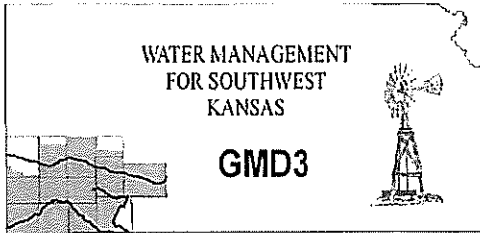

Southwest Kansas
Groundwater Management District No. 3
2009 E. Spruce Street
Garden City, Kansas 67846
(620) 275-7147 phone (620) 275-1431 fax
www.gmd3.org

March 29, 2018

Thomas P. Makens
Division of Water Resources
2508 N Johns Street
Garden City, Kansas 67846

RECEIVED

MAR 30 2018

Garden City Field Office
Division of Water Resources

RE: Applications for Change in Place of Use
Water Rights, File Nos. 23247

Dear Thomas:

We have completed a review of the application for the above referenced water right. The proposal is not in conflict with the Management Program of the Southwest Kansas Groundwater Management District No. 3 (GMD3). The proposed change in place of use, to cover a partial pivot in the SE quarter of 30-29s-29w, by removing some of the currently authorized corners, is in accordance with K.A.R. 5-5-11. It is therefore recommended that the application be approved at this time.

Thank you for the opportunity to review the applications and to provide a recommendation. If you have any questions, please don't hesitate to contact us.

Sincerely,

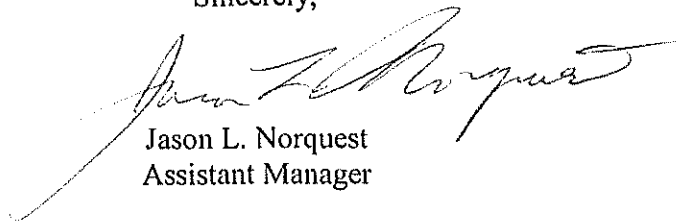

Jason L. Norquest
Assistant Manager

GMD3 Change Review

File No(s): 23247.

DWR office: GC.

App filed to change: PU.

Is Landowner(s) correct in WRIS: YES.

If NO, is documentation included?

Is Water Use Correspondent correct in WRIS? Yes.

If NO, is documentation included?

Regulation(s) Reviewed: KAR 5-5-11

Point of diversion ID No(s) being changed.

RECEIVED

MAR 30 2018

Garden City Field Office
Division of Water Resources

	ft. North	ft. West	
Authorized PD			
Proposed PD			
Difference	0	0	
a2 + b2 = c2	0	0	0

GPS for proposed PD: Lat: Long: .

Is proposed PD stacking on existing WRs? .

Is Proposed PU overlapping existing WRs? NO.

Land Owner(s) notified: Yes.

Name . Name .

Address . Address .

Zip . Zip .

Neighboring certified well(s) notified: .

Name . Name .

Address . Address .

Zip . Zip .

Domestic well(s) notified: .

Name . Name .

Address . Address .

Zip . Zip .

Base Acres: 477 (agreed with DWR).

Perfected Acres: .

Irr. Return-Flow %

Current acres = 477.25

Proposed acres = 477.25

Applicant proposes eliminating the corners of pivots from three quarters in order to add a portion of a pivot on ground currently not authorized.

Is a waiver needed: No.

Final Recommendation: After review of all available information, it appears the current area rules are met. Staff therefore recommends approval of the application.



23247 Change Review, PU

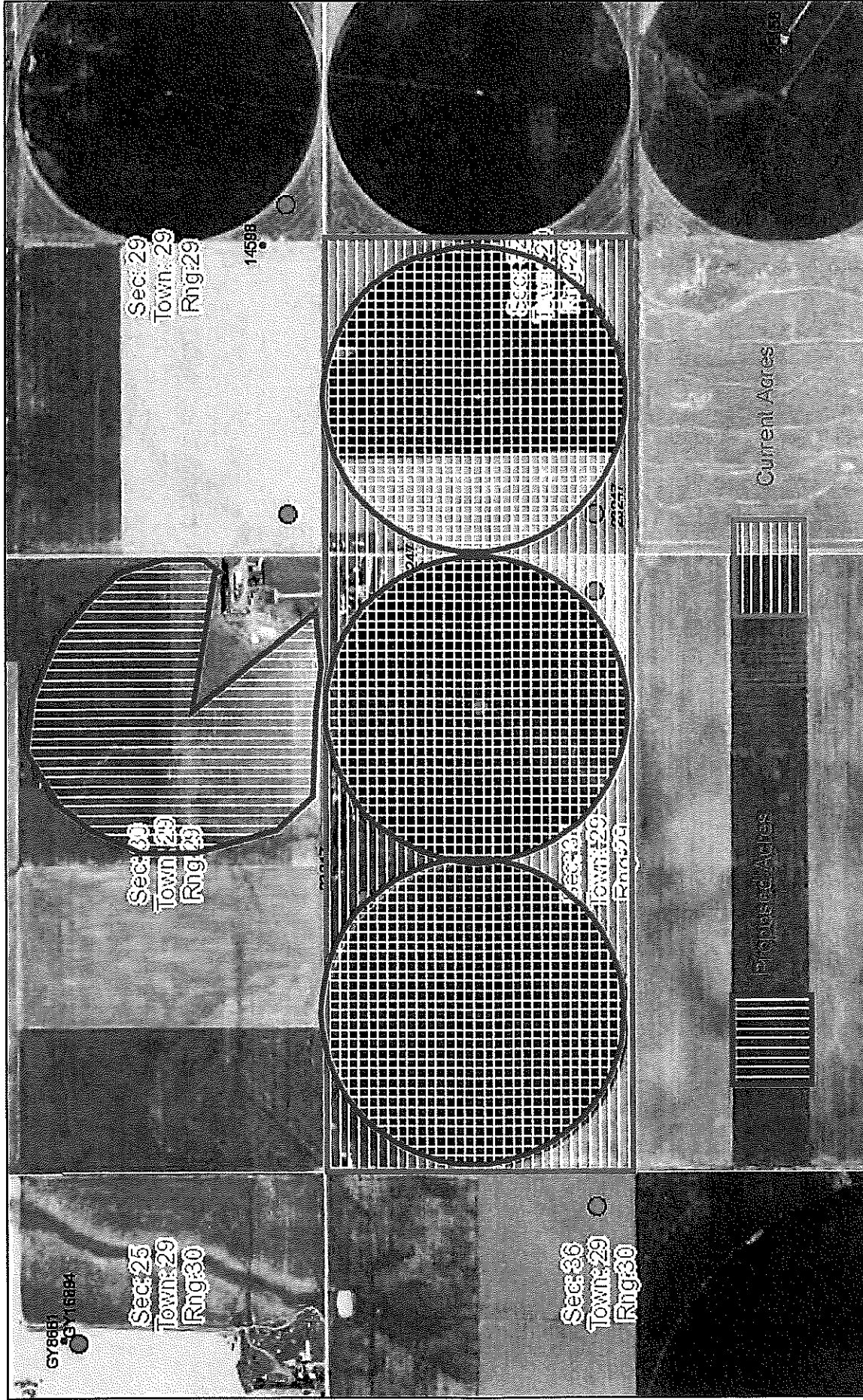

March 29, 2018
13:20 PM

DISCLAIMER: This map is not intended for conveyances, nor is it a legal survey. The information is presented on a best-efforts basis, and should not be relied upon for making financial, survey, legal or other commitments.

Wells ? + CON FPR ▲ MUN ♣ THX
 ? Other ☒ DEW HYD ▽ REC ? Empty
 • IRR ▲ DOM ★ IND ☼ STK ● WWC5 WELLS GMD3

Sections RECEIVED

MAR 30 2018

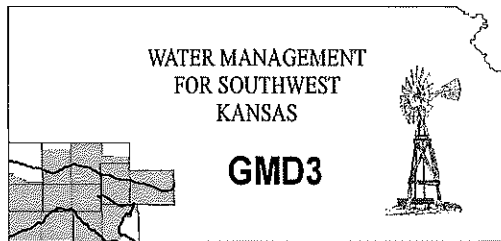

**Southwest Kansas
Groundwater Management District No. 3**
2009 E. Spruce Street
Garden City, Kansas 67846
(620) 275-7147 phone (620) 275-1431 fax
www.gmd3.org

March 29, 2018

Thomas P. Makens
Division of Water Resources
2508 N Johns Street
Garden City, Kansas 67846

RE: Applications for Change in Place of Use
Water Rights, File Nos. 23247

Dear Thomas:

We have completed a review of the application for the above referenced water right. The proposal is not in conflict with the Management Program of the Southwest Kansas Groundwater Management District No. 3 (GMD3). The proposed change in place of use, to cover a partial pivot in the SE quarter of 30-29s-29w, by removing some of the currently authorized corners, is in accordance with K.A.R. 5-5-11. It is therefore recommended that the application be approved at this time.

Thank you for the opportunity to review the applications and to provide a recommendation. If you have any questions, please don't hesitate to contact us.

Sincerely,

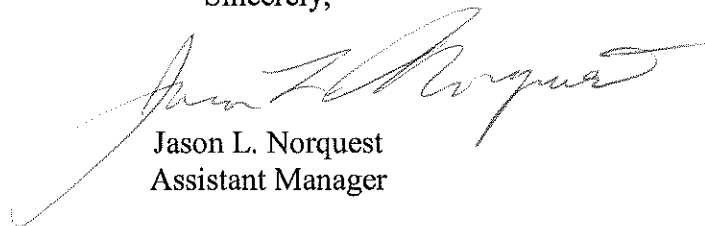

Jason L. Norquest
Assistant Manager

RECEIVED

APR 12 2018

Entered in Transfer Record in my office this
22nd day of January, A. D., 1988
Derk L. Hedlund
Notary Public
Gray County, Kansas

This sixteenth day of November, 19 87

JAMES D. SMITH and ELAINE SMITH, husband and wife,

CONVEY AND WARRANT TO

MICHAEL LYNN KOEHN and CYNTHIA JANE KOEHN, husband and wife

as JOINT TENANTS and not as tenants in common, with full rights of survivorship, the whole estate to vest in the survivor in the event of the death of either, all the following described REAL ESTATE in the County of Gray and the State of Kansas, to-wit:

The Southeast Quarter (SE $\frac{1}{4}$) of Section Thirty (30) in Township Twenty-nine (29) South of Range Twenty-nine (29) West of the 6th P.M.

for the sum of Ten Dollars and other valuable consideration.

EXCEPT AND SUBJECT TO:

Dated November, 19 87

STATE OF KANSAS, GRAY COUNTY, ss

BE IT REMEMBERED, That on this 16th day of Nov.

A. D. 19 87, before me, the undersigned, a

in and for the County and State aforesaid, came

James D. Smith and Elaine Smith,
husband and wife,

James D. Smith
(James D. Smith)
Elaine Smith
(Elaine Smith)

who are personally known to me to be the same person s who executed the within instrument of writing and such person is duly acknowledged the execution of the same.

IN WITNESS WHEREOF, I have hereunto set my hand and affixed my seal the day and year last above written

DERK L. HEDLUND
NOTARY PUBLIC
STATE OF KANSAS
MY APPT. EXPIRES 5/6/90
Term expires 5/6, 19 90

[Signature]
Notary Public.

STATE OF Kansas }
Gray County, } ss.
This instrument was filed for record on the
22nd day of January, A. D., 19 88,
at 1:35 o'clock P. M., and duly recorded
in book 96 of Deeds
at page 341
Barbara K. Gauthaker
Register of Deeds.
INDEXED
PHOTO-COPIED
Fees, \$ 5.00 Deputy.

RECEIVED
MAR 28 2018

Garden City Field Office
Division of Water Resources

