

Kansas Department of Agriculture  
 Division of Water Resources  
**CHANGE: P/U WORKSHEET**

1. File Number: <b>29674D1</b>	2. Status Change Date: <i>2/20/18</i>	3. Change Num: <b>c2</b>	4. Field Office: <b>04</b>	5. GMD: <b>03</b>
6. Status: <input checked="" type="checkbox"/> Approved <input type="checkbox"/> Denied by DWR/GMD <input type="checkbox"/> Dismiss by Request/Failure to Return				7. Filing Date of Change: <b>12/12/17</b>
8a. Applicant(s) New to system <input type="checkbox"/>  <b>DANNY J &amp; SONDR A KOEHN 10714 CC RD MONTEZUMA KS 67867</b>		Person ID <u><b>24666</b></u> Add Seq# <u><b>1</b></u>		
8b. Landowner(s) New to system <input type="checkbox"/>  <b>DANNY J &amp; SONDR A KOEHN 10714 CC RD MONTEZUMA KS 67867</b>		Person ID <u><b>24666</b></u> Add Seq# <u><b>1</b></u>		
8c. Landowner(s) New to system <input type="checkbox"/>  <b>LOREN D &amp; MARSHA L KOEHN 4906 STATE ROAD 144 COPELAND KS 67837-8222</b>		Person ID <u><b>34086</b></u> Add Seq# <u><b>1</b></u>		
8d. WUC New to system <input type="checkbox"/>  <b>DANNY J &amp; SONDR A KOEHN 10714 CC RD MONTEZUMA KS 67867</b>		Person ID <u><b>24666</b></u> Add Seq# <u><b>1</b></u>		
9. Documents and Enclosure(s): <input checked="" type="checkbox"/> DWR Meter(s) Date to Comply: <u><b>12/31/18</b></u> <input type="checkbox"/> N & P Date to Comply: _____				
<input type="checkbox"/> Anti-Reverse Meter <input type="checkbox"/> Meter Seal <input type="checkbox"/> Check Valve <input type="checkbox"/> N & P Form <input type="checkbox"/> Water Tube <input type="checkbox"/> Driller Copy <input type="checkbox"/> H & E Letter				
<input type="checkbox"/> Conservation Plan    Date Required: _____    Date Approved: _____    Date to Comply: _____				
10. Use Made of Water    From: _____    To: _____				
Date Prepared: <b>2/20/18</b>				By: <b>TPM</b>
Date Entered: _____				By: _____





1320 Research Park Drive  
Manhattan, Kansas 66502  
785-564-6700

900 SW Jackson, Room 456  
Topeka, Kansas 66612  
785-296-3556

Secretary Jackie McClaskey

Governor Jeff Colyer, M.D.

February 20, 2018

DANNY J & SONDR A KOEHN  
10714 CC RD  
MONTEZUMA KS 67867

RE: Change the Place of Use, File Nos 275, 11439,  
28806, 29674 D1, 29674 D2

Dear Mr. Koehn;

Enclosed you will find a *Summary Order Approving Application for Change in Place of Use* for the above referenced files. Since these orders modify the original documents, it should be recorded at the County Register of Deeds.

These orders modify the authorized acres that can be irrigated by these files. The authorized place of use is as shown on the plats within the change approvals.

A condition of this order is that an acceptable flow meter must be properly installed on the diversion works authorized under the referenced file number in accordance with the Kansas Administrative Regulations 5-1-4 through 5-1-12. This water flow meter shall be used to provide information required on the annual water use report (including the meter reading at the beginning and end of the report year).

This order shall become final if a request for a hearing is not filed with the Chief Engineer within 15 days of the date of service of this order. The date of service is the date listed on the enclosed *Certificate of Service*.

Should you have any questions, please feel free to call this office or arrange an appointment for additional assistance. Please refer to the file number when you contact us if you wish to discuss a specific file.

Sincerely,

Thomas P. Makens  
Assistant Water Commissioner

TPM:tpm  
Enclosures  
GMD#3

**CERTIFICATE OF SERVICE**

On this 21<sup>st</sup> day of February 2018, I hereby certify that the attached original Approval of Application to Change the Place of Use under Water Right File 275, 11439, 28806, 29674 D1, 29674 D2 dated February 20, 2018, was mailed postage prepaid, first class, US mail to the following:

DANNY J & SONDR A KOEHN  
10714 CC RD  
MONTEZUMA KS 67867

Copy provided to GMD#3

A handwritten signature in black ink, appearing to be 'J. Koehn', written over a horizontal line.

Division of Water Resources



5. **Presently authorized point of diversion:**  
 One in the CS Quarter of the SW Quarter of the SE Quarter  
 of Section 34, Township 28 South, Range 30 W,  
 in GRAY County, Kansas, 100 feet North 1940 feet West of Southeast corner of section.  
 Authorized Rate 1925gpm Authorized Quantity 252AF Depth of well \_\_\_\_\_ (feet)  
 (DWR use only: Computer ID No. \_\_\_\_\_ GPS \_\_\_\_\_ feet North \_\_\_\_\_ feet West)  
 This point will not be changed      This point will be changed as follows:  
**Proposed point of diversion: (Complete only if change is requested)**  
 One in the \_\_\_\_\_ Quarter of the \_\_\_\_\_ Quarter of the \_\_\_\_\_ Quarter  
 of Section \_\_\_\_\_, Township \_\_\_\_\_ South, Range \_\_\_\_\_ W,  
 in \_\_\_\_\_ County, Kansas, \_\_\_\_\_ feet North \_\_\_\_\_ feet West of Southeast corner of section.  
 Proposed Rate \_\_\_\_\_ Proposed Quantity \_\_\_\_\_ Proposed well depth (feet) \_\_\_\_\_  
 This point is: Additional Well Geo Center List other water rights that will use this point RECEIVED

6. **Presently authorized point of diversion:**  
 One in the \_\_\_\_\_ Quarter of the \_\_\_\_\_ Quarter of the DEC 12 2017 Quarter  
 of Section \_\_\_\_\_, Township \_\_\_\_\_ South, Range \_\_\_\_\_  
 in \_\_\_\_\_ County, Kansas, \_\_\_\_\_ feet North \_\_\_\_\_ feet West of Southeast corner of section.  
 Authorized Rate \_\_\_\_\_ Authorized Quantity \_\_\_\_\_ Depth of well \_\_\_\_\_ (feet)  
 (DWR use only: Computer ID No. \_\_\_\_\_ GPS \_\_\_\_\_ feet North \_\_\_\_\_ feet West)  
 This point will not be changed      This point will be changed as follows:  
**Proposed point of diversion: (Complete only if change is requested)**  
 One in the \_\_\_\_\_ Quarter of the \_\_\_\_\_ Quarter of the \_\_\_\_\_ Quarter  
 of Section \_\_\_\_\_, Township \_\_\_\_\_ South, Range \_\_\_\_\_ (E/W),  
 in \_\_\_\_\_ County, Kansas, \_\_\_\_\_ feet North \_\_\_\_\_ feet West of Southeast corner of section.  
 Proposed Rate \_\_\_\_\_ Proposed Quantity \_\_\_\_\_ Proposed well depth (feet) \_\_\_\_\_  
 This point is: Additional Well Geo Center List other water rights that will use this point \_\_\_\_\_

7. Why do you need a new point of diversion? NA
8. If a well, is the test hole log attached? Yes      No
9. When do you propose to complete the new point of diversion?  
NA
10. If the point of diversion is a well:  
 (a) What are you going to do with the old well?  
NA  
 (b) When will this be done? \_\_\_\_\_
11. Groundwater Management District recommendation attached? Yes      No
12. Assisted by GMD3/JLN
- 13a. If the proposed point of diversion will be relocated within 100 feet of the existing point of diversion, indicate its location on

the diagram below in relation to the existing point of diversion. (PLEASE NOTE: The "X" in center of diagram below represents presently authorized point of diversion.)

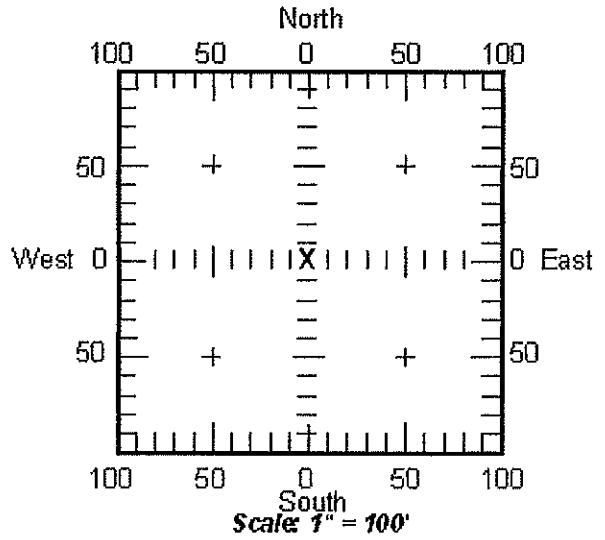

- 13b. If the proposed point of diversion will be relocated more than 100 feet but within 1320 feet from the existing point of diversion, attach a topographic map or aerial photograph. For groundwater sources, show all wells (including domestic) within one-half mile of the proposed point of diversion and the names and mailing addresses of the owners. For surface water sources, show the names and addresses of the landowner(s) one-half mile downstream and one-half mile upstream from your property lines.

14. If the proposed groundwater point of diversion is 300 or fewer feet from existing point of diversion, complete the following:

- (a) Does the undersigned represent all owners of the currently authorized place(s) of use identified in this application?  
Yes                    No (If no, all owners must sign this application.)
- (b) Will the ownership interest of any owner of the currently authorized place(s) of use identified in this application be adversely affected if this application is approved as requested?  
Yes                    No (If yes, all owners must sign this application.)
- (c) If this application is not approved expeditiously, will there be substantial damage to property, public health or safety?  
Yes                    No (If no, all owners must sign this application.)

If the application proposes a surface water change in point of diversion, a groundwater change in point of diversion greater than 300 feet, or a change in place of use, the application must be signed by all owners of the currently authorized place of use, or their duly authorized agent (attach notarized statement authorizing representation).

I hereby verify, being first duly sworn upon my oath or affirmation and under penalty of perjury, that I am of lawful age and the owner, the spouse of the owner, or a duly authorized agent of the owner(s) to make this application on their behalf, in regard to the water right(s) to which this application pertains. I further verify that the statements contained in this application are true, correct and complete.

Dated at 12-12-17, Kansas, this \_\_\_\_\_ day of \_\_\_\_\_, 20\_\_\_\_\_.

Danny J Koehn  
(Owner)

Sandra Koehn  
(Spouse)

DANNY J KOEHN  
(Please Print)

Sandra Koehn  
(Please Print)

\_\_\_\_\_  
(Owner)

\_\_\_\_\_  
(Spouse)

\_\_\_\_\_  
(Please Print)

\_\_\_\_\_  
(Please Print)

\_\_\_\_\_  
(Owner)

\_\_\_\_\_  
(Spouse)

\_\_\_\_\_  
(Please Print)

\_\_\_\_\_  
(Please Print)

RECEIVED  
DEC 12 2017

State of Kansas }  
County of Gray } SS

Garden City Field Office  
Division of Water Resources

I hereby certify that the foregoing application was signed in my presence and sworn to before me this 12 day of December, 2017

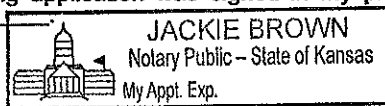

Jackie Brown  
Notary Public

My Commission Expires 12-10-19

**ONLY COMPLETE APPLICATIONS WILL BE PROCESSED.** To be complete, all of the applicable portions of the application form must be completed with accurate information; maps, if necessary, must be included; signatures of all the appropriate owners' must be affixed to the application and notarized; and the appropriate fee must be paid.

**FFF SCHEDULE**

Each application to change the place of use or the point of diversion under this section shall be accompanied by the application fee set forth in the schedule below: Make checks payable to: **Kansas Department of Agriculture**

(1) Application to change a point of diversion 300 feet or less .....	\$100
(2) Application to change a point of diversion more than 300 feet .....	\$200
(3) Application to change the place of use .....	\$200

14. If the proposed groundwater point of diversion is 300 or fewer feet from existing point of diversion, complete the following:
- (a) Does the undersigned represent all owners of the currently authorized place(s) of use identified in this application?  
 Yes     No    (If no, all owners must sign this application.)
  - (b) Will the ownership interest of any owner of the currently authorized place(s) of use identified in this application be adversely affected if this application is approved as requested?  
 Yes     No    (If yes, all owners must sign this application.)
  - (c) If this application is not approved expeditiously, will there be substantial damage to property, public health or safety?  
 Yes     No    (If no, all owners must sign this application.)

If the application proposes a surface water change in point of diversion, a groundwater change in point of diversion greater than 300 feet, or a change in place of use, the application must be signed by all owners of the currently authorized place of use, or their duly authorized agent (attach notarized statement authorizing representation).

I hereby verify, being first duly sworn upon my oath or affirmation and under penalty of perjury, that I am of lawful age and the owner, the spouse of the owner, or a duly authorized agent of the owner(s) to make this application on their behalf, in regard to the water right(s) to which this application pertains. I further verify that the statements contained in this application are true, correct and complete.

Dated at COPELAND, Kansas, this 12 day of FEB, 20 18.

X Lorin D Koehn  
 (Owner)

Lorin D Koehn  
 (Please Print)

(Owner)

(Please Print)

(Owner)

(Please Print)

X Marsha L Koehn  
 (Spouse)

Marsha L Koehn  
 (Please Print)

(Spouse)

(Please Print)

(Spouse)

(Please Print)

RECEIVED

FEB 16 2018

Garden City Field Office  
 Division of Water Resources

State of Kansas }  
 County of Gray } SS

I hereby certify that the foregoing application was signed in my presence and sworn to before me this 12 day of February, 20 18.



Lori Fleming  
 Notary Public

My Commission Expires 2-19-2021

ONLY COMPLETE APPLICATIONS WILL BE PROCESSED. To be complete, all of the applicable portions of the application form must be completed with accurate information; maps, if necessary, must be included; signatures of all the appropriate owners' must be affixed to the application and notarized; and the appropriate fee must be paid.

**FEE SCHEDULE**

Each application to change the place of use or the point of diversion under this section shall be accompanied by the application fee set forth in the schedule below: Make checks payable to: **Kansas Department of Agriculture**

- (1) Application to change a point of diversion 300 feet or less ..... \$100
- (2) Application to change a point of diversion more than 300 feet ..... \$200
- (3) Application to change the place of use ..... \$200





# Change App PU 275, 11439, 29674 D1 & D2

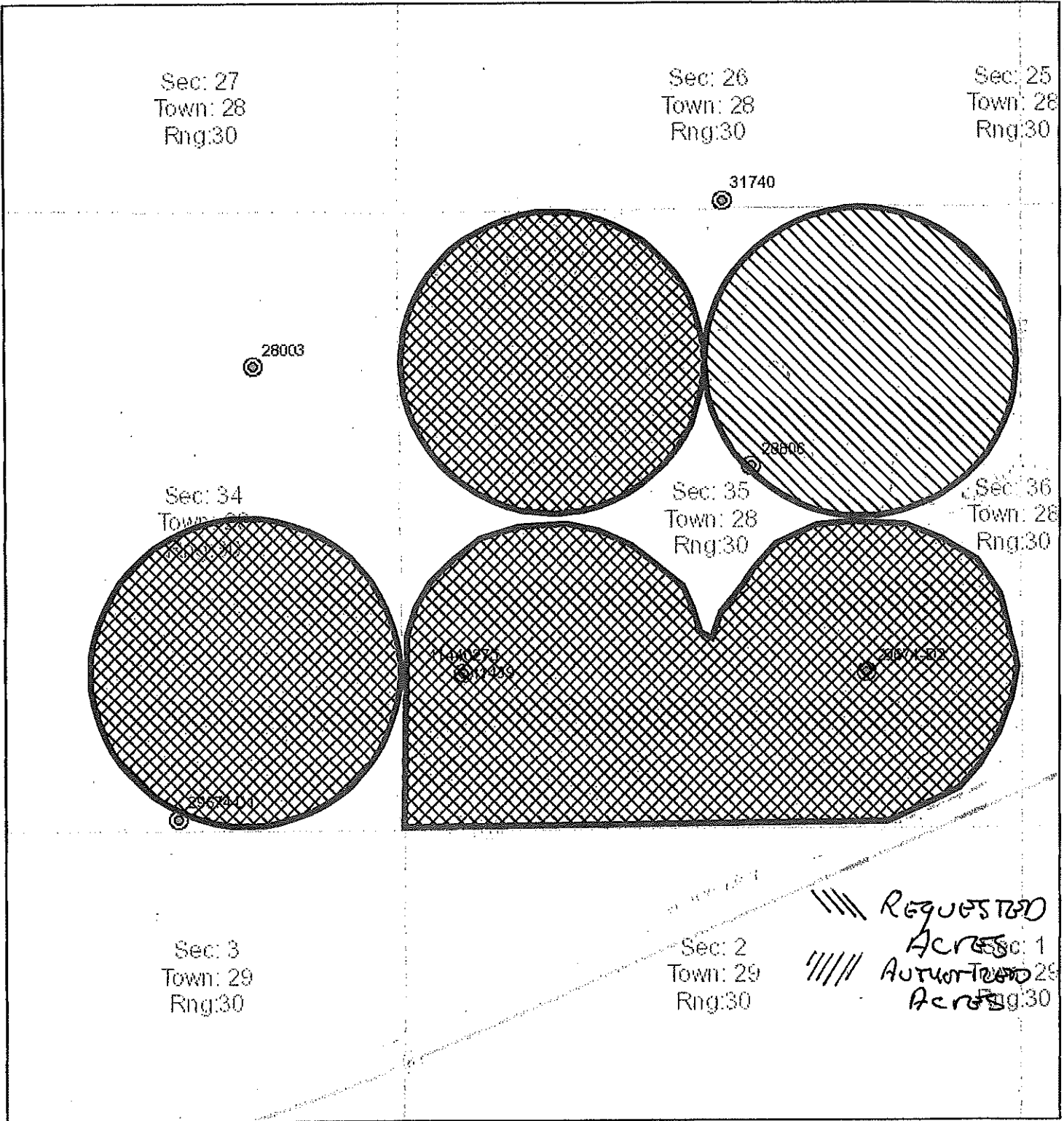

November 30, 2017

DISCLAIMER: This map is not intended for conveyances, nor is it a legal survey. The information is presented on a best-efforts basis, and should not be relied upon for making financial, survey, legal or other commitments.

Legend

- ⊙ Meters
- Wells
- Sections

RECEIVED

DEC 12 2017

Garden City Field Office  
Division of Water Resources

1:18,056

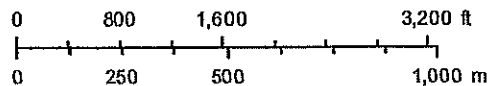

Sources: Esri, HERE, DeLorme, Intermap, increment P Corp., GEBCO, USGS, FAO, NPS, NRCAN, GeoBase, IGN, Kadaster NL, Ordnance Survey, Esri Japan, METI, Esri China (Hong Kong), swisstopo, MapmyIndia, © OpenStreetMap contributors, and the GIS User Community