

Kansas Department of Agriculture
 Division of Water Resources
CHANGE: P/U WORKSHEET

1. File Number: 29674D2	2. Status Change Date: 2/20/18	3. Change Num: c 2	4. Field Office: 04	5. GMD: 03
6. Status: <input checked="" type="checkbox"/> Approved <input type="checkbox"/> Denied by DWR/GMD <input type="checkbox"/> Dismiss by Request/Failure to Return				7. Filing Date of Change: 12/12/17
8a. Applicant(s) New to system <input type="checkbox"/> DANNY J & SONDR A KOEHN 10714 CC RD MONTEZUMA KS 67867		Person ID 24666 Add Seq# 1		
8b. Landowner(s) New to system <input type="checkbox"/> DANNY J & SONDR A KOEHN 10714 CC RD MONTEZUMA KS 67867		Person ID 24666 Add Seq# 1		
8c. Landowner(s) New to system <input type="checkbox"/> LOREN D & MARSHA L KOEHN 4906 STATE ROAD 144 COPELAND KS 67837-8222		Person ID 34086 Add Seq# 1		
8d. WUC New to system <input type="checkbox"/> DANNY J & SONDR A KOEHN 10714 CC RD MONTEZUMA KS 67867		Person ID 24666 Add Seq# 1		
9. Documents and Enclosure(s): <input checked="" type="checkbox"/> DWR Meter(s) Date to Comply: 12/31/18 <input type="checkbox"/> N & P Date to Comply: _____				
<input type="checkbox"/> Anti-Reverse Meter <input type="checkbox"/> Meter Seal <input type="checkbox"/> Check Valve <input type="checkbox"/> N & P Form <input type="checkbox"/> Water Tube <input type="checkbox"/> Driller Copy <input type="checkbox"/> H & E Letter <input type="checkbox"/> Conservation Plan Date Required: _____ Date Approved: _____ Date to Comply: _____				
10. Use Made of Water From: _____ To: _____				
Date Prepared: 2/20/18 By: TPM Date Entered: _____ By: _____				

12. Points of Diversion
 CHK _____ Rate and Quantity
 MOD _____ Authorized _____ Additional _____
 DEL PDIV _____ Rate _____ Quantity _____ Rate _____ Quantity _____
 ENT _____ gpm/cfs _____ af/mgy _____ gpm/cfs _____ af/mgy _____
 Comment (AKA Line) _____ 'W _____ 'N _____ 'ID _____ 'R _____ 'S _____ 'T _____ 'U _____ 'V _____ 'W _____ 'X _____ 'Y _____ 'Z _____
 Overlap PD Files _____

13. Storage: Rate _____ NF _____ Quantity _____ ac/ft Additional Rate _____ NF _____ Additional Quantity _____ ac/ft
 14. Limitation: _____ af/yr at _____ gpm (_____ cfs) when combined with file number(s) _____
 Limitation: _____ af/yr at _____ gpm (_____ cfs) when combined with file number(s) _____

15. 5YR Allocation: Allocation Type _____ Start Year _____ 5 YR Amount _____ Amount Unit _____ Base Acres _____ Comment _____

16. Place of Use CHK MOD DEL ENT	P	U	S	T	R	I	NE 1/4			NW 1/4			SW 1/4			SE 1/4			Total	Owner	Chg?	Overlap Files
							NE 1/4	NW 1/4	SE 1/4	NW 1/4	NE 1/4	SW 1/4	SE 1/4	NE 1/4	NW 1/4	SW 1/4	SE 1/4					
NC	7999	34	28	30W	1											31	31	31	31	124	8c Yes 275 11439 28806 29674 D2 29674 D1	
ENT	26962	35	28	30W	1	31.25	31.25	31.25	31.25	30	30	30	30	30	30	32	32	39	27	516	8b Yes 275 11439 28806 29674 D2 29674 D1	
DEL	38572																					

Base Acres: _____ Year: _____ Minimum Reasonable Quantity: _____
 Comments: _____



1320 Research Park Drive
Manhattan, Kansas 66502
785-564-6700

900 SW Jackson, Room 456
Topeka, Kansas 66612
785-296-3556

Secretary Jackie McClaskey

Governor Jeff Colyer, M.D.

February 20, 2018

DANNY J & SONDR A KOEHN
10714 CC RD
MONTEZUMA KS 67867

RE: Change the Place of Use, File Nos 275, 11439,
28806, 29674 D1, 29674 D2

Dear Mr. Koehn;

Enclosed you will find a *Summary Order Approving Application for Change in Place of Use* for the above referenced files. Since these orders modify the original documents, it should be recorded at the County Register of Deeds.

These orders modify the authorized acres that can be irrigated by these files. The authorized place of use is as shown on the plats within the change approvals.

A condition of this order is that an acceptable flow meter must be properly installed on the diversion works authorized under the referenced file number in accordance with the Kansas Administrative Regulations 5-1-4 through 5-1-12. This water flow meter shall be used to provide information required on the annual water use report (including the meter reading at the beginning and end of the report year).

This order shall become final if a request for a hearing is not filed with the Chief Engineer within 15 days of the date of service of this order. The date of service is the date listed on the enclosed *Certificate of Service*.

Should you have any questions, please feel free to call this office or arrange an appointment for additional assistance. Please refer to the file number when you contact us if you wish to discuss a specific file.

Sincerely,

Thomas P. Makens
Assistant Water Commissioner

TPM:tpm
Enclosures
GMD#3

CERTIFICATE OF SERVICE

On this 21st day of February 2018, I hereby certify that the attached original Approval of Application to Change the Place of Use under Water Right File 275, 11439, 28806, 29674 D1, 29674 D2 dated February 20, 2018, was mailed postage prepaid, first class, US mail to the following:

DANNY J & SONDR A KOEHN
10714 CC RD
MONTEZUMA KS 67867

Copy provided to GMD#3

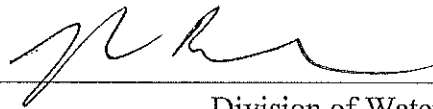
A handwritten signature in black ink, appearing to be 'J. Koehn', written over a horizontal line.

Division of Water Resources

5. **Presently authorized point of diversion:**
 One in the _____ Quarter of the NC Quarter of the SE Quarter
 of Section 35, Township 28 South, Range 30 W,
 in GRAY County, Kansas, 1310 feet North 1340 feet West of Southeast corner of section.
 Authorized Rate 1395gpm Authorized Quantity 260AF Depth of well _____ (feet)
 (DWR use only: Computer ID No. _____ GPS _____ feet North _____ feet West)
 This point will not be changed This point will be changed as follows:
Proposed point of diversion: (Complete only if change is requested)
 One in the _____ Quarter of the _____ Quarter of the _____ Quarter
 of Section _____, Township _____ South, Range _____ W,
 in _____ County, Kansas, _____ feet North _____ feet West of Southeast corner of section.
 Proposed Rate _____ Proposed Quantity _____ Proposed well depth (feet) _____
 This point is: Additional Well Geo Center List other water rights that will use this point _____

6. **Presently authorized point of diversion:**
 One in the _____ Quarter of the _____ Quarter of the _____ Quarter
 of Section _____, Township _____ South, Range _____
 in _____ County, Kansas, _____ feet North _____ feet West of Southeast corner of section.
 Authorized Rate _____ Authorized Quantity _____ Depth of well _____ (feet)
 (DWR use only: Computer ID No. _____ GPS _____ feet North _____ feet West)
 This point will not be changed This point will be changed as follows:
Proposed point of diversion: (Complete only if change is requested)
 One in the _____ Quarter of the _____ Quarter of the _____ Quarter
 of Section _____, Township _____ South, Range _____
 in _____ County, Kansas, _____ feet North _____ feet West of Southeast corner of section.
 Proposed Rate _____ Proposed Quantity _____ Proposed well depth (feet) _____
 This point is: Additional Well Geo Center List other water rights that will use this point _____

RECEIVED
DEC 12 2017
Garden City Field Office
Division of Water Resources (E/W)

7. Why do you need a new point of diversion? NA

the diagram below in relation to the existing point of diversion. (PLEASE NOTE: The "X" in center of diagram below represents presently authorized point of diversion.)

8. If a well, is the test hole log attached? Yes No

9. When do you propose to complete the new point of diversion?
NA

10. If the point of diversion is a well:
 (a) What are you going to do with the old well?
NA
 (b) When will this be done? _____

11. Groundwater Management District recommendation attached? Yes No

12. Assisted by GMD3/JLN

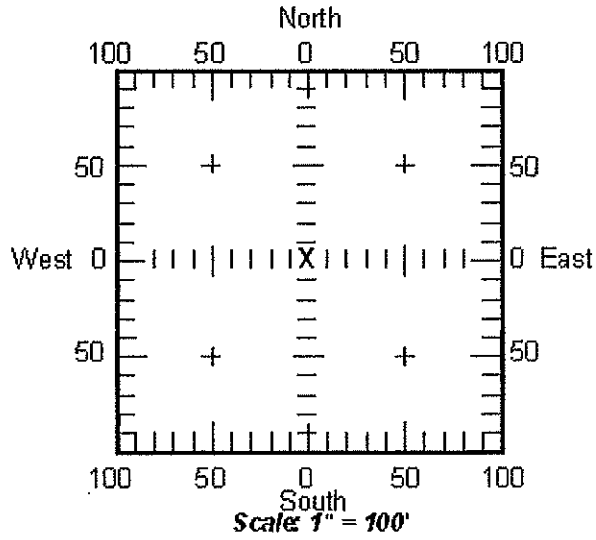

13a. If the proposed point of diversion will be relocated within 100 feet of the existing point of diversion, indicate its location on

13b. If the proposed point of diversion will be relocated more than 100 feet but within 1320 feet from the existing point of diversion, attach a topographic map or aerial photograph. For groundwater sources, show all wells (including domestic) within one-half mile of the proposed point of diversion and the names and mailing addresses of the owners. For surface water sources, show the names and addresses of the landowner(s) one-half mile downstream and one-half mile upstream from your property lines.

14. If the proposed groundwater point of diversion is 300 or fewer feet from existing point of diversion, complete the following:

- (a) Does the undersigned represent all owners of the currently authorized place(s) of use identified in this application?
Yes No (If no, all owners must sign this application.)
- (b) Will the ownership interest of any owner of the currently authorized place(s) of use identified in this application be adversely affected if this application is approved as requested?
Yes No (If yes, all owners must sign this application.)
- (c) If this application is not approved expeditiously, will there be substantial damage to property, public health or safety?
Yes No (If no, all owners must sign this application.)

RECEIVED
DEC 12 2017

Garden City Field Office
Division of Water Resources

If the application proposes a surface water change in point of diversion, a groundwater change in point of diversion greater than 300 feet, or a change in place of use, the application must be signed by all owners of the currently authorized place of use, or their duly authorized agent (attach notarized statement authorizing representation).

I hereby verify, being first duly sworn upon my oath or affirmation and under penalty of perjury, that I am of lawful age and the owner, the spouse of the owner, or a duly authorized agent of the owner(s) to make this application on their behalf, in regard to the water right(s) to which this application pertains. I further verify that the statements contained in this application are true, correct and complete.

Dated at 12-12-17, Kansas, this _____ day of _____, 20_____.

[Signature]

(Owner)

[Signature]

(Spouse)

DANNY J KOEHL

(Please Print)

Sandra Koehn

(Please Print)

(Owner)

(Spouse)

(Please Print)

(Please Print)

(Owner)

(Spouse)

(Please Print)

(Please Print)

State of Kansas }
County of Gray } SS

I hereby certify that the foregoing application was signed in my presence and sworn to before me this 12 day of December, 2017

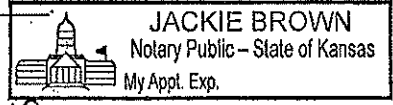
 JACKIE BROWN
Notary Public - State of Kansas
My Appt. Exp.

[Signature]

Notary Public

My Commission Expires 12-10-19

ONLY COMPLETE APPLICATIONS WILL BE PROCESSED. To be complete, all of the applicable portions of the application form must be completed with accurate information; maps, if necessary, must be included; signatures of all the appropriate owners' must be affixed to the application and notarized; and the appropriate fee must be paid.

FFF SCHEDULE

Each application to change the place of use or the point of diversion under this section shall be accompanied by the application fee set forth in the schedule below: Make checks payable to: **Kansas Department of Agriculture**

- (1) Application to change a point of diversion 300 feet or less \$100
- (2) Application to change a point of diversion more than 300 feet \$200
- (3) Application to change the place of use \$200

14. If the proposed groundwater point of diversion is 300 or fewer feet from existing point of diversion, complete the following:
- (a) Does the undersigned represent all owners of the currently authorized place(s) of use identified in this application?
 Yes No (If no, all owners must sign this application.)
 - (b) Will the ownership interest of any owner of the currently authorized place(s) of use identified in this application be adversely affected if this application is approved as requested?
 Yes No (If yes, all owners must sign this application.)
 - (c) If this application is not approved expeditiously, will there be substantial damage to property, public health or safety?
 Yes No (If no, all owners must sign this application.)

If the application proposes a surface water change in point of diversion, a groundwater change in point of diversion greater than 300 feet, or a change in place of use, the application must be signed by all owners of the currently authorized place of use, or their duly authorized agent (attach notarized statement authorizing representation).

I hereby verify, being first duly sworn upon my oath or affirmation and under penalty of perjury, that I am of lawful age and the owner, the spouse of the owner, or a duly authorized agent of the owner(s) to make this application on their behalf, in regard to the water right(s) to which this application pertains. I further verify that the statements contained in this application are true, correct and complete.

Dated at COPELAND, Kansas, this 12 day of Feb, 20 18.

X Lorin D Koehn
 (Owner)

 Lorin D Koehn
 (Please Print)

 (Owner)

 (Please Print)

 (Owner)

 (Please Print)

X Marsha L Koehn
 (Spouse)

 Marsha L Koehn
 (Please Print)

 (Spouse)

 (Please Print)

 (Spouse)

 (Please Print)

RECEIVED
 FEB 16 2018
 Garden City Field Office
 Division of Water Resources

State of Kansas }
 County of Gray } SS

I hereby certify that the foregoing application was signed in my presence and sworn to before me this 12 day of February, 20 18.

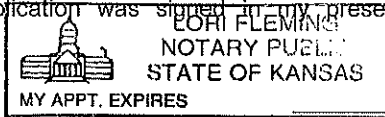

Lori Fleming
 Notary Public

My Commission Expires 2-19-2021.

ONLY COMPLETE APPLICATIONS WILL BE PROCESSED. To be complete, all of the applicable portions of the application form must be completed with accurate information; maps, if necessary, must be included; signatures of all the appropriate owners' must be affixed to the application and notarized; and the appropriate fee must be paid.

FEE SCHEDULE

Each application to change the place of use or the point of diversion under this section shall be accompanied by the application fee set forth in the schedule below: Make checks payable to: **Kansas Department of Agriculture**

- (1) Application to change a point of diversion 300 feet or less \$100
- (2) Application to change a point of diversion more than 300 feet \$200
- (3) Application to change the place of use \$200

SUMMARY ORDER APPROVING APPLICATION FOR CHANGE AND IMPOSING CONDITIONS

This Summary Order is issued under authority of K.S.A. 82a-708b, as amended, and K.A.R. 5-14-3 and other applicable provisions of the *Kansas Water Appropriation Law, K.S.A. 82a-701 et. seq.*, and rules and regulations promulgated thereunder, K.A.R. 5-1-1 *et. seq.* With the exception of those conditions expressly contained herein, this Summary Order does not change the terms, conditions and limitations of File No. 29674 D2.

- 1. A change application was received on December 12, 2017 requesting that the place of use and / or point of diversion authorized under the above-referenced file number be changed as described in the application.
- 2. On and after the effective date of this summary order, the authorized place(s) of use shall be located substantially as shown on the topographic map accompanying the application to change the place of use. Applicable Not Applicable
- 3. The change in point of diversion shall not impair existing rights and shall be limited to the same source or sources of water as previously authorized. The point of diversion authorized by this summary order shall be located within a _____ foot radius of the authorized point(s) of diversion. Applicable Not Applicable
- 4. The point(s) of diversion authorized herein shall not actually be located more than _____ feet from the previously authorized point(s) of diversion. Applicable Not Applicable
- 5. As required by K.A.R. 5-3-5d, if the works for diversion is a well with a diversion rate of 100 gallons per minute or more, a tube or other device suitable for making water level measurements shall be installed, operated and maintained in accordance with K.A.R. 5-6-13. Applicable Not Applicable
- 6. The owner of the authorized place(s) of use shall properly install an acceptable water flow meter on or before **December 31, 2018**, or before the first use of water, whichever occurs first. The water flow meter shall be installed, operated and maintained in accordance with K.A.R. 5-1-4 through 5-1-12. As required by K.S.A. 82a-732, as amended, and K.A.R. 5-3-5e, the owner shall maintain records and report the reading of the water flow meter and the total quantity of water diverted annually to the Chief Engineer by March 1 following the end of each calendar year. Applicable Not Applicable
- 7. Installation of the works for diversion of water shall be completed on or before **December 31, 20**____, or within any authorized extension of time. By March 1, 20____ the applicant shall notify the Chief Engineer that construction of the works for diversion has been completed, on the form provided by the Chief Engineer, as required by K.A.R. 5-8-4e. Applicable Not Applicable
- 8. The completed well log shall be submitted with the required notice. Applicable Not Applicable
- 9. All diversion works into which any type of chemical or other foreign substance will be injected into the water shall be equipped with an in-line, automatic, quick-closing check valve capable of preventing pollution of the source of the water supply. The check valve(s) shall be installed, operated and maintained in accordance with K.A.R. 5-3-5c. Applicable Not Applicable
- 10. Additional Conditions are attached. Yes No
- 11. In accordance with K.S.A. 82a-708a, as amended, and K.A.R. 5-5-14, all of the owners of the authorized place(s) of use of water appropriated under the above-referenced file number are responsible for compliance with its terms, conditions and limitations, as amended and/or supplemented by this Summary Order, and with applicable provisions of the *Kansas Water Appropriation Law* and the *Rules and Regulations* promulgated thereunder. Failure to comply with these provisions may result in civil penalties pursuant to K.S.A. 82a-737, as amended, and/or the suspension or revocation and dismissal of the water or appropriation right or any other enforcement actions authorized by law.

Administrative Appeal and Effective Date of Order

You have the right to a hearing in accordance with K.A.R. 5-14-3 before this Summary Order becomes final action of the Kansas Department of Agriculture. Any request for a hearing must be filed with the **Chief Engineer, Division of Water Resources, Kansas Department of Agriculture, 109 SW 9th Street, Topeka, Kansas 66612**, within 15 days after the date shown on the Certificate of Service attached hereto. If a hearing is not requested in accordance with K.A.R. 5-14-3, this Summary Order will become effective on the 15th day after the date shown on the Certificate of Service.

For Use by Register of Deeds

FOR OFFICE USE ONLY
**APPLICATION APPROVED AND
SUMMARY ORDER ISSUED**

By: _____
Duly Authorized Designee of the Chief Engineer

(Print Name): Thomas P Makens
Division of Water Resources - Kansas Department of Agriculture

Date of Issuance: FEBRUARY 20, 2018

State of Kansas)
) SS
County of Finney)

Acknowledged before me on February 20, 2018
by Thomas P Makens

Signature: Sue Keeny
Notary Public

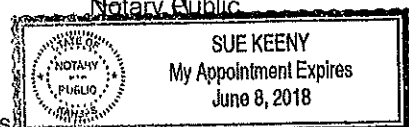

My commission expires _____
(Notary Seal)

Change App PI: 275, 11439, 29674 D1 & D2

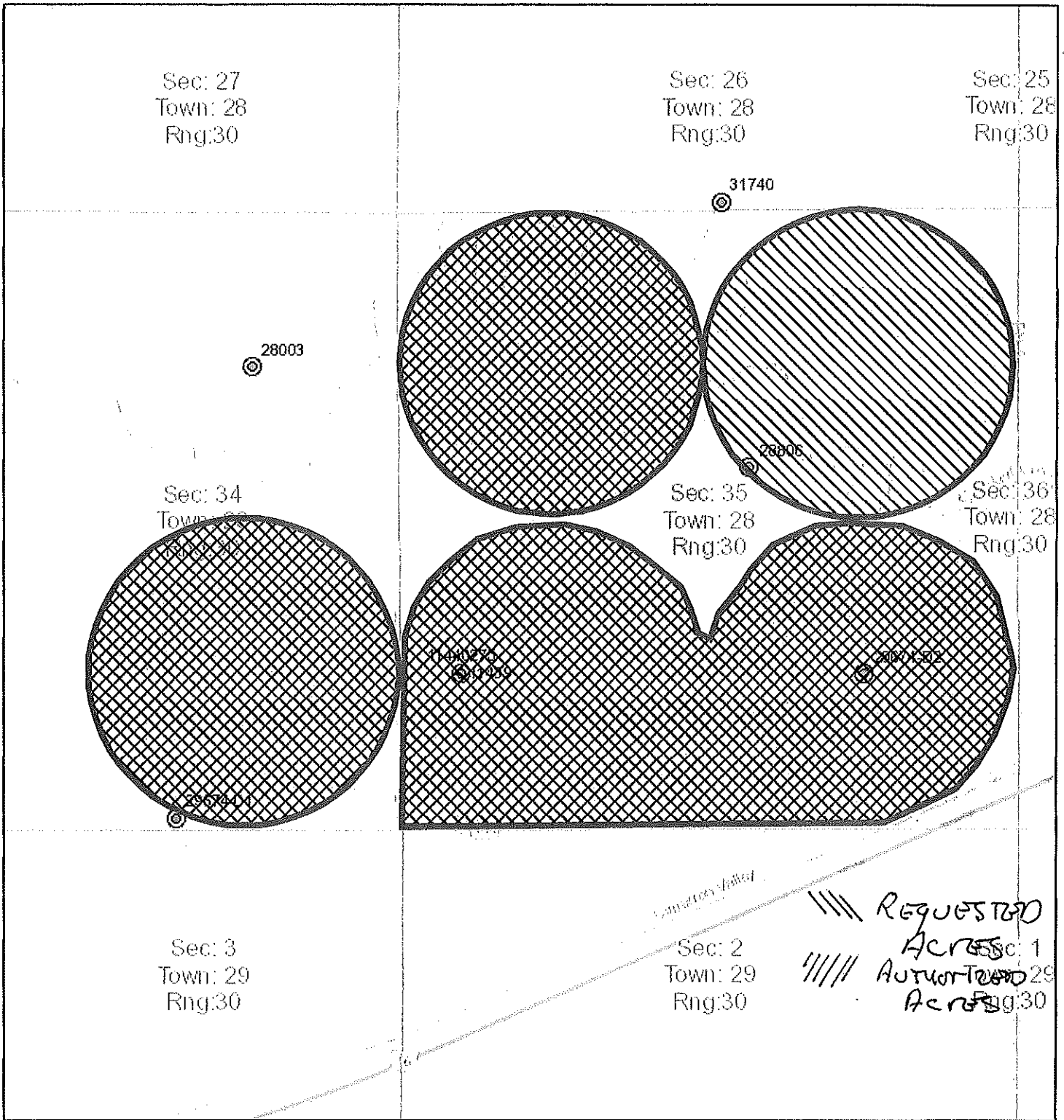

November 30, 2017

DISCLAIMER: This map is not intended for conveyances, nor is it a legal survey. The information is presented on a best-efforts basis, and should not be relied upon for making financial, survey, legal or other commitments.

Legend

- ⊙ Meters
- Wells
- Sections

RECEIVED

DEC 12 2017

Garden City Field Office
Division of Water Resources

1:18,056

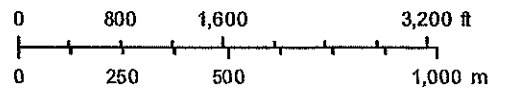

Sources: Esri, HERE, DeLorme, Intermap, increment P Corp., GEBCO, USGS, FAO, NPS, NRCAN, GeoBase, IGN, Kadaster NL, Ordnance Survey, Esri Japan, METI, Esri China (Hong Kong), swisstopo, MapmyIndia, © OpenStreetMap contributors, and the GIS User Community