

Kansas Department of Agriculture  
 Division of Water Resources  
**CHANGE: P/D WORKSHEET**

1. File Number: <b>30069</b>	2. Status Change Date: <b>5/10/18</b>	3. Change Num: <b>c1</b>	4. Field Office: <b>04</b>	5. GMD: <b>03</b>
6. Status: <input checked="" type="checkbox"/> Approved <input type="checkbox"/> Denied by DWR/GMD <input type="checkbox"/> Dismiss by Request/Failure to Return				7. Filing Date of Change: <b>5/8/18</b>
8a. Applicant(s) New to system <input type="checkbox"/>  <b>EAKES FARM INC LARRY EAKES 13204 2 RD PLAINS KS 67869</b>		Person ID <b>36374</b> Add Seq# <b>1</b>		
8b. Landowner(s) New to system <input type="checkbox"/>  <b>NC</b>		Person ID _____ Add Seq# _____		
8c. Landowner(s) New to system <input type="checkbox"/>		Person ID _____ Add Seq# _____		
8d. WUC New to system <input type="checkbox"/>  <b>NC</b>		Person ID _____ Add Seq# _____		
9. Documents and Enclosure(s): <input checked="" type="checkbox"/> DWR Meter(s) Date to Comply: <b>12/31/18</b> <input checked="" type="checkbox"/> N & P Date to Comply: <b>12/31/18</b>				
<input type="checkbox"/> Anti-Reverse Meter <input type="checkbox"/> Meter Seal <input type="checkbox"/> Check Valve <input type="checkbox"/> N & P Form <input type="checkbox"/> Water Tube <input type="checkbox"/> Driller Copy <input type="checkbox"/> H & E Letter <input type="checkbox"/> Conservation Plan    Date Required: _____    Date Approved: _____    Date to Comply: _____				
10. Use Made of Water    From: _____    To: _____				
Date Prepared: <b>5/8/18</b> By: <b>TPM</b> Date Entered: _____    By: _____				



STATE OF KANSAS

DEPARTMENT OF AGRICULTURE  
DIVISION OF WATER RESOURCES  
GARDEN CITY FIELD OFFICE  
2508 JOHNS STREET  
GARDEN CITY, KS 67846-2804



PHONE: (620) 276-2901  
FAX: (620) 276-9315  
www.agriculture.ks.gov

GOVERNOR JEFF COLYER, M.D.  
JACKIE McCLASKEY, SECRETARY OF AGRICULTURE

May 10, 2018

EAKES FARM INC  
LARRY EAKES  
13204 2 RD  
PLAINS KS 67869

RE: Change in Point of Diversion Water Right, File No 26116, 30069

Dear Mr. Eakes:

Enclosed you will find a *Summary Order Approving Application for Change in Points of Diversion* for the above referenced file. This order modifies the authorized well location under the referenced file. This order modifies the original document; it should be recorded at the County Register of Deeds.

Your attention is directed to the enclosures and to the terms, conditions, and limitations specified in this order. The diversion works should be completed and reported to the Division of Water Resources **by December 31, 2018**. Enclosed is a form for this purpose, along with other information for reference.

A condition of this order is that an acceptable flow meter must be properly installed on the diversion works authorized under the referenced file number in accordance with the Kansas Administrative Regulations 5-1-4 through 5-1-12. This water flow meter shall be used to provide information required on the annual water use report.

This order shall become final if a request for a hearing is not filed with the Chief Engineer within 15 days of the date of service of this order. The date of service is the date listed on the enclosed *Certificate of Service*.

Should you have any questions, please feel free to call this office. If you would prefer, you could arrange an appointment for additional assistance.

Sincerely,

Thomas P. Makens  
Assistant Water Commissioner

TPM:tpm  
Enclosures  
GMD#3

**CERTIFICATE OF SERVICE**

On this 11<sup>th</sup> day of May 2018, I hereby certify that the attached original Approval of Application to Change the Point of Diversion under Water Right, File No. 26116, 30069 dated May 10, 2018 was mailed postage prepaid, first class, US mail to the following:

EAKES FARM INC  
LARRY EAKES  
13204 2 RD  
PLAINS KS 67869

Copy provided to GMD#3

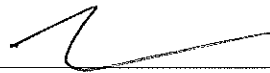

---

Division of Water Resources

Submit completed application to:  
 Kansas Department of Agriculture  
 Division of Water Resources  
 Field Office for your area.  
 Call for address:

Topeka -- (785) 296-5733  
 Stafford -- (620) 234-5311  
 Stockton -- (785) 425-6787  
 Garden City -- (620) 276-2901  
<http://agriculture.ks.gov/dwr>

## DWR FIELD OFFICE APPLICATION FOR APPROVAL TO CHANGE THE PLACE OF USE AND/OR THE POINT OF DIVERSION



STATE OF KANSAS

Filing Fee Must Accompany the Application, K.S.A. 82a-708b(b), as amended.  
 Fee Schedule is on the third page of this application form.

Paragraph Nos. 1, 2, 3 & 5 must be completed. Complete all other applicable portions. If change in point of diversion is greater than 100 feet, or if place of use will be changed, include a topographic map or detailed plat showing the authorized and proposed point(s) of diversion and/or place of use.

File No. 30069

RECEIVED  
 (10:38 AM  
 MAY 08 2018

1. Application is hereby made for approval of the Chief Engineer to change the (check one or both):

Place of Use                       Point of Diversion

Garden City Field Office  
 Division of Water Resources

under the water right which is the subject of this application in accordance with the conditions described below.

The source of supply is:                       Groundwater                       Surface water

2. Name and address of Applicant: EAKES FARM INC LARRY EAKES  
13204 2 RD PLAINS KS 67869

Phone Number: (     )                      Email address: \_\_\_\_\_

Name and address of Water Use Correspondent: EAKES FARM INC LARRY EAKES  
13204 2 RD PLAINS KS 67869

Phone Number: (     )                      Email address: \_\_\_\_\_

3. The presently authorized place of use is:

Owner of Land ---- NAME: LAWRENCE J & DEBRA K EAKES REV TRUST

ADDRESS: 13204 2 RD PLAINS KS 67869

(If there is more than one landowner, attach supplemental sheets as necessary.)

Sec.	Twp.	Range	NE¼				NW¼				SW¼				SE¼				TOTAL ACRES		
			NE¼	NW¼	SW¼	SE¼	NE¼	NW¼	SW¼	SE¼	NE¼	NW¼	SW¼	SE¼	NE¼	NW¼	SW¼	SE¼			

4. If this application is for a change in place of use, it is proposed that the place of use be changed to:

Owner of Land ---- NAME: no change to acres

ADDRESS: \_\_\_\_\_

(If there is more than one landowner, attach supplemental sheets as necessary.)

Sec.	Twp.	Range	NE¼				NW¼				SW¼				SE¼				TOTAL ACRES			
			NE¼	NW¼	SW¼	SE¼	NE¼	NW¼	SW¼	SE¼	NE¼	NW¼	SW¼	SE¼	NE¼	NW¼	SW¼	SE¼				

For Office Use Only: Code \_\_\_\_\_ Fee \$ 100 TR # \_\_\_\_\_ Receipt Date 5/8/18 Check # 7104

5. **Presently authorized point of diversion:**  
 One in the       nw       Quarter of the       nw       Quarter of the       se       Quarter  
 of Section       35      , Township       31       South, Range       31       W,  
 in       Seward       County, Kansas,       2550       feet North       2600       feet West of Southeast corner of section.  
 Authorized Rate \_\_\_\_\_ Authorized Quantity \_\_\_\_\_ Depth of well \_\_\_\_\_ (feet)  
 (DWR use only: Computer ID No.       2       GPS \_\_\_\_\_ feet North \_\_\_\_\_ feet West)  
 This point will not be changed  This point will be changed as follows:  No change, point better described with GPS as follows:  
**Proposed point of diversion: (Complete only if change is requested or if existing point is better described by GPS)**  
 One in the       nw NE       Quarter of the       nw NE       Quarter of the       se SW       Quarter  
 of Section       35      , Township       31       South, Range       31       W,  
 in       Seward       County, Kansas,       2550       feet North       2686       feet West of Southeast corner of section.  
 Proposed Rate \_\_\_\_\_ Proposed Quantity \_\_\_\_\_ Proposed well depth (feet) \_\_\_\_\_  
 This point is:  Additional Well  Geo Center List other water rights that will use this point \_\_\_\_\_

6. **Presently authorized point of diversion:**  
 One in the \_\_\_\_\_ Quarter of the \_\_\_\_\_ Quarter of the \_\_\_\_\_ Quarter  
 of Section \_\_\_\_\_, Township \_\_\_\_\_ South, Range \_\_\_\_\_ (E/W),  
 in \_\_\_\_\_ County, Kansas, \_\_\_\_\_ feet North \_\_\_\_\_ feet West of Southeast corner of section.  
 Authorized Rate \_\_\_\_\_ Authorized Quantity \_\_\_\_\_ Depth of well \_\_\_\_\_ (feet)  
 (DWR use only: Computer ID No. \_\_\_\_\_ GPS \_\_\_\_\_ feet North \_\_\_\_\_ feet West)  
 This point will not be changed  This point will be changed as follows:  No change, point better described with GPS as follows:  
**Proposed point of diversion: (Complete only if change is requested or if existing point is better described by GPS)**  
 One in the \_\_\_\_\_ Quarter of the \_\_\_\_\_ Quarter of the \_\_\_\_\_ Quarter  
 of Section \_\_\_\_\_, Township \_\_\_\_\_ South, Range \_\_\_\_\_ (E/W),  
 in \_\_\_\_\_ County, Kansas, \_\_\_\_\_ feet North \_\_\_\_\_ feet West of Southeast corner of section.  
 Proposed Rate \_\_\_\_\_ Proposed Quantity \_\_\_\_\_ Proposed well depth (feet) \_\_\_\_\_  
 This point is:  Additional Well  Geo Center List other water rights that will use this point \_\_\_\_\_

7. The changes herein are desired for the following reasons?  
 (please be specific) \_\_\_\_\_  
 old well needs to be replaced \_\_\_\_\_

8. If a well, is the test hole log attached?  Yes  No

9. The change(s) (was)(will be) completed by?  
      May 11, 2018      

10. If the point of diversion is a well:  
 (a) What are you going to do with the old well?  
      plug        
 (b) When will this be done?       2018      

11. Groundwater Management District recommendation attached?  
 Yes  No

12. Assisted by       tpm      

13a. If the proposed point of diversion will be relocated more than 300 feet but within 2,640 feet of the existing point of diversion, attach a topographic map or aerial photograph. For groundwater sources, show all wells (including domestic) within one-half mile of the proposed point of diversion and the names and mailing addresses of the owners. For surface water sources, show the names and addresses of the landowner(s) one-half mile downstream and one-half mile upstream from your property lines

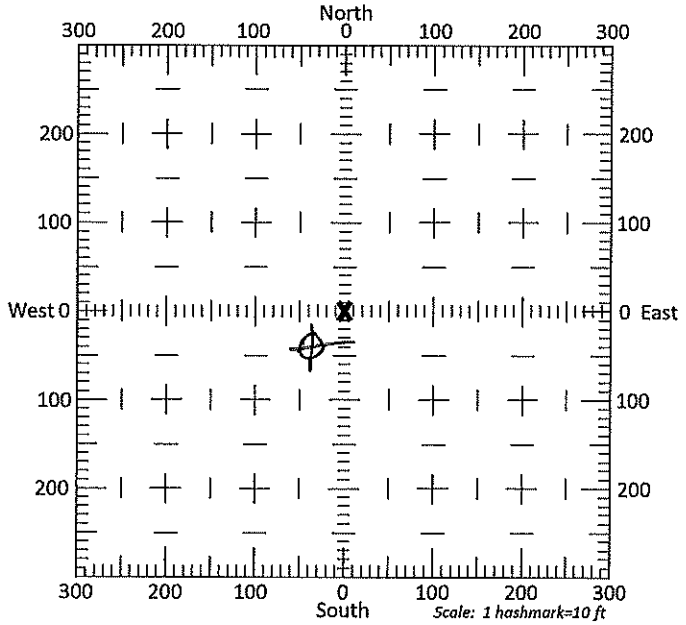

13b. If the proposed point of diversion will be relocated within 300 feet of the existing point of diversion, indicate its location on the diagram shown above in relation to the existing point of diversion. (PLEASE NOTE: The "X" in center of diagram above represents the presently authorized point of diversion.)

14. If the proposed groundwater point of diversion is 300 or fewer feet from the existing point of diversion, complete the following:

(a) Does the undersigned represent all owners of the currently authorized place(s) of use identified in this application?  
 Yes     No    (If no, all owners must sign this application.)

(b) Will the ownership interest of any owner of the currently authorized place(s) of use identified in this application be adversely affected if this application is approved as requested?  
 Yes     No    (If yes, all owners must sign this application.)

(c) If this application is not approved expeditiously, will there be substantial damage to property, public health or safety?  
 Yes     No    (If no, all owners must sign this application.)

If the application proposes a surface water change in point of diversion, a groundwater change in point of diversion greater than 300 feet, or a change in place of use, the application must be signed by all owners of the currently authorized place of use, or their duly authorized agent (attach notarized statement authorizing representation).

I hereby verify, being first duly sworn upon my oath or affirmation and under penalty of perjury, that I am of lawful age and the owner, the spouse of the owner, or a duly authorized agent of the owner(s) to make this application on their behalf, in regards to the water right(s) to which this application pertains. I further verify that the statements contained in this application are true, correct and complete.

Dated at GARDEN CITY, Kansas, this 7<sup>th</sup> day of MAY, 2018.

Gary Estes  
(Owner)

\_\_\_\_\_  
(Spouse)

\_\_\_\_\_  
(Please Print)

\_\_\_\_\_  
(Please Print)

\_\_\_\_\_  
(Owner)

\_\_\_\_\_  
(Spouse)

\_\_\_\_\_  
(Please Print)

\_\_\_\_\_  
(Please Print)

\_\_\_\_\_  
(Owner)

\_\_\_\_\_  
(Spouse)

\_\_\_\_\_  
(Please Print)

\_\_\_\_\_  
(Please Print)

State of Kansas

County of ANNEK } SS

I hereby certify that the foregoing application was signed in my presence and sworn to before me this 7<sup>th</sup> day of MAY, 2018.



Catherine Beibert  
Notary Public

My Commission Expires 9-18-18

ONLY COMPLETE APPLICATIONS WILL BE PROCESSED. To be complete, all of the applicable portions of the application form must be completed with accurate information; maps, if necessary, must be included; signatures of all the appropriate owners' must be affixed to the application and notarized; and the appropriate fee must be paid.

**FEE SCHEDULE**

Each application to change the place of use or the point of diversion under this section shall be accompanied by the application fee set forth in the schedule below: Make checks payable to: **Kansas Department of Agriculture**

- (1) Application to change a point of diversion 300 feet or less . . . . . \$100
- (2) Application to change a point of diversion more than 300 feet . . . . . \$200
- (3) Application to change the place of use . . . . . \$200

**SUMMARY ORDER APPROVING APPLICATION FOR CHANGE AND IMPOSING CONDITIONS**

This Summary Order is issued under authority of K.S.A. 82a-708b, as amended, and K.A.R. 5-5-1, *et seq.* and other applicable provisions of the *Kansas Water Appropriation Law, K.S.A. 82a-701 et seq.*, and rules and regulations promulgated thereunder, With the exception of those conditions expressly contained herein, this Summary Order does not change the terms, conditions and limitations of File No. 30069.

1. A change application was received on MAY 8, 2018 requesting that the place of use and / or point of diversion authorized under the above-referenced file number be changed as described in the application.
2. On and after the effective date of this summary order, the authorized place(s) of use shall be located substantially as shown on the topographic map accompanying the application to change the place of use.  Applicable  Not Applicable
3. The change in point of diversion shall not impair existing rights and shall be limited to the same source or sources of water as previously authorized. The point of diversion authorized by this summary order shall be located within a 50 foot radius of the authorized point(s) of diversion.  Applicable  Not Applicable
4. The point(s) of diversion described herein is administratively corrected to be more accurately described using the Global Positioning System (GPS), as described in the application.  Applicable  Not Applicable
5. The point(s) of diversion authorized herein shall not actually be located more than \_\_\_\_\_ feet from the previously authorized point(s) of diversion.  Applicable  Not Applicable
6. As required by K.A.R. 5-3-5d, if the works for diversion is a well with a diversion rate of 100 gallons per minute or more, a tube or other device suitable for making water level measurements shall be installed, operated and maintained in accordance with K.A.R. 5-6-13.  Applicable  Not Applicable
7. The owner of the authorized place(s) of use shall properly install an acceptable water flow meter on or before December 31, 2018, or before the first use of water, whichever occurs first. The water flow meter shall be installed, operated and maintained in accordance with K.A.R. 5-1-4 through 5-1-12. As required by K.S.A. 82a-732, as amended, and K.A.R. 5-3-5e, the owner shall maintain records and report the reading of the water flow meter and the total quantity of water diverted annually to the Chief Engineer by March 1 following the end of each calendar year.  Applicable  Not Applicable
8. Installation of the works for diversion of water shall be completed on or before December 31, 2018, or within any authorized extension of time. By March 1, 2019 the applicant shall notify the Chief Engineer that construction of the works for diversion has been completed, on the form provided by the Chief Engineer, as required by K.A.R. 5-8-4e.  Applicable  Not Applicable
9. The completed well log shall be submitted with the required notice.  Applicable  Not Applicable
10. All diversion works into which any type of chemical or other foreign substance will be injected into the water shall be equipped with an in-line, automatic, quick-closing check valve capable of preventing pollution of the source of the water supply. The check valve(s) shall be installed, operated and maintained in accordance with K.A.R. 5-3-5c.  Applicable  Not Applicable
11. Additional Conditions are attached.  Yes  No
12. In accordance with K.S.A. 82a-708a, as amended, and K.A.R. 5-5-14, all of the owners of the authorized place(s) of use of water appropriated under the above-referenced file number are responsible for compliance with its terms, conditions and limitations, as amended and/or supplemented by this Summary Order, and with applicable provisions of the *Kansas Water Appropriation Law* and the *Rules and Regulations* promulgated thereunder. Failure to comply with these provisions may result in civil penalties pursuant to K.S.A. 82a-737, as amended, and/or the suspension or revocation and dismissal of the water or appropriation right or any other enforcement actions authorized by law.

**Administrative Appeal and Effective Date of Order**

If you are aggrieved by this order, pursuant to K.S.A. 82a-1901, you may request an evidentiary hearing before the Chief Engineer or request administrative review by the Secretary of Agriculture. A request for hearing by the Chief Engineer must be filed within **15 days** of service of this Order and a request for administrative review by the Secretary must be filed within **30 days** pursuant to K.S.A. 77-531. Any request for administrative review must state a basis for review pursuant to K.S.A. 77-527. File any request with **Kansas Department of Agriculture, Legal Division, 1320 Research Park Drive, Manhattan, KS 66502**. Failure to timely request a hearing or review may preclude review under the Kansas Judicial Review Act.

*For Use by Register of Deeds*

FOR OFFICE USE ONLY  
**APPLICATION APPROVED AND SUMMARY ORDER ISSUED**

By: [Signature]  
Duly Authorized Designee of the Chief Engineer

(Print Name): THOMAS P. MAKENS  
Division of Water Resources - Kansas Department of Agriculture

Date of Issuance: MAY 10, 2018

State of Kansas \_\_\_\_\_ )

County of Finney ) SS

Acknowledged before me on MAY 10, 2018

by Thomas P. Makens

Signature: [Signature]

My commission expires: \_\_\_\_\_  
  
 (Notary Seal)



3795 W. Jones Ave.  
 Garden City, KS 67846  
 PH: 620-277-2389



**Hydro**  
resources

PO Box 639  
 Garden City, KS 67846  
 Fax: 620-277-0224

FILE # 26116 & 30069

EAKES FARMS CELL 620-629-3884

Customer Name: Larry Eakes WO#: 13759 Date: 5-4-18  
 Street Address: 13204 ROAD 2 Test #: 2 E LOG: Yes  
 City, State: PLAINVILLE KS 67869 Driller: Dale Guinn  
 County: Seward Quarter: SE Section: 35 Township: 31 Range: 31  
 Location: 22' South & 25' West of Existing Well GPS: N37.30766 W100.66219  
 Rig #: 10002 Elevation: 2776' Static WL: 277' Estimated?           
 Proposed Well Depth 526

WELL LOCATION 10' SUMP

%	Footage			Description of Strata
	From	Pay	To	
	0		2	Top Soil
	2		36	Brown Sandy Clay w/couple fine sand ledges
	36		48	Brown Clay & Caliche
	48		58	Sand fine to med course small gravel
	58		80	Brown Clay & Caliche w/few lime rock ledges
	80		134	Sand fine to med course small gravel
	134		156	Sand fine to med course w/some clay stringers & few clay ledges
	156		184	Sand fine to med course some small gravel
	184		208	Brown Clay w/couple sand ledges
	208		220	Sand fine to med course
	220		232	Brown & light Blue Clay
	232		255	Sand fine to med course
	255		260	Brown Clay
25	260	18	295	Sand fine to med course
	295		341	Blue Clay - sticky -
25	341	23	364	Sand fine to med course
	364		374	Brown Clay - sticky -
15	374	11	385	Sand fine to med course w/some clay stringers
30	385	23	408	Sand fine to med course small gravel - Drilled loose -
15	408	7	415	Sand fine to med course w/some clay stringers
	415		418	Brown Clay - sticky -
5	418	22	440	Lime Rock & Fine sand w/few clay stringers & couple clay ledges
10	440	25	465	Fine sand w/few clay stringers - Drilled Fairly loose -
30	465	31	496	Sand fine to med course w/brown rock
25	496	20	516	Brown Rock w/some clay stringers
	516		520	Red Bed
		162		Super Gel X -2
				Bent Plug 3/4 -5
				Perma Plug -1
				4 3/4 Drag Blade -1

# Larry Eakes

SE 35-31-31 Seward  
Proposed Well Location

2795  
Road 23

2782

2791

Well

2790

2791

35 2785

87.30766, -100.66219

2785

2785

Co Rd 1 W

2787

2783

2782

X

Google Earth

© 2013 Google

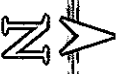

2000 ft