

Submit completed application to:
 Kansas Department of Agriculture
 Division of Water Resources
 Field Office for your area.

Call for address:

Topeka -- (785) 296-5733
 Stafford -- (620) 234-5311
 Stockton -- (785) 425-6787
 Garden City -- (620) 276-2901
<http://agriculture.ks.gov/dwr>

DWR FIELD OFFICE APPLICATION FOR APPROVAL TO CHANGE THE PLACE OF USE AND/OR THE POINT OF DIVERSION



STATE OF KANSAS

Filing Fee Must Accompany the Application, K.S.A. 82a-708b(b), as amended.
 Fee Schedule is on the third page of this application form.

Paragraph Nos. 1, 2, 3 & 5 must be completed. Complete all other applicable portions. If change in point of diversion is greater than 100 feet, or if place of use will be changed, include a topographic map or detailed plat showing the authorized and proposed point(s) of diversion and/or place of use.

File No. 30093

RECEIVED
 4:03 PM
 AUG 8 2018

1. Application is hereby made for approval of the Chief Engineer to change the (check one or both):

Place of Use Point of Diversion

Garden City Field Office
 Division of Water Resources

under the water right which is the subject of this application in accordance with the conditions described below.

The source of supply is: Groundwater Surface water

2. Name and address of Applicant: FRANK P DEVINE

PO BOX 489 MEADE KS 67864-0489

Phone Number: (620)873-2765

Email address: _____

Name and address of Water Use Correspondent: FRANK P DEVINE

PO BOX 489 MEADE KS 67864-0489

Phone Number: () _____

Email address: _____

3. The presently authorized place of use is:

Owner of Land ---- NAME: DDD FARMS LLC

ADDRESS: PO BOX 489 MEADE KS 67864-0489

(If there is more than one landowner, attach supplemental sheets as necessary.)

Sec.	Twp.	Range	NE¼				NW¼				SW¼				SE¼				TOTAL ACRES	
			NE¼	NW¼	SW¼	SE¼	NE¼	NW¼	SW¼	SE¼	NE¼	NW¼	SW¼	SE¼	NE¼	NW¼	SW¼	SE¼		

4. If this application is for a change in place of use, it is proposed that the place of use be changed to:

Owner of Land ---- NAME: no change to acres irrigated

ADDRESS: _____

(If there is more than one landowner, attach supplemental sheets as necessary.)

Sec.	Twp.	Range	NE¼				NW¼				SW¼				SE¼				TOTAL ACRES		
			NE¼	NW¼	SW¼	SE¼	NE¼	NW¼	SW¼	SE¼	NE¼	NW¼	SW¼	SE¼	NE¼	NW¼	SW¼	SE¼			

For Office Use Only: Code _____	Fee \$ <u>100</u>	TR # _____	Receipt Date <u>8/8/18</u>	Check # <u>2179</u>
---------------------------------	-------------------	------------	----------------------------	---------------------

5. **Presently authorized point of diversion:**
 One in the se Quarter of the se Quarter of the nw Quarter of Section 4, Township 31 South, Range 27 W, in Meade County, Kansas, 2645 feet North 2681 feet West of Southeast corner of section.
 Authorized Rate _____ Authorized Quantity _____ Depth of well _____ (feet)
 (DWR use only: Computer ID No. 3 GPS _____ feet North _____ feet West)
 This point will not be changed This point will be changed as follows: No change, point better described with GPS as follows:
Proposed point of diversion: (Complete only if change is requested or if existing point is better described by GPS)
 One in the nw Quarter of the nw Quarter of the se Quarter of Section 4, Township 31 South, Range 27 W, in Meade County, Kansas, 2427 feet North 2494 feet West of Southeast corner of section.
 Proposed Rate _____ Proposed Quantity _____ Proposed well depth (feet) 320.
 This point is: Additional Well Geo Center List other water rights that will use this point _____

6. **Presently authorized point of diversion:**
 One in the _____ Quarter of the _____ Quarter of the _____ Quarter of Section _____, Township _____ South, Range _____ (E/W), in _____ County, Kansas, _____ feet North _____ feet West of Southeast corner of section.
 Authorized Rate _____ Authorized Quantity _____ Depth of well _____ (feet)
 (DWR use only: Computer ID No. _____ GPS _____ feet North _____ feet West)
 This point will not be changed This point will be changed as follows: No change, point better described with GPS as follows:
Proposed point of diversion: (Complete only if change is requested or if existing point is better described by GPS)
 One in the _____ Quarter of the _____ Quarter of the _____ Quarter of Section _____, Township _____ South, Range _____ (E/W), in _____ County, Kansas, _____ feet North _____ feet West of Southeast corner of section.
 Proposed Rate _____ Proposed Quantity _____ Proposed well depth (feet) _____.
 This point is: Additional Well Geo Center List other water rights that will use this point _____

7. The changes herein are desired for the following reasons?
 (please be specific) _____
 old well needs to be replaced _____

8. If a well, is the test hole log attached? Yes No

9. The change(s) (was)(will be) completed by?
august 15, 2018

10. If the point of diversion is a well:
 (a) What are you going to do with the old well?
plug
 (b) When will this be done? 2018

11. Groundwater Management District recommendation attached?
 Yes No

12. Assisted by tpm _____

13a. If the proposed point of diversion will be relocated more than 300 feet but within 2,640 feet of the existing point of diversion, attach a topographic map or aerial photograph. For groundwater sources, show all wells (including domestic) within one-half mile of the proposed point of diversion and the names and mailing addresses of the owners. For surface water sources, show the names and addresses of the landowner(s) one-half mile downstream and one-half mile upstream from your property lines

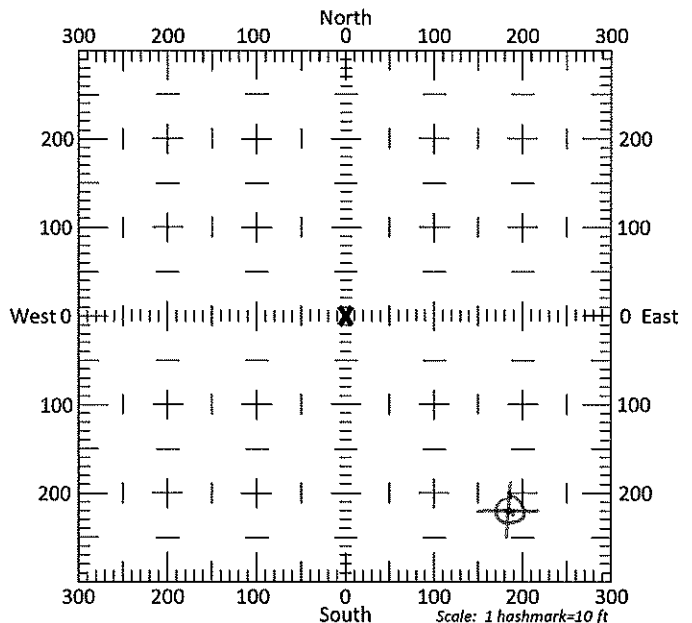

13b. If the proposed point of diversion will be relocated within 300 feet of the existing point of diversion, indicate its location on the diagram shown above in relation to the existing point of diversion. (PLEASE NOTE: The "X" in center of diagram above represents the presently authorized point of diversion.)

14. If the proposed groundwater point of diversion is 300 or fewer feet from the existing point of diversion, complete the following:

- (a) Does the undersigned represent all owners of the currently authorized place(s) of use identified in this application?
 Yes No (If no, all owners must sign this application.)
- (b) Will the ownership interest of any owner of the currently authorized place(s) of use identified in this application be adversely affected if this application is approved as requested?
 Yes No (If yes, all owners must sign this application.)
- (c) If this application is not approved expeditiously, will there be substantial damage to property, public health or safety?
 Yes No (If no, all owners must sign this application.)

If the application proposes a surface water change in point of diversion, a groundwater change in point of diversion greater than 300 feet, or a change in place of use, the application must be signed by all owners of the currently authorized place of use, or their duly authorized agent (attach notarized statement authorizing representation).

I hereby verify, being first duly sworn upon my oath or affirmation and under penalty of perjury, that I am of lawful age and the owner, the spouse of the owner, or a duly authorized agent of the owner(s) to make this application on their behalf, in regards to the water right(s) to which this application pertains. I further verify that the statements contained in this application are true, correct and complete.

Dated at GARDEN CITY, Kansas, this 7th day of AUGUST, 2018.

X Francis F. Derwent
(Owner)

(Spouse)

(Please Print)

(Please Print)

(Owner)

(Spouse)

(Please Print)

(Please Print)

(Owner)

(Spouse)

(Please Print)

(Please Print)

State of Kansas }
County of FINNEY } SS

I hereby certify that the foregoing application was signed in my presence and sworn to before me this 7th day of AUGUST, 2018.



Catherine Reinert
Notary Public

My Commission Expires 9-14-18

ONLY COMPLETE APPLICATIONS WILL BE PROCESSED. To be complete, all of the applicable portions of the application form must be completed with accurate information; maps, if necessary, must be included; signatures of all the appropriate owners' must be affixed to the application and notarized; and the appropriate fee must be paid.

FEE SCHEDULE

Each application to change the place of use or the point of diversion under this section shall be accompanied by the application fee set forth in the schedule below: Make checks payable to: **Kansas Department of Agriculture**

- (1) Application to change a point of diversion 300 feet or less \$100
- (2) Application to change a point of diversion more than 300 feet \$200
- (3) Application to change the place of use \$200

3795 W. Jones Ave.
 Garden City, KS 67846
 PH: 620-277-2389



Hydro
 resources

PO Box 639
 Garden City, KS 67846
 Fax: 620-277-0224

FRANK DEVINE 620-873-2765 CELL 620-338-0468

30913

Customer Name: Frank Devine WO#: 13938 Date: 7-24-18
 Street Address: P.O. Box 489 Test #: 1 E LOG: _____
 City, State: MEADE KS. 67864 Driller: Dale Quinn
 County: Meade Quarter: SE Section: 4 Township: 31 Range: 27
 Location: 173' East & 207' South of Existing Well GPS: N37.37930 W100.26258
 Rig #: 10002 Elevation: 2482' Static WL: 136' well Estimated? RECEIVED
 Proposed Well Depth 320

WELL LOCATION JUL 27 2018

%	Footage		To	Description of Strata	20' SUMM
	From	Pay			
	0		2	Top Soil	
	2		9	Brown Sandy Clay	
	9		17	Gray Sandy Clay	
	17		42	Gray Clay - sticky -	
	42		61	Blue Clay	
	61		68	Brown Clay w/little Caliche Mixed	
	68		74	Light Green Clay w/little Caliche Mixed - sticky -	
	74		85	Light Blue Clay - sticky -	
	85		94	Blue Clay - sticky -	
	94		145	Brown Clay	
35	145	18	163	Sand fine to med course small gravel - Drilled loose & used water -	
15	163	7	170	Sand fine to med course small gravel w/some clay Mixed	
35	170	7	177	Sand fine to med course small gravel - Drilled loose & used water -	
	177		189	Brown Sandy Clay	
5	189	22	211	Fine Sand w/some clay stringers	
15	211	6	217	Sand fine few med	
5	217	38	255	Fine sand w/many clay stringers & few lime rock strips	
20	255	26	281	Fine Sand - Drilled loose -	
35	281	19	300	Sand fine to med course w/brown & tan rock - Drilled loose & used water -	
	300		306	Sandstone	
	306		360	Blue Shale	
				Super Gel X	-2
				Grout	-3
				Bent Plus 3/4	-3
				Perma Plug	-1

Garden City Field Office
 Division of Water Resources

TOPO! map printed on 07/26/18 from "Untitled.tpo"

100.26667° W

NAD27 100.25000° W

100.28333° W

37.38333° N

37.38333° N

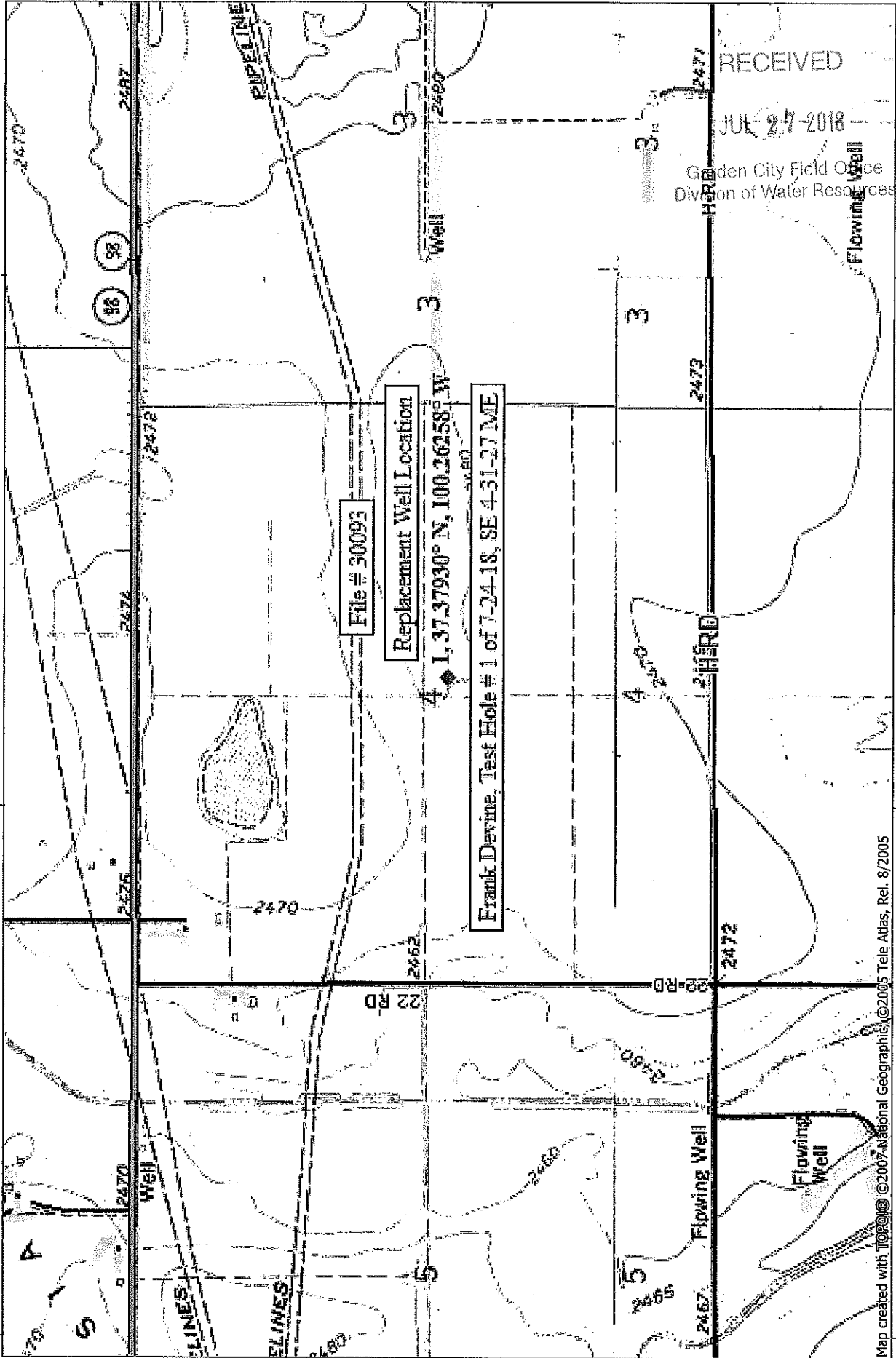

RECEIVED
 JUL 27 2018
 Golden City Field Office
 Division of Water Resources

100.26667° W

NAD27 100.25000° W

100.28333° W

Map created with TOPO! ©2007-National Geographic, ©2005 Tele Atlas, Rel. 8/2005

NATIONAL GEOGRAPHIC

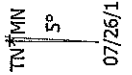
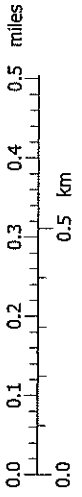

07/26/18

