

DEPARTMENT OF AGRICULTURE
1320 RESEARCH PARK DRIVE
MANHATTAN, KS 66502
PHONE: (785) 564-6700
FAX: (785) 564-6777

STATE OF KANSAS



GOVERNOR JEFF COLYER, M.D.
JACKIE McCLASKEY, SECRETARY OF AGRICULTURE

900 SW JACKSON, ROOM 456
TOPEKA, KS 66612
PHONE: (785) 296-3556
www.agriculture.ks.gov

August 6, 2018

CAROL L SWAYZE
12525 STATE HIGHWAY 34
BUCKLIN KS 67834-8828

RE: Water Right 5784, 9281

Dear Ms. Swayze:

This is to advise you that the Bryan Smith has filed an application for approval of the Chief Engineer, Division of Water Resources, Kansas Department of Agriculture, to change the place of use under the above referenced application.

You are notified on this proposed change in place of use so that you may furnish this office with any comments or other information you may want to submit.

You can find the complete application posted by water right file number as referenced above at www.agriculture.ks.gov/divisions-programs/dwr/water-appropriation/notices Should you have any questions, please feel free to call this office. If you would prefer, an appointment could be arranged for additional assistance. Please refer to the file number when you contact us if you wish to discuss a specific file.

Sincerely,

Thomas P. Makens
Environmental Scientist III

pc: GMD#3

Submit completed application to:
 Kansas Department of Agriculture
 Division of Water Resources
 Field Office for your area.

Call for address:

Topeka -- (785) 296-5733
 Stafford -- (620) 234-5311
 Stockton -- (785) 425-6787
 Garden City -- (620) 276-2901
<http://agriculture.ks.gov/dwr>

DWR FIELD OFFICE APPLICATION FOR APPROVAL TO CHANGE THE PLACE OF USE AND/OR THE POINT OF DIVERSION



STATE OF KANSAS

Filing Fee Must Accompany the Application, K.S.A. 82a-708b(b), as amended.
 Fee Schedule is on the third page of this application form.

Paragraph Nos. 1, 2, 3 & 5 must be completed. Complete all other applicable portions. If change in point of diversion is greater than 100 feet, or if place of use will be changed, include a topographic map or detailed plat showing the authorized and proposed point(s) of diversion and/or place of use.

RECEIVED
 4:54pm
 AUG 6 2018

File No. 5784

Garden City Field Office
 Division of Water Resources

1. Application is hereby made for approval of the Chief Engineer to change the (check one or both):
- Place of Use Point of Diversion
- under the water right which is the subject of this application in accordance with the conditions described below.
- The source of supply is: Groundwater Surface water

2. Name and address of Applicant: J & L SMITH FARMS INC
9170 E ROAD 2, ULYSSES KS 67880-8151
 Phone Number: (620) 353-4018 Email address: Vortex@pld.com
- Name and address of Water Use Correspondent: J & L SMITH FARMS INC
9170 E ROAD 2, ULYSSES KS 67880-8151
 Phone Number: (620) 353-4018 Email address: Vortex@pld.com

3. The presently authorized place of use is:
 Owner of Land ---- NAME: J & L SMITH FARMS INC
 ADDRESS: 9170 E ROAD 2, ULYSSES KS 67880-8151
 (If there is more than one landowner, attach supplemental sheets as necessary.)

| Sec. | Twp. | Range | NE¼ | | | | NW¼ | | | | SW¼ | | | | SE¼ | | | | TOTAL ACRES | | | | |
|------|------|-------|-----|-----|-----|-----|-----|-----|-----|-----|-----|-----|-----|-----|-----|-----|-----|-----|-------------|----|----|----|-----|
| | | | NE¼ | NW¼ | SW¼ | SE¼ | NE¼ | NW¼ | SW¼ | SE¼ | NE¼ | NW¼ | SW¼ | SE¼ | NE¼ | NW¼ | SW¼ | SE¼ | | | | | |
| 18 | 27S | 36W | | | | | | | | | | | | | | | | | 30 | 40 | 40 | 40 | 150 |
| | | | | | | | | | | | | | | | | | | | | | | | |

4. If this application is for a change in place of use, it is proposed that the place of use be changed to:
 Owner of Land ---- NAME: J & L SMITH FARMS INC
 ADDRESS: 9170 E ROAD 2, ULYSSES KS 67880-8151
 (If there is more than one landowner, attach supplemental sheets as necessary.)

| Sec. | Twp. | Range | NE¼ | | | | NW¼ | | | | SW¼ | | | | SE¼ | | | | TOTAL ACRES | | | | |
|------|------|-------|-----|-----|-----|-----|-----|-----|-----|-----|-----|-----|-----|-----|-----|-----|-----|-----|-------------|----|----|----|-----|
| | | | NE¼ | NW¼ | SW¼ | SE¼ | NE¼ | NW¼ | SW¼ | SE¼ | NE¼ | NW¼ | SW¼ | SE¼ | NE¼ | NW¼ | SW¼ | SE¼ | | | | | |
| 18 | 27S | 36W | | | | | | | | | 35 | | | | 35 | | | | 10 | 35 | 35 | 10 | 160 |
| 19 | 27S | 36W | 40 | 40 | 40 | 40 | | | | | | | | | | | | | | | | | 160 |

For Office Use Only: Code _____ Fee \$ 200 TR # _____ Receipt Date 8/6/18 Check # 001777

14. If the proposed groundwater point of diversion is 300 or fewer feet from the existing point of diversion, complete the following:
- (a) Does the undersigned represent all owners of the currently authorized place(s) of use identified in this application?
 Yes No (If no, all owners must sign this application.)
 - (b) Will the ownership interest of any owner of the currently authorized place(s) of use identified in this application be adversely affected if this application is approved as requested?
 Yes No (If yes, all owners must sign this application.)
 - (c) If this application is not approved expeditiously, will there be substantial damage to property, public health or safety?
 Yes No (If no, all owners must sign this application.)

If the application proposes a surface water change in point of diversion, a groundwater change in point of diversion greater than 300 feet, or a change in place of use, the application must be signed by all owners of the currently authorized place of use, or their duly authorized agent (attach notarized statement authorizing representation).

I hereby verify, being first duly sworn upon my oath or affirmation and under penalty of perjury, that I am of lawful age and the owner, the spouse of the owner, or a duly authorized agent of the owner(s) to make this application on their behalf, in regards to the water right(s) to which this application pertains. I further verify that the statements contained in this application are true, correct and complete.

Dated at Ulysses, Kansas, this 30 day of July, 2018.

| | |
|---|---|
| <p>X <u><i>Bryan Smith</i></u> _____ (Owner)</p> <p><u>Bryan Smith</u> _____ (Please Print)</p> <p>_____ (Owner)</p> <p>_____ (Please Print)</p> <p>_____ (Owner)</p> <p>_____ (Please Print)</p> | <p>_____ (Spouse)</p> <p>_____ (Please Print)</p> <p>_____ (Spouse)</p> <p>_____ (Please Print)</p> <p>_____ (Spouse)</p> <p>_____ (Please Print)</p> |
|---|---|

State of Kansas }
 County of Grant } SS

I hereby certify that the foregoing application was signed in my presence and sworn to before me this 30 day of July, 2018.

My Commission Expires 10/13/18

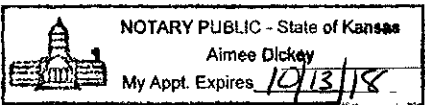

Aimee Dickey

 Notary Public

ONLY COMPLETE APPLICATIONS WILL BE PROCESSED. To be complete, all of the applicable portions of the application form must be completed with accurate information; maps, if necessary, must be included; signatures of all the appropriate owners' must be affixed to the application and notarized; and the appropriate fee must be paid.

FEE SCHEDULE

Each application to change the place of use or the point of diversion under this section shall be accompanied by the application fee set forth in the schedule below: Make checks payable to: **Kansas Department of Agriculture**

- (1) Application to change a point of diversion 300 feet or less \$100
- (2) Application to change a point of diversion more than 300 feet \$200
- (3) Application to change the place of use \$200

Change in Place of Use: WR #5784

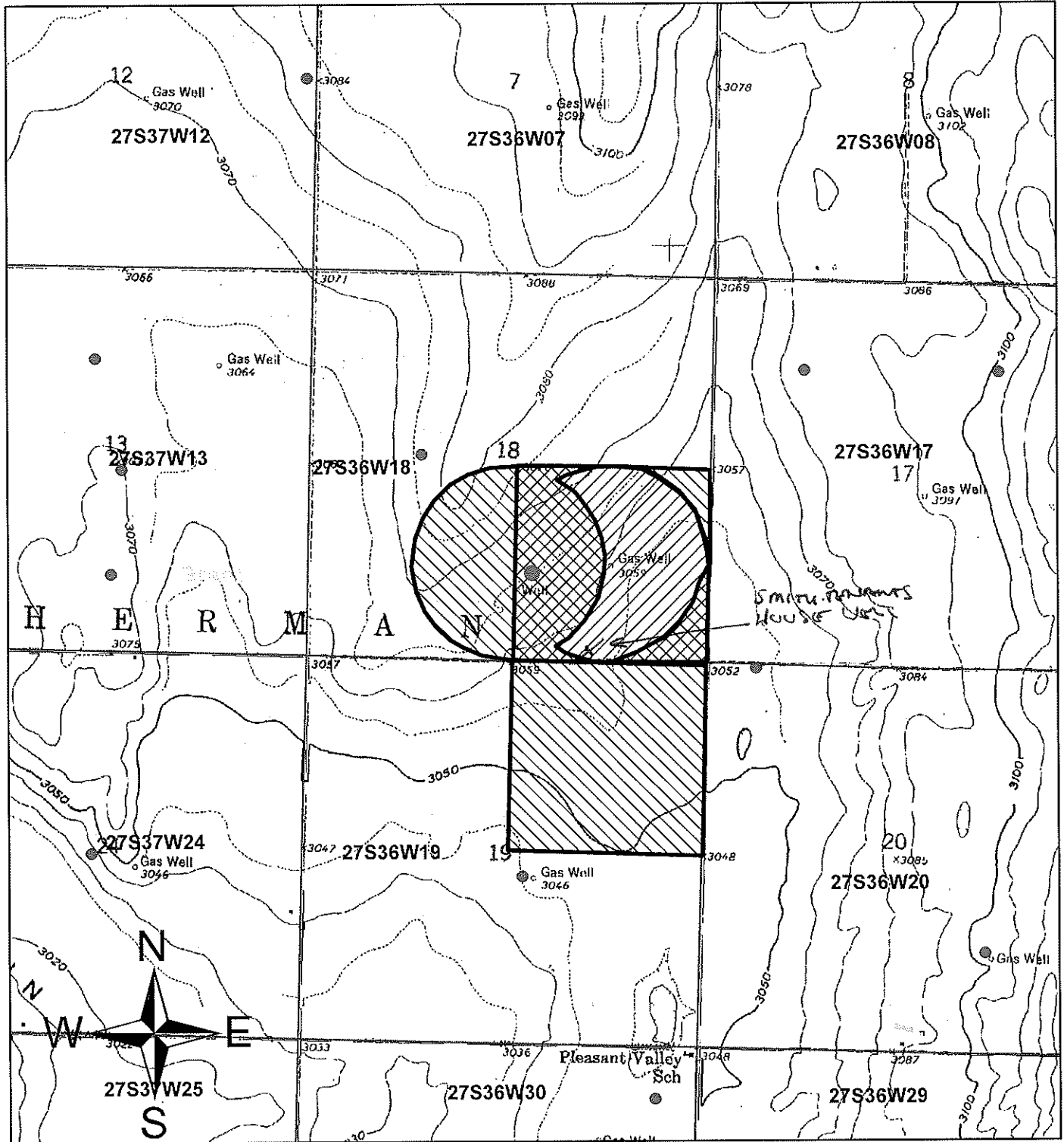

Legend

0 0.125 0.25 0.5 0.75 1 Miles

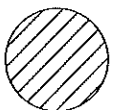

Current Place of Use

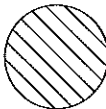

Proposed Place of Use

I agree to the best of my knowledge that all known water wells (IRR, DOM, IND, etc) are shown within green circle(s) on the map. If not, I have edited the map indicating the location of other wells, type, & owner information.

Signature(_____)