

Kansas Department of Agriculture  
 Division of Water Resources  
**CHANGE: P/D WORKSHEET**

1. File Number: <b>22575-D1</b>	2. Status Change Date: <b>7-9-19</b>	3. Change Num: <b>C2</b>	4. Field Office: <b>04</b>	5. GMD: <b>03</b>
------------------------------------	---	-----------------------------	-------------------------------	----------------------

6. Status: <input checked="" type="checkbox"/> Approved <input type="checkbox"/> Denied by DWR/GMD <input type="checkbox"/> Dismiss by Request/Failure to Return	7. Filing Date of Change: <b>7/3/19</b>
--	--

8a. applicant, LANDOWNER New to system <input type="checkbox"/> Person ID <b>64846</b> Add Seq# <b>1</b>  <b>SANDYHILL ENTERPRISES LLC                  JACOB NEUFELD                  10165 W RIVER RD                  HOLCOMB KS 67851</b>	8c. landowner New to system <input checked="" type="checkbox"/> Person ID _____ Add Seq# _____
---	--

8b. Landowner(s), correspondent New to system <input type="checkbox"/> Person ID _____ Add Seq# _____	8d. LANDOWNER New to system <input type="checkbox"/> Person ID _____ Add Seq# _____
---	---

9. Documents and Enclosure(s):  DWR Meter(s) Date to Comply: **12/31/19**     N & P Date to Comply: **12/31/20**

Anti-Reverse Meter     Meter Seal     Check Valve     N & P Form     Water Tube     Driller Copy     H & E Letter  
 Conservation Plan    Date Required: \_\_\_\_\_    Date Approved: \_\_\_\_\_    Date to Comply: \_\_\_\_\_

10. Use Made of Water    From: \_\_\_\_\_    To: \_\_\_\_\_

Date Prepared: **7/8/19**    By: **MAM**  
 Date Entered: **7/29/2019**    By: **LMoody**

File No. <b>22575-D1</b>	11. County: <b>FI</b>	Basin: <b>ARKANSAS RIVER</b>	Stream:	Formation Code: <b>211/331</b>	Special Use:																																																																																																																							
12. Points of Diversion <table border="1" style="width:100%; border-collapse: collapse;"> <thead> <tr> <th rowspan="2">CHK MOD DEL ENT</th> <th rowspan="2">Qualifier</th> <th rowspan="2">S</th> <th rowspan="2">T</th> <th rowspan="2">R</th> <th rowspan="2">ID</th> <th rowspan="2">'N</th> <th rowspan="2">'W</th> <th colspan="4">Rate and Quantity</th> <th rowspan="2">Additional</th> </tr> <tr> <th colspan="2">Authorized</th> <th colspan="2">Additional</th> </tr> <tr> <th></th> <th></th> <th></th> <th></th> <th></th> <th></th> <th></th> <th></th> <th>Rate gpm</th> <th>Quantity af</th> <th>Rate gpm</th> <th>Quantity af</th> <th></th> </tr> </thead> <tbody> <tr> <td><b>ENT 87625</b></td> <td><b>NWSENW</b></td> <td><b>13</b></td> <td><b>26</b></td> <td><b>34W</b></td> <td><b>3921'</b></td> <td><b>3834'</b></td> <td></td> <td><b>1050</b></td> <td><b>272</b></td> <td><b>1050</b></td> <td><b>272</b></td> <td><b>NONE</b></td> </tr> </tbody> </table>						CHK MOD DEL ENT	Qualifier	S	T	R	ID	'N	'W	Rate and Quantity				Additional	Authorized		Additional										Rate gpm	Quantity af	Rate gpm	Quantity af		<b>ENT 87625</b>	<b>NWSENW</b>	<b>13</b>	<b>26</b>	<b>34W</b>	<b>3921'</b>	<b>3834'</b>		<b>1050</b>	<b>272</b>	<b>1050</b>	<b>272</b>	<b>NONE</b>																																																																												
CHK MOD DEL ENT	Qualifier	S	T	R	ID									'N	'W	Rate and Quantity				Additional																																																																																																								
						Authorized		Additional																																																																																																																				
								Rate gpm	Quantity af	Rate gpm	Quantity af																																																																																																																	
<b>ENT 87625</b>	<b>NWSENW</b>	<b>13</b>	<b>26</b>	<b>34W</b>	<b>3921'</b>	<b>3834'</b>		<b>1050</b>	<b>272</b>	<b>1050</b>	<b>272</b>	<b>NONE</b>																																																																																																																
13. Storage: Rate _____ NF _____ Quantity _____ ac/ft Additional Rate _____ NF _____ Additional Quantity _____ ac/ft																																																																																																																												
14. Limitation: _____ af/yr at _____ gpm ( _____ cfs) when combined with file number(s) _____ Limitation: _____ af/yr at _____ gpm ( _____ cfs) when combined with file number(s) _____																																																																																																																												
15. 5YR Allocation: Allocation Type _____ Start Year _____ 5 YR Amount _____ Amount Unit _____ Base Acres _____ Comment _____																																																																																																																												
16. Place of Use <table border="1" style="width:100%; border-collapse: collapse;"> <thead> <tr> <th rowspan="3">CHK MOD DEL ENT</th> <th rowspan="3">PUSE</th> <th rowspan="3">S</th> <th rowspan="3">T</th> <th rowspan="3">R</th> <th rowspan="3">ID</th> <th colspan="3">NE<sup>1</sup>/<sub>4</sub></th> <th colspan="3">NW<sup>1</sup>/<sub>4</sub></th> <th colspan="3">SW<sup>1</sup>/<sub>4</sub></th> <th colspan="3">SE<sup>1</sup>/<sub>4</sub></th> <th rowspan="3">Total</th> <th rowspan="3">Owner</th> <th rowspan="3">Chg?</th> <th rowspan="3">Overlap Files</th> </tr> <tr> <th>NE</th> <th>NW</th> <th>SW</th> <th>NE</th> <th>NW</th> <th>SW</th> <th>NE</th> <th>NW</th> <th>SW</th> <th>NE</th> <th>NW</th> <th>SW</th> </tr> <tr> <th><sup>1</sup>/<sub>4</sub></th> <th><sup>1</sup>/<sub>4</sub></th> <th><sup>1</sup>/<sub>4</sub></th> <th><sup>1</sup>/<sub>4</sub></th> <th><sup>1</sup>/<sub>4</sub></th> <th><sup>1</sup>/<sub>4</sub></th> <th><sup>1</sup>/<sub>4</sub></th> <th><sup>1</sup>/<sub>4</sub></th> <th><sup>1</sup>/<sub>4</sub></th> <th><sup>1</sup>/<sub>4</sub></th> <th><sup>1</sup>/<sub>4</sub></th> <th><sup>1</sup>/<sub>4</sub></th> <th><sup>1</sup>/<sub>4</sub></th> <th><sup>1</sup>/<sub>4</sub></th> </tr> </thead> <tbody> <tr> <td><b>CHK 39318</b></td> <td></td> <td></td> <td></td> <td></td> <td></td> <td></td><td></td><td></td><td></td><td></td><td></td><td></td><td></td><td></td><td></td><td></td><td></td><td></td><td></td><td></td><td></td><td></td> </tr> <tr> <td><b>CHK 34971</b></td> <td></td> <td></td> <td></td> <td></td> <td></td> <td></td><td></td><td></td><td></td><td></td><td></td><td></td><td></td><td></td><td></td><td></td><td></td><td></td><td></td><td></td><td></td><td></td><td></td> </tr> <tr> <td><b>CHK 12984</b></td> <td></td> <td></td> <td></td> <td></td> <td></td> <td></td><td></td><td></td><td></td><td></td><td></td><td></td><td></td><td></td><td></td><td></td><td></td><td></td><td></td><td></td><td></td><td></td><td></td> </tr> </tbody> </table>						CHK MOD DEL ENT	PUSE	S	T	R	ID	NE <sup>1</sup> / <sub>4</sub>			NW <sup>1</sup> / <sub>4</sub>			SW <sup>1</sup> / <sub>4</sub>			SE <sup>1</sup> / <sub>4</sub>			Total	Owner	Chg?	Overlap Files	NE	NW	SW	NE	NW	SW	NE	NW	SW	NE	NW	SW	<sup>1</sup> / <sub>4</sub>	<sup>1</sup> / <sub>4</sub>	<sup>1</sup> / <sub>4</sub>	<sup>1</sup> / <sub>4</sub>	<sup>1</sup> / <sub>4</sub>	<sup>1</sup> / <sub>4</sub>	<sup>1</sup> / <sub>4</sub>	<sup>1</sup> / <sub>4</sub>	<sup>1</sup> / <sub>4</sub>	<sup>1</sup> / <sub>4</sub>	<sup>1</sup> / <sub>4</sub>	<sup>1</sup> / <sub>4</sub>	<sup>1</sup> / <sub>4</sub>	<sup>1</sup> / <sub>4</sub>	<b>CHK 39318</b>																							<b>CHK 34971</b>																								<b>CHK 12984</b>																							
CHK MOD DEL ENT	PUSE	S	T	R	ID							NE <sup>1</sup> / <sub>4</sub>			NW <sup>1</sup> / <sub>4</sub>			SW <sup>1</sup> / <sub>4</sub>			SE <sup>1</sup> / <sub>4</sub>							Total	Owner	Chg?	Overlap Files																																																																																													
												NE	NW	SW	NE	NW	SW	NE	NW	SW	NE	NW	SW																																																																																																					
						<sup>1</sup> / <sub>4</sub>	<sup>1</sup> / <sub>4</sub>	<sup>1</sup> / <sub>4</sub>	<sup>1</sup> / <sub>4</sub>	<sup>1</sup> / <sub>4</sub>	<sup>1</sup> / <sub>4</sub>	<sup>1</sup> / <sub>4</sub>	<sup>1</sup> / <sub>4</sub>	<sup>1</sup> / <sub>4</sub>	<sup>1</sup> / <sub>4</sub>	<sup>1</sup> / <sub>4</sub>	<sup>1</sup> / <sub>4</sub>	<sup>1</sup> / <sub>4</sub>	<sup>1</sup> / <sub>4</sub>																																																																																																									
<b>CHK 39318</b>																																																																																																																												
<b>CHK 34971</b>																																																																																																																												
<b>CHK 12984</b>																																																																																																																												
<b>Base Acres:</b> _____ <b>Year:</b> _____ <b>Minimum Reasonable Quantity:</b> _____ <b>Comments:</b> _____																																																																																																																												



Garden City Field Office  
4532 W. Jones, Suite B  
Garden City, KS 67846

Phone: 620-276-2901  
Fax: 620-276-9315  
www.agriculture.ks.gov

Mike Beam, Secretary

Laura Kelly, Governor

July 9, 2019

SANDYHILL ENTERPRISES LLC  
JACOB NEUFELD  
10165 W RIVER RD  
HOLCOMB KS 67851

RE: Water Right, File Nos. 22575-D1

Dear Sir or Madam:

Enclosed is an order executed by the designee of the Chief Engineer, Division of Water Resources, Kansas Department of Agriculture, approving the application for change under the above referenced file number.

Your attention is directed to the enclosures and to the terms, conditions, and limitations specified in this approval for change. A condition of this approval is that an acceptable water flow meter must be installed on the diversion works authorized under the referenced file number and meet current specifications. Please return the required notification of completion of the diversion works and/or installation of the required meter as soon as these actions are completed.

Since this orders modify the original documents referred to above, it should be recorded with the Register of Deeds as other instruments affecting real estate.

Should you have any questions, please feel free contact this office. If you would prefer, you could arrange an appointment for additional assistance.

Sincerely,

  
Michael A. Meyer  
Water Commissioner

MAM:  
enclosures

pc:  
GROUNDWATER MANAGEMENT DISTRICT NO. 3

**CERTIFICATE OF SERVICE**

On this 9<sup>th</sup> day of July, 2019, I hereby certify that the foregoing Approval of Application for Change in Point of Diversion, Water Right, File No. 22575-D1 dated 9<sup>th</sup> day of July, 2019 was mailed postage prepaid, first class, US mail to the following:

SANDYHILL ENTERPRISES LLC  
JACOB NEUFELD  
10165 W RIVER RD  
HOLCOMB KS 67851

Pc:

GROUNDWATER MANAGEMENT DISTRICT NO. 3



---

Division of Water Resources Staff



Submit completed application to:  
 Kansas Department of Agriculture  
 Division of Water Resources  
 Field Office for your area.

Call for address:

Topeka -- (785) 296-5733  
 Stafford -- (620) 234-5311  
 Stockton -- (785) 425-6787  
 Garden City -- (620) 276-2901  
<http://agriculture.ks.gov/dwr>

## DWR FIELD OFFICE APPLICATION FOR APPROVAL TO CHANGE THE PLACE OF USE AND/OR THE POINT OF DIVERSION



**STATE OF KANSAS**

Filing Fee Must Accompany the Application, K.S.A. 82a-708b(b), as amended.  
 Fee Schedule is on the third page of this application form.

Paragraph Nos. 1, 2, 3 & 5 must be completed. Complete all other applicable portions. If change in point of diversion is greater than 100 feet, or if place of use will be changed, include a topographic map or detailed plat showing the authorized and proposed point(s) of diversion and/or place of use.

File No. 22575-D1 #3

RECEIVED  
 11:55 AM  
 JUL 03 2019

1. Application is hereby made for approval of the Chief Engineer to change the (check one or both):

Place of Use                       Point of Diversion

Garden City Field Office  
 DIVISION OF WATER RESOURCES

under the water right which is the subject of this application in accordance with the conditions described below.

The source of supply is:                       Groundwater                       Surface water

2. Name and address of Applicant: SANDYHILL ENTERPRISES LLC  
JACOB NEUFELD, 10165 W. RIVER ROD, HOLCOMB, KS 67851  
 Phone Number: (     )                      Email address: \_\_\_\_\_  
 Name and address of Water Use Correspondent: SAME AS ABOVE

Phone Number: (     )                      Email address: \_\_\_\_\_

3. The presently authorized place of use is:  
 Owner of Land ---- NAME: SANDYHILL ENTERPRISES LLC  
 ADDRESS: JACOB NEUFELD, 10165 W. RIVER ROD, HOLCOMB, KS 67851  
 (If there is more than one landowner, attach supplemental sheets as necessary.)

Sec.	Twp.	Range	NE¼				NW¼				SW¼				SE¼				TOTAL ACRES
			NE¼	NW¼	SW¼	SE¼	NE¼	NW¼	SW¼	SE¼	NE¼	NW¼	SW¼	SE¼	NE¼	NW¼	SW¼	SE¼	

4. If this application is for a change in place of use, it is proposed that the place of use be changed to:  
 Owner of Land ---- NAME: \_\_\_\_\_  
 ADDRESS: \_\_\_\_\_  
 (If there is more than one landowner, attach supplemental sheets as necessary.)

Sec.	Twp.	Range	NE¼				NW¼				SW¼				SE¼				TOTAL ACRES
			NE¼	NW¼	SW¼	SE¼	NE¼	NW¼	SW¼	SE¼	NE¼	NW¼	SW¼	SE¼	NE¼	NW¼	SW¼	SE¼	

For Office Use Only: Code _____ Fee \$ <u>100.00</u> TR # _____ Receipt Date <u>7-3-19</u> Check # <u>1036</u>
--

5. **Presently authorized point of diversion:**  
 One in the \_\_\_\_\_ Quarter of the NC Quarter of the NW Quarter  
 of Section 13, Township 26 South, Range 34 W,  
 in FINNEY County, Kansas, 3985 feet North 3960 feet West of Southeast corner of section.  
 Authorized Rate \_\_\_\_\_ Authorized Quantity \_\_\_\_\_ Depth of well \_\_\_\_\_ (feet)  
**(DWR use only: Computer ID No. 03 GPS \_\_\_\_\_ feet North \_\_\_\_\_ feet West)**  
 This point will not be changed  This point will be changed as follows:  No change, point better described with GPS as follows:  
**Proposed point of diversion: (Complete only if change is requested or if existing point is better described by GPS)**  
 One in the NW Quarter of the NC SE Quarter of the NW Quarter  
 of Section 13, Township 26 South, Range 34 (E/W)  
 in FINNEY County, Kansas, 3921 feet North 3834 feet West of Southeast corner of section.  
 Proposed Rate \_\_\_\_\_ Proposed Quantity \_\_\_\_\_ Proposed well depth (feet) \_\_\_\_\_  
 This point is:  Additional Well  Geo Center List other water rights that will use this point \_\_\_\_\_

6. **Presently authorized point of diversion:**  
 One in the \_\_\_\_\_ Quarter of the NC Quarter of the NW NE Quarter  
 of Section 13, Township 26 South, Range 34 W,  
 in FINNEY County, Kansas, 3980 feet North 3960 feet West of Southeast corner of section.  
 Authorized Rate \_\_\_\_\_ Authorized Quantity \_\_\_\_\_ Depth of well \_\_\_\_\_ (feet)  
**(DWR use only: Computer ID No. 10 02 GPS \_\_\_\_\_ feet North \_\_\_\_\_ feet West)**  
 This point will not be changed  This point will be changed as follows:  No change, point better described with GPS as follows:  
**Proposed point of diversion: (Complete only if change is requested or if existing point is better described by GPS)**  
 One in the \_\_\_\_\_ Quarter of the \_\_\_\_\_ Quarter of the \_\_\_\_\_ Quarter  
 of Section \_\_\_\_\_, Township \_\_\_\_\_ South, Range \_\_\_\_\_ (E/W),  
 in \_\_\_\_\_ County, Kansas, \_\_\_\_\_ feet North \_\_\_\_\_ feet West of Southeast corner of section.  
 Proposed Rate \_\_\_\_\_ Proposed Quantity \_\_\_\_\_ Proposed well depth (feet) \_\_\_\_\_  
 This point is:  Additional Well  Geo Center List other water rights that will use this point \_\_\_\_\_

7. The changes herein are desired for the following reasons?  
 (please be specific) \_\_\_\_\_  
 \_\_\_\_\_

8. If a well, is the test hole log attached?  Yes  No

9. The change(s) (was)(will be) completed by?  
 \_\_\_\_\_

10. If the point of diversion is a well:  
 (a) What are you going to do with the old well?  
 \_\_\_\_\_  
 (b) When will this be done? \_\_\_\_\_

11. Groundwater Management District recommendation attached?  
 Yes  No

12. Assisted by JLL \_\_\_\_\_

13a. If the proposed point of diversion will be relocated more than 300 feet but within 2,640 feet of the existing point of diversion, attach a topographic map or aerial photograph. For groundwater sources, show all wells (including domestic) within one-half mile of the proposed point of diversion and the names and mailing addresses of the owners. For surface water sources, show the names and addresses of the landowner(s) one-half mile downstream and one-half mile upstream from your property lines

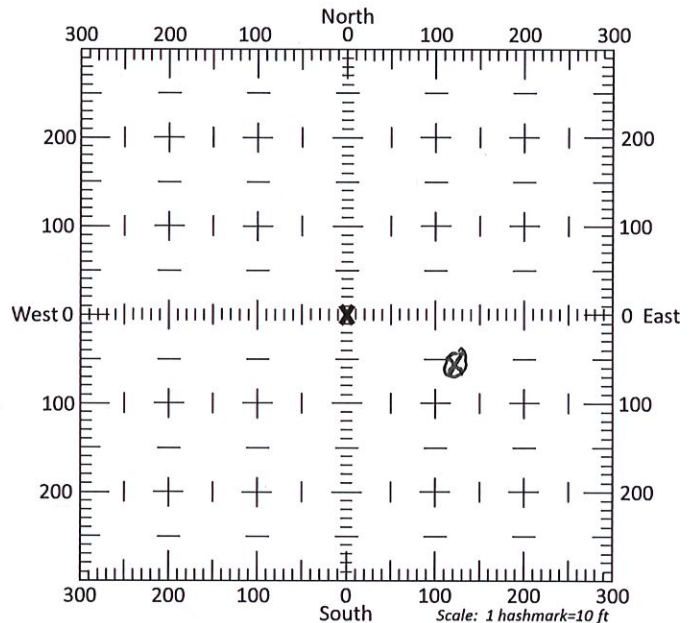

13b. If the proposed point of diversion will be relocated within 300 feet of the existing point of diversion, indicate its location on the diagram shown above in relation to the existing point of diversion. (PLEASE NOTE: The "X" in center of diagram above represents the presently authorized point of diversion.)



APPLICATION FOR APPROVAL TO CHANGE  
THE PLACE OF USE AND/OR POINT OF DIVERSION  
SUPPLEMENTAL SHEET  
FILE NO. 22575-D1

**Presently authorized point of diversion:**  
One in the \_\_\_\_\_ Quarter of the NC Quarter of the SE Quarter  
of Section 12, Township 26 South, Range 34 W,  
in FI County, Kansas, 1345 feet North 1320 feet West of Southeast corner of section.  
Authorized Rate --- Authorized Quantity ---- Depth of well \_\_\_\_\_ (feet)  
**(DWR use only: Computer ID No. 02 GPS \_\_\_\_\_ feet North \_\_\_\_\_ feet West)**  
 This point will not be changed  This point will be changed as follows:  No change, point better described with GPS as follows:  
**Proposed point of diversion: (Complete only if change is requested or if existing point is better described by GPS)**  
One in the \_\_\_\_\_ Quarter of the \_\_\_\_\_ Quarter of the \_\_\_\_\_ Quarter  
of Section \_\_\_\_\_, Township \_\_\_\_\_ South, Range \_\_\_\_\_ (E/W),  
in \_\_\_\_\_ County, Kansas, \_\_\_\_\_ feet North \_\_\_\_\_ feet West of Southeast corner of section.  
Proposed Rate \_\_\_\_\_ Proposed Quantity \_\_\_\_\_ Proposed well depth (feet) \_\_\_\_\_  
This point is:  Additional Well  Geo Center List other water rights that will use this point \_\_\_\_\_

**Presently authorized point of diversion:**  
One in the NW Quarter of the NW Quarter of the SW Quarter  
of Section 12, Township 26 South, Range 34 W,  
in FI County, Kansas, 2395 feet North 4690 feet West of Southeast corner of section.  
Authorized Rate --- Authorized Quantity --- Depth of well \_\_\_\_\_ (feet)  
**(DWR use only: Computer ID No. \_\_\_\_\_ GPS \_\_\_\_\_ feet North \_\_\_\_\_ feet West)**  
 This point will not be changed  This point will be changed as follows:  No change, point better described with GPS as follows:  
**Proposed point of diversion: (Complete only if change is requested or if existing point is better described by GPS)**  
One in the \_\_\_\_\_ Quarter of the \_\_\_\_\_ Quarter of the \_\_\_\_\_ Quarter  
of Section \_\_\_\_\_, Township \_\_\_\_\_ South, Range \_\_\_\_\_ (E/W),  
in \_\_\_\_\_ County, Kansas, \_\_\_\_\_ feet North \_\_\_\_\_ feet West of Southeast corner of section.  
Proposed Rate \_\_\_\_\_ Proposed Quantity \_\_\_\_\_ Proposed well depth (feet) \_\_\_\_\_  
This point is:  Additional Well  Geo Center List other water rights that will use this point \_\_\_\_\_

**Presently authorized point of diversion:**  
One in the \_\_\_\_\_ Quarter of the \_\_\_\_\_ Quarter of the \_\_\_\_\_ Quarter  
of Section \_\_\_\_\_, Township \_\_\_\_\_ South, Range \_\_\_\_\_ (E/W),  
in \_\_\_\_\_ County, Kansas, \_\_\_\_\_ feet North \_\_\_\_\_ feet West of Southeast corner of section.  
Authorized Rate \_\_\_\_\_ Authorized Quantity \_\_\_\_\_ Depth of well \_\_\_\_\_ (feet)  
**(DWR use only: Computer ID No. \_\_\_\_\_ GPS \_\_\_\_\_ feet North \_\_\_\_\_ feet West)**  
 This point will not be changed  This point will be changed as follows:  No change, point better described with GPS as follows:  
**Proposed point of diversion: (Complete only if change is requested or if existing point is better described by GPS)**  
One in the \_\_\_\_\_ Quarter of the \_\_\_\_\_ Quarter of the \_\_\_\_\_ Quarter  
of Section \_\_\_\_\_, Township \_\_\_\_\_ South, Range \_\_\_\_\_ (E/W),  
in \_\_\_\_\_ County, Kansas, \_\_\_\_\_ feet North \_\_\_\_\_ feet West of Southeast corner of section.  
Proposed Rate \_\_\_\_\_ Proposed Quantity \_\_\_\_\_ Proposed well depth (feet) \_\_\_\_\_  
This point is:  Additional Well  Geo Center List other water rights that will use this point \_\_\_\_\_

**Presently authorized point of diversion:**  
One in the \_\_\_\_\_ Quarter of the \_\_\_\_\_ Quarter of the \_\_\_\_\_ Quarter  
of Section \_\_\_\_\_, Township \_\_\_\_\_ South, Range \_\_\_\_\_ (E/W),  
in \_\_\_\_\_ County, Kansas, \_\_\_\_\_ feet North \_\_\_\_\_ feet West of Southeast corner of section.  
Authorized Rate \_\_\_\_\_ Authorized Quantity \_\_\_\_\_ Depth of well \_\_\_\_\_ (feet)  
**(DWR use only: Computer ID No. \_\_\_\_\_ GPS \_\_\_\_\_ feet North \_\_\_\_\_ feet West)**  
 This point will not be changed  This point will be changed as follows:  No change, point better described with GPS as follows:  
**Proposed point of diversion: (Complete only if change is requested or if existing point is better described by GPS)**  
One in the \_\_\_\_\_ Quarter of the \_\_\_\_\_ Quarter of the \_\_\_\_\_ Quarter  
of Section \_\_\_\_\_, Township \_\_\_\_\_ South, Range \_\_\_\_\_ (E/W),  
in \_\_\_\_\_ County, Kansas, \_\_\_\_\_ feet North \_\_\_\_\_ feet West of Southeast corner of section.  
Proposed Rate \_\_\_\_\_ Proposed Quantity \_\_\_\_\_ Proposed well depth (feet) \_\_\_\_\_  
This point is:  Additional Well  Geo Center List other water rights that will use this point \_\_\_\_\_



14. If the proposed groundwater point of diversion is 300 or fewer feet from the existing point of diversion, complete the following:
- (a) Does the undersigned represent all owners of the currently authorized place(s) of use identified in this application?  
 Yes     No    (If no, all owners must sign this application.)
  - (b) Will the ownership interest of any owner of the currently authorized place(s) of use identified in this application be adversely affected if this application is approved as requested?  
 Yes     No    (If yes, all owners must sign this application.)
  - (c) If this application is not approved expeditiously, will there be substantial damage to property, public health or safety?  
 Yes     No    (If no, all owners must sign this application.)

If the application proposes a surface water change in point of diversion, a groundwater change in point of diversion greater than 300 feet, or a change in place of use, the application must be signed by all owners of the currently authorized place of use, or their duly authorized agent (attach notarized statement authorizing representation).

I hereby verify, being first duly sworn upon my oath or affirmation and under penalty of perjury, that I am of lawful age and the owner, the spouse of the owner, or a duly authorized agent of the owner(s) to make this application on their behalf, in regards to the water right(s) to which this application pertains. I further verify that the statements contained in this application are true, correct and complete.

Dated at Warden City, Kansas, this 3<sup>rd</sup> day of July, 2019.

[Signature]  
 \_\_\_\_\_  
 (Owner)

Aganetha Neufeld  
 \_\_\_\_\_  
 (Spouse)

Jacob Neufeld  
 \_\_\_\_\_  
 (Please Print)

Aganetha Neufeld  
 \_\_\_\_\_  
 (Please Print)

\_\_\_\_\_  
 (Owner)

\_\_\_\_\_  
 (Spouse)

\_\_\_\_\_  
 (Please Print)

\_\_\_\_\_  
 (Please Print)

\_\_\_\_\_  
 (Owner)

\_\_\_\_\_  
 (Spouse)

\_\_\_\_\_  
 (Please Print)

\_\_\_\_\_  
 (Please Print)

State of Kansas }  
 County of Finney } SS

I hereby certify that the foregoing application was signed in my presence and sworn to before me this 3<sup>rd</sup> day of July, 2019.



Julie Jones  
 \_\_\_\_\_  
 Notary Public

My Commission Expires \_\_\_\_\_

ONLY COMPLETE APPLICATIONS WILL BE PROCESSED. To be complete, all of the applicable portions of the application form must be completed with accurate information; maps, if necessary, must be included; signatures of all the appropriate owners' must be affixed to the application and notarized; and the appropriate fee must be paid.

**FEE SCHEDULE**

Each application to change the place of use or the point of diversion under this section shall be accompanied by the application fee set forth in the schedule below: Make checks payable to: **Kansas Department of Agriculture**

(1) Application to change a point of diversion 300 feet or less . . . . .	\$100
(2) Application to change a point of diversion more than 300 feet . . . . .	\$200
(3) Application to change the place of use . . . . .	\$200



**SUMMARY ORDER APPROVING APPLICATION FOR CHANGE AND IMPOSING CONDITIONS**

This Summary Order is issued under authority of K.S.A. 82a-708b, as amended, and K.A.R. 5-5-1, *et seq.* and other applicable provisions of the *Kansas Water Appropriation Law, K.S.A. 82a-701 et. seq.*, and rules and regulations promulgated thereunder, With the exception of those conditions expressly contained herein, this Summary Order does not change the terms, conditions and limitations of File No. 22575-D1 #3.

1. A change application was received on 7/2/19 requesting that the place of use and / or point of diversion authorized under the above-referenced file number be changed as described in the application.
2. On and after the effective date of this summary order, the authorized place(s) of use shall be located substantially as shown on the topographic map accompanying the application to change the place of use.  Applicable  Not Applicable
3. The change in point of diversion shall not impair existing rights and shall be limited to the same source or sources of water as previously authorized. The point of diversion authorized by this summary order shall be located within a 50 foot radius of the authorized point(s) of diversion.  Applicable  Not Applicable
4. The point(s) of diversion described herein is administratively corrected to be more accurately described using the Global Positioning System (GPS), as described in the application.  Applicable  Not Applicable
5. The point(s) of diversion authorized herein shall not actually be located more than          feet from the previously authorized point(s) of diversion.  Applicable  Not Applicable
6. As required by K.A.R. 5-3-5d, if the works for diversion is a well with a diversion rate of 100 gallons per minute or more, a tube or other device suitable for making water level measurements shall be installed, operated and maintained in accordance with K.A.R. 5-6-13.  Applicable  Not Applicable
7. **The owner of the authorized place(s) of use shall properly install an acceptable water flow meter on or before December 31, 2019**, or before the first use of water, whichever occurs first. The water flow meter shall be installed, operated and maintained in accordance with K.A.R. 5-1-4 through 5-1-12. As required by K.S.A. 82a-732, as amended, and K.A.R. 5-3-5e, the owner shall maintain records and report the reading of the water flow meter and the total quantity of water diverted annually to the Chief Engineer by March 1 following the end of each calendar year.  
 Applicable  Not Applicable
8. **Installation of the works for diversion of water shall be completed on or before December 31, 2019**, or within any authorized extension of time. By March 1, 2020 the applicant shall notify the Chief Engineer that construction of the works for diversion has been completed, on the form provided by the Chief Engineer, as required by K.A.R. 5-8-4e.  
 Applicable  Not Applicable
9. **The completed well log shall be submitted with the required notice.**  Applicable  Not Applicable
10. All diversion works into which any type of chemical or other foreign substance will be injected into the water shall be equipped with an in-line, automatic, quick-closing check valve capable of preventing pollution of the source of the water supply. The check valve(s) shall be installed, operated and maintained in accordance with K.A.R. 5-3-5c.  Applicable  Not Applicable
11. Additional Conditions are attached.  Yes  No
12. In accordance with K.S.A. 82a-708a, as amended, and K.A.R. 5-5-14, all of the owners of the authorized place(s) of use of water appropriated under the above-referenced file number are responsible for compliance with its terms, conditions and limitations, as amended and/or supplemented by this Summary Order, and with applicable provisions of the *Kansas Water Appropriation Law* and the *Rules and Regulations* promulgated thereunder. Failure to comply with these provisions may result in civil penalties pursuant to K.S.A. 82a-737, as amended, and/or the suspension or revocation and dismissal of the water or appropriation right or any other enforcement actions authorized by law.

**Administrative Appeal and Effective Date of Order**

If you are aggrieved by this order, pursuant to K.S.A. 82a-1901, you may request an evidentiary hearing before the Chief Engineer or request administrative review by the Secretary of Agriculture. A request for hearing by the Chief Engineer must be filed within **15 days** of service of this Order and a request for administrative review by the Secretary must be filed within **30 days** pursuant to K.S.A. 77-531. Any request for administrative review must state a basis for review pursuant to K.S.A. 77-527. File any request with **Kansas Department of Agriculture, Legal Division, 1320 Research Park Drive, Manhattan, KS 66502**. Failure to timely request a hearing or review may preclude review under the Kansas Judicial Review Act.

*For Use by Register of Deeds*

FOR OFFICE USE ONLY  
**APPLICATION APPROVED AND SUMMARY ORDER ISSUED**

By: Michael A. Meyer  
Duly Authorized Designee of the Chief Engineer  
(Print Name): MICHAEL A. MEYER  
Division of Water Resources - Kansas Department of Agriculture

Date of Issuance: July 9, 2019

State of Kansas )  
County of FENNSBY ) SS

Acknowledged before me on 9 July 2019  
by Michael A. Meyer

Signature: [Signature]

My commission expires November 2, 2021  
(Notary Seal)



# WELL LOG

DATE: 6/5/2019

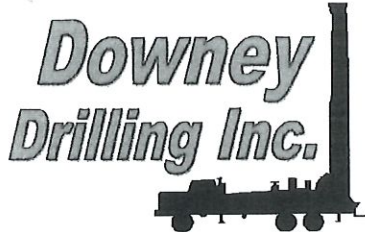

CUSTOMER NAME: JACOB NEUFELD

TEST HOLE #1 G-102

LEGAL: NW 13-26-34W

COUNTY: FINNEY

**SWL - 259'**

GPS: N 37.791131

**G-102  
# 22575 D-1**

W 100.992865

DRILLER: ROCKY

WO: 19-110

TW	FROM	TO	TYPE	HARDNESS	COLOR	SPEED	PULL DOWN	OTHER / DRILLING ACTION
	0	2	TOPSOIL, SILT, SAND	SOFT	BROWN	FAST		
	10	25	SILT, SANDY CLAY	SOFT	BROWN	FAST		
	25	130	COARSE-VERY, VERY, COARSE SAND, F-M-C-VC GRAVEL	SOFT	RED	FAST		CHATTER
	130	141	MED-VVC SAND, FINE-MED GRAVEL	SOFT	RED	FAST		CHATTER
	141	150	SANDY CLAY	SOFT	BROWN	FAST		SMOOTHER
	150	250	MED-VVC SAND, FINE-MED GRAVEL	SOFT	RED	FAST		CHATTER
	250	265	SANDY CLAY	SOFT	BROWN	FAST		SMOOTHER
	265	296	MED-VVC SAND, FINE-MED GRAVEL	SOFT	RED	FAST		CHATTER
	296	308	MED SAND, SANDY CLAY	SOFT	TAN	FAST		
	308	320	FINE - MED SAND	SOFT	TAN	FAST		SLIGHT CHATTER
	320	325	SANDY CLAY	SOFT	BROWN / TAN	FAST		SMOOTH
	325	335	SANDY CLAY, CLAY	SOFT	BROWN	SLOWER		SMOOTH
	335	342	FINE SAND, SANDY CLAY, SOAPSTONE	NOT AS SOFT	BROWN / WHITE	SLOWER		SMOOTH
	342	368	CLAY	STIFFER	BROWN	SLOWER		SMOOTH
	368	405	FINE TR., MED SAND	SOFTER	TAN	FASTER		SLIGHT CHATTER
	405	420	MED, TR. COARSE SAND, SOME FINE GRAVEL	SOFT	TAN	FASTER		CHATTER
	420	440	FINE SAND, SANDY CLAY	NOT AS SOFT	TAN	NOT AS FAST		VERY SLIGHT CH @ TIMES
	440	455	MED SAND, BROWN ROCK	FASTER	BROWN	NOT AS FAST		CHOPPY TO ROUGH AT TIMES
	455	465	BLUE CLAY, FINE SAND, BROWN ROCK LAYERS	SLOWER	BROWN / DARK	NOT AS FAST		CHOPPY TO ROUGH AT TIMES
	465	480	SHALE, BROWN ROCK LAYERS	SAME	BROWN / DARK	SAME		SAME
	480	528	FINE TR. MED SAND, SANDSTONE	SOFTER	LT. TAN	FASTER		SLIGHT CHATTER
	528	541	SANDSTONE	SOFTER	LT. TAN	FASTER		SLIGHT CHATTER
	541	561	FINE SAND, TR. SANDSTONE, W/SHALE LENSES	NOT AS SOFT	LT TAN / DARK	NOT AS FAST		SLIGHT CHATTER @ TIMES
	561	620	BLACK SHALE	STIFFER	DARK	SLOWER		SMOOTH
		7	QUIKGEL					
		25%	SODA ASH					
		2	HOLEPLUG					
		1	CASE SEAL					
		2	EZ MUD GOLD					
		1-1/4	WATER LOADS					



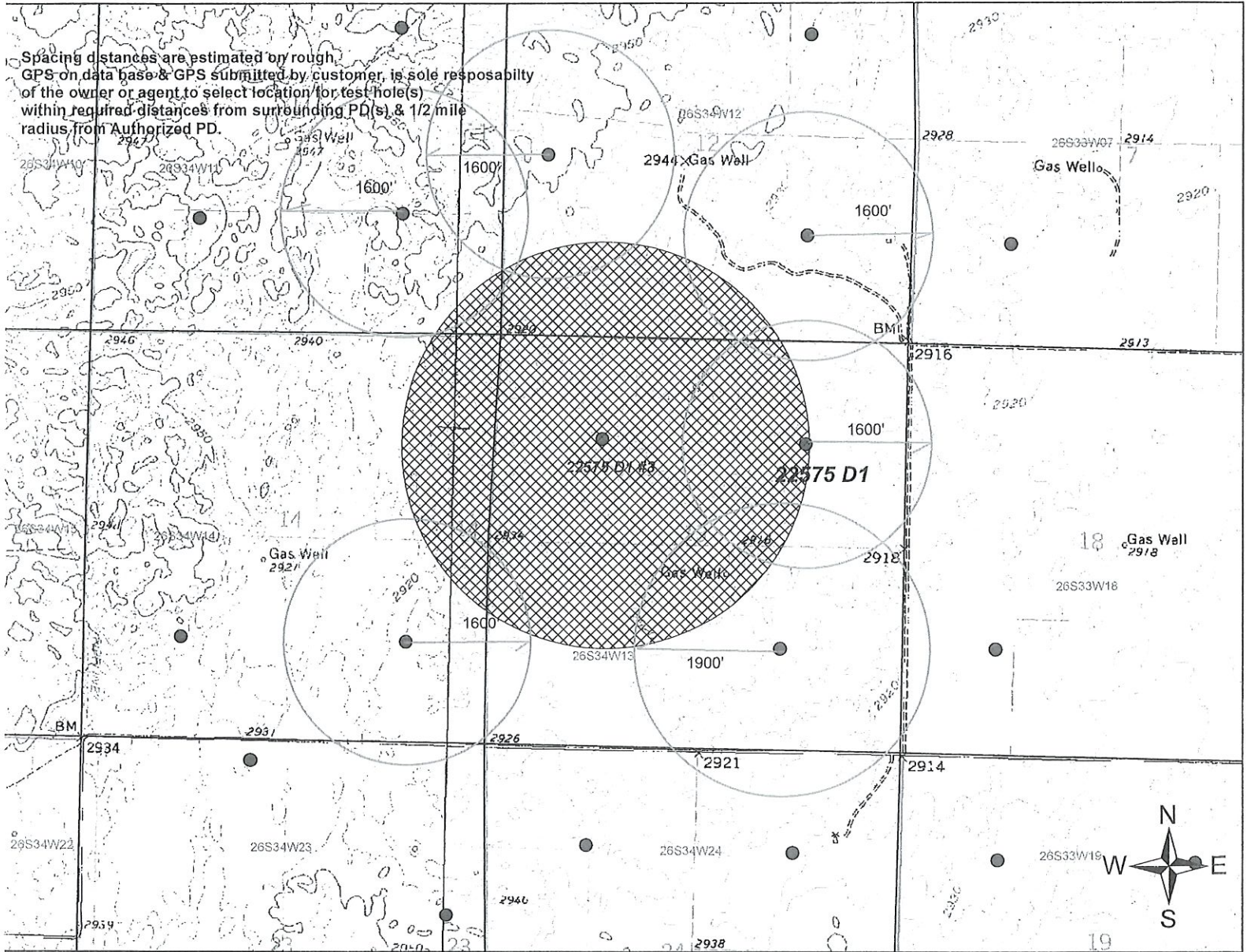

## Spacing Map WR 22575 D1 ID No 3 Section 13 T26 R34W Finney Co.

Spacing distances are estimated by rough GPS on data base & GPS submitted by customer, is sole responsibility of the owner or agent to select location for test hole(s) within required distances from surrounding PD(s) & 1/2 mile radius from Authorized PD.



- Authorized PD
- Requested PD
- Point of Diversion

-  Authorized PU
-  Requested PU

-  Half Mile Radius

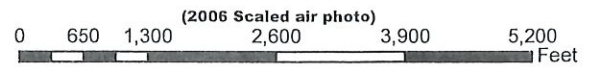

N 37. 7897  
W 100. 9948  
Between  
4 & 5 Spine

Applicant Signature

By signing this map the applicant is aware that no other wells (Irrigation, Domestic, Industrial etc) are within the 1/2 mile radius circle.



**JACOB NEUELD**  
NW 13-26S-34W FINNEY CO.  
#G-102

ORIGINAL WELL 2930'  
TH #1 ELEV=2925'

IRR WELL FILE #16157 ELEV=2927

Legend



W Ty Rd  
2000 ft

Google Earth

© 2018 Google