

Kansas Department of Agriculture
 Division of Water Resources
CHANGE: P/U WORKSHEET

| | | | | |
|---------------------------------|------------------------|-----------------------------|------------------------------|---------------------|
| 1. File Number: 32073 | 2. Status Change Date: | 3. Change Num: C1 | 4. Field Office: 4 | 5. GMD: 3 |
|---------------------------------|------------------------|-----------------------------|------------------------------|---------------------|

| | |
|--|---------------------------|
| 6. Status: <input checked="" type="checkbox"/> Approved <input type="checkbox"/> Denied by DWR/GMD <input type="checkbox"/> Dismiss by Request/Failure to Return | 7. Filing Date of Change: |
|--|---------------------------|

| | |
|--|---|
| 8a. Applicant(s) Person ID 64846 New to system <input type="checkbox"/> Add Seq# _____ SANDYHILL ENTERPRISES LLC JACOB NEUFELD 10165 W RIVER RD HOLCOMB KS 67851 | 8c. Landowner(s) Person ID _____ New to system <input type="checkbox"/> Add Seq# _____ ← New Owner |
|--|---|

| | |
|--|---|
| 8b. Landowner(s) Person ID _____ New to system <input type="checkbox"/> Add Seq# _____ 8a | 8d. WUC Person ID _____ New to system <input type="checkbox"/> Add Seq# _____ 8a |
|--|---|

9. Documents and Enclosure(s): DWR Meter(s) Date to Comply: **12/31/2019** N & P Date to Comply: _____

Anti-Reverse Meter Meter Seal Check Valve N & P Form Water Tube Driller Copy H & E Letter

Conservation Plan Date Required: _____ Date Approved: _____ Date to Comply: _____

10. Use Made of Water From: _____ To: _____

Date Prepared: **6/20/2019** By: **AM**
 Date Entered: _____ By: _____

File No. **32073** 11. County: **GT** Basin: **Arkansas River** Stream: Formation Code: Special Use:

12. Points of Diversion
 Rate and Quantity
 Authorized Additional
 Rate Quantity Rate Quantity
 gpm/cfs af/mgy gpm/cfs af/mgy Overlap PD Files

| CHK | MOD | DEL | ENT | PDIV | Qualifier | S | T | R | ID | 'N | 'W | Comment (AKA Line) | Rate gpm/cfs | Quantity af/mgy | Rate gpm/cfs | Quantity af/mgy | Overlap PD Files |
|------------|-----|-----|-----|------|--------------|---|---|---|----|----|----|--------------------|--------------|-----------------|--------------|-----------------|------------------|
| CHK | | | | | 52043 | | | | | | | | | | | | |

13. Storage: Rate _____ NF Quantity _____ ac/ft Additional Rate _____ NF Additional Quantity _____ ac/ft

14. Limitation: _____ af/yr at _____ gpm (_____ cfs) when combined with file number(s) _____
 Limitation: _____ af/yr at _____ gpm (_____ cfs) when combined with file number(s) _____

15. 5YR Allocation: Allocation Type _____ Start Year _____ 5 YR Amount _____ Amount Unit _____ Base Acres _____ Comment _____

| 16. Place of Use CHK MOD DEL ENT | PUSE | S | T | R | ID | NE¼ | | | | NW¼ | | | | SW¼ | | | | SE¼ | | | | Total | Owner | Chg? | Overlap Files |
|--|--------------|-----------|------------|------------|----------|-----------|-----------|-----------|-----------|-----------|-----------|-----------|-----------|-----------|-----------|-----------|-----------|-----------|-----------|-----------|-----------|------------|-----------|----------|---------------|
| | | | | | | NE ¼ | NW ¼ | SW ¼ | SE ¼ | NE ¼ | NW ¼ | SW ¼ | SE ¼ | NE ¼ | NW ¼ | SW ¼ | SE ¼ | NE ¼ | NW ¼ | SW ¼ | SE ¼ | | | | |
| ENT | 39318 | 12 | 26S | 34W | 1 | | | | | | | | | 34 | 34 | 34 | 34 | 34 | 34 | 34 | 34 | 272 | 8a | N | 32073 |
| ENT | 34971 | 13 | 26S | 34W | 2 | 34 | 34 | 34 | 34 | 34 | 34 | 34 | 34 | | | | | | | | | 272 | 8a | N | 32073 |
| CHK | 12984 | 11 | 26S | 34W | 2 | | | | | | | | | | | | | 40 | 40 | 40 | 40 | 160 | 8a | Y | 32073 |

Base Acres: Year: Minimum Reasonable Quantity:
 Comments:

Garden City Field Office
4532 W. Jones, Suite B
Garden City, KS 67846



Phone: 620-276-2901
Fax: 620-276-9315
www.agriculture.ks.gov

Mike Beam, Secretary

Laura Kelly, Governor

June 20, 2019

SANDYHILL ENTERPRISES LLC
JACOB NEUFELD
10165 W RIVER RD
HOLCOMB KS 67851

RE: Water Right, File Nos. 22575-D1 and 32073

Dear Sir or Madam:

Enclosed are orders executed by the designee of the Chief Engineer, Division of Water Resources, Kansas Department of Agriculture, approving the applications for change under the above referenced file numbers.

Your attention is directed to the enclosures and to the terms, conditions, and limitations specified in these approvals for change. A condition of these approvals are that an acceptable water flow meter must be installed on the diversion works authorized under the referenced file numbers and meet current specifications. Please return the required notification of completion of the diversion works and/or installation of the required meter as soon as these actions are completed.

Since these orders modify the original documents referred to above, they should be recorded with the Register of Deeds as other instruments affecting real estate.

Should you have any questions, please feel free contact this office. If you would prefer, you could arrange an appointment for additional assistance.

Sincerely,

A handwritten signature in blue ink that reads "Austin J. McColloch".

Austin J. McColloch
Assistant Water Commissioner

AM:
enclosures

pc:
GROUNDWATER MANAGEMENT DISTRICT NO. 3

CERTIFICATE OF SERVICE

On this 20th day of June, 2019, I hereby certify that the foregoing Approval of Applications for Change in Place of Use, Water Right, File Nos. 22575-D1 and 32073 dated 20th day of June, 2019 was mailed postage prepaid, first class, US mail to the following:

SANDYHILL ENTERPRISES LLC
JACOB NEUFELD
10165 W RIVER RD
HOLCOMB KS 67851

Pc:

GROUNDWATER MANAGEMENT DISTRICT NO. 3

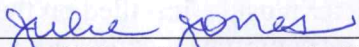

Division of Water Resources Staff

Submit completed application to:
 Kansas Department of Agriculture
 Division of Water Resources
 Field Office for your area.

Call for address:

Topeka -- (785) 296-5733
 Stafford -- (620) 234-5311
 Stockton -- (785) 425-6787
 Garden City -- (620) 276-2901
<http://agriculture.ks.gov/dwr>

DWR FIELD OFFICE APPLICATION FOR APPROVAL TO CHANGE THE PLACE OF USE AND/OR THE POINT OF DIVERSION



STATE OF KANSAS

Filing Fee Must Accompany the Application, K.S.A. 82a-708b(b), as amended.
 Fee Schedule is on the third page of this application form.

Paragraph Nos. 1, 2, 3 & 5 must be completed. Complete all other applicable portions. If change in point of diversion is greater than 100 feet, or if place of use will be changed, include a topographic map or detailed plat showing the authorized and proposed point(s) of diversion and/or place of use.

File No. 32073

RECEIVED
 1:31 pm
 MAY 16 2019

Garden City Field Office
 DIVISION OF WATER RESOURCES

1. Application is hereby made for approval of the Chief Engineer to change the (check one or both):

Place of Use Point of Diversion

under the water right which is the subject of this application in accordance with the conditions described below.

The source of supply is: Groundwater Surface water

2. Name and address of Applicant: SANDYHILL ENTERPRISES LLC - JACOB NEUFELD

10165 W RIVER RD HOLCOMB KS 67851

Phone Number: () _____ Email address: _____

Name and address of Water Use Correspondent: SAME AS ABOVE

Phone Number: () _____ Email address: _____

3. The presently authorized place of use is:

Owner of Land ---- NAME: SAME AS ABOVE

ADDRESS: _____

(If there is more than one landowner, attach supplemental sheets as necessary.)

| Sec. | Twp. | Range | NE¼ | | | | NW¼ | | | | SW¼ | | | | SE¼ | | | | TOTAL ACRES | | | |
|------|------|-------|-----|-----|-----|-----|-----|-----|-----|-----|-----|-----|-----|-----|-----|-----|-----|-----|-------------|----|----|-----|
| | | | NE¼ | NW¼ | SW¼ | SE¼ | NE¼ | NW¼ | SW¼ | SE¼ | NE¼ | NW¼ | SW¼ | SE¼ | NE¼ | NW¼ | SW¼ | SE¼ | | | | |
| 11 | 26S | 34W | | | | | | | | | | | | | | | | 40 | 40 | 40 | 40 | 160 |
| | | | | | | | | | | | | | | | | | | | | | | |

4. If this application is for a change in place of use, it is proposed that the place of use be changed to:

Owner of Land ---- NAME: SAME AS ABOVE

ADDRESS: _____

(If there is more than one landowner, attach supplemental sheets as necessary.)

| Sec. | Twp. | Range | NE¼ | | | | NW¼ | | | | SW¼ | | | | SE¼ | | | | TOTAL ACRES | | | |
|------|------|-------|-----|-----|-----|-----|-----|-----|-----|-----|-----|-----|-----|-----|-----|-----|-----|-----|-------------|----|----|-----|
| | | | NE¼ | NW¼ | SW¼ | SE¼ | NE¼ | NW¼ | SW¼ | SE¼ | NE¼ | NW¼ | SW¼ | SE¼ | NE¼ | NW¼ | SW¼ | SE¼ | | | | |
| 12 | 26S | 34W | | | | | | | | | | | | | | | | 34 | 34 | 34 | 34 | 272 |
| 13 | 26S | 34W | 34 | 34 | 34 | 34 | 34 | 34 | 34 | 34 | 34 | 34 | 34 | 34 | 34 | 34 | 34 | | | | | 272 |
| 11 | 26S | 34W | | | | | | | | | | | | | | | | 40 | 40 | 40 | 40 | 160 |

For Office Use Only: Code _____ Fee \$ 200.00 TR # _____ Receipt Date 5-16-19 Check # 4182

5. **Presently authorized point of diversion:**
 One in the _____ Quarter of the _____ Quarter of the _____ Quarter
 of Section _____, Township _____ South, Range _____ (E/W),
 in _____ County, Kansas, _____ feet North _____ feet West of Southeast corner of section.
 Authorized Rate _____ Authorized Quantity _____ Depth of well _____ (feet)
(DWR use only: Computer ID No. _____ GPS _____ feet North _____ feet West)
 This point will not be changed This point will be changed as follows: No change, point better described with GPS as follows:
Proposed point of diversion: (Complete only if change is requested or if existing point is better described by GPS)
 One in the _____ Quarter of the _____ Quarter of the _____ Quarter
 of Section _____, Township _____ South, Range _____ (E/W),
 in _____ County, Kansas, _____ feet North _____ feet West of Southeast corner of section.
 Proposed Rate _____ Proposed Quantity _____ Proposed well depth (feet) _____
 This point is: Additional Well Geo Center List other water rights that will use this point _____

6. **Presently authorized point of diversion:**
 One in the _____ Quarter of the _____ Quarter of the _____ Quarter
 of Section _____, Township _____ South, Range _____ (E/W),
 in _____ County, Kansas, _____ feet North _____ feet West of Southeast corner of section.
 Authorized Rate _____ Authorized Quantity _____ Depth of well _____ (feet)
(DWR use only: Computer ID No. _____ GPS _____ feet North _____ feet West)
 This point will not be changed This point will be changed as follows: No change, point better described with GPS as follows:
Proposed point of diversion: (Complete only if change is requested or if existing point is better described by GPS)
 One in the _____ Quarter of the _____ Quarter of the _____ Quarter
 of Section _____, Township _____ South, Range _____ (E/W),
 in _____ County, Kansas, _____ feet North _____ feet West of Southeast corner of section.
 Proposed Rate _____ Proposed Quantity _____ Proposed well depth (feet) _____
 This point is: Additional Well Geo Center List other water rights that will use this point _____

7. The changes herein are desired for the following reasons?
 (please be specific) OVERLAP PLACE OF USE

8. If a well, is the test hole log attached? Yes No

9. The change(s) (was)(will be) completed by?
UPON APPROVAL

10. If the point of diversion is a well:
 (a) What are you going to do with the old well?

 (b) When will this be done? _____

11. Groundwater Management District recommendation attached?
 Yes No

12. Assisted by AM/GCFO

13a. If the proposed point of diversion will be relocated more than 300 feet but within 2,640 feet of the existing point of diversion, attach a topographic map or aerial photograph. For groundwater sources, show all wells (including domestic) within one-half mile of the proposed point of diversion and the names and mailing addresses of the owners. For surface water sources, show the names and addresses of the landowner(s) one-half mile downstream and one-half mile upstream from your property lines

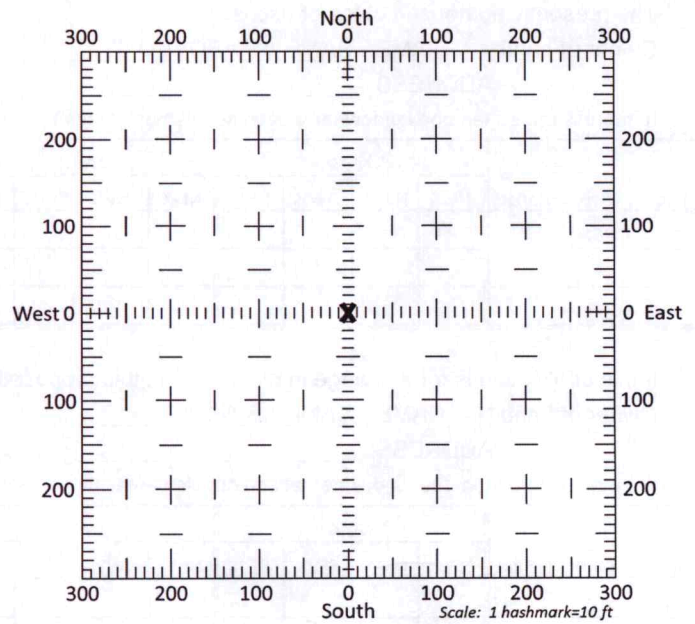

13b. If the proposed point of diversion will be relocated within 300 feet of the existing point of diversion, indicate its location on the diagram shown above in relation to the existing point of diversion. (PLEASE NOTE: The "X" in center of diagram above represents the presently authorized point of diversion.)

14. If the proposed groundwater point of diversion is 300 or fewer feet from the existing point of diversion, complete the following:
- (a) Does the undersigned represent all owners of the currently authorized place(s) of use identified in this application?
 Yes No (If no, all owners must sign this application.)
 - (b) Will the ownership interest of any owner of the currently authorized place(s) of use identified in this application be adversely affected if this application is approved as requested?
 Yes No (If yes, all owners must sign this application.)
 - (c) If this application is not approved expeditiously, will there be substantial damage to property, public health or safety?
 Yes No (If no, all owners must sign this application.)

If the application proposes a surface water change in point of diversion, a groundwater change in point of diversion greater than 300 feet, or a change in place of use, the application must be signed by all owners of the currently authorized place of use, or their duly authorized agent (attach notarized statement authorizing representation).

I hereby verify, being first duly sworn upon my oath or affirmation and under penalty of perjury, that I am of lawful age and the owner, the spouse of the owner, or a duly authorized agent of the owner(s) to make this application on their behalf, in regards to the water right(s) to which this application pertains. I further verify that the statements contained in this application are true, correct and complete.

Dated at Garden City, Kansas, this 16th day of May, 2019.

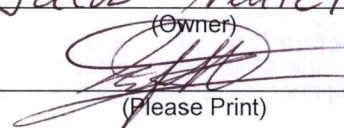
Jacob Newfeld
 (Owner)

 (Please Print)

 (Owner)

 (Please Print)

 (Owner)

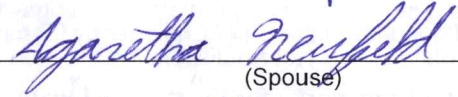
 (Please Print)

Aganetha Newfeld
 (Spouse)

Aganetha Newfeld
 (Please Print)

 (Spouse)

 (Please Print)

 (Spouse)

 (Please Print)

State of Kansas }
 County of Finney } SS

I hereby certify that the foregoing application was signed in my presence and sworn to before me this 16th day of May, 2019.



My Commission Expires _____

Julie Jones
 Notary Public

ONLY COMPLETE APPLICATIONS WILL BE PROCESSED. To be complete, all of the applicable portions of the application form must be completed with accurate information; maps, if necessary, must be included; signatures of all the appropriate owners' must be affixed to the application and notarized; and the appropriate fee must be paid.

FEE SCHEDULE

Each application to change the place of use or the point of diversion under this section shall be accompanied by the application fee set forth in the schedule below: Make checks payable to: **Kansas Department of Agriculture**

- (1) Application to change a point of diversion 300 feet or less \$100
- (2) Application to change a point of diversion more than 300 feet \$200
- (3) Application to change the place of use \$200

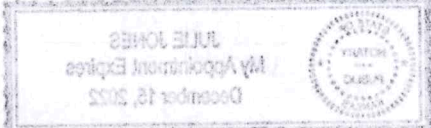

SUMMARY ORDER APPROVING APPLICATION FOR CHANGE AND IMPOSING CONDITIONS

This Summary Order is issued under authority of K.S.A. 82a-708b, as amended, and K.A.R. 5-5-1, *et seq.* and other applicable provisions of the *Kansas Water Appropriation Law, K.S.A. 82a-701 et. seq.*, and rules and regulations promulgated thereunder, With the exception of those conditions expressly contained herein, this Summary Order does not change the terms, conditions and limitations of File No. 32073.

1. A change application was received on May 16, 2019 requesting that the place of use and / or point of diversion authorized under the above-referenced file number be changed as described in the application.
2. On and after the effective date of this summary order, the authorized place(s) of use shall be located substantially as shown on the topographic map accompanying the application to change the place of use. Applicable Not Applicable
3. The change in point of diversion shall not impair existing rights and shall be limited to the same source or sources of water as previously authorized. The point of diversion authorized by this summary order shall be located within a foot radius of the authorized point(s) of diversion. Applicable Not Applicable
4. The point(s) of diversion described herein is administratively corrected to be more accurately described using the Global Positioning System (GPS), as described in the application. Applicable Not Applicable
5. The point(s) of diversion authorized herein shall not actually be located more than feet from the previously authorized point(s) of diversion. Applicable Not Applicable
6. As required by K.A.R. 5-3-5d, if the works for diversion is a well with a diversion rate of 100 gallons per minute or more, a tube or other device suitable for making water level measurements shall be installed, operated and maintained in accordance with K.A.R. 5-6-13. Applicable Not Applicable
7. **The owner of the authorized place(s) of use shall properly install an acceptable water flow meter on or before December 31, 2019**, or before the first use of water, whichever occurs first. The water flow meter shall be installed, operated and maintained in accordance with K.A.R. 5-1-4 through 5-1-12. As required by K.S.A. 82a-732, as amended, and K.A.R. 5-3-5e, the owner shall maintain records and report the reading of the water flow meter and the total quantity of water diverted annually to the Chief Engineer by March 1 following the end of each calendar year.
 Applicable Not Applicable
8. **Installation of the works for diversion of water shall be completed on or before December 31, 20**, or within any authorized extension of time. By March 1, 20 the applicant shall notify the Chief Engineer that construction of the works for diversion has been completed, on the form provided by the Chief Engineer, as required by K.A.R. 5-8-4e.
 Applicable Not Applicable
9. **The completed well log shall be submitted with the required notice.** Applicable Not Applicable
10. All diversion works into which any type of chemical or other foreign substance will be injected into the water shall be equipped with an in-line, automatic, quick-closing check valve capable of preventing pollution of the source of the water supply. The check valve(s) shall be installed, operated and maintained in accordance with K.A.R. 5-3-5c. Applicable Not Applicable
11. Additional Conditions are attached. Yes No
12. In accordance with K.S.A. 82a-708a, as amended, and K.A.R. 5-5-14, all of the owners of the authorized place(s) of use of water appropriated under the above-referenced file number are responsible for compliance with its terms, conditions and limitations, as amended and/or supplemented by this Summary Order, and with applicable provisions of the *Kansas Water Appropriation Law* and the *Rules and Regulations* promulgated thereunder. Failure to comply with these provisions may result in civil penalties pursuant to K.S.A. 82a-737, as amended, and/or the suspension or revocation and dismissal of the water or appropriation right or any other enforcement actions authorized by law.

Administrative Appeal and Effective Date of Order

If you are aggrieved by this order, pursuant to K.S.A. 82a-1901, you may request an evidentiary hearing before the Chief Engineer or request administrative review by the Secretary of Agriculture. A request for hearing by the Chief Engineer must be filed within **15 days** of service of this Order and a request for administrative review by the Secretary must be filed within **30 days** pursuant to K.S.A. 77-531. Any request for administrative review must state a basis for review pursuant to K.S.A. 77-527. File any request with **Kansas Department of Agriculture, Legal Division, 1320 Research Park Drive, Manhattan, KS 66502**. Failure to timely request a hearing or review may preclude review under the Kansas Judicial Review Act.

For Use by Register of Deeds

FOR OFFICE USE ONLY
**APPLICATION APPROVED AND
SUMMARY ORDER ISSUED**

By: Austin McCulloch
Duty Authorized Designee of the Chief Engineer
(Print Name): Austin McCulloch
Division of Water Resources - Kansas Department of Agriculture
Date of Issuance: June 20, 2019
State of Kansas)
County of Winney) SS
Acknowledged before me on June 20, 2019
by Austin McCulloch
Signature: Julie Jones
Notary Public

My commission expires

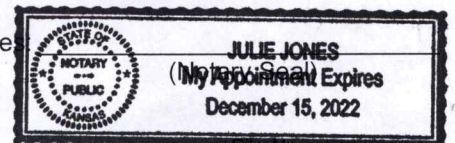

WR FILE NO. 32073 CHANGE IN PLACE OF USE

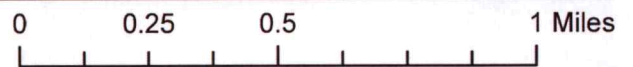
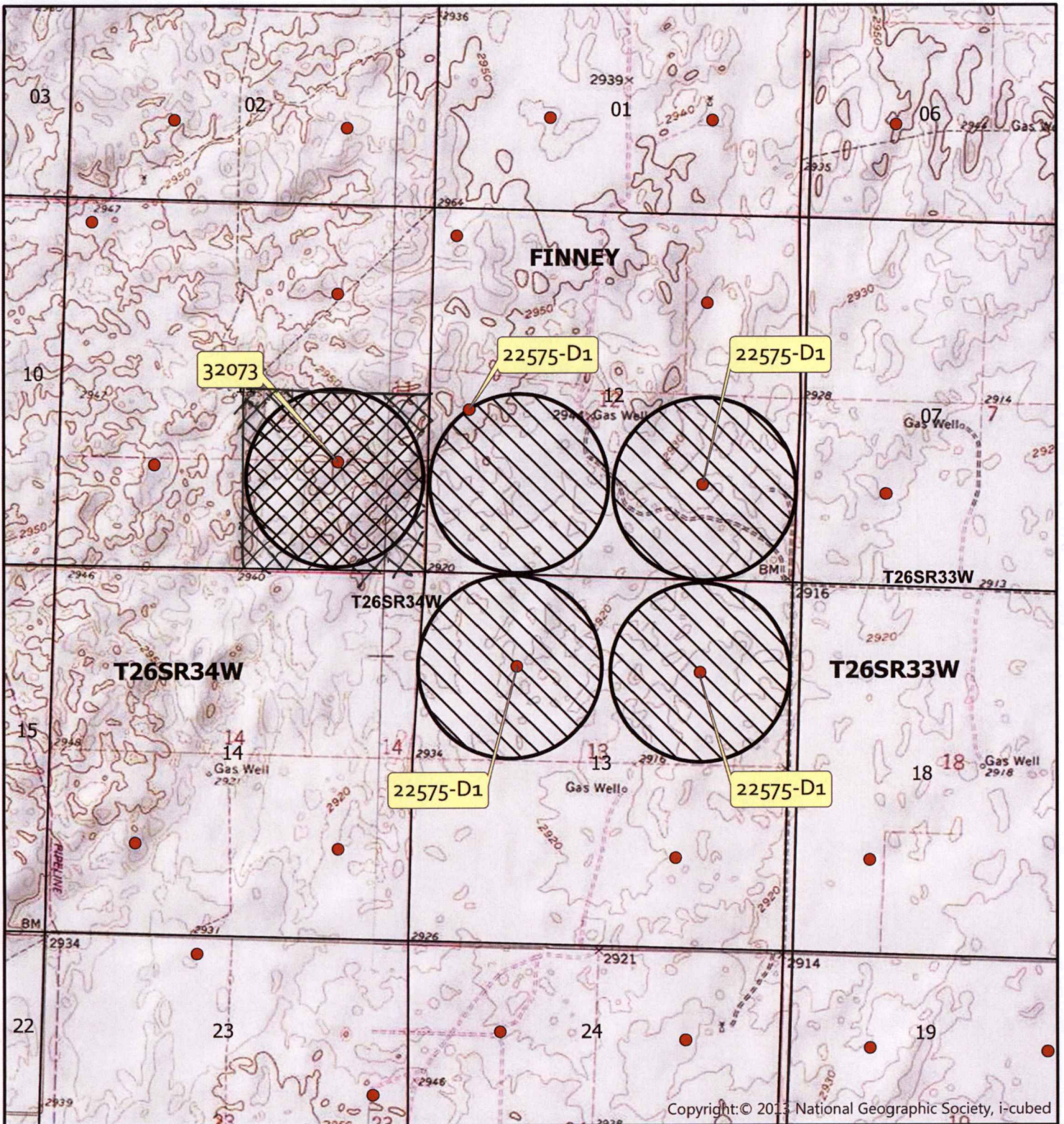

● POINT OF DIVERSION

▨ AUTHORIZED PLACE OF USE

▨ PROPOSED PLACE OF USE



Print Page

These Links May Require Adobe Acrobat Reader, Click [here](#) to Download it.
[View Tax Information](#) --- [View Sketch](#) --- [View Valuation Notice](#) --- [Back to Search Page](#) --- [Home](#)

The Parcel Number for this Property is 028-331-11-2-00-00-001.00-0
Quick Ref ID: 14645

Owner Information

| | |
|-------------------|---|
| Owner Name | SANDYHILL ENTERPRISES LLC |
| Address | 10165 W RIVER RD HOLCOMB, KS 67851-9087 |

Property Situs Address

| | |
|----------------|-------------------------------------|
| Address | SEC 11 26-34, Garden City, KS 67846 |
|----------------|-------------------------------------|

Land Based Classification System

| | |
|------------------|--|
| Function | Farming / ranch land (no improvements) |
| Activity | Farming, plowing, tilling, harvesting, or related activities |
| Ownership | Private-fee simple |
| Site | Dev Site - crops, grazing etc - no structures |

General Property Information

| | |
|-----------------------|----------------------|
| Prop Class | Agricultural Use - A |
| Living Units | |
| Zoning | |
| Neighborhood | 124 |
| Tax Unit Group | 125 |

Property Factors

| | |
|--------------------------|--------------------------|
| Topography | Level - 1 Rolling - 4 |
| Utilities | None - 8 |
| Access | Dirt Road - 3 |
| Fronting | Secondary Street - 3 |
| Location | Neighborhood or Spot - 6 |
| Parking Type | None - 0 |
| Parking Quantity | None - 0 |
| Parking Proximity | Far - 0 |
| Parking Covered | |
| Parking Uncovered | |

2019 Appraised Value

| Class | Land | Building | Total |
|----------------------|--------|----------|--------|
| Agricultural Use - A | 16,140 | 0 | 16,140 |

| | | | |
|-------|--------|---|--------|
| Total | 16,140 | 0 | 16,140 |
|-------|--------|---|--------|

Tract Description

E 1/2, S11, T26, R34W, ACRES 322.31 Deed Book/Page 0269/0399 0269/0398 0074/0924 0074/0923 0074/0922 0029/0160

Deed Information

| Book1 | Page1 | Book2 | Page2 | Book3 | Page3 | Book4 | Page4 |
|-------|-------|-------|-------|-------|-------|-------|-------|
| 338 | 118 | 0269 | 0399 | 0269 | 0398 | 0074 | 0923 |

Agricultural Land

| Ag Type | Ag Acres | Soil Unit | Irr Type | Well Depth | Acre Feet | Acre Ft/Ac | Adj Code | Govt Prog | Base Rate | Adj Rate | Ag Value |
|---------------------|----------|-----------|----------|------------|-----------|------------|----------|-----------|-----------|----------|----------|
| Native Grass - NG | 7.21 | 1985 | | | | 0 | | | 10 | 10 | 70 |
| Irrigated Land - IR | 119.77 | 1982 | C | 400 | 203 | 2 | | | 10 | 13 | 1,560 |
| Irrigated Land - IR | 90.54 | 1982 | C | 300 | 201 | 2 | | | 75 | 98 | 8,870 |
| Irrigated Land - IR | 28.38 | 1985 | C | 300 | 201 | 2 | | | 131 | 172 | 4,880 |
| Native Grass - NG | 76.41 | 1982 | | | | 0 | | | 10 | 10 | 760 |

Ag Land Summary

| | |
|------------------------------|---------|
| Dry Land Acres | 0 |
| Irrigated Acres | 238.69 |
| Native Grass Acres | 83.62 |
| Tame Grass Acres | 0 |
| Total Ag Acres | 322.31 |
| Total Ag Use Value | 16,140 |
| Total Ag Market Value | 726,870 |

These Links May Require Adobe Acrobat Reader, Click [here](#) to Download it.

[View Tax Information](#) --- [View Sketch](#) --- [View Valuation Notice](#) --- [Back to Search Page](#) --- [Home](#)

Parcel Search powered by  THOMSON REUTERS

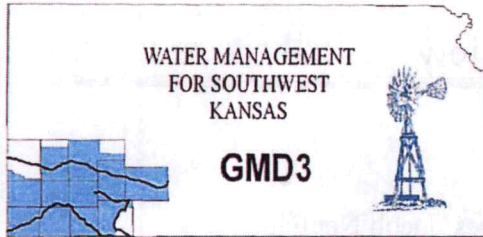

Southwest Kansas
Groundwater Management District No. 3
2009 E. Spruce Street
Garden City, Kansas 67846
(620) 275-7147 phone (620) 275-1431 fax
www.gmd3.org

May 20, 2019

Michael A. Meyer
Division of Water Resources
2508 N Johns Street
Garden City, Kansas 67846

RE: Applications for Change in Place of Use
Water Right, File Nos. 22575 D1 & 32073

Dear Mike:

We have completed a review of the applications for the above referenced water rights. The proposals are not in conflict with the Management Program of the Southwest Kansas Groundwater Management District No. 3 (GMD3). The proposed change in place of use for a complete overlap in irrigation acres is in accordance with K.A.R. 5-5-11(b)(1). It is therefore recommended that the applications be approved at this time.

Thank you for the opportunity to review the applications and to provide a recommendation. If you have any questions, please don't hesitate to contact us.

Sincerely,

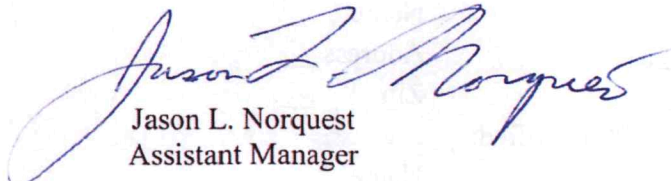

Jason L. Norquest
Assistant Manager

RECEIVED

MAY 21 2019

Garden City Field Office
Division of Water Resources

GMD3 Change Review

File No(s): 22575D1 & 32073 DWR office: GC.

App filed to change: PU.

Is Landowner(s) correct in WRIS: Sandyhill Enterprises, Jacob Neufeld.

If NO, is documentation included?

Is Water Use Correspondent correct in WRIS? Deed with apps for one of the quarters.

If NO, is documentation included?

Regulation(s) Reviewed: KAR 5-5-11

Point of diversion ID No(s) being changed.

| | ft. North | ft. West | | | |
|-------------------|-----------|----------|---|--|--|
| Authorized PD | | | | | |
| Proposed PD | | | | | |
| Difference | 0 | 0 | | | |
| $a^2 + b^2 = c^2$ | 0 | 0 | 0 | | |

GPS for proposed PD: Lat: Long: .

Is proposed PD stacking on existing WRs? .

Is Proposed PU overlapping existing WRs? Proposal to make a complete overlap with all the WRs listed.

Land Owner(s) notified: .

Name . Name .

Address . Address .

Zip . Zip .

Neighboring certified well(s) notified: .

Name . Name .

Address . Address .

Zip . Zip .

Domestic well(s) notified: .

Name . Name .

Address . Address .

Zip . Zip .

Base Acres: .

Perfected Acres: .

Irr. Return-Flow %

All proposed acres are covered by at least one of the WRs and no new acres being proposed.

Is a waiver needed: NO.

Recommendation: The proposal meets the criteria for all current area rules and is not bring in any acres not currently covered by a water right. Staff therefore recommends approval of the application.



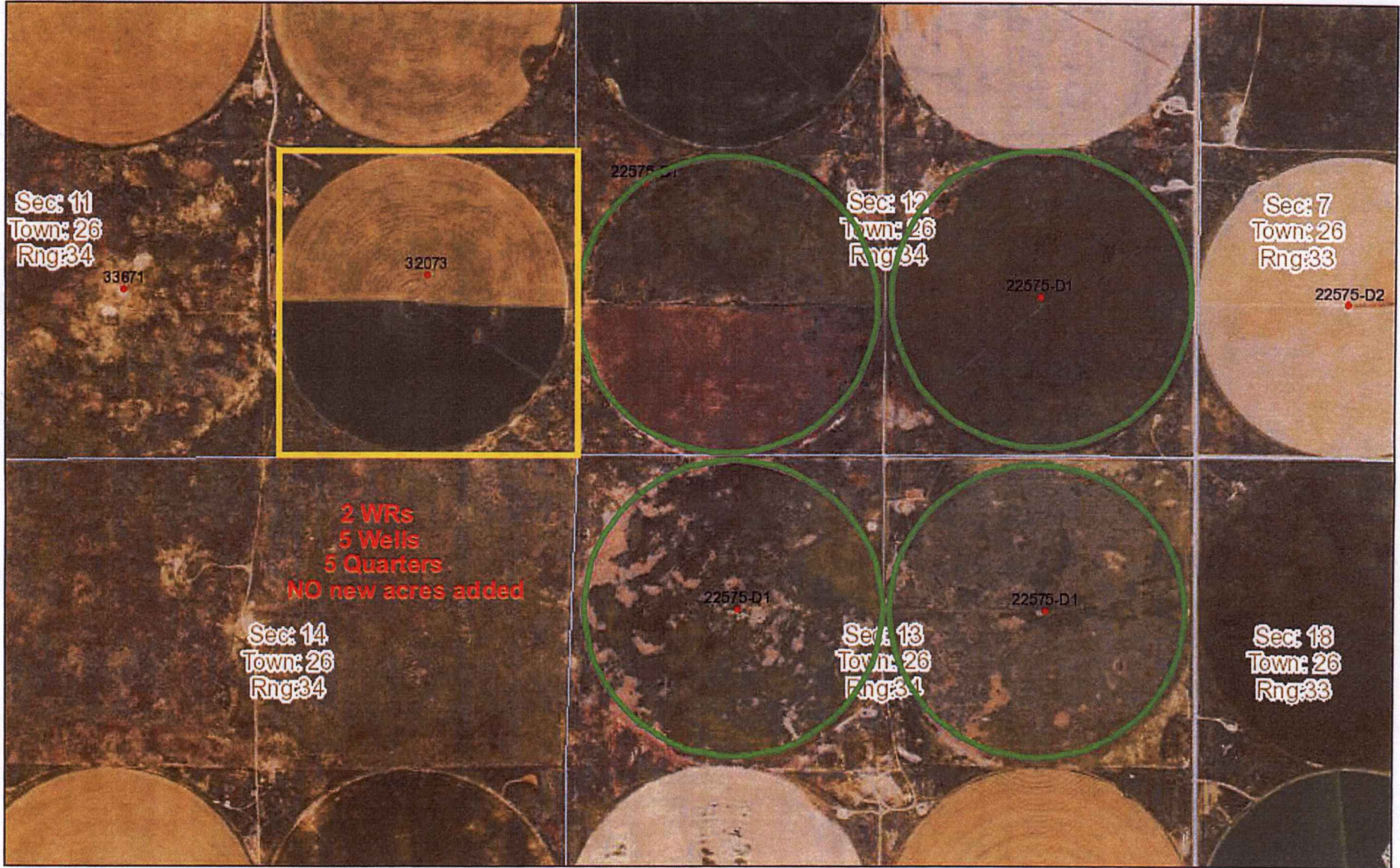

May 20, 2019
15:35 PM

DISCLAIMER: This map is not intended for conveyances, nor is it a legal survey. The information is presented on a best-efforts basis, and should not be relied upon for making financial, survey, legal or other commitments.

| | | | | | | | | |
|--------------|-------|-----|-----|-----|-----|-----|-----|------------|
| Wells | + | CON | ● | FPR | ▲ | MUN | ⚡ | THX |
| ? | Other | ⊠ | DEW | ⊕ | HYD | ⚑ | REC | ? Empty |
| ● | IRR | ⚑ | DOM | ★ | IND | ⊗ | STK | □ Sections |

1:18,056

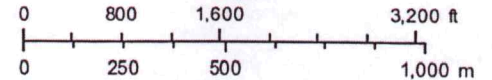

RECEIVED

MAY 21 2019

Garden City Field Office
Division of Water Resources

Garden City Field Office
4532 W. Jones, Suite B
Garden City, KS 67846



Phone: 620-276-2901
Fax: 620-276-9315
www.agriculture.ks.gov

Mike Beam, Secretary

Laura Kelly, Governor

May 20, 2019

SOUTHWEST KANSAS GROUNDWATER
MANAGEMENT DISTRICT NO. 3
409 CAMPUS DRIVE, SUITE 106
GARDEN CITY KS 67846

Re: Water Right File Nos. 22575-D1 & 32073

Dear Mr. Norquest:

This is to advise you that Sandyhill Enterprises LLC-Jacob Neufeld, has filed applications for approval of the Chief Engineer, Division of Water Resources, Kansas Department of Agriculture, to change the place of use for the above referenced files. These applications are proposing a complete overlap among all referenced water rights, with no new land.

We are delaying action on the change applications to allow you time to review and provide a recommendation. Please submit a recommendation within 15 days from the date of this letter.

Thank you and as always feel free to contact this office at any time.

Sincerely,

A handwritten signature in blue ink that reads "Michael A. Meyer". The signature is fluid and cursive, with a long horizontal flourish extending to the right.

Michael A. Meyer
Water Commissioner

MAM
Enclosures