

Kansas Department of Agriculture  
 Division of Water Resources  
**CHANGE: P/U WORKSHEET**

1. File Number: <b>20063</b>	2. Status Change Date: <b>10-7-2020</b>	3. Change Num: <b>C2</b>	4. Field Office: <b>4</b>	5. GMD: <b>3</b>
---------------------------------	--	-----------------------------	------------------------------	---------------------

6. Status: <input checked="" type="checkbox"/> Approved <input type="checkbox"/> Denied by DWR/GMD <input type="checkbox"/> Dismiss by Request/Failure to Return	7. Filing Date of Change: <b>9/28/2020</b>
--	---

8a. Applicant(s) New to system <input type="checkbox"/> Person ID <b>41565</b> Add Seq# _____  <b>LOVE AG COMPANY</b> <b>Attn: GREG LOVE</b> <b>24506 13 RD</b> <b>MONTEZUMA, KS 67867-9073</b>	8c. Landowner(s) New to system <input type="checkbox"/> Person ID _____ Add Seq# _____
--	--

8b. Landowner(s) New to system <input type="checkbox"/> Person ID _____ Add Seq# _____  <b>8a</b>	8d. WUC New to system <input type="checkbox"/> Person ID _____ Add Seq# _____  <b>8a</b>
---	--

9. Documents and Enclosure(s):  DWR Meter(s) Date to Comply: **12/31/2020**     N & P Date to Comply: \_\_\_\_\_

Anti-Reverse Meter     Meter Seal     Check Valve     N & P Form     Water Tube     Driller Copy     H & E Letter  
 Conservation Plan    Date Required: \_\_\_\_\_    Date Approved: \_\_\_\_\_    Date to Comply: \_\_\_\_\_

10. Use Made of Water    From: \_\_\_\_\_    To: \_\_\_\_\_

Date Prepared: **10/6/2020**    By: **AM**  
 Date Entered: \_\_\_\_\_    By: \_\_\_\_\_

File No. **20063**      11. County: **GY**      Basin: **ARKANSAS RIVER**      Stream:      Formation Code: **211**      Special Use:

12. Points of Diversion											Rate and Quantity						
CHK	MOD	DEL	ENT	PDIV	Qualifier	S	T	R	ID	'N	'W	Comment (AKA Line)	Rate gpm	Quantity af	Rate gpm	Quantity af	Overlap PD Files
<b>CHK</b>					<b>88425 SW SW SE</b>	<b>12</b>	<b>27S</b>	<b>29W</b>	<b>3</b>	<b>200</b>	<b>2394</b>		<b>915</b>	<b>199</b>	<b>915</b>	<b>199</b>	<b>NONE</b>

13. Storage: Rate \_\_\_\_\_ NF      Quantity \_\_\_\_\_ ac/ft      Additional Rate \_\_\_\_\_ NF      Additional Quantity \_\_\_\_\_ ac/ft

14. Limitation: \_\_\_\_\_ af/yr at \_\_\_\_\_ gpm ( \_\_\_\_\_ cfs) when combined with file number(s) \_\_\_\_\_  
 Limitation: \_\_\_\_\_ af/yr at \_\_\_\_\_ gpm ( \_\_\_\_\_ cfs) when combined with file number(s) \_\_\_\_\_

15. 5YR Allocation:      Allocation Type \_\_\_\_\_      Start Year \_\_\_\_\_      5 YR Amount \_\_\_\_\_      Amount Unit \_\_\_\_\_      Base Acres \_\_\_\_\_      Comment \_\_\_\_\_

16. Place of Use											NE¼								NW¼				SW¼				SE¼				Total	Owner	Chg?	Overlap Files	
CHK	MOD	DEL	ENT	PUSE	S	T	R	ID	NE ¼	NW ¼	SW ¼	SE ¼	NE ¼	NW ¼	SW ¼	SE ¼	NE ¼	NW ¼	SW ¼	SE ¼	NE ¼	NW ¼	SW ¼	SE ¼	NE ¼	NW ¼	SW ¼	SE ¼							
<b>MOD</b>	<b>18312</b>	<b>7</b>	<b>27S28W</b>	<b>1</b>																															
<b>ENT</b>	<b>33536</b>	<b>12</b>	<b>27S29W</b>	<b>2</b>																															

Base Acres:      Year:      Minimum Reasonable Quantity:  
 Comments:



Garden City Field Office  
4532 W. Jones, Suite B  
Garden City, KS 67846



Phone: 620-276-2901  
Fax: 620-276-9315  
www.agriculture.ks.gov

Mike Beam, Secretary

Laura Kelly, Governor

October 7, 2020

LOVE AG COMPANY  
Attn: GREG LOVE  
24506 13 RD  
MONTEZUMA, KS 67867-9073

RE: Water Right, File No. 20063

Dear Sir or Madam:

Enclosed is the order executed by the designee of the Chief Engineer, Division of Water Resources, Kansas Department of Agriculture, approving the application for change under the above referenced file numbers.

Your attention is directed to the enclosures and to the terms, conditions, and limitations specified in this approval for change. A condition of this approval is that an acceptable water flow meter must be installed on the diversion works authorized under the referenced file number and meet current specifications. Please return the required notification of completion of the diversion works and/or installation of the required meter as soon as these actions are completed.

Since the order modifies the original document referred to above, it should be recorded with the Register of Deeds as other instruments affecting real estate.

Should you have any questions, please feel free contact this office. If you would prefer, you could arrange an appointment for additional assistance.

Sincerely,

A handwritten signature in blue ink that reads "Austin J. McColloch".

Austin J. McColloch  
Assistant Water Commissioner

AM:  
enclosures

pc: GROUNDWATER MANAGEMENT DISTRICT NO. 3

**CERTIFICATE OF SERVICE**

On this 7<sup>th</sup> day of October, 2020, I hereby certify that the foregoing Approval of Application for Change in Place of Use, Water Right, File No. 20063 dated 7<sup>th</sup> day of October, 2020 was mailed postage prepaid, first class, US mail to the following:

LOVE AG COMPANY  
Attn: GREG LOVE  
24506 13 RD  
MONTEZUMA, KS 67867-9073

Pc:

GROUNDWATER MANAGEMENT DISTRICT NO. 3

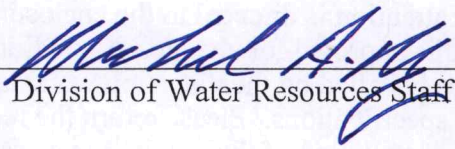
  
Division of Water Resources Staff



Submit completed application to:  
 Kansas Department of Agriculture  
 Division of Water Resources  
 Field Office for your area.

Call for address:

Topeka -- (785) 296-5733  
 Stafford -- (620) 234-5311  
 Stockton -- (785) 425-6787  
 Garden City -- (620) 276-2901  
<http://agriculture.ks.gov/dwr>

## DWR FIELD OFFICE APPLICATION FOR APPROVAL TO CHANGE THE PLACE OF USE AND/OR THE POINT OF DIVERSION



STATE OF KANSAS

Filing Fee Must Accompany the Application, K.S.A. 82a-708b(b), as amended.  
 Fee Schedule is on the third page of this application form.

Paragraph Nos. 1, 2, 3 & 5 must be completed. Complete all other applicable portions. If change in point of diversion is greater than 100 feet, or if place of use will be changed, include a topographic map or detailed plat showing the authorized and proposed point(s) of diversion and/or place of use.

RECEIVED  
 1:24 pm  
 SEP 28 2020

File No. 20063

1. Application is hereby made for approval of the Chief Engineer to change the (check one or both):

Place of Use                       Point of Diversion

Garden City Field Office  
 Division of Water Resources

under the water right which is the subject of this application in accordance with the conditions described below.

The source of supply is:                       Groundwater                       Surface water

2. Name and address of Applicant: LOVE AG. CO.

24506 RD 13 MONTEZUMA, KS. 67867

Phone Number: (    )                      Email address: \_\_\_\_\_

Name and address of Water Use Correspondent: LOVE AG. CO

24506 13 RD. MONTEZUMA, KS. 67867

Phone Number: (    )                      Email address: \_\_\_\_\_

3. The presently authorized place of use is:

Owner of Land ---- NAME: LOVE AG. CO.

ADDRESS: 24506 13 RD. MONTEZUMA, KS. 67867

(If there is more than one landowner, attach supplemental sheets as necessary.)

Sec.	Twp.	Range	NE¼				NW¼				SW¼				SE¼				TOTAL ACRES
			NE¼	NW¼	SW¼	SE¼	NE¼	NW¼	SW¼	SE¼	NE¼	NW¼	SW¼	SE¼	NE¼	NW¼	SW¼	SE¼	
7	27S	28W									34	34	34	34					136

4. If this application is for a change in place of use, it is proposed that the place of use be changed to:

Owner of Land ---- NAME: \_\_\_\_\_

ADDRESS: \_\_\_\_\_

(If there is more than one landowner, attach supplemental sheets as necessary.)

Sec.	Twp.	Range	NE¼				NW¼				SW¼				SE¼				TOTAL ACRES
			NE¼	NW¼	SW¼	SE¼	NE¼	NW¼	SW¼	SE¼	NE¼	NW¼	SW¼	SE¼	NE¼	NW¼	SW¼	SE¼	
7	27S	28W									31.50	31.50	31.50	31.50					136
12	27S	29W									31.50	31.50	31.50	31.50	31.50	31.50	31.50	31.50	252

For Office Use Only: Code \_\_\_\_\_ Fee \$ 200.00 TR # \_\_\_\_\_ Receipt Date 9-28-2020 Check # 3025



5. **Presently authorized point of diversion:**  
 One in the SW Quarter of the SW Quarter of the LOT 4 (SW 34) Quarter of Section 7, Township 27 South, Range 28 (W), in GRAY County, Kansas, 260 feet North 5020 feet West of Southeast corner of section.  
 Authorized Rate 915 GPM Authorized Quantity 199 AF Depth of well \_\_\_\_\_ (feet)  
 (DWR use only: Computer ID No. 6 GPS \_\_\_\_\_ feet North \_\_\_\_\_ feet West)  
 This point will not be changed  This point will be changed as follows:  No change, point better described with GPS as follows:  
**Proposed point of diversion: (Complete only if change is requested or if existing point is better described by GPS)**  
 One in the \_\_\_\_\_ Quarter of the \_\_\_\_\_ Quarter of the \_\_\_\_\_ Quarter of Section \_\_\_\_\_, Township \_\_\_\_\_ South, Range \_\_\_\_\_ (W), in \_\_\_\_\_ County, Kansas, \_\_\_\_\_ feet North \_\_\_\_\_ feet West of Southeast corner of section.  
 Proposed Rate \_\_\_\_\_ Proposed Quantity \_\_\_\_\_ Proposed well depth (feet) \_\_\_\_\_  
 This point is:  Additional Well  Geo Center List other water rights that will use this point \_\_\_\_\_

6. **Presently authorized point of diversion:**  
 One in the \_\_\_\_\_ Quarter of the \_\_\_\_\_ Quarter of the \_\_\_\_\_ Quarter of Section \_\_\_\_\_, Township \_\_\_\_\_ South, Range \_\_\_\_\_ (W), in \_\_\_\_\_ County, Kansas, \_\_\_\_\_ feet North \_\_\_\_\_ feet West of Southeast corner of section.  
 Authorized Rate \_\_\_\_\_ Authorized Quantity \_\_\_\_\_ Depth of well \_\_\_\_\_ (feet)  
 (DWR use only: Computer ID No. \_\_\_\_\_ GPS \_\_\_\_\_ feet North \_\_\_\_\_ feet West)  
 This point will not be changed  This point will be changed as follows:  No change, point better described with GPS as follows:  
**Proposed point of diversion: (Complete only if change is requested or if existing point is better described by GPS)**  
 One in the \_\_\_\_\_ Quarter of the \_\_\_\_\_ Quarter of the \_\_\_\_\_ Quarter of Section \_\_\_\_\_, Township \_\_\_\_\_ South, Range \_\_\_\_\_ (W), in \_\_\_\_\_ County, Kansas, \_\_\_\_\_ feet North \_\_\_\_\_ feet West of Southeast corner of section.  
 Proposed Rate \_\_\_\_\_ Proposed Quantity \_\_\_\_\_ Proposed well depth (feet) \_\_\_\_\_  
 This point is:  Additional Well  Geo Center List other water rights that will use this point \_\_\_\_\_

7. The changes herein are desired for the following reasons?  
 (please be specific) \_\_\_\_\_  
 \_\_\_\_\_

8. If a well, is the test hole log attached?  Yes  No

9. The change(s) (was)(will be) completed by?  
 \_\_\_\_\_

10. If the point of diversion is a well:  
 (a) What are you going to do with the old well?  
 \_\_\_\_\_  
 (b) When will this be done? \_\_\_\_\_

11. Groundwater Management District recommendation attached?  
 Yes  No

12. Assisted by CAC \_\_\_\_\_

13a. If the proposed point of diversion will be relocated more than 300 feet but within 2,640 feet of the existing point of diversion, attach a topographic map or aerial photograph. For groundwater sources, show all wells (including domestic) within one-half mile of the proposed point of diversion and the names and mailing addresses of the owners. For surface water sources, show the names and addresses of the landowner(s) one-half mile downstream and one-half mile upstream from your property lines

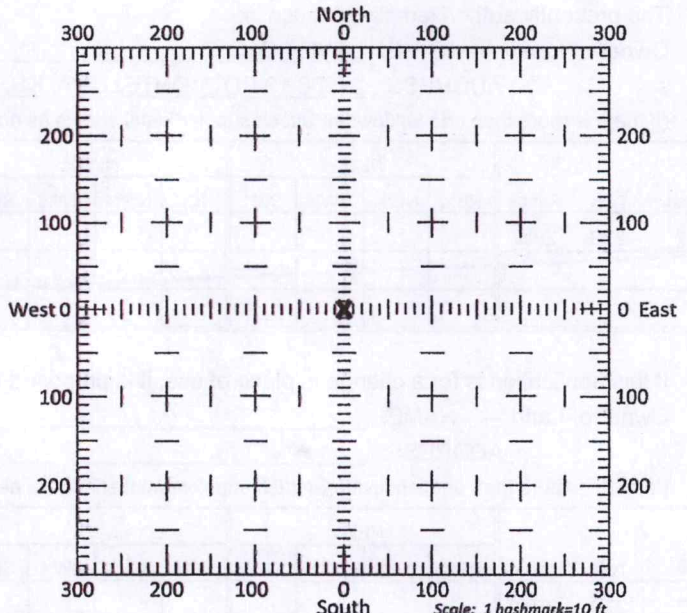

13b. If the proposed point of diversion will be relocated within 300 feet of the existing point of diversion, indicate its location on the diagram shown above in relation to the existing point of diversion. (PLEASE NOTE: The "X" in center of diagram above represents the presently authorized point of diversion.)



14. If the proposed groundwater point of diversion is 300 or fewer feet from the existing point of diversion, complete the following:

- (a) Does the undersigned represent all owners of the currently authorized place(s) of use identified in this application?  
 Yes     No    (If no, all owners must sign this application.)
- (b) Will the ownership interest of any owner of the currently authorized place(s) of use identified in this application be adversely affected if this application is approved as requested?  
 Yes     No    (If yes, all owners must sign this application.)
- (c) If this application is not approved expeditiously, will there be substantial damage to property, public health or safety?  
 Yes     No    (If no, all owners must sign this application.)

If the application proposes a surface water change in point of diversion, a groundwater change in point of diversion greater than 300 feet, or a change in place of use, the application must be signed by all owners of the currently authorized place of use, or their duly authorized agent (attach notarized statement authorizing representation).

I hereby verify, being first duly sworn upon my oath or affirmation and under penalty of perjury, that I am of lawful age and the owner, the spouse of the owner, or a duly authorized agent of the owner(s) to make this application on their behalf, in regards to the water right(s) to which this application pertains. I further verify that the statements contained in this application are true, correct and complete.

Dated at \_\_\_\_\_, Kansas, this \_\_\_\_\_ day of \_\_\_\_\_, 20\_\_\_\_\_.

*[Signature]*  
 \_\_\_\_\_ (Owner) \_\_\_\_\_ (Spouse)  
*Gregory L. Love Love Ag Co.*  
 \_\_\_\_\_ (Please Print) \_\_\_\_\_ (Please Print)  
 \_\_\_\_\_ (Owner) \_\_\_\_\_ (Spouse)  
 \_\_\_\_\_ (Please Print) \_\_\_\_\_ (Please Print)  
 \_\_\_\_\_ (Owner) \_\_\_\_\_ (Spouse)  
 \_\_\_\_\_ (Please Print) \_\_\_\_\_ (Please Print)

State of Kansas }  
County of Gray } SS

I hereby certify that the foregoing application was signed in my presence and sworn to before me this 23 day of September, 2020

 YOLANDA J. BLATTNER  
 Notary Public - State of Kansas  
 My Appt. Exp. 11-14-2020

*[Signature]*  
\_\_\_\_\_  
Notary Public

My Commission Expires 11-14-2020

**ONLY COMPLETE APPLICATIONS WILL BE PROCESSED.** To be complete, all of the applicable portions of the application form must be completed with accurate information; maps, if necessary, must be included; signatures of all the appropriate owners' must be affixed to the application and notarized; and the appropriate fee must be paid.

**FEE SCHEDULE**

Each application to change the place of use or the point of diversion under this section shall be accompanied by the application fee set forth in the schedule below: Make checks payable to: **Kansas Department of Agriculture**

- (1) Application to change a point of diversion 300 feet or less ..... \$100
- (2) Application to change a point of diversion more than 300 feet ..... \$200
- (3) Application to change the place of use ..... \$200

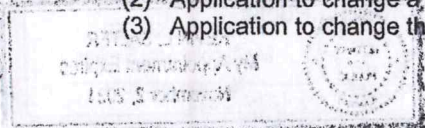



**SUMMARY ORDER APPROVING APPLICATION FOR CHANGE AND IMPOSING CONDITIONS**

This Summary Order is issued under authority of K.S.A. 82a-708b, as amended, and K.A.R. 5-5-1, *et seq.* and other applicable provisions of the *Kansas Water Appropriation Law, K.S.A. 82a-701 et. seq.*, and rules and regulations promulgated thereunder, With the exception of those conditions expressly contained herein, this Summary Order does not change the terms, conditions and limitations of File No. 20063.

1. A change application was received on September 28, 2020 requesting that the place of use and / or point of diversion authorized under the above-referenced file number be changed as described in the application.
2. On and after the effective date of this summary order, the authorized place(s) of use shall be located substantially as shown on the topographic map accompanying the application to change the place of use.  Applicable  Not Applicable
3. The change in point of diversion shall not impair existing rights and shall be limited to the same source or sources of water as previously authorized. The point of diversion authorized by this summary order shall be located within a \_\_\_\_\_ foot radius of the authorized point(s) of diversion.  Applicable  Not Applicable
4. The point(s) of diversion described herein is administratively corrected to be more accurately described using the Global Positioning System (GPS), as described in the application.  Applicable  Not Applicable
5. The point(s) of diversion authorized herein shall not actually be located more than \_\_\_\_\_ feet from the previously authorized point(s) of diversion.  Applicable  Not Applicable
6. As required by K.A.R. 5-3-5d, if the works for diversion is a well with a diversion rate of 100 gallons per minute or more, a tube or other device suitable for making water level measurements shall be installed, operated and maintained in accordance with K.A.R. 5-6-13.  Applicable  Not Applicable
7. The owner of the authorized place(s) of use shall properly install an acceptable water flow meter on or before December 31, 2020, or before the first use of water, whichever occurs first. The water flow meter shall be installed, operated and maintained in accordance with K.A.R. 5-1-4 through 5-1-12. As required by K.S.A. 82a-732, as amended, and K.A.R. 5-3-5e, the owner shall maintain records and report the reading of the water flow meter and the total quantity of water diverted annually to the Chief Engineer by March 1 following the end of each calendar year.  
 Applicable  Not Applicable
8. Installation of the works for diversion of water shall be completed on or before December 31, 20\_\_, or within any authorized extension of time. By March 1, 20\_\_ the applicant shall notify the Chief Engineer that construction of the works for diversion has been completed, on the form provided by the Chief Engineer, as required by K.A.R. 5-8-4e.  
 Applicable  Not Applicable
9. The completed well log shall be submitted with the required notice.  Applicable  Not Applicable
10. All diversion works into which any type of chemical or other foreign substance will be injected into the water shall be equipped with an in-line, automatic, quick-closing check valve capable of preventing pollution of the source of the water supply. The check valve(s) shall be installed, operated and maintained in accordance with K.A.R. 5-3-5c.  Applicable  Not Applicable
11. Additional Conditions are attached.  Yes  No
12. In accordance with K.S.A. 82a-708a, as amended, and K.A.R. 5-5-14, all of the owners of the authorized place(s) of use of water appropriated under the above-referenced file number are responsible for compliance with its terms, conditions and limitations, as amended and/or supplemented by this Summary Order, and with applicable provisions of the *Kansas Water Appropriation Law* and the *Rules and Regulations* promulgated thereunder. Failure to comply with these provisions may result in civil penalties pursuant to K.S.A. 82a-737, as amended, and/or the suspension or revocation and dismissal of the water or appropriation right or any other enforcement actions authorized by law.

**Administrative Appeal and Effective Date of Order**

If you are aggrieved by this order, pursuant to K.S.A. 82a-1901, you may request an evidentiary hearing before the Chief Engineer or request administrative review by the Secretary of Agriculture. A request for hearing by the Chief Engineer must be filed within **15 days** of service of this Order and a request for administrative review by the Secretary must be filed within **30 days** pursuant to K.S.A. 77-531. Any request for administrative review must state a basis for review pursuant to K.S.A. 77-527. File any request with **Kansas Department of Agriculture, Legal Division, 1320 Research Park Drive, Manhattan, KS 66502**. Failure to timely request a hearing or review may preclude review under the Kansas Judicial Review Act.

*For Use by Register of Deeds*

FOR OFFICE USE ONLY  
**APPLICATION APPROVED AND  
SUMMARY ORDER ISSUED**

By: Austin McColloch  
Duly Authorized Designee of the Chief Engineer

(Print Name): Austin McColloch  
Division of Water Resources - Kansas Department of Agriculture

Date of Issuance: October 7, 2020

State of Kansas \_\_\_\_\_ )

County of FINNEY ) SS

Acknowledged before me on 7 October 2020

by AUSTIN MCCOLLOCH

Signature: [Signature]

My commission expires: \_\_\_\_\_





**Place of Use Change  
WR 20063  
T27 R28W Section 7  
Gray Co.**

Spacing distances are estimated on rough GPS on data base and or GPS submitted by customer, is sole responsibility of the owner or agent to select location for test hole(s) within required distances from surrounding PD(s) & 1/2 mile radius from Authorized PD.

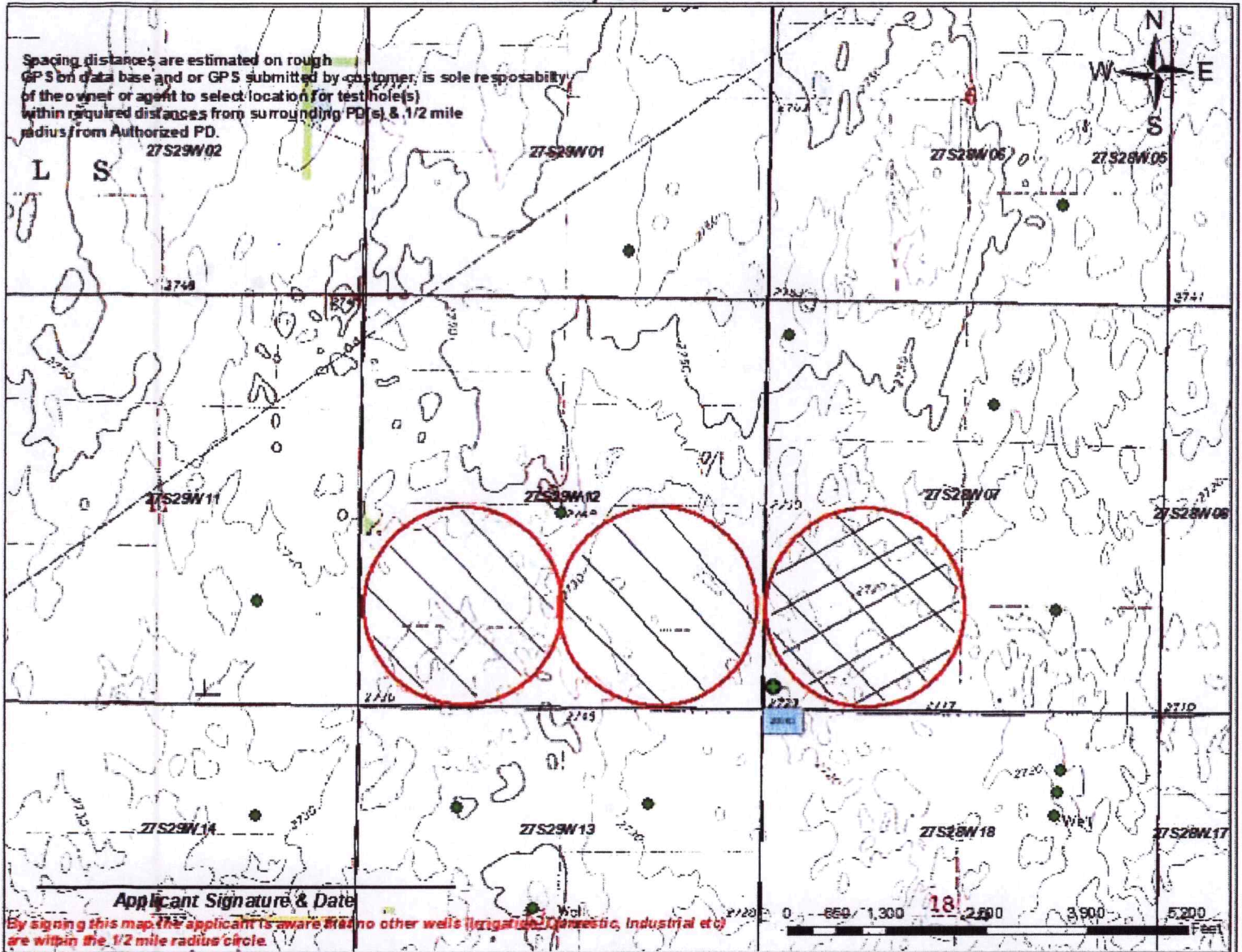

**Applicant Signature & Date**

By signing this map the applicant is aware that no other wells (irrigation, domestic, industrial etc) are within the 1/2 mile radius circle.

- Authorized PD
- Requested PD
- Point of Diversion
- ⊗ Half Mile Radius
- Active Water Right w/in 1/2 mile
- + domestic well w/in 1/2 mile

**Water Right w/in 1/2 mile & Owner(if apply)**  
● #1 Water Right No

**Domestic well w/in 1/2 mile & Owner (if apply)**  
+ A - Domestic well

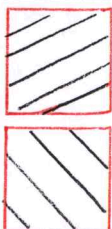

Authorized PU

Requested PU



## McColloch, Austin [KDA]

---

**From:** Garrett Love <garrett.t.love@gmail.com>  
**Sent:** Friday, October 2, 2020 3:26 PM  
**To:** Greg and Sue Love; McColloch, Austin [KDA]  
**Subject:** Re: FW: Change Place of Use 20063

**EXTERNAL:** This email originated from outside of the organization. Do not click any links or open any attachments unless you trust the sender and know the content is safe.

Yes, if they're supposed to be 126 acres and not 136 acres, then that's fine with us. Thanks!

On Fri, Oct 2, 2020 at 2:36 PM McColloch, Austin [KDA] <[Austin.McColloch@ks.gov](mailto:Austin.McColloch@ks.gov)> wrote:

Garrett,

I tried reaching out to Greg. Can you confirm approval of the amendment. We need the place of use to match in the SW¼ of 7-27-28.



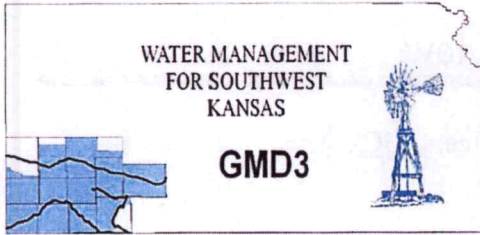

**Southwest Kansas**  
**Groundwater Management District No. 3**  
2009 E. Spruce Street  
Garden City, Kansas 67846  
(620) 275-7147 phone (620) 275-1431 fax  
www.gmd3.org

September 29, 2020

Michael A. Meyer  
Division of Water Resources  
4532 W Jones Ave., Suite B  
Garden City, Kansas 67846

RE: Application for Change in Place of Use  
Water Right, File No. 20063

Dear Mike:

We have assisted with the application for the above referenced water right. The proposal is not in conflict with the Management Program of the Southwest Kansas Groundwater Management District No. 3 (GMD3). The proposed change in place of use will make a complete overlap in acres, with water right 14550, to better suit the operation and is in accordance with K.A.R. 5-5-11. No new acres are being proposed. It is therefore recommended that the applications be approved at this time.

Thank you for the opportunity to review the applications and to provide a recommendation. If you have any questions, please don't hesitate to contact us.

Sincerely,



Jason L. Norquest  
Assistant Manager



## GMD3 Change Review

---

File No(s): 20063.

DWR office: GC.

App filed to change: PU.

Is Landowner(s) correct in WRIS: Love Ag.

If NO, is documentation included?

Is Water Use Correspondent correct in WRIS?    .

If NO, is documentation included?

Regulation(s) Reviewed: KAR 5-5-11

Point of diversion ID No(s)     being changed.

	ft. North	ft. West			
Authorized PD					
Proposed PD					
Difference	0	0			
a2 + b2 = c2	0	0	0		

GPS for proposed PD: Lat:     Long:    .

Is proposed PD stacking on existing WRs? No Change.

Is Proposed PU overlapping existing WRs? Overlap 14550.

Neighboring certified well(s) notified:    .

Name    .

Address    .

Zip    .

Email:     Phone:    .

Domestic well(s) notified:    .

Name    .

Address    .

Zip    .

Base Acres:    .

Perfected Acres:    .

Irr. Return-Flow    %

**14550 currently authorizes the SW & SW of sect.12 and SW sect.7 while 20063 only authorizes the SW of sect 7.**

**This application will authorize 20063 on the quarters in sect 12 and make a complete overlap with 14550.**

**No new acres are proposed with this change.**

Is a waiver needed: No new acres and will make a complete overlap, which prior was incomplete.

Recommendation: After review of all available information, it appears current area rules are met. Staff therefore recommends approval of the application.

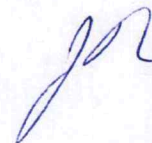



## Meyer, Mike [KDA]

---

**From:** Meyer, Mike [KDA]  
**Sent:** Monday, September 28, 2020 1:54 PM  
**To:** 'Norquest, Jason (Norquest@gmd3.org)'  
**Subject:** 20063 request for recommendation  
**Attachments:** 20200928133634375.pdf

jason

hopefully you are up from your nap

please see the attached proposed place of use application to make the required complete overlap with file no. 14550 this will allow them to legally pump file no. 20063 to section 12.

please note that we have approved the change in point of diversion for File No. 20063, and dismissed the pending application for point of diversion for File No. 14550 we did not require an observation well, but Mr. Love agreed to voluntarily drill an observation well if he wants other applications evaluated with site specific data.

please review the application and provide a recommendation within 15 days.  
(sorry for the scanned application being out of order) thank you

Mike

-----Original Message-----

From: kda.fax@ks.gov <kda.fax@ks.gov>  
Sent: Monday, September 28, 2020 1:37 PM  
To: Meyer, Mike [KDA] <Mike.Meyer@ks.gov>  
Subject: Message from "GardenCity-Savin-Color"

This E-mail was sent from "GardenCity-Savin-Color" (MP C3004ex).

Scan Date: 09.28.2020 13:36:34 (-0500)  
Queries to: kda.fax@ks.gov

This E-Mail was sent from the Kansas Department of Agriculture.

Garden City Field Office  
4532 W. Jones, Suite B  
Garden City, KS 67846



Phone: 620-276-2901  
Fax: 620-276-9315  
www.agriculture.ks.gov

Mike Beam, Secretary

Laura Kelly, Governor

September 28, 2020

SOUTHWEST KANSAS GROUNDWATER  
MANAGEMENT DISTRICT NO. 3  
2009 E SPRUCE ST  
GARDEN CITY KS 67846

Re: Water Right, File No. 20063

Dear Mr. Norquest:

This is to advise you that Love Ag Co, has filed an application for approval of the Chief Engineer, Division of Water Resources, Kansas Department of Agriculture, to change the place of use for the above referenced file. The application is overlapping the same place of use as File No. 14550

We are delaying action on the change applications to allow you time to review and provide a recommendation. Please submit a recommendation within 15 days from the date of this letter.

Thank you and as always feel free to contact this office at any time.

Sincerely,

  
Michael A. Meyer  
Water Commissioner

MAM  
Enclosures