

NOTICE

This scan only represents the application as filed. The information contained herein meets the requirements of K.A.R. 5-3-1 or K.A.R. 5-5-1, and has been found acceptable for filing in the office of the Chief Engineer. The application should not be considered to be a complete application as per K.A.R. 5-3-1b or K.A.R. 5-5-2a.

20209037

Water Resources

Submit To: CHIEF ENGINEER
Division of Water Resources
Kansas Department of Agriculture
1320 Research Park Drive
Manhattan, Kansas 66502
http://agriculture.ks.gov/dwr

APPLICATION FOR TERM PERMIT

Received

- GROUNDWATER
SURFACE WATER
(check one)

APR 06 2020

2:25
KS Dept Of Agriculture



State of Kansas

STATUTORY FILING FEE MUST ACCOMPANY THIS APPLICATION
(Make check payable to the Kansas Department of Agriculture)

1. Applicant: (Please print or type)

Name TOM RIDDER
Street 411 E COUNTY RD 11, LEOTI KS 67861
City and State LEOTI, KS
Zip Code 67861 Telephone No. (620) 874-0447
E-Mail Address tomridder65@gmail.com
Social Security I.D. No.
and/or Taxpayer I.D. No.

2. Location of Point of Diversion:

Sec. 35, Twp. 18, Rng. 35, W,
Wichita County, Kansas.
Distance from Southeast Corner of Section:
5222 feet North from Southeast Corner
4959 feet West from Southeast Corner
NOTE: If point of diversion is not site specific (i.e. groundwater pit) show the approximate geographic center.

3. Water Use Data:

Proposed Max. Pumping Rate (gpm) 500
Amount Requested (acre-feet) 240 (0 additional)
per calendar year
Depth of Well (feet)
Date (completed) (will be completed)
Drainage Basin Whitewoman Creek
Name of Stream

4. Water is to be used for (briefly describe proposed use and explain the rate and quantity requested):

To allow additional authority (acres) for the pivot located in the NW 1/4 of 35-18-35W. division agreements and change applications are in process, this allows temporary authority until those documents are finalized to authorize the acres.

5. Location of place of use:

Pivot NW 1/4 35-18-35W (south half of pivot needs authority)

6. Period of use:

Commencing date: April 2020
Ending Date: Dec. 31 2020 Also enter on Item 12

If off-stream pit, check here

Will pit floor intersect water table? Yes No

7. Location of the proposed point of diversion and those of other water users within 1/2 mile shall be indicated on the diagram to the lower-left, scale 1 inch = 2,000 feet. If surface water, indicate on the diagram the course of the stream, and its name. List other D.W.R. permit numbers that cover the requested point(s) of diversion or place of use here:

Pd overlap w/ 7190

Pu w/ 7190 & WH 003

FEE SCHEDULE

1. The filing fee for an application is based on the maximum amount of water use proposed within a year. Except for storage, the fee is:

Table with 2 columns: Acre-feet, Fee. Rows: 0-100 (\$200.00), 101-320 (\$300.00), More than 320 (\$300.00)

plus \$20 for each additional 100 acre-feet or any part thereof.

2. The fee for an application in which storage is requested, is:

Table with 2 columns: Acre-feet, Fee. Rows: 0-250 (\$200.00), More than 250 (\$200.00)

plus \$20.00 for each additional 250 acre-feet of storage or any part thereof.

NOTE: If an application requests both direct use and storage, the fee charged shall be as determined under No. 1 or No. 2 above, whichever is greater, but not both fees.

3. A request for an extension of time to extend the term of a term permit shall be accompanied by a fee of \$100.00.

4. There is a separate application form for domestic use. Do not use this form for domestic use.

CONVERSION FACTORS

1 acre-foot equals 325,851 gallons
1 million gallons equal 3.07 acre-feet

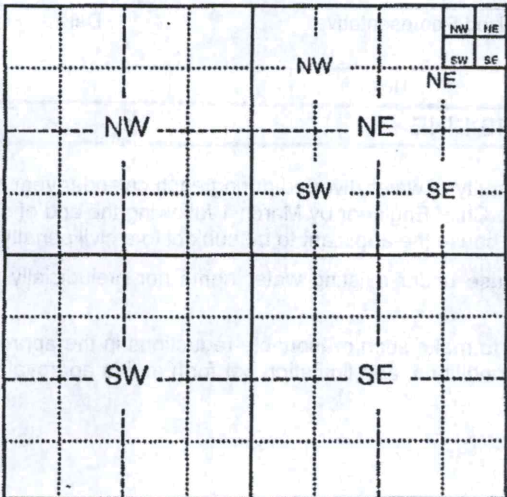

4/9/2020
LMoody

Assisted by

For Office Use Only:

F.O. 4 GMD 3 Meets K.A.R. 5-3-1 (YES / NO) Use IRR Source G/S County Stevens By BMM Date 4/7/20
Code TR2 Fee \$300 TR # Receipt Date 4/9/2020 Check # 9476

Water Resources
Received

APR 06 2020

KS Dept Of Agriculture

8. For groundwater use, list below all wells within 1/2 mile of the proposed well, and plot locations upon the diagram on reverse side. If additional space is needed, attach a map.

Other wells -

Well A Owner(s): Gary Graff
Address: 368 south county road 23, marienthal ks 67863

Well B Owner(s): _____
Address: _____

9. For surface water use, list below the names and addresses of all landowners from a point 1/2 mile upstream to a point 1/2 mile downstream of the tract of land upon which the point of diversion is located. If additional space is needed, attach sheet.

Tract A Owner(s): _____
Address: _____

Tract B Owner(s): _____
Address: _____

10. The owner of the point of diversion, if other than the applicant is (please print):
Fairchild Farms LLC. 10625 West Farm Road, Republic, MO 65738
(name, address and telephone number)

You must provide evidence of legal access to, or control of, the point of diversion from the landowner or the landowner's authorized representative. Provide a copy of a recorded deed, lease, easement or other document with this application. In lieu thereof, you may sign the following sworn statement:

I have legal access to, or control of, the point of diversion described in this application from the landowner or the landowner's authorized representative. I declare under penalty of perjury that the foregoing is true and correct.

Executed on 04-02, 2020. _____
Applicant's Signature

The applicant must provide the required information or signature irrespective of whether they are the landowner. Failure to complete this portion of the application will cause it to be unacceptable for filing and the application will be returned to the applicant.

- 11. The applicant states that the information set hereon is true and accurate to the best of his/her knowledge.
- 12. The applicant agrees to waive any right to a hearing on the matter of abandonment of this appropriation right and further agrees that this appropriation right may be dismissed and terminated upon completion of the proposed project, said dismissal date to be on December 31, 2020 or within any extension of time authorized by the Chief Engineer, Division of Water Resources, Kansas Department of Agriculture.
- 13. The applicant agrees to provide water to nearby water users, at no charge to said users, should their rights to use water become impaired by the project proposed by this application.
- 14. Water use contact person (in event emergency contact is needed):

Name: Thomas Alan Ridder Telephone No. (620) 874 0447

Signature of Applicant or _____ Authorized Representative Date 04-02-2020

Thomas Alan Ridder
Applicant's Name Printed Title

DO NOT WRITE BELOW THIS LINE

CONDITIONS OF APPROVAL:

The applicant shall maintain accurate and complete records from which the quantity of water diverted during each calendar year may be readily determined. Accurate and complete records shall be furnished to the Chief Engineer by March 1 following the end of each calendar year. Failure to file the annual water use report by the due date, shall cause the applicant to be subject to a civil penalty.

The use of water herein authorized shall not be made so as to impair any use under existing water rights nor prejudicially and unreasonably affect the public interest.

The Chief Engineer specifically retains jurisdiction in this matter with authority to make such reasonable reductions in the approved rate of diversion and quantity authorized, and such changes in other terms, conditions, and limitation set forth in this approval and permit to proceed as may be deemed to be in the public interest.

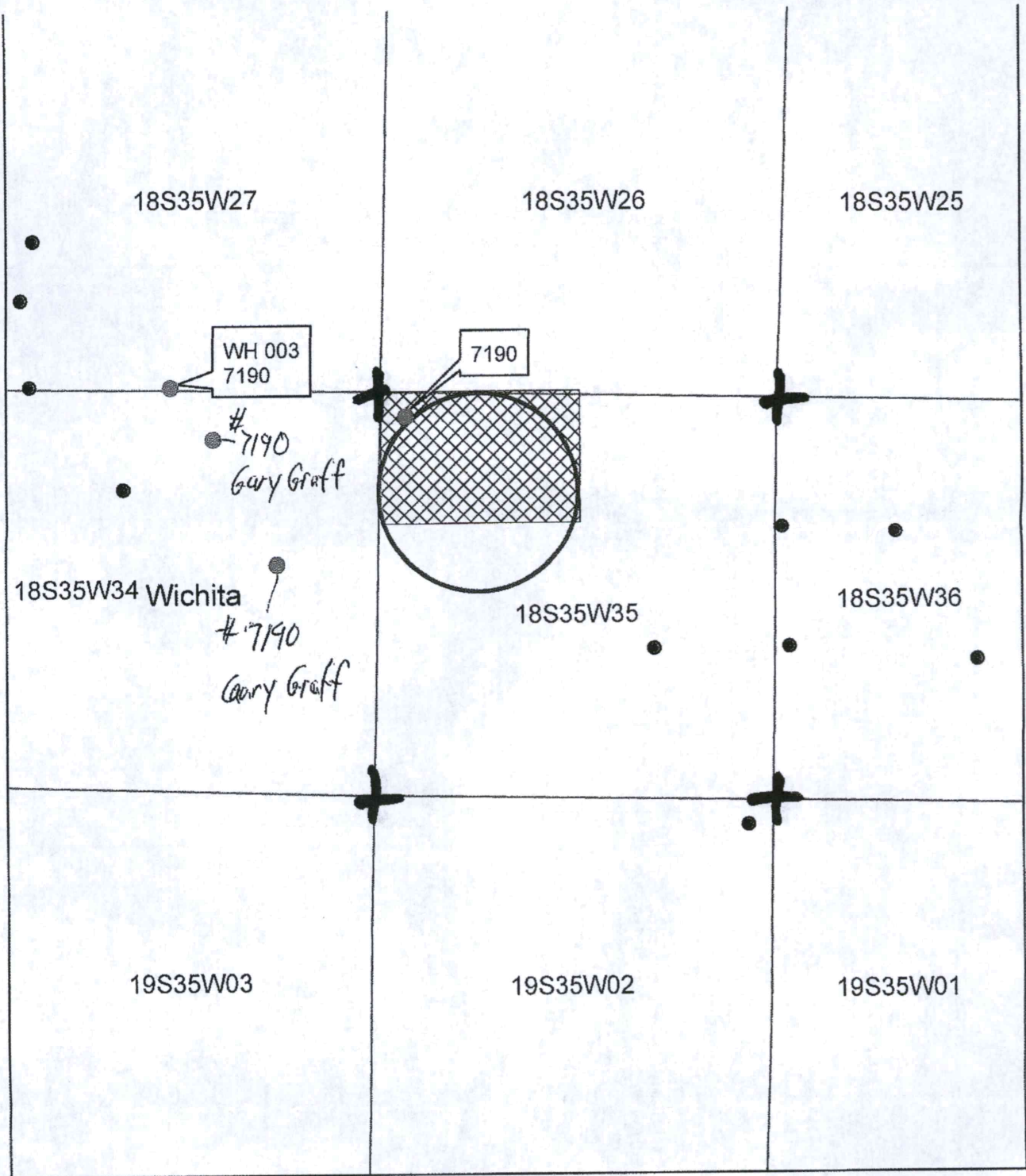

TERM PERMIT

Water Resources
Received

APR 06 2020

KS Dept Of Agriculture

scale 1" = 2640'

From: Meyer, Mike [KDA] Mike.Meyer@ks.gov
Subject: term permit
Date: Apr 2, 2020 at 3:44:01 PM
To: tomridder65@gmail.com

Tom attached are 2 term permit applications for the pivot in the NW of 35. An application for each well to supply water to the unauthorized ground. You will need to sign both applications on the back side of each in item No. 10 and item No. 14.

A total fee of \$600.00.

A check can be made to the Kansas Department of Agriculture, and send all to the address on the top left hand corner of the applications

Let me know if you have any questions

Michael A. Meyer, PG
Kansas Department of Agriculture
Division of Water Resources
Garden City Field Office
4532 W Jones Ave, Suite B
Garden City KS 67846
Lat 37.98820, Lon -100.944470
(620)-276-2901
mike.meyer@ks.gov



20200402...24489.pdf
252 KB

WATER RESOURCES
RECEIVED
APR 06 2020
KS DEPT OF AGRICULTURE

DATA ENTRY SYSTEM ID NUMBER SHEET

FILE NUMBER 20209037

APPLICANT PERSON ID & SEQ #	PDIV ID	BATTERY ID
51654	48794	

LANDOWNER PERSON ID & SEQ #	PUSE ID
6370 32921	1663 20393
16785	5182 2255
32919	6572 23942
32920	

WATER USE CORRESPONDENT PERSON ID & SEQ #
16785