

NOTICE

This scan only represents the application as filed. The information contained herein meets the requirements of K.A.R. 5-3-1 or K.A.R. 5-5-1, and has been found acceptable for filing in the office of the Chief Engineer. The application should not be considered to be a complete application as per K.A.R. 5-3-1b or K.A.R. 5-5-2a.

Submit To: CHIEF ENGINEER
 Division of Water Resources
 Kansas Department of Agriculture
 109 SW 9TH Street, 2nd Floor
 Topeka, KS 66612-1283
 www.ksda.gov/dwr

APPLICATION FOR TERM PERMIT

- GROUNDWATER
 SURFACE WATER
 (check one)

WATER RESOURCES RECEIVED

DEC 22 2020

3:22

KS DEPT OF AGRICULTURE



State of Kansas

STATUTORY FILING FEE MUST ACCOMPANY THIS APPLICATION
 (Make check payable to the Kansas Department of Agriculture)

20209093

1. Applicant: (Please print or type)
 Name Wiatt Cole Tackett
 Street PO Box 46
 City and State Deerfield, KS
 Zip Code 67838 Telephone No. (620) 805-4384
 E-Mail Address coletackett123@gmail.com
 Social Security I.D. No. _____
 and/or Taxpayer I.D. No. _____

2. Location of Point of Diversion:
 Sec. 14, Twp. 24, Rng. 35, W,
Kearny County, Kansas.
 Distance from Southeast Corner of Section:
363 feet North from Southeast Corner
2350 feet West from Southeast Corner
 NOTE: If point of diversion is not site specific (i.e. groundwater pit) show the approximate geographic center.

3. Water Use Data:
 Proposed Max. Pumping Rate (gpm) 900gpm
 Amount Requested (acre-feet) 50AF
 per calendar year
 Depth of Well (feet) 65 ft
 Date (completed) (will be completed) June 10, 1977
 Drainage Basin _____
 Name of Stream _____

4. Water is to be used for (briefly describe proposed use and explain the rate and quantity requested):
Finish out 2020 season only for IRR
Offset from KE 28. Working on permanent changes
 5. Location of place of use:
124 acres SE 14-24-35
 6. Period of use:
 Commencing date: _____
 Ending Date: 12/31/20 **Also enter on Item 12**
 If off-stream pit, check here
 Will pit floor intersect water table? Yes No
 7. Location of the proposed point of diversion and those of other water users within 1/2 mile shall be indicated on the diagram to the lower-left, scale 1 inch = 2,000 feet. If surface water, indicate on the diagram the course of the stream, and its name. List other D.W.R. permit numbers that cover the requested point(s) of diversion or place of use here:
PU overlap 9552 ID03. Offset from KE28

FEE SCHEDULE

1. The filing fee for an application is based on the maximum amount of water use proposed within a year. Except for storage, the fee is:
- | Acre-feet | Fee |
|---------------|----------|
| 0-100 | \$200.00 |
| 101-320 | \$300.00 |
| More than 320 | \$300.00 |
- plus \$20 for each additional 100 acre-feet or any part thereof.
2. The fee for an application in which storage is requested, is:
- | Acre-feet | Fee |
|---------------|----------|
| 0-250 | \$200.00 |
| More than 250 | \$200.00 |
- plus \$20.00 for each additional 250 acre-feet of storage or any part thereof.
- NOTE: If an application requests both direct use and storage, the fee charged shall be as determined under No. 1 or No. 2 above, whichever is greater, but not both fees.
3. The fee for an application for a permit to appropriate water for water power or dewatering purposes shall be \$100.00 plus \$200.00 for each 100 cubic feet per second, or part thereof, of the diversion rate requested.
4. A request for an extension of time to extend the term of a term permit shall be accompanied by a fee of \$100.00.
5. There is a separate application form for domestic use. Do not use this form for domestic use.

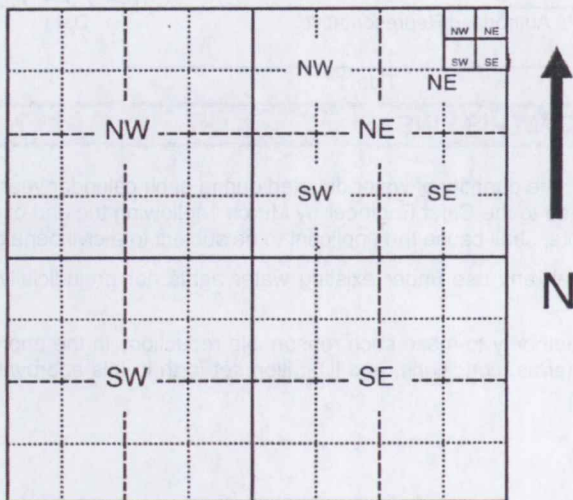

CONVERSION FACTORS

1 acre-foot equals 325,851 gallons
 1 million gallons equal 3.07 acre-feet

RECEIVED

DEC 16 2020

Garden City Field Office
 DIVISION OF WATER RESOURCES

Assisted by GMD3

For Office Use Only:
 F.O. 4 GMD Meets K.A.R. 5-3-1 (YES/NO) Use IRR Source G/S County KE By BMM Date 12/23/20
 Code TRP Fee \$ 200.00 TR # _____ Receipt Date 12-16-20 Check # 00423

WATER RESOURCES RECEIVED

DEC 22 2020

KS DEPT OF AGRICULTURE

8. For groundwater use, list below all wells within 1/2 mile of the proposed well, and plot locations upon the diagram on reverse side. If additional space is needed, attach a map.

Other wells -

Well A Owner(s): None within 1/2 mile
Address: _____

Well B Owner(s): _____
Address: _____

9. For surface water use, list below the names and addresses of all landowners from a point 1/2 mile upstream to a point 1/2 mile downstream of the tract of land upon which the point of diversion is located. If additional space is needed, attach sheet.

Tract A Owner(s): _____
Address: _____

Tract B Owner(s): _____
Address: _____

10. The owner of the point of diversion, if other than the applicant is (please print):

(name, address and telephone number)

You must provide evidence of legal access to, or control of, the point of diversion from the landowner or the landowner's authorized representative. Provide a copy of a recorded deed, lease, easement or other document with this application. In lieu thereof, you may sign the following sworn statement:

I have legal access to, or control of, the point of diversion described in this application from the landowner or the landowner's authorized representative. I declare under penalty of perjury that the foregoing is true and correct.

Executed on 16 Dec, 2020, 20____. Kerry Zickell POA
Applicant's Signature

The applicant must provide the required information or signature irrespective of whether they are the landowner. Failure to complete this portion of the application will cause it to be unacceptable for filing and the application will be returned to the applicant.

- 11. The applicant states that the information set hereon is true and accurate to the best of his/her knowledge.
- 12. The applicant agrees to waive any right to a hearing on the matter of abandonment of this appropriation right and further agrees that this appropriation right may be dismissed and terminated upon completion of the proposed project, said dismissal date to be on _____ or within any extension of time authorized by the Chief Engineer, Division of Water Resources, Kansas Department of Agriculture.
- 13. The applicant agrees to provide water to nearby water users, at no charge to said users, should their rights to use water become impaired by the project proposed by this application.

14. Water use contact person (in event emergency contact is needed):

Name: Wiaft Cole Talbert Telephone No. (620) 805-4384

Wiaft Cole Talbert or 12/15/20

Signature of Applicant Authorized Representative Date

Wiaft Cole Talbert or _____

Applicant's Name Printed Title

DO NOT WRITE BELOW THIS LINE

CONDITIONS OF APPROVAL:

The applicant shall maintain accurate and complete records from which the quantity of water diverted during each calendar year may be readily determined. Accurate and complete records shall be furnished to the Chief Engineer by March 1 following the end of each calendar year. Failure to file the annual water use report by the due date, shall cause the applicant to be subject to a civil penalty.

The use of water herein authorized shall not be made so as to impair any use under existing water rights nor prejudicially and unreasonably affect the public interest.

The Chief Engineer specifically retains jurisdiction in this matter with authority to make such reasonable reductions in the approved rate of diversion and quantity authorized, and such changes in other terms, conditions, and limitation set forth in this approval and permit to proceed as may be deemed to be in the public interest.

DEC 18 2020
DIVISION OF WATER RESOURCES



December 14, 2020
11:11 AM

DISCLAIMER: This map is not intended for conveyances, nor is it a legal survey. The information is presented on a best-efforts basis, and should not be relied upon for making financial, survey, legal or other commitments.

1:42,063

Wells	+	CON	⬮	FPR	▲	MUN	⚡	THX	
?	Other	⊠	DEW	⊕	HYD	▤	REC	?	Empty
•	IRR	⚠	DOM	★	IND	⊗	STK	□	Sections

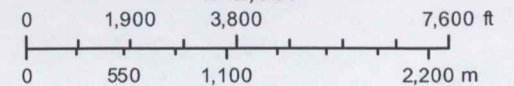

RECEIVED

DEC 16 2020

Garden City Field Office
DIVISION OF WATER RESOURCES

Term App. (Base WR 9552)

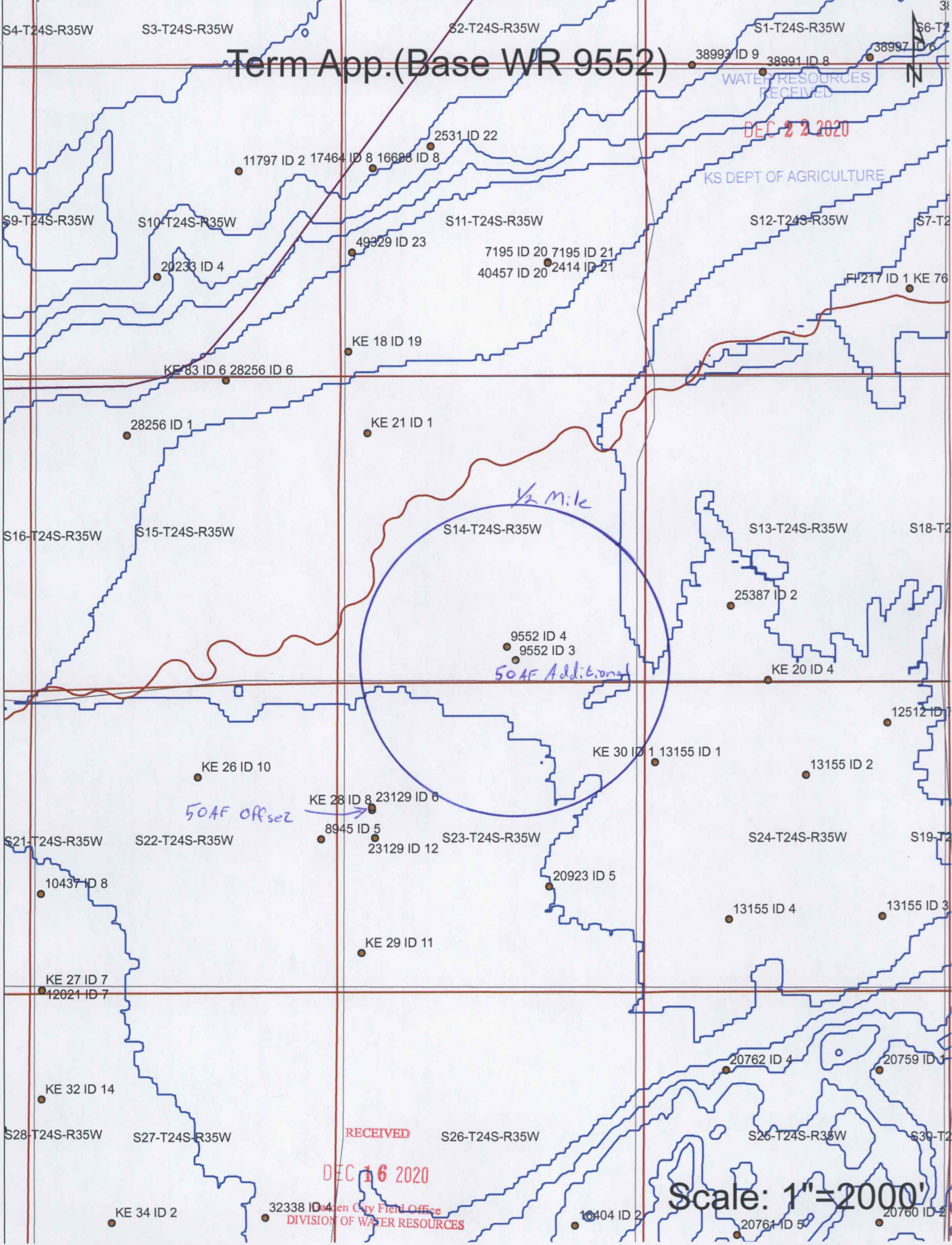

DEC 22 2020

KS DEPT OF AGRICULTURE

1/2 Mile

50AF Additional

50AF Offset

RECEIVED

DEC 16 2020

44th City Field Office
DIVISION OF WATER RESOURCES

Scale: 1" = 2000'

Term App. (Base WR 9552)

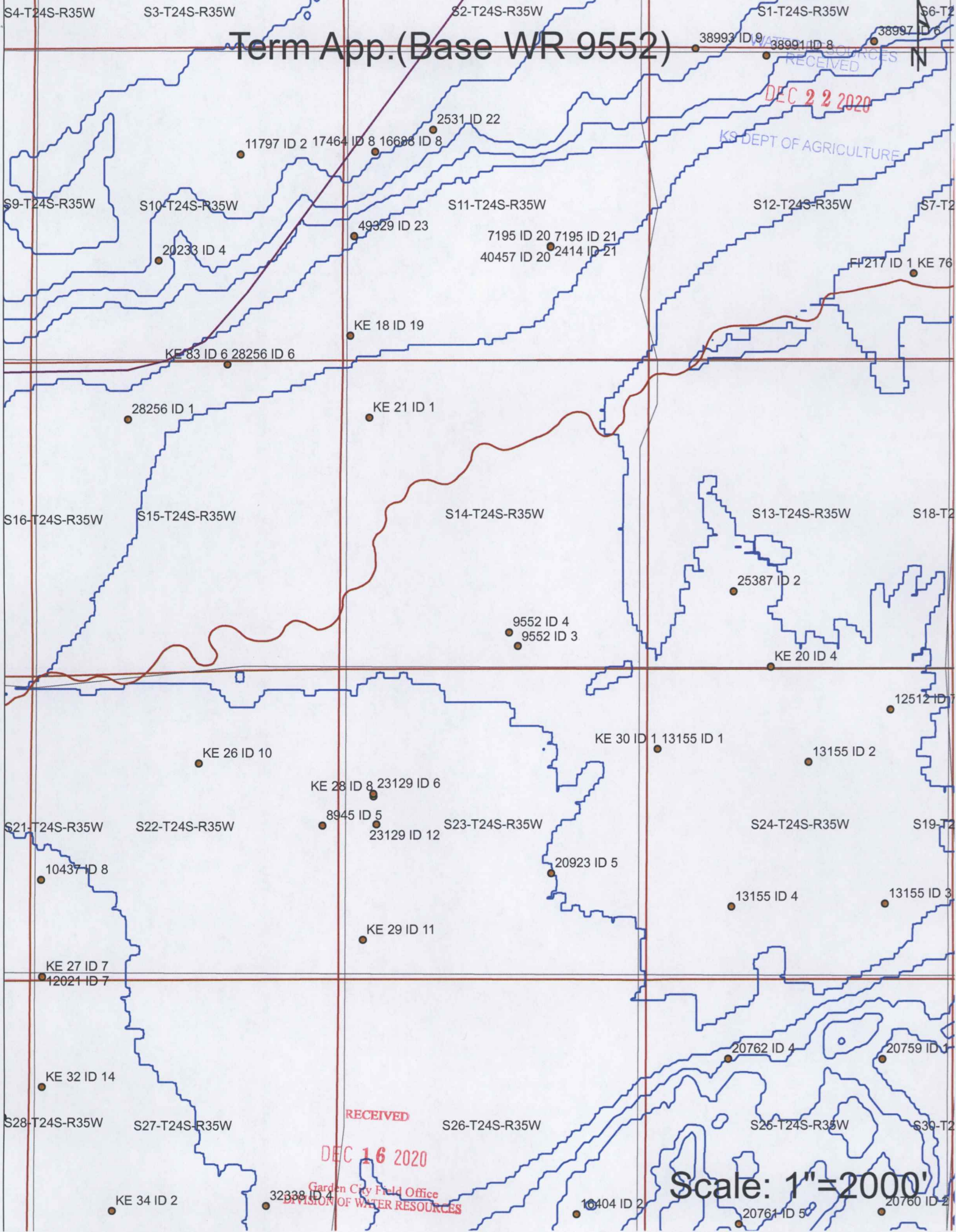

RECEIVED
DEC 22 2020

RECEIVED
DEC 16 2020

Garden City Field Office
DIVISION OF WATER RESOURCES

Scale: 1" = 2000'

WATER RESOURCES
RECEIVED

DEC 22 2020

KS DEPT OF AGRICULTURE

Kerry Trickett

Box 46

Deepfield, Ks.

67838

620-260-5108

1320 Research Park Drive
Manhattan, KS 66502
785-564-6700
www. agriculture.ks.gov



900 SW Jackson, Room 456
Topeka, KS 66612
785-296-3556

Mike Beam, Secretary

Laura Kelly, Governor

December 23, 2020

WIATT COLE TACKETT
PO BOX 46
DEERFIELD KS 67838

RE: Application, File No(s). **20209093**

Dear Sir or Madam:

The Division of Water Resources (Division) has received your application(s) for a permit to appropriate water for beneficial use. Your application(s) has been assigned the file number(s) referenced above. Please be aware that the Division may have a large number of pending applications on hand at times and makes every attempt to process them in the order in which they are received. You will be contacted if additional information is required.

Please note, this letter only acknowledges receipt of your application(s) and does not guarantee approval. In accordance with the provisions of the Kansas Water Appropriation Act, the use of water as proposed prior to approval of the application(s) is unlawful.

Additional information about the process may be found on our website at agriculture.ks.gov/divisions-programs/dwr. If you have any other questions, please contact our office at 785-564-6640 or your local Garden City Field Office at 620-276-2901. *Garden City Field Office at 620-276-2901*. If you call, please reference the file number so we can help you more efficiently.

Sincerely,

Kris Neuhauser
New Applications Lead
Water Appropriation Program