

Kansas Department of Agriculture
 Division of Water Resources
CHANGE: P/D WORKSHEET

1. File Number: 16123	2. Status Change Date:	3. Change Num: C2	4. Field Office: 4	5. GMD: 3
---------------------------------	------------------------	-----------------------------	------------------------------	---------------------

6. Status: <input checked="" type="checkbox"/> Approved <input type="checkbox"/> Denied by DWR/GMD <input type="checkbox"/> Dismiss by Request/Failure to Return	7. Filing Date of Change:
--	---------------------------

8a. Applicant(s)/Landowner(s) Person ID **6372**
 New to system Add Seq# _____

GRAHAM FARMS INC
2150 ROAD 220
DEERFIELD, KS 67838-9513

8c. Landowner(s) Person ID **6380**
 New to system Add Seq# _____

ROY DEAN GRAHAM
RR 1 BOX 190
DEERFIELD, KS 67838

8b. Landowner(s) Person ID **28021**
 New to system Add Seq# _____

SKY VIEW INC
RR 1 BOX 192
DEERFIELD, KS 67838-9513

8d. WUC Person ID **38964**
 New to system Add Seq# _____

TRIPLE G FARMS ET AL
Attn: ROY GRAHAM
2156 RD 220
DEERFIELD, KS 67838

9. Documents and Enclosure(s): DWR Meter(s) Date to Comply: **12/31/2021** N & P Date to Comply: **3/1/2022**

Anti-Reverse Meter Meter Seal Check Valve N & P Form Water Tube Driller Copy H & E Letter

Conservation Plan Date Required: _____ Date Approved: _____ Date to Comply: _____

10. Use Made of Water From: _____ To: _____

Date Prepared: **1/15/2021** By: **AM**
 Date Entered: _____ By: _____

File No. **16123** 11. County: **KE** Basin: **ARKANSAS RIVER** Stream: _____ Formation Code: **100/211** Special Use: _____

12. Points of Diversion										Rate and Quantity						
CHK	MOD	DEL	PDIV	Qualifier	S	T	R	ID	'N	'W	Comment (AKA Line)	Rate gpm	Quantity af	Rate gpm	Quantity af	Overlap PD Files
DEL			46816													
ENT				SW NE SW	16	23S	35W		1454	3805		1230	412	1230	412	NONE
CHK	72756			NW SW NE	21	23S	35W	8	3945	2480		1845	28	622	28	1588; 27276

13. Storage: Rate _____ NF Quantity _____ ac/ft Additional Rate _____ NF Additional Quantity _____ ac/ft

14. Limitation: _____ af/yr at **1845** gpm (_____ cfs) when combined with file number(s) **FOR WELL 3945N & 2480W SEC 21 COM/W 1588**
 Limitation: _____ af/yr at _____ gpm (_____ cfs) when combined with file number(s) ****UPDATE LIMITATION TEXT****

15. 5YR Allocation: Allocation Type _____ Start Year _____ 5 YR Amount _____ Amount Unit _____ Base Acres _____ Comment _____

16. Place of Use																		Total	Owner	Chg?	Overlap Files								
CHK	MOD	DEL	ENT	PUSE	S	T	R	ID		NE¼				NW¼				SW¼				SE¼							
										NE ¼	NW ¼	SW ¼	SE ¼	NE ¼	NW ¼	SW ¼	SE ¼	NE ¼	NW ¼	SW ¼	SE ¼	NE ¼	NW ¼	SW ¼	SE ¼				
CHK				15046																									
CHK				19423																									
CHK				23791																									
CHK				25384																									
CHK				38446																									

Base Acres: _____ Year: _____ Minimum Reasonable Quantity: _____
 Comments: _____

Garden City Field Office
4532 W. Jones, Suite B
Garden City, KS 67846

Mike Beam, Secretary



Phone: 620-276-2901
Fax: 620-276-9315
www.agriculture.ks.gov

Laura Kelly, Governor

January 19, 2021

GRAHAM FARMS INC
2150 ROAD 220
DEERFIELD, KS 67838-9513

RE: Water Right, File No. 16123

Dear Sir or Madam:

Enclosed is the order executed by the designee of the Chief Engineer, Division of Water Resources, Kansas Department of Agriculture, approving the application for change under the above referenced file numbers.

Your attention is directed to the enclosures and to the terms, conditions, and limitations specified in this approval for change. A condition of this approval is that an acceptable water flow meter must be installed on the diversion works authorized under the referenced file number and meet current specifications. Please return the required notification of completion of the diversion works and installation of the required meter as soon as these actions are completed.

Since the order modifies the original document referred to above, it should be recorded with the Register of Deeds as other instruments affecting real estate.

Should you have any questions, please feel free contact this office. If you would prefer, you could arrange an appointment for additional assistance.

Sincerely,

A handwritten signature in blue ink, appearing to read "Austin J. McColloch".

Austin J. McColloch
Assistant Water Commissioner

AM:
enclosures

pc: Roy D. Graham
Sky View Inc.
Triple G Farms
GROUNDWATER MANAGEMENT DISTRICT NO. 3

CERTIFICATE OF SERVICE

On this 19th day of January, 2021, I hereby certify that the foregoing Approval of Application for Change in Point of Diversion, Water Right, File No. 16,123 dated 19th day of January, 2021 was mailed postage prepaid, first class, US mail to the following:

GRAHAM FARMS INC
2150 ROAD 220
DEERFIELD, KS 67838-9513

Pc:

ROY DEAN GRAHAM
RR 1 BOX 190
DEERFIELD, KS 67838

SKY VIEW INC
RR 1 BOX 192
DEERFIELD, KS 67838-9513

TRIPLE G FARMS ET AL
Attn: ROY GRAHAM
2156 RD 220
DEERFIELD, KS 67838

GROUNDWATER MANAGEMENT DISTRICT NO. 3



Division of Water Resources Staff

Submit completed application to:
 Kansas Department of Agriculture
 Division of Water Resources
 Field Office for your area.
 Call for address:

Topeka -- (785) 296-5733
 Stafford -- (620) 234-5311
 Stockton -- (785) 425-6787
 Garden City -- (620) 276-2901
<http://agriculture.ks.gov/dwr>

DWR FIELD OFFICE APPLICATION FOR APPROVAL TO CHANGE THE PLACE OF USE AND/OR THE POINT OF DIVERSION



STATE OF KANSAS

Filing Fee Must Accompany the Application, K.S.A. 82a-708b(b), as amended.
 Fee Schedule is on the third page of this application form.

Paragraph Nos. 1, 2, 3 & 5 must be completed. Complete all other applicable portions. If change in point of diversion is greater than 100 feet, or if place of use will be changed, include a topographic map or detailed plat showing the authorized and proposed point(s) of diversion and/or place of use.

RECEIVED

JAN 11 2021

11:50 am

Garden City Field Office
 Division of Water Resources

File No. 16123

1. Application is hereby made for approval of the Chief Engineer to change the (check one or both):

Place of Use Point of Diversion

under the water right which is the subject of this application in accordance with the conditions described below.

The source of supply is: Groundwater Surface water

2. Name and address of Applicant: GRAHAM FARMS INC

2150 ROAD 220, DEERFIELD, KS 67838-9513

Phone Number: () Email address: _____

Name and address of Water Use Correspondent: TRIPLE G FARMS ET AL, Attn: ROY GRAHAM

2156 RD 220, DEERFIELD, KS 67838

Phone Number: () Email address: _____

3. The presently authorized place of use is:

Owner of Land ---- NAME: ROY DEAN GRAHAM, RR 1 BOX 190, DEERFIELD, KS 67838

ADDRESS: SKY VIEW INC, RR 1 BOX 192, DEERFIELD, KS 67838-9513

(If there is more than one landowner, attach supplemental sheets as necessary.)

Sec.	Twp.	Range	NE¼				NW¼				SW¼				SE¼				TOTAL ACRES		
			NE¼	NW¼	SW¼	SE¼	NE¼	NW¼	SW¼	SE¼	NE¼	NW¼	SW¼	SE¼	NE¼	NW¼	SW¼	SE¼			

4. If this application is for a change in place of use, it is proposed that the place of use be changed to:

Owner of Land ---- NAME: _____

ADDRESS: _____

(If there is more than one landowner, attach supplemental sheets as necessary.)

Sec.	Twp.	Range	NE¼				NW¼				SW¼				SE¼				TOTAL ACRES			
			NE¼	NW¼	SW¼	SE¼	NE¼	NW¼	SW¼	SE¼	NE¼	NW¼	SW¼	SE¼	NE¼	NW¼	SW¼	SE¼				

For Office Use Only: Code _____ Fee \$ 100⁰⁰ TR # _____ Receipt Date 1-11-21 Check # 5350

5. **Presently authorized point of diversion:**
 One in the _____ Quarter of the _____ NC Quarter of the _____ SW Quarter
 of Section _____ 16 _____, Township _____ 23 _____ South, Range _____ 35 _____ (W),
 in KE _____ County, Kansas, _____ 1320 _____ feet North _____ 3960 _____ feet West of Southeast corner of section.
 Authorized Rate No change Authorized Quantity No change Depth of well _____ (feet)
 (DWR use only: Computer ID No. 1 GPS _____ feet North _____ feet West)
 This point will not be changed This point will be changed as follows: No change, point better described with GPS as follows:
Proposed point of diversion: (Complete only if change is requested or if existing point is better described by GPS)
 One in the SW Quarter of the _____ NC NE Quarter of the _____ SW Quarter
 of Section _____ 16 _____, Township _____ 23 _____ South, Range _____ 35 _____ (W),
 in KE _____ County, Kansas, _____ 1454 _____ feet North _____ 3805 _____ feet West of Southeast corner of section.
 Proposed Rate No change Proposed Quantity No change Proposed well depth (feet) _____ 360 _____
 This point is: Additional Well Geo Center List other water rights that will use this point _____

6. **Presently authorized point of diversion:**
 One in the _____ NW Quarter of the _____ SW Quarter of the _____ NE Quarter
 of Section _____ 16 _____, Township _____ 23 _____ South, Range _____ 35 _____ (W),
 in KE _____ County, Kansas, _____ 3945 _____ feet North _____ 2480 _____ feet West of Southeast corner of section.
 Authorized Rate No change Authorized Quantity No change Depth of well _____ (feet)
 (DWR use only: Computer ID No. 8 GPS _____ feet North _____ feet West)
 This point will not be changed This point will be changed as follows: No change, point better described with GPS as follows:
Proposed point of diversion: (Complete only if change is requested or if existing point is better described by GPS)
 One in the _____ Quarter of the _____ Quarter of the _____ Quarter
 of Section _____, Township _____ South, Range _____ (E/W),
 in _____ County, Kansas, _____ feet North _____ feet West of Southeast corner of section.
 Proposed Rate _____ Proposed Quantity _____ Proposed well depth (feet) _____
 This point is: Additional Well Geo Center List other water rights that will use this point _____

7. The changes herein are desired for the following reasons?
 (please be specific) _____

8. If a well, is the test hole log attached? Yes No

9. The change(s) (was)(will be) completed by?

10. If the point of diversion is a well:
 (a) What are you going to do with the old well?

 (b) When will this be done? _____

11. Groundwater Management District recommendation attached?
 Yes No

12. Assisted by mf/GCFO

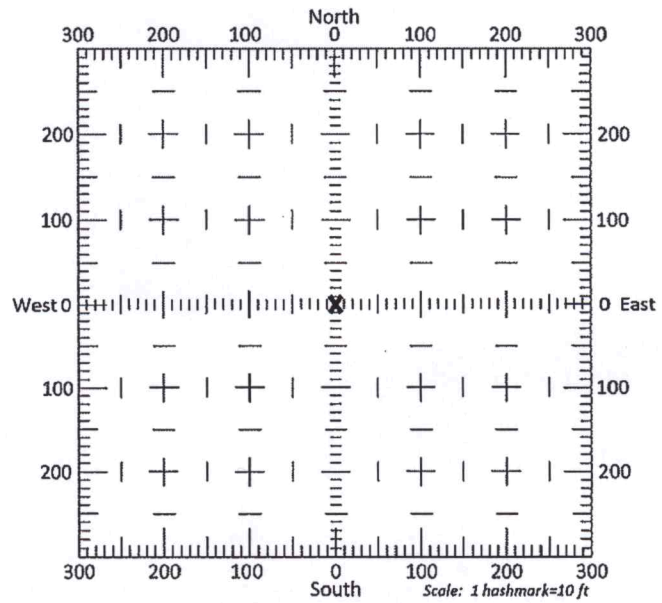

13a. If the proposed point of diversion will be relocated more than 300 feet but within 2,640 feet of the existing point of diversion, attach a topographic map or aerial photograph. For groundwater sources, show all wells (including domestic) within one-half mile of the proposed point of diversion and the names and mailing addresses of the owners. For surface water sources, show the names and addresses of the landowner(s) one-half mile downstream and one-half mile upstream from your property lines

13b. If the proposed point of diversion will be relocated within 300 feet of the existing point of diversion, indicate its location on the diagram shown above in relation to the existing point of diversion. (PLEASE NOTE: The "X" in center of diagram above represents the presently authorized point of diversion.)

14. If the proposed groundwater point of diversion is 300 or fewer feet from the existing point of diversion, complete the following:

- (a) Does the undersigned represent all owners of the currently authorized place(s) of use identified in this application?
 Yes No (If no, all owners must sign this application.)
- (b) Will the ownership interest of any owner of the currently authorized place(s) of use identified in this application be adversely affected if this application is approved as requested?
 Yes No (If yes, all owners must sign this application.)
- (c) If this application is not approved expeditiously, will there be substantial damage to property, public health or safety?
 Yes No (If no, all owners must sign this application.)

If the application proposes a surface water change in point of diversion, a groundwater change in point of diversion greater than 300 feet, or a change in place of use, the application must be signed by all owners of the currently authorized place of use, or their duly authorized agent (attach notarized statement authorizing representation).

I hereby verify, being first duly sworn upon my oath or affirmation and under penalty of perjury, that I am of lawful age and the owner, the spouse of the owner, or a duly authorized agent of the owner(s) to make this application on their behalf, in regards to the water right(s) to which this application pertains. I further verify that the statements contained in this application are true, correct and complete.

Dated at Gardner City, Kansas, this 11 day of JAN, 2021.

[Signature]
(Owner)

(Spouse)

Graham Farms Inc Roy Graham
(Please Print)

(Please Print)

(Owner)

(Spouse)

(Please Print)

(Please Print)

(Owner)

(Spouse)

(Please Print)

(Please Print)

State of Kansas }
County of Finnery } SS

I hereby certify that the foregoing application was signed in my presence and sworn to before me this 11th day of January, 2021.

[Signature]
Notary Public

My Commission Expires

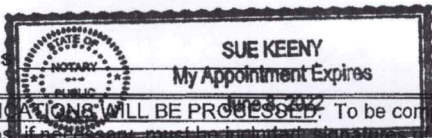

ONLY COMPLETE APPLICATIONS WILL BE PROCESSED. To be complete, all of the applicable portions of the application form must be completed with accurate information; maps if necessary, must be included; signatures of all the appropriate owners' must be affixed to the application and notarized; and the appropriate fee must be paid.

FEE SCHEDULE

Each application to change the place of use or the point of diversion under this section shall be accompanied by the application fee set forth in the schedule below: Make checks payable to: **Kansas Department of Agriculture**

- (1) Application to change a point of diversion 300 feet or less \$100
- (2) Application to change a point of diversion more than 300 feet \$200
- (3) Application to change the place of use \$200

MIDWEST WELL & PUMP

PO BOX 692, Garden City, Kansas 67846

(620)275-1920

RECEIVED

JAN 08 2021

Garden City Field Office
Division of Water Resources

Owner Name: Graham Farms
Address: 2150 Rd. 220
City, St, Zip: Deerfield, KS 67838
GPS: N.38.05057 W.101.17081
Contact #: Cory 620-272-3074
Location: SW ¼ 16-23-35 Kearny County
From Old Well: About 270' East North East

Date: 1/20
Test Hole: 3-20
Driller: Soukup
Dig Safe#19602684
Static Water Level About: 165'
Total Depth: 360' Black Shale

FROM:	TO:	STRATA:	
0	2	Top Soil	
2	10	Brown Clay	
10	14	Coarse Sand Small Gravel	
14	70	Soft Brown Clay	
70	72	Fine To Medium Sand	
72	84	Fine To Medium Sand With Brown Clay Streaks	
84	94	Brown Clay Few Small Fine To Medium Sand Streaks	
94	108	Medium To Coarse Sand Small Gravel	
108	122	Fine To Medium Sand Some Small Gravel With Brown Clay Streaks	
122	126	Brown Clay	
126	140	Fine To Medium Sand With Brown Clay Streaks	
140	141	Brown Clay	
141	145	Fine To Medium Sand	
145	150	Brown Clay With Fine To Medium Sand Streaks	
150	152	Fine To Medium Sand	
152	158	Brown Clay With Few Fine Sand Streaks	
158	162	Medium To Coarse Sand	
162	176	Brown Clay Few Medium Sand Streaks	
176	191	Fine To Medium Sand Some Small Gravel	
191	192	Brown Clay	
192	212	Medium To Coarse Sand Small Gravel (Loose) (Started To Take Some Water)	20
212	238	Brown Clay With Few Small Medium To Coarse Sand Small Gravel Streaks 85/15	1
238	246	Fine To Medium Sand With Few Small Brown Clay Streaks	5
246	285	Brown Clay With Few Small Fine To Medium Sand Streaks	.
285	302	Fine To Medium Sand Small Gravel Few Small Brown Clay Streaks 75/25	3
302	322	Fine To Coarse Sand Small Gravel And Some Brown Gravel	20
322	326	Fine To Coarse Sand Small Gravel And Some Brown Gravel With Brown Clay Streaks	2
326	339	Fine To Medium Sand Some Small Gravel Few Small Brown Clay	10
339	347	Brown Clay With Fine To Medium Sand Mix 50/50	4
347	366	Medium To Coarse Sand Small Gravel White Broken Rock Few Brown Clay Steaks	19
366	368	Black Shale	83

Change in point of diversion application for water right 16123

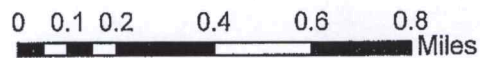
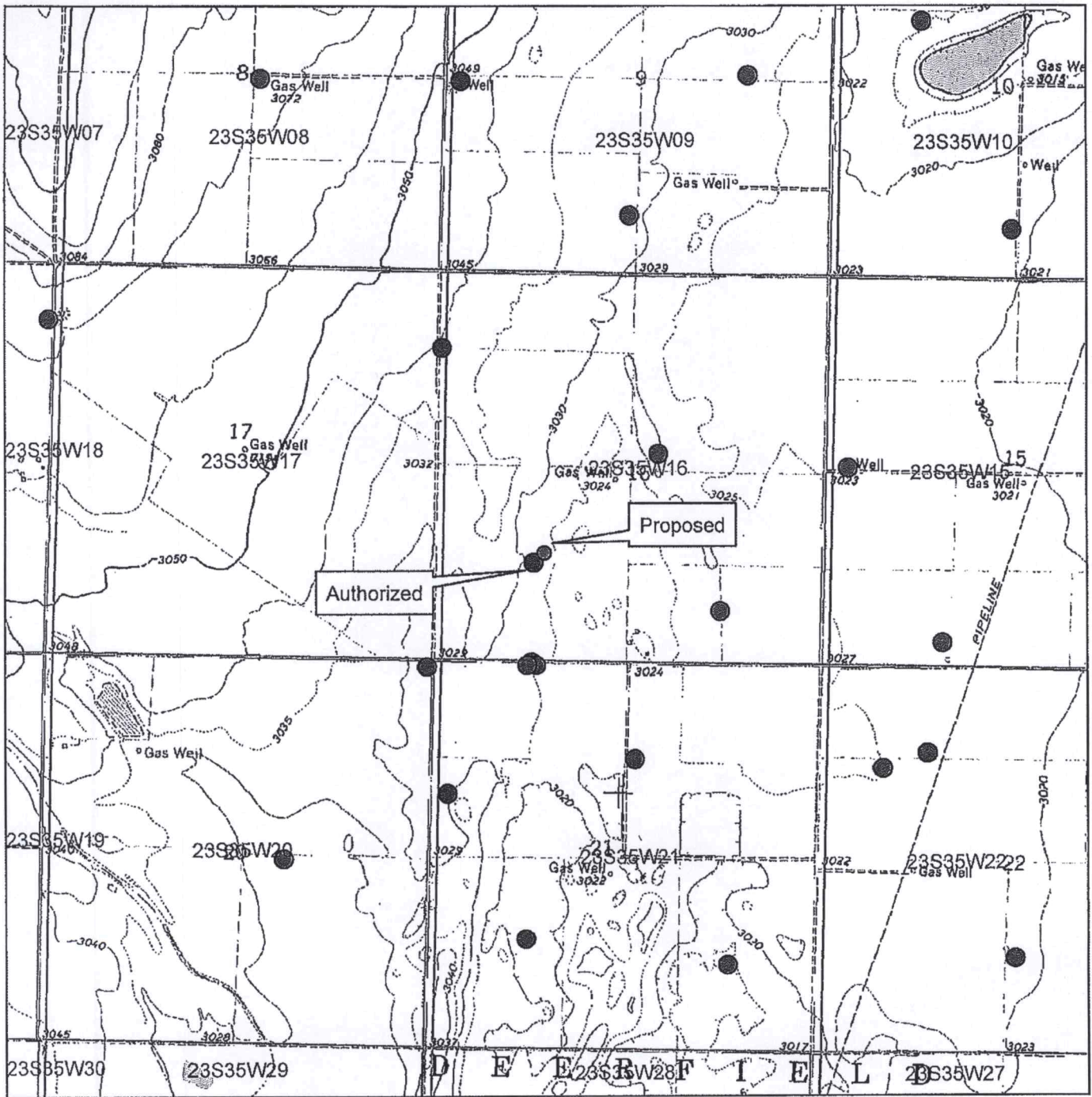

- Authorized point of diversion
- Proposed point of diversion

All wells within 1/2 mile are on this map.

X _____

INPUTS	
Target Section Definition	
Section	16
Township	23
Range	35
Range Direction	w
Target Point Coordinates (NAD27 or NAD83)	
Target Longitude	-101.170810
Target Latitude	38.050570

Load Data and Compute

Instructions

1. Enter values for section, township, range and range direction.
2. Enter **NAD27** or **NAD83** longitude and latitude of target point.
3. Click "Load Data and Compute" button.
4. Use feet distances corresponding to datum of target point.

Loaded Section Data From LEOBASE using NAD83		
Corner	Corner Latitudes	Corner Longitudes
SW	38.04654547	-101.17605793
NW	38.06107148	-101.17610352
NE	38.06116368	-101.15757935
SE	38.04657665	-101.15759477
Degrees Longitude per Foot		3.47269715E-06
Degrees Latitude per Foot		2.74606631E-06
Target Point Distances from Corners using NAD83		
Corner	Feet North(+)/South(-)	Feet East(-)/West(+)
SW	1466	-1511
NW	-3824	-1524
NE	-3858	3810
SE	1454	3805

Target point is In Section

Loaded Section Data From LEOBASE using NAD27		
Corner	Corner Latitudes	Corner Longitudes
SW	38.04652400	-101.17561300
NW	38.06105000	-101.17565900
NE	38.06114200	-101.15713500
SE	38.04655500	-101.15715000
Degrees Longitude per Foot		3.47269613E-06
Degrees Latitude per Foot		2.74598553E-06
Target Point Distances from Corners using NAD27		
Corner	Feet North(+)/South(-)	Feet East(-)/West(+)
SW	1473	-1383
NW	-3816	-1396
NE	-3850	3938
SE	1462	3934

Target point is In Section

Difference (NAD83 Minus NAD27)		
Corner	Corner Latitudes	Corner Longitudes
SW	0.00002147	-0.00044493
NW	0.00002148	-0.00044452
NE	0.00002168	-0.00044435
SE	0.00002165	-0.00044477
Difference (NAD83 Minus NAD27)		
Corner	Feet North(+)/South(-)	Feet East(-)/West(+)
SW	-7.86180067	-128.12190964
NW	-7.70982748	-128.00384191
NE	-7.78167335	-127.95645395
SE	-7.92701688	-128.07739613