

Kansas Department of Agriculture
 Division of Water Resources
CHANGE: P/D WORKSHEET

1. File Number: 24239	2. Status Change Date: <i>6-29-2021</i>	3. Change Num: C3	4. Field Office: 04	5. GMD: 03
---------------------------------	--	-----------------------------	-------------------------------	----------------------

6. Status: <input checked="" type="checkbox"/> Approved <input type="checkbox"/> Denied by DWR/GMD <input type="checkbox"/> Dismiss by Request/Failure to Return	7. Filing Date of Change: 6/16/2021
--	---

8a. LANDOWNER, correspondent Person ID **38733**
 New to system Add Seq# _____

CLINT & KENDRA THOMASON
PO BOX 1068
ELKHART, KS 67950

8c. LANDOWNER, correspondent Person ID _____
 New to system Add Seq# _____

8b. Landowner(s), Person ID _____
 New to system Add Seq# _____

8d. correspondent, applicant Person ID **26691**
 New to system Add Seq# _____

ROCK ORMISTON
303 MAIN ST
KISMET, KS 67859-9612

9. Documents and Enclosure(s): DWR Meter(s) Date to Comply: **12/31/2021** N & P Date to Comply: **3/1/2022**

Anti-Reverse Meter Meter Seal Check Valve N & P Form Water Tube Driller Copy H & E Letter

Conservation Plan Date Required: _____ Date Approved: _____ Date to Comply: _____

10. Use Made of Water From: _____ To: _____

Date Prepared: **6/29/2021** By: **MAM**
 Date Entered: _____ By: _____

File No. **24239** 11. County: **SW** Basin: **CIMARRON RIVER** Stream: Formation Code: **211** Special Use:

12. Points of Diversion Rate and Quantity
CHK Authorized Additional
MOD Rate Quantity
DEL PDIV Qualifier S T R ID 'N 'W **Comment (AKA Line)** gpm af gpm af Overlap PD Files
ENT

DEL 21889
ENT 78562 **NWSWNW** **15** **33** **33W** **05** **3363** **5049** **C11** **710** **264** **710** **264** **NONE**

13. Storage: Rate _____ NF Quantity _____ ac/ft Additional Rate _____ NF Additional Quantity _____ ac/ft

14. Limitation: _____ af/yr at _____ gpm (_____ cfs) when combined with file number(s) _____
 Limitation: _____ af/yr at _____ gpm (_____ cfs) when combined with file number(s) _____

15. 5YR Allocation: Allocation Type _____ Start Year _____ 5 YR Amount _____ Amount Unit _____ Base Acres _____ Comment _____

16. Place of Use CHK MOD DEL ENT PUSE S T R ID	NE¼				NW¼				SW¼				SE¼				Total	Owner	Chg?	Overlap Files
	NE ¼	NW ¼	SW ¼	SE ¼	NE ¼	NW ¼	SW ¼	SE ¼	NE ¼	NW ¼	SW ¼	SE ¼	NE ¼	NW ¼	SW ¼	SE ¼				
CHK 23128																				

Base Acres: **Year:** **Minimum Reasonable Quantity:**
 Comments:

Garden City Field Office
4532 W. Jones, Suite B
Garden City, KS 67846



Phone: 620-276-2901
Fax: 620-276-9315
www.agriculture.ks.gov

Mike Beam, Secretary

Laura Kelly, Governor

June 29, 2021

ROCK ORMISTON
303 MAIN ST
KISMET, KS 67859-9612

RE: Water Right, File No. 24239

Dear Sir:

Enclosed is an executed by the designee of the Chief Engineer, Division of Water Resources, Kansas Department of Agriculture, approving the application for change under the above referenced file number.

Your attention is directed to the enclosures and to the terms, conditions, and limitations specified in the approval for change. Conditions of this approval are that an acceptable water flow meter must be installed on the diversion works authorized under the referenced file number and meet current specifications. Please return the required notification of completion of the diversion works and installation of the required meter as soon as these actions are completed.

Since the order modifies the original document referred to above, it should be recorded with the Register of Deeds as other instruments affecting real estate.

The abandoned well must be plugged in accordance with the requirements of Article 30 of the Rules and Regulations as adopted by the Kansas Department of Health and Environment

Should you have any questions, please feel free contact this office. If you would prefer, you could arrange an appointment for additional assistance.

Sincerely,

A handwritten signature in blue ink, appearing to read "Michael A. Meyer".

Michael A. Meyer
Water Commissioner

MAM
enclosures

pc: KENDRA THOMASON
GMD3

CERTIFICATE OF SERVICE

On this 29th day of June 2021, I hereby certify that the foregoing Approval of Application for Change in Point of Diversion, Water Right, File No. 24,239 dated 29th day of June 2021 was mailed postage prepaid, first class, US mail to the following:

ROCK ORMISTON
303 MAIN ST
KISMET, KS 67859-9612
Pc:

CLINT & KENDRA THOMASON
PO BOX 1068
ELKHART, KS 67950

GROUNDWATER MANAGEMENT DISTRICT NO. 3



Division of Water Resources Staff

Submit completed application to:
 Kansas Department of Agriculture
 Division of Water Resources
 Field Office for your area.
 Call for address:

Topeka -- (785) 296-5733
 Stafford -- (620) 234-5311
 Stockton -- (785) 425-6787
 Garden City -- (620) 276-2901
<http://agriculture.ks.gov/dwr>

DWR FIELD OFFICE APPLICATION FOR APPROVAL TO CHANGE THE PLACE OF USE AND/OR THE POINT OF DIVERSION



STATE OF KANSAS

Filing Fee Must Accompany the Application, K.S.A. 82a-708b(b), as amended.
 Fee Schedule is on the third page of this application form.

Paragraph Nos. 1, 2, 3 & 5 must be completed. Complete all other applicable portions. If change in point of diversion is greater than 100 feet, or if place of use will be changed, include a topographic map or detailed plat showing the authorized and proposed point(s) of diversion and/or place of use.

File No. 24239

RECEIVED
 11:50 AM
 JUN 16 2021

1. Application is hereby made for approval of the Chief Engineer to change the (check one or both):

Place of Use Point of Diversion

under the water right which is the subject of this application in accordance with the conditions described below.

The source of supply is: Groundwater Surface water

Garden City Field Office
 Division of Water Resources

2. Name and address of Applicant: CLINT & KENDRA THOMASON

PO BOX 1068 ELKHART, KS. 67950

Phone Number: () Email address: _____

Name and address of Water Use Correspondent: ROCK ORMISTON

303 MAIN ST. KISMET, KS. 67859

Phone Number: (620)629 3979 Email address: _____

3. The presently authorized place of use is:

Owner of Land --- NAME: NO CHANGE

ADDRESS: _____

(If there is more than one landowner, attach supplemental sheets as necessary.)

Sec.	Twp.	Range	NE¼				NW¼				SW¼				SE¼				TOTAL ACRES		
			NE¼	NW¼	SW¼	SE¼	NE¼	NW¼	SW¼	SE¼	NE¼	NW¼	SW¼	SE¼	NE¼	NW¼	SW¼	SE¼			

4. If this application is for a change in place of use, it is proposed that the place of use be changed to:

Owner of Land --- NAME: NO CHANGE

ADDRESS: _____

(If there is more than one landowner, attach supplemental sheets as necessary.)

Sec.	Twp.	Range	NE¼				NW¼				SW¼				SE¼				TOTAL ACRES			
			NE¼	NW¼	SW¼	SE¼	NE¼	NW¼	SW¼	SE¼	NE¼	NW¼	SW¼	SE¼	NE¼	NW¼	SW¼	SE¼				

For Office Use Only: Code _____ Fee \$ 200.00 TR # _____ Receipt Date 6-16-21 Check # 8992

5. **Presently authorized point of diversion:**
 One in the NW Quarter of the SW Quarter of the NE Quarter of Section 15, Township 33 South, Range 33 W, in SEWARD County, Kansas, 3930 feet North 4290 feet West of Southeast corner of section. Authorized Rate 710 GPM Authorized Quantity 264 AF Depth of well 380 (feet)
(DWR use only: Computer ID No. 1 GPS _____ feet North _____ feet West)
 This point will not be changed This point will be changed as follows: No change, point better described with GPS as follows:
Proposed point of diversion: (Complete only if change is requested or if existing point is better described by GPS)
 One in the NW Quarter of the SW Quarter of the NW Quarter of Section 15, Township 33 South, Range 33 W, in SEWARD County, Kansas, 3363 feet North 5049 feet West of Southeast corner of section. Proposed Rate _____ Proposed Quantity _____ Proposed well depth (feet) 652.
 This point is: Additional Well Geo Center List other water rights that will use this point _____.

6. **Presently authorized point of diversion:**
 One in the _____ Quarter of the _____ Quarter of the _____ Quarter of Section _____, Township _____ South, Range _____ (E/W), in _____ County, Kansas, _____ feet North _____ feet West of Southeast corner of section. Authorized Rate _____ Authorized Quantity _____ Depth of well _____ (feet)
(DWR use only: Computer ID No. _____ GPS _____ feet North _____ feet West)
 This point will not be changed This point will be changed as follows: No change, point better described with GPS as follows:
Proposed point of diversion: (Complete only if change is requested or if existing point is better described by GPS)
 One in the _____ Quarter of the _____ Quarter of the _____ Quarter of Section _____, Township _____ South, Range _____ (E/W), in _____ County, Kansas, _____ feet North _____ feet West of Southeast corner of section. Proposed Rate _____ Proposed Quantity _____ Proposed well depth (feet) _____.
 This point is: Additional Well Geo Center List other water rights that will use this point _____.

7. The changes herein are desired for the following reasons?
 (please be specific) Lack of production on current
Location, move back to old completed well

8. If a well, is the test hole log attached? Yes No

9. The change(s) (was)(will be) completed by?
ASAP

10. If the point of diversion is a well:
 (a) What are you going to do with the old well?
To be capped
 (b) When will this be done? _____

11. Groundwater Management District recommendation attached?
 Yes No

12. Assisted by GCFO/DWR

13a. If the proposed point of diversion will be relocated more than 300 feet but within 2,640 feet of the existing point of diversion, attach a topographic map or aerial photograph. For groundwater sources, show all wells (including domestic) within one-half mile of the proposed point of diversion and the names and mailing addresses of the owners. For surface water sources, show the names and addresses of the landowner(s) one-half mile downstream and one-half mile upstream from your property lines

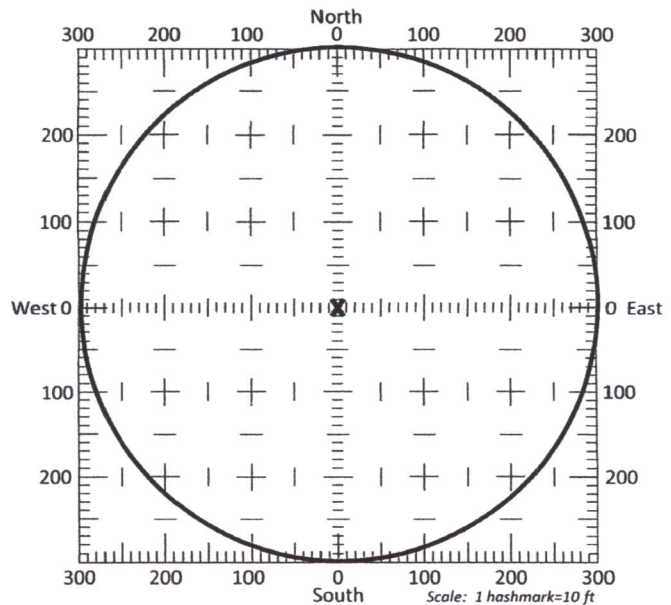

13b. If the proposed point of diversion will be relocated within a 300 foot radius of the existing point of diversion, indicate its location on the diagram shown above in relation to the existing point of diversion. The proposed point of diversion must be located within the circle shown above. **(PLEASE NOTE: The "X" in center of diagram above represents the presently authorized point of diversion.)**

14. If the proposed groundwater point of diversion is 300 or fewer feet from the existing point of diversion, complete the following:

- (a) Does the undersigned represent all owners of the currently authorized place(s) of use identified in this application?
 Yes No (If no, all owners must sign this application.)
- (b) Will the ownership interest of any owner of the currently authorized place(s) of use identified in this application be adversely affected if this application is approved as requested?
 Yes No (If yes, all owners must sign this application.)
- (c) If this application is not approved expeditiously, will there be substantial damage to property, public health or safety?
 Yes No (If no, all owners must sign this application.)

If the application proposes a surface water change in point of diversion, a groundwater change in point of diversion greater than 300 feet, or a change in place of use, the application must be signed by all owners of the currently authorized place of use, or their duly authorized agent (attach notarized statement authorizing representation).

I hereby verify, being first duly sworn upon my oath or affirmation and under penalty of perjury, that I am of lawful age and the owner, the spouse of the owner, or a duly authorized agent of the owner(s) to make this application on their behalf, in regards to the water right(s) to which this application pertains. I further verify that the statements contained in this application are true, correct and complete.

Dated at Eikhart, Kansas, this 15th day of June, 2021.

<u>Kendra Thomason</u> (Owner)	(Spouse)
<u>Kendra Thomason</u> (Please Print)	(Please Print)
(Owner)	(Spouse)
(Please Print)	(Please Print)
(Owner)	(Spouse)
(Please Print)	(Please Print)

State of Kansas }
County of Morton } SS

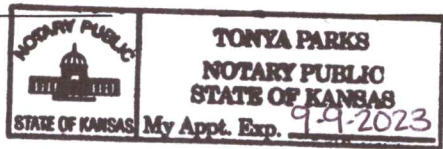

I hereby certify that the foregoing application was signed in my presence and sworn to before me this 15 day of June, 2021.

Tonya Parks
Notary Public

My Commission Expires 9-9-2023

ONLY COMPLETE APPLICATIONS WILL BE PROCESSED. To be complete, all of the applicable portions of the application form must be completed with accurate information; maps, if necessary, must be included; signatures of all the appropriate owners' must be affixed to the application and notarized; and the appropriate fee must be paid.

FEE SCHEDULE

- Each application to change the place of use or the point of diversion under this section shall be accompanied by the application fee set forth in the schedule below: Make checks payable to: **Kansas Department of Agriculture**
- (1) Application to change a point of diversion 300 feet or less \$100
 - (2) Application to change a point of diversion more than 300 feet \$200
 - (3) Application to change the place of use \$200

SUMMARY ORDER APPROVING APPLICATION FOR CHANGE AND IMPOSING CONDITIONS

This Summary Order is issued under authority of K.S.A. 82a-708b, as amended, and K.A.R. 5-5-1, et seq. and other applicable provisions of the *Kansas Water Appropriation Law, K.S.A. 82a-701 et. seq.*, and rules and regulations promulgated thereunder. With the exception of those conditions expressly contained herein, this Summary Order does not change the terms, conditions and limitations of File No. 24239.

1. A change application was received on June 16, 2021 requesting that the place of use and / or point of diversion authorized under the above-referenced file number be changed as described in the application.
2. On and after the effective date of this summary order, the authorized place(s) of use shall be located substantially as shown on the topographic map accompanying the application to change the place of use. Applicable Not Applicable
3. The change in point of diversion shall not impair existing rights and shall be limited to the same source or sources of water as previously authorized. The point of diversion authorized by this summary order shall be located within a 50 foot radius of the authorized point(s) of diversion. Applicable Not Applicable
4. The point(s) of diversion described herein is administratively corrected to be more accurately described using the Global Positioning System (GPS), as described in the application. Applicable Not Applicable
5. The point(s) of diversion authorized herein shall not actually be located more than _____ feet from the previously authorized point(s) of diversion. Applicable Not Applicable
6. As required by K.A.R. 5-3-5d, if the works for diversion is a well with a diversion rate of 100 gallons per minute or more, a tube or other device suitable for making water level measurements shall be installed, operated and maintained in accordance with K.A.R. 5-6-13. Applicable Not Applicable
7. **The owner of the authorized place(s) of use shall properly install an acceptable water flow meter on or before December 31, 2021**, or before the first use of water, whichever occurs first. The water flow meter shall be installed, operated and maintained in accordance with K.A.R. 5-1-4 through 5-1-12. As required by K.S.A. 82a-732, as amended, and K.A.R. 5-3-5e, the owner shall maintain records and report the reading of the water flow meter and the total quantity of water diverted annually to the Chief Engineer by March 1 following the end of each calendar year. Applicable Not Applicable
8. **Installation of the works for diversion of water shall be completed on or before December 31, 2021**, or within any authorized extension of time. By March 1, 2022 the applicant shall notify the Chief Engineer that construction of the works for diversion has been completed, on the form provided by the Chief Engineer, as required by K.A.R. 5-8-4e. Applicable Not Applicable
9. **The completed well log shall be submitted with the required notice.** Applicable Not Applicable *existing*
10. All diversion works into which any type of chemical or other foreign substance will be injected into the water shall be equipped with an in-line, automatic, quick-closing check valve capable of preventing pollution of the source of the water supply. The check valve(s) shall be installed, operated and maintained in accordance with K.A.R. 5-3-5c. Applicable Not Applicable
11. Additional Conditions are attached. Yes No
12. In accordance with K.S.A. 82a-708a, as amended, and K.A.R. 5-5-14, all of the owners of the authorized place(s) of use of water appropriated under the above-referenced file number are responsible for compliance with its terms, conditions and limitations, as amended and/or supplemented by this Summary Order, and with applicable provisions of the *Kansas Water Appropriation Law* and the *Rules and Regulations* promulgated thereunder. Failure to comply with these provisions may result in civil penalties pursuant to K.S.A. 82a-737, as amended, and/or the suspension or revocation and dismissal of the water or appropriation right or any other enforcement actions authorized by law.

Administrative Appeal and Effective Date of Order

If you are aggrieved by this order, pursuant to K.S.A. 82a-1901, you may request an evidentiary hearing before the Chief Engineer or request administrative review by the Secretary of Agriculture. A request for hearing by the Chief Engineer must be filed within **15 days** of service of this Order and a request for administrative review by the Secretary must be filed within **30 days** pursuant to K.S.A. 77-531. Any request for administrative review must state a basis for review pursuant to K.S.A. 77-527. File any request with **Kansas Department of Agriculture, Legal Division, 1320 Research Park Drive, Manhattan, KS 66502**. Failure to timely request a hearing or review may preclude review under the Kansas Judicial Review Act.

For Use by Register of Deeds

FOR OFFICE USE ONLY

**APPLICATION APPROVED AND
SUMMARY ORDER ISSUED**

By: Michael A. Meyer
Duly Authorized Designee of the Chief Engineer

(Print Name): MICHAEL A. MEYER
Division of Water Resources - Kansas Department of Agriculture

Date of Issuance: June 29, 2021

State of Kansas)

County of Finney) SS

Acknowledged before me on June 29, 2021

by Michael A. Meyer

Signature: Julie Jones
Notary Public

My commission expires:



Point of Diversion Change WR'(s) 24,239

T33S R33W Section 15

Seward Co

Distances are estimated on rough
 topographic base and/or GPS submitted by customer, is sole responsibility of customer or agent to select location for test hole(s)
 Distances from surrounding PD(s) & 1/2 mile
 radius Authorized PD.

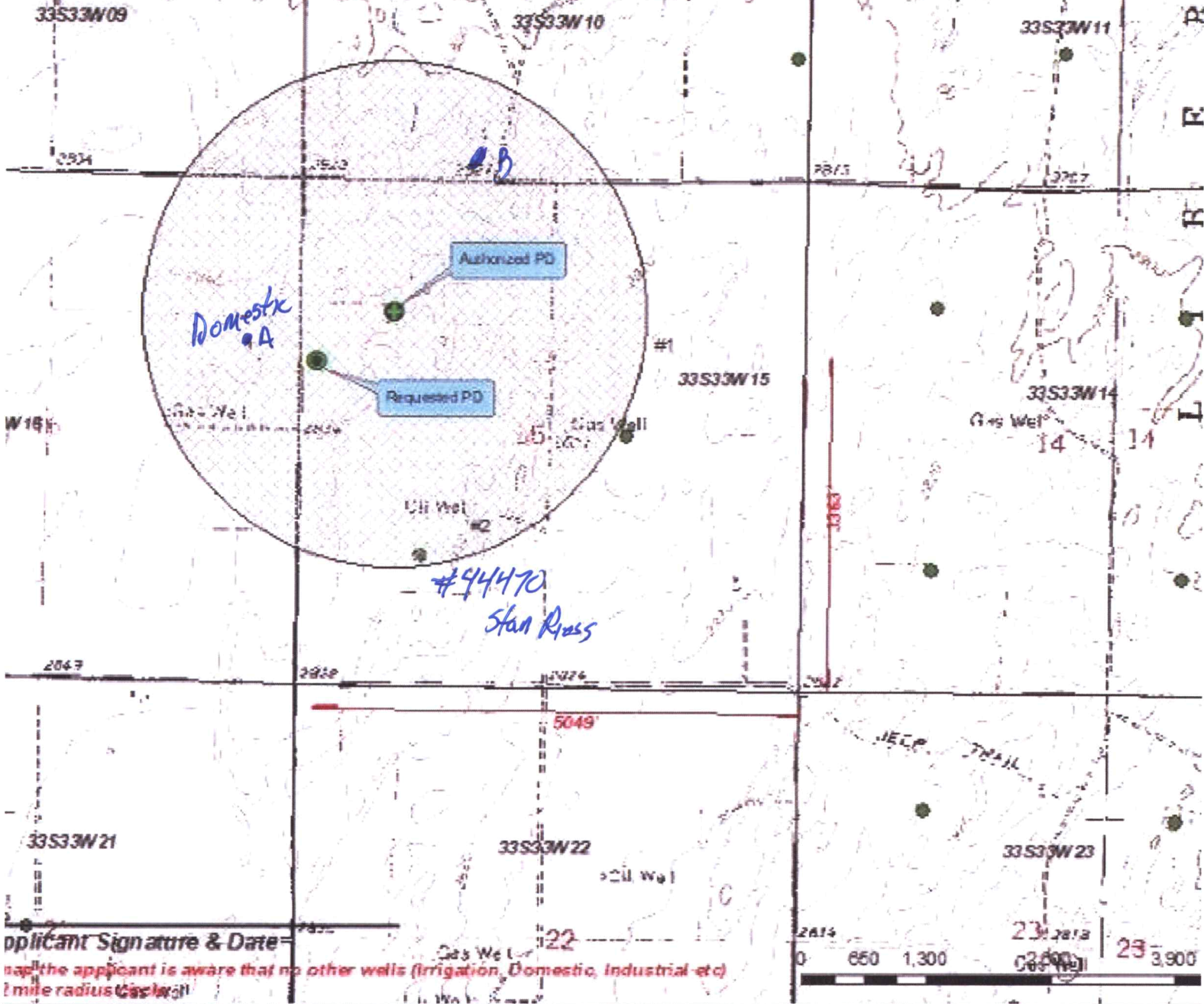

Applicant Signature & Date

The applicant is aware that no other wells (irrigation, Domestic, Industrial, etc) within 1/2 mile radius of the well.

Authorized PD
 Requested PD
 Point of Diversion
 1/2 Mile Radius
 Water Right w/in 1/2 mile
 Well w/in 1/2 mile
 Authorized PU
 Requested PD

Water Right w/in 1/2 mile & Owner (if apply)

- #1 Water Right No
- #2 Water Right No 44470

Domestic well w/in 1/2 mile & Owner (if apply)

- + A - Domestic well
- Matthew + Lindsay Fitzgerald
 6981 Road 20
 Moscow KS 67452-5231
- B - Lindsay Wright
 PO Box 356 Sublette KS 67877

WATER WELL RECORD

Form WWC-5

Division of Water Resources App. No.

24,239

1 LOCATION OF WATER WELL: County: Seward	Fraction ¼ NW ¼ SW ¼ NW ¼	Section Number 15	Township No. T 33 S	Range Number R 33 <input type="checkbox"/> E <input checked="" type="checkbox"/> W
--	------------------------------	----------------------	------------------------	---

Street/Rural Address of Well Location; if unknown, distance & direction from nearest town or intersection: If at owner's address, check here approx 7.6 miles northeast of Liberal, KS

Global Positioning System (GPS) information:
 Latitude: .37.17932..... (in decimal degrees)
 Longitude: 100.90409..... (in decimal degrees)
 Elevation: .2812.....
 Datum: WGS 84, NAD 83, NAD 27
 Collection Method:
 GPS unit (Make/Model:)
 Digital Map/Photo, Topographic Map, Land Survey
 Est. Accuracy: <3 m, 3-5 m, 5-15 m, >15 m

2 WATER WELL OWNER: Clint Thomason
 RR#, Street Address, Box #: PO Box 1068
 City, State, ZIP Code : Elkhart, KS 67950

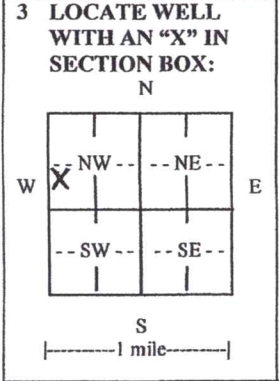

4 DEPTH OF COMPLETED WELL 652..... ft.

Depth(s) Groundwater Encountered (1)..... ft. (2)..... ft. (3)..... ft.

WELL'S STATIC WATER LEVEL.. 236..... ft. below land surface measured on mo/day/yr. 5/14/11.....

Pump test data: Well water was... 4.18..... ft. after..... 4..... hours pumping... 400..... gpm

EST. YIELD..... gpm. Well water was..... ft. after..... hours pumping..... gpm

Bore Hole Diameter 16..... in. to 652..... ft., and in. to ft.

WELL WATER TO BE USED AS: Public water supply Geothermal Injection well
 Domestic Feedlot Oil field water supply Dewatering Other (Specify below)
 Irrigation Industrial Domestic-lawn & garden Monitoring well

Was a chemical/bacteriological sample submitted to Department? Yes No

If yes, mo/day/yr sample was submitted.....

Water well disinfected? Yes No

5 TYPE OF CASING USED: Steel PVC Other

CASING JOINTS: Glued Clamped Welded Threaded

Casing diameter 16..... in. to 652..... ft., Diameter in. to ft., Diameter in. to ft.

Casing height above land surface 12..... in., Weight 42.09..... lbs./ft., Wall thickness or gauge No. 0.250.....

TYPE OF SCREEN OR PERFORATION MATERIAL:
 Steel Stainless Steel PVC Other (Specify)
 Brass Galvanized Steel None used (open hole)

SCREEN OR PERFORATION OPENINGS ARE:
 Continuous slot Mill slot Gauze wrapped Torch cut Drilled holes None (open hole)
 Louvered shutter Key punched Wire wrapped Saw cut Other (specify)

SCREEN-PERFORATED INTERVALS: From 235..... ft. to 355..... ft., From 418..... ft. to 448..... ft.
 From 505..... ft. to 645..... ft., From ft. to ft.

GRAVEL PACK INTERVALS: From ft. to ft., From ft. to ft.
 From ft. to ft., From ft. to ft.

6 GROUT MATERIAL: Neat cement Cement grout Bentonite Other

Grout Intervals: From 0..... ft. to 20..... ft., From ft. to ft., From ft. to ft.

What is the nearest source of possible contamination:
 Septic tank Lateral lines Pit privy Livestock pens Insecticide storage Other (specify below)
 Sewer lines Cesspool Sewage lagoon Fuel storage Abandoned water well
 Watertight sewer lines Seepage pit Feedyard Fertilizer storage Oil well/gas well None Detected

Direction from well Distance from well

FROM	TO	LITHOLOGIC LOG	FROM	TO	LITHO. LOG (cont.) or PLUGGING INTERVALS
0	2	top soil	283	308	fine to med sand and some clay beds
2	13	brown sandy clay	308	322	fine-med & some coarse gravel mix
13	93	fine sand	322	345	fine sand, some clay mix
93	108	brown sandy clay some calicho beds	345	355	fine-med coarse grvl some clay beds
108	200	fine to med coarse sand	355	360	gray clay
200	217	fine-med & some coarse grvl mix	360	415	blue clv + spstne blk shale ledges
217	222	brown sandy clay	415	448	brown sandstone
222	243	fine to med sand, some clay mix	448	505	blk shale spstne few sndstne beds
243	271	fine to med sand	505	645	sandstone and sahle soapstone mix
271	283	gray + brwn clay lime rock ledges	645	650	red bed

7 CONTRACTOR'S OR LANDOWNER'S CERTIFICATION: This water well was constructed, reconstructed, or plugged under my jurisdiction and was completed on (mo/day/year) 5/15/11..... and this record is true to the best of my knowledge and belief. Kansas Water Well Contractor's License No. 145..... This Water Well Record was completed on (mo/day/year) 6/9/11..... under the business name of Hydro Resources..... by (signature) *Blaine J. Rieckmann*.....

INSTRUCTIONS: Use typewriter or ball point pen. PLEASE PRESS FIRMLY and PRINT clearly. Please fill in blanks and check the correct answers. Send three copies (white, blue, pink) to Kansas Department of Health and Environment, Bureau of Water, Geology Section, 1000 SW Jackson St., Suite 420, Topeka, Kansas 66612-1367. Telephone 785-296-5522. Send one copy to WATER WELL OWNER and retain one for your records. Include fee of \$5.00 for each constructed well. Visit us at <http://www.kdheks.gov/waterwell/index.html>.

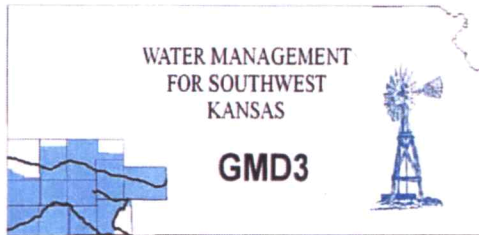

Southwest Kansas
Groundwater Management District No. 3
2009 E. Spruce Street
Garden City, Kansas 67846
(620) 275-7147 phone (620) 275-1431 fax
www.gmd3.org

June 29, 2021

Michael A. Meyer
Division of Water Resources
4532 W Jones Ave., Suite B
Garden City, Kansas 67846

RE: Application for Change in Point of Diversion
Water Right, File No. 24239

Dear Mike:

We have completed a review of the application for the above referenced water right. The proposed change in point of diversion is in accordance with current area rules, K.A.R. 5-23-3, as it pertains to distance moved and minimum spacing to neighboring wells.

Well evaluations were conducted to estimate possible effects of the proposal on the supply of other wells with water rights prior to the proposal per K.S.A. 82a-708b, and the draft revised management program. Under K.S.A. 82a-708b, an applicant requesting a change in point of diversion must demonstrate to the chief engineer that any proposed change is reasonable and will not impair. The enclosed report is an analysis performed by the GMD on behalf of our membership. Under this analysis, the proposed change is considered to be reasonable and unlikely to impair if either the net in-season well-to-well effect of the proposed change is less than a strict maximum allowable threshold (4.0 ft in cases where saturated thickness is greater than 200 ft), or if no well with a net well-to-well effect exceeding the threshold is identified as critical. Critical wells are identified as wells that are expected to either lose or greatly diminish water supply over the next 25 years. The attached review information is based on a Theis analysis using inputs from the GMD3 aquifer model, which is considered to be the best information on well and aquifer data readily and easily available to the public. If either the applicant or the neighbors believe they have better data that might change the result of the analysis, they should contact GMD3. Conclusions of the well analysis may change if better information on well and aquifer data can be made available.

Every neighboring well within 1 mile of the proposed move was evaluated. Evaluations showed that none of the neighboring wells exceeded the net effect above the maximum allowable threshold. Our office received no comments of concern from neighboring well owners. Therefore, GMD3 sees this move as reasonable and therefore recommend that the application be approved. If aquifer conditions change or there is a change to the water right in the future, we would be happy to evaluate the effects at that time.

Thank you for the opportunity to review the applications and to provide a recommendation. If you have any questions, please don't hesitate to contact us.

Sincerely,

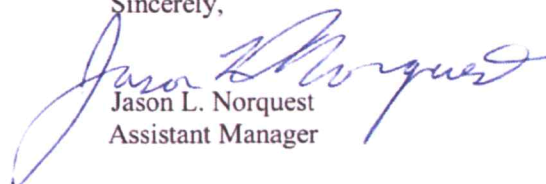
Jason L. Norquest
Assistant Manager

RECEIVED

JUN 29 2021

Garden City Field Office
Division of Water Resources

GMD3 Change Review

File No(s): 24239. DWR office: GC.

App filed to change: PD.

Is Landowner(s) correct in WRIS: Clint & Kendra Thomason.

If NO, is documentation included?

Is Water Use Correspondent correct in WRIS? .

If NO, is documentation included?

Regulation(s) Reviewed: KAR 5-23-3

Point of diversion ID No(s) being changed.

	ft. North	ft. West	
Authorized PD	3930	4290	Sect 15-33-33
Proposed PD	3363	5049	
Difference	567 s	-759 w	
$a^2 + b^2 = c^2$	321489	576081	947.4017 foot move SW

GPS for proposed PD: Lat: 37.17932 Long: -100.90409.

Is proposed PD stacking on existing WRs? No.

Is Proposed PU overlapping existing WRs? No Change.

Neighboring certified well(s) notified: .

Name Reiss Farmland LP %Stan Reiss (44470, 24980, 42856).

Address 20494 Highway 160.

Zip Plains, KS 67869.

Email: clint@southwestff.com. Phone: 620-563-7212.

Name Rustin & Ashley Wettstein (35096).

Address 1701 N Kansas Ave, Ste 102.

Zip Liberal, KS 67901.

Email: rwettstein76@yahoo.com. Phone: 620-629-3301.

Domestic well(s) notified: .

Name Lindsay Wright Rev Liv TR (SW 10-33-33).

Address PO Box 356.

Zip Sublette, KS 67877.

Name Isaak & Helena Bergen (SW 9-33-33).

Address 9449 Road 14.

Zip Liberal, KS 67901.

Name Ramon & Margaretha Fehr (SW 9-33-33).

Address 9447 Road 14.

Zip Liberal, KS 67901.

GMD3 Change Review

Name Carl & Patriciaa Shoemate (SW 9-33-33).
Address 9083 Road 14.
Zip Liberal, KS 67901-6036.

Name Charles Tryon (NW 16-33-33).
Address 13911 Hwy 83.
Zip Liberal, KS 67901.

Name Larry & Paula Swan (NE 21-33-33).
Address 9566 Road 13.
Zip Liberal, KS 67901.

Name Esther Swan (NE 21-33-33).
Address RR 2 Box 85.
Zip Liberal, KS 67901.

Name Matthew & Lindsay Fitzgerald (NE 16-33-33).
Address 6891 Road 20.
Zip Moscow, KS 67952-5231.

Base Acres: __.

Perfected Acres: __.

Irr. Return-Flow __%

Proposed move is moving the PD back to the location it came from after the approval of a change app in 2012.

Also had a change app approved in 2011, moving from this proposed location to the current location.

2439 authorized 264AF @ 710gpm.

2014 inspection calculated flow of 376gpm. Not running during 2018 inspection.

2012-2020 Avg Use Reported: 157.172AF (No rates reported)

Is a waiver needed: Move is less than half mile and appears minimum spacing is met.

Analysis shows that possible effects are well within the guidelines and does not appear to create any critical wells.

Recommendation: After review of all available information, it appears the proposed change meets the current area rules. Proposed move would have minimal effects to neighboring wells. Staff therefore recommends approval of the application.



RECEIVED
JUN 29 2021
Garden City Field Office
Division of Water Resources

35096: Drawdown from current location = 0.29 ft
Drawdown from proposed location = 0.56 ft
Net drawdown = **0.3 ft**

Domestic 1: Drawdown from current location = 0.35 ft
Drawdown from proposed location = 0.64 ft
Net drawdown = **0.3 ft**

Domestic 2: Drawdown from current location = 0.32 ft
Drawdown from proposed location = 0.58 ft
Net drawdown = **0.3 ft**

Domestic 3: Drawdown from current location = 0.56 ft
Drawdown from proposed location = 0.94 ft
Net drawdown = **0.4 ft**

Domestic 4: Drawdown from current location = 0.59 ft
Drawdown from proposed location = 0.80 ft
Net drawdown = **0.2 ft**

Domestic 5: Drawdown from current location = 0.72 ft
Drawdown from proposed location = 1.85 ft
Net drawdown = **1.1 ft**

Domestic 6: Drawdown from current location = 0.29 ft
Drawdown from proposed location = 0.52 ft
Net drawdown = **0.2 ft**

Domestic 7: Drawdown from current location = 0.32 ft
Drawdown from proposed location = 0.52 ft
Net drawdown = **0.2 ft**

Domestic 8: Drawdown from current location = 0.30 ft
Drawdown from proposed location = 0.58 ft
Net drawdown = **0.3 ft**

Net drawdown does not exceed the drawdown allowance of 4.0 ft for any well within 1 mile of the proposed location. Therefore, critical well analysis is not necessary.

RECEIVED
JUN 29 2021
Garden City Field Office
Division of Water Resources

Conclusion:

The proposed move is likely to create minimal effects on neighboring wells and is unlikely to cause impairment. GMD3 staff recommends approval of this proposal.

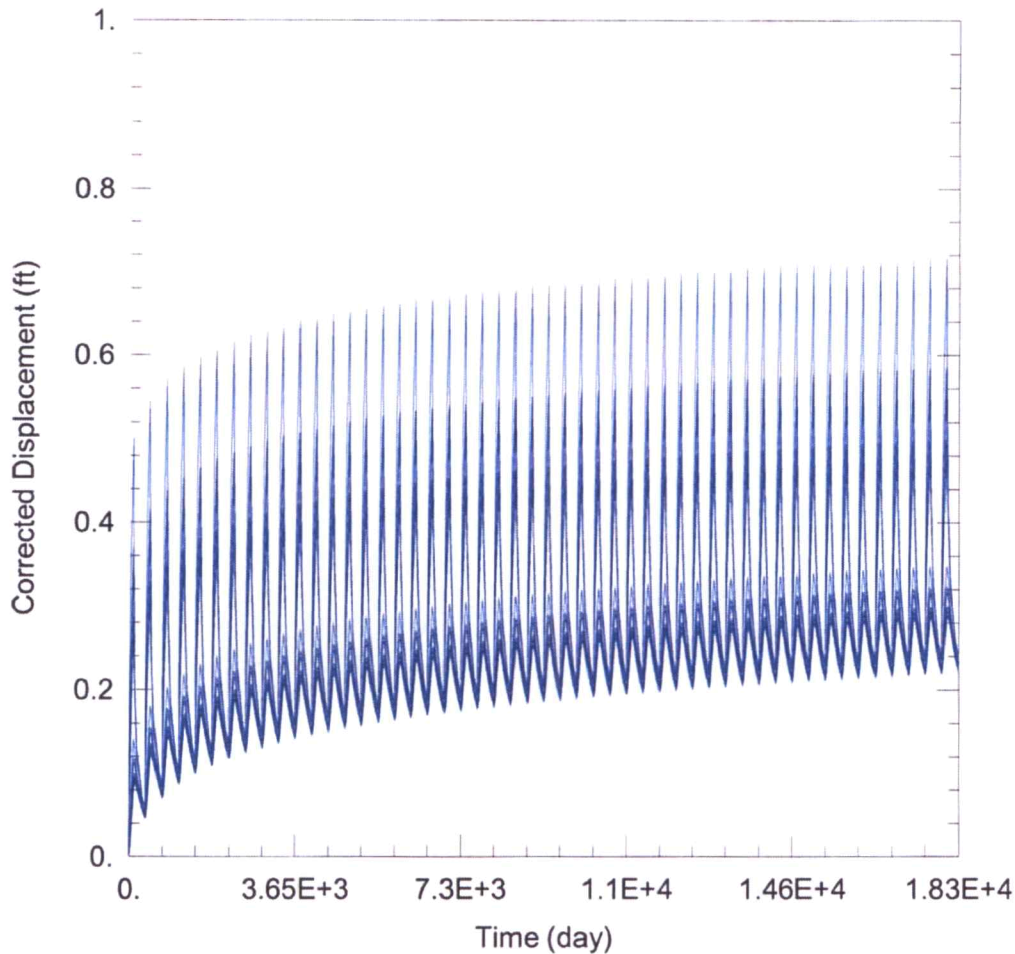

WELL TEST ANALYSIS

Data Set: C:\Users\trevora\Documents\2021_Moves\24239\24239 Current.aqt

Date: 06/21/21

Time: 14:40:34

PROJECT INFORMATION

Company: GMD 3

Project: 24239

Location: Seward County

RECEIVED
JUN 29 2021
 Garden City Field Office
 Division of Water Resources

WELL DATA

Pumping Wells

Well Name	X (ft)	Y (ft)
24239	-29704	111346

Observation Wells

Well Name	X (ft)	Y (ft)
□	-29704	111346
□ 24980 & 42856	-27229	110099
□ 44470	-29357	108805
□ 35096	-34631	108807
□ Domestic 1	-33723	113040
□ Domestic 2	-34385	113046
□ Domestic 3	-31078	113015
□ Domestic 4	-28930	113200
□ Domestic 5	-31072	111043
□ Domestic 6	-35374	112073
□ Domestic 7	-26435	107775
□ Domestic 8	-33045	107124

SOLUTION

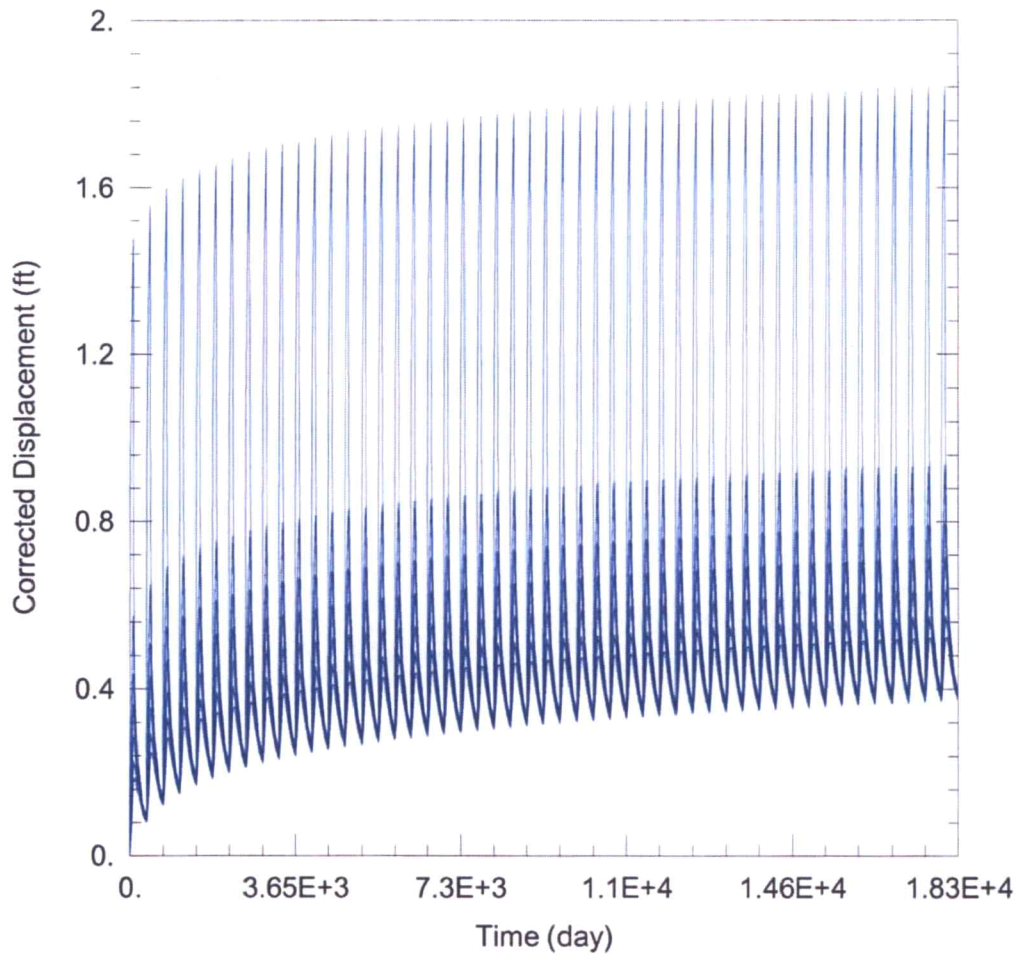

WELL TEST ANALYSIS

Data Set: C:\Users\trevora\Documents\2021_Moves\24239\24239 Proposed.aqt

Date: 06/21/21

Time: 14:40:28

PROJECT INFORMATION

Company: GMD 3

Project: 24239

Location: Seward County

WELL DATA

Pumping Wells

Well Name	X (ft)	Y (ft)
24239	-30488	110816

Observation Wells

Well Name	X (ft)	Y (ft)
□	-30488	110816
□ 24980 & 42856	-27229	110099
□ 44470	-29357	108805
□ 35096	-34631	108807
□ Domestic 1	-33723	113040
□ Domestic 2	-34385	113046
□ Domestic 3	-31078	113015
□ Domestic 4	-28930	113200
□ Domestic 5	-31072	111043
□ Domestic 6	-35374	112073
□ Domestic 7	-26435	107775
□ Domestic 8	-33045	107124

SOLUTION

Water Rights and Points of Diversion Within 1 mile of point defined as:

3363 Feet N and 5049 Feet W of the Southeast Corner of Section 15 Twp 33S Rng 33W
 Located at: 100.904091 West Longitude and 37.179319 North Latitude
 Both SURFACE WATER and GROUNDWATER

File Number	Use	ST	SR	Dist (ft)	Q4	Q3	Q2	Q1	FeetN	FeetW	Sec	Twp	Rng	ID	Batt	Auth_Quan	Add_Quan	
A__ AF	24239 00	IRR	NK	G* ←	936	--	NE	SW	NW	3930	4290	15	33	33W	1	1	264.00	264.00
A__ AF	24980 00	IRR	NK	G	3338	↙	SE	SW	NE	2650	1800	15	33	33W	2		198.00	198.00
A__ AF	35096 00	IRR	NK	G	4603	↙	--	NC	SW	1373	3888	16	33	33W	2	160'	260.00	260.00
A__ AF	42856 00	IRR	NK	G	3338	↙	SE	SW	NE	2650	1800	15	33	33W	2	230'	520.00	322.00
A__ AF	44470 00	IRR	NK	G	2307	↙	--	NC	SW	1355	3904	15	33	33W	4	210'	480.00	466.00

Total Net Quantities Authorized:	Direct	Storage
Total Requested Amount (AF) =	.00	.00
Total Permitted Amount (AF) =	.00	.00
Total Inspected Amount (AF) =	.00	.00
Total Pro_Cert Amount (AF) =	.00	.00
Total Certified Amount (AF) =	1510.00	.00
Total Vested Amount (AF) =	.00	.00
TOTAL AMOUNT (AF) =	1510.00	.00

Spacing Appears MET.

An * after the source of supply indicates a pending application for change under the file number.
 An * after the ID indicates a 15 AF exemption was granted under the file number.
 A "G" in the Batt column indicates the GEO CTR of a battery. A "B" indicates a well in the battery.
 The number in the Batt column is the number of wells in the battery.

Water Rights and Points of Diversion Within 1 mile of point defined as:

3363 Feet North and 5049 Feet West of the Southeast Corner of Section 15 Twp 33S Rng 33W
 Located at: 100.904091 West Longitude and 37.179319 North Latitude
 Both SURFACE WATER and GROUNDWATER
 WATER USE CORRESPONDENTS:

- > ROCK ORMISTON
- >
- > 303 MAIN ST
- > KISMET KS 67859
-
- > HATCHER LAND CO LP
- > 1701 N KANSAS AVE STE 102
- > LIBERAL KS 67901
-
- > RUSTIN P & ASHLEY L WETTSTEIN
- >
- > 3793 ROAD 9
- > LIBERAL KS 67901
-
- > HATCHER LAND CO LP
- > 1701 N KANSAS AVE STE 102
- > LIBERAL KS 67901
-
- > HATCHER LAND CO LP
- > 1701 N KANSAS AVE STE 102
- > LIBERAL KS 67901

24239 Applicant

24980 Reiss

25096

42856 Reiss

44470

*Reiss Farm land LP ? Sen Reiss
 Just Bought*

RECEIVED
JUN 29 2021
 Garden City Field Office
 Division of Water Resources

Meyer, Mike [KDA]

From: Meyer, Mike [KDA]
Sent: Thursday, June 24, 2021 8:30 AM
To: 'clint@southwestff.com'
Subject: letter
Attachments: 20210624081758344.pdf

clint, we tried to send a letter (attached) to that address. not sure if we got it correct or not, but if you have any aconcerners of Rock's (Thomason) well) in NE¼15-33-33W north of liberal moving to a new location west of current well along the west side of that section let me know. there is actually an old casing there drilled a few years ago that they never moved to, but now want to move to that location.

let me know

thanks

Michael A. Meyer, PG
Kansas Department of Agriculture
Division of Water Resources
Garden City Field Office
4532 W Jones Ave, Suite B
Garden City KS 67846
Lat 37.98820, Lon -100.944470
(620)-276-2901
mike.meyer@ks.gov

Garden City Field Office
4532 W. Jones, Suite B
Garden City, KS 67846



Phone: 620-276-2901
Fax: 620-276-9315
www.agriculture.ks.gov

Mike Beam, Secretary

Laura Kelly, Governor

June 17, 2021

REISS FARMLAND LP
Attn: STAN REISS
PO BOX 8
PLAINS, KS 67869-0008

RE: Water Right, File No. 24239

Dear Sir:

This is to advise you that Kendra Thomason has filed an application for approval of the Chief Engineer, Division of Water Resources, Kansas Department of Agriculture, to point of diversion under the above referenced application. An irrigation well is proposed to be relocated to an old existing well.

You can find the complete application posted by water right file number as referenced above at www.agriculture.ks.gov/divisions-programs/dwr/water-appropriation/notices

You are notified on this proposed point of diversion (well) so that you may furnish this office with any comments or other information you may want to submit. Such comments or other information must be received in this office within 15 days from the date of this letter.

Should you have any questions, please feel free to call this office. If you would prefer, an appointment could be arranged for additional assistance. Please refer to the file number when you contact us if you wish to discuss a specific file.

Sincerely,

A handwritten signature in black ink that reads "Michael A. Meyer". The signature is fluid and cursive.

Michael A. Meyer
Water Commissioner

MAM
Pc:

Groundwater Management District No. 3

SCANNED

Garden City Field Office
4532 W. Jones, Suite B
Garden City, KS 67846



Phone: 620-276-2901
Fax: 620-276-9315
www.agriculture.ks.gov

Mike Beam, Secretary

Laura Kelly, Governor

June 17, 2021

MATTHEW & LINDSAY FITZGERALD
6981 ROAD 20
MOSCOW KS 67952-5231

RE: Water Right, File No. 24239

Dear Sir:

This is to advise you that Kendra Thomason has filed an application for approval of the Chief Engineer, Division of Water Resources, Kansas Department of Agriculture, to point of diversion under the above referenced application. An irrigation well is proposed to be relocated to an old existing well.

You can find the complete application posted by water right file number as referenced above at www.agriculture.ks.gov/divisions-programs/dwr/water-appropriation/notices

You are notified on this proposed point of diversion (well) so that you may furnish this office with any comments or other information you may want to submit. Such comments or other information must be received in this office within 15 days from the date of this letter.

Should you have any questions, please feel free to call this office. If you would prefer, an appointment could be arranged for additional assistance. Please refer to the file number when you contact us if you wish to discuss a specific file.

Sincerely,

A handwritten signature in black ink, appearing to read "Michael A. Meyer".

Michael A. Meyer
Water Commissioner

MAM

Pc:

Groundwater Management District No. 3

SCANNED

Garden City Field Office
4532 W. Jones, Suite B
Garden City, KS 67846



Phone: 620-276-2901
Fax: 620-276-9315
www.agriculture.ks.gov

Mike Beam, Secretary

Laura Kelly, Governor

June 17, 2021

LINDAY WRIGHT REV TRUST
PO BOX 356
SUBLETTE KS 67877

RE: Water Right, File No. 24239

Dear Sir:

This is to advise you that Kendra Thomason has filed an application for approval of the Chief Engineer, Division of Water Resources, Kansas Department of Agriculture, to point of diversion under the above referenced application. An irrigation well is proposed to be relocated to an old existing well.

You can find the complete application posted by water right file number as referenced above at www.agriculture.ks.gov/divisions-programs/dwr/water-appropriation/notices

You are notified on this proposed point of diversion (well) so that you may furnish this office with any comments or other information you may want to submit. Such comments or other information must be received in this office within 15 days from the date of this letter.

Should you have any questions, please feel free to call this office. If you would prefer, an appointment could be arranged for additional assistance. Please refer to the file number when you contact us if you wish to discuss a specific file.

Sincerely,

A handwritten signature in cursive script that reads "Michael A. Meyer".

Michael A. Meyer
Water Commissioner

MAM

Pc:

Groundwater Management District No. 3

SCANNED

Garden City Field Office
4532 W. Jones, Suite B
Garden City, KS 67846



Phone: 620-276-2901
Fax: 620-276-9315
www.agriculture.ks.gov

Mike Beam, Secretary

Laura Kelly, Governor

June 17, 2021

SOUTHWEST KANSAS GROUNDWATER
MANAGEMENT DISTRICT NO. 3
2009 E SPRUCE ST
GARDEN CITY KS 67846

Re: Water Right, File No. 24239

Dear Mr. Norquest:

This is to advise you that Kendra Thomason, has filed an application for approval of the Chief Engineer, Division of Water Resources, Kansas Department of Agriculture, to change the point of diversion. The proposal is to move back to a previous location that already exists a well.

We are delaying action on the change applications to allow you time to review and provide a recommendation. Please submit a recommendation within 15 days from the date of this letter.

Thank you and as always feel free to contact this office at any time.

Sincerely,

A handwritten signature in blue ink that reads "Michael A. Meyer".

Michael A. Meyer
Water Commissioner

MAM
Enclosures