

Kansas Department of Agriculture
 Division of Water Resources
CHANGE: P/U WORKSHEET

1. File Number: 26261	2. Status Change Date:	3. Change Num: C1	4. Field Office: 04	5. GMD: 01
---------------------------------	------------------------	-----------------------------	-------------------------------	----------------------

6. Status: <input checked="" type="checkbox"/> Approved <input type="checkbox"/> Denied by DWR/GMD <input type="checkbox"/> Dismiss by Request/Failure to Return	7. Filing Date of Change: 11/5/21
--	---

8a. Applicant(s) Person ID **5067**
 New to system Add Seq# _____

FAIRLEIGH CORPORATION
207 E BELLEVUE
SCOTT CITY, KS 67871

8c. Landowner(s) Person ID _____
 New to system Add Seq# _____

8b. Landowner(s) Person ID _____
 New to system Add Seq# _____

8a

8d. WUC Person ID **64064**
 New to system Add Seq# _____

VULGAMORE FAMILY FARMS LLC
1550 W ROAD 70
SCOTT CITY, KS 67871

9. Documents and Enclosure(s): DWR Meter(s) Date to Comply: **12/31/22** N & P Date to Comply: **3/1/23**

Anti-Reverse Meter Meter Seal Check Valve N & P Form Water Tube Driller Copy H & E Letter

Conservation Plan Date Required: _____ Date Approved: _____ Date to Comply: _____

10. Use Made of Water From: _____ To: _____

Date Prepared: **11/23/21** By: **AM**
 Date Entered: _____ By: _____

File No. **26261** 11. County: **SC** Basin: **ARKANSAS RIVER** Stream: Formation Code: **211** Special Use:

12. Points of Diversion
 CHK
 MOD
 DEL PDIV
 ENT
 Qualifier S T R ID 'N 'W Comment (AKA Line) Rate gpm/cfs Quantity af/mgy Rate gpm/cfs Quantity af/mgy Overlap PD Files

CHK 27520

13. Storage: Rate _____ NF Quantity _____ ac/ft Additional Rate _____ NF Additional Quantity _____ ac/ft

14. Limitation: _____ af/yr at _____ gpm (_____ cfs) when combined with file number(s) _____
 Limitation: _____ af/yr at _____ gpm (_____ cfs) when combined with file number(s) _____

15. 5YR Allocation: Allocation Type _____ Start Year _____ 5 YR Amount _____ Amount Unit _____ Base Acres _____ Comment _____

16. Place of Use CHK MOD DEL ENT	PUSE	S	T	R	ID	NE¼				NW¼				SW¼				SE¼				Total	Owner	Chg?	Overlap Files
						NE¼	NW¼	SW¼	SE¼	NE¼	NW¼	SW¼	SE¼	NE¼	NW¼	SW¼	SE¼	NE¼	NW¼	SW¼	SE¼				
ENT 12821	19	20S	32W	2						40	L-1 39.42	L-2 39.48	40	40	L-3 39.52	L-4 39.58	40					318	8a	N	MULTIPLE
ENT 31443	25	20S	33W	3		40	34	22	40													136	8a	N	MULTIPLE
MOD 29962	30	20S	32W	3						40	L-1 39.61	L-2 39.63	40	40	L-3 39.65	L-4 39.67	40					318.56	8a	Y	MULTIPLE

Base Acres: Year: Minimum Reasonable Quantity:
 Comments: **OVERLAPPING PU FILES: 546; 7748; 25355; 23956-D1; 26261 & 27048 NOTE: COMBINE PU IDS 29962 (KEEP) & 32093 (DELETE)**

Garden City Field Office
4532 W. Jones, Suite B
Garden City, KS 67846



Phone: 620-276-2901
Fax: 620-276-9315
www.agriculture.ks.gov

Mike Beam, Secretary

Laura Kelly, Governor

November 24, 2021

FAIRLEIGH CORPORATION
207 E BELLEVUE
SCOTT CITY, KS 67871

RE: Filed Office Application for Change
Water Right, File Nos. 546; 7748; 23956-D1; 25355; 26261 & 27048

Dear Sir or Madam:

Enclosed is the order executed by the designee of the Chief Engineer, Division of Water Resources, Kansas Department of Agriculture, approving the application for change under the above referenced file numbers.

Your attention is directed to the enclosures and to the terms, conditions, and limitations specified in this approval for change. A condition of this approval is that an acceptable water flow meter must be installed on the diversion works authorized under the referenced file number and meet current specifications. Please return the required notification of completion of the diversion works and/or installation of the required meter as soon as these actions are completed.

Since the order modifies the original document referred to above, it should be recorded with the Register of Deeds as other instruments affecting real estate.

Should you have any questions, please feel free contact this office. If you would prefer, you could arrange an appointment for additional assistance.

Sincerely,

A handwritten signature in blue ink that reads "Austin J. McColloch".

Austin J. McColloch
Assistant Water Commissioner

AM:
enclosures

pc: GROUNDWATER MANAGEMENT DISTRICT NO. 1

CERTIFICATE OF SERVICE

On this 24th day of November, 2021, I hereby certify that the foregoing Approval of Application for Change in Place of Use, Water Right, File Nos. 546; 7,748; 23,956-D1; 25,355; 26,261 & 27,048 dated 24th day of November, 2021 was mailed postage prepaid, first class, US mail to the following:

FAIRLEIGH CORPORATION
207 E BELLEVUE
SCOTT CITY, KS 67871

Pc:

GROUNDWATER MANAGEMENT DISTRICT NO. 1



Division of Water Resources Staff

Submit completed application to:
 Kansas Department of Agriculture
 Division of Water Resources
 Field Office for your area.

Call for address:

Topeka -- (785) 296-5733
 Stafford -- (620) 234-5311
 Stockton -- (785) 425-6787
 Garden City -- (620) 276-2901
<http://agriculture.ks.gov/dwr>

DWR FIELD OFFICE APPLICATION FOR APPROVAL TO CHANGE THE PLACE OF USE AND/OR THE POINT OF DIVERSION



STATE OF KANSAS

Filing Fee Must Accompany the Application, K.S.A. 82a-708b(b), as amended.
 Fee Schedule is on the third page of this application form.

Paragraph Nos. 1, 2, 3 & 5 must be completed. Complete all other applicable portions. If change in point of diversion is greater than 100 feet, or if place of use will be changed, include a topographic map or detailed plat showing the authorized and proposed point(s) of diversion and/or place of use.

RECEIVED
 8:49 am
 NOV 05 2021

File No. 26.261

1. Application is hereby made for approval of the Chief Engineer to change the (check one or both):
 Place of Use Point of Diversion

Garden City Field Office
 Division of Water Resources

under the water right which is the subject of this application in accordance with the conditions described below.

The source of supply is: Groundwater Surface water

2. Name and address of Applicant: Fairleigh Corporation
PO Box 560, Scott City, KS 67871
 Phone Number: (620) 872-1111 Email address: gglunz@fairleigh.com
 Name and address of Water Use Correspondent: Vulgamore Family Farms, LLC
1550 W Road 70, Scott City, KS 67871
 Phone Number: (620) 872-5242 Email address: _____

3. The presently authorized place of use is:
 Owner of Land ---- NAME: Fairleigh Corporation
 ADDRESS: PO Box 560, Scott City, KS 67871
 (If there is more than one landowner, attach supplemental sheets as necessary.)

Sec.	Twp.	Range	NE¼				NW¼				SW¼				SE¼				TOTAL ACRES
			NE¼	NW¼	SW¼	SE¼	NE¼	NW¼	SW¼	SE¼	NE¼	NW¼	SW¼	SE¼	NE¼	NW¼	SW¼	SE¼	
30	20S	32W					40.00	L-1 39.61	L-2 39.63	40.00									159.24

4. If this application is for a change in place of use, it is proposed that the place of use be changed to:
 Owner of Land ---- NAME: Fairleigh Corporation
 ADDRESS: PO Box 560, Scott City, KS 67871
 (If there is more than one landowner, attach supplemental sheets as necessary.)

Sec.	Twp.	Range	NE¼				NW¼				SW¼				SE¼				TOTAL ACRES
			NE¼	NW¼	SW¼	SE¼	NE¼	NW¼	SW¼	SE¼	NE¼	NW¼	SW¼	SE¼	NE¼	NW¼	SW¼	SE¼	
19	20S	32W					40.00	L-1 39.42	L-2 39.48	40.00	40.00	L-3 39.52	L-4 39.58	40.00					318.00
30	20S	32W					40.00	L-1 39.61	L-2 39.63	40.00	40.00	L-3 39.65	L-4 39.67	40.00					318.56
25	20S	33W	40.00	34.00	22.00	40.00													136.00

For Office Use Only: Code _____ Fee \$ 200 TR # _____ Receipt Date 11-5-21 Check # 20192

5. **Presently authorized point of diversion:**
 One in the _____ Quarter of the _____ Quarter of the _____ Quarter of the _____
 of Section _____, Township _____ South, Range _____ (E/W),
 in _____ County, Kansas, _____ feet North _____ feet West of Southeast corner of section.
 Authorized Rate _____ Authorized Quantity _____ Depth of well _____ (feet)
(DWR use only: Computer ID No. _____ GPS _____ feet North _____ feet West)
 This point will not be changed This point will be changed as follows: No change, point better described with GPS as follows:
Proposed point of diversion: (Complete only if change is requested or if existing point is better described by GPS)
 One in the _____ Quarter of the _____ Quarter of the _____ Quarter of the _____
 of Section _____, Township _____ South, Range _____ (E/W),
 in _____ County, Kansas, _____ feet North _____ feet West of Southeast corner of section.
 Proposed Rate _____ Proposed Quantity _____ Proposed well depth (feet) _____
 This point is: Additional Well Geo Center List other water rights that will use this point _____

6. **Presently authorized point of diversion:**
 One in the _____ Quarter of the _____ Quarter of the _____ Quarter of the _____
 of Section _____, Township _____ South, Range _____ (E/W),
 in _____ County, Kansas, _____ feet North _____ feet West of Southeast corner of section.
 Authorized Rate _____ Authorized Quantity _____ Depth of well _____ (feet)
(DWR use only: Computer ID No. _____ GPS _____ feet North _____ feet West)
 This point will not be changed This point will be changed as follows: No change, point better described with GPS as follows:
Proposed point of diversion: (Complete only if change is requested or if existing point is better described by GPS)
 One in the _____ Quarter of the _____ Quarter of the _____ Quarter of the _____
 of Section _____, Township _____ South, Range _____ (E/W),
 in _____ County, Kansas, _____ feet North _____ feet West of Southeast corner of section.
 Proposed Rate _____ Proposed Quantity _____ Proposed well depth (feet) _____
 This point is: Additional Well Geo Center List other water rights that will use this point _____

7. The changes herein are desired for the following reasons?
 (please be specific) Completely overlap the places of use
relating to File Nos. 546, 7748, 25355, 23956-D1, 26261
and 27048.

8. If a well, is the test hole log attached? Yes No

9. The change(s) (was)(will be) completed by?
Upon approval.

10. If the point of diversion is a well:
 (a) What are you going to do with the old well?

 (b) When will this be done? _____

11. Groundwater Management District recommendation attached?
 Yes No

12. Assisted by _____

13a. If the proposed point of diversion will be relocated more than 300 feet but within 2,640 feet of the existing point of diversion, attach a topographic map or aerial photograph. For groundwater sources, show all wells (including domestic) within one-half mile of the proposed point of diversion and the names and mailing addresses of the owners. For surface water sources, show the names and addresses of the landowner(s) one-half mile downstream and one-half mile upstream from your property lines

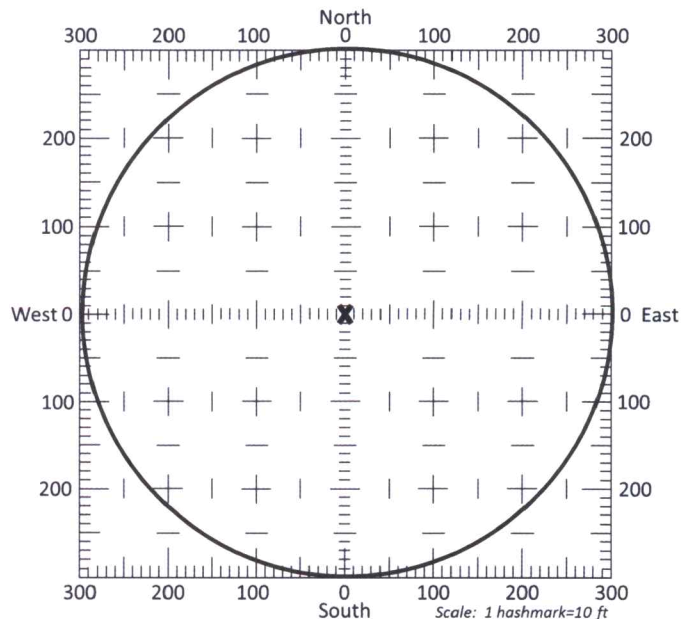

13b. If the proposed point of diversion will be relocated within a 300 foot radius of the existing point of diversion, indicate its location on the diagram shown above in relation to the existing point of diversion. The proposed point of diversion must be located within the circle shown above. **(PLEASE NOTE: The "X" in center of diagram above represents the presently authorized point of diversion.)**

14. If the proposed groundwater point of diversion is 300 or fewer feet from the existing point of diversion, complete the following:
- (a) Does the undersigned represent all owners of the currently authorized place(s) of use identified in this application?
 Yes No (If no, all owners must sign this application.)
 - (b) Will the ownership interest of any owner of the currently authorized place(s) of use identified in this application be adversely affected if this application is approved as requested?
 Yes No (If yes, all owners must sign this application.)
 - (c) If this application is not approved expeditiously, will there be substantial damage to property, public health or safety?
 Yes No (If no, all owners must sign this application.)

If the application proposes a surface water change in point of diversion, a groundwater change in point of diversion greater than 300 feet, or a change in place of use, the application must be signed by all owners of the currently authorized place of use, or their duly authorized agent (attach notarized statement authorizing representation).

I hereby verify, being first duly sworn upon my oath or affirmation and under penalty of perjury, that I am of lawful age and the owner, the spouse of the owner, or a duly authorized agent of the owner(s) to make this application on their behalf, in regards to the water right(s) to which this application pertains. I further verify that the statements contained in this application are true, correct and complete.

Dated at Scott City, Kansas, this 2nd day of November, 2021.

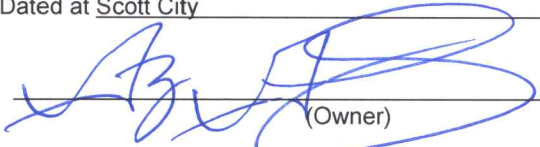

 (Owner)

 (Spouse)

Greg Glunz, CEO, Fairleigh Corporation

 (Please Print)

 (Please Print)

 (Owner)

 (Spouse)

 (Please Print)

 (Please Print)

 (Owner)

 (Spouse)

 (Please Print)

 (Please Print)

State of Kansas }
 County of Spott } SS

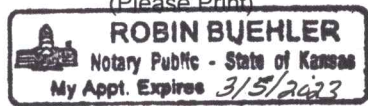

I hereby certify that the foregoing application was signed in my presence and sworn to before me this 2nd day of November, 2021.



 Notary Public

My Commission Expires 3/5/2023.

ONLY COMPLETE APPLICATIONS WILL BE PROCESSED. To be complete, all of the applicable portions of the application form must be completed with accurate information; maps, if necessary, must be included; signatures of all the appropriate owners' must be affixed to the application and notarized; and the appropriate fee must be paid.

FEE SCHEDULE

Each application to change the place of use or the point of diversion under this section shall be accompanied by the application fee set forth in the schedule below: Make checks payable to: **Kansas Department of Agriculture**

- (1) Application to change a point of diversion 300 feet or less \$100
- (2) Application to change a point of diversion more than 300 feet \$200
- (3) Application to change the place of use \$200

SUMMARY ORDER APPROVING APPLICATION FOR CHANGE AND IMPOSING CONDITIONS

This Summary Order is issued under authority of K.S.A. 82a-708b, as amended, and K.A.R. 5-5-1, *et seq.* and other applicable provisions of the *Kansas Water Appropriation Law, K.S.A. 82a-701 et seq.*, and rules and regulations promulgated thereunder, With the exception of those conditions expressly contained herein, this Summary Order does not change the terms, conditions and limitations of File No. 26,261.

1. A change application was received on November 5, 2021 requesting that the place of use and / or point of diversion authorized under the above-referenced file number be changed as described in the application.
2. On and after the effective date of this summary order, the authorized place(s) of use shall be located substantially as shown on the topographic map accompanying the application to change the place of use. Applicable Not Applicable
3. The change in point of diversion shall not impair existing rights and shall be limited to the same source or sources of water as previously authorized. The point of diversion authorized by this summary order shall be located within a foot radius of the authorized point(s) of diversion. Applicable Not Applicable
4. The point(s) of diversion described herein is administratively corrected to be more accurately described using the Global Positioning System (GPS), as described in the application. Applicable Not Applicable
5. The point(s) of diversion authorized herein shall not actually be located more than feet from the previously authorized point(s) of diversion. Applicable Not Applicable
6. As required by K.A.R. 5-3-5d, if the works for diversion is a well with a diversion rate of 100 gallons per minute or more, a tube or other device suitable for making water level measurements shall be installed, operated and maintained in accordance with K.A.R. 5-6-13. Applicable Not Applicable
7. **The owner of the authorized place(s) of use shall properly install an acceptable water flow meter on or before December 31, 2022**, or before the first use of water, whichever occurs first. The water flow meter shall be installed, operated and maintained in accordance with K.A.R. 5-1-4 through 5-1-12. As required by K.S.A. 82a-732, as amended, and K.A.R. 5-3-5e, the owner shall maintain records and report the reading of the water flow meter and the total quantity of water diverted annually to the Chief Engineer by March 1 following the end of each calendar year. Applicable Not Applicable
8. **Installation of the works for diversion of water shall be completed on or before December 31, 2022**, or within any authorized extension of time. By March 1, 2023 the applicant shall notify the Chief Engineer that construction of the works for diversion has been completed, on the form provided by the Chief Engineer, as required by K.A.R. 5-8-4e. Applicable Not Applicable
9. **The completed well log shall be submitted with the required notice.** Applicable Not Applicable
10. All diversion works into which any type of chemical or other foreign substance will be injected into the water shall be equipped with an in-line, automatic, quick-closing check valve capable of preventing pollution of the source of the water supply. The check valve(s) shall be installed, operated and maintained in accordance with K.A.R. 5-3-5c. Applicable Not Applicable
11. Additional Conditions are attached. Yes No
12. In accordance with K.S.A. 82a-708a, as amended, and K.A.R. 5-5-14, all of the owners of the authorized place(s) of use of water appropriated under the above-referenced file number are responsible for compliance with its terms, conditions and limitations, as amended and/or supplemented by this Summary Order, and with applicable provisions of the *Kansas Water Appropriation Law* and the *Rules and Regulations* promulgated thereunder. Failure to comply with these provisions may result in civil penalties pursuant to K.S.A. 82a-737, as amended, and/or the suspension or revocation and dismissal of the water or appropriation right or any other enforcement actions authorized by law.

Administrative Appeal and Effective Date of Order

If you are aggrieved by this order, pursuant to K.S.A. 82a-1901, you may request an evidentiary hearing before the Chief Engineer or request administrative review by the Secretary of Agriculture. A request for hearing by the Chief Engineer must be filed within **15 days** of service of this Order and a request for administrative review by the Secretary must be filed within **30 days** pursuant to K.S.A. 77-531. Any request for administrative review must state a basis for review pursuant to K.S.A. 77-527. File any request with **Kansas Department of Agriculture, Legal Division, 1320 Research Park Drive, Manhattan, KS 66502**. Failure to timely request a hearing or review may preclude review under the Kansas Judicial Review Act.

For Use by Register of Deeds

FOR OFFICE USE ONLY
APPLICATION APPROVED AND SUMMARY ORDER ISSUED

By: Austin McColloch
Duly Authorized Designee of the Chief Engineer
(Print Name): Austin McColloch
Division of Water Resources - Kansas Department of Agriculture

Date of Issuance: November 24, 2021

State of Kansas)
County of Finney) SS

Acknowledged before me on November 24, 2021
by Austin McColloch

Signature: Julie Jones
Notary Public

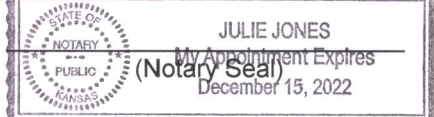

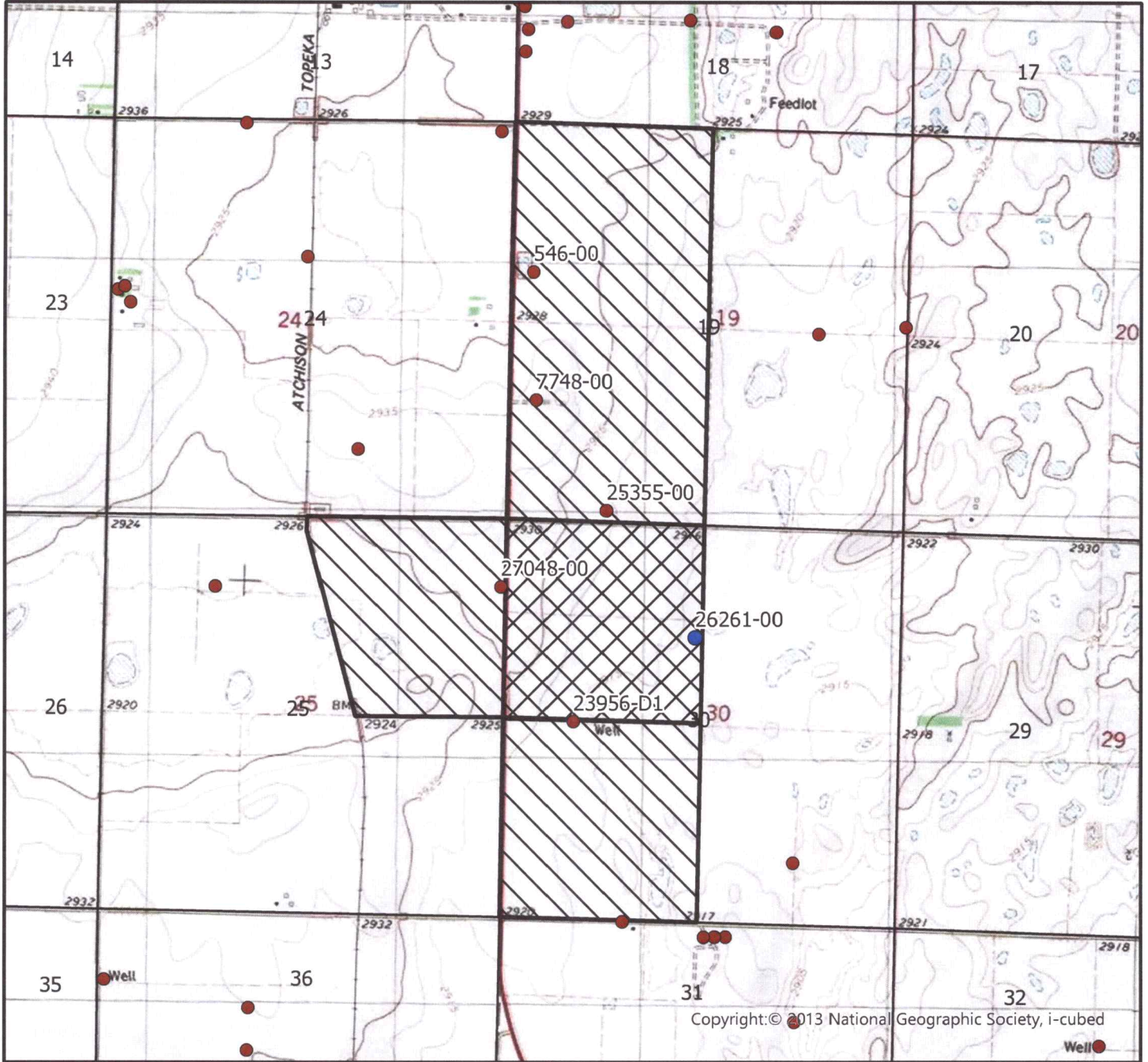

My commission expires: _____

CHANGE IN PLACE OF USE WATER RIGHT FILE NO. 26261

Township 20 South Range 32 West Scott County



Copyright: © 2013 National Geographic Society, i-cubed

	Authorized Point of Diversion
	Permitted Water Right
	Domestic Well within 1/2 mile
	Authorized Place of Use
	Proposed Place of Use

List of owner name and addresses within 1/2 mile:



By signing below I agree that all wells, including domestic, and owners names and addresses within 1/2 mile of the proposed point of diversion have been shown on the map

 _____ 11/02/2021
(Signature) Date

Date AM/GCFO
1:24,000 Scale

Property Details for PID: 0861893000000002000

Shareable link to Property Information : <https://www.kansasgis.org/orka/permalinkprop.cfm?parcelid=0861893000000002000>

Shareable link to Map: <https://www.kansasgis.org/orka/permalink.cfm?parcelid=0861893000000002000>

QuickRef ID : R4636

Owner Name : FAIRLEIGH CORP

Location: 00000 E ROAD 20, Scott City, KS 67871

Abbreviated Boundary Description: S30, T20, R32, ACRES 153.5, NW4 LESS RD R/W

Owner Information:

Owner FAIRLEIGH CORP

Mailing Address PO BOX 560 SCOTT CITY, KS 67871

Property Information:

Type Agricultural Use

Status Active

Taxing Unit 050 LAKE TOWNSHIP

Neighborhood Code 200

No Secondary Address Details found

Market Land Details:

Actual Width: 0

Eff. Width	0
Eff. Depth	0
Acres	0
Square Feet	0

Permit Details

Number	Date	Amount	Purpose
26261			

Deed Book Page Details

Book	Page
0310	0181

Additional Deed Book Page Details

Deed Book/Page 0310/0181 0233/0097 0206/0176 0079/P909

Value Details

	Year	2021
Current Final Value (Agricultural)	Land	\$85,460.00
	Building	\$0.00
	Total	\$85,460.00

No Dwelling Details found

No Manufactured Home Details found

No Additional Dwelling Details found

No Other Improvements found

No Commercial Building Details found

No Commercial Building Section Details found

Ag Land Details

Acre Type :	No Acres :	Map Unit :	Irrig :	Well Depth :
Irrigated Land - IR	119.57	1375	C	200
Irrigated Land - IR	7.18	1704	C	200
Dry Land - DR	23.73	1375		
Dry Land - DR	3.02	1704		
Total Acres :	153.50			

No Ag Building Details found



WESTERN KANSAS GROUNDWATER MANAGEMENT DISTRICT NO.1

November 12, 2021

Austin McColloch
Assistant Water Commissioner
Kansas Dept. of Agriculture – DWR
Garden City Field Office
4532 W. Jones Ave., Suite B
Garden City, KS. 67846

RE: File Nos. 546; 7748; 25355; 23956-D1; 26261 & 27048

Dear Mr. McColloch,

After reviewing the above referenced applications, the Western Kansas Groundwater Management District No. 1 recommends approval.

Sincerely,

Kyle Spencer
District Manager

RECEIVED

NOV 12 2021

Garden City Field Office
Division of Water Resources

Garden City Field Office
4532 W. Jones, Suite B
Garden City, KS 67846



Phone: 620-276-2901
Fax: 620-276-9315
www.agriculture.ks.gov

Mike Beam, Secretary

Laura Kelly, Governor

November 8, 2021

GROUNDWATER MANAGEMENT DISTRICT #3
2009 E SPRUCE ST
GARDEN CITY KS 67846

Re: Request for Recommendation,
File Nos. 546; 7748; 25355; 23956-D1; 26261 & 27048

Dear Sir or Madam:

We are enclosing a copy of the referenced application, which was submitted by Fairleigh Corporation and appears to be in proper form, for your review.

We are delaying any further action for a period of 15 days from the date of this letter to allow you time to submit your recommendation concerning this application. Please submit your recommendation within the allotted time, or any authorized extension of time thereof.

If you have any questions, please contact me at (620) 276-2901. If you wish to discuss a specific file, please have the file number ready to that I may help you more efficiently.

Sincerely,

A handwritten signature in blue ink, appearing to read "Austin McColloch".

Austin McColloch
Assistant Water Commissioner

Enclosure
pc: