

Kansas Department of Agriculture
 Division of Water Resources
CHANGE: P/D WORKSHEET

1. File Number: <b style="font-size: 1.2em;">3125	2. Status Change Date:	3. Change Num: <b style="font-size: 1.2em;">C1	4. Field Office: <b style="font-size: 1.2em;">4	5. GMD: <b style="font-size: 1.2em;">3
--	------------------------	---	--	---

6. Status: <input checked="" type="checkbox"/> Approved <input type="checkbox"/> Denied by DWR/GMD <input type="checkbox"/> Dismiss by Request/Failure to Return	7. Filing Date of Change: <b style="font-size: 1.2em;">1/22/2021
--	---

8a. Applicant(s) <input type="checkbox"/> New to system Person ID 14601 Add Seq# _____ MERL D REXFORD PO BOX 880 MEADE, KS 67864-0880	8c. Landowner(s) <input type="checkbox"/> New to system Person ID _____ Add Seq# _____
--	--

8b. Landowner(s) <input type="checkbox"/> New to system Person ID _____ Add Seq# _____ 8a *UPDATE OWNERSHIP*	8d. WUC <input type="checkbox"/> New to system Person ID _____ Add Seq# _____ 8a
--	--

9. Documents and Enclosure(s): DWR Meter(s) Date to Comply: **12/31/2021** N & P Date to Comply: **3/1/2022**

Anti-Reverse Meter Meter Seal Check Valve N & P Form Water Tube Driller Copy H & E Letter

Conservation Plan Date Required: _____ Date Approved: _____ Date to Comply: _____

10. Use Made of Water From: _____ To: _____

Date Prepared: **2/9/2021** By: **AM**
 Date Entered: _____ By: _____

File No. **3125** 11. County: **ME** Basin: **CROOKED CREEK** Stream: Formation Code: **211** Special Use:

12. Points of Diversion
 CHK
 MOD
 DEL PDIV
 ENT
 Qualifier S T R ID 'N 'W Comment (AKA Line) Rate gpm Quantity af Additional Rate gpm Quantity af Overlap PD Files

DEL 63361
ENT NE NW NE 9 31S 28W 5226 1725 925 422 925 422 NONE

13. Storage: Rate _____ NF Quantity _____ ac/ft Additional Rate _____ NF Additional Quantity _____ ac/ft

14. Limitation: _____ af/yr at _____ gpm (_____ cfs) when combined with file number(s) _____
 Limitation: _____ af/yr at _____ gpm (_____ cfs) when combined with file number(s) _____

15. 5YR Allocation: Allocation Type _____ Start Year _____ 5 YR Amount _____ Amount Unit _____ Base Acres _____ Comment _____

16. Place of Use CHK MOD DEL ENT	PUSE	S	T	R	ID	NE¼				NW¼				SW¼				SE¼				Total	Owner	Chg?	Overlap Files
						NE ¼	NW ¼	SW ¼	SE ¼	NE ¼	NW ¼	SW ¼	SE ¼	NE ¼	NW ¼	SW ¼	SE ¼	NE ¼	NW ¼	SW ¼	SE ¼				
CHK 31426																									

Base Acres: Year: Minimum Reasonable Quantity:
 Comments:

Garden City Field Office
4532 W. Jones, Suite B
Garden City, KS 67846



Phone: 620-276-2901
Fax: 620-276-9315
www.agriculture.ks.gov

Mike Beam, Secretary

Laura Kelly, Governor

February 9, 2021

MERL D REXFORD
PO BOX 880
MEADE, KS 67864-0880

RE: Water Right, File Nos. 3125 & 22922

Dear Sir or Madam:

Enclosed is the order executed by the designee of the Chief Engineer, Division of Water Resources, Kansas Department of Agriculture, approving the application for change under the above referenced file numbers.

Your attention is directed to the enclosures and to the terms, conditions, and limitations specified in this approval for change. A condition of this approval is that an acceptable water flow meter must be installed on the diversion works authorized under the referenced file number and meet current specifications. Please return the required notification of completion of the diversion works and installation of the required meter as soon as these actions are completed.

Since the order modifies the original document referred to above, it should be recorded with the Register of Deeds as other instruments affecting real estate.

Should you have any questions, please feel free contact this office. If you would prefer, you could arrange an appointment for additional assistance.

Sincerely,

A handwritten signature in blue ink that reads "Austin J. McColloch".

Austin J. McColloch
Assistant Water Commissioner

AM:
enclosures

pc: GROUNDWATER MANAGEMENT DISTRICT NO. 3

CERTIFICATE OF SERVICE

On this 9th day of February, 2021, I hereby certify that the foregoing Approval of Application for Change in Point of Diversion, Water Right, File Nos. 3,125 and 22,922 dated 9th day of February, 2021 was mailed postage prepaid, first class, US mail to the following:

MERL D REXFORD
PO BOX 880
MEADE, KS 67864-0880

Pc:

GROUNDWATER MANAGEMENT DISTRICT NO. 3

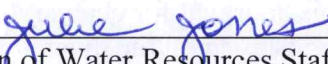

Division of Water Resources Staff

Submit completed application to:
 Kansas Department of Agriculture
 Division of Water Resources
 Field Office for your area.

Call for address:

Topeka -- (785) 296-5733
 Stafford -- (620) 234-5311
 Stockton -- (785) 425-6787
 Garden City -- (620) 276-2901
<http://agriculture.ks.gov/dwr>

DWR FIELD OFFICE APPLICATION FOR APPROVAL TO CHANGE THE PLACE OF USE AND/OR THE POINT OF DIVERSION



STATE OF KANSAS

Filing Fee Must Accompany the Application, K.S.A. 82a-708b(b), as amended.
 Fee Schedule is on the third page of this application form.

Paragraph Nos. 1, 2, 3 & 5 must be completed. Complete all other applicable portions. If change in point of diversion is greater than 100 feet, or if place of use will be changed, include a topographic map or detailed plat showing the authorized and proposed point(s) of diversion and/or place of use.

File No. 3125

RECEIVED
 11:00 AM
 JAN 22 2021

Garden City Field Office
 Division of Water Resources

1. Application is hereby made for approval of the Chief Engineer to change the (check one or both):

Place of Use Point of Diversion

under the water right which is the subject of this application in accordance with the conditions described below.

The source of supply is: Groundwater Surface water

2. Name and address of Applicant: BUCK REXFORD
PO BOX 880 MEADE, KS. 67864

Phone Number: (620)629-1604 Email address: _____

Name and address of Water Use Correspondent: ALVA E REXFORD - Deceased
PO BOX 880 MEADE, KS. 67864

Phone Number: (620)629 1828 Email address: _____

3. The presently authorized place of use is:
 Owner of Land ---- NAME: NO CHANGE
 ADDRESS: _____

(If there is more than one landowner, attach supplemental sheets as necessary.)

Sec.	Twp.	Range	NE¼				NW¼				SW¼				SE¼				TOTAL ACRES		
			NE¼	NW¼	SW¼	SE¼	NE¼	NW¼	SW¼	SE¼	NE¼	NW¼	SW¼	SE¼	NE¼	NW¼	SW¼	SE¼			

4. If this application is for a change in place of use, it is proposed that the place of use be changed to:
 Owner of Land ---- NAME: NO CHANGE
 ADDRESS: _____

(If there is more than one landowner, attach supplemental sheets as necessary.)

Sec.	Twp.	Range	NE¼				NW¼				SW¼				SE¼				TOTAL ACRES			
			NE¼	NW¼	SW¼	SE¼	NE¼	NW¼	SW¼	SE¼	NE¼	NW¼	SW¼	SE¼	NE¼	NW¼	SW¼	SE¼				

For Office Use Only: Code _____ Fee \$ 200.00 TR # _____ Receipt Date 1-22-21 Check # 5632

5. **Presently authorized point of diversion:**
 One in the NW Quarter of the SW Quarter of the NW Quarter of Section 10, Township 31 South, Range 28 (W), in MEADE County, Kansas, 3647 feet North 5056 feet West of Southeast corner of section. Authorized Rate 925GPM Authorized Quantity 422AF Depth of well _____ (feet)
(DWR use only: Computer ID No. 3 GPS _____ feet North _____ feet West)
 This point will not be changed This point will be changed as follows: No change, point better described with GPS as follows:
Proposed point of diversion: (Complete only if change is requested or if existing point is better described by GPS)
 One in the NE Quarter of the NW Quarter of the NE Quarter of Section 9, Township 31 South, Range 28 (W), in MEADE County, Kansas, 5226 feet North 1725 feet West of Southeast corner of section. Proposed Rate _____ Proposed Quantity _____ Proposed well depth (feet) _____.
 This point is: Additional Well Geo Center List other water rights that will use this point _____.

6. **Presently authorized point of diversion:**
 One in the _____ Quarter of the _____ Quarter of the _____ Quarter of Section _____, Township _____ South, Range _____ (W), in _____ County, Kansas, _____ feet North _____ feet West of Southeast corner of section. Authorized Rate _____ Authorized Quantity _____ Depth of well _____ (feet)
(DWR use only: Computer ID No. _____ GPS _____ feet North _____ feet West)
 This point will not be changed This point will be changed as follows: No change, point better described with GPS as follows:
Proposed point of diversion: (Complete only if change is requested or if existing point is better described by GPS)
 One in the _____ Quarter of the _____ Quarter of the _____ Quarter of Section _____, Township _____ South, Range _____ (W), in _____ County, Kansas, _____ feet North _____ feet West of Southeast corner of section. Proposed Rate _____ Proposed Quantity _____ Proposed well depth (feet) _____.
 This point is: Additional Well Geo Center List other water rights that will use this point _____.

7. The changes herein are desired for the following reasons?
 (please be specific) lack of production on current PD

8. If a well, is the test hole log attached? Yes No

9. The change(s) (was)(will be) completed by?

10. If the point of diversion is a well:
 (a) What are you going to do with the old well?
To be plugged
 (b) When will this be done? _____

11. Groundwater Management District recommendation attached?
 Yes No

12. Assisted by CAC

13a. If the proposed point of diversion will be relocated more than 300 feet but within 2,640 feet of the existing point of diversion, attach a topographic map or aerial photograph. For groundwater sources, show all wells (including domestic) within one-half mile of the proposed point of diversion and the names and mailing addresses of the owners. For surface water sources, show the names and addresses of the landowner(s) one-half mile downstream and one-half mile upstream from your property lines

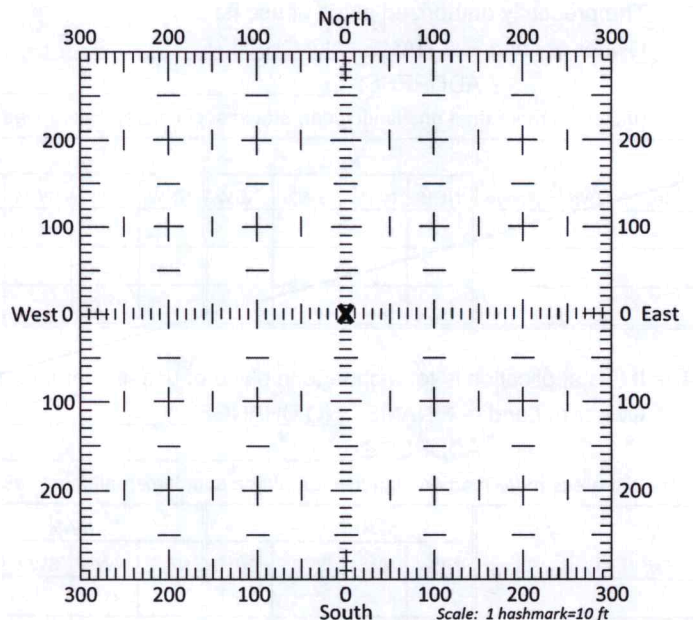

13b. If the proposed point of diversion will be relocated within 300 feet of the existing point of diversion, indicate its location on the diagram shown above in relation to the existing point of diversion. **(PLEASE NOTE: The "X" in center of diagram above represents the presently authorized point of diversion.)**

14. If the proposed groundwater point of diversion is 300 or fewer feet from the existing point of diversion, complete the following:

- (a) Does the undersigned represent all owners of the currently authorized place(s) of use identified in this application?
 Yes No (If no, all owners must sign this application.)
- (b) Will the ownership interest of any owner of the currently authorized place(s) of use identified in this application be adversely affected if this application is approved as requested?
 Yes No (If yes, all owners must sign this application.)
- (c) If this application is not approved expeditiously, will there be substantial damage to property, public health or safety?
 Yes No (If no, all owners must sign this application.)

If the application proposes a surface water change in point of diversion, a groundwater change in point of diversion greater than 300 feet, or a change in place of use, the application must be signed by all owners of the currently authorized place of use, or their duly authorized agent (attach notarized statement authorizing representation).

I hereby verify, being first duly sworn upon my oath or affirmation and under penalty of perjury, that I am of lawful age and the owner, the spouse of the owner, or a duly authorized agent of the owner(s) to make this application on their behalf, in regards to the water right(s) to which this application pertains. I further verify that the statements contained in this application are true, correct and complete.

Dated at GARDEN CITY, Kansas, this 21ST day of JANUARY, 2021.

<u>x Merl D Rexford</u> (Owner)	_____ (Spouse)
<u>MERL D REXFORD</u> (Please Print)	_____ (Please Print)
_____ (Owner)	_____ (Spouse)
_____ (Please Print)	_____ (Please Print)
_____ (Owner)	_____ (Spouse)
_____ (Please Print)	_____ (Please Print)

State of Kansas
County of FINNEY } SS

I hereby certify that the foregoing application was signed in my presence and sworn to before me this 21ST day of JAN, 2021



Catherine Reinert
Notary Public

My Commission Expires 9-14-22

ONLY COMPLETE APPLICATIONS WILL BE PROCESSED. To be complete, all of the applicable portions of the application form must be completed with accurate information; maps, if necessary, must be included; signatures of all the appropriate owners' must be affixed to the application and notarized; and the appropriate fee must be paid.

FEE SCHEDULE

Each application to change the place of use or the point of diversion under this section shall be accompanied by the application fee set forth in the schedule below: Make checks payable to: Kansas Department of Agriculture

- (1) Application to change a point of diversion 300 feet or less \$100
- (2) Application to change a point of diversion more than 300 feet \$200
- (3) Application to change the place of use \$200

14. If the proposed groundwater point of diversion is 300 or fewer feet from the existing point of diversion, complete the following:

- (a) Does the undersigned represent all owners of the currently authorized place(s) of use identified in this application?
 Yes No (If no, all owners must sign this application.)
- (b) Will the ownership interest of any owner of the currently authorized place(s) of use identified in this application be adversely affected if this application is approved as requested?
 Yes No (If yes, all owners must sign this application.)
- (c) If this application is not approved expeditiously, will there be substantial damage to property, public health or safety?
 Yes No (If no, all owners must sign this application.)

If the application proposes a surface water change in point of diversion, a groundwater change in point of diversion greater than 300 feet, or a change in place of use, the application must be signed by all owners of the currently authorized place of use, or their duly authorized agent (attach notarized statement authorizing representation).

I hereby verify, being first duly sworn upon my oath or affirmation and under penalty of perjury, that I am of lawful age and the owner, the spouse of the owner, or a duly authorized agent of the owner(s) to make this application on their behalf, in regards to the water right(s) to which this application pertains. I further verify that the statements contained in this application are true, correct and complete.

Dated at Garden City, Kansas, this 22nd day of January, 2021.

(Owner)	<i>Marilyn J Rexford</i> (Spouse)
(Please Print)	<i>Marilyn J Rexford</i> (Please Print)
(Owner)	(Spouse)
(Please Print)	(Please Print)
(Owner)	(Spouse)
(Please Print)	(Please Print)

State of Kansas }
 County of Finney } SS

I hereby certify that the foregoing application was signed in my presence and sworn to before me this 22nd day of January, 2021.

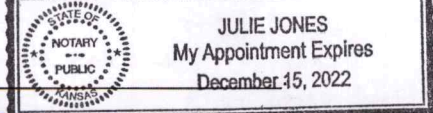
My Commission Expires _____

Julie Jones
 Notary Public

ONLY COMPLETE APPLICATIONS WILL BE PROCESSED. To be complete, all of the applicable portions of the application form must be completed with accurate information; maps, if necessary, must be included; signatures of all the appropriate owners' must be affixed to the application and notarized; and the appropriate fee must be paid.

FEE SCHEDULE

Each application to change the place of use or the point of diversion under this section shall be accompanied by the application fee set forth in the schedule below: Make checks payable to: **Kansas Department of Agriculture**

(1) Application to change a point of diversion 300 feet or less	\$100
(2) Application to change a point of diversion more than 300 feet	\$200
(3) Application to change the place of use	\$200

SUMMARY ORDER APPROVING APPLICATION FOR CHANGE AND IMPOSING CONDITIONS

This Summary Order is issued under authority of K.S.A. 82a-708b, as amended, and K.A.R. 5-5-1, et seq. and other applicable provisions of the Kansas Water Appropriation Law, K.S.A. 82a-701 et seq., and rules and regulations promulgated thereunder, With the exception of those conditions expressly contained herein, this Summary Order does not change the terms, conditions and limitations of File No. 3125

- 1. A change application was received on January 22, 2021 requesting that the place of use and / or point of diversion authorized under the above-referenced file number be changed as described in the application.
2. On and after the effective date of this summary order, the authorized place(s) of use shall be located substantially as shown on the topographic map accompanying the application to change the place of use. [] Applicable [X] Not Applicable
3. The change in point of diversion shall not impair existing rights and shall be limited to the same source or sources of water as previously authorized. The point of diversion authorized by this summary order shall be located within a 300 foot radius of the authorized point(s) of diversion. [X] Applicable [] Not Applicable
4. The point(s) of diversion described herein is administratively corrected to be more accurately described using the Global Positioning System (GPS), as described in the application. [] Applicable [X] Not Applicable
5. The point(s) of diversion authorized herein shall not actually be located more than 2640 feet from the previously authorized point(s) of diversion. [X] Applicable [] Not Applicable
6. As required by K.A.R. 5-3-5d, if the works for diversion is a well with a diversion rate of 100 gallons per minute or more, a tube or other device suitable for making water level measurements shall be installed, operated and maintained in accordance with K.A.R. 5-6-13. [X] Applicable [] Not Applicable
7. The owner of the authorized place(s) of use shall properly install an acceptable water flow meter on or before December 31, 2021, or before the first use of water, whichever occurs first. The water flow meter shall be installed, operated and maintained in accordance with K.A.R. 5-1-4 through 5-1-12. As required by K.S.A. 82a-732, as amended, and K.A.R. 5-3-5e, the owner shall maintain records and report the reading of the water flow meter and the total quantity of water diverted annually to the Chief Engineer by March 1 following the end of each calendar year. [X] Applicable [] Not Applicable
8. Installation of the works for diversion of water shall be completed on or before December 31, 2021, or within any authorized extension of time. By March 1, 2022 the applicant shall notify the Chief Engineer that construction of the works for diversion has been completed, on the form provided by the Chief Engineer, as required by K.A.R. 5-8-4e. [X] Applicable [] Not Applicable
9. The completed well log shall be submitted with the required notice. [X] Applicable [] Not Applicable
10. All diversion works into which any type of chemical or other foreign substance will be injected into the water shall be equipped with an in-line, automatic, quick-closing check valve capable of preventing pollution of the source of the water supply. The check valve(s) shall be installed, operated and maintained in accordance with K.A.R. 5-3-5c. [X] Applicable [] Not Applicable
11. Additional Conditions are attached. [] Yes [X] No
12. In accordance with K.S.A. 82a-708a, as amended, and K.A.R. 5-5-14, all of the owners of the authorized place(s) of use of water appropriated under the above-referenced file number are responsible for compliance with its terms, conditions and limitations, as amended and/or supplemented by this Summary Order, and with applicable provisions of the Kansas Water Appropriation Law and the Rules and Regulations promulgated thereunder. Failure to comply with these provisions may result in civil penalties pursuant to K.S.A. 82a-737, as amended, and/or the suspension or revocation and dismissal of the water or appropriation right or any other enforcement actions authorized by law.

Administrative Appeal and Effective Date of Order

If you are aggrieved by this order, pursuant to K.S.A. 82a-1901, you may request an evidentiary hearing before the Chief Engineer or request administrative review by the Secretary of Agriculture. A request for hearing by the Chief Engineer must be filed within 15 days of service of this Order and a request for administrative review by the Secretary must be filed within 30 days pursuant to K.S.A. 77-531. Any request for administrative review must state a basis for review pursuant to K.S.A. 77-527. File any request with Kansas Department of Agriculture, Legal Division, 1320 Research Park Drive, Manhattan, KS 66502. Failure to timely request a hearing or review may preclude review under the Kansas Judicial Review Act.

For Use by Register of Deeds

FOR OFFICE USE ONLY
APPLICATION APPROVED AND
SUMMARY ORDER ISSUED

By: Austin McColloch
Duly Authorized Designee of the Chief Engineer

(Print Name): Austin McColloch
Division of Water Resources - Kansas Department of Agriculture

Date of Issuance: February 9, 2021

State of Kansas)
) SS
County of Geary)

Acknowledged before me on February 9, 2021
by Austin McColloch

Signature: Julie Jones
Notary Public

My commission expires:
My Appointment Expires December 15, 2022
(Notary Seal)

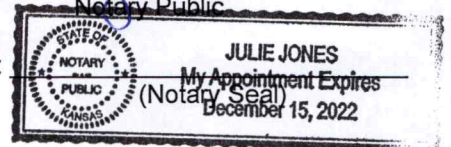

**Point of Diversion Change WR 3125
T31S R28W Section 10
Meade Co**

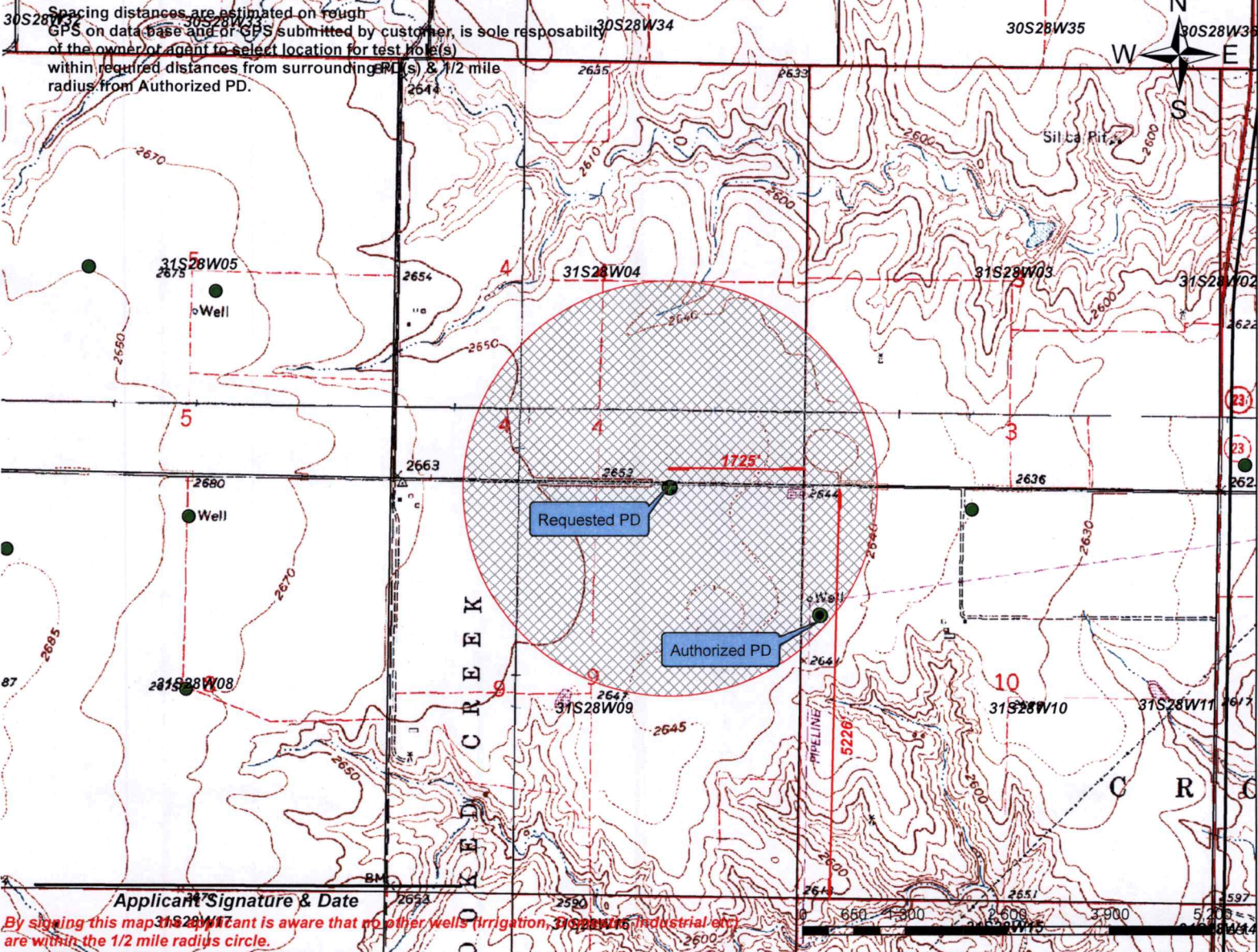

- Authorized PD
- Requested PD
- Point of Diversion
- Half Mile Radius
- Active Water Right w/in 1/2 mile
- domestic well w/in 1/2 mile
- Authorized PU
- Requested PD

Water Right w /in 1/2 mile & Owner(if apply)



Domestic well w /in 1/2 mile & Owner (if apply)



3795 W. Jones A. e.
Garden City, KS 67846
PH: 620-277-2389

WR 3125



Buck REXFORD

CELL 620-629-1604

PO Box 639
Garden City, KS 67846
Fax: 620-277-0224

5226'N / 1725'W
NE NW NE

Customer Name: Buck Rexford WO#: 21248 Date: 1-15-21
 Street Address: P.O. Box 880, 507 E. Vine Test #: 1 E LOG: Yes
 City, State: MEADE, KS 67864 Driller: Dale Guinn
 County: Meade Quarter: NE Section: 9 Township: 31 Range: 28
 Location: GPS: N37.37230 W100.36877
 Rig #: 10002 Elevation: 2640' Static WL: Approx. 220' Estimated?
 Proposed Well Depth 532

WELL LOCATION

20' Sample

%	Footage			Description of Strata
	From	Pay	To	
	0		2	Top Soil
	2		10	Brown Sandy Clay
	10		38	Calich + Brown Sandy Clay
	38		59	Brown Clay
	59		80	Brown Clay + Calich
	80		107	Fine Med Sand "Little Tight"
	107		162	Fine Med Course Sand
	162		208	Fine Med Fine Course Sand w/ some clay layers
	208		221	Brown + some Blue Sandy Clay
10	221	49	270	Fine Sand w/ some clay layers
	270		281	Brown Sandy Clay
20	281	10	291	Fine Med Sand
	291		297	Brown Sandy Clay
25	297	7	304	Fine Med Course Sand
	304		322	Brown Sandy Clay
20	322	5	327	Fine Med Sand
	327		335	Brown + Blue Clay
25	335	10	345	Fine Med Course Sand
	345		371	Brown + Red Sandy Clay w/ few Lime Rock Strips
30	371	9	380	Fine Med Course Sand Small Gravel
	380		385	Brown Sandy Clay
30	385	15	400	Fine Med Course Sand Small Gravel
5	400	10	410	Brown Sandy Clay w/ some Sand Strips
	410		423	Brown Clay w/ Calich + Lime Rock
5	423	68	491	Fine Sand w/ some Clay + few Lime Rock Strips
	491		504	Brown Sandy Clay w/ few Sand Strips
25	504	8	512	Fine Med Sand w/ Brown Rock
	512		581	Shale
	581		600	Red Bed
				Super Gel X -4
				Hole Plug -6
				Perma Plug -1

3125

TOPO! map printed on 01/18/21 from "Untitled.tpo"

100.38333° W

100.36667° W

WGS84 100.35000° W

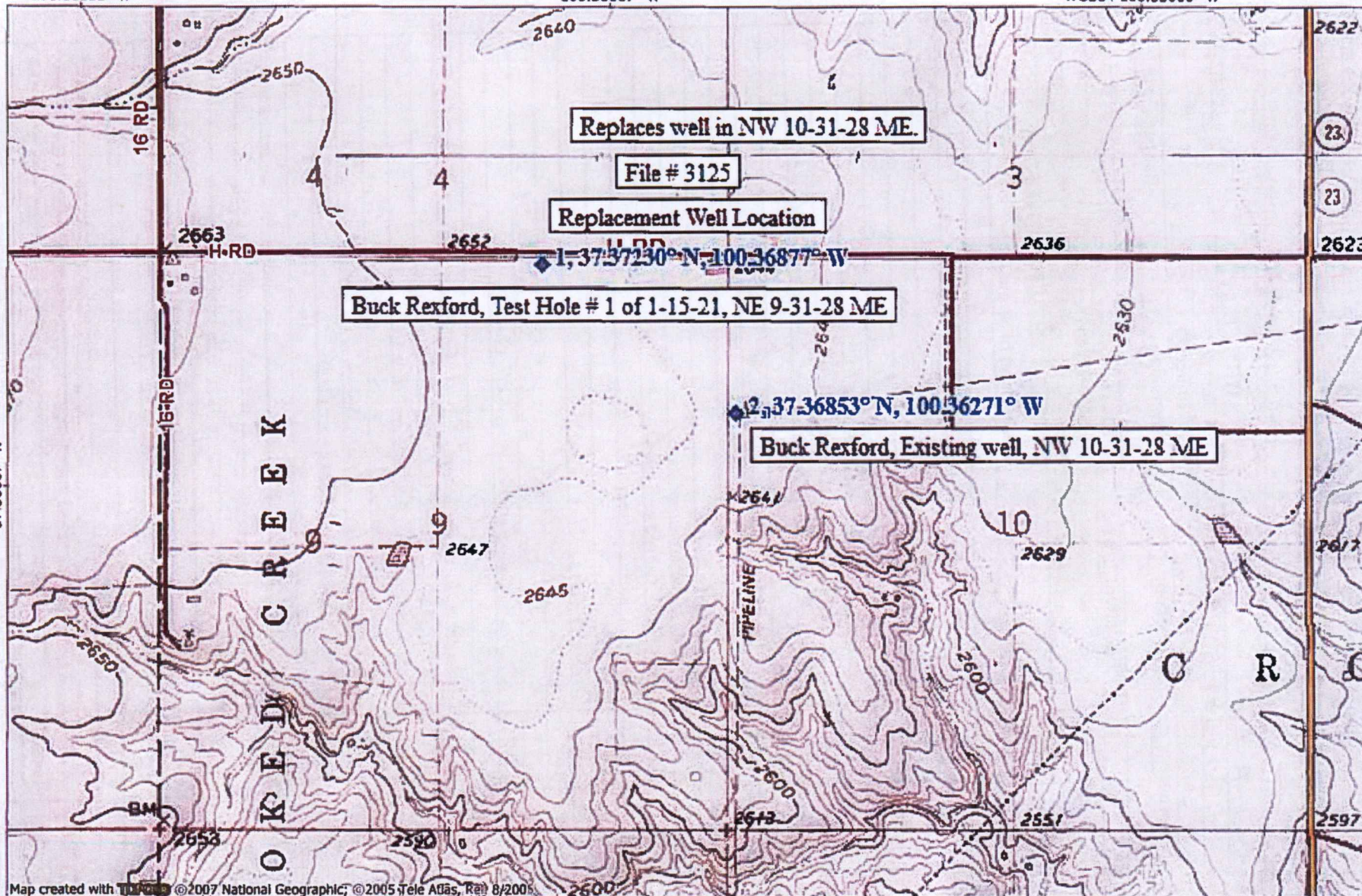

Replaces well in NW 10-31-28 ME.

File # 3125

Replacement Well Location

Buck Rexford, Test Hole # 1 of 1-15-21, NE 9-31-28 ME

2, 37°37'23.0" N, 100°36'87.7" W

Buck Rexford, Existing well, NW 10-31-28 ME

Map created with TopoTools ©2007 National Geographic; ©2005 Tele Atlas, RA 8/2005

100.38333° W

100.36667° W

WGS84 100.35000° W

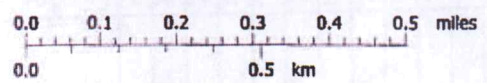

TN MN
5°

01/18/21

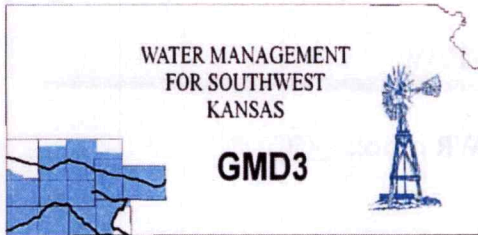

Southwest Kansas
Groundwater Management District No. 3
2009 E. Spruce Street
Garden City, Kansas 67846
(620) 275-7147 phone (620) 275-1431 fax
www.gmd3.org

February 8, 2021

Austin J McColloch
Division of Water Resources
4532 W Jones Ave., Suite B
Garden City, Kansas 67846

RE: Application for Change in Point of Diversion
Water Right, File Nos. 3125 & 22922

Dear Austin:

We have completed a review of the application for the above referenced water right. The proposed change in point of diversion is in accordance with current area rules, K.A.R. 5-23-3, as it pertains to distance moved and minimum spacing to neighboring wells.

Well evaluations were conducted to estimate possible effects of the proposal on the supply of other wells with water rights prior to the proposal per K.S.A. 82a-708b, and the draft revised management program. Under K.S.A. 82a-708b, an applicant requesting a change in point of diversion must demonstrate to the chief engineer that any proposed change is reasonable and will not impair. The enclosed report is an analysis performed by the GMD on behalf of our membership. Under this analysis, the proposed change is considered to be reasonable and unlikely to impair if either the net in-season well-to-well effect of the proposed change is less than a strict maximum allowable threshold (4.0 ft in cases where saturated thickness is greater than 200 ft), or if no well with a net well-to-well effect exceeding the threshold is identified as critical. Critical wells are identified as wells that are expected to either lose or greatly diminish water supply over the next 25 years. The attached review information is based on a Theis analysis using inputs from the GMD3 aquifer model, which is considered to be the best information on well and aquifer data readily and easily available to the public. If either the applicant or the neighbors believe they have better data that might change the result of the analysis, they should contact GMD3. Conclusions of the well analysis may change if better information on well and aquifer data can be made available.

Every neighboring well within 1 mile of the proposed move was evaluated. Evaluations showed that none of the neighboring wells exceeded the net effect above the maximum allowable threshold and were actually well under that threshold. Our office received no comments of concern from neighboring well owners. Therefore, GMD3 sees this move as reasonable and therefore recommend that the application be approved. If aquifer conditions change or there is a change to the water right in the future, we would be happy to evaluate the effects at that time.

Thank you for the opportunity to review the applications and to provide a recommendation. If you have any questions, please don't hesitate to contact us.

Sincerely,

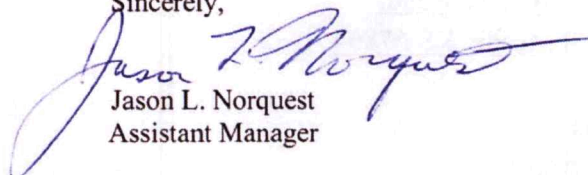

Jason L. Norquest
Assistant Manager

GMD3 Change Review

File No(s): 3125 & 22922.

DWR office: GC.

App filed to change: PDs.

Is Landowner(s) correct in WRIS: Buck Rexford.

If NO, is documentation included?

Is Water Use Correspondent correct in WRIS? ___.

If NO, is documentation included?

Regulation(s) Reviewed: KAR 5-23-3

Point of diversion ID No(s) ___ being changed.

	ft. North	ft. West	3125
Authorized PD	3647	5056	Sect 10-31-28
Proposed PD	5226	1725	Sect 9-31-28
Difference	-1579 n	1949 w	
$a^2 + b^2 = c^2$	2493241	3798601	2508.354 foot move nw

GPS for proposed PD: Lat: 37.37230 Long: -100.36877.

	ft. North	ft. West	22922
Authorized PD	5000	3150	Sect 10-31-28
Proposed PD	3647	5056	
Difference	1353 s	-1906 w	
$a^2 + b^2 = c^2$	1830609	3632836	2337.401 foot move sw

GPS for proposed PD: Lat: Long:

Is proposed PD stacking on existing WRs? 3125 new well, 22922 moving to the well exited by 3125.

Is Proposed PU overlapping existing WRs? No Change.

Neighboring certified well(s) notified: ___.

Name All are the applicants and a domestic.

Address ___.

Zip ___.

Email: ___. Phone: ___.

Domestic well(s) notified: ___.

Name Cynthia Hagemeyer (SW4-31-28).

Address 7138 16 Road.

Zip Meade, KS 67864.

Name Don Josserand (SW9-31-28).

Address 8122 16 Road.

Zip Meade, KS 67864.

Base Acres: ___.

Perfected Acres: ___.

Irr. Return-Flow ___%

GMD3 Change Review

3125: 422AF @ 925gpm

2010-2019 average reported use = 257.3AF

22922: 590AF @ 1670gpm

2020 GMD3 inspection calculated flow 452gpm (450gpm visual)

2010-2019 average reported use = 183.9AF

2016 GMD3 inspection calculated flow of 262gpm (200gpm visual)

Is a waiver needed: Both moves are less than half mile and minimum spacing appears met. Analysis shows that possible effects in the area are well within the guidelines and should not cause impairment. We did not receive any concerns or comments from neighbors.

Recommendation: After review of all available information, it appears the proposed change meets current area rules. Analysis shows that the move is within guidelines and should have possible effects within the guidelines. Staff therefore recommends approval of the application.

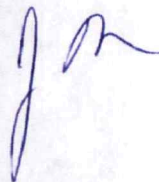

Domestic 9-31-28: Drawdown from current location = 0.52 ft
Drawdown from proposed location = 1.47 ft
Net drawdown = **1.0 ft**

Domestic 10-31-28: Drawdown from current location = 0.99 ft
Drawdown from proposed location = 1.86 ft
Net drawdown = **0.9 ft**

AP

Net drawdown does not exceed the drawdown allowance of 4.0 ft for any well within 1 mile of the proposed location. Therefore, critical well analysis is not necessary.

Conclusion:

The proposed move is likely to create minimal effects on neighboring wells and is unlikely to cause impairment. GMD3 staff recommends approval of this proposal.

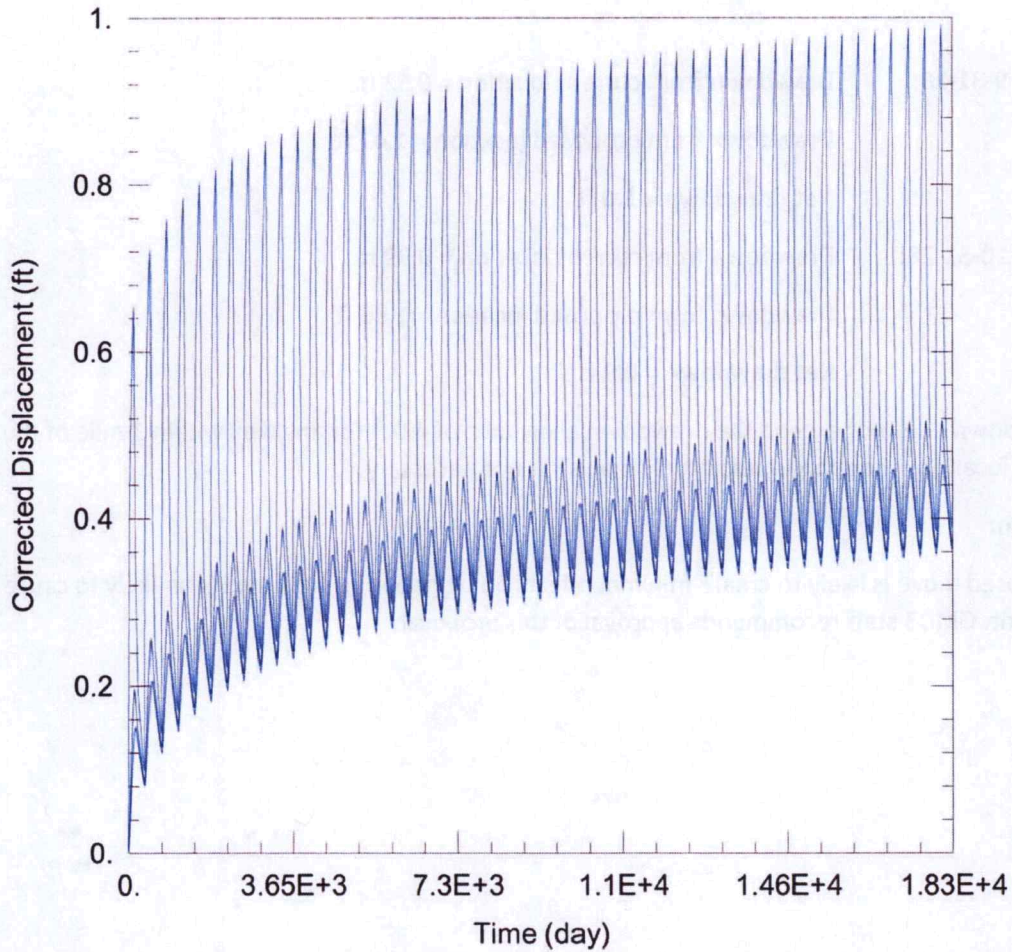

WELL TEST ANALYSIS

Data Set: C:\Users\trevora\Documents\2021_Moves\3125_22922\3125 & 22922 Current.aqt
 Date: 01/26/21 Time: 14:07:59

PROJECT INFORMATION

Company: GMD 3
 Project: 3125 & 22922
 Location: Meade County
 Test Well: 3125 & 22922

WELL DATA

Pumping Wells

Well Name	X (ft)	Y (ft)
	127222	179770
	129125	181132

Observation Wells

Well Name	X (ft)	Y (ft)
□	127222	179770
□	129125	181132
□ Domestic 4-31-28	121921	184417
□ Domestic 9-31-28	121994	178429
□ Domestic 10-31-28	129193	179778

SOLUTION

Aquifer Model: Unconfined

Solution Method: Theis

T = 5.29E+4 ft²/day

S = 0.2249

Kz/Kr = 1.

b = 270. ft

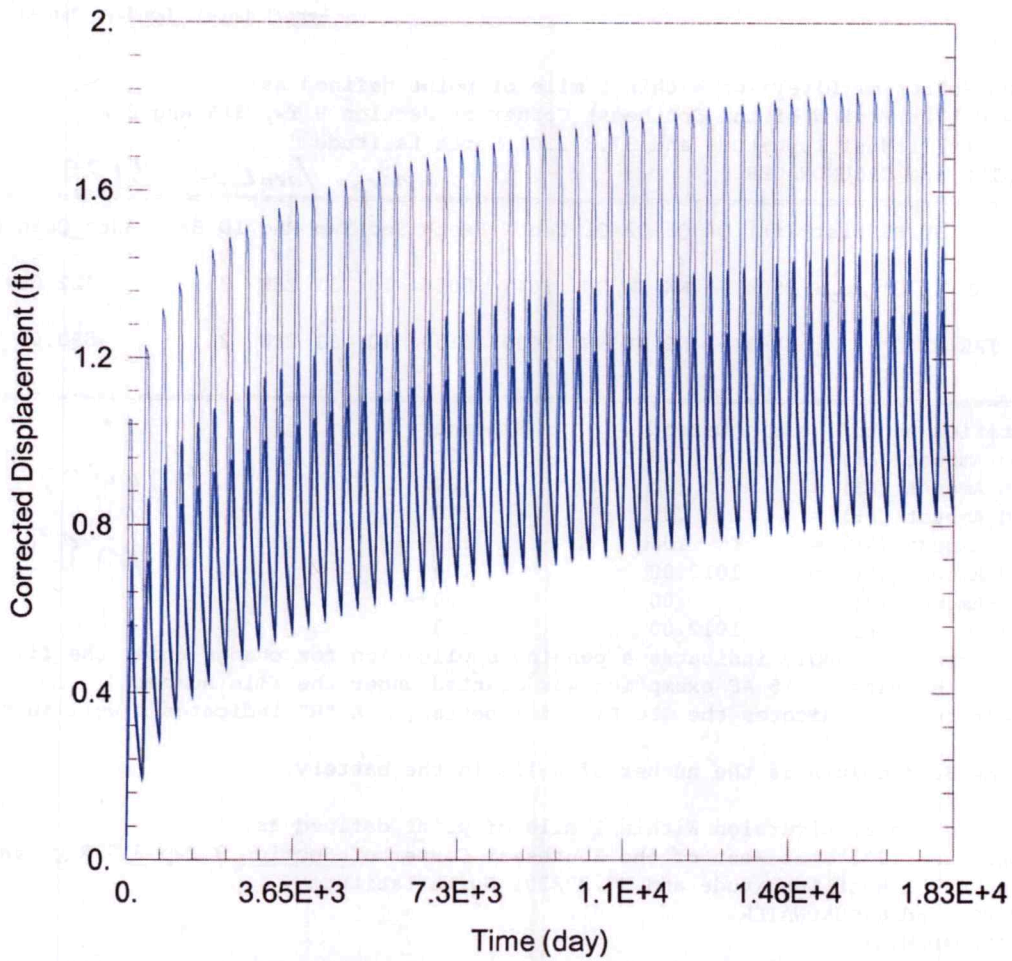

WELL TEST ANALYSIS

Data Set: C:\Users\trevora\Documents\2021_Moves\3125_22922\3125 & 22922 Proposed.aqt
 Date: 01/26/21 Time: 14:07:52

PROJECT INFORMATION

Company: GMD 3
 Project: 3125 & 22922
 Location: Meade County
 Test Well: 3125 & 22922

WELL DATA

Pumping Wells

Well Name	X (ft)	Y (ft)
	125154	181353
	127222	179770

Observation Wells

Well Name	X (ft)	Y (ft)
□	125154	181353
□	127222	179770
□ Domestic 4-31-28	121921	184417
□ Domestic 9-31-28	121994	178429
□ Domestic 10-31-28	129193	179778

SOLUTION

Aquifer Model: Unconfined

Solution Method: Theis

T = 5.29E+4 ft²/day
 Kz/Kr = 1.

S = 0.2249
 b = 270. ft

Water Rights and Points of Diversion Within 1 mile of point defined as:

5226 Feet N and 1725 Feet W of the Southeast Corner of Section 9 Twp 31S Rng 28W
Located at: 100.368771 West Longitude and 37.372301 North Latitude
Both SURFACE WATER and GROUNDWATER

New local. on 3125

File Number	Use	ST	SR	Dist (ft)	Q4	Q3	Q2	Q1	FeetN	FeetW	Sec	Twp	Rng	ID	Batt	Auth_Quan	Add_Quan
A__ AF	3125	00	IRR NK G*	↔ 2504	--	NW	SW	NW	3647	5056	10	31	28W	3		422.00	422.00
A__ AF	22922	00	IRR NK G*	3863	--	NE	NE	NW	5000	3150	10	31	28W	2		590.00	590.00

Total Net Quantities Authorized:	Direct	Storage
Total Requested Amount (AF) =	.00	.00
Total Permitted Amount (AF) =	.00	.00
Total Inspected Amount (AF) =	.00	.00
Total Pro_Cert Amount (AF) =	.00	.00
Total Certified Amount (AF) =	1012.00	.00
Total Vested Amount (AF) =	.00	.00
TOTAL AMOUNT (AF) =	1012.00	.00

Spacing MET

An * after the source of supply indicates a pending application for change under the file number.
An * after the ID indicates a 15 AF exemption was granted under the file number.
A "G" in the Batt column indicates the GEO CTR of a battery. A "B" indicates a well in the battery.
The number in the Batt column is the number of wells in the battery.

Water Rights and Points of Diversion Within 1 mile of point defined as:

5226 Feet North and 1725 Feet West of the Southeast Corner of Section 9 Twp 31S Rng 28W
Located at: 100.368771 West Longitude and 37.372301 North Latitude
Both SURFACE WATER and GROUNDWATER
WATER USE CORRESPONDENTS:

- > File Number Use ST SR
- > ALVA E REXFORD
- >
- > PO BOX 880
- > MEADE KS 67864
- >-----
- > ALVA E REXFORD
- >
- > PO BOX 880
- > MEADE KS 67864
- >-----

Garden City Field Office
4532 W. Jones, Suite B
Garden City, KS 67846

Mike Beam, Secretary



Phone: 620-276-2901
Fax: 620-276-9315
www.agriculture.ks.gov

Laura Kelly, Governor

January 25, 2021

GROUNDWATER MANAGEMENT DISTRICT #3
2009 E SPRUCE ST
GARDEN CITY KS 67846

Change Application,
File Nos. 3125 & 22922

Dear Sir or Madam:

We are enclosing a copy of the referenced application, which was submitted by Merl Rexford and appears to be in proper form, for your review.

We are delaying any further action for a period of 15 days from the date of this letter to allow you time to submit your recommendation concerning this application. Please submit your recommendation within the allotted time, or any authorized extension of time thereof.

If you have any questions, please contact me at (620) 276-2901. If you wish to discuss a specific file, please have the file number ready to that I may help you more efficiently.

Sincerely,

A handwritten signature in blue ink that reads "Austin McColloch".

Austin McColloch
Assistant Water Commissioner

Enclosure
pc:

Property Details for PID: 0600820900000001000

Shareable link to Property Information : <https://www.kansasgis.org/orka/permalinkprop.cfm?parcelid=0600820900000001000>

Shareable link to Map: <https://www.kansasgis.org/orka/permalink.cfm?parcelid=0600820900000001000>

QuickRef ID : R894

Owner Name : REXFORD, MERL D & MARILYN J

Location: 00000, Meade, KS 67864

Abbreviated Boundary Description: S09 , T31 , R28 , ACRES 316.7 , E2 LESS R/W

Owner Information:

Owner REXFORD, MERL D & MARILYN J

Mailing Address PO BOX 880 MEADE, KS 67864

Property Information:

Type Agricultural Use

Status Active

Taxing Unit 008

Neighborhood Code 412

No Secondary Address Details found

Market Land Details:

Actual Width: 0

Eff. Width 0

Eff. Depth 0

Acres 0

Square Feet 0

No Permit Details found

Deed Book Page Details

Book	Page
97	143

Additional Deed Book Page Details

Deed Book/Page 09PR/15

Value Details

	Year	2020
Current Final Value (Agricultural)	Land	\$77,890.00
	Building	\$0.00
	Total	\$77,890.00

No Dwelling Details found

No Manufactured Home Details found

No Additional Dwelling Details found

No Other Improvements found

No Commercial Building Details found

No Commercial Building Section Details found

Ag Land Details

Acre Type :	No Acres :	Map Unit :	Irrig :	Well Depth :
Dry Land - DR	74.80	2612		
Dry Land - DR	7.00	2613		
Dry Land - DR	0.40	2692		
Dry Land - DR	9.20	2715		
Dry Land - DR	25.40	2801		
Dry Land - DR	4.40	2815		
Irrigated Land - IR	20.50	2612	C	400
Irrigated Land - IR	10.20	2715	C	400
Irrigated Land - IR	91.30	2801	C	400
Native Grass - NG	47.10	2562		
Native Grass - NG	2.50	2612		

Native Grass - NG	14.00	2613
-------------------	-------	------

Native Grass - NG	6.90	2692
-------------------	------	------

Native Grass - NG	3.00	2815
-------------------	------	------

Total Acres :	316.70	
----------------------	---------------	--

No Ag Building Details found

Property Details for PID: 0600821000000001000

Shareable link to Property Information : <https://www.kansasgis.org/orka/permalinkprop.cfm?parcelid=0600821000000001000>

Shareable link to Map: <https://www.kansasgis.org/orka/permalink.cfm?parcelid=0600821000000001000>

QuickRef ID : R897

Owner Name : REXFORD, MERL D & MARILYN J

Location: 00000, Meade, KS 67864

Abbreviated Boundary Description: S10 , T31 , R28 , ACRES 474.4 , N2 & SW4 LESS R/W

Owner Information:

Owner REXFORD, MERL D & MARILYN J

Mailing Address PO BOX 880 MEADE, KS 67864

Property Information:

Type Agricultural Use

Status Active

Taxing Unit 008

Neighborhood Code 412

No Secondary Address Details found

Market Land Details:

Actual Width: 0

Eff. Width 0

Eff. Depth 0

Acres 0

Square Feet 0

No Permit Details found

Deed Book Page Details

Book	Page
97	143

Additional Deed Book Page Details

Deed Book/Page 09PR/15

Value Details

	Year	2020
Current Final Value (Agricultural)	Land	\$111,980.00
	Building	\$5,140.00
	Total	\$117,120.00

No Dwelling Details found

No Manufactured Home Details found

No Additional Dwelling Details found

No Other Improvements found

No Commercial Building Details found

No Commercial Building Section Details found

Ag Land Details

Acre Type :	No Acres :	Map Unit :	Irrig :	Well Depth :
Dry Land - DR	0.50	2562		
Dry Land - DR	53.80	2612		
Dry Land - DR	0.70	2691		
Dry Land - DR	6.30	2801		
Dry Land - DR	4.60	2815		
Irrigated Land - IR	10.70	2562	C	500
Irrigated Land - IR	208.30	2612	C	500
Irrigated Land - IR	4.50	2691	C	500
Irrigated Land - IR	2.30	2692	C	500
Irrigated Land - IR	21.40	2815	C	500
Native Grass - NG	139.40	2562		

Native Grass - NG	8.60	2612
-------------------	------	------

Native Grass - NG	2.40	2613
-------------------	------	------

Native Grass - NG	4.80	2692
-------------------	------	------

Native Grass - NG	6.10	2815
-------------------	------	------

Total Acres :	474.40	
----------------------	--------	--

Ag Building Details

Type	Quantity	Size	Year Built	Grade	Condition
Tool Shed		16X40	1940	AV	PR
Farm Utility Storage Shed		30X80	1940	AV	PR
Site Improvements		16X18	1980	AV	FR