

File No. **33039** 11. County: **SV** Basin: **CIMARRON RIVER** Stream: Formation Code: Special Use:

12. Points of Diversion
CHK Rate and Quantity
MOD Authorized Additional
DEL PDIV Qualifier S T R ID 'N 'W **Comment (AKA Line)** Rate Quantity Rate Quantity
ENT gpm af gpm af Overlap PD Files

CHK 73793

13. Storage: Rate _____ NF Quantity _____ ac/ft Additional Rate _____ NF Additional Quantity _____ ac/ft

14. Limitation: _____ af/yr at _____ gpm (_____ cfs) when combined with file number(s) _____
 Limitation: _____ af/yr at _____ gpm (_____ cfs) when combined with file number(s) _____

15. 5YR Allocation: Allocation Type _____ Start Year _____ 5 YR Amount _____ Amount Unit _____ Base Acres _____ Comment _____

16. Place of Use CHK MOD DEL ENT	PUSE	S	T	R	ID	NE¼				NW¼				SW¼				SE¼				Total	Owner	Chg?	Overlap Files
						NE ¼	NW ¼	SW ¼	SE ¼	NE ¼	NW ¼	SW ¼	SE ¼	NE ¼	NW ¼	SW ¼	SE ¼	NE ¼	NW ¼	SW ¼	SE ¼				
MOD	15033	20	33	38W	01	23	30	33	23							35	35	20	20	219	8a	NO	6032, 32443		
MOD	39903	21	33	38W	02								32	38.5	29	18	15	34	25	40	231.5	8a	YES	6032, 32443	

Base Acres: **295** Year: Minimum Reasonable Quantity:
 Comments: TOTAL COMBINED BASE = 441 ACRES

Garden City Field Office
4532 W. Jones, Suite B
Garden City, KS 67846



Phone: 620-276-2901
Fax: 620-276-9315
www.agriculture.ks.gov

Mike Beam, Secretary

Laura Kelly, Governor

September 3, 2021

WARREN M & AMANDA R WILLIS
613 ROAD N
HUGOTON, KS 67951

RE: Approval of Application for Change
Water Right, File Nos. 6032, 32443, 33039

Dear Sir and Madam:

Enclosed are orders executed by the designee of the Chief Engineer, Division of Water Resources, Kansas Department of Agriculture, approving the applications for change under the above referenced file numbers.

Your attention is directed to the enclosures and to the terms, conditions, and limitations specified in the approvals for change. A condition of the approval is that acceptable water flow meters must be installed on the diversion works authorized under the referenced file numbers and meet current specification. Please return the required notification of completion of the diversion works and installation of the required meters as soon as these actions are completed.

Since the orders modify the original documents referred to above, they should be recorded with the Register of Deeds as other instruments affecting real estate.

Should you have any questions, please feel free to call this office. If you would prefer, you could arrange an appointment for additional assistance.

Sincerely,

A handwritten signature in blue ink that reads "Michael A. Meyer".

Michael A. Meyer
Water Commissioner

MAM:
enclosures
pc: GMD3

CERTIFICATE OF SERVICE

On this 3rd day of September 2021, I hereby certify that the foregoing Approval of Application for Change in Place of Use, Water Right, File Nos. 6,032, 32,443 and 33,039 dated 3rd day of September 2021 was mailed postage prepaid, first class, US mail to the following:

WARREN M & AMANDA R WILLIS
613 ROAD N
HUGOTON, KS 67951

Pc:

GROUNDWATER MANAGEMENT DISTRICT NO. 3



Division of Water Resources

Submit completed application to:
 Kansas Department of Agriculture
 Division of Water Resources
 Field Office for your area.

Call for address:

Topeka -- (785) 296-5733
 Stafford -- (620) 234-5311
 Stockton -- (785) 425-6787
 Garden City -- (620) 276-2901
<http://agriculture.ks.gov/dwr>

DWR FIELD OFFICE APPLICATION FOR APPROVAL TO CHANGE THE PLACE OF USE AND/OR THE POINT OF DIVERSION



STATE OF KANSAS

Filing Fee Must Accompany the Application, K.S.A. 82a-708b(b), as amended.
 Fee Schedule is on the third page of this application form.

Paragraph Nos. 1, 2, 3 & 5 must be completed. Complete all other applicable portions. If change in point of diversion is greater than 100 feet, or if place of use will be changed, include a topographic map or detailed plat showing the authorized and proposed point(s) of diversion and/or place of use.

RECEIVED
 3:17 PM
 AUG 26 2021

File No. 33039

Garden City Field Office
 Division of Water Resources

1. Application is hereby made for approval of the Chief Engineer to change the (check one or both):

Place of Use Point of Diversion

under the water right which is the subject of this application in accordance with the conditions described below.

The source of supply is: Groundwater Surface water

2. Name and address of Applicant: WARREN M & AMANDA R WILLIS

613 ROAD N, HUGOTON, KS 67951

Phone Number: () Email address: _____

Name and address of Water Use Correspondent: Same

Phone Number: () Email address: _____

3. The presently authorized place of use is:

Owner of Land ---- NAME: WARREN M & AMANDA R WILLIS

ADDRESS: 613 ROAD N, HUGOTON, KS 67951

(If there is more than one landowner, attach supplemental sheets as necessary.)

Sec.	Twp.	Range	NE¼				NW¼				SW¼				SE¼				TOTAL ACRES
			NE¼	NW¼	SW¼	SE¼	NE¼	NW¼	SW¼	SE¼	NE¼	NW¼	SW¼	SE¼	NE¼	NW¼	SW¼	SE¼	
20	33	38W	25	30	30	30													219

4. If this application is for a change in place of use, it is proposed that the place of use be changed to:

Owner of Land ---- NAME: WARREN M & AMANDA R WILLIS

ADDRESS: 613 ROAD N, HUGOTON, KS 67951

(If there is more than one landowner, attach supplemental sheets as necessary.)

Sec.	Twp.	Range	NE¼				NW¼				SW¼				SE¼				TOTAL ACRES
			NE¼	NW¼	SW¼	SE¼	NE¼	NW¼	SW¼	SE¼	NE¼	NW¼	SW¼	SE¼	NE¼	NW¼	SW¼	SE¼	
20	33	38W	23	30	33	23													219

For Office Use Only: Code _____ Fee \$ 200.00 TR # _____ Receipt Date 8-26-21 Check # 12676

5. **Presently authorized point of diversion:**
 One in the _____ Quarter of the _____ Quarter of the _____ Quarter
 of Section _____, Township _____ South, Range _____ (E/W),
 in _____ County, Kansas, _____ feet North _____ feet West of Southeast corner of section.
 Authorized Rate _____ Authorized Quantity _____ Depth of well _____ (feet)
(DWR use only: Computer ID No. _____ GPS _____ feet North _____ feet West)
 This point will not be changed This point will be changed as follows: No change, point better described with GPS as follows:
Proposed point of diversion: (Complete only if change is requested or if existing point is better described by GPS)
 One in the _____ Quarter of the _____ Quarter of the _____ Quarter
 of Section _____, Township _____ South, Range _____ (E/W),
 in _____ County, Kansas, _____ feet North _____ feet West of Southeast corner of section.
 Proposed Rate _____ Proposed Quantity _____ Proposed well depth (feet) _____
 This point is: Additional Well Geo Center List other water rights that will use this point _____

6. **Presently authorized point of diversion:**
 One in the _____ Quarter of the _____ Quarter of the _____ Quarter
 of Section _____, Township _____ South, Range _____ (E/W),
 in _____ County, Kansas, _____ feet North _____ feet West of Southeast corner of section.
 Authorized Rate _____ Authorized Quantity _____ Depth of well _____ (feet)
(DWR use only: Computer ID No. _____ GPS _____ feet North _____ feet West)
 This point will not be changed This point will be changed as follows: No change, point better described with GPS as follows:
Proposed point of diversion: (Complete only if change is requested or if existing point is better described by GPS)
 One in the _____ Quarter of the _____ Quarter of the _____ Quarter
 of Section _____, Township _____ South, Range _____ (E/W),
 in _____ County, Kansas, _____ feet North _____ feet West of Southeast corner of section.
 Proposed Rate _____ Proposed Quantity _____ Proposed well depth (feet) _____
 This point is: Additional Well Geo Center List other water rights that will use this point _____

7. The changes herein are desired for the following reasons?
 (please be specific) _____

8. If a well, is the test hole log attached? Yes No

9. The change(s) (was)(will be) completed by?

10. If the point of diversion is a well:
 (a) What are you going to do with the old well?
 N/A
 (b) When will this be done? N/A

11. Groundwater Management District recommendation attached?
 Yes No

12. Assisted by mdf/GCFO

13a. If the proposed point of diversion will be relocated more than 300 feet but within 2,640 feet of the existing point of diversion, attach a topographic map or aerial photograph. For groundwater sources, show all wells (including domestic) within one-half mile of the proposed point of diversion and the names and mailing addresses of the owners. For surface water sources, show the names and addresses of the landowner(s) one-half mile downstream and one-half mile upstream from your property lines

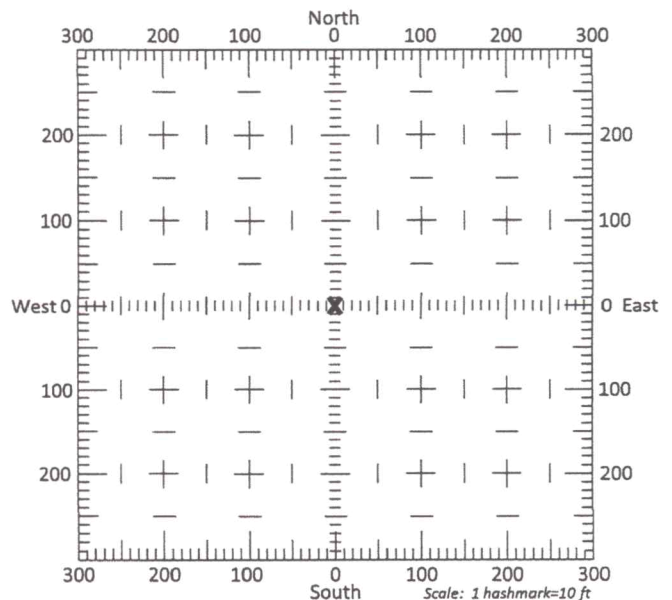

13b. If the proposed point of diversion will be relocated within 300 feet of the existing point of diversion, indicate its location on the diagram shown above in relation to the existing point of diversion. (PLEASE NOTE: The "X" in center of diagram above represents the presently authorized point of diversion.)

APPLICATION FOR APPROVAL TO CHANGE
THE PLACE OF USE AND/OR POINT OF DIVERSION
SUPPLEMENTAL SHEET
FILE NO. 33039
MAKE ADDITIONAL COPIES AS NECESSARY

3. Continued: The presently authorized place of use is:

Owner of Land --- NAME: ~~MICHAEL B & VALERIE L HERSHEY~~
ADDRESS: ~~1176 ROAD 12, HUGOTON, KS 67951~~

Warren & Amanda Willis
613 Rd N Hugoton

Sec.	Twp.	Range	NE¼				NW¼				SW¼				SE¼				TOTAL ACRES
			NE¼	NW¼	SW¼	SE¼	NE¼	NW¼	SW¼	SE¼	NE¼	NW¼	SW¼	SE¼	NE¼	NW¼	SW¼	SE¼	
21	33	38W									39.5	40	12	6	38	38	35	23	231.5

Owner of Land --- NAME: _____
ADDRESS: _____

Sec.	Twp.	Range	NE¼				NW¼				SW¼				SE¼				TOTAL ACRES
			NE¼	NW¼	SW¼	SE¼	NE¼	NW¼	SW¼	SE¼	NE¼	NW¼	SW¼	SE¼	NE¼	NW¼	SW¼	SE¼	

Owner of Land --- NAME: _____
ADDRESS: _____

Sec.	Twp.	Range	NE¼				NW¼				SW¼				SE¼				TOTAL ACRES
			NE¼	NW¼	SW¼	SE¼	NE¼	NW¼	SW¼	SE¼	NE¼	NW¼	SW¼	SE¼	NE¼	NW¼	SW¼	SE¼	

4. Continued: If this application is for a change in place of use, it is proposed that the place of use be changed to:

Owner of Land --- NAME: ~~MICHAEL B & VALERIE L HERSHEY~~
ADDRESS: ~~1176 ROAD 12, HUGOTON, KS 67951~~

Warren M. and Amanda Willis
613 Rd N Hugoton

Sec.	Twp.	Range	NE¼				NW¼				SW¼				SE¼				TOTAL ACRES
			NE¼	NW¼	SW¼	SE¼	NE¼	NW¼	SW¼	SE¼	NE¼	NW¼	SW¼	SE¼	NE¼	NW¼	SW¼	SE¼	
21	33	38W									32	38.5	29	18	15	34	25	40	231.5

Owner of Land --- NAME: _____
ADDRESS: _____

Sec.	Twp.	Range	NE¼				NW¼				SW¼				SE¼				TOTAL ACRES
			NE¼	NW¼	SW¼	SE¼	NE¼	NW¼	SW¼	SE¼	NE¼	NW¼	SW¼	SE¼	NE¼	NW¼	SW¼	SE¼	

Owner of Land --- NAME: _____
ADDRESS: _____

Sec.	Twp.	Range	NE¼				NW¼				SW¼				SE¼				TOTAL ACRES
			NE¼	NW¼	SW¼	SE¼	NE¼	NW¼	SW¼	SE¼	NE¼	NW¼	SW¼	SE¼	NE¼	NW¼	SW¼	SE¼	

14. If the proposed groundwater point of diversion is 300 or fewer feet from the existing point of diversion, complete the following:

- (a) Does the undersigned represent all owners of the currently authorized place(s) of use identified in this application?
 Yes No (If no, all owners must sign this application.)
- (b) Will the ownership interest of any owner of the currently authorized place(s) of use identified in this application be adversely affected if this application is approved as requested?
 Yes No (If yes, all owners must sign this application.)
- (c) If this application is not approved expeditiously, will there be substantial damage to property, public health or safety?
 Yes No (If no, all owners must sign this application.)

If the application proposes a surface water change in point of diversion, a groundwater change in point of diversion greater than 300 feet, or a change in place of use, the application must be signed by all owners of the currently authorized place of use, or their duly authorized agent (attach notarized statement authorizing representation).

I hereby verify, being first duly sworn upon my oath or affirmation and under penalty of perjury, that I am of lawful age and the owner, the spouse of the owner, or a duly authorized agent of the owner(s) to make this application on their behalf, in regards to the water right(s) to which this application pertains. I further verify that the statements contained in this application are true, correct and complete.

Dated at Hugoton, Kansas, this 20 day of August, 2021.

Warren M. Willis
(Owner)

Amanda R Willis
(Spouse)

Warren M. Willis
(Please Print)

Amanda R Willis
(Please Print)

(Owner)

(Spouse)

(Please Print)

(Please Print)

(Owner)

(Spouse)

(Please Print)

(Please Print)

State of Kansas }
County of Stevens } SS

I hereby certify that the foregoing application was signed in my presence and sworn to before me this 20th day of August, 2021.

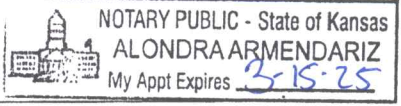

Alondra Armendariz 8-20-21
Notary Public

My Commission Expires _____

ONLY COMPLETE APPLICATIONS WILL BE PROCESSED. To be complete, all of the applicable portions of the application form must be completed with accurate information; maps, if necessary, must be included; signatures of all the appropriate owners' must be affixed to the application and notarized; and the appropriate fee must be paid.



FEE SCHEDULE

Each application to change the place of use or the point of diversion under this section shall be accompanied by the application fee set forth in the schedule below: Make checks payable to: **Kansas Department of Agriculture**

- (1) Application to change a point of diversion 300 feet or less \$100
- (2) Application to change a point of diversion more than 300 feet \$200
- (3) Application to change the place of use \$200

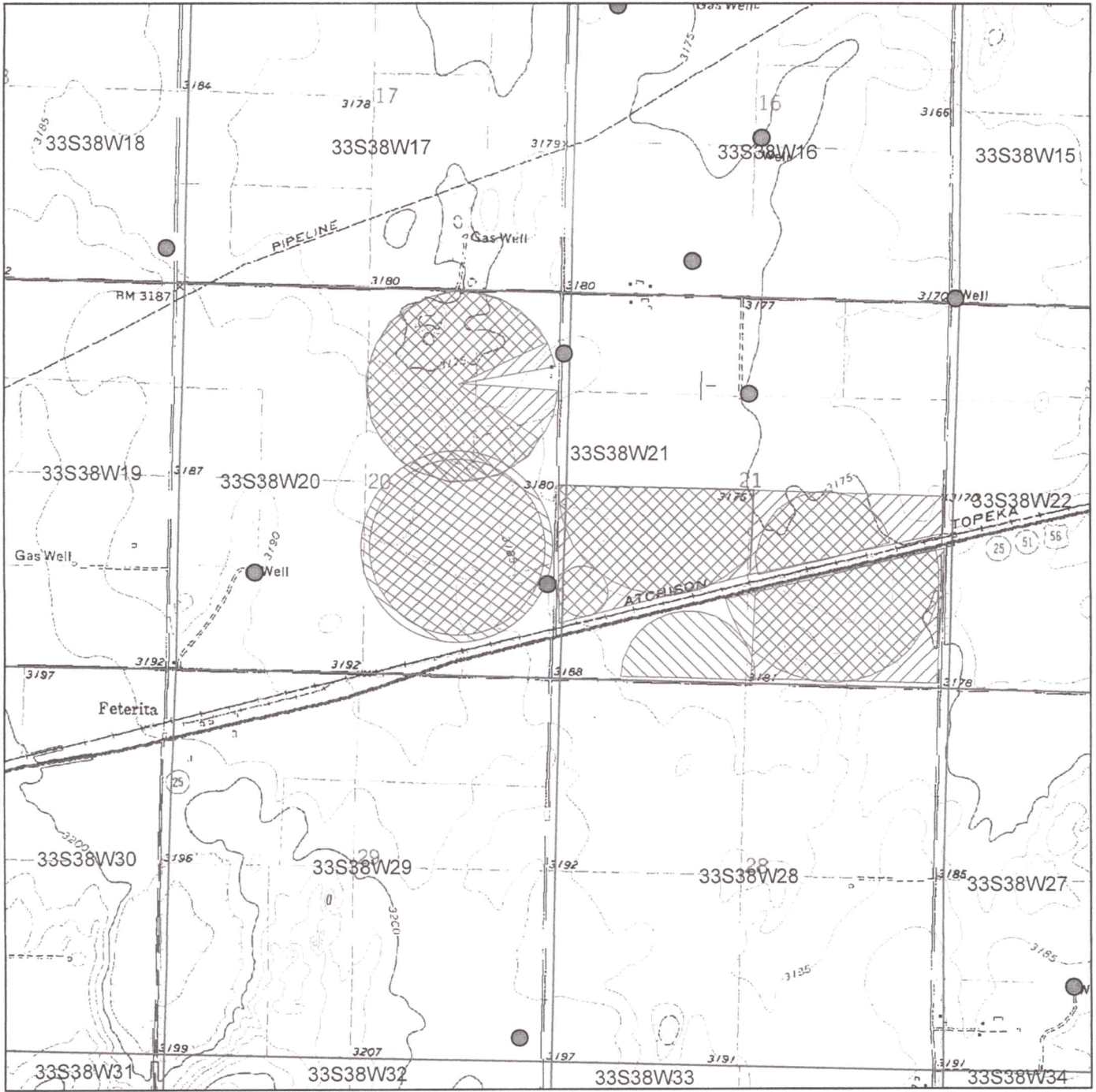
Change in place of use application for water right 33039



-  Authorized place of use
-  Proposed place of use

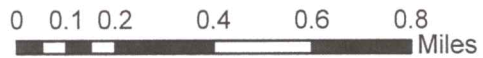

All wells within 1/2 mile are on this map.

X Wane Wilk

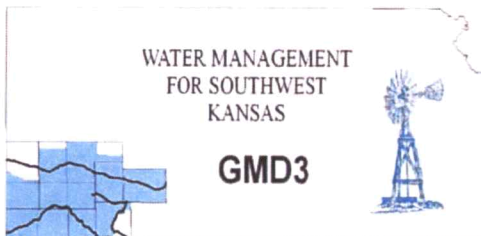

Southwest Kansas
Groundwater Management District No. 3
2009 E. Spruce Street
Garden City, Kansas 67846
(620) 275-7147 phone (620) 275-1431 fax
www.gmd3.org

September 1, 2021

Michael A. Meyer
Division of Water Resources
4532 W Jones Ave., Suite B
Garden City, Kansas 67846

RE: Applications for Change in Place of Use
Water Right, File Nos. 6032, 32443 & 33039

Dear Mike:

We have reviewed the applications for the above referenced water rights. The proposal is not in conflict with the Management Program of the Southwest Kansas Groundwater Management District No. 3 (GMD3). The proposed change in place of use will rearrange the acres to better suit the operation and is in accordance with K.A.R. 5-5-11(b). It will be less than 10 acres over base and no increase in currently authorized acres. It is therefore recommended that the applications be approved at this time.

Thank you for the opportunity to review the applications and to provide a recommendation. If you have any questions, please don't hesitate to contact us.

Sincerely,

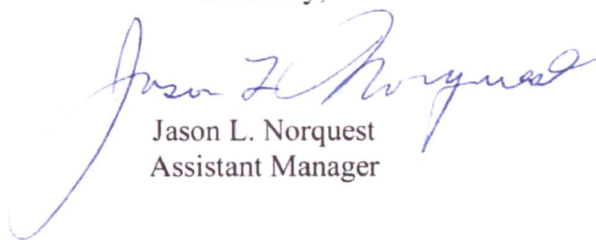

Jason L. Norquest
Assistant Manager

RECEIVED
SEP 01 2021
Garden City Field Office
Division of Water Resources

GMD3 Change Review

File No(s): 6032, 32443, 33039.

DWR office: GC.

App filed to change: PU.

Is Landowner(s) correct in WRIS: Warren & Amanda Willis.

If NO, is documentation included?

Is Water Use Correspondent correct in WRIS? .

If NO, is documentation included?

Regulation(s) Reviewed: KAR 5-5-11(b)

Point of diversion ID No(s) being changed.

	ft. North	ft. West	
Authorized PD			
Proposed PD			
Difference	0	0	
a ² + b ² = c ²	0	0	0

GPS for proposed PD: Lat: Long: .

Is proposed PD stacking on existing WRs? No Change .

Is Proposed PU overlapping existing WRs? Rearrange acres for operation, will be complete overlap.

Neighboring certified well(s) notified: .

Name .

Address .

Zip .

Email: Phone: .

Domestic well(s) notified: .

Name .

Address .

Zip .

Base Acres: 441 acres combined .

Perfected Acres: .

Irr. Return-Flow %

All three WRs currently overlapped in PU.

Current authorized acres: 219 Section 20-33-38

231.5 Section 21-33-38

450.5 acres total

Proposed acres: 450.5 acres, but rearranged

Proposing no more acres than currently authorized and is only 9.5 acres over combined base acres.

Is a waiver needed: Authorizing 9.5 acres over combined base.

Recommendation: After review of all available information, it appears current area rules are met. Staff therefore recommends approval of the applications.



Garden City Field Office
4532 W. Jones, Suite B
Garden City, KS 67846



Phone: 620-276-2901
Fax: 620-276-9315
www.agriculture.ks.gov

Mike Beam, Secretary

Laura Kelly, Governor

August 30, 2021

SOUTHWEST KANSAS GROUNDWATER
MANAGEMENT DISTRICT NO. 3
2009 E SPRUCE ST
GARDEN CITY KS 67846

Re: Water Right, File Nos. 6032, 32443, 33039

Dear Mr. Norquest:

This is to advise you that Warren Willis, has filed applications for approval of the Chief Engineer, Division of Water Resources, Kansas Department of Agriculture, to change the place of use.

We are delaying action on the change application to allow you time to review and provide a recommendation. Please submit a recommendation within 15 days from the date of this letter.

Thank you and as always feel free to contact this office at any time.

Sincerely,

A handwritten signature in blue ink, appearing to read "Michael A. Meyer".

Michael A. Meyer
Water Commissioner

MAM
Enclosures