

File No. **41725** 11. County: **SV** Basin: **CIMARRON RIVER** Stream: _____ Formation Code: **211** Special Use: _____

12. Points of Diversion
CHK Rate and Quantity
MOD Authorized Additional
DEL PDIV Qualifier S T R ID 'N 'W **Comment (AKA Line)** Rate Quantity Rate Quantity
ENT _____ _____ _____ _____ _____ _____ _____ _____ _____ _____ _____ _____
 gpm af gpm af Overlap PD Files

DEL 33776

ENT **SENE** **8 34 35W** **4240 273** **990 728** **205 468** **41456**

13. Storage: Rate _____ NF Quantity _____ ac/ft Additional Rate _____ NF Additional Quantity _____ ac/ft

14. Limitation: _____ af/yr at _____ gpm (_____ cfs) when combined with file number(s) _____
 Limitation: _____ af/yr at _____ gpm (_____ cfs) when combined with file number(s) _____

15. 5YR Allocation: Allocation Type _____ Start Year _____ 5 YR Amount _____ Amount Unit _____ Base Acres _____ Comment _____

16. Place of Use CHK MOD DEL ENT	NE¼				NW¼				SW¼				SE¼				Total	Owner	Chg?	Overlap Files			
	PUSE	S	T	R	ID	NE ¼	NW ¼	SW ¼	SE ¼	NE ¼	NW ¼	SW ¼	SE ¼	NE ¼	NW ¼	SW ¼					SE ¼		
CHK 11596																							
CHK 37772																							

Base Acres: _____ **Year:** _____ **Minimum Reasonable Quantity:** _____
 Comments: _____

Garden City Field Office
4532 W. Jones, Suite B
Garden City, KS 67846



Phone: 620-276-2901
Fax: 620-276-9315
www.agriculture.ks.gov

Mike Beam, Secretary

Laura Kelly, Governor

January 22, 2021

GEORGE TRENT & TAMMY J SOLCUM
PO BOX 244
HUGOTON, KS 67951

RE: Water Right, File Nos. 41456, 41725

Dear Sir and Madam:

Enclosed are orders executed by the designee of the Chief Engineer, Division of Water Resources, Kansas Department of Agriculture, approving the applications for change under the above referenced file numbers.

Your attention is directed to the enclosures and to the terms, conditions, and limitations specified in the approval for change. A condition of the approval is that an acceptable water flow meter must be installed on the diversion works authorized under the referenced file number and meet current specifications. Please return the required notification of completion of the diversion works and installation of the required meter as soon as these actions are completed.

Since the orders modify the original documents referred to above, they should be recorded with the Register of Deeds as other instruments affecting real estate.

The abandoned well must be plugged in accordance with the requirements of Article 30 of the Rules and Regulations as adopted by the Kansas Department of Health and Environment

Should you have any questions, please feel free contact this office. If you would prefer, you could arrange an appointment for additional assistance.

Sincerely,

A handwritten signature in blue ink, appearing to read "Michael A. Meyer".

Michael A. Meyer
Water Commissioner

MAM
enclosures
pc:

GMD3

CERTIFICATE OF SERVICE

On this 22nd day of January 2021, I hereby certify that the foregoing Approval of Application for Change in Point of Diversion, Water Right, File No. 41456 & 41725 dated 22nd day of January 2021 was mailed postage prepaid, first class, US mail to the following:

GEORGE TRENT & TAMMY J SOLCUM
PO BOX 244
HUGOTON, KS 67951

Pc:

GROUNDWATER MANAGEMENT DISTRICT NO. 3



Division of Water Resources Staff

Submit completed application to:
 Kansas Department of Agriculture
 Division of Water Resources
 Field Office for your area.
 Call for address:
 Topeka -- (785) 296-5733
 Stafford -- (620) 234-5311
 Stockton -- (785) 425-6787
 Garden City -- (620) 276-2901
<http://agriculture.ks.gov/dwr>

DWR FIELD OFFICE APPLICATION FOR APPROVAL TO CHANGE THE PLACE OF USE AND/OR THE POINT OF DIVERSION



STATE OF KANSAS

Filing Fee Must Accompany the Application, K.S.A. 82a-708b(b), as amended.
 Fee Schedule is on the third page of this application form.

Paragraph Nos. 1, 2, 3 & 5 must be completed. Complete all other applicable portions. If change in point of diversion is greater than 100 feet, or if place of use will be changed, include a topographic map or detailed plat showing the authorized and proposed point(s) of diversion and/or place of use.

File No. 41725

RECEIVED
 8:56 AM
 DEC 18 2020

1. Application is hereby made for approval of the Chief Engineer to change the (check one or both):

Place of Use Point of Diversion

under the water right which is the subject of this application in accordance with the conditions described below.

The source of supply is: Groundwater Surface water

Garden City Field Office
 DIVISION OF WATER RESOURCES

2. Name and address of Applicant: GEORGE TRENT & TAMMY J SOLCUM SLOCUM
PO BOX 244 HUGOTON KS 67951

Phone Number: () Email address: _____

Name and address of Water Use Correspondent: GEORGE TRENT & TAMMY J SOLCUM SLOCUM
PO BOX 244 HUGOTON KS 67951

Phone Number: () Email address: _____

3. The presently authorized place of use is:

Owner of Land ---- NAME: NO CHANGE

ADDRESS: _____

(If there is more than one landowner, attach supplemental sheets as necessary.)

Sec.	Twp.	Range	NE¼				NW¼				SW¼				SE¼				TOTAL ACRES		
			NE¼	NW¼	SW¼	SE¼	NE¼	NW¼	SW¼	SE¼	NE¼	NW¼	SW¼	SE¼	NE¼	NW¼	SW¼	SE¼			

4. If this application is for a change in place of use, it is proposed that the place of use be changed to:

Owner of Land ---- NAME: NO CHANGE

ADDRESS: _____

(If there is more than one landowner, attach supplemental sheets as necessary.)

Sec.	Twp.	Range	NE¼				NW¼				SW¼				SE¼				TOTAL ACRES			
			NE¼	NW¼	SW¼	SE¼	NE¼	NW¼	SW¼	SE¼	NE¼	NW¼	SW¼	SE¼	NE¼	NW¼	SW¼	SE¼				

For Office Use Only: Code _____ Fee \$ 200.00 TR # _____ Receipt Date 12-18-20 Check # 9027

5. **Presently authorized point of diversion:**
 One in the NE Quarter of the NE Quarter of the NW Quarter of Section 8, Township 34 South, Range 35 W, in Stevens County, Kansas, 5135 feet North 2670 feet West of Southeast corner of section.
 Authorized Rate --- Authorized Quantity --- Depth of well --- (feet)
 (DWR use only: Computer ID No. 03 GPS --- feet North --- feet West)
 This point will not be changed This point will be changed as follows: No change, point better described with GPS as follows:
Proposed point of diversion: (Complete only if change is requested or if existing point is better described by GPS)
 One in the SE Quarter of the NE Quarter of the NE Quarter of Section 8, Township 34 South, Range 35 W, in Stevens County, Kansas, 4240 feet North 273 feet West of Southeast corner of section.
 Proposed Rate --- Proposed Quantity --- Proposed well depth (feet) 651
 This point is: Additional Well Geo Center List other water rights that will use this point 41456

6. **Presently authorized point of diversion:**
 One in the _____ Quarter of the _____ Quarter of the _____ Quarter of Section _____, Township _____ South, Range _____ (E/W), in _____ County, Kansas, _____ feet North _____ feet West of Southeast corner of section.
 Authorized Rate _____ Authorized Quantity _____ Depth of well _____ (feet)
 (DWR use only: Computer ID No. _____ GPS _____ feet North _____ feet West)
 This point will not be changed This point will be changed as follows: No change, point better described with GPS as follows:
Proposed point of diversion: (Complete only if change is requested or if existing point is better described by GPS)
 One in the _____ Quarter of the _____ Quarter of the _____ Quarter of Section _____, Township _____ South, Range _____ (E/W), in _____ County, Kansas, _____ feet North _____ feet West of Southeast corner of section.
 Proposed Rate _____ Proposed Quantity _____ Proposed well depth (feet) _____
 This point is: Additional Well Geo Center List other water rights that will use this point _____

7. The changes herein are desired for the following reasons?
 (please be specific) _____

8. If a well, is the test hole log attached? Yes No

9. The change(s) (was)(will be) completed by?

10. If the point of diversion is a well:
 (a) What are you going to do with the old well?

 (b) When will this be done? _____

11. Groundwater Management District recommendation attached?
 Yes No

12. Assisted by _____

13a. If the proposed point of diversion will be relocated more than 300 feet but within 2,640 feet of the existing point of diversion, attach a topographic map or aerial photograph. For groundwater sources, show all wells (including domestic) within one-half mile of the proposed point of diversion and the names and mailing addresses of the owners. For surface water sources, show the names and addresses of the landowner(s) one-half mile downstream and one-half mile upstream from your property lines

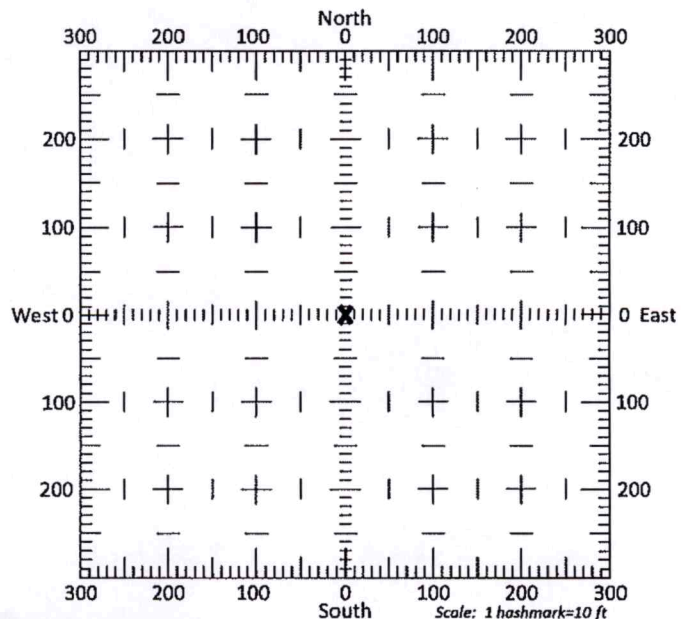

13b. If the proposed point of diversion will be relocated within 300 feet of the existing point of diversion, indicate its location on the diagram shown above in relation to the existing point of diversion. (PLEASE NOTE: The "X" in center of diagram above represents the presently authorized point of diversion.)

14. If the proposed groundwater point of diversion is 300 or fewer feet from the existing point of diversion, complete the following:

- (a) Does the undersigned represent all owners of the currently authorized place(s) of use identified in this application?
 Yes No (If no, all owners must sign this application.)
- (b) Will the ownership interest of any owner of the currently authorized place(s) of use identified in this application be adversely affected if this application is approved as requested?
 Yes No (If yes, all owners must sign this application.)
- (c) If this application is not approved expeditiously, will there be substantial damage to property, public health or safety?
 Yes No (If no, all owners must sign this application.)

If the application proposes a surface water change in point of diversion, a groundwater change in point of diversion greater than 300 feet, or a change in place of use, the application must be signed by all owners of the currently authorized place of use, or their duly authorized agent (attach notarized statement authorizing representation).

I hereby verify, being first duly sworn upon my oath or affirmation and under penalty of perjury, that I am of lawful age and the owner, the spouse of the owner, or a duly authorized agent of the owner(s) to make this application on their behalf, in regards to the water right(s) to which this application pertains. I further verify that the statements contained in this application are true, correct and complete.

Dated at Muscaton, Kansas, this 17 day of December, 2020.

George Trent Stocum
(Owner)

George Trent Stocum
(Please Print)

(Owner)

(Please Print)

(Owner)

(Please Print)

Tammy Jo Stocum
(Spouse)

Tammy Jo Stocum
(Please Print)

(Spouse)

(Please Print)

(Spouse)

(Please Print)

State of Kansas }
County of Stevens } SS

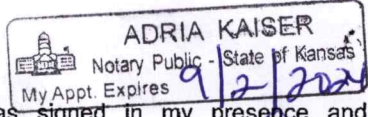

I hereby certify that the foregoing application was signed in my presence and sworn to before me this 17 day of December, 2020.

Adria Kaiser
Notary Public

My Commission Expires 9/2/2024.

ONLY COMPLETE APPLICATIONS WILL BE PROCESSED. To be complete, all of the applicable portions of the application form must be completed with accurate information; maps, if necessary, must be included; signatures of all the appropriate owners' must be affixed to the application and notarized; and the appropriate fee must be paid.

FEE SCHEDULE

Each application to change the place of use or the point of diversion under this section shall be accompanied by the application fee set forth in the schedule below: Make checks payable to Kansas Department of Agriculture

- (1) Application to change a point of diversion 300 feet or less \$100
- (2) Application to change a point of diversion more than 300 feet \$200
- (3) Application to change the place of use \$200

3795 W. Jones Ave.
Garden City, KS 67846
PH: 620-277-2389



PO Box 639-
Garden City, KS 67846
Fax: 620-277-0224

TRENT SLOCUM 620-544-1999

Customer Name: Slocum Farms WO#: 21197 Date: 12-8-20
Street Address: P.O. Box 188 Test #: 1 E LOG: Yes
City, State: HUGOTON, KS 67951 Driller: Dale Guinn
County: Stevens Quarter: NE Section: 8 Township: 34 Range: 35
Location: GPS: N37.10925 W101.14072
Rlg #: 10002 Elevation: 3010' Static WL: 326' Estimated?
Proposed Well Depth 651
WELL LOCATION 20' SUMP

%	Footage			Description of Strata
	From	Pay	To	
	0		2	Top Soil
	2		18	Brown Sandy Clay
	18		60	Fine Med Sand w/Few Clay Layers
	60		82	Fine Med Sand Few Small Brown Gravel
	82		95	Brown Sandy Clay
	95		114	Fine Med Sand w/Very Small Brown Rock + Small Brown Rock
	114		121	Brown Clay w/Few Thin Tan Rock Layers
	121		146	Fine Med Course Sand Small Gravel
	146		157	Brown Sandy Clay
	157		204	Brown Sandy Clay w/Few Lime Rock Layers
	204		225	Brown Sandy Clay w/Some Sand Mixed
	225		230	Fine Med Course Sand
	230		284	Brown Sandy Clay "Little Sticky"
	284		327	Fine Med Sand w/Many clay Layers
	327	64	339	Brown Sandy Clay
25	339	85	424	Fine Med Sand w/Very Small Brown Rock Flakes "Fairly loose" + Few Thin Clay Layers
15	424	19	443	Fine Med Sand w/Some Clay Layers
25	443	45	498	Fine Med Sand w/Few Clay Layers + Very Small Brown Rock Flakes
15	498	22	520	Fine Med Sand w/Some Clay Layers
5	520	40	560	Fine Some Med Sand w/Many Clay Layers
10	560	40	600	Fine Some Med + Course Sand w/Many Clay Layers
	600		621	Grish Blue Clay
10	621	10	631	Fine Med Sand w/Little Clay Mixed
	631		680	Blue Clay
				Super Gel X -4
				EZ Mud 1 qt.
				Grout -2
				Hole Plug -7
				Perma Plug -1
				4 3/4 Dmg Blade -1

TOPO! map printed on 12/11/20 from "Untitled.tpo"

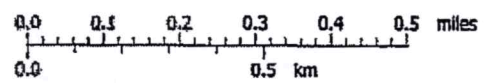
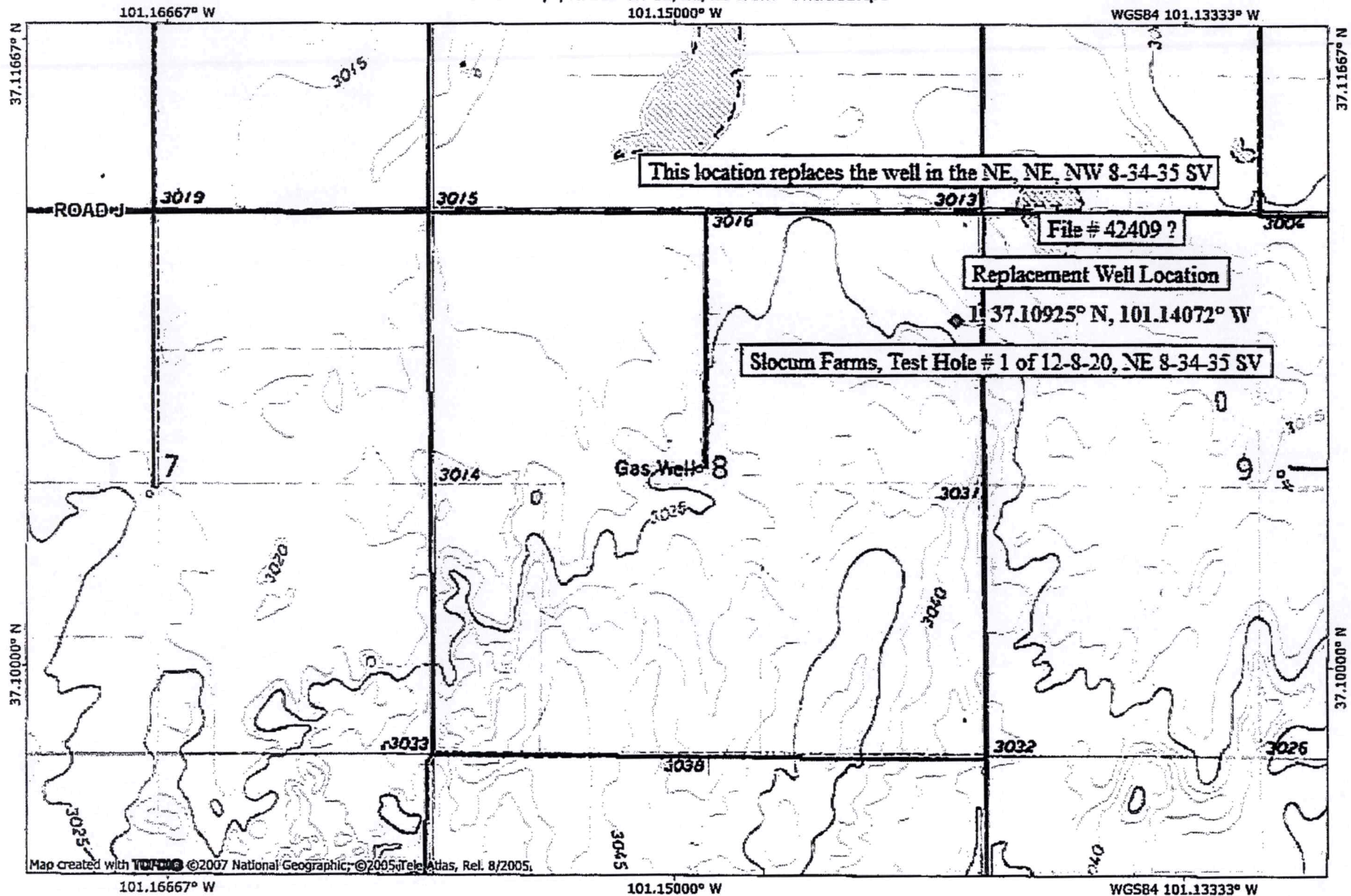

TN MN
5 1/2°
12/11/20

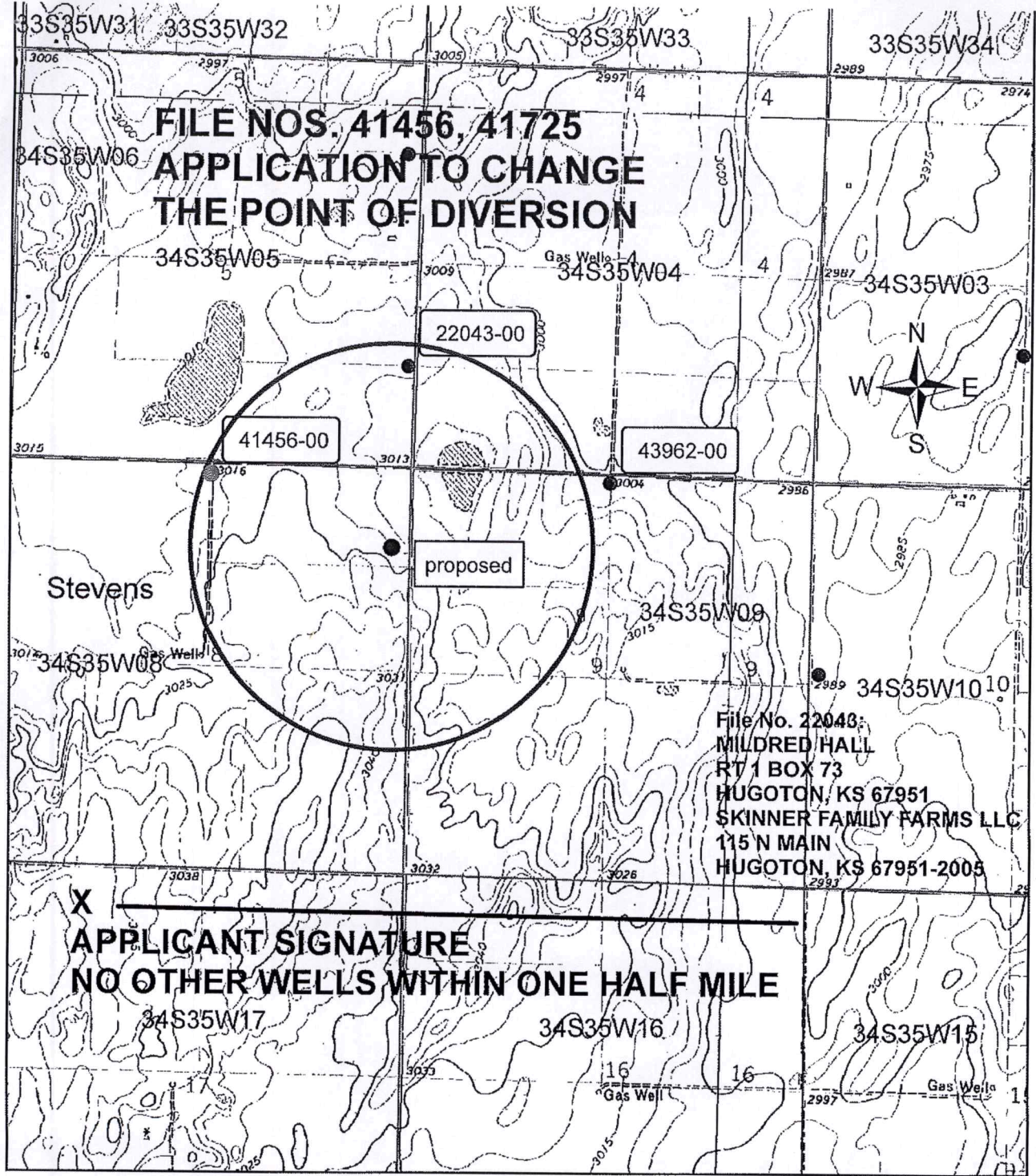

1 inch = 2,000 feet

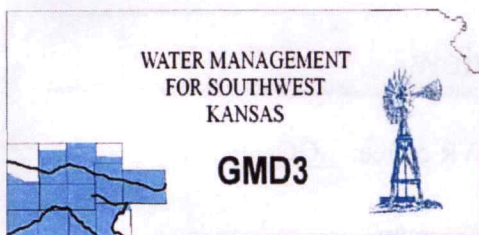

Southwest Kansas
Groundwater Management District No. 3
2009 E. Spruce Street
Garden City, Kansas 67846
(620) 275-7147 phone (620) 275-1431 fax
www.gmd3.org

January 21, 2021

Michael A. Meyer
Division of Water Resources
4532 W Jones Ave., Suite B
Garden City, Kansas 67846

RE: Application for Change in Point of Diversion
Water Right, File Nos. 41456 & 41725

Dear Mike:

We have completed a review of the application for the above referenced water rights. The proposed change in point of diversion is in accordance with current area rules, K.A.R. 5-23-3, as it pertains to distance moved and minimum spacing to neighboring wells.

Well evaluations were conducted to estimate possible effects of the proposal on the supply of other wells with water rights prior to the proposal per K.S.A. 82a-708b, and the draft revised management program. Under K.S.A. 82a-708b, an applicant requesting a change in point of diversion must demonstrate to the chief engineer that any proposed change is reasonable and will not impair. The enclosed report is an analysis performed by the GMD on behalf of our membership. Under this analysis, the proposed change is considered to be reasonable and unlikely to impair if either the net in-season well-to-well effect of the proposed change is less than a strict maximum allowable threshold (4.0 ft in cases where saturated thickness greater than 200 ft), or if no well with a net well-to-well effect exceeding the threshold is identified as critical. Critical wells are identified as wells that are expected to either lose or greatly diminish water supply over the next 25 years. The attached review information is based on a Theis analysis using inputs from the GMD3 aquifer model, which is considered to be the best information on well and aquifer data readily and easily available to the public. If either the applicant or the neighbors believe they have better data that might change the result of the analysis, they should contact GMD3. Conclusions of the well analysis may change if better information on well and aquifer data can be made available.

Every neighboring well within 1 mile of the proposed move was evaluated. Evaluations showed that none of the neighboring wells exceeded the net effect above the maximum allowable threshold and were under that threshold. Our office received one response to clarify the move and results and did not have any comments of concern. Therefore, GMD3 sees this move as reasonable and therefore recommend that the application be approved. If aquifer conditions change or there is a change to the water right in the future, we would be happy to evaluate the effects at that time.

Thank you for the opportunity to review the applications and to provide a recommendation. If you have any questions, please don't hesitate to contact us.

Sincerely,

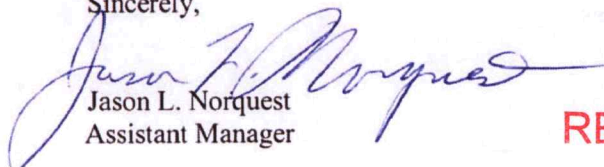
Jason L. Norquest
Assistant Manager

RECEIVED

JAN 21 2021

Garden City Field Office
Division of Water Resources

GMD3 Change Review

File No(s): 41456 & 41725.

DWR office: GC.

App filed to change: PD.

Is Landowner(s) correct in WRIS: George & Tammy Slocum.

If NO, is documentation included?

Is Water Use Correspondent correct in WRIS? __.

If NO, is documentation included?

Regulation(s) Reviewed: KAR 5-23-3

Point of diversion ID No(s) 03 being changed.

	ft. North	ft. West	
Authorized PD	5135	2670	Sect 8-34-35
Proposed PD	4240	273	
Difference	895 s	2397 e	
$a^2 + b^2 = c^2$	801025	5745609	2558.639 foot move SE

GPS for proposed PD: Lat: 37.10925 Long: -101.14072.

Is proposed PD stacking on existing WRs? Moving both WRs.

Is Proposed PU overlapping existing WRs? No Change.

Neighboring certified well(s) notified: __.

Name CJ Skinner (22004 and a domestic well also).

Address 967 Road 24.

Zip Hugoton, KS 67951.

Email: cj.skinner76@gmail.com. Phone: 620-655-4553.

Notes: Mr. Skinner called out office after receiving our notice. Wanted to verify the rules pertaining to the move and that all were met. He also wanted to make sure he understood exactly where the proposed well was to be located and if it could be located somewhere else not located on the application, so we reviewed that policy also. We then reviewed the analysis we did for the proposed redrill and our results. He did NOT have a concern on the move, just asked questions.

Name Richard & Susan James (22043,41608, 43962 & 45450).

Address 1241 Pershing Ave

Zip Liberal, KS 67901.

Email: rsmtjames@att.net. Phone: 620-262-7635.

Domestic well(s) notified: __.

Name __.

Address __.

Zip __.

Base Acres: __.

Perfected Acres: __.

Irr. Return-Flow ___%

GMD3 Change Review

41456 authorized: 260AF @ 785gpm

41725 authorized: 990AF @ 990gpm

Over all limitation of 728AF @ 990gpm

2010-2019 average use: 342.1433AF/year

Current well went to depth of 485ft, drilled in 1995

Is a waiver needed: Appears move is less than half mile and minimum spacing of 2300' is met.

Recommendation:

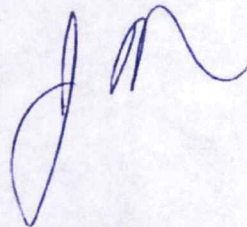

RECEIVED

JAN 21 2021

**Garden City Field Office
Division of Water Resources**

Evaluation of proposed move for Water Right Nos 41456 and 41725

Proposed: Move water right nos. 41456 and 41725 a distance of 2,435 ft to the southeast.

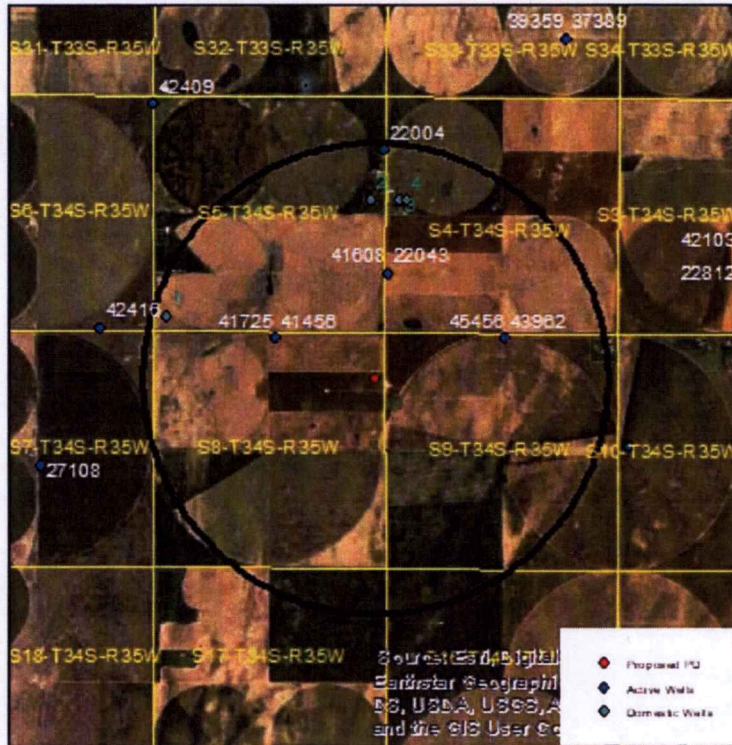

Wells within 1 mile: 22043 & 41608, 43962 & 45456, and 4 domestic wells, numbered on the above map.

The saturated thickness at the proposed well location is estimated to be 363 ft, based upon the GMD3 model. For saturated thickness greater than 200 ft, the drawdown allowance is 4.0 ft.

50 year Theis Analysis: The following values were used to run the analysis:

$S = 0.2251$, $T = 13,372 \text{ ft}^2/\text{day}$, $tp_{\text{current}} = 132 \text{ days}$ (based upon average use and observed rate), $Q_{\text{current}} = 588 \text{ gpm}$ (based upon 2015 field inspection), $tp_{\text{proposed}} = 132 \text{ days}$, $Q_{\text{proposed}} = 990 \text{ gpm}$

Theis drawdowns were calculated as follows:

- 22043 & 41608:
 - Drawdown from current location = 1.68 ft
 - Drawdown from proposed location = 3.83 ft
 - Net drawdown = **2.2 ft**
- 43962 & 45456:
 - Drawdown from current location = 1.17 ft
 - Drawdown from proposed location = 3.33 ft
 - Net drawdown = **2.2 ft**

Domestic 1: Drawdown from current location = 1.84 ft
Drawdown from proposed location = 2.56 ft
Net drawdown = **0.7 ft**

Domestic 2: Drawdown from current location = 1.43 ft
Drawdown from proposed location = 2.87 ft
Net drawdown = **1.4 ft**

Domestic 3: Drawdown from current location = 1.34 ft
Drawdown from proposed location = 2.85 ft
Net drawdown = **1.5 ft**

Domestic 4: Drawdown from current location = 1.32 ft
Drawdown from proposed location = 2.85 ft
Net drawdown = **1.5 ft**

Net drawdown does not exceed the drawdown allowance of 4.0 ft for any wells within 1 mile of the proposed location. Therefore, critical well analysis is not necessary.

Conclusion:

Based upon information from the GMD3 model, this proposal will cause minimal effects on neighboring wells, and is unlikely to create an impairment. GMD3 staff recommends approval of the application.

RECEIVED

JAN 21 2021

Garden City Field Office
Division of Water Resources

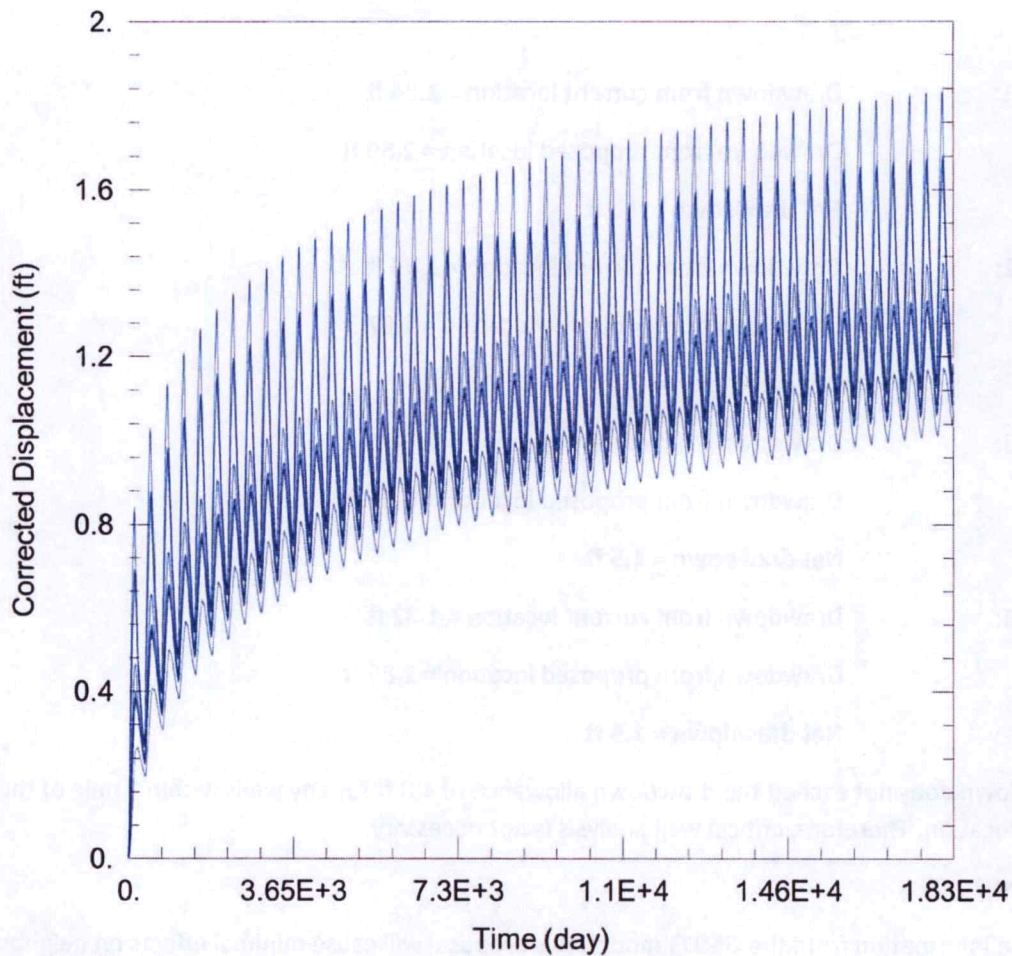

WELL TEST ANALYSIS

Data Set: C:\Users\trevora\Documents\2021_Moves\41456_41725\41456 & 41725 Current.aqt

Date: 01/13/21

Time: 15:55:44

PROJECT INFORMATION

Company: GMD 3

Project: 41456 & 41725

Location: Stevens County

Test Well: 41456 & 41725

WELL DATA

Pumping Wells

Well Name	X (ft)	Y (ft)
41456 & 41725	-101788	86361

Observation Wells

Well Name	X (ft)	Y (ft)
□	-101788	86361
□ 22043 & 41608	-99231	87812
□ 43962 & 45456	-96554	86356
□ Domestic 1	-104246	86863
□ Domestic 2	-99611	89467
□ Domestic 3	-98951	89463
□ Domestic 4	-98794	89444

SOLUTION

Aquifer Model: Unconfined

Solution Method: Theis

T = $1.337E+4$ ft²/day

S = 0.2251

Kz/Kr = 1.

b = 363. ft

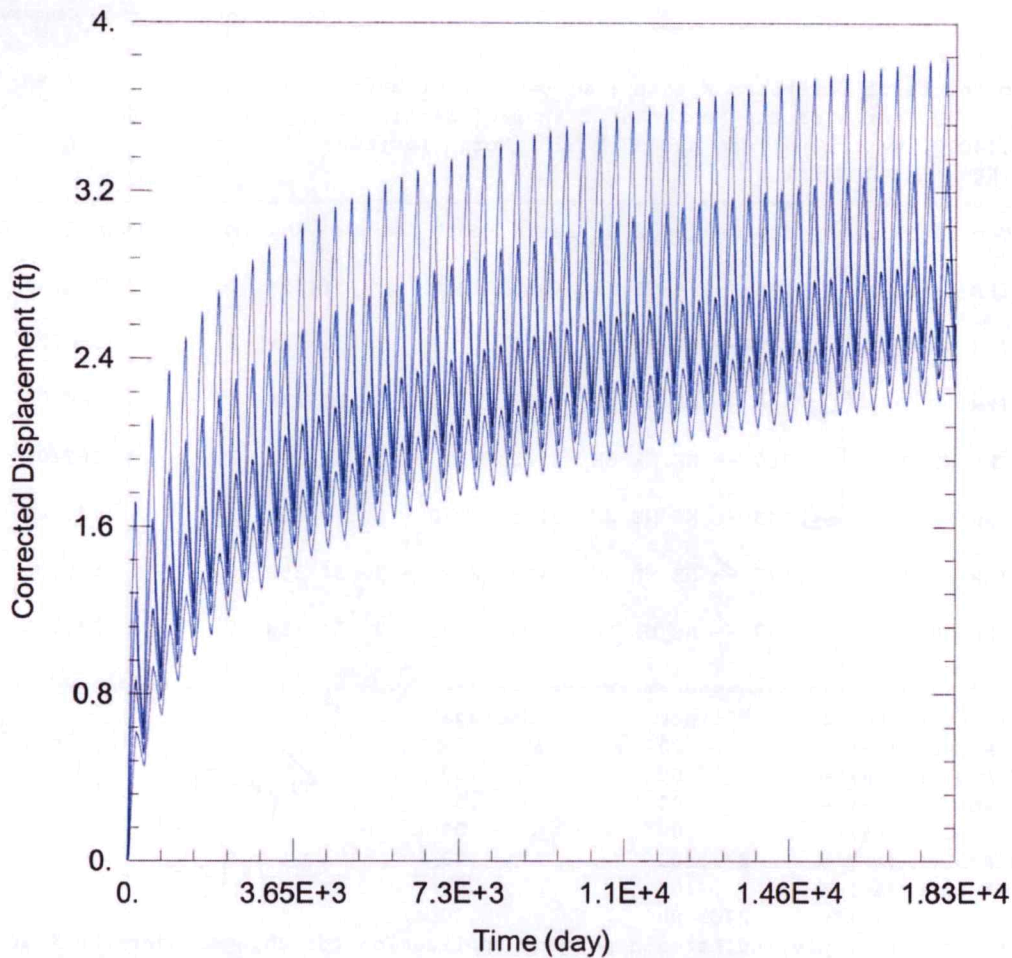

WELL TEST ANALYSIS

Data Set: C:\Users\trevora\Documents\2021_Moves\41456_41725\41456 & 41725 Proposed.aqt
 Date: 01/13/21 Time: 15:55:36

PROJECT INFORMATION

Company: GMD 3
 Project: 41456 & 41725
 Location: Stevens County
 Test Well: 41456 & 41725

WELL DATA

Pumping Wells

Well Name	X (ft)	Y (ft)
41456 & 41725	-99523	85467

Observation Wells

Well Name	X (ft)	Y (ft)
□	-99523	85467
□ 22043 & 41608	-99231	87812
□ 43962 & 45456	-96554	86356
□ Domestic 1	-104246	86863
□ Domestic 2	-99611	89467
□ Domestic 3	-98951	89463
□ Domestic 4	-98794	89444

SOLUTION

Aquifer Model: Unconfined
 $T = 1.337E+4 \text{ ft}^2/\text{day}$
 $Kz/Kr = 1.$

Solution Method: Theis
 $S = 0.2251$
 $b = 363. \text{ ft}$

RECEIVED

JAN 21 2021

Garden City Field Office
 Division of Water Resources

Water Rights and Points of Diversion Within 1 mile of point defined as:

4240 Feet N and 273 Feet W of the Southeast Corner of Section 8 Twp 34S Rng 35W
Located at: 101.140720 West Longitude and 37.109251 North Latitude
Both SURFACE WATER and GROUNDWATER

2300' on 11

File Number	Use	ST	SR	Dist (ft)	Q4	Q3	Q2	Q1	FeetN	FeetW	Sec	Twp	Rng	ID	Batt	Auth_Quan	Add_Quan
A__ AF	22004	00	IRR NK G	5105	✓	--	CE	NE	4060	150	5	34	35W	1		775.00	775.00
A__ AF	22043	00	IRR NK G	2360	✓	--	NE	SE	1300	60	5	34	35W	3		320.00	320.00
A__ AF	41456	00	IRR NK G*	2548	✓	--	NE	NE	5135	2670	8	34	35W	3		260.00	260.00
A__ AF	41608	00	IRR NK G	2360	✓	--	NE	SE	1300	60	5	34	35W	3		168.00	168.00
A__ AF	41725	00	IRR NK G*	2548	✓	--	NE	NE	5135	2670	8	34	35W	3		728.00	468.00
A__ AF	43962	00	IRR NK G	2977	✓	--	NE	NE	5190	2690	9	34	35W	1		500.00	500.00
A__ AF	45456	00	IRR NK G	2977	✓	--	NE	NE	5190	2690	9	34	35W	1		244.00	244.00

Total Net Quantities Authorized:	Direct	Storage
Total Requested Amount (AF) =	.00	.00
Total Permitted Amount (AF) =	.00	.00
Total Inspected Amount (AF) =	.00	.00
Total Pro_Cert Amount (AF) =	.00	.00
Total Certified Amount (AF) =	2735.00	.00
Total Vested Amount (AF) =	.00	.00
TOTAL AMOUNT (AF) =	2735.00	.00

Spacing Appears Met.

An * after the source of supply indicates a pending application for change under the file number.
An * after the ID indicates a 15 AF exemption was granted under the file number.
A "G" in the Batt column indicates the GEO CTR of a battery. A "B" indicates a well in the battery.
The number in the Batt column is the number of wells in the battery.

Water Rights and Points of Diversion Within 1 mile of point defined as:
4240 Feet North and 273 Feet West of the Southeast Corner of Section 8 Twp 34S Rng 35W
Located at: 101.140720 West Longitude and 37.109251 North Latitude
Both SURFACE WATER and GROUNDWATER
WATER USE CORRESPONDENTS:

- > File Number Use ST SR
- > C J SKINNER *22004 ✓*
- > 967 ROAD 24
- > HUGOTON KS 67951
-
- > RICHARD & SUSAN JAMES
- > 1241 PERSHING AVE *22047*
- > LIBERAL KS 67901
-
- > GEORGE TRENT & TAMMY J SOLCUM
- > PO BOX 244 *41456*
- > HUGOTON KS 67951
-
- > RICHARD & SUSAN JAMES
- > 1241 PERSHING AVE *41608*
- > LIBERAL KS 67901
-

1/8/2021

Point Amount Statistics

> GEORGE TRENT & TAMMY J SOLCUM
>
> PO BOX 244
> HUGOTON KS 67951

41725

> RICHARD & SUSAN JAMES
>
> 1241 PERSHING AVE
> LIBERAL KS 67901

43962

> RICHARD & SUSAN JAMES
>
> 1241 PERSHING AVE
> LIBERAL KS 67901

45450

=====

RECEIVED

JAN 21 2021

Garden City Field Office
Division of Water Resources

Garden City Field Office
2508 Johns Street
Garden City, KS 67846-2804



Phone: 620-276-2901
Fax: 620-276-9315
www.agriculture.ks.gov

Mike Beam, Interim Secretary

Laura Kelly, Governor

December 21, 2020

RICHARD & SUSAN JAMES
1241 PERSHING AVE
LIBERAL, KS 67901

RE: Water Right, File No. 41456 & 41725

Dear Sir and Madam:

This is to advise you that George & Tammy Slocum has filed an application for approval of the Chief Engineer, Division of Water Resources, Kansas Department of Agriculture, in point of diversion under the above referenced file numbers. An irrigation well is proposed to be relocated.

You can find the complete application posted by water right file number as referenced above at www.agriculture.ks.gov/divisions-programs/dwr/water-appropriation/notices

You are notified on this proposed point of diversion (well) so that you may furnish this office with any comments or other information you may want to submit. Such comments or other information must be received in this office within 15 days from the date of this letter.

Should you have any questions, please feel free to call this office. If you would prefer, an appointment could be arranged for additional assistance. Please refer to the file number when you contact us if you wish to discuss a specific file.

Sincerely,

A handwritten signature in black ink, appearing to read "Michael A. Meyer".

Michael A. Meyer
Water Commissioner

MAM
Pc:

MILDRED HALL
RT 1 BOX 73
HUGOTON, KS 67951

SKINNER FAMILY FARMS LLC
115 N MAIN
HUGOTON, KS 67951-2005

Groundwater Management District No. 3

SCANNED

Meyer, Mike [KDA]

From: Meyer, Mike [KDA]
Sent: Friday, January 8, 2021 11:51 AM
To: 'Norquest, Jason (Norquest@gmd3.org)'
Subject: request for recommendation, File Nos. 41456 & 41725
Attachments: 20210108113710344.pdf

Hello,
please see the attached applications for change in point of diversion. please review and provide a recommendation within 15 days.
thank you

Mike

Garden City Field Office
4532 W. Jones, Suite B
Garden City, KS 67846



Phone: 620-276-2901
Fax: 620-276-9315
www.agriculture.ks.gov

Mike Beam, Secretary

Laura Kelly, Governor

January 8, 2021

SOUTHWEST KANSAS GROUNDWATER
MANAGEMENT DISTRICT NO. 3
2009 E SPRUCE ST
GARDEN CITY KS 67846

Re: Water Right, File Nos. 41456 & 41725

Dear Mr. Norquest:

This is to advise you that George and Tammy Slocum, have filed applications for approval of the Chief Engineer, Division of Water Resources, Kansas Department of Agriculture, to change the point of diversion for the above referenced files.

We are delaying action on the change applications to allow you time to review and provide a recommendation. Please submit a recommendation within 15 days from the date of this letter.

Thank you and as always feel free to contact this office at any time.

Sincerely,

A handwritten signature in blue ink that reads "Michael A. Meyer".

Michael A. Meyer
Water Commissioner

MAM
Enclosures