

Kansas Department of Agriculture  
 Division of Water Resources  
**CHANGE: P/D WORKSHEET**

1. File Number: <b>8210</b>	2. Status Change Date: <i>10-18-2021</i>	3. Change Num: <b>C3</b>	4. Field Office: <b>4</b>	5. GMD: <b>3</b>
6. Status: <input checked="" type="checkbox"/> Approved <input type="checkbox"/> Denied by DWR/GMD <input type="checkbox"/> Dismiss by Request/Failure to Return				7. Filing Date of Change: <b>10/4/2021</b>
8a. Applicant(s) New to system <input type="checkbox"/>  <b>WARREN M &amp; AMANDA R WILLIS 613 ROAD N HUGOTON, KS 67951</b>		Person ID <b>59134</b> Add Seq# _____		
8b. Landowner(s) New to system <input type="checkbox"/>  <b>8a</b>		Person ID _____ Add Seq# _____		
8c. Landowner(s) New to system <input type="checkbox"/>  <b>V J LAND &amp; CATTLE CO INC 815 S VANBUREN HUGOTON, KS 67951</b>		Person ID <b>35598</b> Add Seq# _____		
8d. WUC New to system <input type="checkbox"/>  <b>8a (NEW WELL PDIV ID ) 8c (PDIV ID 33170)  NO CHANGE</b>		Person ID _____ Add Seq# _____		
9. Documents and Enclosure(s): <input checked="" type="checkbox"/> DWR Meter(s) Date to Comply: <b>12/31/2022</b> <input checked="" type="checkbox"/> N & P Date to Comply: <b>3/1/2023</b>				
<input type="checkbox"/> Anti-Reverse Meter <input type="checkbox"/> Meter Seal <input checked="" type="checkbox"/> Check Valve <input checked="" type="checkbox"/> N & P Form <input checked="" type="checkbox"/> Water Tube <input checked="" type="checkbox"/> Driller Copy <input checked="" type="checkbox"/> H & E Letter				
<input type="checkbox"/> Conservation Plan    Date Required: _____    Date Approved: _____    Date to Comply: _____				
10. Use Made of Water    From: _____    To: _____				
Date Prepared: <b>10/18/2021</b> By: <b>AM</b> Date Entered: _____    By: _____				

File No. **8210**      11. County: **SV**      Basin: **CIMARRON RIVER**      Stream:      Formation Code: **211**      Special Use:

12. Points of Diversion											Rate and Quantity					
CHK	MOD	DEL	PDIV	Qualifier	S	T	R	ID	'N	'W	Comment (AKA Line)	Authorized		Additional		Overlap PD Files
ENT												Rate gpm	Quantity af	Rate gpm	Quantity af	
CHK				SW SE SW	16	33S	38W	5	480	3500		1653	1280	131	595	968
DEL																
ENT				NW NE SE	21	33S	38W		2613	1115		1240	960	99	446	968

**QUANTITY AND RATE REMAINS AS ASSIGNED**

13. Storage: Rate \_\_\_\_\_ NF      Quantity \_\_\_\_\_ ac/ft      Additional Rate \_\_\_\_\_ NF      Additional Quantity \_\_\_\_\_ ac/ft

14. Limitation: \_\_\_\_\_ af/yr at \_\_\_\_\_ gpm ( \_\_\_\_\_ cfs) when combined with file number(s) **SE JKT FOR LIMITATION; NO CHANGE**  
 Limitation: \_\_\_\_\_ af/yr at \_\_\_\_\_ gpm ( \_\_\_\_\_ cfs) when combined with file number(s) \_\_\_\_\_

15. 5YR Allocation: Allocation Type \_\_\_\_\_ Start Year \_\_\_\_\_ 5 YR Amount \_\_\_\_\_ Amount Unit \_\_\_\_\_ Base Acres \_\_\_\_\_ Comment \_\_\_\_\_

16. Place of Use																		Total	Owner	Chg?	Overlap Files							
CHK	MOD	DEL	ENT	PUSE	S	T	R	ID		NE¼				NW¼								SW¼				SE¼		
										NE ¼	NW ¼	SW ¼	SE ¼	NE ¼	NW ¼	SW ¼	SE ¼	NE ¼	NW ¼	SW ¼	SE ¼	NE ¼	NW ¼	SW ¼	SE ¼			
CHK				5153																								
CHK				32415																								
CHK				33610																								
CHK				57812																								
CHK				57813																								
CHK				57814																								

Base Acres:      Year:      Minimum Reasonable Quantity:  
 Comments:

Garden City Field Office  
4532 W. Jones, Suite B  
Garden City, KS 67846



Phone: 620-276-2901  
Fax: 620-276-9315  
www.agriculture.ks.gov

Mike Beam, Secretary

Laura Kelly, Governor

October 18, 2021

WARREN M & AMANDA R WILLIS  
613 ROAD N  
HUGOTON, KS 67951

RE: Filed Office Application for Change  
Water Right, File Nos. 968 & 8210

Dear Sir or Madam:

Enclosed is the order executed by the designee of the Chief Engineer, Division of Water Resources, Kansas Department of Agriculture, approving the application for change under the above referenced file number.

Your attention is directed to the enclosures and to the terms, conditions, and limitations specified in this approval for change. A condition of this approval is that an acceptable water flow meter must be installed on the diversion works authorized under the referenced file number and meet current specifications. Please return the required notification of completion of the diversion works and installation of the required meter as soon as these actions are completed.

Since the order modifies the original document referred to above, it should be recorded with the Register of Deeds as other instruments affecting real estate.

Should you have any questions, please feel free contact this office. If you would prefer, you could arrange an appointment for additional assistance.

Sincerely,

A handwritten signature in blue ink that reads "Michael A. Meyer".

Michael A. Meyer  
Water Commissioner

MAM:am  
enclosures

pc: VJ Land & Cattle Co Inc.  
GROUNDWATER MANAGEMENT DISTRICT NO. 3

**CERTIFICATE OF SERVICE**

On this 18<sup>th</sup> day of October, 2021, I hereby certify that the foregoing Approval of Application for Change in Point of Diversion, Water Right, File Nos. 968 and 8,210 dated 18<sup>th</sup> day of October, 2021 was mailed postage prepaid, first class, US mail to the following:

WARREN M & AMANDA R WILLIS  
613 ROAD N  
HUGOTON, KS 67951

Pc:

V J LAND & CATTLE CO INC  
815 S VANBUREN  
HUGOTON, KS 67951

GROUNDWATER MANAGEMENT DISTRICT NO. 3

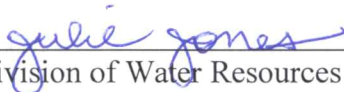
  
\_\_\_\_\_  
Division of Water Resources Staff



Submit completed application to:  
 Kansas Department of Agriculture  
 Division of Water Resources  
 Field Office for your area.

Call for address:

Topeka -- (785) 296-5733  
 Stafford -- (620) 234-5311  
 Stockton -- (785) 425-6787  
 Garden City -- (620) 276-2901  
<http://agriculture.ks.gov/dwr>

## DWR FIELD OFFICE APPLICATION FOR APPROVAL TO CHANGE THE PLACE OF USE AND/OR THE POINT OF DIVERSION



STATE OF KANSAS

**Filing Fee Must Accompany the Application, K.S.A. 82a-708b(b), as amended.**  
 Fee Schedule is on the third page of this application form.

**Paragraph Nos. 1, 2, 3 & 5 must be completed. Complete all other applicable portions.** If change in point of diversion is greater than 100 feet, or if place of use will be changed, include a topographic map or detailed plat showing the authorized and proposed point(s) of diversion and/or place of use.

RECEIVED

OCT 04 2021

File No. 8210

1. Application is hereby made for approval of the Chief Engineer to change the (check one or both):
- Place of Use                       Point of Diversion
- Garden City Field Office  
 Division of Water Resources  
 1:51 pm
- under the water right which is the subject of this application in accordance with the conditions described below.
- The source of supply is:                       Groundwater                       Surface water

2. Name and address of Applicant: WARREN M & AMANDA WILLIS
- 613 ROAD N HUGOTON, KS. 67951
- Phone Number: (620)544-5293                      Email address: \_\_\_\_\_
- Name and address of Water Use Correspondent: WARREN M & AMANDA WILLIS
- 613 ROAD N HUGOTON, KS. 67951
- Phone Number: (620)544 5293                      Email address: \_\_\_\_\_

3. The presently authorized place of use is:
- Owner of Land ---- NAME: NO CHANGE
- ADDRESS: \_\_\_\_\_
- (If there is more than one landowner, attach supplemental sheets as necessary.)

Sec.	Twp.	Range	NE¼				NW¼				SW¼				SE¼				TOTAL ACRES
			NE¼	NW¼	SW¼	SE¼	NE¼	NW¼	SW¼	SE¼	NE¼	NW¼	SW¼	SE¼	NE¼	NW¼	SW¼	SE¼	

4. If this application is for a change in place of use, it is proposed that the place of use be changed to:
- Owner of Land ---- NAME: NO CHANGE
- ADDRESS: \_\_\_\_\_
- (If there is more than one landowner, attach supplemental sheets as necessary.)

Sec.	Twp.	Range	NE¼				NW¼				SW¼				SE¼				TOTAL ACRES
			NE¼	NW¼	SW¼	SE¼	NE¼	NW¼	SW¼	SE¼	NE¼	NW¼	SW¼	SE¼	NE¼	NW¼	SW¼	SE¼	

For Office Use Only: Code \_\_\_\_\_ Fee \$ 200.00 TR # \_\_\_\_\_ Receipt Date 10/4/21 Check # 12752

5. **Presently authorized point of diversion:**  
 One in the SW Quarter of the SE Quarter of the SW Quarter of Section 16, Township 33 South, Range 38 (W), in STEVENS County, Kansas, 480 feet North 3500 feet West of Southeast corner of section.  
 Authorized Rate 1653 GPM Authorized Quantity 1280 AF Depth of well \_\_\_\_\_ (feet)  
**(DWR use only: Computer ID No. 5 GPS \_\_\_\_\_ feet North \_\_\_\_\_ feet West)**  
 This point will not be changed  This point will be changed as follows:  No change, point better described with GPS as follows:  
**Proposed point of diversion: (Complete only if change is requested or if existing point is better described by GPS)**  
 One in the \_\_\_\_\_ Quarter of the \_\_\_\_\_ Quarter of the \_\_\_\_\_ Quarter of Section \_\_\_\_\_, Township \_\_\_\_\_ South, Range \_\_\_\_\_ (E/W), in \_\_\_\_\_ County, Kansas, \_\_\_\_\_ feet North \_\_\_\_\_ feet West of Southeast corner of section.  
 Proposed Rate \_\_\_\_\_ Proposed Quantity \_\_\_\_\_ Proposed well depth (feet) \_\_\_\_\_  
 This point is:  Additional Well  Geo Center List other water rights that will use this point \_\_\_\_\_

6. **Presently authorized point of diversion:**  
 One in the \_\_\_\_\_ Quarter of the CE Quarter of the NW Quarter of Section 21, Township 33 South, Range 38 (W), in STEVENS County, Kansas, 3960 feet North 2675 feet West of Southeast corner of section.  
 Authorized Rate 1240 GPM Authorized Quantity 960 AF Depth of well \_\_\_\_\_ (feet)  
**(DWR use only: Computer ID No. 3 GPS \_\_\_\_\_ feet North \_\_\_\_\_ feet West)**  
 This point will not be changed  This point will be changed as follows:  No change, point better described with GPS as follows:  
**Proposed point of diversion: (Complete only if change is requested or if existing point is better described by GPS)**  
 One in the NW Quarter of the NE Quarter of the SE Quarter of Section 21, Township 33 South, Range 38 (W), in \_\_\_\_\_ County, Kansas, 2613 feet North 1115 feet West of Southeast corner of section.  
 Proposed Rate \_\_\_\_\_ Proposed Quantity \_\_\_\_\_ Proposed well depth (feet) \_\_\_\_\_  
 This point is:  Additional Well  Geo Center List other water rights that will use this point \_\_\_\_\_

7. The changes herein are desired for the following reasons?  
 (please be specific) lack of production on current location

8. If a well, is the test hole log attached?  Yes  No

9. The change(s) (was)(will be) completed by?  
 \_\_\_\_\_

10. If the point of diversion is a well:  
 (a) What are you going to do with the old well?  
to be plugged  
 (b) When will this be done? \_\_\_\_\_

11. Groundwater Management District recommendation attached?  
 Yes  No

12. Assisted by CAC

13a. If the proposed point of diversion will be relocated more than 300 feet but within 2,640 feet of the existing point of diversion, attach a topographic map or aerial photograph. For groundwater sources, show all wells (including domestic) within one-half mile of the proposed point of diversion and the names and mailing addresses of the owners. For surface water sources, show the names and addresses of the landowner(s) one-half mile downstream and one-half mile upstream from your property lines

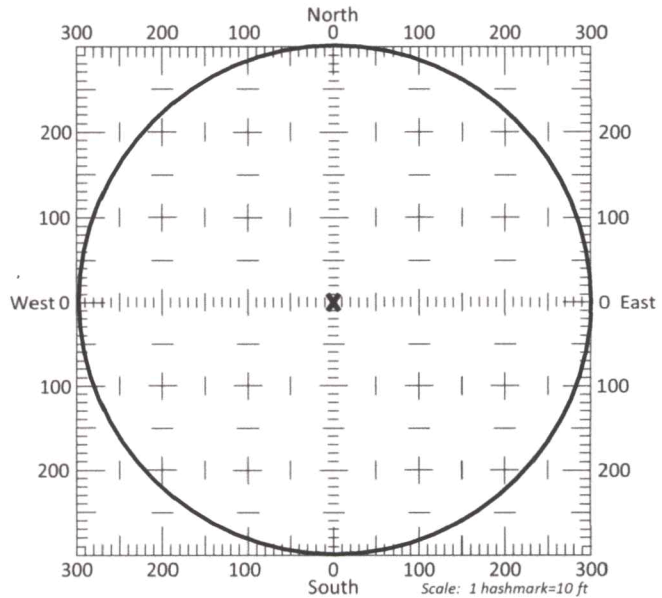

13b. If the proposed point of diversion will be relocated within a 300 foot radius of the existing point of diversion, indicate its location on the diagram shown above in relation to the existing point of diversion. The proposed point of diversion must be located within the circle shown above. **(PLEASE NOTE: The "X" in center of diagram above represents the presently authorized point of diversion.)**



14. If the proposed groundwater point of diversion is 300 or fewer feet from the existing point of diversion, complete the following:

- (a) Does the undersigned represent all owners of the currently authorized place(s) of use identified in this application?  
 Yes     No    (If no, all owners must sign this application.)
- (b) Will the ownership interest of any owner of the currently authorized place(s) of use identified in this application be adversely affected if this application is approved as requested?  
 Yes     No    (If yes, all owners must sign this application.)
- (c) If this application is not approved expeditiously, will there be substantial damage to property, public health or safety?  
 Yes     No    (If no, all owners must sign this application.)

If the application proposes a surface water change in point of diversion, a groundwater change in point of diversion greater than 300 feet, or a change in place of use, the application must be signed by all owners of the currently authorized place of use, or their duly authorized agent (attach notarized statement authorizing representation).

I hereby verify, being first duly sworn upon my oath or affirmation and under penalty of perjury, that I am of lawful age and the owner, the spouse of the owner, or a duly authorized agent of the owner(s) to make this application on their behalf, in regards to the water right(s) to which this application pertains. I further verify that the statements contained in this application are true, correct and complete.

Dated at Hugoton, Kansas, this 29 day of September, 2021.

<p><u>Warren M. Willis</u> (Owner)</p> <p><u>Warren M. Willis</u> (Please Print)</p> <p>_____ (Owner)</p> <p>_____ (Please Print)</p> <p>_____ (Owner)</p> <p>_____ (Please Print)</p>	<p><u>Amenda B Willis</u> (Spouse)</p> <p><u>Amenda B Willis</u> (Please Print)</p> <p>_____ (Spouse)</p> <p>_____ (Please Print)</p> <p>_____ (Spouse)</p> <p>_____ (Please Print)</p>
----------------------------------------------------------------------------------------------------------------------------------------------------------------------------------------------------------------	-----------------------------------------------------------------------------------------------------------------------------------------------------------------------------------------------------------------

State of Kansas }  
 County of Stevens } SS

I hereby certify that the foregoing application was signed in my presence and sworn to before me this 29<sup>th</sup> day of September, 2021.

Susan M. Smith  
 Notary Public  
 State of Kansas  
 My Commission Expires  
 August 9, 2022

Susan M Smith  
 Notary Public

My Commission Expires \_\_\_\_\_

**ONLY COMPLETE APPLICATIONS WILL BE PROCESSED.** To be complete, all of the applicable portions of the application form must be completed with accurate information; maps, if necessary, must be included; signatures of all the appropriate owners' must be affixed to the application and notarized; and the appropriate fee must be paid.

**FEE SCHEDULE**

Each application to change the place of use or the point of diversion under this section shall be accompanied by the application fee set forth in the schedule below: Make checks payable to: **Kansas Department of Agriculture**

- (1) Application to change a point of diversion 300 feet or less ..... \$100
- (2) Application to change a point of diversion more than 300 feet ..... \$200
- (3) Application to change the place of use ..... \$200

14. If the proposed groundwater point of diversion is 300 or fewer feet from the existing point of diversion, complete the following:
- (a) Does the undersigned represent all owners of the currently authorized place(s) of use identified in this application?  
 Yes     No    (If no, all owners must sign this application.)
  - (b) Will the ownership interest of any owner of the currently authorized place(s) of use identified in this application be adversely affected if this application is approved as requested?  
 Yes     No    (If yes, all owners must sign this application.)
  - (c) If this application is not approved expeditiously, will there be substantial damage to property, public health or safety?  
 Yes     No    (If no, all owners must sign this application.)

If the application proposes a surface water change in point of diversion, a groundwater change in point of diversion greater than 300 feet, or a change in place of use, the application must be signed by all owners of the currently authorized place of use, or their duly authorized agent (attach notarized statement authorizing representation).

**I hereby verify, being first duly sworn upon my oath or affirmation and under penalty of perjury, that I am of lawful age and the owner, the spouse of the owner, or a duly authorized agent of the owner(s) to make this application on their behalf, in regards to the water right(s) to which this application pertains. I further verify that the statements contained in this application are true, correct and complete.**

Dated at HUGOTON, Kansas, this 29 day of SEPTEMBER, 2021.

<u>V. LAMM &amp; CATRE CO. INC</u>	
(Owner)	(Spouse)
<u>By A.J. STEGMAN PRES</u>	
(Please Print)	(Please Print)
(Owner)	(Spouse)
(Please Print)	(Please Print)
(Owner)	(Spouse)
(Please Print)	(Please Print)

State of Kansas }  
 County of STEVENS } SS

I hereby certify that the foregoing application was signed in my presence and sworn to before me this 29<sup>th</sup> day of SEPTEMBER, 2021.

SHARON L. CONCANNON  
 Notary Public - State of Kansas  
 My Appt. Expires 3-21-25

Shonannon  
 Notary Public

My Commission Expires \_\_\_\_\_

**ONLY COMPLETE APPLICATIONS WILL BE PROCESSED.** To be complete, all of the applicable portions of the application form must be completed with accurate information; maps, if necessary, must be included; signatures of all the appropriate owners' must be affixed to the application and notarized; and the appropriate fee must be paid.

**FEE SCHEDULE**

Each application to change the place of use or the point of diversion under this section shall be accompanied by the application fee set forth in the schedule below: Make checks payable to: **Kansas Department of Agriculture**

(1) Application to change a point of diversion 300 feet or less .....	\$100
(2) Application to change a point of diversion more than 300 feet .....	\$200
(3) Application to change the place of use .....	\$200



**SUMMARY ORDER APPROVING APPLICATION FOR CHANGE AND IMPOSING CONDITIONS**

This Summary Order is issued under authority of K.S.A. 82a-708b, as amended, and K.A.R. 5-5-1, et seq. and other applicable provisions of the Kansas Water Appropriation Law, K.S.A. 82a-701 et. seq., and rules and regulations promulgated thereunder. With the exception of those conditions expressly contained herein, this Summary Order does not change the terms, conditions and limitations of File No. 8210

- 1. A change application was received on October 9, 2021 requesting that the place of use and / or point of diversion authorized under the above-referenced file number be changed as described in the application.
- 2. On and after the effective date of this summary order, the authorized place(s) of use shall be located substantially as shown on the topographic map accompanying the application to change the place of use.  Applicable  Not Applicable
- 3. The change in point of diversion shall not impair existing rights and shall be limited to the same source or sources of water as previously authorized. The point of diversion authorized by this summary order shall be located within a 300 foot radius of the authorized point(s) of diversion.  Applicable  Not Applicable
- 4. The point(s) of diversion described herein is administratively corrected to be more accurately described using the Global Positioning System (GPS), as described in the application.  Applicable  Not Applicable
- 5. The point(s) of diversion authorized herein shall not actually be located more than 2640 feet from the previously authorized point(s) of diversion.  Applicable  Not Applicable
- 6. As required by K.A.R. 5-3-5d, if the works for diversion is a well with a diversion rate of 100 gallons per minute or more, a tube or other device suitable for making water level measurements shall be installed, operated and maintained in accordance with K.A.R. 5-6-13.  Applicable  Not Applicable
- 7. The owner of the authorized place(s) of use shall properly install an acceptable water flow meter on or before December 31, 2022, or before the first use of water, whichever occurs first. The water flow meter shall be installed, operated and maintained in accordance with K.A.R. 5-1-4 through 5-1-12. As required by K.S.A. 82a-732, as amended, and K.A.R. 5-3-5e, the owner shall maintain records and report the reading of the water flow meter and the total quantity of water diverted annually to the Chief Engineer by March 1 following the end of each calendar year.  Applicable  Not Applicable
- 8. Installation of the works for diversion of water shall be completed on or before December 31, 2022, or within any authorized extension of time. By March 1, 2023 the applicant shall notify the Chief Engineer that construction of the works for diversion has been completed, on the form provided by the Chief Engineer, as required by K.A.R. 5-8-4e.  Applicable  Not Applicable
- 9. The completed well log shall be submitted with the required notice.  Applicable  Not Applicable
- 10. All diversion works into which any type of chemical or other foreign substance will be injected into the water shall be equipped with an in-line, automatic, quick-closing check valve capable of preventing pollution of the source of the water supply. The check valve(s) shall be installed, operated and maintained in accordance with K.A.R. 5-3-5c.  Applicable  Not Applicable
- 11. Additional Conditions are attached.  Yes  No
- 12. In accordance with K.S.A. 82a-708a, as amended, and K.A.R. 5-5-14, all of the owners of the authorized place(s) of use of water appropriated under the above-referenced file number are responsible for compliance with its terms, conditions and limitations, as amended and/or supplemented by this Summary Order, and with applicable provisions of the Kansas Water Appropriation Law and the Rules and Regulations promulgated thereunder. Failure to comply with these provisions may result in civil penalties pursuant to K.S.A. 82a-737, as amended, and/or the suspension or revocation and dismissal of the water or appropriation right or any other enforcement actions authorized by law.

**Administrative Appeal and Effective Date of Order**

If you are aggrieved by this order, pursuant to K.S.A. 82a-1901, you may request an evidentiary hearing before the Chief Engineer or request administrative review by the Secretary of Agriculture. A request for hearing by the Chief Engineer must be filed within **15 days** of service of this Order and a request for administrative review by the Secretary must be filed within **30 days** pursuant to K.S.A. 77-531. Any request for administrative review must state a basis for review pursuant to K.S.A. 77-527. File any request with **Kansas Department of Agriculture, Legal Division, 1320 Research Park Drive, Manhattan, KS 66502**. Failure to timely request a hearing or review may preclude review under the Kansas Judicial Review Act.

For Use by Register of Deeds

FOR OFFICE USE ONLY  
**APPLICATION APPROVED AND SUMMARY ORDER ISSUED**

By: [Signature]  
Duly Authorized Designee of the Chief Engineer  
(Print Name): MICHAEL A. MEYER  
Division of Water Resources - Kansas Department of Agriculture

Date of Issuance: October 18, 2021  
State of Kansas )  
) SS  
County of Linney )

Acknowledged before me on October 18, 2021  
by Michael A. Meyer

Signature: [Signature]  
Notary Public

My commission expires: \_\_\_\_\_  
(Notary Seal)

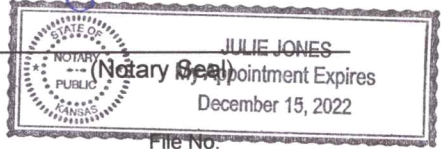



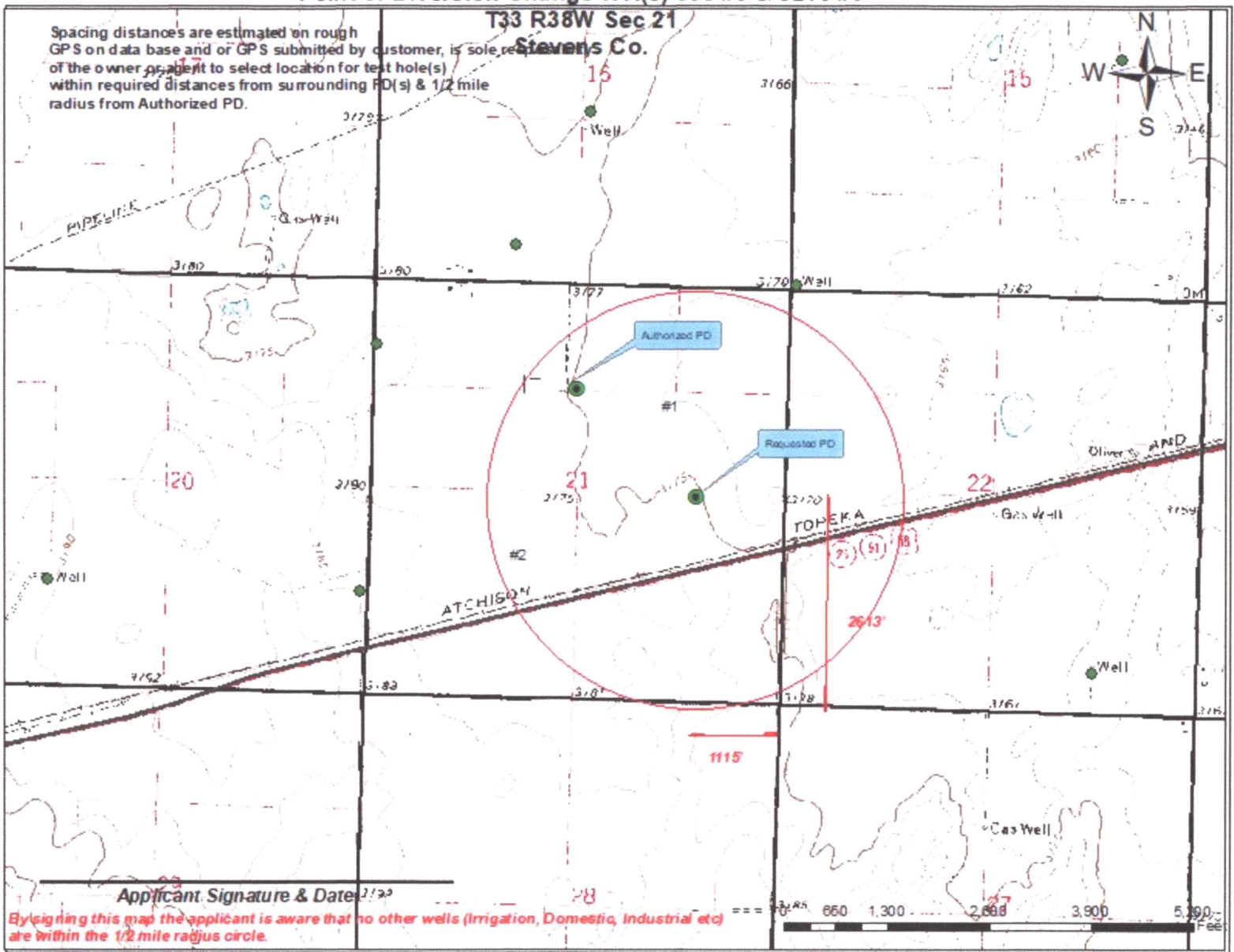

- Authorized PD
- Requested PD
- Point of Diversion
- Half Mile Radius
- Active Water Right w/in 1/2 mile
- + domestic well w/in 1/2 mile
- Authorized PU
- Requested PD

- Water Right w/in 1/2 mile & Owner (if apply)**
- #1 Water Right No 21070 Warren Willis
  - #2 Water Right No
  - #3 Water Right No

- Domestic well w/in 1/2 mile & Owner (if apply)**
- + A - Domestic well



2795 W. Jones Ave.  
Garden City, KS 67846  
PH: 620-277-2389

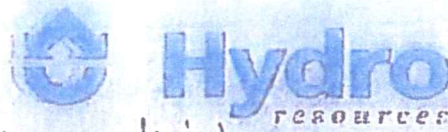

WARREN WILLIS 620-488-1063

2613'N / 1115'W  
NW NE SE

PO Box 639  
Garden City, KS 67846  
Fax: 620-277-0224

Customer Name: Warren Willis WO#: 21387 Date: 2-25-21  
Street Address: 613 RUAN N Test #: 4 ELOG: Yes  
City, State: HUGOTAN, KS 67951 Driller: Dale Guinn  
County: Stevens Quarter: SE Section: 21 Township: 33 Range: 38  
Location: GPS: N 37.16269 W 101.45116  
Rig #: 10002 Elevation: 3168' Static WL: Approx. 260' Estimated?  
Proposed Well Depth 538'

WELL LOCATION 26'SAMP

%	Footage			Description of Strata
	From	Pay	To	
	0		3	Top Soil
	3		11	Fine Sand & Clay Mixed
	11		32	Fine Sand
	32		49	Fine Med Course Sand Some Small Gravel
	49		69	Fine Med Course Sand Small Med Large Gravel
	69		79	Brown Sandy Clay
	79		98	Brown Sandy Clay w/ some Caliche
	98		121	Brown Clay
	121		138	Gray Clay w/ some Caliche Strips
	138		219	Brown Clay
	219		229	Brown Sandy Clay w/ some Sand Strips
	229		240	Fine Fin Med Sand w/ some clay stringers
	240		255	Fine Med Course Sand w/ some Clay Layers
	255		282	Brown + Tan Clay w/ some Thin Fine Sand Strips
	282		297	Brown + Tan Clay w/ some Fine Sand Layers
	297		320	Light Green Clay
	320		372	Brown Clay
5	372	12	384	Fine Some Med Sand & Clay Mixed
20	384	5	389	Fine Med Some Course w/ clay layers
25	389	28	417	Fine Med Course Sand w/ Brown & Tan Rock some clay layers
30	417	16	433	Fine Med Course Sand w/ Brown & Tan Rock w/ couple Clay Layers
35	433	37	470	Fine Med Course Sand w/ Brown & Tan Rock
5	470	5	475	Brown Sandy Clay & Sand Mixed
35	475	8	483	Fine Med Course Sand w/ Brown & Tan Rock
	483		489	Brown Sandy Clay
35	489	29	518	Fine Med Course Sand w/ Brown & Tan Rock
	518		560	Red Bed
				Super Gel X -4
				Platinum Pac -1/3 Bag
				Hole Plug -5
				Perma Plug -1
				43/4 Drag Blade -1
				Hugoton Lendant 1 1/2 Loads

15  
V  
C



TOPO! map printed on 02/26/21 from "Untitled.tpo"

101.46667° W

WGS84 101.45000° W

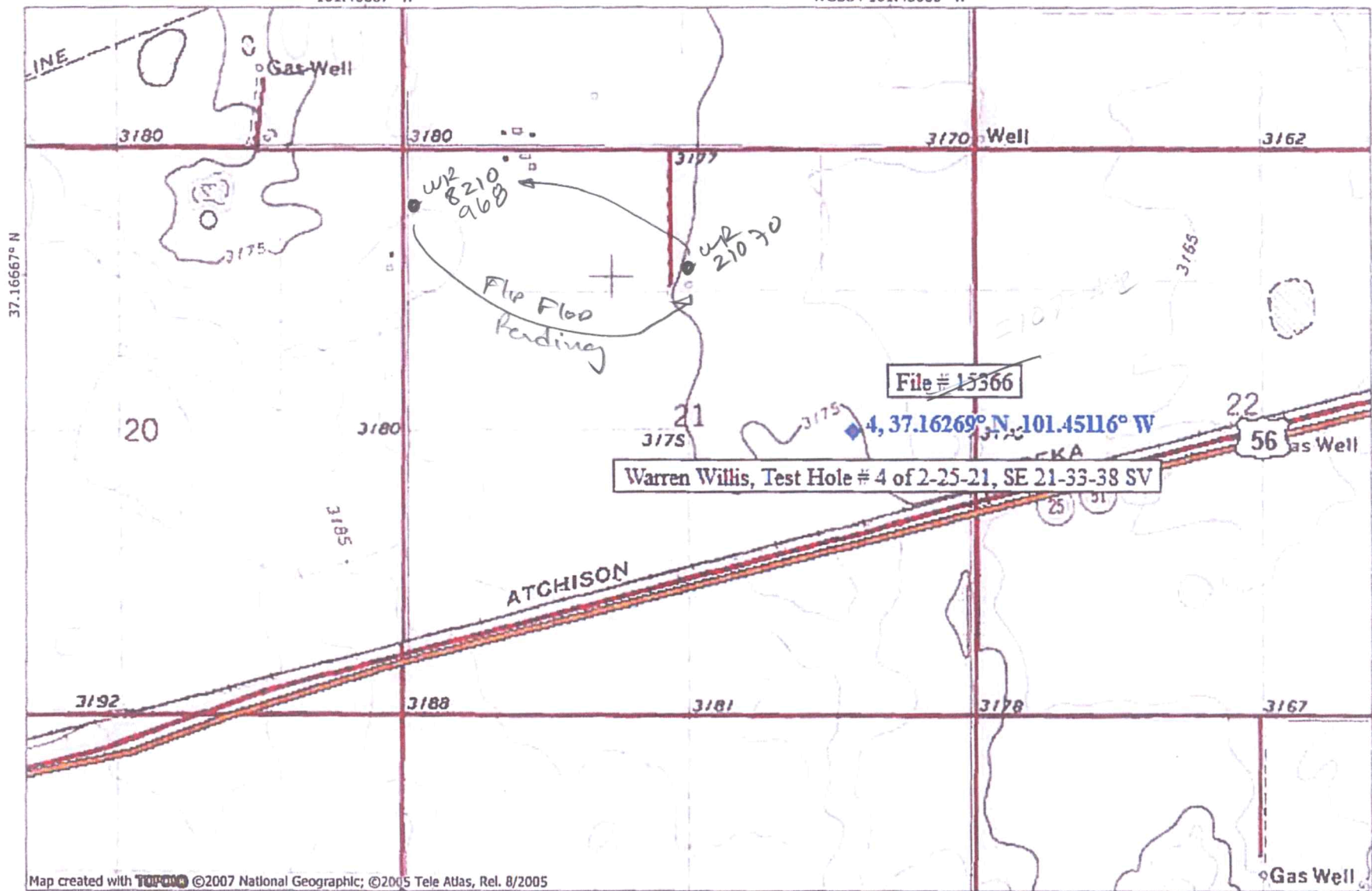

Map created with TOPO! ©2007 National Geographic; ©2005 Tele Atlas, Rel. 8/2005

101.46667° W

WGS84 101.45000° W

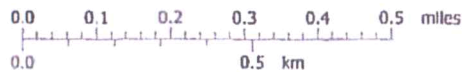

TN MN  
5 1/2" = 1"  
02/26/21

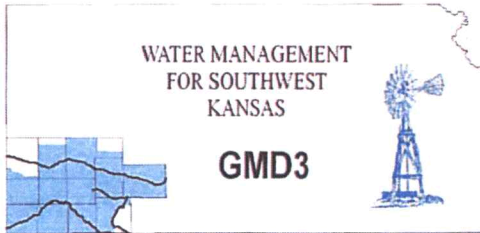

**Southwest Kansas**  
**Groundwater Management District No. 3**  
2009 E. Spruce Street  
Garden City, Kansas 67846  
(620) 275-7147 phone (620) 275-1431 fax  
www.gmd3.org

October 18, 2021

Michael A. Meyer  
Division of Water Resources  
4532 W Jones Ave., Suite B  
Garden City, Kansas 67846

RE: Applications for Change in Point of Diversion  
Water Right, File Nos. 968 & 8210

Dear Mike:

We have completed a review of the applications for the above referenced water rights. The proposed change in authority between the points of diversion is in accordance with current area rules, K.A.R. 5-23-3, as it pertains to distance moved and minimum spacing to neighboring wells.

Well evaluations were conducted again to estimate possible effects of the proposal on the supply of other wells with water rights prior to the proposal per K.S.A. 82a-708b, and the draft revised management program. Under K.S.A. 82a-708b, an applicant requesting a change in point of diversion must demonstrate to the chief engineer that any proposed change is reasonable and will not impair. The enclosed report is an analysis performed by the GMD on behalf of our membership. Under this analysis, the proposed change is considered to be reasonable and unlikely to impair if either the net in-season well-to-well effect of the proposed change is less than a strict maximum allowable threshold (3.5-4.0 ft in cases where saturated thickness is between 150ft-200ft or greater than 200 ft), or if no well with a net well-to-well effect exceeding the threshold is identified as critical. Critical wells are identified as wells that are expected to either lose or greatly diminish water supply over the next 25 years. The attached review information is based on a Theis analysis using inputs from the GMD3 aquifer model, which is considered to be the best information on well and aquifer data readily and easily available to the public. If either the applicant or the neighbors believe they have better data that might change the result of the analysis, they should contact GMD3. Conclusions of the well analysis may change if better information on well and aquifer data can be made available.

Every neighboring well within 1 mile of the proposed move was evaluated. Evaluations showed there were several neighboring wells, with one under the same ownership, exceeded the net effect above the maximum allowable threshold and required further evaluations. Further analysis showed that the proposed new authority would not be considered critical except for the one owned by the applicant. Discussion with the applicant about the results determined that he can manage his system to mitigate the effects. Therefore, GMD3 sees this move as reasonable and therefore recommend that the application be approved. If aquifer conditions change or there is a change to the water right in the future, we would be happy to evaluate the effects at that time.

Thank you for the opportunity to review the applications and to provide a recommendation. If you have any questions, please don't hesitate to contact us.

Sincerely,

A handwritten signature in blue ink, which appears to read "Jason L. Norquest", is written over the typed name.

Jason L. Norquest  
Assistant Manager

**RECEIVED**

**OCT 18 2021**

Garden City Field Office  
Division of Water Resources

## GMD3 Change Review

---

File No(s): 968, 8210.

DWR office: HQ.

App filed to change: PD (Move previously discussed when first move took a waiver).

Is Landowner(s) correct in WRIS: Warren & Amada Willis.

If NO, is documentation included?

Is Water Use Correspondent correct in WRIS? \_\_.

If NO, is documentation included?

Regulation(s) Reviewed: KAR 5-23-3

Point of diversion ID No(s) \_\_ being changed.

	ft. North	ft. West	
Authorized PD	3960	2675	968 & 8210
Proposed PD	2613	1115	
Difference	1347 s	1560 e	
$a^2 + b^2 = c^2$	1814409	2433600	2061.07 foot move SE

GPS for proposed PD: Lat: 37.16269 Long: -101.45116.

Is proposed PD stacking on existing WRs? Keep overlaps as they are.

Is Proposed PU overlapping existing WRs? No Change.

Neighboring certified well(s) notified: \_\_.

Name VJ Land & Cattle Co Inc (968, 6032 ID5, 15366).

Address 815S Vanburen.

Zip Hugoton, KS 67951.

Email: stegrace@pld.com. Phone: 620-544-5293.

Name Joel T McClure (17498).

Address 1949 Road 7.

Zip Hugoton, KS 67951.

Email: mcclure@pld.com. Phone: 620-544-1952.

Domestic well(s) notified: \_\_.

Name Javier & Rosario Lopez (SE SW 16-33-38).

Address 622 Road N.

Zip Hugoton, KS 67951.

Name Juan Romo (SW SW 16-33-38).

Address 616 Road N.

Zip Hugoton, KS 67951.

Base Acres: \_\_.

Perfectured Acres: \_\_.

Irr. Return-Flow \_\_%



## GMD3 Change Review

---

968: Authorized 1200AF @ 2693gpm blanket over two wells (one in sect 21 and one in 16)

8210 ID3 section 21: Authorized 960AF @ 1240gpm (limitations involved)

Average WUR (2011-2020) on ID 3: 391.8AF/year., 1400gpm reported in 2020  
615gpm calculated during 2014 inspection

**THIS CURRENT pd WAS APPROVED AFTER A WAIVER IN JUNE.**

Is a waiver needed: This is the change in the future to move the east well to SE quarter. Analysis shows that there could be effects of the proposed change, as is. The biggest effects is to a well operated by the applicant. We did have a conversation about the results and he understands possible effects. No other neighbors were determined to be critical.

Recommendation: Reviewed with board at August 11<sup>th</sup> meeting for the previous change. The board saw the move and what the applicant needs to accomplish with a second move. The only real effect is to the applicant's own well and can be managed with his operation of the system, no other wells were critical, staff recommends approval of he applications.



RECEIVED

OCT 18 2021

Garden City Field Office  
Division of Water Resources

**Evaluation of proposed move for Water Right Nos 968 and 8210**

Proposed: Move water right nos. 968 and 8210 ID3 to a new well location, located 2,058 ft to the southeast. Note that these rights have recently switched locations with water right number 21070, and this change is not reflected on the below map.

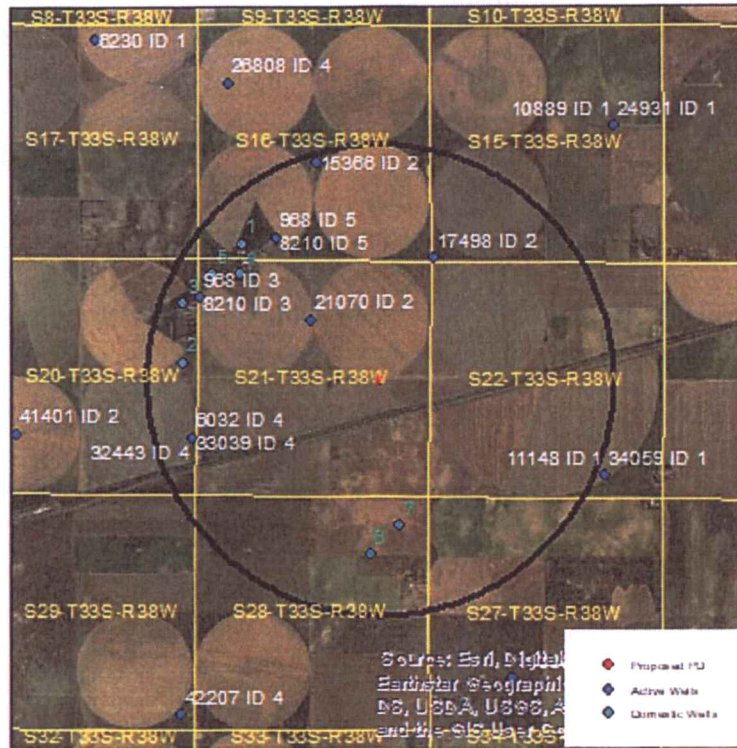

Wells within 1 mile: 21070, 968 & 8210 ID5, 15366, 17498, 6032 & 32443 & 33039, and 7 domestic wells, numbered on the above map.

The saturated thickness at the proposed well location is estimated to be 216 ft, based upon the GMD3 model. Saturated thickness is estimated to be 174 ft in section 20. For saturated thickness greater than 200 ft, the drawdown allowance is 4.0 ft. For saturated thickness between 150 ft and 200 ft, the drawdown allowance is 3.5 ft.

**50 year Theis Analysis:** The following values were used to run the analysis:

$S = 0.1476$ ,  $T = 8614.6 \text{ ft}^2/\text{day}$ ,  $t_{p\text{current}} = 79 \text{ days}$ ,  $Q_{\text{current}} = 800 \text{ gpm}$ ,  $t_{p\text{proposed}} = 131 \text{ days}$ ,  $Q_{\text{proposed}} = 1653 \text{ gpm}$

Theis drawdowns were calculated as follows:

21070: Drawdown from current location = 2.48 ft  
 Drawdown from proposed location = 5.57 ft  
 Net drawdown = 3.1 ft

968 & 8210 ID5: Drawdown from current location = 2.99 ft  
Drawdown from proposed location = 5.99 ft  
Net drawdown = **3.0 ft**

15366: Drawdown from current location = 1.94 ft  
Drawdown from proposed location = 5.15 ft  
Net drawdown = **3.2 ft**

17498: Drawdown from current location = 2.16 ft  
Drawdown from proposed location = 7.19 ft  
Net drawdown = **5.0 ft**

6032 & 32443 & 33039: Drawdown from current location = 1.86 ft  
Drawdown from proposed location = 5.60 ft  
Net drawdown = **3.7 ft**

Domestic 1: Drawdown from current location = 2.68 ft  
Drawdown from proposed location = 5.66ft  
Net drawdown = **3.0 ft**

Domestic 2: Drawdown from current location = 2.16 ft  
Drawdown from proposed location = 5.56 ft  
Net drawdown = **3.4 ft**

Domestic 3: Drawdown from current location = 2.25 ft  
Drawdown from proposed location = 5.35 ft  
Net drawdown = **3.1 ft**

Domestic 4: Drawdown from current location = 3.09 ft  
Drawdown from proposed location = 6.00 ft  
Net drawdown = **3.0 ft**

Domestic 5: Drawdown from current location = 2.58 ft  
Drawdown from proposed location = 5.57 ft  
Net drawdown = **3.0 ft**

**RECEIVED**

**OCT 18 2021**

Garden City Field Office  
Division of Water Resources

Domestic 6: Drawdown from current location = 1.45 ft  
Drawdown from proposed location = 6.00 ft  
Net drawdown = 4.5 ft

Domestic 7: Drawdown from current location = 1.52 ft  
Drawdown from proposed location = 6.73 ft  
Net drawdown = 5.2 ft

Net drawdown exceeds the drawdown allowance of 4.0 ft for water right numbers 6032 & 32443 & 33039, and 17498, as well as domestic wells 6 and 7. Critical well analysis is necessary on those wells.

**Critical Well Evaluation:**

**6032 & 32443 & 33039:**

Water Column = 174 ft

DP = 3.7 ft (Net drawdown from the proposal indicated above)

DE = 22.8 ft (Water level decline from 2021 through 2046 based upon GMD3 model)

DD = 112.9 ft (S = 0.134, T = 36,689.4 gpd/ft, Q = 1604 gpm, tp = 86 days, efficiency = 70%)

DT = 139.4 ft

Economic Drawdown Constraint (EDC) =  $0.4 * 174 \text{ ft} = 69.6 \text{ ft}$

Physical Drawdown Constraint (PDC) =  $174 \text{ ft} - 60 \text{ ft} = 114 \text{ ft}$

Total drawdown of 139.4 ft is greater than the EDC and PDC, so this well is **critical**.

**17498:**

Water Column = 266 ft

DP = 5.0 ft (Net drawdown from the proposal indicated above)

DE = 21.3 ft (Water level decline from 2021 through 2046 based upon GMD3 model)

DD = 50.3 ft (S = 0.1835, T = 61,946.6 gpd/ft, Q = 1212 gpm, tp = 64 days, efficiency = 70%)

DT = 76.6 ft

Economic Drawdown Constraint (EDC) =  $0.4 * 266 \text{ ft} = 106.4 \text{ ft}$

Physical Drawdown Constraint (PDC) =  $266 \text{ ft} - 60 \text{ ft} = 206 \text{ ft}$

Total drawdown of 76.6 ft is less than the EDC and PDC, so this well is **not critical**.



**Domestic 6:**

Water Column = 209 ft

DP = 4.5 ft (Net drawdown from the proposal indicated above)

DE = 23.8 ft (Water level decline from 2021 through 2046 based upon GMD3 model)

DT = 28.3 ft

Economic Drawdown Constraint (EDC) =  $0.4 * 209 \text{ ft} = 83.6 \text{ ft}$

Physical Drawdown Constraint (PDC) =  $209 \text{ ft} - 20 \text{ ft} = 189 \text{ ft}$

Total drawdown of 28.3 ft is less than the EDC and PDC, so this well is **not critical**.

**Domestic 7:**

Water Column = 209 ft

DP = 5.2 ft (Net drawdown from the proposal indicated above)

DE = 23.8 ft (Water level decline from 2021 through 2046 based upon GMD3 model)

DT = 29.0 ft

Economic Drawdown Constraint (EDC) =  $0.4 * 209 \text{ ft} = 83.6 \text{ ft}$

Physical Drawdown Constraint (PDC) =  $209 \text{ ft} - 20 \text{ ft} = 189 \text{ ft}$

Total drawdown of 29.0 ft is less than both the EDC and PDC, so this well is **not critical**.

**Conclusion:**

The proposed moves are located in an area with ample saturated thickness and aquifer properties that allow for productive wells. If the proposed well were to pump its full authorized authority, there would likely be a noticeable effect on some neighboring wells. Critical well analysis shows that one neighboring well, authorized under water right nos. 6032 & 32443 & 33039, is critical because its pumping season saturated thickness is projected to decline by more than 40% over the next 25 years, likely causing some loss in productivity. GMD3 staff is not recommending a limitation to mitigate this effect because this well is operated by the applicant, so any effect would be self-imposed. GMD3 recommends approval of the application as submitted.

RECEIVED

OCT 18 2021

Garden City Field Office  
Division of Water Resources



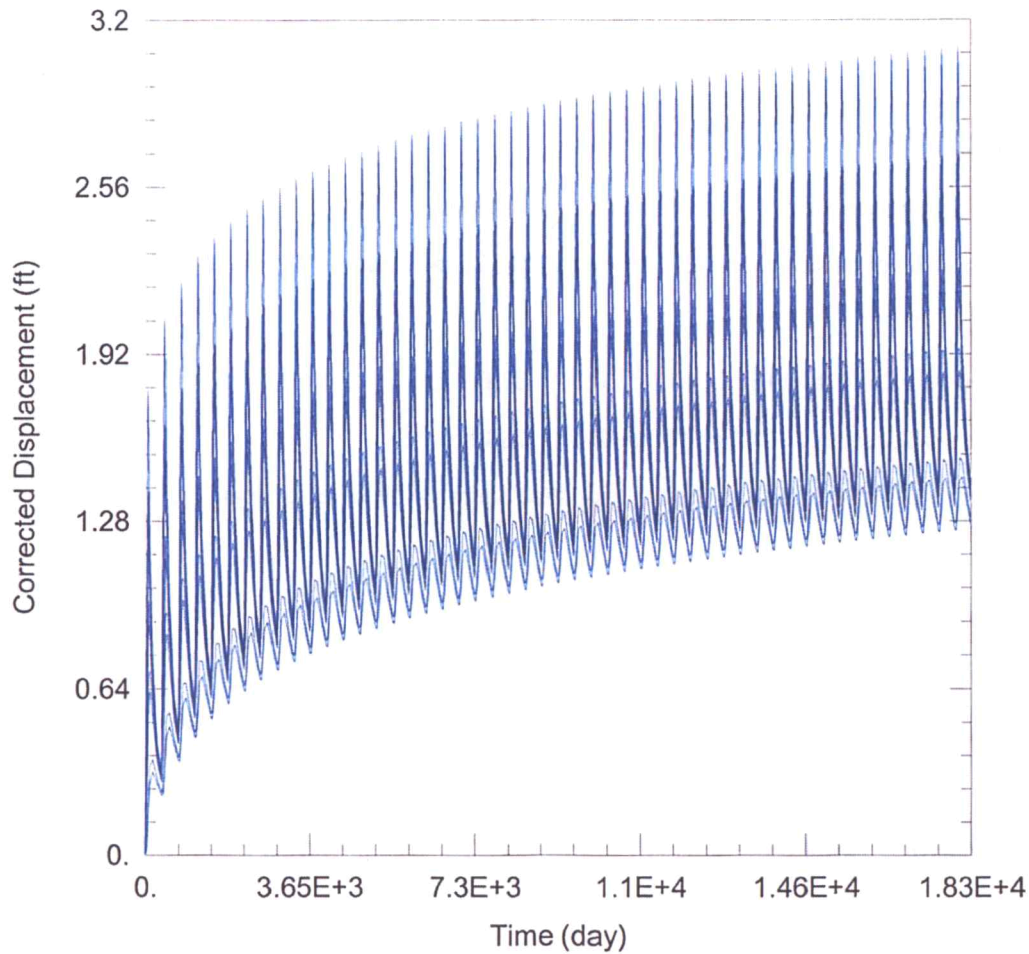

WELL TEST ANALYSIS

Data Set: C:\Users\trevora\Documents\2021\_Moves\968\_8210\968 & 8210 Current.aqt  
 Date: 10/07/21 Time: 10:50:13

PROJECT INFORMATION

Company: GMD 3  
 Project: 968 & 8210  
 Location: Stevens County

WELL DATA

Pumping Wells

Well Name	X (ft)	Y (ft)
968 & 8210 ID3	-191464	106761

Observation Wells

Well Name	X (ft)	Y (ft)
□	-191464	106761
□ 21070	-193996	107267
□ 968 & 8210 ID5	-192268	108562
□ 15366	-191352	110278
□ 17498	-188687	108114
□ 6032 & 32443 & 33039	-194164	104108
□ Domestic 1	-193053	108428
□ Domestic 2	-194401	105798
□ Domestic 3	-194385	107119
□ Domestic 4	-193058	107768
□ Domestic 5	-193718	107774
□ Domestic 6	-190146	101478
□ Domestic 7	-189483	102130

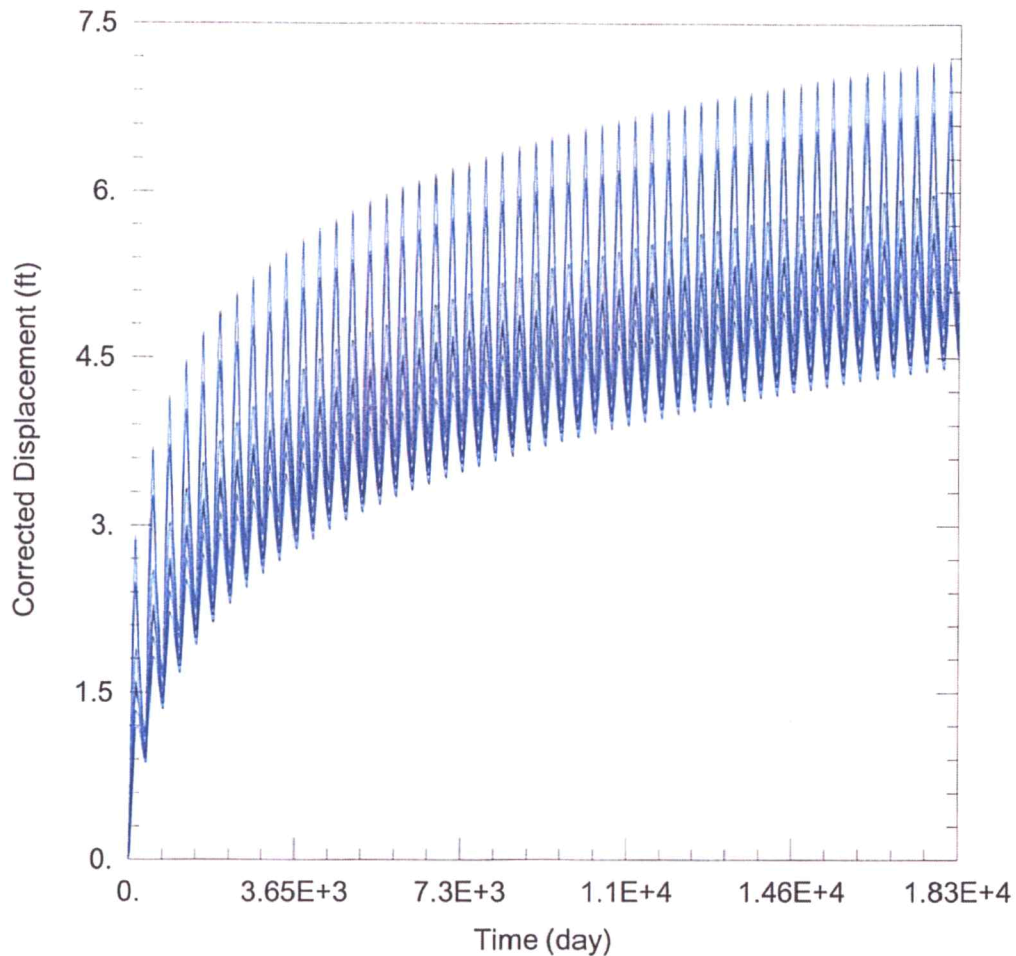

WELL TEST ANALYSIS

Data Set: C:\Users\trevora\Documents\2021\_Moves\968\_8210\968 & 8210 Proposed.aqt

Date: 10/07/21

Time: 10:50:06

PROJECT INFORMATION

Company: GMD 3

Project: 968 & 8210

Location: Stevens County

WELL DATA

Pumping Wells

Well Name	X (ft)	Y (ft)
968 & 8210 ID3	-189918	105403

Observation Wells

Well Name	X (ft)	Y (ft)
□	-189918	105403
□ 21070	-193996	107267
□ 968 & 8210 ID5	-192268	108562
□ 15366	-191352	110278
□ 17498	-188687	108114
□ 6032 & 32443 & 33039	-194164	104108
□ Domestic 1	-193053	108428
□ Domestic 2	-194401	105798
□ Domestic 3	-194385	107119
□ Domestic 4	-193058	107768
□ Domestic 5	-193718	107774
□ Domestic 6	-190146	101478
□ Domestic 7	-189483	102130

**RECEIVED**

**OCT 18 2021**

Garden City Field Office  
Division of Water Resources

Water Rights and Points of Diversion Within 1 mile of point defined as:

2613 Feet N and 1115 Feet W of the Southeast Corner of Section 21 Twp 33S Rng 38W

Located at: 101.451162 West Longitude and 37.162689 North Latitude

Both SURFACE WATER and GROUNDWATER

File Number	Use	ST	SR	Dist	(ft)	Q4	Q3	Q2	Q1	FeetN	FeetW	Sec	Twp	Rng	ID	Batt	Auth_Quan	Add_Quan
A__ AF	968 00	IRR	NK	G*	2058	--	--	CE	NW	3960	2675	21	33	38W	2		1200.00	1200.00
Same					3937	--	SW	SE	SW	480	3500	16	33	38W	5			
A__ AF	6032 00	IRR	NK	G	4439	--	--	CE	SE	1284	70	20	33	38W	4		573.00	573.00
A__ AF	8210 00	IRR	NK	G*	2058	--	--	CE	NW	3960	2675	21	33	38W	2		960.00	446.00
Same					3937	--	SW	SE	SW	480	3500	16	33	38W	5		1280.00	595.00
A__ AF	15366 00	IRR	NK	G	5082	--	NW	NW	SE	2200	2600	16	33	38W	2		820.00	5.00
A__ AF	17498 00	IRR	NK	G	2998	--	SW	SW	SW	100	5180	15	33	38W	2		400.00	400.00
A__ AF	21070 00	IRR	NK	G	4484	--	SW	NW	NW	4450	5200	21	33	38W	3		471.00	.00
A__ AF	32443 00	IRR	NK	G	4439	--	--	CE	SE	1284	70	20	33	38W	4		290.00	290.00
A__ AF	33039 00	IRR	NK	G	4439	--	--	CE	SE	1284	70	20	33	38W	4		246.00	27.00

Total Net Quantities Authorized:	Direct	Storage
Total Requested Amount (AF) =	.00	.00
Total Permitted Amount (AF) =	.00	.00
Total Inspected Amount (AF) =	.00	.00
Total Pro_Cert Amount (AF) =	.00	.00
Total Certified Amount (AF) =	3536.00	.00
Total Vested Amount (AF) =	.00	.00
TOTAL AMOUNT (AF) =	3536.00	.00

An \* after the source of supply indicates a pending application for change under the file number.

An \* after the ID indicates a 15 AF exemption was granted under the file number.

A "G" in the Batt column indicates the GEO CTR of a battery. A "B" indicates a well in the battery.

The number in the Batt column is the number of wells in the battery.

Water Rights and Points of Diversion Within 1 mile of point defined as:

2613 Feet North and 1115 Feet West of the Southeast Corner of Section 21 Twp 33S Rng 38W

Located at: 101.451162 West Longitude and 37.162689 North Latitude

Both SURFACE WATER and GROUNDWATER

WATER USE CORRESPONDENTS:

- > File Number Use ST SR
- > V J LAND & CATTLE CO INC
- >
- > 815 S VANBUREN
- > HUGOTON KS 67951
- >-----
- > WARREN M & AMANDA R WILLIS
- >
- > 613 ROAD N
- > HUGOTON KS 67951
- >-----
- > WARREN M & AMANDA R WILLIS
- >
- > 613 ROAD N
- > HUGOTON KS 67951
- >-----

968

6032



> V J LAND & CATTLE CO INC  
>  
> 815 S VANBUREN  
> HUGOTON KS 67951  
-----> 8210  
> WARREN M & AMANDA R WILLIS  
>  
> 613 ROAD N  
> HUGOTON KS 67951  
-----  
> V J LAND & CATTLE CO INC  
>  
> 815 S VANBUREN 15360  
> HUGOTON KS 67951  
-----  
> JOEL T MCCLURE  
>  
> 1949 ROAD 7 17498  
> HUGOTON KS 67951  
-----  
> WARREN M & AMANDA R WILLIS  
>  
> 613 ROAD N 21070  
> HUGOTON KS 67951  
-----  
> WARREN M & AMANDA R WILLIS  
>  
> 613 ROAD N 32443  
> HUGOTON KS 67951  
-----  
> WARREN M & AMANDA R WILLIS  
>  
> 613 ROAD N 33039  
> HUGOTON KS 67951  
-----  
=====

RECEIVED  
OCT 18 2021  
Garden City Field Office  
Division of Water Resources

## **Meyer, Mike [KDA]**

---

**From:** Meyer, Mike [KDA]  
**Sent:** Monday, October 4, 2021 4:25 PM  
**To:** 'Norquest, Jason (Norquest@gmd3.org)'  
**Subject:** request for recommendation, File Nos. 968 & 8210  
**Attachments:** 20211004161019924.pdf; 20211004161043173.pdf; 20211004161031513.pdf

good afternoon

please see attached the request to change the point of diversion filed by warren willis. the on going package. please review and provide a recommendation within 15 days. the previous package has been approved.

thanks

*Mike*



Garden City Field Office  
4532 W. Jones, Suite B  
Garden City, KS 67846



Phone: 620-276-2901  
Fax: 620-276-9315  
www.agriculture.ks.gov

Mike Beam, Secretary

Laura Kelly, Governor

October 4, 2021

SOUTHWEST KANSAS GROUNDWATER  
MANAGEMENT DISTRICT NO. 3  
2009 E SPRUCE ST  
GARDEN CITY KS 67846

Re: Request for Recommendation  
Water Right, File Nos. 968 & 8210

Dear Mr. Norquest:

This is to advise you that Warren Willis, has filed applications for approval of the Chief Engineer, Division of Water Resources, Kansas Department of Agriculture, to change the point of diversion.

We are delaying action on the change applications to allow you time to review and provide a recommendation. Please submit a recommendation within 15 days from the date of this letter.

Thank you and as always feel free to contact this office at any time.

Sincerely,

A handwritten signature in blue ink that reads "Michael A. Meyer".

Michael A. Meyer  
Water Commissioner

MAM  
Enclosures