

File No. **9283** 11. County: **ST** Basin: **N F CIMARRON RIVER** Stream: Formation Code: **211/331** Special Use:

12. Points of Diversion
 CHK
 MOD
 DEL
 ENT PDIV
 Qualifier S T R ID 'N 'W Comment (AKA Line) Rate gpm Quantity af Rate gpm Quantity af Overlap PD Files

DEL 14262

ENT 81759 NE NE SE 17 29S 39W 5 2600 476 1335 477 1335 477 12407

13. Storage: Rate _____ NF Quantity _____ ac/ft Additional Rate _____ NF Additional Quantity _____ ac/ft

14. Limitation: _____ af/yr at _____ gpm (_____ cfs) when combined with file number(s) _____
 Limitation: _____ af/yr at _____ gpm (_____ cfs) when combined with file number(s) _____

15. 5YR Allocation: Allocation Type _____ Start Year _____ 5 YR Amount _____ Amount Unit _____ Base Acres _____ Comment _____

16. Place of Use CHK MOD DEL ENT PUSE S T R ID	NE¼				NW¼				SW¼				SE¼				Total	Owner	Chg?	Overlap Files
	NE ¼	NW ¼	SW ¼	SE ¼	NE ¼	NW ¼	SW ¼	SE ¼	NE ¼	NW ¼	SW ¼	SE ¼	NE ¼	NW ¼	SW ¼	SE ¼				
CHK 17134																				
CHK 40637																				

Base Acres: Year: Minimum Reasonable Quantity:

Comments: **QUANTITY AND RATE ALL ADDITIONAL**

Garden City Field Office
4532 W. Jones, Suite B
Garden City, KS 67846



Phone: 620-276-2901
Fax: 620-276-9315
www.agriculture.ks.gov

Mike Beam, Secretary

Laura Kelly, Governor

May 6, 2021

L & R LEGACY FARM LLC
2198 EAST ROAD 7
JOHNSON, KS 67855

RE: Water Right, File No. 9283

Dear Sir or Madam:

Enclosed is the order executed by the designee of the Chief Engineer, Division of Water Resources, Kansas Department of Agriculture, approving the application for change under the above referenced file number.

Your attention is directed to the enclosures and to the terms, conditions, and limitations specified in this approval for change. A condition of this approval is that an acceptable water flow meter must be installed on the diversion works authorized under the referenced file number and meet current specifications. Please return the required notification of completion of the diversion works and installation of the required meter as soon as these actions are completed.

Since the order modifies the original document referred to above, it should be recorded with the Register of Deeds as other instruments affecting real estate.

Should you have any questions, please feel free contact this office. If you would prefer, you could arrange an appointment for additional assistance.

Sincerely,

A handwritten signature in blue ink that reads "Austin J. McColloch".

Austin J. McColloch
Assistant Water Commissioner

AM:
enclosures

pc: GROUNDWATER MANAGEMENT DISTRICT NO. 3

CERTIFICATE OF SERVICE

On this 6th day of May, 2021, I hereby certify that the foregoing Approval of Application for Change in Point of Diversion, Water Right, File No. 9,283 dated 6th day of May, 2021 was mailed postage prepaid, first class, US mail to the following:

L & R LEGACY FARM LLC
2198 EAST ROAD 7
JOHNSON, KS 67855

Pc:

GROUNDWATER MANAGEMENT DISTRICT NO. 3



Division of Water Resources Staff

Submit completed application to:
 Kansas Department of Agriculture
 Division of Water Resources
 Field Office for your area.

Call for address:

Topeka -- (785) 296-5733
 Stafford -- (620) 234-5311
 Stockton -- (785) 425-6787
 Garden City -- (620) 276-2901
<http://agriculture.ks.gov/dwr>

DWR FIELD OFFICE APPLICATION FOR APPROVAL TO CHANGE THE PLACE OF USE AND/OR THE POINT OF DIVERSION



STATE OF KANSAS

Filing Fee Must Accompany the Application, K.S.A. 82a-708b(b), as amended.
 Fee Schedule is on the third page of this application form.

Paragraph Nos. 1, 2, 3 & 5 must be completed. Complete all other applicable portions. If change in point of diversion is greater than 100 feet, or if place of use will be changed, include a topographic map or detailed plat showing the authorized and proposed point(s) of diversion and/or place of use.

File No. 9283 _____

RECEIVED
 2:29 pm
 FEB 25 2021

1. Application is hereby made for approval of the Chief Engineer to change the (check one or both):

Place of Use Point of Diversion

under the water right which is the subject of this application in accordance with the conditions described below.

The source of supply is: Groundwater Surface water

Garden City Field Office
 Division of Water Resources

2. Name and address of Applicant: L & R LEGACY FARM LLC
2198 EAST ROAD 7 JOHNSON KS 67855

Phone Number: _____ Email address: _____

Name and address of Water Use Correspondent: JOHN D & CAROLYN K SMITH
PO BOX 526 JOHNSON KS 67855 - 0526

Phone Number: () _____ Email address: _____

3. The presently authorized place of use is:

Owner of Land --- NAME: _____

ADDRESS: _____

(If there is more than one landowner, attach supplemental sheets as necessary.)

Sec.	Twp.	Range	NE¼				NW¼				SW¼				SE¼				TOTAL ACRES	
			NE¼	NW¼	SW¼	SE¼	NE¼	NW¼	SW¼	SE¼	NE¼	NW¼	SW¼	SE¼	NE¼	NW¼	SW¼	SE¼		

4. If this application is for a change in place of use, it is proposed that the place of use be changed to:

Owner of Land --- NAME: _____

ADDRESS: _____

(If there is more than one landowner, attach supplemental sheets as necessary.)

Sec.	Twp.	Range	NE¼				NW¼				SW¼				SE¼				TOTAL ACRES		
			NE¼	NW¼	SW¼	SE¼	NE¼	NW¼	SW¼	SE¼	NE¼	NW¼	SW¼	SE¼	NE¼	NW¼	SW¼	SE¼			

For Office Use Only: Code _____ Fee \$ 200.00 TR # _____ Receipt Date 2-25-21 Check # 1013

5. **Presently authorized point of diversion:**
 One in the NW Quarter of the NW Quarter of the SE Quarter of Section 17, Township 29 South, Range 39 (W), in Stanton County, Kansas, 2500 feet North 2550 feet West of Southeast corner of section. Authorized Rate 970 GPM Authorized Quantity 483 AF Depth of well _____ (feet)
(DWR use only: Computer ID No. 2 GPS _____ feet North _____ feet West)
 This point will not be changed This point will be changed as follows: No change, point better described with GPS as follows:
Proposed point of diversion: (Complete only if change is requested or if existing point is better described by GPS)
 One in the NE Quarter of the NE Quarter of the SE Quarter of Section 17, Township 29 South, Range 39 (W), in Stanton County, Kansas, 2600 feet North 476 feet West of Southeast corner of section. Proposed Rate 970 GPM Proposed Quantity 483 AF Proposed well depth (feet) _____
 This point is: Additional Well Geo Center List other water rights that will use this point 12407

6. **Presently authorized point of diversion:**
 One in the _____ Quarter of the _____ Quarter of the _____ Quarter of Section _____, Township _____ South, Range _____ (E/W), in _____ County, Kansas, _____ feet North _____ feet West of Southeast corner of section. Authorized Rate _____ Authorized Quantity _____ Depth of well _____ (feet)
(DWR use only: Computer ID No. _____ GPS _____ feet North _____ feet West)
 This point will not be changed This point will be changed as follows: No change, point better described with GPS as follows:
Proposed point of diversion: (Complete only if change is requested or if existing point is better described by GPS)
 One in the _____ Quarter of the _____ Quarter of the _____ Quarter of Section _____, Township _____ South, Range _____ (E/W), in _____ County, Kansas, _____ feet North _____ feet West of Southeast corner of section. Proposed Rate _____ Proposed Quantity _____ Proposed well depth (feet) _____
 This point is: Additional Well Geo Center List other water rights that will use this point _____

7. The changes herein are desired for the following reasons?
 (please be specific) MOVE WATER RIGHTS TO
TO FILE NO. 12407 WELL AND HAVE TOTAL
AUTHORITY. ONLY ONE WELL TO PUMP TOTAL

8. If a well, is the test hole log attached? Yes No

9. The change(s) (was)(will be) completed by?
2021

10. If the point of diversion is a well:
 (a) What are you going to do with the old well?
CAP
 (b) When will this be done? _____

11. Groundwater Management District recommendation attached?
 Yes No

12. Assisted by Alex Torrance

13a. If the proposed point of diversion will be relocated more than 300 feet but within 2,640 feet of the existing point of diversion, attach a topographic map or aerial photograph. For groundwater sources, show all wells (including domestic) within one-half mile of the proposed point of diversion and the names and mailing addresses of the owners. For surface water sources, show the names and addresses of the landowner(s) one-half mile downstream and one-half mile upstream from your property lines

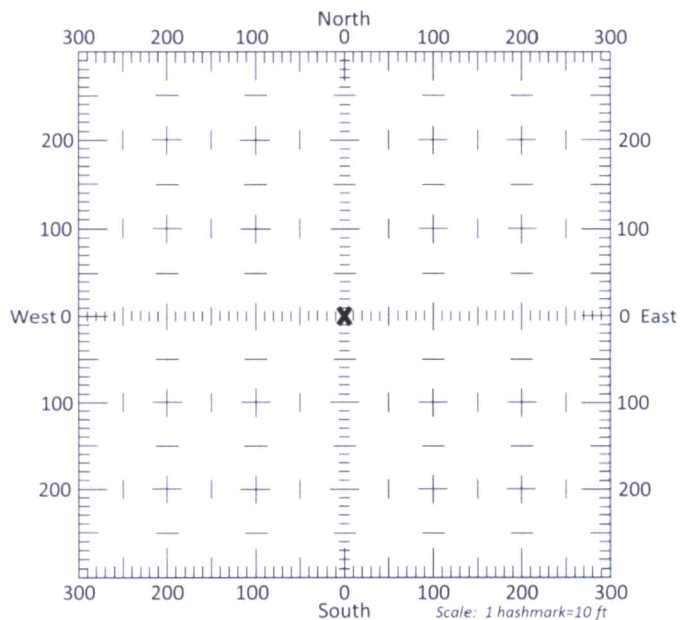

13b. If the proposed point of diversion will be relocated within 300 feet of the existing point of diversion, indicate its location on the diagram shown above in relation to the existing point of diversion. (PLEASE NOTE: The "X" in center of diagram above represents the presently authorized point of diversion.)

14. If the proposed groundwater point of diversion is 300 or fewer feet from the existing point of diversion, complete the following:
- (a) Does the undersigned represent all owners of the currently authorized place(s) of use identified in this application?
 Yes No (If no, all owners must sign this application.)
 - (b) Will the ownership interest of any owner of the currently authorized place(s) of use identified in this application be adversely affected if this application is approved as requested?
 Yes No (If yes, all owners must sign this application.)
 - (c) If this application is not approved expeditiously, will there be substantial damage to property, public health or safety?
 Yes No (If no, all owners must sign this application.)

If the application proposes a surface water change in point of diversion, a groundwater change in point of diversion greater than 300 feet, or a change in place of use, the application must be signed by all owners of the currently authorized place of use, or their duly authorized agent (attach notarized statement authorizing representation).

I hereby verify, being first duly sworn upon my oath or affirmation and under penalty of perjury, that I am of lawful age and the owner, the spouse of the owner, or a duly authorized agent of the owner(s) to make this application on their behalf, in regards to the water right(s) to which this application pertains. I further verify that the statements contained in this application are true, correct and complete.

Dated at 1910 Emaryst Garden City, Kansas, this 17th day of February, 2021.

<p><u>Rita Kae Garey</u> (Owner)</p> <p><u>RITA KAE GAREY</u> (Please Print)</p> <p>_____</p> <p>(Owner)</p> <p>_____</p> <p>(Please Print)</p> <p>_____</p> <p>(Owner)</p> <p>_____</p> <p>(Please Print)</p>	<p>_____</p> <p>(Spouse)</p> <p>_____</p> <p>(Please Print)</p> <p>_____</p> <p>(Spouse)</p> <p>_____</p> <p>(Please Print)</p> <p>_____</p> <p>(Spouse)</p> <p>_____</p> <p>(Please Print)</p>
--	---

State of Kansas }
 County of Donnell } SS

I hereby certify that the foregoing application was signed in my presence and sworn to before me this 17th day of February, 2021

 NOTARY PUBLIC - State of Kansas
 MICHELLE UNRUH
 My Appt. Expires: 5/18/22
Michelle Unruh
 Notary Public

My Commission Expires 5/18/22

ONLY COMPLETE APPLICATIONS WILL BE PROCESSED. To be complete, all of the applicable portions of the application form must be completed with accurate information; maps, if necessary, must be included; signatures of all the appropriate owners' must be affixed to the application and notarized; and the appropriate fee must be paid.

FEE SCHEDULE

Each application to change the place of use or the point of diversion under this section shall be accompanied by the application fee set forth in the schedule below: Make checks payable to: **Kansas Department of Agriculture**

(1) Application to change a point of diversion 300 feet or less	\$100
(2) Application to change a point of diversion more than 300 feet	\$200
(3) Application to change the place of use	\$200

14. If the proposed groundwater point of diversion is 300 or fewer feet from the existing point of diversion, complete the following:
- (a) Does the undersigned represent all owners of the currently authorized place(s) of use identified in this application?
 Yes No (If no, all owners must sign this application.)
 - (b) Will the ownership interest of any owner of the currently authorized place(s) of use identified in this application be adversely affected if this application is approved as requested?
 Yes No (If yes, all owners must sign this application.)
 - (c) If this application is not approved expeditiously, will there be substantial damage to property, public health or safety?
 Yes No (If no, all owners must sign this application.)

If the application proposes a surface water change in point of diversion, a groundwater change in point of diversion greater than 300 feet, or a change in place of use, the application must be signed by all owners of the currently authorized place of use, or their duly authorized agent (attach notarized statement authorizing representation).

I hereby verify, being first duly sworn upon my oath or affirmation and under penalty of perjury, that I am of lawful age and the owner, the spouse of the owner, or a duly authorized agent of the owner(s) to make this application on their behalf, in regards to the water right(s) to which this application pertains. I further verify that the statements contained in this application are true, correct and complete.

Dated at Jolinson, Kansas, this 19th day of Feb, 2021.

Linda Nicholas

 (Owner)
Linda Nicholas

 (Please Print)

 (Owner)

 (Please Print)

 (Owner)

 (Please Print)

 (Spouse)

 (Please Print)

 (Spouse)

 (Please Print)

 (Spouse)

 (Please Print)

State of Kansas }
 County of Stanton } SS

I hereby certify that the foregoing application was signed in my presence and sworn to before me this 19th day of February, 2021.



[Signature]

 Notary Public

My Commission Expires 6-21-21

ONLY COMPLETE APPLICATIONS WILL BE PROCESSED. To be complete, all of the applicable portions of the application form must be completed with accurate information; maps, if necessary, must be included; signatures of all the appropriate owners' must be affixed to the application and notarized; and the appropriate fee must be paid.

FEE SCHEDULE

Each application to change the place of use or the point of diversion under this section shall be accompanied by the application fee set forth in the schedule below: Make checks payable to: **Kansas Department of Agriculture**

- (1) Application to change a point of diversion 300 feet or less \$100
- (2) Application to change a point of diversion more than 300 feet \$200
- (3) Application to change the place of use \$200

CHANGE IN POINT OF DIVERSION 9283

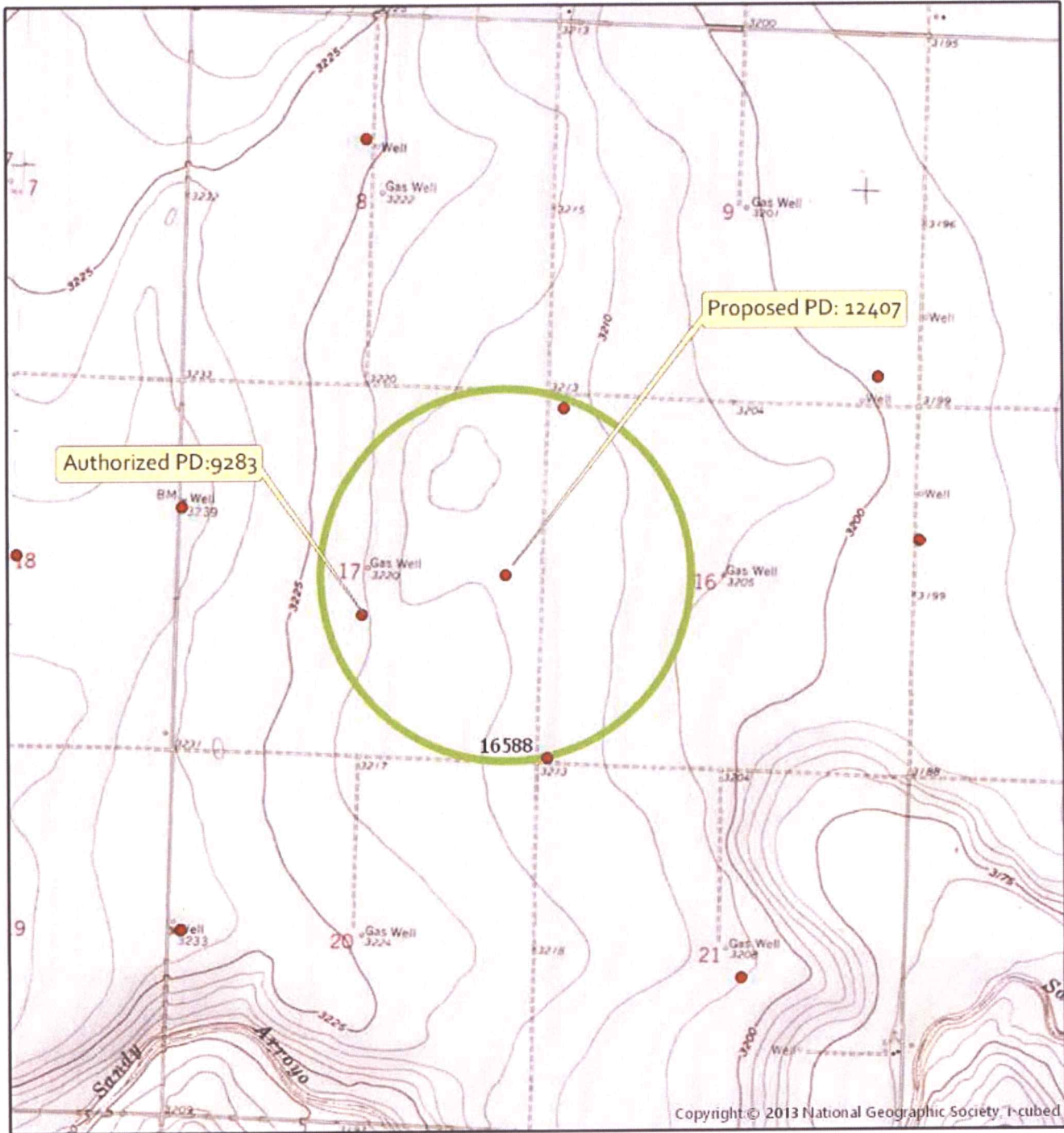

Township 29 South Range 39 West
ST County

0 0.17 0.35 0.7 Miles



All wells of any kind within a half mile of
the proposed point of diversion are shown:

A. McColloch
5/3/2021

This analysis of change in point of diversion, File No. 9,283

A This analysis was used to evaluate the potential impacts of a change in point of diversion. The application proposes moving the point of diversion authorized by File No. 9,283 approximately 2,130 feet east. The 2066 projected saturated thickness (108.5 feet) and from the GMD No. 3 groundwater model was used. Transmissivity (6,592 ft²/day) was obtained from well logs in the local area. The specific storage was assumed to be 10⁻⁵, which results in a storage coefficient of 0.00108.7. Pumping the proposed rate and quantity at the new location was compared to pumping the ten-year average use (221 acre-feet) at the last reported rate (300 gallons per minute). Drawdowns were evaluated at the point of diversion authorized by File No. 18,288. With these assumptions, the drawdown at File No. 18,288 increases by 10.6 feet, or 9.8% of the projected future saturated thickness (Table 1).

Table 1: This analysis of drawdown at File No. 18,288; T = 6,592 ft²/day; S = 0.00108.7

Scenario	Distance (Feet)	Quantity (Acre-Feet)	Rate (GPM)	Drawdown (Feet)	Drawdown (%ST)
Proposed	2507	483	970	15.3	14.1%
Current	4109	221	300	4.7	4.4%
			Net:	10.6	9.8%

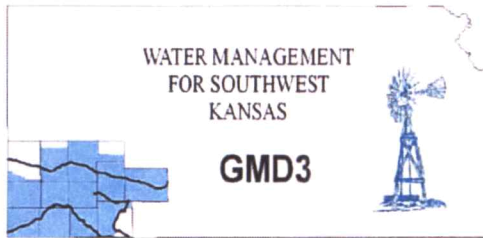

Southwest Kansas
Groundwater Management District No. 3
2009 E. Spruce Street
Garden City, Kansas 67846
(620) 275-7147 phone (620) 275-1431 fax
www.gmd3.org

April 7, 2021

Austin J McColloch
Division of Water Resources
4532 W Jones Ave., Suite B
Garden City, Kansas 67846

RE: Application for Change in Point of Diversion
Water Right, File No. 9283

Dear Austin:

We have completed a review of the application for the above referenced water right. The proposed change in point of diversion to stack the authority on the well under File No. 12407 is in accordance with current area rules, K.A.R. 5-23-3, as it pertains to distance moved and minimum spacing to neighboring wells.

Well evaluations were conducted to estimate possible effects of the proposal on the supply of other wells with water rights prior to the proposal per K.S.A. 82a-708b, and the draft revised management program. Under K.S.A. 82a-708b, an applicant requesting a change in point of diversion must demonstrate to the chief engineer that any proposed change is reasonable and will not impair. The enclosed report is an analysis performed by the GMD on behalf of our membership. Under this analysis, the proposed change is considered to be reasonable and unlikely to impair if either the net in-season well-to-well effect of the proposed change is less than a strict maximum allowable threshold (3.0 ft in cases where saturated thickness is between 125-150 ft), or if no well with a net well-to-well effect exceeding the threshold is identified as critical. Critical wells are identified as wells that are expected to either lose or greatly diminish water supply over the next 25 years. The attached review information is based on a Theis analysis using inputs from the GMD3 aquifer model, which is considered to be the best information on well and aquifer data readily and easily available to the public. If either the applicant or the neighbors believe they have better data that might change the result of the analysis, they should contact GMD3. Conclusions of the well analysis may change if better information on well and aquifer data can be made available.

Every neighboring well within 1 mile of the proposed move was evaluated. Evaluations showed that two of the neighboring wells exceeded the net effect above the maximum allowable threshold. Further analysis shows that the wells would not be critical with limitations on the change. Our office received one response from neighboring well. Our discussion focused mainly on determining the amount that the well could pump with this change and understanding the analysis/report. His main concern was the thought of almost doubling the amount of water the proposed well would be allowed to pump. We discussed how limiting the well would mitigate the effects on his well. They did not provide any written comment for or against the proposal.

Our original analysis was performed at a proposed rate of 916gpm, which was close to how the well was being run in the recent past. The operator stated he would like 1000gpm for the operation in order to run two pivots at proper pressures. We then run the analysis using 1000gpm and what the allocation would be. The operator then had discussions with the landlord. They felt they could easily operate within the proposed limitations. Therefore, GMD3 sees this move as reasonable and therefore recommend that the application be approved and limit the well to 897AF @ 1000gpm. If aquifer conditions change or there is a change to the water right in the future, we would be happy to evaluate the effects at that time.

Thank you for the opportunity to review the applications and to provide a recommendation. If you have any questions, please don't hesitate to contact us.

Sincerely,

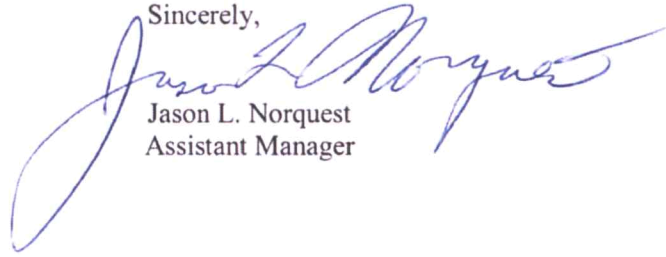
A handwritten signature in blue ink, appearing to read "Jason L. Norquest". The signature is fluid and cursive, with a large loop at the end of the last name.

Jason L. Norquest
Assistant Manager

GMD3 Change Review

File No(s): 9283. DWR office: GC.

App filed to change: PD.

Is Landowner(s) correct in WRIS: L&R Legacy Farm LLC.

If NO, is documentation included?

Is Water Use Correspondent correct in WRIS? .

If NO, is documentation included?

Regulation(s) Reviewed: KAR 5-23-3

Point of diversion ID No(s) 02 being changed.

	ft. North	ft. West	
Authorized PD	2500	2550	Sect 17-29-39
Proposed PD	2600	476	
Difference	-100 n	2074 e	
a2 + b2 = c2	10000	4301476	2076.409 foot move NE

GPS for proposed PD: Lat: Long: .

Is proposed PD stacking on existing WRs? 12407.

Is Proposed PU overlapping existing WRs? No Change.

Neighboring certified well(s) notified: No Change.

Name Barber Farms Inc (5391).

Address 223 N Pine Grove St.

Zip Wichita, KS 67212.

Email: tombarbertax@gmail.com. Phone: 316-619-6364.

Name Bryce A & Rhonda F Wilkerson (18287) {Kilgore Family Farms}.

Address PO Box 568.

Zip Johnson, KS 67855.

Email: brycewilkerson@hotmail.com. Phone: 620-353-8326.

Name R&E Family Farms LP %Gary Floyd (18288).

Address 6190 N Road G.

Zip Johnson, KS 67855.

Email: venture@pld.com. Phone: 620-492-6610.

Gary Floyd. He wanted to make sure he understood the change being proposed and to make sure that the area rules were met. He specifically wanted to verify what amount would be allowed if this change was approved as presented, so we went over what the proposed allocation on that well would be. We also went over the analysis and what the results showed. He did not leave a comment for or against the move.

Domestic well(s) notified: Found none in the area.

Name .

Address .

Zip .

GMD3 Change Review

Base Acres: __.

Perfected Acres: __.

Irr. Return-Flow __%

9283 authorizes 483AF @ 970gpm

Reported Avg use (2011-2020): 220.8AF

Reported 300gpm in 2017

2018 GMD3 inspection showed 302gpm

12407 authorized 477AF @ 1335gpm

Reported Avg use (2011-2020): 466.6AF {3 of the years OP}

Reported 900gpm in 2017

2018 GMD3 inspection showed 916gpm.

Combined authority proposed is 960AF with the proposed stacking.

Is a waiver needed: Move appears less than half mile and minimum spacing met.

Analysis shows that there could be effects to neighboring wells that can be mitigated with limitations 910.8AF @ 916gpm. We were contacted by one of the neighbor notices,

Recommendation: After review of all available information, it appears current area rules are met. Effects on neighboring wells is mitigated if the proposed well is limited to 916gpm and 910.8AF. We then had a conversation with the operator what the analysis showed. He mentioned that he tries to run 2 pivots at 500gpm/each. The original analysis would not work so we reran it and 1000gpm, which would then limit him to 897AF to keep the neighboring effects within the guidelines. The operator took a couple of days to discuss it with the land owners, both agreed that our limitations were at rates and levels that they can operate in. Therefore staff recommends approval of the application with a limitation places on the authority to be 897AF @ 1000gpm.



18287: Drawdown from current location = 7.94 ft
Drawdown from proposed location = 12.04 ft
Net drawdown = **4.1 ft**

18288: Drawdown from current location = 7.83 ft
Drawdown from proposed location = 12.38 ft
Net drawdown = **4.5 ft**

Net drawdown exceeds the drawdown allowance of 3.0 ft for water right nos. 18287 and 18288. Critical well analysis is necessary on those wells.

Critical Well Evaluation:

18287:

Water Column = 141 ft

DP = 4.1 ft (Net drawdown from the proposal indicated above)

DE = 50.1 ft (Water level decline from 2021 through 2046 based upon GMD3 model)

DD = 57.3 ft (S = 0.1518, T = 34,280 gpd/ft, Q = 754 gpm, tp = 121 days, efficiency = 70%)

DT = 111.5 ft

Economic Drawdown Constraint (EDC) = $0.4 * 141 \text{ ft} = 56.4 \text{ ft}$

Physical Drawdown Constraint (PDC) = $141 \text{ ft} - 60 \text{ ft} = 81 \text{ ft}$

Total drawdown of 111.5 ft is greater than the EDC and PDC, so this well is **critical**.

18288:

Water Column = 141 ft

DP = 4.5 ft (Net drawdown from the proposal indicated above)

DE = 50.1 ft (Water level decline from 2021 through 2046 based upon GMD3 model)

DD = 31.6 ft (S = 0.1518, T = 34,280 gpd/ft, Q = 402 gpm, tp = 205 days, efficiency = 70%)

DT = 86.2 ft

Economic Drawdown Constraint (EDC) = $0.4 * 141 \text{ ft} = 56.4 \text{ ft}$

Physical Drawdown Constraint (PDC) = $141 \text{ ft} - 60 \text{ ft} = 81 \text{ ft}$

Total drawdown of 86.2 ft exceeds both the EDC and PDC, so this well is **critical**.

Conclusion:

The proposed move is located in an area with a diminished water supply. Some local wells still have the ability to produce strong flow rates, but much of the lower portion of screened well intervals appears to be made up of soapstone and limestone. The expectation is that as the water table continues to lower, production from these wells will diminish. If the well currently authorized under water right number 12407 were to operate at its full authority, a noticeable effect would occur at nearby wells authorized under water right numbers 18287 and 18288. GMD3 staff recommends a combined rate limitation of 1000 gpm and a combined quantity limitation of 897 AF between water right numbers 9283 and 12407. This rate and quantity would produce the following net effects on neighboring critical wells:

18287: Net Drawdown = **2.6 ft**

18288: Net Drawdown = **3.0 ft**

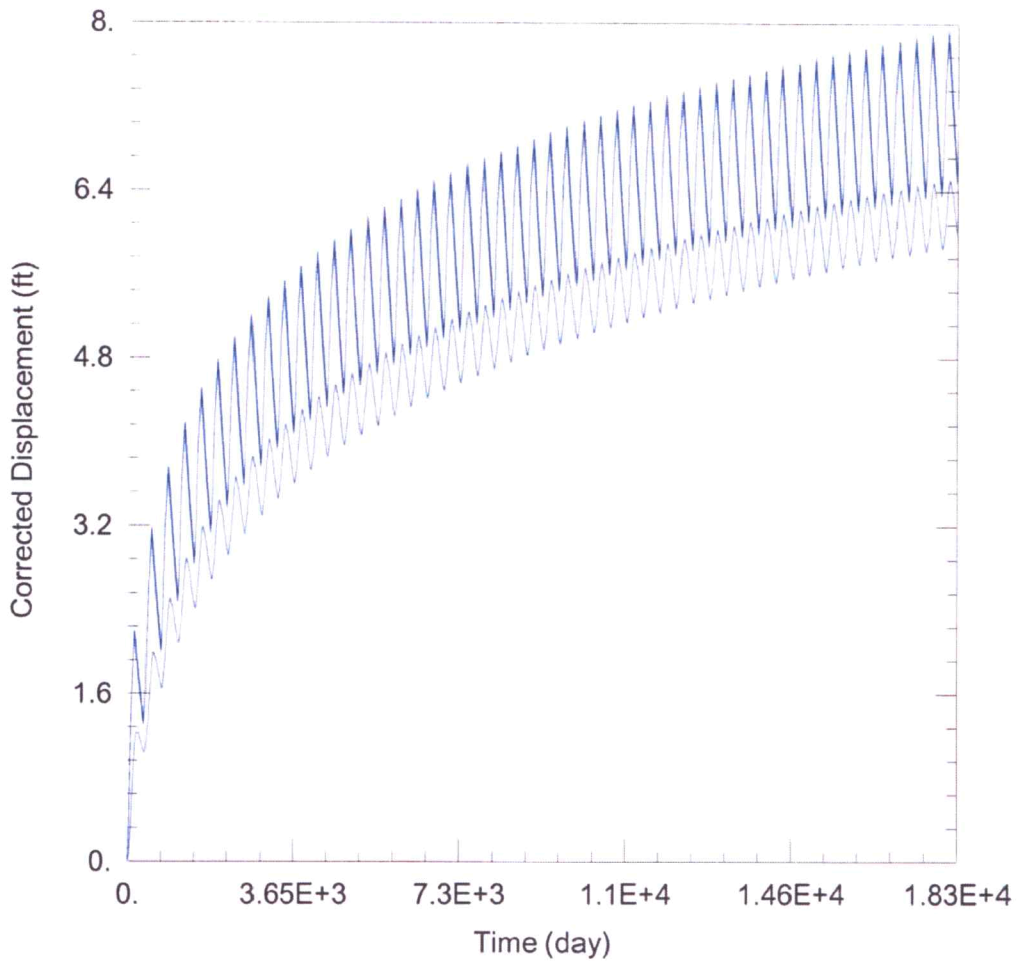

WELL TEST ANALYSIS

Data Set: C:\Users\trevora\Documents\2021_Moves\9283\9283 Current.aqt
 Date: 03/18/21 Time: 10:34:54

PROJECT INFORMATION

Company: GMD 3
 Project: 9283
 Location: Stanton County
 Test Well: 9283

WELL DATA

Pumping Wells

Well Name	X (ft)	Y (ft)
	-234481	237474
	-232428	238083

Observation Wells

Well Name	X (ft)	Y (ft)
□	-234481	237474
□	-232428	238083
□ 5391	-237084	238950
□ 18287	-231778	235489
□ 18288	-231648	240480

SOLUTION

Aquifer Model: Unconfined

Solution Method: Theis

T = 4402.8 ft²/day

S = 0.1694

Kz/Kr = 1.

b = 145. ft

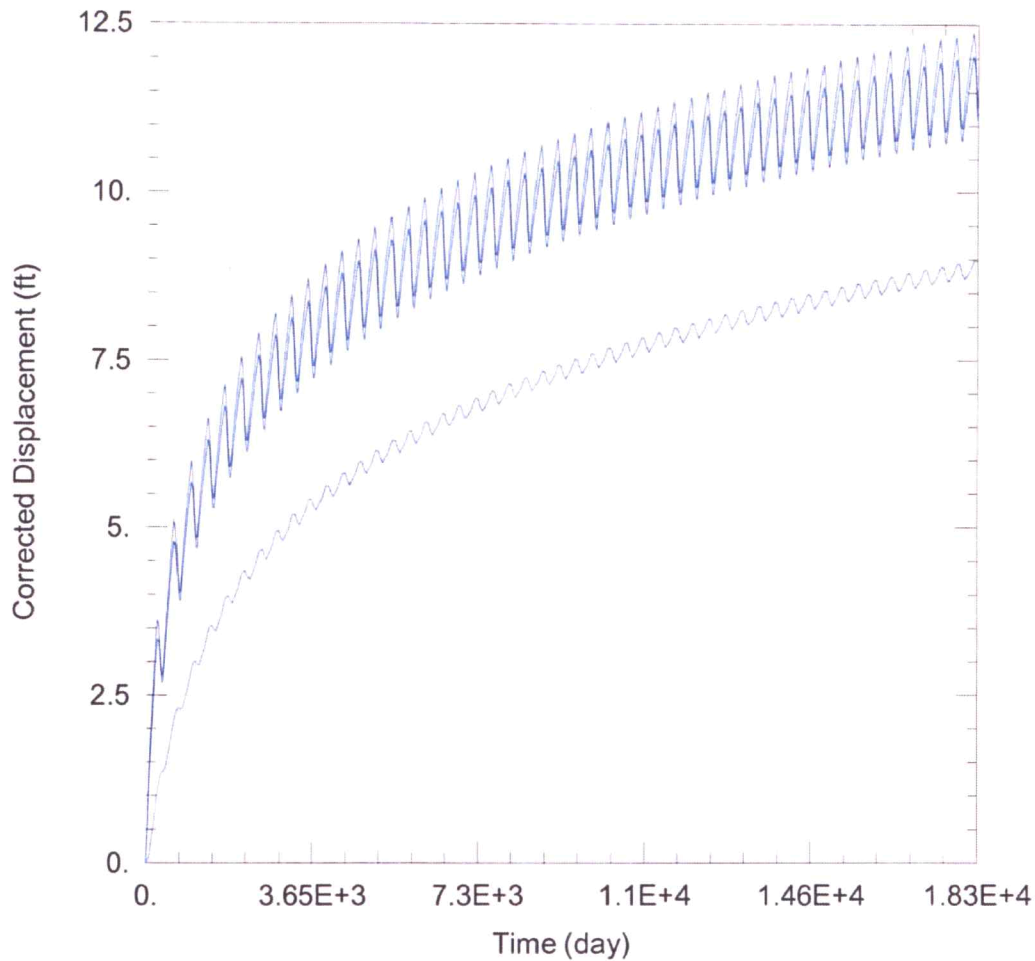

WELL TEST ANALYSIS

Data Set: C:\Users\trevora\Documents\2021_Moves\9283\9283 Proposed.aqt
 Date: 03/18/21 Time: 10:34:45

PROJECT INFORMATION

Company: GMD 3
 Project: 9283
 Location: Stanton County
 Test Well: 9283

WELL DATA

Pumping Wells			Observation Wells		
Well Name	X (ft)	Y (ft)	Well Name	X (ft)	Y (ft)
12407	-232428	238083	□	-232428	238083
			□ 5391	-237084	238950
			□ 18287	-231778	235489
			□ 18288	-231648	240480

SOLUTION

Aquifer Model: <u>Unconfined</u>	Solution Method: <u>Theis</u>
T = <u>4402.8</u> ft ² /day	S = <u>0.1694</u>
Kz/Kr = <u>1.</u>	b = <u>145.</u> ft

AMOUNT STATISTICS REPORT FOR POINTS OF DIVERSION UNDER A 12407 00

#####

AMOUNT STATISTICS REPORT FOR POINTS OF DIVERSION UNDER A 12407 00 IRR

Water Right and Points of Diversion Within 1.00 of a point defined as:

2600 Feet North and 476 Feet West of the Southeast Corner of Section 17 Twp 29S Rng 39W

Both SURFACE WATER and GROUNDWATER

2300' on AF

File Number	Use	ST	SR	Dist (ft)	Q4	Q3	Q2	Q1	FeetN	FeetW	Sec	Twp	Rng	ID	Batt	Auth_Quan	Add_Quan
A__ AF	5391 00	IRR	NK	G	4836	--	NW	SW	NW	3476	5225	17	29	39W	6	640.00	640.00
A__ AF	9283 00	IRR	NK	G*	2090	--	NW	NW	SE	2500	2550	17	29	39W	2	483.00	483.00
A__ AF	12407 00	IRR	NK	G	0	--	NE	NE	SE	2600	476	17	29	39W	5	477.00	477.00
A__ AF	18287 00	IRR	NK	G	2617	--	SW	SW	SW	100	5150	16	29	39W	1	640.00	640.00
A__ AF	18288 00	IRR	NK	G	2547	--	NW	NW	NW	5100	5100	16	29	39W	2	613.00	613.00

Total Net Quantities Authorized:	Direct	Storage
Total Requested Amount (AF) =	.00	.00
Total Permitted Amount (AF) =	.00	.00
Total Inspected Amount (AF) =	.00	.00
Total Pro_Cert Amount (AF) =	.00	.00
Total Certified Amount (AF) =	2853.00	.00
Total Vested Amount (AF) =	.00	.00
TOTAL AMOUNT (AF) =	2853.00	.00

*Spec - 7 Appears
MET*

An * after the source of supply indicates a pending application for change under the file number.

An * after the ID indicates a 15 AF exemption was granted under the file number.

A "G" in the Batt column indicates the GEO CTR of a battery. A "B" indicates a well in the battery.

The number in the Batt column is the number of wells in the battery.

Water Right and Points of Diversion Within 1.00 of a point defined as:

2600 Feet North and 476 Feet West of the Southeast Corner of Section 17 Twp 29S Rng 39W

Both SURFACE WATER and GROUNDWATER

WATER USE CORRESPONDENTS:

- > BARBER FARMS INC
- > 223 N PINE GROVE ST
- > WICHITA KS 67212
- > JOHN D & CAROLYN K SMITH
- > PO BOX 526
- > JOHNSON KS 67855
- > JOHN D & CAROLYN K SMITH
- > PO BOX 526
- > JOHNSON KS 67855
- > BRYCE A & RHONDA F WILKERSON
- > PO BOX 568
- > JOHNSON KS 67855
- > R & E FAMILY FARMS LP
- > GARY FLOYD
- > 6190 N ROAD G

Handwritten notes and checkmarks:
- 2991 ✓
- 0292
- 12407
- 15287 ✓
- 10266

> JOHNSON KS 67855

>-----

=====

#####

Garden City Field Office
4532 W. Jones, Suite B
Garden City, KS 67846



Phone: 620-276-2901
Fax: 620-276-9315
www.agriculture.ks.gov

Mike Beam, Secretary

Laura Kelly, Governor

March 15, 2021

GROUNDWATER MANAGEMENT DISTRICT #3
2009 E SPRUCE ST
GARDEN CITY KS 67846

Change Application,
File No. 9283

Dear Sir or Madam:

We are enclosing a copy of the referenced application, which was submitted by L & R Legacy Farm LLC and appears to be in proper form, for your review.

We are delaying any further action for a period of 15 days from the date of this letter to allow you time to submit your recommendation concerning this application. Please submit your recommendation within the allotted time, or any authorized extension of time thereof.

If you have any questions, please contact me at (620) 276-2901. If you wish to discuss a specific file, please have the file number ready to that I may help you more efficiently.

Sincerely,

A handwritten signature in blue ink that reads "Austin McColloch".

Austin McColloch
Assistant Water Commissioner

Enclosure
pc:

Garden City Field Office
4532 W. Jones, Suite B
Garden City, KS 67846



Phone: 620-276-2901
Fax: 620-276-9315
www.agriculture.ks.gov

Mike Beam, Secretary

Laura Kelly, Governor

February 26, 2021

KILGORE FAMILY PARTNERSHIP LTD
Attn: LEON KILGORE
PO BOX 351
JOHNSON, KS 67855-0351

RE: Water Right, File No. 9283

Dear Sir or Madam:

This is to advise you that L & R Legacy Farms LLC has filed an application for approval of the Chief Engineer, Division of Water Resources, Kansas Department of Agriculture, to change the point of diversion under the above referenced applications. An irrigation well is proposed to be relocated to the NE $\frac{1}{4}$ NE $\frac{1}{4}$ SE $\frac{1}{4}$ of Section 17, Township 29 South, Range 39 West, Stanton County. Please note this is an **existing** well.

You can find the complete applications posted by water right file number as referenced above at: <https://agriculture.ks.gov/divisions-programs/dwr/water-appropriation/notices>

You are notified on this proposed point of diversion (well) so that you may furnish this office with any comments or other information you want to submit. Such comments or other information must be received in this office within 15 days from the date of this letter.

Should you have any questions, please feel free contact this office. If you would prefer, you could arrange an appointment for additional assistance. Please refer to the file number when you contact us if you wish to discuss a specific file.

Sincerely,

A handwritten signature in black ink, appearing to read "Austin J. McColloch".

Austin J. McColloch
Assistant Water Commissioner

AM:
enclosures

pc:
GROUNDWATER MANAGEMENT DISTRICT NO. 3

SCANNED

Garden City Field Office
4532 W. Jones, Suite B
Garden City, KS 67846



Phone: 620-276-2901
Fax: 620-276-9315
www.agriculture.ks.gov

Mike Beam, Secretary

Laura Kelly, Governor

February 26, 2021

R & E FAMILY FARMS LP
Attn: GARY FLOYD
6190 N ROAD G
JOHNSON, KS 67855-8861

RE: Water Right, File No. 9283

Dear Sir or Madam:

This is to advise you that L & R Legacy Farms LLC has filed an application for approval of the Chief Engineer, Division of Water Resources, Kansas Department of Agriculture, to change the point of diversion under the above referenced applications. An irrigation well is proposed to be relocated to the NE $\frac{1}{4}$ NE $\frac{1}{4}$ SE $\frac{1}{4}$ of Section 17, Township 29 South, Range 39 West, Stanton County. Please note this is an **existing** well.

You can find the complete applications posted by water right file number as referenced above at: <https://agriculture.ks.gov/divisions-programs/dwr/water-appropriation/notices>

You are notified on this proposed point of diversion (well) so that you may furnish this office with any comments or other information you want to submit. Such comments or other information must be received in this office within 15 days from the date of this letter.

Should you have any questions, please feel free contact this office. If you would prefer, you could arrange an appointment for additional assistance. Please refer to the file number when you contact us if you wish to discuss a specific file.

Sincerely,

A handwritten signature in black ink, appearing to read "Austin J. McColloch".

Austin J. McColloch
Assistant Water Commissioner

AM:
enclosures

pc:
GROUNDWATER MANAGEMENT DISTRICT NO. 3

SCANNED