

Kansas Department of Agriculture  
 Division of Water Resources  
**CHANGE: P/D WORKSHEET**

1. File Number: <b>16759</b>	2. Status Change Date:	3. Change Num: <b>C2</b>	4. Field Office: <b>4</b>	5. GMD: <b>3</b>
---------------------------------	------------------------	-----------------------------	------------------------------	---------------------

6. Status: <input checked="" type="checkbox"/> Approved <input type="checkbox"/> Denied by DWR/GMD <input type="checkbox"/> Dismiss by Request/Failure to Return	7. Filing Date of Change: <b>5/19/2022</b>
--	---

8a. Applicant(s) New to system <input type="checkbox"/>  <b>KENT DUNN</b> <b>25923 ROAD A</b> <b>MOSCOW, KS 67952</b>	Person ID <b>28502</b> Add Seq# <b>01</b>	8c. Landowner(s) New to system <input type="checkbox"/>  	Person ID _____ Add Seq# _____
--	--	--	-----------------------------------

8b. Landowner(s) New to system <input type="checkbox"/>  <b>8a</b>	Person ID _____ Add Seq# _____	8d. WUC New to system <input type="checkbox"/>  <b>8a</b>	Person ID _____ Add Seq# _____
---	-----------------------------------	--	-----------------------------------

9. Documents and Enclosure(s):  DWR Meter(s) Date to Comply: **12/31/2022**     N & P Date to Comply: **3/1/2023**

Anti-Reverse Meter     Meter Seal     Check Valve     N & P Form     Water Tube     Driller Copy     H & E Letter  
 Conservation Plan    Date Required: \_\_\_\_\_    Date Approved: \_\_\_\_\_    Date to Comply: \_\_\_\_\_

10. Use Made of Water    From: \_\_\_\_\_    To: \_\_\_\_\_

Date Prepared: **6/27/2022**    By: **AM**  
 Date Entered: \_\_\_\_\_    By: \_\_\_\_\_

File No. **16759**      11. County: **SW**      Basin: **CIMARRON RIVER**      Stream:      Formation Code: **211**      Special Use:

12. Points of Diversion  
 CHK  
 MOD  
 DEL      PDIV  
 ENT      Qualifier      S      T      R      ID      'N      'W      Comment (AKA Line)      Rate gpm      Quantity af      Additional Rate gpm      Quantity af      Overlap PD Files

**DEL 13057**  
**ENT      NW SE NW      11      31S 33W      3457      3847      2500      640      2500      640      NONE**

13. Storage: Rate \_\_\_\_\_ NF      Quantity \_\_\_\_\_ ac/ft      Additional Rate \_\_\_\_\_ NF      Additional Quantity \_\_\_\_\_ ac/ft

14. Limitation: \_\_\_\_\_ af/yr at \_\_\_\_\_ gpm ( \_\_\_\_\_ cfs) when combined with file number(s) \_\_\_\_\_  
 Limitation: \_\_\_\_\_ af/yr at \_\_\_\_\_ gpm ( \_\_\_\_\_ cfs) when combined with file number(s) \_\_\_\_\_

15. 5YR Allocation:      Allocation Type \_\_\_\_\_      Start Year \_\_\_\_\_      5 YR Amount \_\_\_\_\_      Amount Unit \_\_\_\_\_      Base Acres \_\_\_\_\_      Comment \_\_\_\_\_

16. Place of Use CHK MOD DEL ENT      PUSE      S      T      R      ID	NE¼				NW¼				SW¼				SE¼				Total	Owner	Chg?	Overlap Files
	NE ¼	NW ¼	SW ¼	SE ¼	NE ¼	NW ¼	SW ¼	SE ¼	NE ¼	NW ¼	SW ¼	SE ¼	NE ¼	NW ¼	SW ¼	SE ¼				
<b>CHK 26484</b>																				

Base Acres:      Year:      Minimum Reasonable Quantity:

Comments:



Garden City Field Office  
4532 W. Jones, Suite B  
Garden City, KS 67846



Phone: 620-276-2901  
Fax: 620-276-9315  
www.agriculture.ks.gov

Mike Beam, Secretary

Laura Kelly, Governor

June 27, 2022

KENT DUNN  
25923 ROAD A  
MOSCOW, KS 67952

RE: Filed Office Application for Change  
Water Right, File No. 16759

Dear Sir or Madam:

Enclosed is the order executed by the designee of the Chief Engineer, Division of Water Resources, Kansas Department of Agriculture, approving the application for change under the above referenced file number.

Your attention is directed to the enclosures and to the terms, conditions, and limitations specified in this approval for change. A condition of this approval is that an acceptable water flow meter must be installed on the diversion works authorized under the referenced file number and meet current specifications. Please return the required notification of completion of the diversion works and installation of the required meter as soon as these actions are completed.

Since the order modifies the original document referred to above, it should be recorded with the Register of Deeds as other instruments affecting real estate.

The abandoned well must be plugged in accordance with the requirements of Article 30 of the Rules and Regulations as adopted by the Kansas Department of Health and Environment.

Should you have any questions, please feel free contact this office. If you would prefer, you could arrange an appointment for additional assistance.

Sincerely,

A handwritten signature in blue ink that reads "Austin J. McColloch".

Austin J. McColloch  
Assistant Water Commissioner

AM:  
enclosures

pc: GROUNDWATER MANAGEMENT DISTRICT NO. 3

## CERTIFICATE OF SERVICE

On this 27<sup>th</sup> day of June, 2022, I hereby certify that the foregoing Approval of Application for Change in Point of Diversion, Water Right, File Nos. 16,759 dated 27<sup>th</sup> day of June, 2022 was mailed postage prepaid, first class, US mail to the following:

KENT DUNN  
25923 ROAD A  
MOSCOW, KS 67952

Pc:

GROUNDWATER MANAGEMENT DISTRICT NO. 3

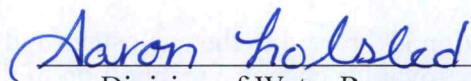

Division of Water Resources Staff



Submit completed application to:  
 Kansas Department of Agriculture  
 Division of Water Resources  
 Field Office for your area.  
 Call for address:  
 Topeka -- (785) 296-5733  
 Stafford -- (620) 234-5311  
 Stockton -- (785) 425-6787  
 Garden City -- (620) 276-2901  
<http://agriculture.ks.gov/dwr>

## DWR FIELD OFFICE APPLICATION FOR APPROVAL TO CHANGE THE PLACE OF USE AND/OR THE POINT OF DIVERSION



**STATE OF KANSAS**

**Filing Fee Must Accompany the Application, K.S.A. 82a-708b(b), as amended.**  
 Fee Schedule is on the third page of this application form.

**Paragraph Nos. 1, 2, 3 & 5 must be completed. Complete all other applicable portions.** If change in point of diversion is greater than 100 feet, or if place of use will be changed, include a topographic map or detailed plat showing the authorized and proposed point(s) of diversion and/or place of use.

**RECEIVED**  
 9:42 am  
 MAY 19 2022

File No. 16759

Garden City Field Office  
 Division of Water Resources

1. Application is hereby made for approval of the Chief Engineer to change the (check one or both):
- Place of Use                       Point of Diversion
- under the water right which is the subject of this application in accordance with the conditions described below.
- The source of supply is:                       Groundwater                       Surface water

2. Name and address of Applicant: KENT DUNN  
25923 ROAD A MOSCOW KS 67952  
 Phone Number: (620) 649-7008                      Email address: kadunn@pld.com  
 Name and address of Water Use Correspondent: SAME AS ABOVE  
 Phone Number: (     )                      Email address: \_\_\_\_\_

3. The presently authorized place of use is:  
 Owner of Land ---- NAME: SAME AS ABOVE - NO CHANGE  
 ADDRESS: \_\_\_\_\_  
 (If there is more than one landowner, attach supplemental sheets as necessary.)

Sec.	Twp.	Range	NE¼				NW¼				SW¼				SE¼				TOTAL ACRES		
			NE¼	NW¼	SW¼	SE¼	NE¼	NW¼	SW¼	SE¼	NE¼	NW¼	SW¼	SE¼	NE¼	NW¼	SW¼	SE¼			

4. If this application is for a change in place of use, it is proposed that the place of use be changed to:  
 Owner of Land ---- NAME: \_\_\_\_\_  
 ADDRESS: \_\_\_\_\_  
 (If there is more than one landowner, attach supplemental sheets as necessary.)

Sec.	Twp.	Range	NE¼				NW¼				SW¼				SE¼				TOTAL ACRES			
			NE¼	NW¼	SW¼	SE¼	NE¼	NW¼	SW¼	SE¼	NE¼	NW¼	SW¼	SE¼	NE¼	NW¼	SW¼	SE¼				

**For Office Use Only:** Code \_\_\_\_\_ Fee \$ 200.00 TR # \_\_\_\_\_ Receipt Date 5-19-22 Check # 7766

5. **Presently authorized point of diversion:**  
 One in the SE Quarter of the SE Quarter of the NW Quarter of Section 11, Township 31 South, Range 33 (W), in SEWARD County, Kansas, 2970 feet North 2750 feet West of Southeast corner of section.  
 Authorized Rate \_\_\_\_\_ Authorized Quantity \_\_\_\_\_ Depth of well \_\_\_\_\_ (feet)  
**(DWR use only: Computer ID No. \_\_\_\_\_ GPS \_\_\_\_\_ feet North \_\_\_\_\_ feet West)**  
 This point will not be changed  This point will be changed as follows:  No change, point better described with GPS as follows:  
**Proposed point of diversion: (Complete only if change is requested or if existing point is better described by GPS)**  
 One in the NW Quarter of the SE Quarter of the NW Quarter of Section 11, Township 31 South, Range 33 (W), in SEWARD County, Kansas, 3457 feet North 3847 feet West of Southeast corner of section.  
 Proposed Rate \_\_\_\_\_ Proposed Quantity \_\_\_\_\_ Proposed well depth (feet) \_\_\_\_\_  
 This point is:  Additional Well  Geo Center List other water rights that will use this point \_\_\_\_\_

6. **Presently authorized point of diversion:**  
 One in the \_\_\_\_\_ Quarter of the \_\_\_\_\_ Quarter of the \_\_\_\_\_ Quarter of Section \_\_\_\_\_, Township \_\_\_\_\_ South, Range \_\_\_\_\_ (W), in \_\_\_\_\_ County, Kansas, \_\_\_\_\_ feet North \_\_\_\_\_ feet West of Southeast corner of section.  
 Authorized Rate \_\_\_\_\_ Authorized Quantity \_\_\_\_\_ Depth of well \_\_\_\_\_ (feet)  
**(DWR use only: Computer ID No. \_\_\_\_\_ GPS \_\_\_\_\_ feet North \_\_\_\_\_ feet West)**  
 This point will not be changed  This point will be changed as follows:  No change, point better described with GPS as follows:  
**Proposed point of diversion: (Complete only if change is requested or if existing point is better described by GPS)**  
 One in the \_\_\_\_\_ Quarter of the \_\_\_\_\_ Quarter of the \_\_\_\_\_ Quarter of Section \_\_\_\_\_, Township \_\_\_\_\_ South, Range \_\_\_\_\_ (W), in \_\_\_\_\_ County, Kansas, \_\_\_\_\_ feet North \_\_\_\_\_ feet West of Southeast corner of section.  
 Proposed Rate \_\_\_\_\_ Proposed Quantity \_\_\_\_\_ Proposed well depth (feet) \_\_\_\_\_  
 This point is:  Additional Well  Geo Center List other water rights that will use this point \_\_\_\_\_

7. The changes herein are desired for the following reasons?  
 (please be specific) LOSS OF PRODUCTION AT  
CURRENT WELL

8. If a well, is the test hole log attached?  Yes  No

9. The change(s) (was)(will be) completed by?  
 \_\_\_\_\_

10. If the point of diversion is a well:  
 (a) What are you going to do with the old well?  
PLUG / CAP  
 (b) When will this be done? UPON COMPLETION

11. Groundwater Management District recommendation attached?  
 Yes  No

12. Assisted by AM / GCFO

13a. If the proposed point of diversion will be relocated more than 300 feet but within 2,640 feet of the existing point of diversion, attach a topographic map or aerial photograph. For groundwater sources, show all wells (including domestic) within one-half mile of the proposed point of diversion and the names and mailing addresses of the owners. For surface water sources, show the names and addresses of the landowner(s) one-half mile downstream and one-half mile upstream from your property lines

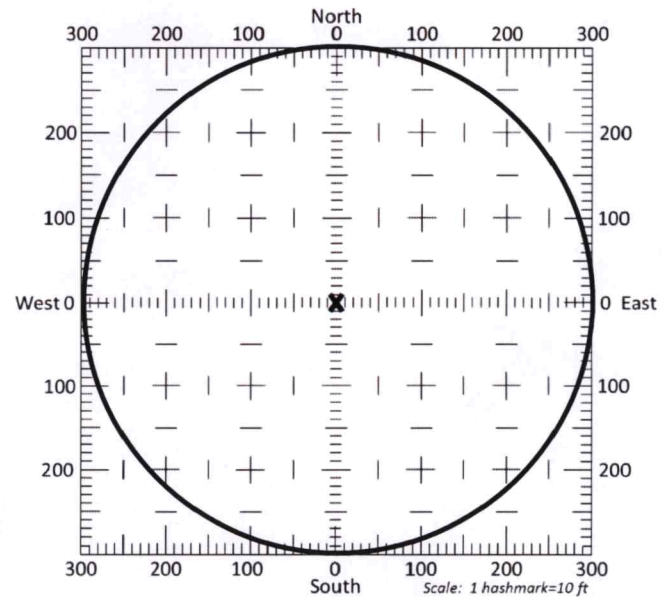

13b. If the proposed point of diversion will be relocated within a 300 foot radius of the existing point of diversion, indicate its location on the diagram shown above in relation to the existing point of diversion. The proposed point of diversion must be located within the circle shown above. **(PLEASE NOTE: The "X" in center of diagram above represents the presently authorized point of diversion.)**



14. If the proposed groundwater point of diversion is 300 or fewer feet from the existing point of diversion, complete the following:
- (a) Does the undersigned represent all owners of the currently authorized place(s) of use identified in this application?  
 Yes     No    (If no, all owners must sign this application.)
  - (b) Will the ownership interest of any owner of the currently authorized place(s) of use identified in this application be adversely affected if this application is approved as requested?  
 Yes     No    (If yes, all owners must sign this application.)
  - (c) If this application is not approved expeditiously, will there be substantial damage to property, public health or safety?  
 Yes     No    (If no, all owners must sign this application.)

If the application proposes a surface water change in point of diversion, a groundwater change in point of diversion greater than 300 feet, or a change in place of use, the application must be signed by all owners of the currently authorized place of use, or their duly authorized agent (attach notarized statement authorizing representation).

**I hereby verify, being first duly sworn upon my oath or affirmation and under penalty of perjury, that I am of lawful age and the owner, the spouse of the owner, or a duly authorized agent of the owner(s) to make this application on their behalf, in regards to the water right(s) to which this application pertains. I further verify that the statements contained in this application are true, correct and complete.**

Dated at 5-12-22, Kansas, this \_\_\_\_\_ day of \_\_\_\_\_, 20\_\_\_\_\_.

*Kent Dunn*  
 \_\_\_\_\_  
 (Owner)

*Kent Dunn*  
 \_\_\_\_\_  
 (Please Print)

\_\_\_\_\_  
 (Owner)

\_\_\_\_\_  
 (Please Print)

\_\_\_\_\_  
 (Owner)

\_\_\_\_\_  
 (Please Print)

*Ardith Dunn*  
 \_\_\_\_\_  
 (Spouse)

*Ardith Dunn*  
 \_\_\_\_\_  
 (Please Print)

\_\_\_\_\_  
 (Spouse)

\_\_\_\_\_  
 (Please Print)

\_\_\_\_\_  
 (Spouse)

\_\_\_\_\_  
 (Please Print)

State of Kansas }  
 County of Haskell } SS

I hereby certify that the foregoing application was signed in my presence and sworn to before me this 12 day of May, 2022



*Shellie Barker*  
 \_\_\_\_\_  
 Notary Public

My Commission Expires 7-14-24

**ONLY COMPLETE APPLICATIONS WILL BE PROCESSED.** To be complete, all of the applicable portions of the application form must be completed with accurate information; maps, if necessary, must be included; signatures of all the appropriate owners' must be affixed to the application and notarized; and the appropriate fee must be paid.

**FEE SCHEDULE**

Each application to change the place of use or the point of diversion under this section shall be accompanied by the application fee set forth in the schedule below: Make checks payable to: Kansas Department of Agriculture

- (1) Application to change a point of diversion 300 feet or less ..... \$100
- (2) Application to change a point of diversion more than 300 feet ..... \$200
- (3) Application to change the place of use ..... \$200



**SUMMARY ORDER APPROVING APPLICATION FOR CHANGE AND IMPOSING CONDITIONS**

This Summary Order is issued under authority of K.S.A. 82a-708b, as amended, and K.A.R. 5-5-1, *et seq.* and other applicable provisions of the *Kansas Water Appropriation Law, K.S.A. 82a-701 et. seq.*, and rules and regulations promulgated thereunder, With the exception of those conditions expressly contained herein, this Summary Order does not change the terms, conditions and limitations of File No. 16759.

1. A change application was received on May 19, 2022 requesting that the place of use and / or point of diversion authorized under the above-referenced file number be changed as described in the application.
2. On and after the effective date of this summary order, the authorized place(s) of use shall be located substantially as shown on the topographic map accompanying the application to change the place of use.  Applicable  Not Applicable
3. The change in point of diversion shall not impair existing rights and shall be limited to the same source or sources of water as previously authorized. The point of diversion authorized by this summary order shall be located within a 50 foot radius of the authorized point(s) of diversion.  Applicable  Not Applicable
4. The point(s) of diversion described herein is administratively corrected to be more accurately described using the Global Positioning System (GPS), as described in the application.  Applicable  Not Applicable
5. The point(s) of diversion authorized herein shall not actually be located more than 2640 feet from the previously authorized point(s) of diversion.  Applicable  Not Applicable
6. As required by K.A.R. 5-3-5d, if the works for diversion is a well with a diversion rate of 100 gallons per minute or more, a tube or other device suitable for making water level measurements shall be installed, operated and maintained in accordance with K.A.R. 5-6-13.  Applicable  Not Applicable
7. **The owner of the authorized place(s) of use shall properly install an acceptable water flow meter on or before December 31, 2022**, or before the first use of water, whichever occurs first. The water flow meter shall be installed, operated and maintained in accordance with K.A.R. 5-1-4 through 5-1-12. As required by K.S.A. 82a-732, as amended, and K.A.R. 5-3-5e, the owner shall maintain records and report the reading of the water flow meter and the total quantity of water diverted annually to the Chief Engineer by March 1 following the end of each calendar year.  Applicable  Not Applicable
8. **Installation of the works for diversion of water shall be completed on or before December 31, 2022**, or within any authorized extension of time. By March 1, 2023 the applicant shall notify the Chief Engineer that construction of the works for diversion has been completed, on the form provided by the Chief Engineer, as required by K.A.R. 5-8-4e.  Applicable  Not Applicable
9. **The completed well log shall be submitted with the required notice.**  Applicable  Not Applicable
10. All diversion works into which any type of chemical or other foreign substance will be injected into the water shall be equipped with an in-line, automatic, quick-closing check valve capable of preventing pollution of the source of the water supply. The check valve(s) shall be installed, operated and maintained in accordance with K.A.R. 5-3-5c.  Applicable  Not Applicable
11. Additional Conditions are attached.  Yes  No
12. In accordance with K.S.A. 82a-708a, as amended, and K.A.R. 5-5-14, all of the owners of the authorized place(s) of use of water appropriated under the above-referenced file number are responsible for compliance with its terms, conditions and limitations, as amended and/or supplemented by this Summary Order, and with applicable provisions of the *Kansas Water Appropriation Law* and the *Rules and Regulations* promulgated thereunder. Failure to comply with these provisions may result in civil penalties pursuant to K.S.A. 82a-737, as amended, and/or the suspension or revocation and dismissal of the water or appropriation right or any other enforcement actions authorized by law.

**Administrative Appeal and Effective Date of Order**

If you are aggrieved by this order, pursuant to K.S.A. 82a-1901, you may request an evidentiary hearing before the Chief Engineer or request administrative review by the Secretary of Agriculture. A request for hearing by the Chief Engineer must be filed within **15 days** of service of this Order and a request for administrative review by the Secretary must be filed within **30 days** pursuant to K.S.A. 77-531. Any request for administrative review must state a basis for review pursuant to K.S.A. 77-527. File any request with **Kansas Department of Agriculture, Legal Division, 1320 Research Park Drive, Manhattan, KS 66502**. Failure to timely request a hearing or review may preclude review under the Kansas Judicial Review Act.

*For Use by Register of Deeds*

FOR OFFICE USE ONLY  
**APPLICATION APPROVED AND SUMMARY ORDER ISSUED**

By: Austin McColloch  
Duly Authorized Designee of the Chief Engineer

(Print Name): Austin McColloch  
Division of Water Resources - Kansas Department of Agriculture

Date of Issuance: June 27, 2022

State of Kansas )  
County of Osage ) SS

Acknowledged before me on June 27, 2022  
by Austin McColloch

Signature: Julie Jones  
Notary Public

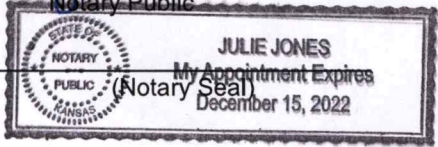
My commission expires: \_\_\_\_\_  



# CHANGE IN POINT OF DIVERSION WATER RIGHT, FILE NO. 16759

NW1/4 of Section 11 Township 31 South Range 33 West Seward County

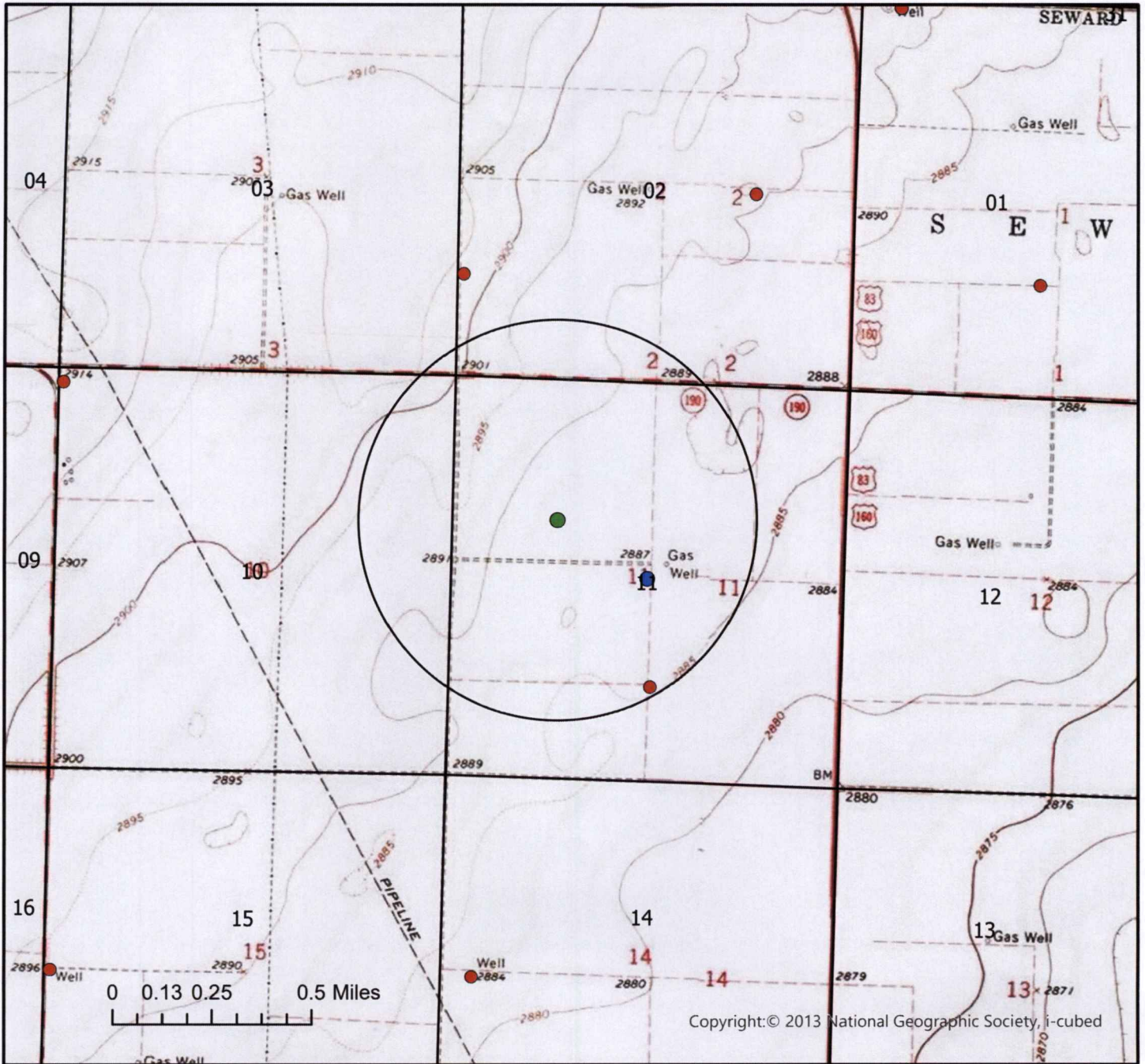

	Authorized Point of Diversion
	Proposed Point of Diversion
	Permitted Water Right
	Domestic Well within 1/2 mile
	1/2 mile buffer

List of owner name and addresses within 1/2 mile:

WR 23518: BARBARA HANSON  
 1036 N PROSPECT AVE  
 LIBERAL KS 67901-2524



By signing below I agree that all wells, including domestic, and owners names and addresses within 1/2 mile of the proposed point of diversion have been shown on the map

(Signature) \_\_\_\_\_ Date \_\_\_\_\_

AM/GCFO  
 1:24,000 Scale







# Kent Dunn

Test Hole # 1 of 4-14-22,  
NW 11-31-33 SW  
Replacement Well Location  
File # 16759

## Legend

 37.36848 N 100.88245 W

190

190

K

 37.36848 N 100.88245 W

 Google Earth



2000 ft



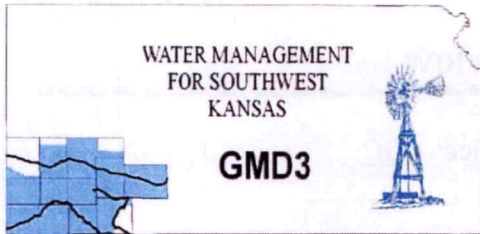

**Southwest Kansas**  
**Groundwater Management District No. 3**  
2009 E. Spruce Street  
Garden City, Kansas 67846  
(620) 275-7147 phone (620) 275-1431 fax  
www.gmd3.org

June 27, 2022

Hunter Hershey  
Division of Water Resources  
4532 W Jones Ave., Suite B  
Garden City, Kansas 67846

RE: Application for Change in Point of Diversion  
Water Right, File No. 16759

Dear Hunter:

We have completed a review of the application for the above referenced water right. The proposed change in point of diversion is in accordance with current area rules, K.A.R. 5-23-3, as it pertains to minimum spacing to neighboring wells and distance moved.

Well evaluations were conducted to estimate possible effects of the proposal on the supply of other wells with water rights prior to the proposal per K.S.A. 82a-708b, and the management program. Under K.S.A. 82a-708b, an applicant requesting a change in point of diversion must demonstrate to the chief engineer that any proposed change is reasonable and will not impair. The enclosed report is an analysis performed by the GMD on behalf of our membership. Under this analysis, the proposed change is considered to be reasonable and unlikely to impair if either the net in-season well-to-well effect of the proposed change is less than a strict maximum allowable threshold (3.5 ft with saturated thickness is between 150-200ft), or if no well with a net well-to-well effect exceeding the threshold is identified as critical. Critical wells are identified as wells that are expected to either lose or greatly diminish water supply over the next 25 years. The attached review information is based on a Theis analysis using inputs from the GMD3 aquifer model, which is considered to be the best information on well and aquifer data readily and easily available to the public. If either the applicant or the neighbors believe they have better data that might change the result of the analysis, they should contact GMD3. Conclusions of the well analysis may change if better information on well and aquifer data can be made available.

Every neighboring well within 1 mile of the proposed move was evaluated. Evaluations showed that none of the neighboring wells exceeded the net effect above the maximum allowable threshold and needed no further evaluation. No critical wells were determined in the area. Therefore, GMD3 sees this move as meeting current area rules and would recommend approval. If aquifer conditions change or there is a change to the water right in the future, we would be happy to evaluate the effects at that time.

Thank you for the opportunity to review the applications and to provide a recommendation. If you have any questions, please don't hesitate to contact us.

Sincerely,

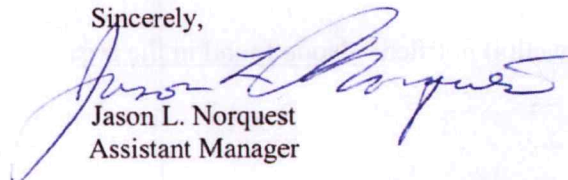

Jason L. Norquest  
Assistant Manager

RECEIVED

JUN 27 2022

Garden City Field Office  
Division of Water Resources

Working Water Conservation Every Day Since 1976



## GMD3 Change Review

---

File No(s): 16759. DWR office: GC.

App filed to change: PD.

Is Landowner(s) correct in WRIS: Kent Dunn.

If NO, is documentation included?

Is Water Use Correspondent correct in WRIS?   .

If NO, is documentation included?

Regulation(s) Reviewed: KAR 5-23-3

Point of diversion ID No(s) 02 being changed.

	ft. North	ft. West	
Authorized PD	2970	2750	Sect 11-31-33
Proposed PD	3457	3847	
Difference	-487 n	-1097 w	
$a^2 + b^2 = c^2$	237169	1203409	1200.241 foot move NW

GPS for proposed PD: Lat: 37.36848 Long: -100.88245.

Is proposed PD stacking on existing WRs? No.

Is Proposed PU overlapping existing WRs? No Change.

Neighboring certified well(s) notified:   .

Name LH & Thais J Brown (23518).

Address PO Box 126.

Zip Plains, KS 67869.

Email: ihbtjb@yahoo.com Phone: 620-563-7314.

Name Joann Dowdy Franz %Jay Hay agent (26205).

Address PO Box 2707.

Zip Liberal, KS 67905.

Email: rod@hayrice.com Phone: 620-624-8471.

Name Larry Davis (27275).

Address PO Box 593.

Zip Sublette, KS 67877.

Email: davisautobody@yahoo.com Phone: 620-290-1055.

**Had discussion with Farm Manager Rob Tanner. They had no concerns, just wanted some questions answered about the process and what all the analysis was showing.**

Domestic well(s) notified: None found in the area.

Name   .

Address   .

Zip   .

Base Acres:   .



## GMD3 Change Review

---

Perfected Acres: \_\_.

Irr. Return-Flow \_\_\_%

**Seward County**

**Authorized 640AF @ 2500gpm**

**Reported use (2012-2021): 467.8AF/year average**

**Reported 1500gpm on 2018 WUR**

**Proposed depth of 595' (20' sump)**

**Well not pumping during most recent GMD3 inspection.**

Is a waiver needed: Move is less than half mile. Minimum spacing to neighboring wells is met. Analysis shows effects within guidelines, no critical wells.

Recommendation: After review of all available information, it appears current area rules are met. Staff therefore recommends approval of the application.





23518:

Drawdown from current location = 6.03 ft

Drawdown from proposed location = 5.51 ft

Net drawdown = -0.5 ft

Net drawdown does not exceed the drawdown allowance of 3.5 ft for any well within 1 mile of the proposed location. Therefore, critical well analysis is not necessary.

**Conclusion:**

The proposed move is likely to create minimal effects on neighboring wells and appears unlikely to cause impairment. Any concerned neighbors should contact GMD3 at (620) 275-7147 or the Division of Water Resources at (620) 276-2901.



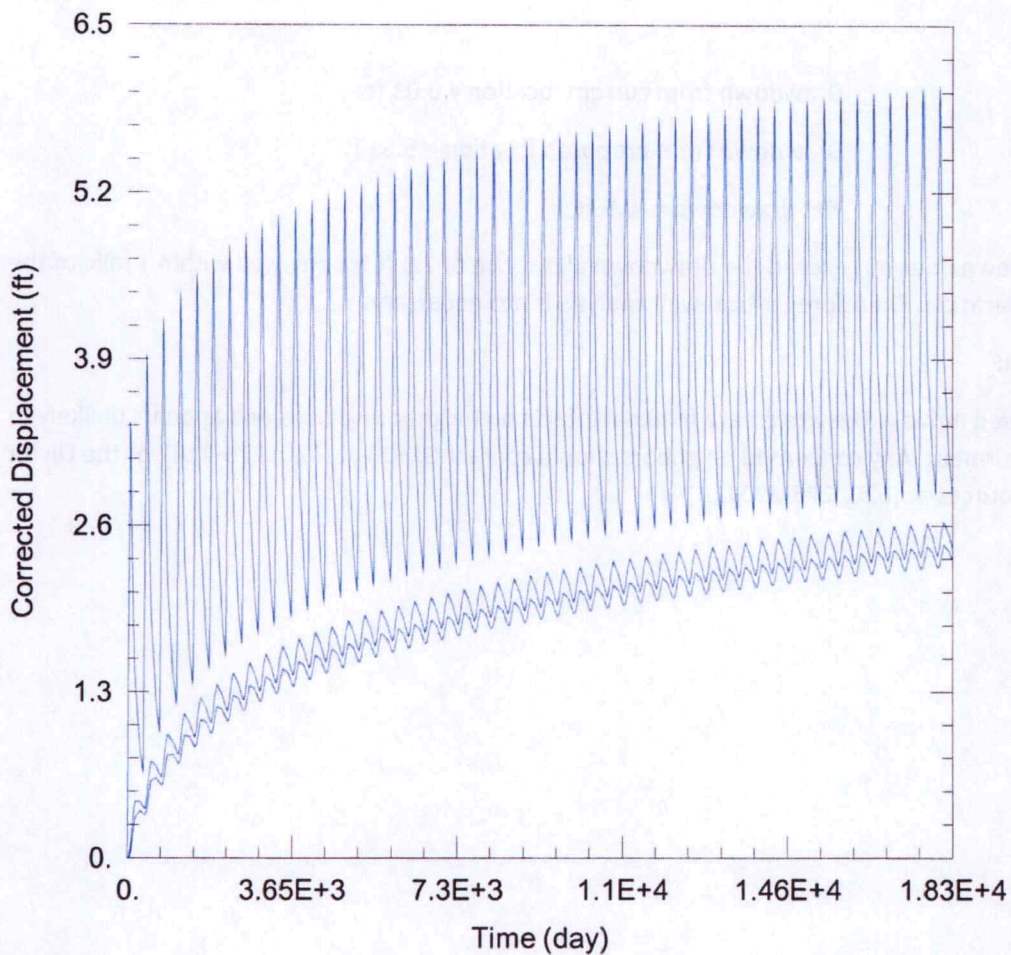

**WELL TEST ANALYSIS**

Data Set: C:\Users\trevora\Documents\2022\_moves\16759\16759 Current.aqt  
 Date: 06/21/22 Time: 15:06:34

**PROJECT INFORMATION**

Company: GMD 3  
 Project: 16759  
 Location: Seward County

**WELL DATA**

**Pumping Wells**

Well Name	X (ft)	Y (ft)
16759	-22909	178941

**Observation Wells**

Well Name	X (ft)	Y (ft)
□	-22909	178941
□ 26205	-25471	182913
□ 27275	-21605	184074
□ 23518	-22831	177510

**SOLUTION**

Aquifer Model: Unconfined

Solution Method: Theis

T = 7186. ft<sup>2</sup>/day

S = 0.2287

Kz/Kr = 1.

b = 190. ft

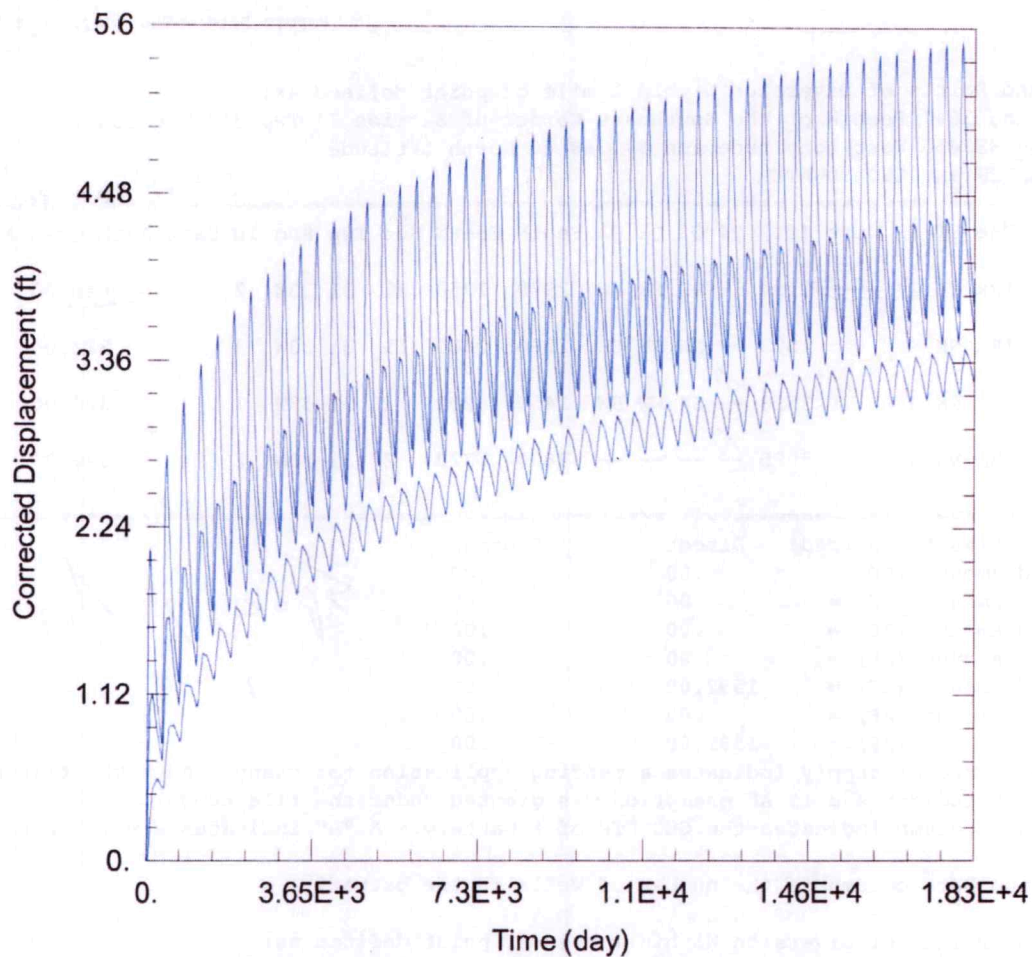

### WELL TEST ANALYSIS

Data Set: C:\Users\trevora\Documents\2022\_moves\16759\16759 Proposed.aqt  
 Date: 06/21/22 Time: 15:06:24

### PROJECT INFORMATION

Company: GMD 3  
 Project: 16759  
 Location: Seward County

### WELL DATA

#### Pumping Wells

Well Name	X (ft)	Y (ft)
16759	-24123	179685

#### Observation Wells

Well Name	X (ft)	Y (ft)
□	-24123	179685
□ 26205	-25471	182913
□ 27275	-21605	184074
□ 23518	-22831	177510

### SOLUTION

Aquifer Model: Unconfined

Solution Method: Theis

T = 7186. ft<sup>2</sup>/day

S = 0.2287

Kz/Kr = 1.

b = 190. ft



Water Rights and Points of Diversion Within 1 mile of point defined as:

3457 Feet N and 3847 Feet W of the Southeast Corner of Section 11 Twp 31S Rng 33W  
 Located at: 100.882450 West Longitude and 37.368480 North Latitude  
 Both SURFACE WATER and GROUNDWATER

*2300' or all*

File Number	Use	ST	SR	Dist (ft)	Q4	Q3	Q2	Q1	FeetN	FeetW	Sec	Twp	Rng	ID	Batt	Auth_Quan	Add_Quan	
A__ AF	16759 00	IRR	NK	G* <i>↔</i> 1194	--	SE	SE	NW	2970	2750	11	31	33W	2		640.00	640.00	
A__ AF	23518 00	IRR	NK	G		2503	--	NW	SW	SE	1280	2600	11	31	33W	3	312.00	312.00
A__ AF	26205 00	IRR	NK	G		3528	--	SW	NW	SW	1450	5200	2	31	33W	1	320.00	320.00
A__ AF	27275 00	IRR	NK	G		5095	--	--	--	--	2600	1320	2	31	33W	2	320.00	320.00

Total Net Quantities Authorized:	Direct	Storage
Total Requested Amount (AF) =	.00	.00
Total Permitted Amount (AF) =	.00	.00
Total Inspected Amount (AF) =	.00	.00
Total Pro_Cert Amount (AF) =	.00	.00
Total Certified Amount (AF) =	1592.00	.00
Total Vested Amount (AF) =	.00	.00
TOTAL AMOUNT (AF) =	1592.00	.00

*Spacing Appears  
not*

An \* after the source of supply indicates a pending application for change under the file number.  
 An \* after the ID indicates a 15 AF exemption was granted under the file number.  
 A "G" in the Batt column indicates the GEO CTR of a battery. A "B" indicates a well in the battery.  
 The number in the Batt column is the number of wells in the battery.

Water Rights and Points of Diversion Within 1 mile of point defined as:

3457 Feet North and 3847 Feet West of the Southeast Corner of Section 11 Twp 31S Rng 33W  
 Located at: 100.882450 West Longitude and 37.368480 North Latitude  
 Both SURFACE WATER and GROUNDWATER  
 WATER USE CORRESPONDENTS:

- > KENT DUNN
- >
- > 25923 ROAD A
- > MOSCOW KS 67952
- >
- > L H & THAIS J BROWN
- >
- > PO BOX 126
- > PLAINS KS 67869
- >
- > JOANN DOWDY FRANZ
- > % JAY HAY AGENT
- > PO BOX 2707
- > LIBERAL KS 67905
- >
- > LARRY DAVIS
- >
- > PO BOX 593
- > SUBLETTE KS 67877
- >

*Application*

*23518*

*26205*

*27275*

Garden City Field Office  
4532 W. Jones, Suite B  
Garden City, KS 67846



Phone: 620-276-2901  
Fax: 620-276-9315  
[www.agriculture.ks.gov](http://www.agriculture.ks.gov)

Mike Beam, Secretary

Laura Kelly, Governor

June 7, 2022

GROUNDWATER MANAGEMENT DISTRICT #3  
2009 E SPRUCE ST  
GARDEN CITY KS 67846

Re: Request for Recommendation,  
File Nos. 16759

Dear Sir or Madam:

We are enclosing a copy of the referenced applications, which was submitted by KENT DUNN and appears to be in proper form, for your review.

We are delaying any further action for a period of 15 days from the date of this letter to allow you time to submit your recommendation concerning this application. Please submit your recommendation within the allotted time, or any authorized extension of time thereof.

If you have any questions, please contact me at (620) 276-2901. If you wish to discuss a specific file, please have the file number ready to that I may help you more efficiently.

Sincerely,

A handwritten signature in blue ink, appearing to read "Hunter Hershey".

Hunter Hershey  
Water Conservation Specialist

Enclosure  
pc:



Garden City Field Office  
4532 W. Jones, Suite B  
Garden City, KS 67846



Phone: 620-276-2901  
Fax: 620-276-9315  
[www.agriculture.ks.gov](http://www.agriculture.ks.gov)

Mike Beam, Secretary

Laura Kelly, Governor

May 23, 2022

BARBARA HANSON  
1036 N PROSPECT AVE  
LIBERAL KS 67901 – 2524

RE: Application for Change  
Water Right, File No. 16759

Dear Sir or Madam:

This is to advise you that KENT DUNN has filed an application for approval of the Chief Engineer, Division of Water Resources, Kansas Department of Agriculture, to change the point of diversion under the above referenced applications. An irrigation well is proposed to be relocated to the NW $\frac{1}{4}$  SE $\frac{1}{4}$  NW $\frac{1}{4}$  of Section 11, Township 31 South, Range 33 West, Seward County.

You can find the complete applications posted by water right file number as referenced above at: [www.Agriculture.ks.gov/DWRNotices](http://www.Agriculture.ks.gov/DWRNotices)

You are notified on this proposed point of diversion (well) so that you may furnish this office with any comments or other information you want to submit. Such comments or other information must be received in this office within 15 days from the date of this letter.

Should you have any questions, please feel free contact this office. If you would prefer, you could arrange an appointment for additional assistance. Please refer to the file number when you contact us if you wish to discuss a specific file.

Sincerely,

A handwritten signature in black ink, appearing to read "H. Hershey".

Hunter Hershey  
Water Conservation Specialist

HH:  
enclosures

pc:  
GROUNDWATER MANAGEMENT DISTRICT NO. 3

SCANNED