

Kansas Department of Agriculture
 Division of Water Resources
CHANGE: P/D WORKSHEET

1. File Number: 23018	2. Status Change Date: <i>10-3-2022</i>	3. Change Num: C4	4. Field Office: 4	5. GMD: 3
6. Status: <input checked="" type="checkbox"/> Approved <input type="checkbox"/> Denied by DWR/GMD <input type="checkbox"/> Dismiss by Request/Failure to Return				7. Filing Date of Change: 7/20/2022
8a. Landowner, applicant, WUC New to system <input type="checkbox"/>		Person ID <u>61621</u> Add Seq# _____	8c. Landowner(s) New to system <input type="checkbox"/>	
HENRY SCHMIDT INC Attn: LONNIE R SCHMIDT PRESIDENT 26906 12 ROAD MONTEZUMA, KS 67867				
8b. Landowner(s), New to system <input type="checkbox"/>		Person ID _____ Add Seq# _____	8d. WUC New to system <input type="checkbox"/>	
9. Documents and Enclosure(s): <input checked="" type="checkbox"/> DWR Meter(s) Date to Comply: <u>12/31/2022</u> <input checked="" type="checkbox"/> N & P Date to Comply: <u>3/1/2023</u>				
<input type="checkbox"/> Anti-Reverse Meter <input type="checkbox"/> Meter Seal <input checked="" type="checkbox"/> Check Valve <input checked="" type="checkbox"/> N & P Form <input type="checkbox"/> Water Tube <input type="checkbox"/> Driller Copy <input type="checkbox"/> H & E Letter				
<input type="checkbox"/> Conservation Plan Date Required: _____ Date Approved: _____ Date to Comply: _____				
10. Use Made of Water From: _____ To: _____				
Date Prepared: 9/27/2022 By: MAM Date Entered: _____ By: _____				

File No. **23018** 11. County: GY Basin: ARKANSAS RIVER Stream: Formation Code: 211 Special Use:

12. Points of Diversion										Rate and Quantity							
CHK	MOD	DEL	ENT	PDIV	Qualifier	S	T	R	ID	'N	'W	Comment (AKA Line)	Rate gpm	Quantity af	Rate gpm	Quantity af	Overlap PD Files
MOD	35626				NCNE	35	26	30W	01	3960	1290		935	92	935	92	none
MOD	50121				NCNW	35	26	30W	02	3925	3960		*460	452	*460	452	none
CHK	63985																
CHK	5199																
CHK	63986																
CHK	7362																

13. Storage: Rate _____ NF Quantity _____ ac/ft Additional Rate _____ NF Additional Quantity _____ ac/ft

14. Limitation: _____ af/ at _____ gpm (_____ cfs) when combined with file number(s) _____
 Limitation: _____ af/yr at _____ gpm (_____ cfs) when combined with file number(s) _____

15. 5YR Allocation: Allocation Type _____ Start Year _____ 5 YR Amount _____ Amount Unit _____ Base Acres _____ Comment _____

16. Place of Use										NE¼								NW¼				SW¼				SE¼				Total	Owner	Chg?	Overlap Files
CHK	MOD	DEL	ENT	PUSE	S	T	R	ID		NE ¼	NW ¼	SW ¼	SE ¼	NE ¼	NW ¼	SW ¼	SE ¼	NE ¼	NW ¼	SW ¼	SE ¼	NE ¼	NW ¼	SW ¼	SE ¼								
CHK	38103																																

Base Acres: Year: Minimum Reasonable Quantity:

Comments: *VOLUNTARILY REDUCED DIVERSION RATE FOR PDIV ID 50121, REQUESTED BY OWNER ON OCTOBER 3, 2022 BY EMAIL AND TELEPHONE CONVERSATION.
SEE SPECIAL CONDITION

Garden City Field Office
4532 W. Jones, Suite B
Garden City, KS 67846



Phone: 620-276-2901
Fax: 620-276-9315
www.agriculture.ks.gov

Mike Beam, Secretary

Laura Kelly, Governor

October 3, 2022

HENRY SCHMIDT INC
Attn: LONNIE R SCHMIDT PRESIDENT
26906 12 ROAD
MONTEZUMA, KS 67867

RE: Field Office Application for Change
Water Right, File No. 23018

Dear Sir:

Enclosed is an order executed by the designee of the Chief Engineer, Division of Water Resources, Kansas Department of Agriculture, approving the applications for change under the above referenced file number.

Your attention is directed to the enclosures and to the terms, conditions, and limitations specified in this approval for change. A condition of this approval is that an acceptable water flow meter must be installed on the diversion works authorized under the referenced file number and meet current specifications. Please return the required notification of completion of the diversion works and installation of the required meter as soon as these actions are completed.

Since the order modifies the original document referred to above, it should be recorded with the Register of Deeds as other instruments affecting real estate.

Should you have any questions, please feel free contact this office. If you would prefer, you could arrange an appointment for additional assistance.

Sincerely,

A handwritten signature in blue ink that reads "Michael A. Meyer".

Michael A. Meyer
Water Commissioner

MAM:
enclosures

pc: GMD3

CERTIFICATE OF SERVICE

On this 4th day of October 2022, I hereby certify that the foregoing Approval of Application for Change in Point of Diversion, Water Right, File No. 23,018 dated 3rd day of October 2022 was mailed postage prepaid, first class, US mail to the following:

HENRY SCHMIDT INC
Attn: LONNIE R SCHMIDT PRESIDENT
26906 12 ROAD
MONTEZUMA, KS 67867

Photocopies sent to:

GMD3



Division of Water Resources Staff

Submit completed application to:
 Kansas Department of Agriculture
 Division of Water Resources
 Field Office for your area.

Call for address:

Topeka -- (785) 296-5733
 Stafford -- (620) 234-5311
 Stockton -- (785) 425-6787
 Garden City -- (620) 276-2901
<http://agriculture.ks.gov/dwr>

DWR FIELD OFFICE APPLICATION FOR APPROVAL TO CHANGE THE PLACE OF USE AND/OR THE POINT OF DIVERSION



STATE OF KANSAS

Filing Fee Must Accompany the Application, K.S.A. 82a-708b(b), as amended.
 Fee Schedule is on the third page of this application form.

Paragraph Nos. 1, 2, 3 & 5 must be completed. Complete all other applicable portions. If change in point of diversion is greater than 100 feet, or if place of use will be changed, include a topographic map or detailed plat showing the authorized and proposed point(s) of diversion and/or place of use.

File No. 23018

RECEIVED
 3:10 pm
 JUL 20 2022

1. Application is hereby made for approval of the Chief Engineer to change the (check one or both):

Place of Use Point of Diversion

under the water right which is the subject of this application in accordance with the conditions described below.

The source of supply is: Groundwater Surface water

Garden City Field Office
 Division of Water Resources

2. Name and address of Applicant: Lonnie Schmidt

3. 26902 12 Rd Montezuma, KS 67867

Phone Number: () Email address: _____

Name and address of Water Use Correspondent: Henry Schmidt - Attn: Lonnie Schmidt

26902 12 Rd Montezuma, KS 67867

Phone Number: () Email address: _____

4. The presently authorized place of use is:

Owner of Land ---- NAME: No Change

ADDRESS: _____

(If there is more than one landowner, attach supplemental sheets as necessary.)

Sec.	Twp.	Range	NE¼				NW¼				SW¼				SE¼				TOTAL ACRES		
			NE¼	NW¼	SW¼	SE¼	NE¼	NW¼	SW¼	SE¼	NE¼	NW¼	SW¼	SE¼	NE¼	NW¼	SW¼	SE¼			

5. If this application is for a change in place of use, it is proposed that the place of use be changed to:

Owner of Land ---- NAME: _____

ADDRESS: _____

(If there is more than one landowner, attach supplemental sheets as necessary.)

Sec.	Twp.	Range	NE¼				NW¼				SW¼				SE¼				TOTAL ACRES			
			NE¼	NW¼	SW¼	SE¼	NE¼	NW¼	SW¼	SE¼	NE¼	NW¼	SW¼	SE¼	NE¼	NW¼	SW¼	SE¼				

For Office Use Only: Code _____ Fee \$ 200.00 TR # _____ Receipt Date 7-20-22 Check # 3275

5. **Presently authorized point of diversion:**
 One in the _____ Quarter of the _____ NC Quarter of the _____ NE Quarter
 of Section _____ 35 _____, Township _____ 26 _____ South, Range _____ 30 _____ W,
 in Gray _____ County, Kansas, _____ 3960 _____ feet North _____ 1290 _____ feet West of Southeast corner of section.
 Authorized Rate _____ 935 GPM Authorized Quantity _____ 192 AF Depth of well _____ (feet)
 (DWR use only: Computer ID No. 01 GPS _____ feet North _____ feet West)
 This point will not be changed This point will be changed as follows: No change, point better described with GPS as follows:
Proposed point of diversion: (Complete only if change is requested or if existing point is better described by GPS)
 One in the _____ Quarter of the _____ NC Quarter of the _____ NW Quarter
 of Section _____ 35 _____, Township _____ 26 _____ South, Range _____ 30 _____ W,
 in Gray _____ County, Kansas, _____ 3960 _____ feet North _____ 1290 _____ feet West of Southeast corner of section.
 Proposed Rate _____ 935 GPM Proposed Quantity _____ 92 AF Proposed well depth (feet) _____
 This point is: Additional Well Geo Center List other water rights that will use this point _____

6. **Presently authorized point of diversion:**
 One in the _____ Quarter of the _____ NC Quarter of the _____ NW Quarter
 of Section _____ 35 _____, Township _____ 26 _____ South, Range _____ 30 _____ W,
 in Gray _____ County, Kansas, _____ 3925 _____ feet North _____ 3960 _____ feet West of Southeast corner of section.
 Authorized Rate _____ 795 GPM Authorized Quantity _____ 352 AF Depth of well _____ (feet)
 (DWR use only: Computer ID No. 02 GPS _____ feet North _____ feet West)
 This point will not be changed This point will be changed as follows: No change, point better described with GPS as follows:
Proposed point of diversion: (Complete only if change is requested or if existing point is better described by GPS)
 One in the _____ Quarter of the _____ NC Quarter of the _____ NW Quarter
 of Section _____ 35 _____, Township _____ 26 _____ South, Range _____ 30 _____ W,
 in Gray X _____ County, Kansas, _____ 3925 _____ feet North _____ 3960 _____ feet West of Southeast corner of section.
 Proposed Rate 460 ~~795~~ GPM Proposed Quantity _____ 452 AF Proposed well depth (feet) _____
 This point is: Additional Well Geo Center List other water rights that will use this point _____

** Request to be reduced by Lonnie Schmidt by email dated 10-3-2022. Reduce to 460 GPM
 MWD/awk*

7. The changes herein are desired for the following reasons?
 (please be specific) rearrange authority within water right

8. If a well, is the test hole log attached? Yes No

9. The change(s) (was)(will be) completed by?
Upon Approval

10. If the point of diversion is a well:
 (a) What are you going to do with the old well?
NA
 (b) When will this be done? _____

11. Groundwater Management District recommendation attached?
 Yes No

12. Assisted by CL-GMD3

13a. If the proposed point of diversion will be relocated more than 300 feet but within 2,640 feet of the existing point of diversion, attach a topographic map or aerial photograph. For groundwater sources, show all wells (including domestic) within one-half mile of the proposed point of diversion and the names and mailing addresses of the owners. For surface water sources, show the names and addresses of the landowner(s) one-half mile downstream and one-half mile upstream from your property lines

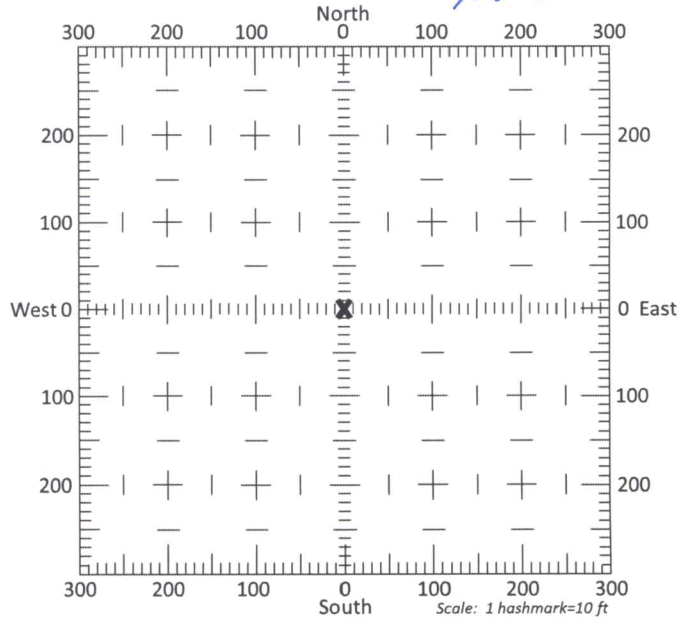

13b. If the proposed point of diversion will be relocated within 300 feet of the existing point of diversion, indicate its location on the diagram shown above in relation to the existing point of diversion. (PLEASE NOTE: The "X" in center of diagram above represents the presently authorized point of diversion.)

APPLICATION FOR APPROVAL TO CHANGE
THE PLACE OF USE AND/OR POINT OF DIVERSION
SUPPLEMENTAL SHEET
FILE NO. 23018

Presently authorized point of diversion:

One in the _____ Quarter of the _____ NC Quarter of the _____ SE Quarter
of Section _____ 35 _____, Township _____ 26 _____ South, Range _____ 30 _____ W,
in Gray _____ County, Kansas, _____ 1310 _____ feet North _____ 1290 _____ feet West of Southeast corner of section.
Authorized Rate _____ 835gpm _____ Authorized Quantity _____ 272AF _____ Depth of well _____ (feet)

(DWR use only: Computer ID No. 04 GPS _____ feet North _____ feet West)

This point will not be changed This point will be changed as follows: No change, point better described with GPS as follows:

Proposed point of diversion: (Complete only if change is requested or if existing point is better described by GPS)

One in the _____ Quarter of the _____ Quarter of the _____ Quarter
of Section _____, Township _____ South, Range _____ (E/W),
in _____ County, Kansas, _____ feet North _____ feet West of Southeast corner of section.
Proposed Rate _____ Proposed Quantity _____ Proposed well depth (feet) _____

This point is: Additional Well Geo Center List other water rights that will use this point _____

Presently authorized point of diversion:

One in the _____ NE Quarter of the _____ SW Quarter of the _____ SW Quarter
of Section _____ 35 _____, Township _____ 26 _____ South, Range _____ 30 _____ W,
in Gray _____ County, Kansas, _____ 1190 _____ feet North _____ 4240 _____ feet West of Southeast corner of section.
Authorized Rate _____ 800gpm _____ Authorized Quantity _____ 272AF _____ Depth of well _____ (feet)

(DWR use only: Computer ID No. 06 GeoCenter GPS _____ feet North _____ feet West)

This point will not be changed This point will be changed as follows: No change, point better described with GPS as follows:

Proposed point of diversion: (Complete only if change is requested or if existing point is better described by GPS)

One in the _____ Quarter of the _____ Quarter of the _____ Quarter
of Section _____, Township _____ South, Range _____ (E/W),
in _____ County, Kansas, _____ feet North _____ feet West of Southeast corner of section.
Proposed Rate _____ Proposed Quantity _____ Proposed well depth (feet) _____

This point is: Additional Well Geo Center List other water rights that will use this point _____

Presently authorized point of diversion:

One in the _____ Quarter of the _____ NC Quarter of the _____ SW Quarter
of Section _____ 35 _____, Township _____ 26 _____ South, Range _____ 30 _____ W,
in Gray _____ County, Kansas, _____ 1330 _____ feet North _____ 3980 _____ feet West of Southeast corner of section.
Authorized Rate _____ 0 _____ Authorized Quantity _____ 0 _____ Depth of well _____ (feet)

(DWR use only: Computer ID No. 03 Batt 1 of 2 GPS _____ feet North _____ feet West)

This point will not be changed This point will be changed as follows: No change, point better described with GPS as follows:

Proposed point of diversion: (Complete only if change is requested or if existing point is better described by GPS)

One in the _____ Quarter of the _____ Quarter of the _____ Quarter
of Section _____, Township _____ South, Range _____ (E/W),
in _____ County, Kansas, _____ feet North _____ feet West of Southeast corner of section.
Proposed Rate _____ Proposed Quantity _____ Proposed well depth (feet) _____

This point is: Additional Well Geo Center List other water rights that will use this point _____

Presently authorized point of diversion:

One in the _____ NE Quarter of the _____ SW Quarter of the _____ SW Quarter
of Section _____ 35 _____, Township _____ 26 _____ South, Range _____ 30 _____ W,
in Gray _____ County, Kansas, _____ 1050 _____ feet North _____ 4500 _____ feet West of Southeast corner of section.
Authorized Rate _____ 0 _____ Authorized Quantity _____ 0 _____ Depth of well _____ (feet)

(DWR use only: Computer ID No. 07 Batt 1 of 2 GPS _____ feet North _____ feet West)

This point will not be changed This point will be changed as follows: No change, point better described with GPS as follows:

Proposed point of diversion: (Complete only if change is requested or if existing point is better described by GPS)

One in the _____ Quarter of the _____ Quarter of the _____ Quarter
of Section _____, Township _____ South, Range _____ (E/W),
in _____ County, Kansas, _____ feet North _____ feet West of Southeast corner of section.
Proposed Rate _____ Proposed Quantity _____ Proposed well depth (feet) _____

This point is: Additional Well Geo Center List other water rights that will use this point _____

14. If the proposed groundwater point of diversion is 300 or fewer feet from the existing point of diversion, complete the following:

- (a) Does the undersigned represent all owners of the currently authorized place(s) of use identified in this application?
 Yes No (If no, all owners must sign this application.)
- (b) Will the ownership interest of any owner of the currently authorized place(s) of use identified in this application be adversely affected if this application is approved as requested?
 Yes No (If yes, all owners must sign this application.)
- (c) If this application is not approved expeditiously, will there be substantial damage to property, public health or safety?
 Yes No (If no, all owners must sign this application.)

If the application proposes a surface water change in point of diversion, a groundwater change in point of diversion greater than 300 feet, or a change in place of use, the application must be signed by all owners of the currently authorized place of use, or their duly authorized agent (attach notarized statement authorizing representation).

I hereby verify, being first duly sworn upon my oath or affirmation and under penalty of perjury, that I am of lawful age and the owner, the spouse of the owner, or a duly authorized agent of the owner(s) to make this application on their behalf, in regards to the water right(s) to which this application pertains. I further verify that the statements contained in this application are true, correct and complete.

Dated at Gm 23 office, Kansas, this 20th day of July, 2022.

Henry Schmidt Trust by Trustee _____ (Owner) _____ (Spouse)
Henry Schmidt Trust _____ (Please Print) _____ (Please Print)

 _____ (Owner) _____ (Spouse)

 _____ (Please Print) _____ (Please Print)

 _____ (Owner) _____ (Spouse)

 _____ (Please Print) _____ (Please Print)

State of Kansas }
County of Finney } SS



I hereby certify that the foregoing application was signed in my presence and sworn to before me this 20th day of July, 2022.

Brandi Sneath
Notary Public

My Commission Expires 11/19/23

ONLY COMPLETE APPLICATIONS WILL BE PROCESSED. To be complete, all of the applicable portions of the application form must be completed with accurate information; maps, if necessary, must be included; signatures of all the appropriate owners' must be affixed to the application and notarized; and the appropriate fee must be paid.

FEE SCHEDULE

Each application to change the place of use or the point of diversion under this section shall be accompanied by the application fee set forth in the schedule below: Make checks payable to: **Kansas Department of Agriculture**

- (1) Application to change a point of diversion 300 feet or less \$100
- (2) Application to change a point of diversion more than 300 feet \$200
- (3) Application to change the place of use \$200

SUMMARY ORDER APPROVING APPLICATION FOR CHANGE AND IMPOSING CONDITIONS

This Summary Order is issued under authority of K.S.A. 82a-708b, as amended, and K.A.R. 5-5-1, *et seq.* and other applicable provisions of the *Kansas Water Appropriation Law, K.S.A. 82a-701 et. seq.*, and rules and regulations promulgated thereunder, With the exception of those conditions expressly contained herein, this Summary Order does not change the terms, conditions and limitations of File No. 23,018

- 1. A change application was received on July 20, 2022 requesting that the place of use and / or point of diversion authorized under the above-referenced file number be changed as described in the application.
- 2. On and after the effective date of this summary order, the authorized place(s) of use shall be located substantially as shown on the topographic map accompanying the application to change the place of use. Applicable Not Applicable
- 3. The change in point of diversion shall not impair existing rights and shall be limited to the same source or sources of water as previously authorized. The point of diversion authorized by this summary order shall be located within a 50 foot radius of the authorized point(s) of diversion. Applicable Not Applicable
- 4. The point(s) of diversion described herein is administratively corrected to be more accurately described using the Global Positioning System (GPS), as described in the application. Applicable Not Applicable
- 5. The point(s) of diversion authorized herein shall not actually be located more than _____ feet from the previously authorized point(s) of diversion. Applicable Not Applicable
- 6. As required by K.A.R. 5-3-5d, if the works for diversion is a well with a diversion rate of 100 gallons per minute or more, a tube or other device suitable for making water level measurements shall be installed, operated and maintained in accordance with K.A.R. 5-6-13. Applicable Not Applicable
- 7. The owner of the authorized place(s) of use shall properly install an acceptable water flow meter on or before December 31, 2023, or before the first use of water, whichever occurs first. The water flow meter shall be installed, operated and maintained in accordance with K.A.R. 5-1-4 through 5-1-12. As required by K.S.A. 82a-732, as amended, and K.A.R. 5-3-5e, the owner shall maintain records and report the reading of the water flow meter and the total quantity of water diverted annually to the Chief Engineer by March 1 following the end of each calendar year. Applicable Not Applicable
- 8. Installation of the works for diversion of water shall be completed on or before December 31, 2023, or within any authorized extension of time. By March 1, 2024 the applicant shall notify the Chief Engineer that construction of the works for diversion has been completed, on the form provided by the Chief Engineer, as required by K.A.R. 5-8-4e. Applicable Not Applicable
- 9. The completed well log shall be submitted with the required notice. Applicable Not Applicable
- 10. All diversion works into which any type of chemical or other foreign substance will be injected into the water shall be equipped with an in-line, automatic, quick-closing check valve capable of preventing pollution of the source of the water supply. The check valve(s) shall be installed, operated and maintained in accordance with K.A.R. 5-3-5c. Applicable Not Applicable
- 11. Additional Conditions are attached. Yes No
- 12. In accordance with K.S.A. 82a-708a, as amended, and K.A.R. 5-5-14, all of the owners of the authorized place(s) of use of water appropriated under the above-referenced file number are responsible for compliance with its terms, conditions and limitations, as amended and/or supplemented by this Summary Order, and with applicable provisions of the *Kansas Water Appropriation Law* and the *Rules and Regulations* promulgated thereunder. Failure to comply with these provisions may result in civil penalties pursuant to K.S.A. 82a-737, as amended, and/or the suspension or revocation and dismissal of the water or appropriation right or any other enforcement actions authorized by law.

Administrative Appeal and Effective Date of Order

If you are aggrieved by this order, pursuant to K.S.A. 82a-1901, you may request an evidentiary hearing before the Chief Engineer or request administrative review by the Secretary of Agriculture. A request for hearing by the Chief Engineer must be filed within **15 days** of service of this Order and a request for administrative review by the Secretary must be filed within **30 days** pursuant to K.S.A. 77-531. Any request for administrative review must state a basis for review pursuant to K.S.A. 77-527. File any request with **Kansas Department of Agriculture, Legal Division, 1320 Research Park Drive, Manhattan, KS 66502**. Failure to timely request a hearing or review may preclude review under the Kansas Judicial Review Act.

For Use by Register of Deeds

FOR OFFICE USE ONLY
APPLICATION APPROVED AND SUMMARY ORDER ISSUED

By: Michael A. Meyer
 Duly Authorized Designee of the Chief Engineer

(Print Name): MICHAEL A. MEYER
 Division of Water Resources - Kansas Department of Agriculture

Date of Issuance: October 3, 2022

State of Kansas)
) SS

County of Stimney)

Acknowledged before me on October 3, 2022
 by Michael A. Meyer

Signature: Julie Jones
 Notary Public

My commission expires _____
 JULIE JONES
 My Appointment Expires
 (Notary Seal) December 15, 2022

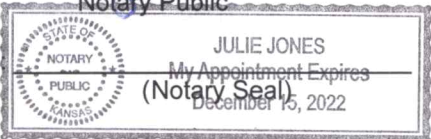

Change App. PD, File No. 23018

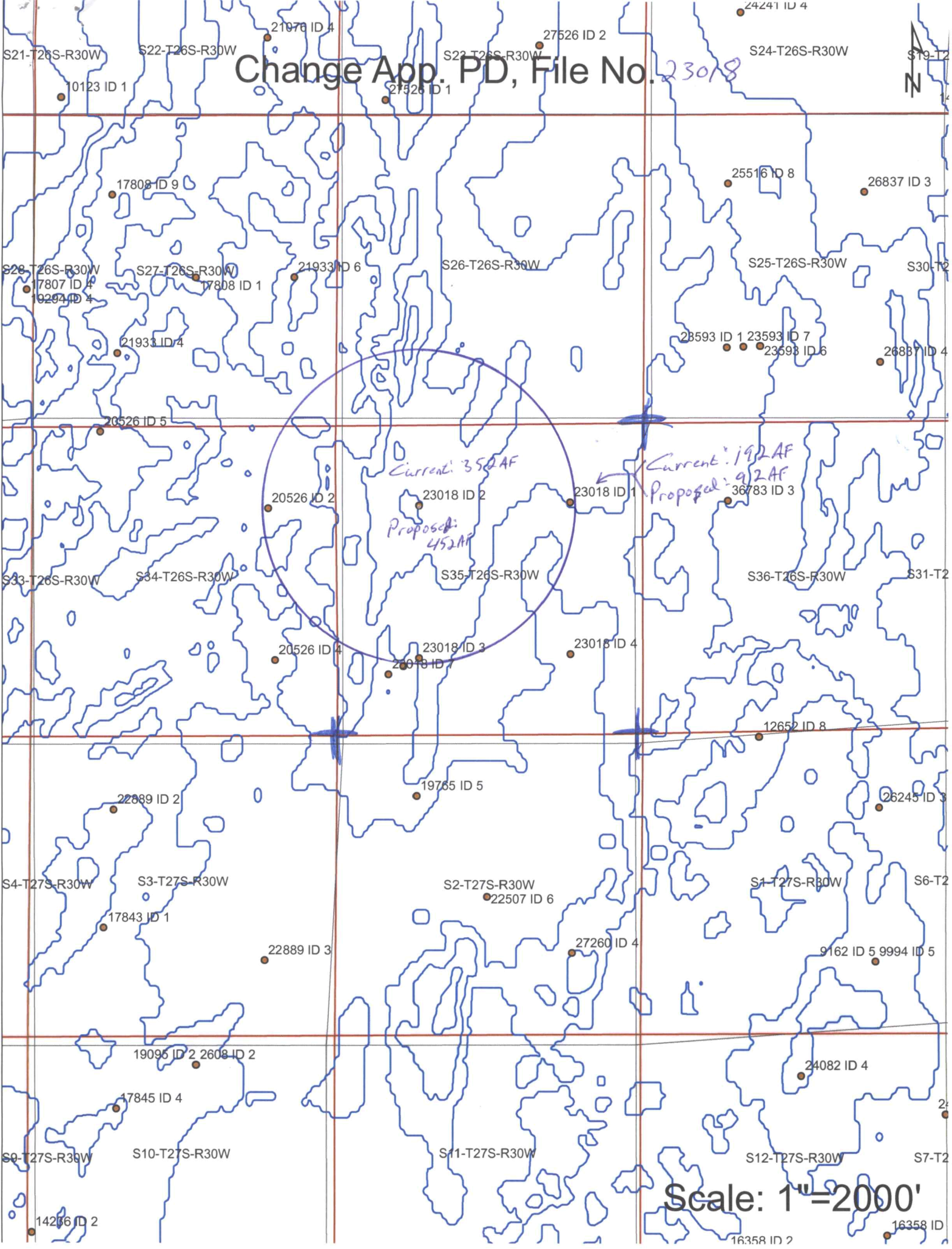

Current: 352 AF
Proposed: 452 AF

Current: 192 AF
Proposed: 92 AF

36783 ID 3

Scale: 1"=2000'

#23018

Meyer, Mike [KDA]

From: Lonnie Schmidt <lrschmidt64@gmail.com>
Sent: Monday, October 3, 2022 3:56 PM
To: Meyer, Mike [KDA]
Subject: Re: FW: water rights

EXTERNAL: This email originated from outside of the organization. Do not click any links or open any attachments unless you trust the sender and know the content is safe.

I request and agree to reduce the authorized diversion rate to 460 GPM for the NW quarter of section 35-26-30. Lonnie Schmidt
Trustee

On Mon, Oct 3, 2022 at 3:35 PM Meyer, Mike [KDA] <Mike.Meyer@ks.gov> wrote:

(Lonnie I sent this right at 8, but noticed I had your email wrong). Sorry

Lonnie,

In order to approve the application pending to move quantity to the Northwest Quarter (NW¼) well (from the Northeast Quarter (NE¼) well, to limit effects to nearby wells, it would be required to reduce the total authorized diversion rate at 460 GPM legally.

It you agree, please respond stating that you request and agree to reduce the authorized diversion rate to 460 GPM for the Northwest Quarter (NW¼) of Section 35-26-30 West.

The proposed quantity of 452 acre feet will remain as proposed.

Thank you

Michael A. Meyer, PG
Kansas Department of Agriculture
Division of Water Resources
Garden City Field Office
4532 [W Jones Ave, Suite B](#)
[Garden City KS 67846](#)

RECEIVED

OCT 03 2022

Garden City Field Office
Division of Water Resources

Lat 37.98820, Lon -100.944470

(620)-276-2901

mike.meyer@ks.gov

Meyer, Mike [KDA]

Subject: FW: 23018
Attachments: Theis_23018.pdf

Mike

From: Engelhaupt, David [KDA] <David.Engelhaupt@ks.gov>
Sent: Monday, September 26, 2022 3:42 PM
To: Meyer, Mike [KDA] <Mike.Meyer@ks.gov>
Cc: Thurlow, Steven [KDA] <Steven.Thurlow@ks.gov>
Subject: RE: 23018

Mike,

See attached report that Steven put together. It was ran as if the receiving PD is simply increasing authorized by 100 AF. This makes sense because the donating PD isn't using anywhere near it's authorized, so the water being moved is "paper water". The result is that it fails the test as proposed, but would pass if reduced to 457 GPM. That rate would be applicable to the additional 100 AF, not the quantity already authorized by the receiving PD. How you want to handle that from the water right side, or if you even want to mess with it, I'll leave to you.

David Engelhaupt, P.E.
Technical Services Supervisor
Kansas Department of Agriculture
Division of Water Resources
(785) 564-6680

Meyer, Mike [KDA]

From: Meyer, Mike [KDA]
Sent: Friday, July 22, 2022 12:27 PM
To: Garrett Love
Subject: near by change application proposal
Attachments: 20220722120107919.pdf

Garrett, sending this email, rather than letter, Lonnie Schmidt to the east of the bob husband well you purchased on 34-26-30W, Lonnie is proposing to move an additional 100 AF from his east well on section 35 to the west well (NW quarter). your well is within half mile, so I am notifying you of this proposal for any comments etc. again, rather than a letter Attached is the application for your review.

Let me know of any concerns or comments the next 15 days.

GMD3 will be doing their well evaluation.

Thanks, and stay cool

Michael A. Meyer, PG
Kansas Department of Agriculture
Division of Water Resources
Garden City Field Office
4532 W Jones Ave, Suite B
Garden City KS 67846
Lat 37.98820, Lon -100.944470
(620)-276-2901
mike.meyer@ks.gov

S. Thurlow
9/26/2022

This evaluation of proposed change in point of diversion, File No. 23018

A 50-year Theis analysis was used to evaluate the potential increase in dynamic drawdown as a result of the proposed reallocation of 100 AF currently authorized by File No. 23018 ID1 to the well currently authorized by File No. 23018 ID2. The change proposes reallocating the authorized quantity approximately 35 feet South and 2,670 feet West of the currently authorized location (Figure 1).

The GMD No. 3 groundwater model was used for a projected future (2068) saturated thickness (59.7 ft). The average of model cells located within Township 26 South, Range 30 West, Sections 25, 26, 27, 34, 35, 36, and Township 27 South, Range 30 West, Sections 2, 3 was used.

The transmissivity was estimated based on lithological logs from the Kansas Geological Survey's Water Well Completion Records Database (WWC5). WWC5 records within 1 mile of the proposed point of diversion were used. Records that were within that area, but did not include lithological data, were not drilled to bed rock, or had poor lithological descriptions were excluded. Hydraulic conductivity assumptions were based on the calibrated values used for the GMD No. 3 groundwater model (Figures 2 and 3). In all, eight lithological logs were evaluated (Figure 4-5, Tables 1-8), with an average transmissivity of 1,559 square feet per day. An assumed specific storage of 1×10^{-5} and the projected saturated thickness was used to determine the assumed storativity of 0.000597.

Drawdown was evaluated at 2 nearby existing wells authorized by File Nos. 20526-D5 and 23018 ID6 and 1 domestic well in section 27S-30W-02 (Tables 9-12). A quantity of 452 acre-feet (AF) at a rate of 795 gallons per minute (gpm) was compared to the average historic use (216.8 AF, 2012-2021) at the most recent pumping rate (375 gpm). The maximum net drawdown occurred at the point of diversion authorized by File No. 20526-D5. The net drawdown at that distance was 25.5 feet, or 42.7% of the projected future saturated thickness (Table 11). If the proposed rate is limited to 457 gallons per minute, the increase in drawdown will be limited to 11.9 feet, or 20.0% of the projected saturated thickness (Table 12).

RECEIVED

SEP 26 2022

Garden City Field Office
Division of Water Resources

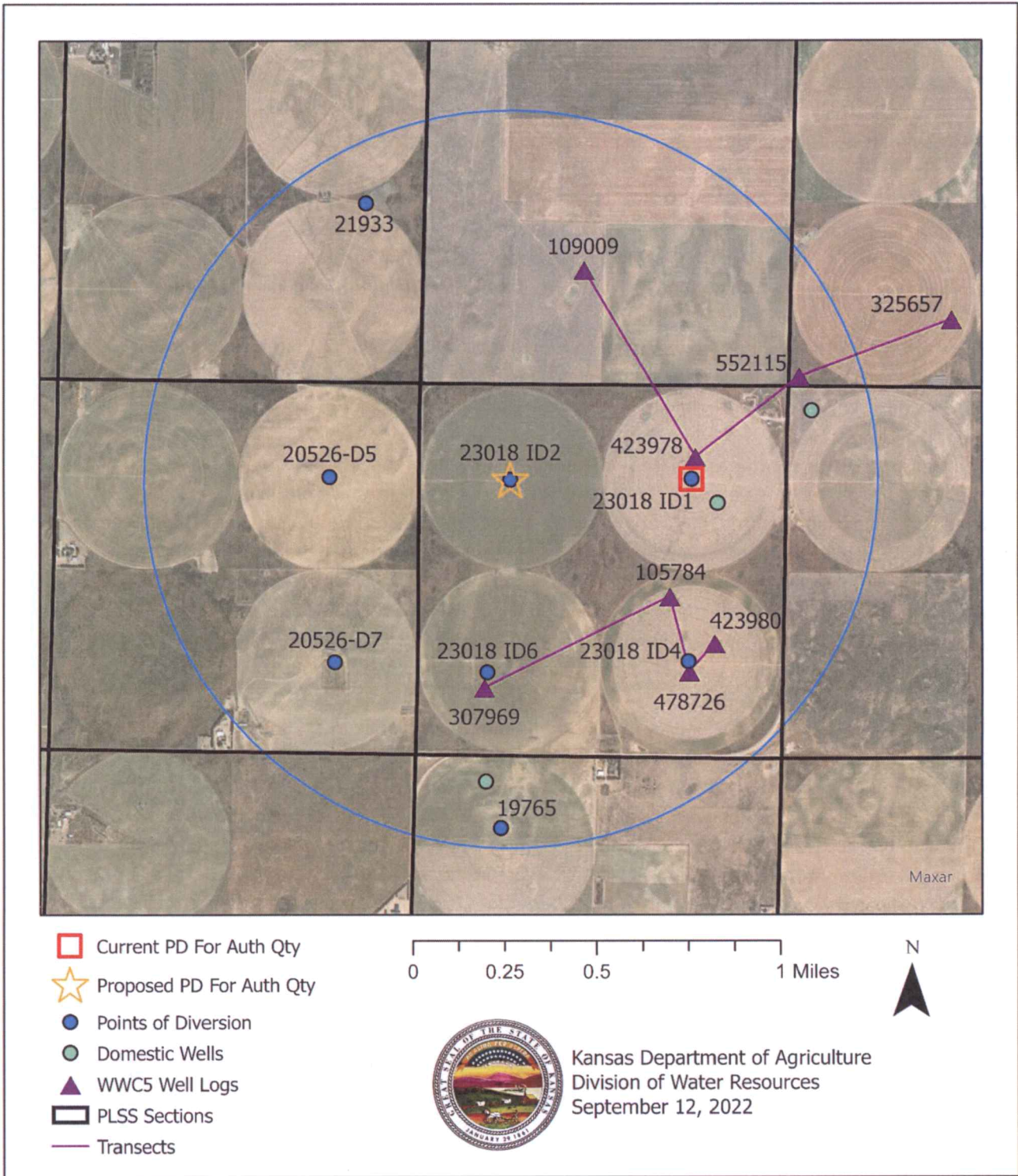

Figure 1: Location of current and proposed point of diversion, surrounding points of diversion, and WWC5 records

Table 1. PST+ synonymy codes and lithology descriptions.

Synonymy	Lithology	Synonymy	Lithology	Synonymy	Lithology
sh	Shale	sc	Sandy Clay or Silty Sand	fsnd	Fine Sand
c	Clay	fds	Fine Sandy Silt	fmgnd	Fine to Medium Sand
coal	Coal	fmnds	Fine to Medium Sandy Silt	fmsnd	Fine to Medium Sand
br	Bedrock	fcrsds	Fine to Coarse Sandy Silt	snd	Sand
rb	Red Bed	ds	Sandy Silt	fcrrsnd	Fine to Coarse Sand
r	Rock	mnds	Medium Sandy Silt	msnd	Medium Sand
sst	Siltstone	gc	Gravelly Clay	mcrssnd	Medium to Coarse Sand
ca	Limestone/caliche	mcrsds	Medium to Coarse Sandy Silt	cg	Clayey Gravel
o	Overburden	crsds	Coarse Sandy Silt	crssnd	Coarse Sand
ts	Topsoil	cesd-cg	Cemented Sand and/or Gravel	sg	Silty Gravel
fs	Fine Silt	fss	Fine Silty Sand	fsdg	Fine Sand and Gravel
fsc	Fine Sandy Clay	fmss	Fine to Medium Silty Sand	fmsdg	Fine to Medium Sand and Gravel
fmsc	Fine to Medium Sandy Clay	ss	Silty Sand	msdg	Medium Sand and Gravel
m	Marl or Ochre	mss	Medium Silty Sand	sdg	Sand and Gravel
msc	Medium Sandy Clay	fcrrss	Fine to Coarse Silty Sand	fcrrsdg	Fine to Coarse Sand and Gravel
s	Silt	mcrsss	Medium to Coarse Silty Sand	mcrssdg	Medium to Coarse Sand and Gravel
crssc	Coarse Sandy Clay	crsss	Coarse Silty Sand	crssdg	Coarse Sand and Gravel
fcrrssc	Fine to Coarse Sandy Clay	u	Unknown (most likely unintelligible)	fg	Fine Gravel
mcrssc	Medium to Coarse Sandy Clay			fmg	Fine to Medium Gravel
				fcrg	Fine to Coarse Gravel
				fcrrsg	Fine to Coarse Gravel
				g	Gravel
				mg	Medium Gravel
				mcrsg	Medium to Coarse Gravel
				crsg	Coarse Gravel

Figure 2: Synonymy codes and lithology descriptions. Source: KGS OFR 2010-18

Table 6. The calibrated values for PST+ synonymy lithologies.

Synonymy	K	Sy	Synonymy	K (ft/d)	Sy	Synonymy	K (ft/d)	Sy
sh	0.00004	0.05	sc	4.4	0.08	fsnd	15	0.24
c	0.00004	0.05	fds	4.4	0.08	fmgnd	15	0.24
coal	0.00004	0.05	fmnds	4.4	0.08	fmsnd	15	0.24
br	0.00004	0.05	fcrsds	4.4	0.08	snd	63	0.24
rb	0.00004	0.05	ds	4.4	0.08	fcrrsnd	63	0.24
r	0.00004	0.05	mnds	4.4	0.08	msnd	63	0.24
sst	0.00004	0.05	gc	4.4	0.08	mcrssnd	63	0.24
ca	0.0001	0.08	mcrsds	4.4	0.08	cg	63	0.24
o	0.0001	0.08	crsds	4.4	0.08	crssnd	63	0.29
ts	0.0001	0.08	cesd-cg	14.5	0.16	sg	63	0.29
fs	0.0001	0.08	fss	14.5	0.16	fsdg	299	0.29
fsc	0.0001	0.08	fmss	14.5	0.16	fmsdg	299	0.29
fmsc	0.0001	0.08	ss	14.5	0.16	msdg	299	0.29
m	0.0001	0.08	mss	14.5	0.16	sdg	299	0.29
msc	0.0001	0.08	fcrrss	14.5	0.16	fcrrsdg	299	0.29
s	0.0001	0.08	mcrsss	14.5	0.16	mcrssdg	299	0.29
crssc	0.0001	0.08	crsss	14.5	0.16	crssdg	299	0.29
fcrrssc	0.0001	0.08	u	14.5	0.16	fg	299	0.29
mcrssc	0.0001	0.08				fmg	299	0.29
						fcrg	299	0.29
						fcrrsg	299	0.29
						g	299	0.29
						mg	299	0.29
						mcrsg	299	0.29
						crsg	299	0.29

Figure 3: Calibrated hydraulic conductivity values. Source: KGS OFR 2010-18

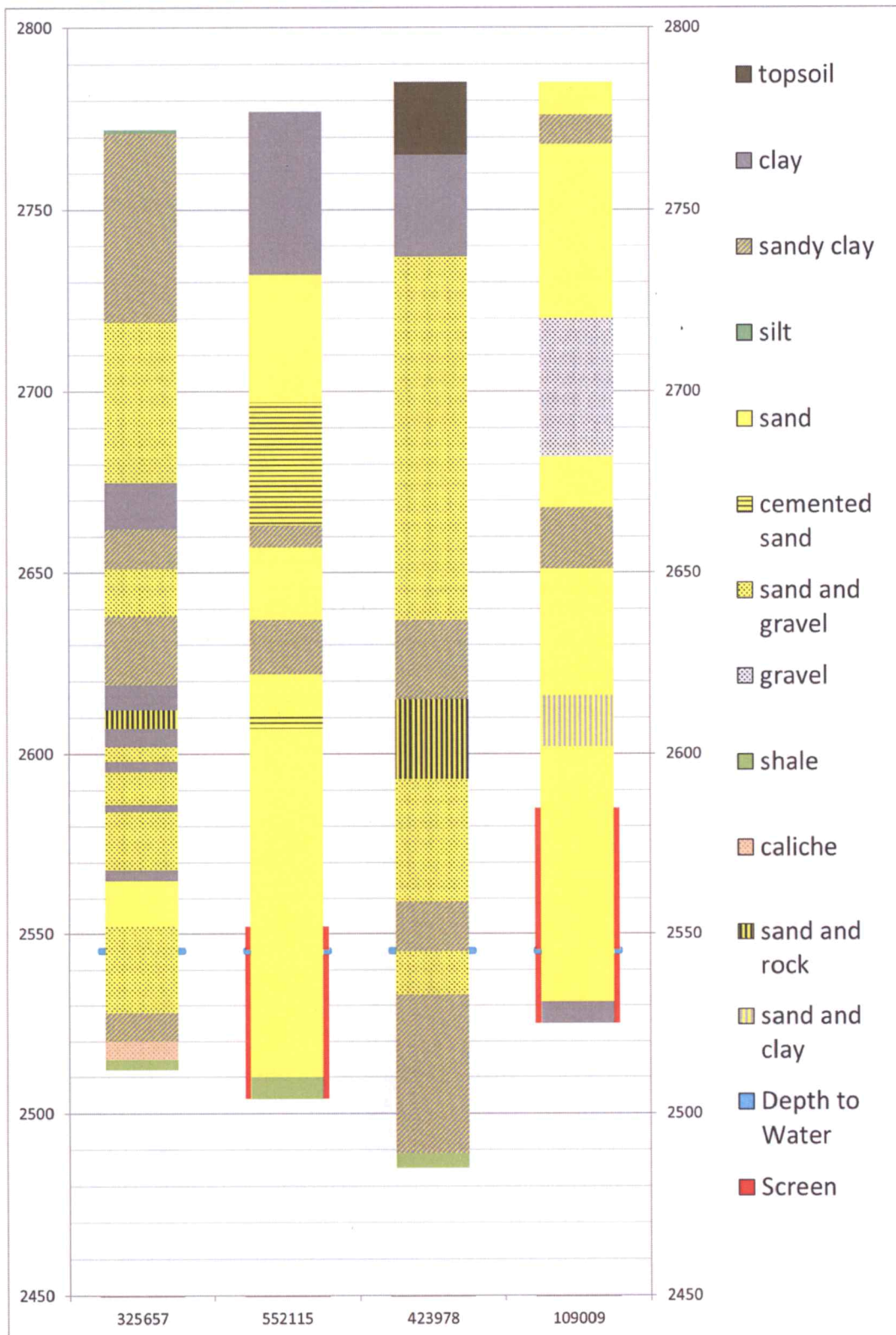

Figure 4: lithology log of KGS Wells on North transect line

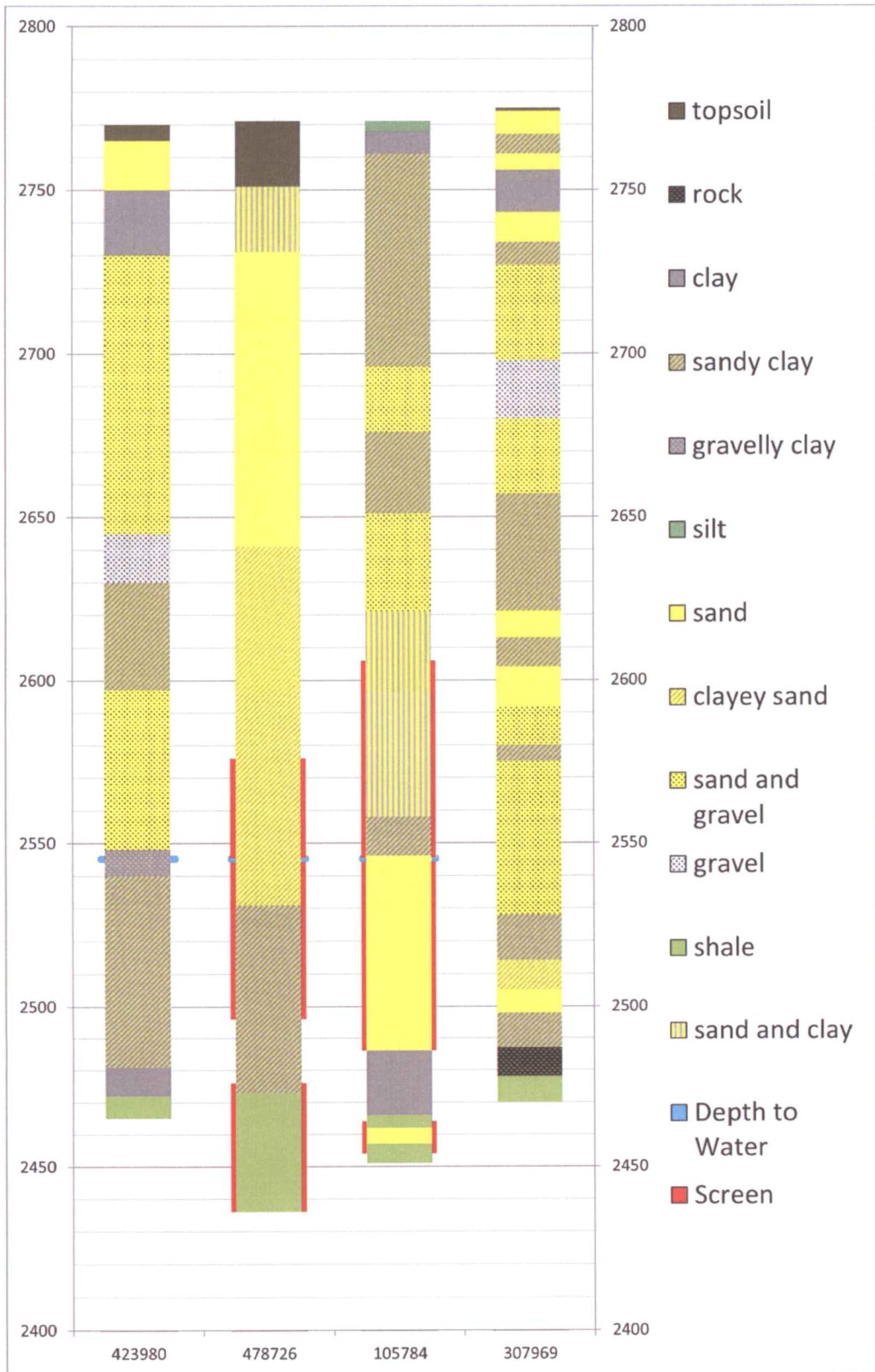

Figure 5: lithology log of KGS Wells on South transect line

Table 1: Lithology, KGS Well ID 325657

Driller's Description	Synonymy Codes	Percentages	Saturated Thickness (Feet)	Transmissivity (feet ² /day)
silt	Above water surface			
sandy clay fine sand				
fine sand				
sandy clay caliche sand				
sand very fine gravel fine gravel				
sand gravel rock				
sand fine gravel clay				
clay				
sandy clay fine sand medium sand				
sand fine gravel				
sandy clay limestone sandstone				
clay limestone sand				
sand rock				
clay				
sand fine gravel clay				
clay				
sand fine gravel rock				
clay				
sand fine gravel rock				
clay				
fine sand sandy clay				
sand fine gravel rock	snd, fg, r	50, 30, 20	17	2060.4
sandy clay	sc	100	8	35.2
caliche limestone	ca	100	5	0.0
shale	sh	100	3	0.0
Total Transmissivity:				2095.6

Table 2: Lithology, KGS Well ID 552115

Driller's Description	Synonymy Codes	Percentages	Saturated Thickness (Feet)	Transmissivity (feet ² /day)
brown clay				
coarse sand				
cemented sand				
brown sandy clay				
medium sand				
brown sandy clay				
coarse sand				
medium sand				
cemented sand				
medium sand and brown sandy clay				
medium sand	msnd	100	35	2205.0
shale	sh	100	6	0.0
Total Transmissivity:				2205.0

Table 3: Lithology, KGS Well ID 423978

Driller's Description	Synonymy Codes	Percentages	Saturated Thickness (Feet)	Transmissivity (feet ² /day)
topsoil and fine sand				
clay				
fine medium sand and coarse gravel (loose)				
fine medium sand and gravel 20% clay				
fine medium sand and gravel (loose)				
sandy clay				
fine medium sand with white rock 10% clay				
fine to medium sand and gravel (loose)				
sandy clay				
fine medium sand and gravel (loose)	fmsnd, g	60, 40	12	1543.2
sandy clay	sc	100	44	193.6
shale	sh	100	4	0.0
Total Transmissivity:				1736.8

Table 4: Lithology, KGS Well ID 109009

Driller's Description	Synonymy Codes	Percentages	Saturated Thickness (Feet)	Transmissivity (feet ² /day)
sand			Above water surface	
sandy clay				
sand				
gravel				
tight sand				
sandy clay/clay				
sand				
sand/clay streaks				
sand	snd	100	14	882.0
clay	c	100	6	0.0
Total Transmissivity:				882.0

Table 5: Lithology, KGS Well ID 423980

Driller's Description	Synonymy Codes	Percentages	Saturated Thickness (Feet)	Transmissivity (feet ² /day)
topsoil			Above water surface	
fine sand				
brown clay				
medium sand and coarse gravel (loose)				
fine to medium sand and gravel with streaks of brown clay				
medium sand and gravel (loose)				
medium coarse gravel (loose)				
brown sandy clay				
fine to medium sand and gravel (loose)				
brown clay with streaks of gravel (hard)	c, g	80, 20	5	299.0
brown sandy clay	sc	100	59	259.6
brown clay with yellow clay (hard)	c	100	9	0.0
shale	sh	100	7	0.0
Total Transmissivity:				558.6

Table 6: Lithology, KGS Well ID 478726

Driller's Description	Synonymy Codes	Percentages	Saturated Thickness (Feet)	Transmissivity (feet ² /day)
top soil and sandy clay	Above water surface			
streaks clay and fine sand				
med. sand and layers coarse sand				
fine and med sand with streaks clay	fmsnd, c	80, 20	14	168.0
clay with streaks fine sand	c, fsnd	80, 20	58	174.0
shale with streaks brown rock	sh, r	100	37	0.0
Total Transmissivity:				342.0

Table 7: Lithology, KGS Well ID 105784

Driller's Description	Synonymy Codes	Percentages	Saturated Thickness (Feet)	Transmissivity (feet ² /day)
silt	Above water surface			
clay				
sandy clay and fine sand				
fine sand, medium sand, and caliche				
fine sand, medium sand, and caliche				
coarse sand, gravel, and clay				
sandy clay, caliche, and sand				
sand and gravel, clay, and caliche				
clay and sand				
sand and clay				
sand and clay				
clay, sandy clay, and sand				
sand and sandy clay	snd, sc	60, 40	15	593.4
sand and sandy clay	snd, sc	60, 40	44	1740.64
clay, caliche, and sand	c, ca, snd	50, 30, 20	20	252.0
shale and sandstone	sh, ds	60, 40	4	7.0
fine sand and shale	fsnd, sh	60, 40	5	45.0
shale and sandstone	sh, ds	60, 40	6	10.6
Total Transmissivity:				2648.6

Table 8: Lithology, KGS Well ID 307969

Driller's Description	Synonymy Codes	Percentages	Saturated Thickness (Feet)	Transmissivity (feet ² /day)
top soil				
fine sand – loose				
brown sandy clay				
fine sand – loose				
brown clay				
fine sand – loose				
brown sandy clay				
fine to medium sand and gravel				
medium coarse gravel				
fine to medium sand and gravel				
brown sandy clay				
fine to medium sand				
brown sandy clay				
fine to medium sand				
fine to medium sand and gravel				
brown sandy clay				
fine to medium sand and gravel – small clay streak	fmsnd, g, c	60, 30, 10	10	987
fine to medium sand and gravel – 10% clay	fmsnd, g, c	60, 30, 10	7	690.9
brown sandy clay	sc	100	14	61.6
fine sand – clay streak	fsnd, c	80, 20	9	108.0
fine to medium sand	fmsnd	100	7	105.0
brown sandy clay	sc	100	11	48.4
yellow white rock – hard pull down 300 to 900	r	100	9	0.0
shale	sh	100	8	0.0
Total Transmissivity:				2000.9

Table 9: This drawdown evaluated at Domestic Well at 27S-30W-02 ; T = 1,559 ft²/day, S = 0.000597

Scenario	Distance (FT)	Pump Rate (GPM)	Volume (AF)	Drawdown (FT)	Drawdown (%ST)
Proposed	4343.9	795	452	40.5	67.9%
Baseline	4343.9	375	216.8	19.3	32.3%
			Net:	21.2	35.6%

Table 10: This drawdown evaluated at File No. 23018-ID6; T = 1,559 ft²/day, S = 0.000597

Scenario	Distance (FT)	Pump Rate (GPM)	Volume (AF)	Drawdown (FT)	Drawdown (%ST)
Proposed	2778.5	795.0	452.0	47.5	79.5%
Baseline	2778.5	375.0	216.8	22.5	37.8%
			Net:	25.0	41.8%

Table 11: This drawdown evaluated at File No. 20526-D5; T = 1,559 ft²/day, S = 0.000597

Scenario	Distance (FT)	Pump Rate (GPM)	Volume (AF)	Drawdown (FT)	Drawdown (%ST)
Proposed	2607.7	795.0	452.0	48.5	81.2%
Baseline	2607.7	375.0	216.8	23.0	38.5%
			Net:	25.5	42.7%

Table 12: This drawdown evaluated at File 20526-D5; T = 1,559 ft²/day, S = 0.000597; Rate = 457 GPM

Scenario	Distance (FT)	Pump Rate (GPM)	Volume (AF)	Drawdown (FT)	Drawdown (%ST)
Proposed	2607.7	461.0	452.0	34.9	58.5%
Baseline	2607.7	375.0	216.8	23.0	38.5%
			Net:	11.9	20.0%

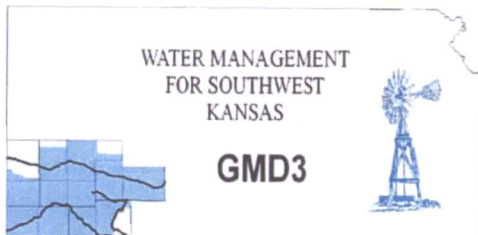

Southwest Kansas
Groundwater Management District No. 3
2009 E. Spruce Street
Garden City, Kansas 67846
(620) 275-7147 phone
www.gmd3.org

August 12, 2022

Mike A Meyer
Division of Water Resources
4532 W Jones Ave., Suite B
Garden City, Kansas 67846

RE: Application for Change in Point of Diversion
Water Right, File No. 23018

Dear Mike:

We have completed a review of the application for the above referenced water right. The proposed change in point of diversion is in accordance with current area rules, K.A.R. 5-23-3, as it pertains to minimum spacing to neighboring wells and distance moved.

Well evaluations were conducted to estimate possible effects of the proposal on the supply of other wells with water rights prior to the proposal per K.S.A. 82a-708b, and our management program. Under K.S.A. 82a-708b, an applicant requesting a change in point of diversion must demonstrate to the chief engineer that any proposed change is reasonable and will not impair. The enclosed report is an analysis performed by the GMD on behalf of our membership. Under this analysis, the proposed change is considered to be reasonable and unlikely to impair if either the net in-season well-to-well effect of the proposed change is less than a strict maximum allowable threshold (2.0 ft on the sections saturated thickness ranging 75-100 ft), or if no well with a net well-to-well effect exceeding the threshold is identified as critical. Critical wells are identified as wells that are expected to either lose or greatly diminish water supply over the next 25 years. The attached review information is based on a Theis analysis using inputs from the GMD3 aquifer model, which is considered to be the best information on well and aquifer data readily and easily available to the public. If either the applicant or the neighbors believe they have better data that might change the result of the analysis, they should contact GMD3. Conclusions of the well analysis may change if better information on well and aquifer data can be made available.

Every neighboring well within 1 mile of the proposed move was evaluated. Evaluations showed that several of the neighboring wells exceeded the net effect above the maximum allowable threshold and needed further evaluation. There could be the potential for critical wells in the area, if the well is pumped at full authority. The evaluations from our data showed that the effects could be mitigated with limitations to the proposed well. We did not receive any written comments from neighbor notices. Therefore, GMD3 sees this move as meeting current rules and would recommend approval with possible limitations or better information given to ensure that neighboring wells are not adversely affected. If aquifer conditions change or there is a change to the water right in the future, we would be happy to evaluate the effects at that time.

Thank you for the opportunity to review the applications and to provide a recommendation. If you have any questions, please don't hesitate to contact us.

Sincerely,

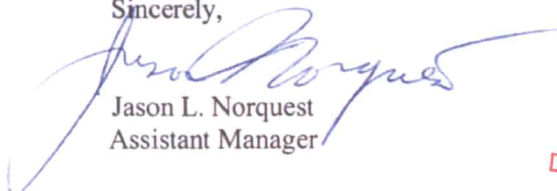
Jason L. Norquest
Assistant Manager

RECEIVED

AUG 15 2022

Garden City Field Office
Division of Water Resources

GMD3 Change Review

File No(s): 23018 . DWR office: GC.

App filed to change: PD (reallocation between PDs).

Is Landowner(s) correct in WRIS: Lonnie Schmidt.

If NO, is documentation included?

Is Water Use Correspondent correct in WRIS? .

If NO, is documentation included?

Regulation(s) Reviewed: KAR 5-23-3

Point of diversion ID No(s) being changed.

	ft. North	ft. West	
Authorized PD	3960	1290	Sect 35-26-30
Proposed PD	3925	3960	
Difference	35	-2670	
$a^2 + b^2 = c^2$	1225	7128900	2670.229

GPS for proposed PD: Lat: Long: .

Is proposed PD stacking on existing WRs? No, reallocation between ID01 to ID02.

Is Proposed PU overlapping existing WRs? No Change.

Neighboring certified well(s) notified: .

Name Ray Allen Smith & possible domestic (19765).

Address 5505 S RD.

Zip Ingalls, KS 67853.

Email: reysmith96@gmail.com Phone: 620-521-2982.

Name Bob Husband NEW OWNER NOW? (20526D5).

Address .

Zip .

Email: Phone: .

Name Clark & Annette Isaac & possible domestic (20526D7).

Address 4502 S RD.

Zip Ingalls, KS 67853.

Email: clarkisaac586@gmail.com Phone: 620-521-274.

Name Lloyd Schmidt (21933).

Address 4105 Q RD.

Zip Ingalls, KS 67853.

Email: lpschmidt@ucom.net Phone: 620-335-5431.

Name Love Land & Cattle Inc (36783).

Address 21506 12 RD.

Zip Montezuma, KS 67867.

GMD3 Change Review

Email: garrett.t.love@gmail.com

Phone: [620-846-223](tel:620-846-223) .

Domestic well(s) notified: ___.

Name ___.

Address ___.

Zip ___.

Base Acres: ___.

Perfected Acres: ___.

Irr. Return-Flow ___%

Gray County

Proposing to reallocate 100aF from ID01 (NE) to ID02 (NW)

ID02: would have 452AF

ID012 would drop to 92AF

Is a waiver needed: This move has been done before prior to this application.

Minimum spacing is still met. Analysis shows that there could be critical wells in the area due to low saturated thickness.

Recommendation: After review of all available information, it appears current area rules are met. Due to the possibility of critical wells, staff would recommend approval after verification of no concern to neighboring wells or better information provided.



RECEIVED

AUG 15 2022

**Garden City Field Office
Division of Water Resources**

Water Rights and Points of Diversion Within 1 mile of point defined as:
 3925 Feet N and 3960 Feet W of the Southeast Corner of Section 35 Twp 26S Rng 30W
 Located at: 100.574809 West Longitude and 37.747496 North Latitude
 Both SURFACE WATER and GROUNDWATER

File Number	Use	ST	SR	Dist (ft)	Q4	Q3	Q2	Q1	FeetN	FeetW	Sec	Twp	Rng	ID	Batt	Auth_Quan	Add_Quan
A__ AF	19765 00	IRR	NK	G	4860	--	--	NC NW	4275	3950	2	27	30W	5		304.00	304.00
A__ AF	20526 D5	IRR	NK	G	2600	--	--	NC NE	3940	1300	34	26	30W	2		272.00	272.00
A__ AF	20526 D7	IRR	NK	G	3616	--	--	NC SE	1330	1180	34	26	30W	4		272.00	272.00
A__ AF	21933 00	IRR	NK	G	4490	--	--	NW NE SE	2582	829	27	26	30W	6		272.00	272.00
A__ AF	23018 00	IRR	NK	G	3	--	--	NC NW	3925	3960	35	26	30W	2		352.00 462	352.00
Same AF					2599	--	--	NC SW	1330	3980	35	26	30W	3	B2	.00	.00
Same AF					2663	--	--	NC NE	3960	1290	35	26	30W	1		192.00 92	192.00
Same AF					2752	--	--	NE SW SW	1190	4240	35	26	30W	6	G2	272.00	272.00
Same AF					2927	--	--	NE SW SW	1050	4500	35	26	30W	7	B2	.00	.00
Same AF					3733	--	--	NC SE	1310	1290	35	26	30W	4		272.00	272.00
A__ AF	36783 00	IRR	NK	G	5267	--	--	NC NW	3980	3960	36	26	30W	3		204.00	204.00

Total Net Quantities Authorized:	Direct	Storage
Total Requested Amount (AF) =	.00	.00
Total Permitted Amount (AF) =	.00	.00
Total Inspected Amount (AF) =	.00	.00
Total Pro_Cert Amount (AF) =	.00	.00
Total Certified Amount (AF) =	2412.00	.00
Total Vested Amount (AF) =	.00	.00
TOTAL AMOUNT (AF) =	2412.00	.00

Minimum Spacing
MET

An * after the source of supply indicates a pending application for change under the file number.
 An * after the ID indicates a 15 AF exemption was granted under the file number.
 A "G" in the Batt column indicates the GEO CTR of a battery. A "B" indicates a well in the battery.
 The number in the Batt column is the number of wells in the battery.

Water Rights and Points of Diversion Within 1 mile of point defined as:
 3925 Feet North and 3960 Feet West of the Southeast Corner of Section 35 Twp 26S Rng 30W
 Located at: 100.574809 West Longitude and 37.747496 North Latitude
 Both SURFACE WATER and GROUNDWATER
 WATER USE CORRESPONDENTS:

- > File Number Use ST SR
- > RAY ALLEN SMITH
- >
- > 5505 S RD
- > INGALLS KS 67853
- >-----
- > BOB HUSBAND
- >
- > 11565 E PLYMELL RD
- > PIERCEVILLE KS 67868
- >-----
- > CLARK & ANNETTE ISAAC

19765

20526 D5

20526 D7

>
> 4502 S RD
> INGALLS KS 67853

> LLOYD SCHMIDT
>
> 4105 Q RD
> INGALLS KS 67853

21933

> HENRY SCHMIDT
> LONNIE R SCHMIDT
> 26902 12 ROAD
> MONTEZUMA KS 67867

Applicant

> LOVE LAND & CATTLE LLC
>
> 21506 12 RD
> MONTEZUMA KS 67867

36783

=====

Evaluation of proposed move for Water Right No. 23018

Proposed: Move 100 AF currently authorized under water right no. 23018 ID1 to the well currently authorized under water right no. 23018 ID2.

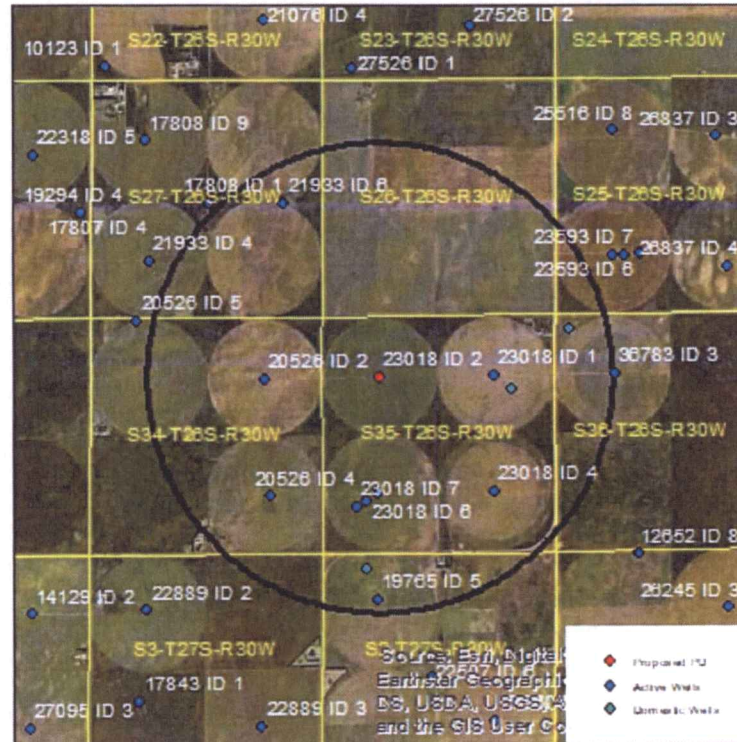

Wells within 1 mile: 23018 ID1, 23018 ID4, 23018 ID6, 21933, 20526 ID2, 20526 ID4, 19785, a domestic well in section 35-26-30, a domestic well in section 36-26-30, and a domestic well in section 2-27-30.

The saturated thickness at the proposed well location is estimated to be 88 ft, based upon the GMD3 model. For saturated thickness between 75 ft and 100 ft, the drawdown allowance is 2.0 ft.

50 year Theis Analysis: The following values were used to run the analysis:

$S = 0.1645$, $T = 2792.6 \text{ ft}^2/\text{day}$, $tp_{\text{current}} = 131 \text{ days}$, $Q_{\text{current}} = 375 \text{ gpm}$, $tp_{\text{proposed}} = 273 \text{ days}$,
 $Q_{\text{proposed}} = 375 \text{ gpm}$

Theis drawdowns were calculated as follows:

23018 ID1: Drawdown from current location = 3.73 ft
 Drawdown from proposed location = 7.36 ft
 Net drawdown = **3.6 ft**

23018 ID4: Drawdown from current location = 3.04 ft
 Drawdown from proposed location = 6.20 ft
 Net drawdown = **3.2 ft**

23018 ID6: Drawdown from current location = 3.58 ft
Drawdown from proposed location = 7.13 ft
Net drawdown = **3.6 ft**

21933: Drawdown from current location = 2.68 ft
Drawdown from proposed location = 5.54 ft
Net drawdown = **2.9 ft**

20526 ID2: Drawdown from current location = 3.73 ft
Drawdown from proposed location = 7.36 ft
Net drawdown = **3.64 ft**

20526 ID4: Drawdown from current location = 3.04 ft
Drawdown from proposed location = 6.21 ft
Net drawdown = **3.2 ft**

19785: Drawdown from current location = 2.50 ft
Drawdown from proposed location = 5.19 ft
Net drawdown = **2.7 ft**

Domestic 35-26-30: Drawdown from current location = 3.41 ft
Drawdown from proposed location = 6.88 ft
Net drawdown = **3.5 ft**

Domestic 36-26-30: Drawdown from current location = 2.69 ft
Drawdown from proposed location = 5.56 ft
Net drawdown = **2.9 ft**

Domestic 2-27-30: Drawdown from current location = 2.74 ft
Drawdown from proposed location = 5.65 ft
Net drawdown = **2.9 ft**

Net drawdown exceeds the drawdown allowance of 2.0 ft for all wells within 1 mile of the proposed location. Critical well analysis is necessary on those wells.

Critical Well Evaluation:

23018 ID1:

Water Column = 88 ft

DP = 3.6 ft (Net drawdown from the proposal indicated above)

DE = 18.2 ft (Water level decline from 2022 through 2047 based upon GMD3 model)

DD = 17.1 ft (S = 0.1645, T = 20,889 gpd/ft, Q = 150 gpm, tp = 57 days, efficiency = 70%)

DT = 38.9 ft

Economic Drawdown Constraint (EDC) = $0.4 * 88 \text{ ft} = 35.2 \text{ ft}$

Physical Drawdown Constraint (PDC) = $88 \text{ ft} - 60 \text{ ft} = 28.0 \text{ ft}$

Total drawdown of 38.9 ft is greater than the EDC and PDC, so this well is **critical**.

23018 ID4:

Water Column = 88 ft

DP = 3.2 ft (Net drawdown from the proposal indicated above)

DE = 18.2 ft (Water level decline from 2022 through 2047 based upon GMD3 model)

DD = 0 ft (No use in last 10 years)

DT = 21.4 ft

Economic Drawdown Constraint (EDC) = $0.4 * 88 \text{ ft} = 35.2 \text{ ft}$

Physical Drawdown Constraint (PDC) = $88 \text{ ft} - 60 \text{ ft} = 28.0 \text{ ft}$

Total drawdown of 21.4 ft is less than the EDC and PDC, so this well is **not critical**.

23018 ID6:

Water Column = 88 ft

DP = 3.6 ft (Net drawdown from the proposal indicated above)

DE = 18.2 ft (Water level decline from 2022 through 2047 based upon GMD3 model)

DD = 29.3 ft (S = 0.1645, T = 20,889 gpd/ft, Q = 250 gpm, tp = 84 days, efficiency = 70%)

DT = 51.1 ft

Economic Drawdown Constraint (EDC) = $0.4 * 88 \text{ ft} = 35.2 \text{ ft}$

Physical Drawdown Constraint (PDC) = $88 \text{ ft} - 60 \text{ ft} = 28.0 \text{ ft}$

Total drawdown of 51.1 ft is greater than the EDC and PDC, so this well is **critical**.

21933:

Water Column = 106 ft

DP = 2.9 ft (Net drawdown from the proposal indicated above)

DE = 26.0 ft (Water level decline from 2022 through 2047 based upon GMD3 model)

DD = 70.8 ft (S = 0.1336, T = 21,244 gpd/ft, Q = 600 gpm, tp = 93 days, efficiency = 70%)

DT = 99.7 ft

Economic Drawdown Constraint (EDC) = $0.4 * 106 \text{ ft} = 42.4 \text{ ft}$

Physical Drawdown Constraint (PDC) = $106 \text{ ft} - 60 \text{ ft} = 46.0 \text{ ft}$

Total drawdown of 99.7 ft is greater than the EDC and PDC, so this well is **critical**.

20526 ID2:

Water Column = 91 ft

DP = 3.6 ft (Net drawdown from the proposal indicated above)

DE = 29.0 ft (Water level decline from 2022 through 2047 based upon GMD3 model)

DD = 23.2 ft (S = 0.2125, T = 31,956 gpd/ft, Q = 300 gpm, tp = 79 days, efficiency = 70%)

DT = 55.8 ft

Economic Drawdown Constraint (EDC) = $0.4 * 91 \text{ ft} = 36.4 \text{ ft}$

Physical Drawdown Constraint (PDC) = $91 \text{ ft} - 60 \text{ ft} = 31.0 \text{ ft}$

Total drawdown of 55.8 ft is greater than the EDC and PDC, so this well is **critical**.

20526 ID4:

Water Column = 91 ft

DP = 3.2 ft (Net drawdown from the proposal indicated above)

DE = 29.0 ft (Water level decline from 2022 through 2047 based upon GMD3 model)

DD = 0 ft (No use in last 10 years)

DT = 32.2 ft

Economic Drawdown Constraint (EDC) = $0.4 * 91 \text{ ft} = 36.4 \text{ ft}$

Physical Drawdown Constraint (PDC) = $91 \text{ ft} - 60 \text{ ft} = 31.0 \text{ ft}$

Total drawdown of 32.2 ft is greater than the PDC, so this well is **critical**.

19785:

Water Column = 79 ft

DP = 2.7 ft (Net drawdown from the proposal indicated above)

DE = 27.9 ft (Water level decline from 2022 through 2047 based upon GMD3 model)

DD = 37.1 ft ($S = 0.1799$, $T = 24,637$ gpd/ft, $Q = 400$ gpm, $tp = 28$ days, efficiency = 70%)

DT = 67.7 ft

Economic Drawdown Constraint (EDC) = $0.4 * 79$ ft = 31.6 ft

Physical Drawdown Constraint (PDC) = 79 ft – 60 ft = 19.0 ft

Total drawdown of 67.7 ft is greater than the EDC and PDC, so this well is **critical**.

Domestic 35-26-30:

Water Column = 88 ft

DP = 3.5 ft (Net drawdown from the proposal indicated above)

DE = 18.2 ft (Water level decline from 2022 through 2047 based upon GMD3 model)

DT = 21.7 ft

Economic Drawdown Constraint (EDC) = $0.4 * 88$ ft = 35.2 ft

Physical Drawdown Constraint (PDC) = 88 ft – 20 ft = 68.0 ft

Total drawdown of 21.7 ft is less than the EDC and PDC, so this well is **not critical**.

Domestic 36-26-30:

Water Column = 75 ft

DP = 2.9 ft (Net drawdown from the proposal indicated above)

DE = 13.0 ft (Water level decline from 2022 through 2047 based upon GMD3 model)

DT = 15.9 ft

Economic Drawdown Constraint (EDC) = $0.4 * 75$ ft = 30.0 ft

Physical Drawdown Constraint (PDC) = 75 ft – 20 ft = 55.0 ft

Total drawdown of 15.9 ft is less than the EDC and PDC, so this well is **not critical**.

Domestic 2-27-30:

Water Column = 79 ft

DP = 2.9 ft (Net drawdown from the proposal indicated above)

DE = 27.9 ft (Water level decline from 2022 through 2047 based upon GMD3 model)

DT = 30.8 ft

Economic Drawdown Constraint (EDC) = $0.4 * 79 \text{ ft} = 31.6 \text{ ft}$

Physical Drawdown Constraint (PDC) = $79 \text{ ft} - 20 \text{ ft} = 59.0 \text{ ft}$

Total drawdown of 30.8 ft is less than the EDC and PDC, so this well is **not critical**.

Conclusion:

The proposed move is in an area with less than 100 ft saturated thickness. If the proposed well were to pump its full authorized authority, there would likely be a small, but noticeable drawdown effect on all neighboring wells. Critical well analysis shows that neighboring wells under water right numbers 23018 ID1, 23018 ID6, 21933, 20526 ID2, 20526 ID4, and 19785 are critical because saturated thickness, accounting for well drawdown effects, is projected to decline by more than 40% in 25 years and leave less than 60 ft remaining. Concerned neighbors can contact GMD3 at (620) 275-7147 or the Division of Water Resources at (620) 276-2901.

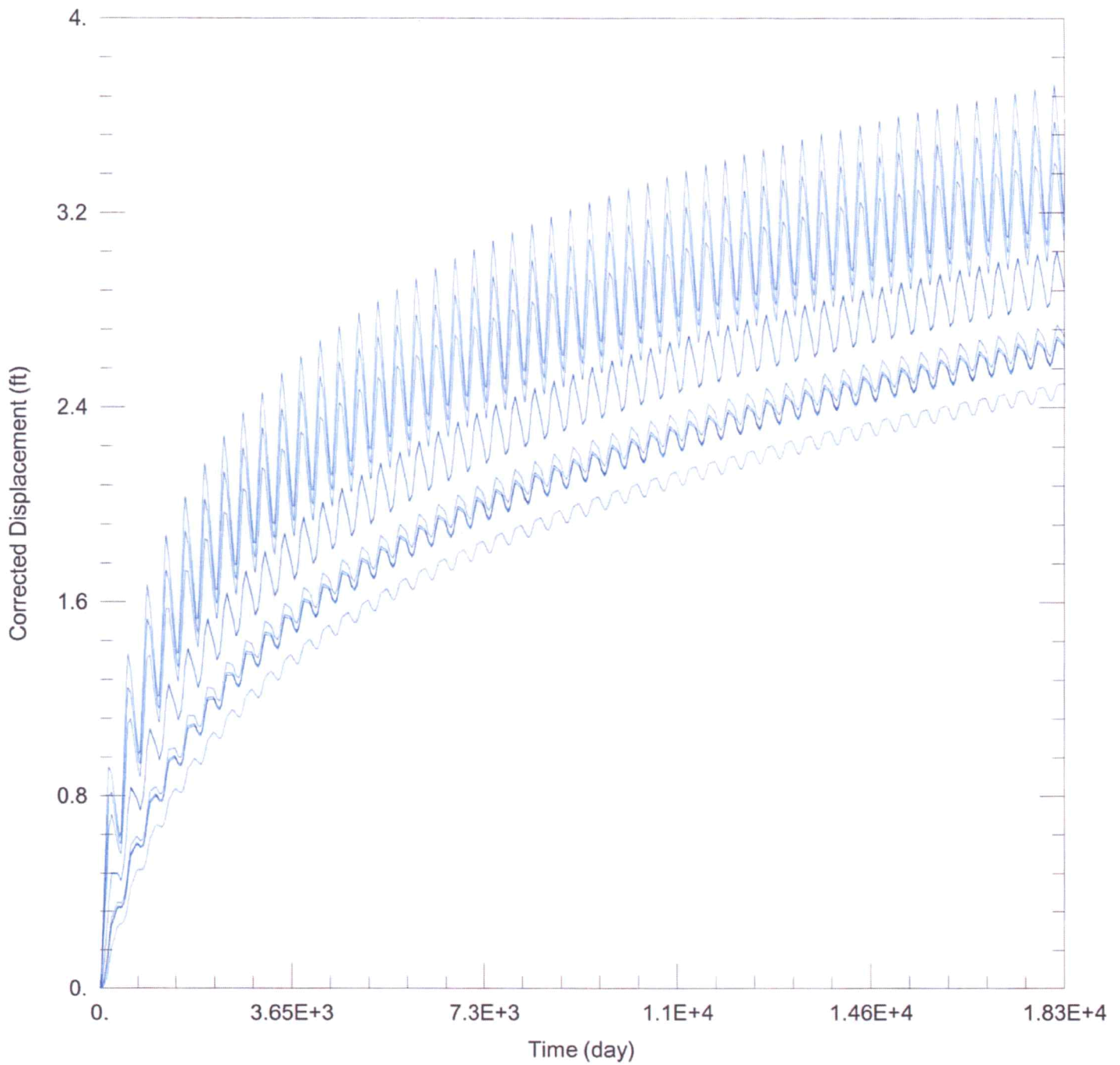

WELL TEST ANALYSIS

Data Set: C:\Users\trevora\Documents\2022_moves\23018\23018 Current.aqt
 Date: 07/22/22 Time: 11:00:59

PROJECT INFORMATION

Company: GMD 3
 Project: 23018
 Location: Gray County

WELL DATA

Pumping Wells			Observation Wells		
Well Name	X (ft)	Y (ft)	Well Name	X (ft)	Y (ft)
23018 ID2	64955	317793	□	64955	317793

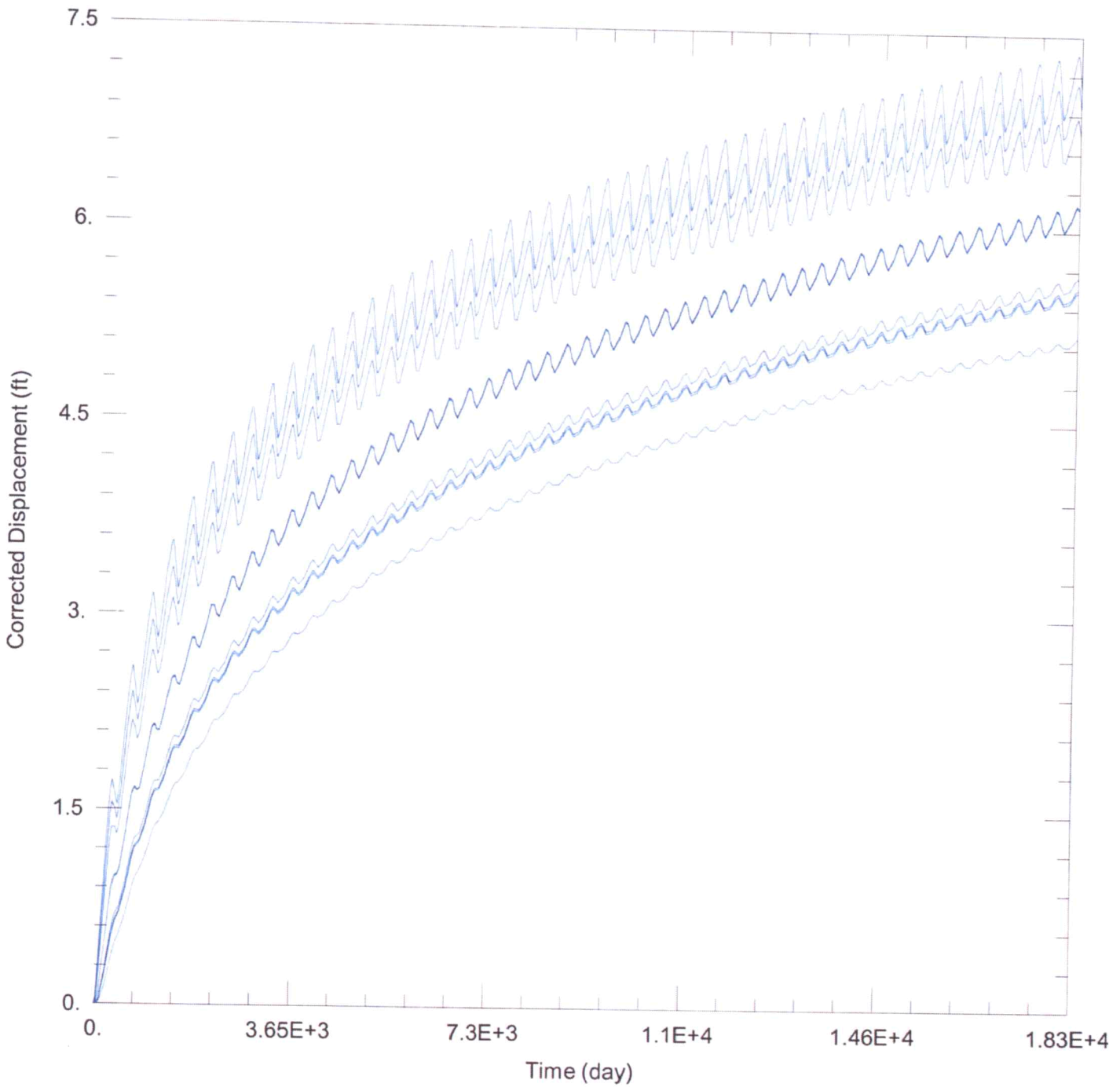

WELL TEST ANALYSIS

Data Set: C:\Users\trevora\Documents\2022_moves\23018\23018 Proposed.aqt
 Date: 07/22/22 Time: 11:00:37

PROJECT INFORMATION

Company: GMD 3
 Project: 23018
 Location: Gray County

WELL DATA

Pumping Wells

Well Name	X (ft)	Y (ft)
23018 ID2	64955	317793

Observation Wells

Well Name	X (ft)	Y (ft)
□	64955	317793

Garden City Field Office
4532 W. Jones, Suite B
Garden City, KS 67846



Phone: 620-276-2901
Fax: 620-276-9315
www.agriculture.ks.gov

Mike Beam, Secretary

Laura Kelly, Governor

August 2, 2022

SOUTHWEST KANSAS GROUNDWATER
MANAGEMENT DISTRICT NO. 3
2009 E SPRUCE ST
GARDEN CITY KS 67846

Re: Request for Recommendation
Water Right, File No. 23018

Dear Mr. Norquest:

This is to advise you that Lonnie Schmidt has filed an application for approval of the Chief Engineer, Division of Water Resources, Kansas Department of Agriculture, to change the point of diversion.

We are delaying action on the change applications to allow you time to review and provide a recommendation. Please submit a recommendation within 15 days from the date of this letter.

Thank you and as always feel free to contact this office at any time.

Sincerely,

A handwritten signature in blue ink that reads "Michael A. Meyer". The signature is fluid and cursive, with a long, sweeping underline that extends to the right.

Michael A. Meyer
Water Commissioner

MAM



State of Kansas, Gray County
This instrument filed
11/24/2020 at 10:51 AM
Book 139 Page 197-198
Fee: \$38.00

Laura Porter
Deputy ROD

PHOTO-COPIED
INDEXED

CORPORATION DEED (GENERAL WARRANTY)

THIS INDENTURE made this 19 day of May, 2020, between **HENRY SCHMIDT, INC.**, a corporation duly organized, incorporated, and existing under and by virtue of the laws of the State of Kansas and having its principal place of business at Montezuma, Kansas, **GRANTOR**, and

LONNIE R. SCHMIDT and CHARLES SCHMIDT, as Trustees of the HENRY AND DELLA SCHMIDT TRUST OF 1998, under agreement dated December 8, 1998

GRANTEE;

WITNESSETH, that Grantor, without consideration, does by these presents Grant, Bargain, Sell, and convey unto Grantee, all the following described real estate situated in Gray County, Kansas:

All of Section 35, Township 26 South, Range 30 West of the 6th P.M.

Southwest Quarter (SW $\frac{1}{4}$) of Section 12, Township 28 South, Range 29 West of the 6th P.M., **LESS AND EXCEPT** a tract of land located in the Southwest Quarter (SW $\frac{1}{4}$) of Section 12, Township 28 South, Range 29 West of the 6th P.M., described as: Beginning at the southwest corner of the Southwest Quarter (SW $\frac{1}{4}$) of said Section 12; thence north, along the west line of said Southwest Quarter (SW $\frac{1}{4}$), 627.00 feet; thence east, parallel with the south line of said Southwest Quarter (SW $\frac{1}{4}$), 825.00 feet, thence south, parallel with the west line of said Southwest Quarter (SW $\frac{1}{4}$), 627.00 feet to a point on the south line of said Southwest Quarter (SW $\frac{1}{4}$); thence west, along said south line, 825.00 feet to the point of beginning, containing 11.88 acres, including 0.83 acres of county road right of way

TO HAVE AND TO HOLD THE SAME, Together with all and singular the tenements, hereditaments, and appurtenances thereunto belonging or in anywise appertaining, forever.

And said Grantor for itself, its successors and assigns, does hereby covenant, promise and agree, to and with Grantee, that at the deliver of these presents it is lawfully seized in its own right, of an absolute and indefeasible estate of inheritance, in fee simple, of and in all and singular the above granted and described premises, with the appurtenances; that the same are free, clear, discharged and unencumbered of and from all former and other grants, titles, charges, estates, judgments, taxes, assessments and encumbrances, of what nature or kind soever;

And that it will warrant and forever defend the same unto Grantee against said party of the first part, its successors and assigns, and all and every person or persons whomsoever, lawfully claiming or to claim the same.

PURSUANT TO K.S.A. 79-1437(e) a real estate validation questionnaire is not required due

STATE OF KANSAS)

COUNTY OF Gray)

ss:

BE IT REMEMBERED, That on this 19 day of May, 2020, before me, the undersigned, a notary public in and for the county and state aforesaid came **Lonnie R. Schmidt, President of Henry Schmidt, Inc.**, a corporation duly organized, incorporated, and existing under and by virtue of the laws of Kansas, who is personally known to me to be such officer, and who is personally known to me to be the same person who executed, as such officer, the within instrument of writing on behalf of said corporation, and such person duly acknowledged the execution of the same to be the act and deed of said corporation.

IN WITNESS WHEREOF, I have hereunto set my hand and affixed my official seal the day and year last above written.

Yolanda J. Blattner
Notary Public

My Term Expires:

11-14-2020

Send Future Tax Statements To:

Henry and Della Schmidt Trust of 1998
c/o Lonnie Schmidt, Trustee
26906 12 Rd.
Montezuma, KS 67867

