

Kansas Department of Agriculture
Division of Water Resources
CHANGE: P/D WORKSHEET

1. File Number: 23698	2. Status Change Date: <i>6-10-2022</i>	3. Change Num: C2	4. Field Office: 4	5. GMD: 3
6. Status: <input checked="" type="checkbox"/> Approved <input type="checkbox"/> Denied by DWR/GMD <input type="checkbox"/> Dismiss by Request/Failure to Return				7. Filing Date of Change: 6/9/2022
8a. Landowner, applicant, WUC New to system <input checked="" type="checkbox"/> DUNN RANCH INC 25923 ROAD A MOSCOW, KS 67952		8c. Landowner(s) New to system <input type="checkbox"/> Person ID _____ Add Seq# _____		
8b. Landowner(s), New to system <input type="checkbox"/> KENT DUNN 25923 ROAD A MOSCOW, KS 67952		8d. WUC New to system <input type="checkbox"/> KENT DUNN 25923 ROAD A MOSCOW, KS 67952		
9. Documents and Enclosure(s): <input checked="" type="checkbox"/> DWR Meter(s) Date to Comply: <u>12/31/2022</u> <input checked="" type="checkbox"/> N & P Date to Comply: <u>3/1/2023</u>				
<input type="checkbox"/> Anti-Reverse Meter <input type="checkbox"/> Meter Seal <input checked="" type="checkbox"/> Check Valve <input checked="" type="checkbox"/> N & P Form <input type="checkbox"/> Water Tube <input type="checkbox"/> Driller Copy <input type="checkbox"/> H & E Letter <input type="checkbox"/> Conservation Plan Date Required: _____ Date Approved: _____ Date to Comply: _____				
10. Use Made of Water From: _____ To: _____				
Date Prepared: 06/09/2022 By: MAM Date Entered: _____ By: _____				

File No. **23698** 11. County: SW Basin: CIMARRON RIVER Stream: Formation Code: 211/331 Special Use:

12. Points of Diversion
 Rate and Quantity
 Authorized Additional
 Rate Quantity Rate Quantity
 gpm af gpm af Overlap PD Files

CHK	MOD	DEL	ENT	PDIV	Qualifier	S	T	R	ID	'N	'W	Comment (AKA Line)	Rate gpm	Quantity af	Rate gpm	Quantity af	Overlap PD Files
DEL	46818																
MOD	66623	LOT 3 (NWSW)	18	31S	34W	05			2283		5116		1480	611	1480	611	643
ENT		NE NE SW	18	31S	34W				2596		2767		1200	548	275	0	

13. Storage: Rate _____ NF Quantity _____ ac/ft Additional Rate _____ NF Additional Quantity _____ ac/ft

14. Limitation: _____ af/ at _____ gpm (_____ cfs) when combined with file number(s) _____
 Limitation: _____ af/yr at _____ gpm (_____ cfs) when combined with file number(s) _____

15. 5YR Allocation: Allocation Type _____ Start Year _____ 5 YR Amount _____ Amount Unit _____ Base Acres _____ Comment _____

CHK	MOD	DEL	ENT	PUSE	S	T	R	ID	NE¼				NW¼				SW¼				SE¼				Total	Owner	Chg?	Overlap Files
									NE ¼	NW ¼	SW ¼	SE ¼	NE ¼	NW ¼	SW ¼	SE ¼	NE ¼	NW ¼	SW ¼	SE ¼	NE ¼	NW ¼	SW ¼	SE ¼				
CHK	7299																									8a	Y	643
CHK	63773																									8B	N	643

16. Place of Use

CHK	MOD	DEL	ENT	PUSE	S	T	R	ID	NE¼				NW¼				SW¼				SE¼				Total	Owner	Chg?	Overlap Files
									NE ¼	NW ¼	SW ¼	SE ¼	NE ¼	NW ¼	SW ¼	SE ¼	NE ¼	NW ¼	SW ¼	SE ¼	NE ¼	NW ¼	SW ¼	SE ¼				
CHK	7299																									8a	Y	643
CHK	63773																									8B	N	643

Base Acres: Year: Minimum Reasonable Quantity:

Comments:

Garden City Field Office
4532 W. Jones, Suite B
Garden City, KS 67846



Phone: 620-276-2901
Fax: 620-276-9315
www.agriculture.ks.gov

Mike Beam, Secretary

Laura Kelly, Governor

June 10, 2022

KENT DUNN
25923 ROAD A
MOSCOW, KS 67952

RE: Field Office Application for Change
Water Right, File Nos. 643 & 23698

Dear Sir:

Enclosed is an order executed by the designee of the Chief Engineer, Division of Water Resources, Kansas Department of Agriculture, approving the applications for change under the above referenced file numbers.

Your attention is directed to the enclosures and to the terms, conditions, and limitations specified in this approval for change. A condition of this approval is that an acceptable water flow meter must be installed on the diversion works authorized under the referenced file number and meet current specifications. Please return the required notification of completion of the diversion works and installation of the required meter as soon as these actions are completed.

Since the orders modify the original documents referred to above, they should be recorded with the Register of Deeds as other instruments affecting real estate.

The abandoned well must be plugged in accordance with the requirements of Article 30 of the Rules and Regulations as adopted by the Kansas Department of Health and Environment.

Should you have any questions, please feel free contact this office. If you would prefer, you could arrange an appointment for additional assistance.

Sincerely,

A handwritten signature in blue ink that reads "Michael A. Meyer".

Michael A. Meyer
Water Commissioner

MAM:
enclosures

pc: Dunn Ranch Inc
GROUNDWATER MANAGEMENT DISTRICT NO. 3

CERTIFICATE OF SERVICE

On this 10th day of June 2022, I hereby certify that the foregoing Approval of Application for Change in Point of Diversion, Water Right, File Nos. 643 & 23698 dated 10th day of June 2022 was mailed postage prepaid, first class, US mail to the following:

KENT DUNN
25923 ROAD A
MOSCOW, KS 67952

Pc:

DUNN RANCH INC
25923 ROAD A
MOSCOW, KS 67952

GROUNDWATER MANAGEMENT DISTRICT NO. 3



Division of Water Resources Staff

Submit completed application to:
 Kansas Department of Agriculture
 Division of Water Resources
 Field Office for your area.

Call for address:

Topeka -- (785) 296-5733
 Stafford -- (620) 234-5311
 Stockton -- (785) 425-6787
 Garden City -- (620) 276-2901
<http://agriculture.ks.gov/dwr>

DWR FIELD OFFICE APPLICATION FOR APPROVAL TO CHANGE THE PLACE OF USE AND/OR THE POINT OF DIVERSION



STATE OF KANSAS

Filing Fee Must Accompany the Application, K.S.A. 82a-708b(b), as amended.
 Fee Schedule is on the third page of this application form.

Paragraph Nos. 1, 2, 3 & 5 must be completed. Complete all other applicable portions. If change in point of diversion is greater than 100 feet, or if place of use will be changed, include a topographic map or detailed plat showing the authorized and proposed point(s) of diversion and/or place of use.

File No. 23698

RECEIVED
 9:41 am
 MAY 19 2022

Garden City Field Office
 Division of Water Resources

1. Application is hereby made for approval of the Chief Engineer to change the (check one or both):

Place of Use Point of Diversion

under the water right which is the subject of this application in accordance with the conditions described below.

The source of supply is: Groundwater Surface water

2. Name and address of Applicant: KENT DUNN /Dunn Ranch Inc
25923 ROAD A MOSCOW KS 67952

Phone Number: () Email address: _____

Name and address of Water Use Correspondent: SAME AS ABOVE

Phone Number: () Email address: _____

3. The presently authorized place of use is:

Owner of Land ---- NAME: NO CHANGE

ADDRESS: _____

(If there is more than one landowner, attach supplemental sheets as necessary.)

Sec.	Twp.	Range	NE¼				NW¼				SW¼				SE¼				TOTAL ACRES		
			NE¼	NW¼	SW¼	SE¼	NE¼	NW¼	SW¼	SE¼	NE¼	NW¼	SW¼	SE¼	NE¼	NW¼	SW¼	SE¼			

4. If this application is for a change in place of use, it is proposed that the place of use be changed to:

Owner of Land ---- NAME: _____

ADDRESS: _____

(If there is more than one landowner, attach supplemental sheets as necessary.)

Sec.	Twp.	Range	NE¼				NW¼				SW¼				SE¼				TOTAL ACRES			
			NE¼	NW¼	SW¼	SE¼	NE¼	NW¼	SW¼	SE¼	NE¼	NW¼	SW¼	SE¼	NE¼	NW¼	SW¼	SE¼				

For Office Use Only: Code _____ Fee \$ 200.00 TR # _____ Receipt Date 5-19-22 Check # 1065

5. **Presently authorized point of diversion:**
 One in the _____ Quarter of the _____ Quarter of the LOT 1 Quarter
 of Section 18, Township 31 South, Range 34 (W),
 in SEWARD County, Kansas, 4890 feet North 5150 feet West of Southeast corner of section.
 Authorized Rate _____ Authorized Quantity _____ Depth of well _____ (feet)
(DWR use only: Computer ID No. 01 GPS 4901 feet North 5104 feet West)
 This point will not be changed This point will be changed as follows: No change, point better described with GPS as follows:
Proposed point of diversion: (Complete only if change is requested or if existing point is better described by GPS)
 One in the LOT 3 Quarter of the NW Quarter of the LOT 3 (NHSW) Quarter
 of Section 18, Township 31 South, Range 34 (W),
 in SEWARD County, Kansas, 2283 feet North 5116 feet West of Southeast corner of section.
 Proposed Rate _____ Proposed Quantity _____ Proposed well depth (feet) 550
 This point is: Additional Well Geo Center List other water rights that will use this point 643

6. **Presently authorized point of diversion:**
 One in the NW Quarter of the NW Quarter of the SW Quarter
 of Section 18, Township 31 South, Range 34 (W),
 in SEWARD County, Kansas, 2254 feet North 5110 feet West of Southeast corner of section.
 Authorized Rate _____ Authorized Quantity _____ Depth of well _____ (feet)
(DWR use only: Computer ID No. 05 GPS _____ feet North _____ feet West)
 This point will not be changed This point will be changed as follows: No change, point better described with GPS as follows:
Proposed point of diversion: (Complete only if change is requested or if existing point is better described by GPS)
 One in the NE Quarter of the NE Quarter of the SW Quarter
 of Section 18, Township 31 South, Range 34 (W),
 in SW County, Kansas, 2596 feet North 2767 feet West of Southeast corner of section.
 Proposed Rate _____ Proposed Quantity _____ Proposed well depth (feet) 547
 This point is: Additional Well Geo Center List other water rights that will use this point _____

7. The changes herein are desired for the following reasons?
 (please be specific) MOVING ID 1 WELL TO ID 5
UPDATING LOCATION BASED ON GPS

8. If a well, is the test hole log attached? Yes No

9. The change(s) (was)(will be) completed by?
UPON APPROVAL

10. If the point of diversion is a well:
 (a) What are you going to do with the old well?
PLUG / CAP
 (b) When will this be done? UPON COMPLETION

11. Groundwater Management District recommendation attached?
 Yes No

12. Assisted by AM / GCFO

13a. If the proposed point of diversion will be relocated more than 300 feet but within 2,640 feet of the existing point of diversion, attach a topographic map or aerial photograph. For groundwater sources, show all wells (including domestic) within one-half mile of the proposed point of diversion and the names and mailing addresses of the owners. For surface water sources, show the names and addresses of the landowner(s) one-half mile downstream and one-half mile upstream from your property lines

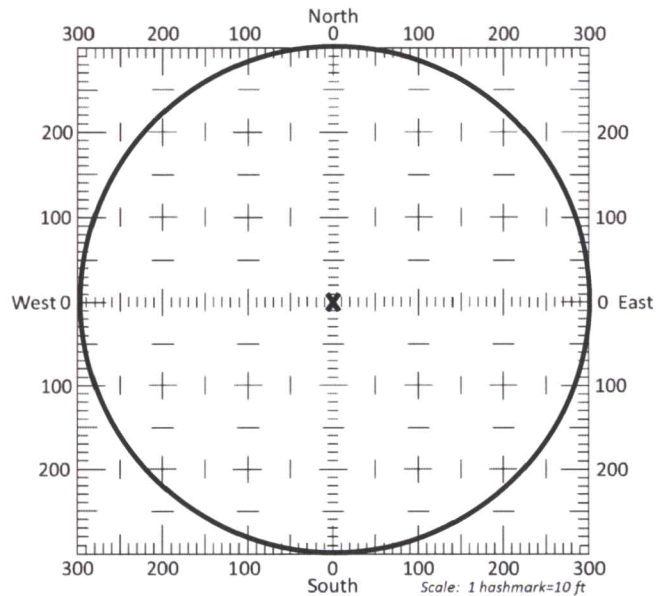

13b. If the proposed point of diversion will be relocated within a 300 foot radius of the existing point of diversion, indicate its location on the diagram shown above in relation to the existing point of diversion. The proposed point of diversion must be located within the circle shown above. **(PLEASE NOTE: The "X" in center of diagram above represents the presently authorized point of diversion.)**

14. If the proposed groundwater point of diversion is 300 or fewer feet from the existing point of diversion, complete the following:
- (a) Does the undersigned represent all owners of the currently authorized place(s) of use identified in this application?
 Yes No (If no, all owners must sign this application.)
 - (b) Will the ownership interest of any owner of the currently authorized place(s) of use identified in this application be adversely affected if this application is approved as requested?
 Yes No (If yes, all owners must sign this application.)
 - (c) If this application is not approved expeditiously, will there be substantial damage to property, public health or safety?
 Yes No (If no, all owners must sign this application.)

If the application proposes a surface water change in point of diversion, a groundwater change in point of diversion greater than 300 feet, or a change in place of use, the application must be signed by all owners of the currently authorized place of use, or their duly authorized agent (attach notarized statement authorizing representation).

I hereby verify, being first duly sworn upon my oath or affirmation and under penalty of perjury, that I am of lawful age and the owner, the spouse of the owner, or a duly authorized agent of the owner(s) to make this application on their behalf, in regards to the water right(s) to which this application pertains. I further verify that the statements contained in this application are true, correct and complete.

Dated at 5-12-22, Kansas, this _____ day of _____, 20_____.

<p><u>Kent Dunn</u> <u>President</u> _____ (Owner)</p> <p><u>Kent Dunn</u> _____ (Please Print)</p> <p><u>Ardith Dunn</u> <u>Secretary</u> _____ (Owner)</p> <p><u>Ardith Dunn</u> _____ (Please Print)</p> <p>_____ (Owner)</p> <p>_____ (Please Print)</p>	<p>_____ (Spouse)</p> <p>_____ (Please Print)</p> <p>_____ (Spouse)</p> <p>_____ (Please Print)</p> <p>_____ (Spouse)</p> <p>_____ (Please Print)</p>
--	---

State of Kansas }
 County of Haskell } SS

I hereby certify that the foregoing application was signed in my presence and sworn to before me this 12 day of May, 2022.



Shellie Barker
 Notary Public

My Commission Expires 7-14-24.

ONLY COMPLETE APPLICATIONS WILL BE PROCESSED. To be complete, all of the applicable portions of the application form must be completed with accurate information; maps, if necessary, must be included; signatures of all the appropriate owners' must be affixed to the application and notarized; and the appropriate fee must be paid.

FEE SCHEDULE

Each application to change the place of use or the point of diversion under this section shall be accompanied by the application fee set forth in the schedule below: Make checks payable to: Kansas Department of Agriculture

- | | |
|---|-------|
| (1) Application to change a point of diversion 300 feet or less | \$100 |
| (2) Application to change a point of diversion more than 300 feet | \$200 |
| (3) Application to change the place of use | \$200 |

SUMMARY ORDER APPROVING APPLICATION FOR CHANGE AND IMPOSING CONDITIONS

This Summary Order is issued under authority of K.S.A. 82a-708b, as amended, and K.A.R. 5-5-1, *et seq.* and other applicable provisions of the *Kansas Water Appropriation Law, K.S.A. 82a-701 et seq.*, and rules and regulations promulgated thereunder, With the exception of those conditions expressly contained herein, this Summary Order does not change the terms, conditions and limitations of File No. 23698.

1. A change application was received on May 19, 2022 requesting that the place of use and / or point of diversion authorized under the above-referenced file number be changed as described in the application.
2. On and after the effective date of this summary order, the authorized place(s) of use shall be located substantially as shown on the topographic map accompanying the application to change the place of use. Applicable Not Applicable
3. The change in point of diversion shall not impair existing rights and shall be limited to the same source or sources of water as previously authorized. The point of diversion authorized by this summary order shall be located within a 300 foot radius of the authorized point(s) of diversion. Applicable Not Applicable
4. The point(s) of diversion described herein is administratively corrected to be more accurately described using the Global Positioning System (GPS), as described in the application. Applicable Not Applicable
5. The point(s) of diversion authorized herein shall not actually be located more than 2640 feet from the previously authorized point(s) of diversion. Applicable Not Applicable
6. As required by K.A.R. 5-3-5d, if the works for diversion is a well with a diversion rate of 100 gallons per minute or more, a tube or other device suitable for making water level measurements shall be installed, operated and maintained in accordance with K.A.R. 5-6-13. Applicable Not Applicable
7. **The owner of the authorized place(s) of use shall properly install an acceptable water flow meter on or before December 31, 2022**, or before the first use of water, whichever occurs first. The water flow meter shall be installed, operated and maintained in accordance with K.A.R. 5-1-4 through 5-1-12. As required by K.S.A. 82a-732, as amended, and K.A.R. 5-3-5e, the owner shall maintain records and report the reading of the water flow meter and the total quantity of water diverted annually to the Chief Engineer by March 1 following the end of each calendar year. Applicable Not Applicable
8. **Installation of the works for diversion of water shall be completed on or before December 31, 2022**, or within any authorized extension of time. By March 1, 2023 the applicant shall notify the Chief Engineer that construction of the works for diversion has been completed, on the form provided by the Chief Engineer, as required by K.A.R. 5-8-4e. Applicable Not Applicable
9. **The completed well log shall be submitted with the required notice.** Applicable Not Applicable
10. All diversion works into which any type of chemical or other foreign substance will be injected into the water shall be equipped with an in-line, automatic, quick-closing check valve capable of preventing pollution of the source of the water supply. The check valve(s) shall be installed, operated and maintained in accordance with K.A.R. 5-3-5c. Applicable Not Applicable
11. Additional Conditions are attached. Yes No
12. In accordance with K.S.A. 82a-708a, as amended, and K.A.R. 5-5-14, all of the owners of the authorized place(s) of use of water appropriated under the above-referenced file number are responsible for compliance with its terms, conditions and limitations, as amended and/or supplemented by this Summary Order, and with applicable provisions of the *Kansas Water Appropriation Law* and the *Rules and Regulations* promulgated thereunder. Failure to comply with these provisions may result in civil penalties pursuant to K.S.A. 82a-737, as amended, and/or the suspension or revocation and dismissal of the water or appropriation right or any other enforcement actions authorized by law.

Administrative Appeal and Effective Date of Order

If you are aggrieved by this order, pursuant to K.S.A. 82a-1901, you may request an evidentiary hearing before the Chief Engineer or request administrative review by the Secretary of Agriculture. A request for hearing by the Chief Engineer must be filed within **15 days** of service of this Order and a request for administrative review by the Secretary must be filed within **30 days** pursuant to K.S.A. 77-531. Any request for administrative review must state a basis for review pursuant to K.S.A. 77-527. File any request with **Kansas Department of Agriculture, Legal Division, 1320 Research Park Drive, Manhattan, KS 66502.** Failure to timely request a hearing or review may preclude review under the Kansas Judicial Review Act.

For Use by Register of Deeds

FOR OFFICE USE ONLY
APPLICATION APPROVED AND SUMMARY ORDER ISSUED

By: Michael A. Meyer
Duly Authorized Designee of the Chief Engineer
(Print Name): MICHAEL A. MEYER
Division of Water Resources - Kansas Department of Agriculture

Date of Issuance: June 10, 2022

State of Kansas)

) SS

County of Tinney)

Acknowledged before me on June 10, 2022
by Michael A. Meyer

Signature: Julie Jones
Notary Public

My commission expires: _____
(Notary Seal)
My Appointment Expires December 15, 2022

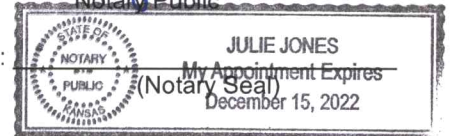

CHANGE IN POINT OF DIVERSION WATER RIGHT, FILE NOS. 643 & 23698

Section 18 Township 31 South Range 34 West Seward County

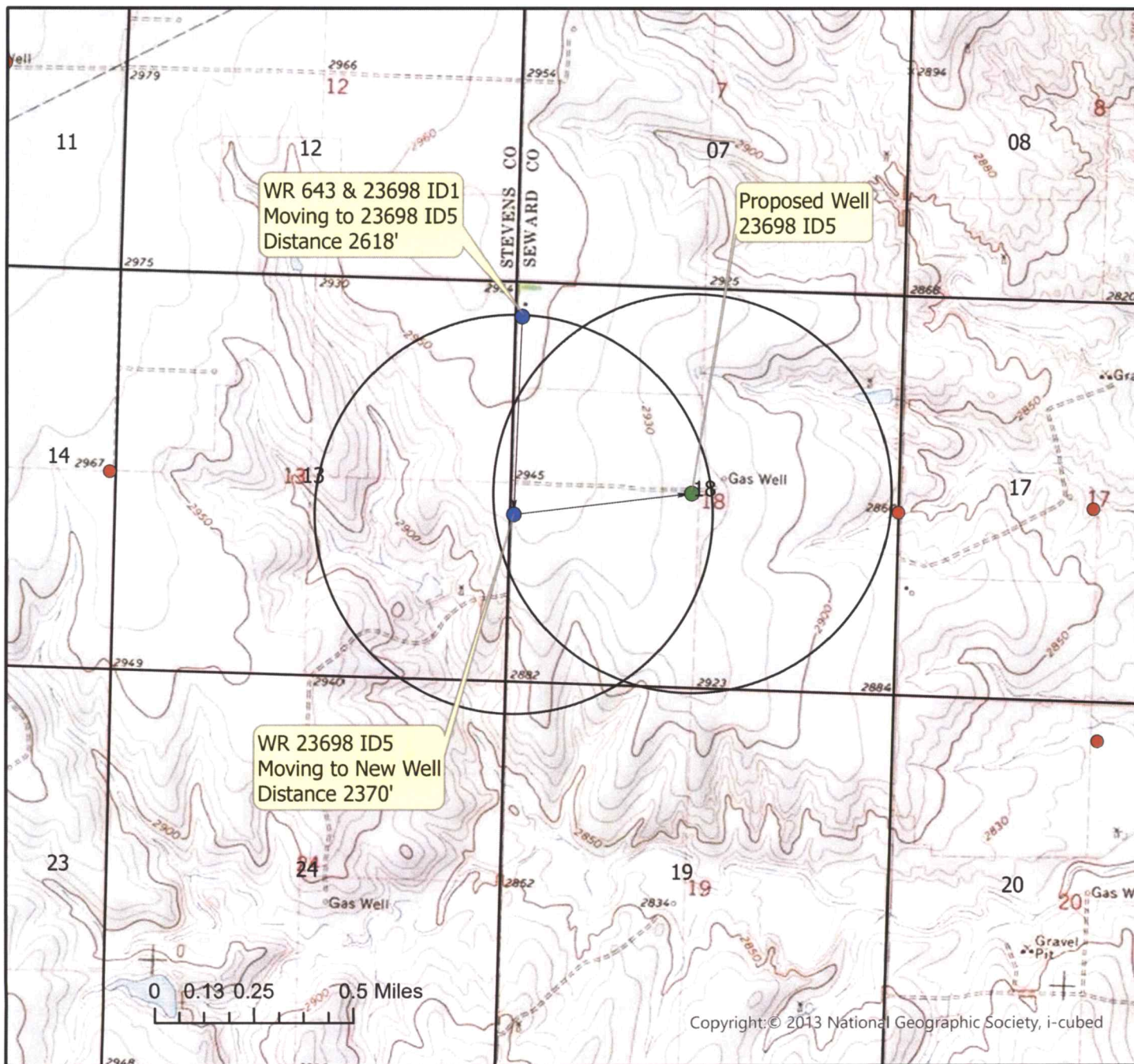

	Authorized Point of Diversion
	Proposed Point of Diversion
	Permitted Water Right
	Domestic Well within 1/2 mile
	1/2 mile buffer

List of owner name and addresses within 1/2 mile:



By signing below I agree that all wells, including domestic, and owners names and addresses within 1/2 mile of the proposed point of diversion have been shown on the map

(Signature)

Date

AM/GCFO
1:24,000 Scale

Kent Dunn

Test Hole # 2 of 4-21-22
SW 18-31-34 SW
Possible replacement well location
FILE #'s 643 & 23698

Legend

 37.35096 N 101.05972 W

A

 37.35096 N 101.05972 W

Google Earth

700 ft



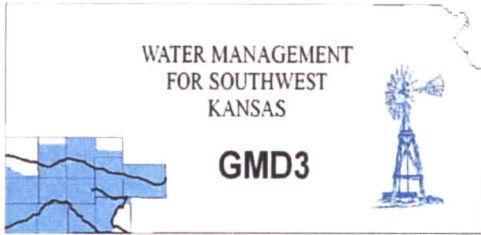

Southwest Kansas
Groundwater Management District No. 3
2009 E. Spruce Street
Garden City, Kansas 67846
(620) 275-7147 phone (620) 275-1431 fax
www.gmd3.org

June 9, 2022

Mike A Meyer
Division of Water Resources
4532 W Jones Ave., Suite B
Garden City, Kansas 67846

RE: Application for Change in Point of Diversion
Water Rights, File Nos. 643 & 23698

Dear Mike:

We have completed a review of the applications for the above referenced water rights. The proposed change in point of diversion is in accordance with current area rules, K.A.R. 5-23-3, as it pertains to minimum spacing to neighboring wells and distance moved.

Well evaluations were conducted to estimate possible effects of the proposal on the supply of other wells with water rights prior to the proposal per K.S.A. 82a-708b, and the draft revised management program. Under K.S.A. 82a-708b, an applicant requesting a change in point of diversion must demonstrate to the chief engineer that any proposed change is reasonable and will not impair. The enclosed report is an analysis performed by the GMD on behalf of our membership. Under this analysis, the proposed change is considered to be reasonable and unlikely to impair if either the net in-season well-to-well effect of the proposed change is less than a strict maximum allowable threshold (3.5 ft on the sections saturated thickness ranging 150-200 ft), or if no well with a net well-to-well effect exceeding the threshold is identified as critical. Critical wells are identified as wells that are expected to either lose or greatly diminish water supply over the next 25 years. The attached review information is based on a Theis analysis using inputs from the GMD3 aquifer model, which is considered to be the best information on well and aquifer data readily and easily available to the public. If either the applicant or the neighbors believe they have better data that might change the result of the analysis, they should contact GMD3. Conclusions of the well analysis may change if better information on well and aquifer data can be made available.

Every neighboring well within 1 mile of the proposed move was evaluated. Evaluations showed that none of the neighboring wells exceeded the net effect above the maximum allowable threshold and no critical wells determined. We did not receive any comments from neighbor notices. Therefore, GMD3 sees this move as meeting current rules and would recommend approval of the applications. If aquifer conditions change or there is a change to the water right in the future, we would be happy to evaluate the effects at that time.

Thank you for the opportunity to review the applications and to provide a recommendation. If you have any questions, please don't hesitate to contact us.

Sincerely,

Jason L. Norquest
Assistant Manager

RECEIVED

JUN 09 2022

Garden City Field Office
Division of Water Resources

GMD3 Change Review

File No(s): 643 & 23698.

DWR office: GC.

App filed to change: PD.

Is Landowner(s) correct in WRIS: Kent Dunn.

If NO, is documentation included?

Is Water Use Correspondent correct in WRIS? .

If NO, is documentation included?

Regulation(s) Reviewed: KAR 5-23-3

Point of diversion ID No(s) 01 & 05 being changed.

643 & 23698 ID 01 moving to 23698 ID05

	ft. North	ft. West	
Authorized PD	4890	5150	Sect 18-31-34
Proposed PD	2283	5116	
Difference	2607 s	34	
a2 + b2 = c2	6796449	1156	2607.222 foot move S

New proposed well for 236989 ID05

	ft. North	ft. West	
Authorized PD	2283	5110	Sect 18-31-34
Proposed PD	2596	2767	
Difference	-313	2343 e	
a2 + b2 = c2	97969	5489649	2363.814 foot move E

GPS for proposed PD: Lat: 37.35096 Long: -101.05972.

Is proposed PD stacking on existing WRs? Keeping current stacks.

Is Proposed PU overlapping existing WRs? No Change.

Neighboring certified well(s) notified: .

Name Betty Jo Young (22685).

Address PO Box 67.

Zip Satanta, KS 67870.

Email: shaneblackwood12@hotmail.com Phone: 620-629-1190.

Domestic well(s) notified: .

Name Micah & Bethany Wood (sect.17).

Address 25259 Road B.

Zip Moscow, KS 67952.

Base Acres: .

Perfected Acres: .

Irr. Return-Flow %

Seward County

Domestic on the section in the applicants.

GMD3 Change Review

643 7 23698 ID01 authorized: 480AF @ 925gpm
548AF

Averaged 128.6AF/year (2012-2016), reported 300gpm. Has not had water reported since 2017.

23698 ID 05 authorized: 611AF @ 1480gpm

Limited to 611AF

ID 05 reported water use (2012-2021): 404.2AF/year

Reported 1100gpm on 2017 WUR

ID01 proposed to move to the well located under ID05.

ID05 will be moved to a new proposed well.

Is a waiver needed: Both moves are less than half mile. Appears minimum spacing is met. Analysis shows effect well within guidelines and no critical wells.

Recommendation: After review of all available information, it appears current area rules/regs are met. Staff therefore recommends approval of the applications.



RECEIVED

JUN 09 2022

Garden City Field Office
Division of Water Resources

Water Rights and Points of Diversion Within 1 mile of point defined as:

2596 Feet N and 2767 Feet W of the Southeast Corner of Section 18 Twp 31S Rng 34W

Located at: 101.059751 West Longitude and 37.350980 North Latitude

Both SURFACE WATER and GROUNDWATER

2300' or All

File Number	Use	ST	SR	Dist (ft)	Q4	Q3	Q2	Q1	FeetN	FeetW	Sec	Twp	Rng	ID	Batt	Auth_Quan	Add_Quan	
A__ AF	643 00	IRR	NK	G*	3298	--	--	--	4890	5150	18	31	34W	1		480.00	480.00	
A__ AF	22685 00	IRR	NK	G	2752	--	NE	NE	SE	2429	31	18	31	34W	7		448.00	448.00
A__ AF	23698 00	IRR	NK	G*	2365	--	NW	NW	SW	2254	5110	18	31	34W	5	<i>New Note</i>	611.00	611.00
Same AF					3298	--	--	--	4890	5150	18	31	34W	1		548.00	.00	

moving to ID 05

Total Net Quantities Authorized:	Direct	Storage
Total Requested Amount (AF) =	.00	.00
Total Permitted Amount (AF) =	.00	.00
Total Inspected Amount (AF) =	.00	.00
Total Pro_Cert Amount (AF) =	.00	.00
Total Certified Amount (AF) =	1539.00	.00
Total Vested Amount (AF) =	.00	.00
TOTAL AMOUNT (AF) =	1539.00	.00

*Spacing Appears
ET!!*

An * after the source of supply indicates a pending application for change under the file number.

An * after the ID indicates a 15 AF exemption was granted under the file number.

A "G" in the Batt column indicates the GEO CTR of a battery. A "B" indicates a well in the battery.

The number in the Batt column is the number of wells in the battery.

Water Rights and Points of Diversion Within 1 mile of point defined as:

2596 Feet North and 2767 Feet West of the Southeast Corner of Section 18 Twp 31S Rng 34W

Located at: 101.059751 West Longitude and 37.350980 North Latitude

Both SURFACE WATER and GROUNDWATER

WATER USE CORRESPONDENTS:

- > KENT DUNN
- >
- > 25923 ROAD A
- > MOSCOW KS 67952
- >-----
- > BETTY JO YOUNG
- >
- > PO BOX 67
- > SATANTA KS 67870
- >-----
- > KENT DUNN
- >
- > 25923 ROAD A
- > MOSCOW KS 67952
- >-----

Application

22685

Application

Evaluation of proposed move for Water Right Nos. 643 and 23698

Proposed: Move water right nos. 643 and 23698 ID1 to the well location currently authorized under water right number 23698 ID5, 2,633 ft to the south. Move water right 23698 ID5 to a new well location, 2,402 ft to the northeast.

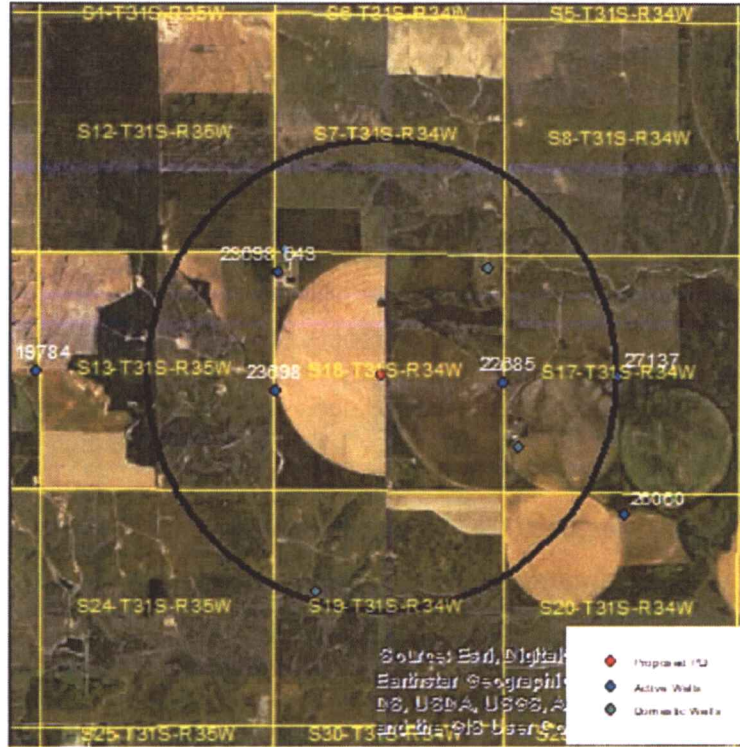

Wells within 1 mile: 22885, a domestic well in section 7-31-34, a domestic well in section 18-31-34, a domestic well in section 17-31-34, and a domestic well in section 19-31-34.

The saturated thickness at the proposed well location is estimated to be 187 ft, based upon the GMD3 model. For saturated thickness between 150 ft and 200 ft, the drawdown allowance is 3.5 ft.

50 year Theis Analysis: The water rights to be moved have overlapping authority, and for purposes of this evaluation, it was assumed they would be pumped evenly. The following values were used to run the analysis:

$S = 0.268, T = 13,279 \text{ ft}^2/\text{day},$

643 & 23698: $tp_{\text{current}} = 49 \text{ days}$ (based on average use and reported rate), $Q_{\text{current}} = 300 \text{ gpm}$ (last reported rate), $tp_{\text{proposed}} = 0 \text{ days}, Q_{\text{proposed}} = 0 \text{ gpm}$

23698: $tp_{\text{current}} = 84 \text{ days}$ (based on average use and observed rate), $Q_{\text{current}} = 1084 \text{ gpm}$ (2012 inspection), $tp_{\text{proposed}} = 64 \text{ days}, Q_{\text{proposed}} = 1084 \text{ gpm}$

New Well Location: $tp_{\text{proposed}} = 53 \text{ days}, Q_{\text{proposed}} = 1316 \text{ gpm}$

RECEIVED
JUN 09 2022
 Garden City Field Office
 Division of Water Resources

Theis drawdowns were calculated as follows:

22685:	Drawdown from current location = 1.55 ft
	Drawdown from proposed location = 2.55 ft
	Net drawdown = 1.0 ft
Domestic 7-31-34:	Drawdown from current location = 2.68 ft
	Drawdown from proposed location = 2.77 ft
	Net drawdown = 0.1 ft
Domestic 18-31-34:	Drawdown from current location = 1.51 ft
	Drawdown from proposed location = 2.31 ft
	Net drawdown = 0.8 ft
Domestic 17-31-34:	Drawdown from current location = 1.45 ft
	Drawdown from proposed location = 2.27 ft
	Net drawdown = 0.8 ft
Domestic 19-31-34:	Drawdown from current location = 1.61 ft
	Drawdown from proposed location = 2.13 ft
	Net drawdown = 0.5 ft

Net drawdown does not exceed the drawdown allowance of 3.5 ft for any well within 1 mile of the proposed location. Therefore, critical well analysis is not necessary.

Conclusion:

The proposed move is likely to create minimal effects on neighboring wells and appears unlikely to cause impairment. Any concerned neighbors should contact GMD3 at (620) 275-7147 or the Division of Water Resources at (620) 276-2901.

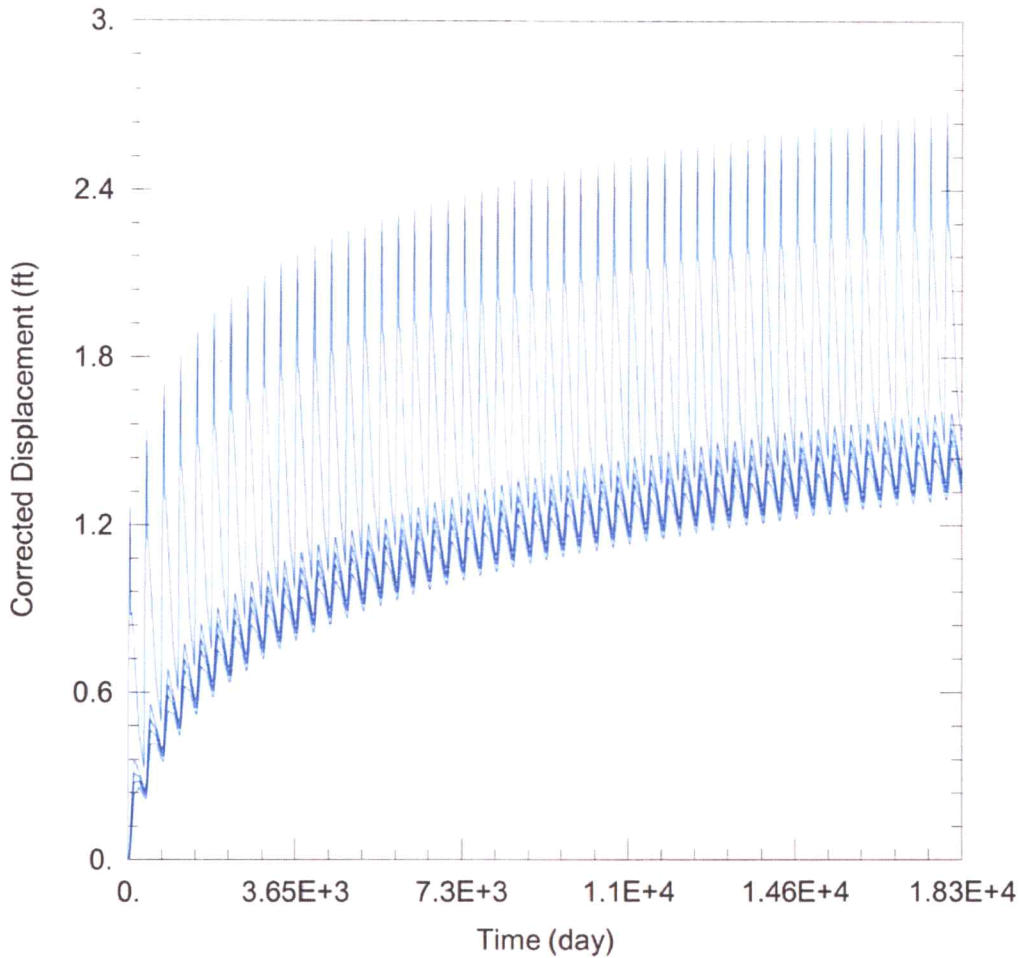

WELL TEST ANALYSIS

Data Set: C:\Users\trevora\Documents\2022_moves\643_23698\643 & 23698 Current.aqt
 Date: 06/02/22 Time: 14:50:53

PROJECT INFORMATION

Company: GMD 3
 Project: 643 & 23698
 Location: Seward County

WELL DATA

Pumping Wells

Well Name	X (ft)	Y (ft)
23698 & 643	-78000	175701
23698I	-78037	173068

Observation Wells

Well Name	X (ft)	Y (ft)
□	-78000	175701
□	-78037	173068
□ 22685	-72920	173232
□ Domestic 7-31-34	-77812	176228
□ Domestic 18-31-34	-73246	175775
□ Domestic 17-31-34	-72581	171795
□ Domestic 19-31-34	-77113	168528

SOLUTION

Aquifer Model: Unconfined
 $T = 1.328E+4 \text{ ft}^2/\text{day}$
 $Kz/Kr = 1.$

Solution Method: Theis
 $S = 0.268$
 $b = 187. \text{ ft}$

RECEIVED

JUN 09 2022

Garden City Field Office
 Division of Water Resources

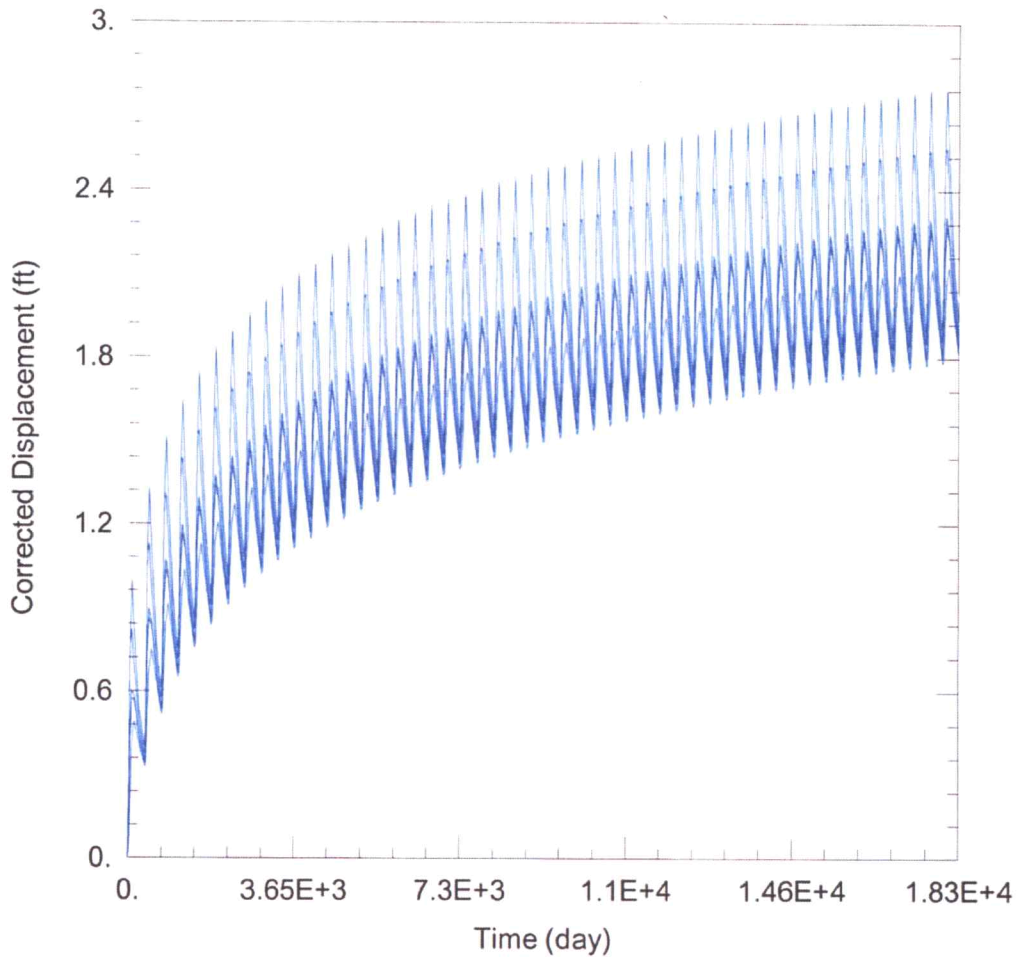

WELL TEST ANALYSIS

Data Set: C:\Users\trevora\Documents\2022_moves\643_23698\643 & 23698 Proposed.aqt
 Date: 06/02/22 Time: 14:50:46

PROJECT INFORMATION

Company: GMD 3
 Project: 643 & 23698
 Location: Seward County

WELL DATA

Pumping Wells

Well Name	X (ft)	Y (ft)
<u>Proposed PD</u>	<u>-75658</u>	<u>173400</u>
<u>23698</u>	<u>-78037</u>	<u>173068</u>

Observation Wells

Well Name	X (ft)	Y (ft)
□	<u>-75658</u>	<u>173400</u>
□	<u>-78037</u>	<u>173068</u>
□ <u>22685</u>	<u>-72920</u>	<u>173232</u>
□ <u>Domestic 7-31-34</u>	<u>-77812</u>	<u>176228</u>
□ <u>Domestic 18-31-34</u>	<u>-73246</u>	<u>175775</u>
□ <u>Domestic 17-31-34</u>	<u>-72581</u>	<u>171795</u>
□ <u>Domestic 19-31-34</u>	<u>-77113</u>	<u>168528</u>

SOLUTION

Aquifer Model: Unconfined

Solution Method: Theis

T = 1.328E+4 ft²/day

S = 0.268

Kz/Kr = 1.

b = 187. ft

Garden City Field Office
4532 W. Jones, Suite B
Garden City, KS 67846



Phone: 620-276-2901
Fax: 620-276-9315
www.agriculture.ks.gov

Mike Beam, Secretary

Laura Kelly, Governor

May 23, 2022

SOUTHWEST KANSAS GROUNDWATER
MANAGEMENT DISTRICT NO. 3
2009 E SPRUCE ST
GARDEN CITY KS 67846

Re: Request for Recommendation
Water Right, File Nos. 643 & 23698

Dear Mr. Norquest:

This is to advise you that Kent Dunn has filed applications for approval of the Chief Engineer, Division of Water Resources, Kansas Department of Agriculture, to change the point of diversion. The applications meet all rules and regulations.

We are delaying action on the change applications to allow you time to review and provide a recommendation. Please submit a recommendation within 15 days from the date of this letter.

Thank you and as always feel free to contact this office at any time.

Sincerely,

A handwritten signature in blue ink, appearing to read "Michael A. Meyer".

Michael A. Meyer
Water Commissioner

MAM
Enclosures