

NOTICE

This scan only represents the application as filed. The information contained herein meets the requirements of K.A.R. 5-3-1 or K.A.R. 5-5-1, and has been found acceptable for filing in the office of the Chief Engineer. The application should not be considered to be a complete application as per K.A.R. 5-3-1b or K.A.R. 5-5-2a.

WATER RESOURCES RECEIVED

NOV 28 2022 2:14

Submit To: CHIEF ENGINEER
Division of Water Resources
Kansas Department of Agriculture
1320 Research Park Drive
Manhattan, Kansas 66502
http://agriculture.ks.gov/dwr

**APPLICATION FOR APPROVAL TO
CHANGE THE PLACE OF USE, THE
POINT OF DIVERSION OR THE USE
MADE OF THE WATER UNDER AN
EXISTING WATER RIGHT**

KS DEPT OF AGRICULTURE



State of Kansas

Filing Fee Must Accompany the Application
(Please refer to Fee Schedule on signature page of application form.)

Paragraph Nos. 1, 2, 3, 4 & 8 must be completed. Complete all other applicable portions. A topographic map or detailed plat showing the authorized and proposed points(s) of diversion and /or place of use must accompany this application.

1. Application is hereby made for approval of the Chief Engineer to change the

- Place of Use
- Point of Diversion
- Use Made of Water

(Check one or more)

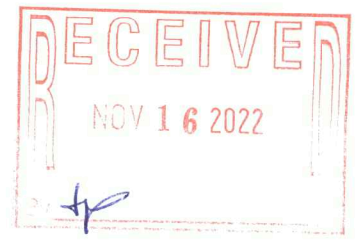

File No. 37093

2. Name of applicant: SKR Land LLC

Address: 695 Kansas 27

City, State and Zip: Sharon Springs KS 67758

Phone Number: (202) 376-8258 (cell) E-mail address: vay.smith@smithlandinc.com

What is your relationship to the water right; owner tenant agent other? If other, please explain. _____

Name of water use correspondent: SKR Land LLC

Address: Same

City, State and Zip: Same

Phone Number: (785) 852-4653 (work) E-mail address: Same

3. The change(s) proposed herein are desired for the following reasons (please be specific): _____

To increase efficiency of water use and provide backup wells in case of break downs.

The change(s) (was) (will be) completed by Mag 2023 (Date)

For Office Use Only:															
F.O. Code	<u>4</u>	GMD	<u>1</u>	Meets K.A.R. 5-5-1	<input checked="" type="checkbox"/> YES / <input type="checkbox"/> NO	Use	<u>IRR</u>	Source	<input type="checkbox"/> G / <input type="checkbox"/> S	County	<u>GL</u>	By	<u>ALB</u>	Date	<u>11/29/22</u>
Code	<u>CPU</u>	Fee \$	<u>200</u>	TR #		Receipt Date	<u>11/28/22</u>	Check #	<u>10017</u>						

12/7/2022
L Moody

4. The presently authorized place of use is:

Owner of Land — NAME: SKR Land LLC

ADDRESS: Same

Sec.	Twp.	Range	NE¼				NW¼				SW¼				SE¼				TOTAL ACRES
			NE¼	NW¼	SW¼	SE¼	NE¼	NW¼	SW¼	SE¼	NE¼	NW¼	SW¼	SE¼	NE¼	NW¼	SW¼	SE¼	
<u>7-16-41</u>			<u>40</u>	<u>40</u>	<u>40</u>	<u>40</u>	<u>40</u>	<u>36.1</u>	<u>36.3</u>	<u>40</u>	<u>40</u>	<u>36.5</u>	<u>36.7</u>	<u>40</u>	<u>40</u>	<u>40</u>	<u>40</u>	<u>625.6</u>	

List any other water rights that cover this place of use. 37095 39231

Owner of Land — NAME: _____

ADDRESS: _____

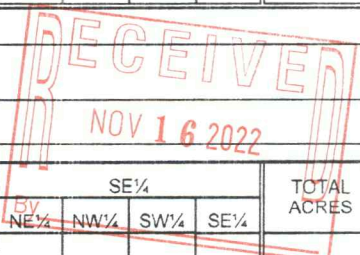

Sec.	Twp.	Range	NE¼				NW¼				SW¼				SE¼				TOTAL ACRES
			NE¼	NW¼	SW¼	SE¼	NE¼	NW¼	SW¼	SE¼	NE¼	NW¼	SW¼	SE¼	NE¼	NW¼	SW¼	SE¼	



List any other water rights that cover this place of use. _____

(If there are more than two landowners, attach additional sheets as necessary.)

KS DEPT OF AGRICULTURE

5. It is proposed that the place of use be changed to:

Owner of Land — NAME: Smith Land Co, Inc.

ADDRESS: 695 Kansas 27 Sharon Springs KS 67758

Sec.	Twp.	Range	NE¼				NW¼				SW¼				SE¼				TOTAL ACRES
			NE¼	NW¼	SW¼	SE¼	NE¼	NW¼	SW¼	SE¼	NE¼	NW¼	SW¼	SE¼	NE¼	NW¼	SW¼	SE¼	
<u>12-16-42</u>			<u>40</u>	<u>40</u>	<u>40</u>	<u>40</u>									<u>40</u>	<u>40</u>	<u>40</u>	<u>40</u>	<u>320</u>

List any other water rights that cover this place of use. 10721 18116

Owner of Land — NAME: SKR Land LLC

ADDRESS: 695 Kansas 27 Sharon Springs KS 67758

Sec.	Twp.	Range	NE¼				NW¼				SW¼				SE¼				TOTAL ACRES
			NE¼	NW¼	SW¼	SE¼	NE¼	NW¼	SW¼	SE¼	NE¼	NW¼	SW¼	SE¼	NE¼	NW¼	SW¼	SE¼	
<u>7-16-41</u>			<u>40</u>	<u>40</u>	<u>40</u>	<u>40</u>	<u>40</u>	<u>36.1</u>	<u>36.3</u>	<u>40</u>	<u>40</u>	<u>36.5</u>	<u>36.7</u>	<u>40</u>	<u>40</u>	<u>40</u>	<u>40</u>	<u>625.6</u>	

List any other water rights that cover this place of use. 37095 39231

IF MORE SPACE IS NEEDED, ATTACH ADDITIONAL SHEETS AS NECESSARY

WATER RESOURCES RECEIVED

NOV 28 2022

KS DEPT OF AGRICULTURE

RECEIVED
NOV 30 2022
By

- 6. The presently authorized point(s) of diversion (is) (are) _____
(Provide description and number of points)
- 7. The proposed point(s) of diversion (is) (are) _____
(Provide description and number of points)

List all presently authorized point(s) of diversion:

8. **Presently authorized point of diversion:**

One in the CN Quarter of the Section Quarter of the _____ Quarter
of Section 7, Township 16 South, Range 41 (E/W),
in Greeley County, Kansas, 5250 feet North 2750 feet West of Southeast corner of section.
Authorized Rate 1010 Authorized Quantity 417
(DWR use only: Computer ID No. _____ GPS _____ feet North _____ feet West)
 This point will not be changed This point will be changed as follows:
Proposed point of diversion: (Complete only if change is requested)
One in the _____ Quarter of the _____ Quarter of the _____ Quarter
of Section _____, Township _____ South, Range _____ (E/W),
in _____ County, Kansas, _____ feet North _____ feet West of Southeast corner of section.
Proposed Rate _____ Proposed Quantity _____
This point is: Additional Well Geo Center List other water rights that will use this point _____

9. **Presently authorized point of diversion:**

One in the NE Quarter of the NW Quarter of the SE Quarter
of Section 7, Township 16 South, Range 41 (E/W),
in Greeley County, Kansas, 2620 feet North 1430 feet West of Southeast corner of section.
Authorized Rate 880 Authorized Quantity 400
(DWR use only: Computer ID No. _____ GPS _____ feet North _____ feet West)
 This point will not be changed This point will be changed as follows:
Proposed point of diversion: (Complete only if change is requested)
One in the _____ Quarter of the _____ Quarter of the _____ Quarter
of Section _____, Township _____ South, Range _____ (E/W),
in _____ County, Kansas, _____ feet North _____ feet West of Southeast corner of section.
Proposed Rate _____ Proposed Quantity _____
This point is: Additional Well Geo Center List other water rights that will use this point _____

10. **Presently authorized point of diversion:**

One in the NW Quarter of the NE Quarter of the SW Quarter
of Section 7, Township 16 South, Range 41 (E/W),
in Greeley County, Kansas, 2560 feet North 3408 feet West of Southeast corner of section.
Authorized Rate 1100 Authorized Quantity 403
(DWR use only: Computer ID No. _____ GPS _____ feet North _____ feet West)
 This point will not be changed This point will be changed as follows:
Proposed point of diversion: (Complete only if change is requested)
One in the _____ Quarter of the _____ Quarter of the _____ Quarter
of Section _____, Township _____ South, Range _____ (E/W),
in _____ County, Kansas, _____ feet North _____ feet West of Southeast corner of section.
Proposed Rate _____ Proposed Quantity _____
This point is: Additional Well Geo Center List other water rights that will use this point _____

- 11. Describe the current condition of and future plans for any point(s) of diversion which will no longer be used. _____

IF MORE SPACE IS NEEDED, ATTACH ADDITIONAL SHEETS AS NECESSARY

6. The presently authorized point(s) of diversion (is) (are) _____
(Provide description and number of points)

NOV 28 2002

7. The proposed point(s) of diversion (is) (are) _____
(Provide description and number of points)

KS DEPT OF AGRICULTURE

List all presently authorized point(s) of diversion:

8. **Presently authorized point of diversion:**
 One in the NE Quarter of the SE Quarter of the NE Quarter of Section 12, Township 16 South, Range 42 (E/W), in Greeley County, Kansas, _____ feet North _____ feet West of Southeast corner of section.
 Authorized Rate 1490 Authorized Quantity 640
 (DWR use only: Computer ID No. _____ GPS _____ feet North _____ feet West)
 This point will not be changed This point will be changed as follows:
Proposed point of diversion: (Complete only if change is requested)
 One in the _____ Quarter of the _____ Quarter of the _____ Quarter of Section _____, Township _____ South, Range _____ (E/W), in _____ County, Kansas, _____ feet North _____ feet West of Southeast corner of section.
 Proposed Rate _____ Proposed Quantity _____
 This point is: Additional Well Geo Center List other water rights that will use this point _____

9. **Presently authorized point of diversion:**
 One in the NE Quarter of the SE Quarter of the NE Quarter of Section 12, Township 16 South, Range 42 (E/W), in Greeley County, Kansas, _____ feet North _____ feet West of Southeast corner of section.
 Authorized Rate 1490 Authorized Quantity 640
 (DWR use only: Computer ID No. _____ GPS _____ feet North _____ feet West)
 This point will not be changed This point will be changed as follows:
Proposed point of diversion: (Complete only if change is requested)
 One in the _____ Quarter of the _____ Quarter of the _____ Quarter of Section _____, Township _____ South, Range _____ (E/W), in _____ County, Kansas, _____ feet North _____ feet West of Southeast corner of section.
 Proposed Rate _____ Proposed Quantity _____
 This point is: Additional Well Geo Center List other water rights that will use this point _____

10. **Presently authorized point of diversion:**
 One in the _____ Quarter of the _____ Quarter of the _____ Quarter of Section _____, Township _____ South, Range _____ (E/W), in _____ County, Kansas, _____ feet North _____ feet West of Southeast corner of section.
 Authorized Rate _____ Authorized Quantity _____
 (DWR use only: Computer ID No. _____ GPS _____ feet North _____ feet West)
 This point will not be changed This point will be changed as follows:
Proposed point of diversion: (Complete only if change is requested)
 One in the _____ Quarter of the _____ Quarter of the _____ Quarter of Section _____, Township _____ South, Range _____ (E/W), in _____ County, Kansas, _____ feet North _____ feet West of Southeast corner of section.
 Proposed Rate _____ Proposed Quantity _____
 This point is: Additional Well Geo Center List other water rights that will use this point _____

11. Describe the current condition of and future plans for any point(s) of diversion which will no longer be used. _____

IF MORE SPACE IS NEEDED, ATTACH ADDITIONAL SHEETS AS NECESSARY

Any use of water that is not as authorized by the water right or permit to authorize water **before** the chief engineer approves this application is a violation of the Kansas Water Appropriation Act for which criminal or civil penalties may be assessed. Such violation is a class C misdemeanor, punishable by a fine not to exceed \$500 and/or a term of confinement not to exceed one month in the county jail. K.S.A. 82a-728(b). Civil penalties shall be not less than \$100 nor more than \$1,000 per violation. In the case of a continuing violation, each day such violation continues may be deemed a separate violation. In addition to these penalties the water right may be modified or suspended. K.S.A. 82a-737, as amended.

The application must be signed by all owners of the place of use authorized under the water right and his or her spouse, if married. Please indicate if there is no spouse. If land is being purchased under contract, the seller must sign as landowner until such time as the contract is completed.

In the event that all applicants cannot appear before one notary public, they may as necessary sign separate copies of the application before any notary public conveniently available to them. All copies signed in this manner shall be considered to be valid parts of the application.

If the request is signed on behalf of any Owner by someone with legal authority to do so (for example, an agent, one who has power of attorney, or an executor, executrix, conservator), it will be necessary to attach proper documents showing such authority.

I declare that I am an owner of the currently authorized place of use as identified herein, or that I represent all such owners and am authorized to make this application on their behalf, and declare further that the statements contained herein are true, correct, and complete. By filing this application I authorize the chief engineer to permanently reduce the quantity of water and/or rate of diversion as specified in sections 14 and 15 of this application.

Dated at Sharon Springs, Kansas, this 16th day of November, 2022.

Ray Smith (Owner) None (Spouse)

Ray P. Smith (Please Print) (Please Print)

(Owner) (Spouse)

(Please Print) (Please Print)

(Owner) (Spouse)

(Please Print) (Please Print)

WATER RESOURCES RECEIVED NOV 28 2022 KS DEPT OF AGRICULTURE

State of Kansas }
County of Wallace } SS



I hereby certify that the foregoing application was signed in my presence and sworn to before me this 16 day of NOV, 2022.

Tammie L. Robben
Notary Public

My Commission Expires Oct. 2, 2025

FEE SCHEDULE

Each application to change the place of use, the point of diversion or the use made of the water under this section shall be accompanied by the application fee set forth in the schedule below:

- (1) Application to change a point of diversion 300 feet or less \$100
- (2) Application to change a point of diversion more than 300 feet \$200
- (3) Application to change the place of use \$200
- (4) Application to change the use made of the water \$300

Make check payable to **Kansas Department of Agriculture.**

10771 & 18116 Old Place of Use

37093, 37095 & 39231 Old Place of Use

NOV 28 2022

KS DEPT OF AGR CULTURE

E 1/2 12-16-42

Points of Diversion

Sec 7-16-41

WATER RESOURCES RECEIVED

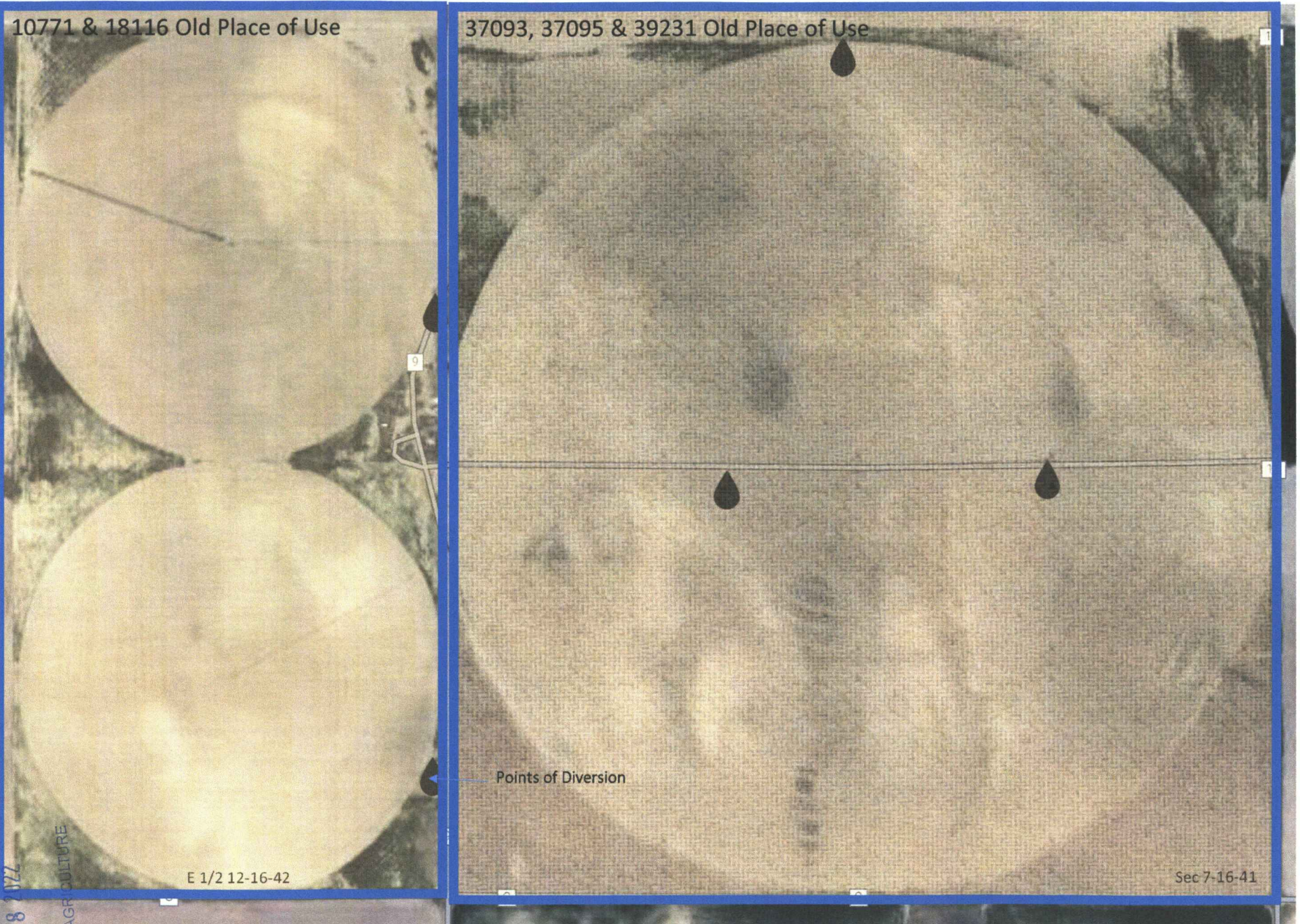

10771, 18116, 37093, 37095 & 39231 New Combined Place of Use

10

10

9

9

Points of Diversion

E 1/2 12-16-42

Sec 7-16-41

SOURCES

8 2022

CULTURE



1320 Research Park Drive
Manhattan, KS 66502
785-564-6700
www. agriculture.ks.gov



900 SW Jackson, Room 456
Topeka, KS 66612
785-296-3556

Mike Beam, Secretary

Laura Kelly, Governor

December 5, 2022

SKR LAND LLC
695 KANSAS 27
SHARON SPRINGS KS 67758

RE: File No(s). **37093**

Dear Sir or Madam:

The Division of Water Resources (Division) has received your application(s) to change the place of use, point of diversion or use made of water for the file number(s) referenced above. Please be aware that the Division may have a large number of pending applications on hand at times and makes every attempt to process them in the order in which they are received. You will be contacted if additional information is required.

Please note, this letter only acknowledges receipt of your application(s) and does not guarantee approval. In accordance with the provisions of the Kansas Water Appropriation(s) Act, the use of water as proposed prior to approval of the application(s) is unlawful.

Additional information about the process may be found on our website at agriculture.ks.gov/divisions-programs/dwr. If you have any other questions, please contact our office at 785-564-6640 or your local Garden City Field Office at 620-276-2901. If you call, please reference the file number so we can help you more efficiently.

Sincerely,

Kristen Baum
New Applications and Changes Supervisor
Water Appropriation Program