

Kansas Department of Agriculture
 Division of Water Resources
CHANGE: P/D WORKSHEET

1. File Number: 15262	2. Status Change Date:	3. Change Num: C1	4. Field Office: 4	5. GMD: 3
6. Status: <input checked="" type="checkbox"/> Approved <input type="checkbox"/> Denied by DWR/GMD <input type="checkbox"/> Dismiss by Request/Failure to Return				7. Filing Date of Change: 2/3/2023
8a. Applicant(s) New to system <input type="checkbox"/> RUSTIN SEGER 4469 NORTH BIG BOW GRADE JOHNSON, KS 67855		Person ID 67381 Add Seq# _____	8c. Landowner(s) New to system <input type="checkbox"/> Person ID _____ Add Seq# _____	
8b. Landowner(s) New to system <input type="checkbox"/> 8a		Person ID _____ Add Seq# _____	8d. WUC New to system <input type="checkbox"/> 8a	
9. Documents and Enclosure(s): <input checked="" type="checkbox"/> DWR Meter(s) Date to Comply: 12/31/2023 <input checked="" type="checkbox"/> N & P Date to Comply: 3/1/2024				
<input type="checkbox"/> Anti-Reverse Meter <input type="checkbox"/> Meter Seal <input checked="" type="checkbox"/> Check Valve <input checked="" type="checkbox"/> N & P Form <input checked="" type="checkbox"/> Water Tube <input checked="" type="checkbox"/> Driller Copy <input checked="" type="checkbox"/> H & E Letter <input type="checkbox"/> Conservation Plan Date Required: _____ Date Approved: _____ Date to Comply: _____				
10. Use Made of Water From: _____ To: _____				
Date Prepared: 3/13/2023 By: AM Date Entered: _____ By: _____				

File No. **15262** 11. County: **ST** Basin: **N F CIMARRON RIVER** Stream: Formation Code: **211/331** Special Use:

12. Points of Diversion
 CHK
 MOD
 DEL PDIV
 ENT
 Qualifier S T R ID 'N 'W Comment (AKA Line) Rate gpm Quantity af Additional Rate gpm Quantity af Overlap PD Files

DEL 51975

ENT SW SW NW 3 30S 39W 2798 5138 2000 320 0 320 15261

13. Storage: Rate _____ NF Quantity _____ ac/ft Additional Rate _____ NF Additional Quantity _____ ac/ft

14. Limitation: _____ af/yr at **2000** gpm (**4.46** cfs) when combined with file number(s) **15261 (NO CHANGE)**
 Limitation: _____ af/yr at _____ gpm (_____ cfs) when combined with file number(s) _____

15. 5YR Allocation: Allocation Type _____ Start Year _____ 5 YR Amount _____ Amount Unit _____ Base Acres _____ Comment _____

16. Place of Use CHK MOD DEL ENT	PUSE	S	T	R	ID	NE¼				NW¼				SW¼				SE¼				Total	Owner	Chg?	Overlap Files
						NE ¼	NW ¼	SW ¼	SE ¼	NE ¼	NW ¼	SW ¼	SE ¼	NE ¼	NW ¼	SW ¼	SE ¼	NE ¼	NW ¼	SW ¼	SE ¼				
CHK 40663																									

Base Acres: Year: Minimum Reasonable Quantity:

Comments:

Garden City Field Office
4532 W. Jones, Suite B
Garden City, KS 67846



Phone: 620-276-2901
Fax: 620-276-9315
www.agriculture.ks.gov

Mike Beam, Secretary

Laura Kelly, Governor

March 13, 2023

RUSTIN SEGER
4469 NORTH BIG BOW GRADE
JOHNSON, KS 67855

RE: Filed Office Application for Change
Water Right, File No. 15261 & 15262

Dear Sir or Madam:

Enclosed is the order executed by the designee of the Chief Engineer, Division of Water Resources, Kansas Department of Agriculture, approving the application for change under the above referenced file number.

Your attention is directed to the enclosures and to the terms, conditions, and limitations specified in this approval for change. A condition of this approval is that an acceptable water flow meter must be installed on the diversion works authorized under the referenced file number and meet current specifications. Please return the required notification of completion of the diversion works and installation of the required meter as soon as these actions are completed.

Since the order modifies the original document referred to above, it should be recorded with the Register of Deeds as other instruments affecting real estate.

The abandoned well must be plugged in accordance with the requirements of Article 30 of the Rules and Regulations as adopted by the Kansas Department of Health and Environment.

Should you have any questions, please feel free contact this office. If you would prefer, you could arrange an appointment for additional assistance.

Sincerely,

A handwritten signature in blue ink that reads "Austin J. McColloch".

Austin J. McColloch
Assistant Water Commissioner

AM:
enclosures

pc: GMD 3

CERTIFICATE OF SERVICE

On this 13th day of March, 2023, I hereby certify that the foregoing Approval of Application for Change in Point of Diversion, Water Right, File No. 15,261 and 15,262 dated 13th day of March, 2023 was mailed postage prepaid, first class, US mail to the following:

RUSTIN SEGER
4469 NORTH BIG BOW GRADE
JOHNSON, KS 67855

Pc:

GMD 3

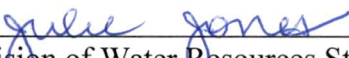

Division of Water Resources Staff

Submit completed application to:
 Kansas Department of Agriculture
 Division of Water Resources
 Field Office for your area.

Call for address:

Topeka -- (785) 296-5733
 Stafford -- (620) 234-5311
 Stockton -- (785) 425-6787
 Garden City -- (620) 276-2901
<http://agriculture.ks.gov/dwr>

DWR FIELD OFFICE APPLICATION FOR APPROVAL TO CHANGE THE PLACE OF USE AND/OR THE POINT OF DIVERSION



STATE OF KANSAS

Filing Fee Must Accompany the Application, K.S.A. 82a-708b(b), as amended.
 Fee Schedule is on the third page of this application form.

Paragraph Nos. 1, 2, 3 & 5 must be completed. Complete all other applicable portions. If change in point of diversion is greater than 100 feet, or if place of use will be changed, include a topographic map or detailed plat showing the authorized and proposed point(s) of diversion and/or place of use.

File No. 15262

RECEIVED
 3:31 pm
 FEB 02 2023

Garden City Field Office
 Division of Water Resources

1. Application is hereby made for approval of the Chief Engineer to change the (check one or both):

Place of Use Point of Diversion

under the water right which is the subject of this application in accordance with the conditions described below.

The source of supply is: Groundwater Surface water

2. Name and address of Applicant: RUSTIN SEGER

4469 NORTH BIG BOW GRADE, JOHNSON, KS 67855

Phone Number: () _____ Email address: _____

Name and address of Water Use Correspondent: Same

Phone Number: () _____ Email address: _____

3. The presently authorized place of use is:

Owner of Land ---- NAME: Same

ADDRESS: _____

(If there is more than one landowner, attach supplemental sheets as necessary.)

Sec.	Twp.	Range	NE¼				NW¼				SW¼				SE¼				TOTAL ACRES		
			NE¼	NW¼	SW¼	SE¼	NE¼	NW¼	SW¼	SE¼	NE¼	NW¼	SW¼	SE¼	NE¼	NW¼	SW¼	SE¼			

4. If this application is for a change in place of use, it is proposed that the place of use be changed to:

Owner of Land ---- NAME: _____

ADDRESS: _____

(If there is more than one landowner, attach supplemental sheets as necessary.)

Sec.	Twp.	Range	NE¼				NW¼				SW¼				SE¼				TOTAL ACRES			
			NE¼	NW¼	SW¼	SE¼	NE¼	NW¼	SW¼	SE¼	NE¼	NW¼	SW¼	SE¼	NE¼	NW¼	SW¼	SE¼				

For Office Use Only: Code _____ Fee \$ 200.00 TR # _____ Receipt Date 2-2-23 Check # 1271

5. **Presently authorized point of diversion:**
 One in the NW Quarter of the NW Quarter of the Lot 4 NW Quarter
 of Section 3 , Township 30 South, Range 39 W,
 in ST County, Kansas, 5250 feet North 5100 feet West of Southeast corner of section.
 Authorized Rate No change Authorized Quantity No change Depth of well _____ (feet)
(DWR use only: Computer ID No. 1 GPS _____ feet North _____ feet West)
 This point will not be changed This point will be changed as follows: No change, point better described with GPS as follows:
Proposed point of diversion: (Complete only if change is requested or if existing point is better described by GPS)
 One in the SW Quarter of the SW Quarter of the NW Quarter
 of Section 3 , Township 30 South, Range 39 W,
 in ST County, Kansas, 2798 feet North 5138 feet West of Southeast corner of section.
 Proposed Rate No change Proposed Quantity No change Proposed well depth (feet) 529.
 This point is: Additional Well Geo Center List other water rights that will use this point _____

6. **Presently authorized point of diversion:**
 One in the _____ Quarter of the _____ Quarter of the _____ Quarter
 of Section _____, Township _____ South, Range _____ (E/W),
 in _____ County, Kansas, _____ feet North _____ feet West of Southeast corner of section.
 Authorized Rate _____ Authorized Quantity _____ Depth of well _____ (feet)
(DWR use only: Computer ID No. _____ GPS _____ feet North _____ feet West)
 This point will not be changed This point will be changed as follows: No change, point better described with GPS as follows:
Proposed point of diversion: (Complete only if change is requested or if existing point is better described by GPS)
 One in the _____ Quarter of the _____ Quarter of the _____ Quarter
 of Section _____, Township _____ South, Range _____ (E/W),
 in _____ County, Kansas, _____ feet North _____ feet West of Southeast corner of section.
 Proposed Rate _____ Proposed Quantity _____ Proposed well depth (feet) _____.
 This point is: Additional Well Geo Center List other water rights that will use this point _____

7. The changes herein are desired for the following reasons?
 (please be specific) _____

8. If a well, is the test hole log attached? Yes No

9. The change(s) (was)(will be) completed by?

10. If the point of diversion is a well:
 (a) What are you going to do with the old well?
Plug / Cap
 (b) When will this be done? _____

11. Groundwater Management District recommendation attached?
 Yes No

12. Assisted by mdf/GCFO

13a. If the proposed point of diversion will be relocated more than 300 feet but within 2,640 feet of the existing point of diversion, attach a topographic map or aerial photograph. For groundwater sources, show all wells (including domestic) within one-half mile of the proposed point of diversion and the names and mailing addresses of the owners. For surface water sources, show the names and addresses of the landowner(s) one-half mile downstream and one-half mile upstream from your property lines

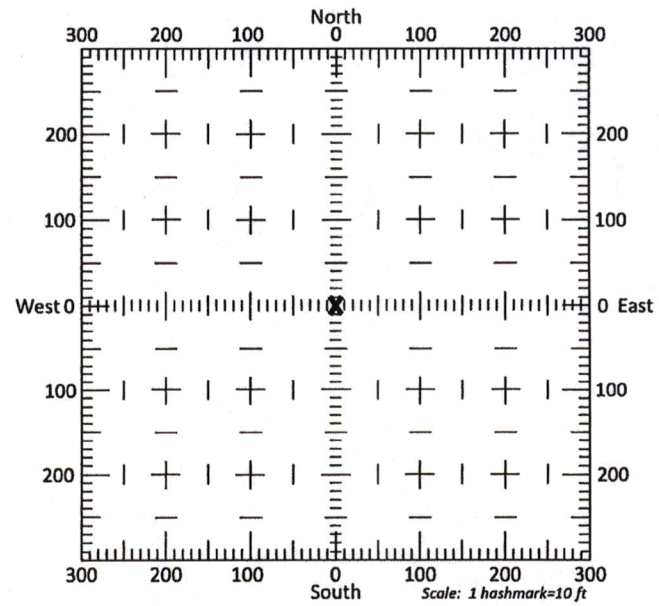

13b. If the proposed point of diversion will be relocated within 300 feet of the existing point of diversion, indicate its location on the diagram shown above in relation to the existing point of diversion. (PLEASE NOTE: The "X" in center of diagram above represents the presently authorized point of diversion.)

14. If the proposed groundwater point of diversion is 300 or fewer feet from the existing point of diversion, complete the following:
- (a) Does the undersigned represent all owners of the currently authorized place(s) of use identified in this application?
 Yes No (If no, all owners must sign this application.)
 - (b) Will the ownership interest of any owner of the currently authorized place(s) of use identified in this application be adversely affected if this application is approved as requested?
 Yes No (If yes, all owners must sign this application.)
 - (c) If this application is not approved expeditiously, will there be substantial damage to property, public health or safety?
 Yes No (If no, all owners must sign this application.)

If the application proposes a surface water change in point of diversion, a groundwater change in point of diversion greater than 300 feet, or a change in place of use, the application must be signed by all owners of the currently authorized place of use, or their duly authorized agent (attach notarized statement authorizing representation).

I hereby verify, being first duly sworn upon my oath or affirmation and under penalty of perjury, that I am of lawful age and the owner, the spouse of the owner, or a duly authorized agent of the owner(s) to make this application on their behalf, in regards to the water right(s) to which this application pertains. I further verify that the statements contained in this application are true, correct and complete.

Dated at _____, Kansas, this _____ day of _____, 20_____.

<p><i>[Signature]</i> _____ (Owner)</p> <p><i>[Signature]</i> Rustin Seeger _____ (Please Print)</p> <p>_____ (Owner)</p> <p>_____ (Please Print)</p> <p>_____ (Owner)</p> <p>_____ (Please Print)</p>	<p>_____ (Spouse)</p> <p>_____ (Please Print)</p> <p>_____ (Spouse)</p> <p>_____ (Please Print)</p> <p>_____ (Spouse)</p> <p>_____ (Please Print)</p>
---	---

State of Kansas }
 County of Stanton } SS

I hereby certify that the foregoing application was signed in my presence and sworn to before me this 2nd day of February, 2023

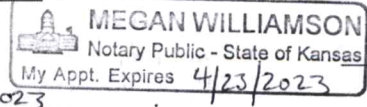

[Signature]

Notary Public

My Commission Expires 4/23/2023

ONLY COMPLETE APPLICATIONS WILL BE PROCESSED. To be complete, all of the applicable portions of the application form must be completed with accurate information; maps, if necessary, must be included; signatures of all the appropriate owners' must be affixed to the application and notarized; and the appropriate fee must be paid.

FEE SCHEDULE

Each application to change the place of use or the point of diversion under this section shall be accompanied by the application fee set forth in the schedule below: **Make checks payable to: Kansas Department of Agriculture**

(1) Application to change a point of diversion 300 feet or less	\$100
(2) Application to change a point of diversion more than 300 feet	\$200
(3) Application to change the place of use	\$200

SUMMARY ORDER APPROVING APPLICATION FOR CHANGE AND IMPOSING CONDITIONS

This Summary Order is issued under authority of K.S.A. 82a-708b, as amended, and K.A.R. 5-5-1, *et seq.* and other applicable provisions of the *Kansas Water Appropriation Law, K.S.A. 82a-701 et. seq.*, and rules and regulations promulgated thereunder. With the exception of those conditions expressly contained herein, this Summary Order does not change the terms, conditions and limitations of File No. 15262.

1. A change application was received on February 3, 2023 requesting that the place of use and / or point of diversion authorized under the above-referenced file number be changed as described in the application.
2. On and after the effective date of this summary order, the authorized place(s) of use shall be located substantially as shown on the topographic map accompanying the application to change the place of use. Applicable Not Applicable
3. The change in point of diversion shall not impair existing rights and shall be limited to the same source or sources of water as previously authorized. The point of diversion authorized by this summary order shall be located within a 300 foot radius of the authorized point(s) of diversion. Applicable Not Applicable
4. The point(s) of diversion described herein is administratively corrected to be more accurately described using the Global Positioning System (GPS), as described in the application. Applicable Not Applicable
5. The point(s) of diversion authorized herein shall not actually be located more than 2640 feet from the previously authorized point(s) of diversion. Applicable Not Applicable
6. As required by K.A.R. 5-3-5d, if the works for diversion is a well with a diversion rate of 100 gallons per minute or more, a tube or other device suitable for making water level measurements shall be installed, operated and maintained in accordance with K.A.R. 5-6-13. Applicable Not Applicable
7. The owner of the authorized place(s) of use shall properly install an acceptable water flow meter on or before December 31, 2023, or before the first use of water, whichever occurs first. The water flow meter shall be installed, operated and maintained in accordance with K.A.R. 5-1-4 through 5-1-12. As required by K.S.A. 82a-732, as amended, and K.A.R. 5-3-5e, the owner shall maintain records and report the reading of the water flow meter and the total quantity of water diverted annually to the Chief Engineer by March 1 following the end of each calendar year. Applicable Not Applicable
8. Installation of the works for diversion of water shall be completed on or before December 31, 2023, or within any authorized extension of time. By March 1, 2024 the applicant shall notify the Chief Engineer that construction of the works for diversion has been completed, on the form provided by the Chief Engineer, as required by K.A.R. 5-8-4e. Applicable Not Applicable
9. The completed well log shall be submitted with the required notice. Applicable Not Applicable
10. All diversion works into which any type of chemical or other foreign substance will be injected into the water shall be equipped with an in-line, automatic, quick-closing check valve capable of preventing pollution of the source of the water supply. The check valve(s) shall be installed, operated and maintained in accordance with K.A.R. 5-3-5c. Applicable Not Applicable
11. Additional Conditions are attached. Yes No
12. In accordance with K.S.A. 82a-708a, as amended, and K.A.R. 5-5-14, all of the owners of the authorized place(s) of use of water appropriated under the above-referenced file number are responsible for compliance with its terms, conditions and limitations, as amended and/or supplemented by this Summary Order, and with applicable provisions of the *Kansas Water Appropriation Law* and the *Rules and Regulations* promulgated thereunder. Failure to comply with these provisions may result in civil penalties pursuant to K.S.A. 82a-737, as amended, and/or the suspension or revocation and dismissal of the water or appropriation right or any other enforcement actions authorized by law.

Administrative Appeal and Effective Date of Order

If you are aggrieved by this order, pursuant to K.S.A. 82a-1901, you may request an evidentiary hearing before the Chief Engineer or request administrative review by the Secretary of Agriculture. A request for hearing by the Chief Engineer must be filed within **15 days** of service of this Order and a request for administrative review by the Secretary must be filed within **30 days** pursuant to K.S.A. 77-531. Any request for administrative review must state a basis for review pursuant to K.S.A. 77-527. File any request with **Kansas Department of Agriculture, Legal Division, 1320 Research Park Drive, Manhattan, KS 66502**. Failure to timely request a hearing or review may preclude review under the Kansas Judicial Review Act.

For Use by Register of Deeds

FOR OFFICE USE ONLY
APPLICATION APPROVED AND SUMMARY ORDER ISSUED

By: Austin McCulloch
Duly Authorized Designee of the Chief Engineer

(Print Name): Austin McCulloch
Division of Water Resources - Kansas Department of Agriculture

Date of Issuance: March 13, 2023

State of Kansas)
County of Winney) SS

Acknowledged before me on March 13, 2023
by Austin McCulloch

Signature: Julie Jones
Notary Public

My commission expires:

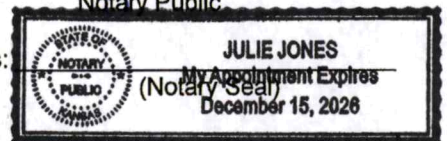

Rusty Seger

Test Hole # 2 of 1-17-23,

NW 3-30-39 ST

FILE # 15262

Legend

 37.46858 N 101.57993 W

 37.46858 N 101.57993 W

RECEIVED
MAY 17 2011
Carter-Voy Field Office
Division of Wildlife Management



Google Earth

3000 ft

Change in point of diversion for water right 15262

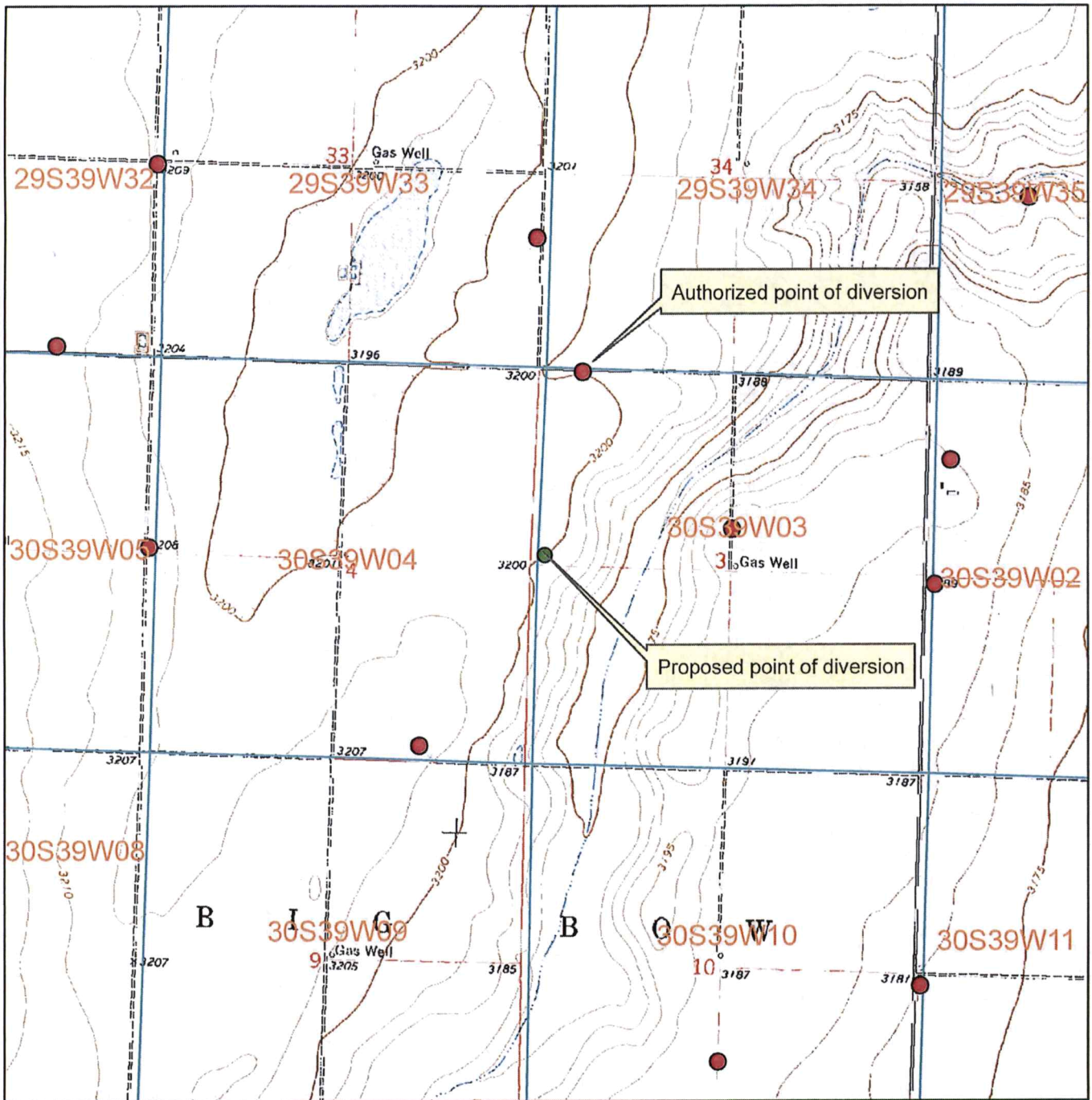

● Authorized point of diversion

● Proposed point of diversion

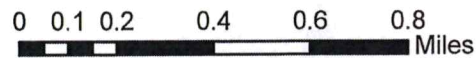

All wells within 1/2 mile are on this map.

X _____

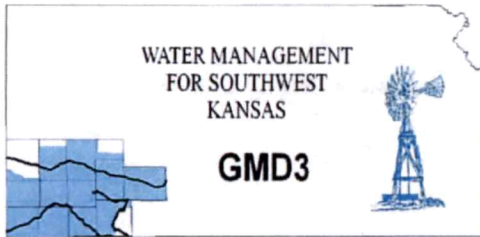

Southwest Kansas
Groundwater Management District No. 3
2009 E. Spruce Street
Garden City, Kansas 67846
(620) 275-7147 phone
www.gmd3.org

March 10, 2023

RECEIVED

MAR 10 2023

Austin McColloch
Division of Water Resources
4532 W Jones Ave., Suite B
Garden City, Kansas 67846

Garden City Field Office
Division of Water Resources

RE: Applications for Change in Point of Diversion
Water Right, File Nos. 15261 & 15262

Dear Austin:

We have completed a review of the applications for the above referenced water rights. The proposed change in point of diversion is in accordance with current area rules, K.A.R. 5-23-3, as it pertains to minimum spacing to neighboring wells and distance moved.

Well evaluations were conducted to estimate possible effects of the proposal on the supply of other wells with water rights prior to the proposal per K.S.A. 82a-708b, and the management program. Under K.S.A. 82a-708b, an applicant requesting a change in point of diversion must demonstrate to the chief engineer that any proposed change is reasonable and will not impair. The enclosed report is an analysis performed by the GMD on behalf of our membership. Under this analysis, the proposed change is considered to be reasonable and unlikely to impair if either the net in-season well-to-well effect of the proposed change is less than a strict maximum allowable threshold (3.0 ft with saturated thickness is between 125-150ft), or if no well with a net well-to-well effect exceeding the threshold is identified as critical. Critical wells are identified as wells that are expected to either lose or greatly diminish water supply over the next 25 years. The attached review information is based on a Theis analysis using inputs from the GMD3 aquifer model, which is considered to be the best information on well and aquifer data readily and easily available to the public. If either the applicant or the neighbors believe they have better data that might change the result of the analysis, they should contact GMD3. Conclusions of the well analysis may change if better information on well and aquifer data can be made available.

Every neighboring well within 1 mile of the proposed move was evaluated. Evaluations showed that none of the neighboring wells exceeded the net effect above the maximum allowable threshold and needed no further evaluation. No critical wells were determined in the area. We did not receive any comments from neighboring well owners. Therefore, GMD3 sees this move as meeting current area rules and would recommend approval. If aquifer conditions change or there is a change to the water right in the future, we would be happy to evaluate the effects at that time.

Thank you for the opportunity to review the applications and to provide a recommendation. If you have any questions, please don't hesitate to contact us.

Sincerely,

A handwritten signature in blue ink, appearing to read "Jason L. Norquest".

Jason L. Norquest
Assistant Manager

GMD3 Change Review

File No(s): 15261 & 15262.

DWR office: GC.

App filed to change: PD.

Is Landowner(s) correct in WRIS: Rustin Seger.

If NO, is documentation included?

Is Water Use Correspondent correct in WRIS? __.

If NO, is documentation included?

Regulation(s) Reviewed: KAR 5-23-3

Point of diversion ID No(s) 01 being changed.

	ft. North	ft. West	
Authorized PD	5250	5100	Sect 3-30-39
Proposed PD	2798	5138	
Difference	2452 s	-38	
a2 + b2 = c2	6012304	1444	2452.294 foot move south

GPS for proposed PD: Lat: 37.46858 Long: -101.57993.

Is proposed PD stacking on existing WRs? Keep existing overlap.

Is Proposed PU overlapping existing WRs? No Change.

Neighboring certified well(s) notified: __.

Name Douglas F Douglas (7530).

Address 8817 W Iliff Ave.

Zip Lakewood, CA 80227.

Email: dtwalker@pld.com Phone: 620-492-2506.

Name Milton E Julian %Melody Julian (9426).

Address 3416 Hayford Ave.

Zip Laramie, WY 82072.

Email: melron@pridev.org Phone: 620-353-9206.

Name G & N Barstow LLC (28635).

Address PO Box 54864.

Zip Hurst, TX 76054.

Email: nbbarstow@yahoo.com Phone: 903-875-8135.

Domestic well(s) notified: One domestic is in relation to applicant.

Name __.

Address __.

Zip __.

Base Acres: __.

Perfected Acres: __.

Irr. Return-Flow __%

GMD3 Change Review

Stanton County

15261 authorized: 320AF @ 2000gpm

15262 authorized: 320AF @ 2000gpm, limited to 2000gpm

Average reported WUR (2012-2021): 498.4AF/year

1100gpm reported on 2020 WUR

2019 GMD3 inspection calculated 1049gpm

Proposed depth of 529'

Is a waiver needed: Move is less than half mile. Minimum spacing to neighboring wells appears to be met. Analysis of the proposed showed that possible effects to the area are within guidelines if pumped at maximum authority.

Recommendation: After review of all available information, it appears current area rules are met. Staff therefore recommends approval of the applications.

A handwritten signature in black ink, appearing to be the initials 'JPL' or similar, written in a cursive style.

Water Rights and Points of Diversion Within 1 mile of point defined as:

2798 Feet N and 5138 Feet W of the Southeast Corner of Section 3 Twp 30S Rng 39W
 Located at: 101.579931 West Longitude and 37.468581 North Latitude
 Both SURFACE WATER and GROUNDWATER

2300' on A11

File Number	Use	ST	SR	Dist (ft)	Q4	Q3	Q2	Q1	FeetN	FeetW	Sec	Twp	Rng	ID	Batt	Auth_Quan	Add_Quan	
A__ AF	7530 00	IRR	NK	G	3006	SE	SW	SE	248	1366	4	30	39W	4		640.00	640.00	
A__ AF	9426 00	IRR	NK	G	5103	SW	SW	NW	-----	-----	4	30	39W	1		320.00	320.00	
A__ AF	15261 00	IRR	NK	G*	2469	--	--	NW	NW	5250	5100	3	30	39W	1		320.00	320.00
A__ AF	15262 00	IRR	NK	G*	2469	--	--	NW	NW	5250	5100	3	30	39W	1		320.00	320.00
A__ AF	17132 00	IRR	NK	G	4205	CE	SE	NE	SE	1700	75	33	29	39W	2		312.00	312.00
A__ AF	28635 00	IRR	NK	G	2557	CW	SW	NE	3141	2607	3	30	39W	2		458.00	458.00	

640.00

Total Net Quantities Authorized:	Direct	Storage
Total Requested Amount (AF) =	.00	.00
Total Permitted Amount (AF) =	.00	.00
Total Inspected Amount (AF) =	.00	.00
Total Pro_Cert Amount (AF) =	.00	.00
Total Certified Amount (AF) =	2370.00	.00
Total Vested Amount (AF) =	.00	.00
TOTAL AMOUNT (AF) =	2370.00	.00

*Minimum spacing
Appears MET.*

An * after the source of supply indicates a pending application for change under the file number.
 An * after the ID indicates a 15 AF exemption was granted under the file number.
 A "G" in the Batt column indicates the GEO CTR of a battery. A "B" indicates a well in the battery.
 The number in the Batt column is the number of wells in the battery.

Water Rights and Points of Diversion Within 1 mile of point defined as:

2798 Feet North and 5138 Feet West of the Southeast Corner of Section 3 Twp 30S Rng 39W
 Located at: 101.579931 West Longitude and 37.468581 North Latitude
 Both SURFACE WATER and GROUNDWATER
 WATER USE CORRESPONDENTS:

- > File Number Use ST SR
- > DOUGLAS F DOUGLAS
- > 8817 W ILIFF AVE
- > LAKEWOOD CO 80227
- > -----
- > MILTON E JULIAN
- > MELODY JULIAN
- > 3416 HAYFORD AVE
- > LARAMIE WY 82072
- > -----
- > RUSTIN SEGER
- > 4469 NORTH BIG BOW GRADE
- > JOHNSON KS 67855
- > -----
- > RUSTIN SEGER
- > 4469 NORTH BIG BOW GRADE
- > JOHNSON KS 67855
- > -----
- > BRET SEGER

7530

9426

15261

15262

17132

Applications

Applicant

>
> 5023 N BIG BOW GRADE
> JOHNSON KS 67855

> G AND N BARSTOW LLC

>
> PO BOX 54864
> HURST TX 76054

28635

Current PD ^{2m. to} AF allocation = 12 311 AF
Proposed PD = 12 631 AF

So this would cause
further evaluation in
Proposed Rate!

Evaluation of proposed move for Water Right Nos. 15261 & 15262

Proposed: Move water right nos. 15261 & 15262 to a new well location, a distance of 2,497 ft to the southwest.

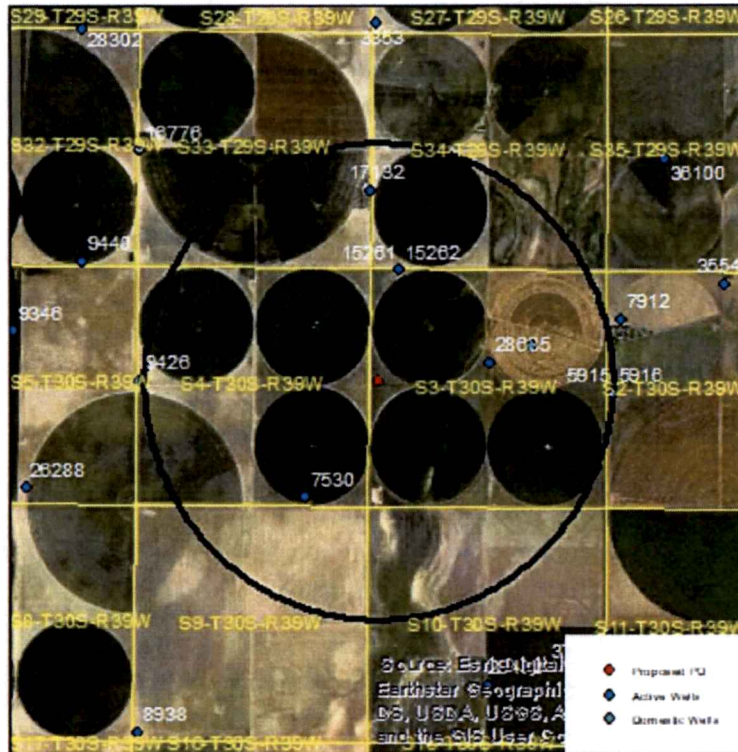

Wells within 1 mile: 17132, 7530, 28635, 5195 & 5196, and a domestic well in section 3-30-39.

The saturated thickness at the proposed well location is estimated to be 132 ft, based upon the GMD3 model. For saturated thickness between 125 ft and 150 ft, the drawdown allowance is 3.0 ft.

50 year Theis Analysis: The following values were used to run the analysis:

$S = 0.2323$, $T = 8309 \text{ ft}^2/\text{day}$, $tp_{\text{current}} = 108 \text{ days}$ (based on average use and observed rate),
 $Q_{\text{current}} = 1049 \text{ gpm}$ (based on 2019 field inspection), $tp_{\text{proposed}} = 72 \text{ days}$, $Q_{\text{proposed}} = 2000 \text{ gpm}$

Theis drawdowns were calculated as follows:

17132:	Drawdown from current location = 4.60 ft
	Drawdown from proposed location = 3.46 ft
	Net drawdown = -1.1 ft
7530:	Drawdown from current location = 2.30 ft
	Drawdown from proposed location = 4.29 ft
	Net drawdown = 2.0 ft

28635: Drawdown from current location = 3.43 ft
Drawdown from proposed location = 4.91 ft
Net drawdown = 1.5 ft

5195 & 5196: Drawdown from current location = 2.28 ft
Drawdown from proposed location = 3.00 ft
Net drawdown = 0.7 ft

Domestic 3-30-39: Drawdown from current location = 3.08 ft
Drawdown from proposed location = 3.87 ft
Net drawdown = 0.8 ft

Net drawdown does not exceed the drawdown allowance of 3.0 ft for any well within 1 mile of the proposed location. Therefore, critical well analysis is not necessary.

Conclusion:

The proposed move is likely to create minimal effects on neighboring wells and appears unlikely to cause impairment. Any concerned neighbors should contact GMD3 at (620) 275-7147 or the Division of Water Resources at (620) 276-2901.

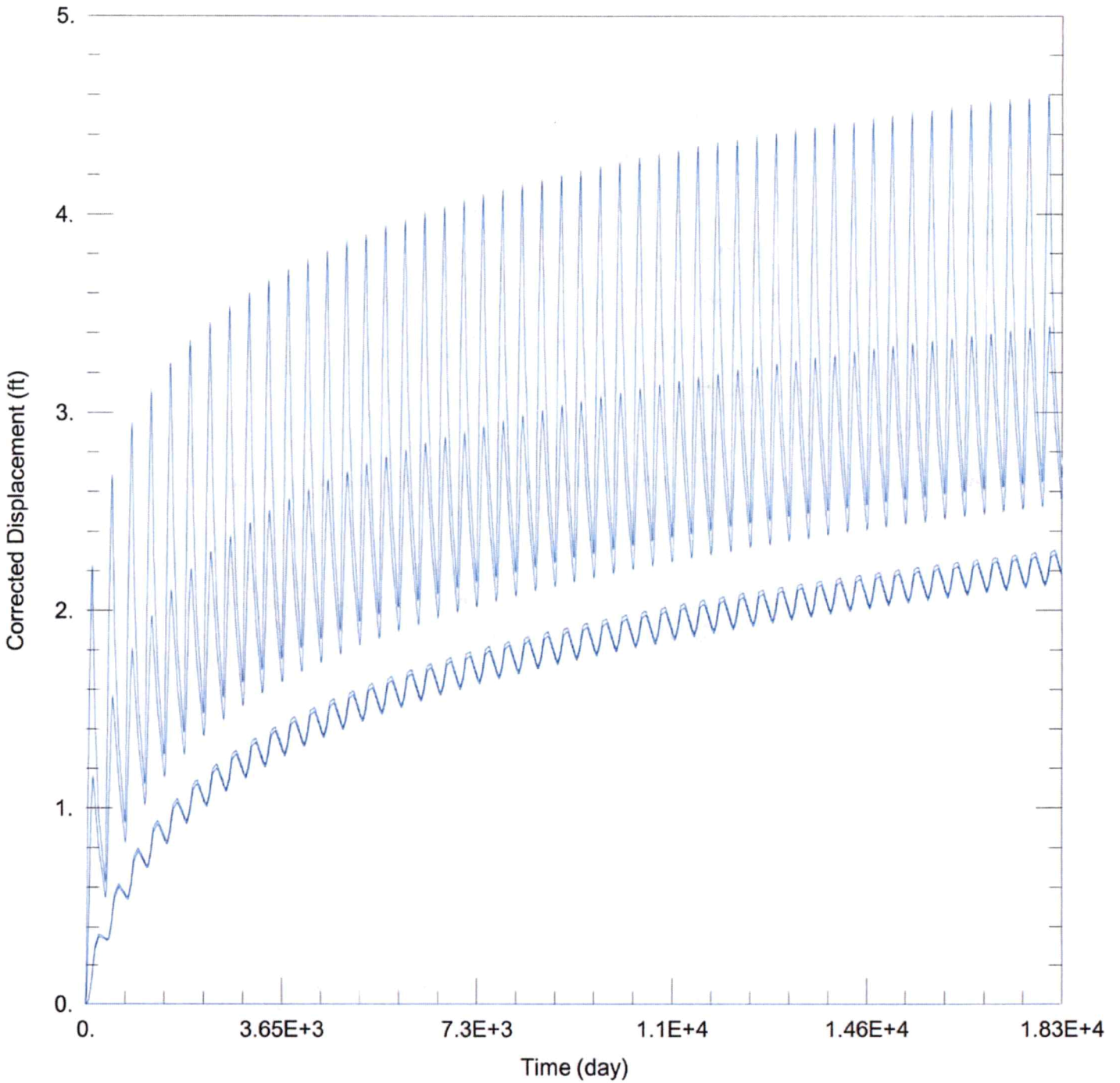

WELL TEST ANALYSIS

Data Set: C:\Users\trevora\Documents\2023_moves\15261_15262\15261 & 15262 Current.aqt
 Date: 03/01/23 Time: 15:03:27

PROJECT INFORMATION

Company: GMD 3
 Project: 15261 & 15262
 Location: Stanton County

WELL DATA

Pumping Wells			Observation Wells		
Well Name	X (ft)	Y (ft)	Well Name	X (ft)	Y (ft)
15261 & 15262	-226054	219520	□	-226054	219520

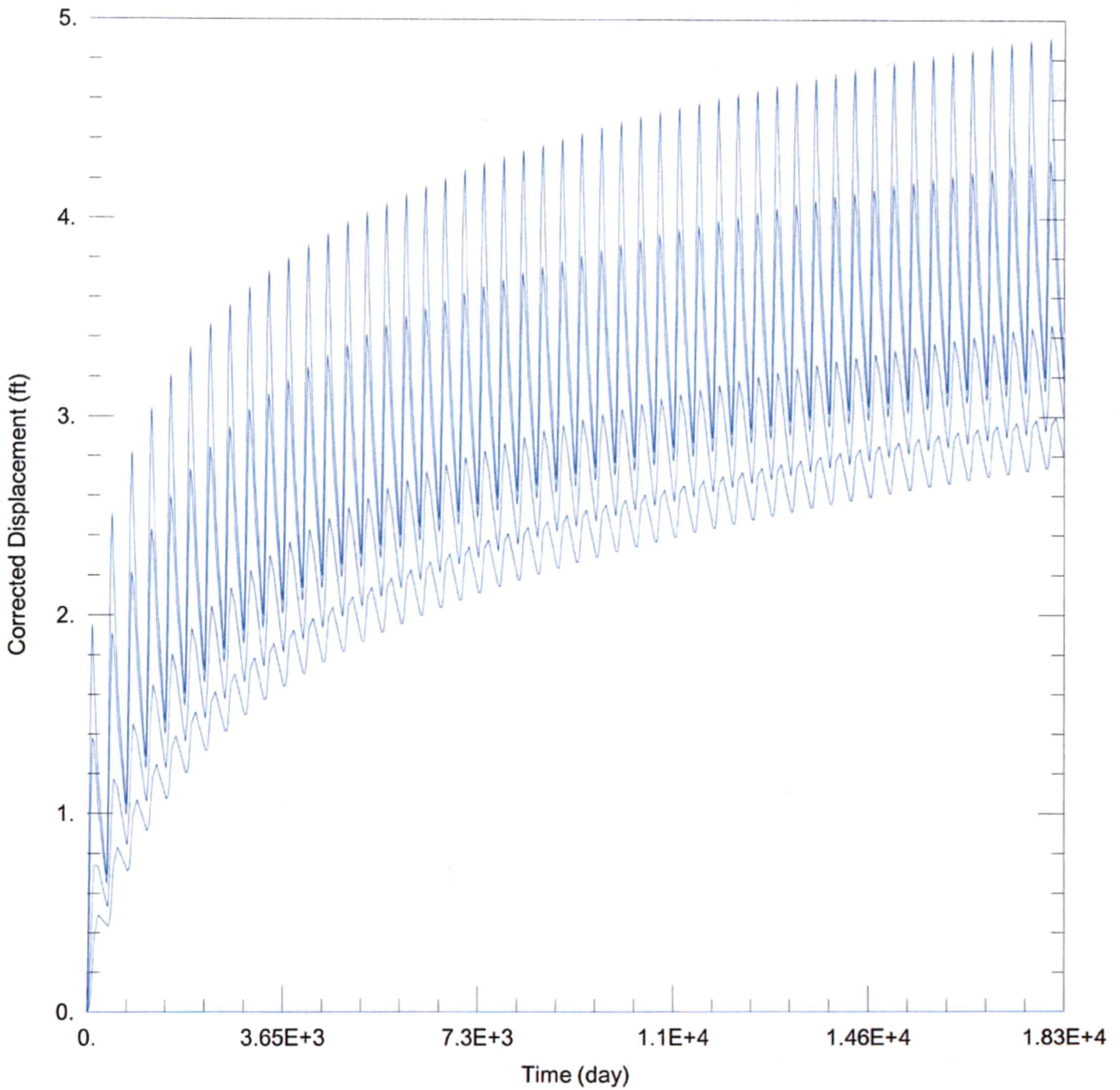

WELL TEST ANALYSIS

Data Set: C:\Users\trevora\Documents\2023_moves\15261_15262\15261 & 15262 Proposed.aqt
 Date: 03/01/23 Time: 15:03:18

PROJECT INFORMATION

Company: GMD 3
 Project: 15261 & 15262
 Location: Stanton County

WELL DATA

Pumping Wells

Well Name	X (ft)	Y (ft)
15261 & 15262	-226516	217066

Observation Wells

Well Name	X (ft)	Y (ft)
□	-226516	217066

Garden City Field Office
4532 W. Jones, Suite B
Garden City, KS 67846



Phone: 620-276-2901
Fax: 620-276-9315
www.agriculture.ks.gov

Mike Beam, Secretary

Laura Kelly, Governor

February 27, 2023

GROUNDWATER MANAGEMENT DISTRICT #3
2009 E SPRUCE ST
GARDEN CITY KS 67846

Re: Request for Recommendation,
File No. 15261 & 15262

Dear Sir or Madam:

We are enclosing a copy of the referenced application, which was submitted by Rustin Seger and appears to be in proper form, for your review.

We are delaying any further action for a period of 15 days from the date of this letter to allow you time to submit your recommendation concerning this application. Please submit your recommendation within the allotted time, or any authorized extension of time thereof.

If you have any questions, please contact me at (620) 276-2901. If you wish to discuss a specific file, please have the file number ready to that I may help you more efficiently.

Sincerely,

A handwritten signature in blue ink that reads "Austin McColloch".

Austin McColloch
Assistant Water Commissioner

Enclosure
pc:

Garden City Field Office
4532 W. Jones, Suite B
Garden City, KS 67846



Phone: 620-276-2901
Fax: 620-276-9315
www.agriculture.ks.gov

Mike Beam, Secretary

Laura Kelly, Governor

February 7, 2023

G AND N BARSTOW LLC
PO BOX 54864
HURST, TX 76054

RE: Application for Change
Water Right, File Nos. 15261 & 15262

Dear Sir or Madam:

This is to advise you that Rustin Seger has filed an application for approval of the Chief Engineer, Division of Water Resources, Kansas Department of Agriculture, to change the point of diversion under the above referenced applications. An irrigation well is proposed to be relocated to the SW $\frac{1}{4}$ SW $\frac{1}{4}$ NW $\frac{1}{4}$ of Section 3, Township 30 South, Range 39 West, Stanton County.

You can find the complete applications posted by water right file number as referenced above at: www.Agriculture.ks.gov/DWRNotices

You are notified on this proposed point of diversion (well) so that you may furnish this office with any comments or other information you want to submit. Such comments or other information must be received in this office within 15 days from the date of this letter.

Should you have any questions, please feel free contact this office. If you would prefer, you could arrange an appointment for additional assistance. Please refer to the file number when you contact us if you wish to discuss a specific file.

Sincerely,

A handwritten signature in black ink, appearing to read "Austin J. McColloch".

Austin J. McColloch
Assistant Water Commissioner

AM:

pc:

SCANNED