

Kansas Department of Agriculture  
 Division of Water Resources  
**CHANGE: P/U WORKSHEET**

1. File Number: <b>21917</b>	2. Status Change Date: <b>3-9-2023</b>	3. Change Num: <b>C2</b>	4. Field Office: <b>4</b>	5. GMD: <b>3</b>
6. Status: <input checked="" type="checkbox"/> Approved <input type="checkbox"/> Denied by DWR/GMD <input type="checkbox"/> Dismiss by Request/Failure to Return				7. Filing Date of Change: <b>2/24/2023</b>
8a. Landowner New to system <input type="checkbox"/>  <b>DARVIN L &amp; LISA M KOEHN 151 ROAD 50 SATANTA, KS 67870-7007</b>		8c. Landowner(s) New to system <input type="checkbox"/>  <b>Person ID <u>34937</u> Add Seq# _____</b>		
8b. Landowner(s) New to system <input type="checkbox"/>  <b>Person ID _____ Add Seq# _____</b>		8d. WUC New to system <input type="checkbox"/>  <b>8a</b>  <b>Person ID _____ Add Seq# _____</b>		
9. Documents and Enclosure(s): <input checked="" type="checkbox"/> DWR Meter(s) Date to Comply: <b>12/31/2023</b> <input type="checkbox"/> N & P Date to Comply: _____ <input type="checkbox"/> Anti-Reverse Meter <input type="checkbox"/> Meter Seal <input checked="" type="checkbox"/> Check Valve <input type="checkbox"/> N & P Form <input type="checkbox"/> Water Tube <input type="checkbox"/> Driller Copy <input type="checkbox"/> H & E Letter <input type="checkbox"/> Conservation Plan    Date Required: _____    Date Approved: _____    Date to Comply: _____				
10. Use Made of Water    From: _____    To: _____				
Date Prepared: <b>3/09/2023</b> By: <b>MAM</b> Date Entered: _____    By: _____				

File No. **21917**      11. County: HS      Basin: **ARKANSAS RIVER**      Stream:      Formation Code:      Special Use:

12. Points of Diversion  
 CHK  
 MOD  
 DEL      PDIV  
 ENT  
 Qualifier      S      T      R      ID      'N      'W      Comment (AKA Line)      Rate gpm/cfs      Quantity af/mgy      Additional Rate gpm/cfs      Quantity af/mgy      Overlap PD Files

**CHK 79506**

13. Storage: Rate \_\_\_\_\_ NF      Quantity \_\_\_\_\_ ac/ft      Additional Rate \_\_\_\_\_ NF      Additional Quantity \_\_\_\_\_ ac/ft

14. Limitation: \_\_\_\_\_ af/yr at \_\_\_\_\_ gpm (\_\_\_\_\_ cfs) when combined with file number(s) \_\_\_\_\_  
 Limitation: \_\_\_\_\_ af/yr at \_\_\_\_\_ gpm (\_\_\_\_\_ cfs) when combined with file number(s) \_\_\_\_\_

15. 5YR Allocation:      Allocation Type \_\_\_\_\_      Start Year \_\_\_\_\_      5 YR Amount \_\_\_\_\_      Amount Unit \_\_\_\_\_      Base Acres \_\_\_\_\_      Comment \_\_\_\_\_

16. Place of Use CHK MOD DEL ENT      PUSE      S      T      R      ID	NE¼				NW¼				SW¼				SE¼				Total	Owner	Chg?	Overlap Files	
	NE ¼	NW ¼	SW ¼	SE ¼	NE ¼	NW ¼	SW ¼	SE ¼	NE ¼	NW ¼	SW ¼	SE ¼	NE ¼	NW ¼	SW ¼	SE ¼					
<b>ENT 14976 30 27 34W 2</b>	34	34	34	34	40	L-1 40.12	L-2 40.35	40	40	L-3 40.59	L-4 40.82	40					457.88	<b>8a</b>	<b>N</b>	<b>27608</b>	
<b>DEL 37958</b>																					

Base Acres:      Year:      Minimum Reasonable Quantity:  
 Comments:

Garden City Field Office  
4532 W. Jones, Suite B  
Garden City, KS 67846



Phone: 620-276-2901  
Fax: 620-276-9315  
www.agriculture.ks.gov

Mike Beam, Secretary

Laura Kelly, Governor

March 9, 2023

DARVIN L & LISA M KOEHN  
151 ROAD 50  
SATANTA, KS 67870-7007

RE: Field Office Application for Change  
Water Right, File Nos. 27608 & 21917

Dear Sir and Madam:

Enclosed are orders executed by the designee of the Chief Engineer, Division of Water Resources, Kansas Department of Agriculture, approving the application for change under the above referenced file numbers.

Your attention is directed to the enclosures and to the terms, conditions, and limitations specified in these approvals for change. A condition of this approval is that an acceptable water flow meter must be installed on the diversion works authorized under the referenced file number and meet current specifications. Please return the required notification of completion of the diversion works and installation of the required meter as soon as these actions are completed.

Since the order modifies the original document referred to above, it should be recorded with the Register of Deeds as other instruments affecting real estate.

Should you have any questions, please feel free contact this office. If you would prefer, you could arrange an appointment for additional assistance.

Sincerely,

A handwritten signature in blue ink that reads "Michael A. Meyer".

Michael A. Meyer  
Water Commissioner

MAM:  
Enclosures

pc: GMD3

**CERTIFICATE OF SERVICE**

On this 10<sup>th</sup> day of March 2023, I hereby certify that the foregoing Approval of Application for Change in Point of Diversion, Water Right, File Nos. 27,608 and 21,917 dated 9<sup>th</sup> day of March 2023 was mailed postage prepaid, first class, US mail to the following:

DARVIN L & LISA M KOEHN  
151 ROAD 50  
SATANTA, KS 67870-7007

**Pc:**

GMD3



---

Division of Water Resources Staff



5. **Presently authorized point of diversion:**  
 One in the \_\_\_\_\_ Quarter of the \_\_\_\_\_ Quarter of the \_\_\_\_\_ Quarter  
 of Section \_\_\_\_\_, Township \_\_\_\_\_ South, Range \_\_\_\_\_ W,  
 in \_\_\_\_\_ County, Kansas, \_\_\_\_\_ feet North \_\_\_\_\_ feet West of Southeast corner of section.  
 Authorized Rate \_\_\_\_\_ Authorized Quantity \_\_\_\_\_ Depth of well \_\_\_\_\_ (feet)  
**(DWR use only: Computer ID No. 1 \_\_\_\_\_ GPS \_\_\_\_\_ feet North \_\_\_\_\_ feet West)**  
 This point will not be changed  This point will be changed as follows:  No change, point better described with GPS as follows:  
**Proposed point of diversion: (Complete only if change is requested or if existing point is better described by GPS)**  
 One in the \_\_\_\_\_ Quarter of the \_\_\_\_\_ Quarter of the \_\_\_\_\_ Quarter  
 of Section \_\_\_\_\_, Township \_\_\_\_\_ South, Range \_\_\_\_\_ W,  
 in \_\_\_\_\_ County, Kansas, \_\_\_\_\_ feet North \_\_\_\_\_ feet West of Southeast corner of section.  
 Proposed Rate \_\_\_\_\_ Proposed Quantity \_\_\_\_\_ Proposed well depth (feet) \_\_\_\_\_  
 This point is:  Additional Well  Geo Center List other water rights that will use this point \_\_\_\_\_

6. **Presently authorized point of diversion:**  
 One in the \_\_\_\_\_ Quarter of the \_\_\_\_\_ Quarter of the \_\_\_\_\_ Quarter  
 of Section \_\_\_\_\_, Township \_\_\_\_\_ South, Range \_\_\_\_\_ W,  
 in \_\_\_\_\_ County, Kansas, \_\_\_\_\_ feet North \_\_\_\_\_ feet West of Southeast corner of section.  
 Authorized Rate \_\_\_\_\_ Authorized Quantity \_\_\_\_\_ Depth of well \_\_\_\_\_ (feet)  
**(DWR use only: Computer ID No. \_\_\_\_\_ GPS \_\_\_\_\_ feet North \_\_\_\_\_ feet West)**  
 This point will not be changed  This point will be changed as follows:  No change, point better described with GPS as follows:  
**Proposed point of diversion: (Complete only if change is requested or if existing point is better described by GPS)**  
 One in the \_\_\_\_\_ Quarter of the \_\_\_\_\_ Quarter of the \_\_\_\_\_ Quarter  
 of Section \_\_\_\_\_, Township \_\_\_\_\_ South, Range \_\_\_\_\_ W,  
 in \_\_\_\_\_ County, Kansas, \_\_\_\_\_ feet North \_\_\_\_\_ feet West of Southeast corner of section.  
 Proposed Rate \_\_\_\_\_ Proposed Quantity \_\_\_\_\_ Proposed well depth (feet) \_\_\_\_\_  
 This point is:  Additional Well  Geo Center List other water rights that will use this point \_\_\_\_\_

7. The changes herein are desired for the following reasons?  
 (please be specific) \_\_\_\_\_  
 \_\_\_\_\_  
 \_\_\_\_\_

8. If a well, is the test hole log attached?  Yes  No

9. The change(s) (was)(will be) completed by?  
 \_\_\_\_\_  
 \_\_\_\_\_

10. If the point of diversion is a well:  
 (a) What are you going to do with the old well?  
 \_\_\_\_\_  
 \_\_\_\_\_  
 (b) When will this be done? \_\_\_\_\_

11. Groundwater Management District recommendation attached?  
 Yes  No

12. Assisted by JG/GCFO \_\_\_\_\_

13a. If the proposed point of diversion will be relocated more than 300 feet but within 2,640 feet of the existing point of diversion, attach a topographic map or aerial photograph. For groundwater sources, show all wells (including domestic) within one-half mile of the proposed point of diversion and the names and mailing addresses of the owners. For surface water sources, show the names and addresses of the landowner(s) one-half mile downstream and one-half mile upstream from your property lines

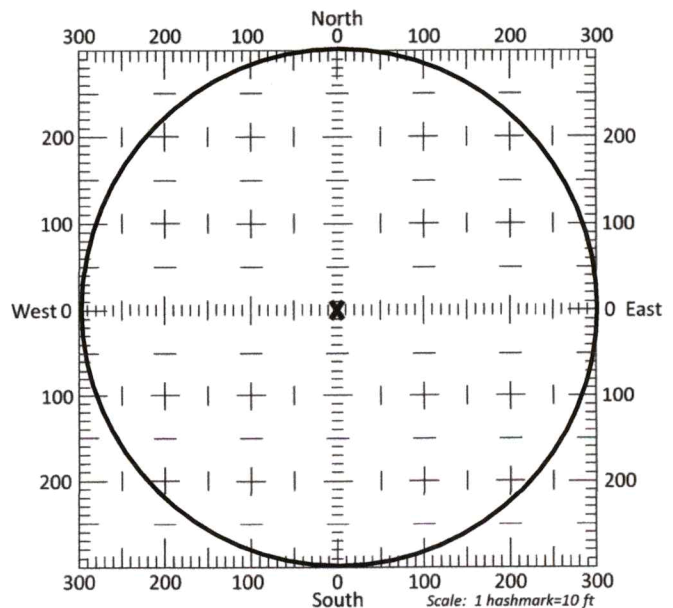

13b. If the proposed point of diversion will be relocated within a 300 foot radius of the existing point of diversion, indicate its location on the diagram shown above in relation to the existing point of diversion. The proposed point of diversion must be located within the circle shown above. **(PLEASE NOTE: The "X" in center of diagram above represents the presently authorized point of diversion.)**

14. If the proposed groundwater point of diversion is 300 or fewer feet from the existing point of diversion, complete the following:

- (a) Does the undersigned represent all owners of the currently authorized place(s) of use identified in this application?  
 Yes     No    (If no, all owners must sign this application.)
- (b) Will the ownership interest of any owner of the currently authorized place(s) of use identified in this application be adversely affected if this application is approved as requested?  
 Yes     No    (If yes, all owners must sign this application.)
- (c) If this application is not approved expeditiously, will there be substantial damage to property, public health or safety?  
 Yes     No    (If no, all owners must sign this application.)

If the application proposes a surface water change in point of diversion, a groundwater change in point of diversion greater than 300 feet, or a change in place of use, the application must be signed by all owners of the currently authorized place of use, or their duly authorized agent (attach notarized statement authorizing representation).

**I hereby verify, being first duly sworn upon my oath or affirmation and under penalty of perjury, that I am of lawful age and the owner, the spouse of the owner, or a duly authorized agent of the owner(s) to make this application on their behalf, in regards to the water right(s) to which this application pertains. I further verify that the statements contained in this application are true, correct and complete.**

Dated at Warden City, Kansas, this 24<sup>th</sup> day of February, 20 23.

Darwin Koehn  
 \_\_\_\_\_  
 (Owner)

Lisa Koehn  
 \_\_\_\_\_  
 (Spouse)

Darwin Koehn  
 \_\_\_\_\_  
 (Please Print)

Lisa Koehn  
 \_\_\_\_\_  
 (Please Print)

\_\_\_\_\_  
 (Owner)

\_\_\_\_\_  
 (Spouse)

\_\_\_\_\_  
 (Please Print)

\_\_\_\_\_  
 (Please Print)

\_\_\_\_\_  
 (Owner)

\_\_\_\_\_  
 (Spouse)

\_\_\_\_\_  
 (Please Print)

\_\_\_\_\_  
 (Please Print)

State of Kansas }  
 County of Linney } SS

I hereby certify that the foregoing application was signed in my presence and sworn to before me this 24<sup>th</sup> day of February, 20 23.



Julie Jones  
 \_\_\_\_\_  
 Notary Public

My Commission Expires \_\_\_\_\_

**ONLY COMPLETE APPLICATIONS WILL BE PROCESSED.** To be complete, all of the applicable portions of the application form must be completed with accurate information; maps, if necessary, must be included; signatures of all the appropriate owners' must be affixed to the application and notarized; and the appropriate fee must be paid.

**FEE SCHEDULE**

Each application to change the place of use or the point of diversion under this section shall be accompanied by the application fee set forth in the schedule below: Make checks payable to: **Kansas Department of Agriculture**

- (1) Application to change a point of diversion 300 feet or less ..... \$100
- (2) Application to change a point of diversion more than 300 feet ..... \$200
- (3) Application to change the place of use ..... \$200





# CHANGE IN PLACE OF DIVERSION WATER RIGHT, FILE NO. 21917

NW 1/4 of Section 30 Township 27 South Range 34 West Haskell County

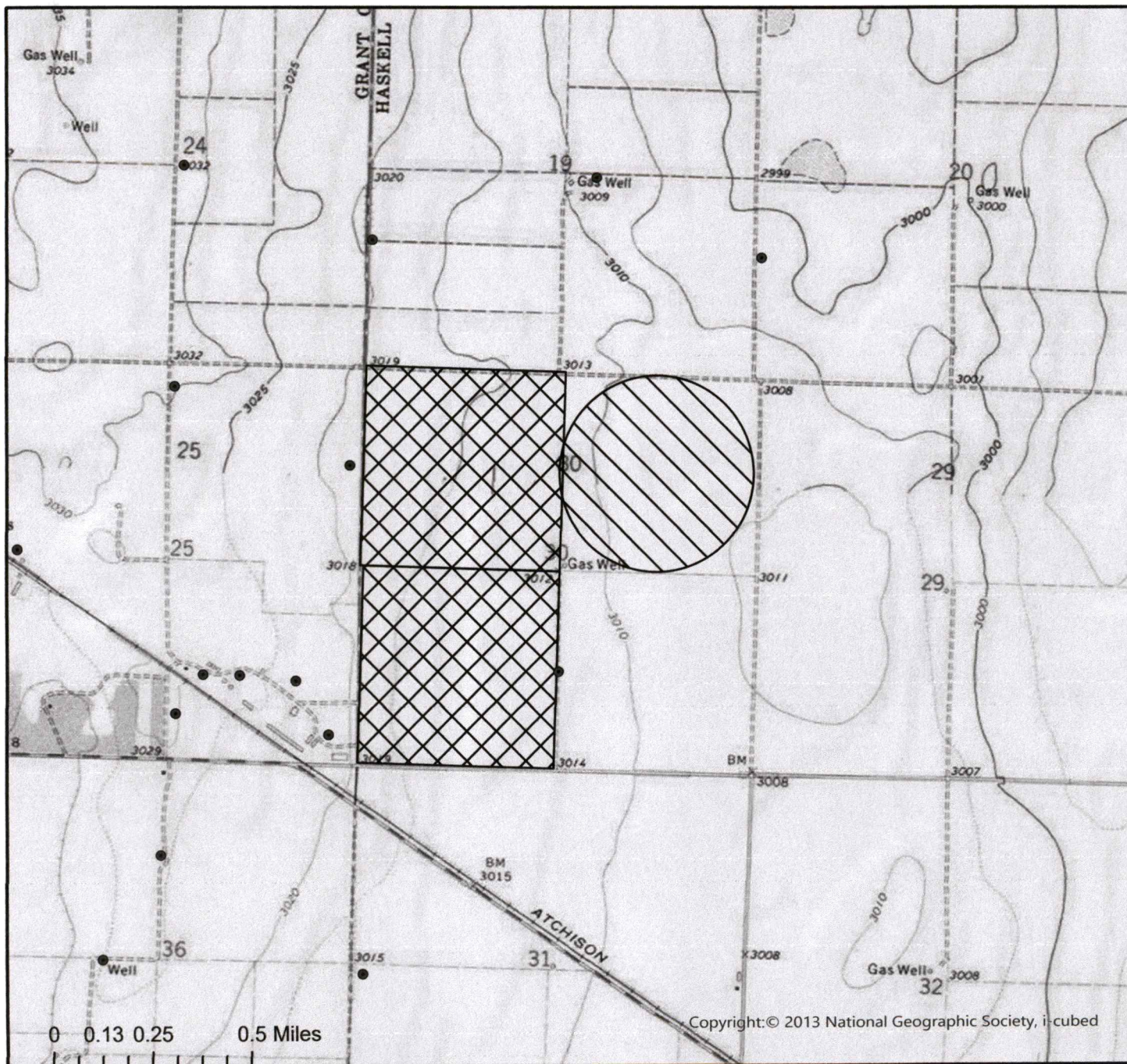

●	Authorized Point of Diversion
●	Domestic Well within 1/2 mile
	Authorized Place of Use
	Proposed Place of Use

List of owner name and addresses within 1/2 mile:



All wells of any kind within 1/2 mile of the requested place of use have been plotted.

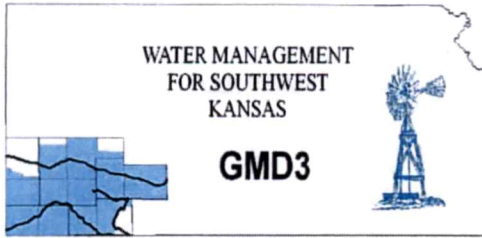

**Southwest Kansas  
Groundwater Management District No. 3**  
2009 E. Spruce Street  
Garden City, Kansas 67846  
(620) 275-7147 phone  
www.gmd3.org

March 3, 2023

Michael A. Meyer  
Division of Water Resources  
4532 W Jones Ave., Suite B  
Garden City, Kansas 67846

RE: Applications for Change in Place of Use  
Water Right, File Nos. 21917 & 27608

Dear Mike:

We have completed a review of the applications for the above referenced water rights. The proposals are not in conflict with the Management Program of the Southwest Kansas Groundwater Management District No. 3 (GMD3). The proposed change in place of use will make a complete overlap in currently authorized place of use in accordance with K.A.R. 5-5-11(b). It is therefore recommended that the applications be approved at this time.

Thank you for the opportunity to review the applications and to provide a recommendation. If you have any questions, please don't hesitate to contact us.

Sincerely,

Jason L. Norquest  
Assistant Manager

**RECEIVED**

**MAR 02 2023**

Garden City Field Office  
Division of Water Resources

## GMD3 Change Review

---

File No(s): 21917 & 27608.

DWR office: GC.

App filed to change: PU.

Is Landowner(s) correct in WRIS: Darvin & Lisa Koehn.

If NO, is documentation included?

Is Water Use Correspondent correct in WRIS? \_\_.

If NO, is documentation included?

Regulation(s) Reviewed: KAR 5-5-11

Point of diversion ID No(s) \_\_ being changed.

	ft. North	ft. West	
Authorized PD			
Proposed PD			
Difference	0	0	
a2 + b2 = c2	0	0	0

GPS for proposed PD: Lat: \_\_ Long: \_\_.

Is proposed PD stacking on existing WRs? No Change.

Is Proposed PU overlapping existing WRs? Make a complete overlap in WRs.

Neighboring certified well(s) notified: \_\_.

Name \_\_.

Address \_\_.

Zip \_\_.

Email: \_\_. Phone: \_\_.

Domestic well(s) notified: \_\_.

Name \_\_.

Address \_\_.

Zip \_\_.

Base Acres: \_\_.

Perfected Acres: \_\_.

Irr. Return-Flow \_\_%

**21917 authorized 480AF @ 1360gpm**

**321.88 acres in W2 of 30-27-34**

**27608 authorized 260AF @ 880gpm**

**136 acres in NE 30-27-34**

**Proposal is to maintain these acres and just make on overlap in PU**

Is a waiver needed: No new acres proposed with the changes.

Recommendation: After review of all available information, it appears current area rules are met. Staff therefore recommends approval of the applications.



Garden City Field Office  
4532 W. Jones, Suite B  
Garden City, KS 67846



Phone: 620-276-2901  
Fax: 620-276-9315  
www.agriculture.ks.gov

Mike Beam, Secretary

Laura Kelly, Governor

March 1, 2023

SOUTHWEST KANSAS GROUNDWATER  
MANAGEMENT DISTRICT NO. 3  
2009 E SPRUCE ST  
GARDEN CITY KS 67846

Re: Request for Recommendation  
Water Right, File Nos. 21917 & 27608

Dear Mr. Norquest:

This is to advise you of an application for approval of the Chief Engineer, Division of Water Resources, Kansas Department of Agriculture, to change the place of use.

We are delaying action on the change application to allow you time to review and provide a recommendation. Please submit a recommendation within 15 days from the date of this letter.

Thank you and as always feel free to contact this office at any time.

Sincerely,

A handwritten signature in blue ink that reads "Michael A. Meyer".

Michael A. Meyer  
Water Commissioner

MAM  
Enclosures