

Kansas Department of Agriculture
 Division of Water Resources
CHANGE: P/D WORKSHEET

1. File Number: 2342	2. Status Change Date:	3. Change Num: C3	4. Field Office: 4	5. GMD: 3
6. Status: <input checked="" type="checkbox"/> Approved <input type="checkbox"/> Denied by DWR/GMD <input type="checkbox"/> Dismiss by Request/Failure to Return				7. Filing Date of Change: 11/13/2023
8a. Applicant(s) New to system <input type="checkbox"/> WHEATLAND ELECTRIC COOPERATIVE INC Attn: PERRY SMITH PO BOX 953 GARDEN CITY, KS 67846		Person ID 19316 Add Seq# _____		
8b. Landowner(s) New to system <input type="checkbox"/> 8a		Person ID _____ Add Seq# _____		
8c. Landowner(s) New to system <input type="checkbox"/>		Person ID _____ Add Seq# _____		
8d. WUC New to system <input type="checkbox"/> 8a		Person ID _____ Add Seq# _____		
9. Documents and Enclosure(s): <input checked="" type="checkbox"/> DWR Meter(s) Date to Comply: 12/31/2024 <input checked="" type="checkbox"/> N & P Date to Comply: 3/1/2025				
<input type="checkbox"/> Anti-Reverse Meter <input type="checkbox"/> Meter Seal <input type="checkbox"/> Check Valve <input checked="" type="checkbox"/> N & P Form <input type="checkbox"/> Water Tube <input type="checkbox"/> Driller Copy <input type="checkbox"/> H & E Letter <input type="checkbox"/> Conservation Plan Date Required: _____ Date Approved: _____ Date to Comply: _____				
10. Use Made of Water From: _____ To: _____				
Date Prepared: 11/16/2023 By: AM Date Entered: _____ By: _____				

File No. **2342** 11. County: FI Basin: **ARKANSAS RIVER** Stream: Formation Code: **211** Special Use:

12. Points of Diversion
 CHK
 MOD
 DEL PDIV
 ENT Qualifier S T R ID 'N 'W Comment (AKA Line) Rate gpm Quantity mgy Additional Rate gpm Quantity mgy Overlap PD Files

DEL 84917
ENT/MOD 68300 NW SW NW 13 24S 33W 64 3683 4787 WELL GC-10 5905 382.87 0 382.87 FI-168 & 2342

NO CHANGE TO OTHER 15 WELLS ***BLANKET R & Q BETWEEN ALL WELLS***

13. Storage: Rate _____ NF Quantity _____ ac/ft Additional Rate _____ NF Additional Quantity _____ ac/ft

14. Limitation: _____ af/yr at **7315** gpm (_____ cfs) when combined with file number(s) **FI-168 & FI-229 (NO CHANGE)**
 Limitation: _____ af/yr at _____ gpm (_____ cfs) when combined with file number(s) _____

15. 5YR Allocation: Allocation Type _____ Start Year _____ 5 YR Amount _____ Amount Unit _____ Base Acres _____ Comment _____

16. Place of Use CHK MOD DEL ENT PUSE S T R ID	NE¼				NW¼				SW¼				SE¼				Total	Owner	Chg?	Overlap Files
	NE ¼	NW ¼	SW ¼	SE ¼	NE ¼	NW ¼	SW ¼	SE ¼	NE ¼	NW ¼	SW ¼	SE ¼	NE ¼	NW ¼	SW ¼	SE ¼				
CHK 5915																				
CHK 28282																				

Base Acres: Year: Minimum Reasonable Quantity:

Comments: **DID NOT COMPLETE C2 CHANGE IN POINT OF DIVERSION – REVERTING BACK TO ORIGINAL WELL W/ UPDATED FEET DISTANCES BASED ON GPS AND INFORMATION FROM C2 CHANGE – REMOVE COMPLETION DATE REQUIREMENT FOR C2**

Garden City Field Office
4532 W. Jones, Suite B
Garden City, KS 67846



Phone: 620-276-2901
Fax: 620-276-9315
www.agriculture.ks.gov

Mike Beam, Secretary

Laura Kelly, Governor

November 16, 2023

WHEATLAND ELECTRIC COOPERATIVE INC
Attn: PERRY SMITH
PO BOX 953
GARDEN CITY, KS 67846

RE: Filed Office Application for Change
Vested Right, File Nos. FI-168 and FI-229
Water Right, File No. 2342

Dear Sir or Madam:

Enclosed is the order executed by the designee of the Chief Engineer, Division of Water Resources, Kansas Department of Agriculture, approving the application for change under the above referenced file number.

Your attention is directed to the enclosures and to the terms, conditions, and limitations specified in this approval for change. A condition of this approval is that an acceptable water flow meter must be installed on the diversion works authorized under the referenced file number and meet current specifications. Please return the required notification of completion of the diversion works and installation of the required meter as soon as these actions are completed.

Since the order modifies the original document referred to above, it should be recorded with the Register of Deeds as other instruments affecting real estate.

The abandoned well must be plugged in accordance with the requirements of Article 30 of the Rules and Regulations as adopted by the Kansas Department of Health and Environment.

Should you have any questions, please feel free contact this office. If you would prefer, you could arrange an appointment for additional assistance.

Sincerely,

A handwritten signature in blue ink, appearing to read "Austin J. McColloch".

Austin J. McColloch
Assistant Water Commissioner

AM:
enclosures

pc:

CERTIFICATE OF SERVICE

On this 16th day of November, 2023, I hereby certify that the foregoing Approval of Application for Change in Point of Diversion, Vested Right, File Nos. FI-168 and FI-229 and Water Right, File No. 2,342 dated 16th day of November, 2023 was mailed postage prepaid, first class, US mail to the following:

WHEATLAND ELECTRIC COOPERATIVE INC
Attn: PERRY SMITH
PO BOX 953
GARDEN CITY, KS 67846

Pc:



Division of Water Resources Staff

Submit completed application to:
 Kansas Department of Agriculture
 Division of Water Resources
 Field Office for your area.

Call for address:

Topeka -- (785) 296-5733
 Stafford -- (620) 234-5311
 Stockton -- (785) 425-6787
 Garden City -- (620) 276-2901
<http://agriculture.ks.gov/dwr>

DWR FIELD OFFICE APPLICATION FOR APPROVAL TO CHANGE THE PLACE OF USE AND/OR THE POINT OF DIVERSION



STATE OF KANSAS

Filing Fee Must Accompany the Application, K.S.A. 82a-708b(b), as amended.
 Fee Schedule is on the third page of this application form.

Paragraph Nos. 1, 2, 3 & 5 must be completed. Complete all other applicable portions. If change in point of diversion is greater than 100 feet, or if place of use will be changed, include a topographic map or detailed plat showing the authorized and proposed point(s) of diversion and/or place of use.

File No. 2342

RECEIVED

NOV 13 2023

10:47 am

Garden City Field Office
 Division of Water Resources

1. Application is hereby made for approval of the Chief Engineer to change the (check one or both):

Place of Use Point of Diversion

under the water right which is the subject of this application in accordance with the conditions described below.

The source of supply is: Groundwater Surface water

2. Name and address of Applicant: WHEATLAND ELECTRIC COOPERATIVE INC
PO BOX 953, GARDEN CITY, KS 67846

Phone Number: () _____ Email address: _____

Name and address of Water Use Correspondent: NO CHANGE SAME

Phone Number: () _____ Email address: _____

3. The presently authorized place of use is:

Owner of Land ---- NAME: NO CHANGE

ADDRESS: _____

(If there is more than one landowner, attach supplemental sheets as necessary.)

Sec.	Twp.	Range	NE¼				NW¼				SW¼				SE¼				TOTAL ACRES		
			NE¼	NW¼	SW¼	SE¼	NE¼	NW¼	SW¼	SE¼	NE¼	NW¼	SW¼	SE¼	NE¼	NW¼	SW¼	SE¼			

4. If this application is for a change in place of use, it is proposed that the place of use be changed to:

Owner of Land ---- NAME: NO CHANGE

ADDRESS: _____

(If there is more than one landowner, attach supplemental sheets as necessary.)

Sec.	Twp.	Range	NE¼				NW¼				SW¼				SE¼				TOTAL ACRES			
			NE¼	NW¼	SW¼	SE¼	NE¼	NW¼	SW¼	SE¼	NE¼	NW¼	SW¼	SE¼	NE¼	NW¼	SW¼	SE¼				

For Office Use Only: Code _____ Fee \$ 100.00 TR # _____ Receipt Date 11-13-23 Check # 169757

5. **Presently authorized point of diversion:**
 One in the NE Quarter of the SW Quarter of the NW Quarter of Section 13, Township 24 South, Range 33 W, in FI County, Kansas, 3777 feet North 4519 feet West of Southeast corner of section.
 Authorized Rate --- Authorized Quantity --- Depth of well --- (feet)
 (DWR use only: Computer ID No. 66 GPS --- feet North --- feet West)
 This point will not be changed This point will be changed as follows: No change, point better described with GPS as follows:
Proposed point of diversion: (Complete only if change is requested or if existing point is better described by GPS)
 One in the NE NW Quarter of the NE SW Quarter of the NW Quarter of Section 13, Township 24 South, Range 33 W, in FI County, Kansas, 3683 feet North 2787 feet West of Southeast corner of section.
 Proposed Rate --- Proposed Quantity --- Proposed well depth (feet) ---
 This point is: Additional Well Geo Center List other water rights that will use this point FI 168, FI 229

6. **Presently authorized point of diversion:**
 One in the NE Quarter of the NE Quarter of the SW Quarter of Section 13, Township 24 South, Range 33 W, in FI County, Kansas, 2017 feet North 2686 feet West of Southeast corner of section.
 Authorized Rate --- Authorized Quantity --- Depth of well --- (feet)
 (DWR use only: Computer ID No. 21 GPS --- feet North --- feet West)
 This point will not be changed This point will be changed as follows: No change, point better described with GPS as follows:
Proposed point of diversion: (Complete only if change is requested or if existing point is better described by GPS)
 One in the _____ Quarter of the _____ Quarter of the _____ Quarter of Section _____, Township _____ South, Range _____ (E/W), in _____ County, Kansas, _____ feet North _____ feet West of Southeast corner of section.
 Proposed Rate _____ Proposed Quantity _____ Proposed well depth (feet) _____
 This point is: Additional Well Geo Center List other water rights that will use this point _____

7. The changes herein are desired for the following reasons?
 (please be specific) did not complete subsect well (well 10) moving back to original location

8. If a well, is the test hole log attached? Yes No

9. The change(s) (was)(will be) completed by?

10. If the point of diversion is a well:
 (a) What are you going to do with the old well?

 (b) When will this be done? _____

11. Groundwater Management District recommendation attached?
 Yes No

12. Assisted by mm/gcfo

13a. If the proposed point of diversion will be relocated more than 300 feet but within 2,640 feet of the existing point of diversion, attach a topographic map or aerial photograph. For groundwater sources, show all wells (including domestic) within one-half mile of the proposed point of diversion and the names and mailing addresses of the owners. For surface water sources, show the names and addresses of the landowner(s) one-half mile downstream and one-half mile upstream from your property lines

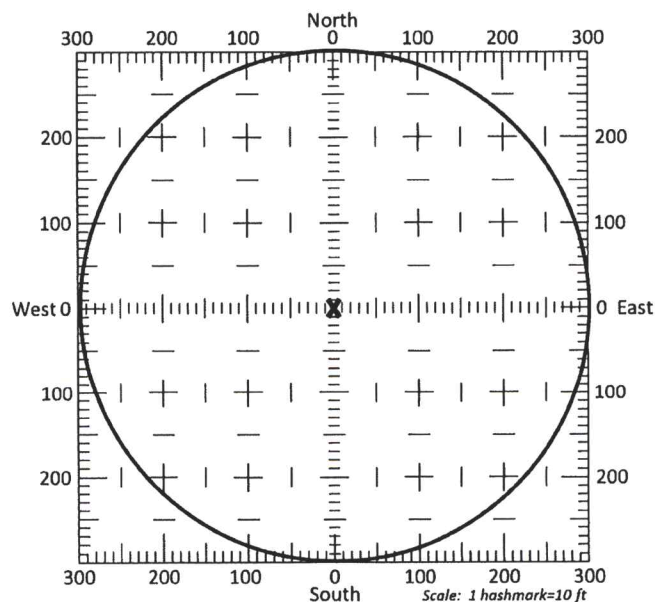

13b. If the proposed point of diversion will be relocated within a 300 foot radius of the existing point of diversion, indicate its location on the diagram shown above in relation to the existing point of diversion. The proposed point of diversion must be located within the circle shown above. (PLEASE NOTE: The "X" in center of diagram above represents the presently authorized point of diversion.)

APPLICATION FOR APPROVAL TO CHANGE
THE PLACE OF USE AND/OR POINT OF DIVERSION
SUPPLEMENTAL SHEET
FILE NO. FI 169, FI 229, 2342

Presently authorized point of diversion:

One in the SE Quarter of the SE Quarter of the NW Quarter
of Section 13, Township 24 South, Range 33 W,
in FI _____ County, Kansas, 3001 feet North 3112 feet West of Southeast corner of section.
Authorized Rate --- Authorized Quantity ---- Depth of well --- (feet)
(DWR use only: Computer ID No. 5 GPS _____ feet North _____ feet West)
 This point will not be changed This point will be changed as follows: No change, point better described with GPS as follows:

Proposed point of diversion: (Complete only if change is requested)

One in the _____ Quarter of the _____ Quarter of the _____ Quarter
of Section _____, Township _____ South, Range _____ (E/W),
in _____ County, Kansas, _____ feet North _____ feet West of Southeast corner of section.
Proposed Rate _____ Proposed Quantity _____ Proposed well depth (feet) _____
This point is: Additional Well Geo Center List other water rights that will use this point _____

Presently authorized point of diversion:

One in the NE Quarter of the NE Quarter of the SW Quarter
of Section 13, Township 24 South, Range 33 W,
in FI _____ County, Kansas, 2320 feet North 2692 feet West of Southeast corner of section.
Authorized Rate --- Authorized Quantity ---- Depth of well --- (feet)
(DWR use only: Computer ID No. 19 GPS _____ feet North _____ feet West)
 This point will not be changed This point will be changed as follows: No change, point better described with GPS as follows:

Proposed point of diversion: (Complete only if change is requested)

One in the _____ Quarter of the _____ Quarter of the _____ Quarter
of Section _____, Township _____ South, Range _____ (E/W),
in _____ County, Kansas, _____ feet North _____ feet West of Southeast corner of section.
Proposed Rate _____ Proposed Quantity _____ Proposed well depth (feet) _____
This point is: Additional Well Geo Center List other water rights that will use this point _____

Presently authorized point of diversion:

One in the NE Quarter of the SW Quarter of the NW Quarter
of Section 13, Township 24 South, Range 33 W,
in FI _____ County, Kansas, 3633 feet North 4289 feet West of Southeast corner of section.
Authorized Rate --- Authorized Quantity ---- Depth of well --- (feet)
(DWR use only: Computer ID No. 16 GPS _____ feet North _____ feet West)
 This point will not be changed This point will be changed as follows: No change, point better described with GPS as follows:

Proposed point of diversion: (Complete only if change is requested)

One in the _____ Quarter of the _____ Quarter of the _____ Quarter
of Section _____, Township _____ South, Range _____ (E/W),
in _____ County, Kansas, _____ feet North _____ feet West of Southeast corner of section.
Proposed Rate _____ Proposed Quantity _____ Proposed well depth (feet) _____
This point is: Additional Well Geo Center List other water rights that will use this point _____

Presently authorized point of diversion:

One in the SE Quarter of the SE Quarter of the NW Quarter
of Section 13, Township 24 South, Range 33 W,
in FI _____ County, Kansas, 3073 feet North 3259 feet West of Southeast corner of section.
Authorized Rate --- Authorized Quantity ---- Depth of well --- (feet)
(DWR use only: Computer ID No. 6 GPS _____ feet North _____ feet West)
 This point will not be changed This point will be changed as follows: No change, point better described with GPS as follows:

Proposed point of diversion: (Complete only if change is requested)

One in the _____ Quarter of the _____ Quarter of the _____ Quarter
of Section _____, Township _____ South, Range _____ (E/W),
in _____ County, Kansas, _____ feet North _____ feet West of Southeast corner of section.
Proposed Rate _____ Proposed Quantity _____ Proposed well depth (feet) _____
This point is: Additional Well Geo Center List other water rights that will use this point _____

APPLICATION FOR APPROVAL TO CHANGE
THE PLACE OF USE AND/OR POINT OF DIVERSION
SUPPLEMENTAL SHEET
FILE NO. FI 169, FI 229, 2342

Presently authorized point of diversion:

One in the NW Quarter of the NE Quarter of the SW Quarter
of Section 13, Township 24 South, Range 33 W,
in FI County, Kansas, 2327 feet North 3326 feet West of Southeast corner of section.
Authorized Rate --- Authorized Quantity ---- Depth of well --- (feet)
(DWR use only: Computer ID No. 20 GPS feet North feet West)
 This point will not be changed This point will be changed as follows: No change, point better described with GPS as follows:

Proposed point of diversion: (Complete only if change is requested)

One in the _____ Quarter of the _____ Quarter of the _____ Quarter
of Section _____, Township _____ South, Range _____ (E/W),
in _____ County, Kansas, _____ feet North _____ feet West of Southeast corner of section.
Proposed Rate _____ Proposed Quantity _____ Proposed well depth (feet) _____
This point is: Additional Well Geo Center List other water rights that will use this point _____

Presently authorized point of diversion:

One in the NE NW Quarter of the SE Quarter of the NW Quarter
of Section 13, Township 24 South, Range 33 W,
in FI County, Kansas, 3591 feet North 3712 feet West of Southeast corner of section.
Authorized Rate --- Authorized Quantity --- Depth of well --- (feet)
(DWR use only: Computer ID No. 10 GPS feet North feet West)
 This point will not be changed This point will be changed as follows: No change, point better described with GPS as follows:

Proposed point of diversion: (Complete only if change is requested)

One in the _____ Quarter of the _____ Quarter of the _____ Quarter
of Section _____, Township _____ South, Range _____ (E/W),
in _____ County, Kansas, _____ feet North _____ feet West of Southeast corner of section.
Proposed Rate _____ Proposed Quantity _____ Proposed well depth (feet) _____
This point is: Additional Well Geo Center List other water rights that will use this point _____

Presently authorized point of diversion:

One in the SW Quarter of the SE Quarter of the NW Quarter
of Section 13, Township 24 South, Range 33 W,
in FI County, Kansas, 3244 feet North 3631 feet West of Southeast corner of section.
Authorized Rate --- Authorized Quantity --- Depth of well --- (feet)
(DWR use only: Computer ID No. 8 GPS feet North feet West)
 This point will not be changed This point will be changed as follows: No change, point better described with GPS as follows:

Proposed point of diversion: (Complete only if change is requested)

One in the _____ Quarter of the _____ Quarter of the _____ Quarter
of Section _____, Township _____ South, Range _____ (E/W),
in _____ County, Kansas, _____ feet North _____ feet West of Southeast corner of section.
Proposed Rate _____ Proposed Quantity _____ Proposed well depth (feet) _____
This point is: Additional Well Geo Center List other water rights that will use this point _____

Presently authorized point of diversion:

One in the NE Quarter of the NW Quarter of the SW Quarter
of Section 13, Township 24 South, Range 33 W,
in FI County, Kansas, 2352 feet North 3989 feet West of Southeast corner of section.
Authorized Rate --- Authorized Quantity --- Depth of well --- (feet)
(DWR use only: Computer ID No. 22 GPS feet North feet West)
 This point will not be changed This point will be changed as follows: No change, point better described with GPS as follows:

Proposed point of diversion: (Complete only if change is requested)

One in the _____ Quarter of the _____ Quarter of the _____ Quarter
of Section _____, Township _____ South, Range _____ (E/W),
in _____ County, Kansas, _____ feet North _____ feet West of Southeast corner of section.
Proposed Rate _____ Proposed Quantity _____ Proposed well depth (feet) _____
This point is: Additional Well Geo Center List other water rights that will use this point _____

APPLICATION FOR APPROVAL TO CHANGE
THE PLACE OF USE AND/OR POINT OF DIVERSION
SUPPLEMENTAL SHEET
FILE NO. FI 169, FI 229, 2342

Presently authorized point of diversion:
One in the NE Quarter of the SW Quarter of the NW Quarter
of Section 13, Township 24 South, Range 33 W,
in FI _____ County, Kansas, 3347 feet North 4473 feet West of Southeast corner of section.
Authorized Rate --- Authorized Quantity ---- Depth of well --- (feet)
(DWR use only: Computer ID No. 15 GPS _____ feet North _____ feet West)
 This point will not be changed This point will be changed as follows: No change, point better described with GPS as follows:
Proposed point of diversion: (Complete only if change is requested)
One in the _____ Quarter of the _____ Quarter of the _____ Quarter
of Section _____, Township _____ South, Range _____ (E/W),
in _____ County, Kansas, _____ feet North _____ feet West of Southeast corner of section.
Proposed Rate _____ Proposed Quantity _____ Proposed well depth (feet) _____
This point is: Additional Well Geo Center List other water rights that will use this point _____

Presently authorized point of diversion:
One in the SE Quarter of the SW Quarter of the NW Quarter
of Section 13, Township 24 South, Range 33 W,
in FI _____ County, Kansas, 3252 feet North 3998 feet West of Southeast corner of section.
Authorized Rate --- Authorized Quantity ---- Depth of well --- (feet)
(DWR use only: Computer ID No. 23 GPS _____ feet North _____ feet West)
 This point will not be changed This point will be changed as follows: No change, point better described with GPS as follows:
Proposed point of diversion: (Complete only if change is requested)
One in the _____ Quarter of the _____ Quarter of the _____ Quarter
of Section _____, Township _____ South, Range _____ (E/W),
in _____ County, Kansas, _____ feet North _____ feet West of Southeast corner of section.
Proposed Rate _____ Proposed Quantity _____ Proposed well depth (feet) _____
This point is: Additional Well Geo Center List other water rights that will use this point _____

Presently authorized point of diversion:
One in the SE Quarter of the SW Quarter of the NW Quarter
of Section 13, Township 24 South, Range 33 W,
in FI _____ County, Kansas, 3277 feet North 4179 feet West of Southeast corner of section.
Authorized Rate --- Authorized Quantity ---- Depth of well --- (feet)
(DWR use only: Computer ID No. 13 GPS _____ feet North _____ feet West)
 This point will not be changed This point will be changed as follows: No change, point better described with GPS as follows:
Proposed point of diversion: (Complete only if change is requested)
One in the _____ Quarter of the _____ Quarter of the _____ Quarter
of Section _____, Township _____ South, Range _____ (E/W),
in _____ County, Kansas, _____ feet North _____ feet West of Southeast corner of section.
Proposed Rate _____ Proposed Quantity _____ Proposed well depth (feet) _____
This point is: Additional Well Geo Center List other water rights that will use this point _____

Presently authorized point of diversion:
One in the SW Quarter of the NE Quarter of the NW Quarter
of Section 13, Township 24 South, Range 33 W,
in FI _____ County, Kansas, 4483 feet North 3630 feet West of Southeast corner of section.
Authorized Rate --- Authorized Quantity ---- Depth of well --- (feet)
(DWR use only: Computer ID No. 61 GPS _____ feet North _____ feet West)
 This point will not be changed This point will be changed as follows: No change, point better described with GPS as follows:
Proposed point of diversion: (Complete only if change is requested)
One in the _____ Quarter of the _____ Quarter of the _____ Quarter
of Section _____, Township _____ South, Range _____ (E/W),
in _____ County, Kansas, _____ feet North _____ feet West of Southeast corner of section.
Proposed Rate _____ Proposed Quantity _____ Proposed well depth (feet) _____
This point is: Additional Well Geo Center List other water rights that will use this point _____

APPLICATION FOR APPROVAL TO CHANGE
THE PLACE OF USE AND/OR POINT OF DIVERSION
SUPPLEMENTAL SHEET
FILE NO. FI 169, FI 229, 2342

Presently authorized point of diversion:
One in the NE Quarter of the SW Quarter of the NW Quarter
of Section 13, Township 24 South, Range 33 W,
in FI County, Kansas, 3678 feet North 4608 feet West of Southeast corner of section.
Authorized Rate --- Authorized Quantity ---- Depth of well --- (feet)
(DWR use only: Computer ID No. 62 GPS feet North feet West)
 This point will not be changed This point will be changed as follows: No change, point better described with GPS as follows:
Proposed point of diversion: (Complete only if change is requested)
One in the _____ Quarter of the _____ Quarter of the _____ Quarter
of Section _____, Township _____ South, Range _____ (E/W),
in _____ County, Kansas, _____ feet North _____ feet West of Southeast corner of section.
Proposed Rate _____ Proposed Quantity _____ Proposed well depth (feet) _____
This point is: Additional Well Geo Center List other water rights that will use this point _____

Presently authorized point of diversion:
One in the NE Quarter of the NE Quarter of the NW Quarter
of Section 13, Township 24 South, Range 33 W,
in FI County, Kansas, 4727 feet North 2790 feet West of Southeast corner of section.
Authorized Rate --- Authorized Quantity ---- Depth of well --- (feet)
(DWR use only: Computer ID No. 63 GPS feet North feet West)
 This point will not be changed This point will be changed as follows: No change, point better described with GPS as follows:
Proposed point of diversion: (Complete only if change is requested)
One in the _____ Quarter of the _____ Quarter of the _____ Quarter
of Section _____, Township _____ South, Range _____ (E/W),
in _____ County, Kansas, _____ feet North _____ feet West of Southeast corner of section.
Proposed Rate _____ Proposed Quantity _____ Proposed well depth (feet) _____
This point is: Additional Well Geo Center List other water rights that will use this point _____

Presently authorized point of diversion:
One in the _____ Quarter of the _____ Quarter of the _____ Quarter
of Section _____, Township _____ South, Range _____
in _____ County, Kansas, _____ feet North _____ feet West of Southeast corner of section.
Authorized Rate _____ Authorized Quantity _____ Depth of well _____ (feet)
(DWR use only: Computer ID No. _____ GPS _____ feet North _____ feet West)
 This point will not be changed This point will be changed as follows: No change, point better described with GPS as follows:
Proposed point of diversion: (Complete only if change is requested)
One in the _____ Quarter of the _____ Quarter of the _____ Quarter
of Section _____, Township _____ South, Range _____ (E/W),
in _____ County, Kansas, _____ feet North _____ feet West of Southeast corner of section.
Proposed Rate _____ Proposed Quantity _____ Proposed well depth (feet) _____
This point is: Additional Well Geo Center List other water rights that will use this point _____

Presently authorized point of diversion:
One in the _____ Quarter of the _____ Quarter of the _____ Quarter
of Section _____, Township _____ South, Range _____
in _____ County, Kansas, _____ feet North _____ feet West of Southeast corner of section.
Authorized Rate _____ Authorized Quantity _____ Depth of well _____ (feet)
(DWR use only: Computer ID No. _____ GPS _____ feet North _____ feet West)
 This point will not be changed This point will be changed as follows: No change, point better described with GPS as follows:
Proposed point of diversion: (Complete only if change is requested)
One in the _____ Quarter of the _____ Quarter of the _____ Quarter
of Section _____, Township _____ South, Range _____ (E/W),
in _____ County, Kansas, _____ feet North _____ feet West of Southeast corner of section.
Proposed Rate _____ Proposed Quantity _____ Proposed well depth (feet) _____
This point is: Additional Well Geo Center List other water rights that will use this point _____

14. If the proposed groundwater point of diversion is 300 or fewer feet from existing point of diversion, complete the following:

- (a) Does the undersigned represent all owners of the currently authorized place(s) of use identified in this application?
 Yes No (If no, all owners must sign this application.)
- (b) Will the ownership interest of any owner of the currently authorized place(s) of use identified in this application be adversely affected if this application is approved as requested?
 Yes No (If yes, all owners must sign this application.)
- (c) If this application is not approved expeditiously, will there be substantial damage to property, public health or safety?
 Yes No (If no, all owners must sign this application.)

If the application proposes a surface water change in point of diversion, a groundwater change in point of diversion greater than 300 feet, or a change in place of use, the application must be signed by all owners of the currently authorized place of use, or their duly authorized agent (attach notarized statement authorizing representation).

I hereby verify, being first duly sworn upon my oath or affirmation and under penalty of perjury, that I am of lawful age and the owner, the spouse of the owner, or a duly authorized agent of the owner(s) to make this application on their behalf, in regard to the water right(s) to which this application pertains. I further verify that the statements contained in this application are true, correct and complete.

Dated at Garden City, Kansas, this 13 day of November, 2023.

 _____ (Owner)	_____ (Spouse)
<u>Wheatland Electric Cooperative, Inc.</u> _____ (Please Print)	_____ (Please Print)
_____ (Owner)	_____ (Spouse)
_____ (Please Print)	_____ (Please Print)
_____ (Owner)	_____ (Spouse)
_____ (Please Print)	_____ (Please Print)

State of Kansas }
County of Finney } SS

I hereby certify that the foregoing application was signed in my presence and sworn to before me this 13 day of November, 2023.

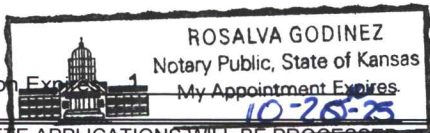



Notary Public

ONLY COMPLETE APPLICATIONS WILL BE PROCESSED. To be complete, all of the applicable portions of the application form must be completed with accurate information; maps, if necessary, must be included; signatures of all the appropriate owners' must be affixed to the application and notarized; and the appropriate fee must be paid.

FEE SCHEDULE

Each application to change the place of use or the point of diversion under this section shall be accompanied by the application fee set forth in the schedule below: Make checks payable to: **Kansas Department of Agriculture**

- (1) Application to change a point of diversion 300 feet or less \$100
- (2) Application to change a point of diversion more than 300 feet \$200
- (3) Application to change the place of use \$200

SUMMARY ORDER APPROVING APPLICATION FOR CHANGE AND IMPOSING CONDITIONS

This Summary Order is issued under authority of K.S.A. 82a-708b, as amended, and K.A.R. 5-5-1, *et seq.* and other applicable provisions of the *Kansas Water Appropriation Law, K.S.A. 82a-701 et seq.*, and rules and regulations promulgated thereunder, With the exception of those conditions expressly contained herein, this Summary Order does not change the terms, conditions and limitations of File No. 2342.

1. A change application was received on November 13, 2023 requesting that the place of use and / or point of diversion authorized under the above-referenced file number be changed as described in the application.
2. On and after the effective date of this summary order, the authorized place(s) of use shall be located substantially as shown on the topographic map accompanying the application to change the place of use. Applicable Not Applicable
3. The change in point of diversion shall not impair existing rights and shall be limited to the same source or sources of water as previously authorized. The point of diversion authorized by this summary order shall be located within a 50 foot radius of the authorized point(s) of diversion. Applicable Not Applicable
4. The point(s) of diversion described herein is administratively corrected to be more accurately described using the Global Positioning System (GPS), as described in the application. Applicable Not Applicable
5. The point(s) of diversion authorized herein shall not actually be located more than 300 feet from the previously authorized point(s) of diversion. Applicable Not Applicable
6. As required by K.A.R. 5-3-5d, if the works for diversion is a well with a diversion rate of 100 gallons per minute or more, a tube or other device suitable for making water level measurements shall be installed, operated and maintained in accordance with K.A.R. 5-6-13. Applicable Not Applicable
7. The owner of the authorized place(s) of use shall properly install an acceptable water flow meter on or before December 31, 2024, or before the first use of water, whichever occurs first. The water flow meter shall be installed, operated and maintained in accordance with K.A.R. 5-1-4 through 5-1-12. As required by K.S.A. 82a-732, as amended, and K.A.R. 5-3-5e, the owner shall maintain records and report the reading of the water flow meter and the total quantity of water diverted annually to the Chief Engineer by March 1 following the end of each calendar year. Applicable Not Applicable
8. Installation of the works for diversion of water shall be completed on or before December 31, 2024, or within any authorized extension of time. By March 1, 2025 the applicant shall notify the Chief Engineer that construction of the works for diversion has been completed, on the form provided by the Chief Engineer, as required by K.A.R. 5-8-4e. Applicable Not Applicable
9. The completed well log shall be submitted with the required notice. Applicable Not Applicable
10. All diversion works into which any type of chemical or other foreign substance will be injected into the water shall be equipped with an in-line, automatic, quick-closing check valve capable of preventing pollution of the source of the water supply. The check valve(s) shall be installed, operated and maintained in accordance with K.A.R. 5-3-5c. Applicable Not Applicable
11. Additional Conditions are attached. Yes No
12. In accordance with K.S.A. 82a-708a, as amended, and K.A.R. 5-5-14, all of the owners of the authorized place(s) of use of water appropriated under the above-referenced file number are responsible for compliance with its terms, conditions and limitations, as amended and/or supplemented by this Summary Order, and with applicable provisions of the *Kansas Water Appropriation Law* and the *Rules and Regulations* promulgated thereunder. Failure to comply with these provisions may result in civil penalties pursuant to K.S.A. 82a-737, as amended, and/or the suspension or revocation and dismissal of the water or appropriation right or any other enforcement actions authorized by law.

Administrative Appeal and Effective Date of Order

If you are aggrieved by this order, pursuant to K.S.A. 82a-1901, you may request an evidentiary hearing before the Chief Engineer or request administrative review by the Secretary of Agriculture. A request for hearing by the Chief Engineer must be filed within **15 days** of service of this Order and a request for administrative review by the Secretary must be filed within **30 days** pursuant to K.S.A. 77-531. Any request for administrative review must state a basis for review pursuant to K.S.A. 77-527. File any request with **Kansas Department of Agriculture, Legal Division, 1320 Research Park Drive, Manhattan, KS 66502**. Failure to timely request a hearing or review may preclude review under the Kansas Judicial Review Act.

For Use by Register of Deeds

FOR OFFICE USE ONLY
**APPLICATION APPROVED AND
SUMMARY ORDER ISSUED**

By: Austin McColloch
Duly Authorized Designee of the Chief Engineer

(Print Name): Austin McColloch
Division of Water Resources - Kansas Department of Agriculture

Date of Issuance: November 16, 2023

State of Kansas)
) SS

County of Tinney)

Acknowledged before me on November 16, 2023

by Austin McColloch

Signature: Julie Jones

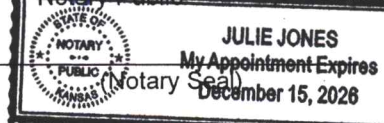
My commission expires: _____

**EXISTING WELLS
CORRECTED BY GPS**

one (1) well (a.k.a. GC-01) located in the Southwest Quarter of the Southeast Quarter of the Northwest Quarter (SW $\frac{1}{4}$ SE $\frac{1}{4}$ NW $\frac{1}{4}$) of Section 13, more particularly described as being near a point 3,244 feet North and 3,631 feet West of the Southeast corner of said section,

one (1) well (a.k.a. GC-02) located in the Southeast Quarter of the Southwest Quarter of the Northwest Quarter (SE $\frac{1}{4}$ SW $\frac{1}{4}$ NW $\frac{1}{4}$) of Section 13, more particularly described as being near a point 3,277 feet North and 4,179 feet West of the Southeast corner of said section;

one (1) well (a.k.a. GC-03) located in the Northeast Quarter of the Southwest Quarter of the Northwest Quarter (NE $\frac{1}{4}$ SW $\frac{1}{4}$ NW $\frac{1}{4}$) of Section 13, more particularly described as being near a point 3,347 feet North and 4,473 feet West of the Southeast corner of said section;

one (1) well (a.k.a. GC-04) located in the Southeast Quarter of the Southwest Quarter of the Northwest Quarter (SE $\frac{1}{4}$ SW $\frac{1}{4}$ NW $\frac{1}{4}$) of Section 13, more particularly described as being near a point 3,252 feet North and 3,998 feet West of the Southeast corner of said section;

one (1) well (a.k.a. GC-06) located in the Northwest Quarter of the Southeast Quarter of the Northwest Quarter (NW $\frac{1}{4}$ SE $\frac{1}{4}$ NW $\frac{1}{4}$) of Section 13, more particularly described as being near a point 3,591 feet North and 3,712 feet West of the Southeast corner of said section;

one (1) well (a.k.a. GC-08) located in the Northeast Quarter of the Southwest Quarter of the Northwest Quarter (NE $\frac{1}{4}$ SW $\frac{1}{4}$ NW $\frac{1}{4}$) of Section 13, more particularly described as being near a point 3,633 feet North and 4,289 feet West of the Southeast corner of said section;

one (1) well (a.k.a. GC-09) located in the Northeast Quarter of the Southwest Quarter of the Northwest Quarter (NE $\frac{1}{4}$ SW $\frac{1}{4}$ NW $\frac{1}{4}$) of Section 13, more particularly described as being near a point 3,678 feet North and 4,608 feet West of the Southeast corner of said section;

one (1) well (a.k.a. GC-10) located in the NorthWest Quarter of the Southwest Quarter of the Northwest Quarter (NW $\frac{1}{4}$ SW $\frac{1}{4}$ NW $\frac{1}{4}$) of Section 13, more particularly described as being near a point 3,683 feet North and 4,787 feet West of the Southeast corner of said section;

one (1) well (a.k.a. GC-11) located in the Southwest Quarter of the Northeast Quarter of the Northwest Quarter (SW $\frac{1}{4}$ NE $\frac{1}{4}$ NW $\frac{1}{4}$) of Section 13, more particularly described as being near a point 4,483 feet North and 3,620 feet West of the Southeast corner of said section;

2016 Change Information

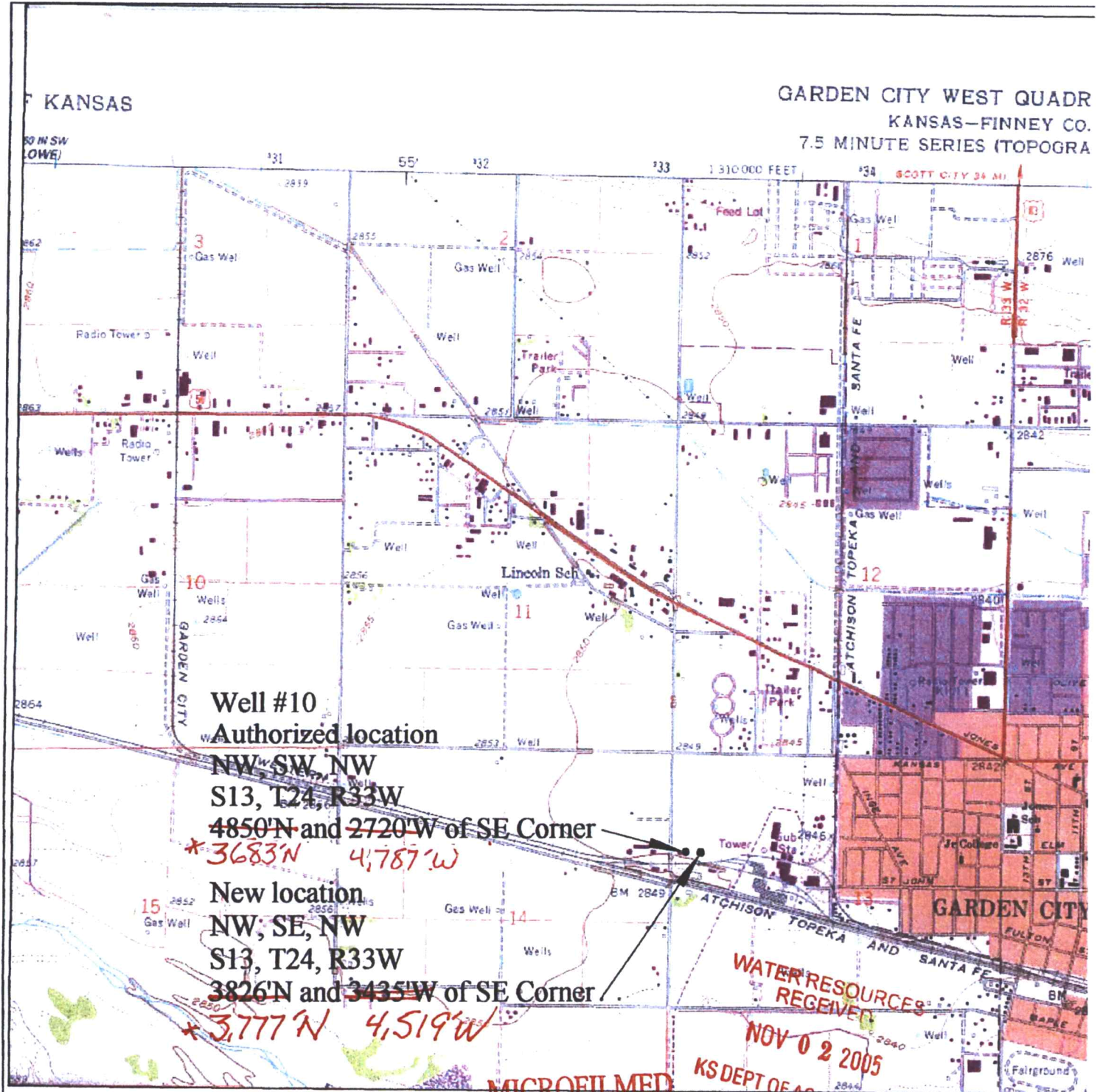

*BAT DWR
AS PER EMAIL/M. MEYER 12-23-15