

Kansas Department of Agriculture  
 Division of Water Resources  
**CHANGE: P/U WORKSHEET**

1. File Number: <b>36330</b>	2. Status Change Date: <b>9-27-2023</b>	3. Change Num: <b>C1</b>	4. Field Office: <b>4</b>	5. GMD: <b>3</b>
6. Status: <input checked="" type="checkbox"/> Approved <input type="checkbox"/> Denied by DWR/GMD <input type="checkbox"/> Dismiss by Request/Failure to Return				7. Filing Date of Change: <b>9/21/2023</b>
8a. Landowner, applicant New to system <input checked="" type="checkbox"/>  <b>DESERET TRUST #2-50899 Attn: FARMLAND RESERVE INC 521 50TH ROAD SATANTA, KS 67870</b>		Person ID <u>40999</u> Add Seq# _____	8c. Landowner(s) New to system <input type="checkbox"/>  Person ID _____ Add Seq# _____	
8b. Landowner(s) New to system <input type="checkbox"/>  Person ID <u>59951</u> Add Seq# _____		8d. WUC New to system <input type="checkbox"/> <b>8a</b>  Person ID <u>40999</u> Add Seq# _____		
9. Documents and Enclosure(s): <input checked="" type="checkbox"/> DWR Meter(s) Date to Comply: <b>12/31/2023</b> <input type="checkbox"/> N & P Date to Comply: _____ <input type="checkbox"/> Anti-Reverse Meter <input type="checkbox"/> Meter Seal <input checked="" type="checkbox"/> Check Valve <input type="checkbox"/> N & P Form <input type="checkbox"/> Water Tube <input type="checkbox"/> Driller Copy <input type="checkbox"/> H & E Letter <input type="checkbox"/> Conservation Plan    Date Required: _____    Date Approved: _____    Date to Comply: _____				
10. Use Made of Water    From: _____    To: _____				
Date Prepared: <b>9/27/2023</b> By: <b>MAM</b> Date Entered: _____    By: _____				

File No. **36330**      11. County: FI      Basin: ARKANSAS RIVER      Stream:      Formation Code:      Special Use:

12. Points of Diversion										Rate and Quantity				
CHK										Authorized		Additional		
MOD										Rate	Quantity	Rate	Quantity	Overlap PD Files
DEL	PDIV	Qualifier	S	T	R	ID	'N	'W	Comment (AKA Line)	gpm/cfs	af/mgy	gpm/cfs	af/mgy	
ENT														

**CHK 26871**

13. Storage: Rate \_\_\_\_\_ NF      Quantity \_\_\_\_\_ ac/ft      Additional Rate \_\_\_\_\_ NF      Additional Quantity \_\_\_\_\_ ac/ft

14. Limitation: \_\_\_\_\_ af/yr at \_\_\_\_\_ gpm ( \_\_\_\_\_ cfs) when combined with file number(s) \_\_\_\_\_  
 Limitation: \_\_\_\_\_ af/yr at \_\_\_\_\_ gpm ( \_\_\_\_\_ cfs) when combined with file number(s) \_\_\_\_\_

15. 5YR Allocation:      Allocation Type \_\_\_\_\_      Start Year \_\_\_\_\_      5 YR Amount \_\_\_\_\_      Amount Unit \_\_\_\_\_      Base Acres \_\_\_\_\_      Comment \_\_\_\_\_

16. Place of Use CHK MOD DEL ENT	PUSE	S	T	R	ID	NE¼				NW¼				SW¼				SE¼				Total	Owner	Chg?	Overlap Files							
						NE ¼	NW ¼	SW ¼	SE ¼	NE ¼	NW ¼	SW ¼	SE ¼	NE ¼	NW ¼	SW ¼	SE ¼	NE ¼	NW ¼	SW ¼	SE ¼											
<b>ENT 8603</b>						34	34	34	34	34	34	34	34	34	34	34	34	34	34	34	34	34	34	34	34	34	34	34	544	8a	N	36324, 36333, 36370
<b>DEL 35610</b>																																

Base Acres:      Year:      Minimum Reasonable Quantity:      Comments:

Garden City Field Office  
4532 W. Jones, Suite B  
Garden City, KS 67846



Phone: 620-276-2901  
Fax: 620-276-9315  
[www.agriculture.ks.gov](http://www.agriculture.ks.gov)

Mike Beam, Secretary

Laura Kelly, Governor

September 27, 2023

DESERET TRUST COMPANY  
521 50TH ROAD  
SATANTA, KS 67870

RE: Field Office Application for Change  
Water Right, File Nos. 22578-D1, 27106, 30820, & 36324, 36330, 36333, 36370

Dear Sir or Madam:

Enclosed are orders executed by the designee of the Chief Engineer, Division of Water Resources, Kansas Department of Agriculture, approving the applications for change under the above referenced file numbers.

Your attention is directed to the enclosures and to the terms, conditions, and limitations specified in these approvals for change. A condition of these approvals is that an acceptable water flow meter must be installed on the diversion works authorized under the referenced file number and meet current specifications. Please return the required notification of completion of the diversion works and installation of the required meter as soon as these actions are completed.

Since the orders modify the original documents referred to above, they should be recorded with the Register of Deeds as other instruments affecting real estate.

Should you have any questions, please feel free contact this office. If you would prefer, you could arrange an appointment for additional assistance.

Sincerely,

A handwritten signature in blue ink that reads "Michael A. Meyer".

Michael A. Meyer  
Water Commissioner

MAM:  
Enclosures  
pc: GMD3

### CERTIFICATE OF SERVICE

On this 27<sup>th</sup> day of September 2023, I hereby certify that the foregoing Approval of Application for Change in Point of Diversion, Water Right, File Nos. 22,578-D1, 27,106, 30,820, & 36,324, 36,330, 36,333, 36,370 dated 27<sup>th</sup> day of September 2023 was mailed postage prepaid, first class, US mail to the following:

DESERET TRUST COMPANY  
521 50TH ROAD  
SATANTA, KS 67870

pc:

GMD3



Division of Water Resources Staff

Submit completed application to:  
 Kansas Department of Agriculture  
 Division of Water Resources  
 Field Office for your area.  
 Call for address:

Topeka -- (785) 296-5733  
 Stafford -- (620) 234-5311  
 Stockton -- (785) 425-6787  
 Garden City -- (620) 276-2901  
<http://agriculture.ks.gov/dwr>

## DWR FIELD OFFICE APPLICATION FOR APPROVAL TO CHANGE THE PLACE OF USE AND/OR THE POINT OF DIVERSION



STATE OF KANSAS

**Filing Fee Must Accompany the Application, K.S.A. 82a-708b(b), as amended.**  
 Fee Schedule is on the third page of this application form.

**Paragraph Nos. 1, 2, 3 & 5 must be completed. Complete all other applicable portions.** If change in point of diversion is greater than 100 feet, or if place of use will be changed, include a topographic map or detailed plat showing the authorized and proposed point(s) of diversion and/or place of use.

RECEIVED  
 10:34 am  
 SEP 21 2023

File No. 36330

1. Application is hereby made for approval of the Chief Engineer to change the (check one or both):

Place of Use       Point of Diversion

under the water right which is the subject of this application in accordance with the conditions described below.

The source of supply is:       Groundwater       Surface water

Garden City Field Office  
 Division of Water Resources

2. Name and address of Applicant: DESERET TRUST COMPANY

521 50<sup>TH</sup> ROAD, SATANTA, KS 67870

Phone Number: (    )      Email address: \_\_\_\_\_

Name and address of Water Use Correspondent: \_\_\_\_\_

Phone Number: (    )      Email address: \_\_\_\_\_

3. The presently authorized place of use is:

Owner of Land ---- NAME: SAME AS ABOVE

ADDRESS: SAME AS ABOVE

(If there is more than one landowner, attach supplemental sheets as necessary.)

Sec.	Twp.	Range	NE¼				NW¼				SW¼				SE¼				TOTAL ACRES
			NE¼	NW¼	SW¼	SE¼	NE¼	NW¼	SW¼	SE¼	NE¼	NW¼	SW¼	SE¼	NE¼	NW¼	SW¼	SE¼	
27	26	34	34	34	34	34													136

4. If this application is for a change in place of use, it is proposed that the place of use be changed to:

Owner of Land ---- NAME: SAME AS ABOVE

ADDRESS: SAME AS ABOVE

(If there is more than one landowner, attach supplemental sheets as necessary.)

Sec.	Twp.	Range	NE¼				NW¼				SW¼				SE¼				TOTAL ACRES
			NE¼	NW¼	SW¼	SE¼	NE¼	NW¼	SW¼	SE¼	NE¼	NW¼	SW¼	SE¼	NE¼	NW¼	SW¼	SE¼	
27	26	34	34	34	34	34	34	34	34	34	34	34	34	34	34	34	34	34	544

**For Office Use Only:** Code \_\_\_\_\_ Fee \$ 200.00 TR # \_\_\_\_\_ Receipt Date 9-21-23 Check # 21579

5. **Presently authorized point of diversion:**  
 One in the \_\_\_\_\_ Quarter of the \_\_\_\_\_ Quarter of the \_\_\_\_\_ Quarter  
 of Section \_\_\_\_\_, Township \_\_\_\_\_ South, Range \_\_\_\_\_ W,  
 in \_\_\_\_\_ County, Kansas, \_\_\_\_\_ feet North \_\_\_\_\_ feet West of Southeast corner of section.  
 Authorized Rate \_\_\_\_\_ Authorized Quantity \_\_\_\_\_ Depth of well \_\_\_\_\_ (feet)  
**(DWR use only: Computer ID No. 1 \_\_\_\_\_ GPS \_\_\_\_\_ feet North \_\_\_\_\_ feet West)**  
 This point will not be changed  This point will be changed as follows:  No change, point better described with GPS as follows:  
**Proposed point of diversion: (Complete only if change is requested or if existing point is better described by GPS)**  
 One in the \_\_\_\_\_ Quarter of the \_\_\_\_\_ Quarter of the \_\_\_\_\_ Quarter  
 of Section \_\_\_\_\_, Township \_\_\_\_\_ South, Range \_\_\_\_\_ W,  
 in \_\_\_\_\_ County, Kansas, \_\_\_\_\_ feet North \_\_\_\_\_ feet West of Southeast corner of section.  
 Proposed Rate \_\_\_\_\_ Proposed Quantity \_\_\_\_\_ Proposed well depth (feet) \_\_\_\_\_  
 This point is:  Additional Well  Geo Center List other water rights that will use this point \_\_\_\_\_

6. **Presently authorized point of diversion:**  
 One in the \_\_\_\_\_ Quarter of the \_\_\_\_\_ Quarter of the \_\_\_\_\_ Quarter  
 of Section \_\_\_\_\_, Township \_\_\_\_\_ South, Range \_\_\_\_\_ W,  
 in \_\_\_\_\_ County, Kansas, \_\_\_\_\_ feet North \_\_\_\_\_ feet West of Southeast corner of section.  
 Authorized Rate \_\_\_\_\_ Authorized Quantity \_\_\_\_\_ Depth of well \_\_\_\_\_ (feet)  
**(DWR use only: Computer ID No. \_\_\_\_\_ GPS \_\_\_\_\_ feet North \_\_\_\_\_ feet West)**  
 This point will not be changed  This point will be changed as follows:  No change, point better described with GPS as follows:  
**Proposed point of diversion: (Complete only if change is requested or if existing point is better described by GPS)**  
 One in the \_\_\_\_\_ Quarter of the \_\_\_\_\_ Quarter of the \_\_\_\_\_ Quarter  
 of Section \_\_\_\_\_, Township \_\_\_\_\_ South, Range \_\_\_\_\_ W,  
 in \_\_\_\_\_ County, Kansas, \_\_\_\_\_ feet North \_\_\_\_\_ feet West of Southeast corner of section.  
 Proposed Rate \_\_\_\_\_ Proposed Quantity \_\_\_\_\_ Proposed well depth (feet) \_\_\_\_\_  
 This point is:  Additional Well  Geo Center List other water rights that will use this point \_\_\_\_\_

7. The changes herein are desired for the following reasons?  
 (please be specific) \_\_\_\_\_  
 \_\_\_\_\_

8. If a well, is the test hole log attached?  Yes  No

9. The change(s) (was)(will be) completed by?  
 \_\_\_\_\_

10. If the point of diversion is a well:  
**(a)** What are you going to do with the old well?  
 \_\_\_\_\_  
**(b)** When will this be done? \_\_\_\_\_

11. Groundwater Management District recommendation attached?  
 Yes  No

12. Assisted by JG/GCFO \_\_\_\_\_

13a. If the proposed point of diversion will be relocated more than 300 feet but within 2,640 feet of the existing point of diversion, attach a topographic map or aerial photograph. For groundwater sources, show all wells (including domestic) within one-half mile of the proposed point of diversion and the names and mailing addresses of the owners. For surface water sources, show the names and addresses of the landowner(s) one-half mile downstream and one-half mile upstream from your property lines

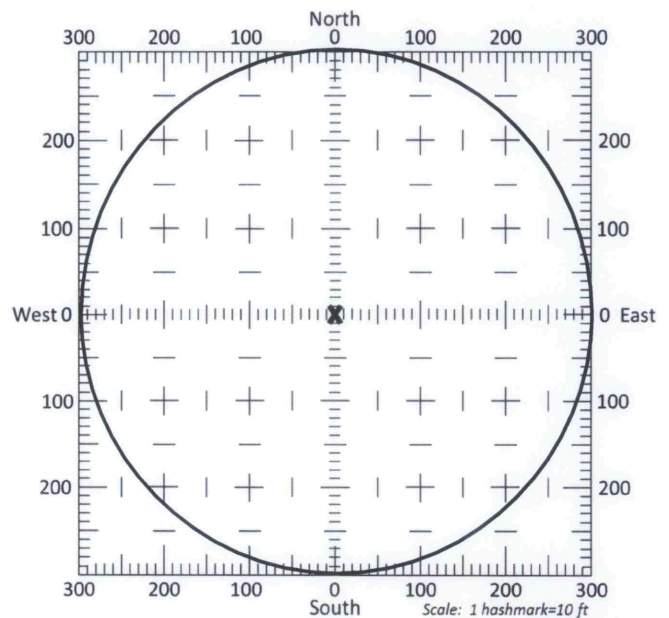

13b. If the proposed point of diversion will be relocated within a 300 foot radius of the existing point of diversion, indicate its location on the diagram shown above in relation to the existing point of diversion. The proposed point of diversion must be located within the circle shown above. **(PLEASE NOTE: The "X" in center of diagram above represents the presently authorized point of diversion.)**

14. If the proposed groundwater point of diversion is 300 or fewer feet from the existing point of diversion, complete the following:
- (a) Does the undersigned represent all owners of the currently authorized place(s) of use identified in this application?  
 Yes     No    (If no, all owners must sign this application.)
  - (b) Will the ownership interest of any owner of the currently authorized place(s) of use identified in this application be adversely affected if this application is approved as requested?  
 Yes     No    (If yes, all owners must sign this application.)
  - (c) If this application is not approved expeditiously, will there be substantial damage to property, public health or safety?  
 Yes     No    (If no, all owners must sign this application.)

If the application proposes a surface water change in point of diversion, a groundwater change in point of diversion greater than 300 feet, or a change in place of use, the application must be signed by all owners of the currently authorized place of use, or their duly authorized agent (attach notarized statement authorizing representation).

I hereby verify, being first duly sworn upon my oath or affirmation and under penalty of perjury, that I am of lawful age and the owner, the spouse of the owner, or a duly authorized agent of the owner(s) to make this application on their behalf, in regards to the water right(s) to which this application pertains. I further verify that the statements contained in this application are true, correct and complete.

Dated at Salt Lake City, <sup>Utah</sup>~~Kansas~~, this 19 day of September, 2023.

<u>Karin Hardy</u> (Owner)	
	(Spouse)
<u>Karin Hardy</u> (Please Print)	
	(Please Print)
<u>Matthew Lawrence</u> (Owner)	
	(Spouse)
<u>Matthew Lawrence</u> (Please Print)	
	(Please Print)
	(Owner)
	(Spouse)
	(Please Print)
	(Please Print)

State of <sup>Utah</sup>~~Kansas~~  
 County of Salt Lake City } SS

I hereby certify that the foregoing application was signed in my presence and sworn to before me this 19 day of September, 2023.

My Commission Expires April 24, 2027

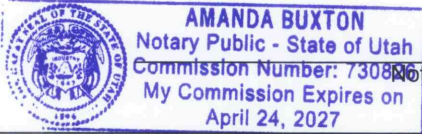

Amanda Buxton  
 Notary Public

**ONLY COMPLETE APPLICATIONS WILL BE PROCESSED.** To be complete, all of the applicable portions of the application form must be completed with accurate information; maps, if necessary, must be included; signatures of all the appropriate owners' must be affixed to the application and notarized; and the appropriate fee must be paid.

**FEE SCHEDULE**

Each application to change the place of use or the point of diversion under this section shall be accompanied by the application fee set forth in the schedule below: Make checks payable to: **Kansas Department of Agriculture**

(1) Application to change a point of diversion 300 feet or less .....	\$100
(2) Application to change a point of diversion more than 300 feet .....	\$200
(3) Application to change the place of use .....	\$200

**SUMMARY ORDER APPROVING APPLICATION FOR CHANGE AND IMPOSING CONDITIONS**

This Summary Order is issued under authority of K.S.A. 82a-708b, as amended, and K.A.R. 5-5-1, et seq. and other applicable provisions of the *Kansas Water Appropriation Law, K.S.A. 82a-701 et. seq.*, and rules and regulations promulgated thereunder, With the exception of those conditions expressly contained herein, this Summary Order does not change the terms, conditions and limitations of File No. 36330.

1. A change application was received on September 21, 2023 requesting that the place of use and / or point of diversion authorized under the above-referenced file number be changed as described in the application.
2. On and after the effective date of this summary order, the authorized place(s) of use shall be located substantially as shown on the topographic map accompanying the application to change the place of use.  Applicable  Not Applicable
3. The change in point of diversion shall not impair existing rights and shall be limited to the same source or sources of water as previously authorized. The point of diversion authorized by this summary order shall be located within a \_\_\_\_\_ foot radius of the authorized point(s) of diversion.  Applicable  Not Applicable
4. The point(s) of diversion described herein is administratively corrected to be more accurately described using the Global Positioning System (GPS), as described in the application.  Applicable  Not Applicable
5. The point(s) of diversion authorized herein shall not actually be located more than \_\_\_\_\_ feet from the previously authorized point(s) of diversion.  Applicable  Not Applicable
6. As required by K.A.R. 5-3-5d, if the works for diversion is a well with a diversion rate of 100 gallons per minute or more, a tube or other device suitable for making water level measurements shall be installed, operated and maintained in accordance with K.A.R. 5-6-13.  Applicable  Not Applicable
7. The owner of the authorized place(s) of use shall properly install an acceptable water flow meter on or before December 31, 2023, or before the first use of water, whichever occurs first. The water flow meter shall be installed, operated and maintained in accordance with K.A.R. 5-1-4 through 5-1-12. As required by K.S.A. 82a-732, as amended, and K.A.R. 5-3-5e, the owner shall maintain records and report the reading of the water flow meter and the total quantity of water diverted annually to the Chief Engineer by March 1 following the end of each calendar year.  Applicable  Not Applicable
8. Installation of the works for diversion of water shall be completed on or before December 31, 2023, or within any authorized extension of time. By March 1, 20\_\_\_\_ the applicant shall notify the Chief Engineer that construction of the works for diversion has been completed, on the form provided by the Chief Engineer, as required by K.A.R. 5-8-4e.  Applicable  Not Applicable
9. The completed well log shall be submitted with the required notice.  Applicable  Not Applicable
10. All diversion works into which any type of chemical or other foreign substance will be injected into the water shall be equipped with an in-line, automatic, quick-closing check valve capable of preventing pollution of the source of the water supply. The check valve(s) shall be installed, operated and maintained in accordance with K.A.R. 5-3-5c.  Applicable  Not Applicable
11. Additional Conditions are attached.  Yes  No
12. In accordance with K.S.A. 82a-708a, as amended, and K.A.R. 5-5-14, all of the owners of the authorized place(s) of use of water appropriated under the above-referenced file number are responsible for compliance with its terms, conditions and limitations, as amended and/or supplemented by this Summary Order, and with applicable provisions of the *Kansas Water Appropriation Law* and the *Rules and Regulations* promulgated thereunder. Failure to comply with these provisions may result in civil penalties pursuant to K.S.A. 82a-737, as amended, and/or the suspension or revocation and dismissal of the water or appropriation right or any other enforcement actions authorized by law.

**Administrative Appeal and Effective Date of Order**

If you are aggrieved by this order, pursuant to K.S.A. 82a-1901, you may request an evidentiary hearing before the Chief Engineer or request administrative review by the Secretary of Agriculture. A request for hearing by the Chief Engineer must be filed within **15 days** of service of this Order and a request for administrative review by the Secretary must be filed within **30 days** pursuant to K.S.A. 77-531. Any request for administrative review must state a basis for review pursuant to K.S.A. 77-527. File any request with **Kansas Department of Agriculture, Legal Division, 1320 Research Park Drive, Manhattan, KS 66502**. Failure to timely request a hearing or review may preclude review under the Kansas Judicial Review Act.

*For Use by Register of Deeds*

**FOR OFFICE USE ONLY**  
**APPLICATION APPROVED AND**  
**SUMMARY ORDER ISSUED**

By: Michael A. Meyer  
Duly Authorized Designee of the Chief Engineer  
(Print Name): MICHAEL A. MEYER  
Division of Water Resources - Kansas Department of Agriculture  
Date of Issuance: September 27, 2023  
State of Kansas )  
) SS  
County of Linn )  
Acknowledged before me on September 27th, 23  
by Michael A. Meyer  
Signature: Aaron Holsted

My commission expires: \_\_\_\_\_  



# CHANGE IN PLACE OF USE WATER RIGHT, FILE NO. 36330

NE 1/4 of Section 27 Township 26 South Range 34 West FINNEY County

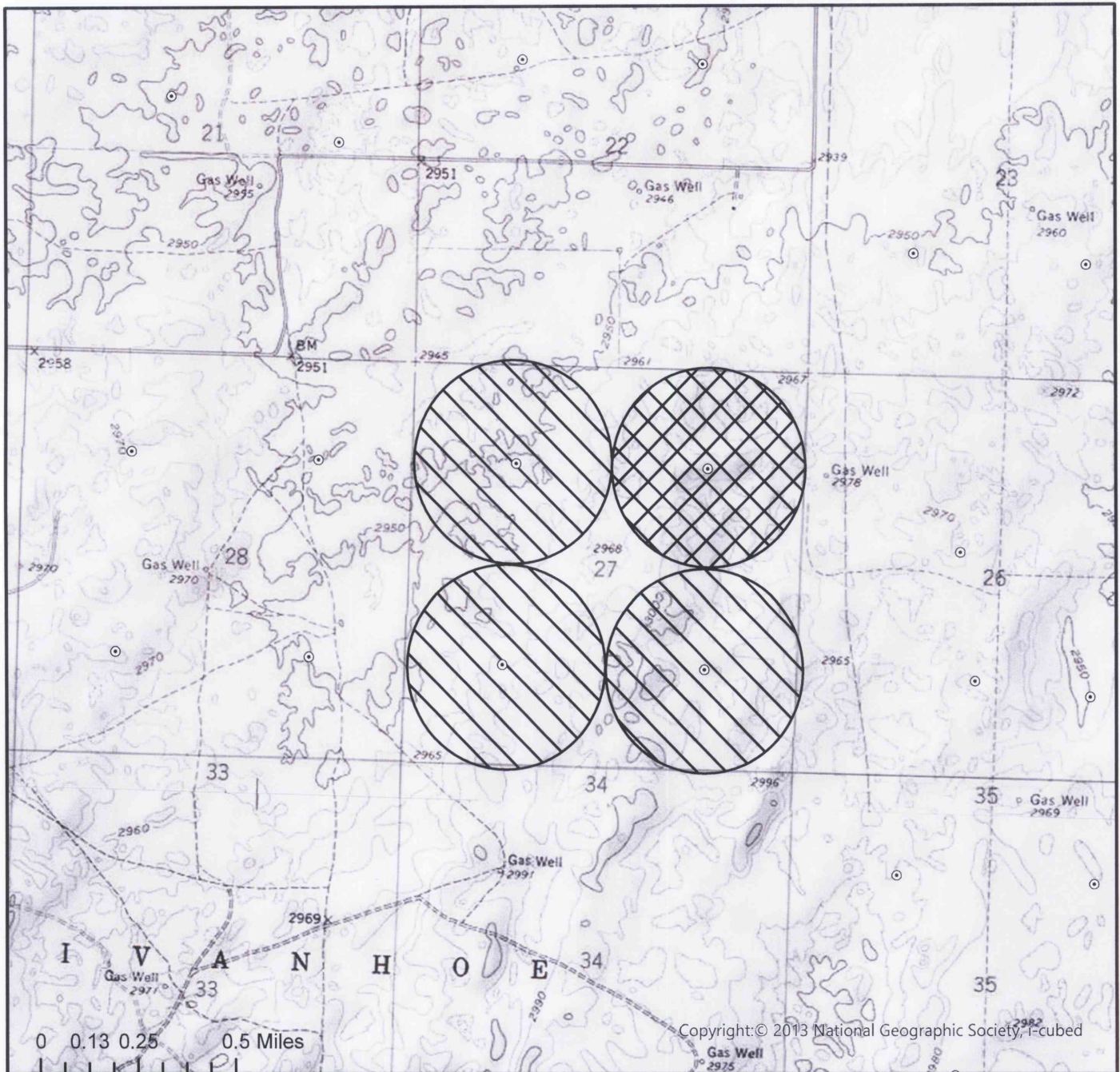

	Authorized Point of Diversion
	Domestic Well within 1/2 mile
	Authorized Place of Use
	Proposed Place of Use

List of owner name and addresses within 1/2 mile:



All wells of any kind within 1/2 mile of the requested place of use have been plotted.

Karin Hardy 9/19/2023  
 (Signature) Date

Walter J. ...



**Southwest Kansas  
Groundwater Management District No. 3**  
2009 E. Spruce Street  
Garden City, Kansas 67846  
(620) 275-7147 phone  
www.gmd3.org

September 26, 2023

Michael A. Meyer  
Division of Water Resources  
4532 W Jones Ave., Suite B  
Garden City, Kansas 67846

RE: Applications for Change in Place of Use  
Water Right, File Nos. 22578 D1, 27106 & 30820  
36324, 36330, 36333 & 36370

Dear Mike:

We have completed a review of the applications for the above referenced water rights. The proposals are not in conflict with the Management Program of the Southwest Kansas Groundwater Management District No. 3 (GMD3). These applications are actually making two separate groupings that proposes to make a change in place of use will make a complete overlap in currently authorized place of use in accordance with K.A.R. 5-5-11(b), respectively. So no new acres are being proposed. It is therefore recommended that the applications be approved at this time.

Thank you for the opportunity to review the applications and to provide a recommendation. If you have any questions, please don't hesitate to contact us.

Sincerely,

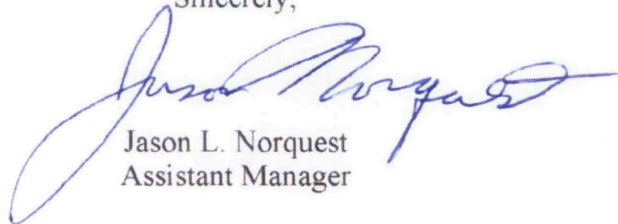

Jason L. Norquest  
Assistant Manager

RECEIVED

SEP 27 2023

Garden City Field Office  
Division of Water Resources

## GMD3 Change Review

---

File No(s): 22578D1, 27106, 30820.

DWR office: GC.

App filed to change: PU.

Is Landowner(s) correct in WRIS: Deseret Trust Company.

If NO, is documentation included?

Is Water Use Correspondent correct in WRIS?    

If NO, is documentation included?

Regulation(s) Reviewed: KAR 5-5-11

Point of diversion ID No(s)     being changed.

	ft. North	ft. West	
Authorized PD			
Proposed PD			
Difference	0	0	
$a^2 + b^2 = c^2$	0	0	0

GPS for proposed PD: Lat:     Long:    

Is proposed PD stacking on existing WRs? No Change.

Is Proposed PU overlapping existing WRs? Making a complete overlap in current acres.

Neighboring certified well(s) notified:    

Name    

Address    

Zip    

Email:     Phone:    

Domestic well(s) notified:    

Name    

Address    

Zip    

Base Acres:    

Perfected Acres:    

Irr. Return-Flow    %

### **Haskell County**

**These water rights are part of a recently approved WCA**

**22578 D1: 4 wells in 35-26-34**

**ID02, 272AF**

**ID05, 272AF**

**ID07, 272AF**

**ID08, 272AF**

**Authorized acres: 136acres/quarter, 544acres total, 35-26-34**

**27106: 260AF, 3960N 3980W, 2-27-34**

**Authorized 159.8 acres NW of 2-27-34**

**30820: 266AF, 4180N 1430W, 2-27-34**

## GMD3 Change Review

---

Authorized 133 acres NE of 2-27-34

Proposed acres:

Same as already listed, this is just making a complete overlap in PU

Is a waiver needed: No new acres being proposed, just a complete overlap in current acres.

Recommendation: After review of all available information, it appears current area rules are met. Staff therefore recommends approval of the applications.



RECEIVED

SEP 27 2023

Garden City Field Office  
Division of Water Resources

## GMD3 Change Review

---

File No(s): 36324, 36330, 36333, 36370.

DWR office: GC.

App filed to change: PU.

Is Landowner(s) correct in WRIS: Deseret Trust Company.

If NO, is documentation included?

Is Water Use Correspondent correct in WRIS?    .

If NO, is documentation included?

Regulation(s) Reviewed: KAR 5-5-11

Point of diversion ID No(s)     being changed.

	ft. North	ft. West
Authorized PD		
Proposed PD		
<hr/>		
Difference	0	0
a2 + b2 = c2	0	0
		0

GPS for proposed PD: Lat:     Long:    .

Is proposed PD stacking on existing WRs? No Change.

Is Proposed PU overlapping existing WRs? Making a complete overlap in current acres.

Neighboring certified well(s) notified:    .

Name    .

Address    .

Zip    .

Email:     Phone:    .

Domestic well(s) notified:    .

Name    .

Address    .

Zip    .

Base Acres:    .

Perfected Acres:    .

Irr. Return-Flow    %

### Finney County

**These water rights are part of recently approved WCA**

**36324: 260AF, 1350N 1320W, 27-26-34**

**Authorized 136acres, SE 27-26-34**

**36330: 260AF, 3940N 1320W, 27-26-34**

**Authorized 136 acres, NE 27-26-34**

**36333: 260AF, 3960N 3930W, 27-26-34**

**Authorized 136 acres NW of 27-26-34**

**36370: 260AF, 1290N 3960W, 27-26-34**

**Authorized 136acres SW of 27-26-34**

**Proposed acres:**

## GMD3 Change Review

---

**Same as already listed, this is just making a complete overlap in PU**

Is a waiver needed: No new acres being proposed, just a complete overlap in current acres.

Recommendation: After review of all available information, it appears current area rules are met. Staff therefore recommends approval of the applications.



RECEIVED

SEP 27 2023

Garden City Field Office  
Division of Water Resources

Garden City Field Office  
4532 W. Jones, Suite B  
Garden City, KS 67846



Phone: 620-276-2901  
Fax: 620-276-9315  
www.agriculture.ks.gov

Mike Beam, Secretary

Laura Kelly, Governor

September 25, 2023

SOUTHWEST KANSAS GROUNDWATER  
MANAGEMENT DISTRICT NO. 3  
2009 E SPRUCE ST  
GARDEN CITY KS 67846

Re: Request for Recommendation  
Water Right, File Nos. 22578-D1, 27106, 30820, & 36324, 36330, 36333, 36370

Dear Mr. Norquest:

This is to advise you that Deseret Trust Company has filed applications for approval of the Chief Engineer, Division of Water Resources, Kansas Department of Agriculture, to change the place of use. There are two groups of applications attached.

We are delaying action on the change application to allow you time to review and provide a recommendation. Please submit a recommendation within 15 days from the date of this letter.

Thank you and as always feel free to contact this office at any time.

Sincerely,

A handwritten signature in blue ink that reads "Michael A. Meyer".

Michael A. Meyer  
Water Commissioner

MAM  
Enclosures

**CERTIFICATE OF RESOLUTION**

I, the undersigned, Assistant Secretary of Deseret Trust Company, a Utah corporation, hereby certify that the following is a true copy of a certain resolution duly adopted by the Board of Trustees of the said corporation and recorded in the Minutes of a meeting of the said Board duly held on the 23<sup>rd</sup> day of February 2023, at which time a quorum was present, and that the same has not been rescinded or modified and is now in full force and effect.

I further certify that said corporation is duly organized and existing and has the power to take the action called for by the following resolution.

RESOLVED: The following officers shall be elected, each to hold the respective office until they shall resign or shall be removed or otherwise disqualified to serve, or a successor shall be qualified and elected:

Chairman of the Board/President/CEO	M. Wesley Mashburn
Vice-Chairman of Board of Trustees	Kent H. Collins
VP/Chief Financial Officer/BSA/AML Officer	Matthew S. Lawrence
VP/Sr. Trust Officer & Asst. Secretary	Karin S. Hardy
Treasurer	Scott B. Colton
Senior Trust Administrator	Denisha R. Harris
Trust Officer	Tyler G. Burnett
Trust Officer	Ryan L. Gonda
Trust Officer	Ryan T. Jenkins
BSA/AML Officer	Christina Cheney
Secretary & General Counsel	Lucas R. Deppermann
Assistant Treasurer	Douglas H. Martin
Assistant Treasurer	Gregory N. Tarbet

IN WITNESS WHEREOF, I have hereunto subscribed my name and affixed the seal of the said corporation this 30<sup>th</sup> day of March 20 23.

(SEAL)

DESERET TRUST COMPANY

RECEIVED

SEP 21 2023

Garden City Field Office  
Division of Water Resources

By   
Karin S. Hardy, Assistant Secretary





**CERTIFICATE OF RESOLUTION**

I, the undersigned, Assistant Secretary of Deseret Trust Company, a Utah corporation, hereby certify that the following is a true copy of a certain resolution duly adopted by the Board of Trustees of the said corporation and recorded in the Minutes of a meeting of the said Board duly held on the 23<sup>rd</sup> day of February 2023, at which time a quorum was present, and that the same has not been rescinded or modified and is now in full force and effect.

I further certify that said corporation is duly organized and existing and has the power to take the action called for by the following resolution.

RESOLVED: The President/CEO of Deseret Trust Company acting alone, or in his absence at least two (2) Vice Presidents, is authorized to perform all acts or execute any and all instruments, including deeds and endorsements necessary and proper or desirable for the sale, purchase, pledge, assignment, transfer, discharge and release of real estate, notes and other obligations, mortgages (real estate or chattel) or deeds of trust held by Deseret Trust Company in its own right or in any fiduciary capacity, pursuant to and in accordance with the terms of any such purchase, sale, pledge, assignment, transfer, discharge and release as approved by the Investment Review Committee (IRC).

IN WITNESS WHEREOF, I have hereunto subscribed my name and affixed the seal of the said corporation this 30<sup>th</sup> day of March 2023.

DESERET TRUST COMPANY

(SEAL)

By Karin S. Hardy  
Karin S. Hardy, Assistant Secretary

RECEIVED  
SEP 21 2023  
Garden City Field Office  
Division of Water Resources