

Kansas Department of Agriculture
 Division of Water Resources
CHANGE: P/D WORKSHEET

1. File Number: 437	2. Status Change Date: 2-9-2023	3. Change Num: C1	4. Field Office: 4	5. GMD: 3
-------------------------------	---	-----------------------------	------------------------------	---------------------

6. Status: <input checked="" type="checkbox"/> Approved <input type="checkbox"/> Denied by DWR/GMD <input type="checkbox"/> Dismiss by Request/Failure to Return	7. Filing Date of Change: 1/23/2023
--	---

8a. Applicant, Landowner New to system <input type="checkbox"/> LEON KILGORE 204 S KNOX BOX 351 JOHNSON, KS 67855	8c. Landowner(s) New to system <input type="checkbox"/> 8a
Person ID 9355 Add Seq# _____	Person ID _____ Add Seq# _____

8b. Landowner(s) New to system <input type="checkbox"/>	8d. WUC New to system <input type="checkbox"/> BRYCE A & RHONDA F WILKERSON PO BOX 568 JOHNSON, KS 67855-0568
Person ID _____ Add Seq# _____	Person ID 25302 Add Seq# _____

9. Documents and Enclosure(s): DWR Meter(s) Date to Comply: **12/31/2023** N & P Date to Comply: **3/1/2024**

Anti-Reverse Meter Meter Seal Check Valve N & P Form Water Tube Driller Copy H & E Letter

Conservation Plan Date Required: _____ Date Approved: _____ Date to Comply: _____

10. Use Made of Water From: _____ To: _____

Date Prepared: **1/31/2023** By: **MAM**
 Date Entered: _____ By: _____

File No. **437** 11. County: **ST** Basin: **NF CIMARRON RIVER** Stream: Formation Code: **211/331** Special Use:

12. Points of Diversion
 CHK
 MOD
 DEL
 ENT PDIV
 Qualifier S T R ID 'N 'W Comment (AKA Line) Rate gpm Quantity af Additional Rate gpm Quantity af Overlap PD Files

DEL 30342
ENT SENENW 20 29 29W 4401 3163 1800 320 1800 320 9150

13. Storage: Rate _____ NF Quantity _____ ac/ft Additional Rate _____ NF Additional Quantity _____ ac/ft

14. Limitation: _____ af/yr at _____ gpm (_____ cfs) when combined with file number(s) _____
 Limitation: _____ af/yr at _____ gpm (_____ cfs) when combined with file number(s) _____

15. 5YR Allocation: Allocation Type _____ Start Year _____ 5 YR Amount _____ Amount Unit _____ Base Acres _____ Comment _____

16. Place of Use CHK MOD DEL ENT PUSE S T R ID	NE¼				NW¼				SW¼				SE¼				Total	Owner	Chg?	Overlap Files
	NE ¼	NW ¼	SW ¼	SE ¼	NE ¼	NW ¼	SW ¼	SE ¼	NE ¼	NW ¼	SW ¼	SE ¼	NE ¼	NW ¼	SW ¼	SE ¼				
CHK 20079																				

Base Acres: Year: Minimum Reasonable Quantity:
 Comments:

Garden City Field Office
4532 W. Jones, Suite B
Garden City, KS 67846



Phone: 620-276-2901
Fax: 620-276-9315
www.agriculture.ks.gov

Mike Beam, Secretary

Laura Kelly, Governor

February 9, 2023

LEON KILGORE
204 S KNOX BOX 351
JOHNSON, KS 67855

RE: Field Office Application for Change
Water Right, File Nos. 437 and 9150

Dear Sir:

Enclosed are orders executed by the designee of the Chief Engineer, Division of Water Resources, Kansas Department of Agriculture, approving the applications for change under the above referenced file numbers.

Your attention is directed to the enclosures and to the terms, conditions, and limitations specified in these approvals for change. A condition of this approval is that an acceptable water flow meter must be installed on the diversion works authorized under the referenced file number and meet current specifications. Please return the required notification of completion of the diversion works and installation of the required meter as soon as these actions are completed. Please note the reminder of the existing additional condition attached.

Since the order modifies the original document referred to above, it should be recorded with the Register of Deeds as other instruments affecting real estate.

The abandoned well must be plugged in accordance with the requirements of Article 30 of the Rules and Regulations as adopted by the Kansas Department of Health and Environment.

Should you have any questions, please feel free contact this office. If you would prefer, you could arrange an appointment for additional assistance.

Sincerely,

A handwritten signature in blue ink that reads "Michael A. Meyer".

Michael A. Meyer
Water Commissioner

MAM:

Enclosures

pc: Bryce & Rhonda Wilkerson
GMD3

CERTIFICATE OF SERVICE

On this 9th day of February 2023, I hereby certify that the foregoing Approval of Application for Change in Point of Diversion, Water Right, File Nos. 437 and 9,150 dated 9th day of February 2023 was mailed postage prepaid, first class, US mail to the following:

LEON KILGORE
204 S KNOX BOX 351
JOHNSON, KS 67855

pc:

BRYCE A & RHONDA F WILKERSON
PO BOX 568
JOHNSON, KS 67855-0568

GMD3

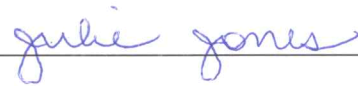

Division of Water Resources Staff

Submit completed application to:
 Kansas Department of Agriculture
 Division of Water Resources
 Field Office for your area.
 Call for address:

Topeka -- (785) 296-5733
 Stafford -- (620) 234-5311
 Stockton -- (785) 425-6787
 Garden City -- (620) 276-2901
<http://agriculture.ks.gov/dwr>

DWR FIELD OFFICE APPLICATION FOR APPROVAL TO CHANGE THE PLACE OF USE AND/OR THE POINT OF DIVERSION



STATE OF KANSAS

Filing Fee Must Accompany the Application, K.S.A. 82a-708b(b), as amended.
 Fee Schedule is on the third page of this application form.

Paragraph Nos. 1, 2, 3 & 5 must be completed. Complete all other applicable portions. If change in point of diversion is greater than 100 feet, or if place of use will be changed, include a topographic map or detailed plat showing the authorized and proposed point(s) of diversion and/or place of use.

File No. 437

RECEIVED
 11:06 am
 JAN 23 2023

1. Application is hereby made for approval of the Chief Engineer to change the (check one or both):

Place of Use Point of Diversion

Garden City Field Office
 Division of Water Resources

under the water right which is the subject of this application in accordance with the conditions described below.

The source of supply is: Groundwater Surface water

2. Name and address of Applicant: KILGORE FARMS LLC

5201 E 3RD STREET NORTH KECHI, KS. 67067

Phone Number: (620)353 8326

Email address: _____

Name and address of Water Use Correspondent: BRYCE A & RHONDA F WILKERSON

PO BOX 568 JHONSON, KS. 67855

Phone Number: (620)353 8326

Email address: _____

3. The presently authorized place of use is:

Owner of Land ---- NAME: NO CHANGE

ADDRESS: _____

(If there is more than one landowner, attach supplemental sheets as necessary.)

Sec.	Twp.	Range	NE¼				NW¼				SW¼				SE¼				TOTAL ACRES		
			NE¼	NW¼	SW¼	SE¼	NE¼	NW¼	SW¼	SE¼	NE¼	NW¼	SW¼	SE¼	NE¼	NW¼	SW¼	SE¼			

4. If this application is for a change in place of use, it is proposed that the place of use be changed to:

Owner of Land ---- NAME: NO CHANGE

ADDRESS: _____

(If there is more than one landowner, attach supplemental sheets as necessary.)

Sec.	Twp.	Range	NE¼				NW¼				SW¼				SE¼				TOTAL ACRES			
			NE¼	NW¼	SW¼	SE¼	NE¼	NW¼	SW¼	SE¼	NE¼	NW¼	SW¼	SE¼	NE¼	NW¼	SW¼	SE¼				

For Office Use Only: Code _____ Fee \$ 200.00 TR # _____ Receipt Date 1-23-23 Check # 2076

5. **Presently authorized point of diversion:**
 One in the SW Quarter of the SW Quarter of the NW Quarter of Section 20, Township 29 South, Range 39 W, in STANTON County, Kansas, 2772 feet North 5082 feet West of Southeast corner of section.
 Authorized Rate 1800 GPM Authorized Quantity 320 AF Depth of well _____ (feet)
(DWR use only: Computer ID No. 1 GPS _____ feet North _____ feet West)
 This point will not be changed This point will be changed as follows: No change, point better described with GPS as follows:
Proposed point of diversion: (Complete only if change is requested or if existing point is better described by GPS)
 One in the SE Quarter of the NE Quarter of the NW Quarter of Section 20, Township 29 South, Range 39 W, in STANTON County, Kansas, 4401 feet North 3163 feet West of Southeast corner of section.
 Proposed Rate 580 Proposed Quantity 9150 Proposed well depth (feet) _____
 This point is: Additional Well Geo Center List other water rights that will use this point _____

6. **Presently authorized point of diversion:**
 One in the _____ Quarter of the _____ Quarter of the _____ Quarter of Section _____, Township _____ South, Range _____ (E/W), in _____ County, Kansas, _____ feet North _____ feet West of Southeast corner of section.
 Authorized Rate _____ Authorized Quantity _____ Depth of well _____ (feet)
(DWR use only: Computer ID No. _____ GPS _____ feet North _____ feet West)
 This point will not be changed This point will be changed as follows: No change, point better described with GPS as follows:
Proposed point of diversion: (Complete only if change is requested or if existing point is better described by GPS)
 One in the _____ Quarter of the _____ Quarter of the _____ Quarter of Section _____, Township _____ South, Range _____ (E/W), in _____ County, Kansas, _____ feet North _____ feet West of Southeast corner of section.
 Proposed Rate _____ Proposed Quantity _____ Proposed well depth (feet) _____
 This point is: Additional Well Geo Center List other water rights that will use this point _____

7. The changes herein are desired for the following reasons?
 (please be specific) Lack of production on current location

8. If a well, is the test hole log attached? Yes No

9. The change(s) (was)(will be) completed by?

10. If the point of diversion is a well:
 (a) What are you going to do with the old well?
To be plugged
 (b) When will this be done? _____

11. Groundwater Management District recommendation attached?
 Yes No

12. Assisted by cac

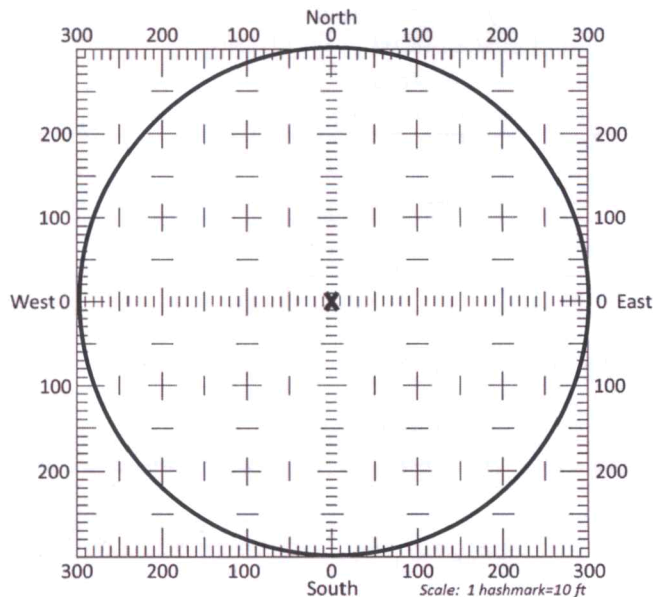

13a. If the proposed point of diversion will be relocated more than 300 feet but within 2,640 feet of the existing point of diversion, attach a topographic map or aerial photograph. For groundwater sources, show all wells (including domestic) within one-half mile of the proposed point of diversion and the names and mailing addresses of the owners. For surface water sources, show the names and addresses of the landowner(s) one-half mile downstream and one-half mile upstream from your property lines

13b. If the proposed point of diversion will be relocated within a 300 foot radius of the existing point of diversion, indicate its location on the diagram shown above in relation to the existing point of diversion. The proposed point of diversion must be located within the circle shown above. **(PLEASE NOTE: The "X" in center of diagram above represents the presently authorized point of diversion.)**

14. If the proposed groundwater point of diversion is 300 or fewer feet from the existing point of diversion, complete the following:

- (a) Does the undersigned represent all owners of the currently authorized place(s) of use identified in this application?
 Yes No (If no, all owners must sign this application.)
- (b) Will the ownership interest of any owner of the currently authorized place(s) of use identified in this application be adversely affected if this application is approved as requested?
 Yes No (If yes, all owners must sign this application.)
- (c) If this application is not approved expeditiously, will there be substantial damage to property, public health or safety?
 Yes No (If no, all owners must sign this application.)

If the application proposes a surface water change in point of diversion, a groundwater change in point of diversion greater than 300 feet, or a change in place of use, the application must be signed by all owners of the currently authorized place of use, or their duly authorized agent (attach notarized statement authorizing representation).

I hereby verify, being first duly sworn upon my oath or affirmation and under penalty of perjury, that I am of lawful age and the owner, the spouse of the owner, or a duly authorized agent of the owner(s) to make this application on their behalf, in regards to the water right(s) to which this application pertains. I further verify that the statements contained in this application are true, correct and complete.

Dated at 17th (m) Sedgewick County Kansas, this 17th day of January, 20 23.

Sign Here

[Signature]
(Owner) _____ (Spouse) _____

LEONAL W KILGORE
(Please Print) _____ (Please Print) _____

KILGORE FARMS LLC
(Owner) _____ (Spouse) _____

(Please Print) _____ (Please Print) _____

(Owner) _____ (Spouse) _____

(Please Print) _____ (Please Print) _____

State of Kansas }
County of Sedgewick } SS

MARCUS C. MASON
Notary Public - State of Kansas
My Appointment Expires 2-10-26

I hereby certify that the foregoing application was signed in my presence and sworn to before me this 17th day of January, 20 23.

[Signature]
Notary Public

My Commission Expires 2-10-2026.

ONLY COMPLETE APPLICATIONS WILL BE PROCESSED. To be complete, all of the applicable portions of the application form must be completed with accurate information; maps, if necessary, must be included; signatures of all the appropriate owners' must be affixed to the application and notarized, and the appropriate fee must be paid.

FEE SCHEDULE

Each application to change the place of use or the point of diversion under this section shall be accompanied by the application fee set forth in the schedule below: (Make checks payable to: **Kansas Department of Agriculture**)

- (1) Application to change a point of diversion 300 feet or less \$100
- (2) Application to change a point of diversion more than 300 feet \$200
- (3) Application to change the place of use \$200

FILE # 437

SUMMARY ORDER APPROVING APPLICATION FOR CHANGE AND IMPOSING CONDITIONS

This Summary Order is issued under authority of K.S.A. 82a-708b, as amended, and K.A.R. 5-5-1, *et seq.* and other applicable provisions of the *Kansas Water Appropriation Law, K.S.A. 82a-701 et seq.*, and rules and regulations promulgated thereunder, With the exception of those conditions expressly contained herein, this Summary Order does not change the terms, conditions and limitations of File No. 437.

1. A change application was received on January 23, 2023 requesting that the place of use and / or point of diversion authorized under the above-referenced file number be changed as described in the application.
2. On and after the effective date of this summary order, the authorized place(s) of use shall be located substantially as shown on the topographic map accompanying the application to change the place of use. Applicable Not Applicable
3. The change in point of diversion shall not impair existing rights and shall be limited to the same source or sources of water as previously authorized. The point of diversion authorized by this summary order shall be located within a 300 foot radius of the authorized point(s) of diversion. Applicable Not Applicable
4. The point(s) of diversion described herein is administratively corrected to be more accurately described using the Global Positioning System (GPS), as described in the application. Applicable Not Applicable
5. The point(s) of diversion authorized herein shall not actually be located more than 2640 feet from the previously authorized point(s) of diversion. Applicable Not Applicable
6. As required by K.A.R. 5-3-5d, if the works for diversion is a well with a diversion rate of 100 gallons per minute or more, a tube or other device suitable for making water level measurements shall be installed, operated and maintained in accordance with K.A.R. 5-6-13. Applicable Not Applicable
7. **The owner of the authorized place(s) of use shall properly install an acceptable water flow meter on or before December 31, 2023**, or before the first use of water, whichever occurs first. The water flow meter shall be installed, operated and maintained in accordance with K.A.R. 5-1-4 through 5-1-12. As required by K.S.A. 82a-732, as amended, and K.A.R. 5-3-5e, the owner shall maintain records and report the reading of the water flow meter and the total quantity of water diverted annually to the Chief Engineer by March 1 following the end of each calendar year.
 Applicable Not Applicable
8. **Installation of the works for diversion of water shall be completed on or before December 31, 2023**, or within any authorized extension of time. By March 1, 2024 the applicant shall notify the Chief Engineer that construction of the works for diversion has been completed, on the form provided by the Chief Engineer, as required by K.A.R. 5-8-4e.
 Applicable Not Applicable
9. **The completed well log shall be submitted with the required notice.** Applicable Not Applicable
10. All diversion works into which any type of chemical or other foreign substance will be injected into the water shall be equipped with an in-line, automatic, quick-closing check valve capable of preventing pollution of the source of the water supply. The check valve(s) shall be installed, operated and maintained in accordance with K.A.R. 5-3-5c. Applicable Not Applicable
11. Additional Conditions are attached. Yes No
12. In accordance with K.S.A. 82a-708a, as amended, and K.A.R. 5-5-14, all of the owners of the authorized place(s) of use of water appropriated under the above-referenced file number are responsible for compliance with its terms, conditions and limitations, as amended and/or supplemented by this Summary Order, and with applicable provisions of the *Kansas Water Appropriation Law* and the *Rules and Regulations* promulgated thereunder. Failure to comply with these provisions may result in civil penalties pursuant to K.S.A. 82a-737, as amended, and/or the suspension or revocation and dismissal of the water or appropriation right or any other enforcement actions authorized by law.

Administrative Appeal and Effective Date of Order

If you are aggrieved by this order, pursuant to K.S.A. 82a-1901, you may request an evidentiary hearing before the Chief Engineer or request administrative review by the Secretary of Agriculture. A request for hearing by the Chief Engineer must be filed within **15 days** of service of this Order and a request for administrative review by the Secretary must be filed within **30 days** pursuant to K.S.A. 77-531. Any request for administrative review must state a basis for review pursuant to K.S.A. 77-527. File any request with **Kansas Department of Agriculture, Legal Division, 1320 Research Park Drive, Manhattan, KS 66502**. Failure to timely request a hearing or review may preclude review under the Kansas Judicial Review Act.

For Use by Register of Deeds

FOR OFFICE USE ONLY
APPLICATION APPROVED AND SUMMARY ORDER ISSUED

By: Michael A. Meyer
Duly Authorized Designee of the Chief Engineer
(Print Name): MICHAEL A. MEYER
Division of Water Resources - Kansas Department of Agriculture

Date of Issuance: February 9, 2023
State of Kansas)
County of Finney) SS

Acknowledged before me on February 9, 2023
by Michael A Meyer
Signature: Julie Jones
Notary Public

My commission expires:

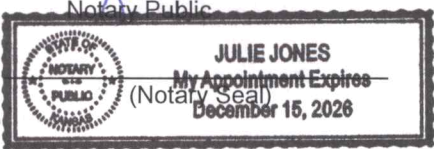

Point of Diversion Change WR's 437 & 9150 T29 R39W Section 20 Stanton Co.,

Spacing distances are estimated on rough GPS on data base and or GPS submitted by customer, is sole responsibility of the owner or agent to select location for test hole(s) within required distances from surrounding PD(s) & 1/2 mile radius from Authorized PD, including domestic wells

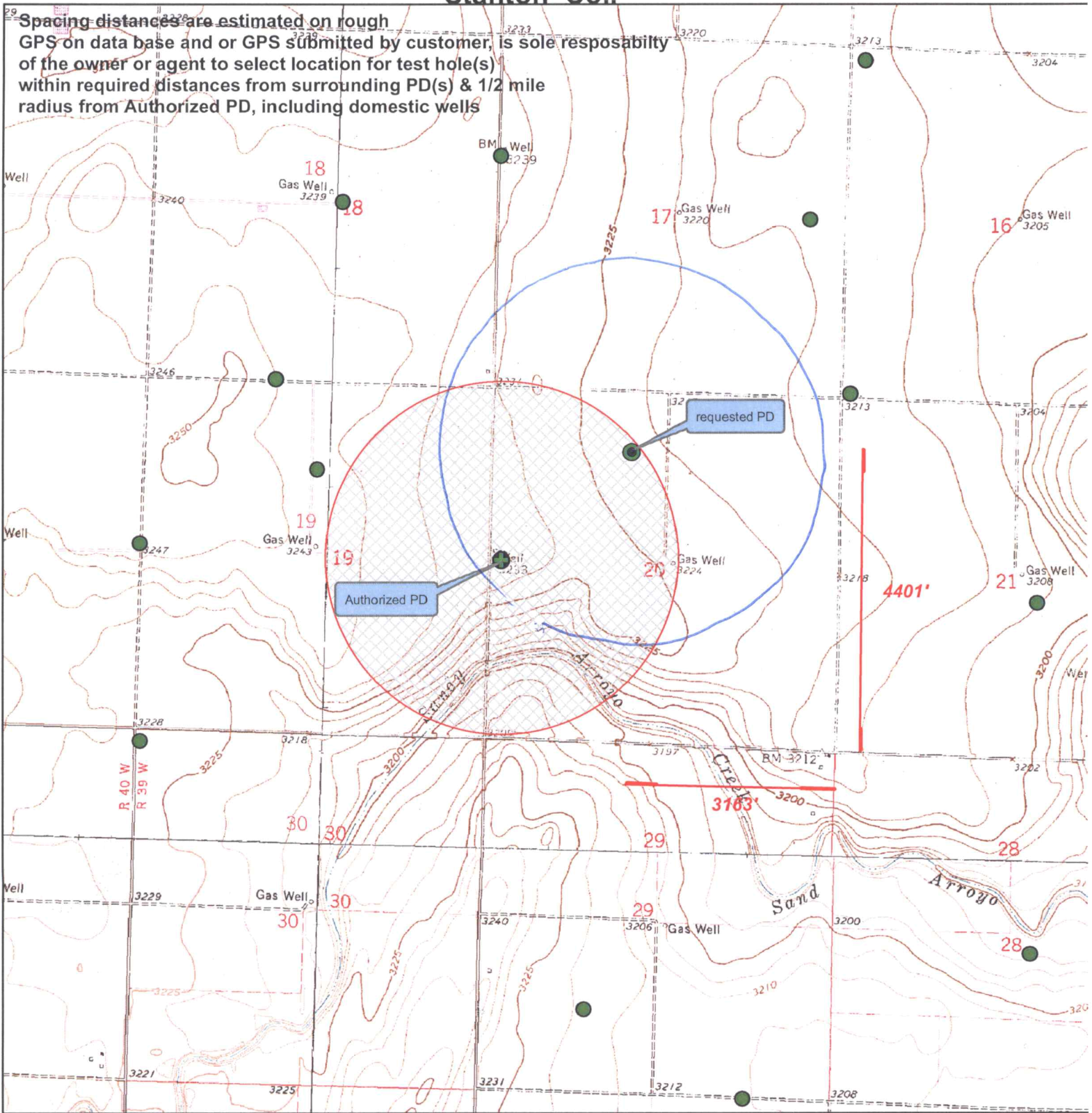

- Authorized PD
- Requested PD
- Point of Diversion
- Active Water Right w/in 1/2 mile

- ⊗ Half Mile Radius
- + domestic well w/in 1/2 mile

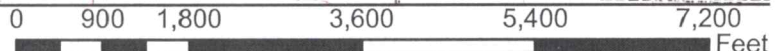

Applicant Signature & Date

By signing this map the applicant is aware that no other wells (Irrigation, Domestic, Industrial etc) are within the 1/2 mile radius circle.

3795 W. Jones Ave.
Garden City, KS 67846
PH: 620-277-2389



PO Box 639
Garden City, KS 67846
Fax: 620-277-0224

FARMER: BRYCE WILKERSON

CELL 620-353-8326

4401' N / 3163' W
SE N E N W

Customer Name: Kilgore Farms, LLC WO#: 24704 Date: 12-20-22
Street Address: 5201 E. 3RD STREET, NORTH Test #: 3 E LOG: _____
City, State: KECHI, KS 67067 Driller: Dale Guinn
County: Stanton Quarter: NW Section: 20 Township: 29 Range: 39
Location: _____ GPS: N37.51641 W101.60983
Rig #: 10002 Elevation: _____ Static WL: _____ Estimated? 350FT

2560' NORTHEAST OF EXISTING WELL

WELL LOCATION

Proposed Well Depth 553
20' SUMP

%	Footage			Description of Strata	4370 9150 20.41
	From	Pay	To		
	0		2	Top Soil	
	2		58	Brown Sandy Clay	
	58		94	Brown Sandy Clay w/ some Caliche + Fine Sand Mixed	
	94		100	Sand Fine Med Course	
	100		111	Sand Fine Med w/ Few Clay Layers	
	111		127	Brown Clay w/ Few Thin Sand Strips	
	127		140	Brown + Light Blue Clay	
	140		197	Brown Clay	
	197		201	Sand Fine	
	201		210	Brown Clay	
	210		225	Sand Fine w/ Few Clay Layers	
	225		251	Sand Fine Med Course	
	251		264	Brown Clay	
	264		275	Sand Fine Med	
	275		312	Brown Clay	
	312		328	Sand Fine Med Course	
	328		337	Brown Clay	
35	337	60	410	Sand Fine Med Course w/ Brown + Tan Rock	
	410		416	Yellow Soapstone + Some False Red Bed	
10	416	41	457	Sandstone w/ Few Soapstone Strips "Used Little Water"	
15	457	27	484	Sandstone	
5	484	49	533	Sandstone + Soapstone	
	533		559	Soapstone	
	559		580	Red Bed	
				Super Gel X	-4
				Grout	-4
				Hole Plug	-6
				Perms Plug	-1
				4 3/4 Drag Blade	-1

Kilgore Farms, LLC

Test Hole # 3 of 12-20-22

REPLACEMENT WELL LOCATION
NW 20-29-39 ST

FILE #'s 437 & 9150 Id. # 1

Legend

 37.51641 N 101.60983 W

 37.51641 N 101.60983 W



Garden City Field Office
4532 W. Jones, Suite B
Garden City, KS 67846



Phone: 620-276-2901
Fax: 620-276-9315
www.agriculture.ks.gov

Mike Beam, Secretary

Laura Kelly, Governor

January 23, 2023

SOUTHWEST KANSAS GROUNDWATER
MANAGEMENT DISTRICT NO. 3
2009 E SPRUCE ST
GARDEN CITY KS 67846

Re: Request for Recommendation
Water Right, File Nos. 437 & 9150

Dear Mr. Norquest:

This is to advise you that the Kilgore Farms LLC filed applications for approval of the Chief Engineer, Division of Water Resources, Kansas Department of Agriculture, to change the point of diversion.

We are delaying action on the change applications to allow you time to review and provide a recommendation. Please submit a recommendation within 15 days from the date of this letter.

Thank you and as always feel free to contact this office at any time.

Sincerely,

A handwritten signature in blue ink that reads "Michael A. Meyer".

Michael A. Meyer
Water Commissioner

MAM
Enclosures