

WATER RESOURCES RECEIVED

JUL 19 2024

11:25

KS Dept. of Agriculture



State of Kansas

Submit To: CHIEF ENGINEER  
Division of Water Resources  
Kansas Department of Agriculture  
1320 Research Park Drive  
Manhattan, Kansas 66502  
http://agriculture.ks.gov/dwr

APPLICATION FOR APPROVAL TO  
CHANGE THE PLACE OF USE, THE  
POINT OF DIVERSION OR THE USE  
MADE OF THE WATER UNDER AN  
EXISTING WATER RIGHT

Filing Fee Must Accompany the Application  
(Please refer to Fee Schedule on signature page of application form.)

Paragraph Nos. 1, 2, 3, 4 & 8 must be completed. Complete all other applicable portions. A topographic map or detailed plat showing the authorized and proposed points(s) of diversion and /or place of use must accompany this application.

1. Application is hereby made for approval of the Chief Engineer to change the

- Place of Use
- (Check one or more)  Point of Diversion
- Use Made of Water

File No. 10946-IND

2. Name of applicant: APC, LLC

Address: 1197 Highway 83

City, State and Zip: Sublette, KS 67877

Phone Number: (515) 963-4847 E-mail address: Victor.Ibarra@apcproteins.com

What is your relationship to the water right;  owner  tenant  agent  other? If other, please explain. \_\_\_\_\_

Name of water use correspondent: Victor Ibarra

Address: same as above

City, State and Zip: \_\_\_\_\_

Phone Number: ( ) \_\_\_\_\_ E-mail address: \_\_\_\_\_

3. The change(s) proposed herein are desired for the following reasons (please be specific): \_\_\_\_\_

The preexisting well that was used for industrial water will remain and now be used as a standby well and metered.

The change(s) (was) (will be) completed by 7/1/2024  
(Date)

For Office Use Only:															
F.O.	<u>4</u>	GMD	<u>3</u>	Meets K.A.R. 5-5-1	<input checked="" type="checkbox"/> YES / <input type="checkbox"/> NO	Use	<u>IND</u>	Source	<input type="checkbox"/> G / <input checked="" type="checkbox"/> S	County	<u>HS</u>	By	<u>KJN</u>	Date	<u>7/23/24</u>
Code	<u>C67</u>	Fee \$	<u>200</u>	TR #		Receipt Date	<u>7-19-24</u>	Check #	<u>2505003679</u>	<i>Money order</i>					

7/24/2024  
KAnderson

WATER RESOURCES  
RECEIVED

JUL 19 2024

File No. 10946-IND

4. The presently authorized place of use is:

KS Dept. of Agriculture

Owner of Land — NAME: APC, LLC

ADDRESS: 1197 Highway 83, Sublette, KS 67877

Sec.	Twp.	Range	NE¼				NW¼				SW¼				SE¼				TOTAL ACRES		
			NE¼	NW¼	SW¼	SE¼	NE¼	NW¼	SW¼	SE¼	NE¼	NW¼	SW¼	SE¼	NE¼	NW¼	SW¼	SE¼			

List any other water rights that cover this place of use. \_\_\_\_\_

Owner of Land — NAME: \_\_\_\_\_

ADDRESS: \_\_\_\_\_

Sec.	Twp.	Range	NE¼				NW¼				SW¼				SE¼				TOTAL ACRES			
			NE¼	NW¼	SW¼	SE¼	NE¼	NW¼	SW¼	SE¼	NE¼	NW¼	SW¼	SE¼	NE¼	NW¼	SW¼	SE¼				

List any other water rights that cover this place of use. \_\_\_\_\_

(If there are more than two landowners, attach additional sheets as necessary.)

5. It is proposed that the place of use be changed to:

Owner of Land — NAME: \_\_\_\_\_

ADDRESS: \_\_\_\_\_

Sec.	Twp.	Range	NE¼				NW¼				SW¼				SE¼				TOTAL ACRES				
			NE¼	NW¼	SW¼	SE¼	NE¼	NW¼	SW¼	SE¼	NE¼	NW¼	SW¼	SE¼	NE¼	NW¼	SW¼	SE¼					

List any other water rights that cover this place of use. \_\_\_\_\_

Owner of Land — NAME: \_\_\_\_\_

ADDRESS: \_\_\_\_\_

Sec.	Twp.	Range	NE¼				NW¼				SW¼				SE¼				TOTAL ACRES					
			NE¼	NW¼	SW¼	SE¼	NE¼	NW¼	SW¼	SE¼	NE¼	NW¼	SW¼	SE¼	NE¼	NW¼	SW¼	SE¼						

List any other water rights that cover this place of use. \_\_\_\_\_

JUL 19 2024

KS Dept. of Agriculture

File No. 10946-IND

6. The presently authorized point(s) of diversion (is) (are) One point of diversion  
(Provide description and number of points)
7. The proposed point(s) of diversion (is) (are) Two points of diversion  
(Provide description and number of points)

List all presently authorized point(s) of diversion:

8. **Presently authorized point of diversion:** (new well location)

One in the NE Quarter of the NE Quarter of the NE Quarter of Section 25, Township 28S South, Range 33W (E/W), in Haskell County, Kansas, 4701 feet North 175 feet West of Southeast corner of section.  
Authorized Rate \_\_\_\_\_ Authorized Quantity \_\_\_\_\_  
(DWR use only: Computer ID No. \_\_\_\_\_ GPS \_\_\_\_\_ feet North \_\_\_\_\_ feet West)  
 This point will not be changed  This point will be changed as follows:

**Proposed point of diversion: (Complete only if change is requested)**

One in the \_\_\_\_\_ Quarter of the \_\_\_\_\_ Quarter of the \_\_\_\_\_ Quarter of Section \_\_\_\_\_, Township \_\_\_\_\_ South, Range \_\_\_\_\_ (E/W), in \_\_\_\_\_ County, Kansas, \_\_\_\_\_ feet North \_\_\_\_\_ feet West of Southeast corner of section.  
Proposed Rate \_\_\_\_\_ Proposed Quantity \_\_\_\_\_  
This point is:  Additional Well  Geo Center List other water rights that will use this point 11104-D2

9. **Presently authorized point of diversion:**

One in the \_\_\_\_\_ Quarter of the \_\_\_\_\_ Quarter of the \_\_\_\_\_ Quarter of Section \_\_\_\_\_, Township \_\_\_\_\_ South, Range \_\_\_\_\_ (E/W), in \_\_\_\_\_ County, Kansas, \_\_\_\_\_ feet North \_\_\_\_\_ feet West of Southeast corner of section.  
Authorized Rate \_\_\_\_\_ Authorized Quantity \_\_\_\_\_  
(DWR use only: Computer ID No. \_\_\_\_\_ GPS \_\_\_\_\_ feet North \_\_\_\_\_ feet West)  
 This point will not be changed  This point will be changed as follows:

**Proposed point of diversion: (Complete only if change is requested)** (old well location)

One in the NE Quarter of the NE Quarter of the NE Quarter of Section 25, Township 28S South, Range 33W (E/W), in Haskell County, Kansas, 4934 feet North 132 feet West of Southeast corner of section.  
Proposed Rate \_\_\_\_\_ Proposed Quantity \_\_\_\_\_  
This point is:  Additional Well  Geo Center List other water rights that will use this point Standby well

10. **Presently authorized point of diversion:**

One in the \_\_\_\_\_ Quarter of the \_\_\_\_\_ Quarter of the \_\_\_\_\_ Quarter of Section \_\_\_\_\_, Township \_\_\_\_\_ South, Range \_\_\_\_\_ (E/W), in \_\_\_\_\_ County, Kansas, \_\_\_\_\_ feet North \_\_\_\_\_ feet West of Southeast corner of section.  
Authorized Rate \_\_\_\_\_ Authorized Quantity \_\_\_\_\_  
(DWR use only: Computer ID No. \_\_\_\_\_ GPS \_\_\_\_\_ feet North \_\_\_\_\_ feet West)  
 This point will not be changed  This point will be changed as follows:

**Proposed point of diversion: (Complete only if change is requested)**

One in the \_\_\_\_\_ Quarter of the \_\_\_\_\_ Quarter of the \_\_\_\_\_ Quarter of Section \_\_\_\_\_, Township \_\_\_\_\_ South, Range \_\_\_\_\_ (E/W), in \_\_\_\_\_ County, Kansas, \_\_\_\_\_ feet North \_\_\_\_\_ feet West of Southeast corner of section.  
Proposed Rate \_\_\_\_\_ Proposed Quantity \_\_\_\_\_  
This point is:  Additional Well  Geo Center List other water rights that will use this point \_\_\_\_\_

11. Describe the current condition of and future plans for any point(s) of diversion which will no longer be used. \_\_\_\_\_

JUL 19 2024

KS Dept. of Agriculture File No. 10946-IND

12. The presently authorized use of water is for Industrial purposes.  
It is proposed that the use be changed to no changes purposes.
13. If changing the place of use and/or use made of water, describe how the consumptive use will not be increased.  
No chnage in consumptive use.
- 
- 
- 

(Please show any calculations here.)

14. It is requested that the maximum annual quantity of water be reduced to N/A (acre-feet or million gallons).
15. It is requested that the maximum rate of diversion of water be reduced to N/A gallons per minute (     c.f.s.).
16. The application must include either a topographic map or detailed plat. A U.S. Geological Survey Topographic Map, scale 1:24,000, is available through the Kansas Geological Survey, 1930 Constant Avenue, University of Kansas, Lawrence, Kansas 66047-3726 ([www.usgs.gov](http://www.usgs.gov)). The map should show the location of the presently authorized point(s) of diversion. Distances North and West of the Southeast corner of the section must be shown. The presently authorized place of use should also be shown. Identify the center of the section, the section lines and the section corners and show the appropriate section, township, and range numbers on the map. In addition the following information must also be shown on the map.
- a. If a change in the location of the point(s) of diversion is proposed, show:
- 1) The location of the proposed point(s) of diversion. Distances North and West of the Southeast corner of the section must be shown. Please be certain that the information shown on the map agrees with the information shown in Paragraph Nos. 9, 10 and 11 of the application.
  - 2) If the source of supply is groundwater, please show the location of existing water wells of any kind, including domestic wells, within ½ mile of the proposed well or wells. Identify each well as to its use and furnish name and mailing address of the property owner or owners. If there are no wells within ½ mile, please indicate so on the map.
  - 3) If the source of supply is surface water, the names and mailing addresses of all landowner(s) ½ mile downstream and ½ mile upstream from your property lines must be shown.
- b. If a change in the place of use is desired, show the proposed place of use by crosshatching on the map. Please be certain that the information shown on the map agrees with the information shown in Paragraph No. 5 of the application.
17. Attach documentation to show the change(s) proposed herein will not impair existing water rights and relates to the same local source of supply as to which the water right relates. This information may include statements, plats, geology reports, well logs, test hole logs, and other information as necessary information to show the above. Additional comments may be made below.
- The log for the prexisting well is attached. This well will serve as a standby well with no changes to the consumptive use; therefore, no impairment to other water rights will occur.
- 
- 
- 

18. If the proposed change(s) does not meet all applicable rules and regulations of the Kansas Water Appropriation Act, please identify the rules and regulations for which you request a waiver. State the reason why a waiver is needed and why the request should be granted. Attach documentation showing that granting the request will not impair existing water rights and will not prejudicially and unreasonably affect the public interest.
- N/A
- 
- 
-

JUL 19 2024

File No. 10946-IND

KS Dept. of Agriculture

Any use of water that is not as authorized by the water right or permit to authorize water before the chief engineer approves this application is a violation of the Kansas Water Appropriation Act for which criminal or civil penalties may be assessed. Such violation is a class C misdemeanor, punishable by a fine not to exceed \$500 and/or a term of confinement not to exceed one month in the county jail. K.S.A. 82a-728(b). Civil penalties shall be not less than \$100 nor more than \$1,000 per violation. In the case of a continuing violation, each day such violation continues may be deemed a separate violation. In addition to these penalties the water right may be modified or suspended. K.S.A. 82a-737, as amended.

The application must be signed by all owners of the place of use authorized under the water right and his or her spouse, if married. Please indicate if there is no spouse. If land is being purchased under contract, the seller must sign as landowner until such time as the contract is completed.

In the event that all applicants cannot appear before one notary public, they may as necessary sign separate copies of the application before any notary public conveniently available to them. All copies signed in this manner shall be considered to be valid parts of the application.

If the request is signed on behalf of any Owner by someone with legal authority to do so (for example, an agent, one who has power of attorney, or an executor, executrix, conservator), it will be necessary to attach proper documents showing such authority.

I declare that I am an owner of the currently authorized place of use as identified herein, or that I represent all such owners and am authorized to make this application on their behalf, and declare further that the statements contained herein are true, correct, and complete. By filing this application I authorize the chief engineer to permanently reduce the quantity of water and/or rate of diversion as specified in sections 14 and 15 of this application.

Dated at Sublette, Kansas, this 25<sup>th</sup> day of June, 2024.

<u>[Signature]</u> (Owner)	_____	(Spouse)
<u>Victor Ibarra</u> (Please Print)	_____	(Please Print)
_____	_____	(Spouse)
_____	_____	(Please Print)
_____	_____	(Spouse)
_____	_____	(Please Print)

State of Kansas }  
County of Haskell } SS

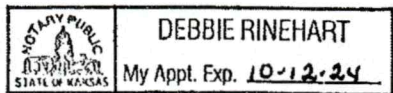

I hereby certify that the foregoing application was signed in my presence and sworn to before me this 25<sup>th</sup> day of June, 2024. Before me appeared Victor Ibarra

Debbie Rinehart  
Notary Public

My Commission Expires 10-12-24

FEE SCHEDULE

Each application to change the place of use, the point of diversion or the use made of the water under this section shall be accompanied by the application fee set forth in the schedule below:

- (1) Application to change a point of diversion 300 feet or less ..... \$100
- (2) Application to change a point of diversion more than 300 feet ..... \$200
- (3) Application to change the place of use ..... \$200
- (4) Application to change the use made of the water ..... \$300

Make check payable to Kansas Department of Agriculture.

JUL 19 2024

KS Dept. of Agriculture

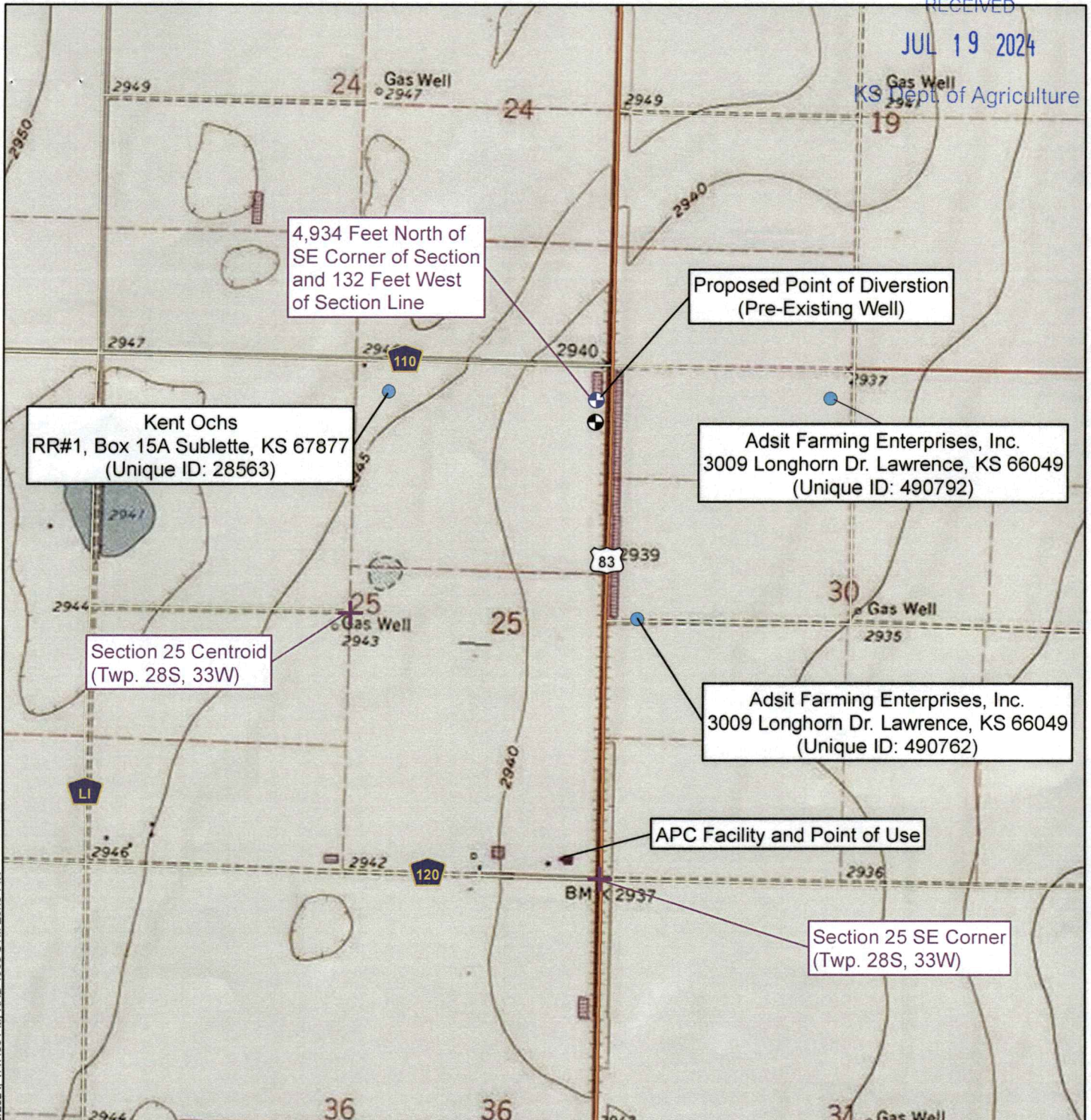

- APC's Proposed Point of Diversion (Pre-Existing Well)
- APC's Present Point of Diversion (New Well)
- Private Well Within Half Mile of APC's Proposed Point of Diversion

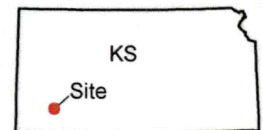
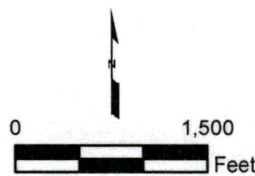

Service Layer Credits: Copyright: © 2013 National Geographic Society, i-cubed  
 Notes: Locations are approximate and not survey grade.  
 Source: Well and setback locations are digitize from a map supplied by KS DWR.



Prepared By:  
**LRE Water**  
 Minneapolis / St. Paul Office  
 Minnesota  
 (612) 805-0919

<b>APC, LLC</b> CHANGE OF DIVERSION APPLICATION SUBLETTE, KS	
APC'S SUBLETTE, KS FACILITY WELL LOCATIONS AND POINTS OF DIVERSION	
FILE:5059APC01_01d.MXD	DATE:6/20/2024   FIGURE: 1

C:\GIS\GIS\APC\5059APC01\maps\5059APC01\_01d.mxd, 6/20/2024, 1:47:56 PM, NAD, 1983 UTM Zone 14N

JUL 19 2024

8/9/99 REV. 0

WATER WELL RECORD Form WWC-5 KSA 82a-1212 KS Dept of Agriculture

1 LOCATION OF WATER WELL: Fraction Section Number Township Number Range Number  
 COUNTY: 041 HASKELL NE 1/4 NE 1/4 NE 1/4 25 T 28 S R 33 W

Distance and direction from nearest town or city street address of well if located within city?  
 FROM SUBLETTE, APPX 1 1/2 MILES WEST AND 6 1/2 MILES NORTH

2 WATER WELL OWNER: CLAUSEN KOCH COPORATION Board of Agriculture, Division of Water Resources  
 RR#, St. Address, Box #: HCR 1 BOX 14A  
 City, State, ZIP code: SUBLETTE, KS. 67877-9756 Application Number: 11,104-D2

3 LOCATE WELL'S LOCATION WITH AN "X" IN SECTION BOX: 4 DEPTH OF COMPLETED WELL 570 ELEVATION: 0  
 Depth(s) Groundwater Encountered 1. 0 ft. 2. 0 ft. 3. 0 ft.  
 WELL'S STATIC WATER LEVEL 340 ft. below land surface measured on mo/day/yr 10/29/98  
 Pump test data: Well water was 0 ft. after 0 hours pumping 0 gpm  
 Estimated Yield 0 gpm: Well water was 0 ft. after 0 hours pumping 0 gpm  
 Bore Hole Diameter 17.5 in. to 570 ft., and in. to 0 ft.  
 WELL WATER TO BE USED AS: 04 INDUSTRIAL  
 Was a chemical/bacteriological sample submitted to department? No;  
 If yes, mo/day/yr sample was submitted Water well disinfected? Yes

TYPE OF BLANK CASING USED: 02 PVC CASING JOINTS: GLUED  
 Blank casing diameter 8 in. to 570 ft., Dia in. to 0 ft., Dia in. to 0 ft.  
 Casing height above land surface 12 in., weight 7 lbs/ft. Wall thickness or gauge No. .41  
 TYPE OF SCREEN OR PERFORATION MATERIAL: 07 PVC  
 SCREEN OR PERFORATION OPENINGS ARE: 08 SAW CUT

SCREEN PERFORATED INTERVALS: From 390 ft. to 430 ft., From 0 ft. to 0 ft.  
 From 450 ft. to 470 ft., From 0 ft. to 0 ft.  
 GRAVEL PACK INTERVALS: From 25 ft. to 570 ft., From 0 ft. to 0 ft.  
 From 0 ft. to 0 ft., From 0 ft. to 0 ft.

6 GROUT MATERIAL 03 BENTONITE  
 Grout Intervals: From 5 ft. to 25 ft., From 0 ft. to 0 ft., From 0 ft. to 0 ft.  
 What is the nearest source of possible contamination: NONE OBSERVED  
 Direction from well? How many feet? 0

FROM	TO	LITHOLOGIC LOG	FROM	TO	PLUGGING INTERVALS
2	67	04 SANDY CLAY 01 CLAY 31 CALICHE			
67	130	05 SAND 11 GRAVEL 01 CLAY			
2	67	04 SANDY CLAY 01 CLAY 31 CALICHE			
130	204	05 SAND 11 GRAVEL			
67	130	05 SAND 11 GRAVEL 01 CLAY			
204	207	01 CLAY			
130	204	05 SAND 11 GRAVEL			
207	218	05 SAND 13 FINE GRAVEL 14 MED GRAVEL			
204	207	01 CLAY			
218	228	01 CLAY			

7 CONTRACTOR'S OR LANDOWNER'S CERTIFICATION: This water well was Constructed under my jurisdiction and was completed on (mo/day/year) 06/11/99 and this record is true to the best of my knowledge and belief. Kansas Water Well Contractor's License No. 145 This Water Well Record was completed on (mo/day/yr) 06/21/99

JUL 19 2024

KS Dept. of Agriculture

(Continued)

WATER WELL RECORD Form WWC-5 KSA 82a-1212

LOCATION OF WATER WELL: COUNTY: 041 HASKELL	Fraction NE 1/4 NE 1/4 NE 1/4	Section Number 25	Township Number T 28 S	Range Number R 33 W
--	----------------------------------	----------------------	---------------------------	------------------------

2 WATER WELL OWNER: CLAUSEN KOCH CORPORATION  
 RR#, St. Address, Box #: HCR 1 BOX 14A Board of Agriculture, Division of Water Resources

City, State, ZIP code : SUBLETTE, KS 67877-9756 Application Number: 11,104-D2

FROM	TO	LITHOLOGIC LOG
207	218	05 SAND 13 FINE GRAVEL 14 MED GRAVEL
228	288	01 CLAY
218	228	01 CLAY
288	322	01 CLAY 05 SAND
228	288	01 CLAY
322	340	05 SAND 13 FINE GRAVEL 01 CLAY
288	322	01 CLAY 05 SAND
340	378	05 SAND 13 FINE GRAVEL 04 SANDY CLAY
322	340	05 SAND 13 FINE GRAVEL 01 CLAY
378	400	05 SAND 13 FINE GRAVEL 04 SANDY CLAY
340	378	05 SAND 13 FINE GRAVEL 04 SANDY CLAY
400	418	05 SAND 13 FINE GRAVEL 14 MED GRAVEL
378	400	05 SAND 13 FINE GRAVEL 04 SANDY CLAY
418	428	05 SAND 13 FINE GRAVEL 04 SANDY CLAY
400	418	05 SAND 13 FINE GRAVEL 14 MED GRAVEL
418	428	05 SAND 13 FINE GRAVEL 04 SANDY CLAY
428	441	04 SANDY CLAY 20 LIMESTONE 28 ROCK
441	472	05 SAND 01 CLAY
428	441	04 SANDY CLAY 20 LIMESTONE 28 ROCK
472	490	04 SANDY CLAY 20 LIMESTONE 05 SAND
441	472	05 SAND 01 CLAY
490	510	01 CLAY 05 SAND 28 ROCK
472	490	04 SANDY CLAY 20 LIMESTONE 05 SAND
510	530	05 SAND 28 ROCK 01 CLAY
490	510	01 CLAY 05 SAND 28 ROCK
530	568	05 SAND 28 ROCK
510	530	05 SAND 28 ROCK 01 CLAY
568	574	31 CALICHE 01 CLAY
530	568	05 SAND 28 ROCK
574	578	19 SHALE
568	574	31 CALICHE 01 CLAY
574	578	19 SHALE

7 CONTRACTOR'S OR LANDOWNER'S CERTIFICATION: This water well was Constructed under my jurisdiction and was completed on (mo/day/year) 06/11/99 and this record is true to the best of my knowledge and belief. Kansas Water Well Contractor's License No. 145 This Water Well Record was completed on (mo/day/yr) 06/21/99 by the business name of HFNKLE DRILLING & SUPPLY by (signature) *Bruce Reichmuth*



JUL 19 2024

TEST 00819

KS Dept. of Agriculture

# Henkle

DRILLING & SUPPLY CO., INC.

3795 W. JONES AVE.  
316/277-2389  
FAX/277-0224

P.O. Box 639  
GARDEN CITY, KANSAS 67846

316-675-8691

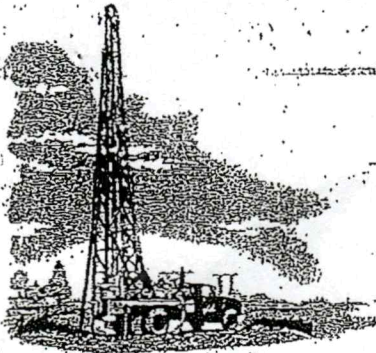

CUSTOMER'S NAME CLAWSON KOCH CORPORATION DATE 10/29/98  
 STREET ADDRESS HCR 1 BOX 14A TEST # 1 E. LOG NO  
 CITY & STATE SUBLETTE KS 67877 DRILLER T MAI  
 COUNTY HASKELL QUARTER NE SECTION 25 TOWNSHIP 28 RANGE 33  
 LOCATION 365' S & 165' W OF NE CORNER

POWER LINES 90' E OF TEST

%	FOOTAGE			DESCRIPTION OF STRATA	STATIC WATER LEVEL:
	From	Pay	To		Proposed Well Depth:
	0		2	TOP SOIL	340'
	2		67	BROWN SANDY & BROWN CLAY & CALICHE FRS SMALL SANDSTKS	570'
	67		130	SAND-FINE TO MED COURSE SMALL TO MED GRAVEL, FIRM LIME FRM SMALL CLAY STKS	
	130		204	SAND-FINE TO MED COURSE SMALL TO LARGE GRAVEL, ROUGH, USES WATER	
	204		207	BROWN CLAY	
	207		218	SAND-FINE TO MED COURSE SMALL TO MED GRAVEL	
	218		228	BROWN CLAY - STICKY	
	228		288	GREY CLAY - STICKY	
	288		322	BLUE CLAY - STICKY FRS LEDGES, DLVE SAND, STK	
	322		340	SAND-FINE TO MED COURSE SMALL GRAVEL, CLAY STKS, LIM ROCK LINDS	
30	340	38	378	SAND-FINE TO MED COURSE SMALL GRAVEL & SANDY CLAY	
40	378	22	400	SAND-FINE TO MED COURSE SMALL GRAVEL, FRS SANDY CLAY STKS	
85	400	18	418	SAND-FINE TO MED COURSE SMALL & FRS MED GRAVEL	
45	418	10	428	SAND-FINE TO MED COURSE SMALL GRAVEL, FRS SANDY CLAY	
	428		441	SANDY CLAY, LIM ROCK ROCK LEDGES & FRS SAND STKS	
40	441	31	472	SAND-FINE TO MED FRS COURSE FRS CLAY STKS	
	472		490	SANDY CLAY, LIM ROCK & FRS SAND STKS	
	490		510	BROWN CLAY, HARD CLAY STRINGS, FRS FINE SAND STRINGS & BROWN TAN ROCK STICKY IN PLACES	
40	510	20	530	SAND-FINE & SMALL FRS MED & COURSE BROWN TAN ROCK FRS SMALL CLAY STKS, FIRM IN PLACES	
65	530	38	568	SAND-FINE TO MED COURSE SMALL & FRS MED BROWN TAN ROCK CRUMBLING IN PLACES ROUGH	
	568		574	YELLOW SANDSTONE & RED CLAY VERY STICKY	
	574		578	SHALE - STICKY	
				5 QUICKCEL	
				2 AQUA GUARD	
				5 HOLE PLUG	
				3 LOADS WATER @ \$4.00	
				TEST RIG EAST PIT SOUTH 3	
				55	
				6.6	
				330	
				33	

JUL 19 2024

June 8, 1999  
BJR

KS Dept. of Agriculture

CLAUSEN KOCH CORP  
SUBLETTE, KS 67877  
NE 25-28-33 HASKELL Co

W.O. 6447  
Test Hole #1  
WD = 570'  
1 7/2" Hole

Depth	8" PVC Perf (SOR-21) Class 200 (.032" slot)	8" PVC Casing Class 200 (SOR-2)
570' - 510'	60'	
510' - 470'		40'
470' - 450'	20'	
450' - 430'		20'
430' - 390'	40'	
390' - 0'		390'
	<u>Perf 120'</u>	<u>Casing 450'</u> <u>Perf 120'</u>
		TOTAL 570'

8" Cap on bottom

567 - 1" Water Level Measuring Tube - 1" Blk Merchant Pipe

Centering guides every 40' in perf area

25' - 570' - Approx 47 ton - Fine - Double Washed - Huber Sand

5' - 25' - Bentonite Surface Seal - 35 bags - Hole Plug

1320 Research Park Drive  
Manhattan, KS 66502  
785-564-6700  
www. agriculture.ks.gov



900 SW Jackson, Room 456  
Topeka, KS 66612  
785-296-3556

Mike Beam, Secretary

Laura Kelly, Governor

August 9, 2024

APC LLC  
1197 HIGHWAY 83  
SUBLETTE KS 67877

RE: File No(s). **10946**

Dear Sir or Madam:

The Division of Water Resources (Division) has received your application(s) to change the place of use, point of diversion or use made of water for the file number(s) referenced above. Please be aware that the Division may have a large number of pending applications on hand at times and makes every attempt to process them in the order in which they are received. You will be contacted if additional information is required.

Please note, this letter only acknowledges receipt of your application(s) and does not guarantee approval. In accordance with the provisions of the Kansas Water Appropriation(s) Act, the use of water as proposed prior to approval of the application(s) is unlawful.

Additional information about the process may be found on our website at [agriculture.ks.gov/divisions-programs/dwr](http://agriculture.ks.gov/divisions-programs/dwr). If you have any other questions, please contact our office at 785-564-6640 or your local Garden City Field Office at 620-276-2901. If you call, please reference the file number so we can help you more efficiently.

Sincerely,

A handwritten signature in black ink that reads "Kristen A. Baum". The signature is written in a cursive style.

Kristen Baum  
New Applications and Changes Supervisor  
Water Appropriation Program