

Kansas Department of Agriculture  
 Division of Water Resources  
**CHANGE: P/U WORKSHEET**

1. File Number: <b>10986</b>	2. Status Change Date: <b>9-3-2024</b>	3. Change Num: <b>C3</b>	4. Field Office: <b>4</b>	5. GMD: <b>3</b>
---------------------------------	---	-----------------------------	------------------------------	---------------------

6. Status: <input checked="" type="checkbox"/> Approved <input type="checkbox"/> Denied by DWR/GMD <input type="checkbox"/> Dismiss by Request/Failure to Return	7. Filing Date of Change: <b>2/29/2024</b>
--	---

8a. Landowner                      Person ID 36178  
 New to system               Add Seq# \_\_\_\_\_

**KMC AG LLC**  
**PO BOX 279**  
**PLAINS, KS 67869-0279**

8d. Landowner                      Person ID 69269  
 New to system               Add Seq# \_\_\_\_\_

**KP LAND COMPANY LLC**  
**263 RD 140**  
**SATANTA, KS 67870**

8b. Landowner(s)                      Person ID 57020  
 New to system               Add Seq# \_\_\_\_\_

**CLAWSON LAND PARTNERSHIP**  
**PO BOX 279**  
**PLAINS, KS 67869**

8e. Landowner                      Person ID 69328  
 New to system               Add Seq# \_\_\_\_\_

**WILLIAM R WOOD II TRUST**  
**1551 N WATERFRONT PARKWAY SUITE**  
**100**  
**WICHITA, KS 67206**

8c. Landowner                      Person ID 68431  
 New to system               Add Seq# \_\_\_\_\_

**LANA M CLAWSON TRUST #1**  
**146 ROAD 140**  
**SATANTA, KS 67870-8400**

8f. Correspondent                      Person ID 37451  
 New to system               Add Seq# \_\_\_\_\_

**CLAWSON HASKELL CO #1**  
**PO BOX 279**  
**PLAINS, KS 67869-0279**

9. Documents and Enclosure(s):  DWR Meter(s) Date to Comply: 12/31/2024     N & P Date to Comply: \_\_\_\_\_

Anti-Reverse Meter     Meter Seal     Check Valve     N & P Form     Water Tube     Driller Copy     H & E Letter

Conservation Plan    Date Required: \_\_\_\_\_    Date Approved: \_\_\_\_\_    Date to Comply: \_\_\_\_\_

10. Use Made of Water    From: \_\_\_\_\_    To: \_\_\_\_\_

Date Prepared: **8/30/2024**    By: **MAM**  
 Date Entered: \_\_\_\_\_    By: \_\_\_\_\_

File No. **10986**      11. County: HS      Basin: CIMARRON RIVER      Stream:      Formation Code:      Special Use:

12. Points of Diversion  
 Rate and Quantity  
 Authorized      Additional  
 Rate      Quantity      Rate      Quantity  
 gpm      af      gpm      af      Overlap PD Files

CHK	MOD	DEL	ENT	PDIV	Qualifier	S	T	R	ID	'N	'W	Comment (AKA Line)	Rate gpm	Quantity af	Rate gpm	Quantity af	Overlap PD Files
<b>CHK 19912</b>																	

13. Storage: Rate \_\_\_\_\_ NF      Quantity \_\_\_\_\_ ac/ft      Additional Rate \_\_\_\_\_ NF      Additional Quantity \_\_\_\_\_ ac/ft

14. Limitation: \_\_\_\_\_ af/yr at \_\_\_\_\_ gpm ( \_\_\_\_\_ cfs) when combined with file number(s) \_\_\_\_\_  
 Limitation: \_\_\_\_\_ af/yr at \_\_\_\_\_ gpm ( \_\_\_\_\_ cfs) when combined with file number(s) \_\_\_\_\_

15. 5YR Allocation:      Allocation Type \_\_\_\_\_      Start Year \_\_\_\_\_      5 YR Amount \_\_\_\_\_      Amount Unit \_\_\_\_\_      Base Acres \_\_\_\_\_      Comment \_\_\_\_\_

CHK	MOD	DEL	ENT	PUSE	S	T	R	ID	NE¼				NW¼				SW¼				SE¼				Total	Owner	Chg?	Overlap Files
									NE ¼	NW ¼	SW ¼	SE ¼	NE ¼	NW ¼	SW ¼	SE ¼	NE ¼	NW ¼	SW ¼	SE ¼	NE ¼	NW ¼	SW ¼	SE ¼				
<b>CHK 33764</b>					<b>4</b>	<b>29</b>	<b>34W</b>	<b>1</b>									<b>40</b>	<b>40</b>	<b>40</b>	<b>40</b>					<b>160</b>			<b>8a N 4886, 6255, 8582, 9235, 10030, 10581, 13191, 13795, 15368, 15369, 21946, 22820, 26849,</b>
<b>MOD 2700</b>					<b>5</b>	<b>29</b>	<b>34W</b>	<b>1</b>	L-1 40.01	L-2 40.02	40	40	L-3 35	L-4 30	30	40	40	40	40	35	40	40	40	40	620.03			<b>8a N 4886, 6255, 8582, 9235, 10030, 10581, 13191, 13795, 15368, 15369, 21946, 22820, 26849,</b>
<b>DEL 33764</b>																												
<b>MOD 34199</b>					<b>6</b>	<b>29</b>	<b>34W</b>	<b>1</b>	L-1 40.05	L-2 36	40	38	L-3 40.02	L-4 38.22	L-5 38.10	38.10	40	40	L-6 37.99	L-7 37.88	40	40	34	18.6	589.86			<b>8a N 4886, 6255, 8582, 9235, 10030, 10581, 13191, 13795, 15368, 15369, 21946, 22820, 26849,</b>
<b>CHK 4207</b>					<b>7</b>	<b>29</b>	<b>34W</b>	<b>1</b>	40	37	40	40									40	40	40	40	317			<b>8a N 4886, 6255, 8582, 9235, 10030, 10581, 13191, 13795, 15368, 15369, 21946, 22820, 26849,</b>

Base Acres:      Year:      Minimum Reasonable Quantity:  
 Comments:





Garden City Field Office  
4532 W. Jones, Suite B  
Garden City, KS 67846



Phone: 620-276-2901  
Fax: 620-276-9315  
www.agriculture.ks.gov

Mike Beam, Secretary

Laura Kelly, Governor

September 3, 2024

KENBY CLAWSON  
146 ROAD 140  
SATANTA KS 67870-8400

RE: Field Office Application for Change  
Water Right, File Nos. 4886, 6255, 8582, 9235, 10030, 10581, 10986, 13191,  
13795, 15368, 15369, 21946, 22820, 26849

Dear Sir:

Enclosed are orders executed by the designee of the Chief Engineer, Division of Water Resources, Kansas Department of Agriculture, approving the applications for change under the above referenced file numbers.

Your attention is directed to the enclosures and to the terms, conditions, and limitations specified in these approvals for change. A condition of this approval is that an acceptable water flow meter must be installed on the diversion works authorized under the referenced file number and meet current specifications. Please return the required notification of completion of the diversion works and installation of the required meter as soon as these actions are completed.

Since the orders modify the original documents referred to above, they should be recorded with the Register of Deeds as other instruments affecting real estate.

Should you have any questions, please feel free contact this office. If you would prefer, you could arrange an appointment for additional assistance.

Sincerely,

A handwritten signature in blue ink that reads "Michael A. Meyer".

Michael A. Meyer  
Water Commissioner

MAM:  
Enclosures

pc: KMC AG LLC  
LANA M CLAWSON TRUST #1  
CLAWSON LAND PARTNERSHIP  
CLAWSON HASKELL CO #1  
KP LAND COMPANY LLC  
WILLIAM R WOOD II TRUST  
GMD3

## CERTIFICATE OF SERVICE

On this 4<sup>th</sup> day of September 2024, I hereby certify that the foregoing Approvals of Application for Change in Place of use, Water Right, File Nos. 4886, 6255, 8582, 9235, 10030, 10581, 10986, 13191, 13795, 15368, 15369, 21946, 22820,26849 dated 3<sup>rd</sup> day of September 2024 was mailed postage prepaid, first class, US mail to the following:

KENBY CLAWSON  
146 ROAD 140  
SATANTA KS 67870-8400

**Pc:**

KMC AG LLC  
PO BOX 279  
PLAINS, KS 67869-0279

LANA M CLAWSON TRUST #1  
146 ROAD 140  
SATANTA, KS 67870-8400

CLAWSON LAND PARTNERSHIP  
PO BOX 279  
PLAINS, KS 67869

CLAWSON HASKELL CO #1  
PO BOX 279  
PLAINS, KS 67869-0279

KP LAND COMPANY LLC  
263 RD 140  
SATANTA, KS 67870

WILLIAM R WOOD II TRUST  
1551 N WATERFRONT PARKWAY SUITE 100  
WICHITA, KS 67206

GMD3



Aaron Holsted

Division of Water Resources Staff

Submit completed application to:  
 Kansas Department of Agriculture  
 Division of Water Resources  
 Field Office for your area.  
 Call for address:

Topeka -- (785) 296-5733  
 Stafford -- (620) 234-5311  
 Stockton -- (785) 425-6787  
 Garden City -- (620) 276-2901  
<http://agriculture.ks.gov/dwr>

## DWR FIELD OFFICE APPLICATION FOR APPROVAL TO CHANGE THE PLACE OF USE AND/OR THE POINT OF DIVERSION



STATE OF KANSAS

**Filing Fee Must Accompany the Application, K.S.A. 82a-708b(b), as amended.**  
 Fee Schedule is on the third page of this application form.

**Paragraph Nos. 1, 2, 3 & 5 must be completed. Complete all other applicable portions.** If change in point of diversion is greater than 100 feet, or if place of use will be changed, include a topographic map or detailed plat showing the authorized and proposed point(s) of diversion and/or place of use.

File No. 10986

**RECEIVED**  
 10:19 am  
 FEB 08 2024

Garden City Field Office  
 Division of Water Resources

1. Application is hereby made for approval of the Chief Engineer to change the (check one or both):

Place of Use                       Point of Diversion

under the water right which is the subject of this application in accordance with the conditions described below.

The source of supply is:                       Groundwater                       Surface water

2. Name and address of Applicant: Kenby Clawson

146 Road 140, Satanta, KS 67870

Phone Number: (    )                      Email address: \_\_\_\_\_

Name and address of Water Use Correspondent: Clawson Haskell Co #1

PO Box 279, Plains, KS 67869

Phone Number: (    )                      Email address: \_\_\_\_\_

3. The presently authorized place of use is:

Owner of Land ---- NAME: \_\_\_\_\_

ADDRESS: \_\_\_\_\_

(If there is more than one landowner, attach supplemental sheets as necessary.)

Sec.	Twp.	Range	NE¼				NW¼				SW¼				SE¼				TOTAL ACRES
			NE¼	NW¼	SW¼	SE¼	NE¼	NW¼	SW¼	SE¼	NE¼	NW¼	SW¼	SE¼	NE¼	NW¼	SW¼	SE¼	

4. If this application is for a change in place of use, it is proposed that the place of use be changed to:

Owner of Land ---- NAME: \_\_\_\_\_

ADDRESS: \_\_\_\_\_

(If there is more than one landowner, attach supplemental sheets as necessary.)

Sec.	Twp.	Range	NE¼				NW¼				SW¼				SE¼				TOTAL ACRES
			NE¼	NW¼	SW¼	SE¼	NE¼	NW¼	SW¼	SE¼	NE¼	NW¼	SW¼	SE¼	NE¼	NW¼	SW¼	SE¼	

**For Office Use Only:** Code \_\_\_\_\_ Fee \$ 200.00 TR # \_\_\_\_\_ Receipt Date 2-8-24 Check # 1314



APPLICATION FOR APPROVAL TO CHANGE  
 THE PLACE OF USE AND/OR POINT OF DIVERSION  
 SUPPLEMENTAL SHEET  
**FILE NO. 10986**

MAKE ADDITIONAL COPIES AS NECESSARY

3. *Continued:* The presently authorized place of use is:

Owner of Land ---- NAME: KMC Ag LLC  
 ADDRESS: PO Box 279, Plains, KS 67869

Sec.	Twp.	Range	NE¼				NW¼				SW¼				SE¼				TOTAL ACRES
			NE¼	NW¼	SW¼	SE¼	NE¼	NW¼	SW¼	SE¼	NE¼	NW¼	SW¼	SE¼	NE¼	NW¼	SW¼	SE¼	
4	29	34W									40	40	40	40					160
5	29	34W	L-1 40.01	L-2 40.02	40	40	L-3 35	L-4 30	40	40	40	40	35	40	40	40	40	620.03	
6	29	34W	L-1 40.05	L-2 36	40	38	L-3 40.02	L-4 38.22	L-5 38.10	40	40	L-6 37.99	L-7 37.88	40	40	40	34	38	618.26

Owner of Land ---- NAME: KMC Ag LLC  
 ADDRESS: PO Box 279, Plains, KS 67869

Sec.	Twp.	Range	NE¼				NW¼				SW¼				SE¼				TOTAL ACRES
			NE¼	NW¼	SW¼	SE¼	NE¼	NW¼	SW¼	SE¼	NE¼	NW¼	SW¼	SE¼	NE¼	NW¼	SW¼	SE¼	
7	29	34W	40	37	40	40									40	40	40	40	317
9	29	34W	40	40	40	40					40	40	40	40	40	40	40	40	480

Owner of Land ---- NAME: KMC Ag LLC  
 ADDRESS: PO Box 279, Plains, KS 67869

Sec.	Twp.	Range	NE¼				NW¼				SW¼				SE¼				TOTAL ACRES
			NE¼	NW¼	SW¼	SE¼	NE¼	NW¼	SW¼	SE¼	NE¼	NW¼	SW¼	SE¼	NE¼	NW¼	SW¼	SE¼	
12	29	35W	40	40	40	40	40	40	40	40	40	40	35	40	40	40	40	635	
14	29	35W	30.75	30.75	30.75	30.75									30.75	30.75	30.75	30.75	246

4. *Continued:* If this application is for a change in place of use, it is proposed that the place of use be changed to:

Owner of Land ---- NAME: KMC Ag LLC  
 ADDRESS: PO Box 279, Plains, KS 67869

Sec.	Twp.	Range	NE¼				NW¼				SW¼				SE¼				TOTAL ACRES
			NE¼	NW¼	SW¼	SE¼	NE¼	NW¼	SW¼	SE¼	NE¼	NW¼	SW¼	SE¼	NE¼	NW¼	SW¼	SE¼	
4	29	34W									40	40	40	40					160
5	29	34W	L-1 40.01	L-2 40.02	40	40	L-3 35	L-4 30	40	40	40	40	35	40	40	40	40	620.03	
6	29	34W	L-1 40.05	L-2 36	40	38	L-3 40.02	L-4 38.22	L-5 38.10	40	40	L-6 37.99	L-7 37.88	40	40	40	34	18.6	589.86

Owner of Land ---- NAME: KMC Ag LLC  
 ADDRESS: PO Box 279, Plains, KS 67869

Sec.	Twp.	Range	NE¼				NW¼				SW¼				SE¼				TOTAL ACRES
			NE¼	NW¼	SW¼	SE¼	NE¼	NW¼	SW¼	SE¼	NE¼	NW¼	SW¼	SE¼	NE¼	NW¼	SW¼	SE¼	
7	9	34W	40	37	40	40									40	40	40	40	317
9	29	34W	40	40	40	40					40	40	40	40	40	40	40	40	480

Owner of Land ---- NAME: KMC Ag LLC  
 ADDRESS: PO Box 279, Plains, KS 67869

Sec.	Twp.	Range	NE¼				NW¼				SW¼				SE¼				TOTAL ACRES
			NE¼	NW¼	SW¼	SE¼	NE¼	NW¼	SW¼	SE¼	NE¼	NW¼	SW¼	SE¼	NE¼	NW¼	SW¼	SE¼	
12	29	35W	40	40	40	40	40	40	40	40	40	40	35	40	40	40	40	635	
14	29	35W	30.75	30.75	30.75	30.75									30.75	30.75	30.75	30.75	246

5. **Presently authorized point of diversion:**  
 One in the \_\_\_\_\_ Quarter of the \_\_\_\_\_ Quarter of the \_\_\_\_\_ Quarter  
 of Section \_\_\_\_\_, Township \_\_\_\_\_ South, Range \_\_\_\_\_ (W),  
 in \_\_\_\_\_ County, Kansas, \_\_\_\_\_ feet North \_\_\_\_\_ feet West of Southeast corner of section.  
 Authorized Rate \_\_\_\_\_ Authorized Quantity \_\_\_\_\_ Depth of well \_\_\_\_\_ (feet)  
**(DWR use only: Computer ID No. \_\_\_\_\_ GPS \_\_\_\_\_ feet North \_\_\_\_\_ feet West)**  
 This point will not be changed  This point will be changed as follows:  No change, point better described with GPS as follows:  
**Proposed point of diversion: (Complete only if change is requested or if existing point is better described by GPS)**  
 One in the \_\_\_\_\_ Quarter of the \_\_\_\_\_ Quarter of the \_\_\_\_\_ Quarter  
 of Section \_\_\_\_\_, Township \_\_\_\_\_ South, Range \_\_\_\_\_ (W),  
 in \_\_\_\_\_ County, Kansas, \_\_\_\_\_ feet North \_\_\_\_\_ feet West of Southeast corner of section.  
 Proposed Rate \_\_\_\_\_ Proposed Quantity \_\_\_\_\_ Proposed well depth (feet) \_\_\_\_\_  
 This point is:  Additional Well  Geo Center List other water rights that will use this point \_\_\_\_\_

6. **Presently authorized point of diversion:**  
 One in the \_\_\_\_\_ Quarter of the \_\_\_\_\_ Quarter of the \_\_\_\_\_ Quarter  
 of Section \_\_\_\_\_, Township \_\_\_\_\_ South, Range \_\_\_\_\_ (W),  
 in \_\_\_\_\_ County, Kansas, \_\_\_\_\_ feet North \_\_\_\_\_ feet West of Southeast corner of section.  
 Authorized Rate \_\_\_\_\_ Authorized Quantity \_\_\_\_\_ Depth of well \_\_\_\_\_ (feet)  
**(DWR use only: Computer ID No. \_\_\_\_\_ GPS \_\_\_\_\_ feet North \_\_\_\_\_ feet West)**  
 This point will not be changed  This point will be changed as follows:  No change, point better described with GPS as follows:  
**Proposed point of diversion: (Complete only if change is requested or if existing point is better described by GPS)**  
 One in the \_\_\_\_\_ Quarter of the \_\_\_\_\_ Quarter of the \_\_\_\_\_ Quarter  
 of Section \_\_\_\_\_, Township \_\_\_\_\_ South, Range \_\_\_\_\_ (W),  
 in \_\_\_\_\_ County, Kansas, \_\_\_\_\_ feet North \_\_\_\_\_ feet West of Southeast corner of section.  
 Proposed Rate \_\_\_\_\_ Proposed Quantity \_\_\_\_\_ Proposed well depth (feet) \_\_\_\_\_  
 This point is:  Additional Well  Geo Center List other water rights that will use this point \_\_\_\_\_

7. The changes herein are desired for the following reasons?  
 (please be specific) \_\_\_\_\_  
 \_\_\_\_\_  
 \_\_\_\_\_

8. If a well, is the test hole log attached?  Yes  No

9. The change(s) (was)(will be) completed by?  
 \_\_\_\_\_  
 \_\_\_\_\_

10. If the point of diversion is a well:  
 (a) What are you going to do with the old well?  
 \_\_\_\_\_  
 (b) When will this be done? \_\_\_\_\_

11. Groundwater Management District recommendation attached?  
 Yes  No

12. Assisted by CI, GCFO \_\_\_\_\_

13a. If the proposed point of diversion will be relocated more than 300 feet but within 2,640 feet of the existing point of diversion, attach a topographic map or aerial photograph. For groundwater sources, show all wells (including domestic) within one-half mile of the proposed point of diversion and the names and mailing addresses of the owners. For surface water sources, show the names and addresses of the landowner(s) one-half mile downstream and one-half mile upstream from your property lines

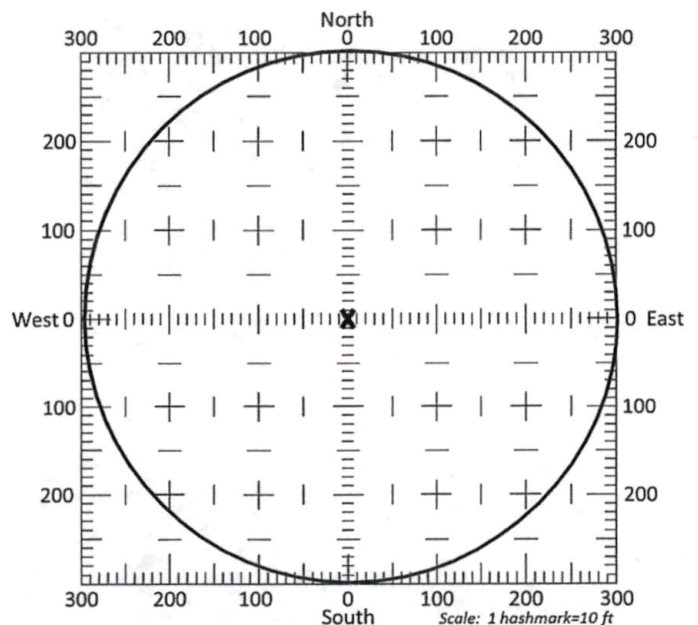

13b. If the proposed point of diversion will be relocated within a 300 foot radius of the existing point of diversion, indicate its location on the diagram shown above in relation to the existing point of diversion. The proposed point of diversion must be located within the circle shown above. (PLEASE NOTE: The "X" in center of diagram above represents the presently authorized point of diversion.)



APPLICATION FOR APPROVAL TO CHANGE  
 THE PLACE OF USE AND/OR POINT OF DIVERSION  
 SUPPLEMENTAL SHEET  
**FILE NO. 10986**

MAKE ADDITIONAL COPIES AS NECESSARY

3. *Continued:* The presently authorized place of use is:

Owner of Land ---- NAME: KP Land Company LLC  
 ADDRESS: 263 Road 140, Satanta, KS 67860

Sec.	Twp.	Range	NE¼				NW¼				SW¼				SE¼				TOTAL ACRES
			NE¼	NW¼	SW¼	SE¼	NE¼	NW¼	SW¼	SE¼	NE¼	NW¼	SW¼	SE¼	NE¼	NW¼	SW¼	SE¼	
8	29	34W	40	30	40	40	35	40	40	40	38	40	40	40					463
7	29	34W					40	37.83	37.86	40									155.69

Owner of Land ---- NAME: William R Wood II Trust (12/04/1997 AND 01/20/2005)

Steven J. Wood Trust (12/04/1997 AND 01/20/2005)

ADDRESS: 1551 N Waterfront Parkway, Suite 100, Wichita, KS 67206

Sec.	Twp.	Range	NE¼				NW¼				SW¼				SE¼				TOTAL ACRES
			NE¼	NW¼	SW¼	SE¼	NE¼	NW¼	SW¼	SE¼	NE¼	NW¼	SW¼	SE¼	NE¼	NW¼	SW¼	SE¼	
9	29	34W					40	40	35	40									155

Owner of Land ---- NAME: Clawson Land Partnership

ADDRESS: PO Box 279, Plains, KS 67869

Sec.	Twp.	Range	NE¼				NW¼				SW¼				SE¼				TOTAL ACRES
			NE¼	NW¼	SW¼	SE¼	NE¼	NW¼	SW¼	SE¼	NE¼	NW¼	SW¼	SE¼	NE¼	NW¼	SW¼	SE¼	
3	29	34W									31	40	31	31					133

5. *Continued:* If this application is for a change in place of use, it is proposed that the place of use be changed to:

Owner of Land ---- NAME: KP Land Company LLC  
 ADDRESS: 263 Road 140, Satanta, KS 67860

Sec.	Twp.	Range	NE¼				NW¼				SW¼				SE¼				TOTAL ACRES
			NE¼	NW¼	SW¼	SE¼	NE¼	NW¼	SW¼	SE¼	NE¼	NW¼	SW¼	SE¼	NE¼	NW¼	SW¼	SE¼	
8	29	34W		15	40	15	35	40	40	40	38	40	40	40	<del>26</del>	<del>40</del>	<del>20</del>		463 <b>383</b>
7	29	34W					40	37.83	37.86	40									155.69

Owner of Land ---- NAME: William R Wood II Trust (12/04/1997 AND 01/20/2005)

Steven J. Wood Trust (12/04/1997 AND 01/20/2005)

ADDRESS: 1551 N Waterfront Parkway, Suite 100, Wichita, KS 67206

Sec.	Twp.	Range	NE¼				NW¼				SW¼				SE¼				TOTAL ACRES
			NE¼	NW¼	SW¼	SE¼	NE¼	NW¼	SW¼	SE¼	NE¼	NW¼	SW¼	SE¼	NE¼	NW¼	SW¼	SE¼	
9	29	34W					40	40	35	40									155

Owner of Land ---- NAME: Clawson Land Partnership

ADDRESS: PO Box 279, Plains, KS 67869

Sec.	Twp.	Range	NE¼				NW¼				SW¼				SE¼				TOTAL ACRES
			NE¼	NW¼	SW¼	SE¼	NE¼	NW¼	SW¼	SE¼	NE¼	NW¼	SW¼	SE¼	NE¼	NW¼	SW¼	SE¼	
3	29	34W									31	40	31	31					133

APPLICATION FOR APPROVAL TO CHANGE  
THE PLACE OF USE AND/OR POINT OF DIVERSION  
SUPPLEMENTAL SHEET  
FILE NO. 10986  
MAKE ADDITIONAL COPIES AS NECESSARY

3. *Continued:* The presently authorized place of use is:

Owner of Land ---- NAME: \_\_\_\_\_  
ADDRESS: \_\_\_\_\_

Sec.	Twp.	Range	NE¼				NW¼				SW¼				SE¼				TOTAL ACRES
			NE¼	NW¼	SW¼	SE¼	NE¼	NW¼	SW¼	SE¼	NE¼	NW¼	SW¼	SE¼	NE¼	NW¼	SW¼	SE¼	

Owner of Land ---- NAME: \_\_\_\_\_  
ADDRESS: \_\_\_\_\_

Sec.	Twp.	Range	NE¼				NW¼				SW¼				SE¼				TOTAL ACRES
			NE¼	NW¼	SW¼	SE¼	NE¼	NW¼	SW¼	SE¼	NE¼	NW¼	SW¼	SE¼	NE¼	NW¼	SW¼	SE¼	

Owner of Land ---- NAME: \_\_\_\_\_  
ADDRESS: \_\_\_\_\_

Sec.	Twp.	Range	NE¼				NW¼				SW¼				SE¼				TOTAL ACRES
			NE¼	NW¼	SW¼	SE¼	NE¼	NW¼	SW¼	SE¼	NE¼	NW¼	SW¼	SE¼	NE¼	NW¼	SW¼	SE¼	

4. *Continued:* If this application is for a change in place of use, it is proposed that the place of use be changed to:

Owner of Land ---- NAME: LANA M CLAWSON TRUST #1  
ADDRESS: 146 ROAD 140, SATANTA, KS 67870-8400

Sec.	Twp.	Range	NE¼				NW¼				SW¼				SE¼				TOTAL ACRES
			NE¼	NW¼	SW¼	SE¼	NE¼	NW¼	SW¼	SE¼	NE¼	NW¼	SW¼	SE¼	NE¼	NW¼	SW¼	SE¼	
8	29	34W													20	40	20		80
6	29	34W																19.4	19.4

Owner of Land ---- NAME: \_\_\_\_\_  
ADDRESS: \_\_\_\_\_

Sec.	Twp.	Range	NE¼				NW¼				SW¼				SE¼				TOTAL ACRES
			NE¼	NW¼	SW¼	SE¼	NE¼	NW¼	SW¼	SE¼	NE¼	NW¼	SW¼	SE¼	NE¼	NW¼	SW¼	SE¼	

Owner of Land ---- NAME: \_\_\_\_\_  
ADDRESS: \_\_\_\_\_

Sec.	Twp.	Range	NE¼				NW¼				SW¼				SE¼				TOTAL ACRES
			NE¼	NW¼	SW¼	SE¼	NE¼	NW¼	SW¼	SE¼	NE¼	NW¼	SW¼	SE¼	NE¼	NW¼	SW¼	SE¼	



14. If the proposed groundwater point of diversion is 300 or fewer feet from the existing point of diversion, complete the following:

- (a) Does the undersigned represent all owners of the currently authorized place(s) of use identified in this application?  
 Yes     No    (If no, all owners must sign this application.)
- (b) Will the ownership interest of any owner of the currently authorized place(s) of use identified in this application be adversely affected if this application is approved as requested?  
 Yes     No    (If yes, all owners must sign this application.)
- (c) If this application is not approved expeditiously, will there be substantial damage to property, public health or safety?  
 Yes     No    (If no, all owners must sign this application.)

If the application proposes a surface water change in point of diversion, a groundwater change in point of diversion greater than 300 feet, or a change in place of use, the application must be signed by all owners of the currently authorized place of use, or their duly authorized agent (attach notarized statement authorizing representation).

I hereby verify, being first duly sworn upon my oath or affirmation and under penalty of perjury, that I am of lawful age and the owner, the spouse of the owner, or a duly authorized agent of the owner(s) to make this application on their behalf, in regards to the water right(s) to which this application pertains. I further verify that the statements contained in this application are true, correct and complete.

Dated at Garden City, Kansas, this 13th day of December, 2023.

David Clauson for Clauson Land Partnership  
\_\_\_\_\_  
(Owner) (Spouse)

David Clauson  
\_\_\_\_\_  
(Please Print) (Please Print)

David Clauson for KMC Ag LLC  
\_\_\_\_\_  
(Owner) (Spouse)

David Clauson  
\_\_\_\_\_  
(Please Print) (Please Print)

\_\_\_\_\_  
(Owner) (Spouse)

\_\_\_\_\_  
(Please Print) (Please Print)

State of Kansas }  
County of Finney } SS

I hereby certify that the foregoing application was signed in my presence and sworn to before me this 13th day of December, 2023.

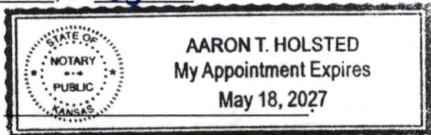

Aaron Holsted  
\_\_\_\_\_  
Notary Public

My Commission Expires

ONLY COMPLETE APPLICATIONS WILL BE PROCESSED. To be complete, all of the applicable portions of the application form must be completed with accurate information; maps, if necessary, must be included; signatures of all the appropriate owners' must be affixed to the application and notarized; and the appropriate fee must be paid.

**FEE SCHEDULE**

Each application to change the place of use or the point of diversion under this section shall be accompanied by the application fee set forth in the schedule below: Make checks payable to: **Kansas Department of Agriculture**

- (1) Application to change a point of diversion 300 feet or less ..... \$100
- (2) Application to change a point of diversion more than 300 feet ..... \$200
- (3) Application to change the place of use ..... \$200





AUG 06 2024

Garden City Field Office  
Division of Water Resources

14. If the proposed groundwater point of diversion is 300 or fewer feet from the existing point of diversion, complete the following:

- (a) Does the undersigned represent all owners of the currently authorized place(s) of use identified in this application?  
 Yes     No    (If no, all owners must sign this application.)
- (b) Will the ownership interest of any owner of the currently authorized place(s) of use identified in this application be adversely affected if this application is approved as requested?  
 Yes     No    (If yes, all owners must sign this application.)
- (c) If this application is not approved expeditiously, will there be substantial damage to property, public health or safety?  
 Yes     No    (If no, all owners must sign this application.)

If the application proposes a surface water change in point of diversion, a groundwater change in point of diversion greater than 300 feet, or a change in place of use, the application must be signed by all owners of the currently authorized place of use, or their duly authorized agent (attach notarized statement authorizing representation).

I hereby verify, being first duly sworn upon my oath or affirmation and under penalty of perjury, that I am of lawful age and the owner, the spouse of the owner, or a duly authorized agent of the owner(s) to make this application on their behalf, in regards to the water right(s) to which this application pertains. I further verify that the statements contained in this application are true, correct and complete.

Dated at Wichita, Kansas, this 23rd day of July, 20 24.

[Signature]  
(Owner)

\_\_\_\_\_  
(Spouse)

William R. Wood, II Trust u/a/d 12/04/1997

(Please Print)

\_\_\_\_\_  
(Please Print)

[Signature]  
(Owner)

\_\_\_\_\_  
(Spouse)

William R. Wood, II Trust u/a/d 01/20/2005

(Please Print)

\_\_\_\_\_  
(Please Print)

\_\_\_\_\_  
(Owner)

\_\_\_\_\_  
(Spouse)

\_\_\_\_\_  
(Please Print)

\_\_\_\_\_  
(Please Print)

State of Kansas }  
County of Sedgwick } SS

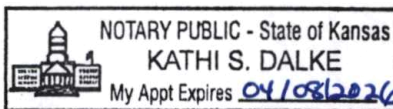

I hereby certify that the foregoing application was signed in my presence and sworn to before me this 23rd day of July, 20 24.

[Signature]  
Notary Public

My Commission Expires 04/08/2026.

ONLY COMPLETE APPLICATIONS WILL BE PROCESSED. To be complete, all of the applicable portions of the application form must be completed with accurate information; maps, if necessary, must be included; signatures of all the appropriate owners' must be affixed to the application and notarized; and the appropriate fee must be paid.

**FEE SCHEDULE**

Each application to change the place of use or the point of diversion under this section shall be accompanied by the application fee set forth in the schedule below: Make checks payable to: **Kansas Department of Agriculture**

- (1) Application to change a point of diversion 300 feet or less ..... \$100
- (2) Application to change a point of diversion more than 300 feet ..... \$200
- (3) Application to change the place of use ..... \$200



RECEIVED

AUG 06 2024

Garden City Field Office  
Division of Water Resources

14. If the proposed groundwater point of diversion is 300 or fewer feet from the existing point of diversion, complete the following:

- (a) Does the undersigned represent all owners of the currently authorized place(s) of use identified in this application?  
 Yes     No    (If no, all owners must sign this application.)
- (b) Will the ownership interest of any owner of the currently authorized place(s) of use identified in this application be adversely affected if this application is approved as requested?  
 Yes     No    (If yes, all owners must sign this application.)
- (c) If this application is not approved expeditiously, will there be substantial damage to property, public health or safety?  
 Yes     No    (If no, all owners must sign this application.)

If the application proposes a surface water change in point of diversion, a groundwater change in point of diversion greater than 300 feet, or a change in place of use, the application must be signed by all owners of the currently authorized place of use, or their duly authorized agent (attach notarized statement authorizing representation).

I hereby verify, being first duly sworn upon my oath or affirmation and under penalty of perjury, that I am of lawful age and the owner, the spouse of the owner, or a duly authorized agent of the owner(s) to make this application on their behalf, in regards to the water right(s) to which this application pertains. I further verify that the statements contained in this application are true, correct and complete.

Dated at Stuart, Florida, ~~Kansas~~, this 30 day of July, 2024.

_____	(Owner)	_____	(Spouse)
<u>Steven J. Wood Trust u/a/d 12/04/1997</u>	(Please Print)	_____	(Please Print)
<u>Steven J. Wood, Trustee</u>	(Owner)	_____	(Spouse)
<u>Steven J. Wood Trust u/a/d 01/20/2005</u>	(Please Print)	_____	(Please Print)
_____	(Owner)	_____	(Spouse)
_____	(Please Print)	_____	(Please Print)

State of ~~Kansas~~ Florida }  
County of Martin } SS

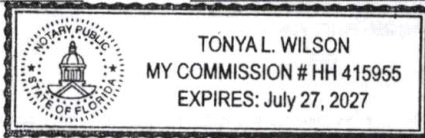

I hereby certify that the foregoing application was signed in my presence and sworn to before me this 30 day of July, 2024.

Tonya L. Wilson  
Notary Public

My Commission Expires 7/27/2027

**ONLY COMPLETE APPLICATIONS WILL BE PROCESSED.** To be complete, all of the applicable portions of the application form must be completed with accurate information; maps, if necessary, must be included; signatures of all the appropriate owners' must be affixed to the application and notarized; and the appropriate fee must be paid.

**FEE SCHEDULE**

- Each application to change the place of use or the point of diversion under this section shall be accompanied by the application fee set forth in the schedule below: Make checks payable to: **Kansas Department of Agriculture**
- (1) Application to change a point of diversion 300 feet or less ..... \$100
  - (2) Application to change a point of diversion more than 300 feet ..... \$200
  - (3) Application to change the place of use ..... \$200



WRs 4886, 6255, 8582, 9235, 10030, 10581, 10986,  
13191, 13795, 15368, 15369, 21946, 22820, 26849  
Change in Place of Use

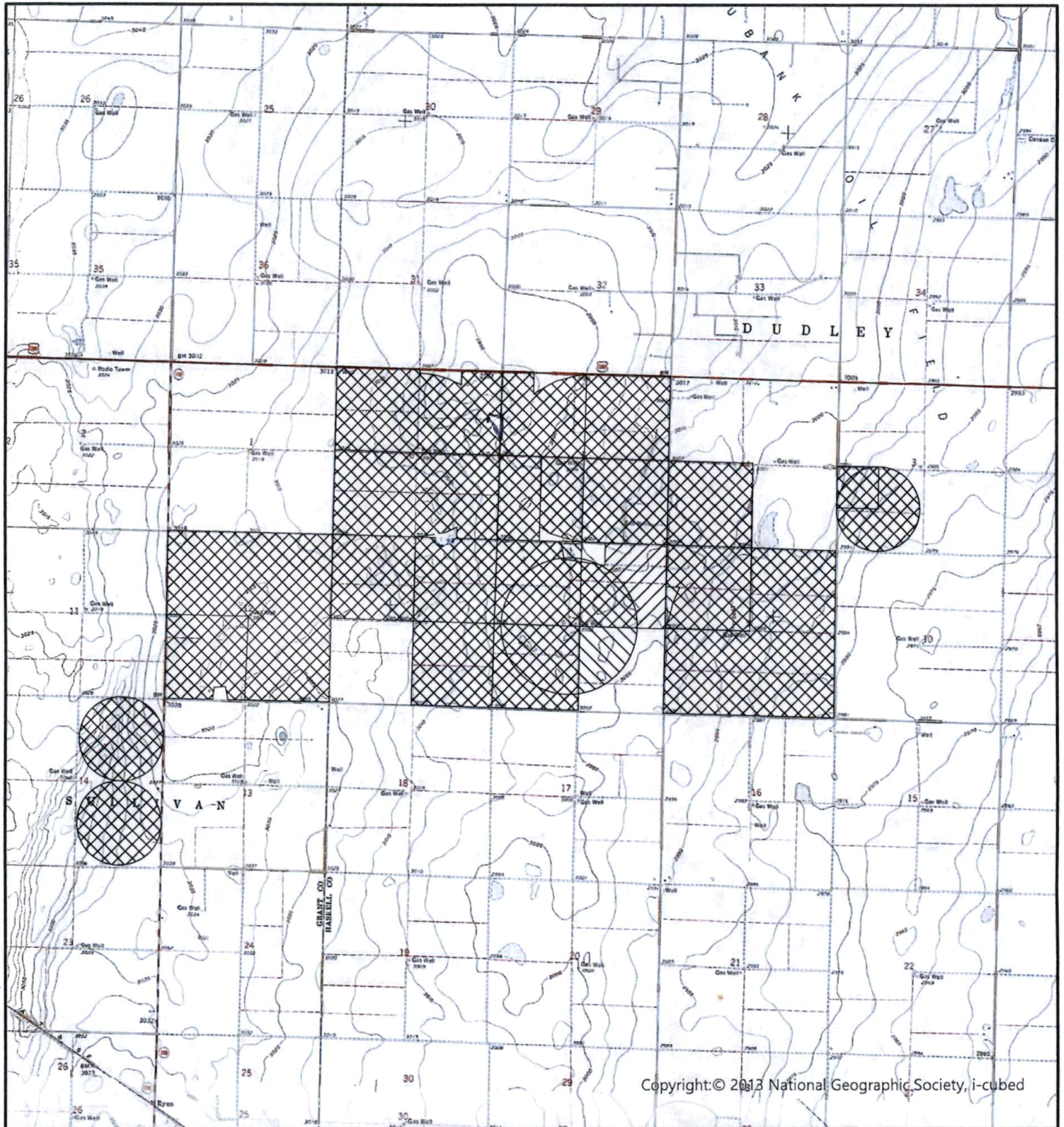

Copyright © 2013 National Geographic Society, i-cubed

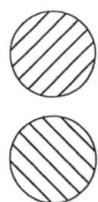

Authorized Place of Use

Proposed Place of Use

● Existing Well



Created By: CI/GCFO





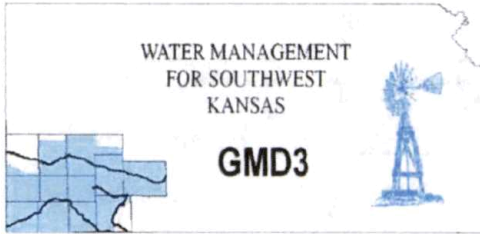

**Southwest Kansas**  
**Groundwater Management District No. 3**  
2009 E. Spruce Street  
Garden City, Kansas 67846  
(620) 275-7147 phone  
www.gmd3.org

August 1, 2024

Michael A. Meyer  
Division of Water Resources  
4532 W Jones Ave., Suite B  
Garden City, Kansas 67846

RE: Applications for Change in Place of Use  
Water Right, File Nos. 4886, 6255, 8582, 9235, 10030, 10581, 10986, 13191, 13795,  
15368, 15369, 21369, 22820 & 26849

Dear Mike:

We have completed a review of the applications for the above referenced water rights. The proposals are not in conflict with the Management Program of the Southwest Kansas Groundwater Management District No. 3 (GMD3). The proposed change in place of use will maintain a complete overlap in authorized place of use while rearranging 80 acres within the operation, in accordance with K.A.R. 5-5-11. Proposed acres are within the combined base acres for the water rights. It is therefore recommended that the applications be approved at this time.

Thank you for the opportunity to review the applications and to provide a recommendation. If you have any questions, please don't hesitate to contact us.

Sincerely,

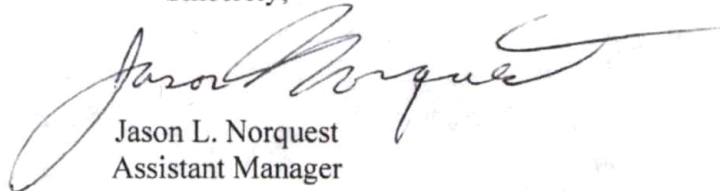

Jason L. Norquest  
Assistant Manager

RECEIVED  
AUG 14 2024  
Garden City Field Office  
Division of Water Resources



## GMD3 Change Review

---

File No(s): 4886, 6255, 8582, 9235, 10030, 10581, 10986, 13191, 13795, 15368, 15369, 21369, 22820, 26849. DWR office: GC.

App filed to change: PU.

Is Landowner(s) correct in WRIS: Kenby Clawson.

If NO, is documentation included?

Regulation(s) Reviewed: KAR 5-5-11

Point of diversion ID No(s)    being changed.

	ft. North	ft. West	
Authorized PD			
Proposed PD			
Difference	0	0	
a <sup>2</sup> + b <sup>2</sup> = c <sup>2</sup>	0	0	0

GPS for proposed PD: Lat:    Long:   .

Is proposed PD stacking on existing WRs? No changes.

Is Proposed PU overlapping existing WRs? Keep current complete overlap, rearranging acres to match current farming operation.

Neighboring certified well(s) notified:   .

Name   .

Address   .

Zip   .

Email:    Phone:   .

Domestic well(s) notified:   .

Name   .

Address   .

Zip   .

Base Acres: 3982.98 combined (all currently authorized acres).

Perfected Acres:   .

Irr. Return-Flow   %

### Haskell County

**Current combined acres = 3982.98.**

**Rearranging the acres in 8-29-34. Taking from the NE and moving the 80 acres into the SE. This will allow a current pivot to make a complete circle**

**Proposed combined acres = 3982.98**

Is a waiver needed: Rearranging acres staying at their combined base acres, no waiver needed.

Recommendation: After review of available information, it appears current area rules are met. Staff recommends approval of the applications.



Garden City Field Office  
4532 W. Jones, Suite B  
Garden City, KS 67846



Phone: 620-276-2901  
Fax: 620-276-9315  
[www.agriculture.ks.gov](http://www.agriculture.ks.gov)

Mike Beam, Secretary

Laura Kelly, Governor

July 31, 2024

SOUTHWEST KANSAS GROUNDWATER  
MANAGEMENT DISTRICT NO. 3  
2009 E SPRUCE ST  
GARDEN CITY KS 67846

Re: Request for Recommendation  
Water Right, File Nos. 4886, 6255, 8582, 9235, 10030, 10581, 10986, 13191,  
13795, 15368, 15369, 21946, 22820, 26849

Dear Mr. Norquest:

This is to advise you that Kenby Clawson has filed applications for approval of the Chief Engineer, Division of Water Resources, Kansas Department of Agriculture, to change the place of use.

We are delaying action on the change applications to allow you time to review and provide a recommendation. Please submit a recommendation within 15 days from the date of this letter.

Thank you and as always feel free to contact this office at any time.

Sincerely,

A handwritten signature in blue ink that reads "Michael A. Meyer".

Michael A. Meyer  
Water Commissioner

MAM  
Enclosures



# FOULSTON

ATTORNEYS AT LAW

William R. Wood, II

bwood@foulston.com  
Phone: 316.291.9772  
Fax: 316.267.6345

1551 N. WATERFRONT PARKWAY, SUITE 100  
WICHITA, KS 67206-4466

July 23, 2024

Paige Clawson  
146 Road 140  
Satanta, KS 67870

Re: DWR Application for Approval – KLC Farms

Dear Paige:

Enclosed are 14 original executed signature pages for the DWR application.

Sincerely,

FOULSTON SIEFKIN LLP

William R. Wood, II

WRW/kd  
Enclosures

RECEIVED

AUG 06 2024

Garden City Field Office  
Divison of Water Resources

LexMundi  
Member

GGi  
INDEPENDENT MEMBER

July 30, 2024

**Via Federal Express**  
**Tracking No.: 7776 8526 1437**  
Paige A. Clawson  
146 Road 140  
Satanta, Kansas 67870

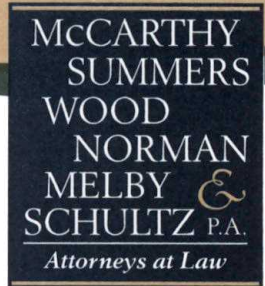

**RE: Steven J. Wood Trust u/a/d 12/04/1997**  
**Steven J. Wood Trust u/a/d 01/20/2005**  
**Form DWR 1-121**

Ms. Clawson,

Enclosed please find the following:

1. Fourteen (14) signatures pages executed by Steven J. Wood as Trustee of The Steven J. Wood Trust u/a/d 12/04/1997; and
2. Fourteen (14) signatures pages executed by Steven J. Wood as Trustee of The Steven J. Wood Trust u/a/d 01/20/2005.

Thank you for your assistance in this matter.

Best regards,

A handwritten signature in blue ink, which appears to be "Tonya L. Wilson", is written over the "Best regards," text.

Tonya L. Wilson, ACP, FCP, FRP  
Advanced Certified Paralegal

[Tlw@McCarthySummers.com](mailto:Tlw@McCarthySummers.com)

/tlc  
Enclosures

Cc: Steven J. Wood, Trustee

Terence P. McCarthy \*  
Robert P. Summers \*  
Steven J. Wood \*\*  
Kenneth A. Norman  
Nicola J. Boone Melby \*\*\*  
Owen Schultz  
Margaret E. Wood  
Jessica M. VanValkenburgh  
Christen Spake  
Kimberly A. Ryan  
Loren N. Esposito  
Ross C. Alagna

*\*Board Certified  
Real Estate Lawyer*

*\*\*Board Certified Wills,  
Trusts & Estates Lawyer*

*\*\*\*Board Certified  
Elder Law Lawyer*

RECEIVED  
AUG 06 2024

Garden City Field Office  
Division of Water Resources