

Kansas Department of Agriculture  
 Division of Water Resources  
**CHANGE: P/U WORKSHEET**

1. File Number: <b>13330</b>	2. Status Change Date: <b>5-23-2024</b>	3. Change Num: <b>C3</b>	4. Field Office: <b>4</b>	5. GMD: <b>3</b>
6. Status: <input checked="" type="checkbox"/> Approved <input type="checkbox"/> Denied by DWR/GMD <input type="checkbox"/> Dismiss by Request/Failure to Return				7. Filing Date of Change: <b>5/02/2024</b>
8a. Landowner, applicant New to system <input type="checkbox"/>  <b>REX &amp; ROGLENDA COULTER 1165 ROAD 7 HUGOTON, KS 67951-5144</b>		8c. Landowner(s) New to system <input checked="" type="checkbox"/>  <b>TONI HAMLIN &amp; DONA KIRK 1200 S ADAMS HUGOTON KS 67951-2924</b>		
8b. Landowner(s) New to system <input type="checkbox"/>  <b>HARRISON KREY 1760 ROAD 20 ROLLA, KS 67954-1115</b>		8d. WUC New to system <input type="checkbox"/> 8b  Person ID <u>61447</u> Add Seq# _____		
9. Documents and Enclosure(s): <input checked="" type="checkbox"/> DWR Meter(s) Date to Comply: <u>12/31/2024</u> <input type="checkbox"/> N & P Date to Comply: _____ <input type="checkbox"/> Anti-Reverse Meter <input type="checkbox"/> Meter Seal <input checked="" type="checkbox"/> Check Valve <input type="checkbox"/> N & P Form <input type="checkbox"/> Water Tube <input type="checkbox"/> Driller Copy <input type="checkbox"/> H & E Letter <input type="checkbox"/> Conservation Plan    Date Required: _____    Date Approved: _____    Date to Comply: _____				
10. Use Made of Water    From: _____    To: _____				
Date Prepared: <b>05/23/2024</b> By: <b>MAM</b> Date Entered: _____ By: _____				

File No. 13330      11. County: SV      Basin: CIMARRON RIVER      Stream:      Formation Code:      Special Use:

12. Points of Diversion  
 CHK  
 MOD  
 DEL PDIV  
 ENT  
 Qualifier      S      T      R      ID      'N      'W      Comment (AKA Line)  
 Rate and Quantity  
 Authorized      Additional  
 Rate      Quantity      Rate      Quantity  
 gpm/cfs      af/mgy      gpm/cfs      af/mgy      Overlap PD Files

CHK 31953

13. Storage: Rate \_\_\_\_\_ NF      Quantity \_\_\_\_\_ ac/ft      Additional Rate \_\_\_\_\_ NF      Additional Quantity \_\_\_\_\_ ac/ft

14. Limitation: \_\_\_\_\_ af/yr at \_\_\_\_\_ gpm ( \_\_\_\_\_ cfs) when combined with file number(s) \_\_\_\_\_  
 Limitation: \_\_\_\_\_ af/yr at \_\_\_\_\_ gpm ( \_\_\_\_\_ cfs) when combined with file number(s) \_\_\_\_\_

15. 5YR Allocation:      Allocation Type \_\_\_\_\_      Start Year \_\_\_\_\_      5 YR Amount \_\_\_\_\_      Amount Unit \_\_\_\_\_      Base Acres \_\_\_\_\_      Comment \_\_\_\_\_

16. Place of Use CHK MOD DEL ENT	PUSE	S	T	R	ID	NE¼				NW¼				SW¼				SE¼				Total	Owner	Chg?	Overlap Files				
						NE ¼	NW ¼	SW ¼	SE ¼	NE ¼	NW ¼	SW ¼	SE ¼	NE ¼	NW ¼	SW ¼	SE ¼	NE ¼	NW ¼	SW ¼	SE ¼								
MOD	14419	27	33	38W	1					13.5		16.5	40					40	13.5		9.5					67	8a	N	NONE
MOD	68943	27	33	38W	5																								
ENT		27	33	38W																		9.5	40	8.5		116	8c	N	NONE

Base Acres: **236** Year:      Minimum Reasonable Quantity:  
 Comments:

Garden City Field Office  
4532 W. Jones, Suite B  
Garden City, KS 67846



Phone: 620-276-2901  
Fax: 620-276-9315  
www.agriculture.ks.gov

Mike Beam, Secretary

Laura Kelly, Governor

May 23, 2024

REX & ROGLENDA COULTER  
1165 ROAD 7  
HUGOTON, KS 67951-5144

RE: Field Office Application for Change  
Water Right, File No. 13330

Dear Sir and Madam:

Enclosed is an order executed by the designee of the Chief Engineer, Division of Water Resources, Kansas Department of Agriculture, approving the application for change under the above referenced file number.

Your attention is directed to the enclosures and to the terms, conditions, and limitations specified in these approvals for change. A condition of this approval is that an acceptable water flow meter must be installed on the diversion works authorized under the referenced file number and meet current specifications. Please return the required notification of completion of the diversion works and installation of the required meter as soon as these actions are completed.

Since the order modifies the original document referred to above, it should be recorded with the Register of Deeds as other instruments affecting real estate.

Should you have any questions, please feel free contact this office. If you would prefer, you could arrange an appointment for additional assistance.

Sincerely,

A blue ink signature of Michael A. Meyer, written in a cursive style.

Michael A. Meyer  
Water Commissioner

MAM:  
Enclosures

pc: Harrison Krey  
Toni Hamlin & Dona Kirk  
GMD3

**CERTIFICATE OF SERVICE**

On this 23<sup>rd</sup> day of May 2024, I hereby certify that the foregoing Approvals of Application for Change in Place of use, Water Right, File No. 13,330 dated 23<sup>rd</sup> day of May 2024 was mailed postage prepaid, first class, US mail to the following:

REX & ROGLENDA COULTER  
1165 ROAD 7  
HUGOTON, KS 67951-5144

**Pc:**

HARRISON KREY  
1760 ROAD 20  
ROLLA, KS 67954-1115

TONI HAMLIN & DONA KIRK  
1200 S ADAMS  
HUGOTON KS 67951-2924

GMD3



Aaron Holsted

Division of Water Resources Staff



Submit completed application to:  
 Kansas Department of Agriculture  
 Division of Water Resources  
 Field Office for your area.  
 Call for address:

Topeka -- (785) 296-5733  
 Stafford -- (620) 234-5311  
 Stockton -- (785) 425-6787  
 Garden City -- (620) 276-2901  
<http://agriculture.ks.gov/dwr>

## DWR FIELD OFFICE APPLICATION FOR APPROVAL TO CHANGE THE PLACE OF USE AND/OR THE POINT OF DIVERSION



**STATE OF KANSAS**

**Filing Fee Must Accompany the Application, K.S.A. 82a-708b(b), as amended.**  
 Fee Schedule is on the third page of this application form.

**Paragraph Nos. 1, 2, 3 & 5 must be completed. Complete all other applicable portions.** If change in point of diversion is greater than 100 feet, or if place of use will be changed, include a topographic map or detailed plat showing the authorized and proposed point(s) of diversion and/or place of use.

File No. 13330

**RECEIVED**  
 2:20 pm  
 MAY 02 2024

1. Application is hereby made for approval of the Chief Engineer to change the (check one or both):

Place of Use                       Point of Diversion

under the water right which is the subject of this application in accordance with the conditions described below.

The source of supply is:                       Groundwater                       Surface water

Garden City Field Office  
 Division of Water Resources

2. Name and address of Applicant: REX COULTER

1165 ROAD 7 HUGOTON KS 67951 - 5144

Phone Number: (    )                      Email address: \_\_\_\_\_

Name and address of Water Use Correspondent: TRAVIS COULTER

1200 S ADAMS HUGOTON KS 67951 - 2924

Phone Number: (    )                      Email address: \_\_\_\_\_

3. The presently authorized place of use is:

Owner of Land ---- NAME: REX COULTER

ADDRESS: 1165 ROAD 7 HUGOTON KS 67951 - 5144

(If there is more than one landowner, attach supplemental sheets as necessary.)

Sec.	Twp.	Range	NE¼				NW¼				SW¼				SE¼				TOTAL ACRES
			NE¼	NW¼	SW¼	SE¼	NE¼	NW¼	SW¼	SE¼	NE¼	NW¼	SW¼	SE¼	NE¼	NW¼	SW¼	SE¼	
27	33S	38W					31.25	31.25	31.25	31.25									125

4. If this application is for a change in place of use, it is proposed that the place of use be changed to:

Owner of Land ---- NAME: REX COULTER

ADDRESS: 1165 ROAD 7 HUGOTON KS 67951 - 5144

(If there is more than one landowner, attach supplemental sheets as necessary.)

Sec.	Twp.	Range	NE¼				NW¼				SW¼				SE¼				TOTAL ACRES
			NE¼	NW¼	SW¼	SE¼	NE¼	NW¼	SW¼	SE¼	NE¼	NW¼	SW¼	SE¼	NE¼	NW¼	SW¼	SE¼	
27	33S	38W					13.5			13.5									67

**For Office Use Only:** Code \_\_\_\_\_ Fee \$ 200.00 TR # \_\_\_\_\_ Receipt Date 5-2-24 Check # 1584

APPLICATION FOR APPROVAL TO CHANGE  
THE PLACE OF USE AND/OR POINT OF DIVERSION  
SUPPLEMENTAL SHEET  
**FILE NO. 13330**  
MAKE ADDITIONAL COPIES AS NECESSARY

3. *Continued:* The presently authorized place of use is:

Owner of Land ---- NAME: HARRISON KREY

ADDRESS: 1203 RD 5 HUGOTON KS 67951

Sec.	Twp.	Range	NE¼				NW¼				SW¼				SE¼				TOTAL ACRES
			NE¼	NW¼	SW¼	SE¼	NE¼	NW¼	SW¼	SE¼	NE¼	NW¼	SW¼	SE¼	NE¼	NW¼	SW¼	SE¼	
27	33S	38W									40	40	1	40					121

Owner of Land ---- NAME: \_\_\_\_\_

ADDRESS: \_\_\_\_\_

Sec.	Twp.	Range	NE¼				NW¼				SW¼				SE¼				TOTAL ACRES
			NE¼	NW¼	SW¼	SE¼	NE¼	NW¼	SW¼	SE¼	NE¼	NW¼	SW¼	SE¼	NE¼	NW¼	SW¼	SE¼	

Owner of Land ---- NAME: \_\_\_\_\_

ADDRESS: \_\_\_\_\_

Sec.	Twp.	Range	NE¼				NW¼				SW¼				SE¼				TOTAL ACRES
			NE¼	NW¼	SW¼	SE¼	NE¼	NW¼	SW¼	SE¼	NE¼	NW¼	SW¼	SE¼	NE¼	NW¼	SW¼	SE¼	

4. *Continued:* If this application is for a change in place of use, it is proposed that the place of use be changed to:

Owner of Land ---- NAME: HARRISON KREY

ADDRESS: 1203 RD 5 HUGOTON KS 67951

Sec.	Twp.	Range	NE¼				NW¼				SW¼				SE¼				TOTAL ACRES
			NE¼	NW¼	SW¼	SE¼	NE¼	NW¼	SW¼	SE¼	NE¼	NW¼	SW¼	SE¼	NE¼	NW¼	SW¼	SE¼	
27	33S	38W									40	13.5		9.5					63

Owner of Land ---- NAME: TONI HAMLIN & DONA KIRK

ADDRESS: 1200 S ADAMS, HUGOTON KS 67951-2924

Sec.	Twp.	Range	NE¼				NW¼				SW¼				SE¼				TOTAL ACRES
			NE¼	NW¼	SW¼	SE¼	NE¼	NW¼	SW¼	SE¼	NE¼	NW¼	SW¼	SE¼	NE¼	NW¼	SW¼	SE¼	
27	33S	38W		8.5	40	9.5									9.5	40	8.5		116

Owner of Land ---- NAME: \_\_\_\_\_

ADDRESS: \_\_\_\_\_

Sec.	Twp.	Range	NE¼				NW¼				SW¼				SE¼				TOTAL ACRES
			NE¼	NW¼	SW¼	SE¼	NE¼	NW¼	SW¼	SE¼	NE¼	NW¼	SW¼	SE¼	NE¼	NW¼	SW¼	SE¼	



5. **Presently authorized point of diversion:**  
 One in the \_\_\_\_\_ Quarter of the \_\_\_\_\_ Quarter of the \_\_\_\_\_ Quarter  
 of Section \_\_\_\_\_, Township \_\_\_\_\_ South, Range \_\_\_\_\_ (W),  
 in \_\_\_\_\_ County, Kansas, \_\_\_\_\_ feet North \_\_\_\_\_ feet West of Southeast corner of section.  
 Authorized Rate \_\_\_\_\_ Authorized Quantity \_\_\_\_\_ Depth of well \_\_\_\_\_ (feet)  
**(DWR use only: Computer ID No. \_\_\_\_\_ GPS \_\_\_\_\_ feet North \_\_\_\_\_ feet West)**  
 This point will not be changed  This point will be changed as follows:  No change, point better described with GPS as follows:  
**Proposed point of diversion: (Complete only if change is requested or if existing point is better described by GPS)**  
 One in the \_\_\_\_\_ Quarter of the \_\_\_\_\_ Quarter of the \_\_\_\_\_ Quarter  
 of Section \_\_\_\_\_, Township \_\_\_\_\_ South, Range \_\_\_\_\_ (W),  
 in \_\_\_\_\_ County, Kansas, \_\_\_\_\_ feet North \_\_\_\_\_ feet West of Southeast corner of section.  
 Proposed Rate \_\_\_\_\_ Proposed Quantity \_\_\_\_\_ Proposed well depth (feet) \_\_\_\_\_  
 This point is:  Additional Well  Geo Center List other water rights that will use this point \_\_\_\_\_

6. **Presently authorized point of diversion:**  
 One in the \_\_\_\_\_ Quarter of the \_\_\_\_\_ Quarter of the \_\_\_\_\_ Quarter  
 of Section \_\_\_\_\_, Township \_\_\_\_\_ South, Range \_\_\_\_\_ (W),  
 in \_\_\_\_\_ County, Kansas, \_\_\_\_\_ feet North \_\_\_\_\_ feet West of Southeast corner of section.  
 Authorized Rate \_\_\_\_\_ Authorized Quantity \_\_\_\_\_ Depth of well \_\_\_\_\_ (feet)  
**(DWR use only: Computer ID No. \_\_\_\_\_ GPS \_\_\_\_\_ feet North \_\_\_\_\_ feet West)**  
 This point will not be changed  This point will be changed as follows:  No change, point better described with GPS as follows:  
**Proposed point of diversion: (Complete only if change is requested or if existing point is better described by GPS)**  
 One in the \_\_\_\_\_ Quarter of the \_\_\_\_\_ Quarter of the \_\_\_\_\_ Quarter  
 of Section \_\_\_\_\_, Township \_\_\_\_\_ South, Range \_\_\_\_\_ (W),  
 in \_\_\_\_\_ County, Kansas, \_\_\_\_\_ feet North \_\_\_\_\_ feet West of Southeast corner of section.  
 Proposed Rate \_\_\_\_\_ Proposed Quantity \_\_\_\_\_ Proposed well depth (feet) \_\_\_\_\_  
 This point is:  Additional Well  Geo Center List other water rights that will use this point \_\_\_\_\_

7. The changes herein are desired for the following reasons?  
 (please be specific) REVERTING BACK TO PREVIOUS  
AUTHORIZED PLACE OF USE - DID NOT COMPLETE  
2023 PLACE OF USE CHANGE

8. If a well, is the test hole log attached?  Yes  No

9. The change(s) (was)(will be) completed by?  
UPON APPROVAL

10. If the point of diversion is a well:  
 (a) What are you going to do with the old well?  
N / A  
 (b) When will this be done? N / A

11. Groundwater Management District recommendation attached?  
 Yes  No

12. Assisted by AM / GTFO

13a. If the proposed point of diversion will be relocated more than 300 feet but within 2,640 feet of the existing point of diversion, attach a topographic map or aerial photograph. For groundwater sources, show all wells (including domestic) within one-half mile of the proposed point of diversion and the names and mailing addresses of the owners. For surface water sources, show the names and addresses of the landowner(s) one-half mile downstream and one-half mile upstream from your property lines

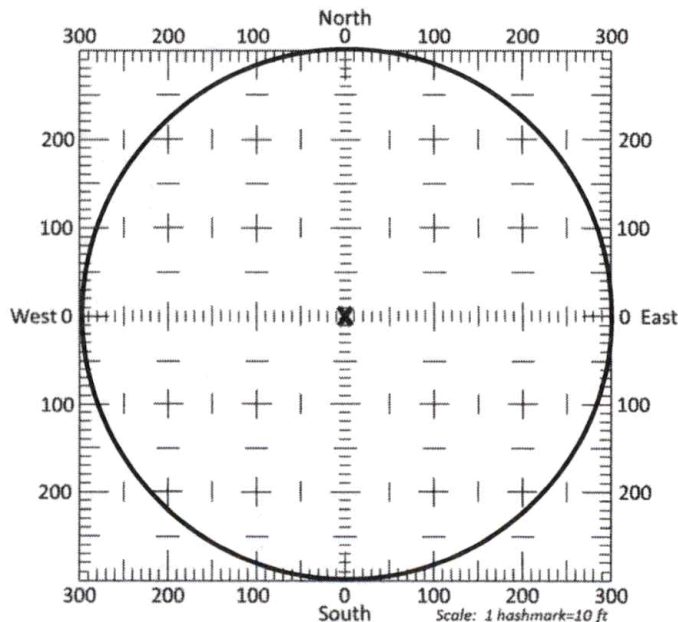

13b. If the proposed point of diversion will be relocated within a 300 foot radius of the existing point of diversion, indicate its location on the diagram shown above in relation to the existing point of diversion. The proposed point of diversion must be located within the circle shown above. **(PLEASE NOTE: The "X" in center of diagram above represents the presently authorized point of diversion.)**

14. If the proposed groundwater point of diversion is 300 or fewer feet from the existing point of diversion, complete the following:
- (a) Does the undersigned represent all owners of the currently authorized place(s) of use identified in this application?  
 Yes     No    (If no, all owners must sign this application.)
  - (b) Will the ownership interest of any owner of the currently authorized place(s) of use identified in this application be adversely affected if this application is approved as requested?  
 Yes     No    (If yes, all owners must sign this application.)
  - (c) If this application is not approved expeditiously, will there be substantial damage to property, public health or safety?  
 Yes     No    (If no, all owners must sign this application.)

If the application proposes a surface water change in point of diversion, a groundwater change in point of diversion greater than 300 feet, or a change in place of use, the application must be signed by all owners of the currently authorized place of use, or their duly authorized agent (attach notarized statement authorizing representation).

**I hereby verify, being first duly sworn upon my oath or affirmation and under penalty of perjury, that I am of lawful age and the owner, the spouse of the owner, or a duly authorized agent of the owner(s) to make this application on their behalf, in regards to the water right(s) to which this application pertains. I further verify that the statements contained in this application are true, correct and complete.**

Dated at Hugoton, Kansas, this 7<sup>th</sup> day of May, 2024.

[Signature]  
 (Owner)  
Harrison Key  
 (Please Print)  
Rex Coulter  
 (Owner)  
Rex Coulter  
 (Please Print)  
Joni Hamlin  
 (Owner)  
Toni Hamlin  
 (Please Print)

[Signature]  
 (Spouse)  
Roni Key  
 (Please Print)  
Glenda Coulter  
 (Spouse)  
Glenda Coulter  
 (Please Print)  
Jack Hamlin  
 (Spouse)  
Jack Hamlin  
 (Please Print)

State of Kansas }  
 County of Kansas } SS

I hereby certify that the foregoing application was signed in my presence and sworn to before me this 1 day of May, 2024.

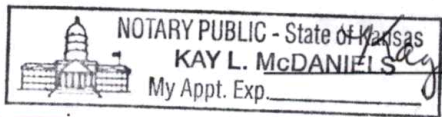

[Signature]  
 Notary Public

My Commission Expires 4-22-26

**ONLY COMPLETE APPLICATIONS WILL BE PROCESSED.** To be complete, all of the applicable portions of the application form must be completed with accurate information; maps, if necessary, must be included; signatures of all the appropriate owners' must be affixed to the application and notarized; and the appropriate fee must be paid.

**FEE SCHEDULE**

Each application to change the place of use or the point of diversion under this section shall be accompanied by the application fee set forth in the schedule below: Make checks payable to: **Kansas Department of Agriculture**

- (1) Application to change a point of diversion 300 feet or less ..... \$100
- (2) Application to change a point of diversion more than 300 feet ..... \$200
- (3) Application to change the place of use ..... \$200



14. If the proposed groundwater point of diversion is 300 or fewer feet from the existing point of diversion, complete the following:

- (a) Does the undersigned represent all owners of the currently authorized place(s) of use identified in this application?  
 Yes     No    (If no, all owners must sign this application.)
- (b) Will the ownership interest of any owner of the currently authorized place(s) of use identified in this application be adversely affected if this application is approved as requested?  
 Yes     No    (If yes, all owners must sign this application.)
- (c) If this application is not approved expeditiously, will there be substantial damage to property, public health or safety?  
 Yes     No    (If no, all owners must sign this application.)

If the application proposes a surface water change in point of diversion, a groundwater change in point of diversion greater than 300 feet, or a change in place of use, the application must be signed by all owners of the currently authorized place of use, or their duly authorized agent (attach notarized statement authorizing representation).

I hereby verify, being first duly sworn upon my oath or affirmation and under penalty of perjury, that I am of lawful age and the owner, the spouse of the owner, or a duly authorized agent of the owner(s) to make this application on their behalf, in regards to the water right(s) to which this application pertains. I further verify that the statements contained in this application are true, correct and complete.

Dated at Red Oak, Texas Ellis County, Kansas, this 01 day of May, 20 24.

\_\_\_\_\_  
 (Owner)  
Dona Kirk  
 (Please Print)  
DONA KIRK  
 (Owner)  
 \_\_\_\_\_  
 (Please Print)  
 \_\_\_\_\_  
 (Owner)

\_\_\_\_\_  
 (Spouse)  
 \_\_\_\_\_  
 (Please Print)  
 \_\_\_\_\_  
 (Spouse)  
 \_\_\_\_\_  
 (Please Print)  
 \_\_\_\_\_  
 (Spouse)

\_\_\_\_\_  
 (Please Print)  
 State of Kansas Texas  
 County of Stevens Ellis } SS

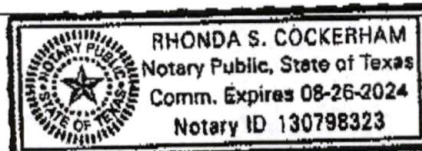

\_\_\_\_\_  
 (Please Print)

I hereby certify that the foregoing application was signed in my presence and sworn to before me this 01 day of May, 20 24.

Rhonda S. Cockerham  
 Notary Public

My Commission Expires 26 August 2024

**ONLY COMPLETE APPLICATIONS WILL BE PROCESSED.** To be complete, all of the applicable portions of the application form must be completed with accurate information; maps, if necessary, must be included; signatures of all the appropriate owners must be affixed to the application and notarized; and the appropriate fee must be paid.

**FEE SCHEDULE**

Each application to change the place of use or the point of diversion under this section shall be accompanied by the application fee set forth in the schedule below: Make checks payable to: **Kansas Department of Agriculture**

- (1) Application to change a point of diversion 300 feet or less ..... \$100
- (2) Application to change a point of diversion more than 300 feet ..... \$200
- (3) Application to change the place of use ..... \$200



**SUMMARY ORDER APPROVING APPLICATION FOR CHANGE AND IMPOSING CONDITIONS**

This Summary Order is issued under authority of K.S.A. 82a-708b, as amended, and K.A.R. 5-5-1, *et seq.* and other applicable provisions of the *Kansas Water Appropriation Law, K.S.A. 82a-701 et seq.*, and rules and regulations promulgated thereunder, With the exception of those conditions expressly contained herein, this Summary Order does not change the terms, conditions and limitations of File No. 13,330

1. A change application was received on May 2, 2024 requesting that the place of use and / or point of diversion authorized under the above-referenced file number be changed as described in the application.
2. On and after the effective date of this summary order, the authorized place(s) of use shall be located substantially as shown on the topographic map accompanying the application to change the place of use.  Applicable  Not Applicable
3. The change in point of diversion shall not impair existing rights and shall be limited to the same source or sources of water as previously authorized. The point of diversion authorized by this summary order shall be located within a \_\_\_\_\_ foot radius of the authorized point(s) of diversion.  Applicable  Not Applicable
4. The point(s) of diversion described herein is administratively corrected to be more accurately described using the Global Positioning System (GPS), as described in the application.  Applicable  Not Applicable
5. The point(s) of diversion authorized herein shall not actually be located more than \_\_\_\_\_ feet from the previously authorized point(s) of diversion.  Applicable  Not Applicable
6. As required by K.A.R. 5-3-5d, if the works for diversion is a well with a diversion rate of 100 gallons per minute or more, a tube or other device suitable for making water level measurements shall be installed, operated and maintained in accordance with K.A.R. 5-6-13.  Applicable  Not Applicable
7. **The owner of the authorized place(s) of use shall properly install an acceptable water flow meter on or before December 31, 2024**, or before the first use of water, whichever occurs first. The water flow meter shall be installed, operated and maintained in accordance with K.A.R. 5-1-4 through 5-1-12. As required by K.S.A. 82a-732, as amended, and K.A.R. 5-3-5e, the owner shall maintain records and report the reading of the water flow meter and the total quantity of water diverted annually to the Chief Engineer by March 1 following the end of each calendar year.  Applicable  Not Applicable
8. **Installation of the works for diversion of water shall be completed on or before December 31, 2024**, or within any authorized extension of time. By March 1, 2024 the applicant shall notify the Chief Engineer that construction of the works for diversion has been completed, on the form provided by the Chief Engineer, as required by K.A.R. 5-8-4e.  Applicable  Not Applicable
9. **The completed well log shall be submitted with the required notice.**  Applicable  Not Applicable
10. All diversion works into which any type of chemical or other foreign substance will be injected into the water shall be equipped with an in-line, automatic, quick-closing check valve capable of preventing pollution of the source of the water supply. The check valve(s) shall be installed, operated and maintained in accordance with K.A.R. 5-3-5e.  Applicable  Not Applicable
11. Additional Conditions are attached.  Yes  No
12. In accordance with K.S.A. 82a-708a, as amended, and K.A.R. 5-5-14, all of the owners of the authorized place(s) of use of water appropriated under the above-referenced file number are responsible for compliance with its terms, conditions and limitations, as amended and/or supplemented by this Summary Order, and with applicable provisions of the *Kansas Water Appropriation Law* and the *Rules and Regulations* promulgated thereunder. Failure to comply with these provisions may result in civil penalties pursuant to K.S.A. 82a-737, as amended, and/or the suspension or revocation and dismissal of the water or appropriation right or any other enforcement actions authorized by law.

**Administrative Appeal and Effective Date of Order**

If you are aggrieved by this order, pursuant to K.S.A. 82a-1901, you may request an evidentiary hearing before the Chief Engineer or request administrative review by the Secretary of Agriculture. A request for hearing by the Chief Engineer must be filed within **15 days** of service of this Order and a request for administrative review by the Secretary must be filed within **30 days** pursuant to K.S.A. 77-531. Any request for administrative review must state a basis for review pursuant to K.S.A. 77-527. File any request with **Kansas Department of Agriculture, Legal Division, 1320 Research Park Drive, Manhattan, KS 66502**. Failure to timely request a hearing or review may preclude review under the Kansas Judicial Review Act.

*For Use by Register of Deeds*

FOR OFFICE USE ONLY  
**APPLICATION APPROVED AND SUMMARY ORDER ISSUED**

By: Michael A. Meyer  
Duly Authorized Designee of the Chief Engineer

(Print Name): MICHAEL A. MEYER  
Division of Water Resources - Kansas Department of Agriculture

Date of Issuance: May 23, 2024

State of Kansas \_\_\_\_\_ )

County of Linn \_\_\_\_\_ ) SS

Acknowledged before me on May 23, 2024

by Michael A Meyer

Signature: Aaron Holsted  
Notary Public

My commission expires \_\_\_\_\_

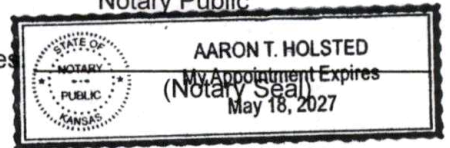



# CHANGE IN PLACE OF USE WATER RIGHT, FILE NO. 13330

Section 27 Township 33 South Range 38 West Stevens County

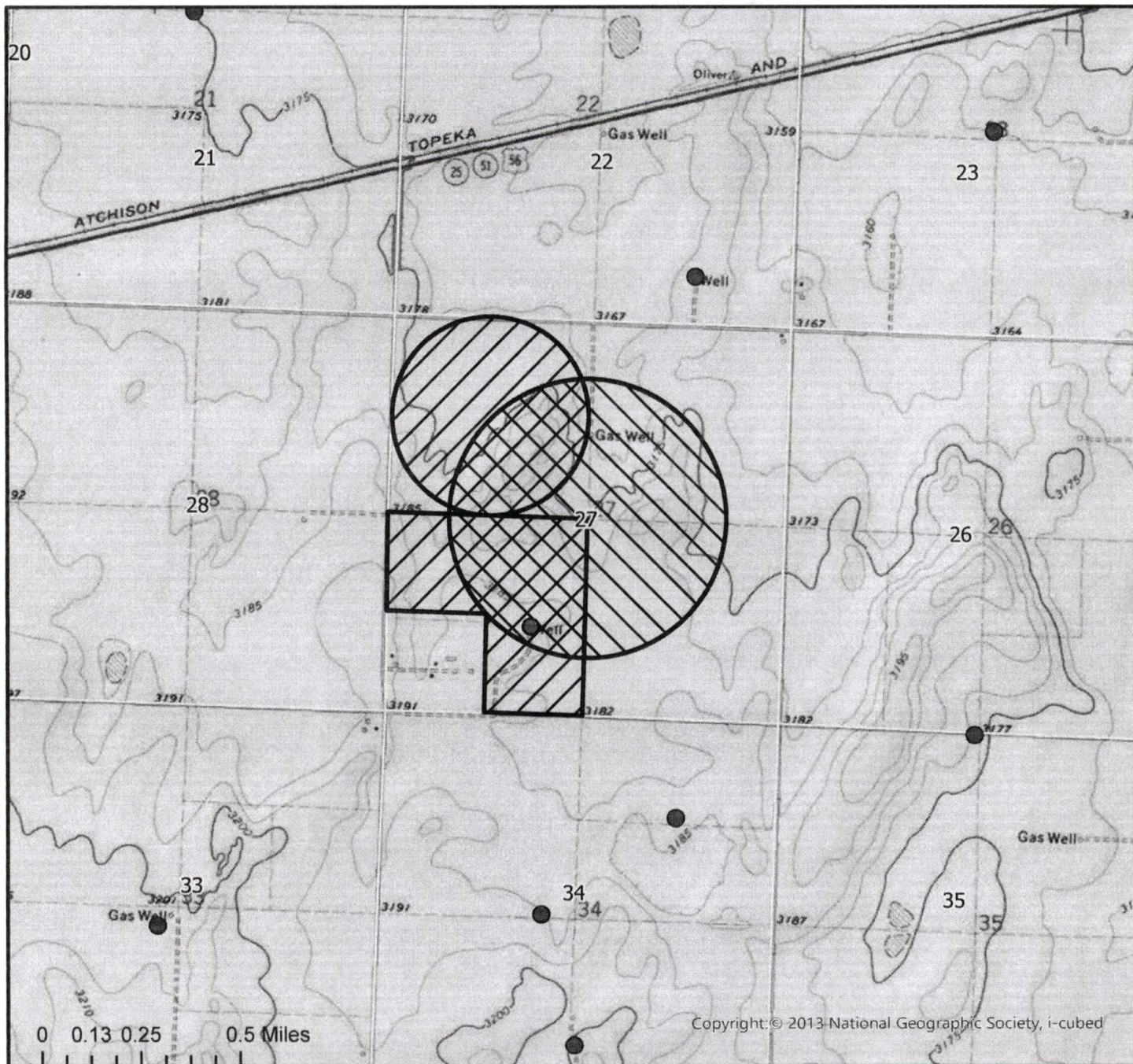

●	Authorized Point of Diversion
●	Permitted Water Right
★	Domestic Well within 1/2 mile
	Authorized Place of Use
	Proposed Place of Use

List of owner name and addresses within 1/2 mile:



By signing below I agree that all wells, including domestic, and owners names and addresses within 1/2 mile of the proposed point of diversion have been shown on the map

(Signature)

5/1/24  
Date

AM/GCFO  
1:24,000 Scale



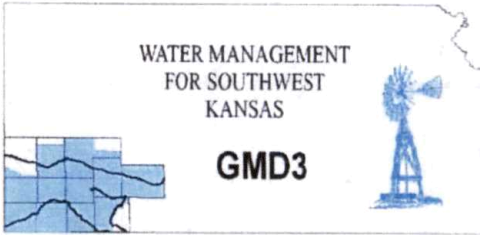

**Southwest Kansas**  
**Groundwater Management District No. 3**  
**2009 E. Spruce Street**  
**Garden City, Kansas 67846**  
(620) 275-7147 phone  
www.gmd3.org

May 20, 2024

Michael A. Meyer  
Division of Water Resources  
4532 W Jones Ave., Suite B  
Garden City, Kansas 67846

RE: Application for Change in Place of Use  
Water Right, File No. 13330

Dear Mike:

We have completed a review of the application for the above referenced water right. The proposal is not in conflict with the Management Program of the Southwest Kansas Groundwater Management District No. 3 (GMD3). The proposed change in place of use will revert the authorized acres back to the original acres prior to a 2023 change approval. Base are the same in accordance with K.A.R. 5-5-11. No new acres are proposed that was not covered prior to the 2023 change approval. It is therefore recommended that the application be approved at this time.

Thank you for the opportunity to review the applications and to provide a recommendation. If you have any questions, please don't hesitate to contact us.

Sincerely,

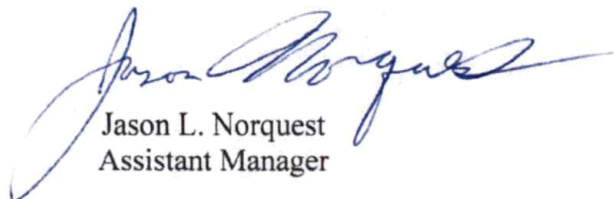

Jason L. Norquest  
Assistant Manager

RECEIVED

MAY 20 2024

Garden City Field Office  
Division of Water Resources

## GMD3 Change Review

---

File No(s): 13330. DWR office: GC.

App filed to change: PU.

Is Landowner(s) correct in WRIS: Rex Coulter.

If NO, is documentation included?

Is Water Use Correspondent correct in WRIS?   .

If NO, is documentation included?

Regulation(s) Reviewed: KAR 5-5-11

Point of diversion ID No(s)    being changed.

	ft. North	ft. West
Authorized PD		
Proposed PD		
<hr/>		
Difference	0	0
a2 + b2 = c2	0	0
<hr/>		

GPS for proposed PD: Lat:    Long:   .

Is proposed PD stacking on existing WRs? No Change.

Is Proposed PU overlapping existing WRs? Reverting back to previous acres.

Neighboring certified well(s) notified:   .

Name   .

Address   .

Zip   .

Email:    Phone:   .

Domestic well(s) notified:   .

Name   .

Address   .

Zip   .

Base Acres: 246.

Perfected Acres:   .

Irr. Return-Flow   %

**Authorized: 420AF @ 1600gpm**

**Current acres were from a change approved in 20234**

**Currently a total of 246acres:**

**125acre pivot in the NW**

**121acres in the SW quarter (excludes the SW of SW)**

**Proposed:**

**246acre pivot with center approximately in the center of section**

Is a waiver needed: No, this is reverting back to original acres and still within the base acres of the WR.

Recommendation: After review of available information, it appears current area rules are met. Staff recommends approval of the application.



Garden City Field Office  
4532 W. Jones, Suite B  
Garden City, KS 67846



Phone: 620-276-2901  
Fax: 620-276-9315  
www.agriculture.ks.gov

Mike Beam, Secretary

Laura Kelly, Governor

May 6, 2024

SOUTHWEST KANSAS GROUNDWATER  
MANAGEMENT DISTRICT NO. 3  
2009 E SPRUCE ST  
GARDEN CITY KS 67846

Re: Request for Recommendation  
Water Right, File No. 13330

Dear Mr. Norquest:

This is to advise you that Harrison has filed an application for approval of the Chief Engineer, Division of Water Resources, Kansas Department of Agriculture, to change the place of use.

We are delaying action on the change application to allow you time to review and provide a recommendation. Please submit a recommendation within 15 days from the date of this letter.

Thank you and as always feel free to contact this office at any time.

Sincerely,

A handwritten signature in blue ink that reads "Michael A. Meyer".

Michael A. Meyer  
Water Commissioner

MAM  
Enclosures



Entered in Transfer Record by my office this  
12 day of December  
A.D. 20 23  
[Signature]  
County Clerk



STATE OF KANSAS SS  
COUNTY OF STEVENS

This instrument was filed for record on the 11  
day of December A.D. 2023  
at 2:00 clock P M. and duly recorded in  
Book 359 on page 124 Fee \$21.00

[Signature]  
Register of Deeds

Book 359 Page 124

### Warranty Deed

Effective on this 8th day of December, 2023, Travis Coulter, a single person, "Grantor",  
**CONVEYS AND WARRANTS to:**

Harrison Krey, "Grantee" of 1760 Road 20, Rolla, KS 67954, all of the following-described real  
estate in Stevens County, Kansas:

**Surface rights only, including water rights, in and to the Southeast Quarter of  
the Southwest Quarter (SE/4 SW/4), the Northeast Quarter of the Southwest  
Quarter (NE/4 SW/4) and the Northwest Quarter of the Southwest Quarter  
(NW/4 SW/4) all in Section Twenty-seven (27), Township Thirty-three (33)  
South, Range Thirty-eight (38) West of the 6th P.M., Stevens County, Kansas;**

for the sum of Ten Dollars (\$10.00) cash in hand paid by Grantee to Grantor, and other good and  
valuable consideration, the receipt of which is hereby acknowledged; and,

SUBJECT TO: all covenants, restrictions and easements of record or apparent on the ground.

[Signature]  
Travis Coulter, Grantor

RECEIVED  
MAY 02 2024  
Garden City Field Office  
Division of Water Resources

STATE OF Kansas  
COUNTY OF Stevens

This instrument was acknowledged before me on this 7<sup>th</sup> day of December, 2023, by Travis  
Coulter, a single person.

[Signature]  
Notary Public  
My appointment expires: 04-05-27

