

Kansas Department of Agriculture
 Division of Water Resources
CHANGE: P/U WORKSHEET

1. File Number: 15368	2. Status Change Date: 9-3-2024	3. Change Num: C1	4. Field Office: 4	5. GMD: 3
6. Status: <input checked="" type="checkbox"/> Approved <input type="checkbox"/> Denied by DWR/GMD <input type="checkbox"/> Dismiss by Request/Failure to Return				7. Filing Date of Change: 2/29/2024
8a. Landowner New to system <input type="checkbox"/> Person ID <u>36178</u> Add Seq# _____ KMC AG LLC PO BOX 279 PLAINS, KS 67869-0279		8d. Landowner New to system <input type="checkbox"/> Person ID <u>69269</u> Add Seq# _____ KP LAND COMPANY LLC 263 RD 140 SATANTA, KS 67870		
8b. Landowner(s) New to system <input type="checkbox"/> Person ID <u>57020</u> Add Seq# _____ CLAWSON LAND PARTNERSHIP PO BOX 279 PLAINS, KS 67869		8e. Landowner New to system <input type="checkbox"/> Person ID <u>69328</u> Add Seq# _____ WILLIAM R WOOD II TRUST 1551 N WATERFRONT PARKWAY SUITE 100 WICHITA, KS 67206		
8c. Landowner New to system <input type="checkbox"/> Person ID <u>68431</u> Add Seq# _____ LANA M CLAWSON TRUST #1 146 ROAD 140 SATANTA, KS 67870-8400		8f. Correspondent New to system <input type="checkbox"/> Person ID <u>37451</u> Add Seq# _____ CLAWSON HASKELL CO #1 PO BOX 279 PLAINS, KS 67869-0279		
9. Documents and Enclosure(s): <input checked="" type="checkbox"/> DWR Meter(s) Date to Comply: <u>12/31/2024</u> <input type="checkbox"/> N & P Date to Comply: _____ <input type="checkbox"/> Anti-Reverse Meter <input type="checkbox"/> Meter Seal <input checked="" type="checkbox"/> Check Valve <input type="checkbox"/> N & P Form <input type="checkbox"/> Water Tube <input type="checkbox"/> Driller Copy <input type="checkbox"/> H & E Letter <input type="checkbox"/> Conservation Plan Date Required: _____ Date Approved: _____ Date to Comply: _____				
10. Use Made of Water From: _____ To: _____				
Date Prepared: 8/30/2024 By: MAM Date Entered: _____ By: _____				

File No. **15368** 11. County: HS Basin: CIMARRON RIVER Stream: Formation Code: Special Use:

12. Points of Diversion
 Rate and Quantity
 Authorized Additional
 Rate Quantity Rate Quantity
 gpm af gpm af Overlap PD Files

CHK	MOD	DEL	ENT	PDIV	Qualifier	S	T	R	ID	'N	'W	Comment (AKA Line)	Rate gpm	Quantity af	Rate gpm	Quantity af	Overlap PD Files
CHK 51044																	

13. Storage: Rate _____ NF Quantity _____ ac/ft Additional Rate _____ NF Additional Quantity _____ ac/ft

14. Limitation: _____ af/yr at _____ gpm (_____ cfs) when combined with file number(s) _____
 Limitation: _____ af/yr at _____ gpm (_____ cfs) when combined with file number(s) _____

15. 5YR Allocation: Allocation Type _____ Start Year _____ 5 YR Amount _____ Amount Unit _____ Base Acres _____ Comment _____

CHK	MOD	DEL	ENT	PUSE	S	T	R	ID	NE¼				NW¼				SW¼				SE¼				Total	Owner	Chg?	Overlap Files
									NE ¼	NW ¼	SW ¼	SE ¼	NE ¼	NW ¼	SW ¼	SE ¼	NE ¼	NW ¼	SW ¼	SE ¼	NE ¼	NW ¼	SW ¼	SE ¼				
CHK 33764	4	29	34W	1									40	40	40	40						160	8a	N	4886, 6255, 8582, 9235, 10030, 10581, 10986, 13191, 13795, 15369, 21946, 22820, 26849,			
MOD 2700	5	29	34W	1	L-1 40.01	L-2 40.02	40	40	L-3 35	L-4 30	30	40	40	40	40	35	40	40	40	40	620.03	8a	N	4886, 6255, 8582, 9235, 10030, 10581, 10986, 13191, 13795, 15369, 21946, 22820, 26849,				
DEL 33764																												
MOD 34199	6	29	34W	1	L-1 40.05	L-2 36	40	38	L-3 40.02	L-4 38.22	L-5 38.10	38.10	40	40	L-6 37.99	L-7 37.88	40	40	34	18.6	589.86	8a	N	4886, 6255, 8582, 9235, 10030, 10581, 10986, 13191, 13795, 15369, 21946, 22820, 26849,				
CHK 4207	7	29	34W	1	40	37	40	40									40	40	40	40	317	8a	N	4886, 6255, 8582, 9235, 10030, 10581, 10986, 13191, 13795, 15369, 21946, 22820, 26849,				

Base Acres: Year: Minimum Reasonable Quantity:
 Comments:

Garden City Field Office
4532 W. Jones, Suite B
Garden City, KS 67846



Phone: 620-276-2901
Fax: 620-276-9315
www.agriculture.ks.gov

Mike Beam, Secretary

Laura Kelly, Governor

September 3, 2024

KENBY CLAWSON
146 ROAD 140
SATANTA KS 67870-8400

RE: Field Office Application for Change
Water Right, File Nos. 4886, 6255, 8582, 9235, 10030, 10581, 10986, 13191,
13795, 15368, 15369, 21946, 22820, 26849

Dear Sir:

Enclosed are orders executed by the designee of the Chief Engineer, Division of Water Resources, Kansas Department of Agriculture, approving the applications for change under the above referenced file numbers.

Your attention is directed to the enclosures and to the terms, conditions, and limitations specified in these approvals for change. A condition of this approval is that an acceptable water flow meter must be installed on the diversion works authorized under the referenced file number and meet current specifications. Please return the required notification of completion of the diversion works and installation of the required meter as soon as these actions are completed.

Since the orders modify the original documents referred to above, they should be recorded with the Register of Deeds as other instruments affecting real estate.

Should you have any questions, please feel free contact this office. If you would prefer, you could arrange an appointment for additional assistance.

Sincerely,

A handwritten signature in blue ink that reads "Michael A. Meyer".

Michael A. Meyer
Water Commissioner

MAM:
Enclosures

pc: KMC AG LLC
LANA M CLAWSON TRUST #1
CLAWSON LAND PARTNERSHIP
CLAWSON HASKELL CO #1
KP LAND COMPANY LLC
WILLIAM R WOOD II TRUST
GMD3

CERTIFICATE OF SERVICE

On this 4th day of September 2024, I hereby certify that the foregoing Approvals of Application for Change in Place of use, Water Right, File Nos. 4886, 6255, 8582, 9235, 10030, 10581, 10986, 13191, 13795, 15368, 15369, 21946, 22820,26849 dated 3rd day of September 2024 was mailed postage prepaid, first class, US mail to the following:

KENBY CLAWSON
146 ROAD 140
SATANTA KS 67870-8400

Pc:

KMC AG LLC
PO BOX 279
PLAINS, KS 67869-0279

LANA M CLAWSON TRUST #1
146 ROAD 140
SATANTA, KS 67870-8400

CLAWSON LAND PARTNERSHIP
PO BOX 279
PLAINS, KS 67869

CLAWSON HASKELL CO #1
PO BOX 279
PLAINS, KS 67869-0279

KP LAND COMPANY LLC
263 RD 140
SATANTA, KS 67870

WILLIAM R WOOD II TRUST
1551 N WATERFRONT PARKWAY SUITE 100
WICHITA, KS 67206

GMD3

A handwritten signature in blue ink that reads "Aaron Holsted". The signature is written over a solid horizontal line.

Division of Water Resources Staff

Submit completed application to:
 Kansas Department of Agriculture
 Division of Water Resources
 Field Office for your area.

Call for address:

Topeka -- (785) 296-5733
 Stafford -- (620) 234-5311
 Stockton -- (785) 425-6787
 Garden City -- (620) 276-2901
<http://agriculture.ks.gov/dwr>

DWR FIELD OFFICE APPLICATION FOR APPROVAL TO CHANGE THE PLACE OF USE AND/OR THE POINT OF DIVERSION



STATE OF KANSAS

Filing Fee Must Accompany the Application, K.S.A. 82a-708b(b), as amended.
 Fee Schedule is on the third page of this application form.

Paragraph Nos. 1, 2, 3 & 5 must be completed. Complete all other applicable portions. If change in point of diversion is greater than 100 feet, or if place of use will be changed, include a topographic map or detailed plat showing the authorized and proposed point(s) of diversion and/or place of use.

File No. 15368

RECEIVED
 10:22 am
 FEB 08 2024

Garden City Field Office
 Division of Water Resources

1. Application is hereby made for approval of the Chief Engineer to change the (check one or both):

Place of Use Point of Diversion

under the water right which is the subject of this application in accordance with the conditions described below.

The source of supply is: Groundwater Surface water

2. Name and address of Applicant: Kenby Clawson
146 Road 140, Satanta, KS 67870

Phone Number: () Email address: _____

Name and address of Water Use Correspondent: Clawson Haskell Co #1

PO Box 279, Plains, KS 67869

Phone Number: () Email address: _____

3. The presently authorized place of use is:
 Owner of Land ---- NAME: _____
 ADDRESS: _____

(If there is more than one landowner, attach supplemental sheets as necessary.)

Sec.	Twp.	Range	NE¼				NW¼				SW¼				SE¼				TOTAL ACRES		
			NE¼	NW¼	SW¼	SE¼	NE¼	NW¼	SW¼	SE¼	NE¼	NW¼	SW¼	SE¼	NE¼	NW¼	SW¼	SE¼			

4. If this application is for a change in place of use, it is proposed that the place of use be changed to:
 Owner of Land ---- NAME: _____
 ADDRESS: _____

(If there is more than one landowner, attach supplemental sheets as necessary.)

Sec.	Twp.	Range	NE¼				NW¼				SW¼				SE¼				TOTAL ACRES			
			NE¼	NW¼	SW¼	SE¼	NE¼	NW¼	SW¼	SE¼	NE¼	NW¼	SW¼	SE¼	NE¼	NW¼	SW¼	SE¼				

For Office Use Only: Code _____ Fee \$ 200.00 TR # _____ Receipt Date 2-8-24 Check # 1314

APPLICATION FOR APPROVAL TO CHANGE
 THE PLACE OF USE AND/OR POINT OF DIVERSION
 SUPPLEMENTAL SHEET
FILE NO. 15368

MAKE ADDITIONAL COPIES AS NECESSARY

3. *Continued:* The presently authorized place of use is:

Owner of Land ---- NAME: KMC Ag LLC
 ADDRESS: PO Box 279, Plains, KS 67869

Sec.	Twp.	Range	NE¼				NW¼				SW¼				SE¼				TOTAL ACRES
			NE¼	NW¼	SW¼	SE¼	NE¼	NW¼	SW¼	SE¼	NE¼	NW¼	SW¼	SE¼	NE¼	NW¼	SW¼	SE¼	
4	29	34W									40	40	40	40					160
5	29	34W	L-1 40.01	L-2 40.02	40	40	L-3 35	L-4 30	40	40	40	40	35	40	40	40	40	620.03	
6	29	34W	L-1 40.05	L-2 36	40	38	L-3 40.02	L-4 38.22	L-5 38.10	40	40	L-6 37.99	L-7 37.88	40	40	40	34	38	618.26

Owner of Land ---- NAME: KMC Ag LLC
 ADDRESS: PO Box 279, Plains, KS 67869

Sec.	Twp.	Range	NE¼				NW¼				SW¼				SE¼				TOTAL ACRES
			NE¼	NW¼	SW¼	SE¼	NE¼	NW¼	SW¼	SE¼	NE¼	NW¼	SW¼	SE¼	NE¼	NW¼	SW¼	SE¼	
7	29	34W	40	37	40	40									40	40	40	40	317
9	29	34W	40	40	40	40					40	40	40	40	40	40	40	40	480

Owner of Land ---- NAME: KMC Ag LLC
 ADDRESS: PO Box 279, Plains, KS 67869

Sec.	Twp.	Range	NE¼				NW¼				SW¼				SE¼				TOTAL ACRES
			NE¼	NW¼	SW¼	SE¼	NE¼	NW¼	SW¼	SE¼	NE¼	NW¼	SW¼	SE¼	NE¼	NW¼	SW¼	SE¼	
12	29	35W	40	40	40	40	40	40	40	40	40	40	35	40	40	40	40	635	
14	29	35W	30.75	30.75	30.75	30.75									30.75	30.75	30.75	30.75	246

4. *Continued:* If this application is for a change in place of use, it is proposed that the place of use be changed to:

Owner of Land ---- NAME: KMC Ag LLC
 ADDRESS: PO Box 279, Plains, KS 67869

Sec.	Twp.	Range	NE¼				NW¼				SW¼				SE¼				TOTAL ACRES
			NE¼	NW¼	SW¼	SE¼	NE¼	NW¼	SW¼	SE¼	NE¼	NW¼	SW¼	SE¼	NE¼	NW¼	SW¼	SE¼	
4	29	34W									40	40	40	40					160
5	29	34W	L-1 40.01	L-2 40.02	40	40	L-3 35	L-4 30	40	40	40	40	35	40	40	40	40	620.03	
6	29	34W	L-1 40.05	L-2 36	40	38	L-3 40.02	L-4 38.22	L-5 38.10	40	40	L-6 37.99	L-7 37.88	40	40	40	34	18.6	589.86

Owner of Land ---- NAME: KMC Ag LLC
 ADDRESS: PO Box 279, Plains, KS 67869

Sec.	Twp.	Range	NE¼				NW¼				SW¼				SE¼				TOTAL ACRES
			NE¼	NW¼	SW¼	SE¼	NE¼	NW¼	SW¼	SE¼	NE¼	NW¼	SW¼	SE¼	NE¼	NW¼	SW¼	SE¼	
7	9	34W	40	37	40	40									40	40	40	40	317
9	29	34W	40	40	40	40					40	40	40	40	40	40	40	40	480

Owner of Land ---- NAME: KMC Ag LLC
 ADDRESS: PO Box 279, Plains, KS 67869

Sec.	Twp.	Range	NE¼				NW¼				SW¼				SE¼				TOTAL ACRES
			NE¼	NW¼	SW¼	SE¼	NE¼	NW¼	SW¼	SE¼	NE¼	NW¼	SW¼	SE¼	NE¼	NW¼	SW¼	SE¼	
12	29	35W	40	40	40	40	40	40	40	40	40	40	35	40	40	40	40	635	
14	29	35W	30.75	30.75	30.75	30.75									30.75	30.75	30.75	30.75	246

5. **Presently authorized point of diversion:**
 One in the _____ Quarter of the _____ Quarter of the _____ Quarter
 of Section _____, Township _____ South, Range _____ (W),
 in _____ County, Kansas, _____ feet North _____ feet West of Southeast corner of section.
 Authorized Rate _____ Authorized Quantity _____ Depth of well _____ (feet)
(DWR use only: Computer ID No. _____ GPS _____ feet North _____ feet West)
 This point will not be changed This point will be changed as follows: No change, point better described with GPS as follows:
Proposed point of diversion: (Complete only if change is requested or if existing point is better described by GPS)
 One in the _____ Quarter of the _____ Quarter of the _____ Quarter
 of Section _____, Township _____ South, Range _____ (W),
 in _____ County, Kansas, _____ feet North _____ feet West of Southeast corner of section.
 Proposed Rate _____ Proposed Quantity _____ Proposed well depth (feet) _____
 This point is: Additional Well Geo Center List other water rights that will use this point _____

6. **Presently authorized point of diversion:**
 One in the _____ Quarter of the _____ Quarter of the _____ Quarter
 of Section _____, Township _____ South, Range _____ (W),
 in _____ County, Kansas, _____ feet North _____ feet West of Southeast corner of section.
 Authorized Rate _____ Authorized Quantity _____ Depth of well _____ (feet)
(DWR use only: Computer ID No. _____ GPS _____ feet North _____ feet West)
 This point will not be changed This point will be changed as follows: No change, point better described with GPS as follows:
Proposed point of diversion: (Complete only if change is requested or if existing point is better described by GPS)
 One in the _____ Quarter of the _____ Quarter of the _____ Quarter
 of Section _____, Township _____ South, Range _____ (W),
 in _____ County, Kansas, _____ feet North _____ feet West of Southeast corner of section.
 Proposed Rate _____ Proposed Quantity _____ Proposed well depth (feet) _____
 This point is: Additional Well Geo Center List other water rights that will use this point _____

7. The changes herein are desired for the following reasons?
 (please be specific) _____

8. If a well, is the test hole log attached? Yes No

9. The change(s) (was)(will be) completed by?

10. If the point of diversion is a well:
 (a) What are you going to do with the old well?

 (b) When will this be done? _____

11. Groundwater Management District recommendation attached?
 Yes No

12. Assisted by CI, GCFO

13a. If the proposed point of diversion will be relocated more than 300 feet but within 2,640 feet of the existing point of diversion, attach a topographic map or aerial photograph. For groundwater sources, show all wells (including domestic) within one-half mile of the proposed point of diversion and the names and mailing addresses of the owners. For surface water sources, show the names and addresses of the landowner(s) one-half mile downstream and one-half mile upstream from your property lines

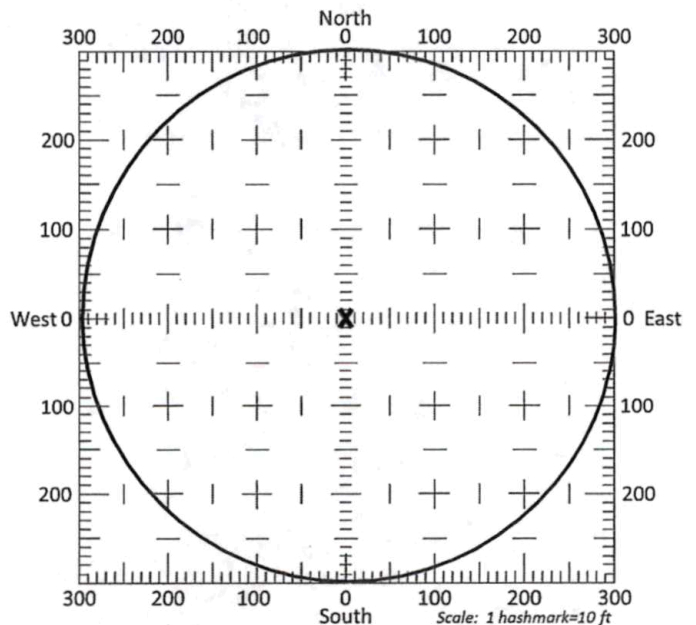

13b. If the proposed point of diversion will be relocated within a 300 foot radius of the existing point of diversion, indicate its location on the diagram shown above in relation to the existing point of diversion. The proposed point of diversion must be located within the circle shown above. (PLEASE NOTE: The "X" in center of diagram above represents the presently authorized point of diversion.)

APPLICATION FOR APPROVAL TO CHANGE
THE PLACE OF USE AND/OR POINT OF DIVERSION
SUPPLEMENTAL SHEET
FILE NO. 15368
MAKE ADDITIONAL COPIES AS NECESSARY

3. *Continued:* The presently authorized place of use is:

Owner of Land ---- NAME: _____
ADDRESS: _____

Sec.	Twp.	Range	NE¼				NW¼				SW¼				SE¼				TOTAL ACRES		
			NE¼	NW¼	SW¼	SE¼	NE¼	NW¼	SW¼	SE¼	NE¼	NW¼	SW¼	SE¼	NE¼	NW¼	SW¼	SE¼			

Owner of Land ---- NAME: _____
ADDRESS: _____

Sec.	Twp.	Range	NE¼				NW¼				SW¼				SE¼				TOTAL ACRES			
			NE¼	NW¼	SW¼	SE¼	NE¼	NW¼	SW¼	SE¼	NE¼	NW¼	SW¼	SE¼	NE¼	NW¼	SW¼	SE¼				

Owner of Land ---- NAME: _____
ADDRESS: _____

Sec.	Twp.	Range	NE¼				NW¼				SW¼				SE¼				TOTAL ACRES				
			NE¼	NW¼	SW¼	SE¼	NE¼	NW¼	SW¼	SE¼	NE¼	NW¼	SW¼	SE¼	NE¼	NW¼	SW¼	SE¼					

4. *Continued:* If this application is for a change in place of use, it is proposed that the place of use be changed to:

Owner of Land ---- NAME: LANA M CLAWSON TRUST #1
ADDRESS: 146 ROAD 140, SATANTA, KS 67870-8400

Sec.	Twp.	Range	NE¼				NW¼				SW¼				SE¼				TOTAL ACRES
			NE¼	NW¼	SW¼	SE¼	NE¼	NW¼	SW¼	SE¼	NE¼	NW¼	SW¼	SE¼	NE¼	NW¼	SW¼	SE¼	
8	29	34W													20	40	20		80
6	29	34W																19.4	19.4

Owner of Land ---- NAME: _____
ADDRESS: _____

Sec.	Twp.	Range	NE¼				NW¼				SW¼				SE¼				TOTAL ACRES				
			NE¼	NW¼	SW¼	SE¼	NE¼	NW¼	SW¼	SE¼	NE¼	NW¼	SW¼	SE¼	NE¼	NW¼	SW¼	SE¼					

Owner of Land ---- NAME: _____
ADDRESS: _____

Sec.	Twp.	Range	NE¼				NW¼				SW¼				SE¼				TOTAL ACRES					
			NE¼	NW¼	SW¼	SE¼	NE¼	NW¼	SW¼	SE¼	NE¼	NW¼	SW¼	SE¼	NE¼	NW¼	SW¼	SE¼						

APPLICATION FOR APPROVAL TO CHANGE
 THE PLACE OF USE AND/OR POINT OF DIVERSION
 SUPPLEMENTAL SHEET
FILE NO. 15368

MAKE ADDITIONAL COPIES AS NECESSARY

3. *Continued:* The presently authorized place of use is:

Owner of Land ---- NAME: KP Land Company LLC
 ADDRESS: 263 Road 140, Satanta, KS 67860

Sec.	Twp.	Range	NE¼				NW¼				SW¼				SE¼				TOTAL ACRES
			NE¼	NW¼	SW¼	SE¼	NE¼	NW¼	SW¼	SE¼	NE¼	NW¼	SW¼	SE¼	NE¼	NW¼	SW¼	SE¼	
8	29	34W	40	30	40	40	35	40	40	40	38	40	40	40					463
7	29	34W					40	37.83	37.86	40									155.69

Owner of Land ---- NAME: William R Wood II Trust (12/04/1997 AND 01/20/2005)

Steven J. Wood Trust (12/04/1997 AND 01/20/2005)
 ADDRESS: 1551 N Waterfront Parkway, Suite 100, Wichita, KS 67206

Sec.	Twp.	Range	NE¼				NW¼				SW¼				SE¼				TOTAL ACRES
			NE¼	NW¼	SW¼	SE¼	NE¼	NW¼	SW¼	SE¼	NE¼	NW¼	SW¼	SE¼	NE¼	NW¼	SW¼	SE¼	
9	29	34W					40	40	35	40									155

Owner of Land ---- NAME: Clawson Land Partnership
 ADDRESS: PO Box 279, Plains, KS 67869

Sec.	Twp.	Range	NE¼				NW¼				SW¼				SE¼				TOTAL ACRES
			NE¼	NW¼	SW¼	SE¼	NE¼	NW¼	SW¼	SE¼	NE¼	NW¼	SW¼	SE¼	NE¼	NW¼	SW¼	SE¼	
3	29	34W									31	40	31	31					133

5. *Continued:* If this application is for a change in place of use, it is proposed that the place of use be changed to:

Owner of Land ---- NAME: KP Land Company LLC
 ADDRESS: 263 Road 140, Satanta, KS 67860

Sec.	Twp.	Range	NE¼				NW¼				SW¼				SE¼				TOTAL ACRES
			NE¼	NW¼	SW¼	SE¼	NE¼	NW¼	SW¼	SE¼	NE¼	NW¼	SW¼	SE¼	NE¼	NW¼	SW¼	SE¼	
8	29	34W		15	40	15	35	40	40	40	38	40	40	40	20	40	20		463 383
7	29	34W					40	37.83	37.86	40									155.69

Owner of Land ---- NAME: William R Wood II Trust (12/04/1997 AND 01/20/2005)

Steven J. Wood Trust (12/04/1997 AND 01/20/2005)
 ADDRESS: 1551 N Waterfront Parkway, Suite 100, Wichita, KS 67206

Sec.	Twp.	Range	NE¼				NW¼				SW¼				SE¼				TOTAL ACRES
			NE¼	NW¼	SW¼	SE¼	NE¼	NW¼	SW¼	SE¼	NE¼	NW¼	SW¼	SE¼	NE¼	NW¼	SW¼	SE¼	
9	29	34W					40	40	35	40									155

Owner of Land ---- NAME: Clawson Land Partnership
 ADDRESS: PO Box 279, Plains, KS 67869

Sec.	Twp.	Range	NE¼				NW¼				SW¼				SE¼				TOTAL ACRES
			NE¼	NW¼	SW¼	SE¼	NE¼	NW¼	SW¼	SE¼	NE¼	NW¼	SW¼	SE¼	NE¼	NW¼	SW¼	SE¼	
3	29	34W									31	40	31	31					133

14. If the proposed groundwater point of diversion is 300 or fewer feet from the existing point of diversion, complete the following:
- (a) Does the undersigned represent all owners of the currently authorized place(s) of use identified in this application?
 Yes No (If no, all owners must sign this application.)
 - (b) Will the ownership interest of any owner of the currently authorized place(s) of use identified in this application be adversely affected if this application is approved as requested?
 Yes No (If yes, all owners must sign this application.)
 - (c) If this application is not approved expeditiously, will there be substantial damage to property, public health or safety?
 Yes No (If no, all owners must sign this application.)

If the application proposes a surface water change in point of diversion, a groundwater change in point of diversion greater than 300 feet, or a change in place of use, the application must be signed by all owners of the currently authorized place of use, or their duly authorized agent (attach notarized statement authorizing representation).

I hereby verify, being first duly sworn upon my oath or affirmation and under penalty of perjury, that I am of lawful age and the owner, the spouse of the owner, or a duly authorized agent of the owner(s) to make this application on their behalf, in regards to the water right(s) to which this application pertains. I further verify that the statements contained in this application are true, correct and complete.

Dated at Garden City, Kansas, this 13th day of December, 2023.

<u>David Clawson for Clawson Land Partnership</u>	
(Owner)	(Spouse)
<u>David Clawson</u>	
(Please Print)	(Please Print)
<u>David Clawson for RMC #2 LLC</u>	
(Owner)	(Spouse)
<u>David Clawson</u>	
(Please Print)	(Please Print)
(Owner)	(Spouse)
(Please Print)	(Please Print)

State of Kansas }
 County of Linney } SS

I hereby certify that the foregoing application was signed in my presence and sworn to before me this 13th day of December, 2023.



Aaron Holsted
 Notary Public

My Commission Expires _____

ONLY COMPLETE APPLICATIONS WILL BE PROCESSED. To be complete, all of the applicable portions of the application form must be completed with accurate information; maps, if necessary, must be included; signatures of all the appropriate owners' must be affixed to the application and notarized; and the appropriate fee must be paid.

FEE SCHEDULE

Each application to change the place of use or the point of diversion under this section shall be accompanied by the application fee set forth in the schedule below: Make checks payable to: **Kansas Department of Agriculture**

(1) Application to change a point of diversion 300 feet or less	\$100
(2) Application to change a point of diversion more than 300 feet	\$200
(3) Application to change the place of use	\$200

14. If the proposed groundwater point of diversion is 300 or fewer feet from the existing point of diversion, complete the following:
- (a) Does the undersigned represent all owners of the currently authorized place(s) of use identified in this application?
 Yes No (If no, all owners must sign this application.)
 - (b) Will the ownership interest of any owner of the currently authorized place(s) of use identified in this application be adversely affected if this application is approved as requested?
 Yes No (If yes, all owners must sign this application.)
 - (c) If this application is not approved expeditiously, will there be substantial damage to property, public health or safety?
 Yes No (If no, all owners must sign this application.)

If the application proposes a surface water change in point of diversion, a groundwater change in point of diversion greater than 300 feet, or a change in place of use, the application must be signed by all owners of the currently authorized place of use, or their duly authorized agent (attach notarized statement authorizing representation).

I hereby verify, being first duly sworn upon my oath or affirmation and under penalty of perjury, that I am of lawful age and the owner, the spouse of the owner, or a duly authorized agent of the owner(s) to make this application on their behalf, in regards to the water right(s) to which this application pertains. I further verify that the statements contained in this application are true, correct and complete.

Dated at Garden City, Kansas, this 8th day of February, 2024.

<u>Lana M. Clawson</u>	
(Owner)	(Spouse)
<u>Lana M. Clawson</u>	
(Please Print)	(Please Print)
<u>R. Clu</u>	
(Owner)	(Spouse)
<u>Paige Clawson PDA KPLand Co LLC</u>	
(Please Print)	(Please Print)
(Owner)	(Spouse)
(Please Print)	(Please Print)

State of Kansas }
 County of Finney } SS

I hereby certify that the foregoing application was signed in my presence and sworn to before me this 8th day of February, 2024.



Aaron Holsted
Notary Public

My Commission Expires _____

ONLY COMPLETE APPLICATIONS WILL BE PROCESSED. To be complete, all of the applicable portions of the application form must be completed with accurate information; maps, if necessary, must be included; signatures of all the appropriate owners' must be affixed to the application and notarized; and the appropriate fee must be paid.

FEE SCHEDULE

Each application to change the place of use or the point of diversion under this section shall be accompanied by the application fee set forth in the schedule below: Make checks payable to: **Kansas Department of Agriculture**

- (1) Application to change a point of diversion 300 feet or less \$100
- (2) Application to change a point of diversion more than 300 feet \$200
- (3) Application to change the place of use \$200

RECEIVED

AUG 06 2024

Garden City Field Office
Division of Water Resources

14. If the proposed groundwater point of diversion is 300 or fewer feet from the existing point of diversion, complete the following:
- (a) Does the undersigned represent all owners of the currently authorized place(s) of use identified in this application?
 Yes No (If no, all owners must sign this application.)
 - (b) Will the ownership interest of any owner of the currently authorized place(s) of use identified in this application be adversely affected if this application is approved as requested?
 Yes No (If yes, all owners must sign this application.)
 - (c) If this application is not approved expeditiously, will there be substantial damage to property, public health or safety?
 Yes No (If no, all owners must sign this application.)

If the application proposes a surface water change in point of diversion, a groundwater change in point of diversion greater than 300 feet, or a change in place of use, the application must be signed by all owners of the currently authorized place of use, or their duly authorized agent (attach notarized statement authorizing representation).

I hereby verify, being first duly sworn upon my oath or affirmation and under penalty of perjury, that I am of lawful age and the owner, the spouse of the owner, or a duly authorized agent of the owner(s) to make this application on their behalf, in regards to the water right(s) to which this application pertains. I further verify that the statements contained in this application are true, correct and complete.

Dated at Wichita, Kansas, this 23rd day of July, 20 24.

<p><u><i>WR Wood</i></u> (Owner)</p> <p><u>William R. Wood, II Trust u/a/d 12/04/1997</u> (Please Print)</p> <p><u><i>WR Wood</i></u> (Owner)</p> <p><u>William R. Wood, II Trust u/a/d 01/20/2005</u> (Please Print)</p> <p>_____ (Owner)</p> <p>_____ (Please Print)</p>	<p>_____ (Spouse)</p> <p>_____ (Please Print)</p> <p>_____ (Spouse)</p> <p>_____ (Please Print)</p> <p>_____ (Spouse)</p> <p>_____ (Please Print)</p>
--	---

State of Kansas }
County of Sedgwick } SS



I hereby certify that the foregoing application was signed in my presence and sworn to before me this 23rd day of July, 20 24.

Kathi S Dalke
Notary Public

My Commission Expires 04/08/2026

ONLY COMPLETE APPLICATIONS WILL BE PROCESSED. To be complete, all of the applicable portions of the application form must be completed with accurate information; maps, if necessary, must be included; signatures of all the appropriate owners' must be affixed to the application and notarized; and the appropriate fee must be paid.

FEE SCHEDULE

Each application to change the place of use or the point of diversion under this section shall be accompanied by the application fee set forth in the schedule below: Make checks payable to: **Kansas Department of Agriculture**

- (1) Application to change a point of diversion 300 feet or less \$100
- (2) Application to change a point of diversion more than 300 feet \$200
- (3) Application to change the place of use \$200

RECEIVED
AUG 06 2024

Application being adversely
Division of Water Resources

14. If the proposed groundwater point of diversion is 300 or fewer feet from the existing point of diversion, complete the following:

- (a) Does the undersigned represent all owners of the currently authorized place(s) of use identified in this application?
 Yes No (If no, all owners must sign this application.)
- (b) Will the ownership interest of any owner of the currently authorized place(s) of use identified in this application be adversely affected if this application is approved as requested?
 Yes No (If yes, all owners must sign this application.)
- (c) If this application is not approved expeditiously, will there be substantial damage to property, public health or safety?
 Yes No (If no, all owners must sign this application.)

If the application proposes a surface water change in point of diversion, a groundwater change in point of diversion greater than 300 feet, or a change in place of use, the application must be signed by all owners of the currently authorized place of use, or their duly authorized agent (attach notarized statement authorizing representation).

I hereby verify, being first duly sworn upon my oath or affirmation and under penalty of perjury, that I am of lawful age and the owner, the spouse of the owner, or a duly authorized agent of the owner(s) to make this application on their behalf, in regards to the water right(s) to which this application pertains. I further verify that the statements contained in this application are true, correct and complete.

Dated at Stuart, Florida, ~~Kansas~~, this 30 day of July, 2024.

_____	(Owner)	_____	(Spouse)
<u>Steven J. Wood Trust u/a/d 12/04/1997</u>	(Please Print)	_____	(Please Print)
<u>Steven J. Wood, trustee</u>	(Owner)	_____	(Spouse)
<u>Steven J. Wood Trust u/a/d 01/20/2005</u>	(Please Print)	_____	(Please Print)
_____	(Owner)	_____	(Spouse)
_____	(Please Print)	_____	(Please Print)

State of Florida }
County of Martin } SS

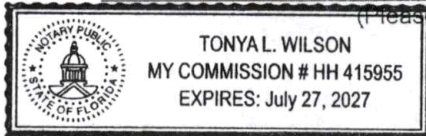

I hereby certify that the foregoing application was signed in my presence and sworn to before me this 30 day of July, 2024.

Tonya L. Wilson
Notary Public

My Commission Expires 7/27/2027

ONLY COMPLETE APPLICATIONS WILL BE PROCESSED. To be complete, all of the applicable portions of the application form must be completed with accurate information; maps, if necessary, must be included; signatures of all the appropriate owners' must be affixed to the application and notarized; and the appropriate fee must be paid.

FEE SCHEDULE

Each application to change the place of use or the point of diversion under this section shall be accompanied by the application fee set forth in the schedule below: Make checks payable to: **Kansas Department of Agriculture**

- (1) Application to change a point of diversion 300 feet or less \$100
- (2) Application to change a point of diversion more than 300 feet \$200
- (3) Application to change the place of use \$200

WRs 4886, 6255, 8582, 9235, 10030, 10581, 10986,
13191, 13795, 15368, 15369, 21946, 22820, 26849
Change in Place of Use

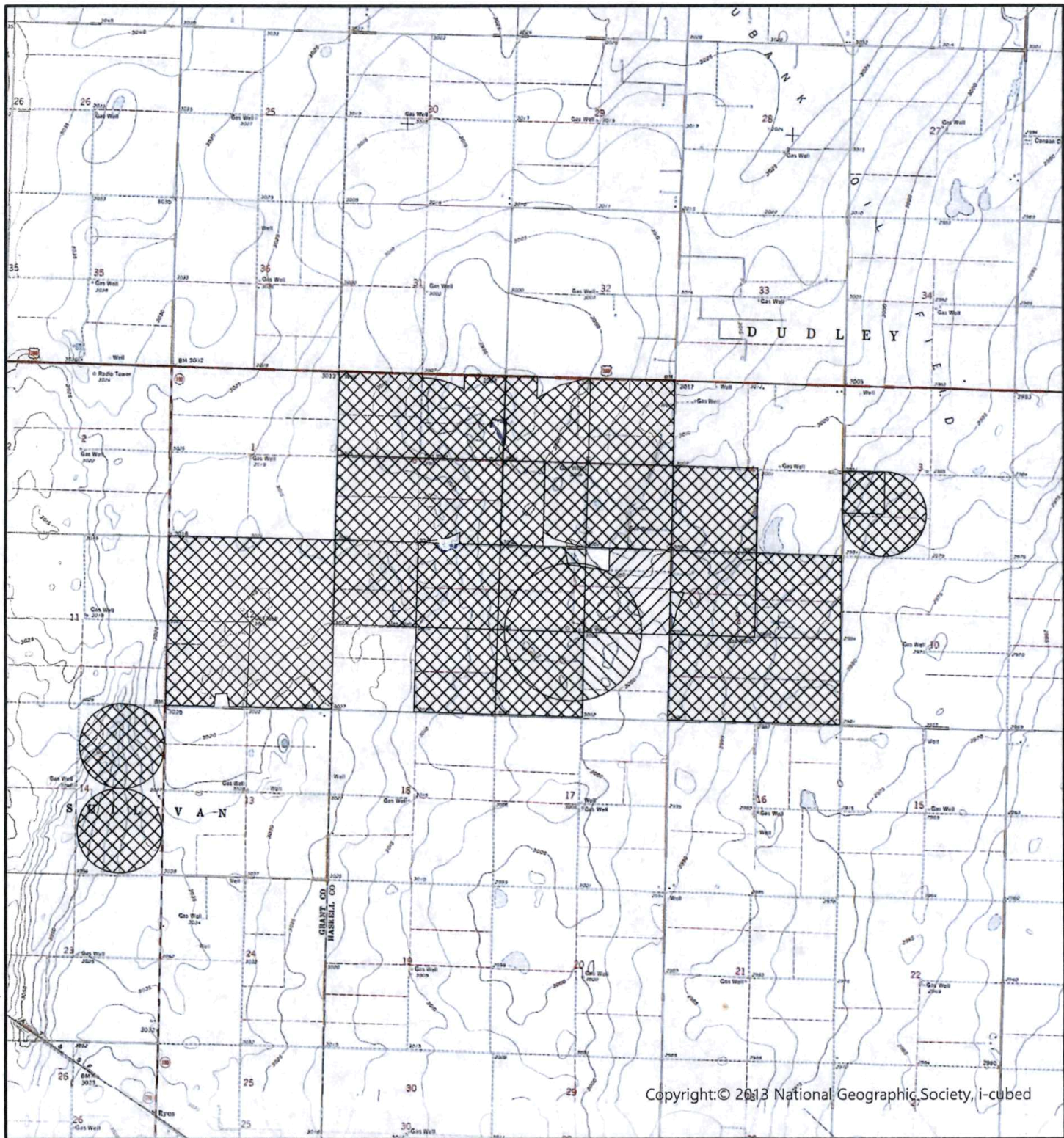

Copyright: © 2013 National Geographic Society, i-cubed

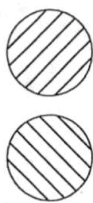

Authorized Place of Use

Proposed Place of Use

● Existing Well



Created By: CI/GCFO

SUMMARY ORDER APPROVING APPLICATION FOR CHANGE AND IMPOSING CONDITIONS

This Summary Order is issued under authority of K.S.A. 82a-708b, as amended, and K.A.R. 5-5-1, *et seq.* and other applicable provisions of the *Kansas Water Appropriation Law, K.S.A. 82a-701 et seq.*, and rules and regulations promulgated thereunder, With the exception of those conditions expressly contained herein, this Summary Order does not change the terms, conditions and limitations of File No. 15368.

1. A change application was received on February 2, 2024 requesting that the place of use and / or point of diversion authorized under the above-referenced file number be changed as described in the application.
2. On and after the effective date of this summary order, the authorized place(s) of use shall be located substantially as shown on the topographic map accompanying the application to change the place of use. Applicable Not Applicable
3. The change in point of diversion shall not impair existing rights and shall be limited to the same source or sources of water as previously authorized. The point of diversion authorized by this summary order shall be located within a _____ foot radius of the authorized point(s) of diversion. Applicable Not Applicable
4. The point(s) of diversion described herein is administratively corrected to be more accurately described using the Global Positioning System (GPS), as described in the application. Applicable Not Applicable
5. The point(s) of diversion authorized herein shall not actually be located more than _____ feet from the previously authorized point(s) of diversion. Applicable Not Applicable
6. As required by K.A.R. 5-3-5d, if the works for diversion is a well with a diversion rate of 100 gallons per minute or more, a tube or other device suitable for making water level measurements shall be installed, operated and maintained in accordance with K.A.R. 5-6-13. Applicable Not Applicable
7. **The owner of the authorized place(s) of use shall properly install an acceptable water flow meter on or before December 31, 2024**, or before the first use of water, whichever occurs first. The water flow meter shall be installed, operated and maintained in accordance with K.A.R. 5-1-4 through 5-1-12. As required by K.S.A. 82a-732, as amended, and K.A.R. 5-3-5e, the owner shall maintain records and report the reading of the water flow meter and the total quantity of water diverted annually to the Chief Engineer by March 1 following the end of each calendar year. Applicable Not Applicable
8. **Installation of the works for diversion of water shall be completed on or before December 31, 2024**, or within any authorized extension of time. By March 1, 2024 the applicant shall notify the Chief Engineer that construction of the works for diversion has been completed, on the form provided by the Chief Engineer, as required by K.A.R. 5-8-4e. Applicable Not Applicable
9. **The completed well log shall be submitted with the required notice.** Applicable Not Applicable
10. All diversion works into which any type of chemical or other foreign substance will be injected into the water shall be equipped with an in-line, automatic, quick-closing check valve capable of preventing pollution of the source of the water supply. The check valve(s) shall be installed, operated and maintained in accordance with K.A.R. 5-3-5c. Applicable Not Applicable
11. Additional Conditions are attached. Yes No
12. In accordance with K.S.A. 82a-708a, as amended, and K.A.R. 5-5-14, all of the owners of the authorized place(s) of use of water appropriated under the above-referenced file number are responsible for compliance with its terms, conditions and limitations, as amended and/or supplemented by this Summary Order, and with applicable provisions of the *Kansas Water Appropriation Law* and the *Rules and Regulations* promulgated thereunder. Failure to comply with these provisions may result in civil penalties pursuant to K.S.A. 82a-737, as amended, and/or the suspension or revocation and dismissal of the water or appropriation right or any other enforcement actions authorized by law.

Administrative Appeal and Effective Date of Order

If you are aggrieved by this order, pursuant to K.S.A. 82a-1901, you may request an evidentiary hearing before the Chief Engineer or request administrative review by the Secretary of Agriculture. A request for hearing by the Chief Engineer must be filed within **15 days** of service of this Order and a request for administrative review by the Secretary must be filed within **30 days** pursuant to K.S.A. 77-531. Any request for administrative review must state a basis for review pursuant to K.S.A. 77-527. File any request with **Kansas Department of Agriculture, Legal Division, 1320 Research Park Drive, Manhattan, KS 66502**. Failure to timely request a hearing or review may preclude review under the Kansas Judicial Review Act.

For Use by Register of Deeds

FOR OFFICE USE ONLY
**APPLICATION APPROVED AND
 SUMMARY ORDER ISSUED**

By: Michael A. Meyer
 Duly Authorized Designee of the Chief Engineer

(Print Name): MICHAEL A. MEYER
 Division of Water Resources - Kansas Department of Agriculture

Date of Issuance: September 3, 2024

State of Kansas)

County of Finney) SS

Acknowledged before me on September 3, 2024

by Michael A Meyer

Signature: Aaron Holsted

My commission expires: _____

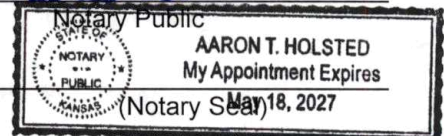

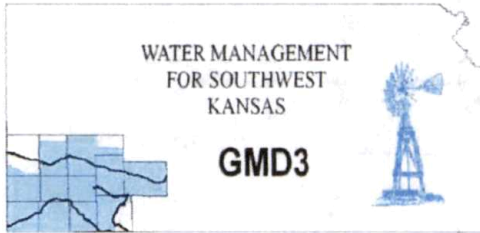

Southwest Kansas
Groundwater Management District No. 3
2009 E. Spruce Street
Garden City, Kansas 67846
(620) 275-7147 phone
www.gmd3.org

August 1, 2024

Michael A. Meyer
Division of Water Resources
4532 W Jones Ave., Suite B
Garden City, Kansas 67846

RE: Applications for Change in Place of Use
Water Right, File Nos. 4886, 6255, 8582, 9235, 10030, 10581, 10986, 13191, 13795,
15368, 15369, 21369, 22820 & 26849

Dear Mike:

We have completed a review of the applications for the above referenced water rights. The proposals are not in conflict with the Management Program of the Southwest Kansas Groundwater Management District No. 3 (GMD3). The proposed change in place of use will maintain a complete overlap in authorized place of use while rearranging 80 acres within the operation, in accordance with K.A.R. 5-5-11. Proposed acres are within the combined base acres for the water rights. It is therefore recommended that the applications be approved at this time.

Thank you for the opportunity to review the applications and to provide a recommendation. If you have any questions, please don't hesitate to contact us.

Sincerely,

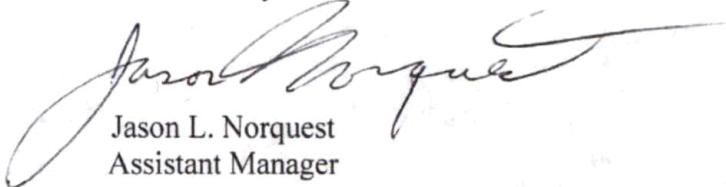

Jason L. Norquest
Assistant Manager

RECEIVED
AUG 14 2024
Garden City Field Office
Division of Water Resources

GMD3 Change Review

File No(s): 4886, 6255, 8582, 9235, 10030, 10581, 10986, 13191, 13795, 15368, 15369, 21369, 22820, 26849. DWR office: GC.

App filed to change: PU.

Is Landowner(s) correct in WRIS: Kenby Clawson.

If NO, is documentation included?

Regulation(s) Reviewed: KAR 5-5-11

Point of diversion ID No(s) being changed.

	ft. North	ft. West	
Authorized PD			
Proposed PD			
Difference	0	0	
$a^2 + b^2 = c^2$	0	0	0

GPS for proposed PD: Lat: Long: .

Is proposed PD stacking on existing WRs? No changes.

Is Proposed PU overlapping existing WRs? Keep current complete overlap, rearranging acres to match current farming operation.

Neighboring certified well(s) notified: .

Name .

Address .

Zip .

Email: Phone: .

Domestic well(s) notified: .

Name .

Address .

Zip .

Base Acres: 3982.98 combined (all currently authorized acres).

Perfected Acres: .

Irr. Return-Flow %

Haskell County

Current combined acres = 3982.98.

Rearranging the acres in 8-29-34. Taking from the NE and moving the 80 acres into the SE. This will allow a current pivot to make a complete circle

Proposed combined acres = 3982.98

Is a waiver needed: Rearranging acres staying at their combined base acres, no waiver needed.

Recommendation: After review of available information, it appears current area rules are met. Staff recommends approval of the applications.



Garden City Field Office
4532 W. Jones, Suite B
Garden City, KS 67846



Phone: 620-276-2901
Fax: 620-276-9315
www.agriculture.ks.gov

Mike Beam, Secretary

Laura Kelly, Governor

July 31, 2024

SOUTHWEST KANSAS GROUNDWATER
MANAGEMENT DISTRICT NO. 3
2009 E SPRUCE ST
GARDEN CITY KS 67846

Re: Request for Recommendation
Water Right, File Nos. 4886, 6255, 8582, 9235, 10030, 10581, 10986, 13191,
13795, 15368, 15369, 21946, 22820, 26849

Dear Mr. Norquest:

This is to advise you that Kenby Clawson has filed applications for approval of the Chief Engineer, Division of Water Resources, Kansas Department of Agriculture, to change the place of use.

We are delaying action on the change applications to allow you time to review and provide a recommendation. Please submit a recommendation within 15 days from the date of this letter.

Thank you and as always feel free to contact this office at any time.

Sincerely,

A handwritten signature in blue ink, appearing to read "Michael A. Meyer".

Michael A. Meyer
Water Commissioner

MAM
Enclosures

FOULSTON

ATTORNEYS AT LAW

William R. Wood, II

bwood@foulston.com
Phone: 316.291.9772
Fax: 316.267.6345

1551 N. WATERFRONT PARKWAY, SUITE 100
WICHITA, KS 67206-4466

July 23, 2024

Paige Clawson
146 Road 140
Satanta, KS 67870

Re: DWR Application for Approval – KLC Farms

Dear Paige:

Enclosed are 14 original executed signature pages for the DWR application.

Sincerely,

FOULSTON SIEFKIN LLP

William R. Wood, II

WRW/kd
Enclosures

RECEIVED

AUG 06 2024

Garden City Field Office
Divison of Water Resources

LexMundi
Member

GGi
INDEPENDENT MEMBER

July 30, 2024

Via Federal Express

Tracking No.: 7776 8526 1437

Paige A. Clawson

146 Road 140

Satanta, Kansas 67870

**RE: Steven J. Wood Trust u/a/d 12/04/1997
Steven J. Wood Trust u/a/d 01/20/2005
Form DWR 1-121**

Ms. Clawson,

Enclosed please find the following:

1. Fourteen (14) signatures pages executed by Steven J. Wood as Trustee of The Steven J. Wood Trust u/a/d 12/04/1997; and
2. Fourteen (14) signatures pages executed by Steven J. Wood as Trustee of The Steven J. Wood Trust u/a/d 01/20/2005.

Thank you for your assistance in this matter.

Best regards,



Tonya L. Wilson, ACP, FCP, FRP
Advanced Certified Paralegal

Tlw@McCarthySummers.com

/tlc

Enclosures

Cc: Steven J. Wood, Trustee

Terence P. McCarthy *
Robert P. Summers *
Steven J. Wood **
Kenneth A. Norman
Nicola J. Boone Melby ***
Owen Schultz
Margaret E. Wood
Jessica M. VanValkenburgh
Christen Spake
Kimberly A. Ryan
Loren N. Esposito
Ross C. Alagna

**Board Certified
Real Estate Lawyer*

***Board Certified Wills,
Trusts & Estates Lawyer*

****Board Certified
Elder Law Lawyer*

RECEIVED

AUG 06 2024

Garden City Field Office
Division of Water Resources