

File No. 26383	13. County: KE Basin: ARKANSAS RIVER Stream:		
Structures File No:	Aquifer Code: 211 / 331	Special Use Area:	

14. Points of Diversion, Rates & Quantities										Qty AF		Rate gpm		Storage Qty		Storage Rate	
PDIV	Qualifier	S	T	R	ID	'N	'W	Comment (AKA Line)		Auth	Add	Auth	Add	Auth	Add	Auth/Add	Overlaps
DEL	53742																
ENT	NW NW NE	4	25S	35W		5004	2064			272	272	825	825				
CHK	86708 NC NW	4	25S	35W	06	3996	3913			272	272	845	845				

15. Limitations	Type:	Quantity:	Rate:	combined with file no(s):
	Type:	Quantity:	Rate:	combined with file no(s):

16. Metering Metering Required Anti-Reverse Required Seal Required Compliance Date: 12/31/2025

17. Place of Use																		Total	Owner(s)	Chg?	Overlaps			
PUSE	S	T	R	ID	NE¼				NW¼				SW¼				SE¼							
					NE	NW	SW	SE	NE	NW	SW	SE	NE	NW	SW	SE	NE	NW	SW	SE				
CHK	17167																							<input type="checkbox"/>
																								<input type="checkbox"/>
																								<input type="checkbox"/>
																								<input type="checkbox"/>
																								<input type="checkbox"/>

18. Point of Diversion and Place of Use Overlaps	
* + # ^	** ++ ## ^^

Garden City Field Office
4532 W. Jones, Suite B
Garden City, KS 67846



Phone: 620-276-2901
Fax: 620-276-9315
www.agriculture.ks.gov

Mike Beam, Secretary

Laura Kelly, Governor

November 22, 2024

HENRY J & GRACE K DYCK
2143 ROAD 130
LAKIN, KS 67860

RE: Filed Office Application for Change
Water Right, File No. 26383

Dear Sir or Madam:

Enclosed is the order executed by the designee of the Chief Engineer, Division of Water Resources, Kansas Department of Agriculture, approving the application for change under the above referenced file number.

Your attention is directed to the enclosures and to the terms, conditions, and limitations specified in this approval for change. A condition of this approval is that an acceptable water flow meter must be installed on the diversion works authorized under the referenced file number and meet current specifications. Please return the required notification of completion of the diversion works and installation of the required meter as soon as these actions are completed.

Since the order modifies the original document referred to above, it should be recorded with the Register of Deeds as other instruments affecting real estate.

The abandoned well must be plugged in accordance with the requirements of Article 30 of the Rules and Regulations as adopted by the Kansas Department of Health and Environment.

Should you have any questions, please feel free contact this office. If you would prefer, you could arrange an appointment for additional assistance.

Sincerely,

A handwritten signature in blue ink that reads "Austin J. McColloch".

Austin J. McColloch
Assistant Water Commissioner

AM:
enclosures

pc: GMD 3

CERTIFICATE OF SERVICE

On this 22nd day of November, 2024, I hereby certify that the foregoing Approval of Application for Change in Point of Diversion, Water Right, File No. 26,383 dated 22nd day of November, 2024 was mailed postage prepaid, first class, US mail to the following:

HENRY J & GRACE K DYCK
2143 ROAD 130
LAKIN, KS 67860

Pc:

GMD 3

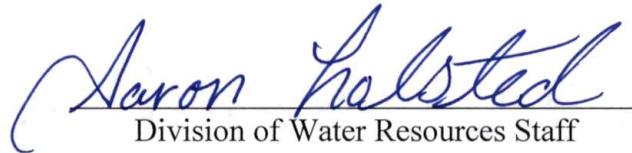
Division of Water Resources Staff

Submit completed application to:
 Kansas Department of Agriculture
 Division of Water Resources
 Field Office for your area.

Call for address:

Topeka -- (785) 296-5733
 Stafford -- (620) 234-5311
 Stockton -- (785) 425-6787
 Garden City -- (620) 276-2901
<http://agriculture.ks.gov/dwr>

DWR FIELD OFFICE APPLICATION FOR APPROVAL TO CHANGE THE PLACE OF USE AND/OR THE POINT OF DIVERSION



STATE OF KANSAS

Filing Fee Must Accompany the Application, K.S.A. 82a-708b(b), as amended.
 Fee Schedule is on the third page of this application form.

Paragraph Nos. 1, 2, 3 & 5 must be completed. Complete all other applicable portions. If change in point of diversion is greater than 100 feet, or if place of use will be changed, include a topographic map or detailed plat showing the authorized and proposed point(s) of diversion and/or place of use.

File No. 26383-00

RECEIVED
 9:30 AM
 OCT 18 2024

1. Application is hereby made for approval of the Chief Engineer to change the (check one or both):

Place of Use Point of Diversion

under the water right which is the subject of this application in accordance with the conditions described below

The source of supply is: Groundwater Surface water

2. Name and address of Applicant: Henry J & Grace K Dyck

2143 Road 130, Lakin, KS 67860

Phone Number: (620) 290-1576 Email address: _____

Name and address of Water Use Correspondent: Same as Above

Same as Above

Phone Number: () _____ Email address: _____

3. The presently authorized place of use is:

Owner of Land ---- NAME: _____

ADDRESS: _____

(If there is more than one landowner, attach supplemental sheets as necessary.)

Sec.	Twp.	Range	NE¼				NW¼				SW¼				SE¼				TOTAL ACRES
			NE¼	NW¼	SW¼	SE¼	NE¼	NW¼	SW¼	SE¼	NE¼	NW¼	SW¼	SE¼	NE¼	NW¼	SW¼	SE¼	

4. If this application is for a change in place of use, it is proposed that the place of use be changed to:

Owner of Land ---- NAME: _____

ADDRESS: _____

(If there is more than one landowner, attach supplemental sheets as necessary.)

Sec.	Twp.	Range	NE¼				NW¼				SW¼				SE¼				TOTAL ACRES
			NE¼	NW¼	SW¼	SE¼	NE¼	NW¼	SW¼	SE¼	NE¼	NW¼	SW¼	SE¼	NE¼	NW¼	SW¼	SE¼	

For Office Use Only: Code C6T Fee \$ 200.00 TR # _____ Receipt Date 10-18-24 Check # 1204

5. **Presently authorized point of diversion:**
 One in the SE Quarter of the SE Quarter of the NW Quarter of Section 4, Township 25 South, Range 35 W, in Kearny County, Kansas, 2667 feet North 3023 feet West of Southeast corner of section.
 Authorized Rate _____ Authorized Quantity _____ Depth of well _____ (feet)
 (DWR use only: Computer ID No. 103 GPS _____ feet North _____ feet West)
 This point will not be changed This point will be changed as follows: No change, point better described with GPS as follows:
Proposed point of diversion: (Complete only if change is requested or if existing point is better described by GPS)
 One in the NW Quarter of the NW Quarter of the NE Quarter of Section 4, Township 25 South, Range 35 W, in Kearny County, Kansas, 5004 feet North 2064 feet West of Southeast corner of section.
 Proposed Rate _____ Proposed Quantity _____ Proposed well depth (feet) 620'
 This point is: Additional Well Geo Center List other water rights that will use this point _____

6. **Presently authorized point of diversion:**
 One in the _____ Quarter of the NC Quarter of the NW Quarter of Section 4, Township 25 South, Range 35 W, in Kearny County, Kansas, 3996 feet North 3913 feet West of Southeast corner of section.
 Authorized Rate _____ Authorized Quantity _____ Depth of well _____ (feet)
 (DWR use only: Computer ID No. 06 GPS _____ feet North _____ feet West)
 This point will not be changed This point will be changed as follows: No change, point better described with GPS as follows:
Proposed point of diversion: (Complete only if change is requested or if existing point is better described by GPS)
 One in the _____ Quarter of the _____ Quarter of the _____ Quarter of Section _____, Township _____ South, Range _____ W, in _____ County, Kansas, _____ feet North _____ feet West of Southeast corner of section.
 Proposed Rate _____ Proposed Quantity _____ Proposed well depth (feet) _____
 This point is: Additional Well Geo Center List other water rights that will use this point _____

7. The changes herein are desired for the following reasons?
 (please be specific) _____

8. If a well, is the test hole log attached? Yes No

9. The change(s) (was)(will be) completed by?

10. If the point of diversion is a well:
 (a) What are you going to do with the old well?
Plug / Cap
 (b) When will this be done? _____

11. Groundwater Management District recommendation attached?
 Yes No

12. Assisted by JG/GCFO

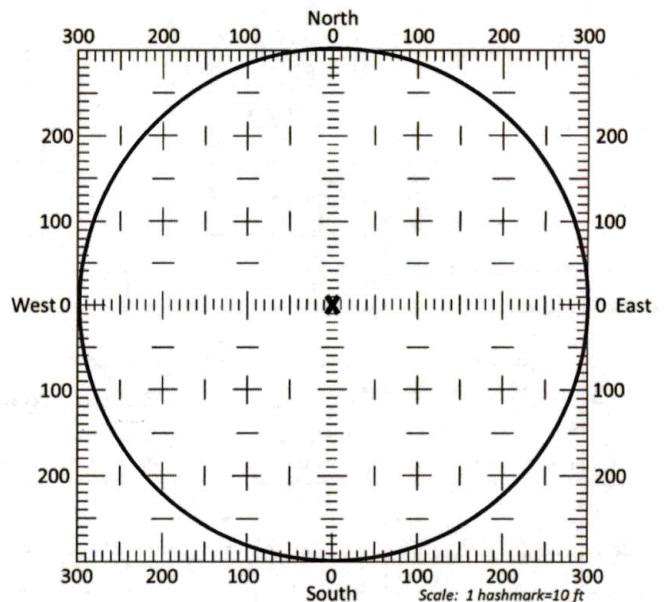

13a. If the proposed point of diversion will be relocated more than 300 feet but within 2,640 feet of the existing point of diversion, attach a topographic map or aerial photograph. For groundwater sources, show all wells (including domestic) within one-half mile of the proposed point of diversion and the names and mailing addresses of the owners. For surface water sources, show the names and addresses of the landowner(s) one-half mile downstream and one-half mile upstream from your property lines

13b. If the proposed point of diversion will be relocated within a 300 foot radius of the existing point of diversion, indicate its location on the diagram shown above in relation to the existing point of diversion. The proposed point of diversion must be located within the circle shown above. (PLEASE NOTE: The "X" in center of diagram above represents the presently authorized point of diversion.)

14. If the proposed groundwater point of diversion is 300 or fewer feet from the existing point of diversion, complete the following:

- (a) Does the undersigned represent all owners of the currently authorized place(s) of use identified in this application?
 Yes No (If no, all owners must sign this application.)
- (b) Will the ownership interest of any owner of the currently authorized place(s) of use identified in this application be adversely affected if this application is approved as requested?
 Yes No (If yes, all owners must sign this application.)
- (c) If this application is not approved expeditiously, will there be substantial damage to property, public health or safety?
 Yes No (If no, all owners must sign this application.)

If the application proposes a surface water change in point of diversion, a groundwater change in point of diversion greater than 300 feet, or a change in place of use, the application must be signed by all owners of the currently authorized place of use, or their duly authorized agent (attach notarized statement authorizing representation).

I hereby verify, being first duly sworn upon my oath or affirmation and under penalty of perjury, that I am of lawful age and the owner, the spouse of the owner, or a duly authorized agent of the owner(s) to make this application on their behalf, in regards to the water right(s) to which this application pertains. I further verify that the statements contained in this application are true, correct and complete.

Dated at GARDEN CITY, Kansas, this 18TH day of OCTOBER, 2024.

Henry Dyck
 (Owner)

Grace Dyck
 (Spouse)

HENRY DYCK
 (Please Print)

Grace Dyck
 (Please Print)

 (Owner)

 (Spouse)

 (Please Print)

 (Please Print)

 (Owner)

 (Spouse)

 (Please Print)

 (Please Print)

State of Kansas
 County of FINNEY } SS

I hereby certify that the foregoing application was signed in my presence and sworn to before me this 18TH day of OCT, 2024.

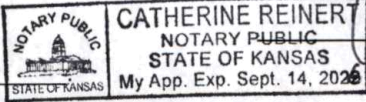
My Commission Expires 9-14-26

Catherine Reiner
 Notary Public

ONLY COMPLETE APPLICATIONS WILL BE PROCESSED. To be complete, all of the applicable portions of the application form must be completed with accurate information; maps, if necessary, must be included; signatures of all the appropriate owners' must be affixed to the application and notarized; and the appropriate fee must be paid.

FEE SCHEDULE

Each application to change the place of use or the point of diversion under this section shall be accompanied by the application fee set forth in the schedule below. Make checks payable to: Kansas Department of Agriculture

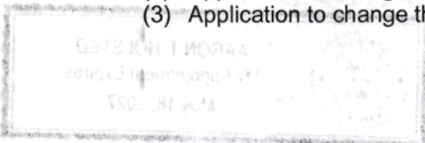
- (1) Application to change a point of diversion 300 feet or less \$100
- (2) Application to change a point of diversion more than 300 feet \$200
- (3) Application to change the place of use \$200



SUMMARY ORDER APPROVING APPLICATION FOR CHANGE AND IMPOSING CONDITIONS

This Summary Order is issued under authority of K.S.A. 82a-708b, as amended, and K.A.R. 5-5-1, *et seq.* and other applicable provisions of the *Kansas Water Appropriation Law, K.S.A. 82a-701 et seq.*, and rules and regulations promulgated thereunder. With the exception of those conditions expressly contained herein, this Summary Order does not change the terms, conditions and limitations of File No. 26383.

1. A change application was received on October 18, 2024 requesting that the place of use and / or point of diversion authorized under the above-referenced file number be changed as described in the application.
2. On and after the effective date of this summary order, the authorized place(s) of use shall be located substantially as shown on the topographic map accompanying the application to change the place of use. Applicable Not Applicable
3. The change in point of diversion shall not impair existing rights and shall be limited to the same source or sources of water as previously authorized. The point of diversion authorized by this summary order shall be located within a 300 foot radius of the authorized point(s) of diversion. Applicable Not Applicable
4. The point(s) of diversion described herein is administratively corrected to be more accurately described using the Global Positioning System (GPS), as described in the application. Applicable Not Applicable
5. The point(s) of diversion authorized herein shall not actually be located more than 2640 feet from the previously authorized point(s) of diversion. Applicable Not Applicable
6. As required by K.A.R. 5-3-5d, if the works for diversion is a well with a diversion rate of 100 gallons per minute or more, a tube or other device suitable for making water level measurements shall be installed, operated and maintained in accordance with K.A.R. 5-6-13. Applicable Not Applicable
7. **The owner of the authorized place(s) of use shall properly install an acceptable water flow meter on or before December 31, 2025**, or before the first use of water, whichever occurs first. The water flow meter shall be installed, operated and maintained in accordance with K.A.R. 5-1-4 through 5-1-12. As required by K.S.A. 82a-732, as amended, and K.A.R. 5-3-5e, the owner shall maintain records and report the reading of the water flow meter and the total quantity of water diverted annually to the Chief Engineer by March 1 following the end of each calendar year. Applicable Not Applicable
8. **Installation of the works for diversion of water shall be completed on or before December 31, 2025**, or within any authorized extension of time. By March 1, 2026 the applicant shall notify the Chief Engineer that construction of the works for diversion has been completed, on the form provided by the Chief Engineer, as required by K.A.R. 5-8-4e. Applicable Not Applicable
9. **The completed well log shall be submitted with the required notice.** Applicable Not Applicable
10. All diversion works into which any type of chemical or other foreign substance will be injected into the water shall be equipped with an in-line, automatic, quick-closing check valve capable of preventing pollution of the source of the water supply. The check valve(s) shall be installed, operated and maintained in accordance with K.A.R. 5-3-5c. Applicable Not Applicable
11. Additional Conditions are attached. Yes No
12. In accordance with K.S.A. 82a-708a, as amended, and K.A.R. 5-5-14, all of the owners of the authorized place(s) of use of water appropriated under the above-referenced file number are responsible for compliance with its terms, conditions and limitations, as amended and/or supplemented by this Summary Order, and with applicable provisions of the *Kansas Water Appropriation Law* and the *Rules and Regulations* promulgated thereunder. Failure to comply with these provisions may result in civil penalties pursuant to K.S.A. 82a-737, as amended, and/or the suspension or revocation and dismissal of the water or appropriation right or any other enforcement actions authorized by law.

Administrative Appeal and Effective Date of Order

If you are aggrieved by this order, pursuant to K.S.A. 82a-1901, you may request an evidentiary hearing before the Chief Engineer or request administrative review by the Secretary of Agriculture. A request for hearing by the Chief Engineer must be filed within **15 days** of service of this Order and a request for administrative review by the Secretary must be filed within **30 days** pursuant to K.S.A. 77-531. Any request for administrative review must state a basis for review pursuant to K.S.A. 77-527. File any request with **Kansas Department of Agriculture, Legal Division, 1320 Research Park Drive, Manhattan, KS 66502**. Failure to timely request a hearing or review may preclude review under the Kansas Judicial Review Act.

For Use by Register of Deeds

FOR OFFICE USE ONLY
**APPLICATION APPROVED AND
 SUMMARY ORDER ISSUED**

By: Austin McColloch
 Duly Authorized Designee of the Chief Engineer
 (Print Name): Austin McColloch
 Division of Water Resources - Kansas Department of Agriculture
 Date of Issuance: November 22, 2024
 State of Kansas)
 County of Linney) SS
 Acknowledged before me on November 22, 2024
 by Austin McColloch
 Signature: Aaron Holsted

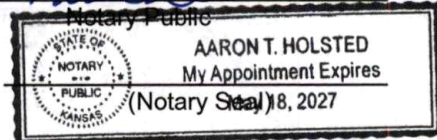

My commission expires:

CHANGE IN PLACE OF DIVERSION WATER RIGHT, FILE NO. 26383

NW 1/4 of Section 4 Township 25 South Range 35 West Kearny County

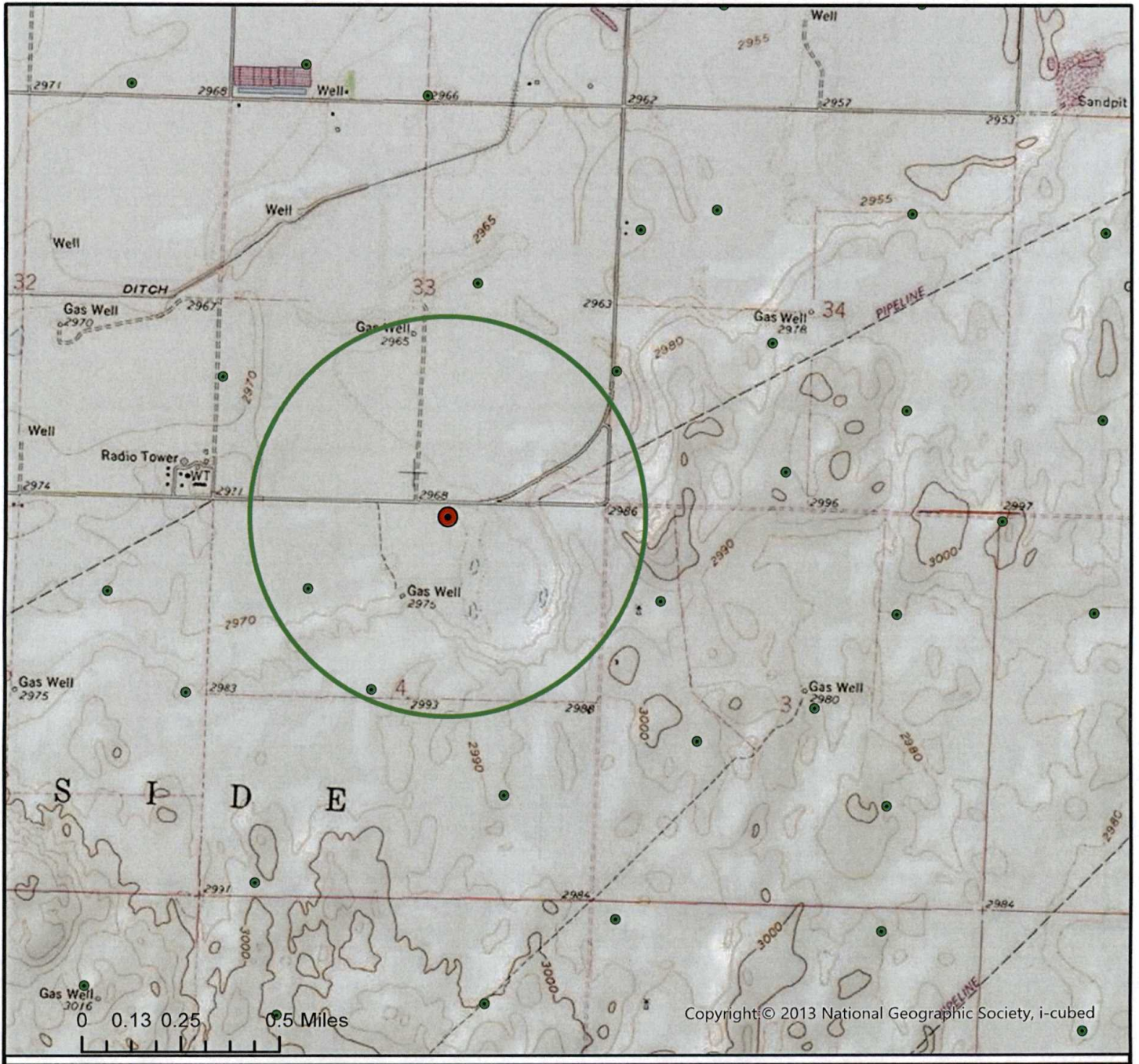

	Authorized Point of Diversion
	Proposed Point of Diversion
	Domestic Well within 1/2 mile
	1/2 mile buffer

List of owner name and addresses within 1/2 mile:



All wells of any kind within 1/2 mile of the requested place of use have been plotted.

(Signature)

Date

3795 W. Jones Ave.
 Garden City, KS 67846
 PH: 620-277-2389



PO Box 639
 Garden City, KS 67846
 Fax: 620-277-0224

HENRY DYCK 620-290-1576

Customer Name: Henry Dyck WO#: 27630 Date: 10-15-24
 Street Address: 2143 ROAN 130 Test #: 3 E LOG: Yes
 City, State: LAKIN, KS. 67860 Driller: Dale Guinn
 County: Kearny Quarter: NE Section: 4 Township: 25 Range: 35
 Location: GPS: N37.91507 W101.16539
 Rig #: 10002 Elevation: 2954' Static WL: 170ft Estimated? Yes
 Proposed Well Depth 651

Need Surface Casing REPLACEMENT WELL LOCATION 20' SUMP

%	Footage		To	Description of Strata	26383
	From	Pay			
	0		2	Top Soil	
	2		32	Sand Fine Med Course Small Med Large Gravel	
	32		40	Sand Fine Med Course w/Few Thin clay strips	
	40		64	Brown Sandy Clay	
	64		79	Blue Clay	
	79		94	Sand Fine w/Many clay Layers	
	94		105	Sand Fine Med Course	
	105		121	Brown + Blue Clay	
	121		134	Sand Fine	
	134		142	Sand Fine Med	
	142		160	Blue + Brown Clay w/Few Fine Sand Layers	
	160		193	Blue Clay w/couple Fine Sand Strips	
10	193	8	201	Sand Fine Med w/Many Brown clay Layers	
25	201	40	241	Sand Fine Med Course	
15	241	23	264	Sand Fine w/Some white Rock + couple Caliche Strips	
20	264	13	277	Sand Fine Med w/Some White Rock	
30	277	18	295	Sand Fine Med Course w/Tan + Some Brown Rock	
	295		299	Brown Sandy Clay	
10	299	10	309	Sand Fine Fin Med w/Few clay Strips	
10	309	25	334	Sandstone w/Few Soapstone w/Some Brown Rock	
	334		336	Black Shale	
20	336	6	342	Sandstone "Loose"	
	342		390	Soapstone w/couple sandstone Strips	
10	390	49	439	Sandstone	
5	439	61	500	Soapstone + Sandstone	
10	500	10	510	Sandstone	
	510		518	Shale	
10	518	93	611	Sandstone w/Few Soapstone Strips	
	611		620	Shale "Hard"	
				Super Gel X	-12
				Platinum Dris Pac Reg	-2
				Grout	-6
				Hole Plug	-6
				Perma Plug	-1
				5/4 Drag Blade	-1

Henry Dyck

TestHole # 3 of 10-15-24

NE 4-25-35 KE

Replacement well location

FILE # 26383

Legend

 37.91507 N 101.16539 W

Rd 130  37.91507 N 101.16539 W

Google Earth

3000 ft



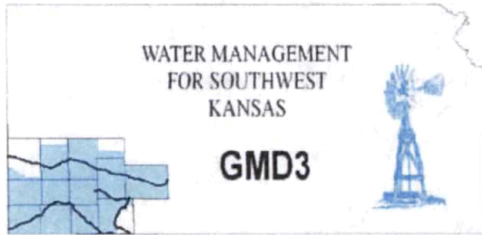

Southwest Kansas
Groundwater Management District No. 3
2009 E. Spruce Street
Garden City, Kansas 67846
(620) 275-7147 phone
www.gmd3.org

November 22, 2024

Austin McColloch
Division of Water Resources
4532 W Jones Ave., Suite B
Garden City, Kansas 67846

RECEIVED

NOV 22 2024

Garden City Field Office
Division of Water Resources

RE: Application for Change in Point of Diversion
Water Right, File No. 26383

Dear Austin:

We have completed a review of the application for the above referenced water right. The proposed change in point of diversion is in accordance with current area rules, K.A.R. 5-23-3, as it pertains to minimum spacing to neighboring wells and distance moved.

Well evaluations were conducted to estimate possible effects of the proposal on the supply of other wells with water rights prior to the proposal per K.S.A. 82a-708b, and the management program. Under K.S.A. 82a-708b, an applicant requesting a change in point of diversion must demonstrate to the chief engineer that any proposed change is reasonable and will not impair. The enclosed report is an analysis performed by the GMD on behalf of our membership. Under this analysis, the proposed change is considered to be reasonable and unlikely to impair if either the net in-season well-to-well effect of the proposed change is less than a strict maximum allowable threshold (3.5 ft with saturated thickness is between 150-200ft), or if no well with a net well-to-well effect exceeding the threshold is identified as critical. Critical wells are identified as wells that are expected to either lose or greatly diminish water supply over the next 25 years. The attached review information is based on a Theis analysis using inputs from the GMD3 aquifer model, which is considered to be the best information on well and aquifer data readily and easily available to the public. If either the applicant or the neighbors believe they have better data that might change the result of the analysis, they should contact GMD3. Conclusions of the well analysis may change if better information on well and aquifer data can be made available.

Every neighboring well within 1 mile of the proposed move was evaluated. Evaluations showed that none of the neighboring wells exceeded the net effect above the maximum allowable threshold and needed no further evaluation. No critical wells were determined in the area. We did not receive any comments from neighboring well owners. Therefore, GMD3 sees this move as meeting current area rules and would recommend approval. If aquifer conditions change or there is a change to the water right in the future, we would be happy to evaluate the effects at that time.

Thank you for the opportunity to review the applications and to provide a recommendation. If you have any questions, please don't hesitate to contact us.

Sincerely,

Jason L. Norquest
Assistant Manager

GMD3 Change Review

File No(s): 26383. DWR office: GC.

App filed to change: PD.

Is Landowner(s) correct in WRIS: Henry & Grace Dyck.

If NO, is documentation included?

Is Water Use Correspondent correct in WRIS? .

If NO, is documentation included?

Regulation(s) Reviewed: KAR 5-23-3

Point of diversion ID No(s) 03 being changed.

	ft. North	ft. West	
Authorized PD	2667	3023	Sect 4-25-35
Proposed PD	5004	2064	
Difference	-2337 n	959 e	
a2 + b2 = c2	5461569	919681	2526.114 foot move NE

GPS for proposed PD: Lat: 37.91507 Long: -101.16539.

Is proposed PD stacking on existing WRs? No.

Is Proposed PU overlapping existing WRs? No Change.

Neighboring certified well(s) notified: .

Name Kyle & Geneva Koehn (14344D1).

Address 1205 Road Y.

Zip Lakin, KS 67860.

Email: kgkoehn88@gmail.com Phone: .

Name David K & Connie J Goertzen Trust (14344D2).

Address 1892 Road 105.

Zip Lakin, KS 67860

Email: dj4849@gmail.com Phone: .

Name Agland Partners LLC (15730.01, 20927).

Address PO Box 95.

Zip Boston, GA 31626.

Email: jaycestabel@gmail.com Phone: .

Name Vyn Land & Cattle (21528, KE81, 21611).

Address 1194 RD Y.

Zip Lakin, KS 67860.

Email: jacobhartland@gmail.com Phone: .

Domestic well(s) notified: .

Name .

Address .

GMD3 Change Review

Zip ____.

Base Acres: ____.

Perfected Acres: ____.

Irr. Return-Flow ____%

Kearny County

One of two wells

ID03 Authorized: 272AF @ 825gpm

2022 GMD3 inspection calculated 391gpm

Avg reported use (2014-2023): 256.47AF/year

Is a waiver needed: Move less than half mile. Appears spacing to neighboring wells is met. Analysis shows possible effects within guidelines, no critical wells.

Recommendation: After review of available information, it appears current area rules are met. Staff therefore recommends approval of the application.



Water Rights and Points of Diversion Within 1 mile of point defined as:

2667 Feet N and 3023 Feet W of the Southeast Corner of Section 4 Twp 25S Rng 35W
 Located at: 101.168715 West Longitude and 37.908651 North Latitude
 Both SURFACE WATER and GROUNDWATER

File Number	Use	ST	SR	Dist (ft)	Q4	Q3	Q2	Q1	FeetN	FeetW	Sec	Twp	Rng	ID	Batt	Auth_Quan	Add_Quan	
A__ AF	14344	D1	IRR	NK	G	2208	--	--	NC	SE	1360	1243	4	25	35W	7	256.00	256.00
Same AF						3005	--	SE	SW	SW	78	4547	4	25	35W	5	256.00	256.00
Same AF						4399	--	NE	SW	NE	3912	1351	9	25	35W	7	256.00	256.00
A__ AF	14344	D2	IRR	NK	G	4452	--	NE	SW	NW	3702	4107	9	25	35W	5	256.00	256.00
A__ AF	15730	01	STK	NK	G	4058	--	NE	SW	NW	3935	4438	3	25	35W	4	16.79	16.79
A__ AF	20927	00	IRR	NK	G	4422	--	NW	NE	SW	2097	3897	3	25	35W	6	272.00	272.00
A__ AF	21528	00	IRR	NK	G	4448	--	NW	NW	NW	5004	4854	10	25	35W	8	272.00	272.00
A__ AF	21611	00	IRR	NK	G	2488	--	SE	SE	NE	2651	239	5	25	35W	6	282.00	282.00
Same AF						3773	--	--	NC	NE	3960	1320	5	25	35W	1	267.00	267.00
A__ AF	26383	00	IRR	NK	G*	4	--	SE	SE	NW	2667	3023	4	25	35W	3	272.00	272.00
Same AF						1599	--	--	NC	NW	3996	3913	4	25	35W	6	272.00	272.00
VKE AF	81	00	IRR	AA	G	4620	--	SW	NW	SW	1506	5194	33	24	35W	1	320.00	320.00

Total Net Quantities Authorized:	Direct	Storage
Total Requested Amount (AF) =	.00	.00
Total Permitted Amount (AF) =	.00	.00
Total Inspected Amount (AF) =	.00	.00
Total Pro_Cert Amount (AF) =	.00	.00
Total Certified Amount (AF) =	2677.79	.00
Total Vested Amount (AF) =	320.00	.00
TOTAL AMOUNT (AF) =	2997.79	.00

An * after the source of supply indicates a pending application for change under the file number.
 An * after the ID indicates a 15 AF exemption was granted under the file number.
 A "G" in the Batt column indicates the GEO CTR of a battery. A "B" indicates a well in the battery.
 The number in the Batt column is the number of wells in the battery.

Water Rights and Points of Diversion Within 1 mile of point defined as:

2667 Feet North and 3023 Feet West of the Southeast Corner of Section 4 Twp 25S Rng 35W
 Located at: 101.168715 West Longitude and 37.908651 North Latitude
 Both SURFACE WATER and GROUNDWATER
 WATER USE CORRESPONDENTS:

- > KYLE & GENEVA KOEHN 1434401
- > 1205 ROAD Y
- > LAKIN KS 67860
- > -----
- > DAVID K & CONNIE J GOERTZEN TRUST
- > 1892 ROAD 105 1434402
- > LAKIN KS 67860

>-----

> AGLAND PARTNERS LLC

> PO BOX 95
> BOSTON GA 31626

15730.01

>-----

> AGLAND PARTNERS LLC

> PO BOX 95
> BOSTON GA 31626

20927

>-----

> VYN LAND & CATTLE

> 1194 RD Y
> LAKIN KS 67860

21528

>-----

> HARTLAND FARMS

> 1194 RD Y
> LAKIN KS 67860

21611

>-----

> HENRY J & GRACE K DYCK

> 2143 ROAD 130
> LAKIN KS 67860

26383 Application

>-----

> VYN LAND & CATTLE

> 1194 RD Y
> LAKIN KS 67860

1281

>-----

=====

Evaluation of proposed move for Water Right No. 26383 ID3

Proposed: Move water right no. 26383 ID3 a distance of 2,525 ft to the northeast to a new location.

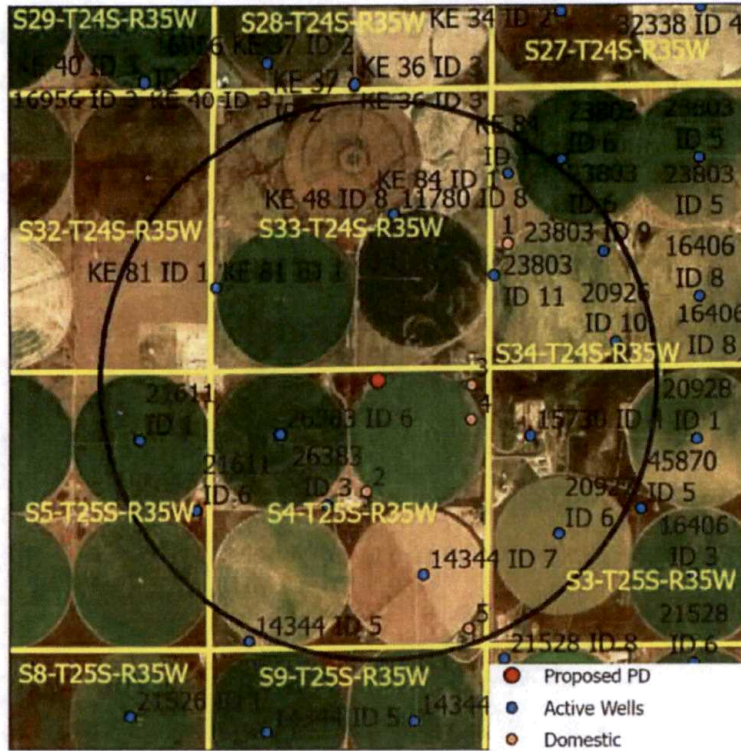

Wells within 1 mile: 81, 48 & 11780, 84, 23803 ID11, 23803 ID9, 20926, 21611 ID1, 21611 ID6, 26383 ID6, 14344, 15730, 20927, and five domestic wells.

The saturated thickness at the proposed well location is estimated to be 193.2 ft, based upon the GMD3 model. For saturated thickness between 150 and 200 ft, the drawdown allowance is 3.5 ft.

50 year Theis Analysis: The following values were used to run the analysis:

$S = 0.05$, $T = 2,337.68 \text{ ft}^2/\text{day}$, $tp_{\text{current}} = 149 \text{ days}$ (based on average use and observed rate),

$Q_{\text{current}} = 391 \text{ gpm}$ (based on 2022 field inspection), $tp_{\text{proposed}} = 75 \text{ days}$, $Q_{\text{proposed}} = 825 \text{ gpm}$

Theis drawdowns were calculated as follows:

- | | |
|-------------|---|
| 81: | Drawdown from current location = 5.85 ft |
| | Drawdown from proposed location = 6.51 ft |
| | Net drawdown = 0.7 ft |
| 48 & 11780: | Drawdown from current location = 6.35 ft |
| | Drawdown from proposed location = 7.05 ft |
| | Net drawdown = 0.7 ft |

20927: Drawdown from current location = 5.14 ft
Drawdown from proposed location = 5.52 ft
Net drawdown = 0.4

Domestic 1: Drawdown from current location = 5.86 ft
Drawdown from proposed location = 6.51 ft
Net drawdown = **0.7 ft**

Domestic 2: Drawdown from current location = 7.96 ft
Drawdown from proposed location = 9.66 ft
Net drawdown = **1.7 ft**

Domestic 3: Drawdown from current location = 8.73 ft
Drawdown from proposed location = 10.85 ft
Net drawdown = **2.1 ft**

Domestic 4: Drawdown from current location = 8.37 ft
Drawdown from proposed location = 10.23 ft
Net drawdown = **1.9 ft**

Domestic 5: Drawdown from current location = 4.80 ft
Drawdown from proposed location = 5.17 ft
Net drawdown = **0.4 ft**

Net drawdown does not exceed the drawdown allowance of 3.5 ft for any well within 1 mile of the proposed location. Therefore, critical well analysis is not necessary.

Conclusion:

The proposed move is likely to create minimal effects on neighboring wells and appears unlikely to cause impairment. Any concerned neighbors should contact GMD3 at (620) 275-7147 or the Division of Water Resources at (620) 276-2901.

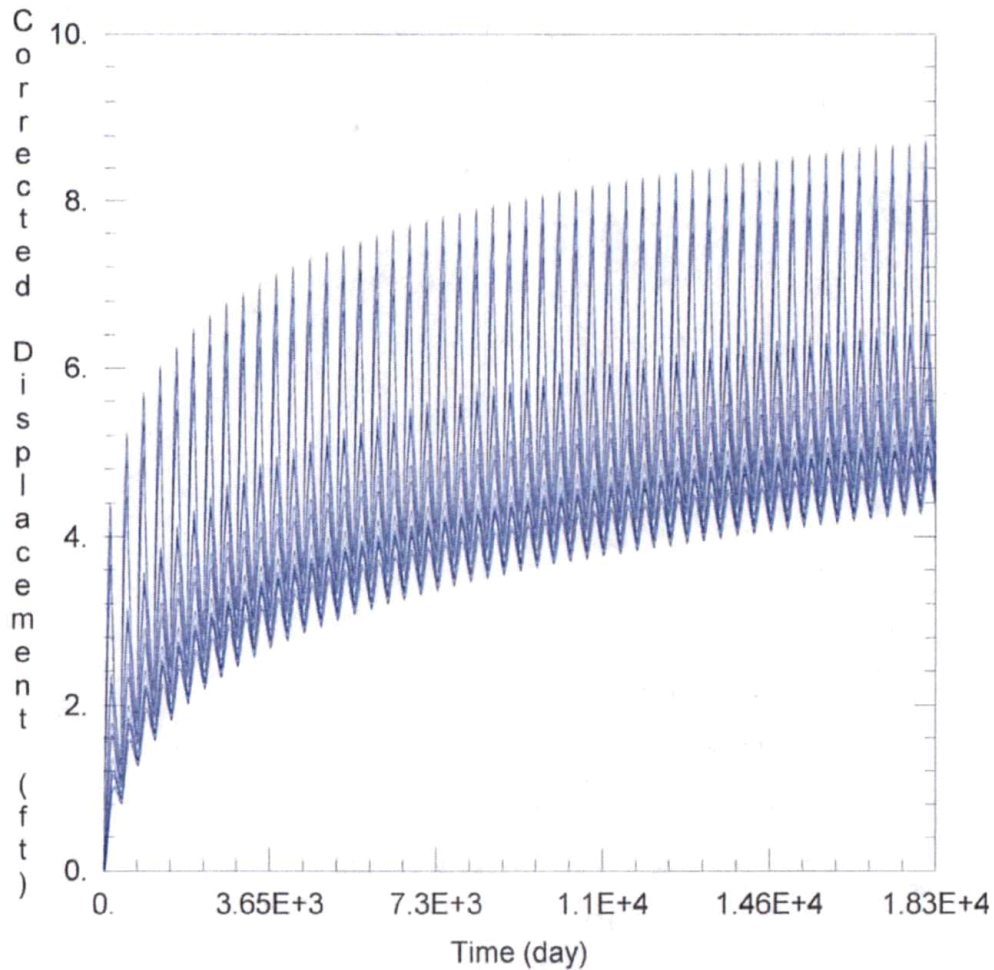

WELL TEST ANALYSIS

Data Set: C:\Users\scanstation\Documents\move requests\26383\26383 current.aqt
 Date: 11/19/24 Time: 16:05:47

PROJECT INFORMATION

Test Well: 26383 ID3

WELL DATA

Pumping Wells

Well Name	X (ft)	Y (ft)
26383 ID3	-105573	378917

Observation Wells

Well Name	X (ft)	Y (ft)
□	-105573	378917
□ 81	-108656	380692
□ 48 & 11780	-105267	382030
□ 84	-103109	382801
□ 23803 ID11	-103375	380913
□ 23803 ID9	-101297	381344
□ 20926	-101073	379639
□ 21611 ID1	-110110	377810
□ 21611 ID6	-109028	376494
□ 26383 ID6	-107426	377916
□ 14344	-104713	375251
□ 15730	-102695	377879
□ 20927	-102154	376035
□ Domestic 1	-103113	381479
□ Domestic 2	-105801	376837
□ Domestic 3	-103802	378834

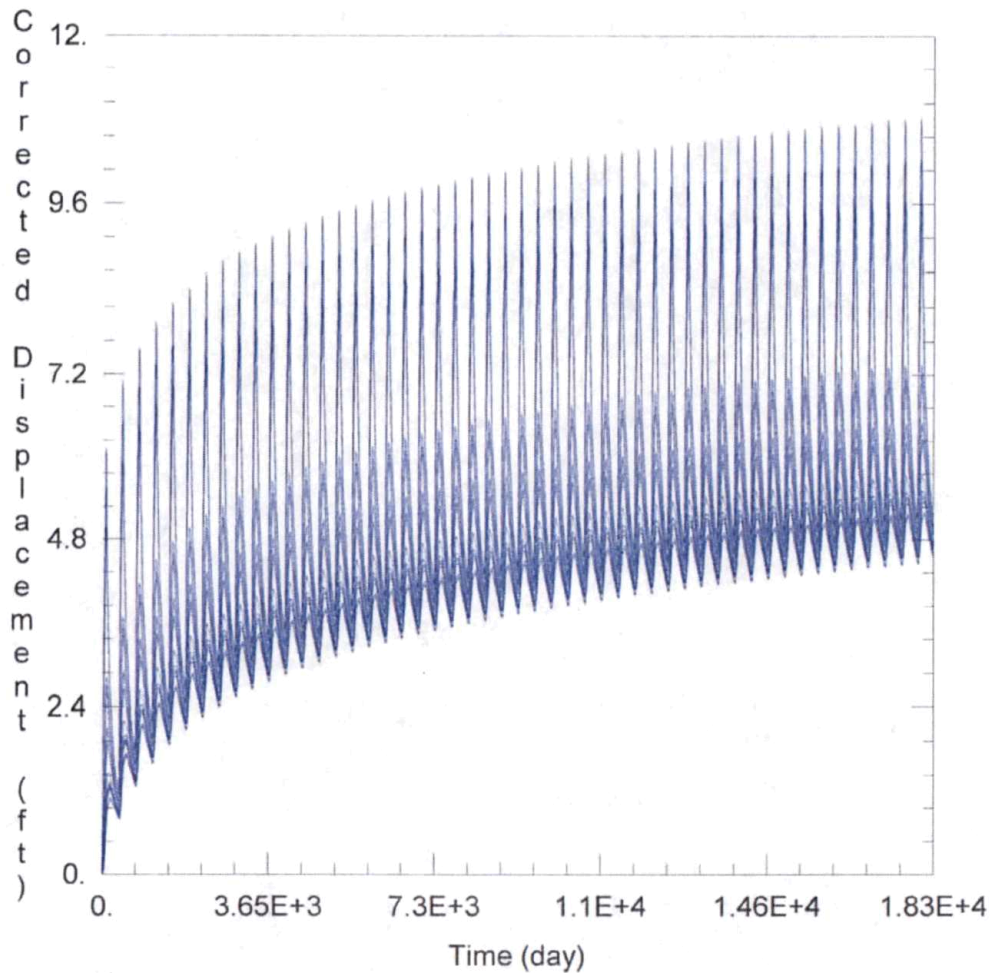

WELL TEST ANALYSIS

Data Set: C:\Users\scanstation\Documents\move requests\26383\26383 proposed.aqt
 Date: 11/19/24 Time: 16:05:51

PROJECT INFORMATION

Test Well: 26383 ID3

WELL DATA

Pumping Wells

Well Name	X (ft)	Y (ft)
26383 ID3	-105573	378917

Observation Wells

Well Name	X (ft)	Y (ft)
□	-105573	378917
□ 81	-108656	380692
□ 48 & 11780	-105267	382030
□ 84	-103109	382801
□ 23803 ID11	-103375	380913
□ 23803 ID9	-101297	381344
□ 20926	-101073	379639
□ 21611 ID1	-110110	377810
□ 21611 ID6	-109028	376494
□ 26383 ID6	-107426	377916
□ 14344	-104713	375251
□ 15730	-102695	377879
□ 20927	-102154	376035
□ Domestic 1	-103113	381479
□ Domestic 2	-105801	376837
□ Domestic 3	-103802	378834

Garden City Field Office
4532 W. Jones, Suite B
Garden City, KS 67846

Mike Beam, Secretary



Phone: 620-276-2901
Fax: 620-276-9315
www.agriculture.ks.gov

Laura Kelly, Governor

November 5, 2024

GROUNDWATER MANAGEMENT DISTRICT #3
2009 E SPRUCE ST
GARDEN CITY KS 67846

Re: Request for Recommendation,
File No. 26383

Dear Sir or Madam:

We are enclosing a copy of the referenced application, which was submitted by Henry Dyck and appears to be in proper form, for your review.

We are delaying any further action for a period of 15 days from the date of this letter to allow you time to submit your recommendation concerning this application. Please submit your recommendation within the allotted time, or any authorized extension of time thereof.

If you have any questions, please contact me at (620) 276-2901. If you wish to discuss a specific file, please have the file number ready to that I may help you more efficiently.

Sincerely,

A handwritten signature in blue ink that reads "Austin McColloch".

Austin McColloch
Assistant Water Commissioner

Enclosure
pc:

Garden City Field Office
4532 W. Jones, Suite B
Garden City, KS 67846



Phone: 620-276-2901
Fax: 620-276-9315
www.agriculture.ks.gov

Mike Beam, Secretary

Laura Kelly, Governor

October 18, 2024

MARILYN WOLFE TRUST
PO BOX 334
DEERFIELD KS 67838

RE: Application for Change
Water Right, File Nos. 26383

Dear Sir or Madam:

This is to advise you that Henry Dyck has filed an application for approval of the Chief Engineer, Division of Water Resources, Kansas Department of Agriculture, to change the point of diversion under the above referenced applications. An irrigation well is proposed to be relocated to the NW $\frac{1}{4}$ NW $\frac{1}{4}$ NE $\frac{1}{4}$ of Section 4, Township 25 South, Range 35 West, Kearny County.

You can find the complete applications posted by water right file number as referenced above at: www.Agriculture.ks.gov/DWRNotices

You are notified on this proposed point of diversion (well) so that you may furnish this office with any comments or other information you want to submit. Such comments or other information must be received in this office within 15 days from the date of this letter.

Should you have any questions, please feel free contact this office. If you would prefer, you could arrange an appointment for additional assistance. Please refer to the file number when you contact us if you wish to discuss a specific file.

Sincerely,

A handwritten signature in black ink, appearing to read "Austin J. McColloch".

Austin J. McColloch
Assistant Water Commissioner

AM:

pc:

SCANNED