

Kansas Department of Agriculture
Division of Water Resources
 APPROVAL OF CHANGE APPLICATION WORKSHEET

1. File No.: 27681	2. Status Change Date: <i>10-7-2024</i>	4. Field Office: 04 - Garden City GMD: 03 - Southwest Structures File No.: Filing/Priority Date: 9/03/2024 Application Complete Date: 10/07/2024
3. Package File No(s):		
5a. <input checked="" type="checkbox"/> Applicant <input checked="" type="checkbox"/> Owner <input checked="" type="checkbox"/> WUC <input type="checkbox"/> Address Change TONY & MARSHA S KOEHN 25206 16 RD MONTEZUMA, KS 67867	Person ID 32398 Add Seq#	5b. <input type="checkbox"/> Owner <input type="checkbox"/> WUC <input type="checkbox"/> Address Change Person ID Add Seq#
5c. <input type="checkbox"/> Owner <input type="checkbox"/> WUC <input type="checkbox"/> Address Change	Person ID Add Seq#	5d. <input type="checkbox"/> Owner <input type="checkbox"/> WUC <input type="checkbox"/> Address Change Person ID Add Seq#
6. Change No.: 1 <input checked="" type="checkbox"/> PD <input type="checkbox"/> PU <input type="checkbox"/> UMW Base Acres: 136 Year: Min Reasonable Q: Previous UMW: MDS Gauge: Active Admin? <input type="checkbox"/> Completion/Start Date: 3/1/2026 Perfection/Expiration Date:		7. Use of Water <input checked="" type="checkbox"/> Groundwater <input type="checkbox"/> Surface Water UMW: IRR-Irrigation UMW: UMW:
8. Action Trail		
9. Special Conditions		
10. 5YR Allocation Type: Start Year: 5YR Quantity: Base Acres: Comment:		
11. Sand & Gravel Proj ID: <input type="checkbox"/> Active <input type="checkbox"/> Dredge <input type="checkbox"/> IND Evap <input type="checkbox"/> Jr Evap <input type="checkbox"/> Other Diversion <input type="checkbox"/> Rpt on Sr		
12. Waiver Rule ID: <input type="checkbox"/> New Date Requested: Applies: Rule No.: Justification: Rule Type: Rule SubType:		
Comments	Processed 10/07/2024 MAM	Entered
	Reviewed	

File No. 27681	13. County: GY Basin: ARKANSAS RIVER Stream:		
Structures File No:	Aquifer Code: 211	Special Use Area:	

14. Points of Diversion, Rates & Quantities										Qty AF		Rate gpm		Storage Qty		Storage Rate	
PDIV	Qualifier	S	T	R	ID	'N	'W	Comment (AKA Line)	Auth	Add	Auth	Add	Auth	Add	Auth/Add	Overlaps	
DEL	20299																
ENT	NWNWSW	35	27	28W	2374	5112			272	272	800	800					

15. Limitations	Type:	Quantity:	Rate:	combined with file no(s):
	Type:	Quantity:	Rate:	combined with file no(s):

16. Metering Metering Required Anti-Reverse Required Seal Required Compliance Date: 12/31/2025

17. Place of Use										NE¼		NW¼		SW¼		SE¼		Total	Owner(s)	Chg? Overlaps
PUSE	S	T	R	ID	NE	NW	SW	SE	NE	NW	SW	SE	NE	NW	SW	SE				
CHK	27075																			<input type="checkbox"/>
																				<input type="checkbox"/>
																				<input type="checkbox"/>
																				<input type="checkbox"/>
																				<input type="checkbox"/>
																				<input type="checkbox"/>

18. Point of Diversion and Place of Use Overlaps	
*	**
+	++
#	##
^	^^

Garden City Field Office
4532 W. Jones, Suite B
Garden City, KS 67846



Phone: 620-276-2901
Fax: 620-276-9315
www.agriculture.ks.gov

Mike Beam, Secretary

Laura Kelly, Governor

October 7, 2024

TONY & MARSHA S KOEHN
25206 16 RD
MONTEZUMA, KS 67867

RE: Filed Office Application for Change
Water Right, File No. 27681

Dear Sir:

Enclosed is the order executed by the designee of the Chief Engineer, Division of Water Resources, Kansas Department of Agriculture, approving the application for change under the above referenced file number.

Your attention is directed to the enclosures and to the terms, conditions, and limitations specified in this approval for change. A condition of this approval is that an acceptable water flow meter must be installed on the diversion works authorized under the referenced file number and meet current specifications.

Since the order modifies the original document referred to above, it should be recorded with the Register of Deeds as other instruments affecting real estate.

The abandoned well must be plugged in accordance with the requirements of Article 30 of the Rules and Regulations as adopted by the Kansas Department of Health and Environment.

Should you have any questions, please feel free contact this office. If you would prefer, you could arrange an appointment for additional assistance.

Sincerely,

A handwritten signature in blue ink that reads "Michael A. Meyer".

Michael A. Meyer
Water Commissioner

MAM

CERTIFICATE OF SERVICE

On this 7th day of October 2024, I hereby certify that the foregoing Approval of Application for Change in Point of Diversion, Water Right, File No. 27,681 dated 7th day of October 2024 was mailed postage prepaid, first class, US mail to the following:

TONY & MARSHA S KOEHN
25206 16 RD
MONTEZUMA, KS 67867



Division of Water Resources Staff

Submit completed application to:
 Kansas Department of Agriculture
 Division of Water Resources
 Field Office for your area.

Call for address:

Topeka -- (785) 296-5733
 Stafford -- (620) 234-5311
 Stockton -- (785) 425-6787
 Garden City -- (620) 276-2901
<http://agriculture.ks.gov/dwr>

DWR FIELD OFFICE APPLICATION FOR APPROVAL TO CHANGE THE PLACE OF USE AND/OR THE POINT OF DIVERSION



STATE OF KANSAS

Filing Fee Must Accompany the Application, K.S.A. 82a-708b(b), as amended.
 Fee Schedule is on the third page of this application form.

Paragraph Nos. 1, 2, 3 & 5 must be completed. Complete all other applicable portions. If change in point of diversion is greater than 100 feet, or if place of use will be changed, include a topographic map or detailed plat showing the authorized and proposed point(s) of diversion and/or place of use.

 File No. 27681

RECEIVED
 11:30 am
 SEP 3 2024

Garden City Field Office
 Division of Water Resources

1. Application is hereby made for approval of the Chief Engineer to change the (check one or both):

Place of Use Point of Diversion

under the water right which is the subject of this application in accordance with the conditions described below.

The source of supply is: Groundwater Surface water

2. Name and address of Applicant: TONY & MARSHA KOEHN

25206 16 RD MONTEZUMA KS 67867

Phone Number: () 876-0067 Email address: _____

Name and address of Water Use Correspondent: SAME AS ABOVE

Phone Number: () _____ Email address: _____

3. The presently authorized place of use is:

Owner of Land ---- NAME: _____

ADDRESS: _____

(If there is more than one landowner, attach supplemental sheets as necessary.)

Sec.	Twp.	Range	NE¼				NW¼				SW¼				SE¼				TOTAL ACRES
			NE¼	NW¼	SW¼	SE¼	NE¼	NW¼	SW¼	SE¼	NE¼	NW¼	SW¼	SE¼	NE¼	NW¼	SW¼	SE¼	

4. If this application is for a change in place of use, it is proposed that the place of use be changed to:

Owner of Land ---- NAME: _____

ADDRESS: _____

(If there is more than one landowner, attach supplemental sheets as necessary.)

Sec.	Twp.	Range	NE¼				NW¼				SW¼				SE¼				TOTAL ACRES
			NE¼	NW¼	SW¼	SE¼	NE¼	NW¼	SW¼	SE¼	NE¼	NW¼	SW¼	SE¼	NE¼	NW¼	SW¼	SE¼	

For Office Use Only: Code _____ Fee \$ 200.00 TR # _____ Receipt Date 9-3-24 Check # 20659

5. **Presently authorized point of diversion:**
 One in the _____ Quarter of the _____ NC _____ Quarter of the _____ SW _____ Quarter
 of Section _____ 35 _____, Township _____ 27 _____ South, Range _____ 28 _____ (W),
 in GRAY _____ County, Kansas, _____ 1300 _____ feet North _____ 3930 _____ feet West of Southeast corner of section.
 Authorized Rate _____ 800 GPM _____ Authorized Quantity _____ 272 AF _____ Depth of well _____ (feet)
(DWR use only: Computer ID No. 2 _____ GPS _____ feet North _____ feet West)
 This point will not be changed This point will be changed as follows: No change, point better described with GPS as follows:
Proposed point of diversion: (Complete only if change is requested or if existing point is better described by GPS)
 One in the _____ NW _____ Quarter of the _____ NW _____ Quarter of the _____ SW _____ Quarter
 of Section _____ 35 _____, Township _____ 27 _____ South, Range _____ 28 _____ (W),
 in GRAY _____ County, Kansas, _____ 2374 _____ feet North _____ 5112 _____ feet West of Southeast corner of section.
 Proposed Rate _____ NO CHANGE _____ Proposed Quantity _____ NO CHANGE _____ Proposed well depth (feet) _____ 340 _____
 This point is: Additional Well Geo Center List other water rights that will use this point _____

6. **Presently authorized point of diversion:**
 One in the _____ Quarter of the _____ Quarter of the _____ Quarter
 of Section _____, Township _____ South, Range _____ (E/W),
 in _____ County, Kansas, _____ feet North _____ feet West of Southeast corner of section.
 Authorized Rate _____ Authorized Quantity _____ Depth of well _____ (feet)
(DWR use only: Computer ID No. _____ GPS _____ feet North _____ feet West)
 This point will not be changed This point will be changed as follows: No change, point better described with GPS as follows:
Proposed point of diversion: (Complete only if change is requested or if existing point is better described by GPS)
 One in the _____ Quarter of the _____ Quarter of the _____ Quarter
 of Section _____, Township _____ South, Range _____ (E/W),
 in _____ County, Kansas, _____ feet North _____ feet West of Southeast corner of section.
 Proposed Rate _____ Proposed Quantity _____ Proposed well depth (feet) _____
 This point is: Additional Well Geo Center List other water rights that will use this point _____

7. The changes herein are desired for the following reasons?
 (please be specific) LOSS OF PRODUCTION

8. If a well, is the test hole log attached? Yes No

9. The change(s) (was)(will be) completed by?
ASAP

10. If the point of diversion is a well:
 (a) What are you going to do with the old well?
PLUG OR CAP
 (b) When will this be done? _____

11. Groundwater Management District recommendation attached?
 Yes No

12. Assisted by AH GFCO

13a. If the proposed point of diversion will be relocated more than 300 feet but within 2,640 feet of the existing point of diversion, attach a topographic map or aerial photograph. For groundwater sources, show all wells (including domestic) within one-half mile of the proposed point of diversion and the names and mailing addresses of the owners. For surface water sources, show the names and addresses of the landowner(s) one-half mile downstream and one-half mile upstream from your property lines

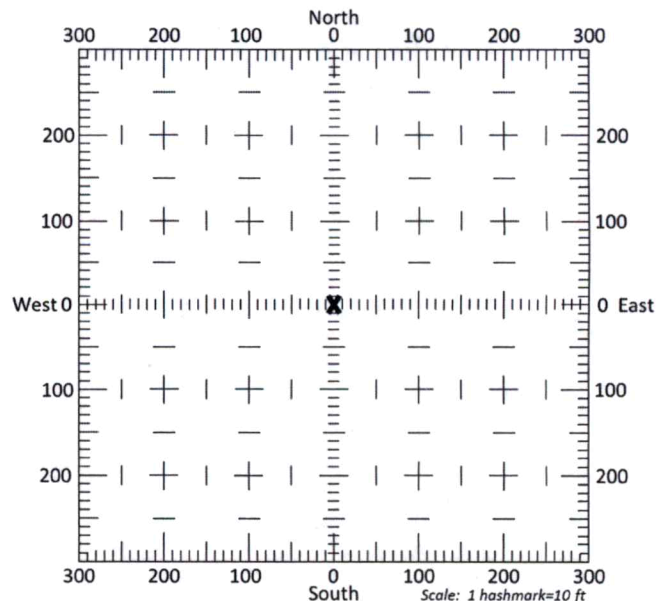



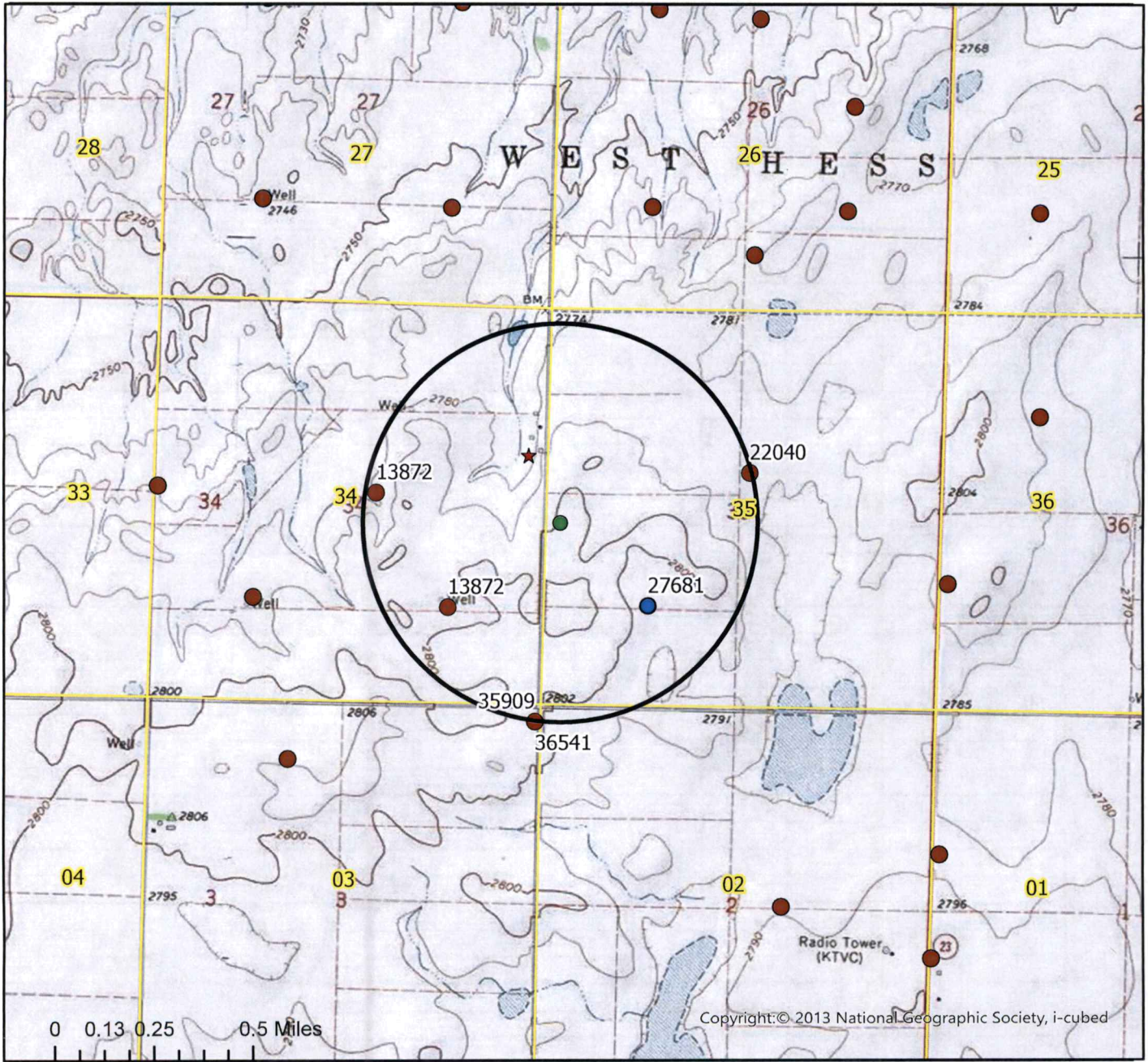

13b. If the proposed point of diversion will be relocated within 300 feet of the existing point of diversion, indicate its location on the diagram shown above in relation to the existing point of diversion. **(PLEASE NOTE: The "X" in center of diagram above represents the presently authorized point of diversion.)**

CHANGE IN POINT OF DIVERSION WATER RIGHT, FILE NO. 27681

SW 1/4 of Section 35 Township 27 South Range 28 West Gray County



	Authorized Point of Diversion
	Proposed Point of Diversion
	Permitted Water Right
	Domestic Well within 1/2 mile
	1/2 mile buffer

List of owner name and addresses within 1/2 mile:
 WR#: 13872 SKINNER FARMS LLC
 11568 W COVE CREST DR. BELLEMONT AZ 86015
 WR#: 22040 TROY SKINNER
 515 N PROSPECT LIBERAL KS 67901
 WR #: 35909 & 36541
 OWNED BY APPLICANT
 DOMESTIC: CHAD & RACHEL KOEHN
 PO BOX 463 MONTEZUMA KS 67867



By signing below I agree that all wells, including domestic, and owners names and addresses within 1/2 mile of the proposed point of diversion have been shown on the map

(Signature) _____ Date _____

Date AH/GCFO
 1:24,000 Scale

3795 W. Jones Ave.
Garden City, KS 67846
PH: 620-277-2389



Cery

PO Box 639
Garden City, KS 67846
Fax: 620-277-0224

TONY KOEHN 620-846-0053

Customer Name: Tony Koehn
Street Address: 25256 Rd 16
City, State: Mankawana, KS 67867
County: Greeley Quarter: SW Section: 35
Location: _____
Rig #: 10003 Elevation: 2811

WO#: 27557 Date: 8/28/24
Test #: 2 E LOG: _____
Driller: David Fezzel
Township: 27 Range: 28
GPS: 37.65641°N 100.81032°W
Static WL: 250' Estimated? (Yes) - NP
Proposed Well Depth: '319' w/ 25' surge - 339'

REPLACEMENT WELL LOCATION 246' in 2022

%	Footage			Description of Strata 27681
	From	Pay	To	
	0		2	Sandstone
	2		25	Beaver Sandy Clay, Colored
	25		61	Free Sand
	61		71	Beaver Sandy Clay
	71		126	Sand, trap to gravel
	126		173	Beaver Sandy Clay, low Perm Rock, Bone Shale
	173		197	Sand free to med. coarse
	197		204	Beaver Sandy Clay, Bone Shale
	204		218	Sand, fine to med coarse, small gravel, thin thin clay
40%	218		—	Sand, fine to med coarse, small to large gravel
	—	30	290	Low Perm, Bone Shale + White Rock (used in the)
40%	—		—	Sand, fine to med coarse, small to med, some large gravel
	290	21	301	(Coarse, loose used in the)
35%	301	18	319	Sand, fine to med coarse, small to large gravel (conventional)
	319		322	Shale, limestone
	322		340	Shale, limestone

- Test Rig -
- Set up Smith -
- Put to Work -
- 2 - Surber Gal X
- 3 - Greut
- 6 - Barbour's Plug
- 1 - Perm Plug
- 1 - Magna Fiber

Tony Koehn

Test Hole # 2 of 8-28-24

SW 35-27-28 GY

FILE # 27681

Legend

 37.65646 N 100.36032 W

 37.65646 N 100.36032 W

23



14. If the proposed groundwater point of diversion is 300 or fewer feet from the existing point of diversion, complete the following:
- (a) Does the undersigned represent all owners of the currently authorized place(s) of use identified in this application?
 Yes No (If no, all owners must sign this application.)
 - (b) Will the ownership interest of any owner of the currently authorized place(s) of use identified in this application be adversely affected if this application is approved as requested?
 Yes No (If yes, all owners must sign this application.)
 - (c) If this application is not approved expeditiously, will there be substantial damage to property, public health or safety?
 Yes No (If no, all owners must sign this application.)

If the application proposes a surface water change in point of diversion, a groundwater change in point of diversion greater than 300 feet, or a change in place of use, the application must be signed by all owners of the currently authorized place of use, or their duly authorized agent (attach notarized statement authorizing representation).

I hereby verify, being first duly sworn upon my oath or affirmation and under penalty of perjury, that I am of lawful age and the owner, the spouse of the owner, or a duly authorized agent of the owner(s) to make this application on their behalf, in regards to the water right(s) to which this application pertains. I further verify that the statements contained in this application are true, correct and complete.

Dated at Garden City, Kansas, this 3rd day of September, 2024.

<u>Anthony Koehn</u>	
(Owner)	(Spouse)
<u>Anthony Koehn</u>	
(Please Print)	(Please Print)
<u>Marsha Koehn</u>	
(Owner)	(Spouse)
<u>Marsha Koehn</u>	
(Please Print)	(Please Print)
(Owner)	(Spouse)
(Please Print)	(Please Print)

State of Kansas }
 County of Finney } SS

I hereby certify that the foregoing application was signed in my presence and sworn to before me this 3rd day of September, 2024.

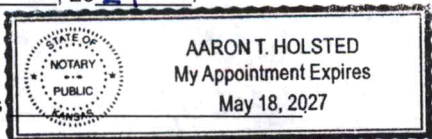

Aaron Holsted
 Notary Public

My Commission Expires _____

ONLY COMPLETE APPLICATIONS WILL BE PROCESSED. To be complete, all of the applicable portions of the application form must be completed with accurate information; maps, if necessary, must be included; signatures of all the appropriate owners' must be affixed to the application and notarized; and the appropriate fee must be paid.

FEE SCHEDULE

Each application to change the place of use or the point of diversion under this section shall be accompanied by the application fee set forth in the schedule below: Make checks payable to: **Kansas Department of Agriculture**

(1) Application to change a point of diversion 300 feet or less	\$100
(2) Application to change a point of diversion more than 300 feet	\$200
(3) Application to change the place of use	\$200

SUMMARY ORDER APPROVING APPLICATION FOR CHANGE AND IMPOSING CONDITIONS

This Summary Order is issued under authority of K.S.A. 82a-708b, as amended, and K.A.R. 5-5-1, *et seq.* and other applicable provisions of the *Kansas Water Appropriation Law, K.S.A. 82a-701 et seq.*, and rules and regulations promulgated thereunder, With the exception of those conditions expressly contained herein, this Summary Order does not change the terms, conditions and limitations of File No. 27681

1. A change application was received on September 3, 2024 requesting that the place of use and / or point of diversion authorized under the above-referenced file number be changed as described in the application.
2. On and after the effective date of this summary order, the authorized place(s) of use shall be located substantially as shown on the topographic map accompanying the application to change the place of use. Applicable Not Applicable
3. The change in point of diversion shall not impair existing rights and shall be limited to the same source or sources of water as previously authorized. The point of diversion authorized by this summary order shall be located within a 300 foot radius of the authorized point(s) of diversion. Applicable Not Applicable
4. The point(s) of diversion described herein is administratively corrected to be more accurately described using the Global Positioning System (GPS), as described in the application. Applicable Not Applicable
5. The point(s) of diversion authorized herein shall not actually be located more than _____ feet from the previously authorized point(s) of diversion. Applicable Not Applicable
6. As required by K.A.R. 5-3-5d, if the works for diversion is a well with a diversion rate of 100 gallons per minute or more, a tube or other device suitable for making water level measurements shall be installed, operated and maintained in accordance with K.A.R. 5-6-13. Applicable Not Applicable
7. **The owner of the authorized place(s) of use shall properly install an acceptable water flow meter on or before December 31, 2025**, or before the first use of water, whichever occurs first. The water flow meter shall be installed, operated and maintained in accordance with K.A.R. 5-1-4 through 5-1-12. As required by K.S.A. 82a-732, as amended, and K.A.R. 5-3-5e, the owner shall maintain records and report the reading of the water flow meter and the total quantity of water diverted annually to the Chief Engineer by March 1 following the end of each calendar year. Applicable Not Applicable
8. **Installation of the works for diversion of water shall be completed on or before December 31, 2025**, or within any authorized extension of time. By March 1, 2026 the applicant shall notify the Chief Engineer that construction of the works for diversion has been completed, on the form provided by the Chief Engineer, as required by K.A.R. 5-8-4e. Applicable Not Applicable
9. **The completed well log shall be submitted with the required notice.** Applicable Not Applicable
10. All diversion works into which any type of chemical or other foreign substance will be injected into the water shall be equipped with an in-line, automatic, quick-closing check valve capable of preventing pollution of the source of the water supply. The check valve(s) shall be installed, operated and maintained in accordance with K.A.R. 5-3-5c. Applicable Not Applicable
11. Additional Conditions are attached. Yes No
12. In accordance with K.S.A. 82a-708a, as amended, and K.A.R. 5-5-14, all of the owners of the authorized place(s) of use of water appropriated under the above-referenced file number are responsible for compliance with its terms, conditions and limitations, as amended and/or supplemented by this Summary Order, and with applicable provisions of the *Kansas Water Appropriation Law* and the *Rules and Regulations* promulgated thereunder. Failure to comply with these provisions may result in civil penalties pursuant to K.S.A. 82a-737, as amended, and/or the suspension or revocation and dismissal of the water or appropriation right or any other enforcement actions authorized by law.

Administrative Appeal and Effective Date of Order

If you are aggrieved by this order, pursuant to K.S.A. 82a-1901, you may request an evidentiary hearing before the Chief Engineer or request administrative review by the Secretary of Agriculture. A request for hearing by the Chief Engineer must be filed within **15 days** of service of this Order and a request for administrative review by the Secretary must be filed within **30 days** pursuant to K.S.A. 77-531. Any request for administrative review must state a basis for review pursuant to K.S.A. 77-527. File any request with **Kansas Department of Agriculture, Legal Division, 1320 Research Park Drive, Manhattan, KS 66502**. Failure to timely request a hearing or review may preclude review under the Kansas Judicial Review Act.

For Use by Register of Deeds

FOR OFFICE USE ONLY
**APPLICATION APPROVED AND
 SUMMARY ORDER ISSUED**

By: Michael A. Meyer
 Duly Authorized Designee of the Chief Engineer

(Print Name): MICHAEL A. MEYER
 Division of Water Resources - Kansas Department of Agriculture

Date of Issuance: October 7, 2024

State of Kansas)

) SS

County of Finney)

Acknowledged before me on October 7, 2024

by Michael A. Meyer

Signature: Julie Jones
 Notary Public

My commission expires December 15, 2026

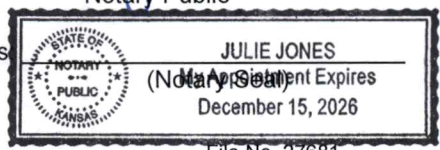

Garden City Field Office
4532 W. Jones, Suite B
Garden City, KS 67846



Phone: 620-276-2901
Fax: 620-276-9315
www.agriculture.ks.gov

Mike Beam, Secretary

Laura Kelly, Governor

September 20, 2024

SOUTHWEST KANSAS GROUNDWATER
MANAGEMENT DISTRICT NO. 3
2009 E SPRUCE ST
GARDEN CITY KS 67846

Re: Request for Recommendation
Water Right, File No. 27681

Dear Mr. Norquest:

This is to advise you that Tony Koehn has filed applications for approval of the Chief Engineer, Division of Water Resources, Kansas Department of Agriculture, to change the point of diversion.

We are delaying action on the change applications to allow you time to review and provide a recommendation. Please submit a recommendation within 15 days from the date of this letter.

Thank you and as always feel free to contact this office at any time.

Sincerely,

A handwritten signature in blue ink that reads "Michael A. Meyer".

Michael A. Meyer
Water Commissioner

MAM
Enclosures

Garden City Field Office
4532 W. Jones, Suite B
Garden City, KS 67846



Phone: 620-276-2901
Fax: 620-276-9315
www.agriculture.ks.gov

Mike Beam, Secretary

Laura Kelly, Governor

September 4, 2024

KENNETH D MILLER
25103 21 RD
CIMARRON, KS 67835

Re: Application for Change, Water Right, File No. 27681

Dear Sir:

This is to advise you that Tony Koehn has filed an application for approval of the Chief Engineer, Division of Water Resources, Kansas Department of Agriculture, for change in point of diversion under the above referenced application.

You can find the complete application posted by water right file number as referenced above at www.agriculture.ks.gov/divisions-programs/dwr/water-appropriation/notices

You are notified of this proposal so that you may furnish this office with any comments or other information you may want to submit. Such comments or other information must be received in this office within 15 days from the date of this letter.

Should you have any questions, please feel free to call this office. If you would prefer, an appointment could be arranged for additional assistance. Please refer to the file number when you contact us if you wish to discuss a specific file.

Sincerely,

Sincerely,

A handwritten signature in blue ink that reads "Michael A. Meyer".

Michael A. Meyer
Water Commissioner

MAM

Garden City Field Office
4532 W. Jones, Suite B
Garden City, KS 67846



Phone: 620-276-2901
Fax: 620-276-9315
www.agriculture.ks.gov

Mike Beam, Secretary

Laura Kelly, Governor

September 4, 2024

CHAD W KOEHN
PO BOX 463
MONTEZUMA, KS 67867

Re: Application for Change, Water Right, File No. 27681

Dear Sir:

This is to advise you that Tony Koehn has filed an application for approval of the Chief Engineer, Division of Water Resources, Kansas Department of Agriculture, for change in point of diversion under the above referenced application.

You can find the complete application posted by water right file number as referenced above at www.agriculture.ks.gov/divisions-programs/dwr/water-appropriation/notices

You are notified of this proposal so that you may furnish this office with any comments or other information you may want to submit. Such comments or other information must be received in this office within 15 days from the date of this letter.

Should you have any questions, please feel free to call this office. If you would prefer, an appointment could be arranged for additional assistance. Please refer to the file number when you contact us if you wish to discuss a specific file.

Sincerely,

Sincerely,

A handwritten signature in blue ink that reads "Michael A. Meyer".

Michael A. Meyer
Water Commissioner

MAM