

WATER RESOURCES
RECEIVED

MAR 22 2024

10:46

KS Dept. of Agriculture



State of Kansas

Submit To: CHIEF ENGINEER
Division of Water Resources
Kansas Department of Agriculture
1320 Research Park Drive
Manhattan, Kansas 66502
http://agriculture.ks.gov/dwr

**APPLICATION FOR APPROVAL TO
CHANGE THE PLACE OF USE, THE
POINT OF DIVERSION OR THE USE
MADE OF THE WATER UNDER AN
EXISTING WATER RIGHT**

*Filing Fee Must Accompany the Application
(Please refer to Fee Schedule on signature page of application form.)*

Paragraph Nos. 1, 2, 3, 4 & 8 must be completed. Complete all other applicable portions. A topographic map or detailed plat showing the authorized and proposed points(s) of diversion and /or place of use must accompany this application.

1. Application is hereby made for approval of the Chief Engineer to change the

Place of Use

(Check one or more) Point of Diversion

Use Made of Water

File No. 45502

2. Name of applicant: Marigail Thomas Revocable Trust %Elise Heger

Address: 1901 University Dr

City, State and Zip: Lawrence, KS 66044

Phone Number: (620) 544-1468

E-mail address: kirkheger@gmail.com

What is your relationship to the water right; owner tenant agent other? If other, please explain. _____

Name of water use correspondent: SAME

Address: _____

City, State and Zip: _____

Phone Number: (____) _____

E-mail address: _____

3. The change(s) proposed herein are desired for the following reasons (please be specific): _____

Proposed change will bring in quarter of ground and enter into a monitoring agreement with GMD3.

The change(s) Will be completed by As soon as approved

(Date)

3/29/2024
KAnderson

For Office Use Only:																
F.O.	<u>4</u>	GMD	<u>3</u>	Meets K.A.R. 5-5-1	<input checked="" type="checkbox"/> YES	<input type="checkbox"/> NO	Use	<u>IRR</u>	Source	<input checked="" type="checkbox"/> G	County	<u>SV</u>	By	<u>ALB</u>	Date	<u>3/22/24</u>
Code	<u>cpu</u>	Fee \$	<u>200</u>	TR #		Receipt Date	<u>3-22-24</u>	Check #	<u>1030</u>							

MAR 22 2024

File No. 45502

KS Dept. of Agriculture

4. The presently authorized place of use is:

Owner of Land — NAME: Marigail Thomas Revocable Trust %Elise Heger

ADDRESS: 1901 University Dr, Lawrence, KS 66044

Sec.	Twp.	Range	NE¼				NW¼				SW¼				SE¼				TOTAL ACRES
			NE¼	NW¼	SW¼	SE¼	NE¼	NW¼	SW¼	SE¼	NE¼	NW¼	SW¼	SE¼	NE¼	NW¼	SW¼	SE¼	
28	34s	36w									32.5	32.5	10.0	32.5	32.5	32.5	32.5	32.5	237.5
33	34s	36w					32.5	32.5	32.5	32.5									130.0

List any other water rights that cover this place of use. _____

Owner of Land — NAME: _____

ADDRESS: _____

Sec.	Twp.	Range	NE¼				NW¼				SW¼				SE¼				TOTAL ACRES
			NE¼	NW¼	SW¼	SE¼	NE¼	NW¼	SW¼	SE¼	NE¼	NW¼	SW¼	SE¼	NE¼	NW¼	SW¼	SE¼	

List any other water rights that cover this place of use. _____

(If there are more than two landowners, attach additional sheets as necessary.)

5. It is proposed that the place of use be changed to:

Owner of Land — NAME: Marigail Thomas Revocable Trust %Elise Heger

ADDRESS: 1901 University Dr, Lawrence, KS 66044

Sec.	Twp.	Range	NE¼				NW¼				SW¼				SE¼				TOTAL ACRES
			NE¼	NW¼	SW¼	SE¼	NE¼	NW¼	SW¼	SE¼	NE¼	NW¼	SW¼	SE¼	NE¼	NW¼	SW¼	SE¼	
28	34s	36w									32.5	32.5	10.0	32.5	32.5	32.5	32.5	32.5	237.5
33	34s	36w					32.5	32.5	32.5	32.5									130.0
34	34s	36w					30.0	30.0	30.0	30.0									120.0

List any other water rights that cover this place of use. _____

Owner of Land — NAME: REVERSION ACRES

ADDRESS: _____

Sec.	Twp.	Range	NE¼				NW¼				SW¼				SE¼				TOTAL ACRES
			NE¼	NW¼	SW¼	SE¼	NE¼	NW¼	SW¼	SE¼	NE¼	NW¼	SW¼	SE¼	NE¼	NW¼	SW¼	SE¼	
28	34S	36W									30.0	30.0	7.0	30.0	30.0	30.0	30.0	30.0	217.0
33	34S	36W					30.0	30.0	30.0	30.0									120.0

List any other water rights that cover this place of use. _____

IF MORE SPACE IS NEEDED, ATTACH ADDITIONAL SHEETS AS NECESSARY

MAR 22 2024

File No. 45502

KS Dept. of Agriculture

6. The presently authorized point(s) of diversion (is) (are) NO CHANGE
(Provide description and number of points)
7. The proposed point(s) of diversion (is) (are) _____
(Provide description and number of points)

List all presently authorized point(s) of diversion:

8. **Presently authorized point of diversion:**
One in the NE Quarter of the NE Quarter of the NW Quarter
of Section 33, Township 34 South, Range 36 W,
in Stevens County, Kansas, 4940 feet North 2742 feet West of Southeast corner of section.
Authorized Rate 1000gpm Authorized Quantity 543AF
(DWR use only: Computer ID No. _____ GPS _____ feet North _____ feet West)
 This point will not be changed This point will be changed as follows:
Proposed point of diversion: (Complete only if change is requested)
One in the _____ Quarter of the _____ Quarter of the _____ Quarter
of Section _____, Township _____ South, Range _____ (E/W),
in _____ County, Kansas, _____ feet North _____ feet West of Southeast corner of section.
Proposed Rate _____ Proposed Quantity _____
This point is: Additional Well Geo Center List other water rights that will use this point _____

9. **Presently authorized point of diversion:**
One in the _____ Quarter of the _____ Quarter of the _____ Quarter
of Section _____, Township _____ South, Range _____ (E/W),
in _____ County, Kansas, _____ feet North _____ feet West of Southeast corner of section.
Authorized Rate _____ Authorized Quantity _____
(DWR use only: Computer ID No. _____ GPS _____ feet North _____ feet West)
 This point will not be changed This point will be changed as follows:
Proposed point of diversion: (Complete only if change is requested)
One in the _____ Quarter of the _____ Quarter of the _____ Quarter
of Section _____, Township _____ South, Range _____ (E/W),
in _____ County, Kansas, _____ feet North _____ feet West of Southeast corner of section.
Proposed Rate _____ Proposed Quantity _____
This point is: Additional Well Geo Center List other water rights that will use this point _____

10. **Presently authorized point of diversion:**
One in the _____ Quarter of the _____ Quarter of the _____ Quarter
of Section _____, Township _____ South, Range _____ (E/W),
in _____ County, Kansas, _____ feet North _____ feet West of Southeast corner of section.
Authorized Rate _____ Authorized Quantity _____
(DWR use only: Computer ID No. _____ GPS _____ feet North _____ feet West)
 This point will not be changed This point will be changed as follows:
Proposed point of diversion: (Complete only if change is requested)
One in the _____ Quarter of the _____ Quarter of the _____ Quarter
of Section _____, Township _____ South, Range _____ (E/W),
in _____ County, Kansas, _____ feet North _____ feet West of Southeast corner of section.
Proposed Rate _____ Proposed Quantity _____
This point is: Additional Well Geo Center List other water rights that will use this point _____

11. Describe the current condition of and future plans for any point(s) of diversion which will no longer be used. _____

IF MORE SPACE IS NEEDED, ATTACH ADDITIONAL SHEETS AS NECESSARY

MAR 22 2024

KS Dept. of Agriculture

File No. 45502

12. The presently authorized use of water is for IRR purposes.
It is proposed that the use be changed to IRR purposes.

13. If changing the place of use and/or use made of water, describe how the consumptive use will not be increased.

Proposed adding acres to the water right under a 5 year allocation and monitoring by GMD3
KAR 5-5-11: NIR50% Stevens Co=1.23. Base acres=337 (in accordance with reduction order)
[(1.23 / 085) X 337] X 5 years = 2483.3AF/5 years, not to exceed 543AF in any one year

(Please show any calculations here.)

14. It is requested that the maximum annual quantity of water be reduced to _____ (acre-feet or million gallons).

15. It is requested that the maximum rate of diversion of water be reduced to _____ gallons per minute (_____ c.f.s.).

16. The application must include either a topographic map or detailed plat. A U.S. Geological Survey Topographic Map, scale 1:24,000, is available through the Kansas Geological Survey, 1930 Constant Avenue, University of Kansas, Lawrence, Kansas 66047-3726 (www.usgs.gov). The map should show the location of the presently authorized point(s) of diversion. Distances North and West of the Southeast corner of the section must be shown. The presently authorized place of use should also be shown. Identify the center of the section, the section lines and the section corners and show the appropriate section, township, and range numbers on the map. In addition the following information must also be shown on the map.

a. If a change in the location of the point(s) of diversion is proposed, show:

- 1) The location of the proposed point(s) of diversion. Distances North and West of the Southeast corner of the section must be shown. Please be certain that the information shown on the map agrees with the information shown in Paragraph Nos. 9, 10 and 11 of the application.
- 2) If the source of supply is groundwater, please show the location of existing water wells of any kind, including domestic wells, within 1/2 mile of the proposed well or wells. Identify each well as to its use and furnish name and mailing address of the property owner or owners. If there are no wells within 1/2 mile, please indicate so on the map.
- 3) If the source of supply is surface water, the names and mailing addresses of all landowner(s) 1/2 mile downstream and 1/2 mile upstream from your property lines must be shown.

b. If a change in the place of use is desired, show the proposed place of use by crosshatching on the map. Please be certain that the information shown on the map agrees with the information shown in Paragraph No. 5 of the application.

17. Attach documentation to show the change(s) proposed herein will not impair existing water rights and relates to the same local source of supply as to which the water right relates. This information may include statements, plats, geology reports, well logs, test hole logs, and other information as necessary information to show the above. Additional comments may be made below.

See attached plat

18. If the proposed change(s) does not meet all applicable rules and regulations of the Kansas Water Appropriation Act, please identify the rules and regulations for which you request a waiver. State the reason why a waiver is needed and why the request should be granted. Attach documentation showing that granting the request will not impair existing water rights and will not prejudicially and unreasonably affect the public interest.

Complies with KAR 5-5-11

IF MORE SPACE IS NEEDED, ATTACH ADDITIONAL SHEETS AS NECESSARY

MAR 22 2024

File No. 45502

KS Dept. of Agriculture

Any use of water that is not as authorized by the water right or permit to authorize water **before** the chief engineer approves this application is a violation of the Kansas Water Appropriation Act for which criminal or civil penalties may be assessed. Such violation is a class C misdemeanor, punishable by a fine not to exceed \$500 and/or a term of confinement not to exceed one month in the county jail. K.S.A. 82a-728(b). Civil penalties shall be not less than \$100 nor more than \$1,000 per violation. In the case of a continuing violation, each day such violation continues may be deemed a separate violation. In addition to these penalties the water right may be modified or suspended. K.S.A. 82a-737, as amended.

The application must be signed by all owners of the place of use authorized under the water right and his or her spouse, if married. Please indicate if there is no spouse. If land is being purchased under contract, the seller must sign as landowner until such time as the contract is completed.

In the event that all applicants cannot appear before one notary public, they may as necessary sign separate copies of the application before any notary public conveniently available to them. All copies signed in this manner shall be considered to be valid parts of the application.

If the request is signed on behalf of any Owner by someone with legal authority to do so (for example, an agent, one who has power of attorney, or an executor, executrix, conservator), it will be necessary to attach proper documents showing such authority

I declare that I am an owner of the currently authorized place of use as identified herein, or that I represent all such owners and am authorized to make this application on their behalf, and declare further that the statements contained herein are true, correct, and complete. By filing this application I authorize the chief engineer to permanently reduce the quantity of water and/or rate of diversion as specified in sections 14 and 15 of this application.

Dated at 2/23/24, Kansas, this _____ day of _____, 20_____.

Elise S. Heger
(Owner)

(Spouse)

Elise S. Heger
(Please Print)

(Please Print)

(Owner)

(Spouse)

(Please Print)

(Please Print)

(Owner)

(Spouse)

(Please Print)

(Please Print)

State of Kansas }
County of Douglas } SS

I hereby certify that the foregoing application was signed in my presence and sworn to before me this 23 day of February, 2024.

Kennedy Hicks-Miller
Notary Public



Kennedy Hicks-Miller
Notary Public
State of Kansas
My Appt. Exp. 03/08/2025

My Commission Expires 03/08/2025

FEE SCHEDULE

Each application to change the place of use, the point of diversion or the use made of the water under this section shall be accompanied by the application fee set forth in the schedule below:

- (1) Application to change a point of diversion 300 feet or less \$100
- (2) Application to change a point of diversion more than 300 feet \$200
- (3) Application to change the place of use \$200*
- (4) Application to change the use made of the water \$300

Make check payable to **Kansas Department of Agriculture**.

Change App. PU, File No. 45502

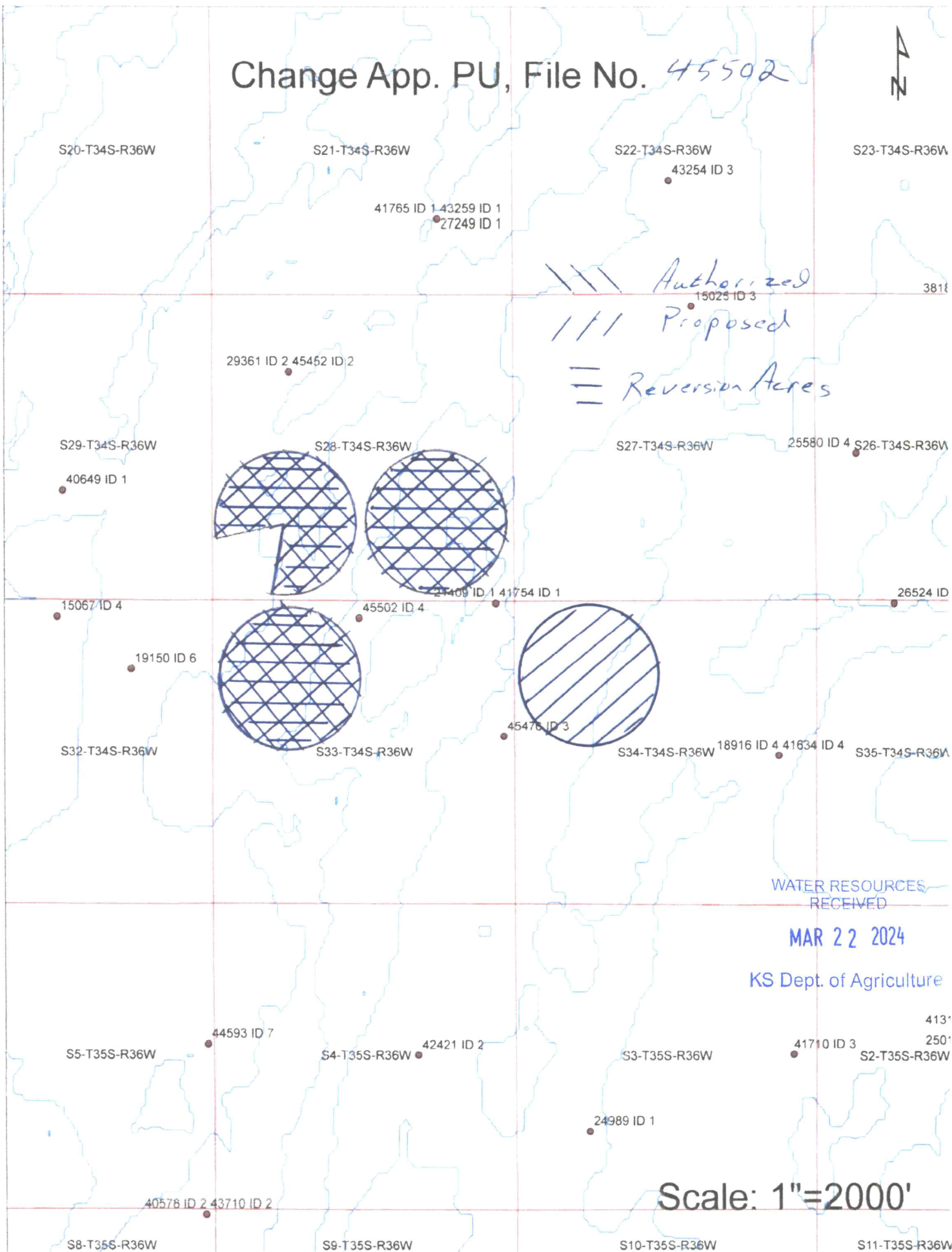

/// Authorized
/// Proposed
= Reversion Acres

WATER RESOURCES
RECEIVED

MAR 22 2024

KS Dept. of Agriculture

Scale: 1"=2000'

MAR 22 2024

KS Dept. of Agriculture

STATEMENT OF REVIEW
under K.A.R. 5-5-11(b)(3), (4) and (5)
for a Point of Diversion located within GMD No. 3

The items listed below were reviewed by the undersigned person(s) at _____
_____ Kansas, on this _____ day of _____
20_____. This review was related to the proposed *Change in Place of Use Under Water
Right* for File No. 45502

- (1) Water flow meters will be required on all wells authorized by the above-referenced file number. These flow meters shall be properly installed and maintained on each well to the satisfaction of the Chief Engineer. The metered quantity of water diverted during the past year by each well shall be reported on the annual water use report required by law to be provided to the Division of Water Resources (Division).
- (2) Southwest Kansas Groundwater Management District No. 3 (GMD No. 3) will make at least one visit per calendar year to this farm. The purpose of this visit is to monitor the compliance with conditions under which this change will be approved, if granted. Reports of verification of compliance and status reports will be completed by GMD No. 3 and furnished to the Division.
- (3) The amount of water required to irrigate the acreage proposed under this change application has been reviewed. The five-year allocation, if required, has been reviewed and is understood to be 2483.3 acre-feet. The five-year allocation is the quantity of water that will be authorized for diversion under this water right for each five-year period.
- (4) The approval of this application will be conditioned so that any use of water in excess of the five-year allocation will result in a two-year suspension of all water use under that water right and a subsequent restriction of the authorized place of use to a place of use equivalent to the base acres at a location specifically set forth on the change application approval.
- (5) For an application that proposes an increase in authorized acres solely for the purpose of rotation of the irrigated land within the authorized place of use, the base acres are _____ acres. The acres irrigated in any one calendar year shall not exceed _____ base acres each calendar year. The land to be irrigated will be certified to GMD No. 3 in writing before applying any water in that calendar year.
- (6) The approval of this application will be conditioned so that the use of water on more than the base acres certified to GMD No. 3 in any calendar year will result in a two-year suspension of all water use under this water right and a subsequent restriction of the authorized place of use equivalent to the base acres at a location specifically set forth on the change application approval.

MAR 22 2024

File No. 45502

KS Dept. of Agriculture

- (7) Changes in the Memorandum of Understanding between GMD No. 3 and the Division may affect the above-referenced files. If the Memorandum of Understanding related to K.A.R. 5-5-11 between the GMD No. 3 and the Division is rescinded because of the fault of GMD No. 3, the authorized place of use will revert to the equivalent of the base acres at a location specifically set forth in the change approval.

By signing below, I am indicating that I have reviewed and understand the items set forth above and agree that I am willing to abide by those conditions if my application for change in place of use is approved.

[Handwritten Signature]
Signature

Signature

Signature

Signature

State of Kansas)
County of Douglas)

I hereby certify that the foregoing document was signed in my presence and sworn before me this 23 day of February, 2024.

[Handwritten Signature]
Notary Public

My commission expires 03/08/2025



Kennedy Hicks-Miller
Notary Public
State of Kansas
My Appt. Exp. 03/08/2025

Signature, Division of Water Resources' Staff
Person Assisting in the Review

MAR 22 2024

KS Dept. of Agriculture

**Certification of Trust for the
Marigail Thomas Revocable Trust
dated July 6, 2022**

This Certification of Trust is signed by all the currently acting Trustees of the Marigail Thomas Revocable Trust dated July 6, 2022, who declare as follows:

1. The Grantor of the trust is Marigail Thomas. The trust is revocable by the Grantor.
2. The Trustees of the trust are Marigail Thomas (whose address is 1820 Road E, Hugoton, KS 67951), Elise S. Heger (whose address is 1901 University Dr., Lawrence, KS 66044), Marc P. Thomas (whose address is 123 N. Mars St., Wichita, KS 67212), and Amanda R. Vaughan (whose address is PO Box 903, Sublette, KS 67877). The signature of one Trustee is sufficient to exercise the power of the Trustee.
3. The tax identification number of the trust is 515-60-2970.
4. Title to assets held in the trust shall be titled as:

Marigail Thomas, Elise S. Heger, Marc P. Thomas, and
Amanda R. Vaughan, Trustees of the Marigail Thomas
Revocable Trust dated July 6, 2022,
and any amendments thereto.
5. Any alternative description shall be effective to title assets in the name of the trust or to designate the trust as a beneficiary if the description includes the name of at least one initial or successor trustee, any reference indicating that property is being held in a fiduciary capacity, and the date of the trust.
6. The powers of the Trustee include, but are not limited to, the following:
 - a. To hold, possess, manage, and to control the trust estate for the purposes and uses herein set forth; to borrow money from any source; to give security in the trust assets; to establish margin accounts with brokers and pledge securities in said accounts.
 - b. To invest and reinvest all or any part of the trust estate in such stocks, bonds, securities or other property, real or personal, as in its discretion it shall deem proper, without regard to statutes limiting the property which Trustees may purchase.
 - c. To vote, sell or trade any corporation stock or securities and to enter into any merger, reorganization or liquidation agreements.
 - d. To sell, transfer, exchange, or otherwise dispose of, any part of the trust estate, for cash or on terms, at public or private sale, and to pledge or encumber the same.
 - e. To lease any real estate held hereunder for any term, notwithstanding the duration of this trust.

MAR 22 2024

KS Dept. of Agriculture

- f. To execute and deliver any deeds, leases, assignments, or other instruments as may be necessary to carry out the provisions of this trust.
- g. To exercise any subscription rights in connection with any security held hereunder, and to consent to or participate in any reorganization, consolidation, or merger of any corporation, company or association, the securities of which may be held hereunder.
- h. To purchase securities or other property of any kind from the administrator or executor of the Donor's estate, without responsibility or liability for any loss resulting to the trust estate from such purchase.
- i. To make loans, secured or unsecured, to the administrator or executor of the Donor's estate, without responsibility or liability for any loss resulting to the trust estate from any such loan.
- j. To make any distribution hereunder either in kind or in money. Distribution in kind shall be made at the market value of the property distributed, and the Trustee may at its discretion, cause the share to be transferred to any distributee to be composed of property like or different from that transferred to any other distributee.
- k. To accept distribution from Donor's executor of any undivided interest in any asset not capable of convenient division, and to continue to hold such undivided interest as long as it deems it advisable to do so.

Additional powers are more specifically set out in the Trust Agreement, but include any and all powers set forth in the Uniform Trust Code of the State of Kansas and any and all relevant laws and regulations.

- 7. The terms of the trust agreement provide that a third party may rely upon this Certificate of Trust as evidence of the existence of the trust and is specifically relieved of any obligation to inquire into the terms of this agreement or the authority of the Trustee, or to see to the application that the Trustee makes of funds or other property received by the Trustee.

From time to time, third parties may require documentation to verify the existence of this agreement, or particular provisions of it, such as the name or names of the Trustee or the powers held by the Trustee. To protect the confidentiality of this agreement, the Trustee may use an affidavit or a certification of trust that identifies the Trustee and sets forth the authority of the Trustee to transact business on behalf of the trust in lieu of providing a copy of this agreement. The affidavit or certification may include pertinent pages from this agreement, such as title or signature pages.

The Certificate of Trust provided for in K.S.A. 58a-1013 "Certification of Trust", as amended shall be prepared and used exclusively as the representative authorized documentation of the trust. Only a qualified beneficiary may receive a full copy of the trust. Provided that, if a party other than a qualified beneficiary requests a full copy of the trust, such may, in the sole discretion of the Trustee be provided IF:

- a. Such requesting party has and provides legal documentation establishing a right to obtain a copy of the trust; and

MAR 22 2024

KS Dept. of Agriculture

- b. Such requesting party executes pursuant to proper authority an ACKNOWLEDGMENT OF LIABILITY which is in substantially the following form and language: "The undersigned requests portions of the Marigail Thomas Revocable Trust which exceed the information set out in the Certificate of Trust for such trust (herein "excess information"). In making this request, the undersigned represents that such request is made in good faith. "Good faith" means that the undersigned represents that there is a legally compelling reason to obtain and use such excess information and that such excess information is secure in the custody of the undersigned such that there will be no violation of the Privacy Act of 1974, as amended or other privacy expectation of Grantor, Trustee or any Beneficiary. Further, the undersigned understands, agrees and acknowledges that by receipt of the excess information portions of the Marigail Thomas Revocable Trust, which portions exceed the information in the Certificate of Trust for such trust, the undersigned is personally liable for any damages resulting from obtaining such excess information which is deemed wholly personal and private to Grantor, Trustee and Beneficiaries of such trust."

In no case are the dispositive terms of the trust to be disclosed to any party except those expressly authorized by law.

K.S.A. 58a-1013 (e) is to be considered by the Trustee as controlling the maximum disclosure allowance as to portions of the trust unless further disclosure is expressly authorized or required by law.

In summary, in the ordinary course of administration of the trust, the Certificate of Trust and only the directly operative empowerment portions of the trust are to be disclosed unless otherwise required by law which law is provided to Trustee before such disclosure.

Provided they act in good faith, a third party may rely upon an affidavit or certification of trust that is signed by the Trustee with respect to the representations contained in the affidavit or certification of trust. A third party, when relying in good faith upon an affidavit or certification of trust shall be exonerated from any liability for actions the third party takes or fails to take in such good faith reliance upon the representations contained in the affidavit or certification of trust.

A third party dealing with the Trustee shall not be required to inquire into the terms of this agreement or the authority of the Trustee, or to see to the application of funds or other property received by the Trustee. The receipt from the Trustee for any money or property paid, transferred or delivered to the Trustee will be a sufficient discharge to the person or persons paying, transferring or delivering the money or property from all liability in connection with its application. A written statement by the Trustee is conclusive evidence of the Trustee's authority. Third parties are not liable for any loss resulting from their reliance on a written statement by the Trustee asserting the Trustee's authority or seeking to effectuate a transfer of property to or from the trust.

8. The trust has not been revoked, modified or amended in any way that would cause the representations in this Certification of Trust to be incorrect.

MAR 22 2024

KS Dept. of Agriculture

Dated: July 7, 2022

Marigail Thomas
Marigail Thomas, Trustee

Elise S. Heger
Elise S. Heger, Trustee

Marc P. Thomas
Marc P. Thomas, Trustee

Amanda R. Vaughan
Amanda R. Vaughan, Trustee

STATE OF KANSAS)
) ss.
COUNTY OF Ford)

This instrument was acknowledged before me on July 7, 2022, by Marigail Thomas, as Trustee.

[Seal]

Nichole M. Byer
Notary Public

The commission expires: 6-11-2023

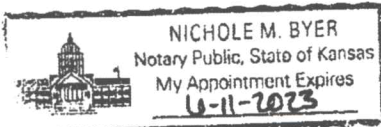

STATE OF KANSAS)
) ss.
COUNTY OF Ford)

This instrument was acknowledged before me on July 7, 2022, by Elise S. Heger, as Trustee.

[Seal]

Nichole M. Byer
Notary Public

The commission expires: 6-11-2023

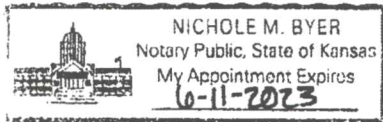

MAR 22 2024

KS Dept. of Agriculture

STATE OF KANSAS)
) ss.
COUNTY OF Ford)

This instrument was acknowledged before me on July 7, 2022, by
Marc P. Thomas, as Trustee.

[Seal]

Nichole M. Byer
Notary Public

The commission expires: 6-11-2023



STATE OF KANSAS)
) ss.
COUNTY OF Ford)

This instrument was acknowledged before me on July 7, 2022, by
Amanda R. Vaughan, as Trustee.

[Seal]

Nichole M. Byer
Notary Public

The commission expires: 6-11-2023

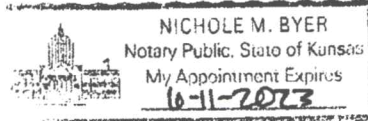

1320 Research Park Drive
Manhattan, KS 66502
785-564-6700
www. agriculture.ks.gov



900 SW Jackson, Room 456
Topeka, KS 66612
785-296-3556

Mike Beam, Secretary

Laura Kelly, Governor

March 29, 2024

MARIGAIL THOMAS REVOCABLE TRUST
1901 UNIVERSITY DR
LAWRENCE KS 66044

RE: File No(s). **45502**

Dear Sir or Madam:

The Division of Water Resources (Division) has received your application(s) to change the place of use, point of diversion or use made of water for the file number(s) referenced above. Please be aware that the Division may have a large number of pending applications on hand at times and makes every attempt to process them in the order in which they are received. You will be contacted if additional information is required.

Please note, this letter only acknowledges receipt of your application(s) and does not guarantee approval. In accordance with the provisions of the Kansas Water Appropriation(s) Act, the use of water as proposed prior to approval of the application(s) is unlawful.

Additional information about the process may be found on our website at agriculture.ks.gov/divisions-programs/dwr. If you have any other questions, please contact our office at 785-564-6640 or your local Garden City Field Office at 620-276-2901. If you call, please reference the file number so we can help you more efficiently.

Sincerely,

Kristen Baum
New Applications and Changes Supervisor
Water Appropriation Program