

Kansas Department of Agriculture  
 Division of Water Resources  
**CHANGE: P/U WORKSHEET**

1. File Number: <b>HS 003</b>	2. Status Change Date: <b>3-11-2024</b>	3. Change Num: <b>C2</b>	4. Field Office: <b>4</b>	5. GMD: <b>3</b>
----------------------------------	--	-----------------------------	------------------------------	---------------------

6. Status: <input checked="" type="checkbox"/> Approved <input type="checkbox"/> Denied by DWR/GMD <input type="checkbox"/> Dismiss by Request/Failure to Return	7. Filing Date of Change: <b>3/06/2024</b>
--	---

8a. Landowner, applicant,    Person ID <u>5865</u> New to system <input type="checkbox"/> Add Seq# _____  <b>GARETSON BROTHERS</b> <b>695 RD XX</b> <b>COPELAND, KS 67837</b>	8c.    Person ID _____ New to system <input type="checkbox"/> Add Seq# _____
--	---

8b. Landowner(s)    Person ID _____ New to system <input type="checkbox"/> Add Seq# _____	8d. WUC    Person ID <u>25330</u> New to system <input type="checkbox"/> Add Seq# _____  <b>JARVIS GARETSON</b> <b>695 RD XX</b> <b>COPELAND, KS 67837</b>
--	---

9. Documents and Enclosure(s):  DWR Meter(s) Date to Comply: 12/31/2024     N & P Date to Comply: \_\_\_\_\_

Anti-Reverse Meter     Meter Seal     Check Valve     N & P Form     Water Tube     Driller Copy     H & E Letter

Conservation Plan    Date Required: \_\_\_\_\_    Date Approved: \_\_\_\_\_    Date to Comply: \_\_\_\_\_

10. Use Made of Water    From: \_\_\_\_\_    To: \_\_\_\_\_

REMOVED "WILDHAWK" FROM PERSON ID AND WUC	Date Prepared: <b>3/7/2024</b>	By: <b>MAM</b>
	Date Entered: _____	By: _____

File No. **HS 003**      11. County: HS      Basin: ARKANSAS RIVER      Stream:      Formation Code:      Special Use:

12. Points of Diversion  
 CHK  
 MOD  
 DEL      PDIV  
 ENT  
 Qualifier      S      T      R      ID      'N      'W      Comment (AKA Line)      Rate gpm      Quantity af      Additional Rate gpm      Quantity af      Overlap PD Files

**CHK 72530**

13. Storage: Rate \_\_\_\_\_ NF      Quantity \_\_\_\_\_ ac/ft      Additional Rate \_\_\_\_\_ NF      Additional Quantity \_\_\_\_\_ ac/ft

14. Limitation: \_\_\_\_\_ af/yr at \_\_\_\_\_ gpm (\_\_\_\_\_ cfs) when combined with file number(s) \_\_\_\_\_  
 Limitation: \_\_\_\_\_ af/yr at \_\_\_\_\_ gpm (\_\_\_\_\_ cfs) when combined with file number(s) \_\_\_\_\_

15. 5YR Allocation:      Allocation Type \_\_\_\_\_      Start Year \_\_\_\_\_      5 YR Amount \_\_\_\_\_      Amount Unit \_\_\_\_\_      Base Acres \_\_\_\_\_      Comment \_\_\_\_\_

16. Place of Use CHK MOD DEL ENT      PUSE      S      T      R      ID	NE¼				NW¼				SW¼				SE¼				Total	Owner	Chg?	Overlap Files
	NE ¼	NW ¼	SW ¼	SE ¼	NE ¼	NW ¼	SW ¼	SE ¼	NE ¼	NW ¼	SW ¼	SE ¼	NE ¼	NW ¼	SW ¼	SE ¼				
<b>MOD 5347 36 27S 31W 01</b>	13	36	40	36	40	31.25	31.25	40	40	31.5	13	36	36	40	36	13	513	<b>8a</b>	<b>N 8157</b>	
<b>DEL 23721</b>																				

Base Acres: **503**      Year:      Minimum Reasonable Quantity:  
 Comments:

Garden City Field Office  
4532 W. Jones, Suite B  
Garden City, KS 67846



Phone: 620-276-2901  
Fax: 620-276-9315  
www.agriculture.ks.gov

Mike Beam, Secretary

Laura Kelly, Governor

March 11, 2024

JARVIS GARETSON  
695 RD XX  
COPELAND, KS 67837

RE: Field Office Application for Change  
Vested Right, File No. HS 003  
Water Right, File No. 8157

Dear Madam or Sir:

Enclosed are orders executed by the designee of the Chief Engineer, Division of Water Resources, Kansas Department of Agriculture, approving the applications for change under the above referenced file numbers.

Your attention is directed to the enclosures and to the terms, conditions, and limitations specified in these approvals for change. A condition of this approval is that an acceptable water flow meter must be installed on the diversion works authorized under the referenced file number and meet current specifications. Please return the required notification of completion of the diversion works and installation of the required meter as soon as these actions are completed.

Since the orders modify the original documents referred to above, it should be recorded with the Register of Deeds as other instruments affecting real estate.

Should you have any questions, please feel free contact this office. If you would prefer, you could arrange an appointment for additional assistance.

Sincerely,

A handwritten signature in blue ink that reads "Michael A. Meyer". The signature is fluid and cursive, with a long horizontal stroke at the end.

Michael A. Meyer  
Water Commissioner

MAM:  
Enclosures  
pc: GMD3

### CERTIFICATE OF SERVICE

On this 11<sup>th</sup> day of March 2024, I hereby certify that the foregoing Approval of Application for Change in Place of Use, Vested Right, File No. HS 003 and Water Right, File Nos. 8,157 dated 11<sup>th</sup> day of March 2024 was mailed postage prepaid, first class, US mail to the following:

JARVIS GARETSON  
695 RD XX  
COPELAND, KS 67837

pc:  
GMD3

A handwritten signature in blue ink that reads "Julie Jones". The signature is written in a cursive style and is positioned above a horizontal line.

Division of Water Resources Staff



Submit completed application to:  
 Kansas Department of Agriculture  
 Division of Water Resources  
 Field Office for your area.

Call for address:

Topeka -- (785) 296-5733  
 Stafford -- (620) 234-5311  
 Stockton -- (785) 425-6787  
 Garden City -- (620) 276-2901  
<http://agriculture.ks.gov/dwr>

## DWR FIELD OFFICE APPLICATION FOR APPROVAL TO CHANGE THE PLACE OF USE AND/OR THE POINT OF DIVERSION



**STATE OF KANSAS**

**Filing Fee Must Accompany the Application, K.S.A. 82a-708b(b), as amended.**  
 Fee Schedule is on the third page of this application form.

**Paragraph Nos. 1, 2, 3 & 5 must be completed. Complete all other applicable portions.** If change in point of diversion is greater than 100 feet, or if place of use will be changed, include a topographic map or detailed plat showing the authorized and proposed point(s) of diversion and/or place of use.

File No. HS 003

**RECEIVED**  
*2:13pm*  
**MAR 06 2024**

Garden City Field Office  
 Division of Water Resources

1. Application is hereby made for approval of the Chief Engineer to change the (check one or both):

Place of Use                       Point of Diversion

under the water right which is the subject of this application in accordance with the conditions described below.

The source of supply is:                       Groundwater                       Surface water

2. Name and address of Applicant: JARVIS GARETSON

695 RD XX, COPELAND KS, 67837

Phone Number: (     )                      Email address: \_\_\_\_\_

Name and address of Water Use Correspondent: JARVIS GARETSON

Phone Number: (     )                      Email address: garetsonbrothers@yahoo.com

3. The presently authorized place of use is:

Owner of Land ---- NAME: GARETSON BROTHERS

ADDRESS: 695 RD XX, COPELAND KS 67837

(If there is more than one landowner, attach supplemental sheets as necessary.)

Sec.	Twp.	Range	NE¼				NW¼				SW¼				SE¼				TOTAL ACRES
			NE¼	NW¼	SW¼	SE¼	NE¼	NW¼	SW¼	SE¼	NE¼	NW¼	SW¼	SE¼	NE¼	NW¼	SW¼	SE¼	
36	27	31W	40	40	40	40	40	28		32	40	31	13	40	36	40	36	12.6	508.6

4. If this application is for a change in place of use, it is proposed that the place of use be changed to:

Owner of Land ---- NAME: GARETSON BROTHERS

ADDRESS: 695 RD XX, COPELAND KS 67837

(If there is more than one landowner, attach supplemental sheets as necessary.)

Sec.	Twp.	Range	NE¼				NW¼				SW¼				SE¼				TOTAL ACRES
			NE¼	NW¼	SW¼	SE¼	NE¼	NW¼	SW¼	SE¼	NE¼	NW¼	SW¼	SE¼	NE¼	NW¼	SW¼	SE¼	
36	27	31W	13	36	40	36	40	31.25	31.25	40	40	31.50	13	36	36	40	36	13	513

For Office Use Only: Code \_\_\_\_\_ Fee \$200.00 TR # \_\_\_\_\_ Receipt Date 3-6-2024 Check # 11196

5. **Presently authorized point of diversion:**  
 One in the \_\_\_\_\_ Quarter of the \_\_\_\_\_ Quarter of the \_\_\_\_\_ Quarter  
 of Section \_\_\_\_\_, Township \_\_\_\_\_ South, Range \_\_\_\_\_ (E/W),  
 in \_\_\_\_\_ County, Kansas, \_\_\_\_\_ feet North \_\_\_\_\_ feet West of Southeast corner of section.  
 Authorized Rate \_\_\_\_\_ Authorized Quantity \_\_\_\_\_ Depth of well \_\_\_\_\_ (feet)  
**(DWR use only: Computer ID No. \_\_\_\_\_ GPS \_\_\_\_\_ feet North \_\_\_\_\_ feet West)**  
 This point will not be changed  This point will be changed as follows:  No change, point better described with GPS as follows:  
**Proposed point of diversion: (Complete only if change is requested or if existing point is better described by GPS)**  
 One in the \_\_\_\_\_ Quarter of the \_\_\_\_\_ Quarter of the \_\_\_\_\_ Quarter  
 of Section \_\_\_\_\_, Township \_\_\_\_\_ South, Range \_\_\_\_\_ (E/W),  
 in \_\_\_\_\_ County, Kansas, \_\_\_\_\_ feet North \_\_\_\_\_ feet West of Southeast corner of section.  
 Proposed Rate \_\_\_\_\_ Proposed Quantity \_\_\_\_\_ Proposed well depth (feet) \_\_\_\_\_  
 This point is:  Additional Well  Geo Center List other water rights that will use this point \_\_\_\_\_

6. **Presently authorized point of diversion:**  
 One in the \_\_\_\_\_ Quarter of the \_\_\_\_\_ Quarter of the \_\_\_\_\_ Quarter  
 of Section \_\_\_\_\_, Township \_\_\_\_\_ South, Range \_\_\_\_\_ (E/W),  
 in \_\_\_\_\_ County, Kansas, \_\_\_\_\_ feet North \_\_\_\_\_ feet West of Southeast corner of section.  
 Authorized Rate \_\_\_\_\_ Authorized Quantity \_\_\_\_\_ Depth of well \_\_\_\_\_ (feet)  
**(DWR use only: Computer ID No. \_\_\_\_\_ GPS \_\_\_\_\_ feet North \_\_\_\_\_ feet West)**  
 This point will not be changed  This point will be changed as follows:  No change, point better described with GPS as follows:  
**Proposed point of diversion: (Complete only if change is requested or if existing point is better described by GPS)**  
 One in the \_\_\_\_\_ Quarter of the \_\_\_\_\_ Quarter of the \_\_\_\_\_ Quarter  
 of Section \_\_\_\_\_, Township \_\_\_\_\_ South, Range \_\_\_\_\_ (E/W),  
 in \_\_\_\_\_ County, Kansas, \_\_\_\_\_ feet North \_\_\_\_\_ feet West of Southeast corner of section.  
 Proposed Rate \_\_\_\_\_ Proposed Quantity \_\_\_\_\_ Proposed well depth (feet) \_\_\_\_\_  
 This point is:  Additional Well  Geo Center List other water rights that will use this point \_\_\_\_\_

7. The changes herein are desired for the following reasons?  
 (please be specific) \_\_\_\_\_  
 \_\_\_\_\_  
 \_\_\_\_\_

8. If a well, is the test hole log attached?  Yes  No

9. The change(s) (was)(will be) completed by?  
 \_\_\_\_\_  
 \_\_\_\_\_

10. If the point of diversion is a well:  
 (a) What are you going to do with the old well?  
 \_\_\_\_\_  
 (b) When will this be done? \_\_\_\_\_

11. Groundwater Management District recommendation attached?  
 Yes  No

12. Assisted by \_\_\_\_\_

13a. If the proposed point of diversion will be relocated more than 300 feet but within 2,640 feet of the existing point of diversion, attach a topographic map or aerial photograph. For groundwater sources, show all wells (including domestic) within one-half mile of the proposed point of diversion and the names and mailing addresses of the owners. For surface water sources, show the names and addresses of the landowner(s) one-half mile downstream and one-half mile upstream from your property lines

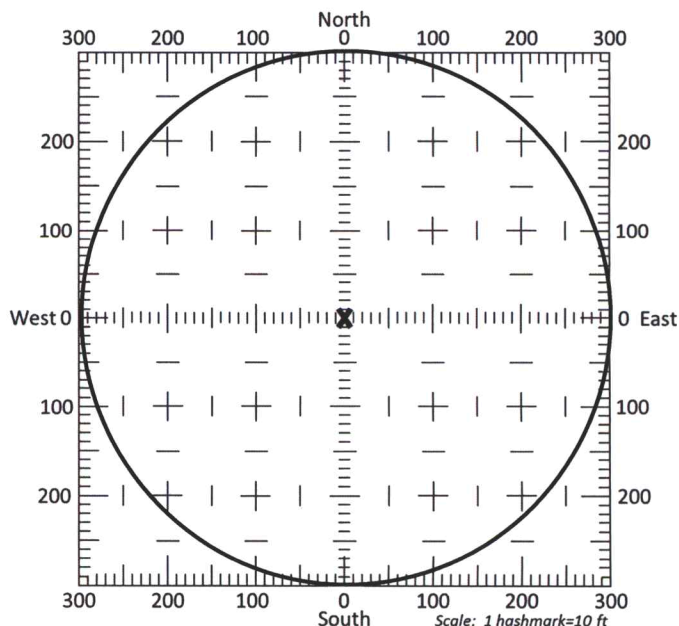

13b. If the proposed point of diversion will be relocated within a 300 foot radius of the existing point of diversion, indicate its location on the diagram shown above in relation to the existing point of diversion. The proposed point of diversion must be located within the circle shown above. **(PLEASE NOTE: The "X" in center of diagram above represents the presently authorized point of diversion.)**



14. If the proposed groundwater point of diversion is 300 or fewer feet from the existing point of diversion, complete the following:
- (a) Does the undersigned represent all owners of the currently authorized place(s) of use identified in this application?  
 Yes     No    (If no, all owners must sign this application.)
  - (b) Will the ownership interest of any owner of the currently authorized place(s) of use identified in this application be adversely affected if this application is approved as requested?  
 Yes     No    (If yes, all owners must sign this application.)
  - (c) If this application is not approved expeditiously, will there be substantial damage to property, public health or safety?  
 Yes     No    (If no, all owners must sign this application.)

If the application proposes a surface water change in point of diversion, a groundwater change in point of diversion greater than 300 feet, or a change in place of use, the application must be signed by all owners of the currently authorized place of use, or their duly authorized agent (attach notarized statement authorizing representation).

**I hereby verify, being first duly sworn upon my oath or affirmation and under penalty of perjury, that I am of lawful age and the owner, the spouse of the owner, or a duly authorized agent of the owner(s) to make this application on their behalf, in regards to the water right(s) to which this application pertains. I further verify that the statements contained in this application are true, correct and complete.**

Dated at Garden City, Kansas, this 5<sup>th</sup> day of March, 2024.

<u>Garetson Brothers by Garetson</u> (Owner)	_____ (Spouse)
<u>Garetson Brothers by Jarvis Garetson</u> (Please Print)	_____ (Please Print)
_____ (Owner)	_____ (Spouse)
_____ (Please Print)	_____ (Please Print)
_____ (Owner)	_____ (Spouse)
_____ (Please Print)	_____ (Please Print)

State of Kansas }  
 County of Jimney } SS

I hereby certify that the foregoing application was signed in my presence and sworn to before me this 5<sup>th</sup> day of March, 2024.

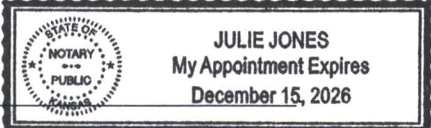

My Commission Expires \_\_\_\_\_

Julie Jones  
Notary Public

**ONLY COMPLETE APPLICATIONS WILL BE PROCESSED.** To be complete, all of the applicable portions of the application form must be completed with accurate information; maps, if necessary, must be included; signatures of all the appropriate owners' must be affixed to the application and notarized; and the appropriate fee must be paid.

**FEE SCHEDULE**

Each application to change the place of use or the point of diversion under this section shall be accompanied by the application fee set forth in the schedule below: Make checks payable to: **Kansas Department of Agriculture**

(1) Application to change a point of diversion 300 feet or less	\$100
(2) Application to change a point of diversion more than 300 feet	\$200
(3) Application to change the place of use	\$200





# FILE NOS. HS 003 AND 8157

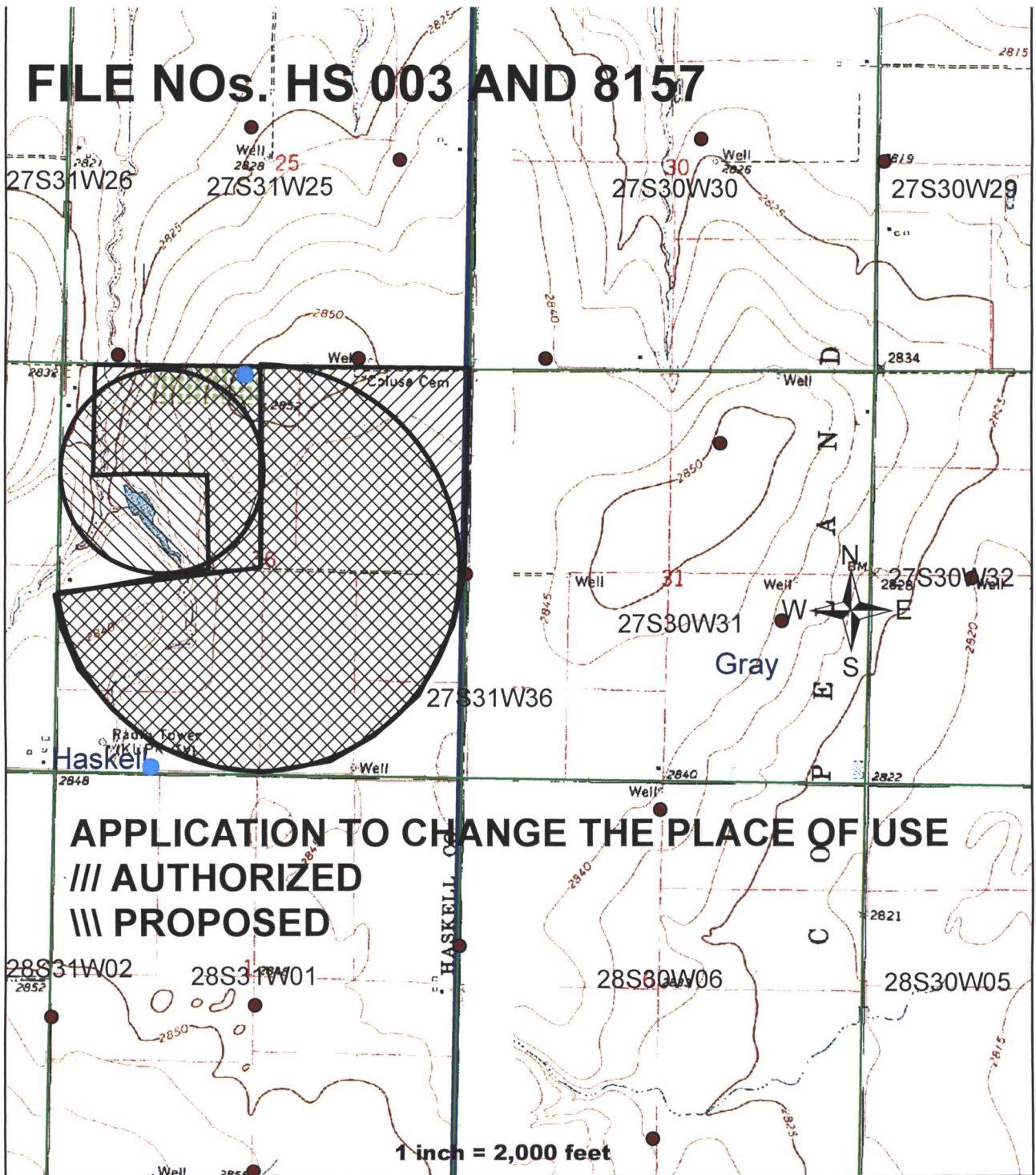

**APPLICATION TO CHANGE THE PLACE OF USE**  
**/// AUTHORIZED**  
**\\\\ PROPOSED**

1 inch = 2,000 feet

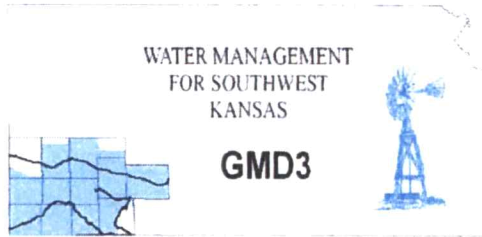

**Southwest Kansas**  
**Groundwater Management District No. 3**  
**2009 E. Spruce Street**  
**Garden City, Kansas 67846**  
(620) 275-7147 phone  
www.gmd3.org

March 8, 2024

Michael A. Meyer  
Division of Water Resources  
4532 W Jones Ave., Suite B  
Garden City, Kansas 67846

RE: Applications for Change in Place of Use  
Vested Right HS03  
Water Right, File No. 8157

RECEIVED

MAR 08 2024

Garden City Field Office  
Division of Water Resources

Dear Mike:

We have completed a review of the applications for the above referenced water rights. The proposals are not in conflict with the Management Program of the Southwest Kansas Groundwater Management District No. 3 (GMD3). The proposed change in place of use will maintain a complete overlap in authorized place of use in accordance with K.A.R. 5-5-11(b) while rearranging acres to better suit the operation. Staying within allowable base acres expansion. It is therefore recommended that the applications be approved at this time.

Thank you for the opportunity to review the applications and to provide a recommendation. If you have any questions, please don't hesitate to contact us.

Sincerely,

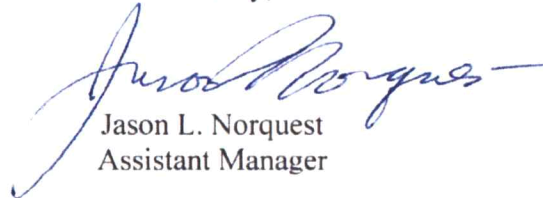

Jason L. Norquest  
Assistant Manager

## GMD3 Change Review

---

File No(s): HS03, 8157.

DWR office: GC.

App filed to change: PU.

Is Landowner(s) correct in WRIS: Jarvis Garetson.

If NO, is documentation included?

Is Water Use Correspondent correct in WRIS?   .

If NO, is documentation included?

Regulation(s) Reviewed: KAR 5-5-11

Point of diversion ID No(s)    being changed.

	ft. North	ft. West
Authorized PD		
Proposed PD		
Difference	0	0
$a^2 + b^2 = c^2$	0	0
		0

GPS for proposed PD: Lat:    Long:   .

Is proposed PD stacking on existing WRs? No Changes.

Is Proposed PU overlapping existing WRs? Making complete overlap and rearranging.

Neighboring certified well(s) notified:   .

Name   .

Address   .

Zip   .

Email:    Phone:   .

Domestic well(s) notified:   .

Name   .

Address   .

Zip   .

Base Acres: 500-503.

Perfected Acres:   .

Irr. Return-Flow   %

**Haskell County**

**HS03: 240AF @ 601gpm**

**All acres in 36-27-31, total of 508.6**

**NE: 160 acres**

**NW: 100 acres**

**SW: 124 acres**

**SE: 124.6 acres**

**8157: 2 PDs, combined allocation 930AF @ 2115gpm, Limited 960AF@2716gpm w/HS03**

**Same acres as HS03**



## GMD3 Change Review

---

**Proposed acres: total of 513**

**NE: 125acres**

**NW: 142.5acres**

**SW: 120.5acres**

**SE: 125acres**

**3quarters covered by half mile pivot. NW quarter proposes a quarter mile pivot.**

Is a waiver needed: Rearranging acres for operation, just over the base acres which is allowed. Maintaining complete overlap with the water rights.

Recommendation: After review of information, it appears current area rules are met. Staff recommends approval of the applications.



RECEIVED

MAR 08 2024

Garden City Field Office  
Divison of Water Resources

Garden City Field Office  
4532 W. Jones, Suite B  
Garden City, KS 67846



Phone: 620-276-2901  
Fax: 620-276-9315  
[www.agriculture.ks.gov](http://www.agriculture.ks.gov)

Mike Beam, Secretary

Laura Kelly, Governor

March 6, 2024

SOUTHWEST KANSAS GROUNDWATER  
MANAGEMENT DISTRICT NO. 3  
2009 E SPRUCE ST  
GARDEN CITY KS 67846

Re: Request for Recommendation  
Vested Right, File No. HS 003  
Water Right, File No. 8157

Dear Mr. Norquest:

This is to advise you of applications for approval of the Chief Engineer, Division of Water Resources, Kansas Department of Agriculture, to change the place of use.

We are delaying action on the change applications to allow you time to review and provide a recommendation. Please submit a recommendation within 15 days from the date of this letter.

Thank you and as always feel free to contact this office at any time.

Sincerely,

A handwritten signature in blue ink that reads "Michael A. Meyer".

Michael A. Meyer  
Water Commissioner

MAM  
Enclosures