

**Kansas Department of Agriculture
Division of Water Resources**

1. File No.: 10396		2. Status Change Date:		4. Field Office: 04 - Garden City GMD: 03 - Southwest Structures File No.: Filing/Priority Date: 03/21/2025 Application Complete Date: 03/28/2025		
3. Package File No(s):						
5a. <input type="checkbox"/> Applicant <input checked="" type="checkbox"/> Owner <input checked="" type="checkbox"/> WUC <input type="checkbox"/> Address Change JACOB & SARA NEUDORF 757 YY ROAD COPELAND, KS 67837-7001		Person ID 66412 Add Seq#		5b. <input checked="" type="checkbox"/> Owner <input type="checkbox"/> WUC <input type="checkbox"/> Address Change EMERY F JOSSERAND LLC 1827 N DENISE MARIE ST WICHITA, KS 67212-7408		
5c. <input type="checkbox"/> Owner <input type="checkbox"/> WUC <input type="checkbox"/> Address Change		Person ID Add Seq#		5d. <input type="checkbox"/> Owner <input type="checkbox"/> WUC <input type="checkbox"/> Address Change Person ID Add Seq#		
6. Change No.: 5 <input type="checkbox"/> PD <input checked="" type="checkbox"/> PU <input type="checkbox"/> UMW Base Acres: Year: Min Reasonable Q: Previous UMW: MDS Gauge: Active Admin? <input type="checkbox"/> Completion/Start Date: Perfection/Expiration Date:				7. Use of Water <input checked="" type="checkbox"/> Groundwater <input type="checkbox"/> Surface Water UMW: IRR-Irrigation UMW: UMW:		
8. Action Trail						
9. Special Conditions						
10. 5YR Allocation		Type:	Start Year:	5YR Quantity:	Base Acres:	
		Comment:				
11. Sand & Gravel Proj ID: <input type="checkbox"/> Active <input type="checkbox"/> Dredge <input type="checkbox"/> IND Evap <input type="checkbox"/> Jr Evap <input type="checkbox"/> Other Diversion <input type="checkbox"/> Rpt on Sr						
12. Waiver Rule ID: <input type="checkbox"/> New Date Requested: Applies: Rule No.: Justification: Rule Type: Rule SubType:						
Comments				Processed 03/31/2025 MAM		Entered
				Reviewed		

File No. 10396	13. County: GY Basin: ARKANSAS RIVER Stream:									
Structures File No:	Aquifer Code:					Special Use Area:				

14. Points of Diversion, Rates & Quantities										Qty AF		Rate gpm		Storage Qty		Storage Rate	
PDIV	Qualifier	S	T	R	ID	'N	'W	Comment (AKA Line)	Auth	Add	Auth	Add	Auth	Add	Auth/Add	Overlaps	
CHK 66268																	

15. Limitations	Type:	Quantity:	Rate:	combined with file no(s):
	Type:	Quantity:	Rate:	combined with file no(s):

16. Metering	<input checked="" type="checkbox"/> Metering Required	<input type="checkbox"/> Anti-Reverse Required	<input type="checkbox"/> Seal Required	Compliance Date: 12/31/2025
--------------	---	--	--	-----------------------------

17. Place of Use						NE¼				NW¼				SW¼				SE¼				Total	Owner(s)	Chg?	Overlaps
PUSE	S	T	R	ID		NE	NW	SW	SE	NE	NW	SW	SE	NE	NW	SW	SE	NE	NW	SW	SE				
MOD 2622	7	28	30W	3		30.5	30.5	37.5	37.5	31	L-1 31	L-2 31	31										260	8a	<input type="checkbox"/> *
CHK 62453	7	28	30W	4														40	40				80	8b	<input type="checkbox"/> *
CHK 17078	1	28	30W	2		L-1 30.5	L-2 30.5	30.5	30.5									35.5	40	40	40		277.50	8a	<input type="checkbox"/> *
CHK 18034	6	28	30W	3						30.25	L-1 30.25	L-2 30.25	30.25	30.25	L-3 30.25	L-4 30.25	30.25	30.25	30.25	30.25	30.25		363	8a	<input type="checkbox"/> *
ENT	12	28	31W				28.98	28.98															57.96	8a	<input type="checkbox"/> *

18. Point of Diversion and Place of Use Overlaps * 17546, 17743, 28858, 31007 + # ^	** ++ ## ^^
---	----------------------

Garden City Field Office
4532 W. Jones, Suite B
Garden City, KS 67846



Phone: 620-276-2901
Fax: 620-276-9315
www.agriculture.ks.gov

Mike Beam, Secretary

Laura Kelly, Governor

March 31, 2025

JACOB & SARA NEUDORF
757 YY ROAD
COPELAND, KS 67837-7001

RE: Field Office Application for Change
Water Right, File Nos. 10396, 17546, 17743, 28858, 31007

Dear Sir:

Enclosed are orders executed by the designee of the Chief Engineer, Division of Water Resources, Kansas Department of Agriculture, approving the applications for change under the above referenced file numbers.

Your attention is directed to the enclosures and to the terms, conditions, and limitations specified in these approvals for change. A condition of this approval is that an acceptable water flow meter must be installed on the diversion works authorized under the referenced file number and meet current specifications. Please return the required notification of completion of the diversion works and installation of the required meter as soon as these actions are completed.

Since the orders modify the original documents referred to above, they should be recorded with the Register of Deeds as other instruments affecting real estate.

Should you have any questions, please feel free contact this office. If you would prefer, you could arrange an appointment for additional assistance.

Sincerely,

A handwritten signature in blue ink, reading "Michael A. Meyer".

Michael A. Meyer
Water Commissioner

MAM:
Enclosures

pc: EMERY F JOSSERAND LLC
GMD3

CERTIFICATE OF SERVICE

On this 31st day of March 2025, I hereby certify that the foregoing Approvals of Application for Change in Place of use, Water Right, File Nos. 10396, 17546, 17743, 28858, 31007 dated 31st day of March 2025 was mailed postage prepaid, first class, US mail to the following:

JACOB & SARA NEUDORF
757 YY ROAD
COPELAND, KS 67837-7001

Pc:

EMERY F JOSSERAND LLC
1827 N DENISE MARIE ST
WICHITA, KS 67212-7408

GMD3

A handwritten signature in blue ink, reading "Aaron Holsted", is written over a horizontal line.

Division of Water Resources Staff

Submit completed application to:
Kansas Department of Agriculture
Division of Water Resources
Field Office for your area.
Call for address:

Topeka -- (785) 296-5733
Stafford -- (620) 234-5311
Stockton -- (785) 425-6787
Garden City -- (620) 276-2901
<http://agriculture.ks.gov/dwr>

DWR FIELD OFFICE APPLICATION FOR APPROVAL TO CHANGE THE PLACE OF USE AND/OR THE POINT OF DIVERSION



STATE OF KANSAS

Filing Fee Must Accompany the Application, K.S.A. 82a-708b(b), as amended.
Fee Schedule is on the third page of this application form.

Paragraph Nos. 1, 2, 3 & 5 must be completed. Complete all other applicable portions. If change in point of diversion is greater than 100 feet, or if place of use will be changed, include a topographic map or detailed plat showing the authorized and proposed point(s) of diversion and/or place of use.

RECEIVED
3:40 pm
MAR 21 2025

Garden City Field Office
Division of Water Resources

File No. 10396

1. Application is hereby made for approval of the Chief Engineer to change the (check one or both):

☒ Place of Use ☐ Point of Diversion

under the water right which is the subject of this application in accordance with the conditions described below.

The source of supply is: ☒ Groundwater ☐ Surface water

2. Name and address of Applicant: JACOB NEUDORF

Phone Number: () Email address:

Name and address of Water Use Correspondent: SAME AS ABOVE

Phone Number: () Email address:

3. The presently authorized place of use is:

Owner of Land ---- NAME: SEE SUPPLEMENTAL SHEET

ADDRESS:

(If there is more than one landowner, attach supplemental sheets as necessary.)

Sec.	Twp.	Range	NE¼				NW¼				SW¼				SE¼				TOTAL ACRES
			NE¼	NW¼	SW¼	SE¼	NE¼	NW¼	SW¼	SE¼	NE¼	NW¼	SW¼	SE¼	NE¼	NW¼	SW¼	SE¼	

4. If this application is for a change in place of use, it is proposed that the place of use be changed to:

Owner of Land ---- NAME: SEE SUPPLEMENTAL SHEET

ADDRESS:

(If there is more than one landowner, attach supplemental sheets as necessary.)

Sec.	Twp.	Range	NE¼				NW¼				SW¼				SE¼				TOTAL ACRES
			NE¼	NW¼	SW¼	SE¼	NE¼	NW¼	SW¼	SE¼	NE¼	NW¼	SW¼	SE¼	NE¼	NW¼	SW¼	SE¼	

For Office Use Only: Code CPU Fee \$ 200.00 TR # Receipt Date 3-21-25 Check # CC

5. **Presently authorized point of diversion:**
 One in the _____ Quarter of the _____ Quarter of the _____ Quarter
 of Section _____, Township _____ South, Range _____ (E/W),
 in _____ County, Kansas, _____ feet North _____ feet West of Southeast corner of section.
 Authorized Rate _____ Authorized Quantity _____ Depth of well _____ (feet)
(DWR use only: Computer ID No. _____ GPS _____ feet North _____ feet West)
☐ This point will not be changed ☐ This point will be changed as follows: ☐ No change, point better described with GPS as follows:
Proposed point of diversion: (Complete only if change is requested or if existing point is better described by GPS)
 One in the _____ Quarter of the _____ Quarter of the _____ Quarter
 of Section _____, Township _____ South, Range _____ (E/W),
 in _____ County, Kansas, _____ feet North _____ feet West of Southeast corner of section.
 Proposed Rate _____ Proposed Quantity _____ Proposed well depth (feet) _____
 This point is: ☐ Additional Well ☐ Geo Center List other water rights that will use this point _____

6. **Presently authorized point of diversion:**
 One in the _____ Quarter of the _____ Quarter of the _____ Quarter
 of Section _____, Township _____ South, Range _____ (E/W),
 in _____ County, Kansas, _____ feet North _____ feet West of Southeast corner of section.
 Authorized Rate _____ Authorized Quantity _____ Depth of well _____ (feet)
(DWR use only: Computer ID No. _____ GPS _____ feet North _____ feet West)
☐ This point will not be changed ☐ This point will be changed as follows: ☐ No change, point better described with GPS as follows:
Proposed point of diversion: (Complete only if change is requested or if existing point is better described by GPS)
 One in the _____ Quarter of the _____ Quarter of the _____ Quarter
 of Section _____, Township _____ South, Range _____ (E/W),
 in _____ County, Kansas, _____ feet North _____ feet West of Southeast corner of section.
 Proposed Rate _____ Proposed Quantity _____ Proposed well depth (feet) _____
 This point is: ☐ Additional Well ☐ Geo Center List other water rights that will use this point _____

7. The changes herein are desired for the following reasons?
 (please be specific) MOVING UNIRRIGATED ACRES

If a well, is the test hole log attached? ☐ Yes ☐ No

8. The change(s) (was)(will be) completed by?

9. If the point of diversion is a well:

(a) What are you going to do with the old well?

(b) When will this be done? _____

10. Groundwater Management District recommendation attached?
☐ Yes ☒ No

11. Assisted by AARON HESS

13a. If the proposed point of diversion will be relocated more than 300 feet but within 2,640 feet of the existing point of diversion, attach a topographic map or aerial photograph. For groundwater sources, show all wells (including domestic) within one-half mile of the proposed point of diversion and the names and mailing addresses of the owners. For surface water sources, show the names and addresses of the landowner(s) one-half mile downstream and one-half mile upstream from your property lines

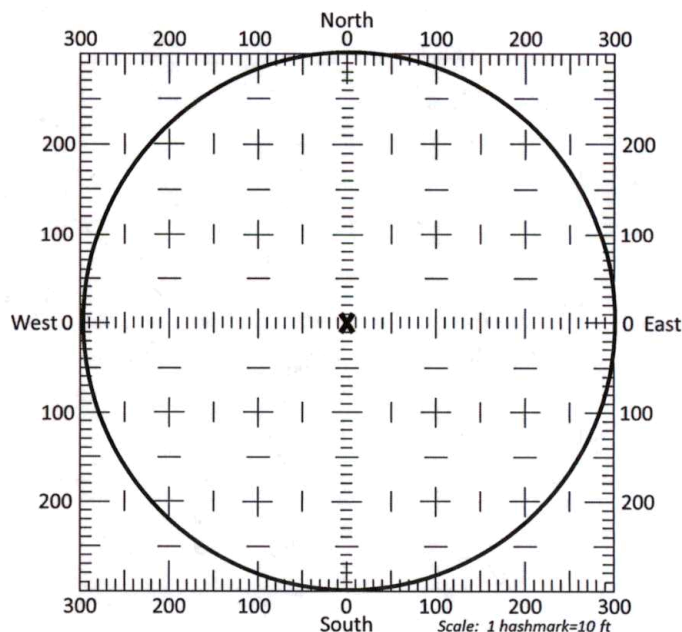

13b. If the proposed point of diversion will be relocated within a 300 foot radius of the existing point of diversion, indicate its location on the diagram shown above in relation to the existing point of diversion. The proposed point of diversion must be located within the circle shown above. **(PLEASE NOTE: The "X" in center of diagram above represents the presently authorized point of diversion.)**

APPLICATION FOR APPROVAL TO CHANGE
THE PLACE OF USE AND/OR POINT OF DIVERSION
SUPPLEMENTAL SHEET
FILE NO. 10396, 17546, 17743, 28858, 31007
MAKE ADDITIONAL COPIES AS NECESSARY

3. *Continued:* The presently authorized place of use is:

Owner of Land ---- NAME: JACOB & SARA NEUDORF

ADDRESS: 757 YY ROAD COPELAND, KS 67837 - 7001

Sec.	Twp.	Range	NE¼				NW¼				SW¼				SE¼				TOTAL ACRES
			NE¼	NW¼	SW¼	SE¼	NE¼	NW¼	SW¼	SE¼	NE¼	NW¼	SW¼	SE¼	NE¼	NW¼	SW¼	SE¼	
7	28S	30W	40	40	40	40	40	39.01	38.95	40									317.96
1	28S	31W	30.5	30.5	30.5	30.5									35.5	40	40	40	277.50
6	28S	30W					30.25	30.25	30.25	30.25	30.25	30.25	30.25	30.25	30.25	30.25	30.25	30.25	363

Owner of Land ---- NAME: EMERY F JOSSERAND LLC

ADDRESS: 1827 N DENISE MARIE ST WICHITA, KS 67212 - 7408

Sec.	Twp.	Range	NE¼				NW¼				SW¼				SE¼				TOTAL ACRES
			NE¼	NW¼	SW¼	SE¼	NE¼	NW¼	SW¼	SE¼	NE¼	NW¼	SW¼	SE¼	NE¼	NW¼	SW¼	SE¼	
7	28S	30W													40	40			80

4. *Continued:* If this application is for a change in place of use, it is proposed that the place of use be changed to:

Owner of Land ---- NAME: JACOB & SARA NEUDORF

ADDRESS: 757 YY ROAD COPELAND, KS 67837 - 7001

Sec.	Twp.	Range	NE¼				NW¼				SW¼				SE¼				TOTAL ACRES
			NE¼	NW¼	SW¼	SE¼	NE¼	NW¼	SW¼	SE¼	NE¼	NW¼	SW¼	SE¼	NE¼	NW¼	SW¼	SE¼	
7	28S	30W	30.5	30.5	37.5	37.5	31	L-1 31	L-2 31	31									260
1	28S	31W	L-1 30.5	L-2 30.5	30.5	30.5									35.5	40	40	40	277.50
6	28S	30W					30.25	L-1 30.25	L-2 30.25	30.25	30.25	30.25	30.25	30.25	30.25	30.25	30.25	30.25	363
12	28S	31W		28.98	28.98														57.96

Owner of Land ---- NAME: EMERY F JOSSERAND LLC

ADDRESS: 1827 N DENISE MARIE ST WICHITA, KS 67212 - 7408

Sec.	Twp.	Range	NE¼				NW¼				SW¼				SE¼				TOTAL ACRES
			NE¼	NW¼	SW¼	SE¼	NE¼	NW¼	SW¼	SE¼	NE¼	NW¼	SW¼	SE¼	NE¼	NW¼	SW¼	SE¼	
7	28S	30W													40	40			80

CHANGE IN PLACE OF USE WATER RIGHT, FILE NO. 10396, 17546, 17743, 28858, 31007

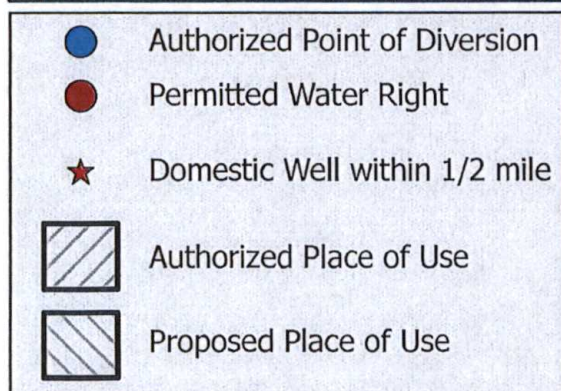
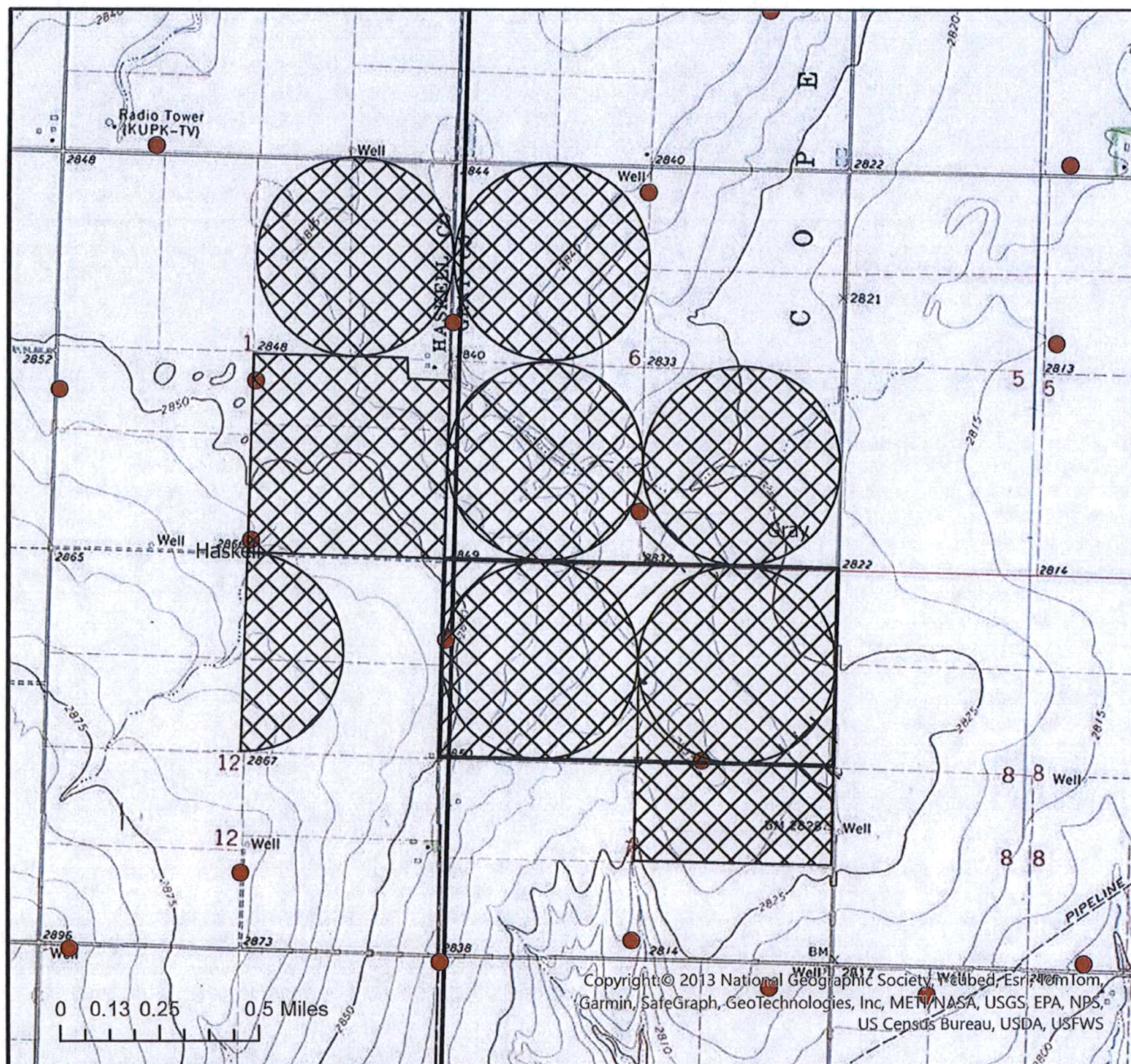

By signing below I agree that all wells, including domestic, and owners names and addresses within 1/2 mile of the proposed point of diversion have been shown on the map

(Signature)

Date

2/20/2025 AH/GCFO
1:24,000 Scale

14. If the proposed groundwater point of diversion is 300 or fewer feet from the existing point of diversion, complete the following:

- (a) Does the undersigned represent all owners of the currently authorized place(s) of use identified in this application?
☐ Yes ☐ No (If no, all owners must sign this application.)
- (b) Will the ownership interest of any owner of the currently authorized place(s) of use identified in this application be adversely affected if this application is approved as requested?
☐ Yes ☐ No (If yes, all owners must sign this application.)
- (c) If this application is not approved expeditiously, will there be substantial damage to property, public health or safety?
☐ Yes ☐ No (If no, all owners must sign this application.)

If the application proposes a surface water change in point of diversion, a groundwater change in point of diversion greater than 300 feet, or a change in place of use, the application must be signed by all owners of the currently authorized place of use, or their duly authorized agent (attach notarized statement authorizing representation).

I hereby verify, being first duly sworn upon my oath or affirmation and under penalty of perjury, that I am of lawful age and the owner, the spouse of the owner, or a duly authorized agent of the owner(s) to make this application on their behalf, in regards to the water right(s) to which this application pertains. I further verify that the statements contained in this application are true, correct and complete.

Dated at Wichita, Kansas, this 25 day of February, 2025.

x Lance Josseland
(Owner)

(Spouse)

x Lance Josseland
(Please Print)

(Please Print)

(Owner)

(Spouse)

(Please Print)

(Please Print)

(Owner)

(Spouse)

(Please Print)

(Please Print)

State of Kansas }
County of Sedgwick } SS



I hereby certify that the foregoing application was signed in my presence and sworn to before me this 25 day of February, 2025.

x Kylee Nicole Eden
Notary Public

My Commission Expires April 25, 2026.

ONLY COMPLETE APPLICATIONS WILL BE PROCESSED. To be complete, all of the applicable portions of the application form must be completed with accurate information; maps, if necessary, must be included; signatures of all the appropriate owners' must be affixed to the application and notarized; and the appropriate fee must be paid.

FEE SCHEDULE

Each application to change the place of use or the point of diversion under this section shall be accompanied by the application fee set forth in the schedule below: Make checks payable to: **Kansas Department of Agriculture**

- | | |
|---|-------|
| (1) Application to change a point of diversion 300 feet or less | \$100 |
| (2) Application to change a point of diversion more than 300 feet | \$200 |
| (3) Application to change the place of use | \$200 |

14. If the proposed groundwater point of diversion is 300 or fewer feet from the existing point of diversion, complete the following:

- (a) Does the undersigned represent all owners of the currently authorized place(s) of use identified in this application?
☐ Yes ☐ No (If no, all owners must sign this application.)
- (b) Will the ownership interest of any owner of the currently authorized place(s) of use identified in this application be adversely affected if this application is approved as requested?
☐ Yes ☐ No (If yes, all owners must sign this application.)
- (c) If this application is not approved expeditiously, will there be substantial damage to property, public health or safety?
☐ Yes ☐ No (If no, all owners must sign this application.)

If the application proposes a surface water change in point of diversion, a groundwater change in point of diversion greater than 300 feet, or a change in place of use, the application must be signed by all owners of the currently authorized place of use, or their duly authorized agent (attach notarized statement authorizing representation).

I hereby verify, being first duly sworn upon my oath or affirmation and under penalty of perjury, that I am of lawful age and the owner, the spouse of the owner, or a duly authorized agent of the owner(s) to make this application on their behalf, in regards to the water right(s) to which this application pertains. I further verify that the statements contained in this application are true, correct and complete.

Dated at Garden City, Kansas, this 21st day of March, 20 25.

x Jacobo Neudorf
(Owner)

Sara Neudorf
(Spouse)

x Jacobo Neudorf-Frisen
(Please Print)

Sara Neudorf
(Please Print)

(Owner)

(Spouse)

(Please Print)

(Please Print)

(Owner)

(Spouse)

(Please Print)

(Please Print)

State of Kansas }
County of Finney } SS

I hereby certify that the foregoing application was signed in my presence and sworn to before me this 21st day of March, 20 25.

Aaron Holsted
Notary Public

My Commission Expires _____.

ONLY COMPLETE APPLICATIONS WILL BE PROCESSED. To be complete, all of the applicable portions of the application form must be completed with accurate information; maps, if necessary, must be included; signatures of all the appropriate owners' must be affixed to the application and notarized; and the appropriate fee must be paid.

FEE SCHEDULE

Each application to change the place of use or the point of diversion under this section shall be accompanied by the application fee set forth in the schedule below: Make checks payable to: **Kansas Department of Agriculture**

- | | |
|---|-------|
| (1) Application to change a point of diversion 300 feet or less | \$100 |
| (2) Application to change a point of diversion more than 300 feet | \$200 |
| (3) Application to change the place of use | \$200 |

SUMMARY ORDER APPROVING APPLICATION FOR CHANGE AND IMPOSING CONDITIONS

This Summary Order is issued under authority of K.S.A. 82a-708b, as amended, and K.A.R. 5-5-1, *et seq.* and other applicable provisions of the *Kansas Water Appropriation Law, K.S.A. 82a-701 et seq.*, and rules and regulations promulgated thereunder. With the exception of those conditions expressly contained herein, this Summary Order does not change the terms, conditions and limitations of File No. 10396.

1. A change application was received on March 21, 2025 requesting that the place of use and / or point of diversion authorized under the above-referenced file number be changed as described in the application.
2. On and after the effective date of this summary order, the authorized place(s) of use shall be located substantially as shown on the topographic map accompanying the application to change the place of use. ☒ Applicable ☐ Not Applicable
3. The change in point of diversion shall not impair existing rights and shall be limited to the same source or sources of water as previously authorized. The point of diversion authorized by this summary order shall be located within a foot radius of the authorized point(s) of diversion. ☐ Applicable ☒ Not Applicable
4. The point(s) of diversion described herein is administratively corrected to be more accurately described using the Global Positioning System (GPS), as described in the application. ☐ Applicable ☒ Not Applicable
5. The point(s) of diversion authorized herein shall not actually be located more than feet from the previously authorized point(s) of diversion. ☐ Applicable ☒ Not Applicable
6. As required by K.A.R. 5-3-5d, if the works for diversion is a well with a diversion rate of 100 gallons per minute or more, a tube or other device suitable for making water level measurements shall be installed, operated and maintained in accordance with K.A.R. 5-6-13. ☐ Applicable ☒ Not Applicable
7. **The owner of the authorized place(s) of use shall properly install an acceptable water flow meter on or before December 31, 2025, or before the first use of water, whichever occurs first.** The water flow meter shall be installed, operated and maintained in accordance with K.A.R. 5-1-4 through 5-1-12. As required by K.S.A. 82a-732, as amended, and K.A.R. 5-3-5e, the owner shall maintain records and report the reading of the water flow meter and the total quantity of water diverted annually to the Chief Engineer by March 1 following the end of each calendar year.
☒ Applicable ☐ Not Applicable
8. **Installation of the works for diversion of water shall be completed on or before December 31, 20 , or within any authorized extension of time.** By March 1, 20 the applicant shall notify the Chief Engineer that construction of the works for diversion has been completed, on the form provided by the Chief Engineer, as required by K.A.R. 5-8-4e.
☐ Applicable ☒ Not Applicable
9. **The completed well log shall be submitted with the required notice.** ☐ Applicable ☒ Not Applicable
10. All diversion works into which any type of chemical or other foreign substance will be injected into the water shall be equipped with an in-line, automatic, quick-closing check valve capable of preventing pollution of the source of the water supply. The check valve(s) shall be installed, operated and maintained in accordance with K.A.R. 5-3-5c. ☒ Applicable ☐ Not Applicable
11. Additional Conditions are attached. ☐ Yes ☒ No
12. In accordance with K.S.A. 82a-708a, as amended, and K.A.R. 5-5-14, all of the owners of the authorized place(s) of use of water appropriated under the above-referenced file number are responsible for compliance with its terms, conditions and limitations, as amended and/or supplemented by this Summary Order, and with applicable provisions of the *Kansas Water Appropriation Law* and the *Rules and Regulations* promulgated thereunder. Failure to comply with these provisions may result in civil penalties pursuant to K.S.A. 82a-737, as amended, and/or the suspension or revocation and dismissal of the water or appropriation right or any other enforcement actions authorized by law.

Administrative Appeal and Effective Date of Order

If you are aggrieved by this order, pursuant to K.S.A. 82a-1901, you may request an evidentiary hearing before the Chief Engineer or request administrative review by the Secretary of Agriculture. A request for hearing by the Chief Engineer must be filed within **15 days** of service of this Order and a request for administrative review by the Secretary must be filed within **30 days** pursuant to K.S.A. 77-531. Any request for administrative review must state a basis for review pursuant to K.S.A. 77-527. File any request with **Kansas Department of Agriculture, Legal Division, 1320 Research Park Drive, Manhattan, KS 66502**. Failure to timely request a hearing or review may preclude review under the Kansas Judicial Review Act.

For Use by Register of Deeds

FOR OFFICE USE ONLY
APPLICATION APPROVED AND
SUMMARY ORDER ISSUED

By: 
Duly Authorized Designee of the Chief Engineer

(Print Name): MICHAEL A. MEYER
Division of Water Resources - Kansas Department of Agriculture

Date of Issuance: MARCH 31, 2025

State of Kansas)
) SS

County of Finney

Acknowledged before me on March 31, 2025

by Michael A Meyer

Signature: Saron Holsted

My commission expires: _____ My Appointment Expires _____

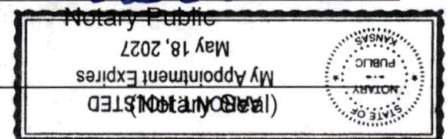

14. If the proposed groundwater point of diversion is 300 or fewer feet from the existing point of diversion, complete the following:

- (a) Does the undersigned represent all owners of the currently authorized place(s) of use identified in this application?
☐ Yes ☐ No (If no, all owners must sign this application.)
- (b) Will the ownership interest of any owner of the currently authorized place(s) of use identified in this application be adversely affected if this application is approved as requested?
☐ Yes ☐ No (If yes, all owners must sign this application.)
- (c) If this application is not approved expeditiously, will there be substantial damage to property, public health or safety?
☐ Yes ☐ No (If no, all owners must sign this application.)

If the application proposes a surface water change in point of diversion, a groundwater change in point of diversion greater than 300 feet, or a change in place of use, the application must be signed by all owners of the currently authorized place of use, or their duly authorized agent (attach notarized statement authorizing representation).

I hereby verify, being first duly sworn upon my oath or affirmation and under penalty of perjury, that I am of lawful age and the owner, the spouse of the owner, or a duly authorized agent of the owner(s) to make this application on their behalf, in regards to the water right(s) to which this application pertains. I further verify that the statements contained in this application are true, correct and complete.

Dated at _____, Kansas, this _____ day of _____, 20_____.

(Owner)

(Spouse)

(Please Print)

(Please Print)

(Owner)

(Spouse)

(Please Print)

(Please Print)

(Owner)

(Spouse)

(Please Print)

(Please Print)

State of Kansas }
County of _____ } SS

I hereby certify that the foregoing application was signed in my presence and sworn to before me this _____ day of _____, 20_____.

My Commission Expires _____.

Notary Public

ONLY COMPLETE APPLICATIONS WILL BE PROCESSED. To be complete, all of the applicable portions of the application form must be completed with accurate information; maps, if necessary, must be included; signatures of all the appropriate owners' must be affixed to the application and notarized; and the appropriate fee must be paid.

FEE SCHEDULE

Each application to change the place of use or the point of diversion under this section shall be accompanied by the application fee set forth in the schedule below: Make checks payable to: **Kansas Department of Agriculture**

- | | |
|---|-------|
| (1) Application to change a point of diversion 300 feet or less | \$100 |
| (2) Application to change a point of diversion more than 300 feet | \$200 |
| (3) Application to change the place of use | \$200 |

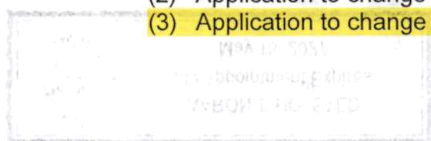

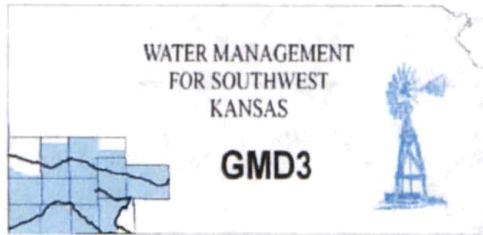

Southwest Kansas
Groundwater Management District No. 3
2009 E. Spruce Street
Garden City, Kansas 67846
(620) 275-7147 phone
www.gmd3.org

March 28, 2025

Michael A. Meyer
Division of Water Resources
4532 W Jones Ave., Suite B
Garden City, Kansas 67846

RE: Applications for Change in Place of Use
Water Right, File Nos. 10396, 17546, 17743, 28858 & 31007

Dear Mike:

We have completed a review of the applications for the above-mentioned water rights. The proposals are not in conflict with the Management Program of the Southwest Kansas Groundwater Management District No. 3 (GMD3). The proposed change in place of use will make a maintain complete overlap while rearranging acres in authorized place of use in accordance with K.A.R. 5-5-11(b). It is therefore recommended that the applications be approved at this time.

Thank you for the opportunity to review the applications and to provide a recommendation. If you have any questions, please don't hesitate to contact us.

Sincerely,

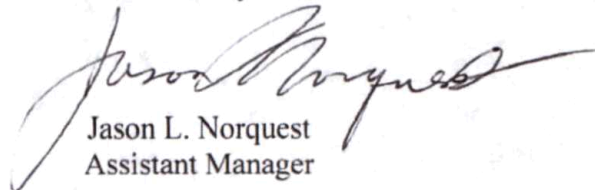

Jason L. Norquest
Assistant Manager

RECEIVED

MAR 27 2025

Garden City Field Office
Division of Water Resources

GMD3 Change Review

File No(s): 10396, 17546, 17743, 28858, 31007.

DWR office: GC.

App filed to change: PU.

Is Landowner(s) correct in WRIS: Jacob Neudorf.

If NO, is documentation included?

Is Water Use Correspondent correct in WRIS? .

If NO, is documentation included?

Regulation(s) Reviewed: KAR 5-5-11

Point of diversion ID No(s) being changed.

	ft. North	ft. West	
Authorized PD			
Proposed PD			
Difference	0	0	
a2 + b2 = c2	0	0	0

GPS for proposed PD: Lat: Long: .

Is proposed PD stacking on existing WRs? No Change.

Is Proposed PU overlapping existing WRs? Rearranging acres and complete overlap.

Neighboring certified well(s) notified: .

Name .

Address .

Zip .

Email: Phone: .

Domestic well(s) notified: .

Name .

Address .

Zip .

Base Acres: 1038.46.

Perfected Acres: .

Irr. Return-Flow %

Gray County

10396: 320AF @ 2000gpm

Current PU:

277.5acres E2 1-28-31

363acres W2 & SE 6-28-30

317.96acres N2 7-28-30

80acres N2 of SE 7-28-30

1038.46acres total

17546: 640AF @ 2800gpm

17743: ID03 394AF @ 1500gpm

ID04 406AF @ 1650gpm

GMD3 Change Review

28858: 320AF @ 1120gpm

31007: 633AF @ 2000gpm Limited 960AF w/10396 & 17546

Proposed PU:

277.5acres E2 1-28-31 (No Change)

363acres W2 & SE 6-28-30 (No Change)

260acres N2 7-28-30 (57.96 acres reduced from corners)

80acres N2 of SE 7-28-30 (No Change)

57.96acres W2 of NE 12-28-30 (New acres)

1038.46acres total

Is a waiver needed: No. Rearranging acres and bringing in 57.96 new acres, all within bases acres for the WRs.

Recommendation: After review of available information, it appears current area rules are met. Staff recommends approval of the applications.



RECEIVED

MAR 27 2025

Garden City Field Office
Division of Water Resources

Garden City Field Office
4532 W. Jones, Suite B
Garden City, KS 67846



Phone: 620-276-2901
Fax: 620-276-9315
www.agriculture.ks.gov

Mike Beam, Secretary

Laura Kelly, Governor

March 25, 2025

SOUTHWEST KANSAS GROUNDWATER
MANAGEMENT DISTRICT NO. 3
2009 E SPRUCE ST
GARDEN CITY KS 67846

Re: Request for Recommendation
Water Right, File Nos. 10396, 17546, 17743, 28858, 31007

Dear Mr. Norquest:

This is to advise you that Jacob Neudorf has filed applications for approval of the Chief Engineer, Division of Water Resources, Kansas Department of Agriculture, to change the place of use.

We are delaying action on the change applications to allow you time to review and provide a recommendation. Please submit a recommendation within 15 days from the date of this letter.

Thank you and as always feel free to contact this office at any time.

Sincerely,

Michael A. Meyer
Water Commissioner

MAM
Enclosures