

Submit To: CHIEF ENGINEER  
Division of Water Resources  
Kansas Department of Agriculture  
1320 Research Park Drive  
Manhattan, Kansas 66502  
<http://agriculture.ks.gov/dwr>

**APPLICATION FOR APPROVAL TO  
CHANGE THE PLACE OF USE, THE  
POINT OF DIVERSION OR THE USE  
MADE OF THE WATER UNDER AN  
EXISTING WATER RIGHT**

WATER RESOURCES  
RECEIVED

FEB 24 2025

13:59

KS Dept. of Agriculture



State of Kansas

**Filing Fee Must Accompany the Application**  
(Please refer to Fee Schedule on signature page of application form.)

**Paragraph Nos. 1, 2, 3, 4 & 8 must be completed. Complete all other applicable portions.** A topographic map or detailed plat showing the authorized and proposed points(s) of diversion and /or place of use must accompany this application.

1. Application is hereby made for approval of the Chief Engineer to change the

☒ Place of Use

(Check one or more) ☐ Point of Diversion

☐ Use Made of Water

File No. 12332

2. Name of applicant: HIGH PLAINS PONDEROSA DAIRY LLC

Address: 2042 V RD

City, State and Zip: PLAINS, KS 67869

Phone Number: (620) 563-9441

E-mail address: greg.bethard@hpp-dairy.com

What is your relationship to the water right; ☐ owner ☐ tenant ☒ agent ☐ other? If other, please explain. \_\_\_\_\_

Name of water use correspondent: SAME AS ABOVE

Address: \_\_\_\_\_

City, State and Zip: \_\_\_\_\_

Phone Number: (\_\_\_\_) \_\_\_\_\_ E-mail address: \_\_\_\_\_

3. The change(s) proposed herein are desired for the following reasons (please be specific): TO INCLUDE THE ENTIRETY OF THE DAIRY OPERATION INTO THE PU

The change(s) (was) (will be) completed by \_\_\_\_\_ (Date)

**For Office Use Only:**

F.O. 4 GMD 3 Meets K.A.R. 5-5-1 (YES) / NO Use STK Source G / S County ME By KJN Date 3/21/25  
Code cpu Fee \$ 200 TR # \_\_\_\_\_ Receipt Date 2/24/25 Check # 87532

3/24/2025  
L Moody

4. The presently authorized place of use is:

Owner of Land — NAME: HIGH PLAINS PONDEROSA DAIRY LLCADDRESS: 2042 V RD PLAINS KS 67869

Sec.	Twp.	Range	NE¼				NW¼				SW¼				SE¼				TOTAL ACRES
			NE¼	NW¼	SW¼	SE¼	NE¼	NW¼	SW¼	SE¼	NE¼	NW¼	SW¼	SE¼	NE¼	NW¼	SW¼	SE¼	
12	33S	31W	DAIRY (S2 LESS IRR LAND)																
7	33S	30W	DAIRY (S2)																
18	33S	30W	DAIRY (W2) & (SE)																

List any other water rights that cover this place of use. \_\_\_\_\_

(If there are more than two landowners, attach additional sheets as necessary.)

5. It is proposed that the place of use be changed to:

Owner of Land — NAME: HIGH PLAINS PONDEROSA DAIRY LLCADDRESS: 2042 V RD PLAINS KS 67869

Sec.	Twp.	Range	NE¼				NW¼				SW¼				SE¼				TOTAL ACRES
			NE¼	NW¼	SW¼	SE¼	NE¼	NW¼	SW¼	SE¼	NE¼	NW¼	SW¼	SE¼	NE¼	NW¼	SW¼	SE¼	
12	33S	31W	DAIRY (S2)																
7	33S	30W	DAIRY (S2)																
18	33S	30W	DAIRY (WHOLE SECTION)																
28	33S	30W	DAIRY (E2)																

List any other water rights that cover this place of use. \_\_\_\_\_

**IF MORE SPACE IS NEEDED, ATTACH ADDITIONAL SHEETS AS NECESSARY**

WATER RESOURCES  
RECEIVED  
FEB 24 2025  
KS Dept. of Agriculture



FEB 24 2025

KS Dept. of Agriculture

6. The presently authorized point(s) of diversion (is) (are) \_\_\_\_\_  
(Provide description and number of points)
7. The proposed point(s) of diversion (is) (are) \_\_\_\_\_  
(Provide description and number of points)

**List all presently authorized point(s) of diversion:**

8. **Presently authorized point of diversion:**

One in the \_\_\_\_\_ Quarter of the \_\_\_\_\_ Quarter of the \_\_\_\_\_ Quarter  
of Section \_\_\_\_\_, Township \_\_\_\_\_ South, Range \_\_\_\_\_ (W),  
in MEADE County, Kansas, \_\_\_\_\_ feet North \_\_\_\_\_ feet West of Southeast corner of section.  
Authorized Rate \_\_\_\_\_ Authorized Quantity \_\_\_\_\_  
(DWR use only: Computer ID No. \_\_\_\_\_ GPS \_\_\_\_\_ feet North \_\_\_\_\_ feet West)  
☐ This point will not be changed ☒ This point will be changed as follows:  
**Proposed point of diversion: (Complete only if change is requested)**  
One in the \_\_\_\_\_ Quarter of the \_\_\_\_\_ Quarter of the \_\_\_\_\_ Quarter  
of Section \_\_\_\_\_, Township \_\_\_\_\_ South, Range \_\_\_\_\_ (W),  
in MEADE County, Kansas, \_\_\_\_\_ feet North \_\_\_\_\_ feet West of Southeast corner of section.  
Proposed Rate \_\_\_\_\_ Proposed Quantity \_\_\_\_\_  
This point is: ☐ Additional Well ☐ Geo Center List other water rights that will use this point \_\_\_\_\_

9. **Presently authorized point of diversion:**

One in the \_\_\_\_\_ Quarter of the \_\_\_\_\_ Quarter of the \_\_\_\_\_ Quarter  
of Section \_\_\_\_\_, Township \_\_\_\_\_ South, Range \_\_\_\_\_ (E/W),  
in \_\_\_\_\_ County, Kansas, \_\_\_\_\_ feet North \_\_\_\_\_ feet West of Southeast corner of section.  
Authorized Rate \_\_\_\_\_ Authorized Quantity \_\_\_\_\_  
(DWR use only: Computer ID No. \_\_\_\_\_ GPS \_\_\_\_\_ feet North \_\_\_\_\_ feet West)  
☐ This point will not be changed ☐ This point will be changed as follows:  
**Proposed point of diversion: (Complete only if change is requested)**  
One in the \_\_\_\_\_ Quarter of the \_\_\_\_\_ Quarter of the \_\_\_\_\_ Quarter  
of Section \_\_\_\_\_, Township \_\_\_\_\_ South, Range \_\_\_\_\_ (E/W),  
in \_\_\_\_\_ County, Kansas, \_\_\_\_\_ feet North \_\_\_\_\_ feet West of Southeast corner of section.  
Proposed Rate \_\_\_\_\_ Proposed Quantity \_\_\_\_\_  
This point is: ☐ Additional Well ☐ Geo Center List other water rights that will use this point \_\_\_\_\_

10. **Presently authorized point of diversion:**

One in the \_\_\_\_\_ Quarter of the \_\_\_\_\_ Quarter of the \_\_\_\_\_ Quarter  
of Section \_\_\_\_\_, Township \_\_\_\_\_ South, Range \_\_\_\_\_ (E/W),  
in \_\_\_\_\_ County, Kansas, \_\_\_\_\_ feet North \_\_\_\_\_ feet West of Southeast corner of section.  
Authorized Rate \_\_\_\_\_ Authorized Quantity \_\_\_\_\_  
(DWR use only: Computer ID No. \_\_\_\_\_ GPS \_\_\_\_\_ feet North \_\_\_\_\_ feet West)  
☐ This point will not be changed ☐ This point will be changed as follows:  
**Proposed point of diversion: (Complete only if change is requested)**  
One in the \_\_\_\_\_ Quarter of the \_\_\_\_\_ Quarter of the \_\_\_\_\_ Quarter  
of Section \_\_\_\_\_, Township \_\_\_\_\_ South, Range \_\_\_\_\_ (E/W),  
in \_\_\_\_\_ County, Kansas, \_\_\_\_\_ feet North \_\_\_\_\_ feet West of Southeast corner of section.  
Proposed Rate \_\_\_\_\_ Proposed Quantity \_\_\_\_\_  
This point is: ☐ Additional Well ☐ Geo Center List other water rights that will use this point \_\_\_\_\_

11. Describe the current condition of and future plans for any point(s) of diversion which will no longer be used. \_\_\_\_\_

**IF MORE SPACE IS NEEDED, ATTACH ADDITIONAL SHEETS AS NECESSARY**

Any use of water that is not as authorized by the water right or permit to authorize water **before** the chief engineer approves this application is a violation of the Kansas Water Appropriation Act for which criminal or civil penalties may be assessed. Such violation is a class C misdemeanor, punishable by a fine not to exceed \$500 and/or a term of confinement not to exceed one month in the county jail. K.S.A. 82a-728(b). Civil penalties shall be not less than \$100 nor more than \$1,000 per violation. In the case of a continuing violation, each day such violation continues may be deemed a separate violation. In addition to these penalties the water right may be modified or suspended. K.S.A. 82a-737, as amended.

**The application must be signed by all owners of the place of use authorized under the water right and his or her spouse, if married. Please indicate if there is no spouse.** If land is being purchased under contract, the seller must sign as landowner until such time as the contract is completed.

In the event that all applicants cannot appear before one notary public, they may as necessary sign separate copies of the application before any notary public conveniently available to them. All copies signed in this manner shall be considered to be valid parts of the application.

If the request is signed on behalf of any Owner by someone with legal authority to do so (for example, an agent, one who has power of attorney, or an executor, executrix, conservator), it will be necessary to attach proper documents showing such authority.

**I declare that I am an owner of the currently authorized place of use as identified herein, or that I represent all such owners and am authorized to make this application on their behalf, and declare further that the statements contained herein are true, correct, and complete. By filing this application I authorize the chief engineer to permanently reduce the quantity of water and/or rate of diversion as specified in sections 14 and 15 of this application.**

Dated at Platts, Kansas, this 3rd day of Feb, 2025.

[Signature]  
(Owner)

\_\_\_\_\_  
(Spouse)

Greg Bernard  
(Please Print)

\_\_\_\_\_  
(Please Print)

\_\_\_\_\_  
(Owner)

\_\_\_\_\_  
(Spouse)

\_\_\_\_\_  
(Please Print)

\_\_\_\_\_  
(Please Print)

\_\_\_\_\_  
(Owner)

\_\_\_\_\_  
(Spouse)

\_\_\_\_\_  
(Please Print)

\_\_\_\_\_  
(Please Print)

State of Kansas }  
County of Meade } SS

I hereby certify that the foregoing application was signed in my presence and sworn to before me this 3rd day of February, 2025.

My Commission Expires 5-19-2028

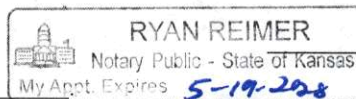

[Signature]  
Notary Public

#### FEE SCHEDULE

Each application to change the place of use, the point of diversion or the use made of the water under this section shall be accompanied by the application fee set forth in the schedule below:

- |   |       |
|---|-------|
| (1) Application to change a point of diversion 300 feet or less .....   | \$100 |
| (2) Application to change a point of diversion more than 300 feet ..... | \$200 |
| (3) Application to change the place of use .....                        | \$200 |
| (4) Application to change the use made of the water .....               | \$300 |

Make check payable to **Kansas Department of Agriculture.**

WATER RESOURCES  
RECEIVED

FEB 24 2025

KS Dept. of Agriculture



12. The presently authorized use of water is for \_\_\_\_\_ purposes.  
It is proposed that the use be changed to \_\_\_\_\_ purposes.
13. If changing the place of use and/or use made of water, describe how the consumptive use will not be increased.
- \_\_\_\_\_
- \_\_\_\_\_
- (Please show any calculations here.)
14. It is requested that the maximum annual quantity of water be reduced to \_\_\_\_\_ (acre-feet or million gallons).
15. It is requested that the maximum rate of diversion of water be reduced to \_\_\_\_\_ gallons per minute (\_\_\_\_\_ c.f.s.).
16. The application must include either a topographic map or detailed plat. A U.S. Geological Survey Topographic Map, scale 1:24,000, is available through the Kansas Geological Survey, 1930 Constant Avenue, University of Kansas, Lawrence, Kansas 66047-3726 ([www.usgs.gov](http://www.usgs.gov)). The map should show the location of the presently authorized point(s) of diversion. Distances North and West of the Southeast corner of the section must be shown. The presently authorized place of use should also be shown. Identify the center of the section, the section lines and the section corners and show the appropriate section, township, and range numbers on the map. In addition the following information must also be shown on the map.
- a. If a change in the location of the point(s) of diversion is proposed, show:
- 1) The location of the proposed point(s) of diversion. Distances North and West of the Southeast corner of the section must be shown. Please be certain that the information shown on the map agrees with the information shown in Paragraph Nos. 9, 10 and 11 of the application.
  - 2) If the source of supply is groundwater, please show the location of existing water wells of any kind, including domestic wells, within ½ mile of the proposed well or wells. Identify each well as to its use and furnish name and mailing address of the property owner or owners. If there are no wells within ½ mile, please indicate so on the map.
  - 3) If the source of supply is surface water, the names and mailing addresses of all landowner(s) ½ mile downstream and ½ mile upstream from your property lines must be shown.
- b. If a change in the place of use is desired, show the proposed place of use by crosshatching on the map. Please be certain that the information shown on the map agrees with the information shown in Paragraph No. 5 of the application.
17. Attach documentation to show the change(s) proposed herein will not impair existing water rights and relates to the same local source of supply as to which the water right relates. This information may include statements, plats, geology reports, well logs, test hole logs, and other information as necessary information to show the above. Additional comments may be made below.
- \_\_\_\_\_
- \_\_\_\_\_
18. If the proposed change(s) does not meet all applicable rules and regulations of the Kansas Water Appropriation Act, please identify the rules and regulations for which you request a waiver. State the reason why a waiver is needed and why the request should be granted. Attach documentation showing that granting the request will not impair existing water rights and will not prejudicially and unreasonably affect the public interest.
- \_\_\_\_\_
- \_\_\_\_\_
- \_\_\_\_\_

**IF MORE SPACE IS NEEDED, ATTACH ADDITIONAL SHEETS AS NECESSARY**

WATER RESOURCES  
RECEIVED

FEB 24 2025

KS Dept of Agriculture



File No. \_\_\_\_\_

Any use of water that is not as authorized by the water right or permit to authorize water before the chief engineer approves this application is a violation of the Kansas Water Appropriation Act for which criminal or civil penalties may be assessed. Such violation is a class C misdemeanor, punishable by a fine not to exceed \$500 and/or a term of confinement not to exceed one month in the county jail. K.S.A. 82a-728(b). Civil penalties shall be not less than \$100 nor more than \$1,000 per violation. In the case of a continuing violation, each day such violation continues may be deemed a separate violation. In addition to these penalties the water right may be modified or suspended. K.S.A. 82a-737, as amended.

The application must be signed by all owners of the place of use authorized under the water right and his or her spouse, if married. Please indicate if there is no spouse. If land is being purchased under contract, the seller must sign as landowner until such time as the contract is completed.

In the event that all applicants cannot appear before one notary public, they may as necessary sign separate copies of the application before any notary public conveniently available to them. All copies signed in this manner shall be considered to be valid parts of the application.

If the request is signed on behalf of any Owner by someone with legal authority to do so (for example, an agent, one who has power of attorney, or an executor, executrix, conservator), it will be necessary to attach proper documents showing such authority.

I declare that I am an owner of the currently authorized place of use as identified herein, or that I represent all such owners and am authorized to make this application on their behalf, and declare further that the statements contained herein are true, correct, and complete. By filing this application I authorize the chief engineer to permanently reduce the quantity of water and/or rate of diversion as specified in sections 14 and 15 of this application.

Dated at Schulenburg, Texas, this 11th day of February, 2025

[Signature]  
(Owner)

\_\_\_\_\_  
(Spouse)

Dax Dittich  
(Please Print)

\_\_\_\_\_  
(Please Print)

\_\_\_\_\_  
(Owner)

\_\_\_\_\_  
(Spouse)

\_\_\_\_\_  
(Please Print)

\_\_\_\_\_  
(Please Print)

\_\_\_\_\_  
(Owner)

\_\_\_\_\_  
(Spouse)

\_\_\_\_\_  
(Please Print)

\_\_\_\_\_  
(Please Print)

State of Texas  
County of Fayette } SS

I hereby certify that the foregoing application was signed in my presence and sworn to before me this 11th day of February, 2025.

[Signature]  
Notary Public

My Commission Expires 09-16-2027

**FEE SCHEDULE**

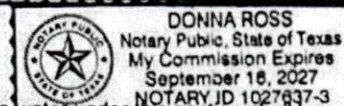

Each application to change the place of use, the point of diversion or the use made of the water under this section shall be accompanied by the application fee set forth in the schedule below:

- |   |       |
|---|-------|
| (1) Application to change a point of diversion 300 feet or less .....   | \$100 |
| (2) Application to change a point of diversion more than 300 feet ..... | \$200 |
| (3) Application to change the place of use .....                        | \$200 |
| (4) Application to change the use made of the water .....               | \$300 |

Make check payable to Kansas Department of Agriculture.

WATER RESOURCES  
RECEIVED

FEB 24 2025

KS Dept of Agriculture



# CHANGE IN PLACE OF USE WATER RIGHT, FILE NO. 12332, 21974, 30777, 40861, 45387

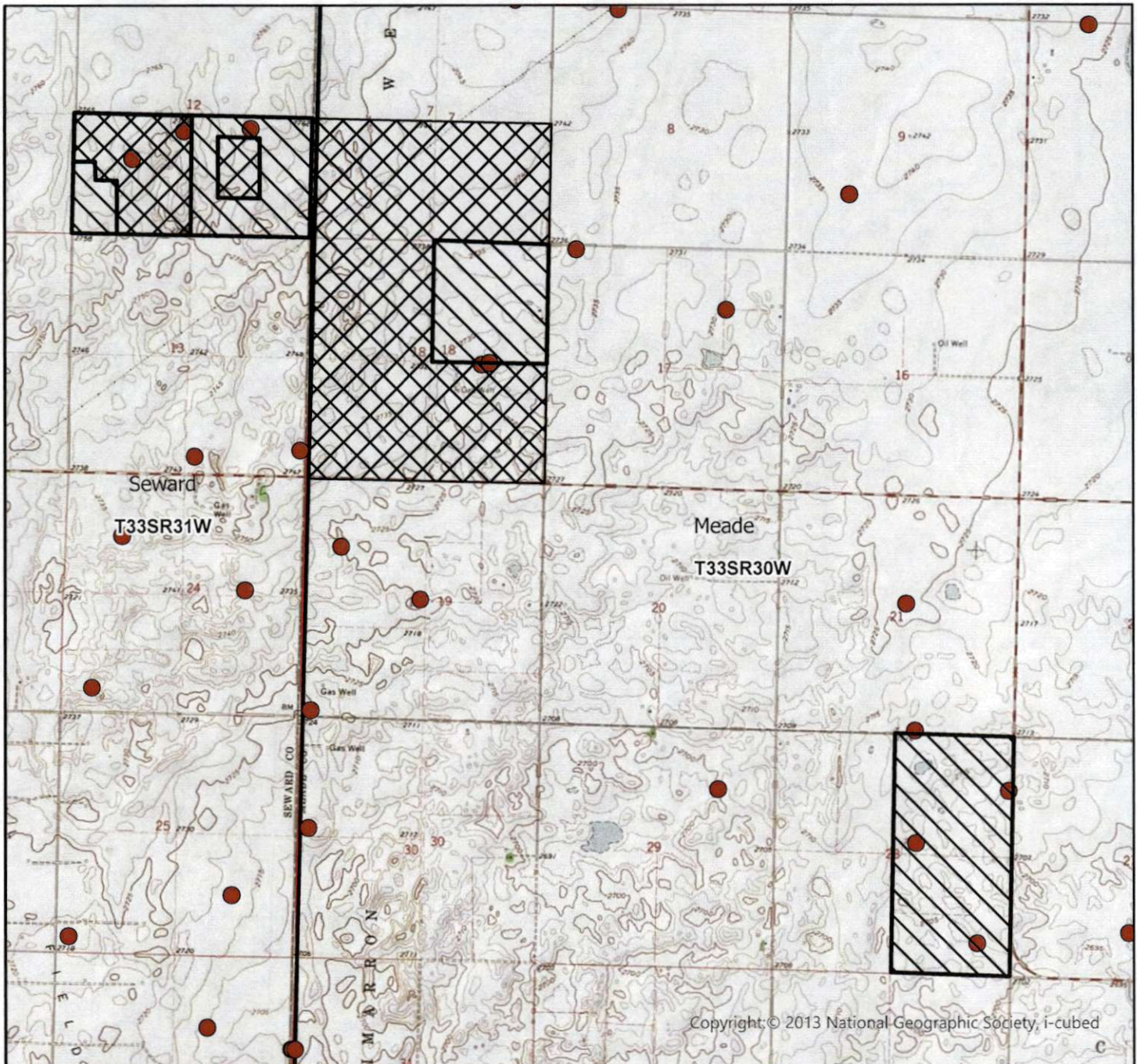

- Authorized Point of Diversion
- Permitted Water Right
- ★ Domestic Well within 1/2 mile
- Authorized Place of Use
- Proposed Place of Use

WATER RESOURCES  
RECEIVED  
FEB 24 2025  
KS Dept. of Agriculture



By signing below I agree that all wells, including domestic, and owners names and addresses within 1/2 mile of the proposed point of diversion have been shown on the map

(Signature)

Date

1/23/2025 AH/GCFO  
1:47,000 Scale