

NOTICE

This scan only represents the application as filed. The information contained herein meets the requirements of K.A.R. 5-3-1 or K.A.R. 5-5-1, and has been found acceptable for filing in the office of the Chief Engineer. The application should not be considered to be a complete application as per K.A.R. 5-3-1b or K.A.R. 5-5-2a.

Submit completed application to:
Kansas Department of Agriculture
Division of Water Resources
Field Office for your area.

Call for address:

Topeka -- (785) 296-5733
Stafford -- (620) 234-5311
Stockton -- (785) 425-6787
Garden City -- (620) 276-2901
<http://agriculture.ks.gov/dwr>

DWR FIELD OFFICE APPLICATION FOR APPROVAL TO CHANGE THE PLACE OF USE AND/OR THE POINT OF DIVERSION



STATE OF KANSAS

Filing Fee Must Accompany the Application, K.S.A. 82a-708b(b), as amended.

Fee Schedule is on the third page of this application form.

Paragraph Nos. 1, 2, 3 & 5 must be completed. Complete all other applicable portions. If change in point of diversion is greater than 100 feet, or if place of use will be changed, include a topographic map or detailed plat showing the authorized and proposed point(s) of diversion and/or place of use.

File No. 21743

RECEIVED
1:26 PM
MAR 21 2025

1. Application is hereby made for approval of the Chief Engineer to change the (check one or both):

☐ Place of Use ☒ Point of Diversion

under the water right which is the subject of this application in accordance with the conditions described below.

The source of supply is: ☒ Groundwater ☐ Surface water

Garden City Field Office
Division of Water Resources

2. Name and address of Applicant: GRAHAM FARMS INC

2150 ROAD 220 DEERFIELD KS 67838 - 9513

Phone Number: (620) 272-3074

Email address: cweatherred@gmail.com

Name and address of Water Use Correspondent: SAME AS ABOVE

Phone Number: ()

Email address:

3. The presently authorized place of use is:

Owner of Land --- NAME:

ADDRESS:

(If there is more than one landowner, attach supplemental sheets as necessary.)

| Sec. | Twp. | Range | NE¼ | | | | NW¼ | | | | SW¼ | | | | SE¼ | | | | TOTAL ACRES |
|------|------|-------|-----|-----|-----|-----|-----|-----|-----|-----|-----|-----|-----|-----|-----|-----|-----|-----|-------------|
| | | | NE¼ | NW¼ | SW¼ | SE¼ | NE¼ | NW¼ | SW¼ | SE¼ | NE¼ | NW¼ | SW¼ | SE¼ | NE¼ | NW¼ | SW¼ | SE¼ | |
| | | | | | | | | | | | | | | | | | | | |
| | | | | | | | | | | | | | | | | | | | |
| | | | | | | | | | | | | | | | | | | | |

4. If this application is for a change in place of use, it is proposed that the place of use be changed to:

Owner of Land --- NAME:

ADDRESS:

(If there is more than one landowner, attach supplemental sheets as necessary.)

| Sec. | Twp. | Range | NE¼ | | | | NW¼ | | | | SW¼ | | | | SE¼ | | | | TOTAL ACRES |
|------|------|-------|-----|-----|-----|-----|-----|-----|-----|-----|-----|-----|-----|-----|-----|-----|-----|-----|-------------|
| | | | NE¼ | NW¼ | SW¼ | SE¼ | NE¼ | NW¼ | SW¼ | SE¼ | NE¼ | NW¼ | SW¼ | SE¼ | NE¼ | NW¼ | SW¼ | SE¼ | |
| | | | | | | | | | | | | | | | | | | | |
| | | | | | | | | | | | | | | | | | | | |
| | | | | | | | | | | | | | | | | | | | |

For Office Use Only: Code CGT Fee \$ 200.00 TR # Receipt Date 3-21-25 Check # 6589

5. **Presently authorized point of diversion:**
 One in the SW Quarter of the NW Quarter of the SE Quarter
 of Section 35, Township 22 South, Range 35 (W),
 in KEARNY County, Kansas, 1560 feet North 2620 feet West of Southeast corner of section.
 Authorized Rate 1500 GPM Authorized Quantity 408 AF Depth of well _____ (feet)
(DWR use only: Computer ID No. 03 GPS _____ feet North _____ feet West)
☐ This point will not be changed ☐ This point will be changed as follows: ☐ No change, point better described with GPS as follows:
Proposed point of diversion: (Complete only if change is requested or if existing point is better described by GPS)
 One in the SW Quarter of the SE Quarter of the SE Quarter
 of Section 35, Township 22 South, Range 35 (W),
 in KEARNY County, Kansas, 201 feet North 812 feet West of Southeast corner of section.
 Proposed Rate _____ Proposed Quantity _____ Proposed well depth (feet) 275'
 This point is: ☐ Additional Well ☐ Geo Center List other water rights that will use this point _____

6. **Presently authorized point of diversion:**
 One in the _____ Quarter of the _____ Quarter of the _____ Quarter
 of Section _____, Township _____ South, Range _____ (W),
 in _____ County, Kansas, _____ feet North _____ feet West of Southeast corner of section.
 Authorized Rate _____ Authorized Quantity _____ Depth of well _____ (feet)
(DWR use only: Computer ID No. _____ GPS _____ feet North _____ feet West)
☐ This point will not be changed ☐ This point will be changed as follows: ☐ No change, point better described with GPS as follows:
Proposed point of diversion: (Complete only if change is requested or if existing point is better described by GPS)
 One in the _____ Quarter of the _____ Quarter of the _____ Quarter
 of Section _____, Township _____ South, Range _____ (W),
 in _____ County, Kansas, _____ feet North _____ feet West of Southeast corner of section.
 Proposed Rate _____ Proposed Quantity _____ Proposed well depth (feet) _____
 This point is: ☐ Additional Well ☐ Geo Center List other water rights that will use this point _____

7. The changes herein are desired for the following reasons?
 (please be specific) LOSS OF PRODUCTION

8. If a well, is the test hole log attached? ☒ Yes ☐ No

9. The change(s) (was)(will be) completed by?

UPON APPROVAL

10. If the point of diversion is a well:

(a) What are you going to do with the old well?

PLUG / CAP

(b) When will this be done? UPON COMPLETION

11. Groundwater Management District recommendation attached?
☐ Yes ☒ No

12. Assisted by AM / GCFO

13a. If the proposed point of diversion will be relocated more than 300 feet but within 2,640 feet of the existing point of diversion, attach a topographic map or aerial photograph. For groundwater sources, show all wells (including domestic) within one-half mile of the proposed point of diversion and the names and mailing addresses of the owners. For surface water sources, show the names and addresses of the landowner(s) one-half mile downstream and one-half mile upstream from your property lines

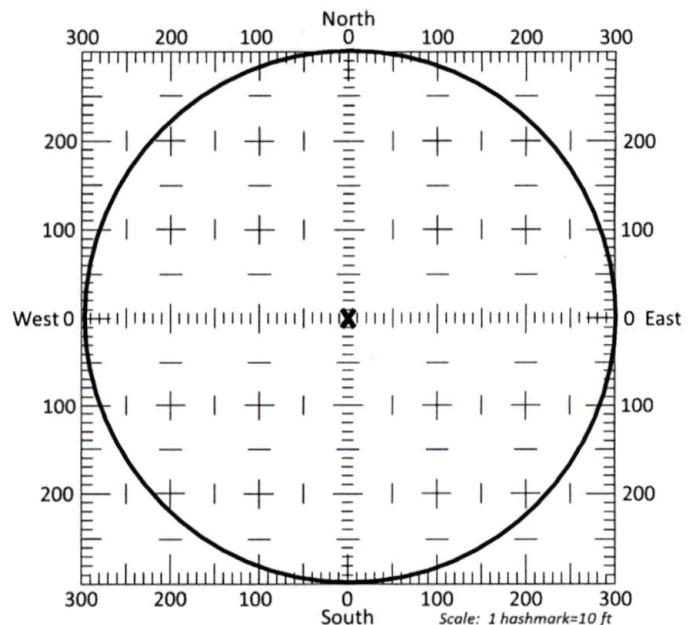

13b. If the proposed point of diversion will be relocated within a 300 foot radius of the existing point of diversion, indicate its location on the diagram shown above in relation to the existing point of diversion. The proposed point of diversion must be located within the circle shown above. **(PLEASE NOTE: The "X" in center of diagram above represents the presently authorized point of diversion.)**



Kansas Water Wells inc.

Test# 4

| | | | | | | | | | |
|--------------------|-----------------------|------------|----------------------|-------|--------------|----------|----|-------|----|
| Customer | Triple G Farms Ptnshp | Date | 9/25/24 | | | | | | |
| Address | 2150 Rd. 220 | City/State | Deerfield, Ks. 67838 | | | | | | |
| County | Kearny | Quarter | SE | Sec. | 35 | Township | 22 | Range | 35 |
| GPS Format | WGS-84 | Lat. | N 38.090892 | Long. | W 101.123809 | | | | |
| Static Water Level | 200' | Well Depth | 275 + Sump | | | | | | |

| From | Pay | To | Description of Strata |
|------------------------|-----|-----|-----------------------------------------------------------------------|
| 0 | | 2 | Top soil |
| 2 | | 90 | Brown sandy clay/few small fine-coarse sand streaks |
| 90 | | 113 | Fine-coarse sand/brown sandy clay streaks |
| 113 | | 146 | Brown sandy clay/few small fine-med sand streaks |
| 146 | | 150 | White sandy clay (firm) |
| 150 | | 160 | Fine-coarse sand/white clay streaks (firm) |
| 160 | | 172 | Fine-coarse sand |
| 172 | | 208 | White sandy clay/gyp (hard in spots) |
| 208 | 8 | 216 | Fine sand (firm) |
| 216 | 4 | 220 | 50% fine sand/50% med-coarse sand (loose) |
| 220 | 5 | 225 | 30% fine30% med/40% coarse sand (very loose) |
| 225 | 13 | 238 | 70% fine-super fine sand/30% white clay (tight) |
| 238 | 18 | 256 | 80% fine-super fine sand/20% clay (little loose) |
| 256 | | 258 | Cemented fine sand |
| 258 | 11 | 269 | 40% fine/30% med/30% coarse sand & small gravel (loose-very loose) |
| 269 | 6 | 275 | Yellow clay/lime rock/fine sand/couple fine sand streaks |
| 275 | | 280 | Black shale |
| | 65 | | Total pay |
| | 45 | | Poor pay |
| | 0 | | Fair pay |
| | 4 | | Good pay |
| | 16 | | Excellent pay |
| Location From Old Hole | | | 1380' South & 1750' east/ or 2250' SE |
| Bags Of High Yield | | | 2 |
| Bags Of Hole Plug | | | 2 |

Signature

CHANGE IN POINT OF DIVERSION WATER RIGHT, FILE NO. 21743

SE1/4 of Section 35 Township 22 South Range 35 West Kearny County

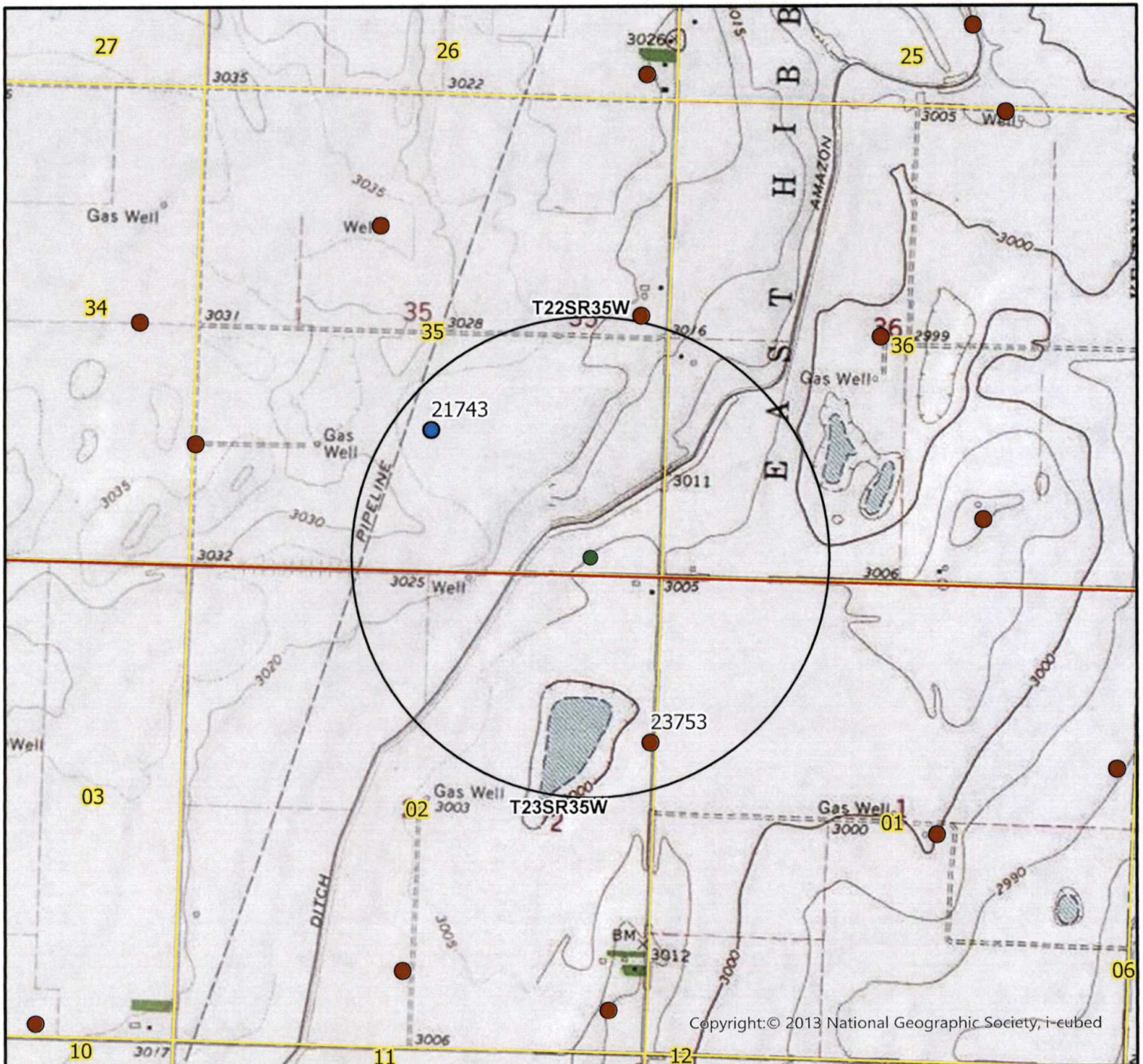

- Authorized Point of Diversion
- Proposed Point of Diversion
- Permitted Water Right
- ★ Domestic Well within 1/2 mile
- 1/2 mile buffer

List of owner name and addresses within 1/2 mile:

WR 21743: ROGER G & RANDALL UNRUH
625 S COWGILL DR GARDEN CITY KS 67846 - 8911



By signing below I agree that all wells, including domestic, and owners names and addresses within 1/2 mile of the proposed point of diversion have been shown on the map

(Signature)

Date

0 0.13 0.25 0.5 Miles

AM/GCFO
1:20,000 Scale

14. If the proposed groundwater point of diversion is 300 or fewer feet from the existing point of diversion, complete the following:

- (a) Does the undersigned represent all owners of the currently authorized place(s) of use identified in this application?
☐ Yes ☐ No (If no, all owners must sign this application.)
- (b) Will the ownership interest of any owner of the currently authorized place(s) of use identified in this application be adversely affected if this application is approved as requested?
☐ Yes ☐ No (If yes, all owners must sign this application.)
- (c) If this application is not approved expeditiously, will there be substantial damage to property, public health or safety?
☐ Yes ☐ No (If no, all owners must sign this application.)

If the application proposes a surface water change in point of diversion, a groundwater change in point of diversion greater than 300 feet, or a change in place of use, the application must be signed by all owners of the currently authorized place of use, or their duly authorized agent (attach notarized statement authorizing representation).

I hereby verify, being first duly sworn upon my oath or affirmation and under penalty of perjury, that I am of lawful age and the owner, the spouse of the owner, or a duly authorized agent of the owner(s) to make this application on their behalf, in regards to the water right(s) to which this application pertains. I further verify that the statements contained in this application are true, correct and complete.

Dated at 3-4-2025 Fairfield, CA, Kansas, this 1st day of March, 2025.

Peggy J. Shipp
(Owner)

(Spouse)

Peggy J Shipp
(Please Print)

(Please Print)

(Owner)

(Spouse)

(Please Print)

(Please Print)

(Owner)

(Spouse)

(Please Print)

(Please Print)

State of Kansas

County of _____

SS

I hereby certify that the foregoing application was signed in my presence and sworn to before me this _____ day of _____, 20____.

THE UPS STORE
5055 BUSINESS CENTER DR.
STE 108
FAIRFIELD, CA 94534
707 207 0470

Notary Public

My Commission Expires _____

ONLY COMPLETE APPLICATIONS WILL BE PROCESSED. To be complete, all of the applicable portions of the application form must be completed with accurate information; maps, if necessary, must be included; signatures of all the appropriate owners' must be affixed to the application and notarized; and the appropriate fee must be paid.

FEE SCHEDULE

Each application to change the place of use or the point of diversion under this section shall be accompanied by the application fee set forth in the schedule below: Make checks payable to: **Kansas Department of Agriculture**

- | | |
|-------------------------------------------------------------------------|-------|
| (1) Application to change a point of diversion 300 feet or less | \$100 |
| (2) Application to change a point of diversion more than 300 feet | \$200 |
| (3) Application to change the place of use | \$200 |

CALIFORNIA ALL-PURPOSE ACKNOWLEDGMENT**CIVIL CODE § 1189**

A notary public or other officer completing this certificate verifies only the identity of the individual who signed the document to which this certificate is attached, and not the truthfulness, accuracy, or validity of that document.

State of California Solano)
County of _____ \

On March 04, 2025 before me, Gurwinder Kaur, Notary Public,
Date Here Insert Name and Title of the Officer

personally appeared Peggy Jane Shipp
Name(s) of Signer(s)

who proved to me on the basis of satisfactory evidence to be the person(s) whose name(s) is/are subscribed to the within instrument and acknowledged to me that he/she/they executed the same in his/her/their authorized capacity(ies), and that by his/her/their signature(s) on the instrument the person(s), or the entity upon behalf of which the person(s) acted, executed the instrument.

I certify under PENALTY OF PERJURY under the laws of the State of California that the foregoing paragraph is true and correct.

WITNESS my hand and official seal.



Signature GKaur
Signature of Notary Public

Place Notary Seal Above

OPTIONAL

Though this section is optional, completing this information can deter alteration of the document or fraudulent reattachment of this form to an unintended document.

Description of Attached Document

Title or Type of Document: Summary Order Application For Change and Imposing Conditions
Document Date: 03-04-2025 Number of Pages: 5
Signer(s) Other Than Named Above: _____

Capacity(ies) Claimed by Signer(s)

Signer's Name: _____
☐ Corporate Officer — Title(s): _____
☐ Partner — ☐ Limited ☐ General
☐ Individual ☐ Attorney in Fact
☐ Trustee ☐ Guardian or Conservator
☐ Other: _____
Signer Is Representing: _____

Signer's Name: _____
☐ Corporate Officer — Title(s): _____
☐ Partner — ☐ Limited ☐ General
☐ Individual ☐ Attorney in Fact
☐ Trustee ☐ Guardian or Conservator
☐ Other: _____
Signer Is Representing: _____

14. If the proposed groundwater point of diversion is 300 or fewer feet from the existing point of diversion, complete the following:
- (a) Does the undersigned represent all owners of the currently authorized place(s) of use identified in this application?
☐ Yes ☐ No (If no, all owners must sign this application.)
 - (b) Will the ownership interest of any owner of the currently authorized place(s) of use identified in this application be adversely affected if this application is approved as requested?
☐ Yes ☐ No (If yes, all owners must sign this application.)
 - (c) If this application is not approved expeditiously, will there be substantial damage to property, public health or safety?
☐ Yes ☐ No (If no, all owners must sign this application.)

If the application proposes a surface water change in point of diversion, a groundwater change in point of diversion greater than 300 feet, or a change in place of use, the application must be signed by all owners of the currently authorized place of use, or their duly authorized agent (attach notarized statement authorizing representation).

I hereby verify, being first duly sworn upon my oath or affirmation and under penalty of perjury, that I am of lawful age and the owner, the spouse of the owner, or a duly authorized agent of the owner(s) to make this application on their behalf, in regards to the water right(s) to which this application pertains. I further verify that the statements contained in this application are true, correct and complete.

Dated at Garden City, Kansas, this 21st day of March, 20 25.

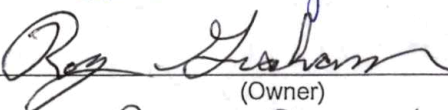
| | | |
|-----------------------------------------------------------------------------------------------------|-------|----------------|
| <u></u> (Owner) | _____ | (Spouse) |
| <u>Roy Graham</u> (Please Print) | _____ | (Please Print) |
| _____ | _____ | (Spouse) |
| (Owner) | _____ | (Please Print) |
| _____ | _____ | (Spouse) |
| (Please Print) | _____ | (Please Print) |
| _____ | _____ | (Spouse) |
| (Owner) | _____ | (Please Print) |
| _____ | _____ | (Please Print) |

State of Kansas }
County of Lenexa } SS

I hereby certify that the foregoing application was signed in my presence and sworn to before me this 21st day of March, 20 25.

My Commission Expires _____



AARON T. HOLSTED
My Appointment Expires
May 18, 2027

Notary Public

ONLY COMPLETE APPLICATIONS WILL BE PROCESSED. To be complete, all of the applicable portions of the application form must be completed with accurate information; maps, if necessary, must be included; signatures of all the appropriate owners' must be affixed to the application and notarized; and the appropriate fee must be paid.

FEE SCHEDULE

Each application to change the place of use or the point of diversion under this section shall be accompanied by the application fee set forth in the schedule below: Make checks payable to: **Kansas Department of Agriculture**

| | |
|-------------------------------------------------------------------------|-------|
| (1) Application to change a point of diversion 300 feet or less | \$100 |
| (2) Application to change a point of diversion more than 300 feet | \$200 |
| (3) Application to change the place of use | \$200 |

14. If the proposed groundwater point of diversion is 300 or fewer feet from the existing point of diversion, complete the following:

- (a) Does the undersigned represent all owners of the currently authorized place(s) of use identified in this application?
☐ Yes ☐ No (If no, all owners must sign this application.)
- (b) Will the ownership interest of any owner of the currently authorized place(s) of use identified in this application be adversely affected if this application is approved as requested?
☐ Yes ☐ No (If yes, all owners must sign this application.)
- (c) If this application is not approved expeditiously, will there be substantial damage to property, public health or safety?
☐ Yes ☐ No (If no, all owners must sign this application.)

If the application proposes a surface water change in point of diversion, a groundwater change in point of diversion greater than 300 feet, or a change in place of use, the application must be signed by all owners of the currently authorized place of use, or their duly authorized agent (attach notarized statement authorizing representation).

I hereby verify, being first duly sworn upon my oath or affirmation and under penalty of perjury, that I am of lawful age and the owner, the spouse of the owner, or a duly authorized agent of the owner(s) to make this application on their behalf, in regards to the water right(s) to which this application pertains. I further verify that the statements contained in this application are true, correct and complete.

Dated at Garden City, Kansas, this 30th day of October, 2024.

76 Maddy
(Owner)

Kirk Maddux
(Please Print)

(Owner)

(Please Print)

(Owner)

(Please Print)

(Spouse)

(Please Print)

(Spouse)

(Please Print)

(Spouse)

(Please Print)

State of Kansas }
County of Finney } SS

I hereby certify that the foregoing application was signed in my presence and sworn to before me this 30th day of October, 2024.

My Commission Expires

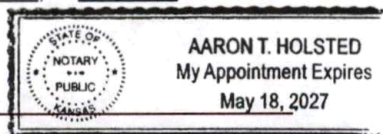

Aaron Holsted
Notary Public

ONLY COMPLETE APPLICATIONS WILL BE PROCESSED. To be complete, all of the applicable portions of the application form must be completed with accurate information; maps, if necessary, must be included; signatures of all the appropriate owners' must be affixed to the application and notarized; and the appropriate fee must be paid.

FEE SCHEDULE

Each application to change the place of use or the point of diversion under this section shall be accompanied by the application fee set forth in the schedule below: Make checks payable to: **Kansas Department of Agriculture**

- | | |
|-------------------------------------------------------------------|-------|
| (1) Application to change a point of diversion 300 feet or less | \$100 |
| (2) Application to change a point of diversion more than 300 feet | \$200 |
| (3) Application to change the place of use | \$200 |

14. If the proposed groundwater point of diversion is 300 or fewer feet from the existing point of diversion, complete the following:

- (a) Does the undersigned represent all owners of the currently authorized place(s) of use identified in this application?
☐ Yes ☐ No (If no, all owners must sign this application.)
- (b) Will the ownership interest of any owner of the currently authorized place(s) of use identified in this application be adversely affected if this application is approved as requested?
☐ Yes ☐ No (If yes, all owners must sign this application.)
- (c) If this application is not approved expeditiously, will there be substantial damage to property, public health or safety?
☐ Yes ☐ No (If no, all owners must sign this application.)

If the application proposes a surface water change in point of diversion, a groundwater change in point of diversion greater than 300 feet, or a change in place of use, the application must be signed by all owners of the currently authorized place of use, or their duly authorized agent (attach notarized statement authorizing representation).

I hereby verify, being first duly sworn upon my oath or affirmation and under penalty of perjury, that I am of lawful age and the owner, the spouse of the owner, or a duly authorized agent of the owner(s) to make this application on their behalf, in regards to the water right(s) to which this application pertains. I further verify that the statements contained in this application are true, correct and complete.

Dated at Warden city, Kansas, this 5th day of November, 20 24.

Alenta maddux

(Owner)

Kent A maddux

(Please Print)

(Owner)

(Please Print)

(Owner)

(Please Print)

(Spouse)

(Please Print)

(Spouse)

(Please Print)

(Spouse)

(Please Print)

State of Kansas

County of Finney

SS

I hereby certify that the foregoing application was signed in my presence and sworn to before me this 5th day of November, 2024.

My Commission Expires

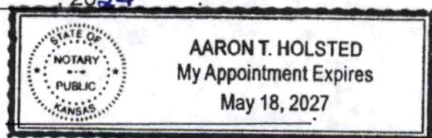

Aaron Holsted
Notary Public

ONLY COMPLETE APPLICATIONS WILL BE PROCESSED. To be complete, all of the applicable portions of the application form must be completed with accurate information; maps, if necessary, must be included; signatures of all the appropriate owners' must be affixed to the application and notarized; and the appropriate fee must be paid.

FEE SCHEDULE

Each application to change the place of use or the point of diversion under this section shall be accompanied by the application fee set forth in the schedule below: Make checks payable to: **Kansas Department of Agriculture**

- | | |
|-------------------------------------------------------------------------|-------|
| (1) Application to change a point of diversion 300 feet or less | \$100 |
| (2) Application to change a point of diversion more than 300 feet | \$200 |
| (3) Application to change the place of use | \$200 |

14. If the proposed groundwater point of diversion is 300 or fewer feet from the existing point of diversion, complete the following:
- (a) Does the undersigned represent all owners of the currently authorized place(s) of use identified in this application?
☐ Yes ☐ No (If no, all owners must sign this application.)
 - (b) Will the ownership interest of any owner of the currently authorized place(s) of use identified in this application be adversely affected if this application is approved as requested?
☐ Yes ☐ No (If yes, all owners must sign this application.)
 - (c) If this application is not approved expeditiously, will there be substantial damage to property, public health or safety?
☐ Yes ☐ No (If no, all owners must sign this application.)

If the application proposes a surface water change in point of diversion, a groundwater change in point of diversion greater than 300 feet, or a change in place of use, the application must be signed by all owners of the currently authorized place of use, or their duly authorized agent (attach notarized statement authorizing representation).

I hereby verify, being first duly sworn upon my oath or affirmation and under penalty of perjury, that I am of lawful age and the owner, the spouse of the owner, or a duly authorized agent of the owner(s) to make this application on their behalf, in regards to the water right(s) to which this application pertains. I further verify that the statements contained in this application are true, correct and complete.

Dated at Garden City, Kansas, this 8th day of November, 2024.

| | |
|------------------------------------------------------------------------------------------------------|-------------------------|
|  _____ (Owner) | _____ (Spouse) |
| <u>Clayton Medley</u> _____ (Please Print) | _____ (Please Print) |
| _____ (Owner) | _____ (Spouse) |
| _____ (Please Print) | _____ (Please Print) |
| _____ (Owner) | _____ (Spouse) |
| _____ (Please Print) | _____ (Please Print) |

State of Kansas }
County of Finney } SS

I hereby certify that the foregoing application was signed in my presence and sworn to before me this 8th day of November, 2024.

My Commission Expires _____



Aaron Holsted

Notary Public

ONLY COMPLETE APPLICATIONS WILL BE PROCESSED. To be complete, all of the applicable portions of the application form must be completed with accurate information; maps, if necessary, must be included; signatures of all the appropriate owners' must be affixed to the application and notarized; and the appropriate fee must be paid.

FEE SCHEDULE

Each application to change the place of use or the point of diversion under this section shall be accompanied by the application fee set forth in the schedule below: Make checks payable to: **Kansas Department of Agriculture**

| | |
|-------------------------------------------------------------------------|-------|
| (1) Application to change a point of diversion 300 feet or less | \$100 |
| (2) Application to change a point of diversion more than 300 feet | \$200 |
| (3) Application to change the place of use | \$200 |

14. If the proposed groundwater point of diversion is 300 or fewer feet from the existing point of diversion, complete the following:

- (a) Does the undersigned represent all owners of the currently authorized place(s) of use identified in this application?
☐ Yes ☐ No (If no, all owners must sign this application.)
- (b) Will the ownership interest of any owner of the currently authorized place(s) of use identified in this application be adversely affected if this application is approved as requested?
☐ Yes ☐ No (If yes, all owners must sign this application.)
- (c) If this application is not approved expeditiously, will there be substantial damage to property, public health or safety?
☐ Yes ☐ No (If no, all owners must sign this application.)

If the application proposes a surface water change in point of diversion, a groundwater change in point of diversion greater than 300 feet, or a change in place of use, the application must be signed by all owners of the currently authorized place of use, or their duly authorized agent (attach notarized statement authorizing representation).

I hereby verify, being first duly sworn upon my oath or affirmation and under penalty of perjury, that I am of lawful age and the owner, the spouse of the owner, or a duly authorized agent of the owner(s) to make this application on their behalf, in regards to the water right(s) to which this application pertains. I further verify that the statements contained in this application are true, correct and complete.

Dated at Garden City, Kansas, this 14th day of November, 2024.

Kyle Maddux
(Owner)
Kyle Maddux
(Please Print)

(Spouse)

(Please Print)

(Owner)

(Spouse)

(Please Print)

(Please Print)

(Owner)

(Spouse)

(Please Print)

(Please Print)

State of Kansas }
County of Linney } SS

I hereby certify that the foregoing application was signed in my presence and sworn to before me this 14th day of November, 2024.

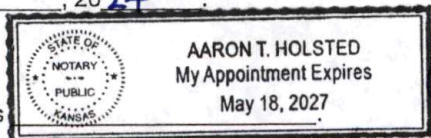

Aaron Holsted
Notary Public

My Commission Expires _____

ONLY COMPLETE APPLICATIONS WILL BE PROCESSED. To be complete, all of the applicable portions of the application form must be completed with accurate information; maps, if necessary, must be included; signatures of all the appropriate owners' must be affixed to the application and notarized; and the appropriate fee must be paid.

FEE SCHEDULE

Each application to change the place of use or the point of diversion under this section shall be accompanied by the application fee set forth in the schedule below: Make checks payable to: **Kansas Department of Agriculture**

- | | |
|-------------------------------------------------------------------|-------|
| (1) Application to change a point of diversion 300 feet or less | \$100 |
| (2) Application to change a point of diversion more than 300 feet | \$200 |
| (3) Application to change the place of use | \$200 |

SUMMARY ORDER APPROVING APPLICATION FOR CHANGE AND IMPOSING CONDITIONS

This Summary Order is issued under authority of K.S.A. 82a-708b, as amended, and K.A.R. 5-5-1, *et seq.* and other applicable provisions of the *Kansas Water Appropriation Law*, K.S.A. 82a-701 *et. seq.*, and rules and regulations promulgated thereunder. With the exception of those conditions expressly contained herein, this Summary Order does not change the terms, conditions and limitations of File No. 21743.

1. A change application was received on _____ requesting that the place of use and / or point of diversion authorized under the above-referenced file number be changed as described in the application.
2. On and after the effective date of this summary order, the authorized place(s) of use shall be located substantially as shown on the topographic map accompanying the application to change the place of use. ☐ Applicable ☐ Not Applicable
3. The change in point of diversion shall not impair existing rights and shall be limited to the same source or sources of water as previously authorized. The point of diversion authorized by this summary order shall be located within a _____ foot radius of the authorized point(s) of diversion. ☐ Applicable ☐ Not Applicable
4. The point(s) of diversion described herein is administratively corrected to be more accurately described using the Global Positioning System (GPS), as described in the application. ☐ Applicable ☐ Not Applicable
5. The point(s) of diversion authorized herein shall not actually be located more than _____ feet from the previously authorized point(s) of diversion. ☐ Applicable ☐ Not Applicable
6. As required by K.A.R. 5-3-5d, if the works for diversion is a well with a diversion rate of 100 gallons per minute or more, a tube or other device suitable for making water level measurements shall be installed, operated and maintained in accordance with K.A.R. 5-6-13. ☐ Applicable ☐ Not Applicable
7. **The owner of the authorized place(s) of use shall properly install an acceptable water flow meter on or before December 31, 20____,** or before the first use of water, whichever occurs first. The water flow meter shall be installed, operated and maintained in accordance with K.A.R. 5-1-4 through 5-1-12. As required by K.S.A. 82a-732, as amended, and K.A.R. 5-3-5e, the owner shall maintain records and report the reading of the water flow meter and the total quantity of water diverted annually to the Chief Engineer by March 1 following the end of each calendar year.
☐ Applicable ☐ Not Applicable
8. **Installation of the works for diversion of water shall be completed on or before December 31, 20____,** or within any authorized extension of time. By March 1, 20____ the applicant shall notify the Chief Engineer that construction of the works for diversion has been completed, on the form provided by the Chief Engineer, as required by K.A.R. 5-8-4e.
☐ Applicable ☐ Not Applicable
9. **The completed well log shall be submitted with the required notice.** ☐ Applicable ☐ Not Applicable
10. All diversion works into which any type of chemical or other foreign substance will be injected into the water shall be equipped with an in-line, automatic, quick-closing check valve capable of preventing pollution of the source of the water supply. The check valve(s) shall be installed, operated and maintained in accordance with K.A.R. 5-3-5c. ☐ Applicable ☐ Not Applicable
11. Additional Conditions are attached. ☐ Yes ☐ No
12. In accordance with K.S.A. 82a-708a, as amended, and K.A.R. 5-5-14, all of the owners of the authorized place(s) of use of water appropriated under the above-referenced file number are responsible for compliance with its terms, conditions and limitations, as amended and/or supplemented by this Summary Order, and with applicable provisions of the *Kansas Water Appropriation Law* and the *Rules and Regulations* promulgated thereunder. Failure to comply with these provisions may result in civil penalties pursuant to K.S.A. 82a-737, as amended, and/or the suspension or revocation and dismissal of the water or appropriation right or any other enforcement actions authorized by law.

Administrative Appeal and Effective Date of Order

If you are aggrieved by this order, pursuant to K.S.A. 82a-1901, you may request an evidentiary hearing before the Chief Engineer or request administrative review by the Secretary of Agriculture. A request for hearing by the Chief Engineer must be filed within **15 days** of service of this Order and a request for administrative review by the Secretary must be filed within **30 days** pursuant to K.S.A. 77-531. Any request for administrative review must state a basis for review pursuant to K.S.A. 77-527. File any request with **Kansas Department of Agriculture, Legal Division, 1320 Research Park Drive, Manhattan, KS 66502**. Failure to timely request a hearing or review may preclude review under the Kansas Judicial Review Act.

For Use by Register of Deeds

FOR OFFICE USE ONLY

APPLICATION APPROVED AND
SUMMARY ORDER ISSUED

By: _____
Duly Authorized Designee of the Chief Engineer

(Print Name): _____
Division of Water Resources - Kansas Department of Agriculture

Date of Issuance: _____

State of Kansas)
) ss

County of _____

Acknowledged before me on _____

by _____.

Signature: _____
Notary Public

My commission expires: _____
(Notary Seal)

Garden City Field Office
4532 W. Jones, Suite B
Garden City, KS 67846



Phone: 620-276-2901
Fax: 620-276-9315
www.agriculture.ks.gov

Mike Beam, Secretary

Laura Kelly, Governor

March 25, 2025

LARRY COMBS
2453 ROAD AA
DEERFIELD, KS 67838

RE: Application for Change
Water Right, File No. 21743

Dear Sir or Madam:

This is to advise you that Graham Farms Inc. has filed an application for approval of the Chief Engineer, Division of Water Resources, Kansas Department of Agriculture, to change the point of diversion under the above referenced applications. An irrigation well is proposed to be relocated to the SE $\frac{1}{4}$ of Section 35, Township 22 South, Range 35 West, Kearny County.

You can find the complete applications posted by water right file number as referenced above at:
<https://www.agriculture.ks.gov/divisions-programs/division-of-water-resources/water-appropriation/notices>

You are notified on this proposed point of diversion (well) so that you may furnish this office with any comments or other information you want to submit. Such comments or other information must be received in this office within 15 days from the date of this letter.

Should you have any questions, please feel free contact this office. If you would prefer, you could arrange an appointment for additional assistance. Please refer to the file number when you contact us if you wish to discuss a specific file.

Sincerely,

A handwritten signature in blue ink, appearing to read "Austin J. McColloch".

Austin J. McColloch
Assistant Water Commissioner

AM:

pc:

Garden City Field Office
4532 W. Jones, Suite B
Garden City, KS 67846

Mike Beam, Secretary



Phone: 620-276-2901
Fax: 620-276-9315
www.agriculture.ks.gov

Laura Kelly, Governor

March 25, 2025

ROGER G & RANDALL UNRUH
625 S COWGILL DR
GARDEN CITY, KS 67846-8911

RE: Application for Change
Water Right, File No. 21743

Dear Sir or Madam:

This is to advise you that Graham Farms Inc. has filed an application for approval of the Chief Engineer, Division of Water Resources, Kansas Department of Agriculture, to change the point of diversion under the above referenced applications. An irrigation well is proposed to be relocated to the SE $\frac{1}{4}$ of Section 35, Township 22 South, Range 35 West, Kearny County.

You can find the complete applications posted by water right file number as referenced above at:
<https://www.agriculture.ks.gov/divisions-programs/division-of-water-resources/water-appropriation/notices>

You are notified on this proposed point of diversion (well) so that you may furnish this office with any comments or other information you want to submit. Such comments or other information must be received in this office within 15 days from the date of this letter.

Should you have any questions, please feel free contact this office. If you would prefer, you could arrange an appointment for additional assistance. Please refer to the file number when you contact us if you wish to discuss a specific file.

Sincerely,

A handwritten signature in blue ink, appearing to read "Austin J. McColloch".

Austin J. McColloch
Assistant Water Commissioner

AM:

pc:

Garden City Field Office
4532 W. Jones, Suite B
Garden City, KS 67846

Mike Beam, Secretary



Phone: 620-276-2901
Fax: 620-276-9315
www.agriculture.ks.gov

Laura Kelly, Governor

March 25, 2025

BRIAN & DAWN GRAHAM
2546 ROAD AA
DEERFIELD, KS 67838

RE: Application for Change
Water Right, File No. 21743

Dear Sir or Madam:

This is to advise you that Graham Farms Inc. has filed an application for approval of the Chief Engineer, Division of Water Resources, Kansas Department of Agriculture, to change the point of diversion under the above referenced applications. An irrigation well is proposed to be relocated to the SE $\frac{1}{4}$ of Section 35, Township 22 South, Range 35 West, Kearny County.

You can find the complete applications posted by water right file number as referenced above at: <https://www.agriculture.ks.gov/divisions-programs/division-of-water-resources/water-appropriation/notices>

You are notified on this proposed point of diversion (well) so that you may furnish this office with any comments or other information you want to submit. Such comments or other information must be received in this office within 15 days from the date of this letter.

Should you have any questions, please feel free contact this office. If you would prefer, you could arrange an appointment for additional assistance. Please refer to the file number when you contact us if you wish to discuss a specific file.

Sincerely,

A handwritten signature in blue ink, appearing to read "Austin J. McColloch".

Austin J. McColloch
Assistant Water Commissioner

AM:

pc: