

1. File No.: 24236		2. Status Change Date:		4. Field Office: 04 - Garden City GMD: 03 - Southwest Structures File No.: Filing/Priority Date: 2/6/2025 Application Complete Date:	
3. Package File No(s): 12255; 16358; 20695; 24082; 27166 (OWNERSHIP INFO)					
5a. <input checked="" type="checkbox"/> Applicant <input checked="" type="checkbox"/> Owner <input checked="" type="checkbox"/> WUC <input type="checkbox"/> Address Change		Person ID 55539 Add Seq#		5b. <input type="checkbox"/> Owner <input type="checkbox"/> WUC <input type="checkbox"/> Address Change	
5c. <input type="checkbox"/> Owner <input type="checkbox"/> WUC <input type="checkbox"/> Address Change		Person ID Add Seq#		5d. <input type="checkbox"/> Owner <input type="checkbox"/> WUC <input type="checkbox"/> Address Change	
5e. <input type="checkbox"/> Owner <input type="checkbox"/> WUC <input type="checkbox"/> Address Change		Person ID Add Seq#		5f. <input type="checkbox"/> Owner <input type="checkbox"/> WUC <input type="checkbox"/> Address Change	
6. Change No.: C2 <input checked="" type="checkbox"/> PD <input type="checkbox"/> PU <input type="checkbox"/> UMW Base Acres: Year: Min Reasonable Q: Previous UMW: Not changing MDS Gauge: Active Admin? <input type="checkbox"/> Completion/Start Date: 12/31/2025 Perfection/Expiration Date:				7. Use of Water <input checked="" type="checkbox"/> Groundwater <input type="checkbox"/> Surface Water UMW: IRR-Irrigation UMW: UMW:	
8. Action Trail					
9. Special Conditions					
10. 5YR Allocation Type: Start Year: 5YR Quantity: Base Acres: Comment:					
11. Sand & Gravel Proj ID: <input type="checkbox"/> Active <input type="checkbox"/> Dredge <input type="checkbox"/> IND Evap <input type="checkbox"/> Jr Evap <input type="checkbox"/> Other Diversion <input type="checkbox"/> Rpt on Sr					
12. Waiver Rule ID: <input type="checkbox"/> New Date Requested: Applies: Rule No.: Justification: Rule Type: Rule SubType:					
Comments UPDATE OWNERSHIP - SEE DEED UNDER WR 12255 IN DOCUWARE. DEED INCLUDES OTHER FILES NOT CONNECTED TO THIS CHANGE - NEEDS UPDATED AS WELL. CORRECT WRIS ADDITIONALS ON PDIV 36176 & 50243 - NO CHANGE TO LIMITATIONS				Processed 3/20/2025 AM Reviewed	
				Entered	

File No. 24236	13. County: GY Basin: ARKANSAS RIVER Stream:																	
Structures File No:	Aquifer Code: 211										Special Use Area:							

14. Points of Diversion, Rates & Quantities										Qty AF		Rate gpm		Storage Qty		Storage Rate	
PDIV	Qualifier	S	T	R	ID	'N	'W	Comment (AKA Line)	Auth	Add	Auth	Add	Auth	Add	Auth/Add	Overlaps	
CHK	31438	NC NE	18	27S	29W	3	3940	1300	271	82	865	865					
MOD	36176	NW SW SE	18	27S	29W	7	1016	2370	197	82	730	0				*	
MOD	50243	NE SW NW	18	27S	29W	6	3340	4425	300	82	800	800					

15. Limitations																
Type: QUANTITY Quantity: 1088 AF Rate: combined with file no(s): 12255 & 20695																
Type: QUANTITY Quantity: 716 AF Rate: combined with file no(s): ON LAND DESCRIBED IN CERT																
Type: QUANTITY & RATE Quantity: 269 AF Rate: 730 gpm combined with file no(s): 12255 WELL ID 7																

16. Metering <input checked="" type="checkbox"/> Metering Required <input type="checkbox"/> Anti-Reverse Required <input type="checkbox"/> Seal Required Compliance Date: 12/31/2025																
-----------------------------------------------------------------------------------------------------------------------------------------------------------------------------------------	--	--	--	--	--	--	--	--	--	--	--	--	--	--	--	--

17. Place of Use																		Total	Owner(s)	Chg?	Overlaps				
PUSE	S	T	R	ID	NE¼				NW¼				SW¼				SE¼								
					NE	NW	SW	SE	NE	NW	SW	SE	NE	NW	SW	SE	NE	NW	SW	SE					
CHK	7483																						5a	<input checked="" type="checkbox"/>	**
CHK	19084																						5a	<input checked="" type="checkbox"/>	**
CHK	33211																						5a	<input checked="" type="checkbox"/>	**

18. Point of Diversion and Place of Use Overlaps																	
* 12255										** 12255; 16358; 20695; 24082; 24236 & 27166							
+										++							
#										##							
^										^^							

Garden City Field Office
4532 W. Jones, Suite B
Garden City, KS 67846

Mike Beam, Secretary



Phone: 620-276-2901
Fax: 620-276-9315
www.agriculture.ks.gov

Laura Kelly, Governor

March 20, 2025

ROGER W & MARILEE YOST
21505 8 RD
MONTEZUMA, KS 67867-9023

RE: Filed Office Application for Change
Water Right, File No. 24236

Dear Sir or Madam:

Enclosed is the order executed by the designee of the Chief Engineer, Division of Water Resources, Kansas Department of Agriculture, approving the application for change under the above referenced file number.

Your attention is directed to the enclosures and to the terms, conditions, and limitations specified in this approval for change. A condition of this approval is that an acceptable water flow meter must be installed on the diversion works authorized under the referenced file number and meet current specifications. Please return the required notification of completion of the diversion works and installation of the required meter as soon as these actions are completed.

Since the order modifies the original document referred to above, it should be recorded with the Register of Deeds as other instruments affecting real estate.

The abandoned well must be plugged in accordance with the requirements of Article 30 of the Rules and Regulations as adopted by the Kansas Department of Health and Environment.

Should you have any questions, please feel free contact this office. If you would prefer, you could arrange an appointment for additional assistance.

Sincerely,

A handwritten signature in blue ink, appearing to read "Austin J. McColloch".

Austin J. McColloch
Assistant Water Commissioner

AM:
enclosures

pc: GMD 3

CERTIFICATE OF SERVICE

On this 20th day of March, 2025, I hereby certify that the foregoing Approval of Application for Change in Point of Diversion, Water Right, File No. 24,236 dated 20th day of March, 2025 was mailed postage prepaid, first class, US mail to the following:

ROGER W & MARILEE YOST
21505 8 RD
MONTEZUMA, KS 67867-9023

Pc:

GMD 3

Division of Water Resources Staff

Submit completed application to:
Kansas Department of Agriculture
Division of Water Resources
Field Office for your area.
Call for address:

Topeka -- (785) 296-5733
Stafford -- (620) 234-5311
Stockton -- (785) 425-6787
Garden City -- (620) 276-2901
<http://agriculture.ks.gov/dwr>

DWR FIELD OFFICE APPLICATION FOR APPROVAL TO CHANGE THE PLACE OF USE AND/OR THE POINT OF DIVERSION



STATE OF KANSAS

Filing Fee Must Accompany the Application, K.S.A. 82a-708b(b), as amended.
Fee Schedule is on the third page of this application form.

Paragraph Nos. 1, 2, 3 & 5 must be completed. Complete all other applicable portions. If change in point of diversion is greater than 100 feet, or if place of use will be changed, include a topographic map or detailed plat showing the authorized and proposed point(s) of diversion and/or place of use.

File No. 24236

RECEIVED
3:40 pm
FEB 06 2025

Garden City Field Office
Division of Water Resources

1. Application is hereby made for approval of the Chief Engineer to change the (check one or both):

☐ Place of Use ☒ Point of Diversion

under the water right which is the subject of this application in accordance with the conditions described below.

The source of supply is: ☒ Groundwater ☐ Surface water

2. Name and address of Applicant: ROGER YOST, 21505 8 RD MONTEZUMA, KS 67867 - 9023

Phone Number: ()

Email address:

Name and address of Water Use Correspondent: SAME AS ABOVE

Phone Number: ()

Email address:

3. ~~The presently authorized place of use is:~~

~~Owner of Land ---- NAME:~~

~~ADDRESS:~~

~~(If there is more than one landowner, attach supplemental sheets as necessary.)~~

Sec.	Twp.	Range	NE¼				NW¼				SW¼				SE¼				TOTAL ACRES
			NE¼	NW¼	SW¼	SE¼	NE¼	NW¼	SW¼	SE¼	NE¼	NW¼	SW¼	SE¼	NE¼	NW¼	SW¼	SE¼	

4. If this application is for a change in place of use, it is proposed that the place of use be changed to:

Owner of Land ---- NAME:

ADDRESS:

(If there is more than one landowner, attach supplemental sheets as necessary.)

Sec.	Twp.	Range	NE¼				NW¼				SW¼				SE¼				TOTAL ACRES
			NE¼	NW¼	SW¼	SE¼	NE¼	NW¼	SW¼	SE¼	NE¼	NW¼	SW¼	SE¼	NE¼	NW¼	SW¼	SE¼	

For Office Use Only: Code CGT Fee \$ 200.00 TR # _____ Receipt Date 2-6-25 Check # PY250247V49

Presently authorized point of diversion:

One in the NE Quarter of the SW Quarter of the NW Quarter
 of Section 18, Township 27 South, Range 29 (W),
 in GRAY County, Kansas, 3340 feet North 4425 feet West of Southeast corner of section.
 Authorized Rate 800GPM Authorized Quantity 228AF Depth of well _____ (feet)

(DWR use only: Computer ID No. 6 GPS feet North feet West)

☐ This point will not be changed ☒ This point will be changed as follows: ☐ No change, point better described with GPS as follows:

Proposed point of diversion: (Complete only if change is requested or if existing point is better described by GPS)

One in the NE Quarter of the SW Quarter of the NW Quarter
 of Section 18, Township 27 South, Range 29 (W),
 in GRAY County, Kansas, 3340 feet North 4425 feet West of Southeast corner of section.

Proposed Rate 800GPM Proposed Quantity 300AF Proposed well depth (feet) _____

This point is: ☐ Additional Well ☐ Geo Center List other water rights that will use this point _____

6. Presently authorized point of diversion:

One in the NW Quarter of the SW Quarter of the SE Quarter
 of Section 18, Township 27 South, Range 29 (W),
 in GRAY County, Kansas, 1016 feet North 2370 feet West of Southeast corner of section.

Authorized Rate 730GPM Authorized Quantity 269AF Depth of well _____ (feet)

(DWR use only: Computer ID No. 7 GPS feet North feet West)

☐ This point will not be changed ☒ This point will be changed as follows: ☐ No change, point better described with GPS as follows:

Proposed point of diversion: (Complete only if change is requested or if existing point is better described by GPS)

One in the NW Quarter of the SW Quarter of the SE Quarter
 of Section 18, Township 27 South, Range 29 (W),
 in GRAY County, Kansas, 1016 feet North 2370 feet West of Southeast corner of section.

Proposed Rate 730GPM Proposed Quantity 197AF Proposed well depth (feet) _____

This point is: ☐ Additional Well ☐ Geo Center List other water rights that will use this point 12255

7. The changes herein are desired for the following reasons?
 (please be specific) MOVE QUANTITY TO BETTER SUIT OPERATION

If a well, is the test hole log attached? ☐ Yes ☒ No

8. The change(s) (was)(will be) completed by?

9. If the point of diversion is a well:

(a) What are you going to do with the old well?

N/A

(b) When will this be done? ASAP

10. Groundwater Management District recommendation attached?

☐ Yes ☒ No

11. Assisted by AARON HESS

- 13a. If the proposed point of diversion will be relocated more than 300 feet but within 2,640 feet of the existing point of diversion, attach a topographic map or aerial photograph. For groundwater sources, show all wells (including domestic) within one-half mile of the proposed point of diversion and the names and mailing addresses of the owners. For surface water sources, show the names and addresses of the landowner(s) one-half mile downstream and one-half mile upstream from your property lines

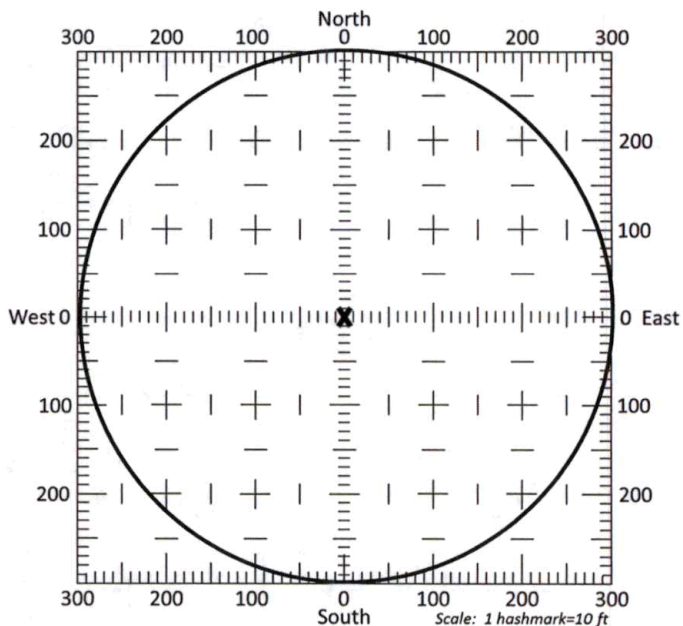

- 13b. If the proposed point of diversion will be relocated within a 300 foot radius of the existing point of diversion, indicate its location on the diagram shown above in relation to the existing point of diversion. The proposed point of diversion must be located within the circle shown above. (PLEASE NOTE: The "X" in center of diagram above represents the presently authorized point of diversion.)

APPLICATION FOR APPROVAL TO CHANGE
THE PLACE OF USE AND/OR POINT OF DIVERSION
SUPPLEMENTAL SHEET
FILE NO. 24236

Presently authorized point of diversion:

One in the _____ Quarter of the _____ NC _____ Quarter of the _____ NE _____ Quarter
of Section _____ 18 _____ Township _____ 27 _____ South, Range _____ 29 _____ (W),
in GRAY _____ County, Kansas, _____ 3940 _____ feet North _____ 2370 _____ feet West of Southeast corner of section.

Authorized Rate _____ 865GPM _____ Authorized Quantity _____ 271AF _____ Depth of well _____ (feet)

(DWR use only: Computer ID No. 3 _____ GPS _____ feet North _____ feet West)

☒ This point will not be changed ☐ This point will be changed as follows: ☐ No change, point better described with GPS as follows:

Proposed point of diversion: (Complete only if change is requested)

One in the _____ Quarter of the _____ Quarter of the _____ Quarter
of Section _____ Township _____ South, Range _____ (W),
in _____ County, Kansas, _____ feet North _____ feet West of Southeast corner of section.

Proposed Rate _____ Proposed Quantity _____ Proposed well depth (feet) _____

This point is: ☐ Additional Well ☐ Geo Center List other water rights that will use this point _____

Presently authorized point of diversion:

One in the _____ Quarter of the _____ Quarter of the _____ Quarter
of Section _____ Township _____ South, Range _____ (W),
in _____ County, Kansas, _____ feet North _____ feet West of Southeast corner of section.

Authorized Rate _____ Authorized Quantity _____ Depth of well _____ (feet)

(DWR use only: Computer ID No. _____ GPS _____ feet North _____ feet West)

☐ This point will not be changed ☒ This point will be changed as follows: ☐ No change, point better described with GPS as follows:

Proposed point of diversion: (Complete only if change is requested)

One in the _____ Quarter of the _____ Quarter of the _____ Quarter
of Section _____ Township _____ South, Range _____ (W),
in _____ County, Kansas, _____ feet North _____ feet West of Southeast corner of section.

Proposed Rate _____ Proposed Quantity _____ Proposed well depth (feet) _____

This point is: ☐ Additional Well ☐ Geo Center List other water rights that will use this point _____

Presently authorized point of diversion:

One in the _____ Quarter of the _____ Quarter of the _____ Quarter
of Section _____ Township _____ South, Range _____ (E/W),
in _____ County, Kansas, _____ feet North _____ feet West of Southeast corner of section.

Authorized Rate _____ Authorized Quantity _____ Depth of well _____ (feet)

(DWR use only: Computer ID No. _____ GPS _____ feet North _____ feet West)

☐ This point will not be changed ☐ This point will be changed as follows: ☐ No change, point better described with GPS as follows:

Proposed point of diversion: (Complete only if change is requested)

One in the _____ Quarter of the _____ Quarter of the _____ Quarter
of Section _____ Township _____ South, Range _____ (E/W),
in _____ County, Kansas, _____ feet North _____ feet West of Southeast corner of section.

Proposed Rate _____ Proposed Quantity _____ Proposed well depth (feet) _____

This point is: ☐ Additional Well ☐ Geo Center List other water rights that will use this point _____

Presently authorized point of diversion:

One in the _____ Quarter of the _____ Quarter of the _____ Quarter
of Section _____ Township _____ South, Range _____ (E/W),
in _____ County, Kansas, _____ feet North _____ feet West of Southeast corner of section.

Authorized Rate _____ Authorized Quantity _____ Depth of well _____ (feet)

(DWR use only: Computer ID No. _____ GPS _____ feet North _____ feet West)

☐ This point will not be changed ☐ This point will be changed as follows: ☐ No change, point better described with GPS as follows:

Proposed point of diversion: (Complete only if change is requested)

One in the _____ Quarter of the _____ Quarter of the _____ Quarter
of Section _____ Township _____ South, Range _____ (E/W),
in _____ County, Kansas, _____ feet North _____ feet West of Southeast corner of section.





Proposed Rate _____ Proposed Quantity _____ Proposed well depth (feet) _____

This point is: ☐ Additional Well ☐ Geo Center List other water rights that will use this point _____

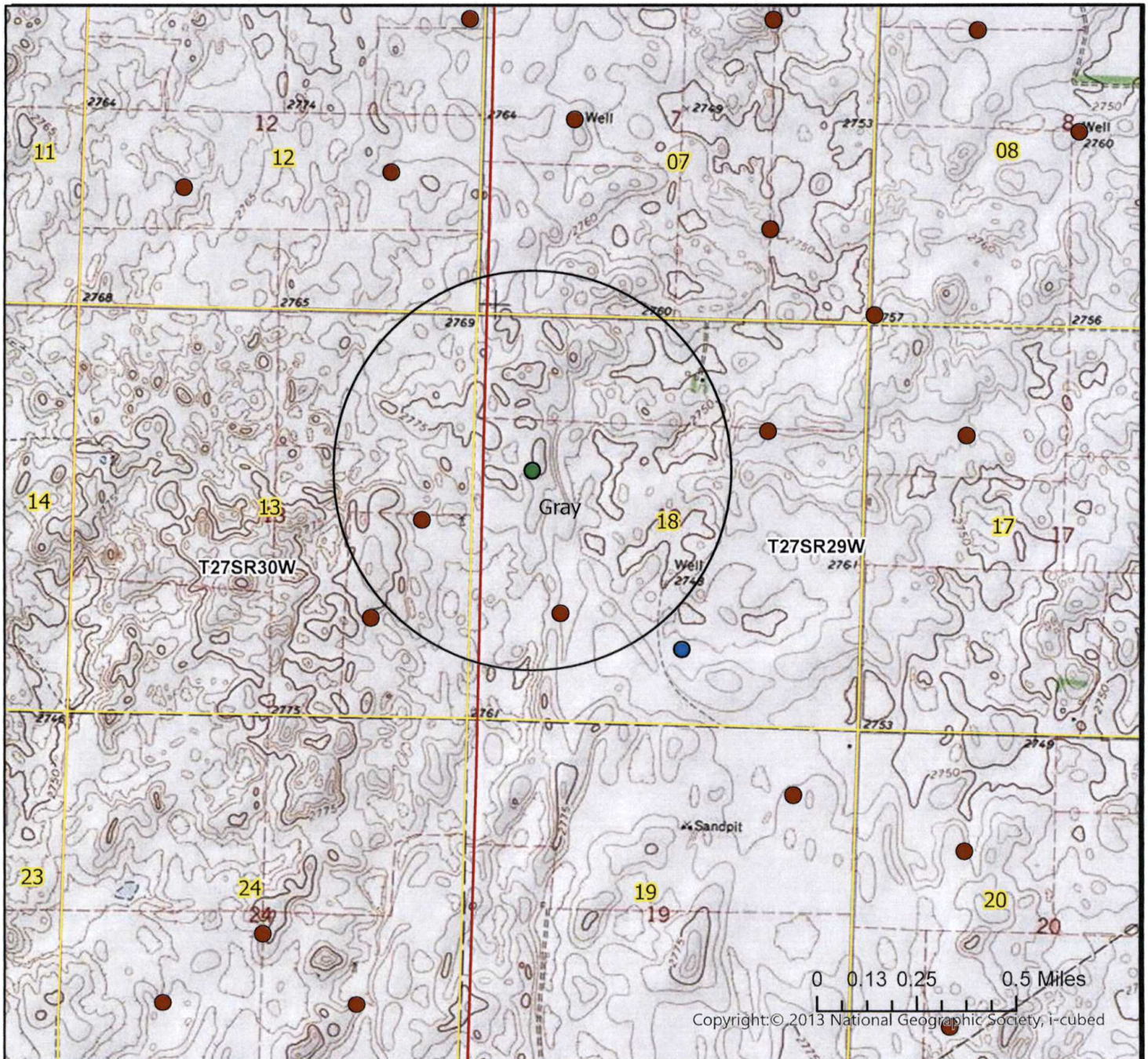
CHANGE IN POINT OF DIVERSION WATER RIGHT, FILE NO. 24236

NW 1/4 of Section 18 Township 27 South Range 29 West Gray County



-  Authorized Point of Diversion
-  Proposed Point of Diversion
-  Permitted Water Right
-  Domestic Well within 1/2 mile
-  1/2 mile buffer

List of owner name and addresses within 1/2 mile:



By signing below I agree that all wells, including domestic, and owners names and addresses within 1/2 mile of the proposed point of diversion have been shown on the map

(Signature)

Date

Date 2/6/2025 AH/GCFO
1:24,000 Scale

14. If the proposed groundwater point of diversion is 300 or fewer feet from the existing point of diversion, complete the following:

- (a) Does the undersigned represent all owners of the currently authorized place(s) of use identified in this application?
☐ Yes ☐ No (If no, all owners must sign this application.)
- (b) Will the ownership interest of any owner of the currently authorized place(s) of use identified in this application be adversely affected if this application is approved as requested?
☐ Yes ☐ No (If yes, all owners must sign this application.)
- (c) If this application is not approved expeditiously, will there be substantial damage to property, public health or safety?
☐ Yes ☐ No (If no, all owners must sign this application.)

If the application proposes a surface water change in point of diversion, a groundwater change in point of diversion greater than 300 feet, or a change in place of use, the application must be signed by all owners of the currently authorized place of use, or their duly authorized agent (attach notarized statement authorizing representation).

I hereby verify, being first duly sworn upon my oath or affirmation and under penalty of perjury, that I am of lawful age and the owner, the spouse of the owner, or a duly authorized agent of the owner(s) to make this application on their behalf, in regards to the water right(s) to which this application pertains. I further verify that the statements contained in this application are true, correct and complete.

Dated at Garden City, Kansas, this 6th day of February, 20 25.

Roger Yost
(Owner)

Roger Yost
(Please Print)

(Owner)

(Please Print)

(Owner)

(Please Print)

(Spouse)

(Please Print)

(Spouse)

(Please Print)

(Spouse)

(Please Print)

State of Kansas }
County of Leney } SS

I hereby certify that the foregoing application was signed in my presence and sworn to before me this 6th day of February, 20 25.

My Commission Expires

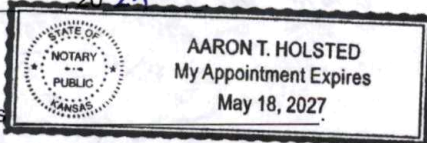

Aaron Holsted
Notary Public

ONLY COMPLETE APPLICATIONS WILL BE PROCESSED. To be complete, all of the applicable portions of the application form must be completed with accurate information; maps, if necessary, must be included; signatures of all the appropriate owners' must be affixed to the application and notarized; and the appropriate fee must be paid.

FEE SCHEDULE

Each application to change the place of use or the point of diversion under this section shall be accompanied by the application fee set forth in the schedule below: Make checks payable to: **Kansas Department of Agriculture**

- | | |
|-------------------------------------------------------------------|-------|
| (1) Application to change a point of diversion 300 feet or less | \$100 |
| (2) Application to change a point of diversion more than 300 feet | \$200 |
| (3) Application to change the place of use | \$200 |

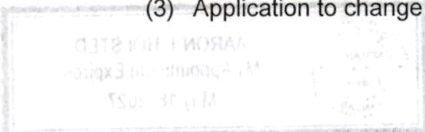

SUMMARY ORDER APPROVING APPLICATION FOR CHANGE AND IMPOSING CONDITIONS

This Summary Order is issued under authority of K.S.A. 82a-708b, as amended, and K.A.R. 5-5-1, *et seq.* and other applicable provisions of the *Kansas Water Appropriation Law*, K.S.A. 82a-701 *et seq.*, and rules and regulations promulgated thereunder. With the exception of those conditions expressly contained herein, this Summary Order does not change the terms, conditions and limitations of File No. 24236.

1. A change application was received on February 6, 2025 requesting that the place of use and / or point of diversion authorized under the above-referenced file number be changed as described in the application.
2. On and after the effective date of this summary order, the authorized place(s) of use shall be located substantially as shown on the topographic map accompanying the application to change the place of use. ☐ Applicable ☒ Not Applicable
3. The change in point of diversion shall not impair existing rights and shall be limited to the same source or sources of water as previously authorized. The point of diversion authorized by this summary order shall be located within a foot radius of the authorized point(s) of diversion. ☐ Applicable ☒ Not Applicable
4. The point(s) of diversion described herein is administratively corrected to be more accurately described using the Global Positioning System (GPS), as described in the application. ☐ Applicable ☒ Not Applicable
5. The point(s) of diversion authorized herein shall not actually be located more than feet from the previously authorized point(s) of diversion. ☐ Applicable ☒ Not Applicable
6. As required by K.A.R. 5-3-5d, if the works for diversion is a well with a diversion rate of 100 gallons per minute or more, a tube or other device suitable for making water level measurements shall be installed, operated and maintained in accordance with K.A.R. 5-6-13. ☒ Applicable ☐ Not Applicable
7. The owner of the authorized place(s) of use shall properly install an acceptable water flow meter on or before December 31, 2025, or before the first use of water, whichever occurs first. The water flow meter shall be installed, operated and maintained in accordance with K.A.R. 5-1-4 through 5-1-12. As required by K.S.A. 82a-732, as amended, and K.A.R. 5-3-5e, the owner shall maintain records and report the reading of the water flow meter and the total quantity of water diverted annually to the Chief Engineer by March 1 following the end of each calendar year. ☒ Applicable ☐ Not Applicable
8. Installation of the works for diversion of water shall be completed on or before December 31, 2025, or within any authorized extension of time. By March 1, 2026 the applicant shall notify the Chief Engineer that construction of the works for diversion has been completed, on the form provided by the Chief Engineer, as required by K.A.R. 5-8-4e. ☒ Applicable ☐ Not Applicable
9. The completed well log shall be submitted with the required notice. ☐ Applicable ☒ Not Applicable
10. All diversion works into which any type of chemical or other foreign substance will be injected into the water shall be equipped with an in-line, automatic, quick-closing check valve capable of preventing pollution of the source of the water supply. The check valve(s) shall be installed, operated and maintained in accordance with K.A.R. 5-3-5c. ☒ Applicable ☐ Not Applicable
11. Additional Conditions are attached. ☐ Yes ☒ No
12. In accordance with K.S.A. 82a-708a, as amended, and K.A.R. 5-5-14, all of the owners of the authorized place(s) of use of water appropriated under the above-referenced file number are responsible for compliance with its terms, conditions and limitations, as amended and/or supplemented by this Summary Order, and with applicable provisions of the *Kansas Water Appropriation Law* and the *Rules and Regulations* promulgated thereunder. Failure to comply with these provisions may result in civil penalties pursuant to K.S.A. 82a-737, as amended, and/or the suspension or revocation and dismissal of the water or appropriation right or any other enforcement actions authorized by law.

Administrative Appeal and Effective Date of Order

If you are aggrieved by this order, pursuant to K.S.A. 82a-1901, you may request an evidentiary hearing before the Chief Engineer or request administrative review by the Secretary of Agriculture. A request for hearing by the Chief Engineer must be filed within **15 days** of service of this Order and a request for administrative review by the Secretary must be filed within **30 days** pursuant to K.S.A. 77-531. Any request for administrative review must state a basis for review pursuant to K.S.A. 77-527. File any request with **Kansas Department of Agriculture, Legal Division, 1320 Research Park Drive, Manhattan, KS 66502**. Failure to timely request a hearing or review may preclude review under the Kansas Judicial Review Act.

For Use by Register of Deeds

FOR OFFICE USE ONLY APPLICATION APPROVED AND SUMMARY ORDER ISSUED

By: Austin McColloch
Duly Authorized Designee of the Chief Engineer
(Print Name): Austin McColloch
Division of Water Resources - Kansas Department of Agriculture
Date of Issuance: March 20, 2025
State of Kansas)
County of Linney) SS
Acknowledged before me on March 20, 2025
by Austin McColloch
Signature: Aaron Holsted
Notary Public

My commission expires: May 18, 2027
(Notary Seal)

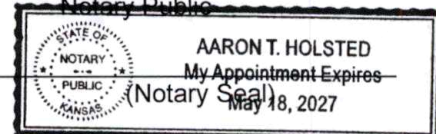

KANSAS DEPARTMENT OF AGRICULTURE
Division of Water Resources
Garden City Field Office

M E M O R A N D U M

TO: File

DATE: March 17, 2025

FROM: Austin J. McColloch *AM*
Assistant Water Commissioner

RE: File No. 24236

An *Application to Change the Point of Diversion* under the above referenced water right was received in this office February 6, 2025. The application proposes to adjust the authorized quantity between two of the three wells authorized under the water right – no new well is being drilled. The proposed 72 AF move from the SE/4 well to the NW/4 well upholds the well to well spacing of the proposed well – however, the wells are located over half a mile apart. This application received a recommendation from the GMD3 that there were concerning effects with the proposal to change the point of diversion due to the low saturated thickness of the area – no recommendation of a waiver for distance moved was provided.

Due to the low quantity adjustment proposed, all wells within a half a mile are owned by the applicant, well spacing is met and GMD drawdown estimations only having an allowance of 1 ft with the largest drawdown calculation showing 1.4 ft net drawdown, approval of the application will not prejudicially or unreasonably affect the public interest, it is recommended that the referenced application be approved.



Southwest Kansas
Groundwater Management District No. 3
2009 E. Spruce Street
Garden City, Kansas 67846
(620) 275-7147 phone
www.gmd3.org

March 3, 2025

Austin McColloch
Division of Water Resources
4532 W Jones Ave., Suite B
Garden City, Kansas 67846

RE: Application for Change in Point of Diversion
Water Right, File No. 24236

Dear Austin:

We have completed a review of the application for the above referenced water right. The proposed change in point of diversion is in accordance with current area rules, K.A.R. 5-23-3, as it pertains to minimum spacing to neighboring wells and distance moved.

Well evaluations were conducted to estimate possible effects of the proposal on the supply of other wells with water rights prior to the proposal per K.S.A. 82a-708b, and the management program. Under K.S.A. 82a-708b, an applicant requesting a change in point of diversion must demonstrate to the chief engineer that any proposed change is reasonable and will not impair. The enclosed report is an analysis performed by the GMD on behalf of our membership. Under this analysis, the proposed change is considered to be reasonable and unlikely to impair if either the net in-season well-to-well effect of the proposed change is less than a strict maximum allowable threshold (1.0 ft with saturated thickness is less than 50ft), or if no well with a net well-to-well effect exceeding the threshold is identified as critical. Critical wells are identified as wells that are expected to either lose or greatly diminish water supply over the next 25 years. The attached review information is based on a Theis analysis using inputs from the GMD3 aquifer model, which is considered to be the best information on well and aquifer data readily and easily available to the public. If either the applicant or the neighbors believe they have better data that might change the result of the analysis, they should contact GMD3. Conclusions of the well analysis may change if better information on well and aquifer data can be made available.

Every neighboring well within 1 mile of the proposed move was evaluated. Evaluations showed that the neighboring wells exceeded the net effect above the maximum allowable threshold and needed further evaluation. Critical wells were determined in the area mainly due to the areas already low saturated thickness. We did not receive any comments from neighboring well owners. Therefore, GMD3 sees this move as meeting current area rules and would recommend approval if the State agrees with our conclusions. If aquifer conditions change or there is a change to the water right in the future, we would be happy to evaluate the effects at that time.

Thank you for the opportunity to review the applications and to provide a recommendation. If you have any questions, please don't hesitate to contact us.

Sincerely,

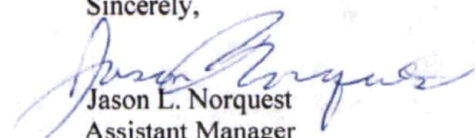
Jason L. Norquest
Assistant Manager

Working Water Conservation Every Day Since 1976

RECEIVED

MAR 03 2025

Garden City Field Office
Division of Water Resources

GMD3 Change Review

File No(s): 24236. DWR office: GC.

App filed to change: PD (Reallocation between wells).

Is Landowner(s) correct in WRIS: Roger Yost.

If NO, is documentation included?

Is Water Use Correspondent correct in WRIS? .

If NO, is documentation included?

Regulation(s) Reviewed: KAR 5-23-3

Point of diversion ID No(s) being changed.

	ft. North	ft. West	
Authorized PD	3340	4425	Sect 18-27-29
Proposed PD	1016	2370	
Difference	2324	2055	
$a^2 + b^2 = c^2$	5400976	4223025	3102.257 feet apart

GPS for proposed PD: Lat: Long: .

Is proposed PD stacking on existing WRs? Reallocation between 2 of the wells.

Is Proposed PU overlapping existing WRs? No Change.

Neighboring certified well(s) notified: .

Name Golden Plains Farm LLC (9162D2, 9994D2, 19492).

Address 10203BB RD.

Zip Montezuma, KS 67867.

Email: gpcustomseedcleaning@gmail.com

Name Verlyn @ Nola Yost (21095).

Address 25304 10 RD.

Zip Montezuma, KS 67867.

Email: verlynnola@gmail.com

Domestic well(s) notified: .

Name .

Address .

Zip .

Base Acres: .

Perfected Acres: .

Irr. Return-Flow %

Gray County

Reallocation proposed, no new wells.

ID06: 228AF @ 800gpm

300AF @ 800gpm, adding 72AF

ID07: 269AF @ 730gpm

GMD3 Change Review

197AF @ 730gpm, reducing 72AF

ID03: 271AF @ 865gpm, this PD won't change

Is a waiver needed: reallocation is further than half mile, but within the same WR, considered same source then. Minimum Spacing still maintained to neighboring wells. Analysis shows possible effects above guidelines, however this is in a low saturated area to start with and any effects could be noticable.

Recommendation: After review of available information, it appears current area rules are met. Critical wells are possible due to the low saturated area to start with, so any effects could be noticeable. Staff recommends approval if the State agrees with conclusions.



Water Rights and Points of Diversion Within 1 mile of point defined as:

3340 Feet N and 4425 Feet W of the Southeast Corner of Section 18 Twp 27S Rng 29W

Located at: 100.540183 West Longitude and 37.702295 North Latitude

Both SURFACE WATER and GROUNDWATER

File Number	Use	ST	SR	Dist (ft)	Q4	Q3	Q2	Q1	FeetN	FeetW	Sec	Twp	Rng	ID	Batt	Auth_Quan	Add_Quan					
A__ Unit																						
A__ AF	9162	D2	IRR	NK	G				4693	--	--	NC	W2	2620	3980	7	27	29W	1		220.00	220.00
A__ AF	9994	D2	IRR	NK	G				4693	--	--	NC	W2	2620	3980	7	27	29W	1		349.00	349.00
A__ AF	12255	00	IRR	NK	G				3099	--	NW	SW	SE	1016	2370	18	27	29W	7		160.00	160.00
A__ AF	16358	00	IRR	NK	G				4398	--	SW	NE	SE	1850	1200	12	27	30W	1		215.00	215.00
A__ AF	19492	00	IRR	NK	G				4509	--	NE	SW	SE	1220	1340	7	27	29W	4		272.00	272.00
A__ AF	20695	00	IRR	NK	G				1607	--	NC	E2	E2	2640	675	13	27	30W	3		315.00	315.00
Same AF									1964	--	--	NC	SW	1430	3960	18	27	29W	5		367.00	367.00
A__ AF	21095	00	IRR	NK	G				5030	--	SW	SW	SW	79	5163	8	27	29W	5		260.00	260.00
A__ AF	24236	00	IRR	NK	G*				5	--	NE	SW	NW	3340	4425	18	27	29W	6		228.00	.00
Same AF									3099	--	NW	SW	SE	1016	2370	18	27	29W	7		269.00	.00
Same AF									3177	--	--	NC	NE	3940	1300	18	27	29W	3		271.00	82.00
A__ AF	27166	00	IRR	NK	G				2918	--	--	NC	SE	1320	1320	13	27	30W	2		244.00	189.00
P__ AF	20240137	00	IND	GY	G				1607	--	NC	E2	E2	2640	675	13	27	30W	3		3.07	3.07
P__ AF	20240138	00	IND	GY	G				1607	--	NC	E2	E2	2640	675	13	27	30W	3		3.07	3.07

Total Net Quantities Authorized:	Direct	Storage
Total Requested Amount (AF) =	.00	.00
Total Permitted Amount (AF) =	6.14	.00
Total Inspected Amount (AF) =	.00	.00
Total Pro_Cert Amount (AF) =	.00	.00
Total Certified Amount (AF) =	2429.00	.00
Total Vested Amount (AF) =	.00	.00
TOTAL AMOUNT (AF) =	2435.14	.00

An * after the source of supply indicates a pending application for change under the file number.

An * after the ID indicates a 15 AF exemption was granted under the file number.

A "G" in the Batt column indicates the GEO CTR of a battery. A "B" indicates a well in the battery.

The number in the Batt column is the number of wells in the battery.

Water Rights and Points of Diversion Within 1 mile of point defined as:

3340 Feet North and 4425 Feet West of the Southeast Corner of Section 18 Twp 27S Rng 29W

Located at: 100.540183 West Longitude and 37.702295 North Latitude

Both SURFACE WATER and GROUNDWATER

WATER USE CORRESPONDENTS:

File Number	Use	ST	SR
> GOLDEN PLAINS FARM LLC			
> 10203 BB RD			
> MONTEZUMA KS 67867			

9162 D2

> GOLDEN PLAINS FARM LLC

> 10203 BB RD

> MONTEZUMA KS 67867

> ROGER W & MARILEE YOST

> 21505 8 RD

> MONTEZUMA KS 67867

> ROGER W & MARILEE YOST

> 21505 8 RD

> MONTEZUMA KS 67867

> GOLDEN PLAINS FARM LLC

> 10203 BB RD

> MONTEZUMA KS 67867

> ROGER W & MARILEE YOST

> 21505 8 RD

> MONTEZUMA KS 67867

> VERLYN & NOLA YOST

> 25304 10 RD

> MONTEZUMA KS 67867

> ROGER W & MARILEE YOST

> 21505 8 RD

> MONTEZUMA KS 67867

> ROGER W & MARILEE YOST

> 21505 8 RD

> MONTEZUMA KS 67867

> RAYMOND OIL CO INC

> PO BOX 48788

> WICHITA KS 67201

> RAYMOND OIL CO INC

> PO BOX 48788

> WICHITA KS 67201

9994 DR

12755

Applicant

16358

Applicant

19492

20695

Applicant

21095

24236

Application

27166

Applicant

Evaluation of proposed move for Water Right No. 24236

Proposed: Move 72 AF of authority from the well authorized under water right nos. 12255 & 24236 to the well authorized under water right no. 24236 ID 6.

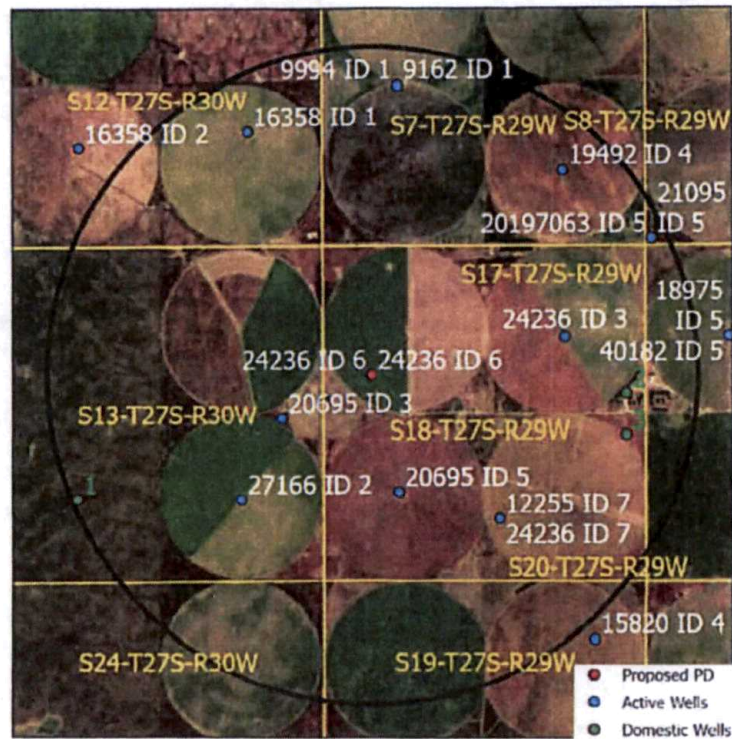

Wells within 1 mile: 24236 ID3, 12255 & 24236, 20695 ID3, 20695 ID5, 16358, 9162 & 9994, 19492, 21095, 27166, and three domestic wells, numbered on the above map.

The saturated thickness at the proposed well location is estimated to be 41 ft, based upon the GMD3 model. For saturated thickness less than 50 ft, the drawdown allowance is 1.0 ft.

50 year Theis Analysis: The following values were used to run the analysis:

$S = 0.052$, $T = 4100.8 \text{ ft}^2/\text{day}$, $tp_{\text{current}} = 120 \text{ days}$, $Q_{\text{current}} = 383 \text{ gpm}$, $tp_{\text{proposed}} = 177 \text{ days}$, $Q_{\text{proposed}} = 383 \text{ gpm}$

Theis drawdowns were calculated as follows:

24236 ID3:	Drawdown from current location = 3.42 ft
	Drawdown from proposed location = 4.71 ft
	Net drawdown = 1.3 ft
12255 & 24236:	Drawdown from current location = 3.48 ft
	Drawdown from proposed location = 4.77 ft
	Net drawdown = 1.3 ft

20695 ID3: Drawdown from current location = 5.10 ft
Drawdown from proposed location = 6.51 ft
Net drawdown = **1.4 ft**

20695 ID5: Drawdown from current location = 4.60 ft
Drawdown from proposed location = 5.99 ft
Net drawdown = **1.4 ft**

16358: Drawdown from current location = 2.78 ft
Drawdown from proposed location = 3.94 ft
Net drawdown = **1.2 ft**

9162 & 9994: Drawdown from current location = 2.67 ft
Drawdown from proposed location = 3.81 ft
Net drawdown = **1.1 ft**

19492: Drawdown from current location = 2.73 ft
Drawdown from proposed location = 3.89 ft
Net drawdown = **1.2 ft**

21095: Drawdown from current location = 2.55 ft
Drawdown from proposed location = 3.66 ft
Net drawdown = **1.1 ft**

27166: Drawdown from current location = 3.62 ft
Drawdown from proposed location = 4.92 ft
Net drawdown = **1.3 ft**

Domestic 1: Drawdown from current location = 2.49 ft
Drawdown from proposed location = 3.60 ft
Net drawdown = **1.1 ft**

Domestic 2: Drawdown from current location = 2.89 ft
Drawdown from proposed location = 4.09 ft
Net drawdown = **1.2 ft**

Domestic 3: Drawdown from current location = 2.85 ft
 Drawdown from proposed location = 4.03 ft
 Net drawdown = 1.2 ft

Net drawdown exceeds the drawdown allowance for all nearby wells. These wells are all critical because projected saturated thickness is less than 60 ft.

Conclusion:

The proposed move is in a depleted aquifer area with about 40 ft of remaining saturated thickness. The analysis shows that net well-to-well effects created by this proposal are likely to be just over 1 ft. This effect is small, but all nearby wells were flagged as critical because well effects were greater than 1 ft and current saturated thickness is less than 50 ft. The GMD3 model projects this area will have about 27 ft of saturated thickness remaining in 25 years, and that decline will significantly affect the ability of wells to produce water. Concerned neighbors should contact GMD3 at (620) 275-7147 or the Division of Water Resources at (620) 276-2901.

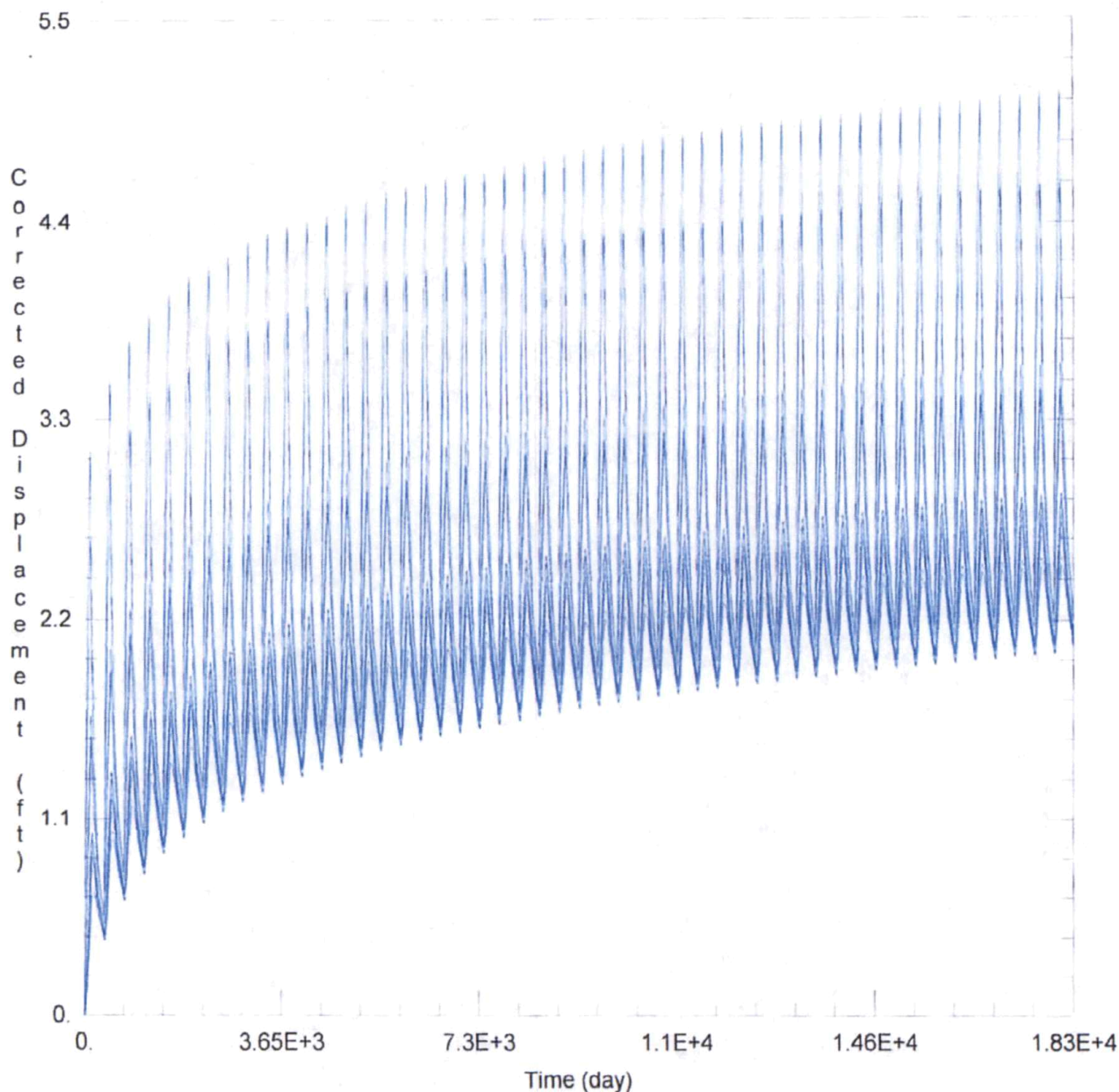

WELL TEST ANALYSIS

Data Set: C:\Users\trevora\Documents\2025_moves\24236\242363 Current.aqt

Date: 02/21/25

Time: 15:49:06

PROJECT INFORMATION

Company: GMD 3

Project: 24236

Location: Gray County

WELL DATA

Pumping Wells			Observation Wells		
Well Name	X (ft)	Y (ft)	Well Name	X (ft)	Y (ft)
24236 ID6	75005	301331	24236 ID3	75005	301331
				78128	301011

6.7

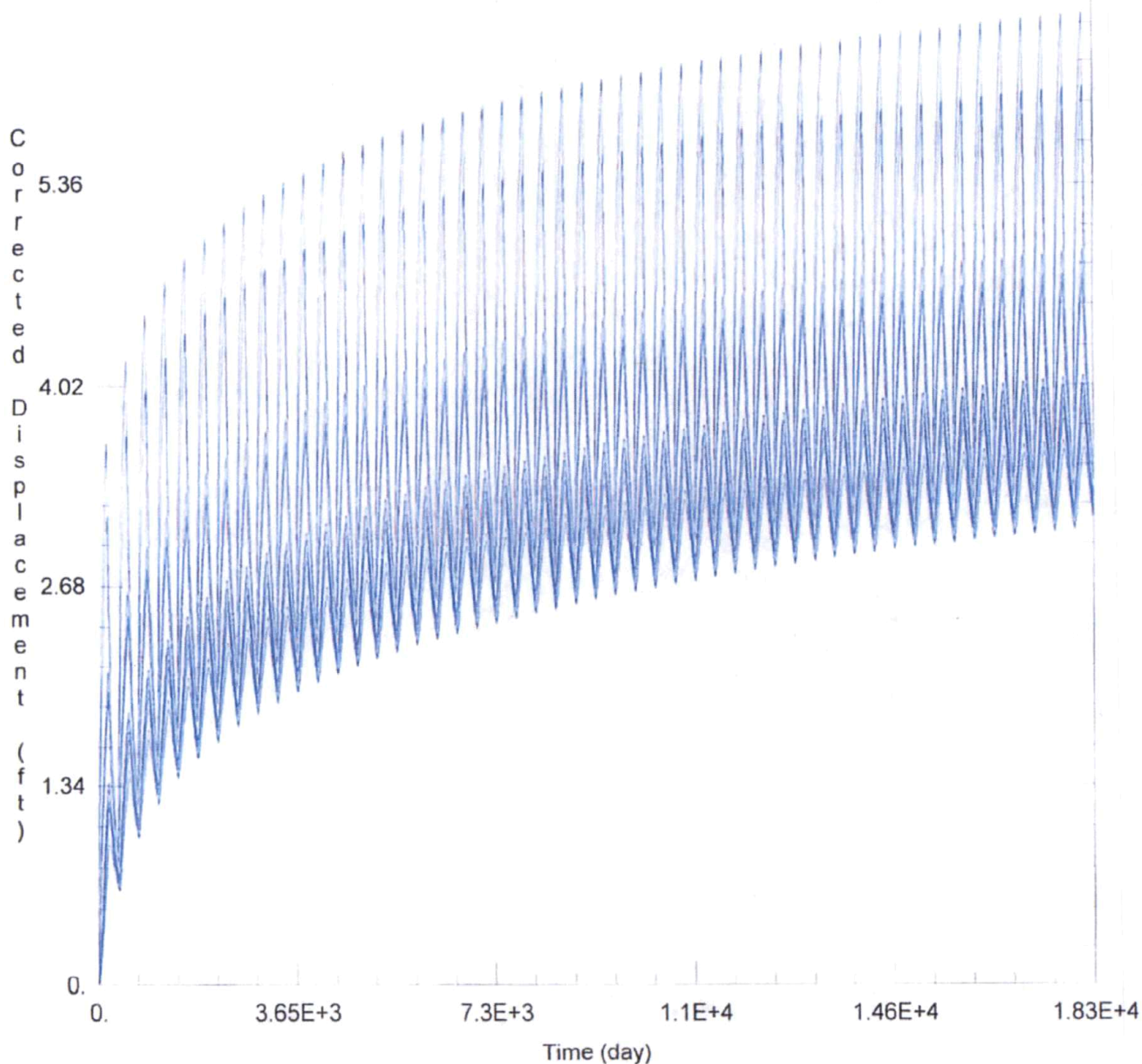

WELL TEST ANALYSIS

Data Set: C:\Users\trevora\Documents\2025_moves\24236\242363 Proposed.aqt

Date: 02/21/25

Time: 15:48:52

PROJECT INFORMATION

Company: GMD 3

Project: 24236

Location: Gray County

WELL DATA

Pumping Wells

Well Name	X (ft)	Y (ft)
24236 ID6	75005	301331

Observation Wells

Well Name	X (ft)	Y (ft)
24236 ID3	75005	301331
	78128	301011

Garden City Field Office
4532 W. Jones, Suite B
Garden City, KS 67846

Mike Beam, Secretary



Phone: 620-276-2901
Fax: 620-276-9315
www.agriculture.ks.gov

Laura Kelly, Governor

February 10, 2025

GROUNDWATER MANAGEMENT DISTRICT #3
2009 E SPRUCE ST
GARDEN CITY KS 67846

Re: Request for Recommendation,
File No. 24236

Dear Sir or Madam:

We are enclosing a copy of the referenced application, which was submitted by Roger Yost and appears to be in proper form, for your review.

We are delaying any further action for a period of 15 days from the date of this letter to allow you time to submit your recommendation concerning this application. Please submit your recommendation within the allotted time, or any authorized extension of time thereof.

If you have any questions, please contact me at (620) 276-2901. If you wish to discuss a specific file, please have the file number ready so that I may help you more efficiently.

Sincerely,

A handwritten signature in blue ink, appearing to read "Austin McColloch".

Austin McColloch
Assistant Water Commissioner

Enclosure
pc: