

**Kansas Department of Agriculture  
Division of Water Resources**

1. File No.: <b>4020</b>		2. Status Change Date:		4. Field Office: <b>04 - Garden City</b> GMD: <b>03 - Southwest</b> Structures File No.: Filing/Priority Date: <b>04/10/2025</b> Application Complete Date: <b>04/15/2025</b>		
3. Package File No(s):						
5a. <input type="checkbox"/> Applicant <input checked="" type="checkbox"/> Owner <input checked="" type="checkbox"/> WUC <input type="checkbox"/> Address Change  <b>JANELL NICHOLS</b> <b>2189 40TH RD</b> <b>COPELAND KS 67837</b>			5b. <input type="checkbox"/> Owner <input type="checkbox"/> WUC <input type="checkbox"/> Address Change  Person ID Add Seq#			
5c. <input type="checkbox"/> Owner <input type="checkbox"/> WUC <input type="checkbox"/> Address Change  Person ID Add Seq#			5d. <input type="checkbox"/> Owner <input type="checkbox"/> WUC <input type="checkbox"/> Address Change  Person ID Add Seq#			
6. Change No.: <b>1</b> <input type="checkbox"/> PD <input checked="" type="checkbox"/> PU <input type="checkbox"/> UMW Base Acres: Year: Min Reasonable Q: Previous UMW: MDS Gauge: Active Admin? <input type="checkbox"/> Completion/Start Date: Perfection/Expiration Date:				7. Use of Water <input checked="" type="checkbox"/> Groundwater <input type="checkbox"/> Surface Water UMW: <b>IRR-Irrigation</b> UMW: UMW:		
8. Action Trail						
9. Special Conditions						
10. 5YR Allocation Type: Start Year: 5YR Quantity: Base Acres: Comment:						
11. Sand & Gravel Proj ID: <input type="checkbox"/> Active <input type="checkbox"/> Dredge <input type="checkbox"/> IND Evap <input type="checkbox"/> Jr Evap <input type="checkbox"/> Other Diversion <input type="checkbox"/> Rpt on Sr						
12. Waiver Rule ID: <input type="checkbox"/> New Date Requested: Applies: Rule No.: Justification: Rule Type: Rule SubType:						
Comments <b>Lonnie Nichols deceased</b>				Processed <b>04/17/2025</b> <b>MAM</b>		Entered
				Reviewed		

File No. <b>4020</b>	13. County: <b>HS</b> Basin: <b>ARKANSAS RIVER</b> Stream:									
Structures File No:	Aquifer Code:					Special Use Area:				

14. Points of Diversion, Rates & Quantities

PDIV	Qualifier	S	T	R	ID	'N	'W	Comment (AKA Line)	Qty AF		Rate gpm		Storage Qty		Storage Rate	
									Auth	Add	Auth	Add	Auth	Add	Auth/Add	Overlaps
<b>CHK 35148</b>																

15. Limitations    Type:                      Quantity:                      Rate:                      combined with file no(s):  
                                  Type:                      Quantity:                      Rate:                      combined with file no(s):

16. Metering    ☒ Metering Required    ☐ Anti-Reverse Required    ☐ Seal Required    Compliance Date: 12/31/2025

17. Place of Use							NE¼				NW¼				SW¼				SE¼				Total	Owner(s)	Chg?	Overlaps
PUSE	S	T	R	ID	NE	NW	SW	SE	NE	NW	SW	SE	NE	NW	SW	SE	NE	NW	SW	SE						
ENT	1512	34	27	31W	1									31.25	37.50	31.25	31.25						131.25	5a	<input checked="" type="checkbox"/>	*
MOD	13344	35	27	31W	1									31.25	31.25	40	31.25						133.75	5a	<input checked="" type="checkbox"/>	*
																									<input type="checkbox"/>	
																									<input type="checkbox"/>	
																									<input type="checkbox"/>	
																									<input type="checkbox"/>	

18. Point of Diversion and Place of Use Overlaps

<p>*    <b>738, 7962</b></p> <p>+</p> <p>#</p> <p>^</p>	<p>**</p> <p>++</p> <p>##</p> <p>^^</p>
---	---

Garden City Field Office  
4532 W. Jones, Suite B  
Garden City, KS 67846



Phone: 620-276-2901  
Fax: 620-276-9315  
[www.agriculture.ks.gov](http://www.agriculture.ks.gov)

Mike Beam, Secretary

Laura Kelly, Governor

April 17, 2025

JANELL NICHOLS  
2189 40TH RD  
COPELAND KS 67837

RE: Filed Office Application for Change  
Water Right, File Nos. 738, 4020, 7962

Dear Madam:

Enclosed are orders executed by the designee of the Chief Engineer, Division of Water Resources, Kansas Department of Agriculture, approving the applications for change under the above reference file numbers.

Your attention is directed to the enclosures and to the terms, conditions, and limitations specified in these approvals for change. A condition of this approval is that an acceptable water flow meter must be installed on the diversion works authorized under the referenced files number and meet current specifications.

Since the orders modify the original documents referred to above, they should be recorded with the Register of Deeds as other instruments affecting real estate.

Should you have any questions, please feel free contact this office. If you would prefer, you could arrange an appointment for additional assistance.

Sincerely,

  
Michael A. Meyer  
Water Commissioner

MAM  
Enclosures

pc: GMD3

### **CERTIFICATE OF SERVICE**

On this 17<sup>th</sup> day of April 2025, I hereby certify that the foregoing Approval of Application for Change in Place of Use, Water Right, File Nos. 738, 4020, 7962 dated 17<sup>th</sup> day of April 2025 was mailed postage prepaid, first class, US mail to the following:

JANELL NICHOLS  
2189 40TH RD  
COPELAND KS 67837

pc:

GMD3

  
Division of Water Resources Staff



Submit completed application to:  
Kansas Department of Agriculture  
Division of Water Resources  
Field Office for your area.

Call for address:

Topeka -- (785) 296-5733  
Stafford -- (620) 234-5311  
Stockton -- (785) 425-6787  
Garden City -- (620) 276-2901  
<http://agriculture.ks.gov/dwr>

# DWR FIELD OFFICE APPLICATION FOR APPROVAL TO CHANGE THE PLACE OF USE AND/OR THE POINT OF DIVERSION



STATE OF KANSAS

Filing Fee Must Accompany the Application, K.S.A. 82a-708b(b), as amended.  
Fee Schedule is on the third page of this application form.

Paragraph Nos. 1, 2, 3 & 5 must be completed. Complete all other applicable portions. If change in point of diversion is greater than 100 feet, or if place of use will be changed, include a topographic map or detailed plat showing the authorized and proposed point(s) of diversion and/or place of use.

File No. 4020

RECEIVED  
3:04pm  
APR 10 2025

Garden City Field Office  
Division of Water Resources

1. Application is hereby made for approval of the Chief Engineer to change the (check one or both):

☒ Place of Use ☐ Point of Diversion

under the water right which is the subject of this application in accordance with the conditions described below.

The source of supply is: ☒ Groundwater ☐ Surface water

2. Name and address of Applicant: JANELL NICHOLS

2189 40TH ROAD COPELAND KS 67837

Phone Number: (620)640-1716

Email address: waylonnichols5@gmail.com

Name and address of Water Use Correspondent: same no change

Phone Number: ( )

Email address:

3. The presently authorized place of use is:

Owner of Land ---- NAME: JANELL NICHOLS

ADDRESS: 2189 40TH ROAD COPELAND KS 67837

(If there is more than one landowner, attach supplemental sheets as necessary.)

Sec.	Twp.	Range	NE¼				NW¼				SW¼				SE¼				TOTAL ACRES
			NE¼	NW¼	SW¼	SE¼	NE¼	NW¼	SW¼	SE¼	NE¼	NW¼	SW¼	SE¼	NE¼	NW¼	SW¼	SE¼	
35	27	31W									40	40	40	40					160

4. If this application is for a change in place of use, it is proposed that the place of use be changed to:

Owner of Land ---- NAME: JANELL NICHOLS

ADDRESS: 2189 40TH ROAD COPELAND KS 67837

(If there is more than one landowner, attach supplemental sheets as necessary.)

Sec.	Twp.	Range	NE¼				NW¼				SW¼				SE¼				TOTAL ACRES
			NE¼	NW¼	SW¼	SE¼	NE¼	NW¼	SW¼	SE¼	NE¼	NW¼	SW¼	SE¼	NE¼	NW¼	SW¼	SE¼	
34	27	31W									31.25	37.50	31.25	31.25					131.25
35	27	31W									31.25	31.25	40	31.25					133.75

For Office Use Only: Code CP4 Fee \$200.00 TR # \_\_\_\_\_ Receipt Date 4-10-2025 Check # 15427

5. **Presently authorized point of diversion:**

One in the \_\_\_\_\_ Quarter of the \_\_\_\_\_ Quarter of the \_\_\_\_\_ Quarter of the \_\_\_\_\_  
of Section \_\_\_\_\_, Township \_\_\_\_\_ South, Range \_\_\_\_\_ (E/W),  
in \_\_\_\_\_ County, Kansas, \_\_\_\_\_ feet North \_\_\_\_\_ feet West of Southeast corner of section.  
Authorized Rate \_\_\_\_\_ Authorized Quantity \_\_\_\_\_ Depth of well \_\_\_\_\_ (feet)  
(DWR use only: Computer ID No. \_\_\_\_\_ GPS \_\_\_\_\_ feet North \_\_\_\_\_ feet West)

☐ This point will not be changed ☐ This point will be changed as follows: ☐ No change, point better described with GPS as follows:

**Proposed point of diversion: (Complete only if change is requested or if existing point is better described by GPS)**

One in the \_\_\_\_\_ Quarter of the \_\_\_\_\_ Quarter of the \_\_\_\_\_ Quarter of the \_\_\_\_\_  
of Section \_\_\_\_\_, Township \_\_\_\_\_ South, Range \_\_\_\_\_ (E/W),  
in \_\_\_\_\_ County, Kansas, \_\_\_\_\_ feet North \_\_\_\_\_ feet West of Southeast corner of section.  
Proposed Rate \_\_\_\_\_ Proposed Quantity \_\_\_\_\_ Proposed well depth (feet) \_\_\_\_\_  
This point is: ☐ Additional Well ☐ Geo Center List other water rights that will use this point \_\_\_\_\_

6. **Presently authorized point of diversion:**

One in the \_\_\_\_\_ Quarter of the \_\_\_\_\_ Quarter of the \_\_\_\_\_ Quarter of the \_\_\_\_\_  
of Section \_\_\_\_\_, Township \_\_\_\_\_ South, Range \_\_\_\_\_ (E/W),  
in \_\_\_\_\_ County, Kansas, \_\_\_\_\_ feet North \_\_\_\_\_ feet West of Southeast corner of section.  
Authorized Rate \_\_\_\_\_ Authorized Quantity \_\_\_\_\_ Depth of well \_\_\_\_\_ (feet)  
(DWR use only: Computer ID No. \_\_\_\_\_ GPS \_\_\_\_\_ feet North \_\_\_\_\_ feet West)

☐ This point will not be changed ☐ This point will be changed as follows: ☐ No change, point better described with GPS as follows:

**Proposed point of diversion: (Complete only if change is requested or if existing point is better described by GPS)**

One in the \_\_\_\_\_ Quarter of the \_\_\_\_\_ Quarter of the \_\_\_\_\_ Quarter of the \_\_\_\_\_  
of Section \_\_\_\_\_, Township \_\_\_\_\_ South, Range \_\_\_\_\_ (E/W),  
in \_\_\_\_\_ County, Kansas, \_\_\_\_\_ feet North \_\_\_\_\_ feet West of Southeast corner of section.  
Proposed Rate \_\_\_\_\_ Proposed Quantity \_\_\_\_\_ Proposed well depth (feet) \_\_\_\_\_  
This point is: ☐ Additional Well ☐ Geo Center List other water rights that will use this point \_\_\_\_\_

7. The changes herein are desired for the following reasons?  
(please be specific) \_\_\_\_\_  
\_\_\_\_\_

8. If a well, is the test hole log attached? ☐ Yes ☐ No

9. The change(s) (was)(will be) completed by?  
\_\_\_\_\_

10. If the point of diversion is a well:

(a) What are you going to do with the old well?  
\_\_\_\_\_

(b) When will this be done? \_\_\_\_\_

11. Groundwater Management District recommendation attached?  
☐ Yes ☐ No

12. Assisted by \_\_\_\_\_

13a. If the proposed point of diversion will be relocated more than 300 feet but within 2,640 feet of the existing point of diversion, attach a topographic map or aerial photograph. For groundwater sources, show all wells (including domestic) within one-half mile of the proposed point of diversion and the names and mailing addresses of the owners. For surface water sources, show the names and addresses of the landowner(s) one-half mile downstream and one-half mile upstream from your property lines

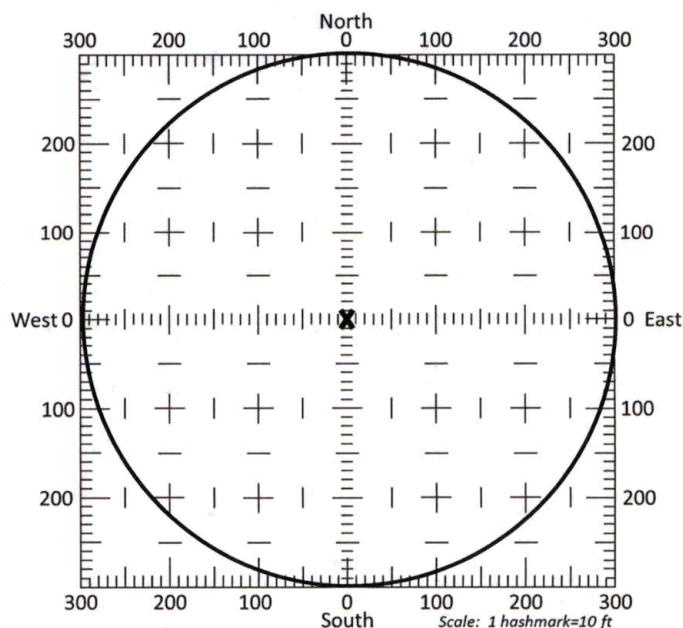

13b. If the proposed point of diversion will be relocated within a 300 foot radius of the existing point of diversion, indicate its location on the diagram shown above in relation to the existing point of diversion. The proposed point of diversion must be located within the circle shown above. (PLEASE NOTE: The "X" in center of diagram above represents the presently authorized point of diversion.)



14. If the proposed groundwater point of diversion is 300 or fewer feet from the existing point of diversion, complete the following:

- (a) Does the undersigned represent all owners of the currently authorized place(s) of use identified in this application?  
☐ Yes ☐ No (If no, all owners must sign this application.)
- (b) Will the ownership interest of any owner of the currently authorized place(s) of use identified in this application be adversely affected if this application is approved as requested?  
☐ Yes ☐ No (If yes, all owners must sign this application.)
- (c) If this application is not approved expeditiously, will there be substantial damage to property, public health or safety?  
☐ Yes ☐ No (If no, all owners must sign this application.)

If the application proposes a surface water change in point of diversion, a groundwater change in point of diversion greater than 300 feet, or a change in place of use, the application must be signed by all owners of the currently authorized place of use, or their duly authorized agent (attach notarized statement authorizing representation).

I hereby verify, being first duly sworn upon my oath or affirmation and under penalty of perjury, that I am of lawful age and the owner, the spouse of the owner, or a duly authorized agent of the owner(s) to make this application on their behalf, in regards to the water right(s) to which this application pertains. I further verify that the statements contained in this application are true, correct and complete.

Dated at Gardencity, Kansas, this 10th day of April, 2025.

Janell Nichols  
(Owner)

Janell Nichols  
(Please Print)

Brandi Sneath  
(Spouse)

Brandi Sneath  
(Please Print)

(Owner)

(Spouse)

(Please Print)

(Please Print)

(Owner)

(Spouse)

(Please Print)

(Please Print)

State of Kansas

County of Finney

SS

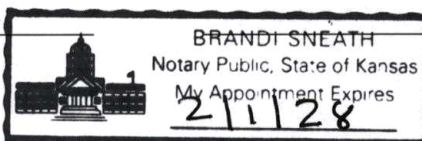

I hereby certify that the foregoing application was signed in my presence and sworn to before me this 10th day of April, 2025.

Brandi Sneath

Notary Public

My Commission Expires 2/1/28

**ONLY COMPLETE APPLICATIONS WILL BE PROCESSED.** To be complete, all of the applicable portions of the application form must be completed with accurate information; maps, if necessary, must be included; signatures of all the appropriate owners' must be affixed to the application and notarized; and the appropriate fee must be paid.

#### FEE SCHEDULE

Each application to change the place of use or the point of diversion under this section shall be accompanied by the application fee set forth in the schedule below: Make checks payable to: **Kansas Department of Agriculture**

- |   |       |
|---|-------|
| (1) Application to change a point of diversion 300 feet or less   | \$100 |
| (2) Application to change a point of diversion more than 300 feet | \$200 |
| (3) Application to change the place of use                        | \$200 |



## SUMMARY ORDER APPROVING APPLICATION FOR CHANGE AND IMPOSING CONDITIONS

This Summary Order is issued under authority of K.S.A. 82a-708b, as amended, and K.A.R. 5-5-1, *et seq.* and other applicable provisions of the *Kansas Water Appropriation Law*, K.S.A. 82a-701 *et seq.*, and rules and regulations promulgated thereunder. With the exception of those conditions expressly contained herein, this Summary Order does not change the terms, conditions and limitations of File No. 4,020.

1. A change application was received on April 10, 2025 requesting that the place of use and / or point of diversion authorized under the above-referenced file number be changed as described in the application.
2. On and after the effective date of this summary order, the authorized place(s) of use shall be located substantially as shown on the topographic map accompanying the application to change the place of use. ☒ Applicable ☐ Not Applicable
3. The change in point of diversion shall not impair existing rights and shall be limited to the same source or sources of water as previously authorized. The point of diversion authorized by this summary order shall be located within a        foot radius of the authorized point(s) of diversion. ☐ Applicable ☒ Not Applicable
4. The point(s) of diversion described herein is administratively corrected to be more accurately described using the Global Positioning System (GPS), as described in the application. ☐ Applicable ☒ Not Applicable
5. The point(s) of diversion authorized herein shall not actually be located more than        feet from the previously authorized point(s) of diversion. ☐ Applicable ☒ Not Applicable
6. As required by K.A.R. 5-3-5d, if the works for diversion is a well with a diversion rate of 100 gallons per minute or more, a tube or other device suitable for making water level measurements shall be installed, operated and maintained in accordance with K.A.R. 5-6-13. ☐ Applicable ☒ Not Applicable
7. The owner of the authorized place(s) of use shall properly install an acceptable water flow meter on or before December 31, 2025, or before the first use of water, whichever occurs first. The water flow meter shall be installed, operated and maintained in accordance with K.A.R. 5-1-4 through 5-1-12. As required by K.S.A. 82a-732, as amended, and K.A.R. 5-3-5e, the owner shall maintain records and report the reading of the water flow meter and the total quantity of water diverted annually to the Chief Engineer by March 1 following the end of each calendar year.  
☒ Applicable ☐ Not Applicable
8. Installation of the works for diversion of water shall be completed on or before December 31, 2025, or within any authorized extension of time. By March 1, 2026 the applicant shall notify the Chief Engineer that construction of the works for diversion has been completed, on the form provided by the Chief Engineer, as required by K.A.R. 5-8-4e.  
☒ Applicable ☐ Not Applicable
9. The completed well log shall be submitted with the required notice. ☐ Applicable ☒ Not Applicable
10. All diversion works into which any type of chemical or other foreign substance will be injected into the water shall be equipped with an in-line, automatic, quick-closing check valve capable of preventing pollution of the source of the water supply. The check valve(s) shall be installed, operated and maintained in accordance with K.A.R. 5-3-5c. ☒ Applicable ☐ Not Applicable
11. Additional Conditions are attached. ☐ Yes ☒ No
12. In accordance with K.S.A. 82a-708a, as amended, and K.A.R. 5-5-14, all of the owners of the authorized place(s) of use of water appropriated under the above-referenced file number are responsible for compliance with its terms, conditions and limitations, as amended and/or supplemented by this Summary Order, and with applicable provisions of the *Kansas Water Appropriation Law* and the *Rules and Regulations* promulgated thereunder. Failure to comply with these provisions may result in civil penalties pursuant to K.S.A. 82a-737, as amended, and/or the suspension or revocation and dismissal of the water or appropriation right or any other enforcement actions authorized by law.

### Administrative Appeal and Effective Date of Order

If you are aggrieved by this order, pursuant to K.S.A. 82a-1901, you may request an evidentiary hearing before the Chief Engineer or request administrative review by the Secretary of Agriculture. A request for hearing by the Chief Engineer must be filed within **15 days** of service of this Order and a request for administrative review by the Secretary must be filed within **30 days** pursuant to K.S.A. 77-531. Any request for administrative review must state a basis for review pursuant to K.S.A. 77-527. File any request with **Kansas Department of Agriculture, Legal Division, 1320 Research Park Drive, Manhattan, KS 66502**. Failure to timely request a hearing or review may preclude review under the Kansas Judicial Review Act.

*For Use by Register of Deeds*

### FOR OFFICE USE ONLY APPLICATION APPROVED AND SUMMARY ORDER ISSUED

By: Michael A. Meyer  
Duly Authorized Designee of the Chief Engineer

(Print Name): MICHAEL A. MEYER  
Division of Water Resources - Kansas Department of Agriculture

Date of Issuance: April 17, 2025

State of Kansas )

) SS

County of Linney )

Acknowledged before me on April 17, 2025

by Michael A Meyer

Signature: Aaron Holsted

My commission expires: \_\_\_\_\_





**FILE NO. 4020, 7962**  
**APPLICATION TO CHANGE THE**  
**PLACE OF USE**  
**/// AUTHORIZED PLACE OF USE**  
**\\ PROPOSED PLACE OF USE**

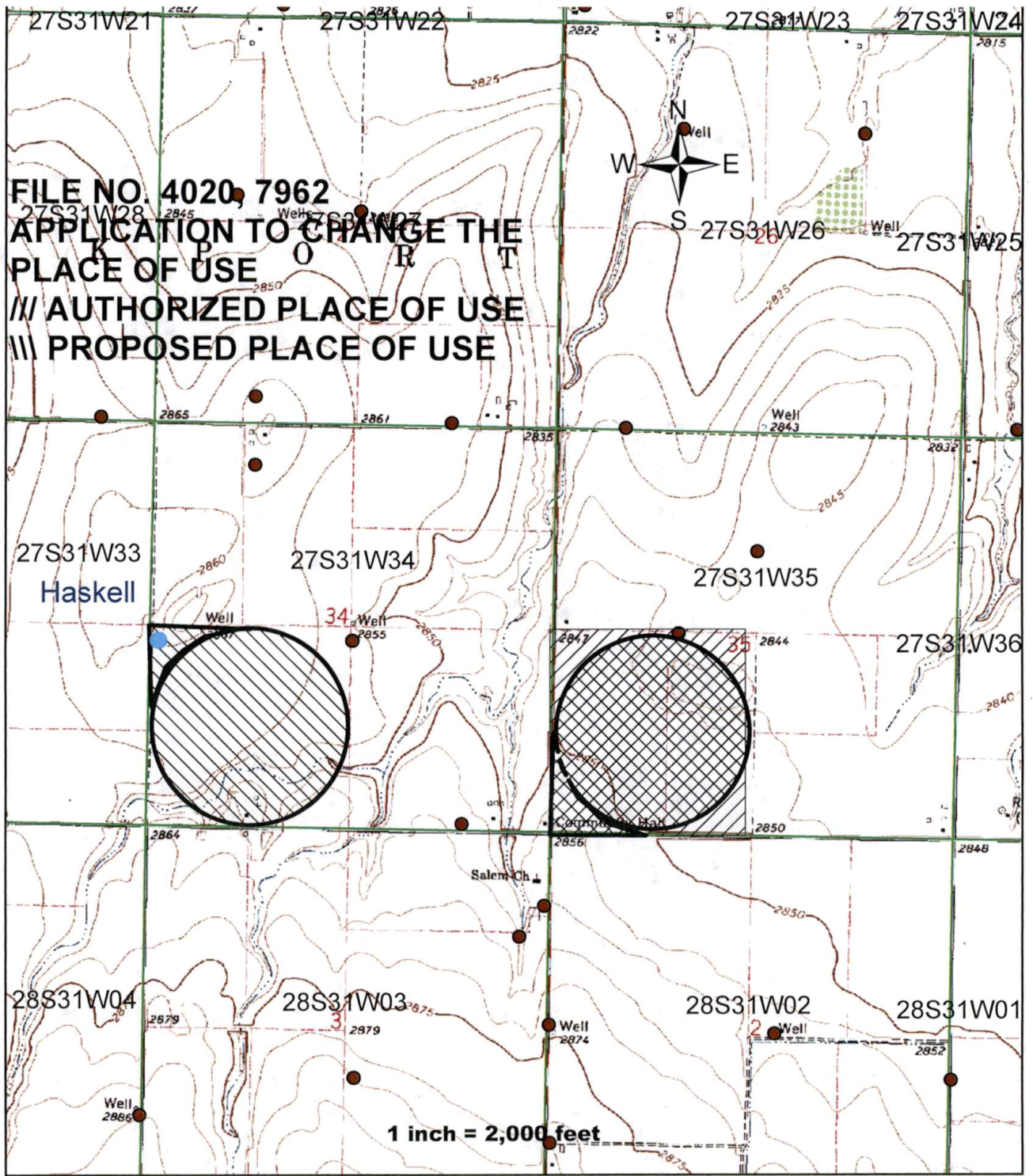

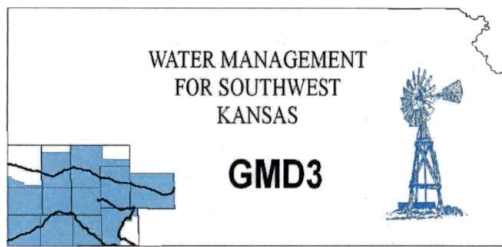

**Southwest Kansas**  
**Groundwater Management District No. 3**  
**2009 E. Spruce Street**  
**Garden City, Kansas 67846**  
(620) 275-7147 phone  
[www.gmd3.org](http://www.gmd3.org)

---

April 15, 2025

Michael A. Meyer  
Division of Water Resources  
4532 W Jones Ave., Suite B  
Garden City, Kansas 67846

RE: Applications for Change in Place of Use  
Water Right, File Nos. 738, 4020 & 7962

Dear Mike:

We have completed a review of the applications for the above-mentioned water rights. The proposals are not in conflict with the Management Program of the Southwest Kansas Groundwater Management District No. 3 (GMD3). The proposed change in place of use will make a complete overlap while rearranging acres in authorized place of use in accordance with K.A.R. 5-5-11(b). It is therefore recommended that the applications be approved at this time.

Thank you for the opportunity to review the applications and to provide a recommendation. If you have any questions, please don't hesitate to contact us.

Sincerely,

Jason L. Norquest  
Assistant Manager

RECEIVED  
APR 15 2025  
Garden City Field Office  
Division of Water Resources

Garden City Field Office  
4532 W. Jones, Suite B  
Garden City, KS 67846



Phone: 620-276-2901  
Fax: 620-276-9315  
[www.agriculture.ks.gov](http://www.agriculture.ks.gov)

Mike Beam, Secretary

Laura Kelly, Governor

April 14, 2025

SOUTHWEST KANSAS GROUNDWATER  
MANAGEMENT DISTRICT NO. 3  
2009 E SPRUCE ST  
GARDEN CITY KS 67846

Re: Request for Recommendation  
Water Right,  
File Nos. 738, 4020, 7962

Dear Mr. Norquest:

This is to advise you that Janell Nichols has filed applications for approval of the Chief Engineer, Division of Water Resources, Kansas Department of Agriculture, to change the place of use.

We are delaying action on the change applications to allow you time to review and provide a recommendation. Please submit a recommendation within 15 days from the date of this letter.

Thank you and as always feel free to contact this office at any time.

Sincerely,

A handwritten signature in blue ink that reads "Michael A. Meyer".

Michael A. Meyer  
Water Commissioner

MAM  
Enclosures



RECORDED IN MY OFFICE THE 7th  
DAY OF April, 2025  
Sammy Miller  
HASKELL COUNTY CLERK



STATE OF KANSAS, HASKELL COUNTY  
This instrument was filed for record on  
April 7, 2025 1:30 PM and  
Recorded in Book 266 Page 71-71  
Fees: \$21.00 202500237



Candy Huffine  
Candy Huffine, Register of Deeds

WARRANTY DEED

TDK FARMS, LLC

CONVEYS AND WARRANTS TO

JANELL NICHOLS

all the following described real estate in Haskell County, Kansas:

Southwest Quarter (SW $\frac{1}{4}$ ) of Section 35, Township 27 South, Range 31 West of the 6th P.M.

plus an irrigation well located within 300 feet of the South edge of the East Half (E $\frac{1}{2}$ ) of Section 34, Township 27 South, Range 31 West of the 6th P.M. which Grantor shall have full access and use of such well and Water Rights File Numbers 4020 and 7962, including the right to re-drill any well within a 400 foot circle of the current well, but not within the little circle on 34, and an easement for a water line along the south edge of Section 34 to the Southeast corner, then on a Northeast diagonal to the center pivot located on Section 35, together with an additional easement for a future water line along the South edge of Section 34 to the west then on a Northwest diagonal to the Grantor's land in the Southwest Quarter of (SW $\frac{1}{4}$ ) of Section 34, Township 27 South, Range 31 West of the 6th P.M.

FOR THE SUM OF: \$10 and other valuable considerations

EXCEPT AND SUBJECT TO: Reservations, restrictions and rights of way of record.

DATED: 4/2, 2025

TDK FARMS, LLC

By: [Signature]  
Travis de Groot, Managing Member

STATE OF KANSAS )  
COUNTY OF GRAY )

BE IT REMEMBERED, that on 4/2, 2025, before me, the undersigned, a notary public in and for the County and State aforesaid, came **Travis de Groot, Managing Member of TDK Farms, LLC**, who is known to me to be the same person who executed the within instrument of writing and such person duly acknowledged the execution of the same.

IN WITNESS WHEREOF, I have hereunto set my hand and affixed my seal, the day and year last above written.



My Term Expires 4/1/29

[Signature]  
Notary Public  
**KYLER KNOBBE**

KYLER G. KNOBBE  
P.O. BOX 937  
CIMARRON, KANSAS 67835  
(620) 855-3100  
knobbe@ucom.net

SEND FUTURE TAX STATEMENTS TO:

Janell Nichols  
2189 40th Rd.  
Copeland, KS 67837