

# CHECK SHEET Short Change

(To be completed and attached to each application)

File No. 49485

Field Office No. 2

GMD No. \_\_\_\_\_

1. **Plugging agreement obtained for GMD?** Yes  No  Non Applicable
2. **Is Landowner correct as currently shown in WRIS?** Yes  No  **Address Change?** NO  
If applicable, list Place of Use Overlap File Nos. None
3. **Is Water Use Correspondent correct as currently shown in WRIS?** Yes  No  **Address Change?** NO  
Name of Former WUC --- Name of New WUC ---
4. a. **Point of diversion computer ID No(s).** 11, 13, 14 **for point(s) being changed.**
- b. **Show feet distances from the** SE **corner of the section for the new point(s) of diversion:**

Action	PDIV ID	Geo Ctr?	Sec	Twp	Rng	'N	'W	County	Qualifiers
DEL	85543	YES	28	19S	1W	3078	4996	McPherson	SW SW NW
ENT		YES	28	19S	1W	3388	5158	McPherson	NW SW NW
NO CHG	85544	NO	28	19S	1W	3328	4996	McPherson	NW SW NW
DEL	85545	NO	28	19S	1W	2828	4996	McPherson	SW SW NW
ENT		NO	28	19S	1W	3717	5186	McPherson	NW SW NW
DEL	85546	NO	28	19S	1W	3036	4699	McPherson	SW SW NW
NO CHG	85547	NO	28	19S	1W	3120	5292	McPherson	SW SW NW

- c. **If multiple points of diversion exist and rates and quantities are individually assigned, show:**
- |             |                 |                 |                     |                     |
|-------------|-----------------|-----------------|---------------------|---------------------|
| Old PDIV ID | Authorized Rate | Additional Rate | Authorized Quantity | Additional Quantity |
| _____       | _____ gpm/cfs   | _____ gpm/cfs   | _____ af/mgy        | _____ af/mgy        |
- d. **Name of Drainage Basin** Little Arkansas River **Is this correctly shown in WRIS?**  Yes  No
- e. **Formation Name & No.** Undifferentiated Kansan/Nebraskan 180 **Special Use Area** None
5. **Distances from the previous p/d (GEOCENTER):** 310 ' N 162 ' W

**6. WATER RIGHT ACTION TRAIL COMMENTS**

11/07/2016 Change Application Received (date accepted for priority)  
11 / 29 / 16 Change Approved  
 Notice and Proof by 12/31/2017  
 \_\_\_\_\_ / \_\_\_\_\_ / \_\_\_\_\_ Completion Requirement Removed (Change No. C \_\_\_\_\_)

**7. METER ACTION TRAIL COMMENTS**

11 / 29 / 16 DWR Meter Required by 12/31/2017  
 \_\_\_\_\_ / \_\_\_\_\_ / \_\_\_\_\_ Anti-Reverse Meter Required by \_\_\_\_\_ / \_\_\_\_\_ / \_\_\_\_\_  
 \_\_\_\_\_ / \_\_\_\_\_ / \_\_\_\_\_ Meter Seal Required by \_\_\_\_\_ / \_\_\_\_\_ / \_\_\_\_\_

8. Base Acres --- Year --- Minimum Reasonable Quantity ---

Date Created 11/28/16 by TJS  
 Date Entered \_\_\_\_\_ by \_\_\_\_\_

CHECK SHEET ATTACHMENT

File Number 49485

9. Changes to the place of use will be:

Action	Owner Person ID	Place Use ID #	Sec.	Twp.	Range		NE¼				NW¼				SW¼				SE¼				TOTAL ACRES
							NE¼	NW¼	SW¼	SE¼	NE¼	NW¼	SW¼	SE¼	NE¼	NW¼	SW¼	SE¼	NE¼	NW¼	SW¼	SE¼	
NO CHG	56945	67333	28	19S	1W	Acres Authorized																	
						New Acres																	
						Acres Authorized																	
						New Acres																	
						Acres Authorized																	
						New Acres																	
						Acres Authorized																	
						New Acres																	

Names and Address:

1. Person ID # <u>56945</u> Arlen R & Nona G Becker 1293 26 <sup>th</sup> Ave Canton KS 67428	2. Person ID # _____ _____ _____ _____	3. Person ID # _____ _____ _____ _____
--	---	---

**GENERAL INSTRUCTIONS**

- |  |   |   |
|--|---|---|
| 1. Give to Applicant:<br>a. <u>Original</u> application/approval<br>b. Original receipt (one for <u>each</u> application)<br>c. Information packet containing:<br><ul style="list-style-type: none"> <li>• Notice and Proof form</li> <li>• Water Meter Specifications</li> <li>• Acceptable Meter list</li> <li>• Water level measurement tube specifications</li> <li>• Check Valve specifications</li> <li>• Pink Sheet - K.S.A. 82a-728 letter</li> <li>• Form stating to record in Register of Deeds Office (OPTIONAL AS NEEDED)</li> </ul> | 2. Send to headquarters:<br>a. Good, <b>scannable</b> copy of application and/or approval and this check sheet<br>b. Original check and copy of receipt<br>c. Test hole log<br>d. GMD recommendation, if any<br>e. Map or aerial photograph, if any<br>3. Send to KDHE: Letter (KDHE.LT) advising of location of abandoned well. <input type="checkbox"/> | 4. Date stamp received and approved.<br>5. Complete ownership and WUC change information. |
|--|---|---|

ADDITIONAL PHOTOCOPIES

HQ \_\_\_\_\_

Driller's Copy \_\_\_\_\_

\_\_\_\_\_

\_\_\_\_\_

\_\_\_\_\_

\_\_\_\_\_

CONDITIONS

1. Insert notice and proof date.
2. Type or print applicant's/owner's name on line.
3. Complete notary statement.

Submit completed application to:  
 Kansas Department of Agriculture  
 Division of Water Resources  
 Field Office for your area.  
 Call for address:

Topeka -- (785) 296-5733  
 Stafford -- (620) 234-5311  
 Stockton -- (785) 425-6787  
 Garden City -- (620) 276-2901  
<http://agriculture.ks.gov/dwr>

## DWR FIELD OFFICE APPLICATION FOR APPROVAL TO CHANGE THE PLACE OF USE AND/OR THE POINT OF DIVERSION **WATER METER REQUIRED**



**STATE OF KANSAS**

**Filing Fee Must Accompany the Application, K.S.A. 82a-708b(b), as amended.**  
 Fee Schedule is on the third page of this application form.

**Paragraph Nos. 1, 2, 3 & 5 must be completed. Complete all other applicable portions.** If change in point of diversion is greater than 100 feet, or if place of use will be changed, include a topographic map or detailed plat showing the authorized and proposed point(s) of diversion and/or place of use.

**RECEIVED**  
*9:40am*  
**NOV 07 2016**

File No. 49,485

Stafford Field Office  
 Division of Water Resources

1. Application is hereby made for approval of the Chief Engineer to change the (check one or both):

Place of Use                       Point of Diversion

under the water right which is the subject of this application in accordance with the conditions described below.

The source of supply is:                       Groundwater                       Surface water

2. Name and address of Applicant: Arlen R. Becker

1293 26<sup>th</sup> Avenue, Canton, KS. 67428

Phone Number: (620)242-4311

Email address: arlenbfarms@gmail.com

Name and address of Water Use Correspondent: Arlen R. and Nona G Becker

1293 26<sup>th</sup> Avenue, Canton, KS. 67428

Phone Number: (620)242-4311

Email address: arlenbfarms@gmail.com

3. The presently authorized place of use is:

Owner of Land ---- NAME: Arlen R. and Nona G. Becker

ADDRESS: 1293 26<sup>th</sup> Avenue, Canton, KS. 67428

(If there is more than one landowner, attach supplemental sheets as necessary.)

Sec.	Twp.	Range	NE¼				NW¼				SW¼				SE¼				TOTAL ACRES	
			NE¼	NW¼	SW¼	SE¼	NE¼	NW¼	SW¼	SE¼	NE¼	NW¼	SW¼	SE¼	NE¼	NW¼	SW¼	SE¼		
28	19S	1W					34			33	33									100

4. If this application is for a change in place of use, it is proposed that the place of use be changed to:

Owner of Land ---- NAME: No change to current place of use proposed.

ADDRESS: \_\_\_\_\_

(If there is more than one landowner, attach supplemental sheets as necessary.)

Sec.	Twp.	Range	NE¼				NW¼				SW¼				SE¼				TOTAL ACRES	
			NE¼	NW¼	SW¼	SE¼	NE¼	NW¼	SW¼	SE¼	NE¼	NW¼	SW¼	SE¼	NE¼	NW¼	SW¼	SE¼		

For Office Use Only: Code \_\_\_\_\_ Fee \$ 200- TR # \_\_\_\_\_ Receipt Date \_\_\_\_\_ Check # 2087

5. **Presently authorized point of diversion: (current geographic center of battery of 4 wells)**  
 One in the SW Quarter of the SW Quarter of the NW Quarter of Section 28, Township 19 South, Range 1 W, in McPherson County, Kansas, 3078 feet North 4996 feet West of Southeast corner of section.  
 Authorized Rate 800 Authorized Quantity 130 Depth of well n/a (feet)  
 (DWR use only: Computer ID No. 11 GPS                      feet North                      feet West)  
 This point will not be changed  This point will be changed as follows: (change to battery of 3 wells)  
**Proposed point of diversion: (Complete only if change is requested) (geographic center of battery of 3 wells)**  
 One in the NW Quarter of the SW Quarter of the NW Quarter of Section 28, Township 19 South, Range 1 W, in                      County, Kansas, 3388 feet North 5158 feet West of Southeast corner of section.  
 Proposed Rate 800 Proposed Quantity 130 Proposed well depth (feet) n/a  
 This point is:  Additional Well  Geo Center List other water rights that will use this point                     

6. **Presently authorized point of diversion: (current north well of battery)**  
 One in the NW Quarter of the SW Quarter of the NW Quarter of Section 28, Township 19 South, Range 1 W, in McPherson County, Kansas, 3328 feet North 4996 feet West of Southeast corner of section.  
 Authorized Rate See geo Authorized Quantity See geo Depth of well                      (feet)  
 (DWR use only: Computer ID No. 12 GPS                      feet North                      feet West)  
 This point will not be changed  This point will be changed as follows:  
**Proposed point of diversion: (Complete only if change is requested)**  
 One in the                      Quarter of the                      Quarter of the                      Quarter of Section                     , Township                      South, Range                      (E/W), in                      County, Kansas,                      feet North                      feet West of Southeast corner of section.  
 Proposed Rate                      Proposed Quantity                      Proposed well depth (feet)                       
 This point is:  Additional Well  Geo Center List other water rights that will use this point                     

7. Why do you need a new point of diversion?                       
Bad water quality found in some of the original wells  
of battery. Chlorides

8. If a well, is the test hole log attached?  Yes  No

9. When do you propose to complete the new point of diversion?  
As soon as approved

10. If the point of diversion is a well:  
 (a) What are you going to do with the old well?  
~~not applicable~~ Plug them  
 (b) When will this be done? ASAP

11. Groundwater Management District recommendation attached?  Yes  No

12. Assisted by Jeff Lanterman

13a. If the proposed point of diversion will be relocated within 100 feet of the existing point of diversion, indicate its location on the diagram below in relation to the existing point of diversion. (PLEASE NOTE: The "X" in center of diagram below represents presently authorized point of diversion.)

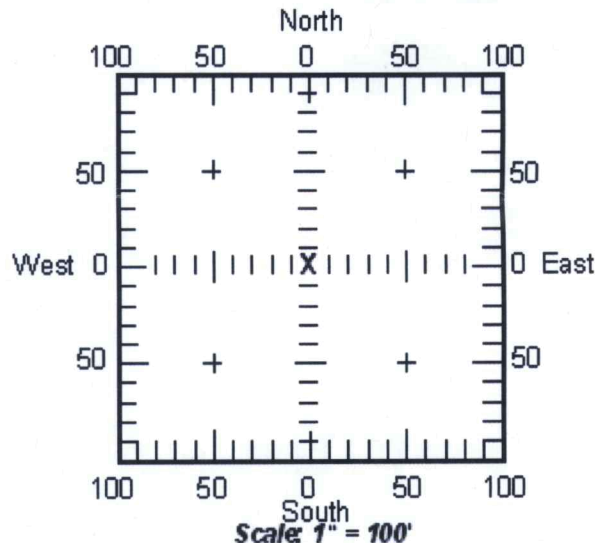

13b. If the proposed point of diversion will be relocated more than 100 feet but within 2640 feet from the existing point of diversion, attach a topographic map or aerial photograph. For groundwater sources, show all wells (including domestic) within one-half mile of the proposed point of diversion and the names and mailing addresses of the owners. For surface water sources, show the names and addresses of the landowner(s) one-half mile downstream and one-half mile upstream from your property lines.

RECEIVED

NOV 07 2016

14. If the proposed groundwater point of diversion is 300 or fewer feet from existing point of diversion, complete the following:

- (a) Does the undersigned represent all owners of the currently authorized place(s) of use identified in this application?  
 Yes     No    (If no, all owners must sign this application.)
- (b) Will the ownership interest of any owner of the currently authorized place(s) of use identified in this application be adversely affected if this application is approved as requested?  
 Yes     No    (If yes, all owners must sign this application.)
- (c) If this application is not approved expeditiously, will there be substantial damage to property, public health or safety?  
 Yes     No    (If no, all owners must sign this application.)

If the application proposes a surface water change in point of diversion, a groundwater change in point of diversion greater than 300 feet, or a change in place of use, the application must be signed by all owners of the currently authorized place of use, or their duly authorized agent (attach notarized statement authorizing representation).

I hereby verify, being first duly sworn upon my oath or affirmation and under penalty of perjury, that I am of lawful age and the owner, the spouse of the owner, or a duly authorized agent of the owner(s) to make this application on their behalf, in regard to the water right(s) to which this application pertains. I further verify that the statements contained in this application are true, correct and complete.

Dated at Canton, Kansas, this 3<sup>rd</sup> day of November, 2016.

Arl R Becker  
(Owner)

Nona Becker  
(Spouse)

Arl R. Becker  
(Please Print)

Nona Becker  
(Please Print)

(Owner)

(Spouse)

(Please Print)

(Please Print)

(Owner)

(Spouse)

(Please Print)

(Please Print)

State of Kansas  
County of McPherson } SS

I hereby certify that the foregoing application was signed in my presence and sworn to before me this 3<sup>rd</sup> day of November, 2016.



Amy Williams  
Notary Public

My Commission Expires 4-13-17

**ONLY COMPLETE APPLICATIONS WILL BE PROCESSED.** To be complete, all of the applicable portions of the application form must be completed with accurate information; maps, if necessary, must be included; signatures of all the appropriate owners' must be affixed to the application and notarized; and the appropriate fee must be paid.

**FEE SCHEDULE**

Each application to change the place of use or the point of diversion under this section shall be accompanied by the application fee set forth in the schedule below: Make checks payable to: **Kansas Department of Agriculture**

- (1) Application to change a point of diversion 300 feet or less ..... \$100
- (2) Application to change a point of diversion more than 300 feet ..... \$200
- (3) Application to change the place of use ..... \$200

RECEIVED

NOV 07 2016

**SUMMARY ORDER APPROVING APPLICATION FOR CHANGE AND IMPOSING CONDITIONS**

This Summary Order is issued under authority of K.S.A. 82a-708b, as amended, and K.A.R. 5-14-3 and other applicable provisions of the *Kansas Water Appropriation Law, K.S.A. 82a-701 et. seq.*, and rules and regulations promulgated thereunder, K.A.R. 5-1-1 *et. seq.* With the exception of those conditions expressly contained herein, this Summary Order does not change the terms, conditions and limitations of File No. 49485.

1. A change application was received on 11/7/16 requesting that the place of use and / or point of diversion authorized under the above-referenced file number be changed as described in the application.
2. On and after the effective date of this summary order, the authorized place(s) of use shall be located substantially as shown on the topographic map accompanying the application to change the place of use.  Applicable  Not Applicable
3. The change in point of diversion shall not impair existing rights and shall be limited to the same source or sources of water as previously authorized. The point of diversion authorized by this summary order shall be located within a 300 foot radius of the authorized point(s) of diversion.  Applicable  Not Applicable
4. The point(s) of diversion authorized herein shall not actually be located more than 649 650 feet from the previously authorized point(s) of diversion.  Applicable  Not Applicable \*
5. As required by K.A.R. 5-3-5d, if the works for diversion is a well with a diversion rate of 100 gallons per minute or more, a tube or other device suitable for making water level measurements shall be installed, operated and maintained in accordance with K.A.R. 5-6-13.  Applicable  Not Applicable
6. **The owner of the authorized place(s) of use shall properly install an acceptable water flow meter on or before December 31, 2017**, or before the first use of water, whichever occurs first. The water flow meter shall be installed, operated and maintained in accordance with K.A.R. 5-1-4 through 5-1-12. As required by K.S.A. 82a-732, as amended, and K.A.R. 5-3-5e, the owner shall maintain records and report the reading of the water flow meter and the total quantity of water diverted annually to the Chief Engineer by March 1 following the end of each calendar year.  Applicable  Not Applicable \* 2018
7. **Installation of the works for diversion of water shall be completed on or before December 31, 2017**, or within any authorized extension of time. By March 1, ~~2017~~ the applicant shall notify the Chief Engineer that construction of the works for diversion has been completed, on the form provided by the Chief Engineer, as required by K.A.R. 5-8-4e.  Applicable  Not Applicable
8. **The completed well log shall be submitted with the required notice.**  Applicable  Not Applicable
9. All diversion works into which any type of chemical or other foreign substance will be injected into the water shall be equipped with an in-line, automatic, quick-closing check valve capable of preventing pollution of the source of the water supply. The check valve(s) shall be installed, operated and maintained in accordance with K.A.R. 5-3-5c.  Applicable  Not Applicable
10. Additional Conditions are attached.  Yes  No
11. In accordance with K.S.A. 82a-708a, as amended, and K.A.R. 5-5-14, all of the owners of the authorized place(s) of use of water appropriated under the above-referenced file number are responsible for compliance with its terms, conditions and limitations, as amended and/or supplemented by this Summary Order, and with applicable provisions of the *Kansas Water Appropriation Law* and the *Rules and Regulations* promulgated thereunder. Failure to comply with these provisions may result in civil penalties pursuant to K.S.A. 82a-737, as amended, and/or the suspension or revocation and dismissal of the water or appropriation right or any other enforcement actions authorized by law.

**Administrative Appeal and Effective Date of Order**

You have the right to a hearing in accordance with K.A.R. 5-14-3 before this Summary Order becomes final action of the Kansas Department of Agriculture. Any request for a hearing must be filed with the **Chief Engineer, Division of Water Resources, Kansas Department of Agriculture, 1320 Research Park Drive, Topeka, Kansas 66502**, within 15 days after the date shown on the Certificate of Service attached hereto. If a hearing is not requested in accordance with K.A.R. 5-14-3, this Summary Order will become effective on the 15<sup>th</sup> day after the date shown on the Certificate of Service.

*For Use by Register of Deeds*

FOR OFFICE USE ONLY  
**APPLICATION APPROVED AND SUMMARY ORDER ISSUED**

By: Jeff Lanterman  
Duly Authorized Designee of the Chief Engineer

(Print Name): Jeff Lanterman  
Division of Water Resources - Kansas Department of Agriculture

Date of Issuance: 11/25/16

State of Kansas )

County of Stafford ) SS

Acknowledged before me on 11/29/16

by Jeff Lanterman

Signature: Jessica Engelbrecht



My commission expires: \_\_\_\_\_ (Notary Seal)

RECEIVED

NOV 07 2016

APPLICATION FOR APPROVAL TO CHANGE  
THE PLACE OF USE AND/OR POINT OF DIVERSION  
SUPPLEMENTAL SHEET  
FILE NO. 49,485

**Presently authorized point of diversion: (current south well of battery)**  
One in the SW Quarter of the SW Quarter of the NW Quarter  
of Section 28, Township 19 South, Range 1 W,  
in McPherson County, Kansas, 2828 feet North 4996 feet West of Southeast corner of section.  
Authorized Rate See Geo Authorized Quantity See Geo Depth of well Not Drilled (feet)  
(DWR use only: Computer ID No. 13 GPS                      feet North                      feet West)  
 This point will not be changed  This point will be changed as follows:  No redrill, point better described with GPS as follows:  
**Proposed point of diversion: (Complete only if change is requested) (new north well of battery)**  
One in the NW Quarter of the SW Quarter of the NW Quarter  
of Section 28, Township 19 South, Range 1 W,  
in McPherson County, Kansas, 3717 feet North 5186 feet West of Southeast corner of section.  
Proposed Rate See Geo Proposed Quantity See Geo Proposed well depth (feet) ~78-88'  
This point is:  Additional Well  Geo Center List other water rights that will use this point                     

**Presently authorized point of diversion: (current east well of battery)**  
One in the SW Quarter of the SW Quarter of the NW Quarter  
of Section 28, Township 19 South, Range 1 W,  
in McPherson County, Kansas, 3036 feet North 4699 feet West of Southeast corner of section.  
Authorized Rate see geo Authorized Quantity See geo Depth of well Not Drilled 87' (feet)  
(DWR use only: Computer ID No. 14 GPS                      feet North                      feet West)  
 This point will not be changed  This point will be changed as follows:  No redrill, point better described with GPS as follows:  
**Proposed point of diversion: (Complete only if change is requested) (This well will be deleted from battery)**  
One in the                      Quarter of the                      Quarter of the                      Quarter  
of Section                     , Township                      South, Range                      (EW),  
in                      County, Kansas,                      feet North                      feet West of Southeast corner of section.  
Proposed Rate                      Proposed Quantity                      Proposed well depth (feet)                       
This point is:  Additional Well  Geo Center List other water rights that will use this point                     

**Presently authorized point of diversion: (current west well of battery)**  
One in the SW Quarter of the SW Quarter of the NW Quarter  
of Section 28, Township 19 South, Range 1 W,  
in McPherson County, Kansas, 3120 feet North 5292 feet West of Southeast corner of section.  
Authorized Rate see geo Authorized Quantity see geo Depth of well Not completed 75' (feet)  
(DWR use only: Computer ID No. 15 GPS                      feet North                      feet West)  
 This point will not be changed  This point will be changed as follows:  No redrill, point better described with GPS as follows:  
**Proposed point of diversion: (Complete only if change is requested)**  
One in the                      Quarter of the                      Quarter of the                      Quarter  
of Section                     , Township                      South, Range                      (EW),  
in                      County, Kansas,                      feet North                      feet West of Southeast corner of section.  
Proposed Rate                      Proposed Quantity                      Proposed well depth (feet)                       
This point is:  Additional Well  Geo Center List other water rights that will use this point                     





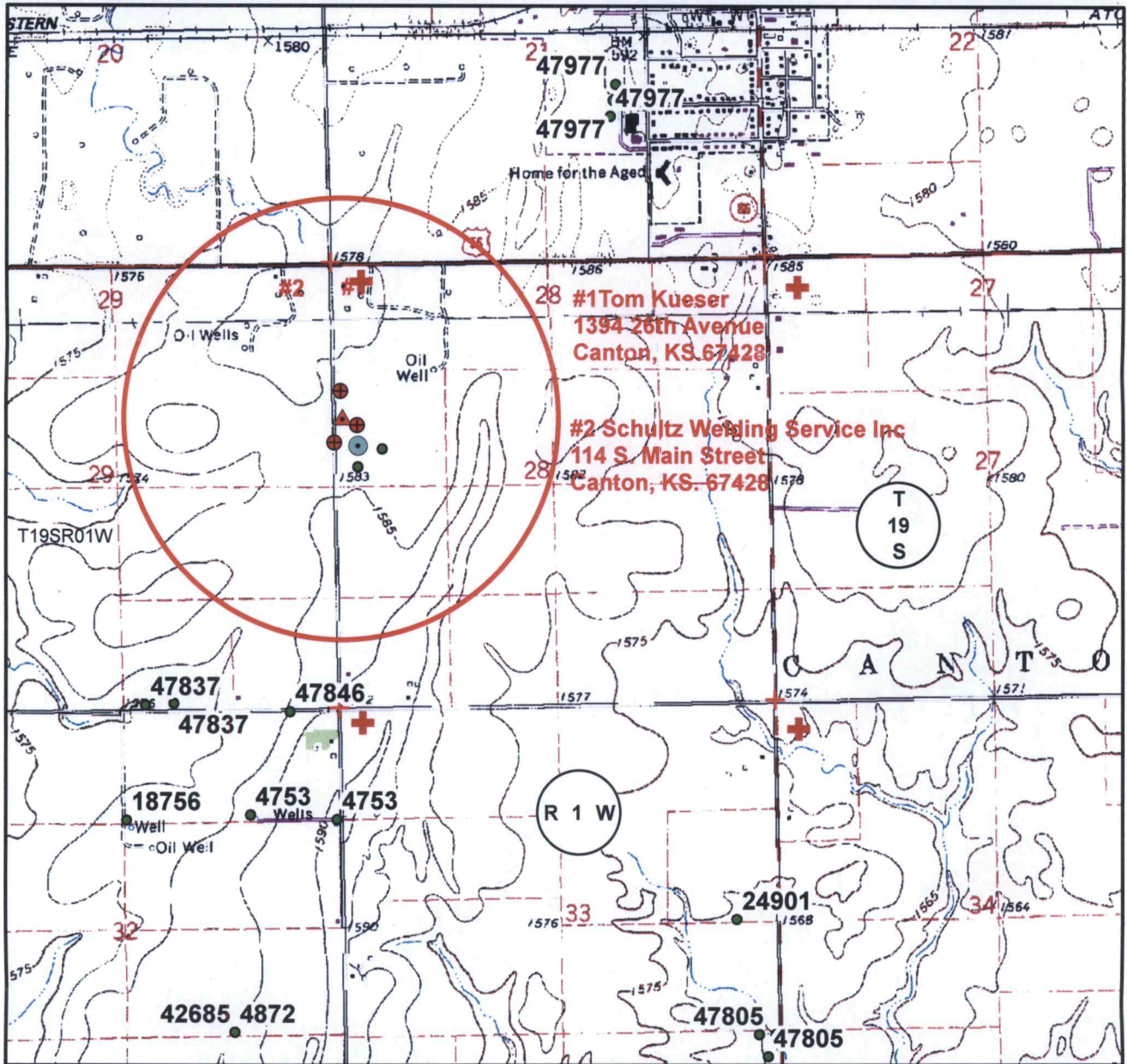

**Presently authorized point of diversion:**  
One in the                      Quarter of the                      Quarter of the                      Quarter  
of Section                     , Township                      South, Range                      (EW),  
in                      County, Kansas,                      feet North                      feet West of Southeast corner of section.  
Authorized Rate                      Authorized Quantity                      Depth of well                      (feet)  
(DWR use only: Computer ID No.                      GPS                      feet North                      feet West)  
 This point will not be changed  This point will be changed as follows:  No redrill, point better described with GPS as follows:  
**Proposed point of diversion: (Complete only if change is requested)**  
One in the                      Quarter of the                      Quarter of the                      Quarter  
of Section                     , Township                      South, Range                      (EW),  
in                      County, Kansas,                      feet North                      feet West of Southeast corner of section.  
Proposed Rate                      Proposed Quantity                      Proposed well depth (feet)                       
This point is:  Additional Well  Geo Center List other water rights that will use this point                     

RECEIVED  
NOV 07 2016

Stafford Field Office  
Division of Water Resources

Point of Diversion File No. 49485



-  Authorized Place of Use
-  Proposed Place of Use
-  Current Geographic Center
-  Proposed Point of Diversion
-  Section Corner
-  Permitted Appropriation
-  Proposed new geo center

I declare that all water wells of any kind have been shown within 1/2 mile of our proposed point of diversion.

*Re Be*

Signature

RECEIVED

NOV 07 2016









Scale: 1 Inch = 2000 Feet

Application Map

	
Drawn By:	Jeff Lanterman - Stafford Field Office
Date:	11/2/2016
Revised:	





-  Authorized Place of Use
-  Proposed Place of Use
-  Current Geographic Center
-  Proposed Point of Diversion
-  Section Corner
-  Permitted Appropriation
-  Proposed new geo center

I declare that all water wells of any kind have been shown within 1/2 mile of our proposed point of diversion.

*Jeff Lanterman*

Signature

RECEIVED



Scale: 1 Inch = 2000 Feet

NOV 07 2016



### Application Map

Drawn By: Jeff Lanterman - Stafford Field Office

Date: 11/2/2016

Revised:



Stafford Field Office  
300 S. Main Street  
Stafford, Kansas 67578-1521

Jackie McClaskey, Secretary  
David W. Barfield, Chief Engineer  
Jeff Lanterman, Water Commissioner

Phone: (620) 234-5311  
Fax: (620) 234-6900  
[www.agriculture.ks.gov](http://www.agriculture.ks.gov)  
Sam Brownback, Governor

November 29, 2016

Arlen R & Nona G Becker  
1293 26<sup>th</sup> Ave  
Canton KS 67428

Re: Water Right, File No(s). 49485

Dear Water Right Owner:

Enclosed is the order executed by the Chief Engineer, Division of Water Resources, Kansas Department of Agriculture, approving the application for change under the above referenced file number(s).

Your attention is directed to the enclosures and to the terms, conditions and limitations specified in this approval for change. An acceptable water flow meter must be installed on your well before any water is applied as authorized under this change approval. A copy of the approved list of Certified Water Flowmeters as well as the regulations regarding the installation of flowmeters, measurement tubes and check valves can be found at <http://agriculture.ks.gov/divisions-programs/dwr/water-appropriation/water-flowmeters>. If you do not have access to the internet, please contact this office and we will send you a paper copy of the referenced information.

Since this order modifies the original document referred to above, it should be recorded with the Register of Deeds as other instruments affecting real estate.

This order requires that a notice and completion of works form be submitted once the diversion works are completed, including a properly installed flowmeter. This form is available at the referenced website.

Any abandoned well must be plugged in accordance with the requirements of Article 30 of the Rules and Regulations as adopted by the Kansas Department of Health and Environment.

Should you have any questions, please feel free to contact this office. If you wish to refer to a specific file, please reference it when you contact us.

Sincerely,

A handwritten signature in black ink, appearing to read "Jeff Lanterman".

Jeff Lanterman  
Water Commissioner

Enclosures  
pc: Water Rights Section

## CERTIFICATE OF SERVICE

On this **29 November 2016**, I hereby certify that the attached Change in Point of Diversion, File No. 49485 dated November 29, 2016 was mailed to the following:

Arlen R & Nona G Becker  
1293 26<sup>th</sup> Ave  
Canton KS 67428

pc: Water Rights Section

  
-----  
Staff

## Saryerwinnie, Tyler

---

**From:** Saryerwinnie, Tyler  
**Sent:** Monday, November 07, 2016 2:39 PM  
**To:** Meier, Matt (Matt.Meier@ks.gov)  
**Cc:** Conant, Cameron  
**Subject:** P/D Change Application - File No. 49485

Matt,

I have received a P/D Change Application for File No 49485 and I am needing a safe yield determination run for the proposed Geo Center of the battery.

Proposed Geo Center:  
Sec. 28, Twp 19S, Range 1W  
3388' N, 5158'W

Please let me know if you are needing any other information.

Thank you,  
Tyler

**Tyler Saryerwinnie**, Environmental Scientist  
Kansas Department of Agriculture  
Division of Water Resources  
Stafford Field Office  
Phone: (620)234-5311

**Analysis Results**

-----  
 The selected PD is in an area to new appropriations.  
 The safe yield, based on the variables listed below is 1,896.57 AF.  
 Total prior appropriation in the circle is 1,344.17 AF.  
 Total quantity of water available for appropriation is 552.40 AF.

**Safe Yield Variables**

-----  
 The area used for the analysis is set at 8,042 acres.  
 Potential annual recharge of the area is estimated to be 2.83 inches.  
 The percent of recharge available for appropriation is 100%.

Authorized Quantity values are as of 07-NOV-2016 and are based on Appropriated and Vested ground water right and possible stream nodes for GMD #2. Domestic, Term and Temporary water rights have been excluded.

There are 18 water right(s) and 27 point(s) of diversion within the circle.

File Number	Use	ST	SR	Q4	Q3	Q2	Q1	FeetN	FeetW	Sec	Twp	Rng	ID	Qind	Auth_Quant	Add_Quant	Tacres	Nacres
A 4306	00 IRR	NK	G					5230	2680	05	20	01W	1	WR	90.00	90.00	120.00	120.00
A 4753	00 MUN	NK	G		NE	SE	NE	0	0	32	19	01W	1	WR	178.92	178.92		
Same		MUN	NK	G		SW	NE	4089	1117	32	19	01W	6	WR				
A 4872	00 IRR	NK	G			NC	SE	1320	1330	32	19	01W	3	WR	140.00	140.00	136.00	136.00
A 18756	00 MUN	NK	G		NW	SW	NE	3879	2622	32	19	01W	7	WR	126.04	49.00		
A 23388	00 IRR	NK	G			N2	NW	5200	5200	04	20	01W	2	WR	79.00	79.00	83.52	83.52
A 24901	00 IRR	NK	G		NE	NE	SE	2600	500	33	19	01W	1	WR	24.00	24.00	42.00	42.00
A 28958	00 IRR	NK	G					4550	3200	04	20	01W	3	PD	41.00	41.00	72.90	72.90
A 29346	00 IRR	NK	G		SW	SW	NW	2800	5200	34	19	01W	1	WR	16.00	16.00	42.00	0.00
A 29347	00 IRR	NK	G			NC	NE	3900	1190	05	20	01W	4	WR	110.00	110.00	157.80	157.80
A 31698	00 IRR	NK	G					5230	2680	05	20	01W	1	WR	111.00	69.00	79.00	5.00
A 40618	00 IRR	NK	G					5280	112	06	20	01W	2	WR	88.00	88.00	77.40	77.40
A 42685	00 IRR	NK	G			NC	SE	1320	1330	32	19	01W	3	WR	42.00	42.00	136.00	0.00
A 45302	00 IRR	NK	G			NC	NE	3900	1190	05	20	01W	4	WR	145.75	34.75	157.80	0.00
A 47805	00 IRR	KE	G		NE	SE	SE	950	150	33	19	01W	3	WR	156.00	156.00	120.00	120.00
Same		IRR	KE	G		NE	SE	1220	250	33	19	01W	4	WR				
Same		IRR	KE	G		NE	SE	1220	50	33	19	01W	5	WR				
Same		IRR	KE	G		NE	SE	680	50	33	19	01W	6	WR				
Same		IRR	KE	G		NE	SE	680	250	33	19	01W	7	WR				
A 47837	00 IRR	LO	G		SW	SW	SE	75	2000	29	19	01W	5	WR	75.00	75.00	63.00	63.00
Same		IRR	LO	G		SW	SW	50	2100	29	19	01W	15	WR				
A 47846	00 IRR	KE	G		NE	NE	NE	5195	580	32	19	01W	8	WR	15.00	15.00	16.00	16.00
A 47977	00 IRR	KE	G		SE	NW	SE	1862	1802	21	19	01W	2	WR	6.50	6.50	5.00	5.00
Same		IRR	KE	G		NE	NW	2052	1766	21	19	01W	3	WR				
Same		IRR	KE	G		SW	NW	1672	1838	21	19	01W	4	WR				
A 49485	00 IRR	GY	G		SW	SW	NW	3078	4996	28	19	01W	11	WR	130.00	130.00	100.00	100.00
Same		IRR	GY	G		NW	SW	3328	4996	28	19	01W	12	WR				
Same		IRR	GY	G		SW	SW	2828	4996	28	19	01W	13	WR				
Same		IRR	GY	G		SW	SW	3036	4699	28	19	01W	14	WR				
Same		IRR	GY	G		SW	SW	3120	5292	28	19	01W	15	WR				

Safe Yield Report Sheet  
Proposed Water Right Application  
Point of Diversion in SWNWSWNW 28-19S-01W

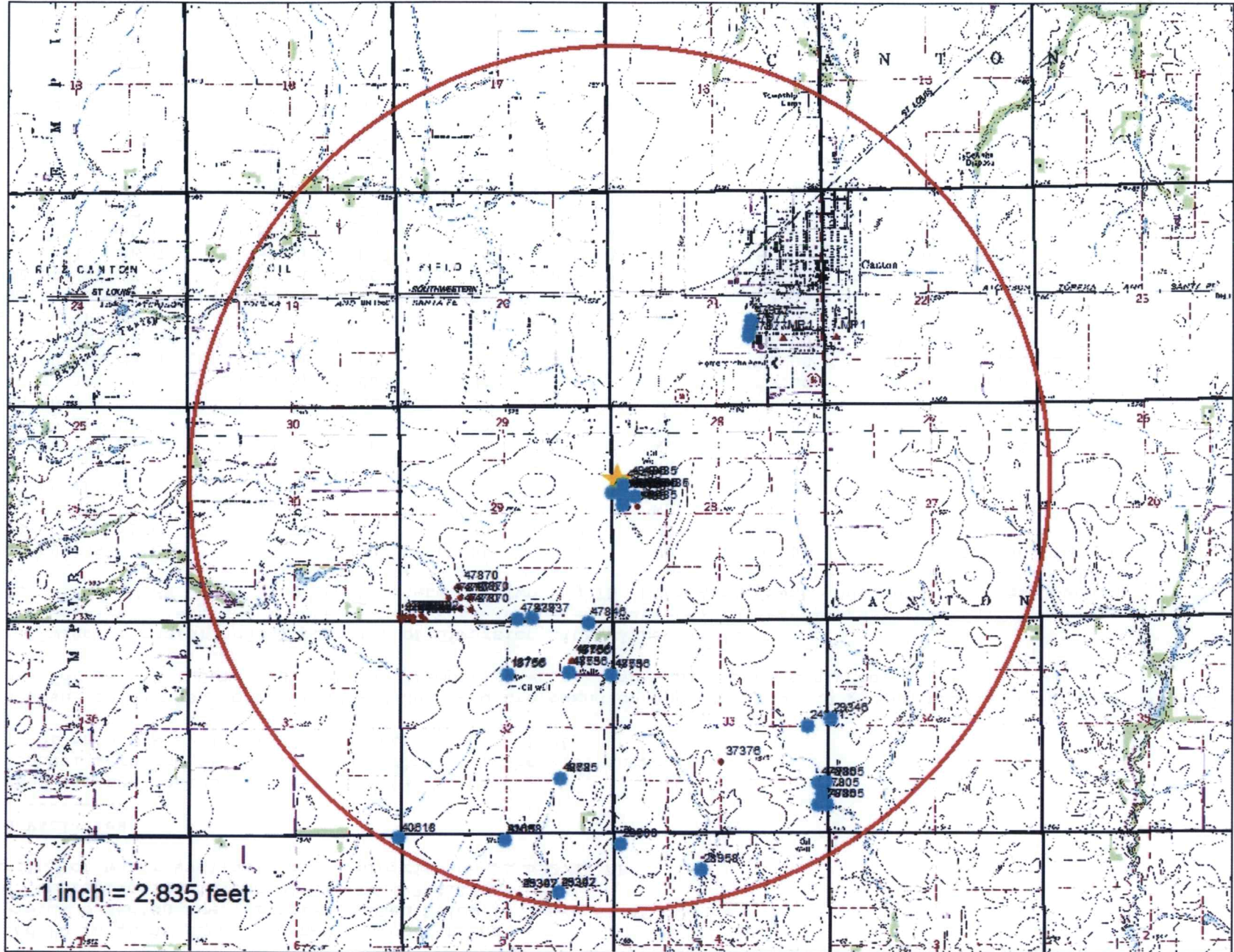

**KANSAS DEPARTMENT OF AGRICULTURE**  
**Division of Water Resources**

**M E M O R A N D U M**

**TO:** Files

**DATE:** November 28, 2016

**FROM:** Tyler Saryerwinnie

**RE:** Water Appropriation, File No. 49,485  
Nearby Owner Notification/Safe Yield

On November 7, 2016, Arlen Becker filed an application for approval to change the authorized point of diversion under File No. 49485 on behalf of Arlen R & Nona G Becker. This file is for irrigation use in the Little Arkansas River Basin and there are no overlaps.

File No. 49,485 authorizes a battery of four (4) wells in the Northwest Quarter of Section 28, Township 19S, Range 1W. The proposed change will move the geographic center approximately 350 feet NW of the currently authorized geographic center location of 3078 North and 4996 West of the southeast corner of Section 28. The change will also be eliminating one well from the battery, consequently creating a battery of three (3) wells.

The proposed well location appears to meet K.A.R. 5-25-2 *Well spacing* to other nearby wells. The application map indicates two (2) nearby domestic wells within one-half mile of the proposed geographic center. Notification letters were sent to each well owner with no responses received.

The same local source of supply will not change, which appears to be Undifferentiated Kansan/Nebraskan (180) based on available information. Because the file has not yet been formally completed, a safe-yield was run at the proposed geographic center location. The analysis determined that the application meets safe-yield requirements.

The file is not in a groundwater management district.

A water flow meter is required. A check valve is required if any chemical or foreign substance is injected into the water through the diversion works.

Based on the above discussion, that the change is reasonable, that impairment to existing water rights is unlikely, and that no change in the local source of supply will occur, it has been recommended that the referenced application be approved.

Tyler Saryerwinnie  
Environmental Scientist *TJS*

*\* 11/29/16  
Concur w/ Recommendation  
JK*